

ANN, HAZ-AL, TUFF M.C. DRILLING REPORT
1979 ASSESSMENT WORK FILING
GREENWOOD MINING DIVISION, B.C., CHRISTINA LAKE

TABLE OF CONTENTS

	PAGE NUMBER
DIAMOND DRILL LOG	1
CERTIFICATE	2
LOCATION MAP	3

HUNTER POINT EXPLORATIONS LTD.
1955 Creelman Avenue,
Vancouver, B.C. V6J 1B8.

RECEIVED

APR 19 1978

PETROLEUM RESOURCES
BRANCH

MINERAL RESOURCES BRANCH ASSESSMENT REPORT 6665 NO. _____

Chromex DDH #58, 1 Jan/78, dip= -83deg E.

- 0-16 Overburden.
 16-66 light grey dyke, fine grained alkaline porphyry with minor pyrite.
 66-90 medium grey-green porph with white phenocrysts oriented at at 80° to core.
 Minor pyrrhotite in small blebs as intergrain crystals. Phenos greenish white.
 75-80... lt grey porph. Fair amount of cubic pyrite. Fine crystals.
 80-90... medium, greygreen, fine grained but as above. Black phenos
 Fine 10mm veins of carbonatite/brucite(effervesces) with pyrite 10deg to core.
- 90-141 As in 80-90 but with large white angular phenos of plagioclase.
 141-166 Dark, greygreen serpentized dyke, with irregular flow structure. Grades into 90-140 as transition zone. Minor millerite (?).
 166-22- 169 Fault. In salt & pepper dyke. Fibrous, primitive asbestos.. mountain leather. Grey. Some brucite present.
 169-226 Dyke. Light grey. S&P. fibrous. Serpentinized. Minor pyrrhotite and millerite ? as at bottom of DDH5.
 209-226... Dark green, Almost as if altered UB (ore type).
 Many fine veins of brucite/carbonatite at 60deg to core.
 Fault at 226.5.
- 226-307 Normal UB- ore type, gabbro. Fine veins of altered UB at 40deg to core.
 290-300... dark grey UB fragmental. Minor sulfides, millerite ?
- 307-311 Lt grey porph dyke.
 311-401 As UB in DDH 17, with fine grained sulfides (millerite ?) & pyrrhotite.
 401-406 Lt grey dyke.
 406-407 Fault.
 407-680 UB type DDH17. Minor slip faults at all angles at various places.
 680-688 Lt greygreen serpentized dyke.
 688-829 UB as type DDH17.
 829-839 Faulted transition zone, probably at 50deg to core.
 839-947 Dyke, s&p, serpentized. Phenos green. Minor chalcopyrite in in fine quartz veins at 10deg to core.
 902-907... fault.
- 947-1067 UB. DDH17 type
 1067-1088 UB fragmental. Transition zone as about to phase into dyke, as per DDH17. Fragments and serpentine derivative (serpentinized dyke) at 40deg to core.

Magnetics: 193, 272, 317, 381 strong.

405-407 fault in medium magnetics, 428, 450, 456, 504 medium magnetic

543 weakly mag

634 med mag

662 strongly mag; 702, 745 strongly mag

776 me mag 809 strongly mag

809, 844, 880, med mag.

945 weakly mag 925

934 med mag, (929 s&p dyke), 952 med mag. 965 strongly mag, 993 med mag

1019 strongly mag, 1034 very strongly mag, 1058 strongly mag. 1077 very st

strongly mag. 1086 very strongly magnetic- maf.

Michael Hutter

Your File No 166- Greenwood.

ANN. HAZ-AL, HUP, TUFF M.C. DRILLING REPORT.

1976 ASSESSMENT WORK FILING .

I Michael Hretchka of 1955 Greelman Ave Vancouver B.C. V6J 1B8 do hereby certify.

1. That I am a prospector and the mine manager for Hunter Point Explorations Ltd owner and operator of the aforementioned mineral claims.
2. That I am the holder of F.M.C. No 153759.
3. That DDH No 1 -1977 was drilled during 1977 to a depth of 1100 feet under my personal on site supervision.
4. That total costs apportioned to drilling during 1977 at \$20,400.00 are reasonable and proper and competitive.
5. That DDH No 1-1977 is carried on the records of the company as DDH No 58 and that this hole was collared at a dip of 83 degrees east.
6. That the location of the drill Hole is as set out in the Form " B " Affidavit Application to record work.
7. That the location of the drill Hole is approx 49 degrees 1 degree north and 118 degrees 10 minutes west.
8. That the diamond drill core is available for inspection at 105 West 6th Ave Vancouver B.C. V5Y 1K3.
9. That the log of the said Hole is attached hereto.

JANUARY 18 1978.



MICHAEL HRETCHKA

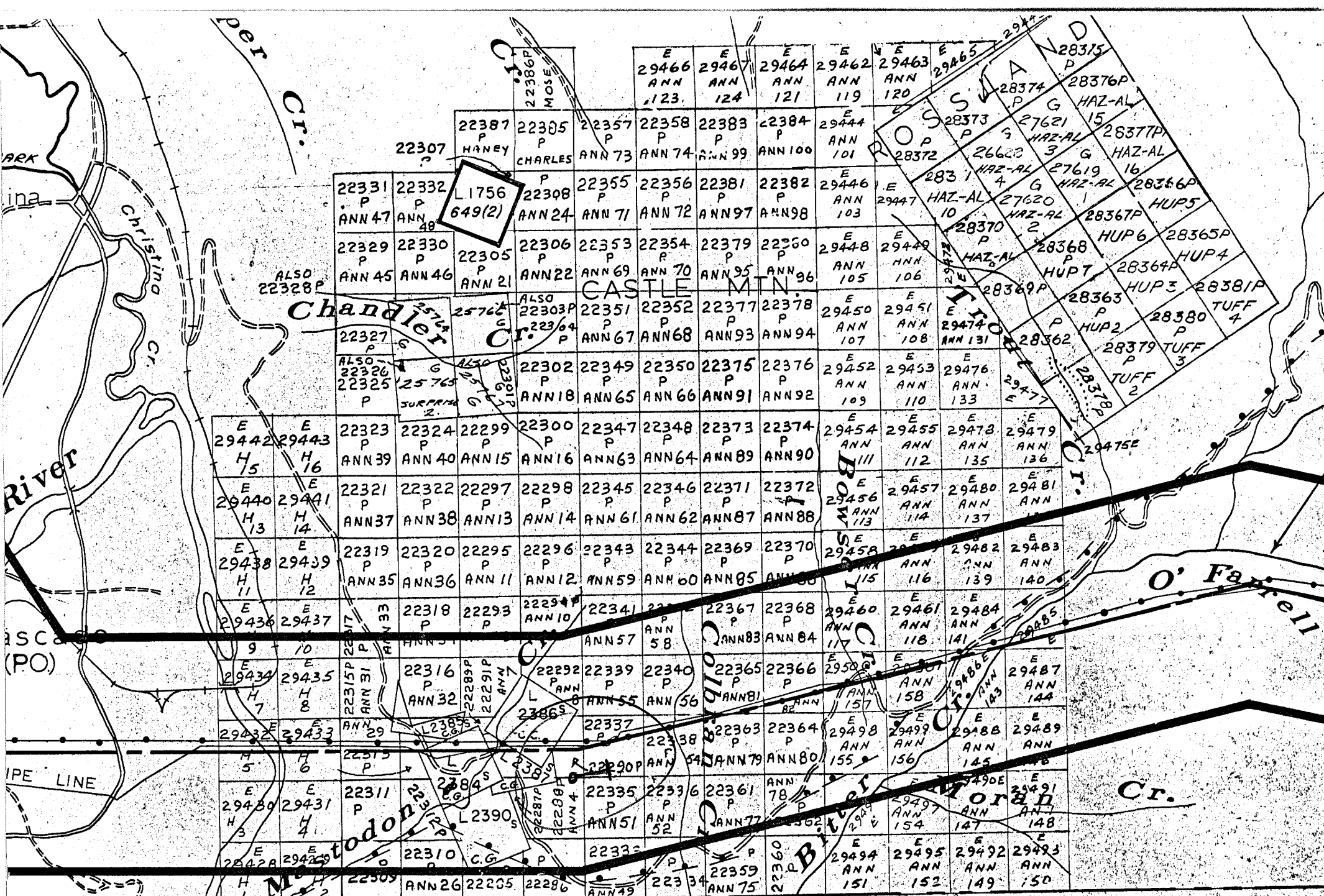

APPROXIMATE
LOCATION
DDH-98

International Boundary