

TABLE OF CONTENTS

STATEMENT OF EXPENDITURES

STATEMENT OF QUALIFICATIONS

LOCATION MAP 1:250,000

TRENCH LOCATION 1: 50,000

TRENCHES 1, 2, 10

TRENCHES 3, 4

TRENCHES 5, 11

TRENCHES 6, 7, 8

TRENCH 9

Part 1 of 2

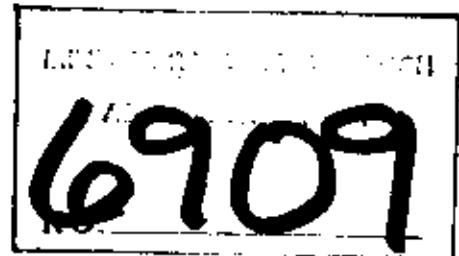

COMINCO LTD.

EXPLORATION  
N.T.S. 82M/13E

WESTERN DISTRICT  
6 OCTOBER 1978

"EXHIBIT A"

STATEMENT OF EXPENDITURES

TRENCHING PROGRAM ON CK MINERAL CLAIMS

KAMLOOPS MINING DIVISION BRITISH COLUMBIA

Latitude: 51°55'N

Longitude: 119°35'W

Dates of Work: This statement covers bulldozer trenching work carried out during June 15,16,17,19,24,26; August 18,19,20.

I. Caterpillar Work

June

Truck - moving Cat		
4 trips @ \$100	\$ 400	
2 hrs. standby @ \$50	100	
Cat work - 37.4 hrs. @ \$32.50	<u>1,215</u>	\$ 1,715

August

Truck - moving Cat		
2 trips @ \$100	200	
Cat work - 20.3 hrs. @ \$32.50	<u>660</u>	860

II Supervision and Hand Work

M.R. Murrell (Project Geologist)		
5 days @ \$150	750	
M. Siefert (student) - 5 days @ \$60	<u>300</u>	1,050

III Assaying & Geochemistry

35 rock samples, 44 geochemical samples		497
---	--	-----

IV <u>Miscellaneous (truck rent, shipping, domicile, etc.)</u>		300
--	--	-----

V Total Costs of Trenching Program

I	Cat Work	\$ 2,575
II	Supervision	1,050
III	Assaying	497
IV	Miscellaneous	300
	Total:	<u>\$ 4,422</u>

VI Costs per cubic metre =  $\frac{4422}{7950}$  = \$0.556

VII Cost Per Trench:

<u>Trench No.</u>	<u>Volume</u>	<u>Cost</u>
Trench No. 1	1100 cu m	\$ 569
2	650	369
3	625	329
4	450	231
5	950	482
6	1950	1,171
7	450	255
8	150	74
9	812.5	544
10	562.5	277
11	<u>250</u>	<u>123</u>
Totals:	7950 cu m	\$4,422

Report by: *M.R. Murrell*  
M.R. Murrell  
Project Geologist

Approved for  
Release by: *D.W. Heddle*  
D.W. Heddle  
Assistant Manager  
Exploration

MRM/gk

STATEMENT OF QUALIFICATIONS

I, Michael R. Murrell, hereby state that I was graduated from the University of Alberta with an Honours degree in Geology, in 1966. During my undergraduate years I was seasonally employed by B.A. Oil (now Gulf) and by a small mining exploration company. Upon graduation I commenced employment with Cominco Ltd. During the past thirteen years I have been engaged in several different projects dealing with mining exploration.

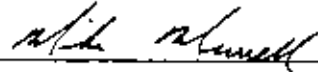

---

M. R. Murrell

MRM/pm  
6 October 1978

Trench 3

Green, D1108

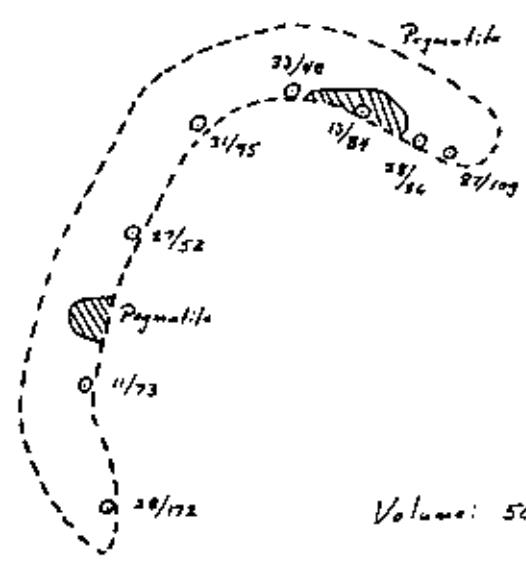
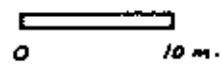

Volume:  $50m \times 5m \times 2.5m = 625 \text{ cu. m.}$

Legend:  
 11/73 - Geochronol Sample  
 ppm Pb/ppm Zn  
 No Assay Samples Cut.

Located on CK3 Claim

Trench 4

Green, D1108

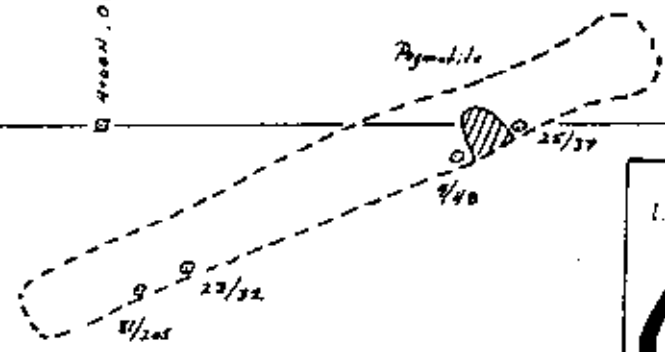
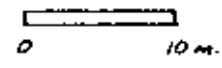

part 1 of 2

6909

Volume:  $45m \times 5m \times 2m = 450 \text{ cu. m.}$

Legend:  
 23/32 - Geochronol Sample  
 ppm Pb/ppm Zn  
 No Assay Samples Cut.

Located on CK 11 Claim.



Drawn by: MRM		Traced by:	
Revised by	Date	Revised by	Date

CK PROPERTY  
 TRENCHES 3, 4

M.R.M.

Scale: 1:500      Date: Aug 31, 1978      Plate:

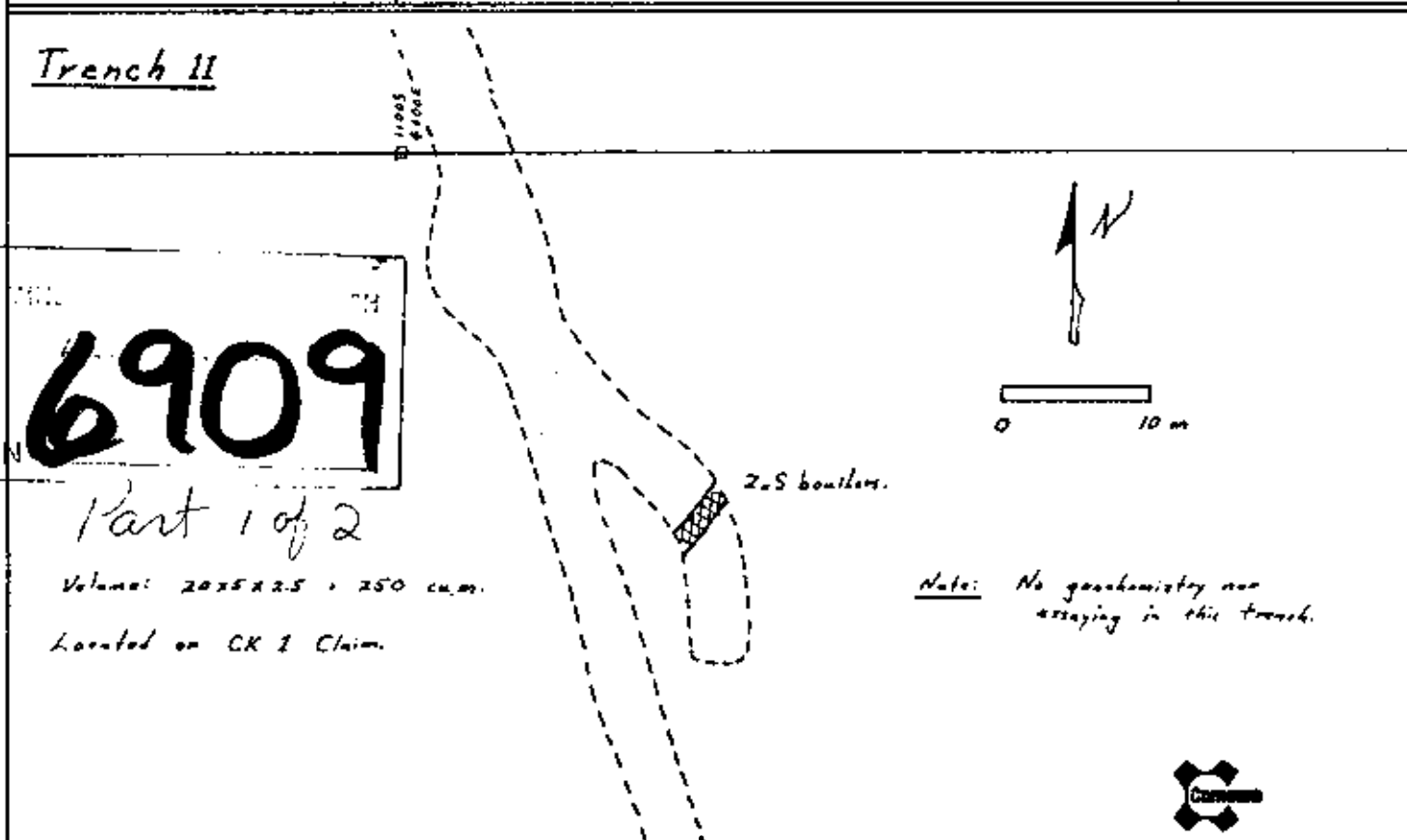
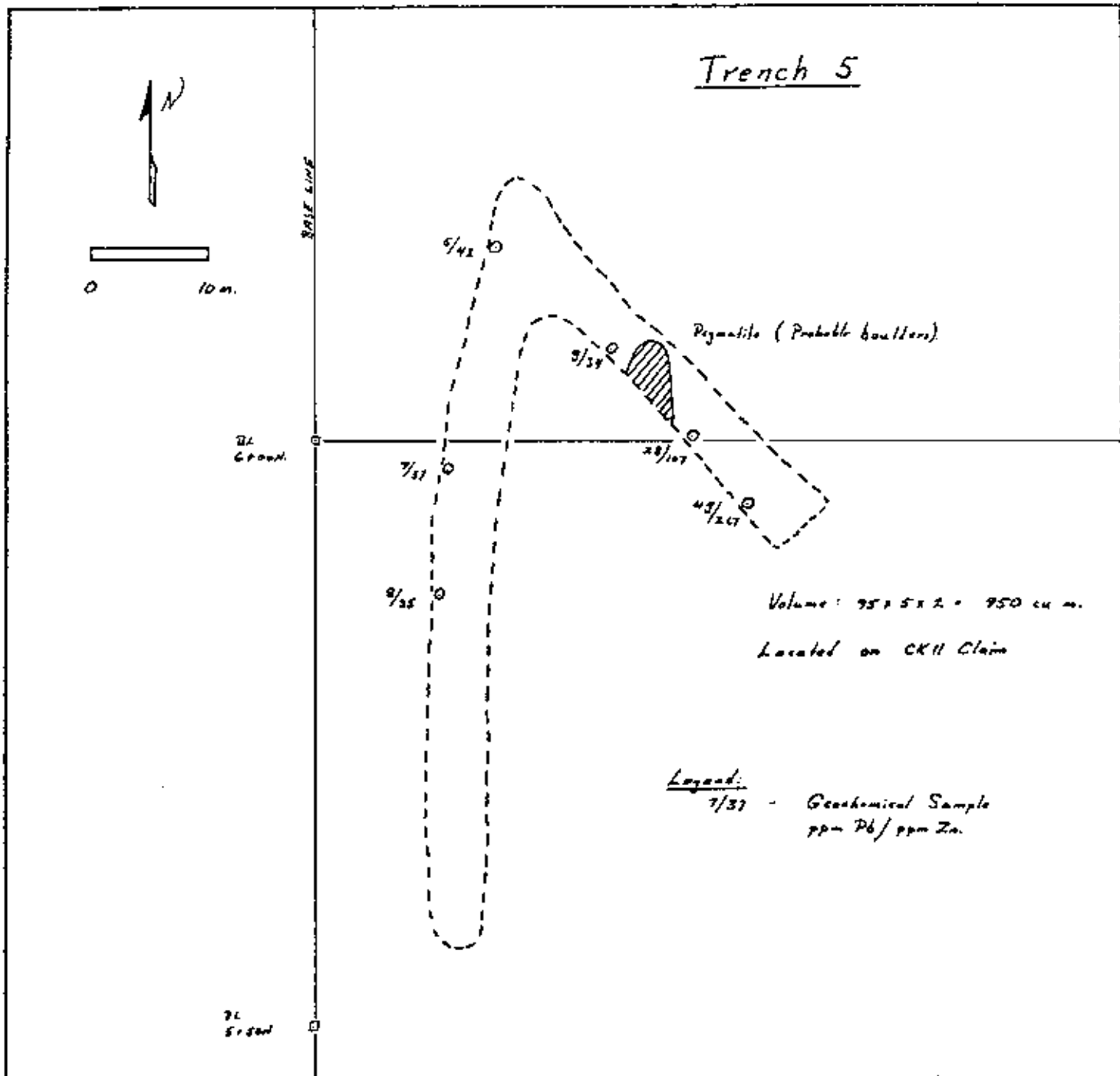

Drawn by: MRH		Traced by:		<p>CK PROPERTY <span style="float: right;">MRH</span></p> <p>TRENCHES 5, 11.</p>
Revised by	Date	Revised by	Date	
Scale: 1/500		Date: Aug 31, 1970		Plate:

Trench 8

Volume:  $10 \times 10 \times 1.5 = 150 \text{ cu. m.}$

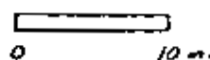

Trench 7

Volume:  $25 \times 12 \times 1.5 = 450 \text{ cu. m.}$

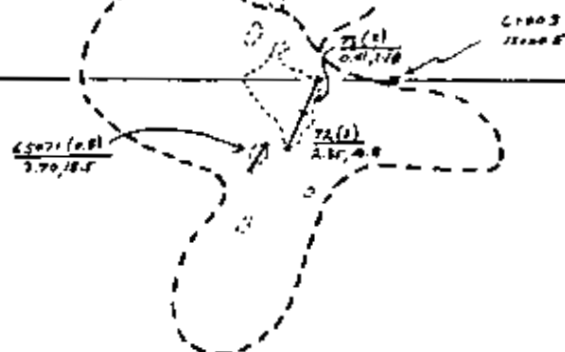

Trench 6

Volume:  $65 \times 20 \times 1.5 = 1950 \text{ cu. m.}$

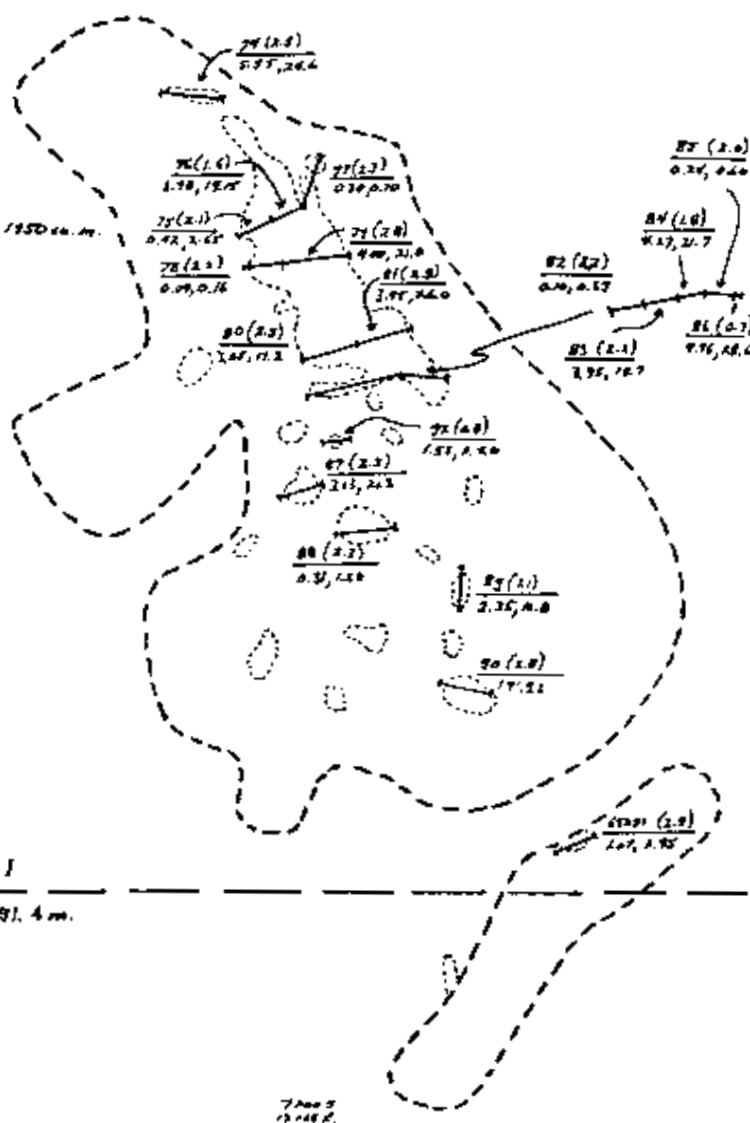

Legend

80 (2-5)      Sample No. (meters)  
 200, 17.2      76, 72

Note: all sample nos. are prefixed 650  
 - These samples located on  
 claim CK 84

6909

Part 1 of 2

1/4 Sec. CK-1  
 - 45°, 91.4 m.



Drawn by: MRM.		Traced by:	
Revised by	Date	Revised by	Date

CK PROPERTY  
 TRENCHES 6, 7, 8

MRM

Scale: 1:500

Date: Sept 2, 1953

Plate:

# Trench 9

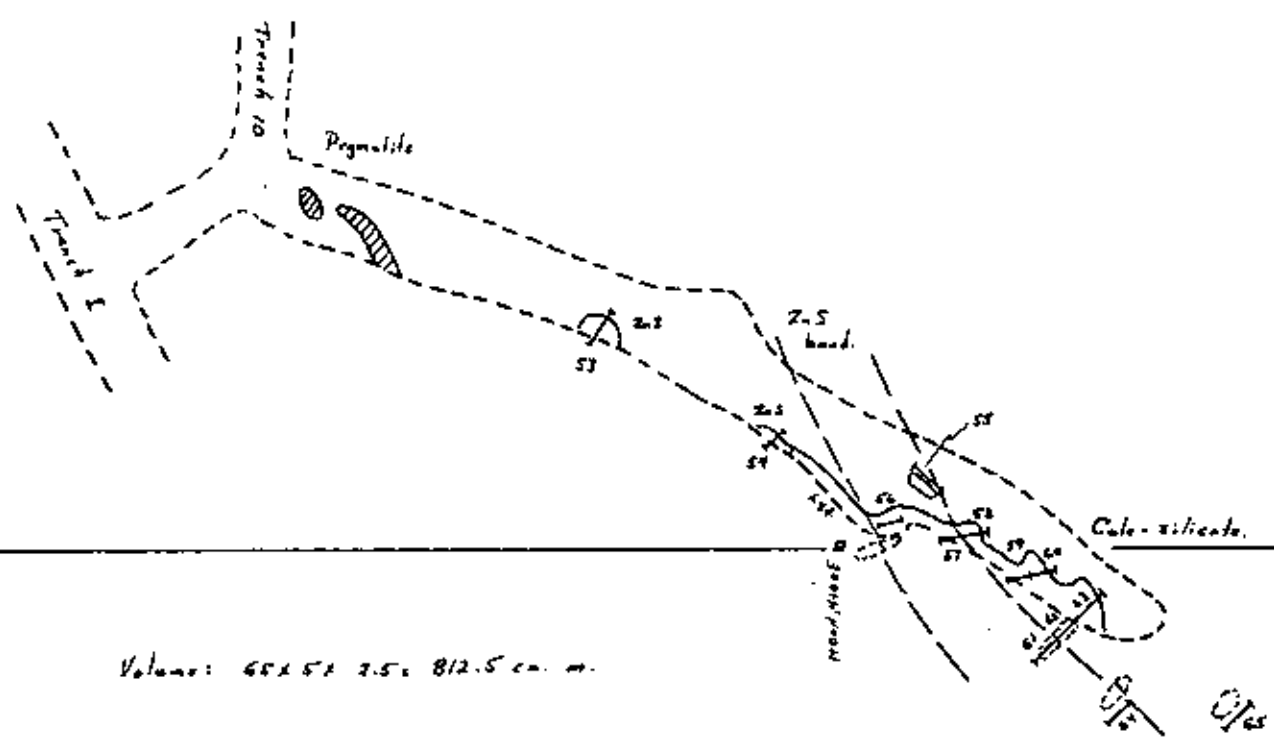
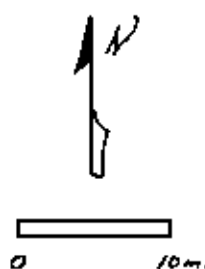

Volume:  $65 \times 51 \times 2.5 = 812.5 \text{ cu. m.}$

Assays:

Note All Sample Nos. are prefixed 651.

No.	Length	% Pt	% Zn
65153	1.5m	4.75	21.40
65154	1.2m	6.00	26.70
65155	1.7m	4.75	21.60
65156	2.0m	4.33	23.00
65157	1.0m	5.15	23.25
65158	2.3m	2.90	20.00
65159	1.5m	2.98	19.10
65160	0.8m	0.19	1.20
65161	1.9m	3.05	11.30
65162	2.4m	3.05	7.50
65163	2.7m	0.51	4.80
65164	2.5m	4.25	10.00
65165	1.7m	0.97	0.51

INDUSTRIAL PATENT OFFICE  
**6909**

Part 1 of 2

Note:  
 No geochemical samples were taken from this trench.

Located on CK 3 Claim.

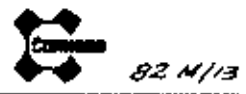

Drawn by:	MRM.	Traced by:	
Revised by:	Date	Revised by:	Date

CK PROPERTY  
 TRENCH 9

MRM.

Scale: as shown      Date: Aug 21, 1979      Plate:



2100 N, 3100 E

All trenches located on CK3 claim.

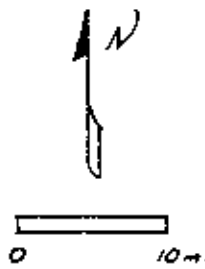

Pyromphite  
108/225

### Trench 1

Volume 1102.5 x 2 m = 1100 cu. m.

41/270

Pyromphite  
15/516

Geochemical Profile:

Pb/Zn (pp.m.)

15/121
24/73
21/147
39/160
14/191

Siliceous  
Biotite  
Gneiss

### Trench 10

Volume: 45m x 5m x 2.5m = 562.5 cu. m.

#### Legend:

7/154 - Geochemical Sample  
ppm Pb/ppm Zn.

# 6909

Part 1 of 2

### Trench 2

Volume: 652.5 x 2 = 650 cu. m.

1100 N, 3100 E

38/167

28/172

14/188

24/185

26/159

24/197

22/185

62/180

124/100

Biotite  
Gneiss  
Foliation 330°/4d.

Geochemical Profile:

Grab Sample: 0.06% Cu  
0.18% Pb  
0.022% Zn

Pb/Zn (pp.m.)

13/230
4/130
9/134
24/286
14/265

208 CK-3

Drawn by: MRM	Traced by:		
Revised by	Date	Revised by	Date

## CK PROPERTY - CK 3 claim

### TRENCHES 1, 2, 10

M/RML

Scale: 1" = 500'

Date: July 31, 1978

Plate:



120°00'

45'

30'

52°00'

45'

To Clearwater - 2 miles  
To Kamloops

30'

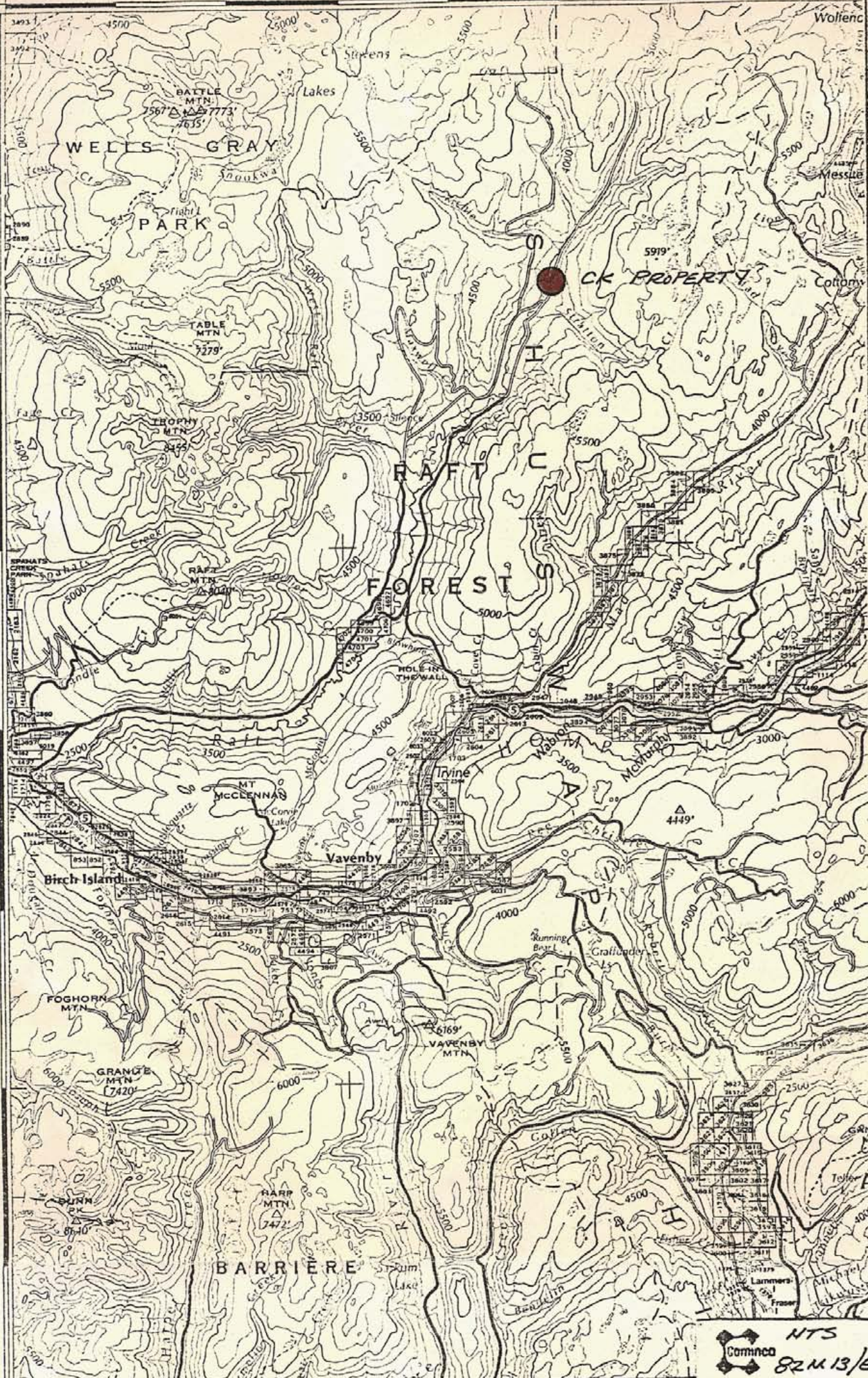

NTS  
Cominco  
82M13/E

Drawn by:  
Revised by: Date  
Revised by: Date

**6909**

Part CK PROPERTY  
1 of 2 LOCATION MAP

MRM

Scale: 1:250,000

Date: OCT. 6, 1978

Plate:



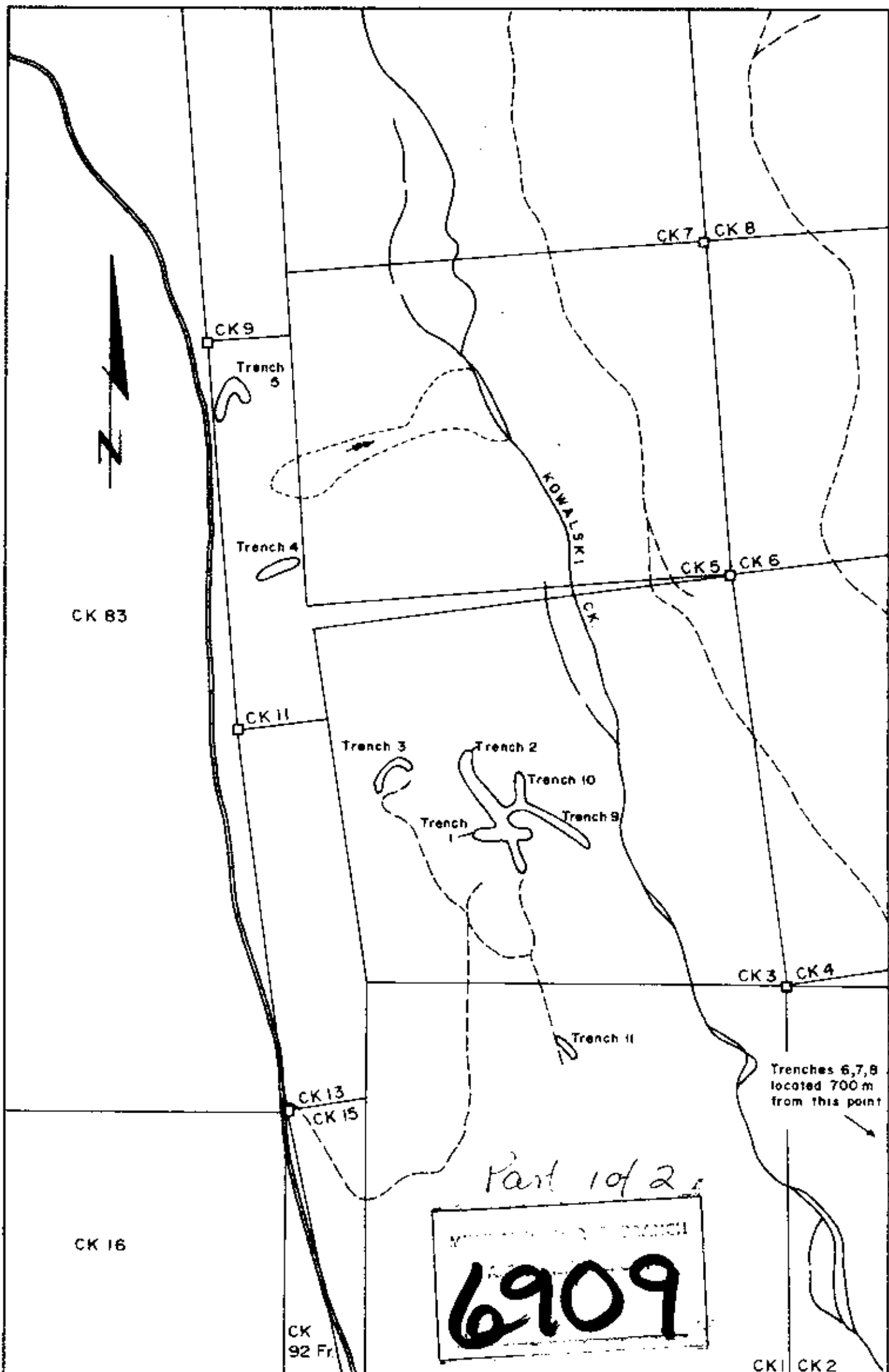

Drawn by: MRM		Traced by:	
Revised by	Date	Revised by	Date

**CK PROPERTY**  
**TRENCH LOCATION**

NTS 82 M13/E  
Scale: 1:5,000      Date: October 6, 1978      Plate: