

COMINCO LTD.

RECEIVED

EXPLORATION DIVISION

OCT 19 1978

WESTERN DISTRICT  
GOLD COMMISSIONER  
FORT STEELE MINING DIVISION  
CRANBROOK, B.C.

DIAMOND DRILLING REPORT

VINE NO. 29 CLAIM

NTS 82G/5W

Fort Steele Mining Division

OCTOBER 1978

Latitude: 115° 53'

Longitude: 49° 21'

Report by:

G.L. WEBBER  
Geologist

Kootenay Exploration  
2450 Cranbrook Street  
Cranbrook, B.C.  
VIC 3T4

MINERAL RESOURCES BRANCH  
ASSESSMENT REPORT

NO. 6936

Under the supervision of:

E.A.U. PARVIAINEN  
Geologist

## TABLE OF CONTENTS

	PAGE
GENERAL STATEMENT	1
INTRODUCTION	
General	1
Location and Access	1
EXHIBIT "A"	2
AFFIDAVIT	3
STATEMENTS OF QUALIFICATIONS	4 & 5
SUMMARY LOGS AND ASSAYS - Detailed cost per metre	
ATTACHMENTS	
Location and Plan of Drilling Area	
Plate V-78-1 (in pocket)	
Plate V-78-2 Drill Hole Section (in pocket)	
Detailed Diamond Drill logs	

COMINCO LTD.

EXPLORATION DIVISION

WESTERN DISTRICT

VINE GROUP 29

Fort Steele Mining Division

-----

GENERAL STATEMENT

This report describes the results and expenditures relating to diamond drilling on the Vine No. 29 claim.

Diamond drilling was performed during July and August 1978.

Total expenditures relating to this diamond drill program amounted to \$70,831.00.

It is requested that \$56,400 be applied as followed:

VINE 29 (12 units) 1 year @ \$100 and 8 years @ \$200. . . .	\$ 20,400
VINE 26 (20 units) 2 years @ \$100 and 8 years @ \$200.. . .	36,000
	<u>\$ 56,400</u>

It is requested that \$14,430 be applied to Cominco Ltd. PAC account.

INTRODUCTION

General

Two DD Holes were collared on the Vine No. 29 claim. DD Hole V-78-3 (HW) was collared on July 12th and abandoned in overburden on July 15th, after drilling 28.05 metres. DD Hole V-78-3A (HQ/NQ) was collared on July 17th and completed August 15th at a depth of 598.02 metres. The objective of this drill program was to test for stratiform Pb/Zn mineralization in the Aldridge Formation. Drilling was performed by Shepherd Enterprises Ltd., 1215 West 7th Avenue, Vancouver, B.C.

Plate V-78-1 shows plan location of each hole.

The drill program was under the direction of E.W. Batchelor and supervised by E.A.U. Parviainen.

Location and Access

The centre of the claim block is approximately 18 km SSW of Cranbrook. Access to the drill site is via paved and secondary gravel roads leading from Highway 3/95. Elevation of the Vine property ranges from 935 m to 2140 m.

Statement of Expenditures

VINE 29 CLAIM

Fort Steele Mining Division

Diamond Drilling - Indirect

Salaries: (field)

E.W. Batchelor (Geologist) 7 days @ \$117. . . . .	\$ 819.00
E.A.U. Parviainen (Geologist) 14 days @ \$130. . . . .	1,820.00

Salaries: (office)

G.L. Webber (Geologist) report and map preparation - 3 days @ \$102. . . . .	306.00
---	--------

Transportation:

Ford 4 x 4 1/2 ton - 1 month @ \$600 including gas . . . . .	600.00
--	--------

SUB-TOTAL . . . . .	3,545.00
---------------------	----------

Diamond Drilling - Direct

Shepherd Enterprises Ltd., 1215 W. 7th Avenue, Vancouver, B.C.

DD Hole V-78-3 28.05 m @ \$358.25. . . . .	\$10,049.00
DD Hole V-78-3A 598.02 m @ \$95.71. . . . .	57,237.00

SUB-TOTAL . . . . .	\$67,286.00
---------------------	-------------

TOTAL EXPENDITURES . . . . .

Diamond Drilling - Indirect. . . . .	\$ 3,545.00
Diamond Drilling - Direct. . . . .	67,286.00

\$70,831.00

This is Exhibit "A" to the Statutory Declaration of G.L. WEBBER declared before me this 19 day of October, 1978.

Marilyn A. Thompson  
A Commissioner for taking Affidavits for the Province of British Columbia.

IN THE MATTER OF THE

3

B.C. MINERAL ACT

AND

IN THE MATTER OF A DIAMOND DRILL PROGRAM

CARRIED OUT ON THE VINE 29 MINERAL CLAIM

MONROE LAKE AREA

in the Fort Steele Mining Division  
of the Province of British Columbia.

More Particularly N.T.S. 82G/5W

A F F I D A V I T

I, G.L. WEBBER, of the City of Kimberley, in the Province of British Columbia, make Oath and say:

1. That I am employed as a Geologist by Cominco Ltd. and as such, have a personal knowledge of the facts to which I hereinafter depose:
2. That annexed hereto and marked as Exhibit "A" to this my Affidavit is a true copy of expenditures incurred on a diamond drill programme, on the Vine 29 Mineral Claim.
3. That the said expenditures were incurred between the 1st day of July, 1978 and the 15th day of October, 1978, for the purpose of mineral exploration on the above noted claim.

Sworn Before Me at Granbrook  
in the Province of British Columbia,  
this 19 day of October, 1978.)

G.L. Webber  
G.L. WEBBER

Marilyn A. Ferguson  
A Commissioner for taking Affidavits  
in the Province of British Columbia. )

EXPLORATION DIVISION

WESTERN DISTRICT

STATEMENT OF QUALIFICATIONS

E.W. BATCHELOR graduated from U.B.C. during 1966 with a B.A.Sc degree in Geological Engineering.

Since that time he has been employed in various phases of base metal exploration.

He is registered as a Professional Engineer in British Columbia (Reg. No. 11335).

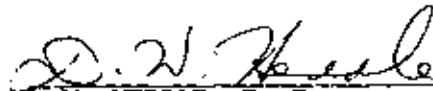

D.W. HEDDLE, P. Eng.  
Assistant Manager,  
Western District Exploration.

EXPLORATION DIVISION

WESTERN DISTRICT

STATEMENT OF QUALIFICATIONS

G.L. WEBBER has personally conducted many types of mineral exploration work for Cominco Ltd. over the last twenty-five years.

I consider him well qualified to prepare this report.

  
\_\_\_\_\_  
D.W. HEDDLE, P. Eng.  
Assistant Manager  
Western District Exploration.

COMINCO LTD.

EXPLORATION DIVISION

WESTERN DISTRICT

Diamond Drilling Report

Vine No. 29 Claim

Fort Steele Mining Division

SUBMITTED BY:

  
G.L. WEBBER  
Geologist

ENDORSED BY:

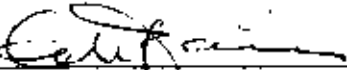
  
E.A.U. PARVIAINEN  
Geologist

APPROVED FOR  
RELEASE BY:

  
D.W. HEDDLE, P. Eng.  
Assistant Manager,  
Western District Exploration.

October 1978



DDH	Core Size	Commenced Completed		Overburden			Bedrock			Total Drilled		
				1	2	3	1	2	3	1	2	3
V-78-3	HW	July 12	July 15	28.05	1855.05	66.13	-	-	-	28.05	1,855.05	66.13
V-78-3A	HQ/NQ	July 17	Aug. 15	3.35	219.76	65.60	594.67	40,936.14	68.84	598.02	41,155.90	68.82
				Mud	Cost	Misc.	Charges	Material Consumed		Hourly Charges		
				2	3	2	3	2	3	2	3	
V-78-3	HW	July 12	July 15	857.69	30.58	-	-	1,487.10	53.02	1,972.00	70.30	
V-78-3A	HQ/NQ	July 17	Aug. 15	3,870.78	6.47	-	-	538.53	.90	8,666.00	14.49	
				Rd.	Bldg. & Site Prep.		Water	Cost	Moves		Mobilization	3rd Party Costs
				2	3	2	3	2	3	2	3	
V-78-3	HW	July 12	July 15	2,250.00	80.21	-	-	1,627.07	58.01	-	-	
V-78-3A	HQ/NQ	July 17	Aug. 15	200.00	0.33	130.00	0.22	2,522	4.22	-	154.77 0.26	
				DDH	BY	DDH						
				1	2	3						
V-78-3	HW	July 12	July 15	28.05	10,049.01	358.25						
V-78-3A	HQ/NQ	July 17	Aug. 15	598.02	57,238.48	95.71						

1. Metres drilled )  
2. Total cost )  
3. Cost per metre ) Can \$  
\* Drilling Cost per metre )  
\*\* Other costs per metre )

# Diamond Drill Geological Log



Objective: To test for stratiform Pb-Zn mineralization in the Aldridge Formation.

Sampled: No sampling for assays

Logged By: E.A.U. PARVIAINEN Date: Sept. 5, 1978

Composites:

Scale

Core Plot & Dip One Diagonal Area

Block: \_\_\_\_\_ Sect: \_\_\_\_\_ Place: VINE 29 M.C. App. Bear: Collar Az. 190° App. Dip: Collar: -75° Length: 598.0m

From m	To m	Discard	Reason
0	3.4	CASED:	No core.
3.4	13.1	QUARTZITIC WACKE:	Dominantly medium-grained, medium- to very thick-bedded, light to dark grey quartzitic wackes with minor fine-grained, thick-laminated dark grey subwackes. Bedding at 90° to core axis.
13.1	13.6	SUBWACKE:	Fine-grained, thin-laminated to very thin-bedded, light to dark grey subwackes. Bedding at 90° to core axis.
13.6	27.7	QUARTZITIC WACKE:	Dominantly medium-grained, thin- to thick-bedded, light to dark grey quartzitic wackes with occasional intersections of thin-laminated to very thin-bedded subwackes. Bedding at 85-90° to core axis.
27.7	71.9	QUARTZITIC WACKE:	Fine- to medium-grained, mainly medium- to thick-bedded, light to dark grey quartzitic wackes. Bedding at 85-90° to core axis.
71.9	80.0	QUARTZITIC WACKE:	As above except for generally decreasing bedding thickness.
80.0	83.7	SUBWACKE:	A sequence of thin- to thick-laminated, fine-grained, dark grey subwackes and wackes. Bedding at 80-85° to core axis.

Core Size  
 HQ from 0 to 300.5 m  
 NQ from 300.5 to 598.0m

Form No.

V-78-3A

Page

1/4

# Diamond Drill Geological Log



Objective:		Sampled		No Scale		
Logged By:		Date:	Composites:	Color Plot & Pos.	Use Classes & Aver.	
Block	Seal	Place	App. Bed:	App. Dip:	Length	
		VINE 29 M.C.	Collar Az. 190°	Collar: -75°	598.0m	
From m	To m	Discard	Remarks			
85.2	92.4		QUARTZITIC WACKE: dominantly thin- to thick-bedded, fine- to medium-grained, light to dark grey quartzitic wackes with minor fine-grained, very thin-bedded wackes. Bedding at 85-90° to core axis.			
92.4	94.6		SUBWACKE: A thin-laminated to thin-bedded, fine-grained sequence of subwackes with minor thin-laminated argillite. Bedding at 85-90° to core axis.			
94.8	158.0		QUARTZITIC WACKE: Mainly very thin to very thick-bedded, medium- and fine-grained, light to dark grey quartzitic wackes with minor thin-laminated, fine-grained subwacke and argillite sequences which rarely show cross-laminations. Bedding at 75-90° to core axis.			
158.0	165.7		WACKE: dominantly thin- to medium-bedded, fine- to medium-grained, grey to dark grey wackes with minor thin-laminated to thin-bedded subwacke and argillite. Occasional minor convolute laminations in argillitic sequences do occur.			
165.7	191.1		WACKE/SUBWACKE: Thin-laminated to medium-bedded, dominantly fine-grained, grey to dark grey wackes and subwackes. Bedding at 65-85° to core axis.			
				Core Size	HQ From 0 to 300.5 m NQ From 300.5 to 598.0m	
				Core No.	V-78-SA Page 2/4	

# Diamond Drill Geological Log



Objective:		Sampled:		40 Scale	
Logged By		Date:	Composited:	Color Plot & Dip:	Ore Grades & Aver:
Block:	Sect:	Place:	App. Bear:	App. Dip:	Length:
		VINE M.C. 29	Collar Az. 190°	Collar: -75°	598.0 m
From	To	Discard	Reason:		
191.1	194.5		SUBWACKE/ARGILLITE: Very thin-laminated to very thin-bedded, fine-grained, grey and brownish subwackes and argillites with minor pyrrhotite disseminated and along bedding planes. No assays. Bedding at 75-80° to core axis.		
194.5	198.7		LITHIC WACKE: Generally a massive, non-graded, lithic wacke with small- to medium-sized, rounded to sub-angular clasts imbedded in medium-grained, light grey wacke matrix. Clast content less than 20%. No foreign clasts observed.		
198.7	485.6		MOYIE INTRUSIVE: A medium- to coarse-grained gabbro sill with sharp foot- and hangingwall contact. Drilling encountered broken ground and an artesian well at depth of 300.5 m. Core site was reduced from HQ to NQ.		
485.6	496.1		WACKE/SUBWACKE: Dominantly laminated to thin-bedded, fine-grained, grey to dark grey wackes and subwackes with minor fine-grained, thin-laminated argillites. Bedding at 80-90° to core axis.		
			Core Size	HQ from 0 to 300.5m NQ from 300.5 to 598.0m	
			File No.	V-78-1A Page 3/4	

# Diamond Drill Geological Log



Objective:		Sampled:		40 Scale		
Logged By:		Date:	Composites:		Color Plot & Dip	Core Cleaned & Assay
Block	Section	Piece	App. Bear:	App. Dip:	Length	
		VINE M.C. 29	Collar Az. 190°	Collar: -75°	598.0m	
From	To	Discard:	Reason:			
496.4	538.6	MOVIE INTRUSIVE:	Dominantly medium-grained, greenish gabbro sill with sharp foot- and hangingwall contacts.			
538.6	590.0	WACKIE/SUBWACKIE:	Thin-bedded to thin-laminated, fine-grained, light to dark grey wackew and subwackes. Bedding at 80 to 90° to core axis.			
END OF DDH V-78-3A.						
CORE STORED AT SULLIVAN MINE, KIMBERLEY, B.C.						
			Core Size HQ from 0 to 300.5 m NQ from 300.5 to 598.0m			
			Hole No. V-78-3A		Page 4/4	

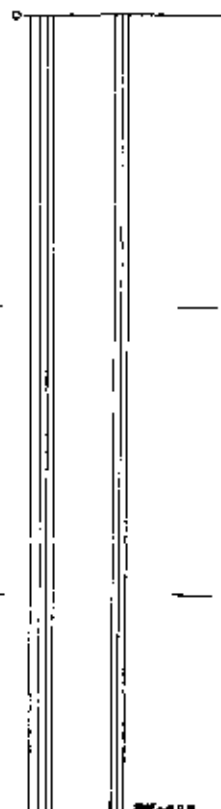

# Diamond Drill Geological Log



Objective: To test stratiform Pb/Zn mineralization  
in the Aldridge Formation.

Sampled: No sampling for assays

Logged By: E. A. H. PARTAINEN

Date: Aug. 17, 1978

Compositer:

Block: Sect: Piece: VINE 29 M.C. App Bear: 190° App Dip: -75° Length: 28.0m

From To Discard

Reason:

0 28.0 CASED: No core. Hole was still in overburden due to the difficulties with casing.

END OF DDH V-78-3.

CORE STORED AT SULLIVAN MINE, FIMBERLEY, B.C.

Core Log

File No V-78-3

Page 1/1

# of Bore	Color, Incl. & Dip	Core Classes & Area
0		

V-78-3 COLLAR: EL. 1170 m AZ. 180° DIP. -75°  
 V-78-3A COLLAR: EL. 1180 m AZ. 190° DIP. -75°

ABANDONED AT 28.5 m

1100 m

Qw & W

1000 m

W & Sw

900 m

MINERAL RESOURCE DESIGNATION  
 ALL INFORMATION  
**6936**  
 NO.

LEGEND

- Q GABBRO
- Qw QUARTZITIC WACKE
- W WACKE
- S SUBWACKE

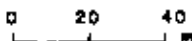

END OF HOLE

598 m

Drawn by: E.W.S.		Traced by: R.V.K.	
Revised by	Date	Revised by	Date

VINE DDH'S  
 V-78-3 V-78-3A

NTS 529/SW

Scale: 1:2000

Date: OCT. 12 1978

Plate: V-78-2

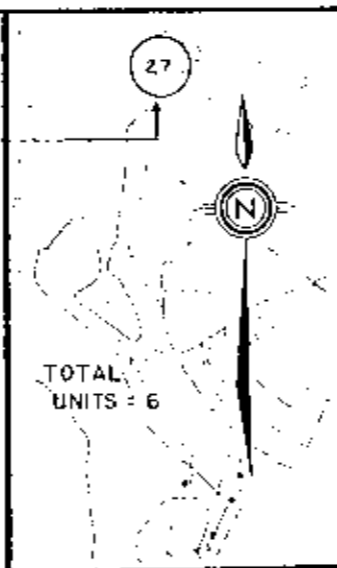
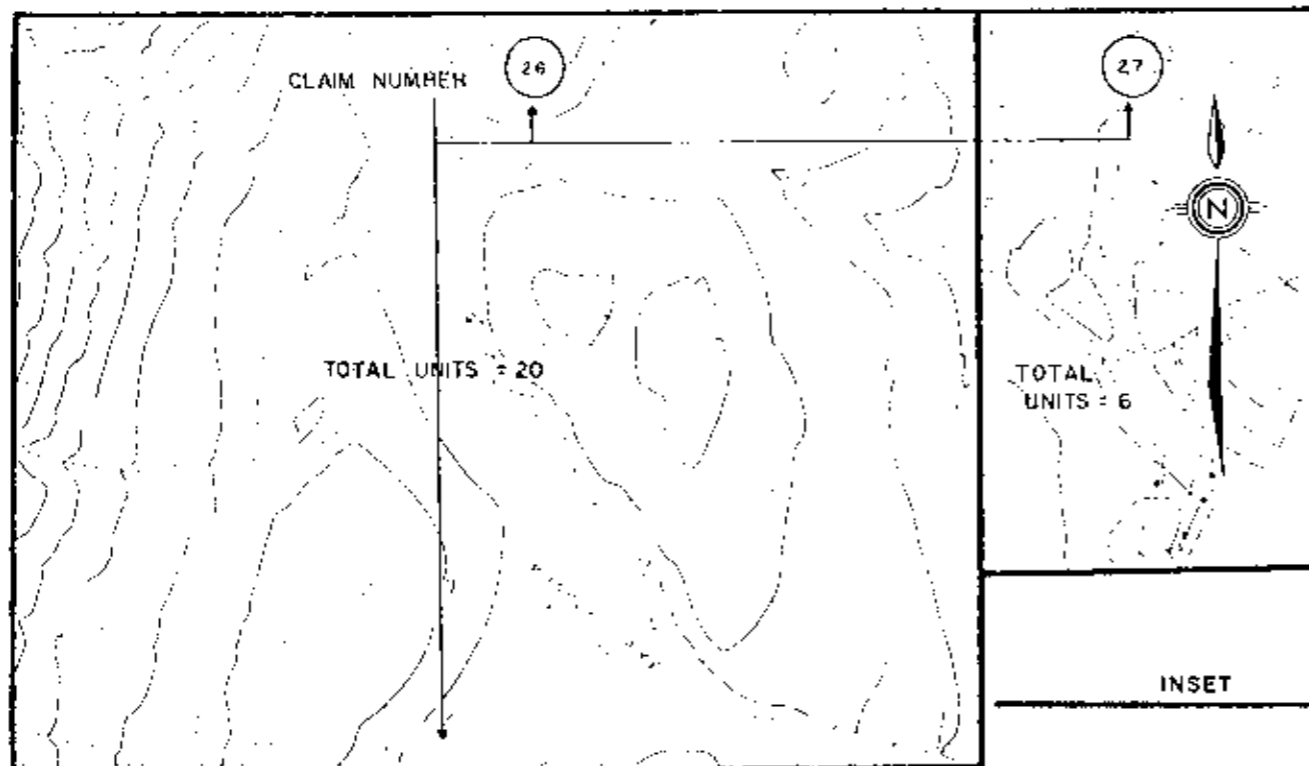

INSET

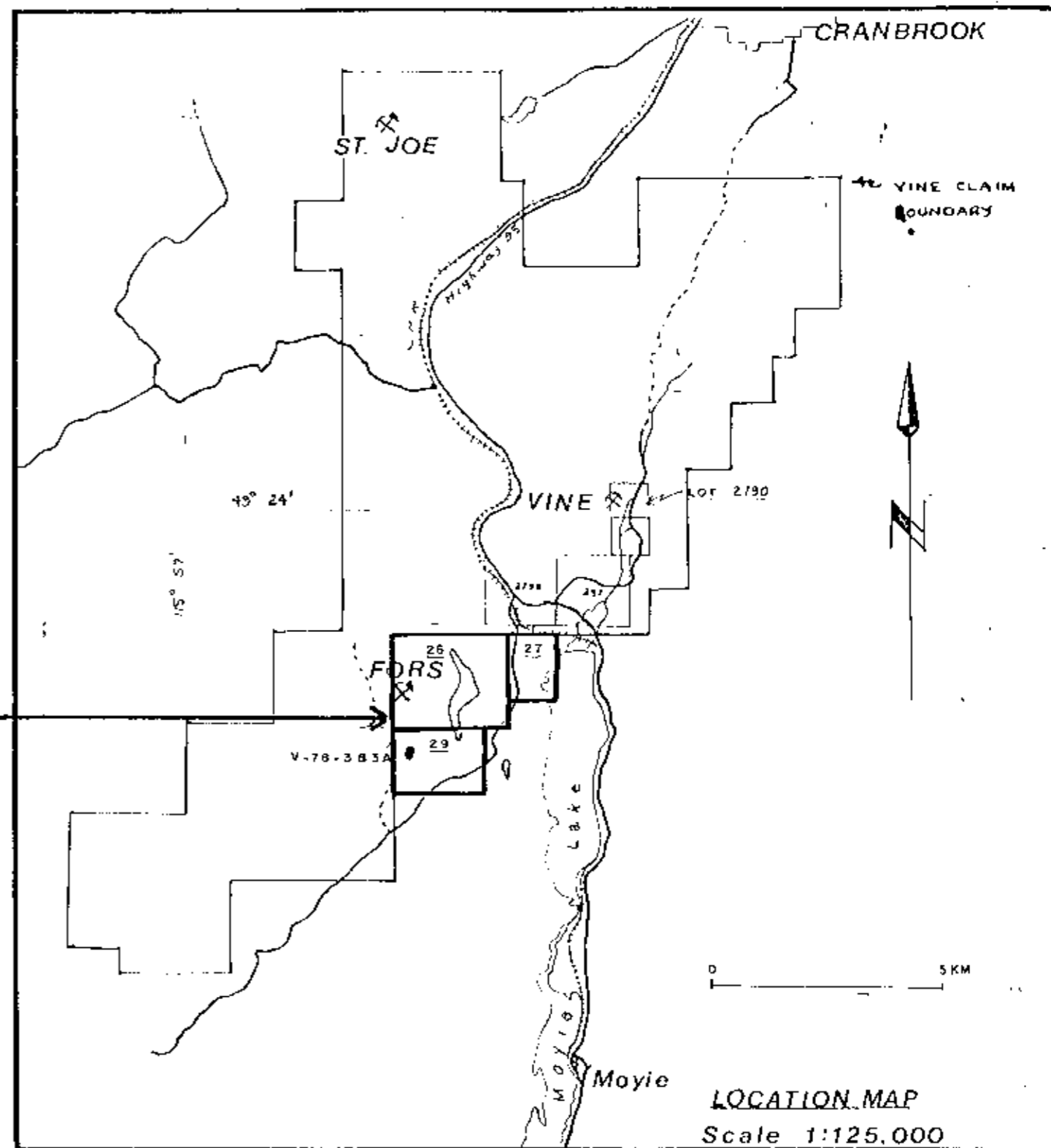
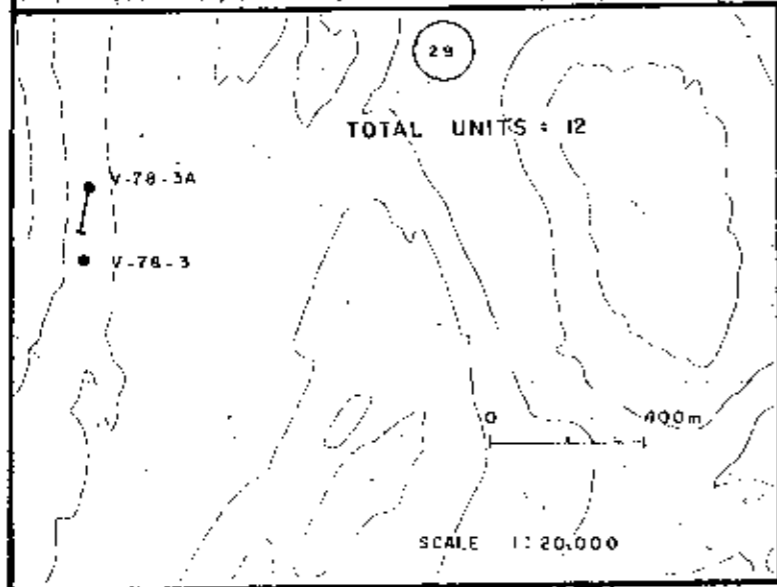

MINERAL RESOURCES BRANCH  
 APPRAISAL REPORT  
**6936**  
 NO.



Drawn by: G.L.W.		Traced by: R.J.K.	
Revised by	Date	Revised by	Date

DDH'S V-78-3 & 3A  
 VINE CLAIM GROUP  
 26, 27, 29

NTS: 82G/5W

Scale: Date: OCT 12 1978 Plate: V-78-1