

Prospecting Report  
on the  
Slocan and Sandon Properties  
of  
G. Sipos and S.J. Chin

Slocan Mining Division      N.T.S.      ~~62K35~~      82F14W

Sandon Properties:    Corinth Mineral Claim

Report by:

George Kachuk  
R.R. # 4 Salmon Arm, B.C.,  
V0E 2T0

Date submitted:

November 20, 1978

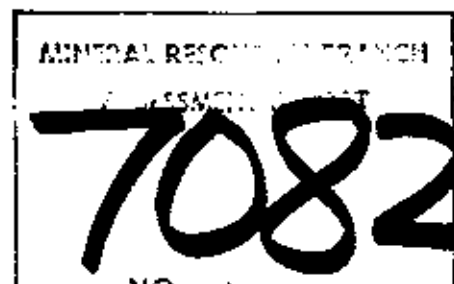

PROSPECTING REPORT ON THE CORINTH MINERAL CLAIM

The Corinth Mineral Claim was easy of access being near the Forestry Lookout Road. Numerous old workings were investigated. Most of the old adits were caved in.

Bulldozer workings on the road below the old bunkhouse uncovered a new silver lode which appears to be several feet wide. No claim posts were located, but focal point of exploration on this and other nearby claims was done from the old bunkhouse on the Corinth property. Areas prospected on this claim indicate perhaps more limy rocks in the admixture of argillites, limestone and quartzites.

Major faulting may appear to be in the Corinth area as this is where there appears to be more workings on old lodes traversing the area in varying directions.

Respectfully submitted

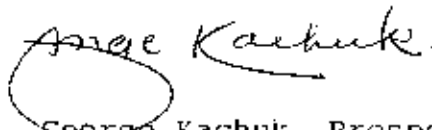

George Kachuk, Prospector

Geological Geophysical (Scanner)

GEOLOGY OF THE CORINTH MINERAL CLAIM

The geology of the Corinth mineral claim shows a predominance of slates and argillites. The argillites are thinly banded and tests will be made to see if there is any amount of graphitic argillite in this area. Argillites in some of the areas especially where faulting had occurred show up as thinly banded and crenulated. Rock types indicate more limestone than in some other explored area. Numerous worked out lodes were examined by the writer and were found to trend in a general north south direction. A bulk shipment was shipped to the Trail smelter and the results are as follows

<u>Pb</u>	<u>Zn</u>	<u>Ag</u>	<u>Si<sub>o2</sub></u>
6.1%	18.6%	6.70%	16.3%

This test was done to determine the feasibility of concentrating the numerous tailings dumps in the area.

Respectfully submitted

*George Kachuk.*

George Kachuk, Prospector  
Geological Geophysical (Scanner)

STATEMENT OF EXPENSES FOR CORINTH MINERAL CLAIM

Transportation and 4 X 4 truck - 3 days	\$140.00
Wages - two men - 1 day	200.00
Meals and lodging - 1 day	<u>48.00</u>
	\$388.00

STATEMENT OF WORK FOR CORINTH MINERAL CLAIMDate of Work

July 8, 1978

Prospecting

Mr. Dan Chin

Mr. George Kachuk

STATEMENT OF QUALIFICATIONS

I, George Kachuk have engaged in mineral prospecting from the year 1960 to 1978. I have worked with numerous prospectors and Mining Engineers and Geologists in British Columbia, The Yukon Territories and Idaho, U.S.A.



George Kachuk,  
Prospector

November 20, 1978

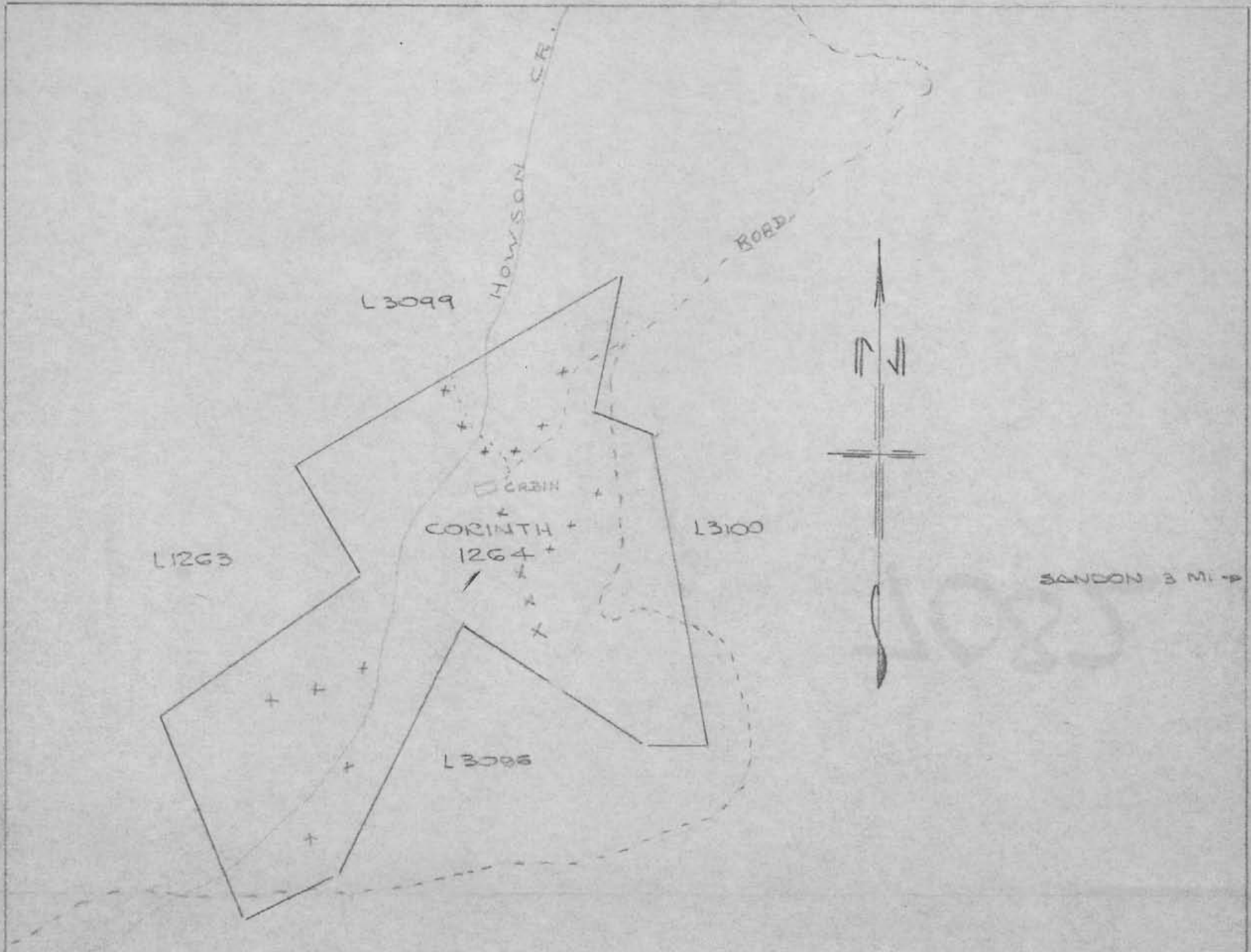

MINERAL RESOURCES BRANCH  
 GEOLOGICAL REPORT  
**7082**  
 13.

CORINTH M.C.  
 SANDON AREA  
 SLOCAN MINING DIVISION

---

SCALE: 1" = 400'

---

X PROSPECTED AREAS

