

ASSESSMENT REPORT

JADE BOULDER DRILLING

PLACER LEASE 1710

Liard Mining Division

1041/7E

58 22'N 128 37'E

Owner & Operator: Cry Lake Jade Mines Ltd.

Author: A.M. Homenuke, P. Eng.

Date: 23 January 1979

7096

CONTENTS

PART I. INTRODUCTORY NOTES

Location Map (Fig. 1)	1
Location and Access	2
Physical Features	2
Property	2
History	2
Economic Assessment	2
Work Summary	2

PART II. TECHNICAL DATA

Boulder Locations (Fig. 2)	3
Drilling Results	4

PART III. INTERPRETATION

ITEMIZED COST STATEMENT	5
CERTIFICATE OF QUALIFICATIONS	6

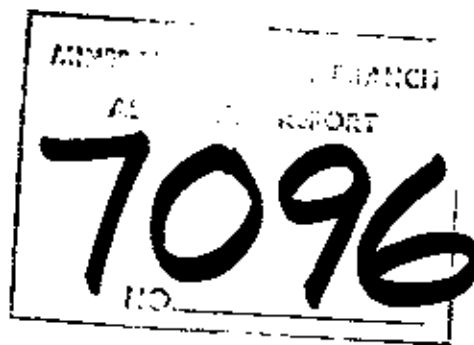

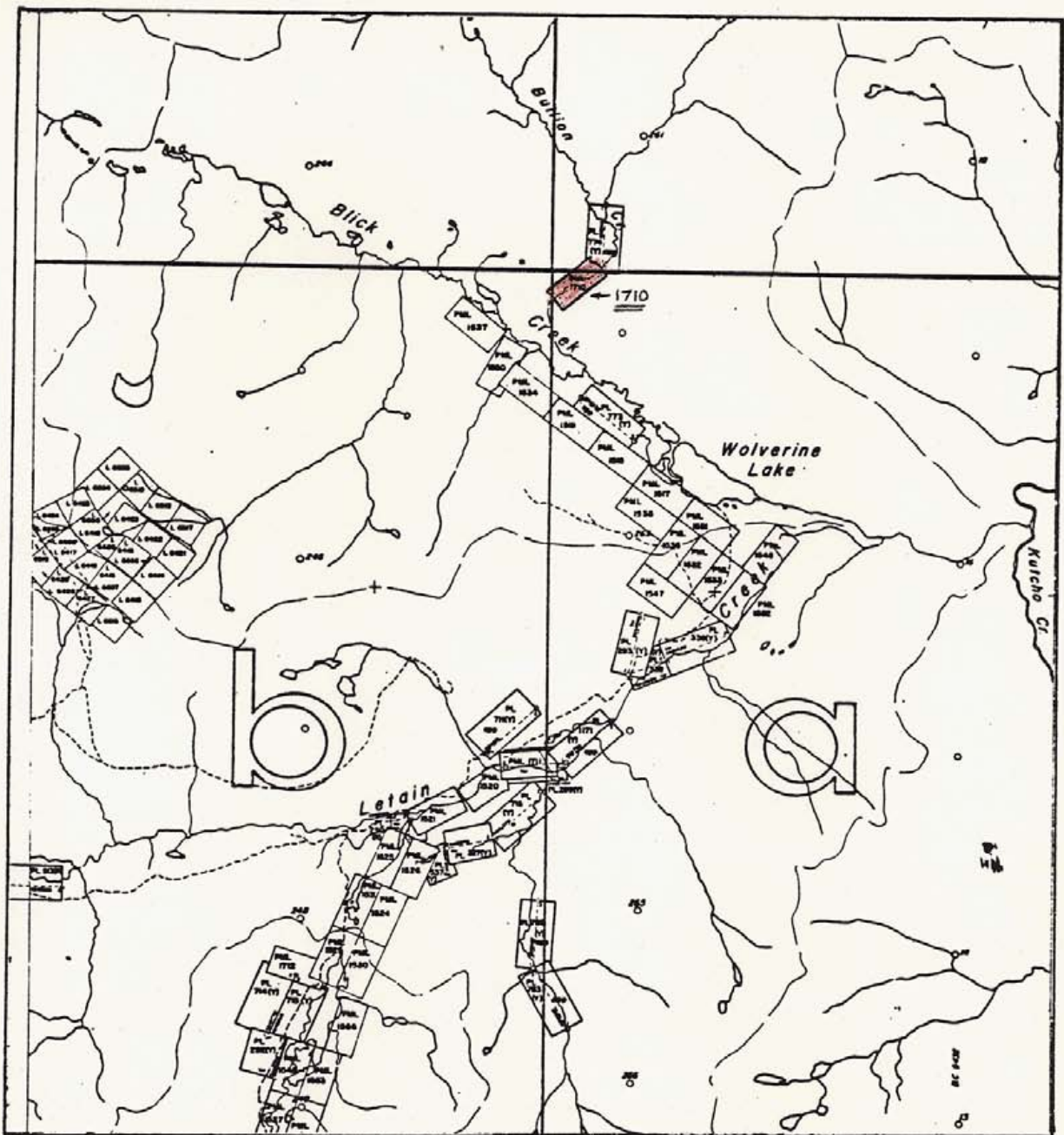

Part of P 104 I / 7E



kilometres



CRY LAKE JADE MINES LTD.
PLACER LEASE
1710
 LIARD MINING DIVISION
LOCATION MAP

PART I. INTRODUCTORY NOTES

Location and Access

Placer Lease 1710 is situated on Bullion Creek 2.5 km northwest of Wolverine Lake (Fig. 1) and 6 km north of Wolverine Airstrip. Access is by air (helicopter) from Dease Lake, about 80 km west. Winter access is possible by cat train from Dease Lake.

Access for work done in 1978 was by helicopter from the Cry Lake camp at Kutcho Creek airstrip.

Physical Features

The claim is located on the west side of a northwesterly trending ridge which drops abruptly into the valley of Blick Creek. Bullion Creek has cut a steep-walled canyon through this ridge and only at the southwest end of the claim does the relief become more gradual.

Total relief on the claim is over 100 meters. Most of the area is covered by forest.

Property

Placer Lease 1710 was located on October 20, 1974 by Harold Komish and the lease was issued on January 8, 1975. The lease has been extended to 1980. On January 5, 1976, all interest was transferred to Cry Lake Jade Mines Ltd. The claim is in the Liard Mining Division.

History

The only previous work was done in 1976 when a few boulders were drilled and a helicopter pad was constructed.

Economic Assessment

Numerous jade boulders are present where the grade of Bullion Creek lessens on the southwest end of the claim. It is reported that some marketable jade was indicated by the 1976 drilling.

Work Summary

Nine further boulders were drilled to assess their values for the jade market.

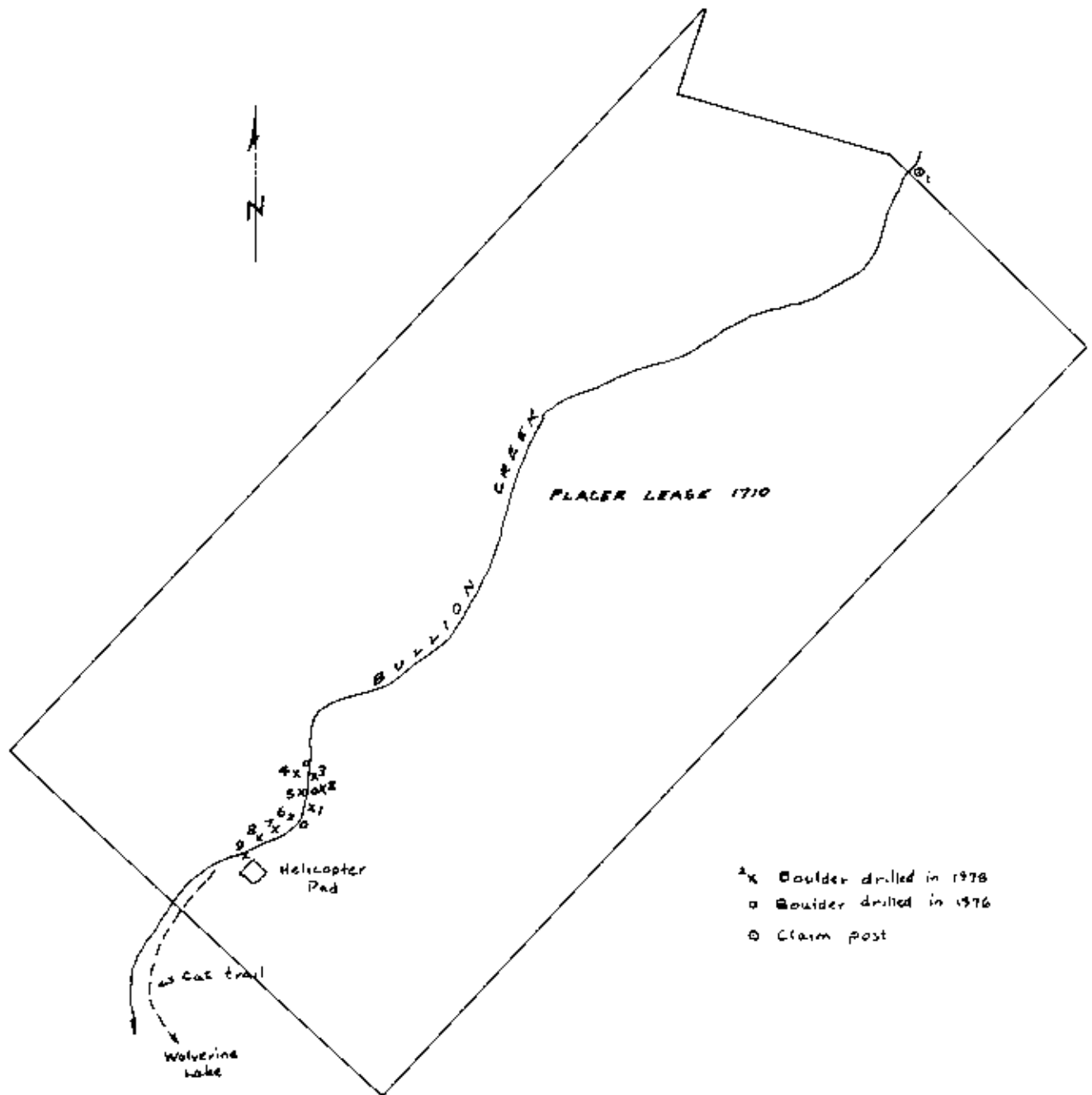

- x Boulder drilled in 1978
- o Boulder drilled in 1976
- o Claim post

100 0 100 200
meters

References P 1048/78
B.C. Airphoto 5427-262

CRY LAKE JADE MINES LTD.

PLACER LEASE 1710
LIARD MINING DIVISION, B.C.

BOULDER LOCATIONS

Prepared by: A.M. Homenuke, P.Eng.
TRI-CON MINING LTD.

JAN. 1979

FIG. 2

PART II. TECHNICAL DATA

Drilling Results

Nine boulders were tested with a "Pack sack" drill. The locations are shown on Fig. 2. The following list summarizes the results

Boulder No.	Depth of Hole	Remarks
1	.91 meters	dark grey
2	.46	dark grey-green
3	.55	medium grey-green; minor "C" grade
4	.61	"C" grade; some weathering
5	.91	pale, talcy to dark grey
6	.91	"C+" to "B-" light greyish green; translucent
7	.61	greenish grey to black
8	.91	talcy; grey-green to dark grey
9	<u>.61</u>	grey to black

Total 6.5 meters

An initial evaluation was made on August 9 and the drilling was done on September 11 and 12. The core is stored in the Cry Lake camp at Kutcho Creek airstrip.

PART III. INTERPRETATION

The cores indicated that two boulders, numbers 4 and 6, contain marketable jade. Two boulders drilled in 1976 also contained good grade jade.

ITEMIZED COST STATEMENT

Pack sack drilling, 9 boulders, 6.5 meters total

NOTE: 2 meters/day may at times be considered good
drilling in jade.

Sept. 11 & 12 1 driller x 2 days @ \$150/day	\$ 300.00
1 helper x 2 days @ \$75.00/day	150.00
Helicopter 2 hours @ \$185/hour	370.00
Room & Board 4 man/days @ \$25/day	100.00
Engineering (Aug. 9 & Sept. 12) and report 1½ days @ \$200/day	300.00
	<hr/>
	Total \$1,220.00

CERTIFICATE OF QUALIFICATIONS

I, ALEXANDER M. HOMENUKE, DO HEREBY CERTIFY:

1. THAT I am a member in good standing of the Association of Professional Engineers of British Columbia.
2. THAT I received the Degree of Bachelor of Science in Geological Engineering from the Colorado School of Mines in 1974.
3. THAT I received a Diploma of Technology in Mining from the B.C. Institute of Technology in 1969.
4. THAT I have been employed in various aspects of mineral exploration for 10 years and am presently employed by Tri-Con Mining Ltd. of 213 - 475 Howe Street, Vancouver, B.C.
5. THAT I presently reside at #1 - 2025 Sandalwood Crescent, Abbotsford, B.C.
6. THAT this report is based on work supervised or conducted by myself.

Dated at Vancouver, B.C., this 23rd day of January 1979.

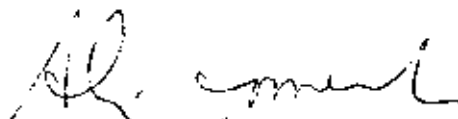

A.M. HOMENUKE, P. Eng.
Geological Engineer