

DIAMOND DRILLING REPORT

OR

REDMAC GROUP

82K/8W & 82K/9W

Golden Mining Division

Report by:

V. J. WINSER

Box 366,

Invermere, B.C.

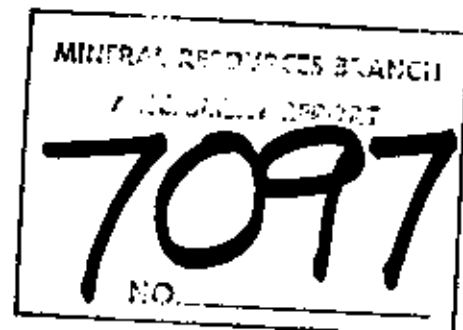

TABLE OF CONTENTS

| | <u>PAGE</u> |
|---------------------|-------------|
| GENERAL STATEMENT | <u>1</u> |
| INTRODUCTION | 1 |
| LOCATION AND ACCESS | 1 |
| EXHIBIT "A" | 2 |
| AFFIDAVIT | 3 |
| DIAMOND DRILL DATA | 4 |
| MAP | Rear |
| CORE LOGS | Rear |

REDMAC GROUP

Golden Mining Division

GENERAL STATEMENT

This report describes the results and expenditures relating to diamond drilling on the Redmac Group.

Diamond drilling was performed from September 30th, to November 9th 1978.

Total expenditures for this drilling program amounted to \$8751.00

It is requested that the sum of \$7500.00 be applied to the 12 Claims of the Redmac Group.

A total of 48 claim years of assessment credits are requested.

INTRODUCTION

The diamond drilling was primarily a program to establish some continuity in the mineralized zone at depth.

The diamond drilling was performed by G. Iarrabee of Wilmer, B.C., at contract price of \$16.00/ft. The drill was equipped to recover AQ core.

The field program was under the direction of V. J. Winser P.O. Box 366, Invermere, B.C. The core was logged by G. E. Webber Cominco Exploration Division.

LOCATION AND ACCESS

The Redmac Group consists of 12 claims, situated on Redline and McDonald Creeks. they lie approximately 18 miles West of Invermere, BC.

The claims are accessible over logging roads in the Horsethief and McDonald Creek drainage area.

EXHIBIT "A"

REDMAC GROUP

Statement of Expenditures

DIAMOND DRILLING

| | | | | | |
|--------------|---|--------------|---------|--------------|-----------|
| D.D. Hole NO | 1 | 146.5' | (44.7m) | @ \$16.00/ft | \$2344.00 |
| D.D. Hole NO | 2 | 302' | (92m) | @ \$16.00/ft | \$4832.00 |
| | | <u>448.5</u> | | | |

TRANSPORTATION

Dodge 4x4 pick up 15 days @ \$25.00/day \$ 375.00

SALARIES

V.J. Winser 16 days @ \$75.00/day \$1200.00

Total Expenditures \$8751.00

This Exhibit "A" to the Statutory Declaration of V.J. Winser declared before me this 27 day of

December 1978.

V.J. Winser

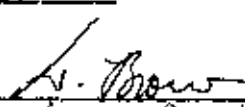
A Commissioner for taking Affidavits for the Province of British Columbia.

A COMMISSIONER FOR TAKING
AFFIDAVITS WITHIN THE PROVINCE
OF BRITISH COLUMBIA.

IN THE MATTER OF THE

B.C. MINERAL ACT

AND

IN THE MATTER OF A DIAMOND DRILL PROGRAM
CARRIED OUT ON THE REDMAC GROUP OF CLAIMS

Located on Redline and McDonald Creeks
approximately 18 miles West of Invermere,
B.C. In the Golden Mining Division of the
Province of British Columbia.

AFFIDAVIT

I V.J. WINSER, of the Village of Invermere, in the Province
of British Columbia, make Oath and say:

1. That I have a personal knowledge of the facts to which
I hereinafter depose:
2. That annexed hereto and marked as Exhibit "A" to this
my Affidavit is a true copy of expenditures incurred
by diamond drilling on the Redmac Group:
3. That the said expenditures were incurred between the
30 day of September, 1978 and the 9th day of November,
1978., for the purpose of mineral exploration on the
above claims.

Sworn Before Me at the Village

of Invermere in the
Province of British Columbia, this
27th day of December 1978
L.H.

L. Brown

A Commissioner for taking Affidavits
in the Province of British Columbia.)

A COMMISSIONER FOR TAKING
AFFIDAVITS WITHIN THE PROVINCE
OF BRITISH COLUMBIA.

V.J. Winser
V.J. Winser

DIAMOND DRILL DATA FOR:

REDLAC GROUP

| <u>D.D. HOLE</u> | <u>DIP</u> | <u>DEPTH</u> | <u>CORE SIZE</u> | <u>COST/FT</u> |
|------------------|------------------|--------------|------------------|----------------|
| NO 1 | -90 ⁰ | 146.5' | AQ | \$16.00 |
| NO 2 | 45 ⁰ | 302' | AQ | \$16.00 |

Core stored at Invermere, B.C.

SIGNED

V.J. WISE

Drill Hole Record



| | | | | | | | |
|--------------|--------|-----------|----------------|-----------|------|-------------|---------------|
| Property | REDMAC | District | Golden | Hole No. | 2 | Claim | |
| Commenced | | Location | McDonald Creek | Tests at | Nil | Hor. Comp. | 213.5(65.1m) |
| Completed | | Core Size | AQ | Corr. Dip | 450 | Vert. Comp. | 213.5(65.1m) |
| Co-ordinates | | | | True Brg. | 0700 | Logged by | G.L. Webber |
| Objective | | | | % Recov. | 95% | Date | Nov. 15, 1978 |

Claim

T Brg.

Collar Dip

Elev.

Length

Hole No. Sheet

| Footage | | Description | Sample No. | Length | Analysis | | |
|---------|-------|---|------------|--------|----------|-----|-----|
| From | To | | | | Ag | Pb | Zn |
| 0 | 32' | QUARTZITE: and quartz grit conglomerate. Disseminated pyrite 1% | | | | | |
| 0 | 9.7m | One grain of bornite. Minor fracture fillings of pyrite, specks of galena and wispy galena around pyrite .5% Pb. Quartz filled fractures and 3 to 5 cm of massive white quartz that blends in with the quartzite and/or quartz grit conglomerate. | | | | | |
| 32' | 92' | CONGLOMERATE: Quartz grit conglomerate with quartzite interbeds | | | | | |
| 9.7 | 28m | Same as 0-32' (0-9.7m) but less galena white dolomite filled fractures at 51' (17.3m). Quartz grit conglomerate contains some quartz pebbles (rounded) up to 1 x 2 cm at 91' (27.7m). White dolomite veins + 4 cm with galena at 90' (27.4m) also pyrite and galena filled fractures. | | | | | |
| 92 | 108.5 | CONGLOMERATE: Quartz grit conglomerate, quartzite and interbedded cream grey laminated argillite at 99' (30.2m). Split and assay from 99 to 107.5 ft. (30.2 - 32.8m) contains fractures with galena and pyrite. Pb appears to be introduced along with white quartz. Contact of conglomerate with shale at 108.5 (33.1m). Bedding 80° | 28887 | 8.5' | .36 | 2.3 | .20 |

Drill Hole Record



Property REDMAC

District Golden

Hole No. 2

Commenced

Location

Tests at

Hor. Comp.

Completed

Core Size

Corr. Dip

Vert. Comp.

Co-ordinates

True Brg.

Logged by

Objective

% Recov.

Date

Claim

T Brg.

Collar Dip

Elev.

Length

Hole No. Sheet

| Footage | | Description | Sample No. | Length | Analysis | | | | | | | | | | |
|---------|-------|---|------------|--------|----------|--|--|--|--|--|--|--|--|--|--|
| From | To | | | | | | | | | | | | | | |
| 108.5 | 149' | SHALE: Pyriteiferous, laminated, medium dark grey to grey. | | | | | | | | | | | | | |
| 33.1 | 45.4m | White quartz vein 114-119' (34.7 to 36.3m). 1.2 ft. (36.6 cm) of mostly barren white quartz recovered - contains .5% Pb. Intermixed quartz and dolomite veins from 124 to 125.5 ft. (37.8 to 38.3m) shale is medium black from 128 to 149 ft. (39.0 to 45.4m). Bedding 80°. | | | | | | | | | | | | | |
| 149 | 187' | SHALE: Pyritiferous - bedded pyrite, shale is medium grey | | | | | | | | | | | | | |
| 45.4 | 57m | black - dolomite filled fractures with pyrite. Fault at 154 to 157 ft. (46.9 to 47.8 m). 5 cm of core recovery in fault. At 162 ft. (49.4m) bedding 90°. | | | | | | | | | | | | | |
| 187 | 222' | ARGILLITE: Dolomitic argillite, grey, laminated and thin-bedded. | | | | | | | | | | | | | |
| 57 | 67.7 | Dips vary from 70 to 80° 2% bedded, wispy and fracture pyrite. | | | | | | | | | | | | | |
| 222 | 302 | SHALE: Interbedded medium dark grey to grey, laminated and thin-bedded, lightly pyritiferous. Some white dolomite veinlets containing pyrite. 3%. At 253' (77.1m) bedding 90°. | | | | | | | | | | | | | |
| 67.7 | 92m | Shale becomes light medium grey with alternating dark grey interbeds. | | | | | | | | | | | | | |

END OF HOLE 302' (92m).

Drill Hole Record

#

7097



| | | | | | |
|--------------|--------|-----------|----------------|-----------|-------------|
| Property | REDMAC | District | Golden | Hole No. | 1 |
| Commenced | | Location | McDonald Creek | Tests at | Nil |
| Completed | | Core Size | AQ | Corr. Dip | -90° |
| Co-ordinates | | True Brg. | | Logged by | G.L. WEBBER |
| Objective | | % Recov. | 92% | Date | Nov. 15/78 |

Claim

T Brg.

Collar Dip

Elev.

Length

Hole No.

Sheet

| Footage From | To | Description | Sample No. | Length | Analysis |
|-----------------|-------|--|---------------|--------|----------|
| 0 | 4' | QUARTZITE: quartz grains in a MgO matrix (50 to 95% quartz) containing specks of galena and disseminated pyrite. | | | |
| 0 | 1.2m | | | | |
| 4 | 9' | CONGLOMERATE Grit conglomerate, quartz 90% specks of galena. | | | |
| 1.2 | 2.7m | | | | |
| 9 | 12' | QUARTZITE: with disseminated pyrite. | | | |
| 2.7m | 3.6m | | | | |
| 12 | 16' | CONGLOMERATE Quartz grit conglomerate - quartzite from 14 to 16' (4.3 to 4.9) Disseminated pyrite 1%. | | | |
| 3.6 | 4.9m | | | | |
| 16 | 20' | DOLOMITE 5% of 1mm quartz grains. | | | |
| 4.9 | 6.1m | | | | |
| 20 | 29' | QUARTZITE Dolomite matrix - disseminated fine pyrite, quartz veins up to 5 cm containing wispy galena and pyrite. Two galena and pyrite filled fractures up to 1 cm (Pb 1% from 20-39' (6.1 to 11.9m). | | | |
| 6.1 | 8.8m | | | | |
| 29 | 45.5' | QUARTZITE and Quartz grit conglomerate - quartz pebbles up to 8mm. Some introduced quartz that blends into the grit, contains wispy | | | |
| 8.8 | 13.9m | | | | |



Drill Hole Record

Scale

Colour Plot
& Dip

| | | | | | |
|--------------|--------|-----------|--------|-----------|-------------|
| Property | REDMAC | District | Golden | Hole No. | 1 |
| Commenced | | Location | | Tests at | Hor. Comp. |
| Completed | | Core Size | | Corr. Dip | Vert. Comp. |
| Co-ordinates | | | | True Brg. | Logged by |
| Objective | | | | % Recov. | Date |

Claim

T Brg.

Collar Dip

Elev.

Length

Hole No. Sheet

| Footage | | Description | Sample No. | Length | Analysis | | | | | | | | | |
|------------|--------------|--|------------|--------|----------|--|--|--|--|--|--|--|--|--|
| From | To | | | | | | | | | | | | | |
| 8.8 | 0 13.9m | continued: | | | | | | | | | | | | |
| | | pods of galena and pyrite 3% Pb from 43.3 to 44 ft. (13.2 to 13.4m). Pyritiferous shale, containing silty and argillaceous partings shale is medium dark grey with interbeds of brownish grey argillite. | | | | | | | | | | | | |
| 45.5 - 66' | 13.9 - 20.1m | SHALE | | | | | | | | | | | | |
| | | Thin-bedded to laminated, medium dark grey and brownish grey beds. Disseminated pyrite and 1 x 2 cm pyrite inclusions. Py filled fractures parallel to bedding. 6 cm quartzite bed at 58 ft. (17.7m). Two 19 cm (approx) argillite beds at 59 ft (18m) and 61' (18.6m 5% pyrite. | | | | | | | | | | | | |
| 66 - 74' | 20.1 - 22.5m | SHALE: | | | | | | | | | | | | |
| | | Medium dark grey, very fine-laminations of bedded pyrite, some silty laminations and thin-bedded grey argillite sections. Minor 3mm pyrite filled fractures. The argillite contains considerable CaO and MgO. | | | | | | | | | | | | |
| 74 - 93 | 22.5 - 28.3m | ARGILLITE | | | | | | | | | | | | |
| | | Magnesium carbonate 10%. Narrow (3mm) fractures containing white to grey dolomite with sphalerite and galena 5% Av. (overall core). | | | | | | | | | | | | |



Drill Hole Record

Property REDMAC District Golden Hole No. 1

Commenced Location Tests at Hor. Comp.

Completed Core Size Corr. Dip Vert. Comp.

Co-ordinates True Brg. Logged by

Objective % Recov. Date

| Footage From To | Description | Sample No. | Length | Analysis | Claim | T Brg. | Collar Dip | Elev. | Length | Hole No. | Sheet |
|--------------------|--|---------------|--------|----------|-------|--------|------------|-------|--------|----------|-------|
| 93 - 103' | DOLOMITE: Impure dolomite, est. MgO 15%. White dolomite veins | | | | | | | | | | |
| 28.3 - 31.4m | quartz veinlets and fractures, lightly brecciated. Wispy pyrite in fractures and as blebs. Bedded argillite | | | | | | | | | | |
| | 1' (30.5cm) with bedded pyrite at 102' (31.1m). | | | | | | | | | | |
| 103 - 108' | ARGILLITE: Some magnesian limestone, thinly-bedded, light grey, | | | | | | | | | | |
| 31.4-32.9m | irregular laminations of pyrite along bedding 2%. Some pyrite | | | | | | | | | | |
| | clasts. Bedding 80°. | | | | | | | | | | |
| 108 - 146.5' | ARGILLITE: Very thinly-laminated, pyrite clasts, thin beds of pyrite | | | | | | | | | | |
| 32.9-44.7 | up to 1 cm (and 2 massive beds up to 1 cm each) could be | | | | | | | | | | |
| | described as shale. | | | | | | | | | | |
| | END OF HOLE AT 146.5' (44.7m) | | | | | | | | | | |

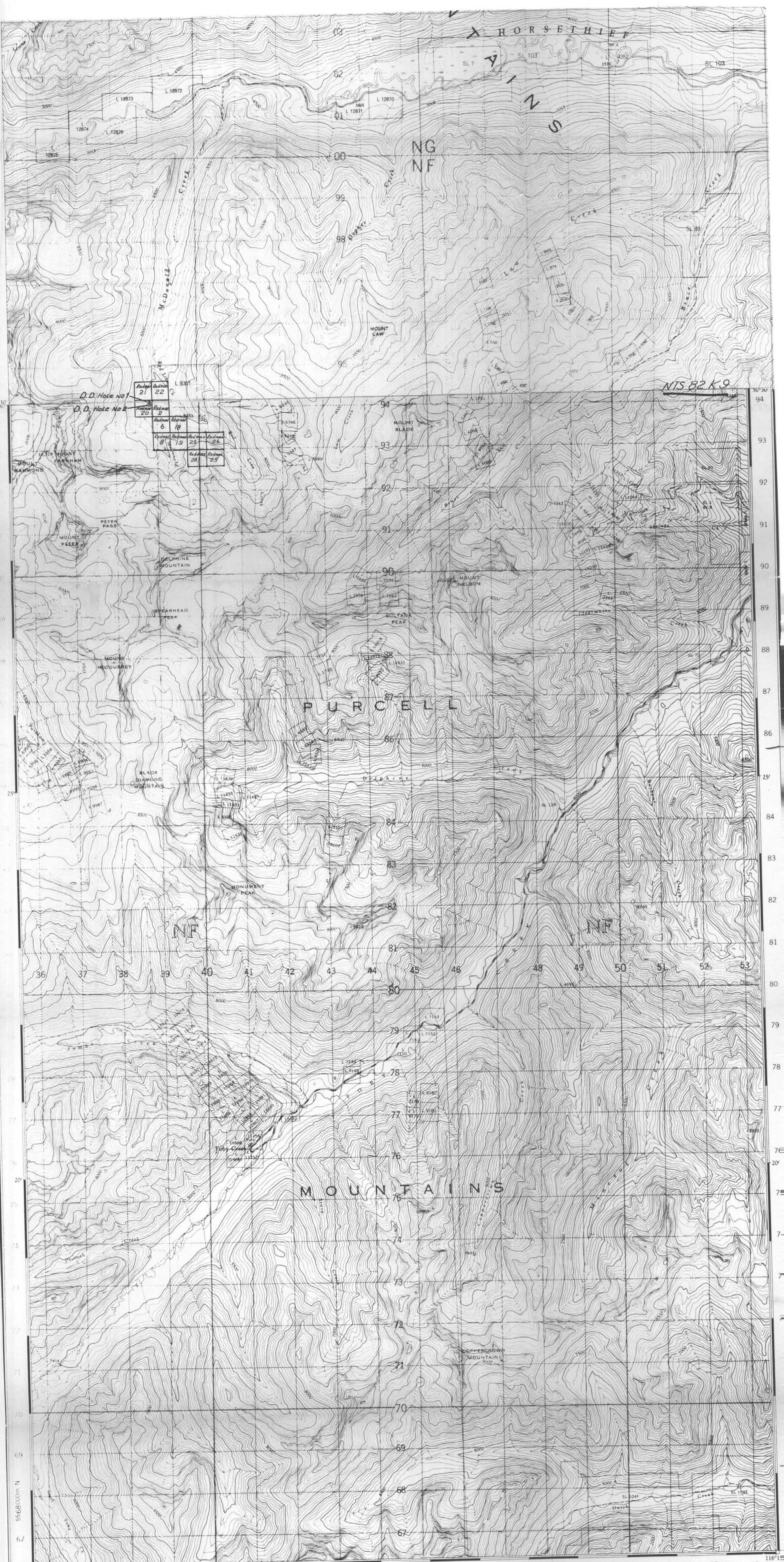

made and printed by the SURVEYS AND MAPPING
NCH, DEPARTMENT OF MINES AND TECHNICAL
SERVICES, 1962, from air photographs taken in 1947 and 1951.

TOBY CREEK

KOOTENAY DISTRICT
BRITISH COLUMBIA

SCALE 1:50,000 ÉCHELLE

MINERAL RESOURCES BRANCH
ASSESSMENT REPORT
7097
NO.

Établie et imprimée par la DIRECTION DES LEVÉS
LA CARTOGRAPHIE, MINISTÈRE DES MINES
RELEVÉS TECHNIQUES en 1962, d'après les données
aériennes prises en 1947 et 1951.

NTS 82K/8W

| Roads | Routes |
|---|--|
| hard surface all weather | paillée toute saison |
| hard surface all weather | paillée toute saison |
| loose surface all weather | de gravier toute saison |
| loose surface all weather | de gravier période sèche |
| loose surface all weather | de terre |
| trail or portage | sentier ou portage |
| Trail or portage | sentier ou portage |
| Railway normal gauge, single track | Chemin de fer voie unique rétro-alimenté, normal |
| Horizontal control point with elevation | Point géodésique avec cote |
| Bench mark with elevation | Repère de nivellement avec cote |

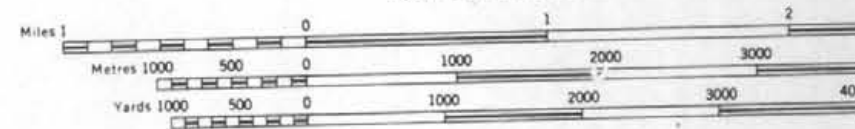

CONTOUR INTERVAL 100 FEET
Elevations in Feet above Mean Sea Level
North American Datum 1927
Transverse Mercator Projection

ÉQUIDISTANCE DES COURBES: 100 PIEDS
Élévations en pieds au-dessus du niveau moyen de la mer
Réseau géodésique nord-américain unifié (1927)
Projection transverse de Mercator

MAGNETIC DECLINATION EAST 22' 14"
AT CENTRE OF MAP 1962 22'00" EAST
Annual change (decreasing) 1"

DÉCLINAISON MAGNÉTIQUE AU CENTRE
DE LA FEUILLE EN 1962 EST 22' 14"
Variation annuelle (décroissante) 1"

| | | | |
|-------------------------------|-----------------------------------|-------------|-----------------|
| Church | Église | Barn | Bureau de poste |
| Power transmission line | Ligne de transport d'énergie | Post Office | Bureau de poste |
| River with bridge | Rivière avec pont | Canterbury | Compère |
| Stream, intermittent or dry | Cours d'eau intermittent ou à sec | | |
| Lake, intermittent, infertile | Lac intermittent, vase imprégné | | |
| Marsh or swam | Marais ou marécage | | |
| Debris or scum | Courbes de cuvette | | |

BM 157