

Assessment Report

on the

Rub Claims

on

Ruby Creek

New Westminster Mining Division

on behalf of

AQUARIUS RESOURCES LIMITED

Report by

G. H. Giroux, P. Eng.

December, 1978



Cochrane Consultants Limited
4882 Delta St., Delta, B.C. V4K 2T8 946-9221
Geotechnical Consulting / Exploration Services

geology
geophysics
geochemist

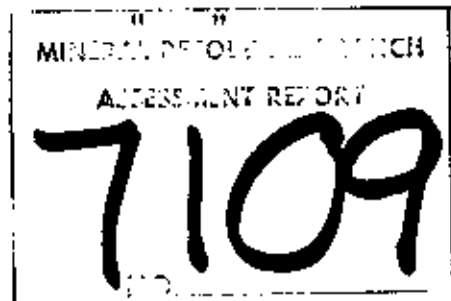

TABLE OF CONTENTS

		PAGE
1.0	INTRODUCTION	1
2.0	SUMMARY AND CONCLUSIONS	2
3.0	LOCATION AND ACCESS	3
4.0	CLAIM INFORMATION	3
5.0	REGIONAL GEOLOGY	4
6.0	HISTORY	5
7.0	GEOCHEMICAL SURVEY	6
7.1	SOIL SURVEY	6
7.2	PROSPECTING	7
8.0	COST ESTIMATE	8
9.0	CERTIFICATE	9
10.0	BIBLIOGRAPHY	10

FIGURES

1.	Location Map	Report body
2.	Claim Map	" "
3.	Geology Map	" "
4.	Geochemical Data	Map Pocket
5.	Geochemical Plan	" "
6.	Prospector's Sketch Map	" "



1.0 INTRODUCTION

This report is written for Aquarius Resources Limited on the Rub 1, 2 and 3 mineral claims situated on Ruby Creek in the New Westminster Mining Division.

The report describes a reconnaissance geochemical survey for gold completed from September 17 to October 18, 1978.

The author examined the data and completed this report at the request of Aquarius Resources Ltd., and the report has been prepared for assessment work submission.



2.0 SUMMARY AND CONCLUSIONS

Aquarius Resources Limited holds title to the Rub 1, 2 and 3 mineral claims containing a combined total of 44 units on Ruby Creek, New Westminster Mining Division, British Columbia.

During the period September 17 to October 18, 1978 a crew cut 32 kilometers of line taking samples every 25 meters on the Rub 1, 2 and 3 mineral claims. A total of 1213 soil samples were collected and analyzed for gold.

Four samples had values greater than 30 ppb, 3 of which were along the north-south base line with the fourth forming the core of an anomaly 200 meters wide on line 2500 S.



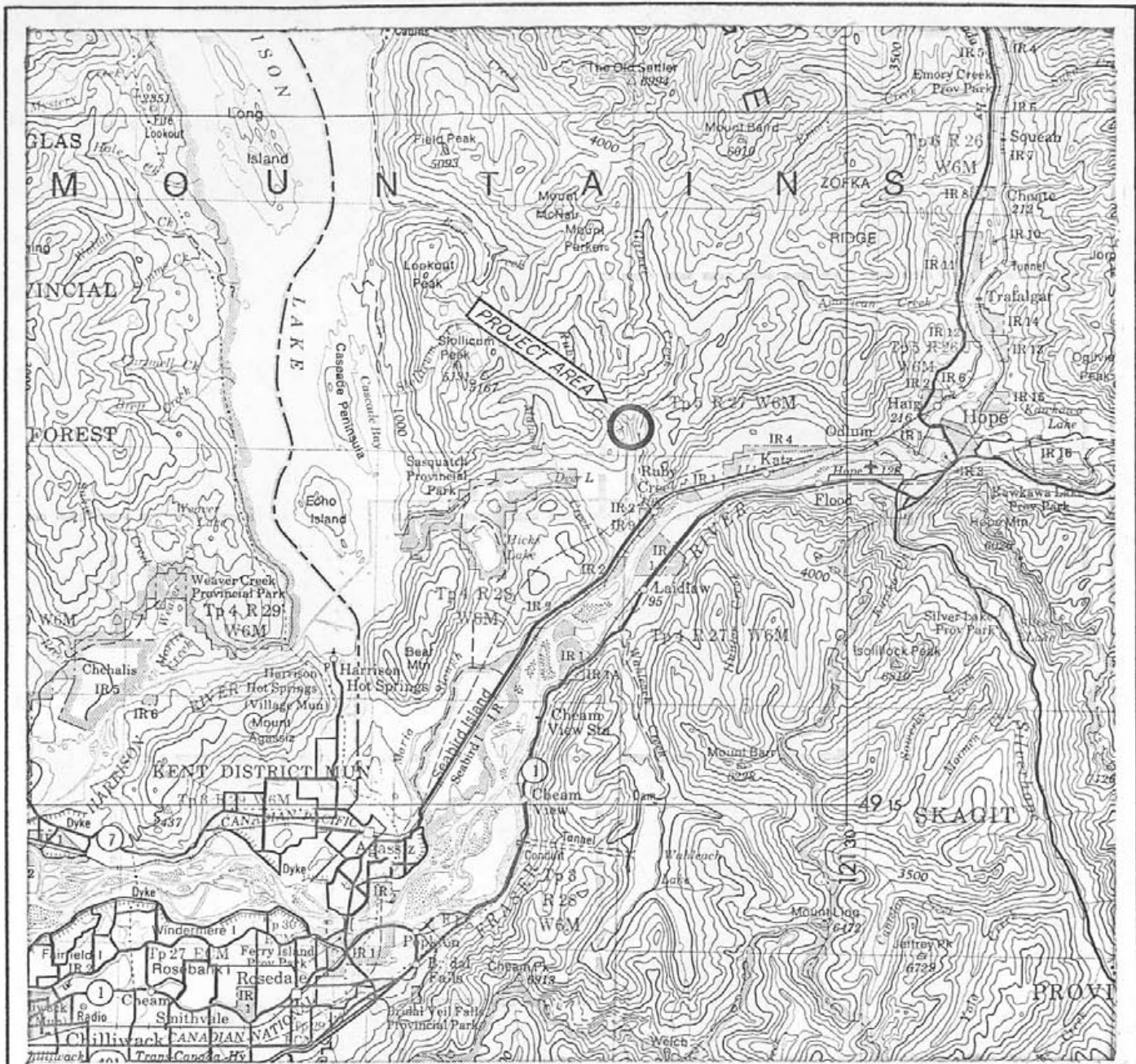



AQUARIUS RESOURCES LTD.

Ruby Cr. Group (Rub 1, 2 & 3 Claims) Ruby Cr., B.C.
 New Westminster Mining Division 92H/5 E.
LOCATION MAP Figure 1

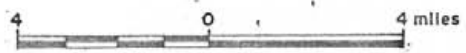
Scale: 1 to 250 000 or 1 inch equals approx. 4 miles

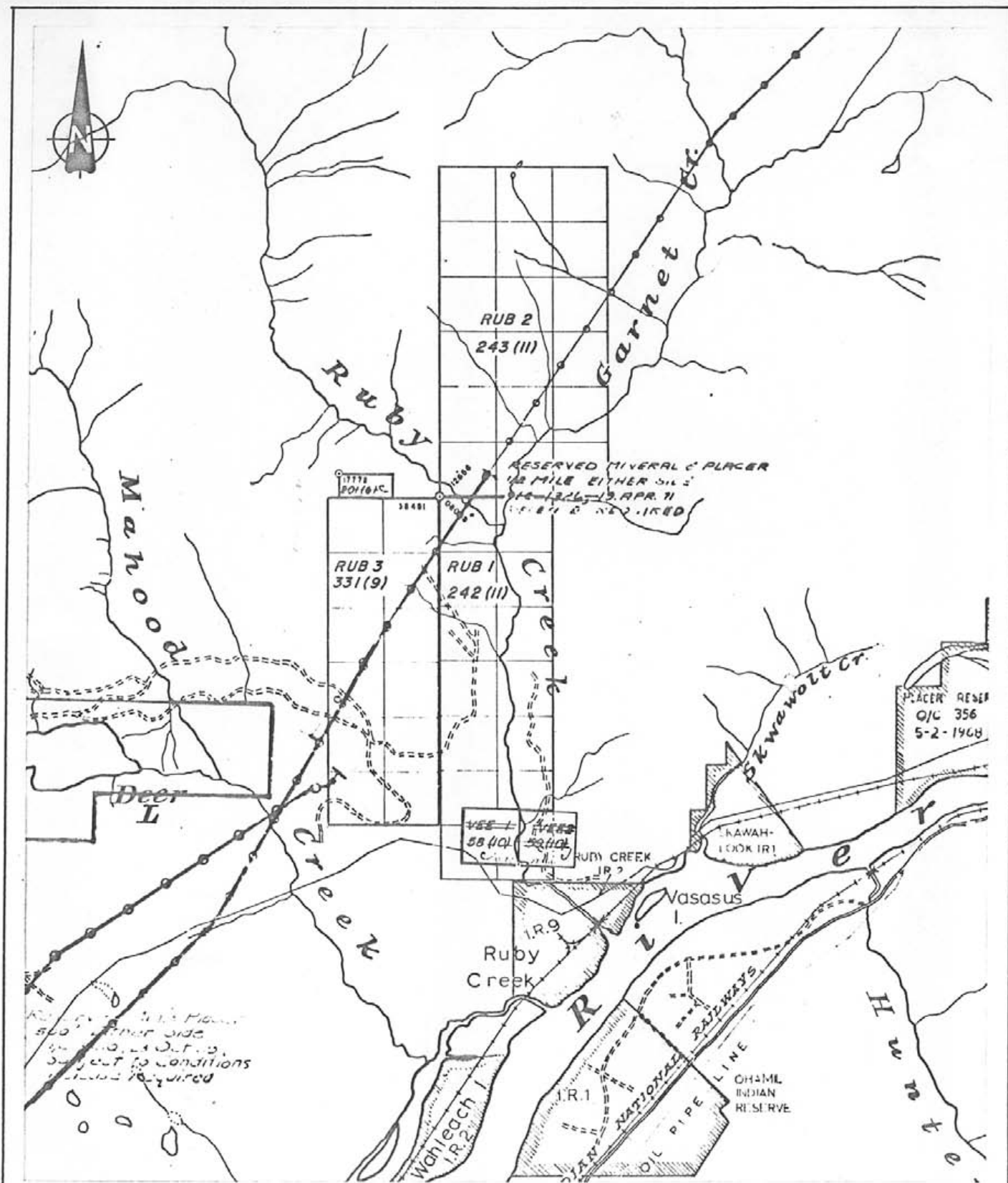

Cochrane Consultants Limited
 4852 Duha St., Delta, B.C. V4K 2T8 344-9221



AQUARIUS RESOURCES LTD.

Ruby Cr. Group (Rub 1, 2 & 3 Claims) Ruby Cr., B.C.
 New Westminster Mining Division 92H/5 E.
CLAIMS MAP Figure 2

Scale: 1:50,000



B.A.C./Jan. 79

 Cochrane Consultants Limited
 4142 Duke St., Delta, B.C. V4K 2T8 914-9221

3.0 LOCATION AND ACCESS

The Rub 1, 2 and 3 mineral claims are located on Ruby Creek on the north side of the Fraser River some 13 kilometers west of Hope, British Columbia. N.T.S. map reference 92H/5E; Latitude $49^{\circ}22'N$; Longitude $121^{\circ}37'W$.

Access to the property is by a dirt road which parallels the east side of Ruby Creek and runs north from Highway 7 at a point 12 kilometers south west of the juncture of Highway 7 and the Trans Canada Highway (1) (see figure 1).

4.0 CLAIM INFORMATION

The Ruby Creek property consists of 3 mineral claims; the Rub 1 with 14 units; Rub 2 with 18 units and Rub 3 with 12 units. The following table summarizes the claim information:

CLAIM	RECORD NO.	EXPIRY DATE
Rub 1 (14 units)	242	Nov. 9, 1981*
Rub 2 (18 units)	243	Nov. 9, 1981*
Rub 3 (12 units)	331	Sept. 30, 1981*

*after assessment credits

For locations of claims see figure 2.



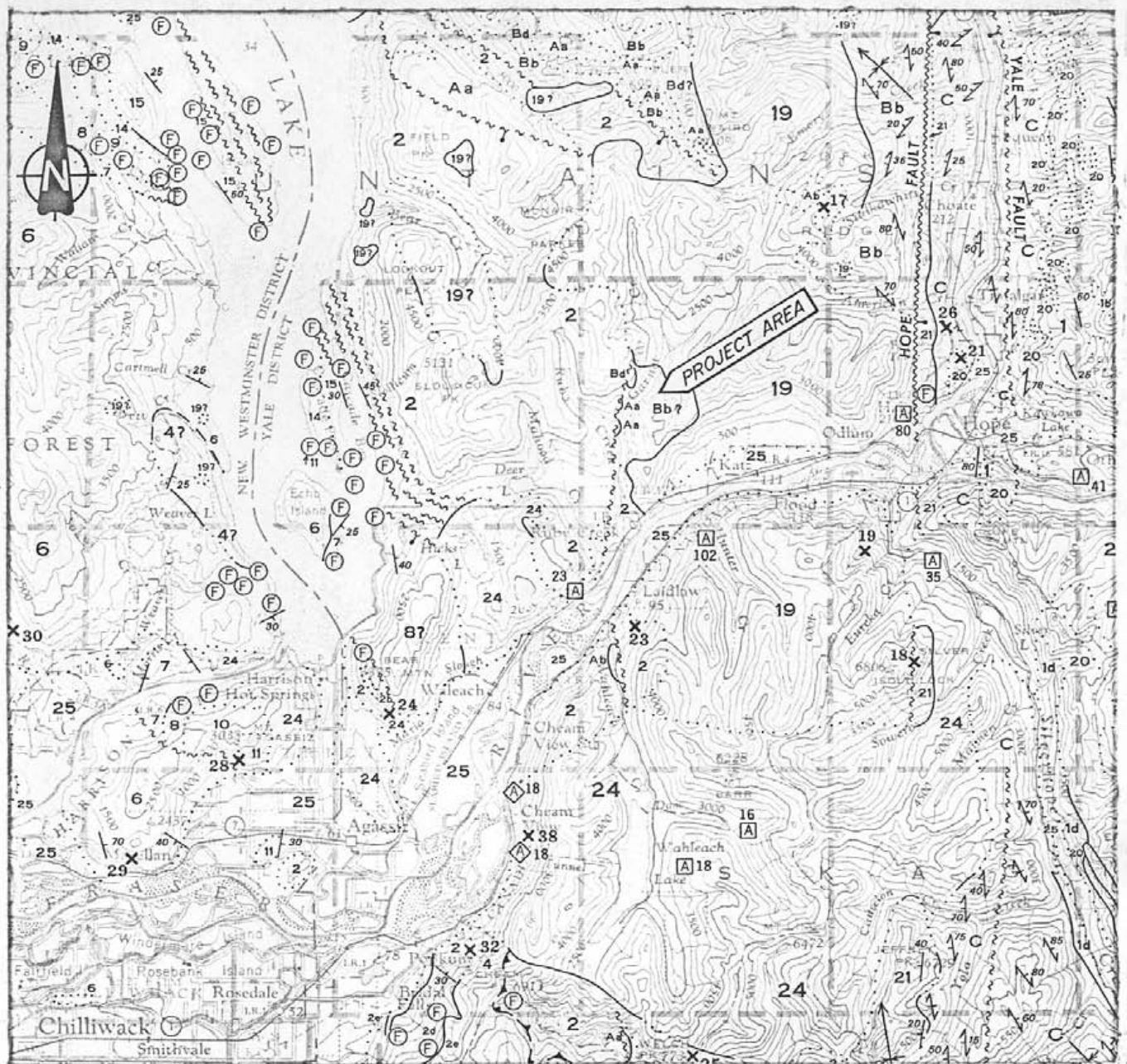

LEGEND:

MESOZOIC CRETACEOUS Upper Cretaceous or (?) older.

19 Quartz diorite.

PALEOZOIC PENNSYLVANIAN & PERMIAN
2 Basic volcanic rocks & pelites. Chilliwack Group.

ULTRAMAFIC ROCK

Aa Serpentinite, serpentized peridotite; Includes some Upper Paleozoic volcanic rocks in broad belt northeast of Hope.

Bb Shist, amphibolite.

SHIST, AMPHIBOLITE & PHYLLITE

Bd Amphibolite, hornblendite, quartz diorite.



AQUARIUS RESOURCES LTD.

Ruby Cr. Group (Rub 1, 2 & 3 Claims) Ruby Cr., B.C.
 New Westminster Mining Division 92H/5 E.
REGIONAL GEOLOGY Figure 3

Scale: 1 to 250000 or 1 inch equals approx. 4 miles

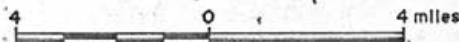

5.0 REGIONAL GEOLOGY

The regional geology of the area containing the Rub claims was described by J.W.H Monger. (G.S.C. Paper 69-47) (see figure 3).

The claims are mainly underlain by Lower Pennsylvanian to Lower Permian basic volcanic rocks and pelites of the Chilliwack Group. On the east side of Ruby Creek a small band of rocks described by Mr. Monger as schist and amphibolite are separated from the Chilliwack volcanics by a north south trending fault. These rocks are in contact to the east with the quartz diorite of the Late Cretaceous Spuzzum Pluton. Two small outcrops of serpentinite and serpentized peridotite were found on the east side of the fault.



6.0 HISTORY

The only recorded work in the claim area was conducted by Black Mastodon Mining Ltd. on the Clover Leaf mineral claims located one mile north of the mouth of Ruby Creek. The showing is reported as pyrrhotite carrying some nickel and copper values in talc enveloped in a serpentinite shear zone. In the period from 1966 to 1973 the British Columbia Annual Minister of Mines Reports describes the work done on the property: surface trenching, open pits, 17 surface diamond drill holes totaling 1115 feet and 2 underground diamond drill holes totaling 500 feet.



7.0 GEOCHEMICAL SURVEY

7.1 SOIL SURVEY

Between the dates September 17, and October 18, 1978 1213 soil samples were taken from the Rub 1, 2 and 3 mineral claims. Samples were taken at 25 meter spacing along lines 500 meters apart and along a section of road. (see figure 4 for sample locations).

The samples were taken to Min-En Laboratories Ltd. of North Vancouver where they were analyzed for gold using a gold Aqua-Regia Atomic Adsorption process.

A representative number of samples, 128 out of 1213, had an arithmetic mean of 5.5 ppb and ranged in value from the detection limit of less than 5 ppb to 30 ppb; contour intervals of 15 to 30 ppb and greater than 30 ppb outlined various small anomalies and one 200 meters wide and open to the south on line 2500 S. (ppb= parts per billion)



7.2 PROSPECTING

A prospector was employed to traverse up Ruby Creek checking outcrop and panning the tributaries. Figure 6 shows the traverses completed with locations panned. All samples panned were negative. Five assays were taken and their results are summarized below.

SAMPLE NO.	WIDTH	Au	Ag	Pt
477 (No. 1)	20 feet	0.08	.001	.00
478 (No. 3)	10 feet	0.04	.002	.00
479 (No. 2)	20 feet	0.02	.001	.00
7380	grab	0.010	.02	---
7381	grab	0.14	.07	---

See prospector's sketch for sample locations

Assays by Min-En Labs of North Vancouver, B. C.

*IF or/Am why
no follow up?
Why no assay sheet?
Why? Why? Why?
Following Ass Rpts. make
no mention of zone.*

8.0 COST ESTIMATE

PERSONNEL:

Prospector:	Oct. 3, 11, 12, 13, 17, 18, 1978; 6 days @ \$90/day	\$ 540.00
Prospector:	Sept. 17, 18, 19, 20, 21, 23, 24, 25, 26, 27; 10 days @ \$90/day	\$ 900.00
Field Man:	Sept. 17, 18, 19, 20, 21, 23, 24, 25, 26, 27; 10 days @ \$70/day	\$ 700.00
Supervisor:	Sept. 17, 18, 19, 20, 21, 23, 24, 25, 26, 27; 10 days @ \$100/day	\$ 1,000.00
Helper:	Sept. 18, 19, 20, 21, 23, 24, 25, 26, 27; 9 days @ \$60/day	\$ 540.00
Field Man:	Sept. 19, 20, 21, 23, 24, 25, 26, 27; 8 days @ \$70/day	\$ 560.00
Field Man:	Sept. 20, 21, 23, 24, 25, 26, 27; 7 days @ \$70/day	\$ 490.00
Field Man:	Sept. 20, 21, 23, 24, 25, 26, 27; 7 days @ \$70/day	\$ 490.00
	Sub total.....	\$ 5,220.00

cont'd.....



COST ESTIMATE (cont'd)

Balance forward	\$ 5,220.00
Geochemical Analysis:	
1213 soil samples @ \$4.40/sample	\$ 5,337.20
7 assays @ \$4.90/assay	\$ 34.30
Food and Accommodation	\$ 1,220.00
Mileage - 400 miles (2 trucks) @ \$.25/mi.....	\$ 100.00
Drafting - 56 hours @ \$12.00/hr.....	\$ 672.00
Total	<u>\$12,583.50</u>



9.0 CERTIFICATE:

I, Gary H. Giroux of 982 Broadview Dr., North Vancouver, British Columbia, do hereby certify that:

1. I am a consulting geological Engineer with an office at 211 - 850 West Hastings Street, Vancouver, British Columbia.
2. I am a graduate of the University of British Columbia (1970) with a degree in Geological Engineering. (B.A. Sc.)
3. I have practiced my profession continuously since graduation.
4. I have no interest, either direct or indirect in the properties or securities of Aquarius Resources Ltd., nor do I expect to receive any such interest.
5. I am a member of good standing of the Association of Professional Engineers of the province of British Columbia.

G. H. Giroux

G. H. Giroux, P. Eng.
982 Broadview Dr.,
North Vancouver, B.
December, 1978.

A circular seal for the Professional Engineers of the Province of British Columbia. The outer ring contains the text "PROFESSIONAL ENGINEERS OF THE PROVINCE OF BRITISH COLUMBIA". The inner circle contains the text "PROFESSIONAL OF G. H. GIROUX BRITISH COLUMBIA ENGINEER".

10.0 BIBLIOGRAPHY

Monger, J.W.H. "Hope Map Area, west half British Columbia",
1969 G.S.C. Paper 69-47

British Columbia Department of Mines: "Cloverleaf" 1966,
p. 276; 1967, p. 64; 1968, p. 77;
1969, p. 198; 1970, p. 249; 1973, p. 130-
131; British Columbia Minister of Mines
Annual Reports.



TABLE OF CONTENTS

	PAGE
1.0 INTRODUCTION.....	1
2.0 SUMMARY AND CONCLUSIONS	2
3.0 LOCATION AND ACCESS	3
4.0 CLAIM INFORMATION	4
5.0 REGIONAL GEOLOGY.....	4
6.0 GEOCHEMICAL SURVEY	5
7.0 COST STATEMENT	6
8.0 CERTIFICATE	7

FIGURES

1.	Location Map	Report body
2.	Claim Map	" "
3.	Regional Geology	" "
4.	Geochemical Plan	" "
5.	Histogram For Gold Values	" "



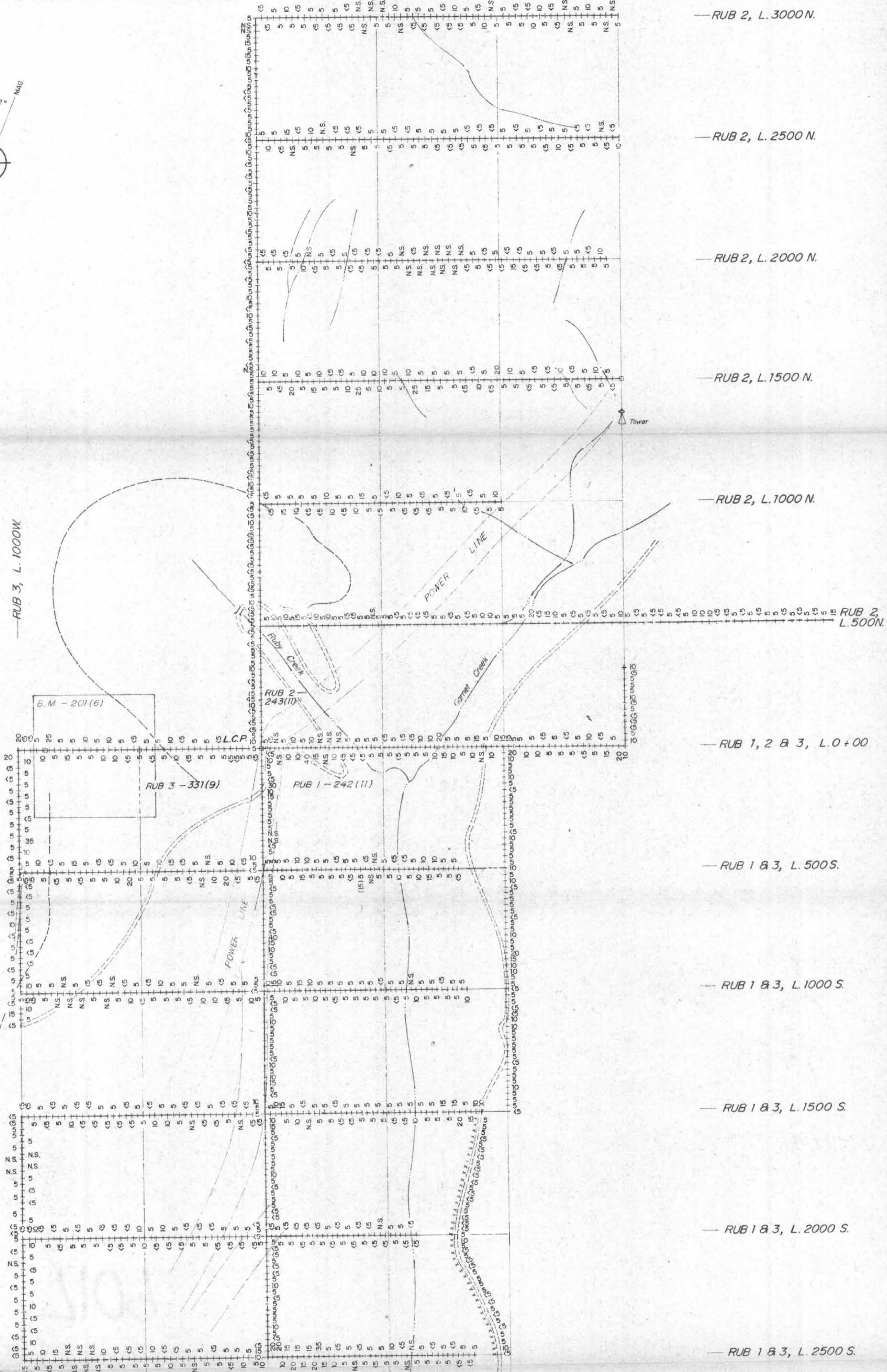

Note: "B" Soil Horizon sampled where possible.

LEGEND

- Bike trail
- Road
- Claim line
- Located post
- Cut line & station

MINERAL RESOURCES BRANCH
 ASSIGNMENT REPORT
7109
 NO.



AQUARIUS RESOURCES LTD.

Ruby Creek Group Project
 Rub 1, 2 & 3 Claims near Laidlaw, B.C.
 New Westminster M.D. N.T.S. 92H/5E.

Scale: 1:10,000
 0 50 100 500 1000 meters

Base map from Company field maps by A.B., Sept. '78 Traced Oct. '78, P.K.C.
 To accompany a report by G.H. Giroux, P.Eng., on the Ruby Creek Group, Dec. '78.

GEOCHEMICAL DATA
 (Au, p.p.b.)

Fig. 4

Cochrane Consultants Limited
 4882 Delta St. Delta, B.C. V4K 2T8 946-9221

RUB 1, 2 & 3, BL.

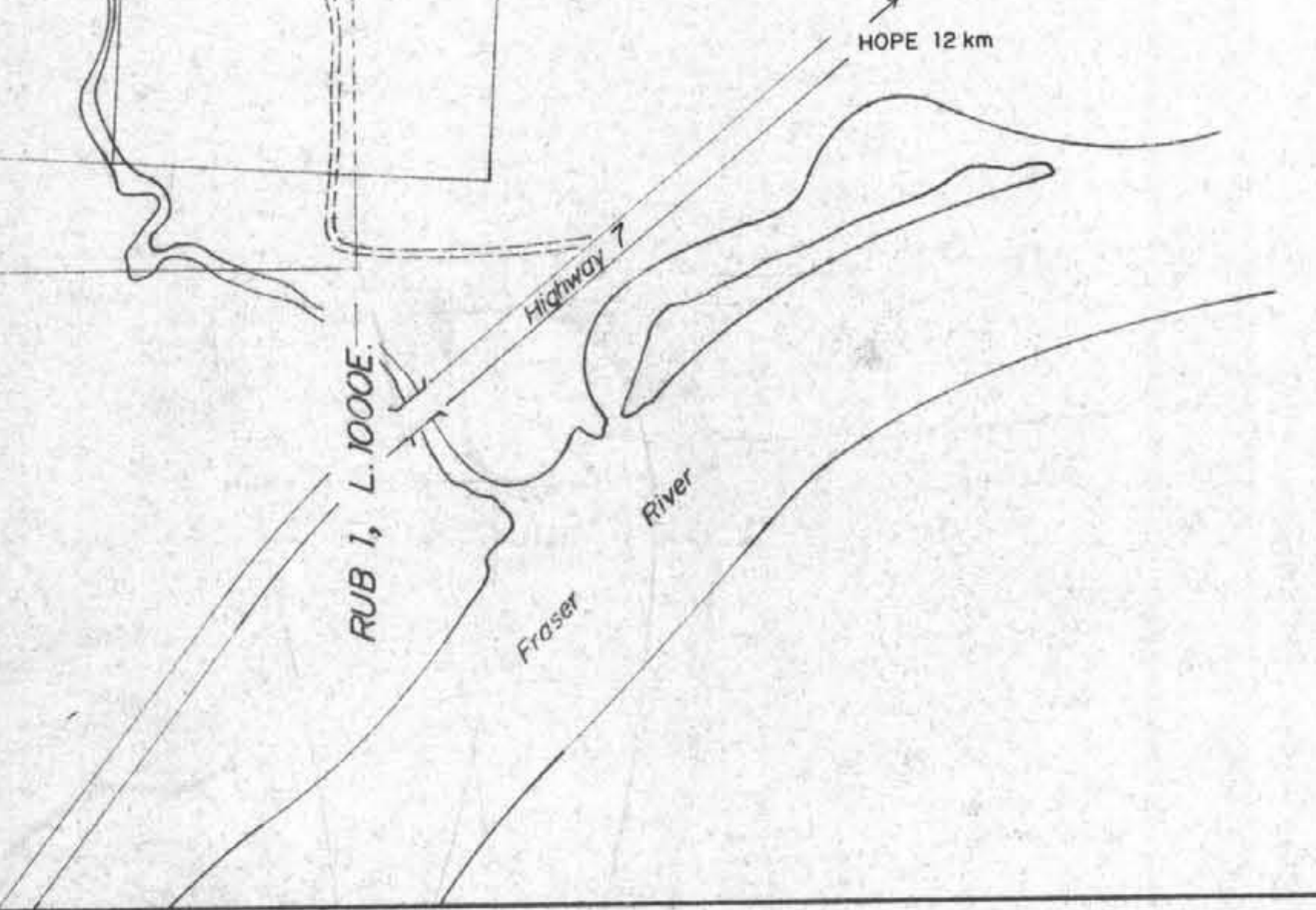

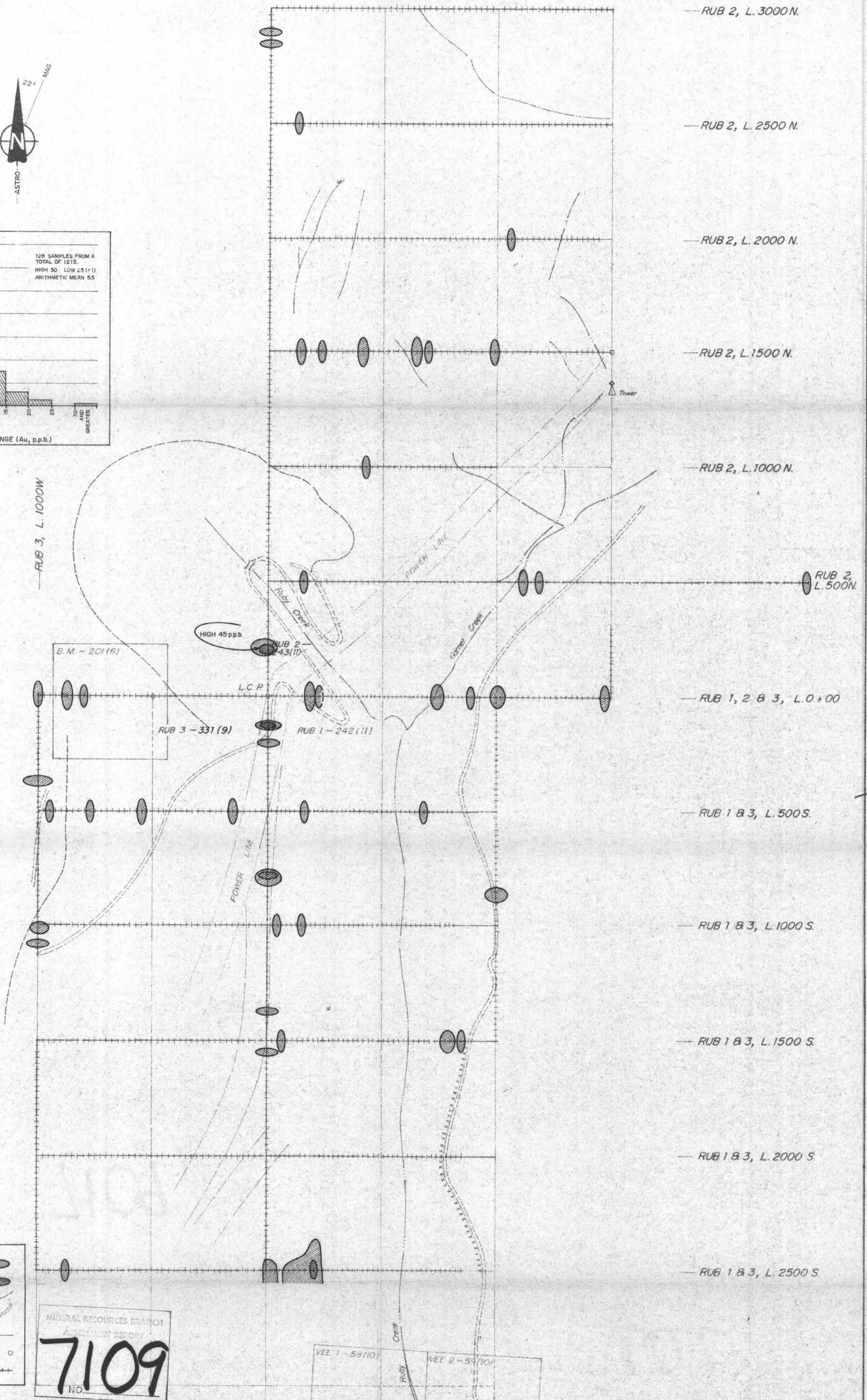
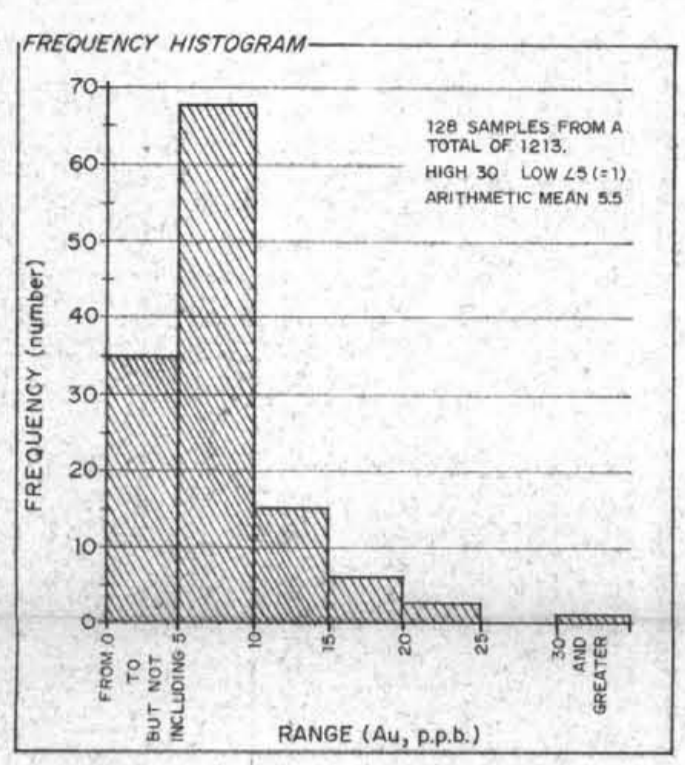

LEGEND

- 15 p.p.b. to 30 p.p.b.
- 30 p.p.b. & greater
- Bike trail
- Road
- Claim line
- Located post
- Cut line & station

MINERAL RESOURCES BRANCH
ASSESSMENT REPORT
7109
NO.

AQUARIUS RESOURCES LTD.

Ruby Creek Group Project
Rub 1, 2 & 3 Claims near Laidlaw, B.C.
New Westminster M.D. N.T.S. 92H/5E.

Scale: 1:10,000
0 50 100 500 1000 meters

Base map from Company field maps by A.B., Sept. '78 Traced Oct. '78, P.K.C.
To accompany a report by G.H. Giroux, P.Eng. on the Ruby Creek Group, Dec. '78

GEOCHEMICAL PLAN Fig. 5
(Au, p.p.b.)

Cochrane Consultants Limited
4882 Delta St., Delta, B.C. V4K 2T8 946-9221

