

REPORT TO MR. HERB ALLEN

TO

VERIFY ASSESSMENT WORK

ON THE TWO

CINDERELLA UNITS

NEAR MERRITT

NICOLA MINING DIVISION, B.C.

BY

SHERWIN F. KELLY, P. ENG.

MARCH 29, 1979

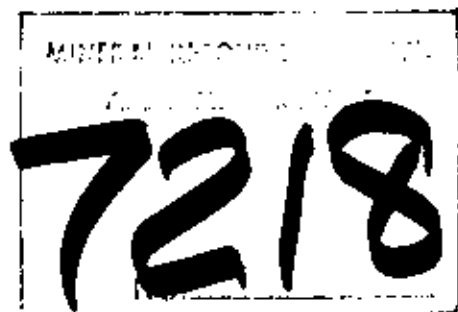

REPORT OF ASSESSMENT WORK
ON THE CINDERELLA CLAIM
NICOLA MINING DIVISION, B.C.

TABLE OF CONTENTS

TEXT.....pp 1-2

BOUND, following text:

LOCATION MAP, CINDERELLA CL.

LOCATION MAP, DRILL HOLE

CORE LOG OF 200 FT.

REPORT TO VERIFY ASSESSMENT WORK
ON THE TWO
CINDERELLA UNITS
NEAR MERRITT
NICOLA MINING DIVISION, B.C.
BY
SHERWIN F. KELLY, P. ENG.

The Cinderella claim, consisting of two units, lies about 3 miles (5km) northeasterly of Merritt. It is up in the hills forming the west (right) bank of the Nicola River, at an elevation of 3,500 to 4,000 ft. (1,140 to 1,200 m). The area is accessible by a dirt road leading off to the north and east from Highway 5 (the road to Kamloops) in the outskirts of Merritt. The position of the claim is shown on the attached Location Map, a copy of a portion of the claim map on file in the office of the Gold Commissioner in Merritt. The Record No. of the claim is 213 and the month of record is February. It was staked and is held by Mr. Herb Allen of Merritt.

On January 28, 1979, an affidavit for assessment work was filed with the Gold Commissioner in Merritt by the claim owner, Herb Allen. Work, consisting of diamond drilling, to the value of \$2,000 was claimed. The drilling was done by Herb Allen himself.

The drill hole was spotted on the boundary line running east and west between the north unit and the south unit of the Cinderella claim. It was collared 500 ft. (153 m) west of the east claim post on that line. The hole was drilled due west at

-70°. It was started on May 1, 1978, and completed at a depth of 600 ft. on May 20, 1978. The hole was drilled with a BQ bit, yielding a core with a diameter of 1 7/16 inches.

The core was boxed and the first 200 ft. (61 m) are stored at Mr. Allen's house at the north edge of Merritt. The balance of 400 ft. (122 m) is at the drill site. Since 200 ft. of drilling is ample to account for \$2,000 worth of work, I logged only the first 200 ft. of core, stored at Mr. Allen's house. The log sheets are attached to this report.

In summary, after penetrating 30 ft. of overburden the drill entered a bedrock of andesitic tuff of the Nicola formation. The 200 ft. logged were all in the same rock and Herb Allen reported that the balance of 400 feet was the same. It carries varying, but small amounts of disseminated pyrite. From 88 to 96 ft., calcite-opidote veining with albitisation occurs. The vein, about 1/2 in. wide, is nearly parallel to the axis of the core. It carries some pyrite and chalcopryite. At 96 ft. a thin vein about 1/16 in. wide cuts across the core, carrying chalcopryite and hematite. Pyrite is more heavily disseminated in the vicinity of this veining than at any other place in the core reviewed. No mineralisation worth sampling was seen.

The figure of \$2,000 is a very reasonable and acceptable cost to ascribe to the drilling of this hole, to cover the 200 ft. of core reviewed. It is therefore requested that the sum of \$2,000 be allocated to assessment work on the two units of the Cinderella claim.

Box 277
Merritt, B.C.
March 29, 1979

Respectfully submitted

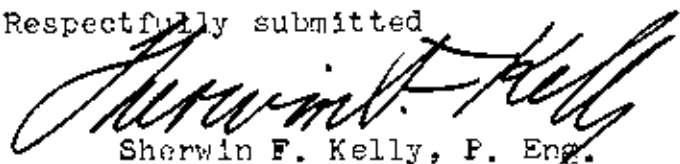
Sherwin F. Kelly, P. Eng.

CINDERELLA is an exact replica of the CN claim which is now plotted on map 92 I/2E.

CINDERELLA 4

TO EAST SEE MAP 92 I/2 E



3



213

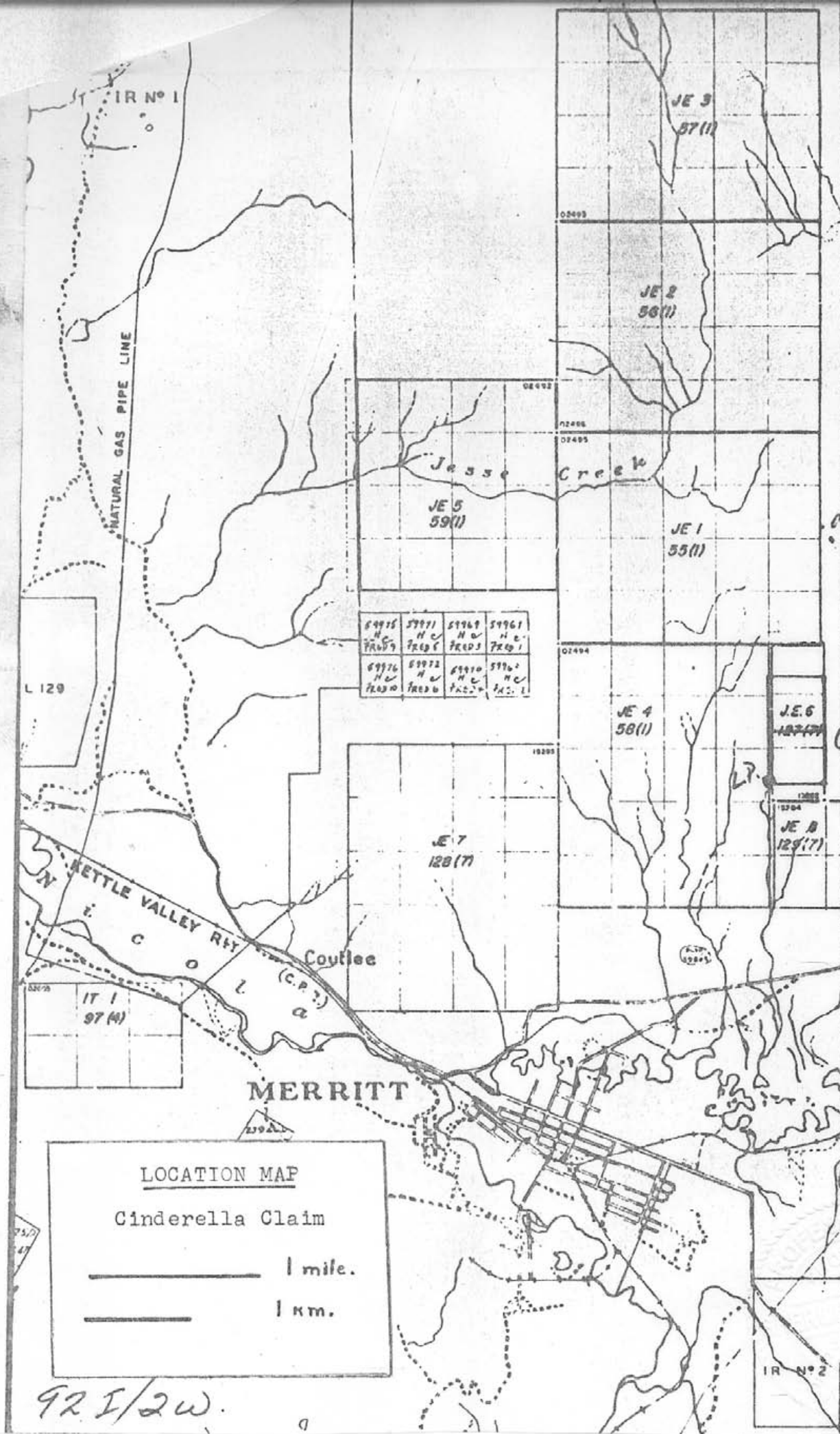

LOCATION MAP

Cinderella Claim

————— 1 mile.

————— 1 km.

92 I/2W.

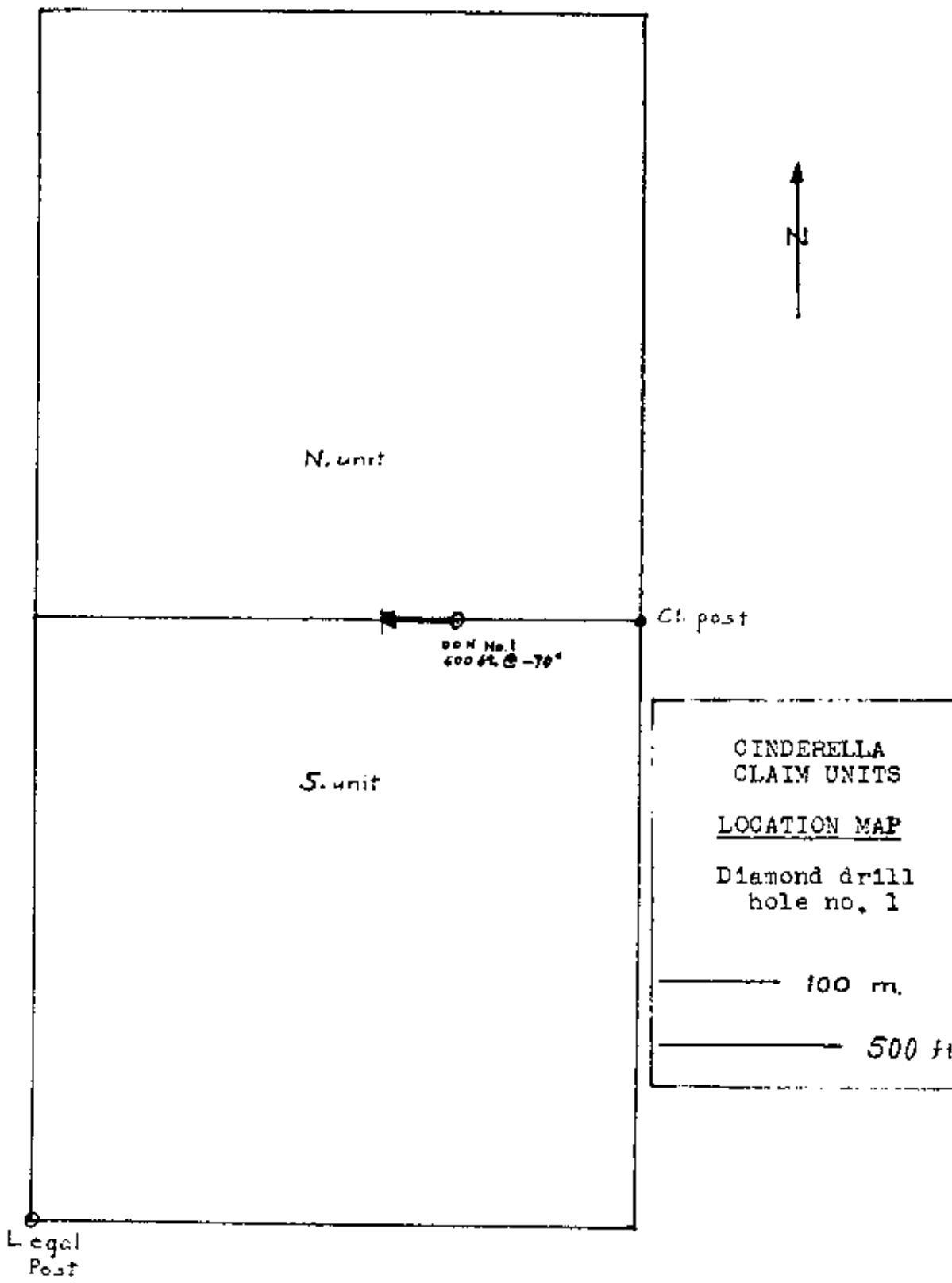

Herbert F. Kelly, Eng.

