

GEOCHEMICAL REPORT

on the

JEWEL CREEK PROPERTY

GREENWOOD MINING DIVISION

118° 37'W Longitude; 49° 10'N Latitude

N.T.S. 82E/2E

on behalf of

OWNER: ROANOKE EXPLORATIONS LTD.

OPERATOR: ROANOKE EXPLORATIONS LTD.

by

JAMES W. McLEOD, GEOLOGIST

June 8, 1979

MINERAL RESOURCES BRANCH ASSESSMENT REPORT 7297 NO. _____
--

## TABLE OF CONTENTS

SUMMARY.....	1
INTRODUCTION.....	1
LOCATION AND ACCESS.....	1
PROPERTY AND OWNERSHIP.....	2
TOPOGRAPHICAL AND PHYSICAL ENVIRONMENT...	2
GEOLOGY AND MINERALIZATION.....	2
WORK PROGRAMME.....	3
CONCLUSIONS AND RECOMMENDATIONS.....	3
PARTIAL COST OF 1978 PROGRAMME.....	4
CERTIFICATE.....	5

## APPENDIX - GEOCHEMICAL SOIL ANALYSES

### ILLUSTRATIONS

- Figure 1 - INDEX MAP in front
- FIGURE 2 - CLAIM SKETCH in front
- FIGURE 3 - PROPERTY PLAN in back



**FIGURE 1**  
**JEWEL CREEK PROPERTY**  
**INDEX MAP**

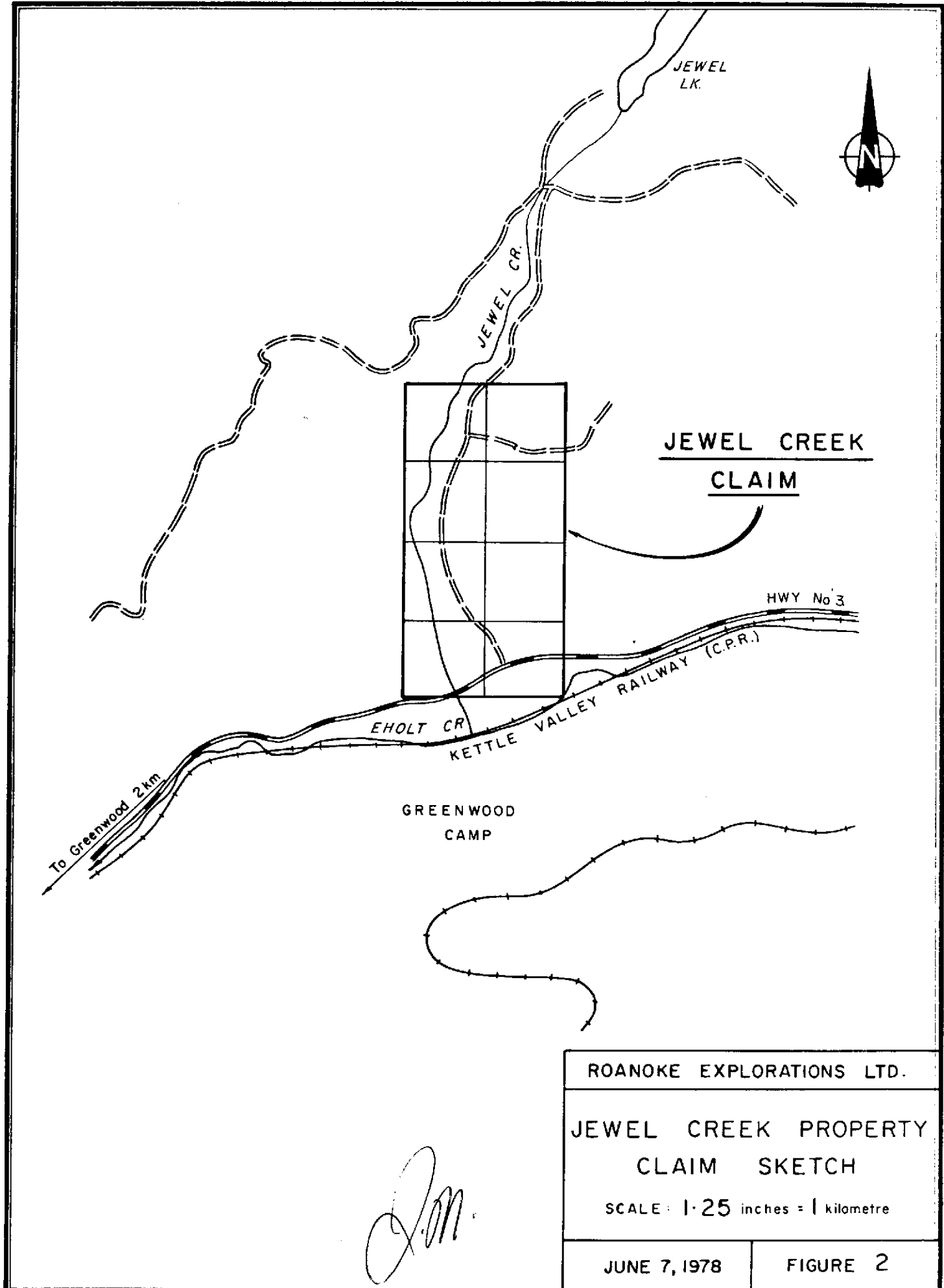

JEWEL CREEK  
CLAIM

ROANOKE EXPLORATIONS LTD.

JEWEL CREEK PROPERTY  
CLAIM SKETCH

SCALE: 1.25 inches = 1 kilometre

JUNE 7, 1978

FIGURE 2

*[Handwritten signature]*

## SUMMARY

Several showings of chalcopyrite, pyrite, magnetite and pyrrhotite mineralization containing values up to 0.82% copper; 0.35 oz/ton silver and 0.002 oz/ton gold were examined by the writer in May 1978. Also a number of zones anomalous in gold were indicated by the geochemical soil survey undertaken on part of the claim area.

The writer recommends that a programme of fill-in geochemical soil sampling, a VLF-EM and magnetometer survey, rock trenching and geological mapping be undertaken about the anomalous zones.

## INTRODUCTION

During May, 1978, the writer examined a number of mineral showings and the linecutting, geochemical soil sampling programme and hand trenching programme that was underway at the time on the property.

The field examination and this report were undertaken at the request of the Directors of Roanoke Explorations Ltd.

## LOCATION AND ACCESS

The property is located approximately 10 kilometers northeast of the Town of Greenwood, British Columbia, and extends north from Highway No. 3 for approximately 2 kilometers and straddles Jewel Creek.

Access to the property is gained by travelling northeast on Highway No. 3 for 4 kilometers from Greenwood, British Columbia.

#### PROPERTY AND OWNERSHIP

The Jewel Mineral Claim is comprised of eight units, having a record number of 770 and an expiry date of May 16, 1979.

The Jewel Mineral Claim is owned by Roanoke Explorations Ltd. of Vancouver, British Columbia.

#### TOPOGRAPHICAL AND PHYSICAL ENVIRONMENT

The property is situated in rounded, moderately steep terrain at an elevation of 600 meters - 1,200 meters m.s.l.

The area is conifer covered on the north-facing slopes and generally more open on the south facing slopes. The area experiences a mild climate and low to moderate precipitation.

#### GEOLOGY AND MINERALIZATION

The property is underlain by Triassic rocks of the Anarchist Formation, which are in geological contact with the Cretaceous Nelson Intrusives. The Anarchist rocks are comprised of greenstone, greywacke, limestone and para-gneiss. The productive properties of the Phoenix Mining Camp are contained mainly within replaced, skarn zones of the same rock, the Brooklyn limestone.

Mineralization observed on the property has many similarities to that encountered in the Phoenix ore deposits, i.e. chalcopryrite, pyrite, magnetite and pyrrhotite. On the property the mineralization occurs as massive blebs and disseminations in a silicified, greenish skarn and as massive blebs in a very siliceous, brown garnet-rich rock, i.e. garnetite? which possibly forms a boundary zone to the skarn and limestone. A

four foot sample of this material, which was extensively decomposed was assayed by the Granby Mining Company and ran 0.82% copper; 0.35 oz/ton silver and 0.002 oz/ton gold. Two mineral showings of this type occur in the southeast corner of the claim. They are separated by several hundred feet of overburden covered area.

The main mineralized zone (see Figure 3) 'A' is a garnet-rich zone "garnetite" over 30 meters in width of which 10 - 15 meters contains disseminated to massive chalcopyrite over approximately one meter. The copper carbonate stain (Malachite) occurs over the 10 - 15 meters of exposed width. Zone 'B' is very similar to 'A'.

#### WORK PROGRAMME

The work programme conducted to date included approximately 13 kilometers of line installation (flagged, blazed and stations marked at 25-meter intervals); 331 soil samples were taken from the 'B' soil horizon where possible; hand trenching at zone 'C' and prospecting.

#### CONCLUSIONS AND RECOMMENDATIONS

The two main mineralized skarn, garnetite zones (see Figures 3 'A' and 'B') contain significant values of copper and silver and the covered area intermediate to these zones revealed anomalous soil sample analysis in copper. A number of soil samples anomalous in gold occur throughout the claim.

The writer recommends that follow-up work be undertaken about the areas of known mineralization and areas exhibiting anomalous soil sample values. The follow-up work should include fill-in geochemical soil sampling; VLF electromagnetic and magnetometer surveys about mineralized and anomalous areas; rock trenching

and geological mapping. The decision to diamond or percussion drill at zones 'A' and 'B' should be deferred until the recommended programme has been completed.

PARTIAL COST OF 1978 PROGRAMME

WAGES

2 men May 25-30, 1978 @ \$80/man/day \$800.00

Respectfully submitted,

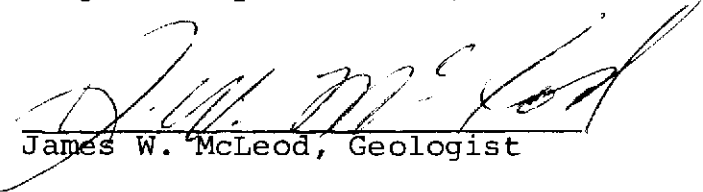
  
James W. McLeod, Geologist



CERTIFICATE

I, JAMES W. McLEOD, of the City of Vancouver, Province of British Columbia, hereby certify as follows:

1. I am a geologist and an Associate Member of the Geological Association of Canada.
2. I reside at 4086 West 17th Avenue, Vancouver, B.C.
3. I graduated in 1969 from the University of British Columbia, B.Sc. (Major - Geology)
4. I have practised my profession since 1969.
5. I have not, directly or indirectly, received or expect to receive any interest, direct or indirect in the property of the Company, or any affiliate, nor do I beneficially own, directly or indirectly, any securities of the Company or any affiliate.
6. The above report is based upon field work performed during May, 1978.

  
James W. McLeod, B.Sc.

Dated at Vancouver British Columbia, this 8th day of June, 1979.

APPENDIX "A"

GEOCHEMICAL SOIL ANALYSES

APPENDIX "A"

**ACME ANALYTICAL LABORATORIES LTD.**

TO Mr. George O'Brien,  
P. O. Box 254,  
Greenwood, B. C.

Assaying & Trace Analysis  
6455 Laurel St., Burnaby, B.C. V5B 3B4

Tel: 299-5242

File No. 8249

Type of Samples Soils

Disposition \_\_\_\_\_

**ANALYSES CERTIFICATE**

*Job #1*

No.	Sample	Mo	Cu	Ag	Au						No.
01	Stn #1 - 0		5	.1	.005						01
02	1E		10	.1	.005						02
03	2		6	.1	.005						03
04	3		10	.1	.005						04
05	4		16	.1	.005						05
06	5		12	.1	.005						06
07	6		10	.1	.005						07
08	7		14	.1	.005						08
09	8		14	.3	.005						09
10	9		11	.1	.005						10
11	10		5	.1	.005						11
12	11		10	.1	.005						12
13	12		9	.1	.005						13
14	13		6	.1	.005						14
15	14		10	.1	.005						15
16	15		9	.1	.005						16
17	16		5	.1	.005						17
18	17		8	.1	.005						18
19	18		14	.1	.020						19
20	19		12	.1	.005						20
21	20		16	.1	.005						21
22	Stn #1 - 20AE		10	.1	.005						22
23											23
24	Stn #2 - 1E		10	.1	.005						24
25	2		11	.1	.005						25
26	3		12	.1	.005						26
27	4		10	.1	.005						27
28	5		22	.1	.005						28
29	6		18	.1	.005						29
30	7		12	.1	.005						30
31	8		12	.1	.005						31
32	9		22	.1	.005						32
33	10		14	.1	.005						33
34	11		12	.2	.005						34
35	12		12	.1	.005						35
36	13		28	.1	.005						36
37	14		18	.1	.005						37
38	15		12	.1	.005						38
39	Stn #2 - 16E		20	.1	.005						39
40											40

All reports are the confidential property of clients.  
All results are in parts per million.

DATE SAMPLES RECEIVED May 15, 1978  
DATE REPORTS MAILED May 23, 1978  
ANALYST G. Lang

**ACME ANALYTICAL LABORATORIES LTD.**

Assaying & Trace Analysis  
6455 Laurel St., Burnaby 2, B.C.

Tel: 299-5242

TO Mr. George O'Brien

File No. 8249

**ANALYSES CERTIFICATE**

Type of Samples soil

Disposition \_\_\_\_\_

No.	Sample	Cu	Ag	Au							No.
01	Stn #2 17E	41	.2	.005							01
02	18	13	.1	.005							02
03	19	10	.1	.005							03
04	20E	14	.1	.005							04
05											05
06	Stn #3 0	10	.1	.010							06
07	1E	17	.1	.010							07
08	2	9	.2	.005							08
09	3	8	.1	.005							09
10	4	9	.1	.005							10
11	5	5	.1	.005							11
12	6	11	.1	.005							12
13	7	9	.1	.005							13
14	8	10	.1	.005							14
15	9	7	.2	.005							15
16	10	6	.1	.005							16
17	11	7	.1	.005							17
18	12	10	.1	.005							18
19	13	6	.1	.005							19
20	14	9	.1	.005							20
21	15	9	.1	.005							21
22	16	12	.1	.005							22
23	17	7	.1	.005							23
24	18	7	.2	.005							24
25	19	9	.1	.010							25
26	20E	7	.1	.010							26
27	Stn #4 0	9	.1	.005							27
28	1E	16	.1	.005							28
29	2	8	.1	.005							29
30	3	7	.1	.005							30
31	4	10	.1	.005							31
32	5	12	.1	.005							32
33	6	27	.1	.005							33
34	7	10	.1	.005							34
35	8	10	.1	.005							35
36	9	10	.1	.005							36
37	10	11	.1	.005							37
38	11	12	.1	.005							38
39	12	10	.1	.005							39
40											40

All reports are the confidential property of clients.

All results are in parts per million.

DATE SAMPLES RECEIVED 5-15-1978

DATE REPORTS MAILED 5-23-1978

ANALYST B. Young

TO Mr. George O'Brien

# ACME ANALYTICAL LABORATORIES LTD.

Assaying & Trace Analysis  
6455 Laurel St., Burnaby 2, B.C.

Tel: 299-5242

File No. 8249

Type of Samples soil

Disposition \_\_\_\_\_

## ANALYSES CERTIFICATE

p.3

No.	Sample	Cu	Ag	Au						No.
01	Stn#4 13E	3	.1	.005						01
02	14	11	.1	.490						02
03	15	6	.1	.005						03
04	16	8	.1	.005						04
05	17	7	.1	.005						05
06	18	10	.1	.005						06
07	19	6	.1	.005						07
08	20E	7	.1	.005						08
09										09
10	Stn#4 0	10	.1	.005						10
11	1	10	.2	.005						11
12	2	12	.2	.005						12
13	3	6	.1	.005						13
14	4	7	.1	.005						14
15	5	16	.1	.005						15
16	6	11	.1	.005						16
17	7	8	.1	.005						17
18	8	10	.1	.005						18
19	9	9	.1	.005						19
20	10	10	.1	.005						20
21	11	10	.1	.005						21
22	12	6	.1	.005						22
23	13	9	.1	.005						23
24	14	7	.1	.005						24
25	15	8	.1	.005						25
26	16	15	.1	.005						26
27	17	8	.1	.005						27
28	18	10	.1	.005						28
29	19	6	.1	.005						29
30	20E	6	.1	.005						30
31										31
32	Stn#6 0	11	.2	.005						32
33	1E	8	.1	.005						33
34	2	10	.1	.005						34
35	3	11	.1	.005						35
36	4	9	.1	.005						36
37	5	9	.1	.005						37
38	6	8	.1	.005						38
39	7	14	.1	.005						39
40	8	6	.1	.005						40

All reports are the confidential property of clients.

All results are in parts per million.

DATE SAMPLES RECEIVED 5-15-1978  
DATE REPORTS MAILED 5-23-1978  
ANALYST B. Young

TO Mr. George O'Brien

ACME ANALYTICAL LABORATORIES LTD.

Assaying & Trace Analysis  
6455 Laurel St., Burnaby 2, B.C.

Tel: 299-5242

File No. 8249

Type of Samples soil

Disposition

ANALYSES CERTIFICATE

p.4

No.	Sample	Cu	Ag	Au						No.
01	Stn #6 9E	11	.1	.005						01
02	10	14	.1	.005						02
03	11	14	.1	.005						03
04	12	12	.1	.005						04
05	13	8	.1	.005						05
06	14	12	.1	.005						06
07	15	12	.2	.005						07
08	16	14	.2	.005						08
09	17	10	.1	.005						09
10	18	8	.1	.005						10
11	19	8	.1	.005						11
12	20E	10	.1	.005						12
13										13
14	Stn#7 0	12	.1	.005						14
15	1E	11	.1	.005						15
16	2	7	.1	.005						16
17	3	7	.1	.005						17
18	4	12	.1	.005						18
19	5	10	.1	.005						19
20	6	6	.1	.005						20
21	7	12	.1	.005						21
22	8	14	.1	.005						22
23	9	12	.1	.005						23
24	10	10	.1	.005						24
25	11	14	.1	.005						25
26	12	12	.1	.005						26
27	13	12	.2	.005						27
28	14	13	.1	.005						28
29	15	5	.1	.005						29
30	16	12	.1	.005						30
31	17	13	.2	.005						31
32	18	4	.1	.005						32
33	19	14	.1	.005						33
34	20E	7	.1	.005						34
35										35
36	Stn#8 0	12	.1	.005						36
37	1E	9	.1	.005						37
38	2	16	.1	.005						38
39	3	11	.1	.005						39
40	4	11	.1	.005						40

All reports are the confidential property of clients.

All results are in parts per million.

DATE SAMPLES RECEIVED 5-15-1978  
DATE REPORTS MAILED 5-23-1978  
ANALYST B. Young

TO Mr. George O'Brien

**ACME ANALYTICAL LABORATORIES LTD.**

Assaying & Trace Analysis  
6455 Laurel St., Burnaby 2, B.C.

Tel: 299-5242

File No. 8249

Type of Samples soil

Disposition \_\_\_\_\_

**ANALYSES CERTIFICATE**

No.	Sample	Cu	Ag	Au							No.
01	Stn#8 5E	10	.1	.005							01
02	6	12	.1	.005							02
03	7	11	.1	.005							03
04	8	9	.1	.005							04
05	9	11	.1	.005							05
06	10	9	.1	.005							06
07	11	14	.1	.005							07
08	12	9	.1	.005							08
09	13	10	.1	.005							09
10	14	11	.1	.005							10
11	15	12	.1	.005							11
12	16	22	.1	.005							12
13	17	12	.1	.005							13
14	18	9	.1	.005							14
15	19	12	.1	.005							15
16	20E	20	.1	.005							16
17											17
18	Stn#9 0	12	.1	.005							18
19	1	12	.1	.005							19
20	2	11	.1	.005							20
21	3	12	.1	.005							21
22	4	7	.1	.005							22
23	5	8	.1	.005							23
24	6	15	.1	.005							24
25	7	12	.1	.005							25
26	8	17	.1	.005							26
27	9	14	.1	.005							27
28	10	12	.1	.005							28
29	11	17	.2	.010							29
30	12	13	.1	.010							30
31	13	9	.1	.005							31
32	14	14	.2	.005							32
33	15	14	.1	.005							33
34	16	15	.1	.005							34
35	17	20	.1	.005							35
36	18	14	.1	.005							36
37	19	13	.1	.005							37
38	20E	14	.1	.005							38
39											39
40											40

All reports are the confidential property of clients.

All results are in parts per million.

DATE SAMPLES RECEIVED 5-15-1978  
 DATE REPORTS MAILED 5-23-1978  
 ANALYST B. Young

TO Mr. George O'Brien

### ACME ANALYTICAL LABORATORIES LTD.

Assaying & Trace Analysis  
6455 Laurel St., Burnaby 2, B.C.

Tel: 299-5242

File No. 8249

Type of Samples soil

Disposition \_\_\_\_\_

## ANALYSES CERTIFICATE

No.	Sample	Cu	Ag	Au							No.
01	Stn#10 0	10	.1	.005							01
02	1E	10	.1	.005							02
03	2	16	.1	.005							03
04	3	14	.1	.005							04
05	4	14	.1	.005							05
06	5	10	.1	.005							06
07	6	16	.1	.005							07
08	7	14	.1	.005							08
09	8	14	.1	.005							09
10	9	12	.1	.005							10
11	10	13	.1	.005							11
12	11	10	.1	.005							12
13	12	11	.2	.005							13
14	13	13	.1	.005							14
15	14	14	.1	.005							15
16	15	15	.1	.005							16
17	16	11	.2	.005							17
18	17	13	.1	.005							18
19	18	12	.1	.005							19
20	19	14	.1	.005							20
21	20E	20	.1	.005							21
22											22
23	Stn#11 1E	15	.1	.005							23
24	2	24	.1	.005							24
25	3	29	.2	.005							25
26	4	19	.1	.005							26
27	5	34	.1	.005							27
28	6	47	.1	.005							28
29	7	90	.1	.005							29
30	8	158	.1	.005							30
31	9	200	.2	.020							31
32	10	22	.1	.005							32
33	11	23	.1	.005							33
34	12	31	.1	.005							34
35	13	21	.1	.005							35
36	14	19	.1	.005							36
37	15E	17	.2	.005							37
38											38
39											39
40											40

All reports are the confidential property of clients.

All results are in parts per million.

DATE SAMPLES RECEIVED 5-15-1978

DATE REPORTS MAILED 5-23-1978

ANALYST B. Young



TO Mr. George O'Brien,  
P. O. Box 254,  
Greenwood, B. C.

**ACME ANALYTICAL LABORATORIES LTD.**

Assaying & Trace Analysis  
6455 Laurel St., Burnaby, B.C. V5B 3B4

Tel: 299-5242

File No. 8249

Type of Samples Soils

Disposition \_\_\_\_\_

**ANALYSES CERTIFICATE**

P. 7

No.	Sample	Mo	Cu	Ag	Au						No.
01	Stn #1 - 1W		14	.1	.005						01
02	2		12	.1	.005						02
03	3		12	.1	.005						03
04	4		16	.1	.005						04
05	5		14	.1	.005						05
06	6		8	.1	.005						06
07	7		12	.1	.005						07
08	8		15	.1	.010						08
09	9		9	.1	.005						09
10	10		12	.1	.005						10
11	11		12	.2	.005						11
12	12		8	.1	.005						12
13	13		16	.1	.005						13
14	14		7	.1	.005						14
15	15		14	.1	.005						15
16	16		10	.1	.005						16
17	17		6	.1	.005						17
18	18		10	.1	.005						18
19	19		14	.1	.005						19
20	Stn #1 - 20W		15	.1	.005						20
21											21
22	STn #2 - 0		8	.1	.005						22
23	1W		10	.1	.005						23
24	2		13	.1	.005						24
25	3		14	.1	.005						25
26	4		11	.1	.005						26
27	5		11	.1	.005						27
28	6		17	.1	.005						28
29	7		9	.1	.005						29
30	8		34	.1	.005						30
31	9		9	.1	.005						31
32	10		11	.1	.005						32
33	11		12	.1	.005						33
34	12		15	.1	.005						34
35	Stn #2 - 13W		12	.1	.005						35
36											36
37	Stn #3 - 1W		13	.2	.005						37
38	2		10	.1	.005						38
39	3		12	.2	.005						39
40	Stn #3 - 4		6	.1	.005						40

All reports are the confidential property of clients.  
All results are in parts per million.

DATE SAMPLES RECEIVED May 15, 1978

DATE REPORTS MAILED May 23, 1978

ANALYST B. Jones

**ACME ANALYTICAL LABORATORIES LTD.**

Assaying & Trace Analysis

6455 Laurel St., Burnaby, B.C. V5B 3B4

Tel: 299-5242

TO Mr. George O'Brien,  
P. O. Box 254,  
Greenwood, B. C.

File No. 8249

Type of Samples Soils

Disposition \_\_\_\_\_

**ANALYSES CERTIFICATE**

P. 8

No.	Sample	Mo	Cu	Ag	Au					No.
01	Stn #3 - 5W		12	.1	.005					01
02	6		7	.1	.005					02
03	7		5	.1	.005					03
04	8		6	.1	.005					04
05	9		4	.1	.005					05
06	10		12	.1	.020					06
07	11		10	.1	.005					07
08	12		16	.1	.005					08
09	13		9	.1	.005					09
10	14		11	.1	.005					10
11	15		10	.1	.005					11
12	16		13	.1	.005					12
13	17		16	.2	.005					13
14	18		8	.1	.005					14
15	19		10	.2	.005					15
16	Stn #3 - 20W		6	.1	.005					16
17										17
18	Stn #4 - 1W		7	.1	.005					18
19	2		7	.1	.005					19
20	3		11	.1	.005					20
21	4		12	.1	.005					21
22	5		9	.1	.005					22
23	6		6	.1	.005					23
24	7		10	.1	.005					24
25	8		12	.1	.005					25
26	9		7	.2	.005					26
27	10		N.	S.						27
28	11		8	.1	.005					28
29	12		10	.1	.005					29
30	Stn #4 - 13W		8	.1	.005					30
31										31
32	Stn #5 - 1W		12	.1	.005					32
33	2		15	.1	.005					33
34	3		9	.1	.005					34
35	4		7	.1	.005					35
36	5		10	.1	.005					36
37	6		12	.1	.005					37
38	7		7	.1	.005					38
39	Stn #5 - 8W		11	.1	.005					39
40										40

All reports are the confidential property of clients.  
All results are in parts per million.

DATE SAMPLES RECEIVED May 15, 1978  
DATE REPORTS MAILED May 23, 1978  
ANALYST B. Young

TO Mr. George O'Brien,  
P. O. Box 254,  
Greenwood, B. C.

**ACME ANALYTICAL LABORATORIES LTD.**

Assaying & Trace Analysis  
6455 Laurel St., Burnaby, B.C. V5B 3B4

Tel: 299-5242

File No 8249

Type of Samples Soils

Disposition \_\_\_\_\_

**ANALYSES CERTIFICATE**

P. 9

No.	Sample	Mo	Cu	Ag	Au						No.
01	Stn #6 - 1W		12	.1	.005						01
02	2		19	.2	.005						02
03	3		11	.2	.005						03
04	4		12	.1	.010						04
05	Stn #6 - 5W		17	.1	.005						05
06											06
07	Stn #7 - 1W		11	.2	.005						07
08	2		12	.1	.005						08
09	3		15	.1	.005						09
10	4		14	.1	.005						10
11	Stn #7 - 5W		10	.1	.005						11
12											12
13	Stn #8 - 1W		13	.1	.005						13
14	2		10	.1	.005						14
15	3		16	.2	.005						15
16	4		15	.1	.005						16
17	5		14	.1	.005						17
18	Stn #8 - 6W		8	.1	.005						18
19											19
20	Stn #9 - 1W		13	.1	.005						20
21	2		9	.1	.005						21
22	3		8	.1	.020						22
23	Stn #9 - 4W		10	.1	.040						23
24											24
25	Stn #10 - 1W		11	.1	.005						25
26	2		13	.1	.005						26
27	Stn #10 - 3W		12	.1	.005						27
28											28
29	Stn #11 - 0		25	.1	.005						29
30	1W		20	.1	.005						30
31	2		21	.1	.005						31
32	3		26	.1	.005						32
33	4		14	.1	.005						33
34	5		22	.1	.005						34
35	6		8	.1	.005						35
36	7		12	.1	.005						36
37	Stn #11 - 8W		24	.4	.030						37
38											38
39											39
40											40

All reports are the confidential property of clients.  
All results are in parts per million.

DATE SAMPLES RECEIVED May 15, 1978  
DATE REPORTS MAILED May 23, 1978  
ANALYST B. Terry

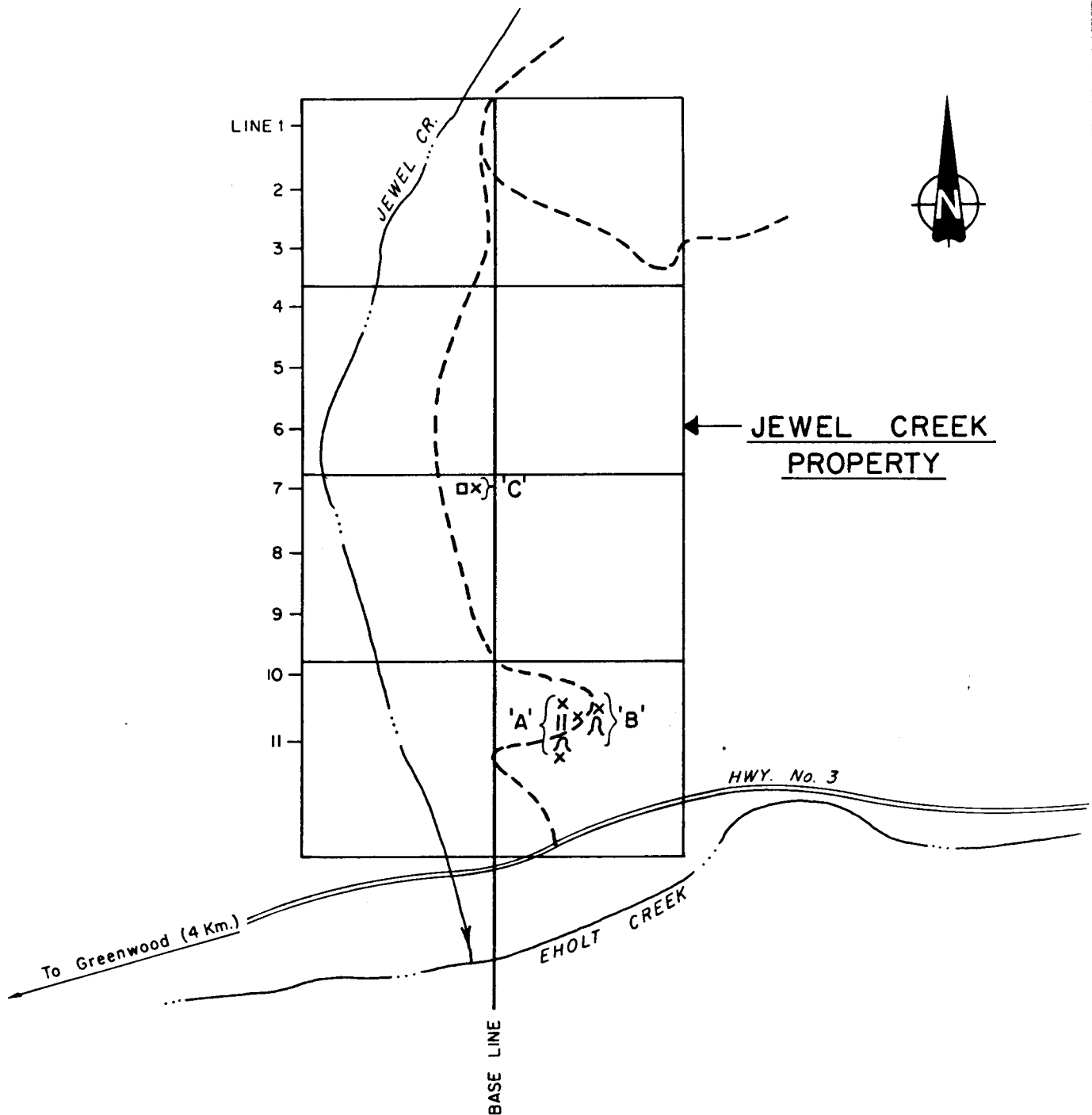

**LEGEND**

- ROAD
- - PIT
- ∩ - ADIT
- || - TRENCH
- x - MINERALIZATION

*J.M.*

ROANOKE EXPLORATIONS LTD.	
JEWEL CREEK PROPERTY PROPERTY PLAN	
SCALE: 1.25 inches = 500 metres	
JUNE 7, 1978	FIGURE 3