

NEW NADIVA EXPLORATIONS LTD

Owen Lake Property
1978 Diamond Drilling

<p>MINERAL DEVELOPMENT BOARD ASSESSMENT REPORT</p> <p>7343</p> <p>NO.</p>

CONTENTS

page	
1	Index map
2	Drill core logs
6	Assays
7	Statement of qualifications
8	Statement of costs
pocket	Property map

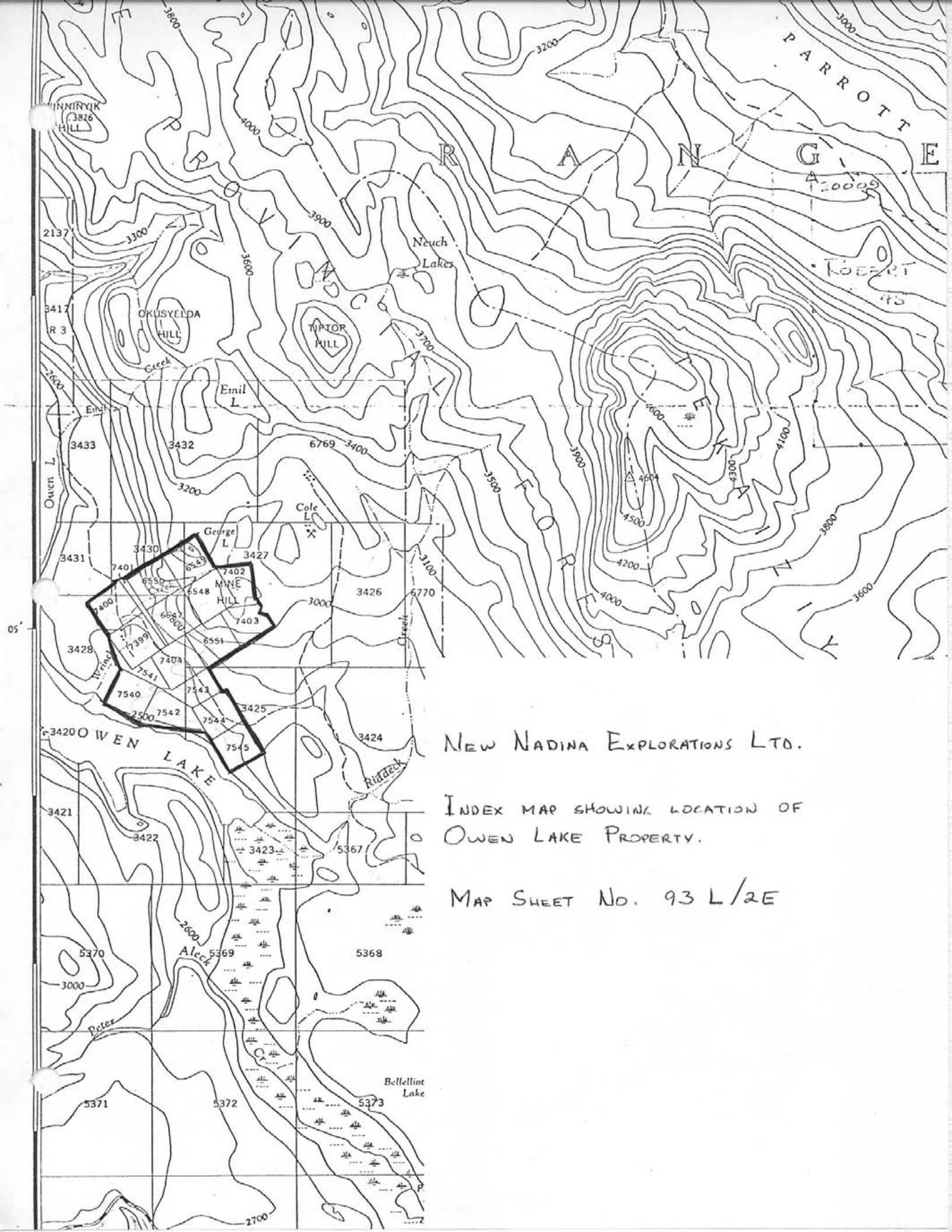

NEW NADINA EXPLORATIONS LTD.

INDEX MAP SHOWING LOCATION OF OWEN LAKE PROPERTY.

MAP SHEET NO. 93 L/2E

DIAMOND DRILL CORE GEOLOGICAL LOG

Hole No. 78-1
 Length 47 metres
 Bearing S 45° W
 Dip 45°
 Core Size BQ

Hole Started Nov 2/78
 Hole Finished Nov 2/78
 Logged By J.M. Hutter
 Signature J.M. Hutter
 Date JAN 15/79

Collar Co-ordinates
 Northing Easting
 Elevation 777 metres

Depth		Description	% Recovery
Feet	Metres		
0-32	0-9.8	OVERBURDEN	
32-35	9.8-10.7	TUFF, LIGHT GREY, KAOLINIZED, PYRITIZED, STRONGLY FRACTURED	90
35-41	10.7-12.5	LAPILLI TUFF, LIGHT GREY, KAOLINIZED, PYRITIZED, SOME FRACTURES HEALED WITH PYRITE; INCLUDES OCCASIONAL LITHIC FRAGMENTS.	100
41-45.5	12.5-13.9	AS ABOVE, LESS STRONGLY KAOLINIZED	100
45.5-58	13.9-17.7	ASH TUFF, LIGHT GREY, PERVASIVE PYRITIZATION, OCCASIONAL MINOR SPHALERITE.	100
58-63	17.7-19.2	ALTERED ASH TUFF WITH STREAKS AND CLOTS OF MAFIC MINERALS; LIGHT GREY; PERVASIVE PYRITIZATION, PYRITE-FILLED FRACTURES COMMON.	100
63-67.5	19.2-20.6	ASH TUFF, LIGHT GREY TO MEDIUM GREY, PYRITIZED.	100
67.5-70	20.6-21.4	PORPHYRITIC MICRODIORITE, LIGHT GREY, LOCALLY TUFFACEOUS; MINOR CALCITE ON FRACTURES, PYRITE IS PERVASIVE AND VERY FINE-GRAINED, OCCASIONAL DYKELETS OF DARKER MATERIAL (UP TO 3.5 CM WIDE) WITH INCREASED CONTENT OF PYRITE.	100
70-72	21.4-22.0	ASH TUFF, MEDIUM GREY, PERVASIVE PYRITIZATION.	100
72-75	22.0-22.9	PORPHYRITIC MICRODIORITE, LIGHT GREY, LOCALLY TUFFACEOUS, STRONGLY PYRITIZED, SOME CALCITE ON FRACTURES.	100
75-76	22.9-23.2	TUFF, MEDIUM GREY, PYRITIZED.	100
76-78.5	23.2-23.9	TUFFACEOUS PORPHYRITIC MICRODIORITE, LIGHT GREY TO YELLOW-GREY; VERY FINE-GRAINED DISSEMINATED PYRITE THROUGHOUT; SUBHEDRAL FELDSPAR PORPHYRIES UP TO 4 MM ACROSS, MOSTLY 1-2 MM.	100
78.5-79.5	23.9-24.2	ALTERED PYRITIZED ASH TUFF, LIGHT BUFF	100
79.5-86	24.2-26.2	PORPHYRITIC MICRODIORITE, LIGHT GREY, PYRITIZED.	100
		24.2-24.7: FRACTURES FILLED WITH DARKER MATERIAL HAVING HIGHER PYRITE CONTENT.	
86-89.5	26.2-27.3	ASH TUFF, MEDIUM GREY, PERVASIVE FINE-GRAINED PYRITE.	100

DIAMOND DRILL CORE GEOLOGICAL LOG

Hole No. 78-1
 Length 47 metres
 Bearing _____
 Dip _____
 Core Size _____

Hole Started _____
 Hole Finished _____
 Logged By J.M. Hutter
 Signature J.M. Hutter
 Date JAN 15/79

Collar Co-ordinates
 Northing _____
 Easting _____
 Elevation _____

Depth Feet Metres		Description	% Recover
89.5-95.5	27.3-29.1	PORPHYRITIC MICRODIORITE, LIGHT GREY, PYRITIZED, CALCITE ON FRACTURE SURFACES.	100
95.5-99	29.1-30.2	AS ABOVE, BUT CONTAINS LESS CALCITE AND PYRITE, AND FELDSPAR PHENOCRYSTS ARE MORE DISTINCT.	100
99-102	30.2-31.1	PORPHYRITIC MICRODIORITE, LIGHT GREY, PYRITIZED.	100
102-107	31.1-32.6	ASH TUFF, MEDIUM GREY. 31.4-31.6: CRUSH ZONE 32.0-32.3: CRUSH ZONE	100
107-108.5	32.6-33.1	VEIN MATERIAL WITH INCLUSIONS OF WALL ROCK UP TO 6 CM ACROSS. APPROXIMATELY 50% VEIN MATERIAL, CONTAINING PYRITE AND SPHALERITE WITH MINOR GALENA.	100
108.5-112	33.1-34.1	ALTERED TUFF, MEDIUM GREY, PYRITIZED, MINOR SPHALERITE.	100
112-113	34.1-34.4	VEIN MATERIAL CONTAINING PYRITE, SPHALERITE AND GALENA WITH INCLUSIONS OF ALTERED WALL ROCK.	100
113-125	34.4-38.1	ALTERED TUFF, MEDIUM GREY, PYRITIZED. 34.6: VEIN MATERIAL (5 CM WIDE) CONTAINING PYRITE AND A LITTLE SPHALERITE. 36.3: LOW GRADE VEIN MATERIAL (10 CM WIDE) CONTAINING PYRITE AND MINOR SPHALERITE.	100
125-125.8	38.1-38.3	LOW GRADE VEIN MATERIAL WITH A LITTLE PYRITE AND SPHALERITE AND MINOR GALENA.	100
125.8-127	38.3-38.7	TUFF, MEDIUM GREY, PYRITIZED, MINOR SPHALERITE.	100
127-134.5	38.7-41.0	MICRODIORITE, MEDIUM GREY, PYRITIZED.	100
134.5-154	41.0-47.0	TUFFACEOUS MICRODIORITE, MEDIUM GREY, PYRITIZED. IN THIS SECTION, THE STRENGTH OF PYRITIZATION AND FRACTURING IS DECREASING AS THE DEPTH INCREASES.	100
154	47.0	END OF HOLE.	

NOTE: LOCATION OF CORE STORAGE,
 - AT RESIDENCE OF J.M. HUTTER,
 R.R. 1, TELKWA, B.C.

DIAMOND DRILL CORE GEOLOGICAL LOG

Hole No. 78-2
 Length 45.7 metres
 Bearing S 40° W
 Dip 45°
 Core Size 8Q

Hole Started Nov 3/78
 Hole Finished Nov 3/78
 Logged By J.M. Hutter
 Signature J.M. Hutter
 Date JAN 15/79

Collar Co-ordinates
 Northing Easting
 Elevation 777 metres

Depth Feet Metres		Description	% Recover
0-54	0-16.5	OVERBURDEN	
54-59	16.5-18.0	LAPILLI TUFF, LIGHT GREY; LAPILLI UP TO 2 CM IN DIAMETER, MOSTLY 1-5 MM.	100
59-59.5	18.0-18.1	CRUSH ZONE, SAND SIZE PARTICLES.	100
59.5-64	18.1-19.5	LAPILLI TUFF, LIGHT GREY TO MEDIUM GREY, WEAKLY PYRITIZED.	100
64-87.5	19.5-26.7	TUFFACEOUS MICRODIORITE, LIGHT GREY TO MEDIUM GREY, WEAKLY PYRITIZED. 20.1: NARROW CRUSH ZONE 21.9-22.6: MOSTLY TUFF, MEDIUM GREY, FINE GRAINED. 23.0-23.9: GRANULAR GOUGE WITH SHORT SECTIONS OF SOLID CORE 25.0-25.9: CORE FRAGMENTED; SHORT SECTIONS OF GRANULAR GOUGE 26.2-26.7: RE-CEMENTED GRANULAR GOUGE	100
87.5-97	26.7-29.6	TUFFACEOUS MICRODIORITE, LIGHT GREY TO LIGHT GREENISH GREY, WEAKLY PYRITIZED, CONTAINS A FEW LITHIC INCLUSIONS. 27.7-28.0: RE-CEMENTED GRANULAR GOUGE. 28.0-28.5: TUFFACEOUS MICRODIORITE BRECCIA.	100
97-101	29.6-30.8	ASH TUFF, LIGHT GREY, WITH CALCITE VEINING (USUALLY HAIRLINE BUT MAY BE UP TO 1 CM WIDE), SLIGHTLY MORE PYRITIZED THAN PREVIOUS.	100
101-104	30.8-31.7	TUFF BRECCIA, LIGHT GREY, MODERATE PYRITIZATION.	100
104-106	31.7-32.3	GRANULAR GOUGE.	100
106-107	32.3-32.6	ASH TUFF, MEDIUM GREY, STRONG PYRITIZATION.	100
107-110	32.6-33.5	ASH TUFF, LIGHT GREY, WEAK PYRITIZATION.	100
110-114	33.5-34.7	ASH TUFF, MEDIUM GREY, MODERATE PYRITIZATION. 33.5: INCLUSIONS OF MEDIUM GREY TUFF IN LIGHT GREY TUFF 33.8-34.7: CORE BROKEN TO GRAVEL SIZE	100
			50

DIAMOND DRILL CORE GEOLOGICAL LOG

Hole No. 78-2
 Length 45.7 metres
 Bearing _____
 Dip _____
 Core Size _____

Hole Started _____
 Hole Finished _____
 Logged By J. M. HUTTER
 Signature J. M. Hutter
 Date JAN 15/79

Collar Co-ordinates
 Northing _____
 Easting _____
 Elevation _____

Depth Feet Metres		Description	% Recovered
114-126	34.7-38.4	TUFFACEOUS MICRODIORITE, LIGHT GREY TO MEDIUM GREY, MODERATELY TO STRONGLY PYRITIZED. 34.7-35.4: LIGHT GREY; MODERATE PYRITIZATION. 35.4-36.9: MOTTLED; PYRITIZATION IS STRONGER IN DARKER AREAS. 36.9-38.1: MOTTLED; MODERATE PYRITIZATION.	100 100 100
126-150	38.4-45.7	DACITE PORPHYRY, MEDIUM GREY. 38.4-40.2: STRONGLY FRACTURED; WEAK PYRITIZATION 40.2-41.5: GRANULAR GOUGE WITH SHORT SECTIONS OF UNBROKEN CORE. 41.5-41.9: WEAKLY PYRITIZED 41.9-42.4: GRANULAR GOUGE. 42.4-42.8: MODERATELY PYRITIZED 42.8-43.3: GRANULAR GOUGE 43.3-43.7: STRONG PYRITIZATION; BLEACHED ON BOTH SIDES OF PYRITE-FILLED FRACTURES. 43.7: SHORT SECTION OF GRANULAR GOUGE 43.7-45.7: WEAKLY PYRITIZED.	80 95 100 95 100 100 100
150	45.7	END OF HOLE.	100

NOTE:

LOCATION OF CORE STORAGE:
 - AT RESIDENCE OF J. M. HUTTER,
 R.R.1, TELKWA, B.C.

STATEMENT OF QUALIFICATIONS

J.M. Hutter:

Education: B.Sc. Geology U.B.C. (1976)

Experience: self-employed in mining exploration since graduation.

Summer 1974- miner's helper, trammer;
Hallmark Resources Ltd.

1973- sampler, labourer, prospector;
The Granby Mining Co. Ltd.

1972- nipper, sampler;
Bradina Joint Venture

1971- labourer;
Granisle Copper Ltd.

J. M. Hutter

STATEMENT OF COSTS

<u>Item</u>	<u>Cost</u>
Diamond drilling: J.T. Thomas 304 feet @ \$16.50 per foot	\$ 5016.00
Assays: Chemex Labs	69.00
Supervision, core logging, transportation, report preparation: J.M. Hutter	<u>500.00</u>
Total:	\$ 5575.00



INVOICE

CHEMEX LABS LTD.

212 BROOKSBANK AVE.
NORTH VANCOUVER, B.C.
CANADA V7J 2C1
TELEPHONE: 985-0648
AREA CODE: 604
TELEX: 043-52597

• ANALYTICAL CHEMISTS • GEOCHEMISTS • REGISTERED ASSAYERS

TO: J. M. Hutter
R.R. 1
Telkwa, B.C.

CERTIFICATE NO. 34990

INVOICE NO. 29618

ATTN:

DATE Feb. 14/79

	DESCRIPTION	SUB-TOTAL	TOTAL
3	Assayed for Cu, Pb, Zn, Ag & Au @ \$23.00	\$69.00	\$69.00

TERMS—NET 30 DAYS

1½% Per Month (18% Per Annum) Charged on Overdue Accounts

78-040

AGREEMENT

BETWEEN: Nadina Mines Ltd.
c/o Mr. Bill McGowan
P.O. Box 341
Smithers, B.C.
VOJ 2N0 (Hereinafter referred to as the
'COMPANY' of the First Part)

AND: J. T. THOMAS DIAMOND DRILLING LTD.
P. O. Box 394
Smithers, British Columbia
(Hereinafter referred to as the
'CONTRACTOR' of the Second Part)

A. THE CONTRACTOR COVENANTS AND AGREES:

1. THAT all holes shall be drilled with BQ wireline equipment providing a core approximately 1-7/16" in diameter.
2. THAT the Contractor shall use his best endeavour to complete all holes according to the wishes of the Company, but should rock conditions prevent successful completion of the hole, the Contractor is not obliged to complete the same, but shall be paid for such incomplete holes at contract rates for the completed footage.
3. THAT the Contractor will supply his own transportation and mobilization.
4. THAT the Contractor will supply water to the drill at his own expense. If over 1,000 feet from drill site to water source, or lift over 200 feet, this cost to be negotiated.
5. THAT the Contractor will not give out any information regarding drill results, or access to core to any person other than to the Company's representative.
6. THAT the Contractor will supply a machine suitable for moving the drill and preparing drill sites. Company to assist with own equipment if necessary.
7. THAT the Contractor will pay the cost of moving between sites.
8. THAT the Contractor will supply coreboxes at no cost.
9. THAT the Contractor will absorb all cementing cost if necessary.
10. THAT the Contractor will pay the cost of drilling mud and additives required for this job.

- A.
11. THAT the Contractor shall maintain General Comprehensive Liability Insurance with minimum inclusive limits of \$500,000 covering bodily injuries and property damage and Motor Vehicle Liability with minimum inclusive limits of \$500,000. This insurance coverage shall not be reduced or cancelled during the period work is being done for the Company unless ten days prior written notice is furnished to the Company.
 12. THAT the Contractor shall be responsible for and will pay promptly all dues and assessments payable under the Workers' Compensation Act, in accordance with the laws of the Province of British Columbia, in respect of its employees.
 13. THAT the Contractor agrees to indemnify and save harmless the Company and its personnel against any and all loss and expense including attorney's fees and other legal expenses, by reason of liability imposed or claimed to be imposed by law upon the Company for damages because of bodily injuries, including death, or on account of damage to property, sustained by any person or persons arising out of or in consequence of the performance of the work called for by this contract whether or not such bodily injuries, death, or damage to property arise or are claimed to arise in whole or in part out of negligence or any other ground of legal liability, including violation or any duty imposed by a statute or ordinance or regulation on the part of the Contractor, their employees, or agents of them.
 14. THAT during the course of the work, the Contractor shall, at all times, keep the Company's premises free from accumulation of waste material or rubbish and upon completion of the work shall remove all tools, scaffoldings, surplus materials and rubbish and leave the premises in a clean condition and as near as possible to its original condition. The Contractor shall observe and comply with all applicable laws of the Province of British Columbia.
 15. THAT this agreement may be altered only by written consent of both parties hereto.
 16. THAT time is of the essence in this agreement
 17. THAT the Contractor agrees to start on or thereabouts.

B. THE COMPANY COVENANTS AND AGREES:

1. THAT the payment for the herein described work shall be \$ 16.50 (Sixteen Dollars Fifty Cents) per foot for core drilling and \$16.50 (Sixteen Dollars Fifty Cents) per foot for overburden.
2. THAT the Company requests the Contractor to complete a minimum of Three Hundred (300) feet of drilling and other services as set forth herein.
3. THAT the Company agrees to make payments at the rates hereinbefore specified in accordance with the terms hereinafter set out, that is: For all work done hereunder between the first and 16th day and the 16th and last day of the month, invoices shall be rendered promptly to the Company, and such invoices shall be due and payable within 30 days of receipt of an invoice by the Company.

- B. 4. THAT the Company agrees to supply room and board for the drill crew.
5. THAT the Company shall construct and maintain access road for Contractor's access.

IN WITNESS WHEREOF these presents have been executed by the parties hereto, this 1 st day of November A. D. 1978.

NADINA MINES LTD.

J. T. THOMAS DIAMOND DRILLING LTD.

W. F. Mc Gowan Jim Thomas
W. F. Mc Gowan

NEW NADINA
EXPLORATIONS LTD.

Plan of 1978 Diamond Drilling.
Data by J.M. Hutter

⊙ Diamond Drill Collar
(data in 1978 assessment report)

MINERAL RIGHTS REPORT
7343

SCALE IN METRES

