

7373

79-#285-#7373
PIE CLAIMS

Omineca M. D. N.T.S. 94F/7 & 7
57°28'N 124°58'W
G. D. Hodgson March 1979

Owner and Operator: Riocanex Ltd.

Work performed on following claims:

| <u>Claim Name</u> | <u>Record Date</u> | <u>Expiry Date</u> |
|-------------------|--------------------|--------------------|
| PIE 1 | 780725 | 790725 |
| PIE 2 | 780725 | 790725 |
| PIE 3 | 780725 | 790725 |
| PIE 4 | 780725 | 790725 |
| PIE 5 | 780725 | 790725 |
| PIE 6 | 780725 | 790725 |
| PIE 7 | 780725 | 790725 |
| PIE 8 | 780725 | 790725 |
| PIE 9 | 780725 | 790725 |
| PIE 10 | 780915 | 790915 |
| PIE 11 | 780915 | 790915 |
| PIE 12 | 780915 | 790915 |

PIE CLAIMS

Omineca M.D. N.T.S. 94F/6 & 7
57°28'N 124°58'W
G.D. Hodgson March 1979

SUMMARY

The property lies in the Rocky Mountains of northern British Columbia between the Kwadacha and Akie Rivers. Devonian Limestone and Devono-Mississippian shales trend NW-SE. Twelve claims (135 units) were staked to cover a sphalerite-chalcopyrite-barite showing in shales, a galena showing in shales, a number of outcrops of massive and nodular bedded barite, and the sites of a dozen anomalous lead values in stream silts. Several small pits were dug by hand to explore the galena showing.

TABLE OF CONTENTS

| | <u>Page No.</u> |
|---|-----------------|
| 1. INTRODUCTION | 1 |
| 2. LOCATION AND ACCESS | 1 |
| 3. TOPOGRAPHY AND VEGETATION | 2 |
| 4. HISTORY AND PREVIOUS WORK | 2 |
| 5. WORK PERFORMED IN 1978 | 2 |
| 6. PERSONS EMPLOYED | 3 |
| 7. REGIONAL GEOLOGY | 3 |
| 8. LOCAL GEOLOGY + MINERALIZATION | 4 |
| 9. GEOCHEMISTRY | 5 |
| 10. RESULTS | 5 |
| 11. CONCLUSIONS | 6 |
| 12. REFERENCES | 6 |

APPENDICES

- I GEOCHEMICAL SAMPLE RESULTS
- II COST STATEMENT
- III STATEMENT OF QUALIFICATIONS

LIST OF ILLUSTRATIONS

| <u>Drawing No.</u> | | <u>After Page</u> |
|--------------------|-----------------------|-------------------|
| L-6565 | Location Map | 1 |
| C-6552 | Claim Map | 2 |
| GC-6555 | Silt Sample Locations | 5 |
| GC-6558 | Ppm Cu, Pb, Zn | 5 |
| G-8664 | Geology of PIE Claims | In Pocket |

1. INTRODUCTION

Devono-Mississippian black shales in northeastern British Columbia were thought to be southern equivalents of similar shales in the Yukon Territory and Mackenzie District, N.W.T., which host important deposits of lead and zinc. A regional reconnaissance programme that included geochemical stream silt sampling, geological mapping and prospecting confirmed that the black shales in northeastern British Columbia have economic potential and four groups of claims, including the PIE claims, were subsequently staked.

2. LOCATION AND ACCESS

The PIE claims lie north of Williston Lake in northern British Columbia, approximately 300 km NW of Fort St. John, 200 km SW of Fort Nelson and 30 km east of the Indian settlement of Fort Ware. After spring breakup barges run to Deserters Canyon at the north end of the Lake. Fort Ware and Ingenika have gravel air strips.

N.T.S. 94 F/6 and 7

Latitude: $57^{\circ}28'N$ Longitude: $124^{\circ}58'W$

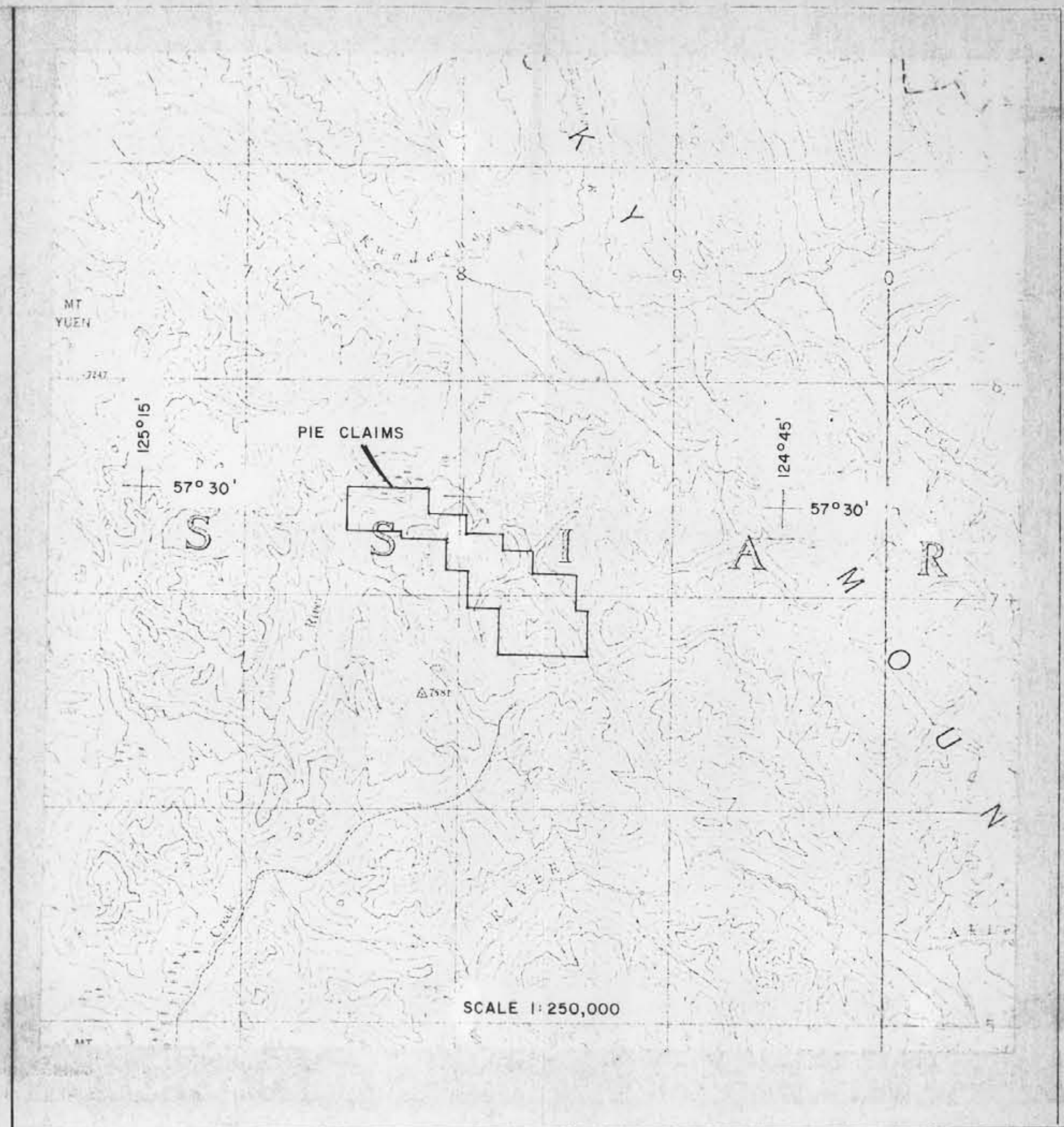
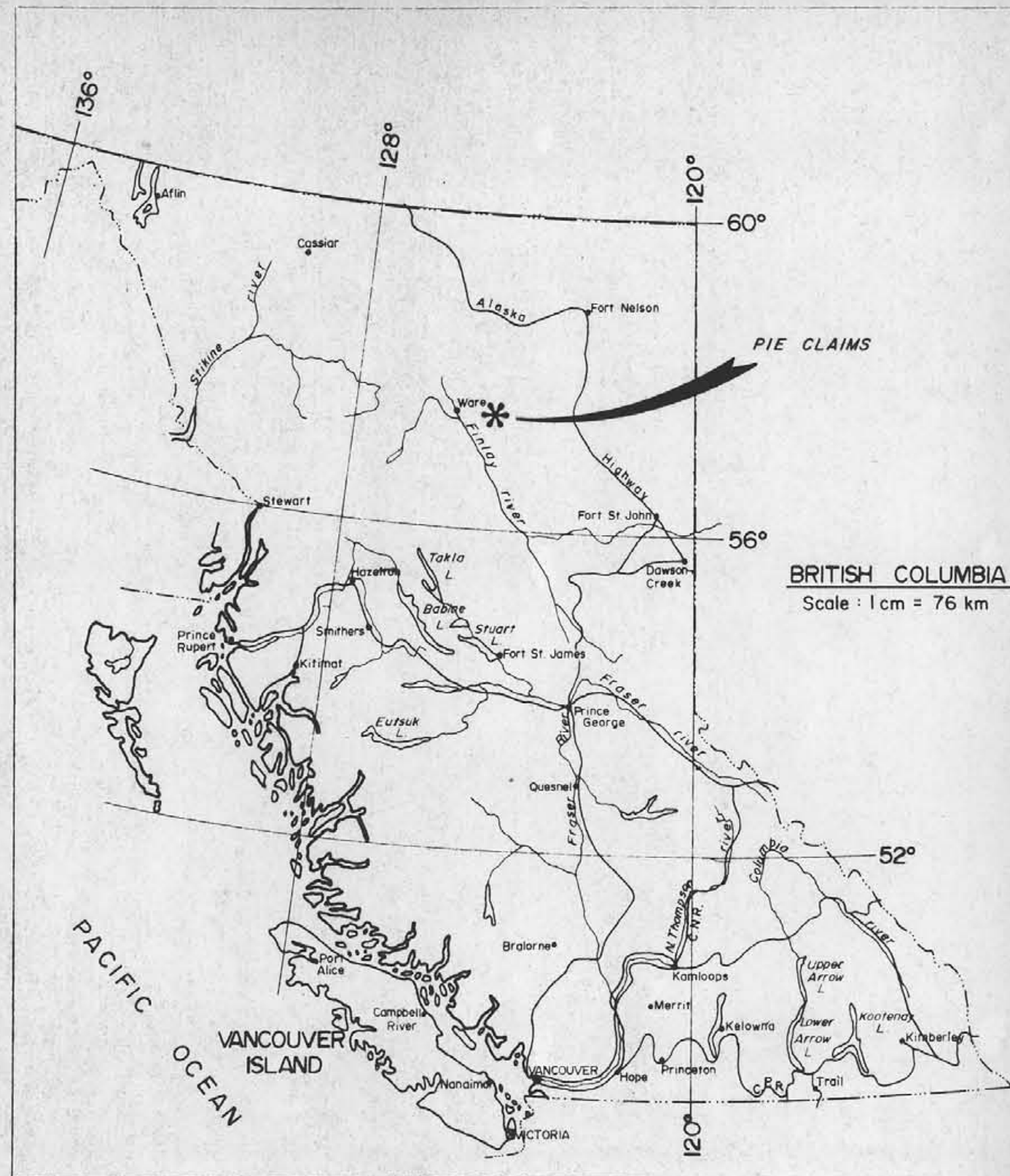

N.T.S. 94-F/6,7

RIO TINTO CANADIAN EXPLORATION LTD.

PIE CLAIMS

LOCATION MAP

APRIL 79

G.H./y.m.

DWG. L-6564

3. TOPOGRAPHY AND VEGETATION

The area is mountainous. Elevations range between 1100 and 2300 m above sea level. Slopes are moderate to steep. Much of the claim block lies above tree line. Lower slopes are covered in dense scrub. Relatively open spruce forest occupies valley bottoms.

4. HISTORY AND PREVIOUS WORK

None.

5. WORK PERFORMED IN 1978

The PIE claims were staked during a regional reconnaissance programme that included geological prospecting and stream silt sampling. One mineralized shale showing was hand trenched after geological mapping on a scale of 1:25,000.

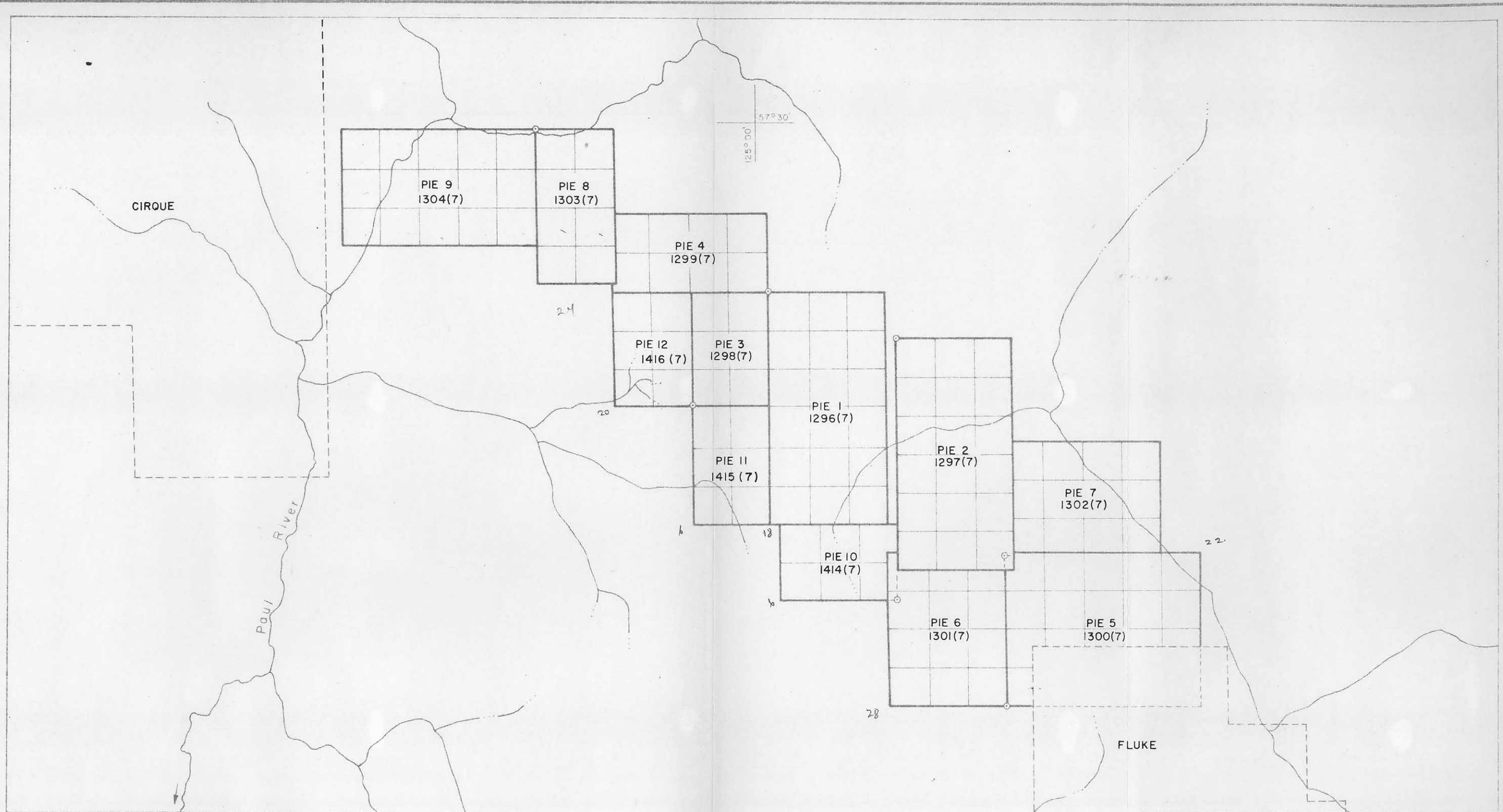

N.T.S. 94 F 6,7

SCALE 1:50,000

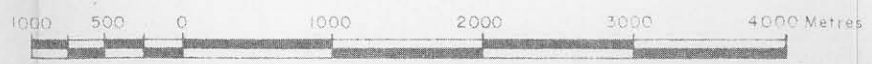

RIO TINTO CANADIAN EXPLORATION LTD.

PIE CLAIMS

CLAIM MAP

s. g.

MAR. 1979

DWG. C-6552

6. PERSONS EMPLOYED

Field party chief C. Graf lead a silt sampling team of six persons, and was responsible for the geological mapping and prospecting. Northern Mountain Helicopters Ltd., under contract to Riocanex, supplied helicopter support.

The programme was carried out under the general supervision of R.V. Longe, Riocanex District Geologist, B.C.

7. REGIONAL GEOLOGY

Devono-Mississippian black shales on the PIE claims are believed to be a southern extension of those in the Selwyn Basin (Yukon Territory and Mackenzie District, N.W.T.) where such shales contain important deposits of lead and zinc. These shales comprise part of a Paleozoic succession of shales, siltstones and carbonates that have been deformed by folding, faulting and thrusting. Tectonic elements trend NW-SE. Mapping has been by Gabrielse (1962, 1977), Taylor and Stott (1973), Taylor (1979), and Graf (1979).

8. LOCAL GEOLOGY + MINERALIZATION

The PIE claims are underlain by dark grey to black graphitic shales, cherty in part, thought to be of Devonian-Mississippian age. Layers of nodular barite are not uncommon. The shales are flanked to the northeast of massive grey Devonian limestone that occupies the core of a NW-SE trending anticline. A dun coloured dolomitic siltstone of Silurian age has been thrust over the black shales from the southwest. DWG. G-8665 is a 1:25,000 geological map of the claims.

A gossanous area overlying black shales yields fragments of rock containing fine grained galena. A grab sample returned 65% Pb and 0.75% Zn. Coarse-grained barite is associated with sphalerite and chalcopyrite in a second showing within the shales, and a grab sample of this returned an assay of 11.2% Pb, 1.76% Zn and 0.19% Cu.

Three showings of disseminated sphalerite are known from the Devonian limestone. Zinc content in mineralized rock varies from 3 to 10%. Lead appears to be absent.

9. GEOCHEMISTRY

Stream silt samples were taken from creeks draining the PIE claims. Sample sites are plotted on DWG. GC-6555 and results on DWG. GC-6558. Values greater than 30 ppm Pb and 40 ppm Cu are considered to be anomalous. The high lead values reflect the metalliferous nature of the underlying shales and the presence of mineralization. Graf (1979) suggested the high copper values are due to the proximity of thin volcanic units within nearby Road River rocks. Zinc values locally reach 19,000 ppm and commonly exceed 1,000 ppm. However, values vary considerably and zinc results are not considered to be significant.

10. RESULTS

10.1 Sulphide-bearing shale fragments have been found in float on the PIE claims.

10.2 The shales display geologic features characteristic of important Ba-Pb-Zn deposits elsewhere. They are:

- i Graphitic shales.
- ii Siliceous shales with numerous chert bands.
- iii Abundant barite, occurring either massive or as nodular barite layers.
- iv Lithologic variations within the overall shale unit suggesting irregularities in topography of the original basin floor, i.e. presence of sub-basins.

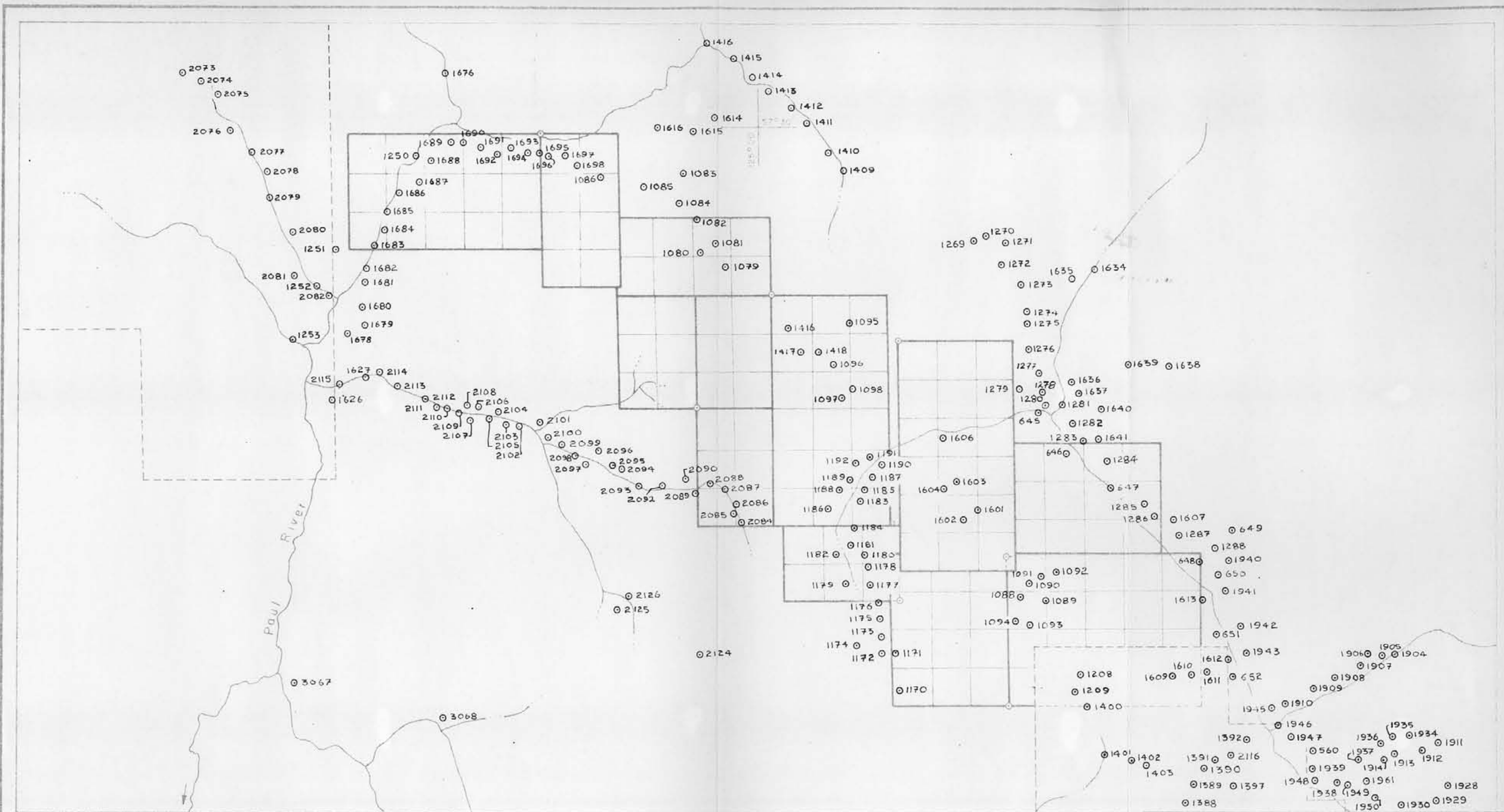

LEGEND

- 2125 Silt sample location & number
- All three digit numbers prefixed by 7810
- Four digit numbers < 2000 prefixed by 781
- Four digit numbers > 2000 prefixed by 782

N.T.S. 94 F 6,7

SCALE 1:50,000



PID TINTO CANADIAN EXPLORATION

PIE CLAIMS

SILT SAMPLE LOCATIONS

s. g.

MAR. 1979

DWG

GC-6555

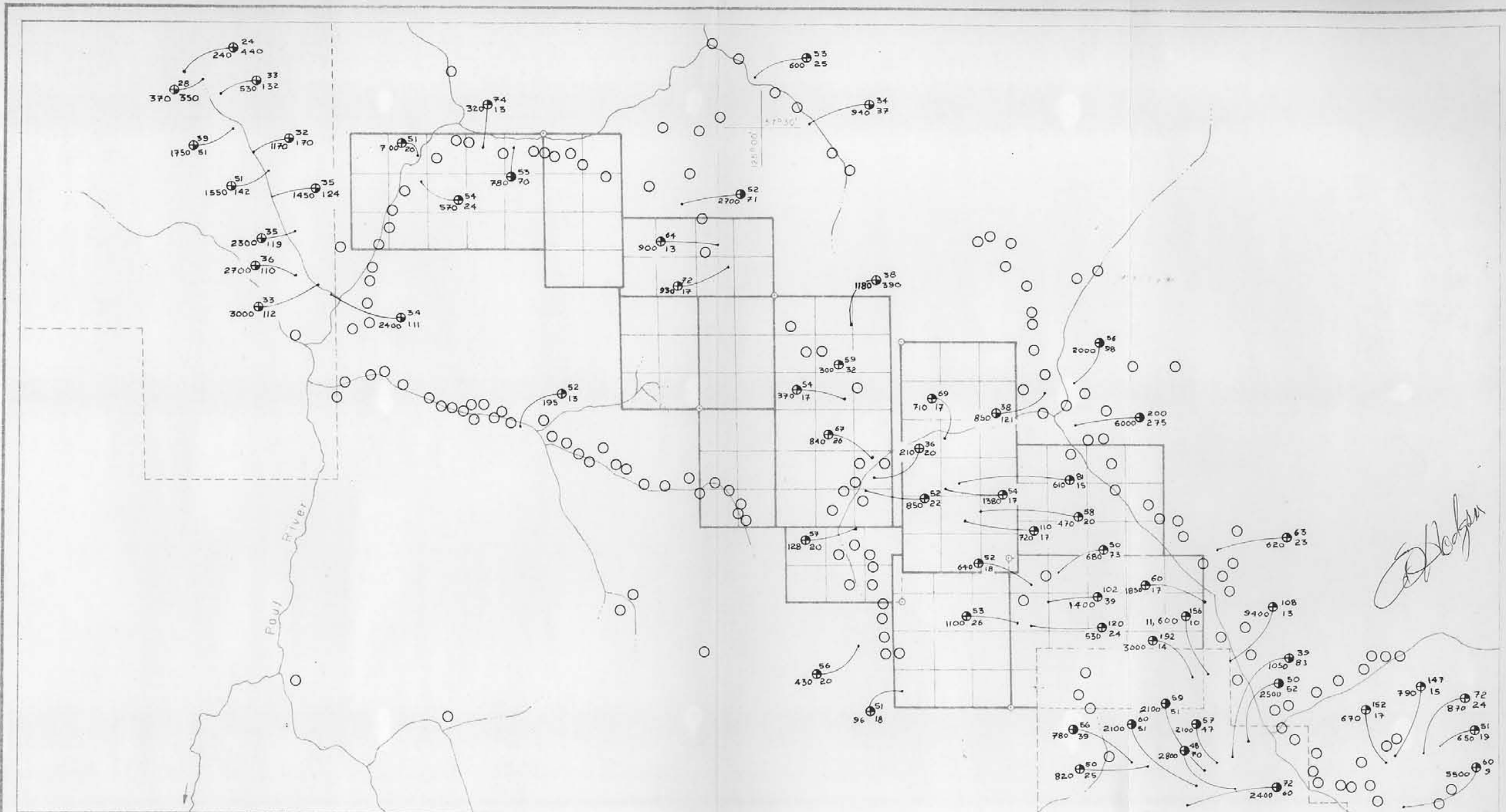

Handwritten signature



LEGEND

- Silt sample location
- ⊕ ppm Cu
- ⊕ ppm Zn
- ⊕ ppm Pb
- ⊕ Anomalous

N.T. 94 F 6,7

SCALE 1:50,000



RIO TINTO CANADIAN EXPLORATION LTD.

PIE CLAIMS

PPM Cu, Pb, Zn

s. g.

MAR. 1979

DWG. GC-6558

v Nearby major limestone unit, regarded by some as a debris flow off a shelf and therefore indicative of instability and possibly marginal growth faults.

10.3 The Devonian limestone is locally enriched with respect to zinc.

11. CONCLUSIONS

The PIE claims overlies metalliferous shales that have the potential for hosting major Ba-Pb-Zn mineralization.

The limestone, locally Zn rich, is a less attractive target.

12. REFERENCES

- GABRIELSE, H., 1962: Geol. Surv. Can. Map 42-1962
 GABRIELSE, H., 1977: Geol. Surv. Can. O.F. 483
 GRAF, C., 1979: Riocanex Rept.
 TAYLOR, G.C., 1979: Geol. Surv. Can. O.F. 606
 TAYLOR, G.C., and STOTT, D.F., 1973: Tuchodi Lakes Map-Area, British Columbia. Geol. Surv. Can., Mem. 373.

G. D. Hodgson
 G. D. Hodgson

H. W. Marsh
 H. W. Marsh P. Eng.



VANCOUVER OFFICE
 April 1979

Appendix I

GEOCHEMICAL SAMPLE RESULTS

RIO TINTO CANADIAN EXPLORATION LIMITED

LABORATORY REPORT

PARTS PER MILLION

| LAB NO. | SAMPLE NO. (NMBR) | Co | Pb | Zn | | | | | COMMENTS |
|--------------|-------------------|----------------|---------------|----------------|-----|--|--|--|----------|
| 1 | 7810541 | 34 | 12 | 215 | 530 | | | | |
| 2 | 542 | 20 | 10 | 110 | | | | | |
| 3 | 543 | 24 | 10 | 235 | | | | | |
| 4 | 544 | 32 | 13 | 245 | | | | | |
| 5 | 545 | 25 | 11 | 215 | | | | | |
| 6 | 546 | 25 | 10 | 225 | | | | | |
| 7 | 547 | 23 | 13 | 152 | | | | | |
| 8 | 548 | 23 | 10 | 220 | | | | | |
| 9 | 549 | 22 | 11 | 235 | | | | | |
| 10 | 550 | 24 | 10 | 230 | | | | | |
| 1 | 551 | 32 | 12 | 235 | | | | | |
| 2 | STD | 18 | 28 | 230 | | | | | |
| 3 | 552 | 20 | 10 | 215 | | | | | |
| 4 | 553 | 27 | 11 | 240 | | | | | |
| 5 | 554 | 25 | 11 | 215 | | | | | |
| 6 | 555 | 25 | 10 | 215 | | | | | |
| 7 | 556 | 37 | 10 | 230 | | | | | |
| 8 | 557 | 42 | 10 | 240 | | | | | |
| 9 | 558 | 14 | 7 | 142 | | | | | |
| 20 | 559 | 14 | 9 | 136 | | | | | |
| 1 | 560 | 26 | 13 | 540 | | | | | |
| 2 | BLANK | 100 | 12 | 100 | | | | | |
| 3 | 561 | 56 | 19 | 3200 | | | | | |
| 4 | 562 | 46 | 11 | 2500 | | | | | |
| 5 | 563 | 100 | 12 | 1160 | | | | | |
| 6 | 564 | 142 | 19 | 2900 | | | | | |
| 7 | 565 | 51 | 39 | 2600 | | | | | |
| 8 | 566 | 27 | 13 | 730 | | | | | |
| 9 | 567 | 62 | 7 | 12,000 | | | | | |
| 30 | 568 | 27 | 12 | 610 | | | | | |
| 1 | 569 | 30 | 14 | 580 | | | | | |
| 2 | 570 | 15 | 11 | 48 | | | | | |
| 3 | 571 | 43 | 14 | 180 | | | | | |
| 4 | 572 | 40 | 17 | 210 | | | | | |
| 5 | 573 | 45 | 18 | 450 | | | | | |
| 6 | 574 | 38 | 13 | 215 | | | | | |
| 7 | 575 | 60 | 32 | 850 | | | | | |
| 8 | 576 | 77 | 19 | 220 | | | | | |
| 9 | 577 | 42 | 35 | 1430 | | | | | |
| 40 | 7810578 | 24 | 14 | 315 | | | | | |

RIO TINTO CANADIAN EXPLORATION LIMITED

LABORATORY REPORT

PARTS PER MILLION

| LAB N ^o . | SAMPLE N ^o . (NMBR) | Cu | Pb | Zn | | | | COMMENTS |
|----------------------|--------------------------------|---------------|---------------|---------------|---|--|--|----------|
| 41 | 7810527 | 33 | 7 | 305 | | | | |
| 2 | 528 | 28 | 8 | 260 | | | | |
| 3 | 529 | 26 | 10 | 152 | | | | |
| 4 | 530 | 31 | 7 | 310 | | | | |
| 5 | 531 | 6 | ND | 1850 | | | | Il. Fe |
| 6 | 532 | 41 | 12 | 1650 | | | | |
| 7 | 533 | 41 | 9 | 1300 | | | | |
| 8 | 534 | 27 27 | 8 | 445 | | | | |
| 9 | 535 | 37 | 9 | 790 | | | | |
| 60 | 536 | 38 | 9 | 1450 | | | | |
| 1 | 537 | 7 | ND | 1230 | | | | Il. Fe |
| 2 | 538 | 38 | 14 | 680 | | | | |
| 3 | STD 3 | 44 | 4 | 58 | | | | |
| 4 | 539 | 28 | 7 | 610 | | | | |
| 5 | 540 | 29 | 10 | 390 | | | | |
| 6 | 845 | 33 | 16 | 425 | | | | |
| 7 | 46 | 33 | 17 | 445 | | | | |
| 8 | 47 | 43 | 22 | 790 | | | | |
| 9 | 48 | 34 | 19 | 700 | | | | |
| 60 | 49 | 11 | 12 | 26,000 | * | | | |
| 1 | 50 | 31 | 10 | 860 | | | | |
| 2 | 51 | 58 | 20 | 1700 | | | | |
| 3 | BLANK | ND | ND | ND | | | | |
| 4 | 52 | 30 | 11 | 630 | | | | |
| 5 | 53 | 17 | 8 | 68 | | | | |
| 6 | 54 | 20 | 13 | 88 | | | | |
| 7 | 55 | 19 | 10 | 72 | | | | |
| 8 | 56 | 17 | 12 | 100 | | | | |
| 9 | 57 | 12 | 10 | 75 | | | | |
| 70 | 58 | 12 | 10 | 42 | | | | |
| 1 | 59 | 14 | 12 | 62 | | | | |
| 2 | 60 | 14 | 10 | 68 | | | | |
| 3 | 61 | 13 | 8 | 52 | | | | |
| 4 | 62 | 14 | 10 | 60 | | | | |
| 5 | 63 | 12 | 9 | 52 | | | | |
| 6 | 64 | 11 | 8 | 50 | | | | |
| 7 | 65 | 21 | 13 | 66 | | | | |
| 8 | 66 | 7 | 7 | 54 | | | | |
| 9 | 67 | 8 | 8 | 52 | | | | |
| 60 | 7810 668 | 10 | 8 | 60 | | | | |

RIO TINTO CANADIAN EXPLORATION LIMITED

LABORATORY REPORT

PARTS PER MILLION

| LAB NO. | SAMPLE NO. (NMBR) | CO | Pb | Zn | | | | | COMMENTS |
|--------------|-------------------|---------------|---------------|----------------|--|--|--|--|----------|
| 1 | 7811065 | 7 | ND | 1400 | | | | | H. Fe |
| 2 | 066 | 7 | ND | 330 | | | | | H. Fe |
| 3 | 067 | 37 | 11 | 1170 | | | | | |
| 4 | 068 | 14 | 8 | 200 | | | | | |
| 5 | 069 | 16 | 4 | 540 | | | | | |
| 6 | 070 | 8 | ND | 1240 | | | | | H. Fe |
| 7 | 071 | 12 | 3 | 230 | | | | | |
| 8 | 072 | 30 | 24 | 88 | | | | | |
| 9 | 073 | 42 | 20 | 160 | | | | | |
| 10 | 074 | 102 | 11 | 380 | | | | | |
| 1 | 075 | 38 | 15 | 570 | | | | | |
| 2 | STO 1 | 15 | 27 | 750 | | | | | |
| 3 | 076 | 47 | 17 | 610 | | | | | |
| 4 | 077 | 46 | 23 | 1150 | | | | | |
| 5 | 078 | 12 | 160 | 2300 | | | | | |
| 6 | 079 | 72 | 17 | 930 | | | | | |
| 7 | 080 | 43 | 13 | 375 | | | | | |
| 8 | 081 | 64 | 13 | 900 | | | | | |
| 9 | 082 | 48 | 16 | 400 | | | | | |
| 20 | 083 | 48 | 15 | 850 | | | | | |
| 1 | 084 | 52 | 71 | 2700 | | | | | |
| 2 | BLANK | ND | ND | ND | | | | | |
| 3 | 085 | 33 | 12 | 610 | | | | | |
| 4 | 086 | 13 | ND | 295 | | | | | H. Fe |
| 5 | 087 | 120 | 24 | 530 | | | | | |
| 6 | 088 | 41 | 25 | 560 | | | | | |
| 7 | 089 | 102 | 34 | 1400 | | | | | |
| 8 | 090 | 52 | 18 | 640 | | | | | |
| 9 | 091 | 43 | 17 | 405 | | | | | |
| 30 | 092 | 50 | 23 | 680 | | | | | |
| 1 | 093 | 37 | 23 | 680 | | | | | |
| 2 | 094 | 53 | 20 | 1100 | | | | | |
| 3 | 095 | 38 | 390 | 1180 | | | | | |
| 4 | 096 | 59 | 32 | 300 | | | | | |
| 5 | 097 | 54 | 17 | 570 | | | | | |
| 6 | 098 | 40 | 13 | 780 | | | | | |
| 7 | 099 | 55 | 14 | 730 | | | | | |
| 8 | 384 | 7656 | 120 | 280 | | | | | |
| 9 | 385 | 78 | 30 | 1270 | | | | | |
| 40 | 7811386 | 78 | 47 | 1170 | | | | | |

RIO TINTO CANADIAN EXPLORATION LIMITED

LABORATORY REPORT

PARTS PER MILLION

| LAB NO. | SAMPLE NO. (NMBR) | Cu | Pb | Zn | | | | | COMMENTS |
|--------------|-------------------|----------------|----------------|----------------|--|--|--|--|----------|
| 41 | 7811169 | 28 | 14 | 370 | | | | | |
| 2 | 170 | 51 | 18 | 96 | | | | | |
| 3 | 171 | 32 | 14 | 16 | | | | | |
| 4 | 172 | 47 | 22 | 138 | | | | | |
| 5 | 173 | 25 | 18 | 320 | | | | | |
| 6 | 174 | 56 | 20 | 430 | | | | | |
| 7 | 175 | 40 | 17 | 55 | | | | | |
| 8 | 176 | 46 | 19 | 52 | | | | | |
| 9 | 177 | 35 | 16 | 24 | | | | | |
| 50 | 178 | 49 | 22 | 26 | | | | | |
| 1 | 179 | 25 | 15 | 114 | | | | | |
| 2 | 180 | 34 | 17 | 66 | | | | | |
| 3 | STD 1 | 15 | 28 | 950 | | | | | |
| 4 | 181 | 38 | 17 | 26 | | | | | |
| 5 | 182 | 36 | 22 | 134 | | | | | |
| 6 | 183 | 50 | 22 | 45 | | | | | |
| 7 | 184 | 57 | 20 | 128 | | | | | |
| 8 | 185 | 55 | 20 | 610 | | | | | |
| 9 | 186 | 28 | 15 | 105 | | | | | |
| 60 | 187 | 52 | 22 | 850 | | | | | |
| 1 | 188 | 19 | 16 | 100 | | | | | |
| 2 | 189 | 34 | 15 | 134 | | | | | |
| 3 | BLANK | 100 | 100 | 100 | | | | | |
| 4 | 190 | 36 | 20 | 310 | | | | | |
| 5 | 191 | 67 | 26 | 840 | | | | | |
| 6 | 192 | 54 | 13 | 215 | | | | | |
| 7 | 193 | 36 | 18 | 142 | | | | | |
| 8 | 194 | 52 | 30 | 198 | | | | | |
| 9 | 195 | 43 | 47 | 380 | | | | | |
| 70 | 196 | 68 | 14 | 62 | | | | | |
| 1 | 197 | 51 | 25 | 290 | | | | | |
| 2 | 198 | 43 | 20 | 600 | | | | | |
| 3 | 199 | 33 | 34 | 720 | | | | | |
| 4 | 229 | 27 | 23 | 230 | | | | | |
| 5 | 229 | 50 | 27 | 205 | | | | | |
| 6 | 230 | 23 | 260 | 245 | | | | | |
| 7 | 231 | 47 | 28 | 2800 | | | | | |
| 8 | 232 | 57 | 1030 | 3300 | | | | | |
| 9 | 233 | 142 | 985 | 4500 | | | | | |
| 80 | 7811234 | 52 | 445 | 2500 | | | | | |

RIO TINTO CANADIAN EXPLORATION LIMITED

LABORATORY REPORT

PARTS PER MILLION

| LAB NO. | SAMPLE NO. (NMBR) | Cu | Pb | Zn | | | | | COMMENTS |
|--------------|--------------------|---------------|----------------|----------------|--|--|--|--|----------|
| 81 | 7811148 | 21 | 12 | 138 | | | | | |
| 2 | 149 | 18 | 7 | 90 | | | | | |
| 3 | 150 | 22 | 13 | 385 | | | | | |
| 4 | 151 | 14 | 9 | 195 | | | | | |
| 5 | 152 | 23 | 11 | 580 | | | | | |
| 6 | 200 | 24 | 9 | 240 | | | | | |
| 7 | 201 | 15 | 5 | 162 | | | | | |
| 8 | 202 | 36 | 11 | 540 | | | | | |
| 9 | 203 | 39 | 16 | 730 | | | | | |
| 90 | 204 | 46 | 16 | 740 | | | | | |
| 1 | 205 | 22 | 11 | 74 | | | | | |
| 2 | 206 | 29 | 15 | 225 | | | | | |
| 3 | 207 | 230 | 18 | 1500 | | | | | |
| 4 | 510 2 | 32 | 370 | 265 | | | | | |
| 5 | 208 | 76 | 17 | 2000 | | | | | |
| 6 | 209 | 34 | 13 | 1060 | | | | | |
| 7 | 210 | 28 | 12 | 520 | | | | | |
| 8 | 211 | 88 | 16 | 1420 | | | | | |
| 9 | 212 | 52 | 13 | 1230 | | | | | |
| 100 | 213 | 56 | 10 | 920 | | | | | |
| 1 | 214 | 61 | 3 | 3000 | | | | | |
| 2 | 215 | 47 | 10 | 870 | | | | | |
| 3 | 216 | 45 | 13 | 350 | | | | | |
| 4 | BLANK | ND | ND | ND | | | | | |
| 5 | 217 | 22 | 7 | 255 | | | | | |
| 6 | 218 | 51 | 12 | 485 | | | | | |
| 7 | 219 | 27 | 11 | 560 | | | | | |
| 8 | 220 | 37 | 11 | 620 | | | | | |
| 9 | 221 | 14 | 4 | 2900 | | | | | |
| 110 | 222 | 25 | 9 | 260 | | | | | |
| 1 | 223 | 35 | 11 | 620 | | | | | |
| 2 | 224 | 29 | 9 | 3300 | | | | | |
| 3 | 225 | 36 | 10 | 600 | | | | | |
| 4 | 226 | 31 | 12 | 220 | | | | | |
| 5 | 7811 227 | 34 | 10 | 590 | | | | | |
| 6 | 7811022 | 37 | 8 | 510 | | | | | |
| 7 | 100 | 30 | 7 | 570 | | | | | |
| 8 | 111 | 33 | 12 | 450 | | | | | |
| 9 | 147 138 | 12 | 9 | 58 | | | | | |
| 120 | 7811 222 | 24 | 7 | 255 | | | | | |

RIO TINTO CANADIAN EXPLORATION LIMITED

LABORATORY REPORT

PARTS PER MILLION

| LAB NO. | SAMPLE NO. (NMBR) | Cu | Pb | Zn | | | | | | COMMENTS |
|--------------|-------------------|----------------|----------------|----------------|--|--|--|--|--|----------|
| 81 | 7811 235 | 29 | 325 | 7300 | | | | | | |
| 2 | 236 | 61 | 655 | 4200 | | | | | | |
| 3 | 237 | 51 | 46 | 1150 | | | | | | |
| 4 | 238 | 85 | 153 | 4000 | | | | | | |
| 5 | 239 | 42 | 335 | 5900 | | | | | | |
| 6 | 240 | 29 | 43 | 710 | | | | | | |
| 7 | 241 | 95 | 48 | 1650 | | | | | | |
| 8 | 242 | 35 | 210 | 6100 | | | | | | |
| 9 | 243 | 43 | 22 | 980 | | | | | | |
| 90 | 244 | 22 | 42 | 1180 | | | | | | |
| 1 | 245 | 30 | 220 | 1100 | | | | | | |
| 2 | 246 | 33 | 22 | 570 | | | | | | |
| 3 | 247 | 22 | 27 | 265 | | | | | | |
| 4 | STD 2 | 50 | 570 | 260 | | | | | | |
| 5 | 248 | 20 | 37 | 300 | | | | | | |
| 6 | 249 | 35 | 19 | 710 | | | | | | |
| 7 | 250 | 51 | 20 | 700 | | | | | | |
| 8 | 251 | 35 | 17 | 520 | | | | | | |
| 9 | 252 | 33 | 112 | 3000 | | | | | | |
| 100 | 253 | 21 | 24 | 250 | | | | | | |
| 1 | 254 | 43 | 21 | 320 | | | | | | |
| 2 | 255 | 28 | 22 | 225 | | | | | | |
| 3 | 256 | 29 | 24 | 520 | | | | | | |
| 4 | BLANK | 101 | 49 | 420 | | | | | | |
| 5 | 257 | 38 | 19 | 215 | | | | | | |
| 6 | 258 | 36 | 31 | 580 | | | | | | |
| 7 | 259 | 47 | 27 | 350 | | | | | | |
| 8 | 260 | 33 | 25 | 255 | | | | | | |
| 9 | 261 | 27 | 12 | 440 | | | | | | |
| 110 | 262 | 40 | 27 | 610 | | | | | | |
| 1 | 263 | 47 | 24 | 475 | | | | | | |
| 2 | 264 | 48 | 28 | 1030 | | | | | | |
| 3 | 265 | 38 | 15 | 285 | | | | | | |
| 4 | 266 | 57 | 14 | 250 | | | | | | |
| 5 | 267 | 43 | 26 | 270 | | | | | | |
| 6 | 268 | 22 | 17 | 280 | | | | | | |
| 7 | 269 | 21 | 12 | 200 | | | | | | |
| 8 | 270 | 29 | 26 | 355 | | | | | | |
| 9 | 271 | 37 | 19 | 530 | | | | | | |
| 120 | 7811 272 | 28 | 24 | 320 | | | | | | |

RIO TINTO CANADIAN EXPLORATION LIMITED

LABORATORY REPORT

PARTS PER MILLION

| LAB NO. | SAMPLE NO. (NMBR) | Co. | Pb. | Zn. | | | | | COMMENTS |
|--------------|---------------------|---------------|----------------|-----------------|--|--|--|--|----------|
| 121 | 7811 273 | 29 | 22 | 360 | | | | | |
| 2 | 274 | 29 | 22 | 370 | | | | | |
| 3 | 275 | 29 | 22 | 305 | | | | | |
| 4 | 276 | 29 | 20 | 340 | | | | | |
| 5 | 277 | 30 | 29 | 1120 | | | | | |
| 6 | 278 | 39 | 23 | 570 | | | | | |
| 7 | 279 | 39 | 24 | 610 | | | | | |
| 8 | 280 | 38 | 121 | 850 | | | | | |
| 9 | 281 | 26 | 122 | 260 | | | | | |
| 130 | 282 | 200 | 275 | 6000 | | | | | |
| 1 | 283 | 29 | 29 | 700 | | | | | |
| 2 | 284 | 33 | 17 | 440 | | | | | |
| 3 | 285 | 11 | 10 | 590 | | | | | |
| 4 | 286 | 10 | 20 | 6200 | | | | | |
| 5 | SFO 3 | 35 | 6 | 55 | | | | | |
| 6 | 287 | 17 | 24 | 4100 | | | | | |
| 7 | 288 | 63 | 23 | 620 | | | | | |
| 8 | 289 | 24 | 11 | 970 | | | | | |
| 9 | 300 | 32 | 11 | 275 | | | | | |
| 140 | 301 | 27 | 14 | 290 | | | | | |
| 1 | 302 | 39 | 13 | 610 | | | | | |
| 2 | 303 | 27 | 13 | 580 | | | | | |
| 3 | 304 | 35 | 16 | 650 | | | | | |
| 4 | 305 | 28 | 14 | 330 | | | | | |
| 5 | BLANK | 20 | 100 | 20 | | | | | |
| 6 | 306 | 31 | 15 | 640 | | | | | |
| 7 | 307 | 23 | 13 | 580 | | | | | |
| 8 | 308 | 27 | 12 | 470 | | | | | |
| 9 | 309 | 33 | 10 | 390 | | | | | |
| 150 | 7811 310 | 37 | 16 | 350 | | | | | |
| 1 | 7811 049 | 30 | 15 | 1100 | | | | | |
| 2 | 061 | 39 | 11 | 300 | | | | | |
| 3 | 165 | 23 | 22 | 710 | | | | | |
| 4 | 176 | 45 | 19 | 50 | | | | | |
| 5 | 185 | 53 | 22 | 590 | | | | | |
| 6 | 235 | 31 | 315 | 7800 | | | | | |
| 7 | 253 | 21 | 20 | 250 | | | | | |
| 8 | 267 | 41 | 18 | 65 | | | | | |
| 9 | 279 | 35 | 29 | 610 | | | | | |
| 160 | 7811 303 | 27 | 15 | 320 | | | | | |

RIO TINTO CANADIAN EXPLORATION LIMITED

LABORATORY REPORT

PARTS PER MILLION

| LAB NO | SAMPLE NO (NUMBR) | | Cu | Pb | Zn | | | | | | COMMENTS |
|--------------|-------------------|--|---------------|---------------|--------------------|--|--|--|--|--|----------|
| 41 | 7811 387 | | 71 | 54 | 1750 | | | | | | |
| 2 | 388 | | 72 | 60 | 2400 | | | | | | |
| 3 | 389 | | 66 | 51 | 2100 | | | | | | |
| 4 | 390 | | 59 | 51 | 2100 | | | | | | |
| 5 | 391 | | 57 | 47 | 2100 | | | | | | |
| 6 | 392 | | 50 | 52 | 2500 | | | | | | |
| 7 | 393 | | 63 | 52 | 2600 | | | | | | |
| 8 | 394 | | 66 | 49 | 2800 | | | | | | |
| 9 | 395 | | 61 | 98 | 3300 | | | | | | |
| 50 | 396 | | 54 | 32 | 950 | | | | | | |
| 1 | 397 | | 48 | 70 | 2800 | | | | | | |
| 2 | 398 | | 44 | 29 | 1000 | | | | | | |
| 3 | STD 2 | | 32 | 27 | 275 | | | | | | |
| 4 | 399 | | 53 | 26 | 600 | | | | | | |
| 5 | 400 | | 43 | 27 | 650 | | | | | | |
| 6 | 401 | | 52 | 21 | 1600 | | | | | | |
| 7 | 402 | | 56 | 39 | 780 | | | | | | |
| 8 | 403 | | 50 | 25 | 820 | | | | | | |
| 9 | 404 | | 50 | 62 | 2800 | | | | | | |
| 60 | 405 | | 44 | 42 | 1820 | | | | | | |
| 1 | 406 | | 48 | 45 | 2000 | | | | | | |
| 2 | 407 | | 48 | 39 | 2200 | | | | | | |
| 3 | BLANK | | ND | ND | ND | | | | | | |
| 4 | 408X | | 45 | 36 | 2400 | | | | | | |
| 5 | 408Y | | 26 | 32 | 460 | | | | | | |
| 6 | 409 | | 24 | 30 | 585 | | | | | | |
| 7 | 410 | | 26 | 22 | 435 | | | | | | |
| 8 | 411 | | 34 | 37 | 940 | | | | | | |
| 9 | 412 | | 39 | 21 | 1000 | | | | | | |
| 70 | 413 | | 34 | 20 | 240 | | | | | | |
| 1 | 414 | | 53 | 25 | 600 | | | | | | |
| 2 | 415 | | 22 | 26 | 580 | | | | | | |
| 3 | 416 | | 31 | 18 | 770 | | | | | | |
| 4 | 417 | | 62 | 16 | 240 | | | | | | |
| 5 | 418 | | 55 | 20 | 800 | | | | | | |
| 6 | 420 | | 30 | 7 | 580 | | | | | | |
| 7 | 421 | | 31 | 9 | 450 450 | | | | | | |
| 8 | 422 | | 29 | 9 | 470 | | | | | | |
| 9 | 423 | | 137 | 11 | 2200 | | | | | | |
| 80 | 7811 424 | | 51 | 10 | 310 | | | | | | |

RIO TINTO CANADIAN EXPLORATION LIMITED

LABORATORY REPORT

PARTS PER MILLION

| LAB NR. | SAMPLE NO. (NMBR) | Cu | Pb | Zn | | | | | COMMENTS |
|--------------|-------------------|---------------|---------------|----------------|--|--|--|--|----------|
| 121 | 7811593 | 34 | 14 | 970 | | | | | |
| 2 | 594 | 38 | 14 | 1030 | | | | | |
| 3 | 595 | 26 | 13 | 1130 | | | | | |
| 4 | 596 | 29 | 10 | 890 | | | | | |
| 5 | 597 | 27 | 14 | 210 | | | | | |
| 6 | 598 | 38 | 14 | 630 | | | | | |
| 7 | 599 | 22 | 10 | 150 | | | | | |
| 8 | 600 | 47 | 15 | 620 | | | | | |
| 9 | 601 | 58 | 20 | 470 | | | | | |
| 130 | 602 | 110 | 17 | 720 | | | | | |
| 1 | 603 | 81 | 15 | 610 | | | | | |
| 2 | 604 | 54 | 17 | 1380 | | | | | |
| 3 | 605 | 33 | 16 | 3700 | | | | | |
| 4 | 606 | 69 | 17 | 710 | | | | | |
| 5 | STD 2 | 34 | 14 | 270 | | | | | |
| 6 | 607 | 8 | ND | 21,500 | | | | | H.F.C. |
| 7 | 608 | 53 | 22 | 1500 | | | | | |
| 8 | 609 | 22 | ND | 1200 | | | | | H.F.C. |
| 9 | 610 | 192 | 14 | 3000 | | | | | |
| 140 | 611 | 156 | 10 | 11,600 | | | | | |
| 1 | 612 | 108 | 13 | 9400 | | | | | |
| 2 | 613 | 60 | 17 | 1850 | | | | | |
| 3 | 614 | 56 | 28 | 780 | | | | | |
| 4 | 700 | 22 | 12 | 1120 | | | | | |
| 5 | BLANK | ND | ND | ND | | | | | |
| 6 | 701 | 23 | 11 | 390 | | | | | |
| 7 | 702 | 27 | 10 | 350 | | | | | |
| 8 | 703 | 20 | 10 | 255 | | | | | |
| 9 | 704 | 22 | 10 | 420 | | | | | |
| 150 | 705 | 18 | 8 | 92 | | | | | |
| 1 | 706 | 19 | 9 | 475 | | | | | |
| 2 | 707 | 58 | 13 | 4700 | | | | | |
| 3 | 708 | 22 | 12 | 350 | | | | | |
| 4 | 709 | 14 | 13 | 205 | | | | | |
| 5 | 710 | 51 | 20 | 2200 | | | | | |
| 6 | 711 | 37 | 18 | 1750 | | | | | |
| 7 | 712 | 53 | 10 | 3900 | | | | | |
| 8 | 713 | 29 | 26 | 360 | | | | | |
| 9 | 714 | 27 | 14 | 1310 | | | | | |
| 160 | 7811715 | 41 | 17 | 5600 | | | | | |

RIO TINTO CANADIAN EXPLORATION LIMITED

LABORATORY REPORT

PARTS PER MILLION

| LAB NO. | SAMPLE NO. (NMBR) | Co | Pb | Zn | | | | COMMENTS |
|--------------|--------------------|----------------|----------------|----------------|-----|--|--|----------|
| 1 | 7911614 | 23 | 15 | 360 | | | | |
| 2 | 615 | 24 | 23 | 480 | | | | |
| 3 | 616 | 34 | 18 | 305 | | | | |
| 4 | 747 | 13 | 7 | 102 | | | | |
| 5 | 748 | 17 | 10 | 130 | | | | |
| 6 | 749 | 49 | 15 | 320 | | | | |
| 7 | 750 | 36 | 18 | 220 | | | | |
| 8 | 751 | 14 | 9 | 118 | | | | |
| 9 | 752 | 20 | 10 | 225 | | | | |
| 10 | 753 | 31 | 8 | 112 | | | | |
| 1 | 754 754 | 16 | 9 | 108 | | | | |
| 2 | STD 2 | 22 | 26 | 260 | | | | |
| 3 | 755 | 16 | 11 | 195 | | | | |
| 4 | 756 | 14 | 9 | 124 | | | | |
| 5 | 757 | 13 | 8 | 108 | | | | |
| 6 | 758 | 31 | 9 | 600 | | | | |
| 7 | 759 | 14 | 9 | 124 | | | | |
| 8 | 760 | 59 | 104 | 3900 | | | | |
| 9 | 761 | 55 | 75 | 730 | | | | |
| 20 | 762 | 69 | 73 | 3400 | | | | |
| 1 | 763 | 44 | 22 | 210 | | | | |
| 2 | BLANK | Nil | Nil | Nil | | | | |
| 3 | 764 | 27 | 35 | 1250 | | | | |
| 4 | 765 | 128 | 26 | 1450 | | | | |
| 5 | 766 | 79 | 18 | 1700 | | | | |
| 6 | 767 | 48 | 21 | 560 | | | | |
| 7 | 768 | 56 | 33 | 4500 | | | | |
| 8 | 769 | 69 | 33 | 2700 | | | | |
| 9 | 800 | 26 | 9 | 400 | | | | |
| 30 | 801 | 16 | 11 | 135 | | | | |
| 1 | 802 | 23 | 9 | 235 | | | | |
| 2 | 803 | 16 | 8 | 150 | | | | |
| 3 | 804 | 15 | 7 | 225 | 128 | | | |
| 4 | 805 | 20 | 13 | 290 | 225 | | | |
| 5 | 806 | 35 | 17 | 152 | 290 | | | |
| 6 | 807 | 14 | 8 | 178 | 132 | | | |
| 7 | 808 | 14 | 8 | 155 | 116 | | | |
| 8 | 809 | 15 | 8 | 315 | 155 | | | |
| 9 | 810 | 45 | 21 | 210 | 315 | | | |
| 40 | 7911811 | 35 | 15 | 6 | 20 | | | |

RIO TINTO CANADIAN EXPLORATION LIMITED

LABORATORY REPORT

PARTS PER MILLION

| LAB NO. | SAMPLE NO. (NMBR) | | Cu | Pb | Zn | | | | | COMMENTS |
|--------------|-------------------|------|---------------|---------------|----------------|--|--|--|--|----------|
| 1 | 7811 617 | 35 | 87 | 116 | 770 | | | | | |
| 2 | 618 | | 168 | 295 | 6000 | | | | | |
| 3 | 619 | | 80 | 22 | 1950 | | | | | |
| 4 | 620 | | 34 | 18 | 640 | | | | | |
| 5 | 621 | | 31 | 16 | 280 | | | | | |
| 6 | 622 | | 36 | 15 | 880 | | | | | |
| 7 | 623 | | 28 | 15 | 640 | | | | | |
| 8 | 624 | | 36 | 14 | 980 | | | | | |
| 9 | 625 | | 35 | 13 | 1060 | | | | | |
| 10 | 626 | | 18 | 12 | 125 | | | | | |
| 1 | 628 | | 22 | 10 | 115 | | | | | |
| 2 | STD 1 | | 15 | 28 | 700 | | | | | |
| 3 | 629 | | 22 | 11 | 146 | | | | | |
| 4 | 630 | | 23 | 11 | 190 | | | | | |
| 5 | 631 | | 65 | 16 | 760 | | | | | |
| 6 | 632 | | 33 | 15 | 235 | | | | | |
| 7 | 633 | | 32 | 13 | 550 | | | | | |
| 8 | 634 | | 27 | 16 | 310 | | | | | |
| 9 | 635 | | 29 | 39 | 1030 | | | | | |
| 20 | 636 | | 56 | 78 | 2000 | | | | | |
| 1 | 637 | | 45 | 24 | 770 | | | | | |
| 2 | BLANK | | 27 | 27 | 102 | | | | | |
| 3 | 638 | | 29 | 19 | 940 | | | | | |
| 4 | 639 | | 26 | 16 | 280 | | | | | |
| 5 | 640 | | 43 | 13 | 345 | | | | | |
| 6 | 641 | | 35 | 16 | 480 | | | | | |
| 7 | 642 | | 24 | 29 | 350 | | | | | |
| 8 | 643 | | 135 | 35 | 1900 | | | | | |
| 9 | 644 | | 54 | 16 | 830 | | | | | |
| 30 | 645 | | 38 | 20 | 840 | | | | | |
| 1 | 646 | | 51 | 26 | 360 | | | | | |
| 2 | 647 | | 37 | 250 | 1170 | | | | | |
| 3 | 648 | | 21 | 17 | 1700 | | | | | |
| 4 | 649 | | 29 | 175 | 560 | | | | | |
| 5 | 650 | 5853 | | 41 | 700 | | | | | |
| 6 | 651 | | 67 | 41 | 1700 | | | | | |
| 7 | 676 | | 33 | 15 | 265 | | | | | |
| 8 | 677 | | 33 | 14 | 290 | | | | | |
| 9 | 678 | | 33 | 23 | 335 | | | | | |
| 40 | 7811679 | | 36 | 28 | 700 | | | | | |

RIO TINTO CANADIAN EXPLORATION LIMITED

LABORATORY REPORT

PARTS PER MILLION

| LAB NO. | SAMPLE NO. (NMBR) | | Cu | Pb | Zn | | | | | | COMMENTS |
|--------------|-------------------|--|---------------|---------------|----------------|--|--|--|--|--|----------|
| 41 | 7811 627 | | 22 | 12 | 115 | | | | | | |
| 2 | 680 | | 23 | 21 | 265 | | | | | | |
| 3 | 681 | | 37 | 5 | 125 | | | | | | |
| 4 | 682 | | 37 | 19 | 470 | | | | | | |
| 5 | 683 | | 16 | 17 | 230 | | | | | | |
| 6 | 684 | | 25 | 6 | 98 | | | | | | |
| 7 | 685 | | 34 | 11 | 148 | | | | | | |
| 8 | 686 | | 23 | 10 | 190 | | | | | | |
| 9 | 687 | | 54 | 24 | 570 | | | | | | |
| 50 | 688 | | 35 | 27 | 600 | | | | | | |
| 1 | 689 | | 17 | 7 | 255 | | | | | | |
| 2 | 690 | | 38 | 24 | 395 | | | | | | |
| 3 | 510 2 | | 38 | 37 | 270 | | | | | | |
| 4 | 691 | | 74 | 13 | 320 | | | | | | |
| 5 | 692 | | 28 | 19 | 185 | | | | | | |
| 6 | 693 | | 53 | 70 | 760 | | | | | | |
| 7 | 694 | | 26 | 14 | 375 | | | | | | |
| 8 | 695 | | 30 | 17 | 320 | | | | | | |
| 9 | 696 | | 30 | 16 | 380 | | | | | | |
| 60 | 697 | | 41 | 15 | 880 | | | | | | |
| 1 | 698 | | 33 | 16 | 540 | | | | | | |
| 2 | 699 | | 49 | 12 | 900 | | | | | | |
| 3 | BLANK | | ND | ND | ND | | | | | | |
| 4 | 770 | | 19 | 53 | 325 | | | | | | |
| 5 | 771 | | 34 | 41 | 3000 | | | | | | |
| 6 | 772 | | 77 | 42 | 5700 | | | | | | |
| 7 | 773 | | 44 | 33 | 3800 | | | | | | |
| 8 | 774 | | 37 | 30 | 2900 | | | | | | |
| 9 | 775 | | 55 | 25 | 1900 | | | | | | |
| 70 | 776 | | 7 | 11 | 46 | | | | | | |
| 1 | 777 | | 6 | 8 | 68 | | | | | | |
| 2 | 778 | | 6 | 10 | 48 | | | | | | |
| 3 | 779 | | 3 | 11 | 64 | | | | | | |
| 4 | 780 | | 19 | 30 | 380 | | | | | | |
| 5 | 781 | | 30 | 18 | 610 | | | | | | |
| 6 | 782 | | 31 | 18 | 620 | | | | | | |
| 7 | 783 | | 28 | 12 | 680 | | | | | | |
| 8 | 784 | | 27 | 14 | 650 | | | | | | |
| 9 | 785 | | 30 | 14 | 1000 | | | | | | |
| 80 | 7811 786 | | 38 | 15 | 630 | | | | | | |

RIO TINTO CANADIAN EXPLORATION LIMITED

LABORATORY REPORT

PARTS PER MILLION

| LAB NO. | SAMPLE NO. (NMBR) | Cu | Pb | Zn | | | | | COMMENTS |
|---------|-------------------|---------------|---------------|----------------|--|--|--|--|----------|
| 81 | 7811 787 | 36 | 14 | 265 | | | | | |
| 2 | 788 | 31 | 17 | 280 | | | | | |
| 3 | 789 | 34 | 14 | 1500 | | | | | |
| 4 | 790 | 34 | 15 | 650 | | | | | |
| 5 | 791 | 50 | 16 | 870 | | | | | |
| 6 | 792 | 46 | 13 | 1080 | | | | | |
| 7 | 793 | 33 | 14 | 900 | | | | | |
| 8 | 794 | 35 | 13 | 750 | | | | | |
| 9 | 795 | 18 | 17 | 78 | | | | | |
| 90 | 796 | 35 | 13 | 4000 | | | | | |
| 1 | 797 | 42 | 14 | 520 | | | | | |
| 2 | 798 | 31 | 13 | 2400 | | | | | |
| 3 | 799 | 28 | 10 | 2600 | | | | | |
| 4 | STD 3 | 30 | 15 | 350 | | | | | |
| 5 | 900 | 32 | 14 | 2000 | | | | | |
| 6 | 901 | 34 | 14 | 1900 | | | | | |
| 7 | 902 | 37 | 16 | 2000 | | | | | |
| 8 | 903 | 29 | 14 | 750 | | | | | |
| 9 | 904 | 19 | 11 | 160 | | | | | |
| 100 | 905 | 23 | 16 | 820 | | | | | |
| 1 | 906 | 29 | 16 | 490 | | | | | |
| 2 | 907 | 34 | 11 | 480 | | | | | |
| 3 | 908 | 26 | 3 | 560 | | | | | |
| 4 | BLANK | 20 | 10 | 120 | | | | | |
| 5 | 909 | 34 | 16 | 455 | | | | | |
| 6 | 910 | 33 | 24 | 660 | | | | | |
| 7 | 911 | 51 | 19 | 650 | | | | | |
| 8 | 912 | 72 | 24 | 870 | | | | | |
| 9 | 913 | 147 | 15 | 790 | | | | | |
| 110 | 914 | 152 | 17 | 670 | | | | | |
| 1 | 915 | 47 | 18 | 2000 | | | | | |
| 2 | 916 | 45 | 16 | 2100 | | | | | |
| 3 | 917 | 44 | 17 | 1450 | | | | | |
| 4 | 918 | 39 | 15 | 2100 | | | | | |
| 5 | 919 | 37 | 16 | 1950 | | | | | |
| 6 | 920 | 16 | 15 | 205 | | | | | |
| 7 | 921 | 400 | NP | 5300 | | | | | 1A F. |
| 8 | 922 | 5 | NP | 6600 | | | | | 1A F. |
| 9 | 923 | 50 | 7 | 6800 | | | | | |
| 120 | 7811 924 | 4 | NP | 6400 | | | | | 1A F. |

RIO TINTO CANADIAN EXPLORATION LIMITED

LABORATORY REPORT

PARTS PER MILLION

| LAB NO. | SAMPLE NO. (NMBR) | Cu | Pb | Zn | | | | | COMMENTS |
|---------|---------------------|---------------|---------------|--------------------|--|--|--|--|----------|
| 121 | 7811 925 | 5 | ND | 5300 | | | | | H.F. |
| 2 | 926 | 4 | ND | 11000 | | | | | H.F. |
| 3 | 927 | 29 | 12 | 4000 | | | | | |
| 4 | 928 | 24 | 17 | 2400 | | | | | |
| 5 | 929 | 20 | 18 | 2600 | | | | | |
| 6 | 930 | 10 | 16 | 1100 | | | | | |
| 7 | 931 | 60 | 9 | 5500 | | | | | |
| 8 | 932 | 350 | 2 | 5700 | | | | | |
| 9 | 933 | 52 | 14 | 2900 | | | | | |
| 130 | 934 | 19 | 21 | 1900 | | | | | |
| 1 | 935 | 46 | 19 | 3200 | | | | | |
| 2 | 936 | 44 | 17 | 1180 | | | | | |
| 3 | 937 | 38 | 18 | 830 | | | | | |
| 4 | 938 | 49 | 16 | 1250 | | | | | |
| 5 | STD 1 | 15 | 28 | 700 | | | | | |
| 6 | 939 | 43 | 17 | 1280 | | | | | |
| 7 | 940 | 27 | 11 | 680 | | | | | |
| 8 | 941 | 35 | 15 | 570 | | | | | |
| 9 | 942 | 30 | 14 | 670 | | | | | |
| 140 | 943 | 31 | 13 | 900 | | | | | |
| 1 | 944 | 38 | 33 | 620 | | | | | |
| 2 | 945 | 35 | 19 | 285 | | | | | |
| 3 | 946 | 40 | 20 | 430 | | | | | |
| 4 | 947 | 22 | 15 | 465 | | | | | |
| 5 | BLANK | ND | ND | ND | | | | | |
| 6 | 948 | 29 | 12 | 700 | | | | | |
| 7 | 949 | 27 | 16 | 670 | | | | | |
| 8 | 950 | 40 | 16 | 425 | | | | | |
| 9 | 951 | 29 | 13 | 580 | | | | | |
| 150 | 7811 952 | 25 | 15 | 440 | | | | | |
| 1 | 7811 625 | 35 | 15 | 1040 | | | | | |
| 2 | 637 | 46 | 33 | 770 770 | | | | | |
| 3 | 648 | 20 | 17 | 1700 | | | | | |
| 4 | 685 | 33 | 12 | 145 | | | | | |
| 5 | 770 | 19 | 57 | 310 | | | | | |
| 6 | 784 | 27 | 14 | 650 | | | | | |
| 7 | 799 | 28 | 10 | 2600 | | | | | |
| 8 | 921 | 455 | ND | 5300 | | | | | H.F. |
| 9 | 927 | 29 | 18 | 4200 | | | | | |
| 160 | 7811 948 | 28 | 12 | 680 | | | | | |

RIO TINTO CANADIAN EXPLORATION LIMITED

LABORATORY REPORT

PARTS PER MILLION

| LAB NO. | SAMPLE NO. (NMBR) | Cu | Pb | Zn | COMMENTS |
|--------------|-------------------|---------------|---------------|-----------------|----------|
| 81 | 7822 065 | 81 | 25 | 1180 | |
| 2 | 066 | 60 | 45 | 1080 | |
| 3 | 067 | 67 | 44 | 1200 | |
| 4 | 068 | 40 | 41 | 880 | |
| 5 | 069 | 38 | 21 | 2200 | |
| 6 | 070 | 33 | 20 | 620 | |
| 7 | 071 | 31 | 17 | 900 | |
| 8 | 072 | 26 | 23 | 410 | |
| 9 | 073 | 24 | 44 | 240 | |
| 90 | 074 | 28 | 35 | 370 | |
| 1 | 075 | 33 | 13 | 530 | |
| 2 | 076 | 39 | 51 | 1750 | |
| 3 | 077 | 32 | 17 | 1170 | |
| 4 | STD | 15 | 27 | 1000 | |
| 5 | 078 | 51 | 14 | 1550 | |
| 6 | 079 | 35 | 12 | 1450 | |
| 7 | 080 | 35 | 11 | 2300 | |
| 8 | 081 | 36 | 11 | 2700 | |
| 9 | 082 | 34 | 11 | 2400 | |
| 100 | 084 | 20 | 19 | 148 | |
| 1 | 085 | 16 | 14 | 400 | |
| 2 | 086 | 39 | 12 | 425 | |
| 3 | 087 | 19 | 14 | 165 | |
| 4 | BLANK | ND | ND | ND | |
| 5 | 088 | 26 | 15 | 270 | |
| 6 | 089 | 46 | 16 | 390 | |
| 7 | 090 | 40 | 15 | 360 | |
| 8 | 091 | 27 | 15 | 340 | |
| 9 | 092 | 28 | 11 | 205 | |
| 110 | 093 | 20 | 9 | 155 | |
| 1 | 094 | 42 | 11 | 330 | |
| 2 | 095 | 48 | 13 | 230 | |
| 3 | 096 | 25 | 16 | 220 | |
| 4 | 097 | 28 | 10 | 250 | |
| 5 | 098 | 31 | 10 | 132 | |
| 6 | 099 | 32 | 7 | 96 | |
| 7 | 100 | 31 | 11 | 72 | |
| 8 | 101 | 39 | 7 | 118 | |
| 9 | 102 | 52 | 13 | 195 | |
| 120 | 7822 103 | 41 | 8 | 138 | |

RIO TINTO CANADIAN EXPLORATION LIMITED

LABORATORY REPORT

PARTS PER MILLION

| LAB. NO. | SAMPLE NO. (NMBR) | Cu | Pb | Zn | | | | | | | COMMENTS |
|--------------|---------------------|---------------|----------------|-----------------|--|--|--|--|--|--|----------|
| 121 | 7822 104 | 34 | 12 | 156 | | | | | | | |
| 2 | 105 | 37 | 12 | 158 | | | | | | | |
| 3 | 106 | 33 | 15 | 325 | | | | | | | |
| 4 | 107 | 27 | 12 | 245 | | | | | | | |
| 5 | 108 | 38 | 22 | 660 | | | | | | | |
| 6 | 109 | 33 | 10 | 270 | | | | | | | |
| 7 | 110 | 4 | ND | 690 | | | | | | | |
| 8 | 111 | 33 | 14 | 315 | | | | | | | |
| 9 | 112 | 29 | 12 | 325 | | | | | | | |
| 130 | 113 | 32 | 14 | 315 | | | | | | | |
| 1 | 114 | 31 | 13 | 275 | | | | | | | |
| 2 | 115 | 43 | 15 | 310 | | | | | | | |
| 3 | 116 | 39 | 83 | 1050 | | | | | | | |
| 4 | 117 | 24 | 20 | 185 | | | | | | | |
| 5 | STD 2 | 31 | 300 | 300 | | | | | | | |
| 6 | 118 | 17 | 22 | 118 | | | | | | | |
| 7 | 119 | 34 | 52 | 1350 | | | | | | | |
| 8 | 120 | 15 | 14 | 165 | | | | | | | |
| 9 | 121 | 15 | 15 | 215 | | | | | | | |
| 140 | 122 | 20 | 28 | 570 | | | | | | | |
| 1 | 300 | 33 | 70 | 1350 | | | | | | | |
| 2 | 301 | 23 | 35 | 400 | | | | | | | |
| 3 | 302 | 36 | 30 | 285 | | | | | | | |
| 4 | 303 | 23 | 24 | 325 | | | | | | | |
| 5 | BLANK | ND | ND | ND | | | | | | | |
| 6 | 304 | 30 | 23 | 315 | | | | | | | |
| 7 | 305 | 41 | 57 | 920 | | | | | | | |
| 8 | 306 | 28 | 33 | 440 | | | | | | | |
| 9 | 307 | 24 | 32 | 340 | | | | | | | |
| 150 | 7822 308 | 38 | 22 | 440 | | | | | | | |
| 1 | 7822 001 | 32 | 23 | 265 | | | | | | | |
| 2 | 011 | 34 | 16 | 910 | | | | | | | |
| 3 | 023 | 37 | 25 | 400 | | | | | | | |
| 4 | 040 | 31 | 28 | 480 | | | | | | | |
| 5 | 056 | 33 | 14 | 1400 | | | | | | | |
| 6 | 071 | 31 | 16 | 870 | | | | | | | |
| 7 | 081 | 35 | 108 | 2800 | | | | | | | |
| 8 | 095 | 48 | 11 | 225 | | | | | | | |
| 9 | 112 | 28 | 12 | 325 | | | | | | | |
| 160 | 7822 303 | 23 | 25 | 315 | | | | | | | |

RIO TINTO CANADIAN EXPLORATION LIMITED

LABORATORY REPORT

PARTS PER MILLION

| LAB NO. | SAMPLE NO. (NMBR) | Cu | Pb | Zn | | | | | | COMMENTS |
|---------|-------------------|-----|-----|--------|--|--|--|--|--|----------|
| 1 | 7822123 | 33 | 123 | 8700 | | | | | | |
| 2 | 124 | 49 | 16 | 640 | | | | | | |
| 3 | 125 | 29 | 26 | 700 | | | | | | |
| 4 | 126 | 49 | 11 | 425 | | | | | | |
| 5 | 127 | 53 | 11 | 1350 | | | | | | |
| 6 | 128 | 114 | ND | 26,000 | | | | | | |
| 7 | 129 | 54 | 11 | 1700 | | | | | | |
| 8 | 130 | 20 | ND | 10,000 | | | | | | |
| 9 | 131 | 23 | 22 | 1050 | | | | | | |
| 10 | 132 | 34 | 59 | 1150 | | | | | | |
| 1 | 133 | 30 | 33 | 810 | | | | | | |
| 2 | STD 3 | 38 | 5 | 58 | | | | | | |
| 3 | 134 | 35 | 23 | 350 | | | | | | |
| 4 | 433 | 18 | 18 | 190 | | | | | | |
| 5 | 463 | 16 | 8 | 265 | | | | | | |
| 6 | 479 | 45 | 25 | 325 | | | | | | |
| 7 | 480 | 39 | 20 | 225 | | | | | | |
| 8 | 481 | 43 | 24 | 360 | | | | | | |
| 9 | 482 | 44 | 24 | 375 | | | | | | |
| 20 | 483 | 43 | 25 | 380 | | | | | | |
| 1 | 484 | 44 | 25 | 375 | | | | | | |
| 2 | BLANK | ND | ND | ND | | | | | | |
| 3 | 485 | 38 | 17 | 390 | | | | | | |
| 4 | 486 | 22 | 13 | 230 | | | | | | |
| 5 | 487 | 40 | 16 | 170 | | | | | | |
| 6 | 488 | 23 | 17 | 240 | | | | | | |
| 7 | 489 | 16 | 10 | 122 | | | | | | |
| 8 | 490 | 20 | 9 | 365 | | | | | | |
| 9 | 491 | 13 | 9 | 105 | | | | | | |
| 30 | 492 | 10 | 7 | 58 | | | | | | |
| 1 | 493 | 8 | 7 | 102 | | | | | | |
| 2 | 494 | 18 | 8 | 178 | | | | | | |
| 3 | 495 | 15 | 5 | 84 | | | | | | |
| 4 | 496 | 27 | 7 | 142 | | | | | | |
| 5 | 497 | 33 | 10 | 730 | | | | | | |
| 6 | 498 | 33 | 9 | 560 | | | | | | |
| 7 | 499 | 13 | 13 | 220 | | | | | | |
| 8 | 551 | 4 | 5 | 54 | | | | | | |
| 9 | 552 | 10 | 11 | 66 | | | | | | |
| 40 | 7822553 | 26 | 11 | 152 | | | | | | |

RIO TINTO CANADIAN EXPLORATION LIMITED

LABORATORY REPORT

PARTS PER MILLION

| LAB NO. | SAMPLE NO. (NMBR) | Cu | Pb | Zn | | | | COMMENTS |
|--------------|-------------------|---------------|---------------|--------------------|--|--|--|----------|
| 1 | 7822989 | 13 | 7 | 102 | | | | |
| 2 | 990 | 39 | 15 | 415 | | | | |
| 3 | 991 | 13 | 6 | 120 | | | | |
| 4 | 992 | 13 | 6 | 122 | | | | |
| 5 | 993 | 12 | 6 | 72 | | | | |
| 6 | 994 | 14 | 7 | 120 | | | | |
| 7 | 995 | 17 | 12 | 240 | | | | |
| 8 | 996 | 13 | 5 | 112 | | | | |
| 9 | 997 | 11 | 5 | 80 | | | | |
| 10 | 998 | 18 | 7 | 132 | | | | |
| 1 | 999 | 15 | 7 | 185 | | | | |
| 2 | STD 1 | 15 | 28 | 910 | | | | |
| 3 | 7823300 | 14 | 5 | 84 | | | | |
| 4 | 7823067 | 27 | 15 | 262 | | | | |
| 5 | 068 | 34 | 15 | 305 | | | | |
| 6 | 069 | 30 | 16 | 228 | | | | |
| 7 | 070 | 45 | 22 | 500 | | | | |
| 8 | 071 | 34 | 17 | 930 930 | | | | |
| 9 | 072 | 46 | 19 | 1100 | | | | |
| 20 | 073 | 44 | 14 | 490 | | | | |
| 1 | 074 | 44 | 13 | 840 | | | | |
| 2 | BLANK | ND | ND | ND | | | | |
| 3 | 075 | 28 | 18 | 650 | | | | |
| 4 | 076 | 53 | 43 | 42 | | | | |
| 5 | 077 | 23 | 10 | 265 | | | | |
| 6 | 078 | 24 | 13 | 820 | | | | |
| 7 | 079 | 34 | 20 | 180 | | | | |
| 8 | 080 | 22 | 18 | 68 | | | | |
| 9 | 082 | 39 | 52 | 920 | | | | |
| 30 | 083 | 30 | 48 | 550 | | | | |
| 1 | 084 | 26 | 27 | 280 | | | | |
| 2 | 085 | 65 | 71 | 4100 | | | | |
| 3 | 086 | 14 | 63 | 230 | | | | |
| 4 | 087 | 22 | 12 | 275 | | | | |
| 5 | 088 | 19 | 24 | 220 | | | | |
| 6 | 089 | 20 | 27 | 110 | | | | |
| 7 | 090 | 57 | 30 | 710 | | | | |
| 8 | 091 | 29 | 23 | 180 | | | | |
| 9 | 092 | 23 | 12 | 320 | | | | |
| 40 | 093 | 22 | 12 | 260 | | | | |

Appendix II
COST STATEMENT

COST STATEMENT

B.C. SIKANNI AREA PROJECTS
GEOLOGICAL, GEOCHEMICAL, & PROSPECTING
9 MAY THROUGH 31 OCTOBER 1978

GENERAL COSTS

FOOD & ACCOMMODATION

9 Persons, 9 May-18 Sep, 765 Man Days \$12,751.00
@ \$16.67/Man Day

RIOCANEX EQUIPMENT

765 Man Days @ \$3/Day 2,295.00

FIXED WING, DHC II,

10 May - 16 Sep @ \$1.75/Mile 24,968.00

HELICOPTERS, 206B

9 May - 24 Sep @ \$315/Hour 94,857.00

SUPPLIES

765 Man Days @ \$5.45/Man Day 4,173.00

FUEL, CAMP & HELICOPTERS

10,737.00

REPAIRS TO RIOCANEX EQUIPMENT

209.00

EXPEDITING SERVICES

9 May - 16 Sep, 130 Days @ \$13.88/Day 1,804.00

REPORT PREPARATION

1,235.00

GENERAL COSTS TOTAL

\$153,029.00

Cost Statement Cont'd

PROSPECTING

GENERAL COSTS

@ 32/765 \$ 6,401.00

SALARIES & WAGES

9 Persons 32 Man Days @ \$31.65/Man Day 1,012.80

BENEFITS

@ 25% of Above 253.20

ASSAYS

Riocanex Lab, 1 Rock Cu/Pb/Zn @ \$4.70 4.70

Bondar-Clegg, 32 element Scan XRF 25.00

13 Rocks, Ag/Cu/Pb/Zn @ \$20.50 266.50

1 Rock, BA @ \$9.50 9.50

1 Rock, Pb/Zn @ \$11.00 11.00

1 Rock, Au @ \$8.50 8.50 325.00

PROSPECTING TOTAL

\$7,992.20

Cost Statement Cont'd

GEOCHEMICAL

GENERAL COSTS

@ 561/765 \$112,221.36

SALARIES & WAGES

9 Persons, 561 Man Days 17,755.65
@ \$31.65/Man Day

BENEFITS

@ 25% of Above 4,438.91

GEOCHEMICAL ANALYSIS

Riocanex Lab, 3003 Soils, \$10,360.35
Cu/Pb/Zn @ \$3.45

Chemex Lab, 310 Soils, BA 930.00
@ \$3.00

Geochemical Supplies 822.00

Shipment of Samples Via C.P. Air 314.06 12,426.41

GEOCHEMICAL TOTAL

\$146,842.23

Cost Statement Cont'd

GEOLOGICAL

GENERAL COSTS

@ 64/765 \$12,802.42

SALARIES & WAGES

9 Persons, 64 Man Days @ \$31.65/Man Day 2,025.60

BENEFITS

@ 25% of Above 506.40

GEOLOGICAL TOTAL \$15,334.42

STAKING

GENERAL COSTS

@ 108/765 \$21,604.08

SALARIES & WAGES

9 Persons, 108 Man Days @ \$31.65 3,418.20

BENEFITS

@ 25% of Above 854.55

STAKING TOTAL \$25,876.83

GRAND TOTAL \$196,045.68

COSTS ATTRIBUTABLE TO PIE CLAIMS

Prospecting \$7,992.20 x $\frac{135}{327}$ (units in PIE claims) = \$ 3,299.53
(total units)

Geological \$15,334.42 x $\frac{135}{327}$ = \$ 6,330.72

Geochemical

Total cost of geochemical programme \$146,842.23

Number of samples collected 3313

Cost per sample $\frac{\$146,842.73}{3313}$ \$44.32

Number of samples in vicinity of claims: 218

Cost attributable to claims 218 x \$44.32 = \$ 9,661.76

TOTAL COST ATTRIBUTABLE TO CLAIMS \$19,292.01

Appendix III

STATEMENT OF QUALIFICATIONS

CERTIFICATE

I, Geoffrey David Hodgson, with business address in Vancouver, British Columbia, and residential address in North Vancouver, British Columbia, do hereby declare

1. I am a geologist employed by Rio Tinto Canadian Exploration Limited.
2. I graduated from Exeter University, U.K. in 1972 with a BSc (Hons.) degree in geology.
3. I graduated from the University of Alberta in 1976 with an MSc degree in geology.
4. I am a Professional Geologist with the Association of Professional Engineers, Geologists and Geophysicists of Alberta.
5. From 1970 to 1979 I have been employed on both a temporary and full-time basis by the Geological Survey of Greenland, Research Council of Alberta, University of Alberta, Cominco Ltd., and Riocanex Ltd.

Respectfully submitted,

G.D. Hodgson

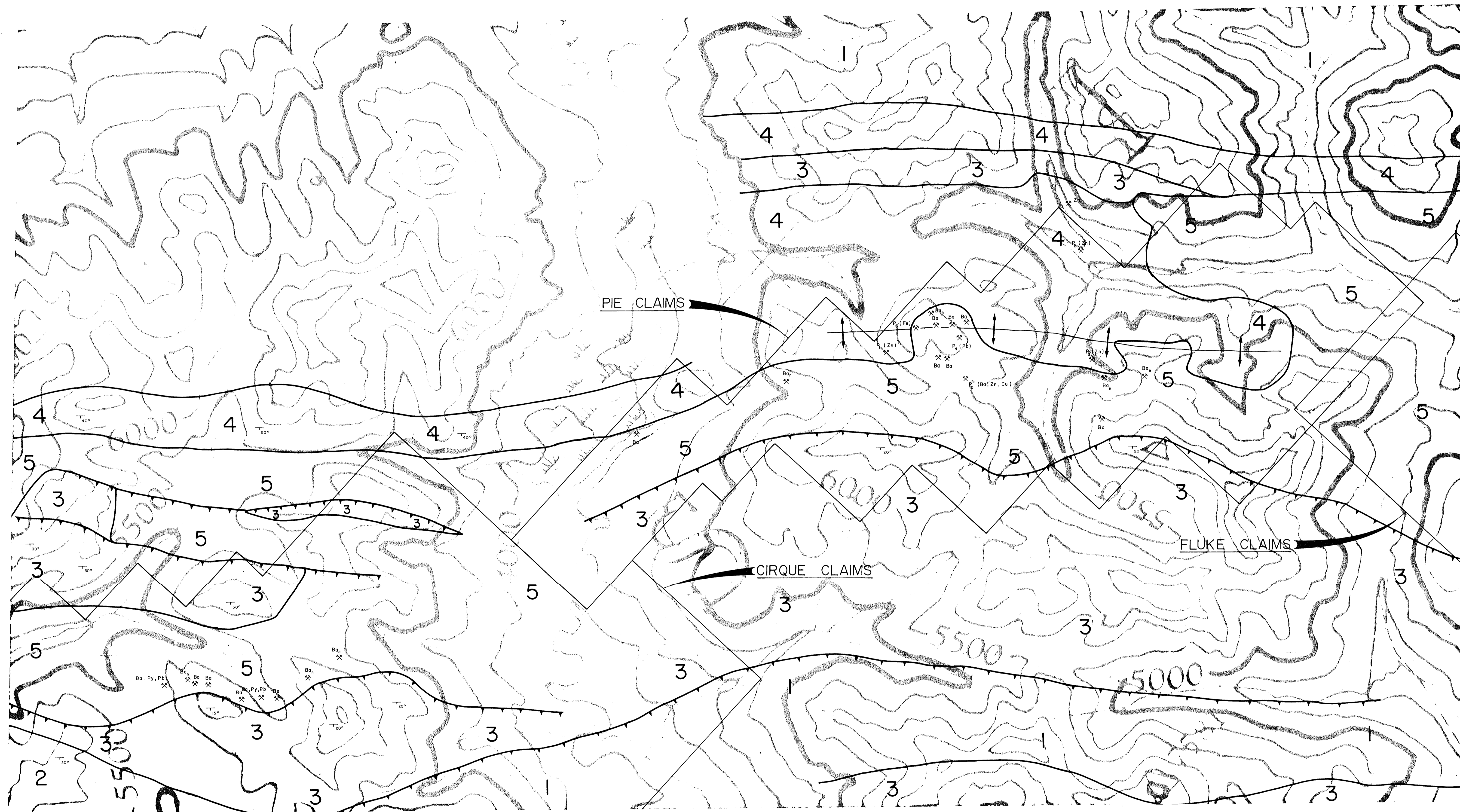

7373

[Handwritten signature]

LEGEND

- | | | | | | | | |
|---|---------------------------------|-----------------|----------------|----------------|--------------------|---|-----------------------------|
| 5 | Devono-Mississippi shale | Ba | Massive Barite | x | Mineral occurrence | ↖ | Strike & dip |
| 4 | Upper Devonian limestone | Ba _n | Nodular Barite | P ₂ | Showing | + | Anticline |
| 3 | Silurian siltstone | Cu | Copper | ↗ | Thrust fault | □ | Outline of claim boundaries |
| 2 | Road River shales | Fe | Iron | — | Geological contact | | |
| 1 | Ordovician Kechika Group shales | Pb | Lead | | | | |
| | | Py | Pyrite | | | | |
| | | Zn | Zinc | | | | |

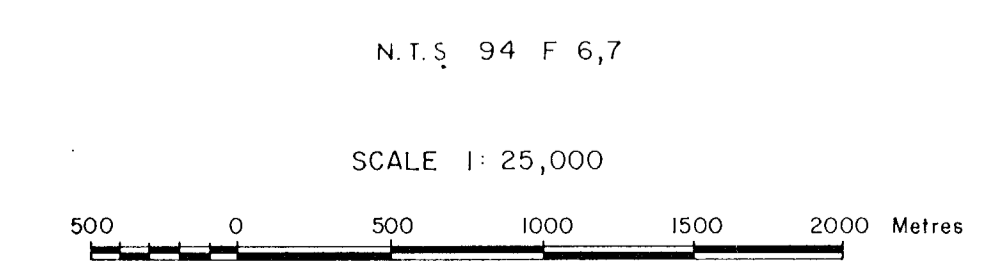

| | | |
|--|-----------|---------------|
| RIO TINTO CANADIAN EXPLORATION LIMITED | | |
| PIE CLAIMS | | |
| PIE CLAIMS | | |
| GEOLOGY & MINERALIZATION | | |
| C.G./y.m. | MAR. 1979 | DWG. 6 - 8665 |