

Assessment Report

on

Geological and Geochemical Work

on the

Alpine Glacier Group
(Alpine and Bozo Claims)

Located

20 air kilometres Southwest of
Lytton

Latitude 50°10'N; Longitude 120°50'W

N.T.S. 92I/4W

Kamloops Mining Division
Southern British Columbia

Field Work between July 24 and August 5, 1979.
on behalf of

AQUARIUS RESOURCES LTD.

Report by

Hans Madeisky
and
D. R. Cochran
August 27, 1979
Delta, B. C.



Cochrane Consultants Limited
4882 Delta St., Delta, B.C. V4K 2T8 946-9221
Geotechnical Consulting / Exploration Services

geology
geophysics
geochemistry

TABLE OF CONTENTS

	Page
Introduction	1
Summary and Conclusions	2
Location and Access	5
Claims Information	6
General Setting	7
Work Done	8
Results Obtained	9
Assay Certificate	10

FIGURES

1	Location Map	Report body
2	Claims Map	" "
3	Geology	Map Pocket
4	Geochemical Plan	" "

APPENDICES

I	Assessment Work Details
II	<i>Cost statement</i> Certificates
III	Assay results

7455



INTRODUCTION

In July and early August 1979, an Aquarius Resources field crew conducted geological and geochemical surveys on the Alpine and Bozo claims, located southwest of Lytton, in southern British Columbia.

This report describes the work done and results obtained and was prepared for assessment work credits. Assessment work details are listed in Appendix I at the end of the report. This report is based on work by Messers. Chase and Ivans (field crew) and geology by Mr. Hans Madeisky.



SUMMARY AND CONCLUSIONS

1. Longbar Minerals Ltd., holds title to the Alpine claim (12 units), and William Chase owns Bozo No. 1 (12 units) and Bozo No. 2 (12 units) covering an old gold and silver prospect formerly known as the Glacier Group and situated in the Cantilever Range of Southern British Columbia. These claims are in the process of being transferred to the name of Aquarius Resources Ltd.

2. The property is centred some 24 air kilometres southwest of Lytton and 130 air kilometres north-northeast of Vancouver in the Kamloops Mining Division. The peak elevation on the property is just over 2300 metres (7600 feet) above sea level, and the most facile type of access is by helicopter.

3. The Alpine Glacier group is partially explored by a series of pits and an adit, and the old work is first reported in the Annual Report for the Minister of Mines in 1915. A good description of the old showing is contained in the 1929 Report of the Minister of Mines (pages C-236 and C-237.)



4. The property was first acquired by Aquarius Resources (Longbar Minerals) Ltd., in 1977, as part of the Boston Bar to Bralorne Project. Reconnaissance geochemical work was conducted in 1977 and this report basically describes "followup" work.

5. 1979 work included the establishment of a ground control grid (100 metres between cross lines, 50 metre station intervals) the collection of 273 upper B horizon soil samples, geological mapping and prospecting.

6. Soil samples were analyzed for their content in gold by A-A methods at Min-En Labs in North Vancouver, B. C. Results ranged from a low of less than 5 to 660 parts per billion (ppb). Threshold is estimated at 20 ppb and several anomalies are outlined.



7. The recent mapping and prospecting has indicated that the property is underlain by metasedimentary and metavolcanic complex of unknown age (phyllite, quartzite, limestone, schist greenstone) intruded by small dikes and plugs of Coast Range granodiorite. The property also straddles a northwest trending band of talc and serpentine similar to the Coquihalla Gold Belt ultramafic band.

8. Further investigation of the widespread geochemical anomaly around the old adit is strongly recommended. The work should be biased towards possibilities of replacement type mineralization.

Respectfully submitted,

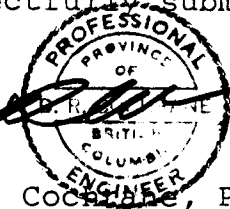
D. R. Cochrane, P. Eng.



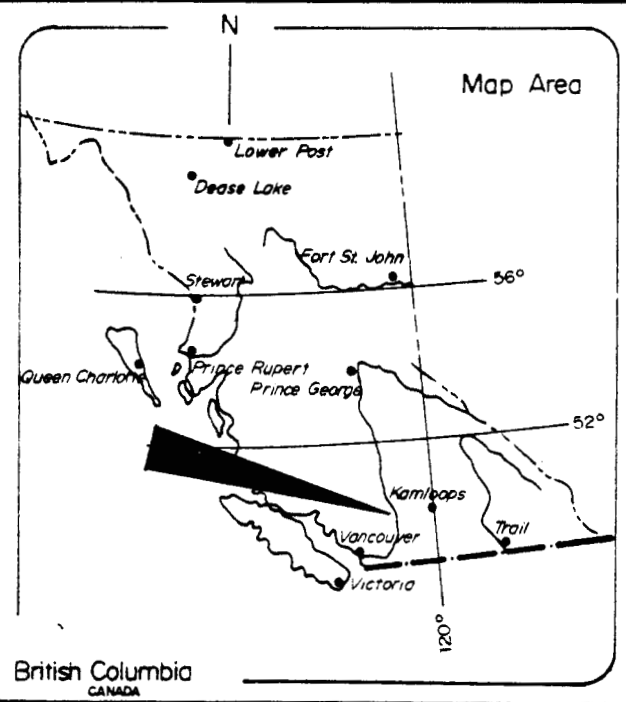
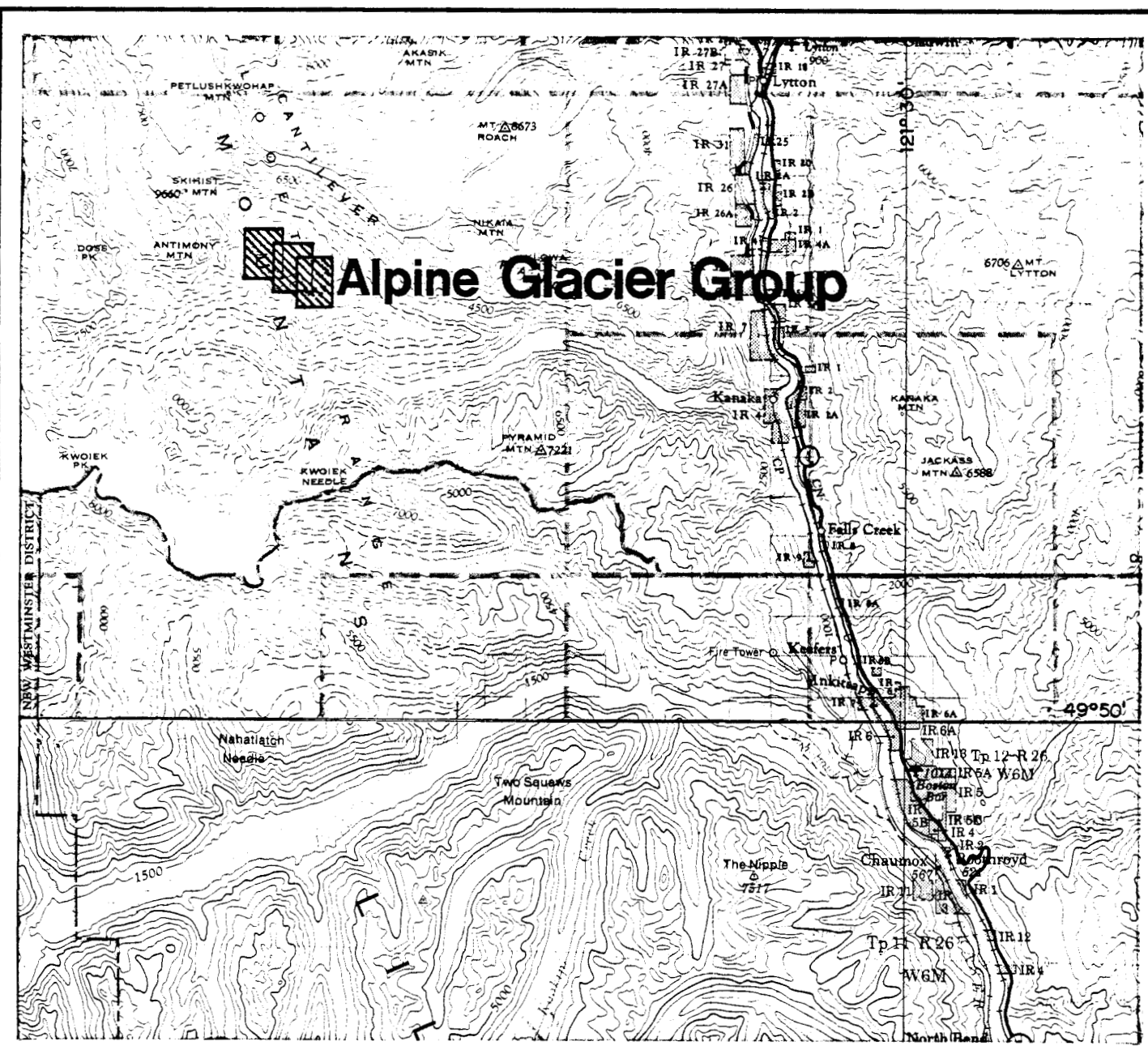

AQUARIUS RESOURCES LTD.

Alpine Glacier Group Kamloops M.D. 921/4

Figure 1
Location Map

Scale : 1 to 250,000 or 1 inch equals approx. 4 miles.

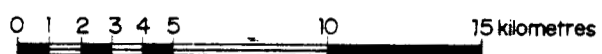

British Columbia
CANADA

P.K.C. SEPT. / 79.

Cochrane Consultants Limited
4622 Delta St. Delta B.C. V4K 2T6 604-922-1

LOCATION AND ACCESS

The Alpine Glacier Group of mineral claims lies in the Kwoiek Creek Area, a part of the Coast Mountain Range of high and rugged peaks. Kwoiek Creek runs eastwards along a U-shaped valley into the Fraser River just south of Lytton. The elevation of the valley floor is about 1000 metres and is glacially fed. The valley sides are extremely steep and rugged, rising to heights in excess of 2800 metres. Timberline is about 2000 metres, above which alpine meadows and extensive outcrops are found. Access to the area is by ferry at Lytton or North Bend, along a rough road to the mouth of Kwoiek Creek opposite Kanaka Bar, and by good logging road up the valley as far as Kokwasky Lake. The area is being actively logged by B.C. Forest Products Ltd., and there are several branch roads which provide good access to elevations of about 1500 metres. Access at higher elevations requires the services of a helicopter which may be chartered from Lytton, Hope or Aggisiz, B. C.

The N.T.S. map sheet for this area is 94I/4.



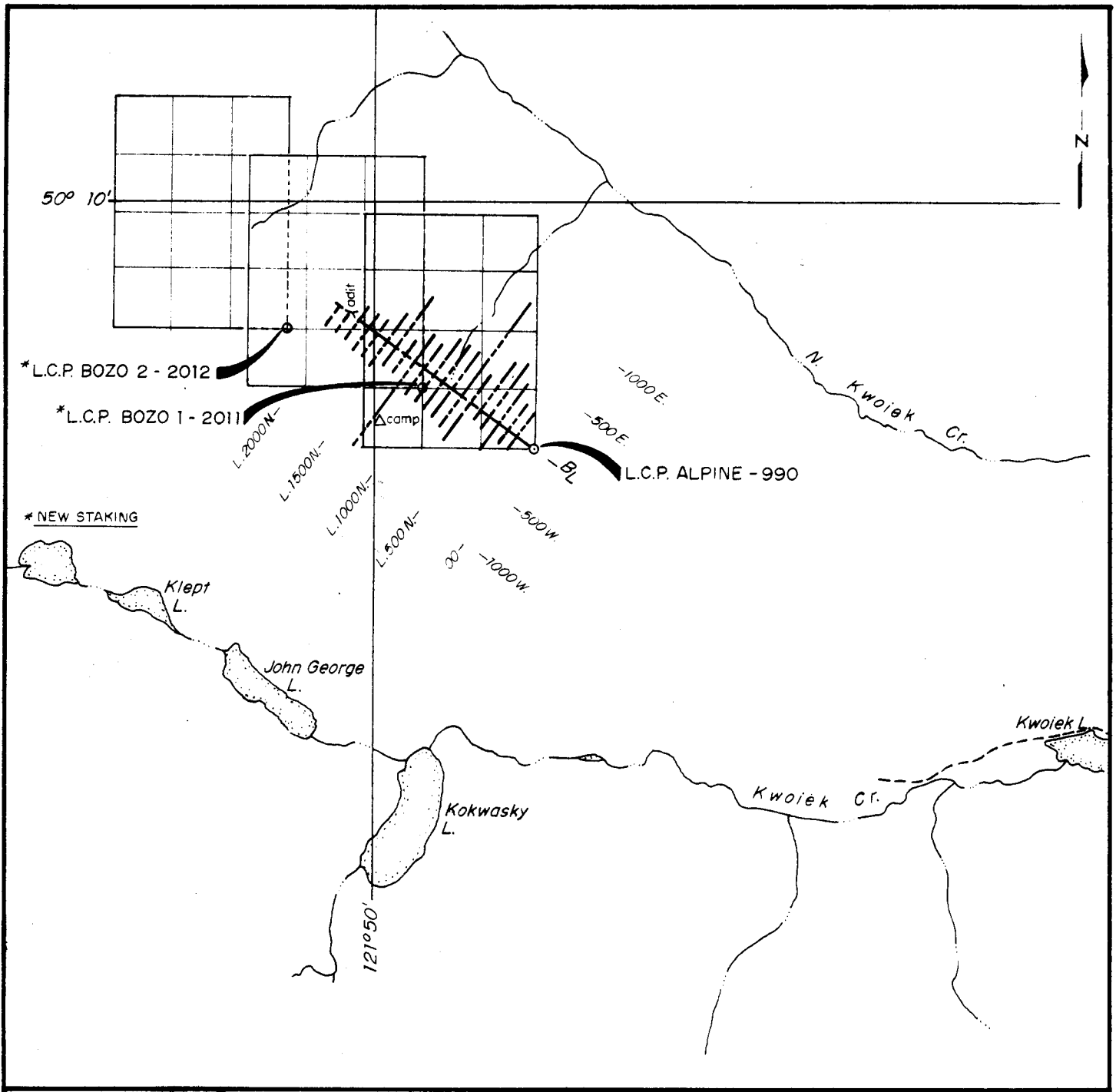

AQUARIUS RESOURCES LTD.

ALPINE GLACIER GROUP, Kwoiek Cr. Area
 Kamloops Mining Division N.T.S. 921/4

CLAIMS MAP

FIGURE 2

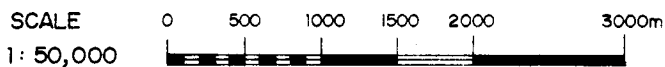

B.A.C. SEPTEMBER / 1979



Cochrane Consultants Limited
 4852 Delta St. Delta B.C. V4K 2T8 945-9221

CLAIMS INFORMATION

The Alpine claim is owned outright by Longbar Minerals Ltd., and the Bozo claims by Mr. W. Chase of Delta, B.C.

The following table lists pertinent claims information:

Claim Name	No. of Units	Record No.	*Expiry Date	**Expiry Date
Alpine	12	990	Aug. 18/79	Aug. 18/81
Bozo No. 1	12	2011	Aug. 16/79	Aug. 16/80
Bozo No. 2	12	2012	Aug. 16/79	Aug. 16/80
*	Before assessment work			
**	After assessment work credits applied for.			



GENERAL SETTING

The claims under consideration lie in a rugged section of the Coast Range Mountains of South Western British Columbia. The area lies just west of the Fraser Canyon and within an old sedimentary-volcanic basin almost completely enclosed by granitic (Coast Range) rocks.

The main focus of economic exploration attention is a northwest trending band of serpentine and talcose rocks similar to the Coquihalla Gold Belt to the south. The Alpine and Bozo claims straddle this major throughgoing belt and cover an old vein type gold showing adjacent to the talc and serpentine band.

Natural outcrops are rather sparse in the lower portions of the abandoned cirque, however there is good natural exposure along the rim.



WORK DONE

The 1979 work on the Alpine Glacier claim group included the establishment of 14 line kilometres of a ground control flag grid, with cross lines 100 metres apart and stations at 50 metre intervals, the collection of 273 upper B horizon soil samples and four rock samples along the grid, a tie in of physical features (and claim posts); and prospecting and geological reconnaissance over approximately two square kilometres.





RESULTS OBTAINED

Soil samples ranged in gold content from a low of less than 5 ppb to a high of 660 ppb. A frequency histogram of the values shows a bimodal distribution, and threshold is estimated at 20 ppb. (See accompanying map for geochemical results).

The prospecting and geological mapping by the field crew and Mr. H. Madeisky is presented in graphic form and accompanies this report.

Respectfully submitted,

D. R. Cochran, P. Eng.



APPENDIX I

Assessment Work Details

PROPERTY: Alpine and Bozo Claims
(Alpine, Bozo No. 1, Bozo No. 2 claims)
LOCATION: 19 km S.W. of Lytton, Southern B. C.
DIVISION: Kamloops Mining Division
N.T.S.: 92I/4
WORK DONE: 14 km ground control; collection of 273
soil samples and four rock samples and
analysis for gold; prospecting and geo-
logical mapping.

FIELD CREW AND DATES:

Mr. W. Chase July 24 to Aug. 5, 1979.
Mr. D. Ivens " "
Mr. H. Madeisky August 2,3,4, 1979.
Mr. J. Stewart August 4, 1979.

OFFICE WORK:

Report preparation: H.E. Madeisky 1/2 day
D. R. Cochrane 1/2 day
Typist, Cochrane Consultants Ltd. 5 hrs.
Draftsperson, Cochrane Consultants Ltd. 37 hrs.

7455

Cont'd.....



COST STATEMENT

PERSONNEL:

J. A. Stewart, supervisor, 1 day	
at \$200/day	\$ 200.00
D. R. Cochrane, P. Eng. 1/2 day	
at \$200/day	100.00
H.E. Madeisky, geologist, 3 1/2 days	
at \$120/day	420.00
W. F. Chase, prospector, 10 days	
at \$100/day	1,000.00
D. Ivens, helper, 10 days	
at \$75/day	750.00
Draftsperson 37 hours	
at \$13.50/hr	449.50
Typist 5 hours	
at \$10/hr	50.00

Vehicle Expenses

Helicopter time, 4 hours	
at \$150/hr	600.00
Truck, 2 days at \$35/day including fuel	70.00

Food Expense

21 man days at \$20/man/day	420.00
-----------------------------------	--------

* Report Preparation, (Diazo prints) 5.50

* Geochemical Analysis

273 soil samples at \$4.50/sample	1,228.50
---	----------

Total \$ 5,293.50

* Final report reproduction, binding and collating, and rock assays not included.



APPENDIX II

CERTIFICATE

I, Hans Eberhard Madeisky of the city of Vancouver, B. C., do hereby certify that:

1. I am an exploration geologist employed by Aquarius Resources Ltd., with an office at 4882 Delta Street, Delta, B. C.
2. I have studied geology and economics at El Camino College, Torrance, California (1965-67), U.S.C. (1966-67), Vancouver City College (1972), University of British Columbia, (1972-74, 1977-78).
3. I have practiced my profession since 1968 in British Columbia, Yukon, North West Territories, and Greece in the employ of companies like, Newmont Mines of Canada Ltd., Canadian Superior Exploration Ltd., and Dennison Mines Ltd.
4. I have no interest, direct or indirect in the securities of Longbar Minerals Ltd., nor Aquarius Resources Ltd., nor do I expect to acquire any such interest.

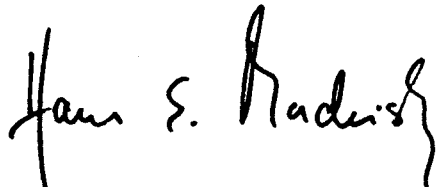

Hans Eberhard Madeisky

August 27, 1979,

Delta, B. C.



APPENDIX II

CERTIFICATE

I, Donald Robert Cochrane, of the Municipality of Delta, British Columbia, do hereby certify that:

1. I am a consulting geological engineer with an office at 4882 Delta Street, Delta, B. C.
2. I am a graduate of the University of Toronto (1962) with a degree in Applied Geology (B.A.Sc.) and a graduate of Queen's University (1964) with a degree in Economic Geology (M.Sc., Eng.).
3. I have practiced my profession continuously since graduation while being employed by such companies as Noranda Exploration Co. Ltd., Quebec Cartier Mines, and Meridian Explorations Syndicate. I have been in private independant practice since 1969.
4. I have no interest, either direct or indirect in the properties or securities of Longbar Minerals Limited, nor Aquarius Resources Ltd., nor do I expect to acquire any such interest.
5. I am a member in good standing of the Association of Professional Engineers (A.P.E.) of the Province of British Columbia, and also a member of the A.P.E. in the Province of Ontario, Saskatchewan, Alberta, and the Yukon Territories.

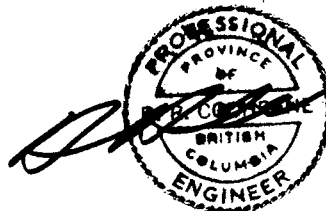

D. R. Cochrane, P. Eng.,
August 27, 1979,
Delta, B. C.



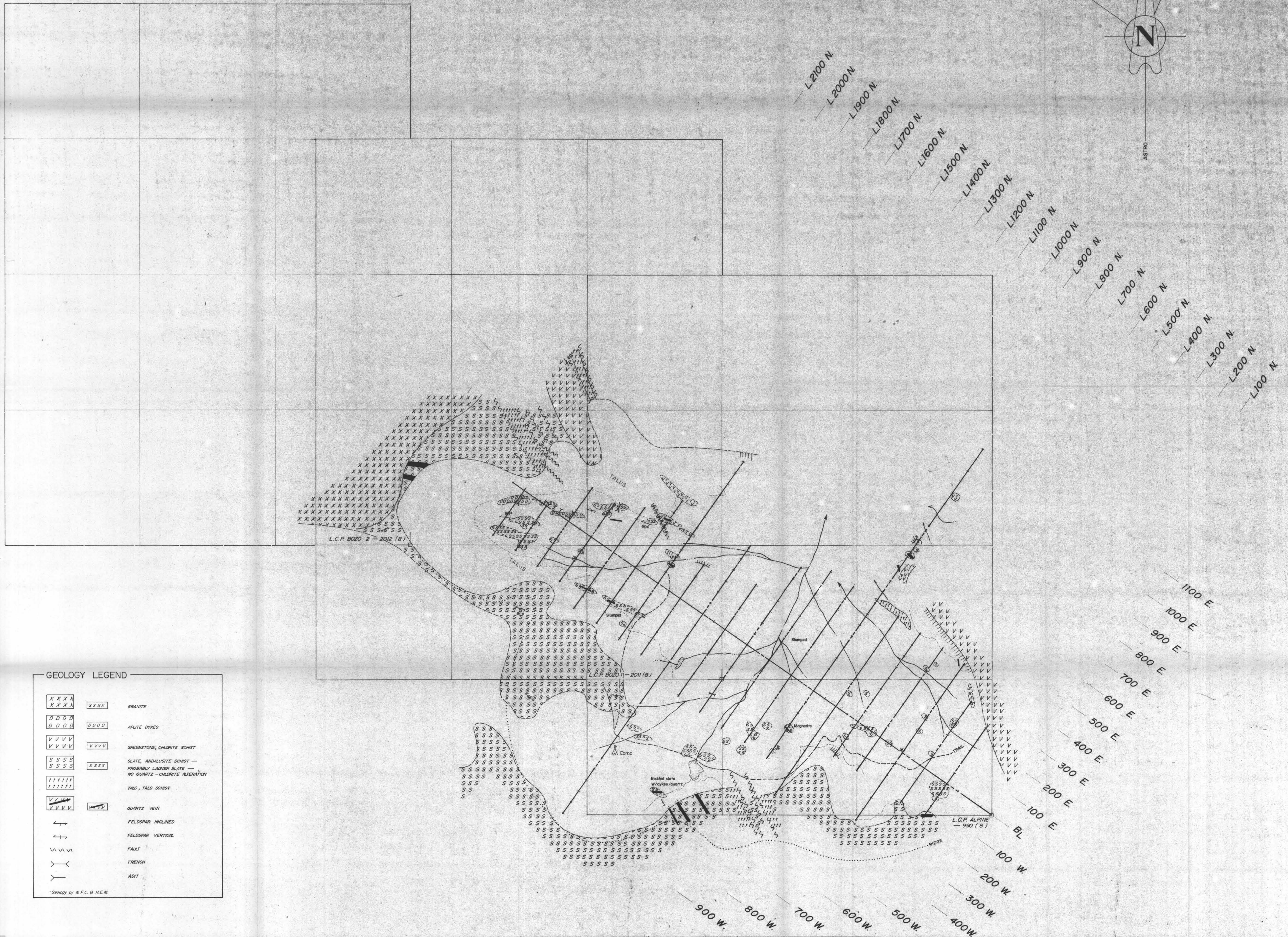

GEOLOGY LEGEND

XXXX XXXX	XXXX	GRANITE
DDDD DDDD	DDDD	APLITE DYKES
VVVV VVVV	VVVV	GREENSTONE, CHLORITE SCHIST
SSSS SSSS	SSSS	SLATE, ANDALUSITE SCHIST — PROBABLY LADNER SLATE — NO QUARTZ — CHLORITE ALTERATION
TTTTT TTTTT	TTTTT	TALC, TALC SCHIST
VVVV	VVVV	QUARTZ VEIN
↗	↗	FELDSPAR INCLINED
↕	↕	FELDSPAR VERTICAL
~ ~ ~	~ ~ ~	FALZ
— —	— —	TRENCH
—	—	ADIT

*Geology by W.F.C. & H.E.M.

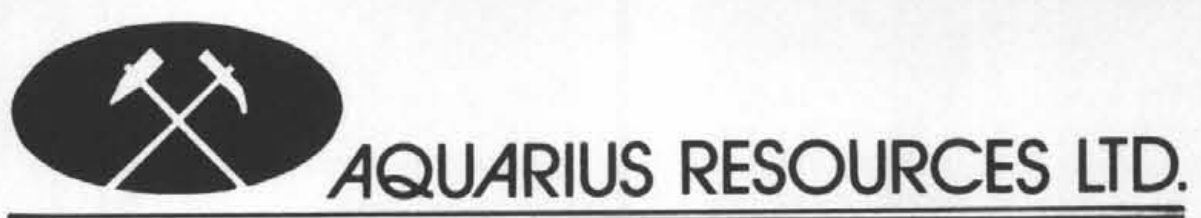

AQUARIUS RESOURCES LTD.
Alpine Glacier Group, Kwoiek Cr. Area, B.C.
Kamloops Mining Division N.T.S. 921/4

Scale 1:5,000
0 50 100 200 300 400 500 metres
Base Map traced from field map & notes by W.F.C. July, 1979.

GEOLOGY **FIG. 3**
To accompany a report by D.R. COCHRANE, P. Eng. on the Alpine Glacier Group dated August 27, 1979.



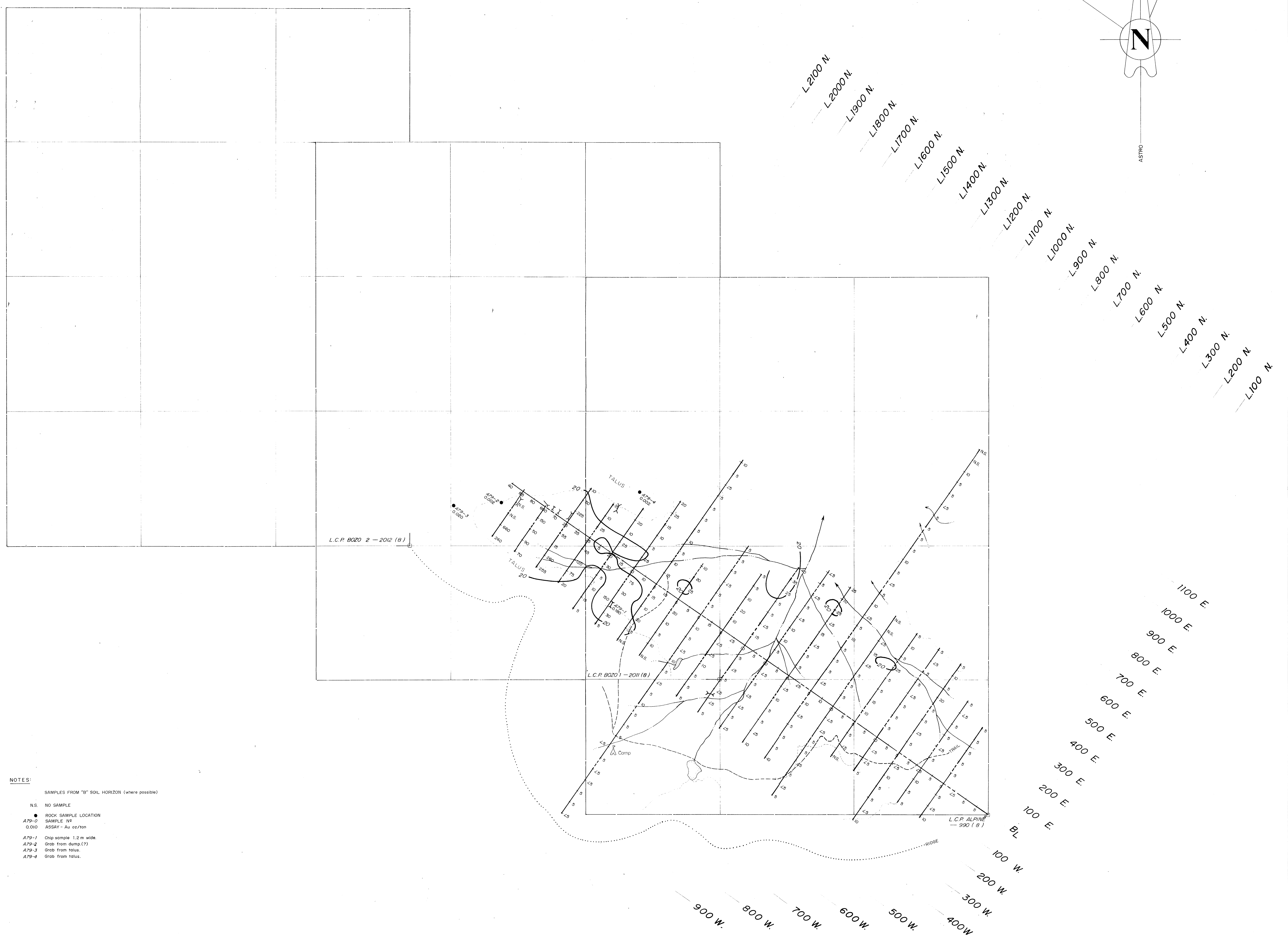
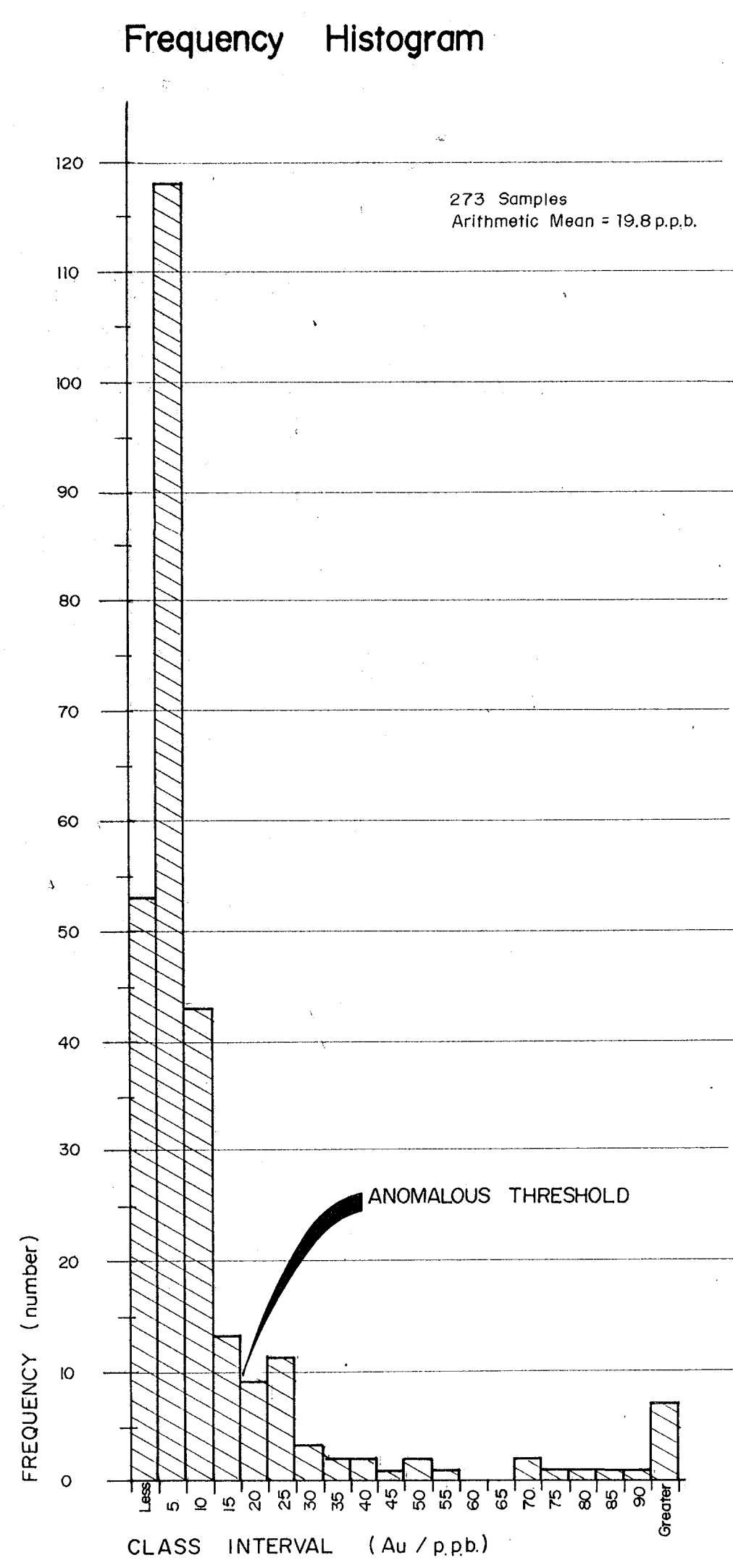

AQUARIUS RESOURCES LTD.
 Alpine Glacier Group, Kwoiek Cr. Area, B.C.
 Kamloops Mining Division N.T.S. 92 I/4

Scale 1:5,000
 Base map traced from field map B notes by W.F.C., July, 1979.

GEOCHEMICAL PLAN FIG. 4
 (Au / p.p.b.)

To accompany a report by D.R. COCHRANE, P. Eng. on the Alpine Glacier Group dated August 27, 1979.

7455

Cochrane Consultants Limited
 4822 Delta St., Delta, B.C. V4K 2T8 945-9231

P.K.C. August, 1979. Project No. 2016.

- NOTES:**
- SAMPLES FROM "0" SDIL HORIZON (where possible)
 - N.S. NO SAMPLE
 - ROCK SAMPLE LOCATION
 - 479-0 SAMPLE NO
 - 0.000 25500 = Au 22/10m
 - 479-1 Chip sample 1.2 m wide
 - 479-2 Grab from dump (P)
 - 479-3 Grab from talus
 - 479-4 Grab from talus