

PROSPECTING REPORT

on the

MISTAKE NO. 1 and SHEAR NO. 1

MINERAL CLAIMS

ATLIN MINING DIVISION

for

R.H. SERAPHIM, P. ENG.

#316, 470 GRANVILLE STREET

VANCOUVER, B.C.

WORK COMPLETED AUGUST 10/78 - AUGUST 29/79

N.T.S. 104N/11W

LAT.  $59^{\circ}45'$  LONG.  $133^{\circ}18'$

by

T.E. LISLE, P. ENG.

SEPT. 9, 1979

7480

CONTENTS

SUMMARY AND CONCLUSIONS	Page 1
INTRODUCTION	Page 2
LOCATION & ACCESS	Page 3
CLAIMS	Page 4
HISTORY	Page 4
WORK PROGRAM	Page 5
GEOLOGY	Page 6 & 7

MAPS

LOCATION MAP  
CLAIM MAP  
PROSPECTING MAP

APPENDIX

EXPENDITURES  
CERTIFICATE

MISTAKE NO. 1 MINERAL CLAIM

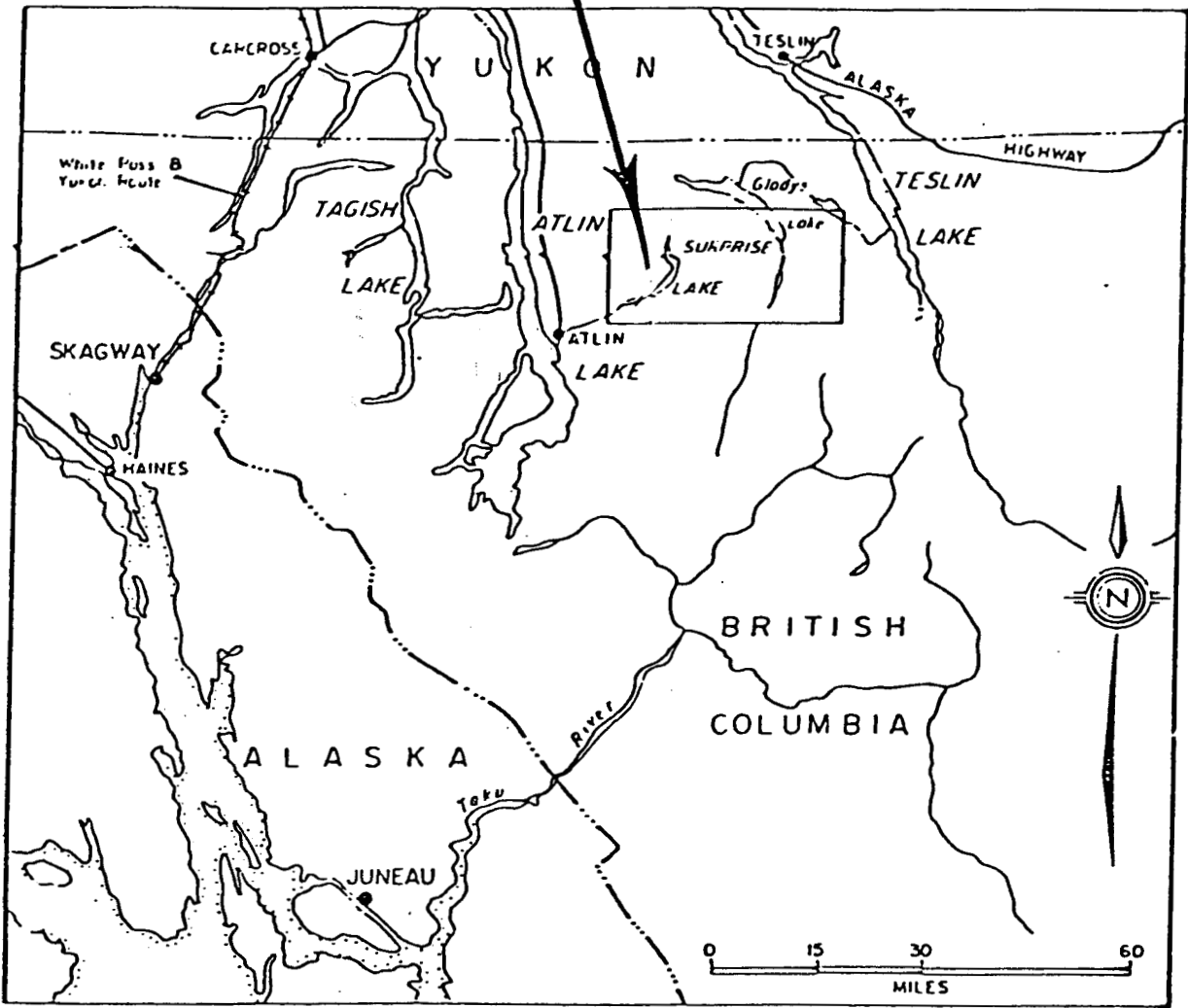

R.H. SERAPHIM ENGINEERING LTD.

LOCATION MAP , MISTAKE NO. 1

ATLIN MINING DIVISION

-104 N/11W

Fig. 1.

## SUMMARY AND CONCLUSIONS

The Mistake No. 1 and Shear No. 1 mineral claims are located over the upper western tributaries of Cracker Creek, in the Atlin Mining Division. Access is by road or helicopter from Atlin.

The claims are underlain by Alaskite of the Cretaceous? Surprise Lake batholith. The Alaskite is locally overlain by pendants and screens of older Paleozoic rocks.

Near the boundary of the two claims, radioactive float has been located. The radioactivity is associated with quartz-sulphide veins in a limonitic zone of northeast shearing and fracturing. Much of the zone is obscured by talus, and the thickness and density of the veins is unknown.

Radioactivity is believed to be from Zuenerite, which is associated with arsenopyrite. Minor amounts of galena, sphalerite?, chalcopyrite, pyrite and fluorite are also present. Some of the specimens assayed also carry gold and silver.

The geology of the zone should be mapped and examined by radiometric survey prior to trenching. Further rock geochemistry may aid in geologic interpretation.

## INTRODUCTION

The Mistake No. 1 and Shear No. mineral claims were staked after the release of the U.R.P. geochemical data in 1978.

The claims were prospected for Uranium in August and September 1978 and briefly in August 1979. This work resulted in the discovery of radioactive float near the common boundary of the Mistake and Shear mineral claims.

This report describes the results of the prospecting completed on the ground to date. Further work will be necessary to more fully evaluate the mineral potential of the claims.

LOCATION AND ACCESS

The property is approximately 32 Kilometers northeast of Atlin in the Atlin Mining Division.

Access is by gravel road via Pine and Ruby Creeks. A poor 4-wheel drive road along Cracker Creek ends about 0.8 Kilometers southeast of the Mistake No. 1 claim. In dry weather, this road is passable by truck, however, most of the year, access by this means is restricted.

Elevations in the claim area range from 1200 to 1800 meters above sea level.

CLAIMS

The property is comprised of the following claims in the Atlin Mining Division.

<u>Name</u>	<u>Record No.</u>	<u>Units</u>	<u>Recording Date</u>
Mistake No. 1	482(8)	16	August 14/78
Shear No. 1	494(9)	3	September 5/78

HISTORY

The Cracker Creek area was investigated for Uranium in the 1954-1955 period. This work resulted in the discovery of the Purple Rose showing south of the Mistake claim.

No evidence of previous work has been found in the area of the radioactive occurrence on the Mistake and Shear claim area.

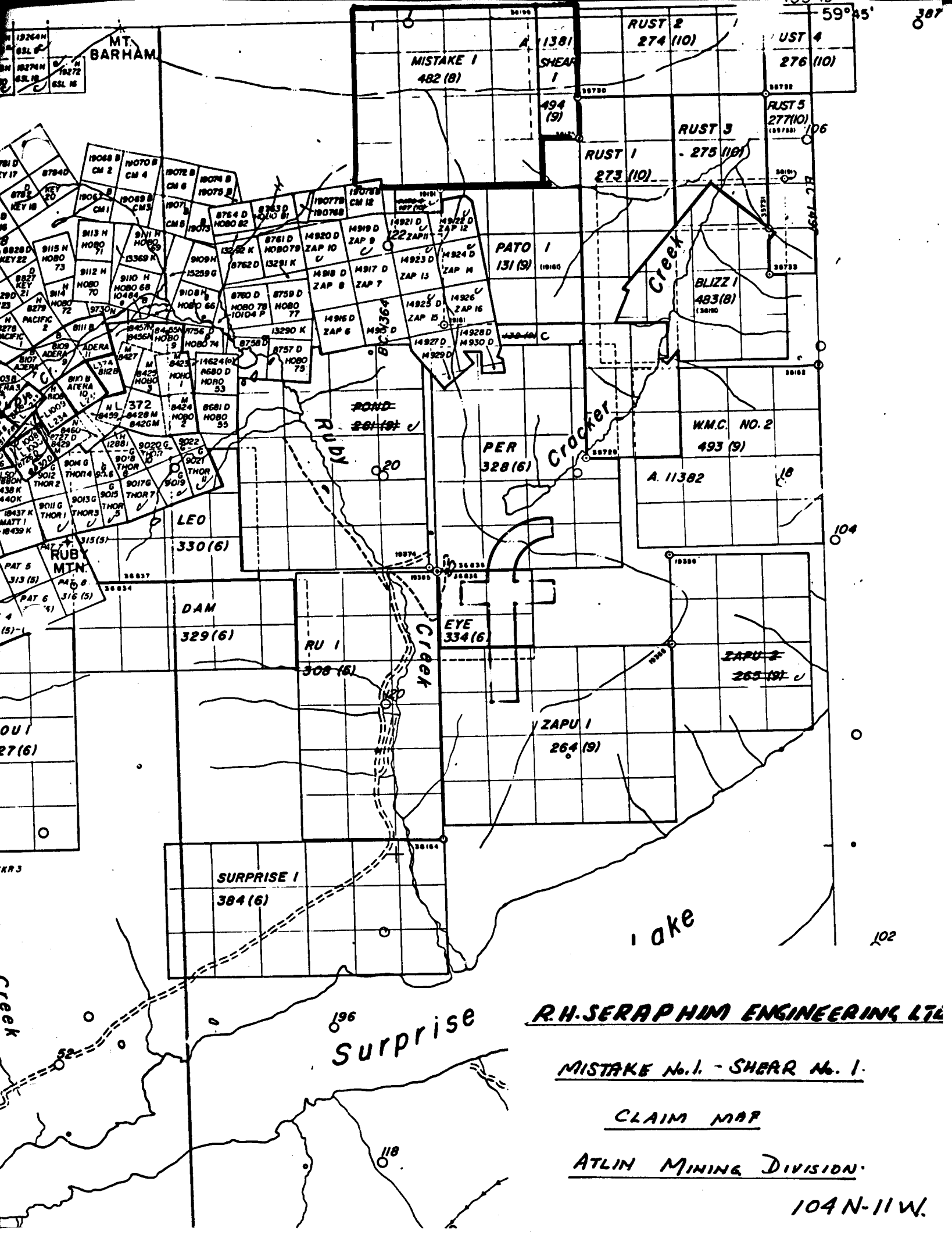

**R.H. SERAPHIM ENGINEERING LTD.**

MISTAKE No. 1. - SHEAR No. 1.

CLAIM MAP

ATLIN MINING DIVISION.

104 N-11 W.



#### WORK PROGRAM

Silt samples were routinely collected from the claim area and from the area around the claims where they were deemed to be of importance. Seven rock chips were also collected from the area of the quartz-sulphide veins near the common boundary of the Mistake and Shear claims.

All samples were packaged and shipped to Chemex Laboratory in North Vancouver, where they were analyzed fluorometrically for Uranium. Rocks were also analyzed for Au. and Ag.

Rock outcrops and float were checked with either G.1 S.4 Spectrometers or geiger counters.

## GEOLOGY

The Mistake and Shear mineral claims are located along the western margins of the Surprise Lake Alaskite batholith. This area is marked by irregular contacts and by pendants of older Paleozoic rocks including serpentine of the Atlin intrusions, and volcanic and sedimentary rocks of the Cache Creek group.

The Alaskite varies from coarse grained and porphyritic, to fine grained varieties similar to the sparse porphyry mapped to the southwest (Adanac area).

Near the northeast section of the Mistake claim, between masses of the older Paleozoic rocks, the Alaskite is sheared, (northeast) well fractured and limonitic. Within this zone, veins and lenses? of quartz with arsenopyrite, minor galena, sphalerite, pyrite, chalcopyrite, manganese and fluorite are present. Much of the zone is obscured by talus.

Radioactivity is locally associated with the rusty quartz-sulphide vein fragments. The mineralization is believed to be mainly Zeunerite, but is not readily identifiable in rock specimens.

To the southwest, the zone is obscured by talus and overburden in the valley bottom. On the upper slopes the vein fragments are scattered over a wide section, and further exploration will be required to determine the width and density of the veins.

GEOLOGY cont'd

Seven rock specimens were collected and assayed. Results are:

<u>Sample No.</u>		<u>Ag. (PPM)</u>	<u>Au. (PPB)</u>	<u>U (PPM)</u>
R.E. 28	Qtz. vein-sulphide	+20	420	+400
R.E. 29	Vein quartz	+20	20	3
R.E. 30	Vuggy limonitic Qtz.	+20	-10	-0.5
R.E. 31	Vein-sulphide	+20	130	+400
C.P. + 170m S.	Sparse porphyry			0.004% U308
C.P. + 270m S.	Vein sulphide			0.002% "
C.P. +340m S.	Sparse porphyry			0.002% "

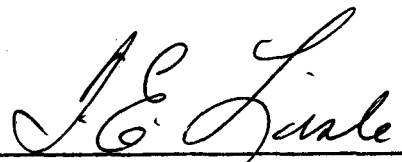

T.E. LISLE P. ENG.

1100 DEARBORN AVENUE  
NORTH VANCOUVER B.C. CANADA

CLIENT : R.H. SERAFIELD

SAMPLES RECEIVED : 07-SEP  
ANALYSIS COMPLETED : 12-SEP  
NOVATRACK CERT. NO. : B90070.  
CHEMEX CERT. NO. : ASSAY 681  
INVOICE NO. :

ATTN. :

SAMPLE ID	U308 PERCENT
SHEAR 170 M SOUTH	0.004
SHEAR 270 M SOUTH	0.002
SHEAR 340 M SOUTH	0.002

CERTIFIED BY .....  .....

ANALYSIS PERFORMED BY NOVATRACK ANALYSTS LTD.  
A SUBSIDIARY COMPANY OF CHEMEX LABS LTD.  
SPECIALIZING IN NEUTRON ACTIVATION ANALYSIS

APPENDIX NO. 1

MISTAKE NO. 1 MINERAL CLAIM

WAGES

E. Scholtes, Prospector - Aug. 10-15/78		
	6 @ 90.00	\$ 540.00
C. Kowall, Geologist - Sept. 9-12/78		
	4 @ 100.00	400.00
T. Lisle, Geologist Supervisor		
	Aug. 13/78 & Aug. 29/79 2 @ 150.00	300.00

CAMP COSTS - 12 days x 20.00 240.00

HELICOPTER SUPPORT

August 10/78 G3B1 - 1.2 x 207.00	248.40
August 16/78 G3B1	93.15
Sept. 9/78 Hughes 500 .5 x 228.00	114.00

GEOCHEMICAL SAMPLES

16 silts @ 3.20	51.20
4 rocks @ 9.50	38.00
3 rocks @ 4.50	13.50

INSTRUMENT RENTAL 75.00

REPORT AND OVERHEAD 200.00

\$ 2,313.25

*J. E. Lisle*

CERTIFICATE OF QUALIFICATION

I, T.E. Lisle of 145 West Rockland Road,  
North Vancouver, B.C. declare that:

1. The work described in this report was carried out by me and by the personnel listed in Appendix 2 under my supervision.
2. I am a graduate of the University of British Columbia with a B.Sc. 1964.
3. I have worked intermittently in exploration geology for several years prior to 1964, and have worked continuously in the same field since that date.
4. I am a member of the following organizations:
  - (a) Canadian Institute of Mining & Metallurgy
  - (b) Geological Association of Canada
  - (c) Association of Professional Engineers of B.C.

  
T.E. Lisle, P.Eng.

7480

Alaskite outcrops this area.

x 21 (location)?

7480

Sample location are approximate

	Ag (ppm)	Au (ppb)	U (ppm)
RE 28	720	420	7400
RE 29	720	20	3
RE 30	720	410	405
RE 31	720	130	7400
1705			0.002% U <sub>3</sub> O <sub>8</sub>
2705			0.002% "
3405			0.002% "

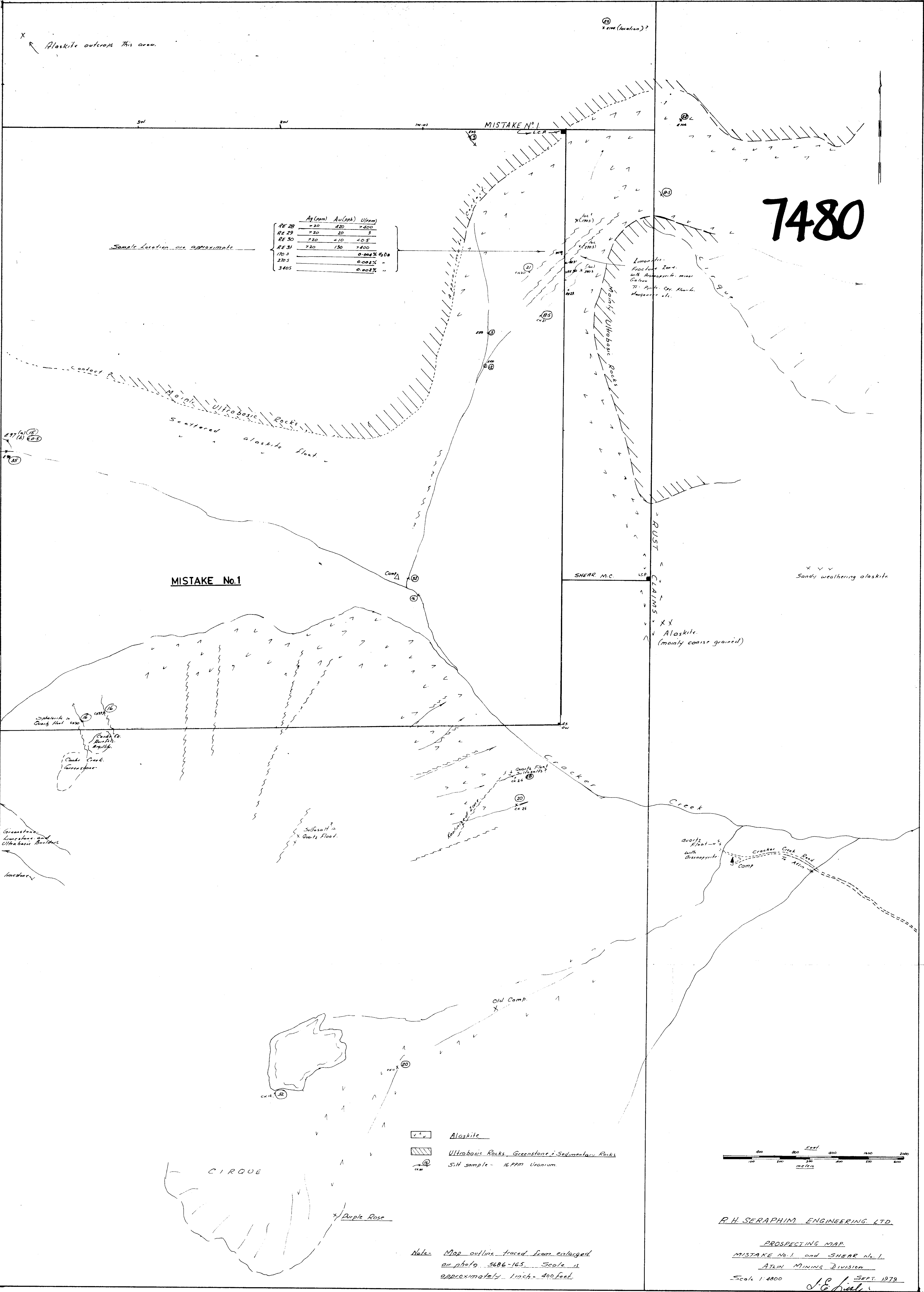

- Alaskite
- Ultrabasic Rocks, Greenstone & Sedimentary Rocks
- S.H. sample - 16 PPM Uranium

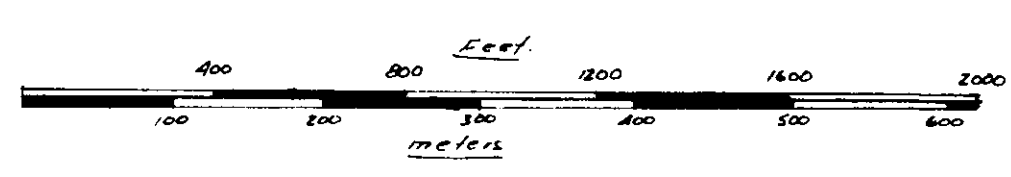

Note: Map outline traced from enlarged air photo 5686-165. Scale is approximately 1 inch = 400 feet.

R.H. SERAPHIM ENGINEERING LTD.  
 PROSPECTING MAP  
 MISTAKE No. 1 and SHEAR No. 1  
 ATLIN MINING DIVISION  
 Scale 1:4800  
 L.P. Hild  
 SEPT. 1979