

GROUND MAGNETOMETER SURVEY
KIT 2-7, 9-11 CLAIMS
SKEENA MINING DIVISION

NTS 104 B/1W
56⁰ 13.5 N
130⁰ 22' W

Owned and Operated by:

Esso Resources Canada Limited
314-1281 W. Georgia St.
Vancouver, B.C.

by

J.M. MARR
September 1979

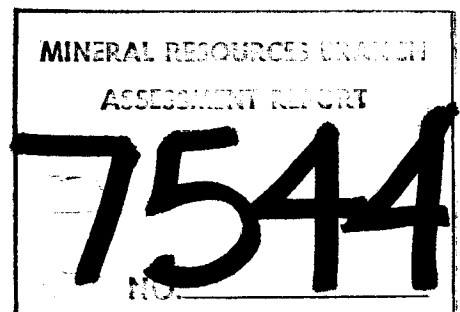

TABLE OF CONTENTS

	<u>Page No.</u>
INTRODUCTION	1
TECHNICAL DATA	4
RESULTS	4
ITEMIZED COST STATEMENT	5
STATEMENT OF QUALIFICATIONS	6

LIST OF MAPS

Map 1 (Page 2)	1:250,000	Location Map
Map 2 (Page 3)	1:20,000	Grid & Claim Location Map
Map 3 (In Pocket)	1:2000	Magnetometer Survey

INTRODUCTION

This ground magnetic survey is submitted in support of an application by this company for one year's assessment credits on the KIT 2-7, 9-11 claims. These claims are located in the Skeena Mining Division (see attached location map) about 2 km west of the Granduc Mine. The claims are owned by Esso Resources Canada Limited and this work was done entirely by Esso personnel.

Map 2 (page 3) shows the grid established on the claims in relation both to the physiography of the area and the location of the claims. The grid, totalling 12 km overall, has a baseline oriented north-south, the starting point (0+00) being located 300 m due north of the survey point at the old camp airstrip. The grid generally covers the eastern edge of the North Leduc Glacier, a very difficult area. Progress was slow over this terrain, composed partly of crevasse-covered ice and partly of steep moraine walls flanking the glacier.

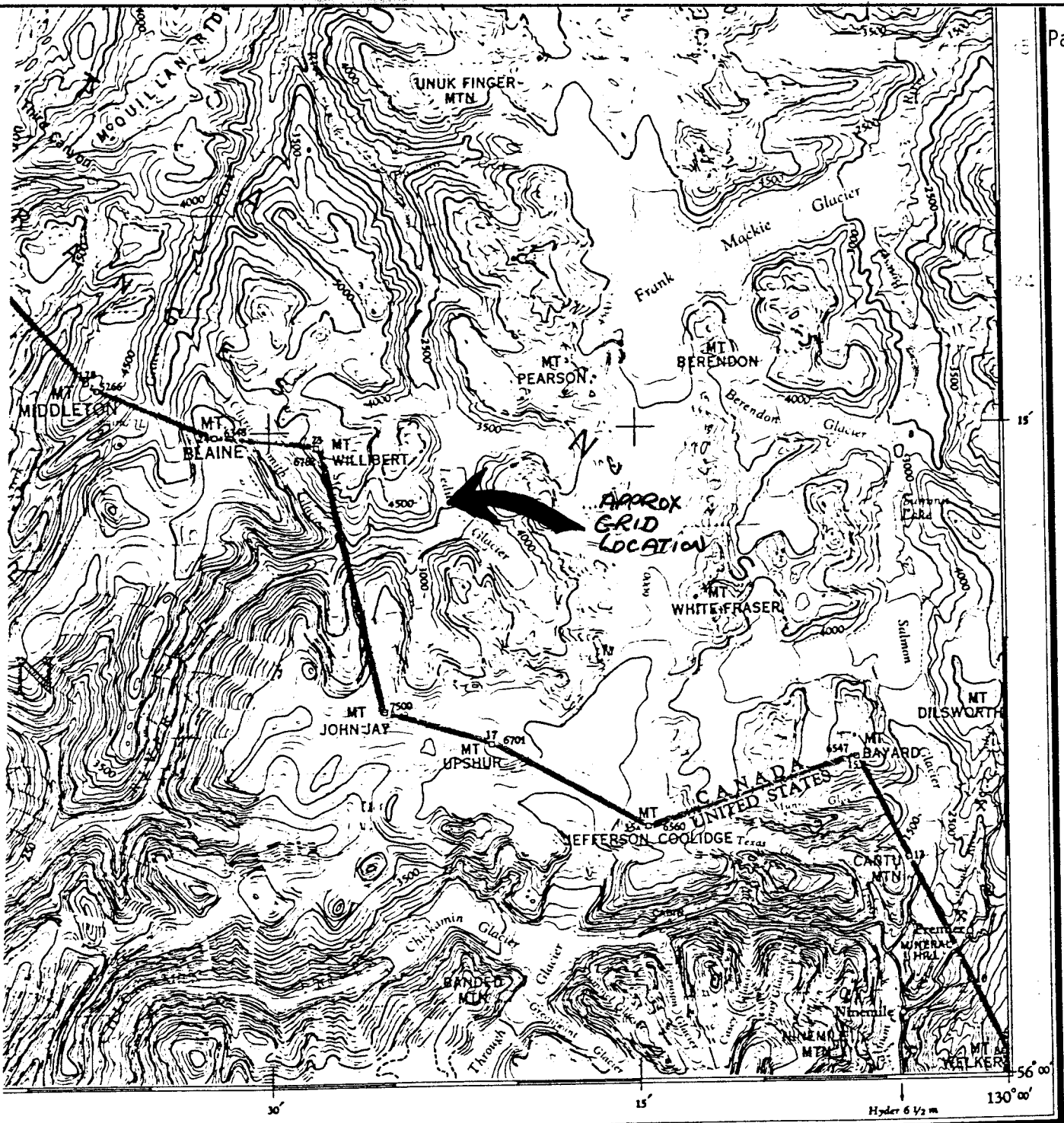

Contour Interval 500 Feet in Canada. Contour Interval in U.S.A. 200 and 250 Feet.

MAP 1.

LOCATION OF MAGNETIC GRID
AND KIT 2-7, 9-11 CLAIMS IN
REGIONAL CONTEXT.

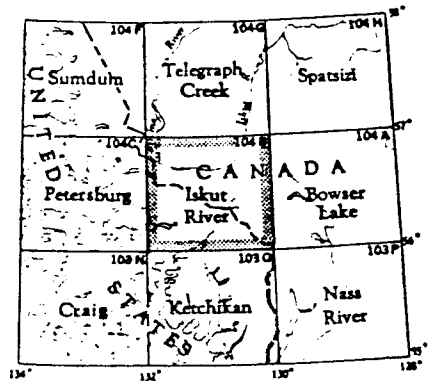

NOTE: On the above index the sheets published are shown crossed green

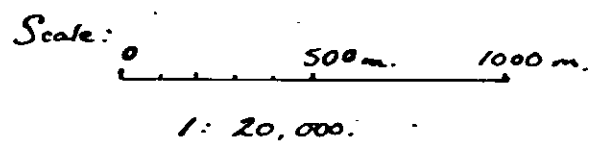
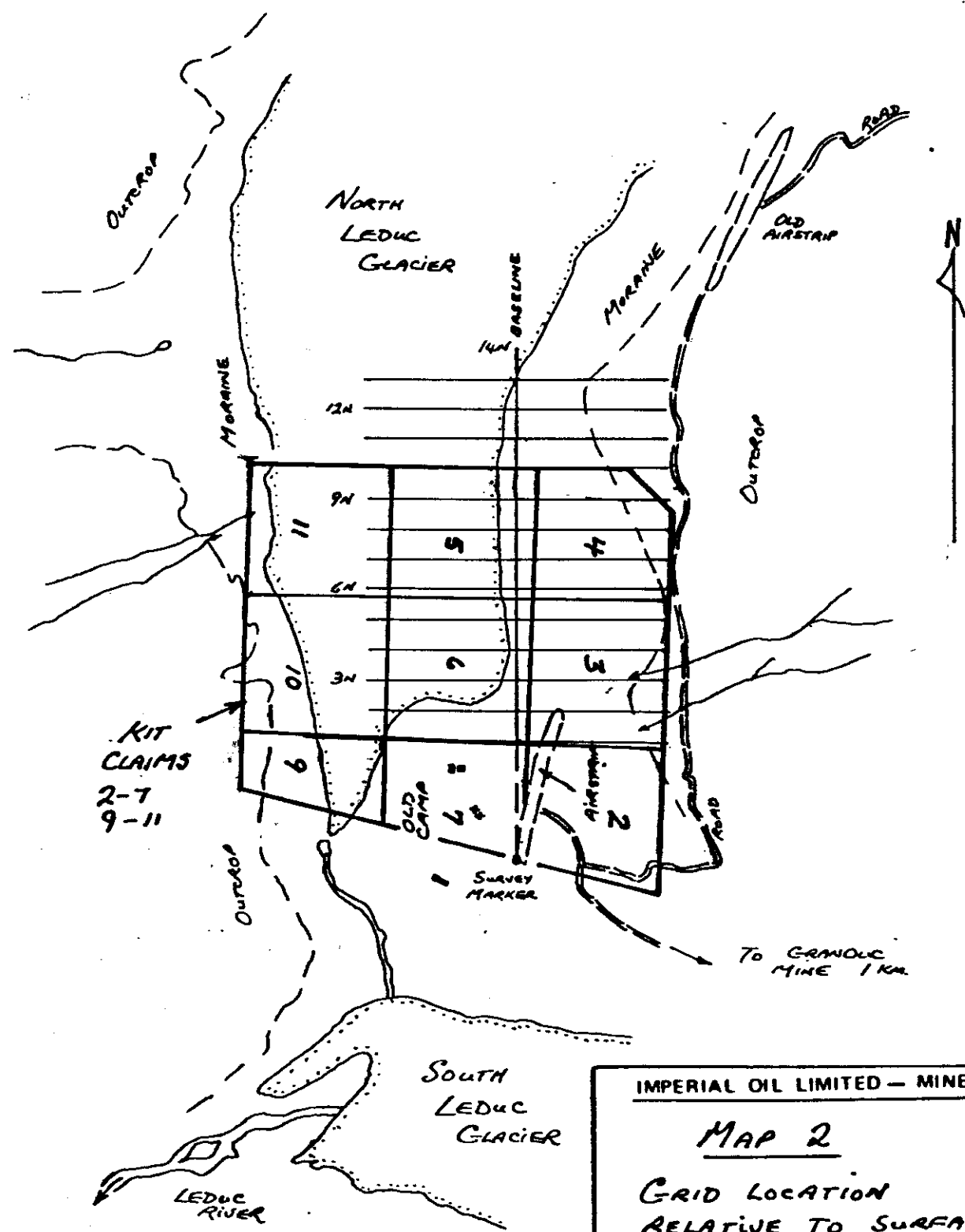

IMPERIAL OIL LIMITED - MINERALS

MAP 2

GRID LOCATION
RELATIVE TO SURFACE
FEATURES AND KIT
CLAIMS.

JAM 9/79

TECHNICAL DATA

All the work herein described was done by C. Hrkac and G. Kary, both students at the University of British Columbia, under my supervision. Both had done this type of survey previously and were thoroughly familiar with the instrument.

The grid was first established in the area using pickets and flagging then read at 25 m intervals with the M 700 Fluxgate magnetometer. The instrument was calibrated in the field, therefore the values in gammas shown in profile form on Map 3 (in pocket) are relative values only of the vertical component of the earth's magnetic field. Each reading has been corrected for diurnal variation of the earth's field. This was done by noting the time of each reading and by repeating several stations on the baseline during the day.

RESULTS

As shown on Map 3, an anomaly was obtained near the glacier/talus contact, trending approximately north-south for something in the order of 700 m.

The anomaly tends to be broad and on several lines is composed of several individual highs.

Preliminary examination of the area indicates this is a bedrock anomaly and not due to detrital concentrations of magnetite. Scattered outcrops on the talus slope near the centre of the anomaly were found to bear heavily disseminated to more massive podiform magnetite concentrations. These occurred in strongly metamorphosed actinolitic dark green andesites. No further work has yet been done on the tenor or extent of the mineralization, or the regional correlation of the host rocks.

ITEMIZED COST STATEMENT

Wages

C. Hrkac - 6 days @ \$45/day	\$ 270.00
G. Kary - 6 days @ \$45/day	270.00

Magnetometer Rental

1 week @ \$10/day	70.00
-------------------	-------

Camp Costs

12 man days @ \$25/day	300.00
------------------------	--------

Transportation

One half of 5 days x 45 min. round trip x \$300/hr.	562.50
--	--------

(Note: access was daily to and from
Stewart, helicopter carrying two
additional men.)

TOTAL	<u>\$1,472.50</u>
-------	-------------------



STATEMENT OF QUALIFICATIONS

I, John M. Marr, of North Vancouver, B.C.
hereby certify the following qualifications:

- (a) I obtained a B.Sc. (Hons.) degree in Geology (1968) from St. Andrews University, Fife, Scotland.
- (b) I obtained an M.Sc. degree in Geology (1970) from the University of Manitoba, Winnipeg, Manitoba
- (c) I have been practising my profession as a geologist in Canada since that time.

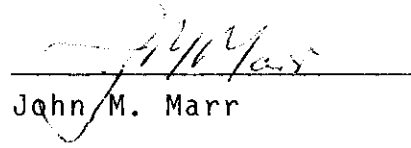

John M. Marr

