

179-#347-#7562

REPORT ON DIAMOND DRILLING  
SUBMITTED FOR ASSESSMENT WORK  
ON THE LAKE GROUP OF MINERAL CLAIMS

Nanaimo, M.D.  
Utah Mines Ltd.

J. Lamb, P.Eng  
Sept. 1979.

CO-ORDINATES

50° 37' N  
127° 28' 20" W

7562

UTAH MINES LTD.

ISLAND COPPER MINE  
P.O. BOX 370  
PORT HARDY, B.C. V0N 2P0  
TELEPHONE (604) 949-6326

September 7th, 1979.

Ministry of Energy, Mines & Petroleum Resources,  
Douglas Building,  
Victoria, B.C.  
V8V 1X4.

Dear Sirs,

Re: Assessment Report - Lake Group of Mineral Claims

The above report, in duplicate, is being submitted in compliance with regulations governing assessment work under the Mineral Act, revised to January 1st, 1978.

Credit is requested for diamond drilling performed between July 24th and August 12th, 1979.

Yours truly,



John Lamb, P.Eng.,  
Project Geologist.

JL:ebh

encl:

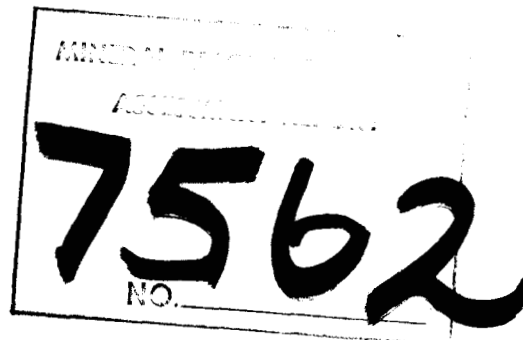

TABLE OF CONTENTS

	<u>Page</u>
Objective	1
Work Performed	2
Statement of Costs	4
Results and Conclusion	6

APPENDICES

- I. Drilling Proposal for Island Copper Contract
- II. Acceptance Letter for Drilling Proposal
- III. Diamond Drill Logs (in rear envelope)

MAPS

- Index Map - Sheet 92<sup>L</sup>/11 Scale 1:50000
- Claim Map - Scale 1: 12000

REPORT ON DIAMOND DRILLING ON THE  
LAKE GROUP OF MINERAL CLAIMS

Lat.  $50^{\circ} 37'$  N Long.  $127^{\circ} 28' 20''$  W.

Objective:

The hole was drilled to determine:

- a) the stratigraphic section through the Parson Bay and Quatsino formations, down to the underlying Karmutsen formation.
- b) the presence of metallic mineralization in these rocks, especially on the contact between the Quatsino and the Karmutsen.

# UTAH MINES LTD.

ISLAND COPPER MINE  
P.O. BOX 370  
PORT HARDY, B.C. V0N 2P0  
TELEPHONE (604) 949-6326

## WORK PERFORMED:

- 1) One hole was diamond drilled between July 23rd and August 12th, 1979.

The hole is at the end of a prepared tractor trail, off an old logging road about 6000 feet at N 10 E from the centre of the Island Copper pit. It is on the Lake M.C. (in unit IN, IW), just outside the boundary of L 2145, which demises Mineral Lease M-34. It is collared about 850 feet at N 68 W from the legal corner post of the Lake mineral claim.

- 2) Particulars of the hole are:

<u>Number</u>	<u>Inclination</u>	<u>Length (feet)</u>	<u>Collar Elevation</u>	<u>Co-ordinates</u>
M-6	-90°	1695	440 Ft.	N.11760
		516.65 M	134.1 M.	E 26625

The co-ordinate position of the collar belongs to the co-ordinate grid used over the whole Island Copper property.

- 3) The drill core is in storage at the Island Copper mine. Logs are included with this report.
- 4) Core logging was performed by:

John Lamb, P. Eng.,  
B.A.Sc., M.A.Sc., - University of B.C.

This person is on the geological staff at the Island Copper Mine.

- 5) An itemized cost statement is included in this report.
- 6) A copy of the diamond drilling proposal is included. This proposal is from Thirty-Two Albert Crescent Ltd., a member company of the Tonto Drilling Ltd., organization. Together with my letter of acceptance, it forms the agreement, under which the work was done.

contd....

**UTAH MINES LTD.**

ISLAND COPPER MINE

P.O. BOX 370

PORT HARDY, B.C. V0N 2P0

TELEPHONE (604) 949-6326

WORK PERFORMED:/contd...

page 2.

- 7) Both an index map and a detailed claim map are attached to this report, showing the drill hole location and the extent of the Lake group of claims.

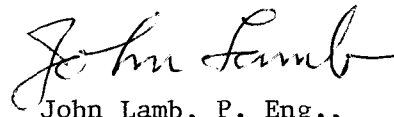

John Lamb, P. Eng.,

Project Geologist.

UTAH MINES LTD.  
 ISLAND COPPER MINE  
 P.O. BOX 370  
 PORT HARDY, B.C. V0N 2P0  
 TELEPHONE (604) 949-6326

STATEMENT OF COSTS  
FOR THE  
LAKE GROUP OF MINERAL CLAIMS

A) Contractor's Charges

Overburden - M-6

0 - 20 at \$14.25 \$ 285.00

Rock - M-6

*Et.*  
 20 - 1000 at \$14.25 \$13,965.00  
 1000 - 1500 at \$15.25 7,625.00  
 1500 - 1695 at \$17.25 3,363.75

Field Cost (Operation at hourly rates;  
 reaming, maintenance testing etc.) 2,305.00

Extra Charges

a) M-6 - (casings, reaming bits, etc.) 211.07  
 b) Mud circulation products at 11% of  
 total mud costs. \$ 2,193.84  
 c) Mobilization cost at 11% of total  
 mobilization 418.00  
 d) Hard ground charges at 20% of footage  
 drilled 339 feet @ \$6.00 \$ 2,034.00

B) Utah Costs

Core house labour \$ 1,660.00  
 Geological Supervision 1,500.00  
 Company overhead at 25% of labour plus  
 supervision 790.00

**UTAH MINES LTD.**  
 ISLAND COPPER MINE  
 P.O. BOX 370  
 PORT HARDY, B.C. V0N 2P0  
 TELEPHONE (604) 949-6326

STATEMENT OF COSTS FOR THE  
LAKE GROUP OF MINERAL CLAIMS/contd...

page 2.

B) Utah Costs

Core boxes, 63 at \$3.95	\$ 248.85
Room and Board 4 men for 21 days at \$15.72/day	1,320.48
Tractor for towing drill, preparing trails and drill sites, 38 hours @ \$50./hour.	\$ 1,900.00
Preparation of report	\$ 400.00
Survey of hole	350.00
Vehicle operation 200 miles @ 30¢/mile	60.00
TOTAL COST -	\$ 40,629.99

Footage Drilled = 1695

∴ Cost Per Foot = \$23.97  
Per Meter = <sup>#</sup>78.65

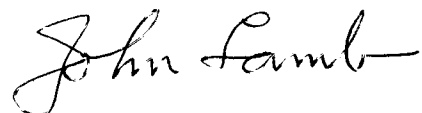

John Lamb, P. Eng.

Project Geologist.

JL:ebh



RESULTS AND CONCLUSION:

The hole was collared in the Parson Bay formation, continuing in it to 215 meters. Numerous short runs of fine fragmental tuff, sandy and cherty tuffs were encountered in this distance. To 418 meters the rock was a highly altered sequence of lithic, lapilli, and fine cherty tuff, with occasional dikes of dark greenish hornblende porphyry. From 418 to 486 meters the rock was mostly contorted gray Quatsino limestone. A thin band of tan skarn was encountered a 484.3 meters, with prominent epidote alteration and good chalcopyrite and pyrite. At 486.5 meters, the dark volcanic rock of the Karmutsen formation was encountered and continued to the bottom of the hole at 516.65 meters.

This hole, together with an earlier hole in the same general area, indicates that the Quatsino-Karmutsen contact zone has a potential for skarn replacement type of copper mineralization. Where this contact encounters the roots of the Island Copper porphyry mineralization, about 1.6 km. to the south, there may well be mineable orebodies. They could lie at depths of about 850 meters, well below the proposed pit bottom.

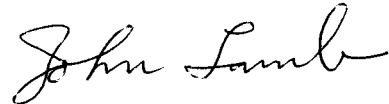

John Lamb,

Project Geologist.

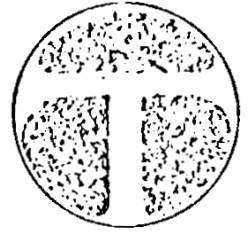

thirty-two albert  
crescent limited

A MEMBER OF THE TONTO GROUP OF COMPANIES

UTAH MINES LTD.

PROPOSAL FOR ISLAND COPPER MINE PROJECT

APRIL 30, 1979

2<sup>nd</sup> proposal

revised from that  
dated 25 April 79.

J.F.

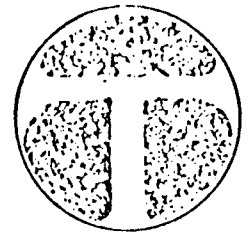

# thirty-two albert crescent limited

A MEMBER OF THE TONTO GROUP OF COMPANIES

April 30, 1979

Utah Mines Ltd.  
Island Copper Mine  
Port Hardy, B.C.

Attn: Mr. John Lamb

Dear Sir:

We are pleased to submit the following quotation on your project at the Island Copper Mine.

A. Scope of the Program

1. The program contemplates a minimum of 15,000 feet of NQ and BQ drilling.
2. The drilling will commence in mid May 1979.
3. The program contemplates holes ranging in depth from 500' to 1,000' with a capability of going to 1,600'. Holes will be inclined from minus 70 degrees to minus 90 degrees.

B. Union Certification

Our employees will be members of the Tunnel and Rock Workers Union, Local 168.

C. UTAH's Responsibilities

1. Drill roads and drill sites are to be constructed and maintained accessible to skid mounted drill rigs, supply trucks and pickups

...2

free of cost to Thirty-Two Albert. Any environmental responsibility relating to the construction, use or reclamation of same shall be the responsibility of Utah. Thirty-Two Albert will, however, remove all trash and loose materials, leaving drill sites in a clean and orderly condition.

2. All licences, land and water use permits, environmental reports, reports relating to hole plugging, etc. shall be the responsibility of Utah. Thirty-Two Albert shall cooperate with and give technical assistance if requested for compliance with these regulations.
3. Utah will hold Thirty-Two Albert harmless for any liability claims which may arise from normal activity related to this contract including pollution of ground water or surrounding land from discharge of drill water and wastes save if Thirty-Two Albert's employees act in an irresponsible manner.
4. Utah will provide locked storage space for Thirty-Two Albert's parts and supplies.
5. Utah will provide equipment to assist in moving Thirty-Two Albert's rigs from site to site.
6. Utah will either provide or be responsible for the following items at Thirty-Two Albert's list price plus 10%:
  - a) cement, drilling mud and additives and soluble oils
  - b) core boxes
  - c) any other special tools or drilling accessories which may be required for testing purposes or requested left in the hole.
7. Utah will provide room and board for Thirty-Two Alberts' crews at no cost to Thirty-Two Albert. It is understood crews will be accommodated in Utah's camp at the mine site.

D. THIRTY-TWO ALBERT's Responsibilities

1. Thirty-Two Albert will provide drill crews, drills and all other necessary equipment and materials to complete the program as outlined above.
  - a) The following equipment will be supplied:
    - 1 skid mounted Longyear Super 38 rig and 1 skid mounted Longyear 34 rig
    - all ancillary pumps, drill strings and other equipment
    - 2 3/4 ton trucks
    - mobile parts trailer and all spares
    - a Bombardier personnel carrier at industry rental rates of approximately \$2,500.00 per month

- b) All drill operators employed on this job will have a minimum of five years drilling experience.
2. Thirty-Two Albert will provide transportation for its personnel to and from the drill sites.
  3. Thirty-Two Albert will provide a full time foreman to supervise the drilling operations. The foreman will have a minimum of ten years experience in running and being responsible for diamond drill jobs.
  4. Thirty-Two Albert will transport the core from the drill site to Utah's core shed.
  5. Thirty-Two Albert will provide water to the drill site at no cost providing the horizontal distance does not exceed 1,500' and the lift 250'. Installation and maintenance are to Utah's account at quoted labour rates.

E. General

1. In the event that drill pipe and other equipment become broken or lost in the hole, Utah will be responsible for time and materials consumed to recover the materials. If they should end up being left in the hole, then they will be charged at their replacement value.
2. In the event that cavities or loose and caving materials are encountered of a nature as to prevent the completion of any hole, then Thirty-Two Albert does not, under these conditions, guarantee to drill to a predetermined depth and in the event that it becomes necessary to abandon the said hole, Thirty-Two Albert shall charge Utah for those holes abandoned, at the depth at which they were abandoned, at the footage rates specified. If required to continue on in the hole then Thirty-Two Albert has the option to revert to standby rate plus all materials, supplies and equipment needed at delivered cost, subsequent to Utah's approval.
3. It is agreed that hourly rates shall be interpreted here to mean the labour of a two-man crew, machine and equipment rental, plus pipe and casing lost or left in holes, diamond loss and setting charges, materials and supplies consumed in the work at Thirty-Two Albert's list price.

In the event extra labour over and above the regular two-man crew is required, Thirty-Two Albert agrees to supply such

additional labour at the rate of sixteen dollars and fifty cents (\$16.50) per man per hour.

F. Bid Prices

1. Moving time

- a) Move in charge including all equipment, supplies and personnel to the transport discharge point for each rig \$ 1900.00
- b) Move from site to site and to and from the transport loading or discharge point including all equipment, supplies and personnel for the rigs. Four hours free time will be allowed for each move. 16.50/man hr.  
10.00/drill hr.
- c) Move out charge including all equipment, supplies and personnel for each rig 1900.00

2. Drilling Rates

	<u>BWL</u>	<u>NWL</u>
a) Overburden or Wastedumps		
0 - 50'	14.25	15.25
50 - 100'*	15.25	16.25
100 - 150'*	17.25	18.25

\*or hourly rate plus material whichever is greater.

Casing shoes charged at cost plus 10%.

	<u>BQ</u>	<u>NQ</u>
b) Core Drilling		
0 - 1000'	14.25	15.25
1000 - 1500'	15.25	16.25
1500 - 2000'	17.25	18.25

Note: If siliceous magnetite breccia or similar hard material is encountered, an additional \$6.00 per foot will be charged for BQ drilling and \$7.00 per foot for NQ drilling. The hard material surcharge will apply anytime the penetration rate drops below four feet per hour and the footage drops below 60 feet per bit.

3. The following services will be performed at the designated hourly cost:

- a) Testing
- b) Standby at Utah's request or any other delays not caused by Thirty-Two Albert
- c) Setting and pulling casing
- d) Regaining lost circulation and cementing including setting and drilling time
- e) Reaming, hole conditioning, drilling cave 16.50/man hr.  
10.00/drill hr.

5.

4. Travel time in excess of one hour per man shift 16.50/man hr.

Thank you for permitting us to tender on your project. We look forward to working for you in the near future.

Yours very truly,

THIRTY-TWO ALBERT CRESCENT  
LIMITED

A handwritten signature in dark ink, appearing to read 'Charles E. Croft', is written over the typed name. The signature is somewhat stylized and overlaps the text.

Charles E. Croft

CEC:cm

## APPENDIX II.

April 30th, 1979.

Mr. C. Croft,  
Tonto Drilling Limited,  
1215 W. 7th Avenue,  
Vancouver, B.C.  
V6H 1B7.

Dear Chuck,

This is to advise you that your bid for this summer's diamond drilling at Island Copper has been accepted with the following proviso's which you and I and John Fleming just discussed on the telephone:

- 1) That your quote will include a non-running foreman which will add approximately 75<sup>c</sup>/foot to the drilling footage rates.
- 2) That your crews will deliver the boxes of core to our shed in camp, when they come off shift.
- 3) That overburden drilling rates beyond 50 feet will increase \$1.00 per ft. to 100 feet of depth and \$2.00 per foot to 150 feet of depth.
- 4) That your definition of hard ground will be "when rate of penetration is less than 4 feet per hour and bit life is less than 60 feet".
- 5) That you will rent us a bombardier carrier for difficult access problems at a rate of approximately \$2,500/month.

You should try to meet a commencement date of May 22nd, just after the long Victoria day holiday weekend.

Wishing you the best and looking forward to working with you this summer, I remain,

yours truly,

  
John Lamb,  
Project Geologist.

JL:ebh



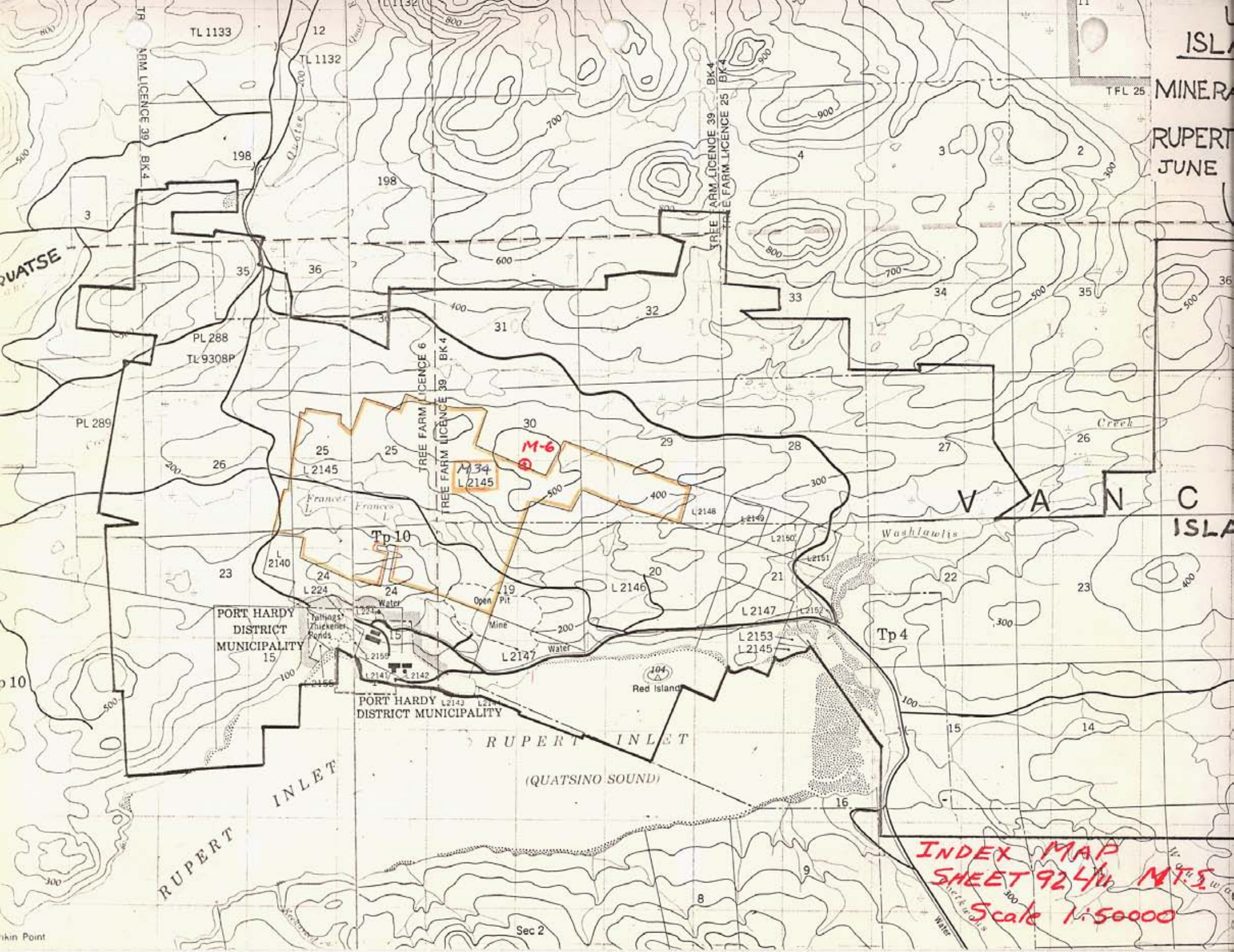

TL 1133

12

TL 1132

TR  
FARM LICENCE 39 BK 4

198

198

TR  
FARM LICENCE 39 BK 4  
FARM LICENCE 25 BK 4

TFL 25

ISLA  
MINERA  
RUPERT  
JUNE

QUATSE

PL 288  
TL 9308P

PL 289

TR  
FARM LICENCE 6  
TR  
FARM LICENCE 39 BK 4

M-6

M 34  
L 2145

VANANCIE ISLAND

PORT HARDY  
DISTRICT  
MUNICIPALITY  
15

PORT HARDY  
DISTRICT MUNICIPALITY

RUPERT INLET  
(QUATSINO SOUND)

RUPERT INLET

INDEX MAP  
SHEET 924/10 M.T.S.  
Scale 1:50000

Sec 2

HOLE NO. *M-6*

CASING COLLAR ELEV.: *440 FT* GROUND ELEV.:

COORDINATES: N. *11760* E. *26625*

INCLINATION: *-90°* BEARING: *—*

PROJECT:

DATE STARTED: *25 JUL '79*

DATE FINISHED: *11 AUG 79*

TOTAL DEPTH: *1695 FT. (516.65 M)*

PAGE NO: *1* OF *28*

REF. TO CLAIM CORNER:

SCALE:

LOGGED BY: *J.L.*

SECTION	ALTERATION			FRACTURING	MINERAL	GEOLOGY	COMMENTS: <i>LOCATED ON LAKE MC a few feet from boundary of L2145 (approx ON SEC 175). 0-20 - overburden. (no core).</i>	AVE CORE REC'Y/HOLE	% SULPHIDES	DRILLING INTERVAL	% CORE RECOVERED	CORE SIZE	SAMPLE INTERVAL	% REC'Y SAMP. INT.	ESTI-MATED
<i>20</i>	<i>6.1 M</i>									<i>20</i>					
							<i>20-23 - Black fractured argillite, somewhat limy. Calc frags w. gils. Some epid.</i>			<i>23</i>	<i>60</i>				
<i>30</i>	<i>9.14 M</i>						<i>23-39 - f. gray dark to greenish tuff. w. fine small frags.</i>								
							<i>} shot w calc vms. + gils. Pale green to buff</i>			<i>39</i>					
<i>40</i>	<i>12.19 M</i>						<i>39-106 - Black limy argillite shot through w. calc network vlt. Some vlt. tinged green w. epid. Some fine bddg. from 40° to 50° to core. Dissem py. in some beds</i>								
<i>50</i>	<i>15.24 M</i>														
<i>60</i>	<i>18.29 M</i>						<i>- thin bddg @ 45°</i>								
<i>70</i>	<i>21.33 M</i>														
<i>80</i>	<i>24.38 M</i>						<i>} sheared w carbonaceous gouge</i>								

MINERALOGICAL INVESTIGATION  
ANNUAL REPORT  
**7562**

HOLE NO. *M-6*

PROJECT:

PAGE NO: *2* OF *28*

CASING COLLAR ELEV.:

GROUND ELEV.:

DATE STARTED:

REF. TO CLAIM CORNER:

COORDINATES:

N.

E.

DATE FINISHED:

SCALE:

INCLINATION:

BEARING:

TOTAL DEPTH:

LOGGED BY:

SECTION	ALTERATION			FRACTURING	MINERAL	GEOLOGY	COMMENTS:	AVE CORE REC'Y / HOLE	% SULPHIDES	DRILLING INTERVAL	% CORE RECOVERED	CORE SIZE	SAMPLE INTERVAL	% REC'Y SAMP. INT.	ESTI-MATED
80	24	3	8 M				<i>39-106 Sec P1.</i>			36					
90	27	4	3 M.								35				
100	30	4	8 M.				<i>- shearing @ 5° to core</i>			106					
110	33	5	3 M				<i>106-171 - B'xt'd sediment w. arg. material to 113., followed by coarse wacke to 120 &amp; gray tuff b'xq to 130'. 130-148 - Pale gray fine bdd tuff. 148-152 - granular mass gray f'gll tuff. 152-171 - pale gray rhyolitic tuff. w. short runs distinct thin bdd. Quite limey.</i>				89				
120	36	5	8 M				<i>- calc crystals in fac</i>								
130	39	6	2 M.				<i>- 1' slip</i>								
140	42	6	7 M				<i>bddg @ 45°</i>			140					

MINERALOGY OF THE SECTION  
106-171

**7562**

MOLE NO. *M-6*

PROJECT:

PAGE NO: *3* OF *28*

CASING COLLAR ELEV.:

GROUND ELEV.:

DATE STARTED:

REF. TO CLAIM CORNER:

COORDINATES:

N.

E.

DATE FINISHED:

SCALE:

INCLINATION:

BEARING:

TOTAL DEPTH:

LOGGED BY:

SECTION	ALTERATION			FRACTURING	MINERAL	GEOLOGY	COMMENTS:	AVE CORE REC'Y / HOLE	% SULPHIDES	DRILLING INTERVAL	% CORE RECOVERED	CORE SIZE	SAMPLE INTERVAL	% REC'Y SAMP. INT.	ESTI-MATED
140							<i>106-171 - See P 2.</i>			<i>140</i>		<i>EG</i>			
150							<i>-bddg @ 35°</i>				<i>39</i>				
160							<i>some gils. -thin bddg @ 32°</i>								
170							<i>171-222 - Pale to med. gray. tuffaceous rocks. + sedimentary b'xas. w. fine calc vlt + some gils.</i>			<i>171</i>					
180							<i>fine - bedding @ 35°</i>								
190							<i>- fault @ 5° to core</i>								
200															

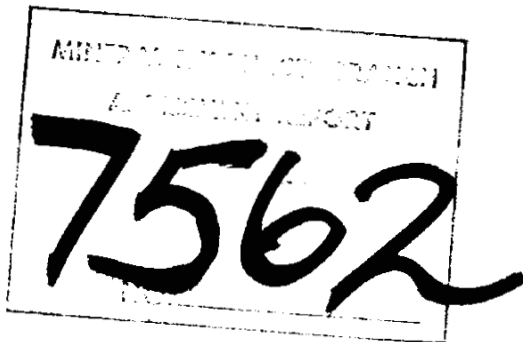

HOLE NO. *M-6*

CASING COLLAR ELEV.:

COORDINATES:

INCLINATION:

GROUND ELEV.:

N. E.

BEARING:

PROJECT:

DATE STARTED:

DATE FINISHED:

TOTAL DEPTH:

PAGE NO: *4* OF *28*

REF. TO CLAIM CORNER:

SCALE:

LOGGED BY:

SECTION	ALTERATION			FRACTURING	MINERAL	GEOLOGY	COMMENTS:	AVE CORE REC'Y / HOLE	% SULPHIDES	DRILLING INTERVAL	% CORE RECOVERED	CORE SIZE	SAMPLE INTERVAL	% REC'Y SAMP. INT.	ESTI-MATED
200							<i>171-222 - See P3. Fine spse dissemin py</i>			<i>200</i>		<i>BQ</i>			
210							<i>- slip w. 1/4" gouge</i>				<i>80</i>				
220										<i>222</i>					
230							<i>222 - 290 Mixed dark f'gt tuffs &amp; limey med. gray tuff w. irreg vns calc-lam. Fine scatt'd py.</i>								
240											<i>90</i>				
250															
260										<i>260</i>					

MINERAL RESEARCH BRANCH  
ESTIMATION REPORT**7562**



MOLE NO. *M-6*

CASING COLLAR ELEV.:

COORDINATES:

INCLINATION:

GROUND ELEV.:

N. E.

BEARING:

PROJECT:

DATE STARTED:

DATE FINISHED:

TOTAL DEPTH:

PAGE NO: *6* OF *28*

REF. TO CLAIM CORNER:

SCALE:

LOGGED BY:

SECTION	ALTERATION			FRACTURING	MINERAL	GEOLOGY	COMMENTS:	AVE CORE REC'Y / HOLE	% SULPHIDES	DRILLING INTERVAL	% CORE RECOVERED	CORE SIZE	SAMPLE INTERVAL	% REC'Y SAMP. INT	ESTI-MATED
320							<i>312-342</i>								
							<i>Sec P5</i>								
330							<i>bddg @ 35°</i>								
340															
							<i>342-344 - Med. gray fgt tuff.</i>								
							<i>bddg @ 45°</i>								
							<i>344-380 -</i>								
350							<i>To 347 black limey arg.</i>								
							<i>To 349 gray limey fgtl tuff</i>								
							<i>To 356 black arg, crackled &amp; lealed w cotc</i>								
							<i>To 359 med gray lms, crackled.</i>								
360							<i>To 366 Black arg w. bddg. @ 45°</i>								
							<i>To 371 Gray fgtl tuff w. frags arg. speckled throughout. Calc vns</i>								
							<i>To 373 crackled argillite.</i>								
370							<i>To 380 dark greenish tuff w. tiny frags arg rolled up.</i>								
380															

MINERALOGY  
LABORATORY  
**7562**  
NO.

*100  
90 M*

*110 M*

HOLE NO. *M-6*

CASING COLLAR ELEV.:

COORDINATES:

INCLINATION:

GROUND ELEV.:

N. E.

BEARING:

PROJECT:

DATE STARTED:

DATE FINISHED:

TOTAL DEPTH:

PAGE NO: *7* OF *28*

REF. TO CLAIM CORNER:

SCALE:

LOGGED BY: *JL*

SECTION	ALTERATION			FRACTURING	MINERAL	GEOLOGY	COMMENTS:	AVE CORE RECY / HOLE	% SULPHIDES	DRILLING INTERVAL	% CORE RECOVERED	CORE SIZE	SAMPLE INTERVAL	% REC'Y SAMP. INT.	ESTI-MATED
380							380 - 440 - arg. w. layers of tuff & limey sandy beds where noted Much calc crackling to 387 - gray tuff w frogs arg.								
390							-bddg @ 30°								
400							-bddg slip 1" wide - strong shearing								
410							-limey bed @ 45°								
420							-bddg @ 45°								
430															
440															

*120 M*

*130 M*

MINERAL RESEARCH  
LABORATORY  
**7562**



MOLE NO. M-6

CASING COLLAR ELEV.:

COORDINATES:

INCLINATION:

GROUND ELEV.:

N. E.

BEARING:

PROJECT:

DATE STARTED:

DATE FINISHED:

TOTAL DEPTH:

PAGE NO: 8 OF 28

REF. TO CLAIM CORNER:

SCALE:

LOGGED BY:

SECTION	ALTERATION			FRACTURING	MINERAL	GEOLOGY	COMMENTS:	AVE CORE REC'Y / HOLE	SULPHIDES	DRILLING INTERVAL	% CORE RECOVERED	CORE SIZE	SAMPLE INTERVAL	% REC'Y SAMP. INT.	ESTI-MATED	
440							440 - 500 - Both massive & t.b. block to gray limey arg. crackled w. calc sms. Numerous bld. seams w. py & lesser sulphides									
450							- 1' gray limey tuff.									
465							- 140 M									
470							- bldg @ 50° - 1/4" bld cpy - fine gray tuff.									
480							- gray tuff wacke w 1/4" rounded frags									
490							- buff. f. gray tuff bld. - much calc crackling									
500							- 150 M									

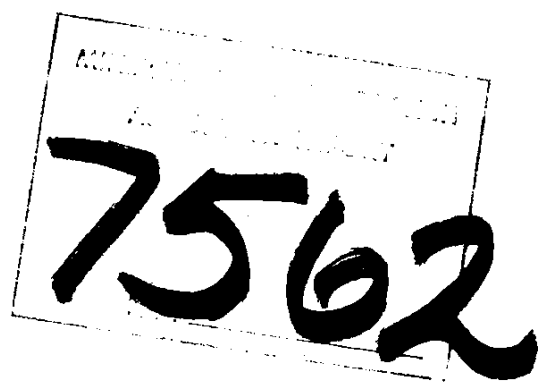
  
 7562

HOLE NO. *M-6*

CASING COLLAR ELEV.:

COORDINATES:

INCLINATION:

GROUND ELEV.:

N. E.

BEARING:

PROJECT:

DATE STARTED:

DATE FINISHED:

TOTAL DEPTH:

PAGE NO: *9* OF *28*

REF. TO CLAIM CORNER:

SCALE:

LOGGED BY:

SECTION	ALTERATION			FRACTURING	MINERAL	GEOLOGY	COMMENTS:	AVE CORE REC'Y / HOLE	SULPHIDES	DRILLING INTERVAL	% CORE RECOVERED	CORE SIZE	SAMPLE INTERVAL	% REC'Y SAMP. INT.	ESTI-MATED	
500							<p><u>500 - 527</u> - Massive black limey arg. w. few fine light bdd stripes. All heavily crackled w. white calc. seams, which themselves are broken by later movement.</p> <p>- bldg @ 45°</p>									
510																
520							<p>- bldg @ 50°</p> <p><u>527 - 650</u> - Mostly well bdd. argillite, black w. thin light cherty bands. Fretted w. calc-lauumontite vns w knots. Some narrow bdd. bands w. heavy py.</p>									
530																
540							<p>- bldg @ 60°</p>									
550																
560							<p>- bldg @ 55°</p>									

MINERAL RESOURCES BRANCH  
 ASSURANCE REPORT  
**7562**

160 M

170 M

527

90

560

HOLE NO. *M-6*

CASING COLLAR ELEV.:

COORDINATES:

INCLINATION:

GROUND ELEV.:

N. E.

BEARING:

PROJECT:

DATE STARTED:

DATE FINISHED:

TOTAL DEPTH:

PAGE NO: *10* OF *28*

REF. TO CLAIM CORNER:

SCALE:

LOGGED BY:

SECTION	ALTERATION	FRACTURING	MINERAL	GEOLOGY	COMMENTS:	AVE CORE REC'Y / HOLE	SULPHIDES	DRILLING INTERVAL	% CORE RECOVERED	CORE SIZE	SAMPLE INTERVAL	% REC'Y SAMP INT.	ESTI-MATED
560					<i>527-650 See p 9.</i>								
570					<i>bdtg @ 50°</i>								
580													
590-180 M					<i>bdtg @ 45°</i>								
600					<i>1/2" band w much py</i>								
610													
620					<i>bdtg @ 65°</i>								

MINERAL RECONSTITUTION  
LABORATORY REPORT  
**7562**

MOLE NO. *M-6*

CASING COLLAR ELEV.:

GROUND ELEV.:

PROJECT:

PAGE NO: *11* OF *28*

COORDINATES:

N. E.

DATE STARTED:

REF. TO CLAIM CORNER:

INCLINATION:

BEARING:

DATE FINISHED:

SCALE:

TOTAL DEPTH:

LOGGED BY:

SECTION	ALTERATION			FRACTURING	MINERAL	GEOLOGY	COMMENTS:	AVE CORE REC'Y / HOLE	% SULPHIDES	DRILLING INTERVAL	% CORE RECOVERED	CORE SIZE	SAMPLE INTERVAL	% REC'Y SAMP. INT.	ESTI-MATED	
620							<p><u>527-650 - See P9.</u></p> <p>- bddg @ 65°</p> <p>- 2' w strongly contort &amp; folded bddg.</p> <div style="border: 1px solid black; padding: 5px; text-align: center;"> <p>MINERAL RESOURCE SERVICES                      TECHNICAL REPORT  <b>7562</b></p> </div> <p>- bddg @ 70°</p>									
630																
640																
650							<p><u>650-667 - Striped, well bdd. black arg. w. numerous grayish sandy cherty layers w. fine speckled py. Num. hairline cracks filled w. calc-lum.</u></p> <p>- bddg @ 70°</p>			650						
660												93				
670							<p><u>667-678 - greenish lithic tuff. w. 1/32" whitish frags throught some sections prob. bdd. in the arg.</u></p>			667						
680												90				
										679						

HOLE NO. *M-6*

CASING COLLAR ELEV.:

COORDINATES:

INCLINATION:

GROUND ELEV.:

N.

E.

BEARING:

PROJECT:

DATE STARTED:

DATE FINISHED:

TOTAL DEPTH:

PAGE NO: *12* OF *28*

REF. TO CLAIM CORNER:

SCALE:

LOGGED BY:

SECTION	ALTERATION			FRACTURING	MINERAL	GEOLOGY	COMMENTS:	AVE CORE REC'Y / HOLE	% SULPHIDES	DRILLING INTERVAL	% CORE RECOVERED	CORE SIZE	SAMPLE INTERVAL	% REC'Y SAMP. INT.	ESTI-MATED	
680							<p><u>678 - 704</u> - Very f. bdd striped black &amp; white limey arg. w thin light sandy layers, w. fine dissem py. Num. seams calc-laum.</p>									
690																
700							<p>- bddg @ 75°</p>									
710							<p><u>704 - 750</u> Pale to dark gray tuff. w. sections cont'ng lapilli to <math>\frac{1}{8}</math>" size. Partly b'xtd &amp; healed. w. calc-laum frags. To 730 conid. development of yellow-green epidote</p>									
720																
730							<p>strongly sheared &amp; brecciated. w. some gougy seams.</p>									
740																

MINERAL DEPOSIT DIVISION  
BUREAU OF MINES  
**7562**

MOLE NO. *M-6*

CASING COLLAR ELEV.:

COORDINATES:

INCLINATION:

GROUND ELEV.:

N. E.

BEARING:

PROJECT:

DATE STARTED:

DATE FINISHED:

TOTAL DEPTH:

PAGE NO: *13* OF *28*

REF. TO CLAIM CORNER:

SCALE:

LOGGED BY:

SECTION	ALTERATION			FRACTURING	MINERAL	GEOLOGY	COMMENTS:	AVE CORE REC'Y / HOLE	% SULPHIDES	DRILLING INTERVAL	% CORE RECOVERED	CORE SIZE	SAMPLE INTERVAL	% REC'Y SAMP. INT	ESTIMATED
740							<i>704-750 See P12</i>								
750							<i>750-800 - gray-green cherty tuff w. some streak vlt's calc. w. some gils. Weak epid streaks in places. Small vms &amp; pods py in places. Occ large frags tuff b'xa.</i>								
760							<i>- sheared parallel to core</i>								
770							<i>- sheared along core</i>								
780							<i>- epid streaks.</i>								
790							<i>- fault at low angle</i>								
800															

*230 M*

*240 M*

MINING BRANCH  
 REPORT  
**7562**

*BQ*

HOLE NO. *M-6*

CASING COLLAR ELEV.:

COORDINATES:

INCLINATION:

GROUND ELEV.:

N. E.

BEARING:

PROJECT:

DATE STARTED:

DATE FINISHED:

TOTAL DEPTH:

PAGE NO: *14* of *28*

REF. TO CLAIM CORNER:

SCALE:

LOGGED BY:

SECTION	ALTERATION			FRACTURING	MINERAL	GEOLOGY	COMMENTS:	AVE CORE REC'Y / HOLE	% SULPHIDES	DRILLING INTERVAL	% CORE RECOVERED	CORE SIZE	SAMPLE INTERVAL	% REC'Y SAMP. INT.	ESTI-MATED
700							<i>800-860-</i>								
							<i>1/4" slip @ 10°</i>								
810							<i>some gouge</i>								
							<i>faint bddy @ 45°</i>								
820	<i>250 M</i>						<i>tuff breccia partly vuggy.</i>								
830															
840															
850	<i>260 M</i>														
860															

MINERAL RESOURCES BRANCH  
 ANNUAL REPORT  
**7562**

860

HOLE NO. *M-6*

CASING COLLAR ELEV.:

COORDINATES:

INCLINATION:

GROUND ELEV.:

N. E.

BEARING:

PROJECT:

DATE STARTED:

DATE FINISHED:

TOTAL DEPTH:

PAGE NO: *15* OF *28*

REF. TO CLAIM CORNER:

SCALE:

LOGGED BY:

SECTION	ALTERATION			FRACTURING	MINERAL	GEOLOGY	COMMENTS:	AVE CORE REC'Y / HOLE	% SULPHIDES	DRILLING INTERVAL	% CORE RECOVERED	CORE SIZE	SAMPLE INTERVAL	% REC'Y SAMP. INT.	ESTI-MATED
860							<p><i>860 - 820</i></p> <p><i>Alternate layers cherty tuff, fragmental tuff w. black speckled frags to 1/2" size, to very fine white speckled tuff. Some calc vns to 1/2". Traces of gils</i></p> <p><i>Rock varies from buff to dark gray green.</i></p>								
870						<p><i>epid. on shearing.</i></p>									
880															
890															
900															
910															
920															

MINERAL RESEARCH ASSOCIATION  
 LABORATORY REPORT  
**7562**

*270 M*

*1' shearing & gougy*

*sheared*

*sheared & gougy w much streaky epid.*

*280 M*

*360*

*90*

*920*



HOLE NO. *M-6*

CASING COLLAR ELEV.:

COORDINATES:

INCLINATION:

GROUND ELEV.:

N. E.

BEARING:

PROJECT:

DATE STARTED:

DATE FINISHED:

TOTAL DEPTH:

PAGE NO: *16* OF *28*

REF. TO CLAIM CORNER:

SCALE:

LOGGED BY:

SECTION	ALTERATION	FRACTURING	MINERAL	GEOLOGY	COMMENTS:	AVE CORE REC'Y / HOLE	% SULPHIDES	DRILLING INTERVAL	% CORE RECOVERED	CORE SIZE	SAMPLE INTERVAL	% REC'Y SAMP INT.	ESTI-MATED
920					<p>good tuff b'xa</p> <p>920 - 952 - epidotized tuff, well b'xtd in short runs w' fine lap. texture in others. Fine horline frac w' gils.</p>			920		BQ			
930					<p>shearing w. clay alt'n</p>				86				
940					<p>narrow qtz vn. parallel to core. clay alt'n on marg.</p>								
950	290 M												
960					<p>soft alt'd shear parallel to core. Gils calc &amp; some epid.</p> <p>952 - 984 - gray-greenish fine lithic tuff w' some bands finely fragtl. A few thin calc vlt's.</p>								
970					<p>1/4" clay alt'n on slip</p>								
980													

MINERAL RESOURCE BRANCH  
SOUTH AFRICA

7562

HOLE NO. *M-6*

PROJECT:

PAGE NO: *17* OF *28*

CASING COLLAR ELEV.:

GROUND ELEV.:

DATE STARTED:

REF. TO CLAIM CORNER:

COORDINATES:

N.

E.

DATE FINISHED:

SCALE:

INCLINATION:

BEARING:

TOTAL DEPTH:

LOGGED BY:

SECTION	ALTERATION			FRACTURING	MINERAL	GEOLOGY	COMMENTS:	AVE CORE REC'Y / HOLE	% SULPHIDES	DRILLING INTERVAL	% CORE RECOVERED	CORE SIZE	SAMPLE INTERVAL	% REC'Y SAMP. INT.	ESTI-MATED
980															
990															
1000															
1010															
1020															
1030															
1040															

MINERAL RESOURCES BRANCH

SASKATCHEWAN

**7562**

DESCRIPTIVE GEOLOGY

984 - 1048 1/2

Dark gray hornblende porphyry  
w. scott'd blackish h'blde phenocrysts  
up to max 1cm size. Core firm &  
hard, breaking into long pieces.

In places some phenos are alt'd to  
silvery gray.

Contact @ 984 very sharp @ 60° to core

" @ 1048 1/2 fairly sharp @ 30° to "

Rock cut by a few hairline vlt's of calc.

epid'ted  
tuff.

BQ

HOLE NO. *M-6*  
CASING COLLAR ELEV.:

GROUND ELEV.:

PROJECT:

PAGE NO: *18* OF *28*

COORDINATES:

N. E.

DATE STARTED:

REF. TO CLAIM CORNER:

INCLINATION:

BEARING:

DATE FINISHED:

SCALE:

TOTAL DEPTH:

LOGGED BY:

SECTION	ALTERATION			FRACTURING	MINERAL	GEOLOGY	COMMENTS:	AVE CORE REC'Y / HOLE	% SULPHIDES	DRILLING INTERVAL	% CORE RECOVERED	CORE SIZE	SAMPLE INTERVAL	% REC'Y SAMP. INT.	ESTI-MATED	
1040							<i>984 - 1048 1/2 See P17</i>  <i>- calc vns. w. gils.</i>									
1050	<i>320 M</i>						<i>1048 1/2 - 1100 - Mostly lap. tuff &amp; fine lithic tuff w. short runs hnbld π as noted. Some short well bdd limey &amp; argillaceous beds, as noted. Some calc vns. w epid alt'n. &amp; also patches epid. A few thin py. sms. Core somewhat broken.</i>									
1060							<i>3 1/2' partly bleached hnbld pory.</i>									
1070							<i>- bddg @ 35°</i>  <i>- beds contort. &amp; folded</i>									
1080	<i>330 M</i>															
1090							<i>- bddg @ 70°</i> <i>- much epid.</i>									
1100																

MINERAL RESEARCH ASSOCIATION  
 7562

HOLE NO. M-6

CASING COLLAR ELEV.:

COORDINATES:

INCLINATION:

GROUND ELEV.:

N. E.

BEARING:

PROJECT:

DATE STARTED:

DATE FINISHED:

TOTAL DEPTH:

PAGE NO: 19 of 28

REF. TO CLAIM CORNER:

SCALE:

LOGGED BY: J. L

SECTION	ALTERATION			FRACTURING	MINERAL	GEOLOGY	COMMENTS:	AVE CORE REC'Y / HOLE	% SULPHIDES	DRILLING INTERVAL	% CORE RECOVERED	CORE SIZE	SAMPLE INTERVAL	% REC'Y SAMP. INT.	ESTI-MATED	
1100							1100 - 1160 Mixed mass. alt'd tuff & t.b. cherty beds. Much epid. alt'n & replacement through the core. Core broken in places rubble.									
1110							6" core loss 3' rubble, mostly lost.									
							Dissem py. Minor calc vns.									
1120							bddg @ 45°									
1130							← almost 1' mass. pyrr w. 2 thin vlt's py } NB									
							bddg @ 50°									
1140							bddg contort. at low core angle									
1150							bddg contorted & parallel to core									
							sheared & epidotized.									
1160							bddg @ 45°									

MINE...  
7562

HOLE NO. *M-6*

CASING COLLAR ELEV.:

COORDINATES:

INCLINATION:

GROUND ELEV.:

N. E.

BEARING:

PROJECT:

DATE STARTED:

DATE FINISHED:

TOTAL DEPTH:

PAGE NO: *20* OF *28*

REF. TO CLAIM CORNER:

SCALE:

LOGGED BY: *J.L.*

SECTION	ALTERATION			FRACTURING	MINERAL	GEOLOGY	COMMENTS:	AVE CORE RECY / HOLE	% SULPHIDES	DRILLING INTERVAL	% CORE RECOVERED	CORE SIZE	SAMPLE INTERVAL	% REC'Y SAMP. INT.	ESTI-MATED	
1160							<p><u>1160 - 1191</u></p> <p>Greenish to almost white in short runs chert &amp; tuff beds</p> <p>Some orange-brown alt'n in streaks. Poss f'spor vns</p> <p>Fine dissem &amp; vn. py.</p> <p>2' bleached white h'nblde. <math>\pi</math>.</p>									
1170							<p>bedding @ <math>35^\circ</math></p>									
1180							<p>webbing of fine calc vns, partly brecciated. Much gils.</p>									
1190							<p>360 M</p>									
1200							<p><u>1191 - 1236 -</u></p> <p>Mostly green to pale gray f'gtl &amp; lap. tuff &amp; tuff b'xa w. dissem fine py. &amp; a few py vns.</p> <p>Stretches of bleached <math>\pi</math> w. pale green well formed X'al phenos (Could be highly alt'd h'nblde - and. <math>\pi</math>)</p> <p>Occ fine selvedge of skarn on calc v'ts.</p>									
1210							<p>looks like bleached h'nblde</p> <p>slip. w calc &amp; gils.</p>									
1220							<p>370 M</p>									

MINERALOGY

7562

HOLE NO. *M-6*

PROJECT:

PAGE NO: *21* OF *28*

CASING COLLAR ELEV.:

GROUND ELEV.:

DATE STARTED:

REF. TO CLAIM CORNER:

COORDINATES:

N. E.

DATE FINISHED:

SCALE:

INCLINATION:

BEARING:

TOTAL DEPTH:

LOGGED BY:

SECTION	ALTERATION			FRACTURING	MINERAL	GEOLOGY	COMMENTS:	AVE CORE REC'Y / HOLE	% SULPHIDES	DRILLING INTERVAL	% CORE RECOVERED	CORE SIZE	SAMPLE INTERVAL	% REC'Y SAMP. INT.	ESTI-MATED
1220							<i>1191-1236 See P20</i>								
1230															
1240							<i>1236-1280 - Partly bedded tuff b'x a + t.b. cherty tuffs. Some calc vns. loaded w. gils.</i>								
1250							<i>mixed tuffs highly alt'd h'nbld tuff andes. T.</i>								
1260							<i>t. bddg @ 80°</i>								
1270							<i>epidotized on bddg. @ 80°</i>								
1280							<i>- laced w. gils</i>								

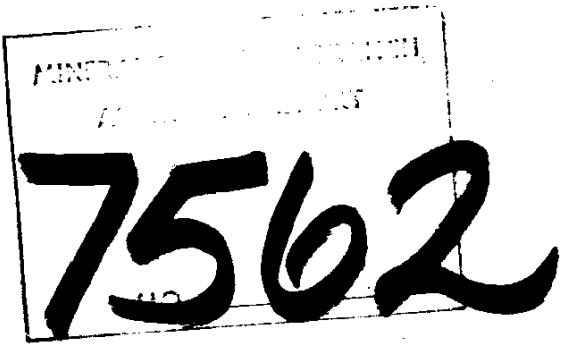
MINERALOGY  
  
**7562**

3.80 M  
 3.90 M

HOLE NO. *M-6*

PROJECT:

PAGE NO: *22* OF *28*

CASING COLLAR ELEV.:

GROUND ELEV.:

DATE STARTED:

REF. TO CLAIM CORNER:

COORDINATES:

N. E.

DATE FINISHED:

SCALE:

INCLINATION:

BEARING:

TOTAL DEPTH:

LOGGED BY:

SECTION	ALTERATION			FRACTURING	MINERAL	GEOLOGY	COMMENTS:	AVE CORE REC'Y / HOLE	% SULPHIDES	DRILLING INTERVAL	% CORE RECOVERED	CORE SIZE	SAMPLE INTERVAL	% REC'Y SAMP. INT.	ESTI-MATED	
1280							<p><u>1280 - 1323</u></p> <p>Mixed lithic tuff (buff) &amp; t.b. limey short arg. vns, some well bdd. laced w. extended calc vns w. consid. gils in places.</p> <p>Consid breakage &amp; healing of rocks &amp; evidence of flowage folding.</p> <p>Some epid streaks.</p>									
1290																
1300																
1310																
1320																
1330							<p><u>1323 - 1371</u></p> <p>Tan, chalky white to pale gray limey &amp; cherty tuff, generally well bedded. Consid contortion &amp; folding in places. Most reacts to HCl.</p>									
1340																

- bddg @ 65°

- 400 M

- bddg @ 50°

- bddg @ 60°

MINERALOGY

7562

HOLE NO. *M-6*

CASING COLLAR ELEV.:

COORDINATES:

INCLINATION:

GROUND ELEV.:

N. E.

BEARING:

PROJECT:

DATE STARTED:

DATE FINISHED:

TOTAL DEPTH:

PAGE NO. *23* OF *28*

REF. TO CLAIM CORNER:

SCALE:

LOGGED BY:

SECTION	ALTERATION	FRACTURING	MINERAL	GEOLOGY	COMMENTS:	AVE CORE REC'Y / HOLE	% SULPHIDES	DRILLING INTERVAL	% CORE RECOVERED	CORE SIZE	SAMPLE INTERVAL	% REC'Y SAMP. INT.	ESTI-MATED
1340					<i>1323-1371 See P22.</i>					<i>BC</i>			
1350													
1360													
1370													
1380					<i>1371-1417 - Mottled chalky buff to grayish lms cut by a few thin vlt's calc. Faintly bedded. in places</i>								
1390													
1400					<i>-bddg @ 45°</i>								

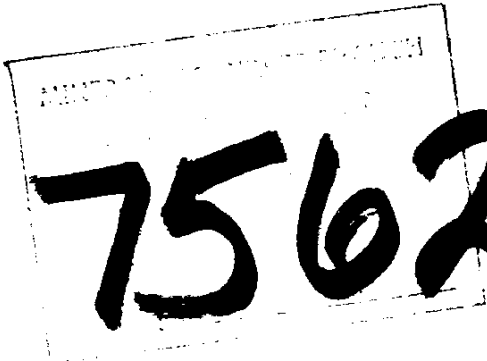
  
**7562**



HOLE NO. *M-6*

PROJECT:

PAGE NO: *24* OF *28*

CASING COLLAR ELEV.:

GROUND ELEV.:

DATE STARTED:

REF. TO CLAIM CORNER:

COORDINATES:

N. E.

DATE FINISHED:

SCALE:

INCLINATION:

BEARING:

TOTAL DEPTH:

LOGGED BY:

SECTION	ALTERATION			FRACTURING	MINERAL	GEOLOGY	COMMENTS:	AVE CORE REC'Y / HOLE	% SULPHIDES	DRILLING INTERVAL	% CORE RECOVERED	CORE SIZE	SAMPLE INTERVAL	% REC'Y SAMP. INT.	ESTI-MATED
<i>1400</i>							<i>1371-1417</i> <i>See P24</i>								
<i>1410</i>															
<i>1420</i>							<i>green-gray lap. tuff</i> <i>1417-1460</i> - Mostly white, streaked w. blue gray bdd lms. except volcanics where noted. Flowage distortion in lms								
<i>1430</i>							<i>cherty tuff w. weak skarn strks.</i>								
<i>1440</i>							<i>greenish lap. tuff and. Good py &amp; some epid</i>								
<i>1450</i>							<i>3' skarny andesite w. py.</i> <i>bddg @ 45°</i>								
<i>1460</i>							<i>bddg @ 45°</i>								

AMERICAN ENGINEERING COMPANY  
**7562**

HOLE NO. M-6

CASING COLLAR ELEV.:

COORDINATES:

INCLINATION:

GROUND ELEV.:

N. E.

BEARING:

PROJECT:

DATE STARTED:

DATE FINISHED:

TOTAL DEPTH:

PAGE NO: 25 OF 28

REF. TO CLAIM CORNER:

SCALE:

LOGGED BY:

SECTION	ALTERATION			FRACTURING	MINERAL	GEOLOGY	COMMENTS:	AVE CORE REC'Y / HOLE	% SULPHIDES	DRILLING INTERVAL	% CORE RECOVERED	CORE SIZE	SAMPLE INTERVAL	% REC'Y SAMP. INT.	ESTI-MATED	
1460							1460-1535 - blue-gray limestone w. greenish andesitic alt'd sills (or dikes) where noted. Some late calc frags.									
1470							dark green andesite w. scattered py & fine skarn selvages. Much epid. alt'n									
1480							contact @ 40° dark green f.gr. andesite bleached on upper cont. Dissem py. throughout.									
1490							bddg @ 50° 1" skarn selvedge Dark greenish black andesite very fine grained.									
1500																
1510							bddg @ 50°									
1520							bddg @ 55°									

MINING RESEARCH  
CORPORATION

# 7562

BQ

HOLE NO. *M-6*

CASING COLLAR ELEV.:

COORDINATES:

INCLINATION:

GROUND ELEV.:

N. E.

BEARING:

PROJECT:

DATE STARTED:

DATE FINISHED:

TOTAL DEPTH:

PAGE NO: *26* OF *28*

REF. TO CLAIM CORNER:

SCALE:

LOGGED BY:

SECTION	ALTERATION			FRACTURING	MINERAL	GEOLOGY	COMMENTS:	AVE CORE REC'Y / HOLE	% SULPHIDES	DRILLING INTERVAL	% CORE RECOVERED	CORE SIZE	SAMPLE INTERVAL	% REC'Y SAMP. INT.	ESTI-MATED	
1520							<p><u>1520 - 1535</u> - Blue gray bedded lms. except for andesite where noted. Hairline calc vns.</p> <p>- bddg @ 50°</p>					BQ				
1530							<p>Greenish andesite, bleached tan margins. Some porphyritic texture. Some py &amp; epid.</p>									
1540							<p><u>1535 - 1589</u> - Blue gray limestone w. vague but def. bddg., some contorted. Cut by late calc vlt's. Some of latter are open &amp; vuggy w. tiny well formed crystals in them</p> <p>- bddg @ 60°</p>									
1550																
1560																
1570																
1580							<p>← bddg @ 60°</p>									

MINERALS

7562

HOLE NO. *M-6*

PROJECT:

PAGE NO: *27* OF *28*

CASING COLLAR ELEV.:

GROUND ELEV.:

DATE STARTED:

REF. TO CLAIM CORNER:

COORDINATES:

N.

E.

DATE FINISHED:

SCALE:

INCLINATION:

BEARING:

TOTAL DEPTH:

LOGGED BY:

SECTION	ALTERATION			FRACTURING	MINERAL	GEOLOGY	COMMENTS:	AVE CORE REC'Y / HOLE	% SULPHIDES	DRILLING INTERVAL	% CORE RECOVERED	CORE SIZE	SAMPLE INTERVAL	% REC'Y. SAMP INT.	ESTI-MATED
1580							<u>1535-1589</u> See P26								
1590							<u>1589-1596</u> - 1 ft tan skarn w. good dissem large masses cpy. followed by epidatized skarny volc. w. dissem py & some cpy.			some gils					
1600							<u>1596-1640</u> Black-green mostly uniformly fine grained granular basaltic looking rock, cut by numerous calcite vltts. w. streaks <u>gils</u> .								
1610							sheared. w. calc vng. & specks <u>gils</u>								
1620															
1630															
1640															

MINERAL RESOURCES BRANCH  
 ASSOCIATED UNIVERSITY  
**7562**

HOLE NO. *M-6*

CASING COLLAR ELEV.:

GROUND ELEV.:

PROJECT:

PAGE NO: *28* OF *28*

DATE STARTED:

REF. TO CLAIM CORNER:

COORDINATES:

N. E.

DATE FINISHED:

SCALE:

INCLINATION:

BEARING:

TOTAL DEPTH:

LOGGED BY:

SECTION	ALTERATION	FRACTURING	MINERAL	GEOLOGY	COMMENTS:	AVE CORE REC'Y / HOLE	% SULPHIDES	DRILLING INTERVAL	% CORE RECOVERED	CORE SIZE	SAMPLE INTERVAL	% REC'Y SAMP. INT.	ESTI-MATED
1640					<u>1640 - 1695 -</u> Dark green-black fine grained but granular basaltic rock. Occ speck py. laced w. calc-lauum frags some w. a little epid. alt'n & clusters of gils.  This probably the Karmutsen group rocks.								
1650													
1660													
1670													
1680													
1690													
1700													

MINERAL RESOURCES CANADA  
ASSESSMENT REPORT  
**7562**  
NO.

1695' (516.65 M.)  
END OF HOLE

510 M

LAKE GROUP  
of  
M.C.'s.

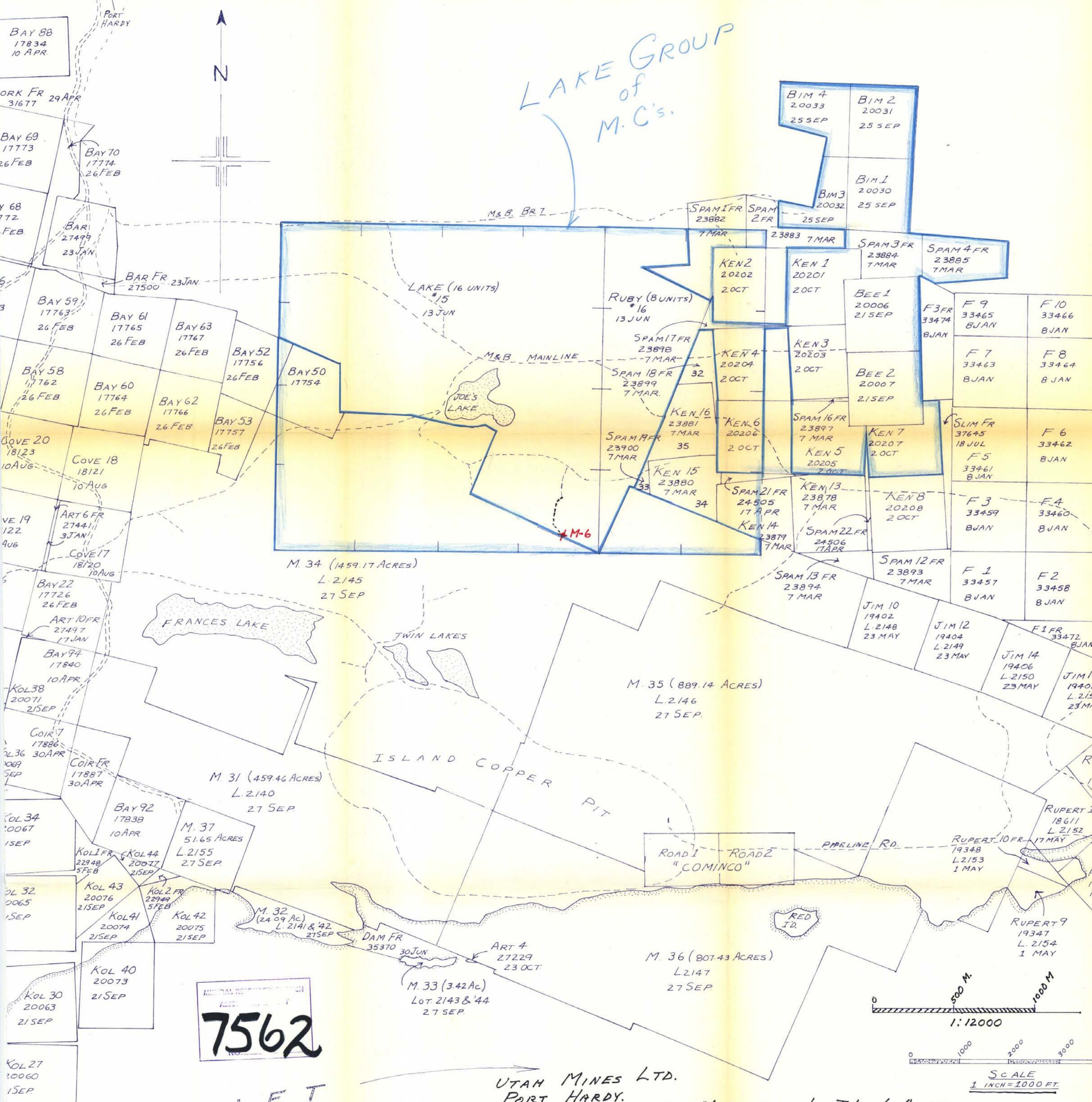

**7562**

INLET

UTAH MINES LTD.  
PORT HARDY.

1. To accompany Assessment Report on "Lake Group by J. Lamb, Aug 1979  
2. Shows location of diamond drill hole M-6

SCALE  
1 INCH = 1000 FT.