

79-#372-#7654

Interim Report
on a
Diamond Drill Program
on the
FAIRWEATHER HILLS PROPERTY
of
SIENNA DEVELOPMENTS LTD.

Nicola M.D.

N.T.S. 92H/15E
49°55' 120°34'

August 8, 1979
Vancouver, B.C.

L. Sookochoff, P.Eng.
Consulting Geologist

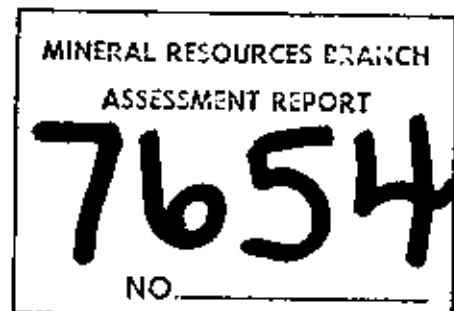

Table of Contents

	Page No
INTRODUCTION -----	1
PROPERTY -----	2
LOCATION AND ACCESS -----	2
DIAMOND DRILLING -----	3
CONCLUSIONS -----	5
RECOMMENDATIONS -----	6

ILLUSTRATIONS

Index Map	1:50 000
Plan of Drill Hole Location	1:240
-Adit Zone	

Diamond Drill Program
on the
FAIRWEATHER HILLS PROPERTY

INTRODUCTION

A diamond drill program was initiated on the Adit zone of the Fairweather Hills property where a drill indicated tonnage of 60,000 tons of an average weighted grade of .876% Cu were delineated. In addition to the former drilling completed on the property geophysical surveys that were carried out on the property outlined several anomalous areas some of which could be interpreted to indicate mineralized extensions on the Adit zone. These anomalous zones were never tested primarily due to a declining copper market.

The purpose of the present drill program was to test the westerly extension of the Adit zone. The control portion of the zone approximately 150 feet west of the westernmost drill hole was selected as one of the drill sites(79-1). The second drill hole(79-2) was spotted 100 feet west of 79-1. These locations were also selected in order to test an anomalous I.P. zone.

This report will be restricted to information on the drill program. For a description on the geology and other pertinent information as to history of the Fairweather Hills property, reference should be made to the writer's report on the property dated April 18, 1978.

PROPERTY

The property is comprised of one located claim consisting of eight units. Particulars are as follows:

<u>Claim Name</u>	<u>Units</u>	<u>Record No</u>	<u>Expiry Date</u>
Lisa #1	8	318	August 23, 1979

LOCATION AND ACCESS

The property is situated 30 miles north of Princeton and 20 miles south of Merritt, B.C. within the Nicola M.D. The claims are directly west of Alleyne Lake.

Access is via a secondary road--Bates road--branching off to the east from the No. 5 Princeton - Merritt highway 20 miles south of Merritt.

DIAMOND DRILLING

The drill program commenced on July 14, 1979 and was completed on July 25, 1979. The program consisted of two drill holes for a total of 453 feet. Particulars are described as follows:

D.H. 79-1

Purpose: To test the westward extension of the mineralized zone and to test an I.P. anomaly.

Location: 41 + 71 N 20 + 32 W

Dip: -90°

Depth: 203 feet

Mineralization: Chalcopyrite blebs at 142'-145', 151'-155'
Native copper blebs at 171'

Assays: Assays of selected samples ranged from .0146% Cu to .0369% Cu in addition to a Tr of Ag/ton to .82 oz Ag/ton

Comments: Although assays of drill hole sections indicated an above average background copper value, significant zones of mineralization comparable to the mineralized Adit zone were not intersected. An unusually high silver assay (.82 oz Ag/ton) could reflect mineral zoning adjacent to the Adit zone. An intersection suggesting a structural continuation of the ore zone to the west was not indicated.

D.H. 79-2

Purpose: To test an I.P. anomaly to the west of the Adit zone which is open to the west.

Location: 45 + 75 N 21 + 35 W

Dip: -90°

Depth: 250 feet

Mineralization: Native copper blebs on fractures at 104'-105', 123', 133.5'. Chalcopyrite splash at 166'

Assays: Assays of selected core samples ranged from .0174% Cu to .0270% Cu

Comments: Diminishing copper mineralization to the west of the Adit zone, as indicated in D.H. 79-1, was confirmed in this drill hole.

The core is stored at the writer's residence - 3812 West 16th Avenue, Vancouver, B.C.

CONCLUSIONS

A significant step out (200 feet) to the west of the Adit zone confirmed that an extension of copper mineralization to this location was not evident. Decreasing copper content an additional 100 feet west indicated a more distal directional trend. Sufficient assays on Ag content were not available to determine a possible zoning pattern, however a local significant silver assay possibly indicates proximal mineral zoning to the Adit zone.

A causitive source of the I.P. anomaly which was tested by D.H. 79-1 and D.H. 79-2 was not determined. However occasional disseminated pyrite present in the core could have been reflected by the I.P. anomaly.

RECOMMENDATIONS

A continuing diamond drill program on the Adit zone is recommended. At this stage the program should be restricted to testing the northern extension of the zone where a continuation to the mineralization is indicated.

Future drilling should be based on less than 50 foot step-outs from the known ore zone in addition to a depth sufficient to test the indicated extension which in this case should be less than 100 feet.

Selected sites, as shown on the accompanying plan, would be north of section 41 + 75 N and west of P9 and DDH1. Drill hole No 1 in this series would be located 40 feet west of DDHL with a projected depth of 50 feet. Additional drill sites would be selected on the basis of the completed drill results however, at this time they are proposed as indicated.

Respectfully submitted



L. SOOKCHOFF, P. Eng.
Consulting Geologist

CERTIFICATE

I, Laurence Sookochoff, of the City of Vancouver, in the Province of British Columbia, do hereby certify:

That I am a Consulting Geologist with the firm of Pan-American Consultants Ltd. of 2602-1055 West Georgia Street, Vancouver, B.C.

I further certify that:

1. I am a graduate of the University of British Columbia (1966) and hold a B.Sc. degree in Geology
2. I have been practising my profession for the past thirteen years.
3. I am registered with the Association of Professional Engineers of British Columbia.

Laurence Sookochoff, P.Eng.
Consulting Geologist

August 8, 1979
Vancouver, B.C.



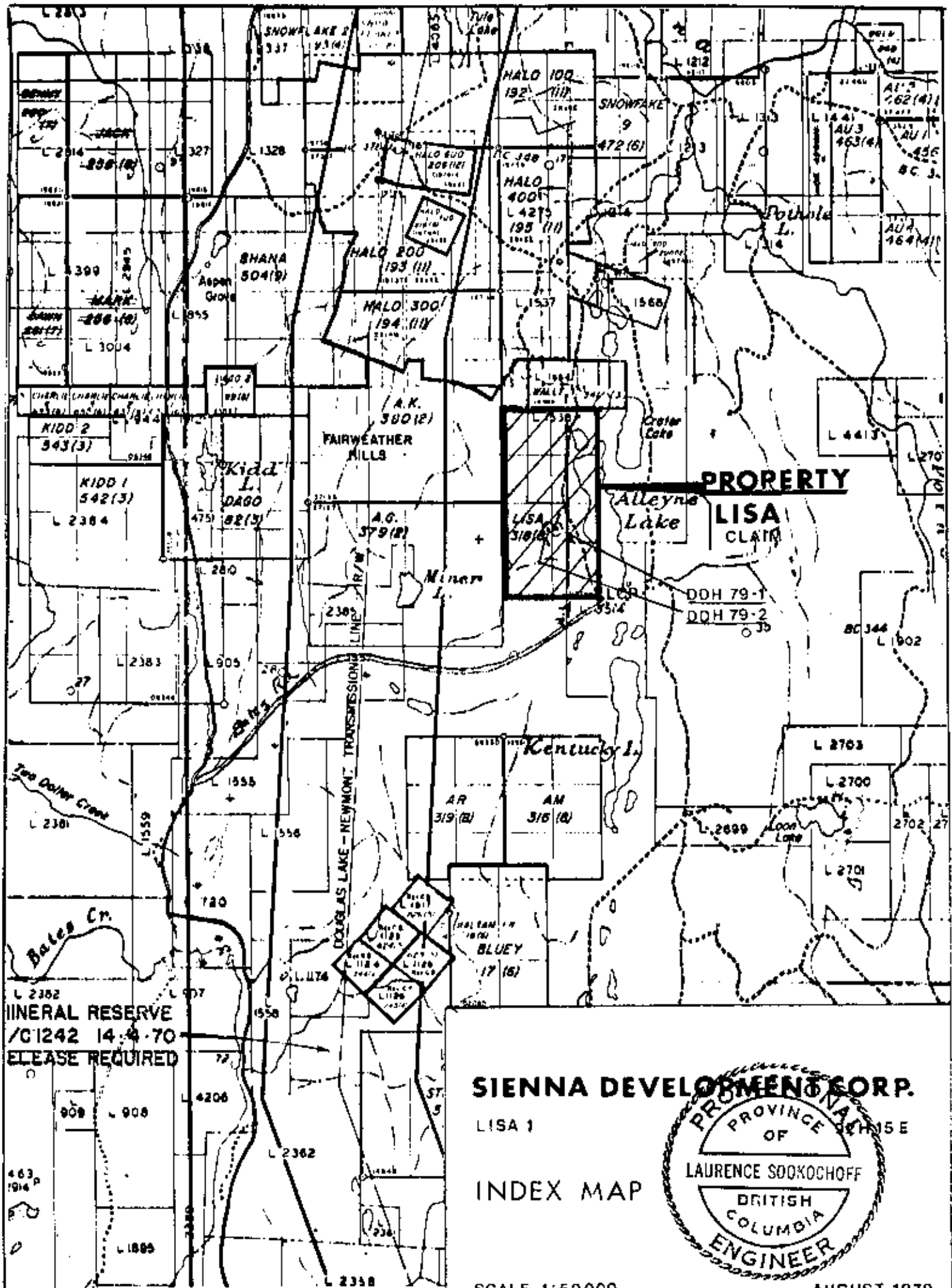

MINERAL RESERVE
/G1242 14-8-70
RELEASE REQUIRED

SIENNA DEVELOPMENT CORP.

LISA 1

INDEX MAP



SCALE 1:50000

AUGUST 1979

RAYMOND DRILLING & EXPLORATION COMPANY LTD.

1028 - 510 WEST HASTINGS
VANCOUVER B.C. V6B 1J6

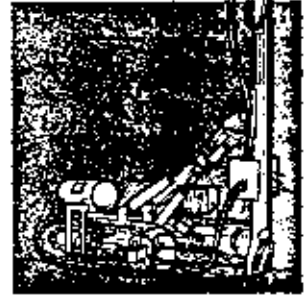

July 30, 1979.

Phone: (604) 669-6443
(604) 733-1446

TO: SIENNA DEVELOPMENT CORPORATION
3rd floor, 555 Howe St.
Vancouver, B.C.

I N V O I C E

Preparationn Drill Site & Building & Clearing	
road - hole # 1 - July 12 - 17 (2 men)	
@ \$300.00 / day	\$ 1,800.00
- hole # 2 - July 20 - 23 (3 men)	
@ \$450.00 / day	1,800.00
Drilling - 453 feet @ \$20.00/foot	<u>\$ 9,060.00</u>
	\$12,660.00
 Paid on account:	
July 13, 1979	\$6,000.00
 Balance to date	 <u><u>\$ 6,660.00</u></u>

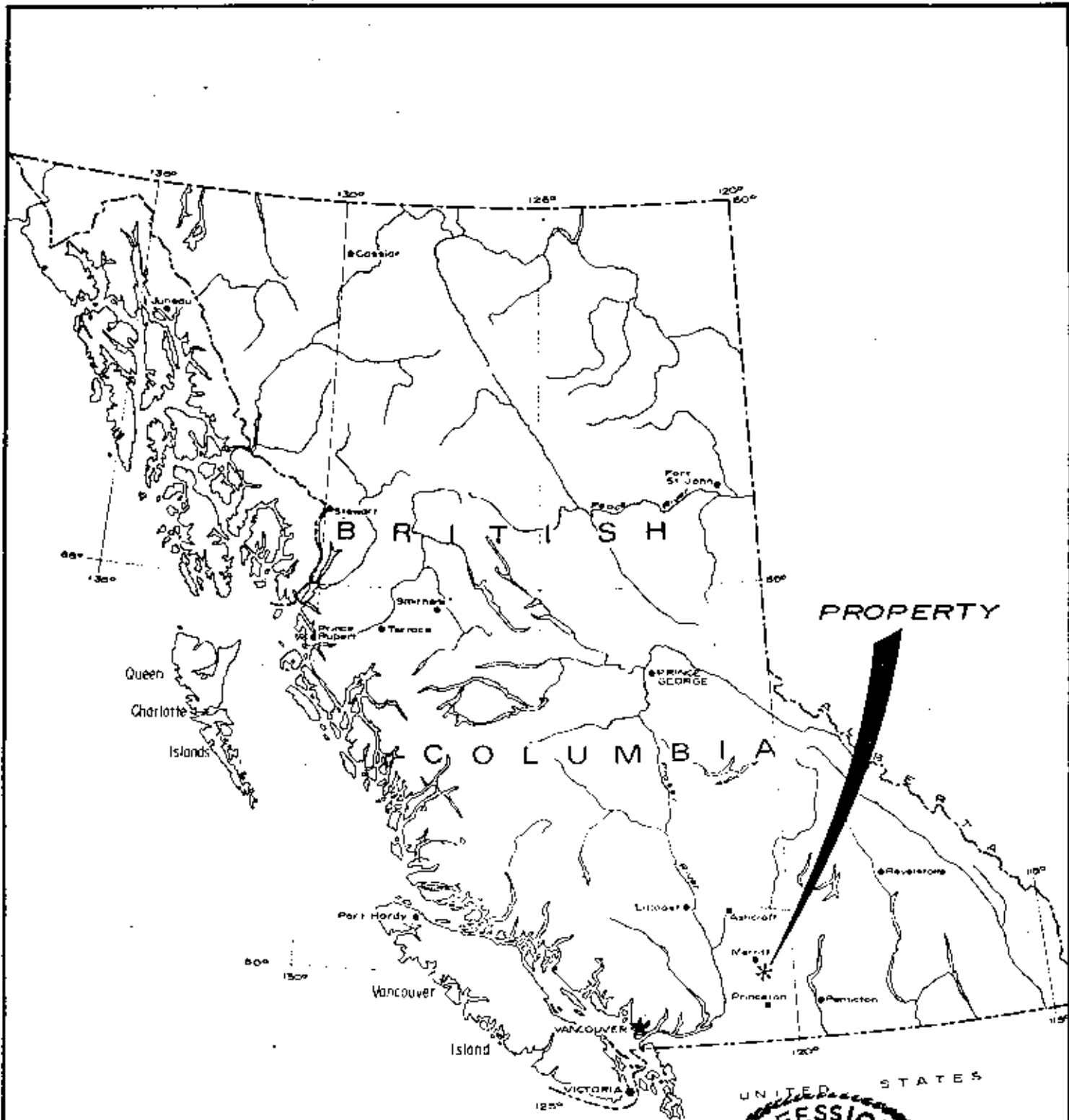

PROPERTY



SIENNA DEVELOPMENT CORPORATION
 FAIRWEATHER HILLS PROPERTY
 LOCATION MAP



DIAMOND DRILL SAMPLING RECORD

Property Fairweather Hills

Started July 22, 1979

Finished July 25, 1979

Logged by L. Sookochoff, P. Eng.

Bearing Dip at Collar -90° Hor. Comp. Ver. Comp.

Location Elevation Lat. 41+75N Dept. 21+35W

Purpose of Hole

DIP TESTS	Hole No. <u>79-2</u>
	Sheet No. <u>1</u>

Distance		DESCRIPTION	Sample No.	Length Location Ft.	Core Recovery %	Analysis		PROGRESSIVE TOTALS					
From	To					Cu ppm		FEET & PER CENT					
0	5	Casing											
5	250	Agglomerate - Rounded to sub-rounded fragments (< 2 inches) of intrusive (dioritic) and volcanic (red and green) in a matrix of m.g. texture feldspar porphyry with phenos < .1 cm in a semi trachytic orientation. Varying amounts of red hematite. Occ. to mod. chloritic alteration	05	24		180							
		Fractures 50' 45° with cal.	04	52		192							
		to 80 40° to 62° with cal.	12	56		214							
		148 60° 85° 45°	07	71		218							
		Calcite stringers: increasing from 60' to 111'	11	103-5		186							
		Epidote rare to 80 str. @ 105	01	117		270							
		Native Cu diss. on fractures 104-105 123, 133.5											
		Cpy splash 166	14	133.5		148							
		Pyrite diss. 162, 221-250											
		Calcite stringers rare 130-170 mod. 180-230	03	166		174							
		225 Serpentine on fr. @ 45°											
		Sericite blebs rare 5-56, 130-148											
		107 K feldspar in intrusive frags. 107-119 broken	13	215		220							
		Mn. on fr.: lt. 62-110; heavy 110-150 rare 175-225	06	235		176							

MILLER MINERALS BRANCH
DIAMOND DRILL REPORT

7654

NO.



Property Omega Development Ltd.
Fairweather Hills

DIAMOND DRILL SAMPLING RECORD

DIP TESTS

Hole No. 79-1
Sheet No. 1.

Started July 14, 1979
Finished July 21, 1979
Logged by L. Sookochoff, P.Eng.

Bearing Dip at Collar -90° Hor. Comp. Ver. Comp.
Location Lisa #1 Elevation Lat. 41+71N Dept. 20+32W
Purpose of Hole Test I.P. Anomaly

Distance		DESCRIPTION	Sample No.	Length Ft.	Core Recovery %	Analysis			PROGRESSIVE TOTALS				
From	To					Cu %	Cu ppm	Ag oz/ton	FEET & PER CENT				
0	2	Casing			96								
2	203	Agglomerate - Rounded to sub-rounded fragments < 2 inches of intrusive and volcanic (red and green) in a matrix of m.g. feldspar porphyry flow. Mikish white euhedral semi trachytic phenocrysts < .1."			overall								
		Fractures : 50' 40°, 55°, 70°, 82°	09	25			146		Tr				
		96' 30°, 55°, 85°	433	48.5		.02							
		175' 25°, 45°, 80°	16	62			146						
			434	68-72		.01			Tr				
			15	91			360						
			435	103		.01			.82				
		Py increasing from 100 to 122	02	113				270					
		Cpy blebs 142-145											
		151-155											
		Native Cu rare blebs on fr. planes @ 171'											
		Py 175 to 190	18	125				160					
		Lt calcite stringers throughout - heavier @ 141-165			50								
			17	142-5				184					
		Rare to occ. sercite blebs 28-52	10	171				354					
		occ 52-70	19	186				244					
		rare 118-125	08	188-190				208					
		mod. 125-140											
		Red hematite throughout (diss. and coating) with intermittent barren sections											
		Mn on fractures throughout - heaviest 104-170											
		203 End of hole											

MINERAL RESEARCH
AGGLOMERATE REPORT
7654
NO.



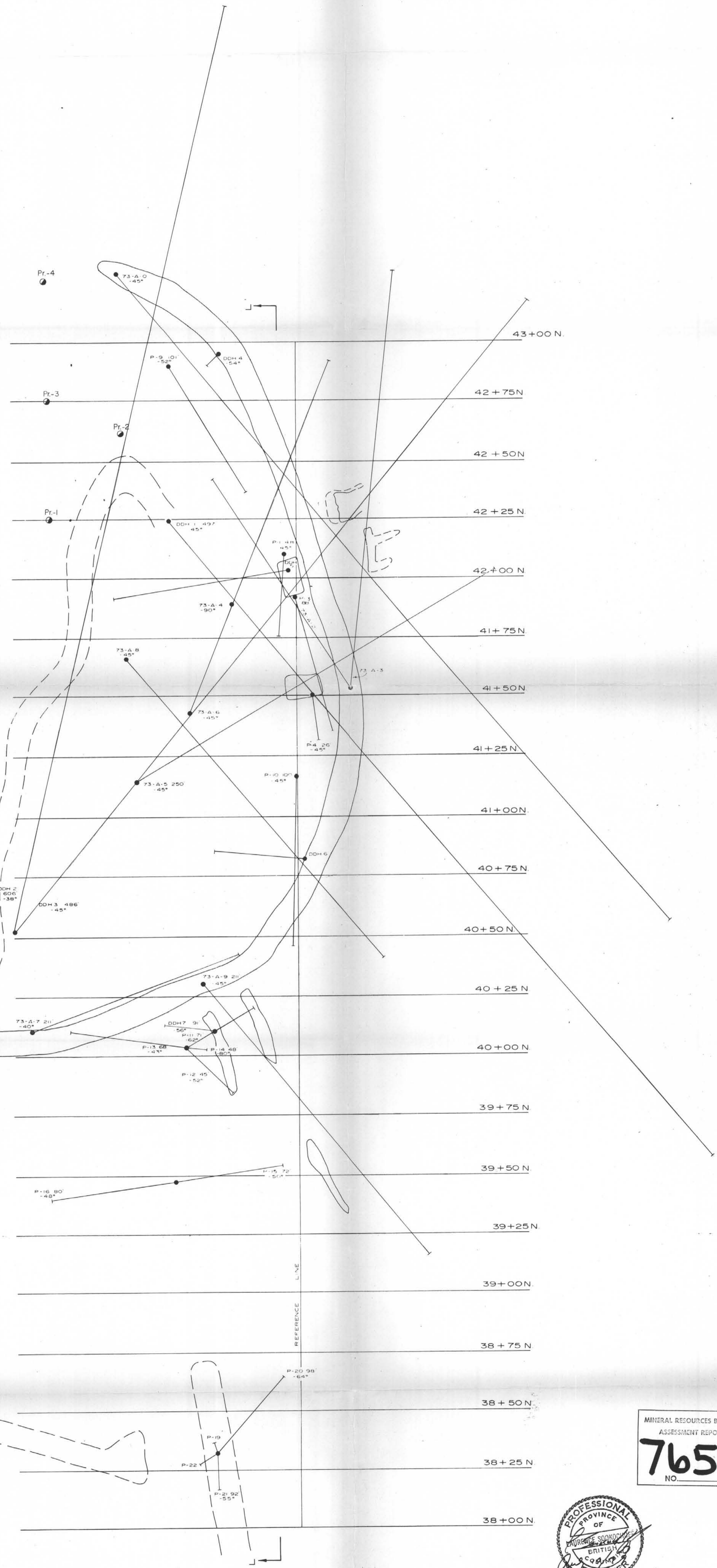
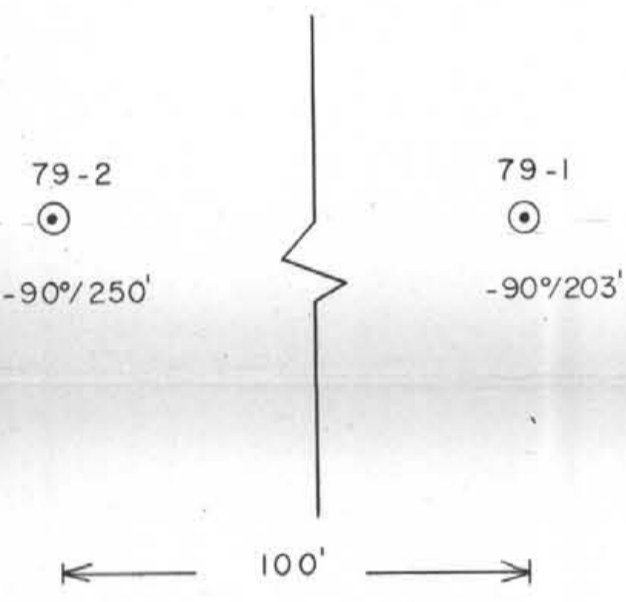

- LEGEND**
- Road and/or Trench
 - Trench
 - 79-1
 - Drill Hole, 79 Series
 - Pr-1
 - Proposed Drill Holes

To accompany Diamond Drill Report on
The Fairweathers Hill property by L.Sookochoff
Dated August 8, 1979

SIENNA DEVELOPMENT CORPORATION
PLAN OF DRILL HOLE LOCATIONS
ADIT ZONE

FAIRWEATHER HILLS PROPERTY

NICOLA MD, B.C.

SCALE 20 0 20 40 FEET
APRIL, 1978

MINERAL RESOURCES BRANCH
ASSESSMENT REPORT
7654
NO.

