

79-#555-#7674

Geochemical Assessment Report

on the

Likely Group

(Peso, Peso B and Peso E mineral claims)

located

8 km southeast of Likely, B.C.

Cariboo Mining Division

Latitude 52°35'N., Longitude 121°29'W

Field work between September 11 and September 17, 1979.

on behalf of

AQUARIUS RESOURCES LTD.

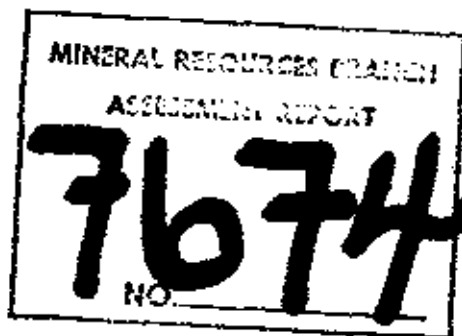

Report by

D. R. Cochrane, P. Eng.,
November 26, 1979,
Delta, B. C.



Cochrane Consultants Limited
4482 Delta St., Delta, B.C. V4K 2T8 248-8221
Geotechnical Consulting / Exploration Services

geology
geophysics
geochemistry

TABLE OF CONTENTS

	Page
INTRODUCTION	1
LOCATION AND ACCESS	2
CLAIMS INFORMATION	3
BACKGROUND	4
REGIONAL GEOLOGY	6
LOCAL GEOLOGY	7
WORK DONE	11
FIELD PROCEEDURE	12
RESULTS OBTAINED	13
DISCUSSION	14

FIGURES

1.	Location Map	Report body
2.	Claims Map	" "
3.	Geochemical Data (Au, ppb)	Map pocket
4.	Geochemical Data (Pb, ppm)	" "
5.	Geochemical Contours (Au)	" "
6.	Geochemical Contours (Pb)	" "

APPENDICES

I	Assessment Work Details
II	Bibliography
III	Certificate
IV	Analytical Report



INTRODUCTION

In September, 1979, an Aquarius Resources Ltd. field crew conducted a geochemical survey on a portion of the Likely Group, and specifically the Peso B mineral claim, located approximately 8 km southeast of Likely, in southcentral British Columbia.

This report describes work done, results obtained, and was prepared for assessment work credits. Assessment work details are set out in Appendix I at the end of the report.

This report is based on field work carried out by the Aquarius Resources Ltd. field crew under the supervision of Mr. J.A. Stewart.



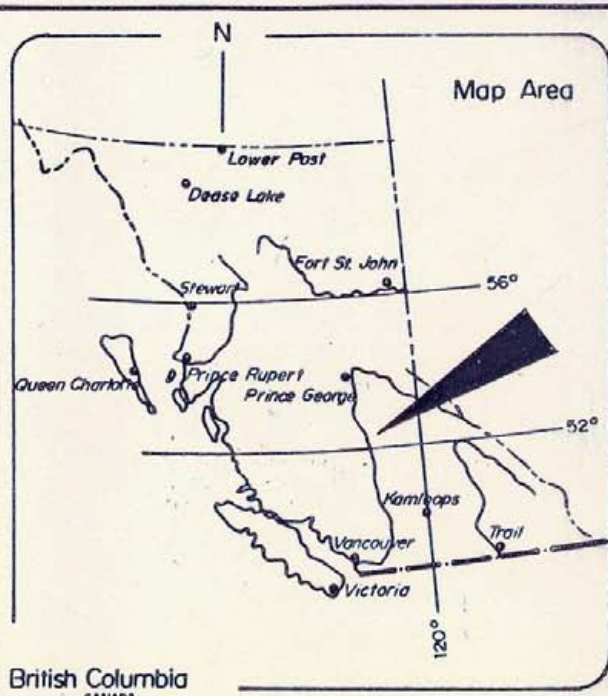
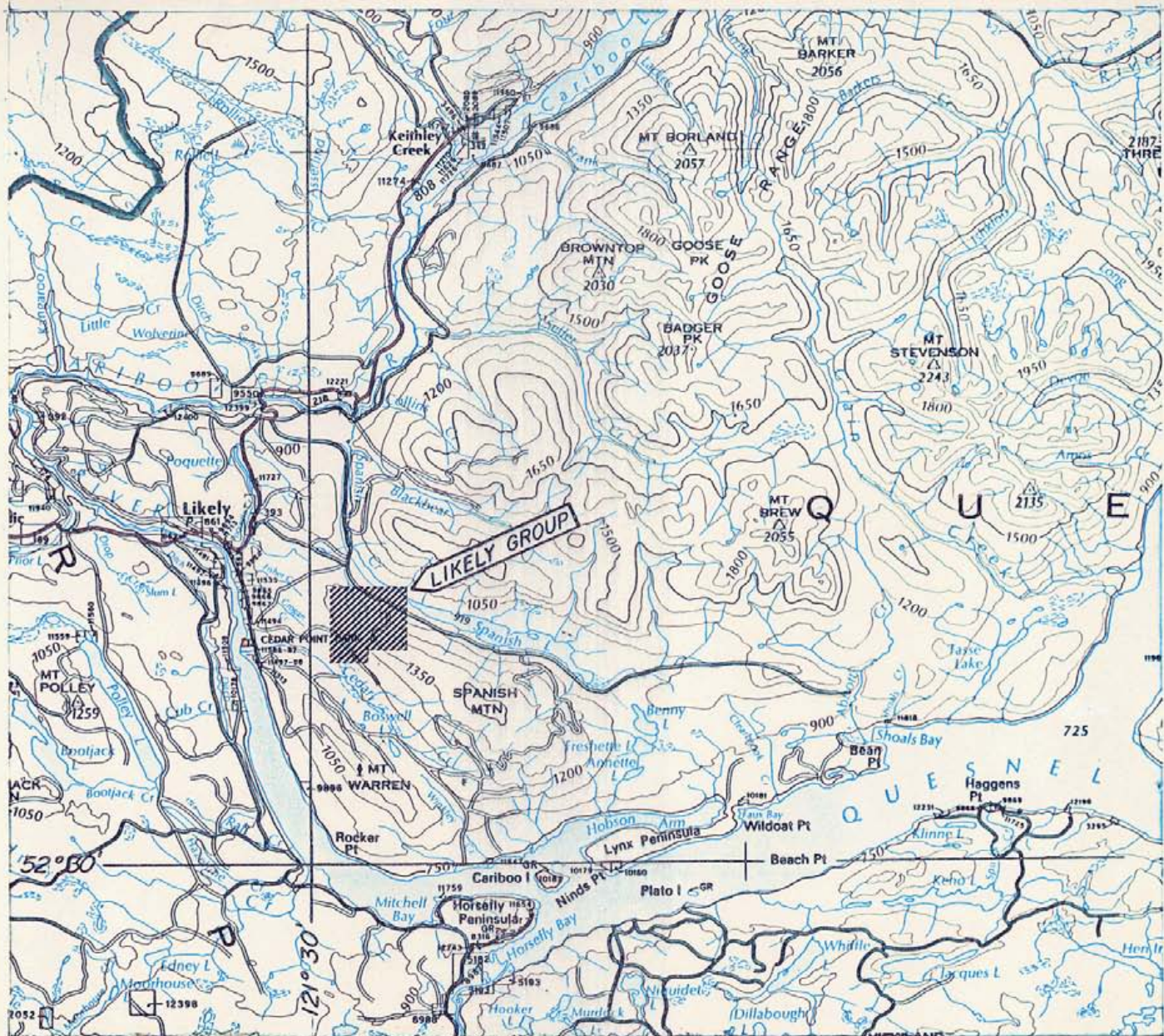

AQUARIUS RESOURCES LTD.

Lively Group Spanish Mtn. Cariboo Mining Division
 Peso Claims Near Lively, B.C. N.T.S. 93A/11 & 12

Figure 1
 Location Map

Scale : 1 to 250,000 or 1 inch equals approx. 4 miles.

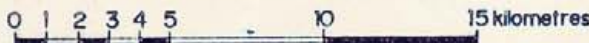

LOCATION AND ACCESS

The Likely Group is situated on the northwest flank of Spanish Mountain, between Cedar Creek and Spanish Creek, approximately 8 km east of Likely, in the historic Cariboo area of central British Columbia.

Good access is by truck from highway 97, and 150 Mile House, thence 75 km north northwest along a good gravel road to Likely. The property is then 8 km east on a good logging road.

The N.T.S. reference for the area is 93A/11W., latitude 52°35'N., longitude 121°29'W.



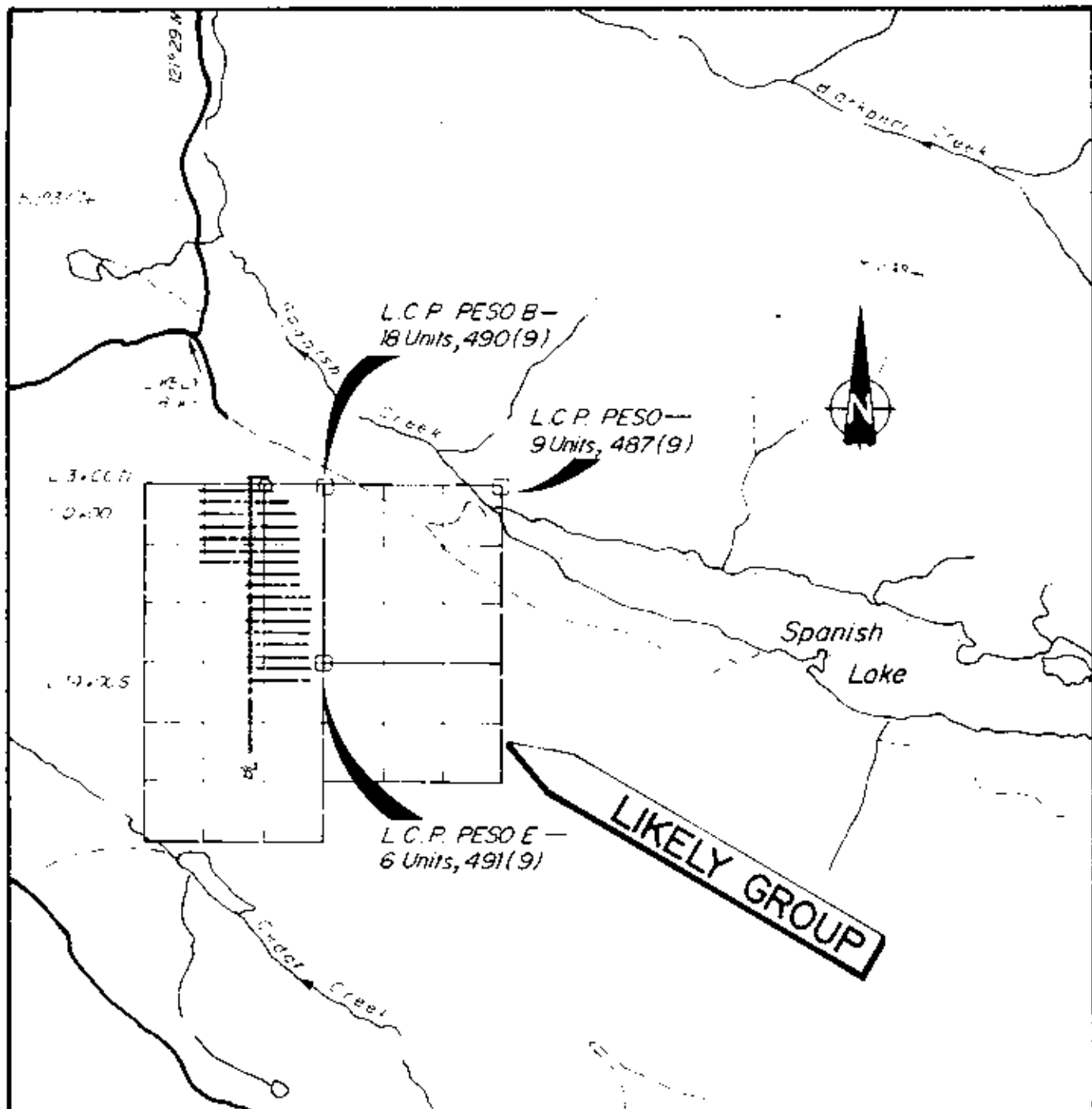

AQUARIUS RESOURCES LTD.

Likely Group

Peso Claims

Spanish Mountain

Near Likely, B.C.

Coriboo Mining Division

NTS.93A/118/12

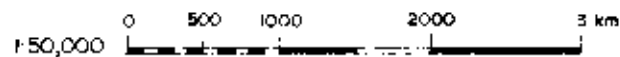

CLAIMS MAP

FIG. 2



CLAIMS INFORMATION

The Likely Group consists of the Peso, Peso B, and Peso E modified grid system mineral claims located in the Cariboo Mining Division. Title to the Peso claim is held by R.E. Mickle of Powell River, B.C.; title to the Peso B and Peso E claims are held by Longbar Minerals Ltd. of Powell River, B.C. One hundred per cent interest in all three claims is in the process of being transferred to Aquarius Resources Ltd. of Edmonton, Alberta. Details are listed in the following table:

LIKELY GROUP

Claim name	Units	Record No.	Anniversary Date	Expiry Date before credits	Expiry Date after credits
Peso	9	487	September 21	1981	1981
Peso B	18	488	September 21	1979	1981
Peso E	6	481	September 21	1979	1981



BACKGROUND

Small placer operations were carried out in this area during the 1860's but no large scale mining was done. Interest revived in the 1920's with production from Spanish Creek to the north and Cedar Creek to the south. Desultory placer work has continued to the present, including some workings on Spanish Mountain.

Gold-bearing quartz veins were discovered on the northeast side of Spanish Mountain in 1933. The veins vary from a few centimetres up to 0.8 metres in width. *One sample from a vein 20 centimetres wide assayed 0.10 oz per ton in gold and 1.4 oz per ton in silver.

Fairly extensive work has been done on this area since 1933. Two adits were driven into sparsely mineralized quartz veins which are 2-5 metres thick. Up to 1947 several hundred feet of diamond drilling had been carried out in the area in search of mineralized quartz veins. The only



significant mineralization was found in the narrow quartz veins which have been exposed by trenching at several places. *Assays of selected samples of this type of vein gave values up to 5.88 oz per ton in gold and 32 oz per ton in silver. A 4 ton shipment of selected ore from surface cuts returned 8 oz of gold, 40 oz of silver, 32 lb of copper.

No significant work has been carried out since 1947 although local residents report intermittent activity.

* See bibliography for references.



REGIONAL GEOLOGY

The main feature of this area is a major fault trending NW-SE, parallel to the main fold axis. At the west end of Spanish Lake this fault swings to a WNW-ESE trend and parallels the lake along the northeast flank of Spanish Mountain. A number of smaller faults are parallel to the latter section of the major fault on its northeast side.

The fault separates Middle Jurassic or Cretaceous andesitic tuff, argillite, chert and conglomerate from Cambrian phyllite, slate and argillite. The latter lie on the north side of the fault and form part of the Cariboo Group which underlies the goldfields of the Yanks Peak area 30 km to the north.

The gold showings on Spanish Mountain are found in the area where the major fault changes strike.



LOCAL GEOLOGY

An excellent description of the local geology is given by A.L. Littlejohn, Geologist, in an assessment report dated September 30, 1977, on behalf of Longbar Minerals Ltd. (now Aquarius Resources Ltd.) and is reproduced in full below:

"The main rock type on Spanish Mountain is a dark grey, fine grained phyllite which is interbedded with impure quartzite horizons of varying thickness and extent. The strike is parallel to the major fault and the rocks dip moderately to the south. Dolomite occurs towards the crest of Spanish Mountain ridge. A medium-grained quartz-felspar dyke, striking NE - SW across the phyllites, was observed in a trench at 4,000 ft. elevation."

"There are two systems of quartz veins. At 3,900 ft. elevation a vein varying in thickness from 1 to 5 m can be traced for 250 m along the strike. It strikes E-W and dips 60 degrees south. A second vein lies 30 ft.



below this and may represent a faulted portion of the main vein, since both are highly fractured, have the same mineralogy and the country rock at the contacts is highly sheared. The veins contain scattered patches of cubic pyrite (often altered to limonite) in open spaces and muscovite. Minor galena is also present. Most of the mineralization is at the contacts. Gold was panned from this vein system, although none was observed. Two adits (now inaccessible) have been driven into these veins. At 4,200 ft. elevation there is another massive quartz vein exposed (partly by trenching) for 30 m. It is about 8 m thick and strikes NW - SE. It's attitude could not be determined. It is highly fractured and shattered and is sparsely mineralized with pyrite."

"The second quartz vein system consists of a series of narrow (0.1 - 0.8 m) veins which strike NE-SW (approximately at right angles to the major fault) and dip 50-70 degrees to the west. Where exposed along road cuts and in trenches they are seen to be rather discontinuous, although one was traced over a length of 120 m. They are generally spaced several metres apart and the thicker ones are tens of metres apart. At least 15 such veins were found over a 40,000 square metre area. The



veins appear to be gash veins, filling fractures in the country rock. Often they are highly fractured themselves."

"The veins are mineralized with gold, silver, pyrite, galena and tetrahedrite. Pyrite occurs in cubic and prismatic aggregates which have usually weathered out to produce a honeycomb structure. This feature is particularly evident at the contacts and extends into the wall rock for a few centimetres, especially if the rock is argillaceous. Many of the cavities are lined with quartz on which the pyrite striations have been imprinted. Thin flakes of gold are found within these cavities and occasionally gold can be seen embedded in limonite. Gold and silver can be panned from the quartz. Alteration in the area is pervasive and has affected all rock types. Pyrite cubes up to 3 cm in diameter give the rocks a mottled appearance, especially the lighter coloured quartzites. In the phyllites, pyrite also forms small pods and stringers. Pyrite mineralization does not appear to favour one particular rock type. This type of mineralization is widespread, being found in argillites on the north side and east end of Spanish Lake. The



association of gold and pyrite is evident in the quartz veins and in the placer workings of Cedar Creek. Pyrite usually has a thin coating of red haematite and more often than not is completely oxidized to limonite. The presence of quartz linings in the pyrite cavities suggests that some silicification has occurred in association with the quartz veining, but this appears to be local."

"A second type of alteration is carbonatization. Ankerite occurs as discrete, brown grains with oval or diamond-shaped cross-section in dolomite and quartzite and in the intrusive dyke. It adds to the already mottled appearance of the rocks. Carbonate minerals also occur in patches within the rock groundmass. It is suspected that rock noted as dolomite in the field, may in fact be highly altered quartzite or intrusive. A malachite-like green mineral occurs in scattered patches, noticeable in the lighter coloured rocks."



WORK DONE

The 1979 work on the Likely Group (and specifically the Peso B claim) was carried out by a three (3) fieldperson, one helper, crew supervised by Mr. J.A. Stewart, prospector. Work included the establishment of eleven (11) km of ground control flag and blaze grid with cross lines 100 m apart and stations at 25 m intervals, the collection of 426 upper "B" horizon (where possible) soil samples; and a tie in of physical features including claim posts, old workings, trenches, adits, dams and creeks.

Several hand specimens were collected by Mr. Stewart, one of which was geochemically analyzed.



FIELD PROCEDURE

Two two-person sample teams were deployed with compass, chain, axe and standard kraft paper sample bags. Soil stations were dug to a depth of several decimetres with a grub hoe and samples were bagged. Soil samples were strung and air dried at the motel at the end of each day's work. Mr. Stewart supervised these teams and traversed the grid area and old roads inspecting old workings, trenches, etc. and examining hand specimens one of which was geochemically analyzed for gold (190 ppb) and lead (3400 ppm). At the end of the project the samples were sealed in cardboard cartons and delivered to Min-En Labs Ltd. of North Vancouver, upon immediate return, where they were analyzed for gold and lead.



RESULTS OBTAINED

Gold in soils ranged from a low of less than 5 parts per billion (ppb) to a high of 6000 ppb. A frequency histogram of 115 random samples was plotted and the resulting curve was skewed right with the 45 to 60 ppb class and 90 to 105 ppb class not conforming (exceeding normal distribution). The geochemical data map was subsequently contoured at the 45 ppb and 90 ppb intervals and accompanies this report. The arithmetic mean was 75 ppb and standard deviation a rather high 158.

Lead in soils ranged from a low of 2 parts per million (ppm) and high of 77 ppm. The resulting frequency histogram illustrated a curve of normal distribution with the 32 to 36 ppm and 40 to 44 ppm population classes exceeding the normal. 115 random samples were taken; the arithmetic mean was 20 ppm and the standard deviation was 9. The geochemical data map was contoured at the 32 and 40 ppm levels and accompanies the report.



DISCUSSION

The average gold content, and range of values in upper "B" horizon soils on the Peso Claims is exceedingly high. Geochemical soil sampling and analysis for gold appears to be an excellent exploration tool in this area. The most impressive anomaly (above 90 ppb) lies along and close to the base line at the north end of the grid area. This area should be trenched, mapped and sampled.

Respectfully submitted

A handwritten signature in black ink, appearing to read 'D. R. Cochrane', is written over a faint circular stamp. The signature is fluid and extends to the right.

D. R. Cochrane, P. Eng.

November 26, 1979,

Delta, B. C.



APPENDIX I

ASSESSMENT WORK DETAILS

Personnel and Dates Worked:

J. A. Stewart, prospector,	September 11 to 17, (incl.) 1979
Three field persons,	" " " "
One helper	" " " "
Draftsperson and Typist	September 11, 17, and 21, 1979 and various dates during data reduction and report preparation.
D. R. Cochrane, P. Eng.	Various dates throughout project and report preparation.

COST STATEMENT:

J. A. Stewart, 7 days at \$200/day	\$ 1,400.00
Field person, 7 days at \$75/day	525.00
Field person, 7 days at \$75/day	525.00
Field person, 7 days at \$75/day	525.00
Helper, 7 days at \$50/day	350.00
Food,	420.00
Accommodation,	357.00
Vehicles, two 4 x 4's, 7 days at \$35/day...	245.00
Mileage, 2824 km at \$0.15/km	423.60
Drafting, office time, 32 hrs at \$13.50/hr	432.00
Typing, 5 hrs at \$10/hr	50.00
Report preparation, D. R. Cochrane 2 one half days at \$200/day	200.00
Reproduction, collation, binding	100.00
426 soil sample analysis, Au and Pb at \$6 ea.	2,556.00
Misc. expenses,	<u>108.00</u>
Total	\$ 8,216.60

APPENDIX I (cont'd)

COST DISTRIBUTION

Total Project Cost		\$ 8,216.60
2 years credits to Peso B		
(18 units) at \$100/unit/year	\$3600.00	
2 years credits to Peso E		
(6 units) at \$100/unit/year	<u>\$1200.00</u>	<u>4,800.00</u>
Work credited to Aquarius Resources		
P.A.C. account		\$ 3,416.60



APPENDIX II

REFERENCES:

B. C. Minister of Mines Annual Reports

1923 pg 124-130
1924 pg 119-126
1933 pg. 134-135
1947 pg 123-127

Campbell, R.B.

1961: Quesnel Lake Map Sheet (93A/W)

Littlejohn, A.L.

Sept. 1977 : Assessment Report on the Peso Claims.



APPENDIX III

CERTIFICATE

I, Donald Robert Cochrane, of the Municipality of Delta, British Columbia, do hereby certify that:

1. I am a consulting geological engineer with an office at 4882 Delta Street, Delta, B.C. V4K 2T8
2. I am a graduate of the University of Toronto (1962) with a degree in Applied Geology (B.A.Sc.) and a graduate of Queen's University (1964) with a degree in Economic Geology (M.Sc., Eng.).
3. I have practiced my profession continuously since graduation while being employed by such companies as Noranda Exploration Co. Ltd., Quebec Cartier Mines, and Meridian Explorations Syndicate. I have been in private independent practice since 1969.
4. I have no interest, either direct or indirect in the properties or securities of Aquarius Resources Ltd., nor do I expect to acquire any such interest.
5. I am a member in good standing of the Association of Professional Engineers (A.P.E.) of the Province of British Columbia, and also a member of the A.P.E. in the Province of Ontario, Saskatchewan, Alberta and the Yukon Territories.

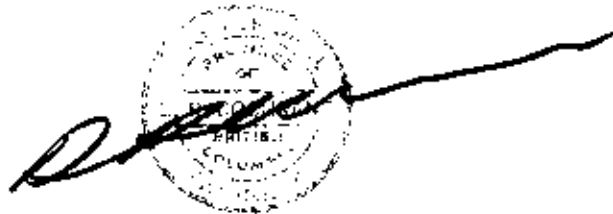

D. R. Cochrane, P. Eng.
November 26, 1979,
Delta, B. C.



APPENDIX IV

ANALYTICAL REPORT



MIN-EN Laboratories Ltd.

705 WEST 15th STREET,
NORTH VANCOUVER, B.C., CANADA V7M 1T2
TELEPHONE (604) 980-5814

ANALYTICAL REPORT

Project **Peso** Date of report **Sept. 25/79.**

File No. **9-669** Date samples received **Sept. 19/79.**

Samples submitted by:

Company: **Aquarius Resources/Cochrane Consultants**

Report on: **461 soils** Geochem samples

Assay samples

Copies sent to:

1. **Aquarius Resources, Powell River, B.C.**
2. **Cochrane Consultants, Delta, B.C.**
3.

Samples: Sieved to mesh **- 80** Ground to mesh

Prepared samples stored discarded

rejects stored discarded

Methods of analysis: **Pb-nitric, perchloric digestion. A.A. Analysis.**

Au-Aqua Regia. A.A. Analysis.

Remarks:

SPECIALISTS IN MINERAL ENVIRONMENTS

COMPAN

"qu" tur Des "cc"
Cochrane Consultants

GEOCHEMICAL ANALYSIS DATA SHEET

PROJECT No: Peso

MIN - EN Laboratories Ltd.

705 WEST 15th ST. NORTH VANCOUVER, B.C. V7M 1T2
PHONE (604) 980-5814No. 9-669DATE: Sept. 251979

ATTENTION:

Sample Number	6 % ppm	10 % ppm	15 % ppm	20 Pb ppm	25 Zn ppm	30 Ni ppm	35 Ca ppm	40 Ag ppm	45 Fe ppm	50 Hg ppb	55 As ppm	60 Mn ppm	65 Au ppb	70	75	80
Bl	85	90	95	100	105	110	115	120	125	130	135	140	145	150	155	160
PL0+00				37				.					200			
				26				.					150			
				21				.					55			
				23				.					45			
				23				.					25			
				29				.					95			
				34				.					10			
				10				.					65			
				12				.					5			
				20				.					25			
				46				.					55			
				25				.					200			
				13				.					65			
				22				.					110			
				19				.					65			
PL0+00				21				.					10			
PL1+00				24				.					15			
				35				.					120			
				no. sample				.					no. sample			
				32				.					90			
				17				.					50			
				24				.					95			
				16				.					65			
				31				.					110			
				24				.					55			
				25				.					25			
				22				.					40			
				29				.					240			
				18				.					45			
PL1+00				25				.					90			

CERTIFIED BY: 

GEOCHEMICAL ANALYSIS DATA SHEET

PROJECT No. Peso

MIN - EN Laboratories Ltd.

DATE: Sept. 25

705 WEST 15th ST., NORTH VANCOUVER, B.C. V7M 1T2
PHONE (604) 980-5814

ATTENTION:

1979

Sample Number	Pb ppm	Zn ppm	Ni ppm	Co ppm	Ag ppm	Fe ppm	Hg ppb	As ppm	Mn ppm	Au ppb
PL1+00N3+7.5W	19									40
PL1+00N4+0.0W	16									70
PL4+00S0+2.5E	15									80
0+5.0E	17									65
0+7.5E	13									10
1+0.0E	16									15
1+2.5E	23									5
1+5.0E	18									20
1+7.5E	24									15
2+0.0E	19									220
2+2.5E	28									5
2+5.0E	20									65
2+7.5E	24									20
PL4+00S3+0.0E	21									10
PL2+00N0+2.5W	25									25
0+5.0W	37									260
0+7.5W	28									300
1+0.0W	22									110
1+2.5W	21									65
1+5.0W	34									5
1+7.5W	18									25
2+0.0W	21									35
2+2.5W	11									5
2+5.0W	18									210
2+7.5W	19									60
3+0.0W	32									220
3+2.5W	26									170
3+5.0W	22									125
3+7.5W	15									45
PL2+00N4+0.0W	16									120

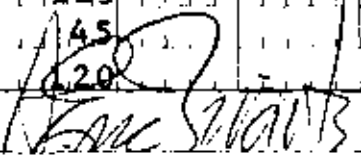
CERTIFIED BY: 

GEOCHEMICAL ANALYSIS DATA SHEET

PROJECT No.: Peao

MIN - EN Laboratories Ltd.

DATE: Sept. 25
1979.

705 WEST 15th ST., NORTH VANCOUVER, B.C. V7M 1T2
PHONE (604) 980-5814

ATTENTION:

Sample Number	6 Pb ppm	10 Zn ppm	15 Ni ppm	20 Co ppm	25 Ag ppm	30 Fe ppm	35 Hg ppb	40 As ppm	45 Mn ppm	50 Au ppb	55	60	65	70	75	80
PL1+00S0+25E				17									300			
				14									75			
				12									65			
				15									30			
				24									65			
				29									1350			
				30									65			
				39									85			
				26									5			
				40									10			
PL1+00S2+75E				42									65			
PL2+00S0+25E				23									240			
				17									5			
				17									5			
				13									65			
				14									65			
				29									200			
				10									10			
				11									65			
				11									65			
				24									5			
				10									65			
PL2+00S3+00E				15									200			
PL4+00S0+25W				47									50			
				23									5			
				17									5			
				29									500			
				26									10			
				25									25			
PL4+00S1+75W				30									20			

CERTIFIED BY:

[Handwritten signature]

COMPAN

Aquatic Resources
Cochrane Consultants

GEOCHEMICAL ANALYSIS DATA SHEET

No. 9-669

PROJECT No. Paso

MIN-EN Laboratories Ltd.

DATE: Sept. 2

705 WEST 15th ST., NORTH VANCOUVER, B.C. V7M 1T2
PHONE (604) 980-5814

1979.

ATTENTION:

Sample Number	K ⁺ ppm	Na ppm	Pb ppm	Zn ppm	Ni ppm	Co ppm	Ag ppm	Fe ppm	Hg ppb	As ppm	Mn ppm	Au ppb	70	75	80	
81	86	90	95	100	105	110	115	120	125	130	135	140	145	150	155	160
PL4+00	S2+00W		23									45				
	2+25W		15									5				
	2+50W		5									45				
	2+75W		17									20				
	3+00W		44									5				
	3+25W		17									45				
	3+50W		19									5				
	3+75W		14									45				
PL4+00	S4+00W		10									45				
PL3+00	S0+25W		12									10				
	0+50W		13									5				
	0+75W		16									45				
	1+00W		25									45				
	1+25W		21									10				
	1+50W		no sample									no sample				
	1+75W		no sample									no sample				
	2+00W		11									5				
	2+25W		10									65				
	2+50W		10									5				
	2+75W		9									45				
	3+00W		14									5				
	3+25W		15									110				
	3+50W		27									5				
	3+75W		24									45				
PL3+00	S4+00W		20									15				
PL2+00	S0+25W		13									125				
	0+50W		12									560				
	0+75W		11									10				
	1+00W		17									15				
PL2+00	S1+25W		12									45				

CERTIFIED BY:



GEOCHEMICAL ANALYSIS DATA SHEET

PROJECT No.: Peso

MIN - EN Laboratories Ltd.

DATE: Sept. 25

705 WEST 15th ST., NORTH VANCOUVER, B.C. V7M 1T2
 PHONE (604) 980-5814

1979

ATTENTION:

Sample Number	10 ppm	15 ppm	20 Pb ppm	25 Zn ppm	30 Ni ppm	35 Co ppm	40 Ag ppm	45 Fe ppm	50 Hg ppb	55 As ppm	60 Mn ppm	65 Au ppb	70	75	80
81	90	95	100	105	110	115	120	125	130	135	140	145	150	155	160
PL 2+00 S1+5.0W			20									25			
			22									30			
			19									15			
			17									5			
			20									45			
			37									10			
			22									30			
			12									45			
			26									5			
			24									45			
PL 2+00 S4+0.0W			32									5			
PL 1+00 S0+2.5W			19									25			
			22									30			
			16									35			
			26									5			
			30									5			
			18									5			
			18									10			
			22									45			
			17									45			
			16									5			
			18									130			
			16									30			
			16									5			
			17									45			
			22									25			
PL 1+00 S4+0.0W			16									15			
PL 7+00 S0+2.5E			14									45			
			28									30			
PL 7+00 S0+7.5E			14									45			

CERTIFIED BY:

[Handwritten Signature]

COMPAN

Aquarius Resources
Cochrane Consultants

GEOCHEMICAL ANALYSIS DATA SHEET

No. 9-669

PROJECT No: Peso

MIN - EN Laboratories Ltd.

DATE: Sept. 25

705 WEST 15th ST., NORTH VANCOUVER, B.C. V7M 1T2

PHONE (604) 980-5814

1979.

ATTENTION:

Sample Number	6	10	15	20	25	30	35	40	45	50	55	60	65	70	75	80
	X ^o	%	Pb	Zn	Ni	Co	Ag	Fe	Hg	As	Mn	Au				
	ppm	ppm	ppm	ppm	ppm	ppm	ppm	ppm	ppb	ppm	ppm	ppb				
81	86	90	95	100	105	110	115	120	125	130	135	140	145	150	155	160
PL7+00S1+00E			13										5			
			19										50			
			23										25			
			52										15			
			21										10			
			49										15			
			30										20			
			25										25			
			14										10			
			33										60			
			29										40			
			47										5			
			24										20			
			31										45			
			43										45			
			28										20			
PL7+00S5+00E			19										30			
PL8+00S0+25E			21										25			
			16										20			
			27										15			
			24										45			
			18										10			
			17										15			
			20										20			
			22										15			
			17										5			
			17										10			
			18										20			
			23										50			
PL8+00S3+25E			37										180			

CERTIFIED BY: 

GEOCHEMICAL ANALYSIS DATA SHEET

No. 9-669

PROJECT No: **Paso**

MIN - EN Laboratories Ltd.

DATE: **Sept. 2**

705 WEST 15th ST., NORTH VANCOUVER, B.C. V7M 1T2
PHONE (604) 980-5814

1979

ATTENTION:

Sample Number	6 %	10 %	15 %	20 Pb ppm	25 Zn ppm	30 Ni ppm	35 Co ppm	40 Ag ppm	45 Fe ppm	50 Hg ppb	55 As ppm	60 Mn ppm	65 Au ppb	70	75	80
PL 8+00				17				*					15			
				28				*					5			
				24				*					100			
				77				*					145			
				25				*					5			
				20				*					960			
PL 8+00				48				*					170			
PL 10+00				22				*					175			
				18				*					30			
				26				*					100			
PL 10+00				21				*					60			
BL 10+25S				17				*					5			
				23				*					95			
				18				*					45			
				20				*					5			
				25				*					20			
				13				*					15			
				16				*					5			
				13				*					10			
				17				*					160			
				18				*					175			
				20				*					6000			
				16				*					15			
				29				*					55			
				22				*					230			
				11				*					35			
				no sample				*					no sample			
				23				*					30			
				26				*					5			
BL 14+75S				19				*					5			

[Handwritten Signature]

COMPAN

aquatic resources
Cochrane Consultants

GEOCHEMICAL ANALYSIS DATA SHEET

No. 9-669

PROJECT No: Peso

MIN - EN Laboratories Ltd.

DATE: Sept. 25
1979.705 WEST 15TH ST., NORTH VANCOUVER, B.C. V7M 1T2
PHONE (604) 980-5814

ATTENTION

Sample Number	6 Pb ppm	10 Pb ppm	15 Pb ppm	20 Pb ppm	25 Zn ppm	30 Ni ppm	35 Co ppm	40 Ag ppm	45 Fe ppm	50 Hg ppb	55 As ppm	60 Mn ppm	65 Au ppb	70	75	80
B1	85	90	95	100	105	110	115	120	125	130	135	140	145	150	155	160
BL-15+00S				15									20			
15+25S				no sample												
15+50S				34									10			
15+75S				16									15			
16+00S				23									10			
16+25S				20									10			
16+50S				33									10			
16+75S				20									5			
17+00S				22									20			
17+25S				23									15			
17+50S				19									25			
17+75S				17									5			
18+00S				18									10			
18+25S				19									15			
18+50S				no sample												
18+75S				20									25			
19+00S				22									10			
19+25S				18									10			
19+50S				19									15			
19+75S				18									5			
BL-20+00S				23									25			
PL11+00S0+25E				17									15			
0+50E				30									170			
0+75E				26									745			
1+00E				18									15			
1+25E				17									20			
1+50E				34									10			
1+75E				18									20			
2+00E				20									580			
PL11+00S2+25E				17									15			

CERTIFIED BY

GEOCHEMICAL ANALYSIS DATA SHEET

PROJECT No. **Peso**

MIN - EN Laboratories Ltd.

DATE: **Sept. 2**

705 WEST 15th ST., NORTH VANCOUVER, B.C. V7M 1T2
 PHONE (604) 280-5814

1979.

ATTENTION:

Sample Number	Pb ppm	Zn ppm	Ni ppm	Co ppm	Ag ppm	Fe ppm	Hg ppb	As ppm	Mn ppm	Au ppb
6	15	20	30	35	40	45	50	55	60	65
81	90	100	110	115	120	125	130	135	140	145
PL11+00S2+50E	12									65
2+75E	18									20
3+00E	10									15
3+25E	5									15
3+75E	22									15
4+00E	14									415
4+25E	23									50
4+50E	2									45
4+75E	10									20
PL11+00S5+00E	10									5
PL12+00S0+25E	12									55
0+50E	9									40
0+75E	14									5
1+00E	8									50
1+25E	4									80
1+50E	7									5
1+75E	8									15
2+00E	14									15
2+25E	14									10
2+50E	12									65
2+75E	9									15
3+00E	6									60
3+25E	9									25
3+50E	10									5
3+75E	10									35
4+00E	20									20
4+25E	12									545
4+50E	48									45
4+75E	17									290
PL12+00S5+00E	18									15

PROJECT No. Peso

MIN - EN Laboratories Ltd.

DATE: Sept. 25

705 WEST 15th ST., NORTH VANCOUVER, B.C. V7M 1T7
PHONE (604) 980-5814

1979

ATTENTION:

Sample Number	6 X ppm	10 X ppm	15 X ppm	20 Pb ppm	25 Zn ppm	30 Ni ppm	35 Co ppm	40 Ag ppm	45 Fe ppm	50 Hg ppb	55 As ppm	60 Mn ppm	65 Au ppb	70	75	80
81	86	90	95	100	105	110	115	120	125	130	135	140	145	150	155	160
PL13+00S0+25E				17				.					5			
0+50E				12				.					10			
0+75E				7				.					75			
1+00E				14				.					5			
1+25E				6				.					20			
1+50E				23				.					35			
1+75E				12				.					10			
2+00E				8				.					10			
2+25E				22				.					500			
2+50E				13				.					5			
2+75E				21				.					25			
3+00E				19				.					25			
3+25E				22				.					30			
3+50E				20				.					15			
3+75E				33				.					5			
4+00E				25				.					5			
4+25E				42				.					15			
4+50E				21				.					10			
4+75E				36				.					5			
PL13+00S5+00E				17				.					5			
PL14+00S0+25E				17				.					5			
0+50E				no sample				.					no sample			
0+75E				19				.					35			
1+00E				16				.					140			
1+25E				13				.					10			
1+50E				21				.					20			
1+75E				22				.					15			
2+00E				14				.					65			
2+25E				12				.					10			
PL14+00S2+50E				9				.					5			

GEOCHEMICAL ANALYSIS DATA SHEET

PROJECT No.: Peso

MIN - EN Laboratories Ltd.

DATE: Sept. 29

705 WEST 15th ST., NORTH VANCOUVER, B.C. V7M 1T2
PHONE (604) 980-5814

ATTENTION:

1979.

Sample Number	6	10	15	20	25	30	35	40	45	50	55	60	65	70	75	80
	%	%	Pb	Zn	Ni	Co	Ag	Fe	Hg	As	Mn	Au				
	ppm	ppm	ppm	ppm	ppm	ppm	ppm	ppm	ppb	ppm	ppm	ppb				
81	86	90	95	100	105	110	115	120	125	130	135	140	145	150	155	160
PL14+00S2+75E			15										10			
			10										15			
			7										5			
			11										45			
			13										15			
			19										5			
			10										45			
			14										5			
			21										15			
PL14+00S5+00E			12										10			
PL5+00S0+25E			18										15			
			14										180			
			9										10			
			15										65			
			16										90			
			8										85			
			13										15			
			9										5			
			14										10			
			8										65			
			31										90			
PL5+00S3+00E			10										110			
PL6+00S0+25E			13										55			
			5										20			
			7										5			
			18										10			
			7										10			
			11										15			
			9										10			
PL6+00S2+00E			9										10			

CERTIFIED BY:

[Handwritten signature]

GEOCHEMICAL ANALYSIS DATA SHEET

PROJECT No.: Peso

MIN - EN Laboratories Ltd.

DATE: Sept. 2

705 WEST 15th ST., NORTH VANCOUVER, B.C. V7M 1T2
 PHONE (604) 980-5814

1979.

ATTENTION:

Sample No.	6	10	15	20	25	30	35	40	45	50	55	60	65	70	75	80
Number	%	%	Pb ppm	Zn ppm	Ni ppm	Co ppm	Ag ppm	Fe ppm	Hg ppb	As ppm	Mn ppm	Au ppb				
Bl	86	90	95	100	105	110	115	120	125	130	135	140	145	150	155	160
PL6+00S2+25E			23										110			
2+50E			14										30			
2+75E			12										45			
PL6+00S3+00E			25										35			
PL3+00S0+25E			11										60			
0+50E			7										45			
0+75E			13										65			
1+00E			14										35			
1+25E			13										20			
1+50E			16										40			
1+75E			14										5			
2+00E			14										20			
2+25E			11										10			
2+50E			13										120			
2+75E			18										300			
PL3+00S3+00E			37										70			
PL9+00S0+25E			22										35			
0+50E			12										170			
0+75E			12										55			
1+00E			14										50			
1+25E			7										30			
1+50E			13										45			
1+75E			11										140			
2+00E			10										20			
2+25E			9										35			
2+50E			12										25			
2+75E			8										25			
3+00E			10										5			
3+25E			7										10			
PL9+00S3+50E			13										5			

[Handwritten signature]
 10
 5

GEOCHEMICAL ANALYSIS DATA SHEET

PROJECT No.: **Peso**

MIN - EN Laboratories Ltd.

DATE: **Sept. 25**

705 WEST 15th ST., NORTH VANCOUVER, B.C. V7M 1T2
PHONE (604) 980-5814

1979

ATTENTION:

Sample Number	6	10	15	20	25	30	35	40	45	50	55	60	65	70	75	80
	As ppm	As ppm	Pb ppm	Zn ppm	Ni ppm	Co ppm	Ag ppm	Fe ppm	Hg ppb	As ppm	Mn ppm	Au ppb				
81	86	90	95	100	105	110	115	120	125	130	135	140	145	150	155	160
PL9+00S3+75E			17										5			
4+00E			16										10			
4+25E			28										30			
4+50E			21										45			
4+75E			40										35			
PL9+00S5+00E			39										5			
PL10+00S0+25E			22										10			
0+50E			24										55			
0+75E			13										10			
1+00E			18										5			
1+25E			15										15			
1+50E			17										115			
1+75E			14										5			
2+00E			11										5			
2+25E			18										10			
2+50E			16										15			
2+75E			9										10			
3+00E			10										5			
3+25E			16										5			
3+50E			24										10			
3+75E			15										50			
4+00E			32										5			
4+25E			46										25			
4+50E			21										10			
4+75E			20										75			
PL10+00S5+00E			36										20			
P-BL0+00N			31										280			
0+25N			30										35			
0+50N			25										120			
P-BL0+75N			11										25			

CERTIFIED BY *[Signature]*

GEOCHEMICAL ANALYSIS DATA SHEET

PROJECT No. **Peso**

MIN - EN Laboratories Ltd.

DATE: **Sept. 2 1979.**

705 WEST 15th ST., NORTH VANCOUVER, B.C. V7M 1T2
 PHONE (604) 980-5814

ATTENTION:

Sample Number	Pb ppm	Zn ppm	Ni ppm	Co ppm	Ag ppm	Fe ppm	Hg ppb	As ppm	Mn ppm	Au ppb
P-BL1+0.0N	33									120
1+2.5N	20									90
1+5.0N	26									95
1+7.5N	17									10
2+0.0N	37									45
2+2.5N	25									125
P-BL2+5.0N	15									30
P-BL0+0.0-0+2.5E	21									80
0+5.0E	16									25
0+7.5E	13									5
1+0.0E	16									10
1+2.5E	15									45
1+5.0E	12									45
1+7.5E	14									70
2+0.0E	25									65
2+2.5E	24									5
PB10+0.0-2+5.0E	37									90
PL1+0.0N0+2.5E	18									130
0+5.0E	14									165
0+7.5E	20									120
1+0.0E	23									200
1+2.5E	32									270
1+5.0E	31									490
1+7.5E	21									100
PL1+0.0N2+0.0E	22									200
PL2+0.0N0+2.5E	18									190
0+5.0E	19									20
0+7.5E	21									1150
1+0.0E	23									270
PL2+0.0N1+2.5E	20									140

CERTIFIED BY

[Handwritten Signature]

GEOCHEMICAL ANALYSIS DATA SHEET

PROJECT No.: **Paso**

MIN - EN Laboratories Ltd.

DATE: **Sept. 25**

705 WEST 15th ST., NORTH VANCOUVER, B.C. V7M 1T2
PHONE (604) 980-5814

ATTENTION:

1979

Sample Number	6	10	15	20	25	30	35	40	45	50	55	60	65	70	75	80
		Pb	Zn	Ni	Co	Ag	Fe	Hg	As	Mn	Au					
		ppm	ppm	ppm	ppm	ppm	ppm	ppb	ppm	ppm	ppb					
PL2+0.0	N1+5.0E	31											30			
PL3+0.0	N0+2.5E	19											75			
	0+5.0E	35											35			
	0+7.5E	21											95			
	1+0.0E	42											110			
	1+2.5E	41											30			
PL3+0.0	N1+5.0E	23											25			
BL-0+2.5S		39											140			
	0+5.0S	34											70			
BL-0+7.5S		17											15			
BL-1+0.0S		16											5			
	1+2.5S	14											65			
	1+5.0S	12											85			
	1+7.5S	13											15			
	2+0.0S	14											40			
	2+2.5S	6											35			
	2+5.0S	9											15			
	2+7.5S	9											25			
	3+0.0S	10											20			
	3+2.5S	5											5			
	3+5.0S	3											25			
	3+7.5S	11											30			
	4+0.0S	26											65			
	4+2.5S	37											25			
	4+5.0S	18											5			
	4+7.5S	30											10			
	5+0.0S	27											15			
	5+2.5S	15											10			
	5+5.0S	16											10			
BL-5+7.5S		12											10			

[Handwritten signature]

COMPAL

qu lu: es rc:
Cochrane Consultants

GEOCHEMICAL ANALYSIS DATA SHEET

No. 9-669

PROJECT No.: Peso

MIN - EN Laboratories Ltd.

DATE: Sept. 25705 WEST 15th ST., NORTH VANCOUVER, B.C. V7M 1T2
PHONE (604) 980-8814

1979

ATTENTION:

Sample Number	6 85	10 90	15 95	20 100	25 105	30 110	35 115	40 120	45 125	50 130	55 135	60 140	65 145	70 150	75 155	80 160
	* ppm	* ppm	Ph ppm	Zn ppm	Ni ppm	Co ppm	Ag ppm	Fe ppm	Hg ppb	As ppm	Mn ppm	Au ppb				
BL-6+00S				27									6.5			
6+25S				26									5			
6+50S				23									2.5			
6+75S				19									1.5			
7+00S				15									1.0			
7+25S				18									5			
7+50S				19									4.0			
7+75S				21									1.0			
8+00S				22									5			
8+25S				22									6.5			
8+50S				15									5			
8+75S				18									1.5			
9+00S				17									3.0			
9+25S				23									2.0			
9+50S				22									5			
9+75S				16									8.5			
BL-10+00S				27									1.0			
#1				3400									1.90			

CERTIFIED BY

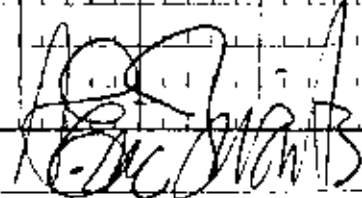

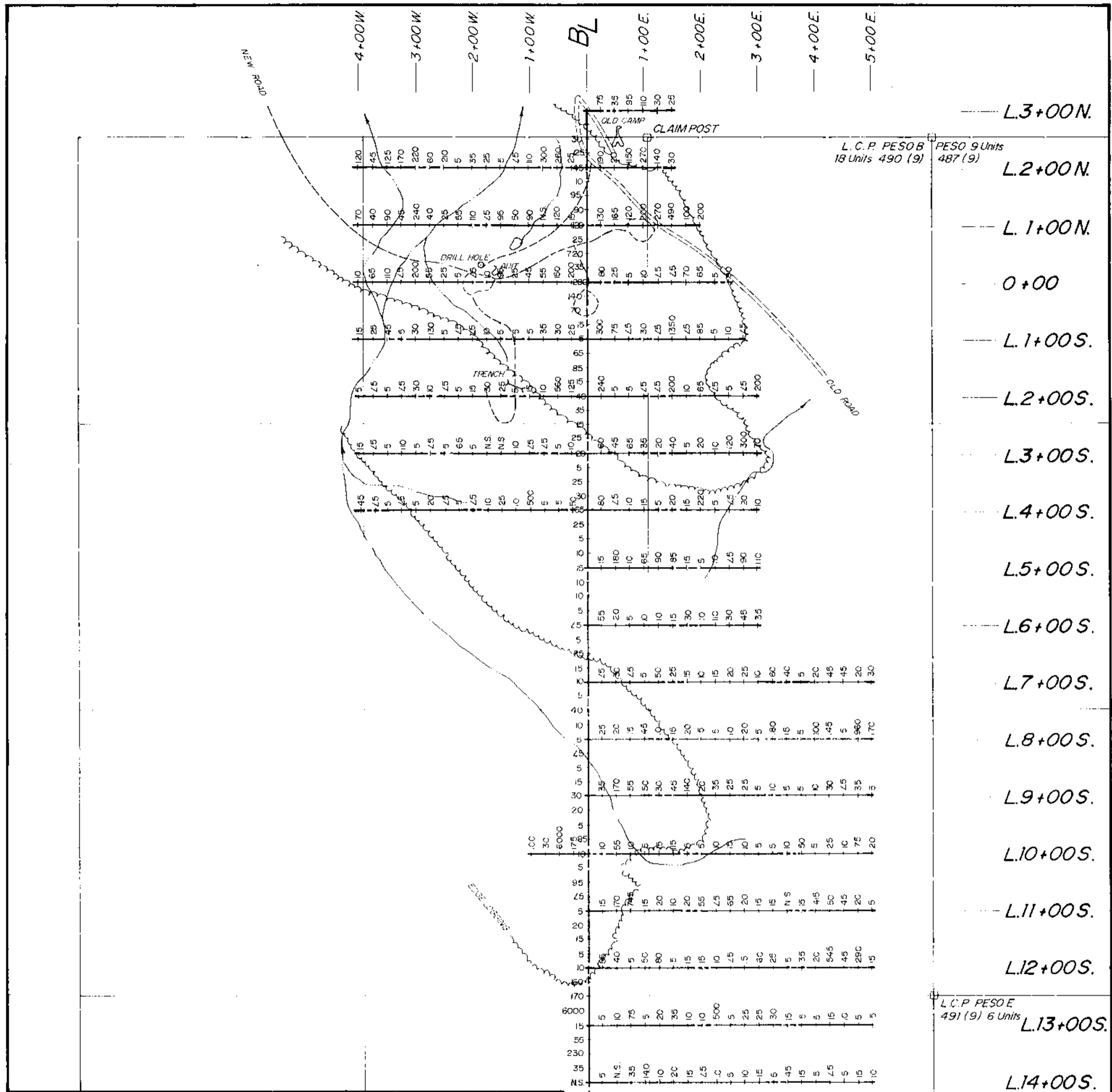

AQUARIUS RESOURCES LTD.

Likely Group Spanish Mountain Cariboo Mining Division
 Peso Claims Near Likely, B.C. N.T.S. 93A / 11 8 & 12

1:5,000
 0 50 100 200 300 400 500 metres

To accompany a report by D.R. COCHRANE, P. Eng on the PESO CLAIMS dated November 26, 1979

GEOCHEMICAL DATA
 (Au / p.p.b.)

FIG. 3



Cochrane Consultants Limited
 4882 Delta St. Delta, B.C. V4K 2T8 946-9221

H.K.C. November 7/79

MINERAL RESOURCES
 ASSESSMENT REPORT

7674
 NO.

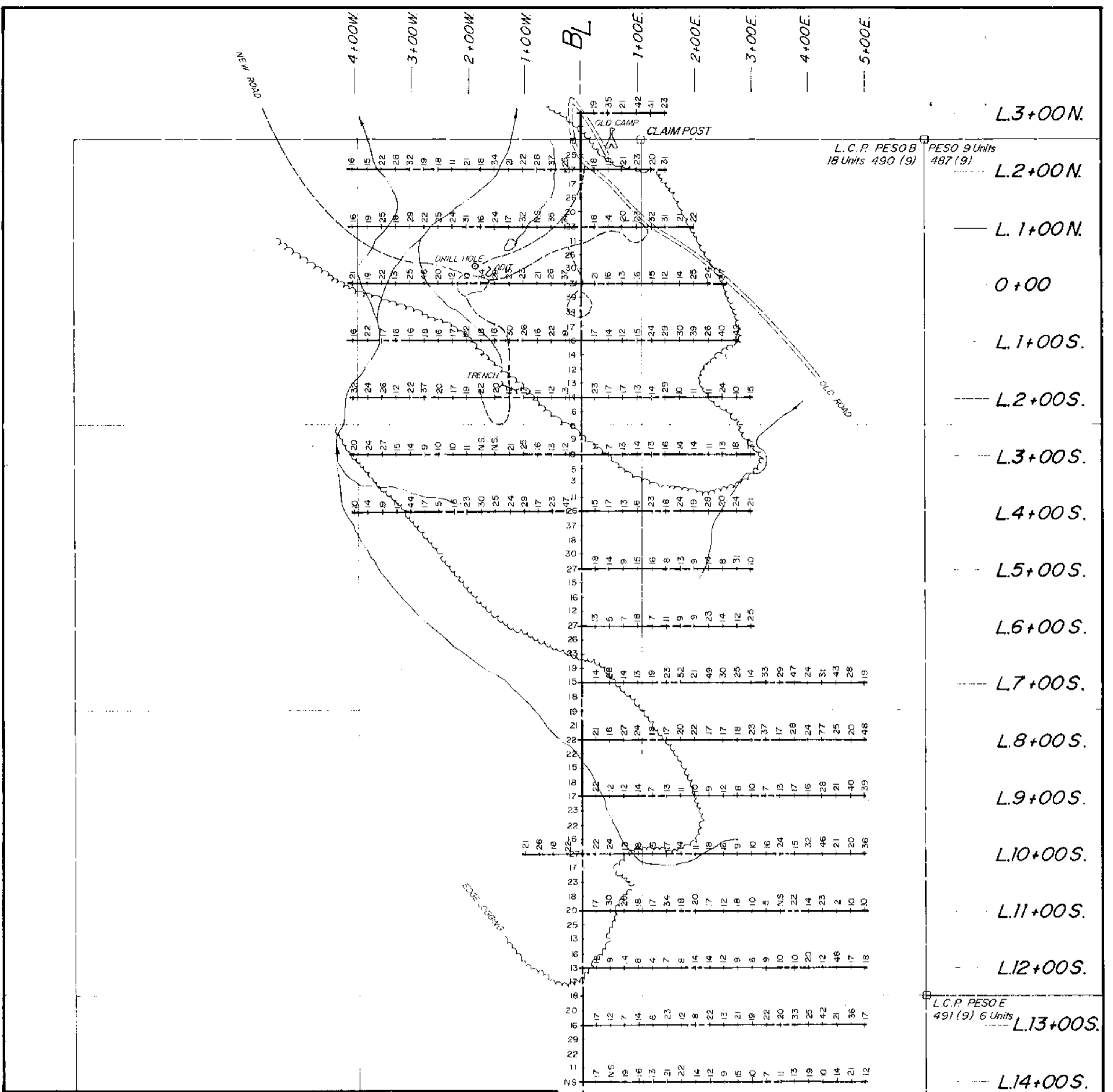

L.C.P. PESO B PESO 9 Units
18 Units 490 (9) 487 (9)

L.C.P. PESO E
491 (9) 6 Units



AQUARIUS RESOURCES LTD.

Likely Group Spanish Mountain Cariboo Mining Division
Peso Claims Near Likely, B.C. N.T.S. 93A / 11 & 12

1:5,000



To accompany a report by D.R. COCHRANE, P. Eng. on the PESO CLAIMS dated November 26, 1979

GEOCHEMICAL DATA
(Pb/pp.m.)

FIG. 4



Cochrane Consultants Limited
4882 Delta St., Delta, B.C. V4K 2T8 946-9221

PKC November / 79

MINERAL RESOURCES BRANCH
ASSESSMENT REPORT
7674

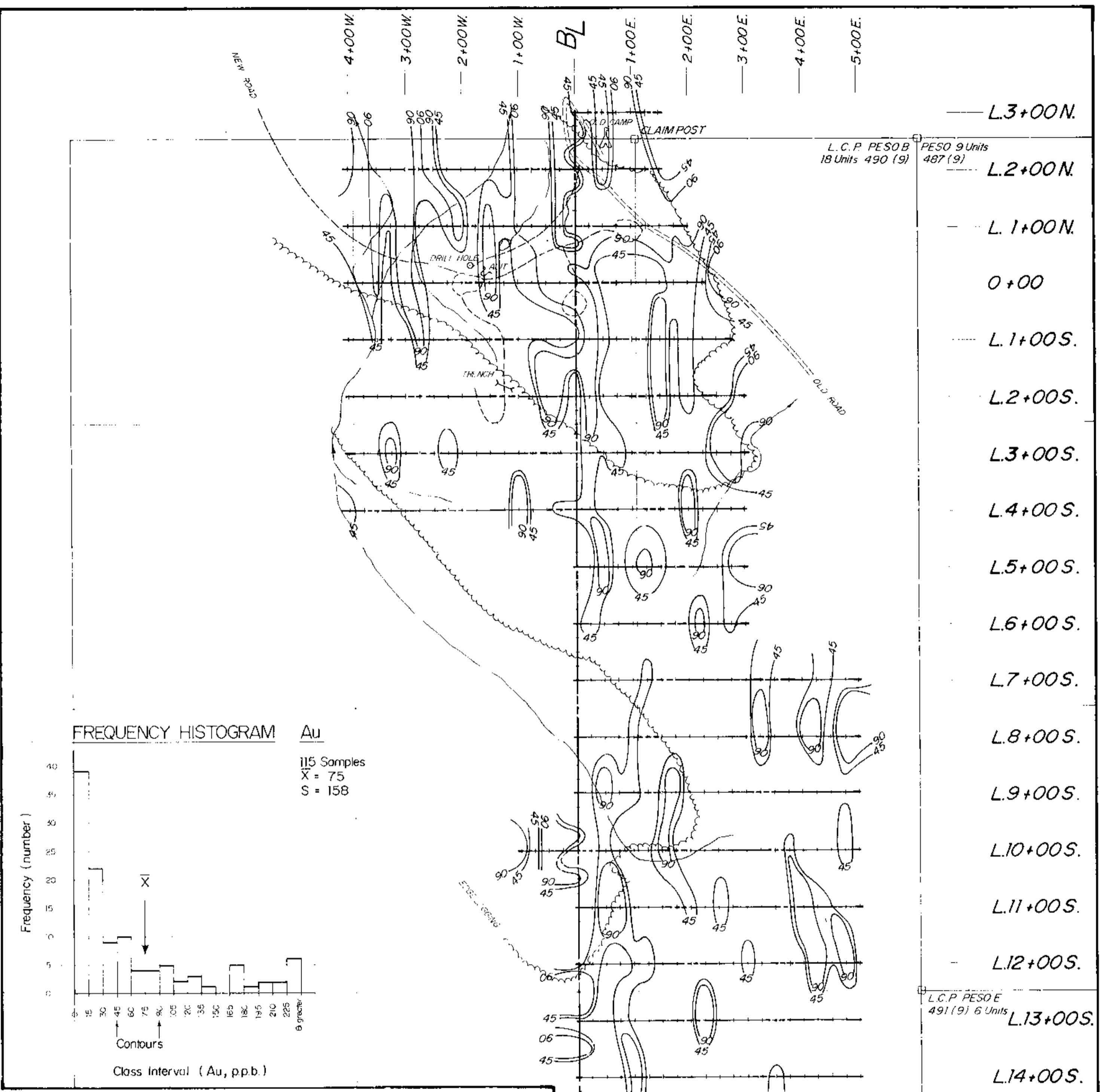

AQUARIUS RESOURCES LTD.

Likely Group Spanish Mountain Cariboo Mining Division
 Peso Claims Near Likely, B.C. N.T.S. 93A / 11 & 12

1:5,000 0 50 100 200 300 400 500 metres

To accompany a report by D.H. COCHRANE, P. Eng. on the PESO CLAIMS dated November 26, 1979

GEOCHEMICAL CONTOURS FIG. 5
 (Au / ppb.)

[Handwritten signature]



Cochrane Consultants Limited
 4882 Delta St. Delta, B.C. V4K 2T8 946-9221

P.K.C. November 79

MINERAL RESOURCES BRANCH
 ASSAY REPORT
7674
 No.

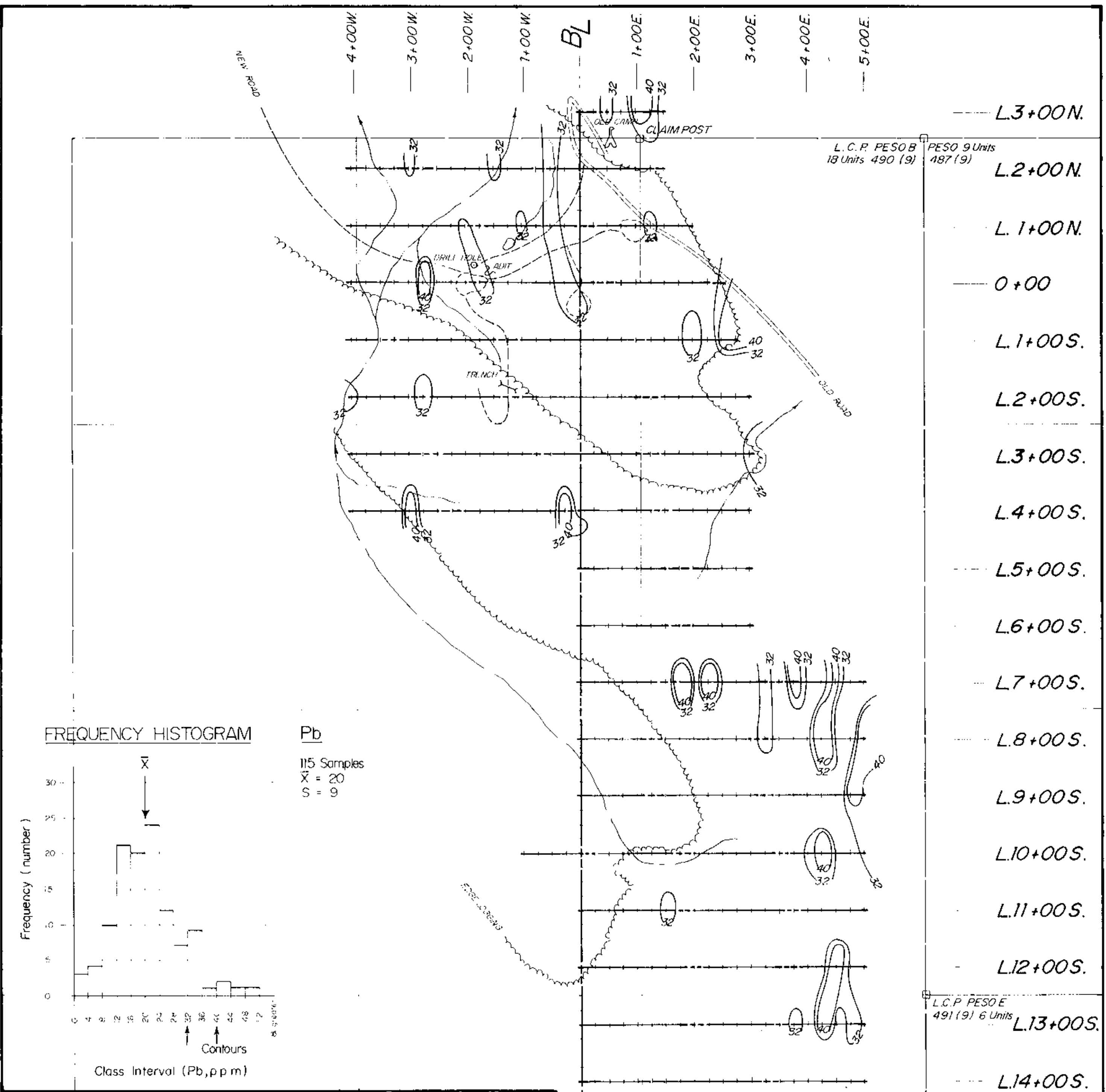

AQUARIUS RESOURCES LTD.

Likely Group Spanish Mountain Cariboo Mining Division
 Peso Claims Near Likely, B.C. N.T.S. 93A / 11 & 12

1:5,000

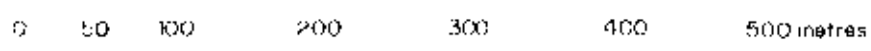

To accompany a report by D.R. COCHRANE, P. Eng on the PESO CLAIMS dated November 26, 1979

GEOCHEMICAL CONTOURS
 (Pb/p.p.m.)

FIG. 6



Cochrane Consultants Limited
 4692 Delta St., Delta, B.C. V4K 2T8 946-9221

P.K.C. November / 79

MIN. OF MINING & TECHN. SURVEY
 REGISTRY

7674