

ASSESSMENT CREDIT REPORT

for

GOODEYE MINERAL CLAIM

Located in the Trail Mining Division

82F/4W

Latitude 49°00' Longitude 117°44'

OWNER-OPERATOR:

RICHARD H. MAYES
BOX 856, ROSSLAND, B.C. VOG 1Y0

Author of Report: Richard H. Mayes

Date submitted: December 31, 1979.

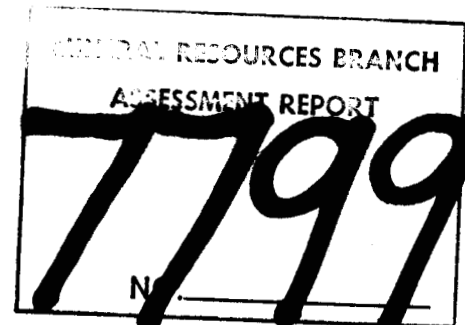

TABLE OF CONTENTS

Introduction Page 1
Index Map Page 2

SECTION NO. 1

Detailed Technical Data and Interpretation.... Page 3
Prospecting Report Page 4
Geochemical Lab Report Page 5
Dept. of Mines Lab Report Page 6
Geochemical Lab Report Page 7
Location Map Page 8

SECTION NO. 2

Itemized Cost Statement Page 9
Statement of Qualifications..... Page 10
Ministry of Mines Test Results Page 11
Plan Map In pocket

- INTRODUCTION -

The Goodeye Mineral Claim is located in the Trail Creek M.D., eight kilometers south of Rossland on the east side of Grouse Ridge, at approximately 3,500 feet elevation.

Access to the claim is gained by traveling north up Goodeve Creek to the International Boundary. The claim lies to the east and west along the International Boundary at Goodeve Creek.

This gold and silver property was staked in May of 1979 and recorded on the 21st day of June 1979. It consists of 18 units.

The current owner-operator of the Goodeye Mineral Claim is Richard H. Mayes, Box 856 , Rossland, B.C.

The economical potential of this property is promising, although further exploration work is required.

SUMMARY OF WORK DONE:

Prospecting-

A total of 26 days was spent prospecting the Goodeye Mineral Claim.

Trenching - 7.6 metres

Rock trenching - 7 metres

Line cutting - 2.5 kilometres

NORTH

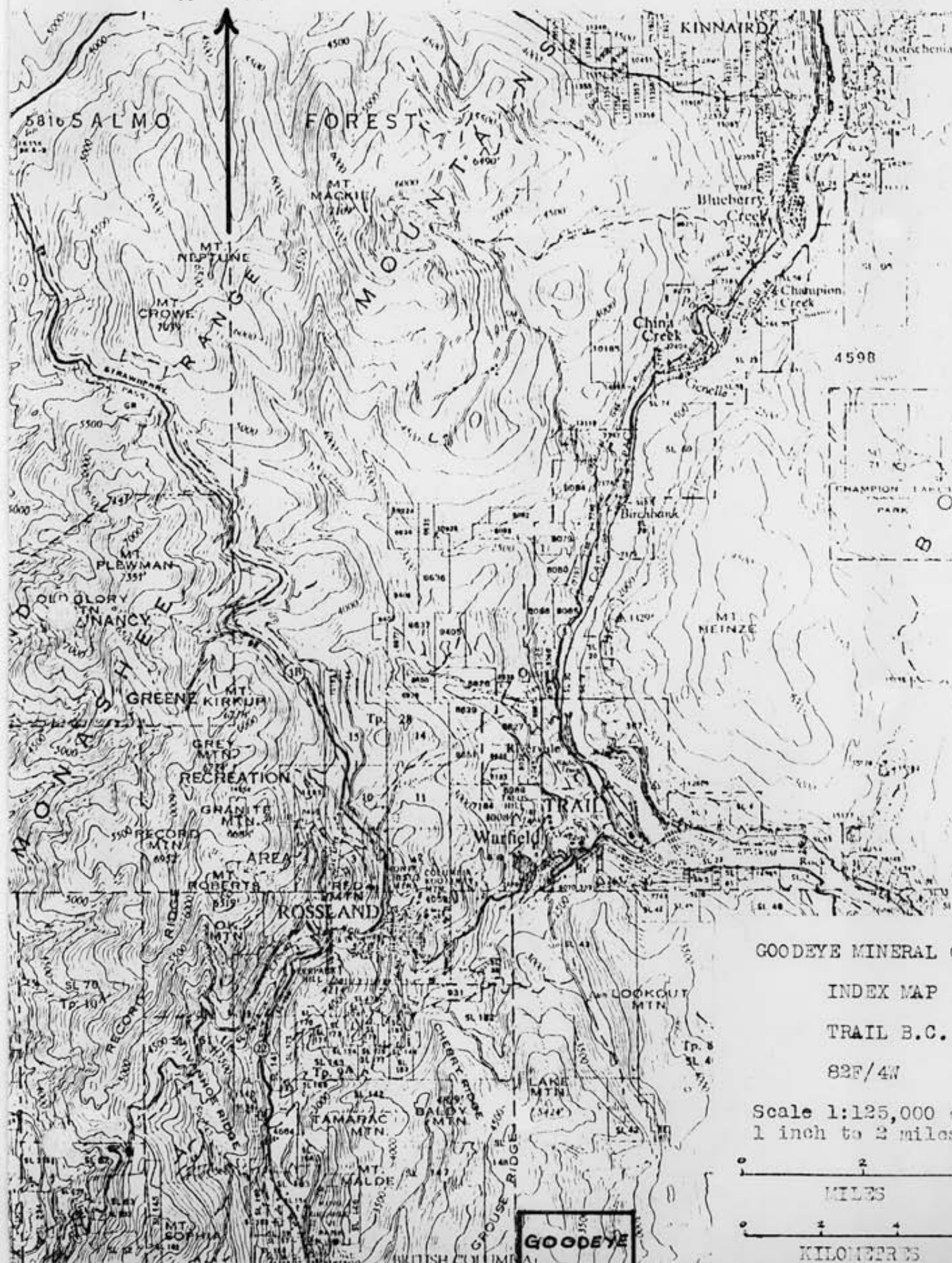

GOODEYE MINERAL CLAIM

INDEX MAP

TRAIL B.C.

82F/4W

Scale 1:125,000 or
1 inch to 2 miles



MILES



KILOMETERS

GOODEYE

SECTION NO. 1

DETAILED TECHNICAL DATA AND INTERPRETATION

-DETAILED TECHNICAL DATA AND INTERPRETATION-

The purpose of the investigation was to locate gold-bearing quartz veins on the east arm of Grouse Ridge and then to attempt to determine the economic potential of those veins.

A number of quartz veins were found on the east arm of Grouse Ridge, varying in width from a fraction of an inch to a metre in width. Most of the veins were found to carry only traces of gold, however, two veins were located on the east arm of Grouse Ridge near the International Boundary which were found to carry values as high as 2.702 ounces of gold per ton.

The veins have been exposed in 5 test pits. The width of the veins varies from 30 centimetres to 1 metre striking in an easterly direction with a vertical dip. The veins have been traced for 75 metres with good mineralization.

GOODEYE MINERAL CLAIM PROSPECTING REPORT

The area prospected is made up of predominately leucocratic granite of the Sheppard formation, with minor occurrences of syenite, granite and monzonites of the Coryell Plutonic Rocks in the vicinity of Goodeve Creek.

The leucocratic granites cut argillites along the west location line near the International Boundary at which point a strong magnetic anomaly was also noted.

Another strong magnetic anomaly was noted on the west side of Goodeve Creek - just north of the International Boundary.

Numerous pockets of shale, argillite and argillaceous quartzites were found to run in a northerly direction through the centre of the claim.

Swarms of narrow quartz veins were found in a number of locations on top of the ridge, to the west of Goodeve Creek and north of the International Boundary.

The area prospected is well exposed on the higher ground, however, the valleys are well timbered with few outcrops.

This report prepared and
signed by

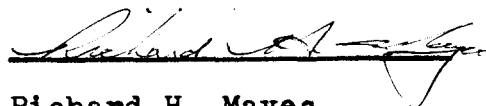

Richard H. Mayes

December 31, 1979.



ENERGY

THE GOVERNMENT OF
THE PROVINCE OF BRITISH COLUMBIA

DEPARTMENT OF MINES AND PETROLEUM RESOURCES
VICTORIA

SAMPLE RECEIVED FROM RICHARD H. MAYES

ADDRESS BOX 856, ROSSLAND B.C. VOG 1Y0

LABORATORY No.	SUBMITTER'S MARK	LABORATORY REPORT
3037	4658 E A - 1	Spectrochemical Analysis: The only base metals found, and their percentages, were those occurring normally in rocks. Gold - Trace Silver - Trace
3038	4656 E G2 - 1	Spectrochemical Analysis: 0.15% Lead was found. The other base metals found, and their percentages, were those occurring normally in rocks. Gold - Trace Silver - Trace
3039	4657 E G2 - 2	Spectrochemical Analysis: The only base metals found, and their percentages, were those occurring normally in rocks. Gold - Trace Silver - Trace
3040	4651 E M - 1	Spectrochemical Analysis: 0.01% Lead was found. The other base metals found, and their percentages, were those occurring normally in rocks. Gold - Trace Silver - Trace

THIS DOCUMENT, OR ANY PART THEREOF, MAY NOT BE REPRODUCED FOR PROMOTIONAL OR ADVERTISING PURPOSES.

DATE September 10, 1979

[Signature]
CHIEF ANALYST AND ASSAYER.

NORTH

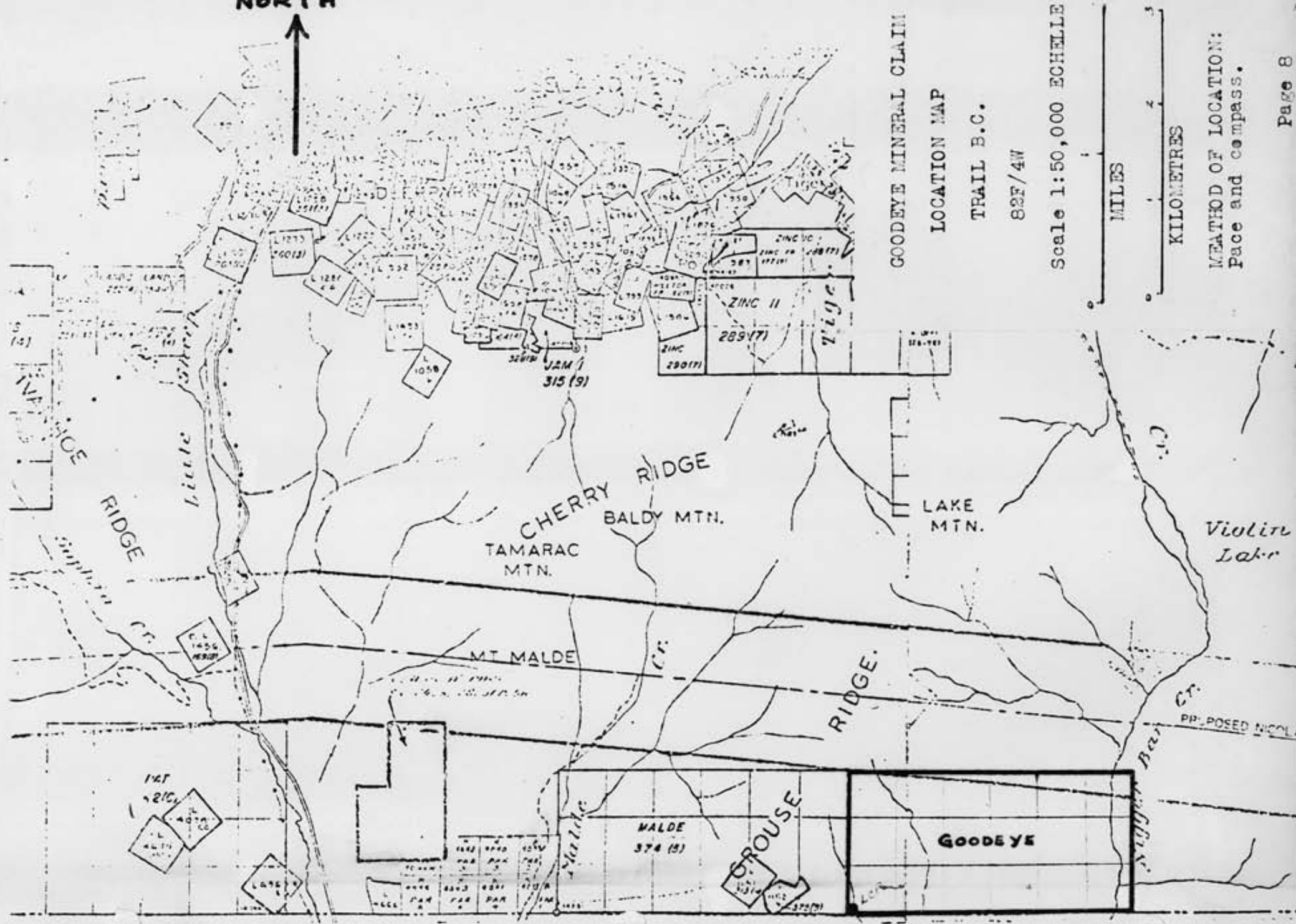

GOODEYE MINERAL CLAIM

LOCATION MAP

TRAIL B.C.

82F/4W

Scale 1:50,000 ECHELLE

MILES

KILOMETRES

METHOD OF LOCATION:
Pace and compass.

Boundary

117° 45' 17" W

SECTION NO. 2

ITEMIZED COST STATEMENT

- ITEMIZED COST STATEMENT -

PROSPECTING COSTS:

May 16-18, 1979; 3 days; line cutting - 1.5 kilometres 3-\$60/man/days	\$180.00
May 22-23, 1979; 2 days; line cutting - 1 kilometre 2-\$60/man/days	\$120.00
June 22, 1979; 1 day; prospecting 1-\$60/man/day	\$ 60.00
June 24, 1979; 1 day; prospecting 1-\$60/man/day	\$ 60.00
July 2, 1979; 1 day; prospecting 1-\$60/man/day	\$ 60.00
July 14, 1979; 1 day; prospecting 1-\$60/man/day	\$ 60.00
July 16, 1979; 1 day; prospecting 1-\$60/man/day	\$ 60.00
July 26, 1979; 1 day; prospecting 1-\$60/man/day	\$ 60.00
July 30-August 1, 1979; 3 days; prospecting 3-\$60/man/days	\$180.00
August 5, 1979; 1 day; prospecting 1-\$60/man/day	\$ 60.00
August 10-11, 1979; 2 days; trenching on s-2, -7.6 metres 4-\$60/man/days	\$240.00
August 13, 1979; 1 day; rock trenching on G2-1 2-\$60/man/days	\$120.00
August 16-17, 1979; 2 days; rock trenching on G-2 pit 4-\$60/man/days 2 METERS	\$240.00
September 14, 1979; 1 day; rock trenching on G2-1 pit 2-\$60/man/days 4 METERS	\$120.00
September 23-24-25, 1979; 3 days; prospecting 3-\$60/man/days	\$180.00
September 30, 1979; 1 day; brushing 1-\$60/man/day	\$ 60.00
October 2, 1979; 1 day; prospecting 1-\$60/man/day	<u>\$ 60.00</u>
PROSPECTING COST	\$1920.00

STATEMENT OF QUALIFICATIONS

I Richard H. Mayes, who did the prospecting and wrote this report feel I am qualified to do so as I have completed several prospecting courses, in Alberta and B.C. including one in March of 1979 at Nelson B.C. in which I obtained 98% on the final examination.

Richard H. Mayes

Province of
British Columbia

Ministry of Energy,
Mines and
Petroleum Resources

OFFICE ADDRESS:
403~~887~~ Vernon Street
Nelson, B.C. V1L 4E4

MAILING ADDRESS:
310 Ward Street
Nelson, B.C. V1L 5S4

March 8th, 1979.

Mr Richard Mayes,
Box 856,
Rossland, B.C
VOG 1Y0

Dear Mr Mayes,

Your mark on the Rock and Mineral Exam
is 98. An excellent mark. Congratulations!

Yours truly,

G. Addie
G. Addie, P. Eng., P. Geol.,
District Geologist.

GA/elg

NORTH



TRAVERSES -----

Location	Rock Type
1	Granite
2	Quartzite
3	Slate
4	Conglomerate
5	Argillite
6	Quartzite
7	Granite
8	Granite
9	Altered Granite
10	Altered Granite
11	Slate
12	Slate
13	Altered Granite
14	Altered Granite
15	Slate
16	Monzonite
17	Altered Granite
18	Altered Granite
19	Slate
20	Granite
21	Syenite
22	Syenite
23	Basalt
24	Syenite
25	Monzonite
26	Altered Granite
27	Basalt
28	Basalt

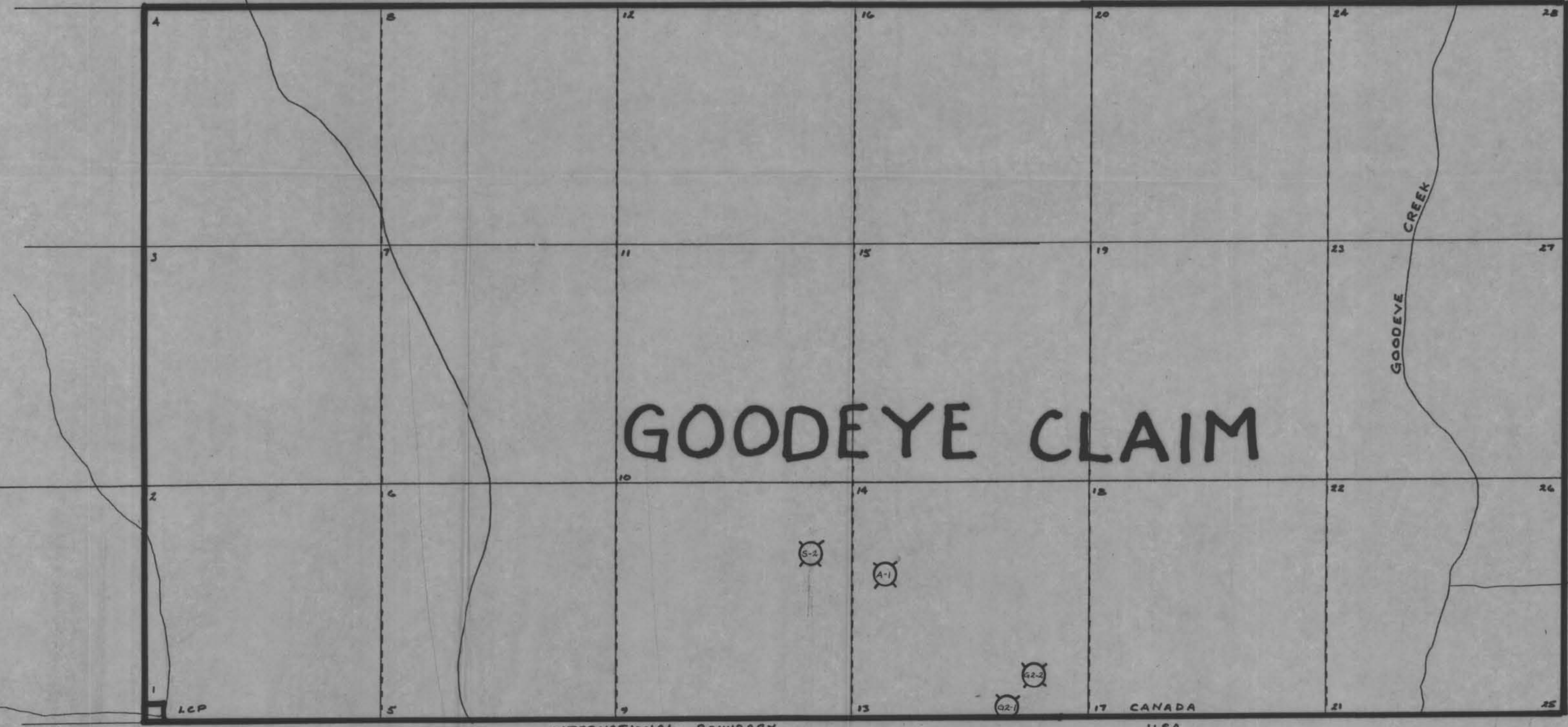

GOODEYE CLAIM

GOODEYE CREEK

INTERNATIONAL BOUNDARY CANADA USA

MINERAL ASSESSMENT REPORT GOODEYE MINERAL CLAIM
7799
 PLAN MAP
 TRAIL B.C.
 BRP/4W

Scale: 1 inch to 400 feet
 0 400 800 1200 1600 feet
 0 100 200 300 400 500 metres

LEGEND:
 - rock sample location.