

Geochemical Soil Survey  
for Gold

on the

LAST LINK Group  
north end of Texada Island  
NANAIMO MINING DIVISION

MAP # 92 F 10 E

Sept 7 to Sept 14, 1979

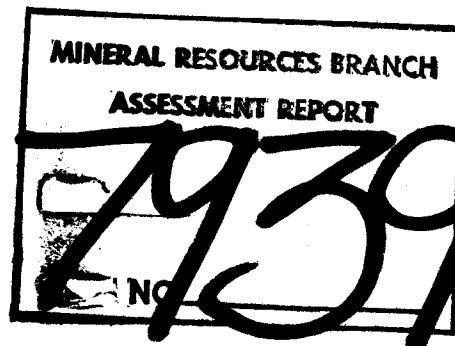

# TABLE of Contents

	Page
Introduction	1
Location and access	2
Climate and Vegetation	3
Geology structure - Lithology and soil cover	4
Field Work and SOIL SAMPLING	5
Sample analysis	6
Results	6
a. Presentation	
b. Conclusion	
STATEMENT	7
Illustrations	
Figure 1. Map 92 F 10E	
Figure 2. Grid lines	
<b>AMENDMENTS</b>	8
	9
	10
	11

A geochemical soil survey was carried out on the LAST LINK GROUP on Texada Island to examine gold content of soil and related mineralization of the bedrock.

LAST LINK Group includes:

LAST LINK  
Gerald 'D'  
Harold 'D'  
DANDY Fraction  
VICTORIA  
TEXADA  
CLIMAX  
LINDSAY  
CRACKER JACK FRACTION

## LOCATION and Access

Page 2

Texada Island lies in the Georgia Strait and is about 70 air miles north west of Vancouver. The eight hour road route from Vancouver to Vananda, Texada Island is linked by three ferry crossings. The Kirk LAKE property is 2 road miles from Vananda.

## Climate and Vegetation!

page 3

Typical west coast rainy forest abounds. Summers are hot. Prolific timber prevails especially where soil cover will permit and where indiscreet logging has bared the landscape of indigenous Douglas Fir, Hemlock, Spruce and replaced by a thick natural growth of Alders and underbrush.

## Geology

page 4

Basically igneous rock with quartz diorite and diorite gabbro intrusives.

These types of structures have been the host materials in the old gold mines at Vananda and Kirk LAKE.

On slopes the soil cover is generally thin with one or more horizons missing and is derived mainly from the bedrock. However on the terraces it is derived partly from glacial till and varying mixtures of organic material. Mountainous juvenile soil is typical of the steeper outcrop slopes, is dark brown and has little vertical extent.

East west lines at 500 metre interval. Throught the property frequency of sampling was at 50 m. stations. Survey was by the chain and compass method and the ends were tied to prominent topographic landmarks.

### SOIL SAMPLING

Samples were collected from the redish-brown B horizon wherever possible. A spade was used as the sampling tool. Each sample was placed in a standard high wet strength paper sampling bag, marked with grid coordinates to correspond with thoes marked on blue and yellow flagging tape for identification in the field. All samples were dried within sampling bags by MIN-EN Laboratories Ltd. in drying ovens.

The samples were delivered undried to MIN-EN LABORATORIES LTD in North Vancouver where they were analysed for gold content.

### RESULTS

#### a) Presentation

1. Map of Texada Island showing Group
2. Geochemical plan showing gold values of soil in P.P.B.

#### b) Conclusion

The above survey which was basically explorative may have been prejudiced by the soil disruption due to extensive logging. However work should continue in the area of LN 1 B+00 W. Perhaps a more detailed soil sampling with VLF-EM and Magnetometer surveys as well.



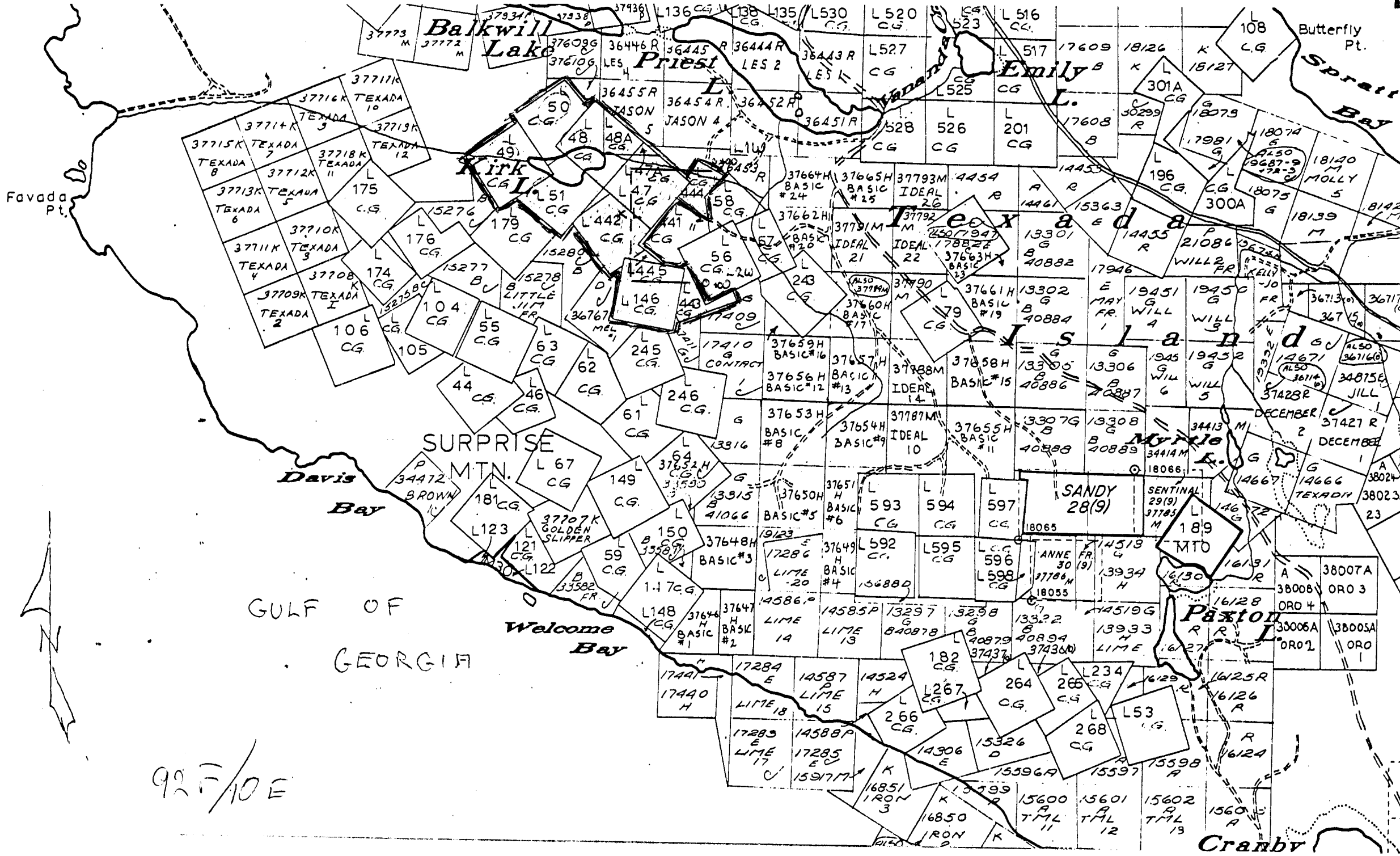

Balkwill Lake

Kirk

Emily

Texada

Island

Sandy

Patton

Cranby

GULF OF GEORGIA

Davis Bay

Welcome Bay

SURPRISE MTN.

92 F/10 E

37773 M  
37772 M

37711K  
37716K TEXADA 10  
37714K TEXADA 9  
37715K TEXADA 8  
37712K TEXADA 11  
37713K TEXADA 6  
37710K TEXADA 7  
37711K TEXADA 3  
37708K TEXADA 4  
37709K TEXADA 2  
37718K TEXADA 12  
37719K TEXADA 10  
37717K TEXADA 5  
37718K TEXADA 12  
37712K TEXADA 11  
37713K TEXADA 6  
37710K TEXADA 7  
37711K TEXADA 3  
37708K TEXADA 4  
37709K TEXADA 2

50 CG  
48 CG  
48A CG  
49 CG  
51 CG  
47 CG  
44 CG  
45 CG  
46 CG  
47 CG  
48 CG  
49 CG  
50 CG  
51 CG  
52 CG  
53 CG  
54 CG  
55 CG  
56 CG  
57 CG  
58 CG  
59 CG  
60 CG  
61 CG  
62 CG  
63 CG  
64 CG  
65 CG  
66 CG  
67 CG  
68 CG  
69 CG  
70 CG  
71 CG  
72 CG  
73 CG  
74 CG  
75 CG  
76 CG  
77 CG  
78 CG  
79 CG  
80 CG  
81 CG  
82 CG  
83 CG  
84 CG  
85 CG  
86 CG  
87 CG  
88 CG  
89 CG  
90 CG  
91 CG  
92 CG  
93 CG  
94 CG  
95 CG  
96 CG  
97 CG  
98 CG  
99 CG  
100 CG

36446 R  
36445 R  
36444 R  
36443 R  
36455 R  
36454 R  
36452 R  
36451 R  
36450 R  
36449 R  
36448 R  
36447 R  
36446 R  
36445 R  
36444 R  
36443 R  
36442 R  
36441 R  
36440 R  
36439 R  
36438 R  
36437 R  
36436 R  
36435 R  
36434 R  
36433 R  
36432 R  
36431 R  
36430 R  
36429 R  
36428 R  
36427 R  
36426 R  
36425 R  
36424 R  
36423 R  
36422 R  
36421 R  
36420 R  
36419 R  
36418 R  
36417 R  
36416 R  
36415 R  
36414 R  
36413 R  
36412 R  
36411 R  
36410 R  
36409 R  
36408 R  
36407 R  
36406 R  
36405 R  
36404 R  
36403 R  
36402 R  
36401 R  
36400 R  
36399 R  
36398 R  
36397 R  
36396 R  
36395 R  
36394 R  
36393 R  
36392 R  
36391 R  
36390 R  
36389 R  
36388 R  
36387 R  
36386 R  
36385 R  
36384 R  
36383 R  
36382 R  
36381 R  
36380 R  
36379 R  
36378 R  
36377 R  
36376 R  
36375 R  
36374 R  
36373 R  
36372 R  
36371 R  
36370 R  
36369 R  
36368 R  
36367 R  
36366 R  
36365 R  
36364 R  
36363 R  
36362 R  
36361 R  
36360 R  
36359 R  
36358 R  
36357 R  
36356 R  
36355 R  
36354 R  
36353 R  
36352 R  
36351 R  
36350 R  
36349 R  
36348 R  
36347 R  
36346 R  
36345 R  
36344 R  
36343 R  
36342 R  
36341 R  
36340 R  
36339 R  
36338 R  
36337 R  
36336 R  
36335 R  
36334 R  
36333 R  
36332 R  
36331 R  
36330 R  
36329 R  
36328 R  
36327 R  
36326 R  
36325 R  
36324 R  
36323 R  
36322 R  
36321 R  
36320 R  
36319 R  
36318 R  
36317 R  
36316 R  
36315 R  
36314 R  
36313 R  
36312 R  
36311 R  
36310 R  
36309 R  
36308 R  
36307 R  
36306 R  
36305 R  
36304 R  
36303 R  
36302 R  
36301 R  
36300 R  
36299 R  
36298 R  
36297 R  
36296 R  
36295 R  
36294 R  
36293 R  
36292 R  
36291 R  
36290 R  
36289 R  
36288 R  
36287 R  
36286 R  
36285 R  
36284 R  
36283 R  
36282 R  
36281 R  
36280 R  
36279 R  
36278 R  
36277 R  
36276 R  
36275 R  
36274 R  
36273 R  
36272 R  
36271 R  
36270 R  
36269 R  
36268 R  
36267 R  
36266 R  
36265 R  
36264 R  
36263 R  
36262 R  
36261 R  
36260 R  
36259 R  
36258 R  
36257 R  
36256 R  
36255 R  
36254 R  
36253 R  
36252 R  
36251 R  
36250 R  
36249 R  
36248 R  
36247 R  
36246 R  
36245 R  
36244 R  
36243 R  
36242 R  
36241 R  
36240 R  
36239 R  
36238 R  
36237 R  
36236 R  
36235 R  
36234 R  
36233 R  
36232 R  
36231 R  
36230 R  
36229 R  
36228 R  
36227 R  
36226 R  
36225 R  
36224 R  
36223 R  
36222 R  
36221 R  
36220 R  
36219 R  
36218 R  
36217 R  
36216 R  
36215 R  
36214 R  
36213 R  
36212 R  
36211 R  
36210 R  
36209 R  
36208 R  
36207 R  
36206 R  
36205 R  
36204 R  
36203 R  
36202 R  
36201 R  
36200 R  
36199 R  
36198 R  
36197 R  
36196 R  
36195 R  
36194 R  
36193 R  
36192 R  
36191 R  
36190 R  
36189 R  
36188 R  
36187 R  
36186 R  
36185 R  
36184 R  
36183 R  
36182 R  
36181 R  
36180 R  
36179 R  
36178 R  
36177 R  
36176 R  
36175 R  
36174 R  
36173 R  
36172 R  
36171 R  
36170 R  
36169 R  
36168 R  
36167 R  
36166 R  
36165 R  
36164 R  
36163 R  
36162 R  
36161 R  
36160 R  
36159 R  
36158 R  
36157 R  
36156 R  
36155 R  
36154 R  
36153 R  
36152 R  
36151 R  
36150 R  
36149 R  
36148 R  
36147 R  
36146 R  
36145 R  
36144 R  
36143 R  
36142 R  
36141 R  
36140 R  
36139 R  
36138 R  
36137 R  
36136 R  
36135 R  
36134 R  
36133 R  
36132 R  
36131 R  
36130 R  
36129 R  
36128 R  
36127 R  
36126 R  
36125 R  
36124 R  
36123 R  
36122 R  
36121 R  
36120 R  
36119 R  
36118 R  
36117 R  
36116 R  
36115 R  
36114 R  
36113 R  
36112 R  
36111 R  
36110 R  
36109 R  
36108 R  
36107 R  
36106 R  
36105 R  
36104 R  
36103 R  
36102 R  
36101 R  
36100 R  
36099 R  
36098 R  
36097 R  
36096 R  
36095 R  
36094 R  
36093 R  
36092 R  
36091 R  
36090 R  
36089 R  
36088 R  
36087 R  
36086 R  
36085 R  
36084 R  
36083 R  
36082 R  
36081 R  
36080 R  
36079 R  
36078 R  
36077 R  
36076 R  
36075 R  
36074 R  
36073 R  
36072 R  
36071 R  
36070 R  
36069 R  
36068 R  
36067 R  
36066 R  
36065 R  
36064 R  
36063 R  
36062 R  
36061 R  
36060 R  
36059 R  
36058 R  
36057 R  
36056 R  
36055 R  
36054 R  
36053 R  
36052 R  
36051 R  
36050 R  
36049 R  
36048 R  
36047 R  
36046 R  
36045 R  
36044 R  
36043 R  
36042 R  
36041 R  
36040 R  
36039 R  
36038 R  
36037 R  
36036 R  
36035 R  
36034 R  
36033 R  
36032 R  
36031 R  
36030 R  
36029 R  
36028 R  
36027 R  
36026 R  
36025 R  
36024 R  
36023 R  
36022 R  
36021 R  
36020 R  
36019 R  
36018 R  
36017 R  
36016 R  
36015 R  
36014 R  
36013 R  
36012 R  
36011 R  
36010 R  
36009 R  
36008 R  
36007 R  
36006 R  
36005 R  
36004 R  
36003 R  
36002 R  
36001 R  
36000 R

34472 P  
BROWN

37707K  
GOLDEN SLIPPER

17441 H  
17440 H

17284 E  
LIME 18  
17285 E  
LIME 17  
15917 M

14587 P  
LIME 15  
14588 P  
LIME 14  
15917 M

182 CG  
264 CG  
266 CG  
268 CG

L 1234  
L 153  
L 268

38007A  
ORO 3  
38008A  
ORO 4  
38009A  
ORO 1  
38000A  
ORO 1

15600 R  
TFL 11  
15601 R  
TFL 12  
15602 R  
TFL 13  
15603 R  
TFL 14

16851 K  
IRON 3  
16850 K  
IRON 2

18065  
18066  
18067  
18068  
18069  
18070  
18071  
18072  
18073  
18074  
18075  
18076  
18077  
18078  
18079  
18080  
18081  
18082  
18083  
18084  
18085  
18086  
18087  
18088  
18089  
18090  
18091  
18092  
18093  
18094  
18095  
18096  
18097  
18098  
18099  
18100

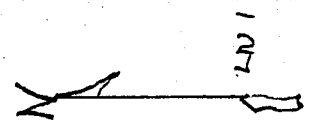

ppb. ft.

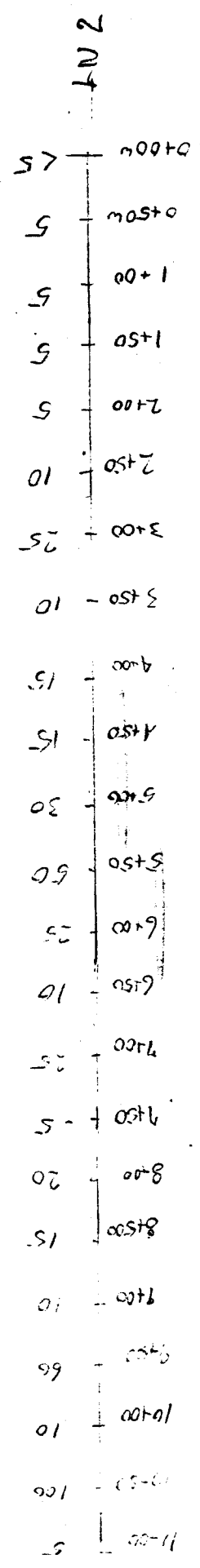
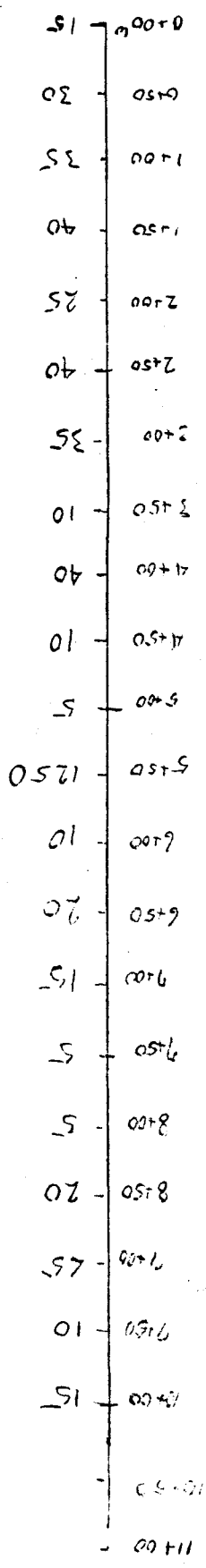

GEOCHEMICAL RESULTS IN PPB - FT  
 GRID COVERS LOTS A7, A42, A44, A45 & A43

STATEMENT

page 7

Statement of costs

Payment to S. L. Beale @ 150<sup>00</sup>/day  
work 6 days \$ 900.00

transportation \$ 40.00

meal allowance \$ 180.00 \$ 30/day

MIN-EN LAB \$ 246.00

MISC \$ 20.00

TOTAL \$ 1,386.00

File 166 Nanaimo

July 21, 1980

Geochemical Report 79 #633

Amendments

1. Location of property 49° - 44' latitude  
124° - 35' longitude
2. Grid shown on location MAP in ink.
3. Author Stanley L. Beale has been a prospector for eight years and has worked in the field with C. Ager Ass. in the Yukon. He is presently employed with SHIMA Resources now doing extensive Diamond drilling on Texada Island.
4. Lab reports included and attached.  
Method of analysis. Au-Aqua Regia AA Analysis

# MIN-EN Laboratories Ltd.

705 WEST 15th STREET,  
NORTH VANCOUVER, B.C., CANADA V7M 1T2  
TELEPHONE (604) 980-5814

## ANALYTICAL REPORT

Project ..... Date of report **Nov. 12/79.**  
 File No. **9-818** ..... Date samples received **Nov. 6/79.**  
 Samples submitted by: **Stan Beale**  
 Company: **Stan Beale**  
 Report on: **52 soils** ..... Geochem samples  
 ..... Assay samples

Copies sent to:  
 1. **Stan Beale**  
 2. ....  
 3. ....

Samples: Sieved to mesh **- 80** ..... Ground to mesh .....  
 Prepared samples stored  discarded   
 rejects stored  discarded

Methods of analysis: **Au-Aqua Regia. A.A. Analysis.**

Remarks: .....

COMP

Stan Beale

## GEOCHEMICAL ANALYSIS DATA SHEET

No. 9-818

PROJECT No.:

MIN - L. Laboratories Ltd.

DATE: Nov. 12,

ATTENTION:

Stan Beale

705 WEST 15th ST., NORTH VANCOUVER, B.C. V7M 1T2  
PHONE (604) 980-5814

1979

Sample Number	6	10	15	20	25	30	35	40	45	50	55	60	65	70	75	80	
	X	X	Pb	Zn	Ni	Co	Ag	Fe	Hg	As	Mn	Au					
	ppm	ppm	ppm	ppm	ppm	ppm	ppm	ppm	ppb	ppm	ppm	ppb					
	81	86	90	95	100	105	110	115	120	125	130	135	140	145	150	155	160
XL1+00S													250				
2+00S													110				
4+00S													15				
5+00S													20				
XL6+00S													25				
XLS7+00S													10				
XLS8+00S													30				
XLN0+00													15				
XLNS3+00													10				
LN1-0+00													15				
LN1-1+00													30				
4+00W													35				
5+00W													40				
6+00W													25				
7+00W													40				
8+00W													35				
9+00W													10				
10+00W													40				
11+00W													10				
12+00W													5				
13+00W													1250				
14+00W													10				
15+00W													20				
16+00W													15				
17+00W													5				
18+00W													5				
19+00W													20				
LN1-20+00W													15				
LN1XL21+00W													10				
LN1-22+00XL													15				

CERTIFIED BY:

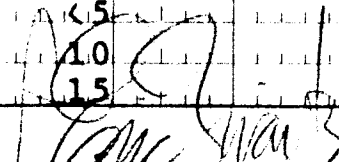

CAL 0100

COMPAN

**Stan Beale**

**GEOCHEMICAL ANALYSIS DATA SHEET**

9-818

PROJECT No.:

MIN - ER Laboratories Ltd.

DATE: **Nov. 12**

705 WEST 15th ST., NORTH VANCOUVER, B.C. V7M 1T2  
PHONE (604) 980-5814

1979

ATTENTION: **Stan Beale**

Sample Number	6 ppm	10 ppm	15 ppm	20 ppm	25 ppm	30 ppm	35 ppm	40 ppm	45 ppm	50 ppb	55 ppm	60 ppm	65 ppb	70	75	80
81	80	90	95	100	105	110	115	120	125	130	135	140	145	150	155	160
LN1-23+00XL													5			
24+00XL													5			
25+00XL													5			
26+00XL													5			
LN1-27+00XL													10			
LN2-000W													5			
1+00W													100			
2+00W													10			
3+00W													60			
4+00W													10			
5+00W													15			
6+00W													20			
7+00W													5			
8+00W													25			
9+00W													10			
10+00W													25			
11+00W													50			
12+00W													30			
13+00W													15			
14+00W													15			
LN2-15+00W													10			
L1-3+00W													25			

CERTIFIED BY

*[Handwritten Signature]*

Page