

A Report On
GEOCHEMICAL SAMPLING

On The

WHIP

Mineral Claim

Similkameen M.D.

NTS 92 H/ 7 W

Lat: 49°16'30"

Long: 120° 48'

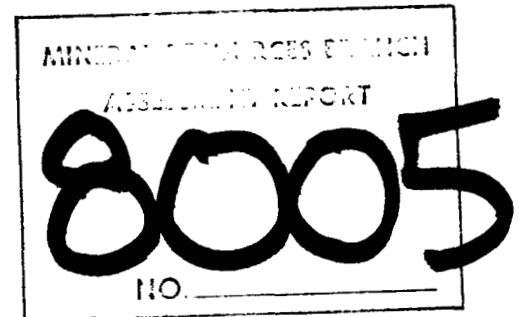

Owner: LACANA MINING CORPORATION

Author: Darrel Johnson, B.Sc.

Date: April 1980

CONTENTS

	<u>Page</u>
SUMMARY	1
CONCLUSIONS AND RECOMMENDATIONS	2
INTRODUCTION	3
GEOLOGY	4
GEOCHEMISTRY	6

LIST OF ILLUSTRATIONS

Figure 1	LOCATION MAP	After Page 1
Figure 2	CLAIM MAP	After Page 6
Figure 3	GEOCHEMISTRY LEAD	After Page 6
Figure 4	GEOCHEMISTRY SILVER	After Page 6
Figure 5	GEOCHEMISTRY COPPER	After Page 6
Figure 6	GEOCHEMISTRY ZINC	After Page 6
Figure 7	GEOCHEMISTRY SAMPLE NUMBERS	After Page 6

APPENDICES

STATEMENT OF QUALIFICATIONS DARREL JOHNSON	Appendix I
STATEMENT OF COSTS	Appendix II
ANALYTICAL PROCEDURES	Appendix III
ANALYTICAL RESULTS	Appendix IV

SUMMARY

The WHIP claim was staked for Lacana in June 1979 to cover a known quartz vein containing values in lead, zinc gold and silver. Work last season relied heavily on geochemical sampling, both soil and stream sediments. All field work covered by this report was performed by Mr. Gordon Davies on behalf of Lacana.

CONCLUSIONS AND RECOMMENDATIONS

Exploration work to date has not expanded our previous knowledge as to the dimensions or continuity of the "WHIP" showing. Geochemical response over the known showing was weak with poor definition over the rest of the area sampled. Hand trenches at 5 anomalous soil sample sites failed to encounter bedrock, although angular float suggests that overburden cover is not deep.

This showing deserves further testing. A closely spaced geophysical survey (VLF EM?) should work well on a distinct sulphide vein with shallow cover. Backhoe trenching, starting essentially on top of the showing, should also prove valuable.

INTRODUCTION

Location and Access

The WHIP showing is located in the bank of 41 Mile Creek about 1 km upstream from the Whipsaw Creek Forest Access Road. A good cattle trail connects to this road, which in turn connects with Provincial Highway 3. Total driving distance from Princeton is about 35 km.

Terrain is gently rolling with elevations from 5,500' to 6,000' asl. Vegetation is sparse pine. Neither terrain or timber cover will be a deterrent to physical work.

Claim Status

The 20 unit WHIP claim, shown on fig. 2, was staked for Lacana by G. Davies and recorded July 9, 1979 at the Princeton office of the Similkameen Mining Division and assigned record number 658.

GEOLOGY

Regional geology is shown on G.S.C. Map 888A, Memoir 243, by H.M.A. Rice. The WHIP showing and several others in the area, are clustered along the contact of the Triassic Nicola Group and the Jurassic Eagle granodiorite.

Local geology and mineralization have been described in some detail by G. Davies, from whose reports the following sections are taken.

" The principal rock type within the claim area is a medium to coarse grained biotite quartz diorite, much of it distinctly gneissic.

Normally gray in colour, it is noticeably brown weathering in most outcrops along 41 Mile Creek. Brownish iron carbonate is dusted throughout in the rock and coats its fractured surfaces. When so weathered, fracturing is generally more intense than in the gray phases.

Along 41 Mile Creek, it was noted that the foliated planes in the gneissic quartz diorite always paralleled the trend of the creek at that particular point, from north to northwest, with principal fracturing at right angles, east to northeast.

Narrow discontinuous pegmatitic or aplitic lenses were noted on occasion."

Mineralization

" On 41 Mile Creek, about 1,300 metres upstream from its confluence with Whipsaw Creek and just above the junction with its principal south flowing tributary, galena, sphalerite and pyrite with quartz is exposed for about a metre in length under an overhanging bank. Its apparent strike closely parallels that of the creek at this point, which is N20°E.

A high grade layer to 17 centimetres thick is enveloped by silicified material, particularly on the footwall side, to a thickness of about 30 centimetres and with it containing minor amounts of fine grained galena, sphalerite and pyrite.

For about 250 metres up this tributary from its mouth, small quartz fragments were noted frequently in the stream bed, and an occasional specimen would contain a crystal or two of pyrite.

For a distance of about 300 metres below the lead-zinc occurrence in 41 Mile Creek, specimens of quartz float were numerous. Generally devoid of sulphide, but occasionally contained pyrite and, in two instances, pyrite with minor amounts of fine grained galena and sphalerite.

Also noted frequently in this distance, a variably altered and siliceous quartz-feldspar porphyry float, containing variable amounts of fine disseminated pyrite.

Quartz float of good size also noted in the bars of creek, upstream from lead-zinc occurrence for a distance of about 250 metres. No sulphide was noted in these specimens."

Assay Data

Due to the mode of occurrence of the showing, essentially in the creek, accurate sampling has not been feasible. One sample was collected over about a 13 cm width, with results as follows:

Cu.	.694%
Pb.	19.3 %
Zn.	11.4 %
Ag.	10.9 oz/ton
Au.	.22 oz/ton

GEOCHEMISTRY

A detailed geochemical sampling programme, utilizing 111 soil samples and 13 stream sediments, was conducted in a limited area in the immediate vicinity of the Pb.-Zn. showing on 41 Mile Creek. Soil samples were taken from the B horizon where possible, at 10 meter spacing along 50 m apart north-south grid lines. Sediment sampling extended from 50 m downstream of the showing to 250 m above, at 25 m spacing. Samples were analyzed for Cu., Pb., Zn. and Ag. by Min-En Laboratories of North Vancouver, using techniques described in Appendix III. Analytical results for the four metals are shown on figures 3 - 6 and sample numbers on fig. 7.

Five samples were taken from pits dug by hand to depths of 1 to 1.3 metres. These are described below:

Sample 79-D-164 was taken at site 79-D-126 where the highest values of Cu., Pb., Zn. and Ag. were obtained. Several angular fragments and small boulders of dense salmon coloured rock containing pyrite and a pale green siliceous rock were unearthed, as well as small fragments of quartz, devoid of sulphide.

Samples 79-D-165, from a pit at site 79-D-101 and 79-D-166 from site 79-D-95, were devoid of sulphide.

At 79-D-167, (79-D-100) small fragments of a cream coloured fine grained rock containing minor disseminated pyrite and yellow-brown weathering quartz with no sulphides were found.

Sample 79-D-168 (79-D-50) was taken from a pit on the north side of 41 Mile Creek and contained several fragments of fine to medium grained, creamy coloured rock, with disseminated pyrite, as well as small fragments of flat angular pyritic rock.

APPENDIX I

STATEMENT OF QUALIFICATIONS

DARREL L. JOHNSON

I Darrel L. Johnson, of the City of Port Coquitlam, British Columbia, do hereby state that:

1. I am a graduate of the University of British Columbia with a B.Sc. degree in Geology, obtained in 1970;
2. I have been working in all phases of mineral exploration in British Columbia since 1964, and have held responsible positions as an exploration geologist with various exploration companies for the last 10 years;
3. I am presently the Managing Geologist of the Vancouver Office of Lacana Mining Corporation;
4. Field work described in this report was conducted by Mr. Gordon Davies, an expert prospector of 27 years experience, under the supervision of the author.

Dated this 25th day of April 1980
at Vancouver, B.C.

Darrel L. Johnson, Geologist

APPENDIX II

STATEMENT OF COSTS WHIP ASSESSMENT REPORT

1.	WAGES	Gordon Davies	July 17-20 29-31			
			Aug. 1,2, 18-24			
			Oct. 11-14	20 days @ \$70		1400
		Rick Ackeril	Same dates	20 Days @ \$40		800
		Darrel Johnson	July 18 Aug. 8	2 Days @ \$100		200
2.	Assay and Geochemical analysis costs (as per Min-En invoices)					576.15
3.	Support costs Meals, motel, car, miscelleneous etc (as per G. Davies expense accounts)					1080.26
			TOTAL			4056.41

David Johnson

*MIN-EN Laboratories Ltd.**Specialists in Mineral Environments*Corner 15th Street and Bewicke
705 WEST 15th STREET
NORTH VANCOUVER, B.C.
CANADAANALYTICAL PROCEDURE REPORTS FOR ASSESSMENT WORKPROCEDURES FOR: Cu, Mo, Cd, Pb, Mn, Ni, Ag, Zn

Samples are processed by Min-En Laboratories Ltd., at 705 W. 15th St., North Vancouver Laboratory employing the following procedures.

After drying the samples at 95^oC soil and stream sediment samples are screened by 80 mesh sieve to obtain the minus 80 mesh fraction for analysis. The rock samples are crushed by jaw crusher and pulverized by ceramic plated pulverizer.

1.0 gram of the samples are digested for 6 hours with HNO₃ and HClO₄ mixture.

After cooling the samples are diluted to standard volume. The solutions are analysed by Atomic Absorption Spectrophotometers.

Copper, Lead, Zinc, Silver, Cadmium, Cobalt, Nickel and Manganese are analysed using the CH₂H₂-Air Flame combination but the Molybdenum determination is carried out by C₂H₂-N₂O gas mixture directly or indirectly (depending on the sensitivity and detection limit required) on these sample solutions.

Background corrections for Pb, Ag, Cd upon request are completed.

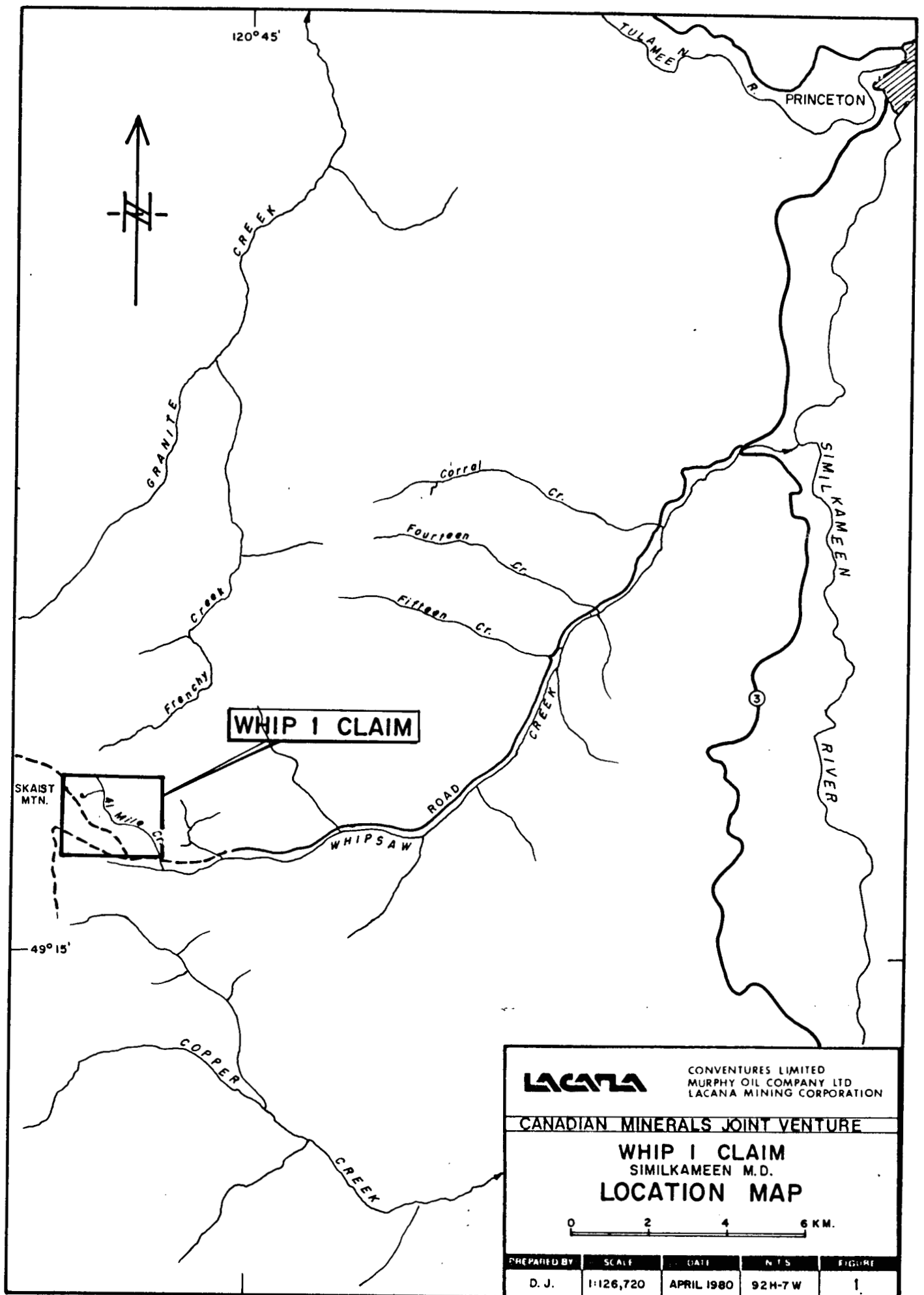

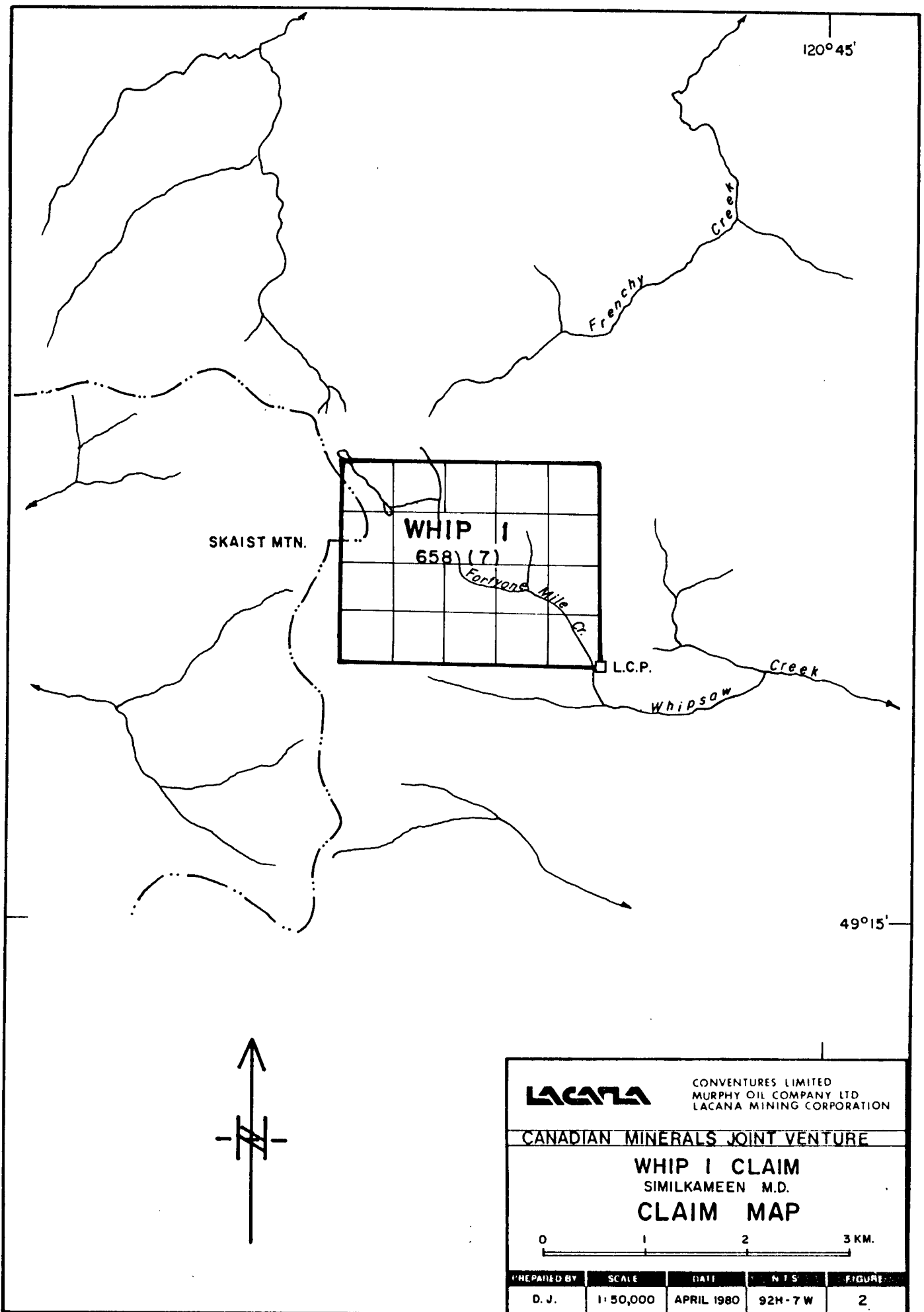

120°45'

SKAIST MTN.

WHIP I
658 (7)

Fortyone Mile Cr.

Frenchy
Creek

L.C.P.

Whipsaw
Creek

49°15'



LACANA		CONVENTURES LIMITED MURPHY OIL COMPANY LTD LACANA MINING CORPORATION		
CANADIAN MINERALS JOINT VENTURE				
WHIP I CLAIM SIMILKAMEEN M.D.				
CLAIM MAP				
0 1 2 3 KM.				
PREPARED BY	SCALE	DATE	N.T.S.	FIGURE
D. J.	1:50,000	APRIL 1980	92H-7 W	2

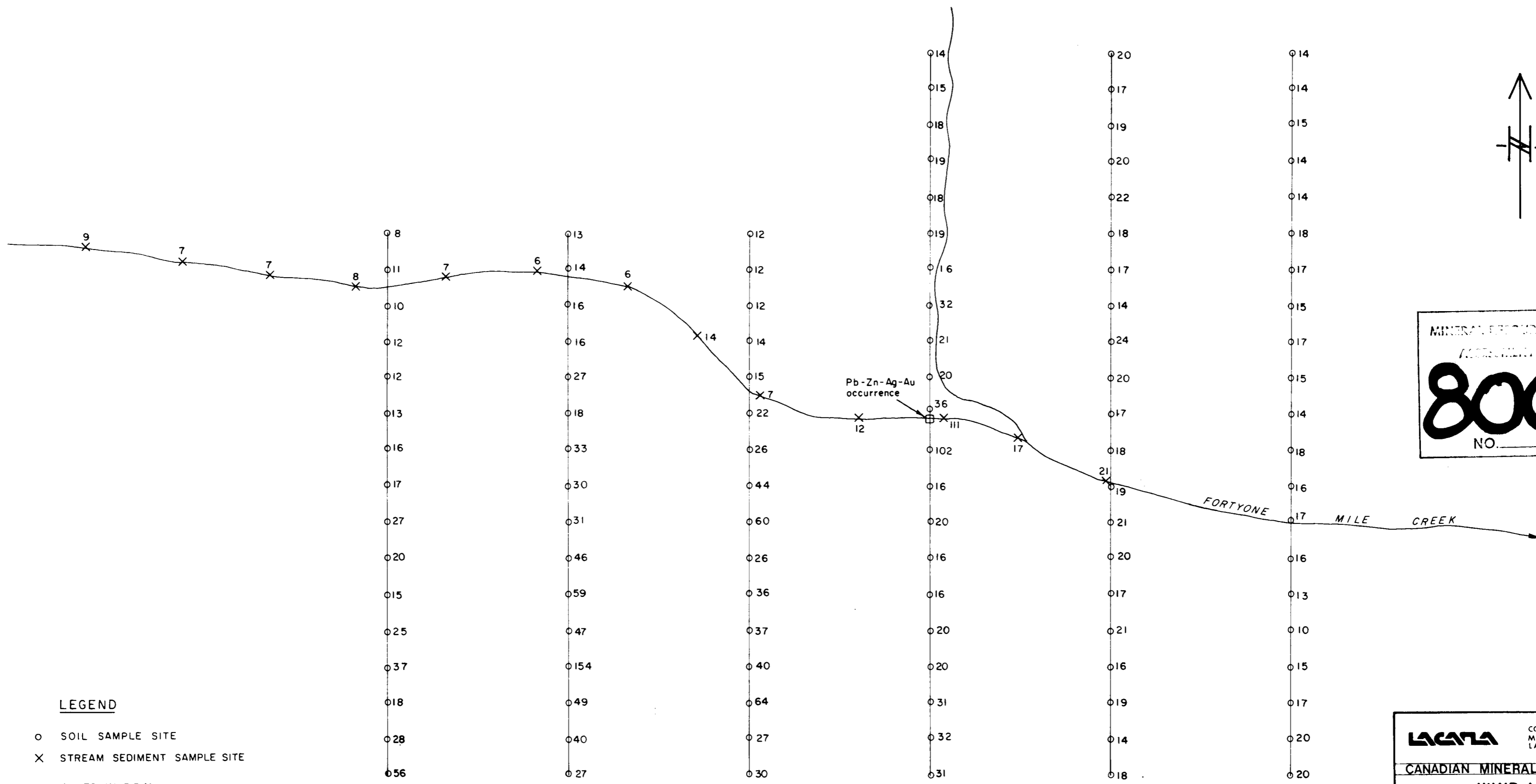

LEGEND

- SOIL SAMPLE SITE
- × STREAM SEDIMENT SAMPLE SITE

ALL VALUES IN P.P.M.

MINERAL RESOURCES BRANCH
ASSESSMENT REPORT
8005
NO. _____

LACANA CONVENTURES LIMITED
MURPHY OIL COMPANY LTD.
LACANA MINING CORPORATION

CANADIAN MINERALS JOINT VENTURE

WHIP 1 CLAIM
SIMILKAMEEN M. D.
LEAD GEOCHEMISTRY

0 10 20 30 40 50 METRES

PREPARED BY	SCALE	DATE	S.T.N.	FIGURE
G.D./D.J.	1:1000	APRIL 1980	92H-7W	3

360 n 1220m

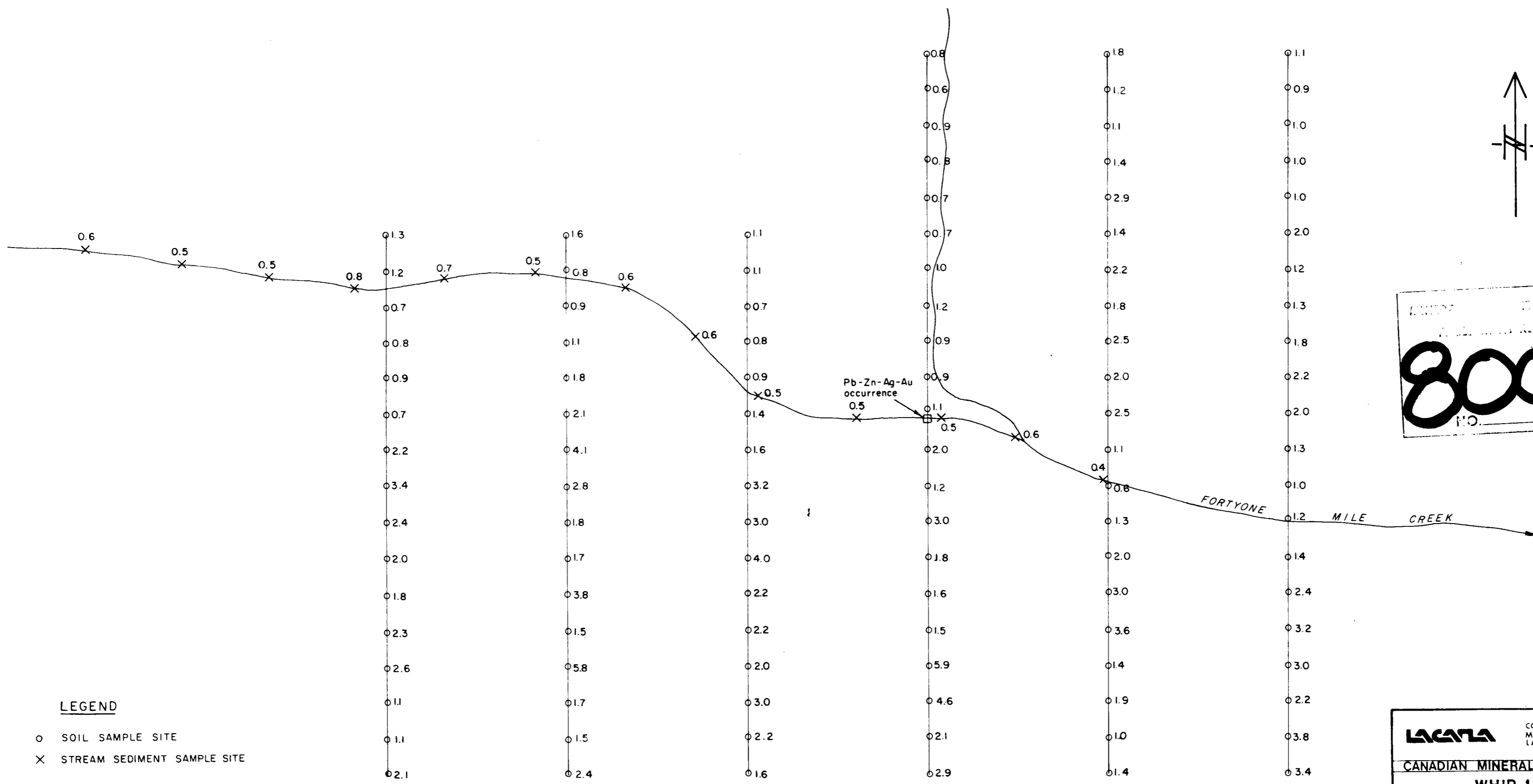

MINING DIVISION
 FIELD REPORT
8005
 NO.

LEGEND

- O SOIL SAMPLE SITE
- X STREAM SEDIMENT SAMPLE SITE

ALL VALUES IN P.P.M.

LACANA				
CONVENTURES LIMITED MURPHY OIL COMPANY LTD LACANA MINING CORPORATION				
CANADIAN MINERALS JOINT VENTURE				
WHIP 1 CLAIM SIMILKAMEEN M. D.				
SILVER GEOCHEMISTRY				
0 10 20 30 40 50 METRES				
PREPARED BY	SCALE	DATE	SHEET	TOTAL SHEETS
GD/D.J.	1:1000	APRIL 1980	92H-7W	4

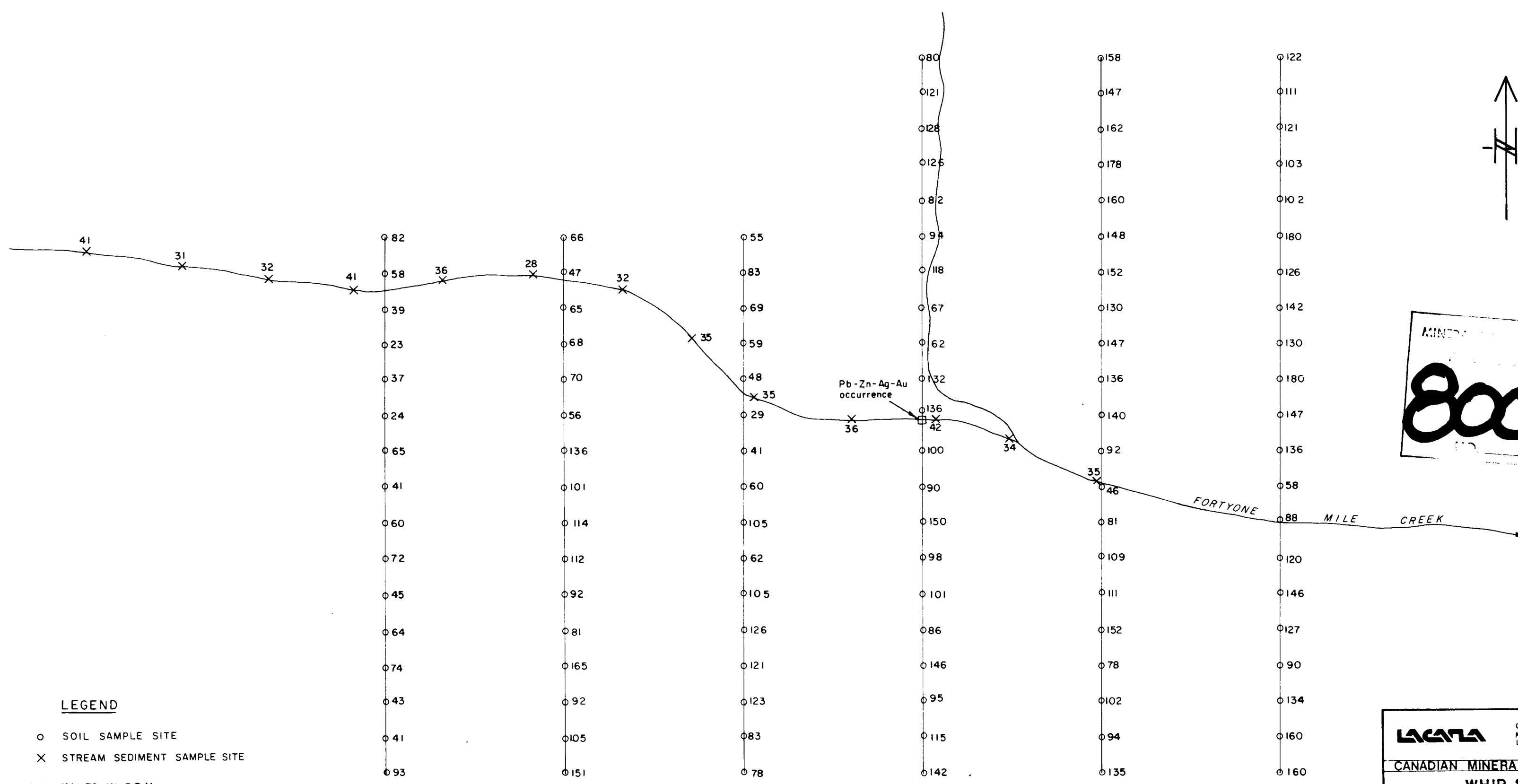

MINERAL PROPERTY REPORT
8005

LEGEND

- SOIL SAMPLE SITE
 - × STREAM SEDIMENT SAMPLE SITE
- ALL VALUES IN P.P.M.

LACANA					CONVENTURES LIMITED MURPHY OIL COMPANY LTD LACANA MINING CORPORATION
CANADIAN MINERALS JOINT VENTURE					
WHIP 1 CLAIM SIMILKAMEEN M. D.					
COPPER GEOCHEMISTRY					
0 10 20 30 40 50 METRES					
PREPARED BY	SCALE	DATE	SHEET	FIGURE	
GD./D.J.	1:1000	APRIL 1980	92H-7W	5	

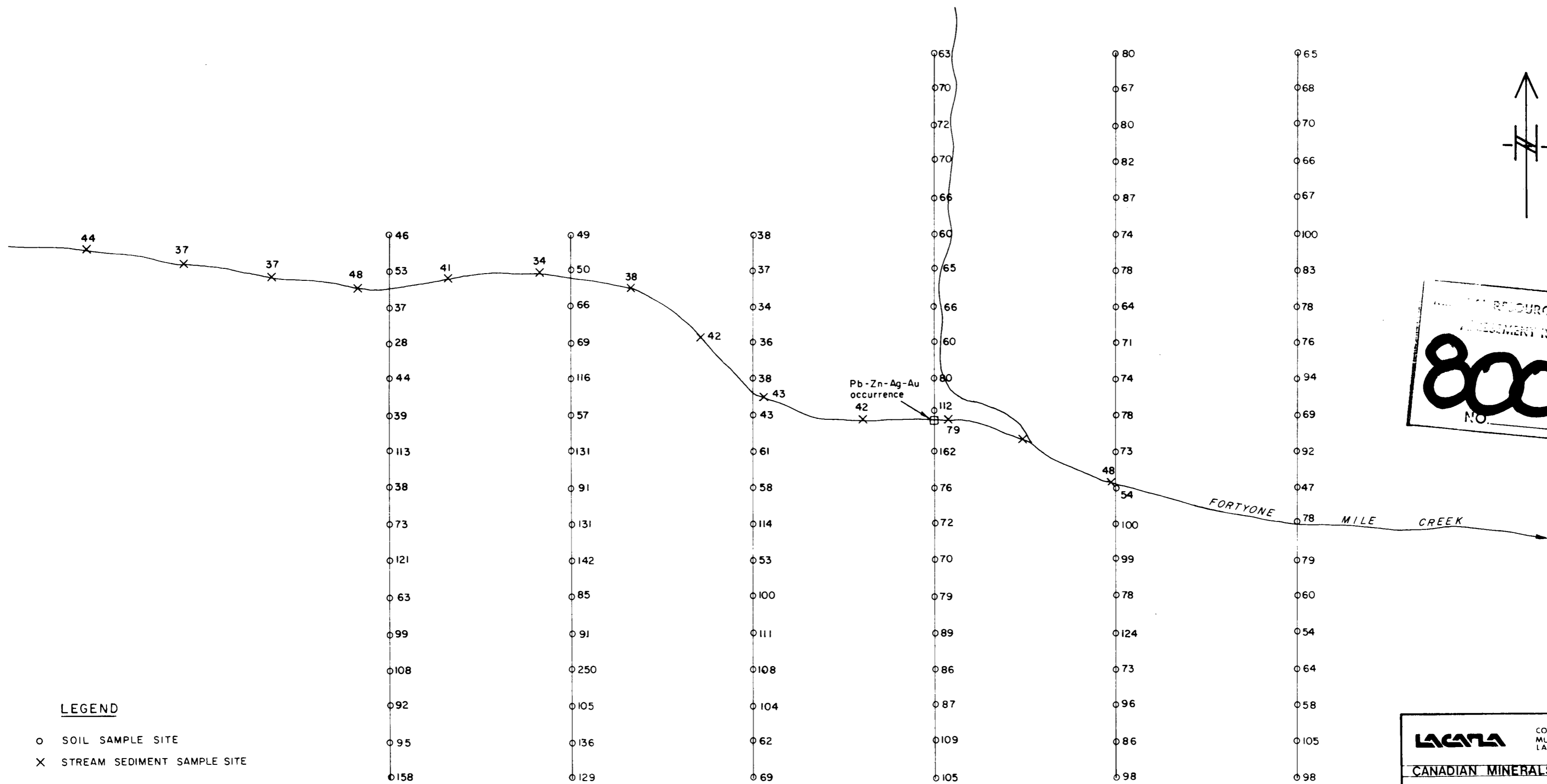

LEGEND

- O SOIL SAMPLE SITE
- X STREAM SEDIMENT SAMPLE SITE

ALL VALUES IN P.P.M.

MINERAL RESOURCES BRANCH
ASSESSMENT REPORT
8005
NO.

LACANA		CONVENTURES LIMITED MURPHY OIL COMPANY LTD LACANA MINING CORPORATION	
CANADIAN MINERALS JOINT VENTURE			
WHIP 1 CLAIM SIMILKAMEEN M. D.			
ZINC GEOCHEMISTRY			
0 10 20 30 40 50 METRES			
PREPARED BY	SCALE	DATE	FILE NO.
G.D./D.J.	1:1000	APRIL 1980	92H-7W 6

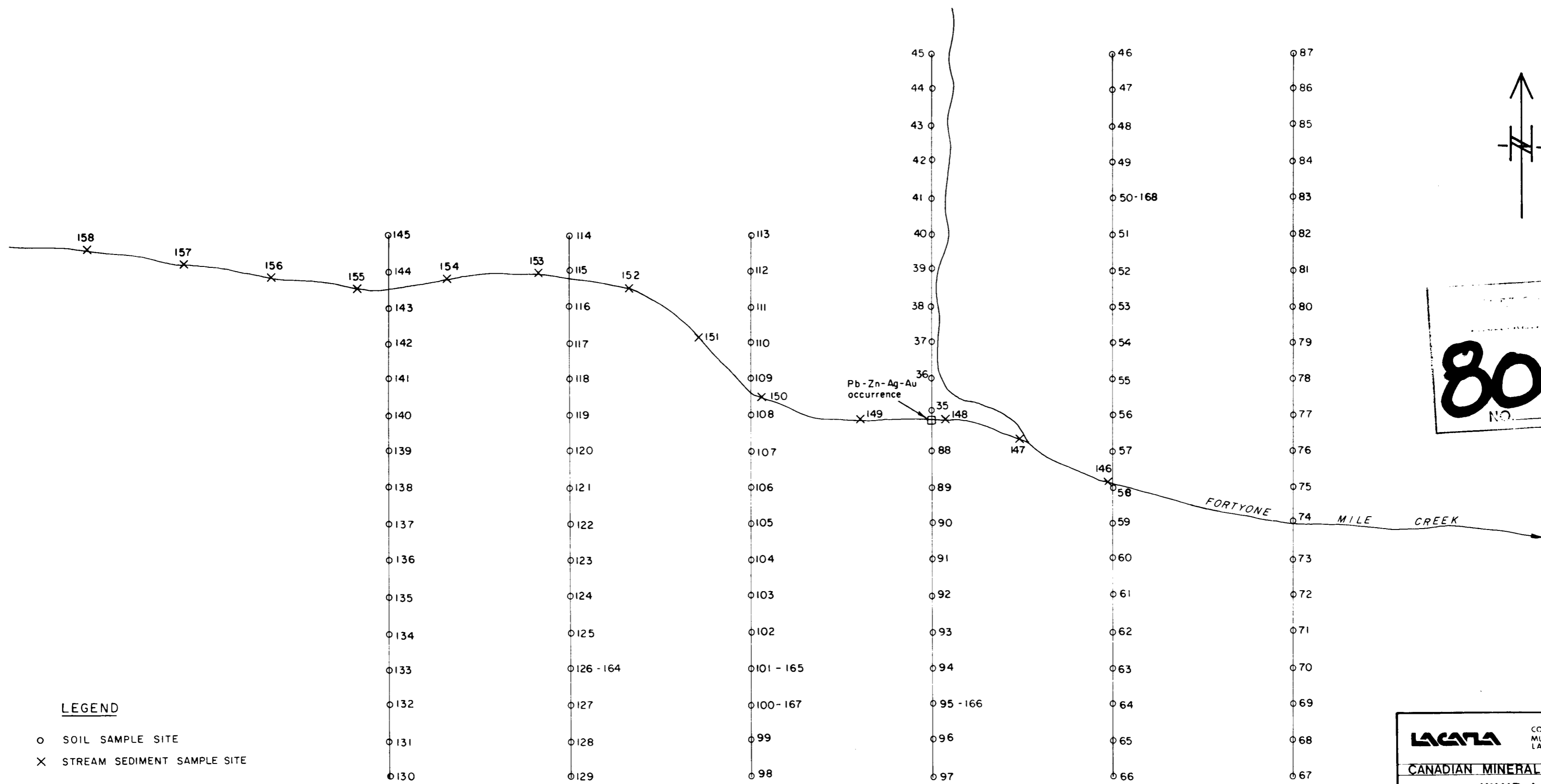

REPORT NO. 8005
 NO. _____

LEGEND

- SOIL SAMPLE SITE
- × STREAM SEDIMENT SAMPLE SITE

LACANA		CONVENTURES LIMITED MURPHY OIL COMPANY LTD. LACANA MINING CORPORATION		
CANADIAN MINERALS JOINT VENTURE				
WHIP 1 CLAIM SIMILKAMEEN M. D. SAMPLE NUMBER				
0 10 20 30 40 50 METRES				
PREPARED BY	SCALE	DATE	SHEET	FIGURE
G.D./D.J	1:1000	APRIL 1980	92H-7W	7

GEOCHEMICAL ANALYSIS DATA SHEET

PROJECT No.:

MIN - EN Laboratories Ltd.

DATE: **July 30**

ATTENTION: **D. Johnson, G. Davies**

705 WEST 15th ST., NORTH VANCOUVER, B.C. V7M 1T2
PHONE (604) 980-5814

1979.

Sample No.	Mo ppm	Cu ppm	Pb ppm	Zn ppm	Ni ppm	Co ppm	Ag ppm	Fe ppm	Hg ppb	As ppm	Mn ppm	Au ppb
79D65		94	14	86			10					
66		135	18	98			14					
67		160	20	98			34					
68		160	20	105			38					
69		134	17	88			22					
70		90	15	64			30					
71		127	10	54			32					
72		146	13	60			24					
73		120	16	79			14					
74		88	17	78			12					
75		58	16	47			10					
76		136	18	92			13					
77		147	14	69			20					
78		180	15	94			22					
79		130	17	76			18					
80		142	15	78			13					
81		126	17	83			12					
82		180	18	100			20					
83		102	14	67			10					
84		103	14	66			10					
85		121	15	70			10					
86		111	14	68			09					
87		122	14	65			11					
88		100	102	162			20					
89		90	16	76			12					
90		150	20	72			30					
91		98	16	70			18					
92		101	16	79			16					
93		86	20	89			15					
79D94		146	20	86			59					

APPENDIX IV

Handwritten mark

PROJECT No. _____

MIN - EN Laboratories Ltd.

DATE: **July 30**

ATTENTION: **D. Johnson, G. Davies**

705 WEST 15th ST. NORTH VANCOUVER, B.C. V7M 1T2
PHONE (604) 980-5914

1979.

Sample Number	Mo ppm	Cu ppm	Pb ppm	Zn ppm	Ni ppm	Co ppm	Ag ppm	Fe ppm	Hg ppb	As ppm	Mn ppm	Au ppb
79D35		136	36	112			11					
36		132	20	80			09					
37		62	21	60			09					
38		67	32	66			12					
39		118	16	65			10					
40		94	19	60			07					
41		82	18	66			07					
42		126	19	70			08					
43		128	18	72			09					
44		121	18	70			06					
45		80	14	63			08					
46		158	20	80			18					
47		147	17	67			12					
48		162	19	80			11					
49		178	20	82			14					
50		160	22	87			29					
51		148	18	74			14					
52		152	17	78			22					
53		130	14	64			18					
54		147	24	71			25					
55		136	20	74			20					
56		140	17	78			25					
57		92	18	73			11					
58		46	19	54			06					
59		81	21	100			13					
60		109	20	99			20					
61		111	17	78			30					
62		154	21	124			36					
63		78	16	73			14					
79D64		102	19	96			19					

APPENDIX IV

Handwritten mark

MIN-EN LABORATORIES LTD.

705 WEST 15TH STREET
 NORTH VANCOUVER, B.C.
 Phone: 980 5814

APPENDIX IV

Certificate of Assay

TO: Lacana Mining Corp.,
312-409 Granville St.,
Vancouver, B.C.

PROJECT No. WHIP

DATE July 31/79.

File No. 9-421

SAMPLE No.	Cu %	Pb %	Zn %	Ag oz/ton	Au oz/ton
	79D34	.694	19.30	11.40	10.90

MIN-EN Laboratories Ltd.

CERTIFIED BY _____

GEOCHEMICAL ANALYSIS DATA SHEET

PROJECT No.:

MIN - EN Laboratories Ltd.

DATE: **Aug. 10,**

ATTENTION: **D. Johnson, G. Davies**

705 WEST 15th ST., NORTH VANCOUVER, B.C. V7M 1T7
PHONE (604) 980-5814

1979.

Sample Number	Mo ppm	Cu ppm	Pb ppm	Zn ppm	Ni ppm	Co ppm	Ag ppm	Fe ppm	Hg ppb	As ppm	Mn ppm	Au ppb
79D114		66	13	49			16					
115		47	14	50			08					
116		65	16	66			09					
117		68	16	69			11					
118		70	27	116			18					
119		56	18	57			21					
120		136	33	131			41					
121		101	30	91			28					
122		114	31	131			18					
123		112	46	142			17					
124		92	59	85			38					
125		81	47	91			15					
126		165	154	250			58					
127		92	49	108			17					
128		105	40	136			15					
129		151	27	129			24					
130		93	56	158			21					
131		41	28	95			11					
132		43	18	92			11					
133		74	37	108			26					
134		64	25	99			23					
135		45	15	63			18					
136		72	20	121			20					
137		60	27	73			24					
138		41	17	38			34					
139		65	16	113			22					
140		24	13	39			07					
141		37	12	44			09					
142		23	12	28			08					
79D143		39	10	37			07					

APPENDIX IV

Handwritten signature

GEOCHEMICAL ANALYSIS DATA SHEET

PROJECT No.:

MIN - EN Laboratories Ltd.

DATE: **July 30**

ATTENTION: **D. Johnson, G. Davies**

705 WEST 15th ST., NORTH VANCOUVER, B.C. V7M 1T2
PHONE (604) 980-5814

1979.

Sample Number	Mo ppm	Cu ppm	Pb ppm	Zn ppm	Ni ppm	Co ppm	Ag ppm	Fe ppm	Hg ppb	As ppm	Mn ppm	Au ppb				
81	86	90	95	100	105	110	115	120	125	130	135	140	145	150	155	160
79D95		138	31	87				46								
96		115	32	109				21								
97		142	31	105				29								
98		78	30	69				16								
99		83	27	62				22								
100		123	64	104				30								
101		121	40	108				20								
102		126	37	111				22								
103		105	36	100				22								
104		62	26	53				40								
105		105	60	114				30								
106		60	44	58				32								
107		41	26	61				16								
108		29	22	43				14								
109		48	15	38				09								
110		59	14	36				08								
111		69	12	34				07								
112		83	12	37				11								
79D113		55	12	38				11								
		%	%	%				oz/ton				oz/ton				
79D34		16.94	19.3	11.4				10.90				0.220				
ASSAY								:								
								:								
								:								
								:								
								:								
								:								
								:								
								:								
								:								

APPENDIX IV

AD 31

COMPAN **Lacana Mining**

GEOCHEMICAL ANALYSIS DATA SHEET

FILE No. **9-478**

PROJECT No.:

MIN - EN Laboratories Ltd.

DATE: **Aug. 10, 1979.**

ATTENTION: **D. Johnson, G. Davies**

705 WEST 15th ST., NORTH VANCOUVER, B.C. V7M 1T2
PHONE (604) 980-5814

Sample Number	Mo ppm	Cu ppm	Pb ppm	Zn ppm	Ni ppm	Co ppm	Ag ppm	Fe ppm	Hg ppb	As ppm	Mn ppm	Au ppb				
81	90	95	100	105	110	115	120	125	130	135	140	145	150	155	160	
79D144		58	11	53			12									
145		82	8	46			13									
146		35	21	48			04									
147		34	17	48			06									
148		42	111	79			05									
149		36	12	42			05									
150		35	7	43			05									
151		35	14	42			06									
152		32	6	38			06									
153		28	6	39			05									(40mesh)
154		36	7	41			07									
155		41	8	48			08									
156		32	7	37			05									
157		31	7	37			05									
158		41	9	44			06									
159		41	8	192			06									
160		37	9	40			05									
79D161		52	10	24			06									
							.									
							.									
							.									
							.									
							.									
							.									
							.									
							.									
							.									
							.									

APPENDIX IV