

PROSPECTING REPORT

ELEANOR GROUP

NELSON M.D.

49° 16' N, 117° 14' W

82 F / 6E

S. W. BARCLAY

TABLE OF CONTENTS

Commodity.....	Page 1
Object.....	Page 1
Location.....	Page 1
Title.....	Page 1
Map No. 1.....	Page 2
Map No. 2.....	Page 3
Access and Topography.....	Page 4
History.....	Page 4
Qualifications.....	Page 4
Statement of Costs.....	Page 5
Map No. 3.....	Page 6
Author's Report.....	Page 7

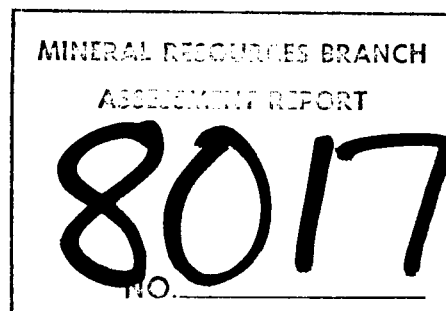

COMMODITY - MO and WO₃

These two minerals occur widespread in the Ymir area, and the price per unit is at record highs, giving the prospector incentive to search out concentrations of these metals.

OBJECT

This report is submitted for the purpose of recording assessment work on the Eleanor Group of 8 claims.

LOCATION

Located in the Nelson Mining Division at Long. 117°14' Lat. 49°10' as shown on Dominion Topographic System area 82/6E.

Map No. 1 - Elevation from 2500' to 3700'.

Map No. 2 - Shows relation to adjoining claims.

The central portion of the claims lie about 500 m north of the Ymir intersection on the Ymir-Nelson Highway, and about 260 m west of the highway.

TITLE

The claims under consideration in this report, Eleanor 1 - 8, are owned by E.H. Barclay, R.R. # 3, Nelson, E.C.

S.W.
AB

85F/6

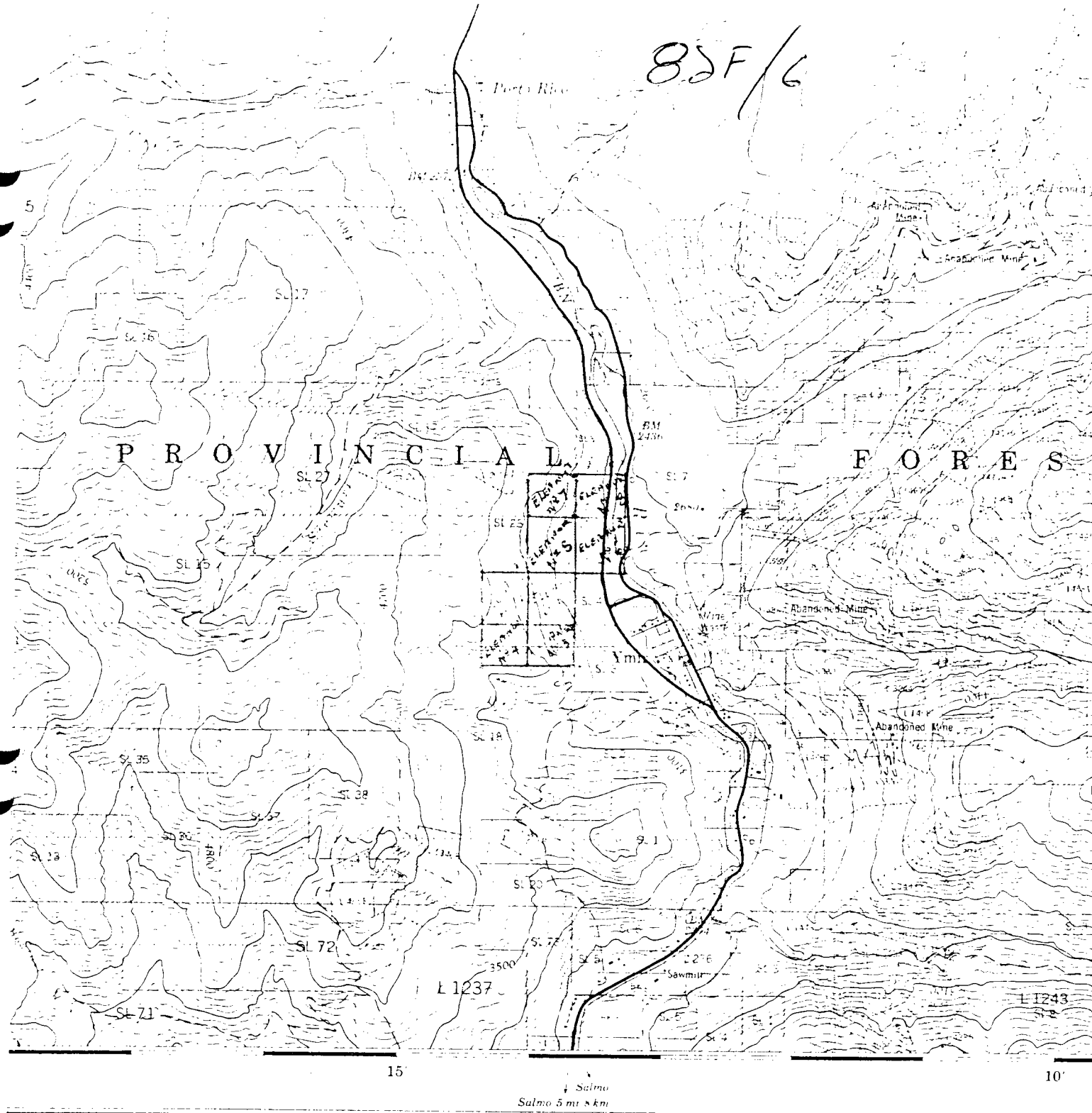

NELSON
 KOOTENAY LAND DISTRICT
 BRITISH COLUMBIA
 WEST OF FIFTH MERIDIAN - OUEST DU CINQUIÈME MÉRIDIEN
 Scale 1:50,000 Échelle

85F/6
 Edition # 3
 MAP # 1

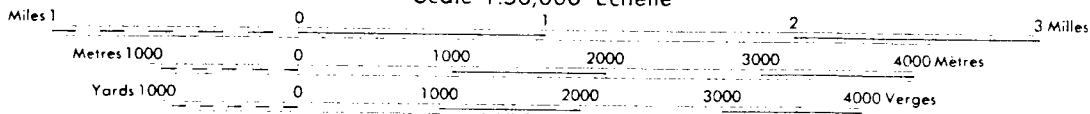

CONTOUR INTERVAL 100 FEET
 Elevations in Feet above Mean Sea Level
 North American Datum 1927
 Transverse Mercator Projection

3
2
1
915'

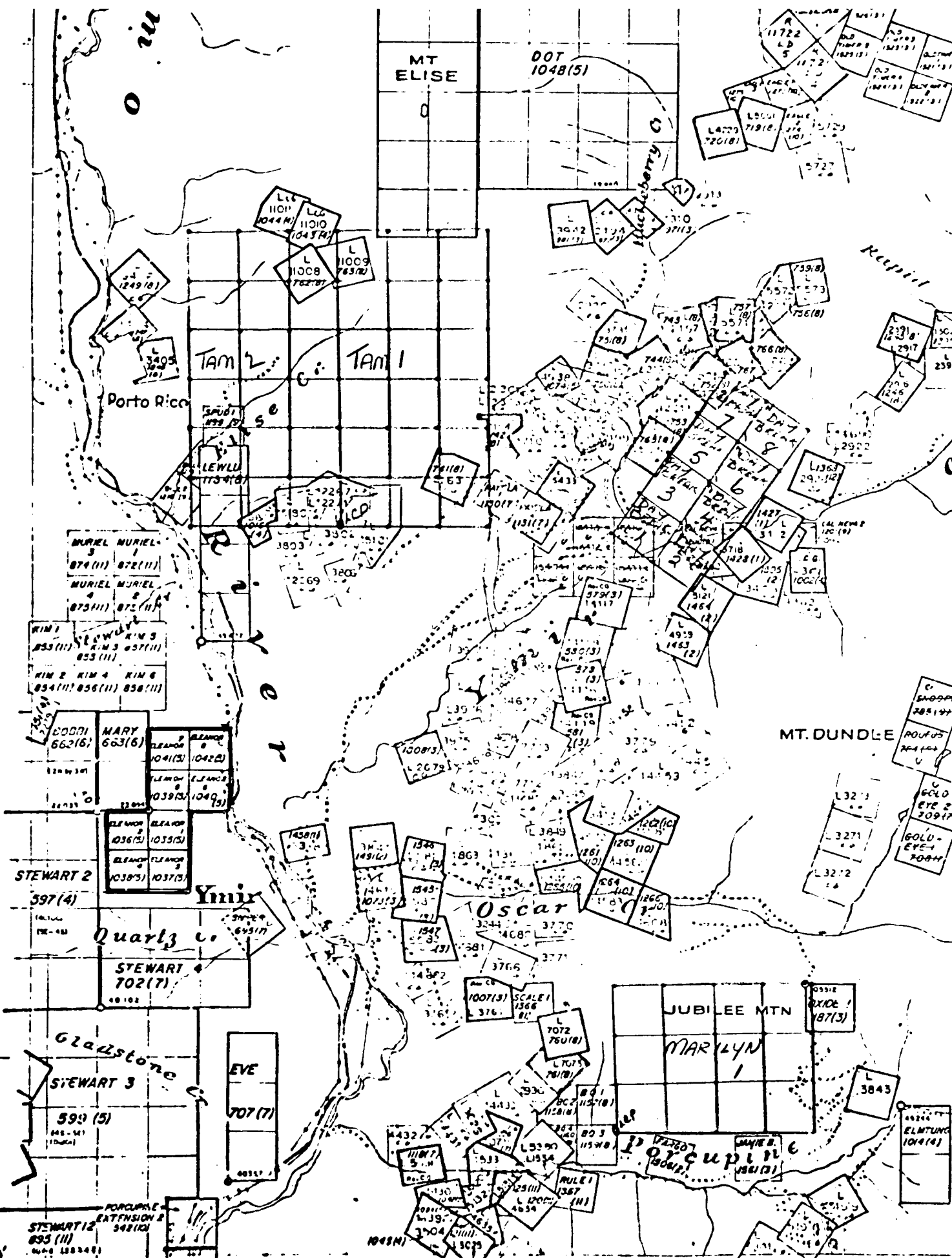

ACCESS AND TOPOGRAPHY

The southern portion of the Group lies in an area that has been logged off leaving down timber and thick underbrush. A very rough and steep road leaves the main highway near the Ymir water tank and goes westerly in a series of switch-backs and gains an altitude of 3500 feet, then along a fairly easy grade where it ends at Young Creek, a small water course.

The northern portion of the property rises abruptly from near the highway from 2500 feet to over 3500 feet making penetration exceedingly rough and tiresome. Although the area has been burnt over there still remains small pockets of sizeable trees, but all species of thick underbrush cover the steep hillside.

HISTORY

The Ymir area is one of the oldest Lode Mining Camps in B.C., and from 1898 for a few years boasted of the largest gold mine in Canada, along with several other properties which had erected small mills to treat their ores.

Although past production from the Ymir area appears to be mainly Gold-Silver-Lead, recent discoveries of MO and WO₃ have revived the area, and the coming season will see work performed on several MO prospects and a new high-grade gold prospect.

QUALIFICATIONS

The author, S.W. Barclay, retired from Newmont Explorations after 25 years as prospector/field representative, and I have been closely associated with the following projects:

1. Trout Lake Molly - Lardeau, B.C.
2. Ajax Molly - Alice Arm, B.C.
3. Pelly River Project - Yukon

During these years I have been active in the search for, and the examination of, properties of merit.

STATEMENT OF COSTS

Powder	\$109.74
Gas	<u>31.00</u>
	\$140.74
Cost of preparation	<u>10.00</u>
	<u>\$150.74</u>

12 day @ .60	720.
Total Cost.	<u>\$ 870.74</u>

Sw Barclay	
10 days @ 60 ⁰⁰ per day	600.00

Peers Pendlebury	
2 days @ 60 ⁰⁰ per day =	120.00
Total Wages	<u>\$1720.00</u>

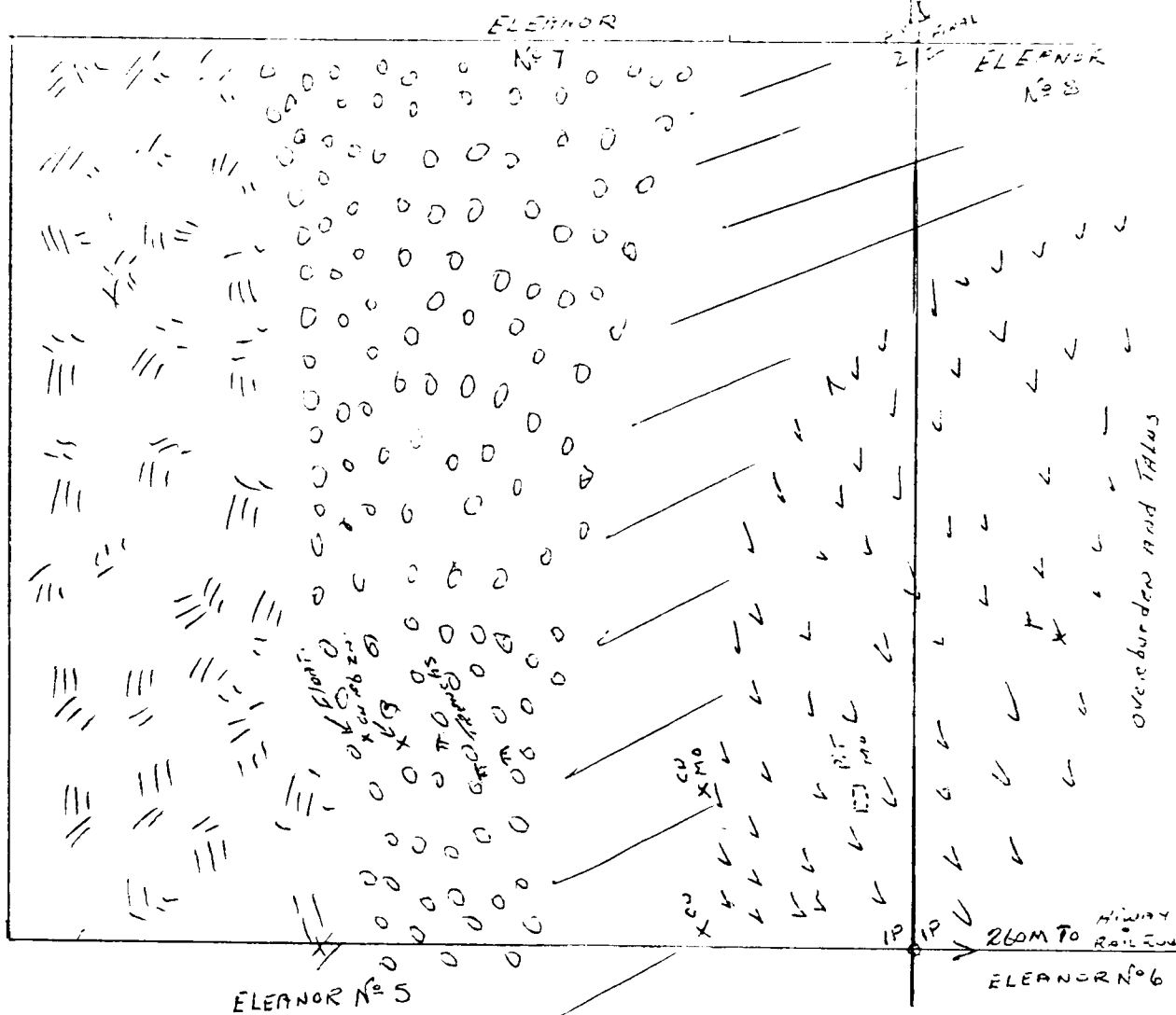

SHOWING WORK ON ELEANOR No. 7
LOCATION SHOWN ON MAP No. 1

CLAIM POSTS POSITIONED BY
BELT METER AND COMPASS

MAP # 3

AUTHOR'S REPORT

Prospecting and blasting of overburden was carried out during the periods listed below. The writer was assisted by Peers Pendlebury, who has completed and passed the Nelson Prospecting Course of 1978.

June 21 - 22 - 23 (2), 1979.
April 9 - 11 - 12 (2), 1980.
April 17 (2) - 18, 1980.

All traverses followed an east-west direction as nearly as possible on the steep hillside. Outcrops were sufficient to project the several rock types through the work area.

On the talus slopes below the work area several pieces of float rock contained some pyrite and minor MO. A few smaller pieces showed considerable chalcopryrite and minor MO. Enough was found to indicate the hillside should be prospected.

Above the talus slope and at the base of the cliffs an area of diorite containing small amounts of pyrite contacts the augite-porphry. The augite near the contact contains several small quartz veins mineralized with pyrite and minor MO. Chalcopryrite was seen as disseminations in the augite-porphry. Altogether the total amount of mineral was not great.

The quartzite band contained a few grains of pyrite and in the upper contact with the seynite some blocks of quartz were seen carrying very minor PbZn and several specks of chalcopryrite. Some blasting was carried out to try and locate the vein but was unsuccessful.



S.W. Barclay