

IGNA engineering & consulting ltd.

A REPORT ON THE 1979 EXPLORATION
ON THE MONTY "A" & "B" CLAIMS
SOUTH OF WELLS, CARIBOO M.D. BRITISH COLUMBIA

N.T.S. 93H/4E

For: L. & G. RESOURCES LTD.

Field Work: Sept. 21-30, 1979
Oct. 30-Nov. 9, 1979

By: I. Borovic, P. Eng.
Geologist

Report: Feb. & March 1980

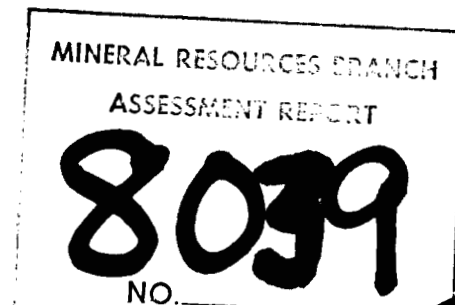

PART 1862

TABLE OF CONTENTS

	<u>Page</u>
Introduction	1
Property.....	1
Location.....	1
Access.....	1
Owner.....	1
Location Map.....	1a
Geology.....	2
Property Geology.....	2
Structure.....	2
Metamorphism.....	2
Work Done.....	3
Sept. 21-30, 1979 Geological Mapping	3
Oct. 30-Nov. 9, 1979 Geochemical Soil Survey.....	4
Sampling.....	4
Results.....	5
Discussion.....	5
Conclusion & Recommendation.....	6
Work To Do.....	6
Budget Estimate.....	8
References.....	9
Statement of Expenses.....	10
Certificate	11
Geological Map 1:5000 (in pocket)	
Geology Plan.....	12
Soil Sample Location Plan Au.....-	13
" Ag.....	14
" Pb.....	15
" Cu.....	16
General Testing Laboratories:	
1. Certificate of Assay No. 7910 - 0450 (in pocket)	
2. Certificate of Assay No. 7911 - 1551(in pocket)	

IGNA engineering & consulting ltd.

L. & G. R E S O U R C E S L T D.

A REPORT ON THE 1979 EXPLORATION OF THE
MONTY "A" & "B" CLAIMS
SOUTH OF WELLS, CARIBOO M.D. BRITISH COLUMBIA

Introduction

Mr. J. La Fleur commissioned the author to do exploration work on the ^{J.E. LA FLEUR'S} (L. & G. Resources) Monty Claims. The following report gives a full account of the work done in late 1979.

Property: Monty "A" (20 units) Monty "B" (20 units)

Location: Lat. 53°02' N. Long. 121°41' (93H/4E)

Cariboo M.D. about 10 km south of Wells, B.C., partly covering the area of the old town of Stanley.

Access: From Stanley toward east, the old Richfield-Barker-ville road runs through the property and connects to the old access road leading north across the property to the top of Burns Mtn.

Owner: ^{J.E. LA FLEUR}
L. & G. Resources Ltd. - OPERATOR

26-640 Burrard St.

Vancouver, B. C. V6C 2L1

(604) 681-9348

2

1

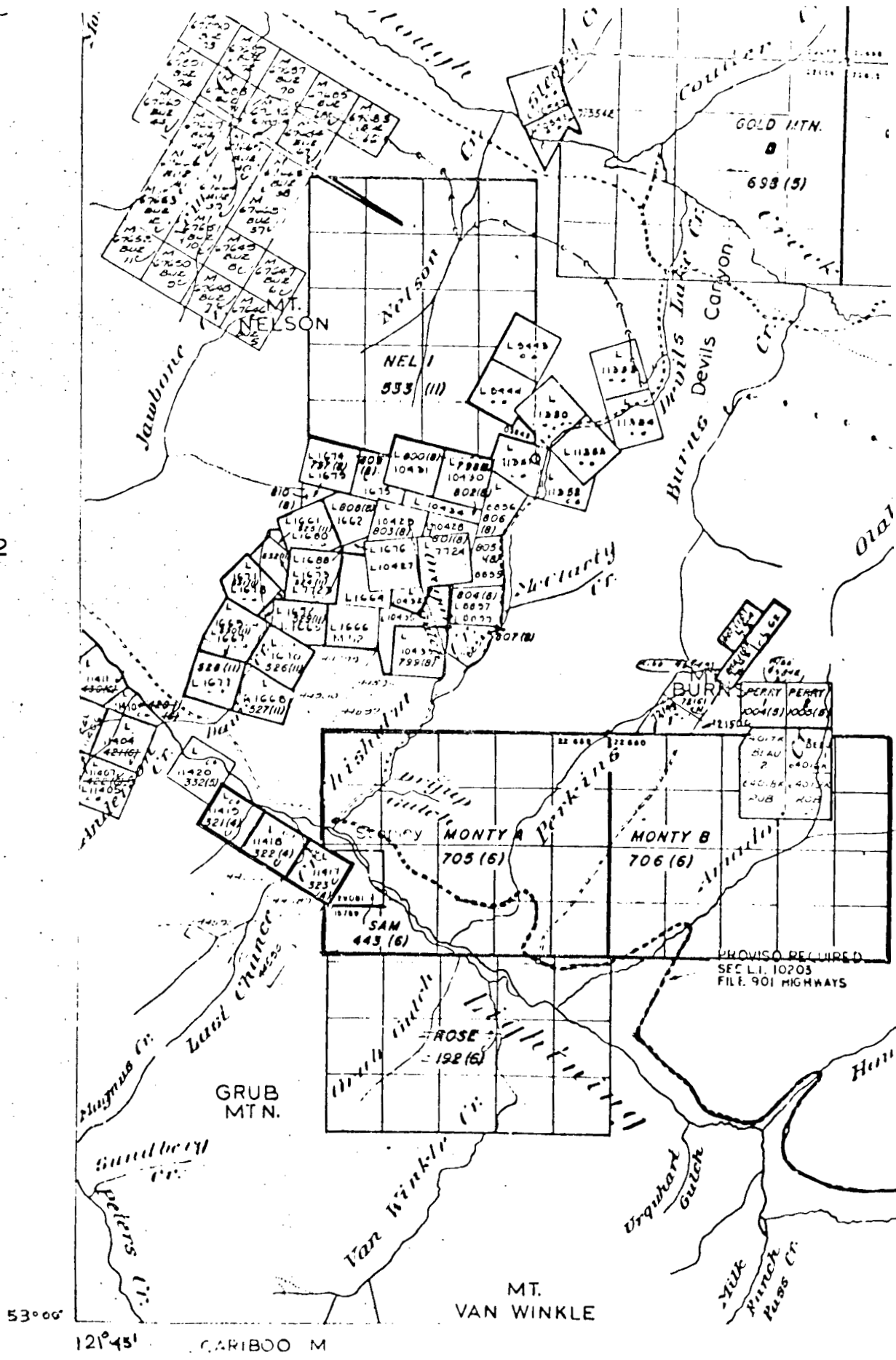

L & G RESOURCES LTD

MONTY "A" & "B"

CLAIM LOCATION MAP

93 H 4

1:50 000

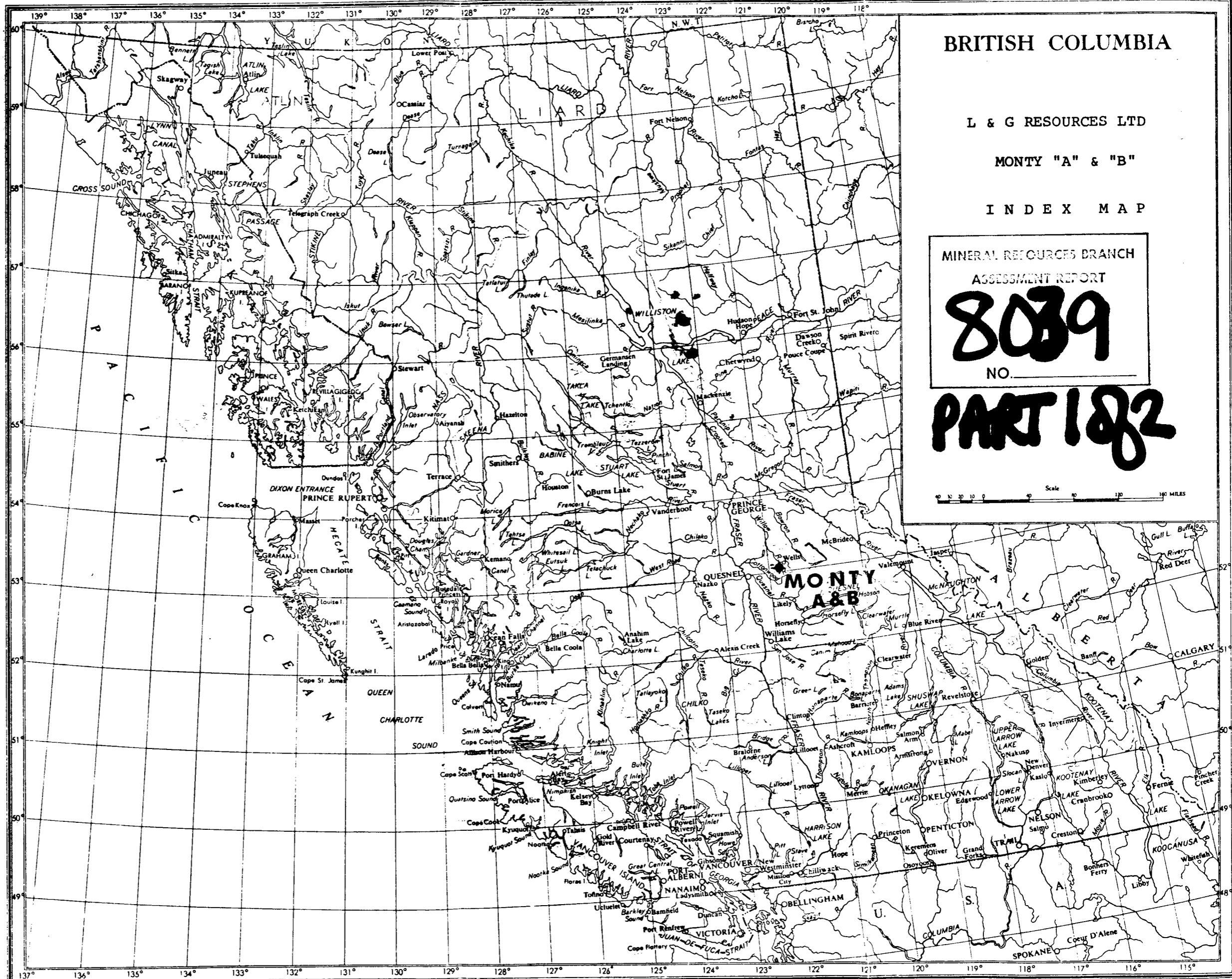

BRITISH COLUMBIA

L & G RESOURCES LTD

MONTY "A" & "B"

INDEX MAP

MINERAL RESOURCES BRANCH
 ASSESSMENT REPORT
8039
 NO.

PART 182

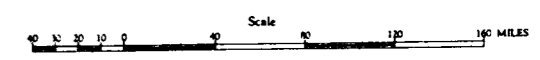

Drawn and Produced by the Map Production Division, Surveys and Mapping Branch, Victoria, British Columbia

Geology

Geological mapping confirmed Campbell, Mountjoy, Young's (1973) description of the regional geology and structure of the Lightning Creek area.

Property Geology

Underlying the property are rocks of Kaza Group and Snowshoe Formation. It appears that two groups are stratigraphically equivalent but facieswise different. Main rock types are: feldspatic sandstones, quartzites (often micaceous and schistose), phyllites, mica schists, minor chloritic schists and occasional limestone lenses.

It is not possible to differentiate and outline different units inside the group in sparsely scattered outcrops.

Structure

Property occupies a part of Lightning Creek anticlinorium. The crest and axis of the structure strikes NW - SE and passes through the Lightning Creek Valley.

Intense folding and faulting was observed inside anticlinorium. Foliation varies with lithology.

Some drag folding was found but there is evidence of primary sedimentary deformation also.

Metamorphism

The rocks outcropping on the property show low intensity metamorphic effects.

Work Done

Following exploration work was accomplished:

Sept. 21-30, 1979

1. Compass and hip-chain survey of the access roads, flagging and marking 100 m stations to be used as starting points for the initial grid system.
2. Preliminary survey of the Monty's Legal Corner Post into the initial grid and tying the L.C.P. to the Rob, Beau and Perry claims in order to outline staked areas and define ownership of the grounds.
3. Geological mapping and sampling.
4. Fourteen samples were analysed for gold, silver and copper in the facilities of the Commercial Testing Laboratories in Vancouver.

The following assay results were obtained:

	<u>Au</u> <u>oz/st</u>	<u>Ag</u> <u>oz/st</u>	<u>Cu (%)</u>
RM 1	0.002	trace	0.003
RM 2	0.008	trace	0.002
RM 3	0.002	trace	0.002
RM 6	0.002	trace	0.002
RM 7-1	0.002	trace	0.003
RM 7-2	0.002	trace	0.003
RM 7-3	0.002	trace	0.004
RM 7-4	0.002	trace	0.003
RM 7-8	0.002	trace	0.002
RM 9	0.002	trace	0.002
RM 10	0.002	trace	0.002

October 30 - November 9

Geochemical soil survey was done on six lines located on the Monty Claims south of Rob #1 & #2 Claims. The survey's aim was to find a narrow target representing gold bearing veins on the southern projection of the Spruce Canyon Fault Zone which appears to control Perkins and Cohen gold vein structure.

Following lines were surveyed:

Line 1 + 00 N 13 + 00 E

Line 3 + 00 N 12 + 50 E

Line 5 + 00 N 11 + 50 E

Line 7 + 00 N 9 + 50 E

Old trench on a

Line 10 + 00 N 12 + 50 E

And road to Burns Mtn. Long Xcut on a

Line 11 + 00 N 9 + 50 E

The locations of soil samples grid are shown on the 1:5000 scale Sample Location Plans and are compatible with 1:5000 Geological Map. The Plans and Map are attached to the report. The survey was done by Mr. Rudy Durfeld, Geologist under supervision of the author. The assaying of the samples was done in the General Testing Laboratories and "Certificates of Assay" , together with handwritten original reports by Mr. Durfeld, are appended to this report.

Sampling

Soil samples were taken from a well developed B-horizon. The soils generally suggested a transported origin but in some instances residual soils were recognized. A Geology

...5

Plan showing type of soil sampled is attached to the report

Results

Some 208 samples were collected and analysed for gold, silver, copper and lead. It was hoped that the pattern of the distribution of assay results would give us a lead on a location of the extension of the gold-bearing veins.

Discussion

Gold

Results do not show any preferred trend. Dispersion is fairly homogenous throughout the surveyed area and values are in general very low. Soils on Line 10 + 00 N toward west show lower values than the rest of the area surveyed, but for one sample assaying 0.13 PPM, which could be caused by contamination of transported glacial overburden.

Silver

I considered 0.5 PPM a threshold value and all values above 1.0 PPM as anomalous. (Note that 1 PPM = 1 gram/tonne metric)

Distribution of high silver values appear erratic but the values are generally high relative to the traces of silver found in the rock samples. (see page 3)

There are not any trends to be recognized and there is no correlation with gold values.

,...6

...6

Copper

The distribution of values shows no trend and in general the values are low. There is only a few analyses above 40 PPM and they are erratic.

Lead

Distribution is erratic and does not correlate with either of analyses metals.

There is one high value of 233PPM (11 + 00 N & 7 + 00 E) which could be result of contamination from the nearby Burns Mtn. Long Xcut but the soil on that place appears to be residual and not transported and it is possible that lead showing is situated on that location.

Conclusion & Recommendation

The results when plotted on the maps appear erratic and do not show a trend of expected mineralized veins. But high silver and some lead values should be checked in the field for possible mineral showings.

In my opinion there is enough encouragement to continue with explorations of this area of Monty Claims, as suggested in my Progress Report of October, 1979.

Work To Do

In order to test the Spruce Canyon fault zone mineralization, the following work is recommended:

Trenching of three trenches (using D-7 bulldozer) as shown on the attached geology map.

Trench #1 Extending in easterly direction and for about 300 m an old trench located at 11 + 50 N.

...7

....7

Trench #2 Along existing trench from 10 + 25 N extending toward southeast and east.

Trench #3 Is located in between and is parallel to T #1 & #2 just north of the access road to "Burns Mtn. Long Xcut".

...8

R E F E R E N C E S

- BOWMAN, A. (1889):
 Report on the Geology of the Mining District
 of Cariboo, B. C.
 G. S. C. Ann. Rept. 1887-88, V.111
- CAMPBELL, R. E. (1961):
 Quesnel Lake (West Half), B. C.
 G.S.C. Map 3-1961
- CAMPBELL, R. B., MOUNTJOY, E. W. & YOUNG, F. G. (1973):
 Geology of McBride Map-Area B. C.
 G.S.C. Paper 72-35
- GUIGUET, M. & MASON, E.E. (1979):
 Report on the Burns Mountain Property, Beau Group.
 Cariboo M. D., Stanley, B. C.
 N.T.S. 93H/4E
- Vancouver, April 18, 1979.
 Spectrum's File
- HANSON, G. (1934):
 Willow River Map-Area, General Geology and
 Lode Deposits
 G.S.C. Summary Report 1933
- HANSON, G. (1935):
 Barkerville Gold Belt, Cariboo District, B. C.
 G.S.C. Memoir 181
- HOLLAND, S.S. (1948)
 Report on the Stanley Area Cariboo Mining Division
 Bulletin No. 26, B. C. Department of Mines, Victoria
- JOHNSTON, W. A. & UGLOW, W. L. (1926):
 Placer and Gold Deposits of Barkerville
 G.S.C. Memoir 1949 .
- SUTHERLAND-BROWN, A. (1957):
 Geology of the Antler Creek Area, Cariboo District,
 B. C.
 B. C. Department of Mines Bulletin 38
- UGLOW, W. L. (1922):
 Bedrock and Quartz Veins, Barkerville.
 G.S.C. Summary Report 1922, Part A, pp 82-87

STATEMENT OF EXPENSES

The following is a breakdown of expenses incurred in carrying out the exploration work on this area of L. & G. Resources Ltd.'s Monty A & B claims during Sept., Oct., Nov. 1979 and Feb.-March 1980.

1. Field Work

Geological Mapping	
Chain & Compass Survey	
<u>-Personnel:</u>	
I. Borović, P. Eng. (Sept. 21-30, 1979)	\$ 2,800
Geochemical Soil Survey	
<u>-Personnel</u>	
R. Durfeld, Geologist (Oct. 30-Nov. 9, 1979)	2,200
I. Borovic, P. Eng. (Oct.30-Nov. 2, 1979)	400
	\$ 5,400

2. Office Work

<u>-Personnel</u>	
I. Borovic, P. Eng. (Feb. & March 1980) 10 days	\$ 2,000
Draftsman (Feb. 1980)	100
<u>-Assays</u>	
General Testing Laboratories	1,932
	\$ 4,032

Recapitulation

Field Work	\$ 5,400
Office Work	\$ 4,032
	\$ 9,432

GEOLOG. MAP + REPORTS BY C.W. BALL 1193
 10625

C E R T I F I C A T E

I, I. Borovic, with business address in Vancouver,
British Columbia, do hereby certify:

1. That I have personally done and supervised exploration
work performed in the area of Monty A & B claims
located in the Cariboo M.D., B. C.
2. That the expenditures claimed for the performance of
the work are correct.

Respectfully submitted

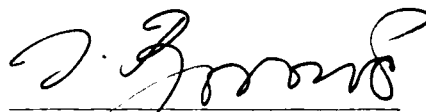

I. Borovic, P. Eng.
Geologist

Symbols

- T - transported soil
- R - residual soil
- Qtz - quartz
- Hem - hematite

GEOLOGY PLAN.

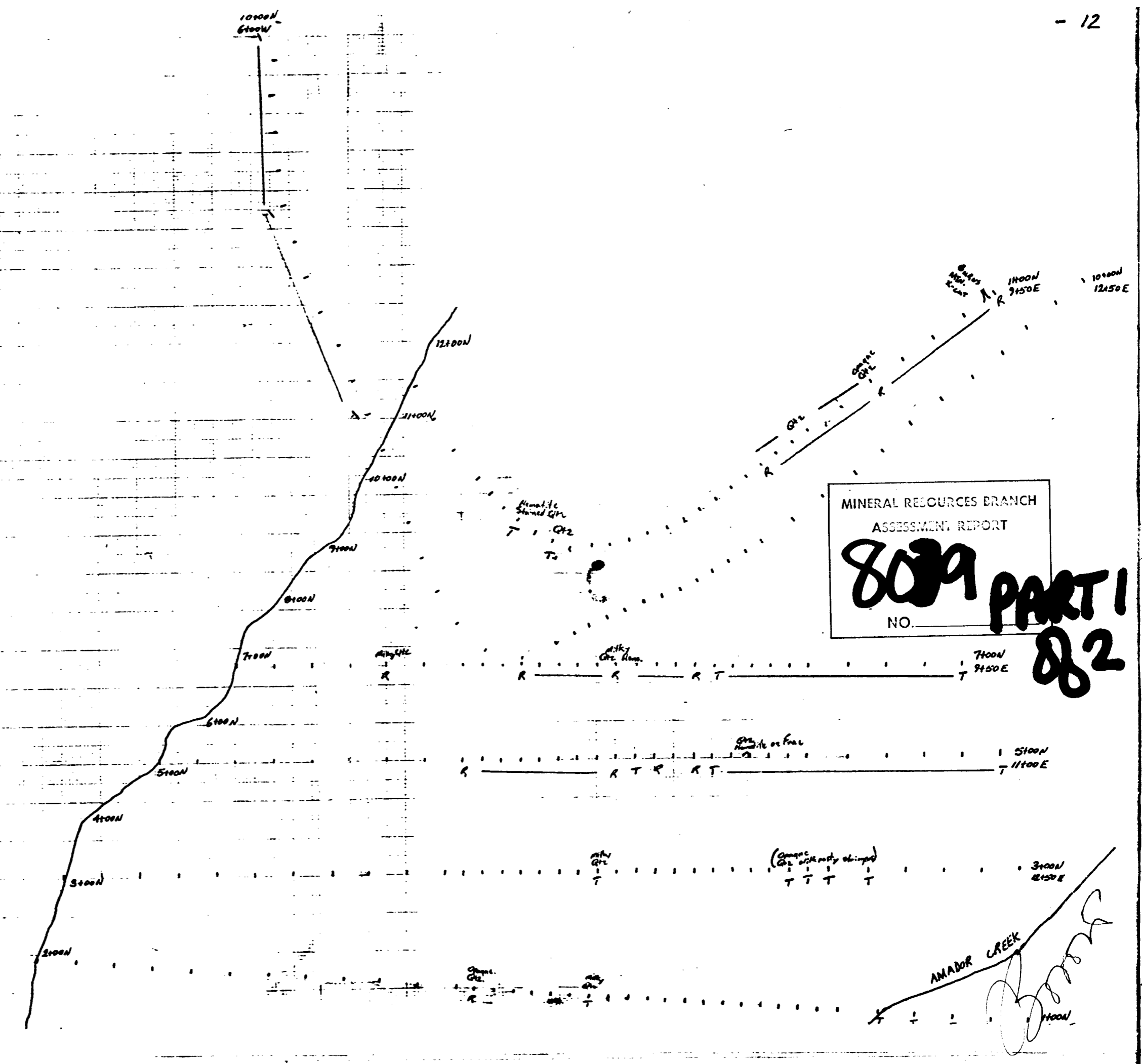

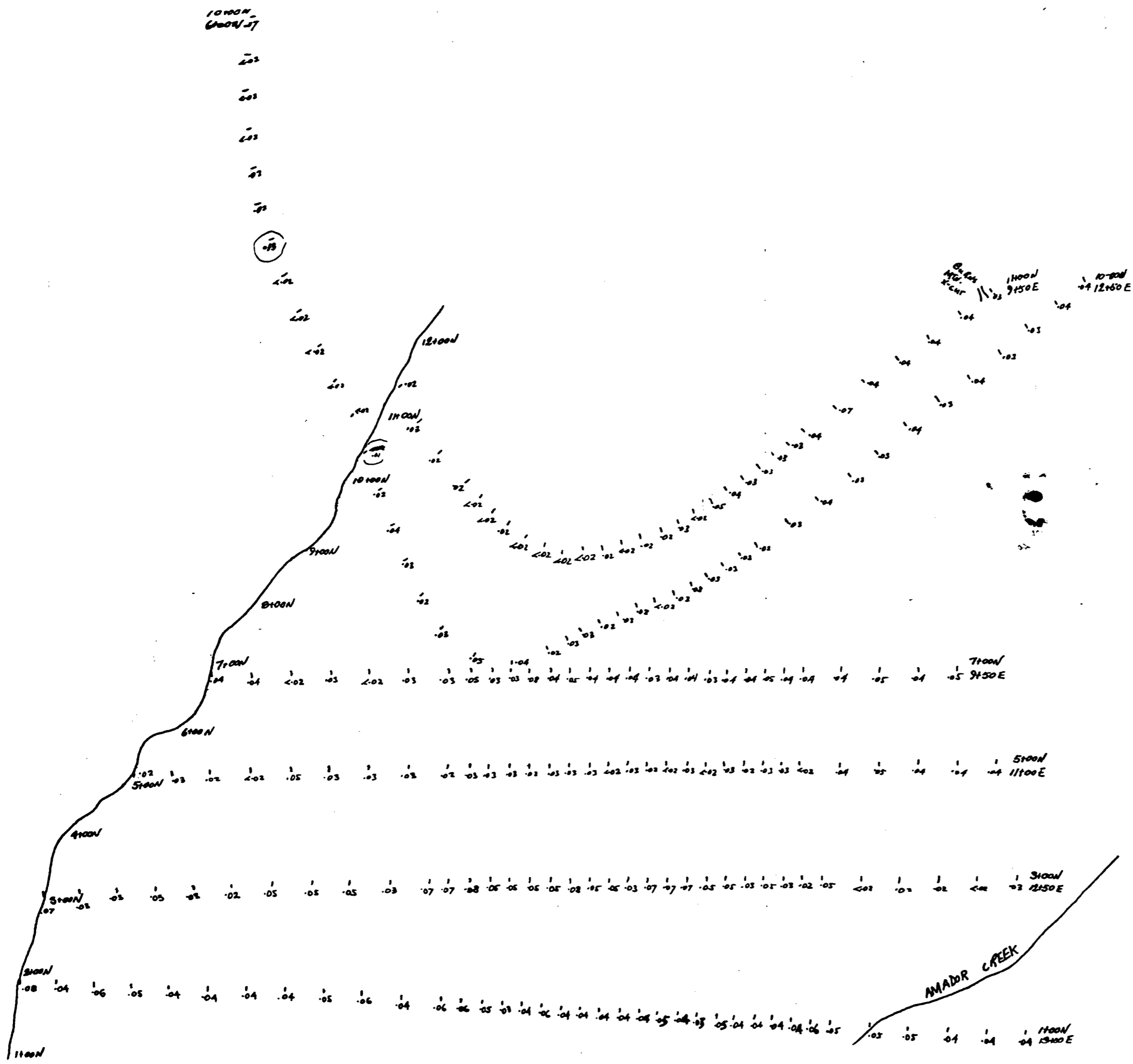

MINERAL RESOURCES BRANCH
 ASSESSMENT REPORT
8039
 NO. _____

PART 1 & 2

A4

MONTY CLAIMS
 SOIL SAMPLE LOCATION PLAN

SCALE: 1:5000

Boone



MINERAL RESOURCES BRANCH
 ASSESSMENT REPORT
8039
 NO. _____

PART 1072

Ag

MONTY CLAIMS

SOIL SAMPLE LOCATION PLAN

SCALE: 1:5000



— > .4 & < .5 —
 ⊙ .1 + *Borish*

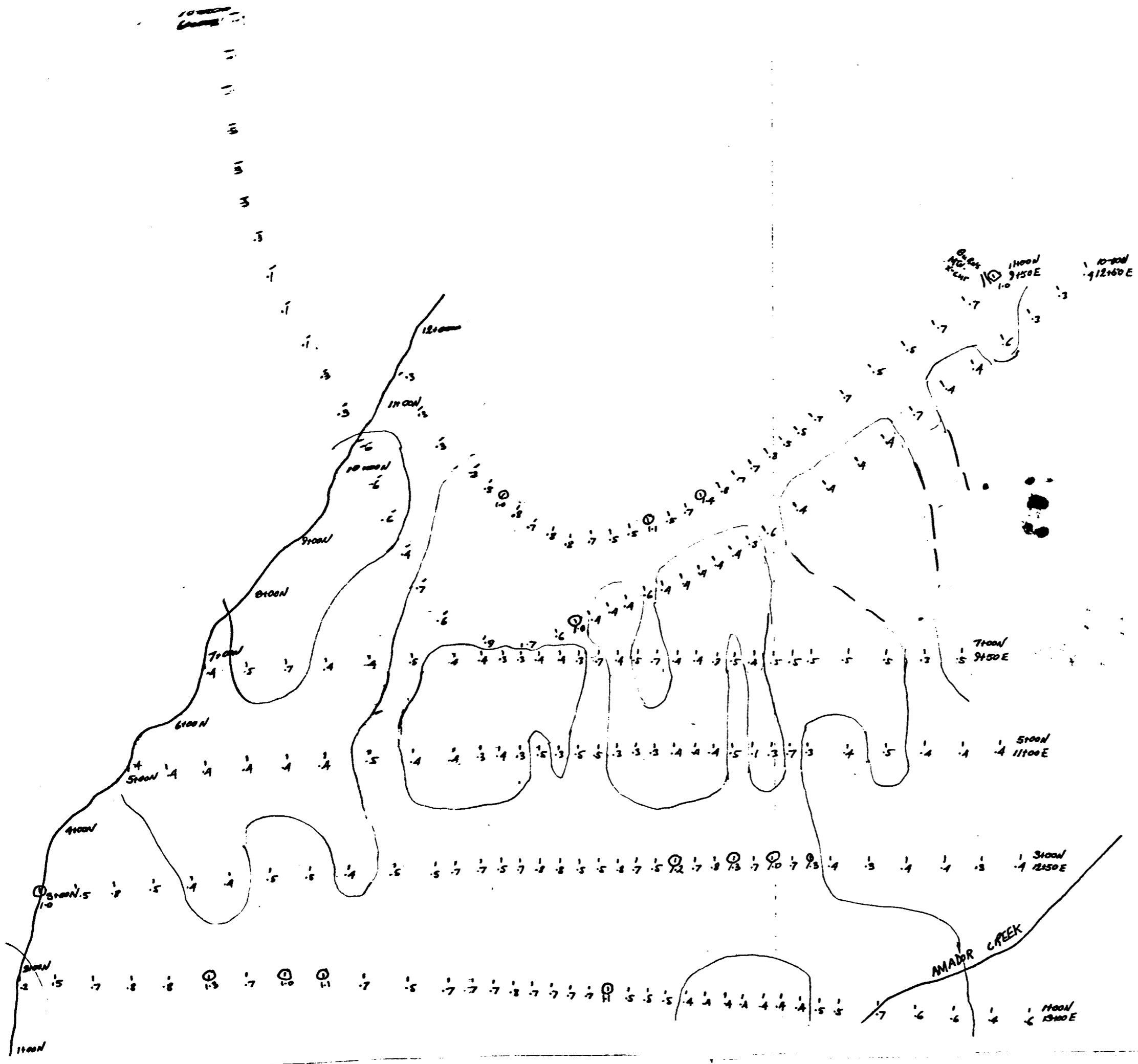

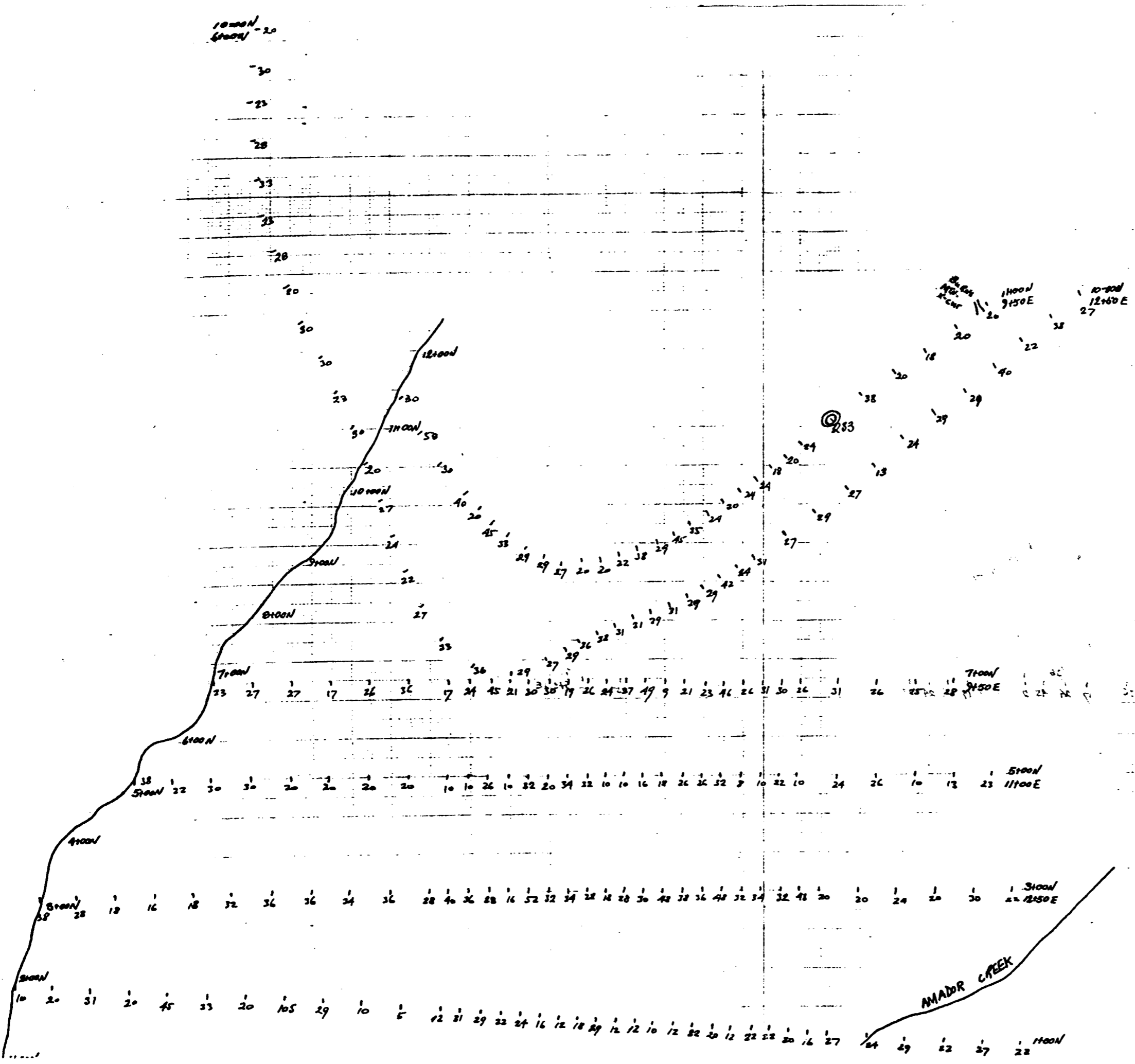

MINERAL RESOURCES BRANCH
 ASSESSMENT REPORT
8039
 NO.

PART 1 & 2

Pb

MONTY CLAIMS
 SOIL SAMPLE LOCATION PLAN
 SCALE: 1:5000



[Handwritten signature]

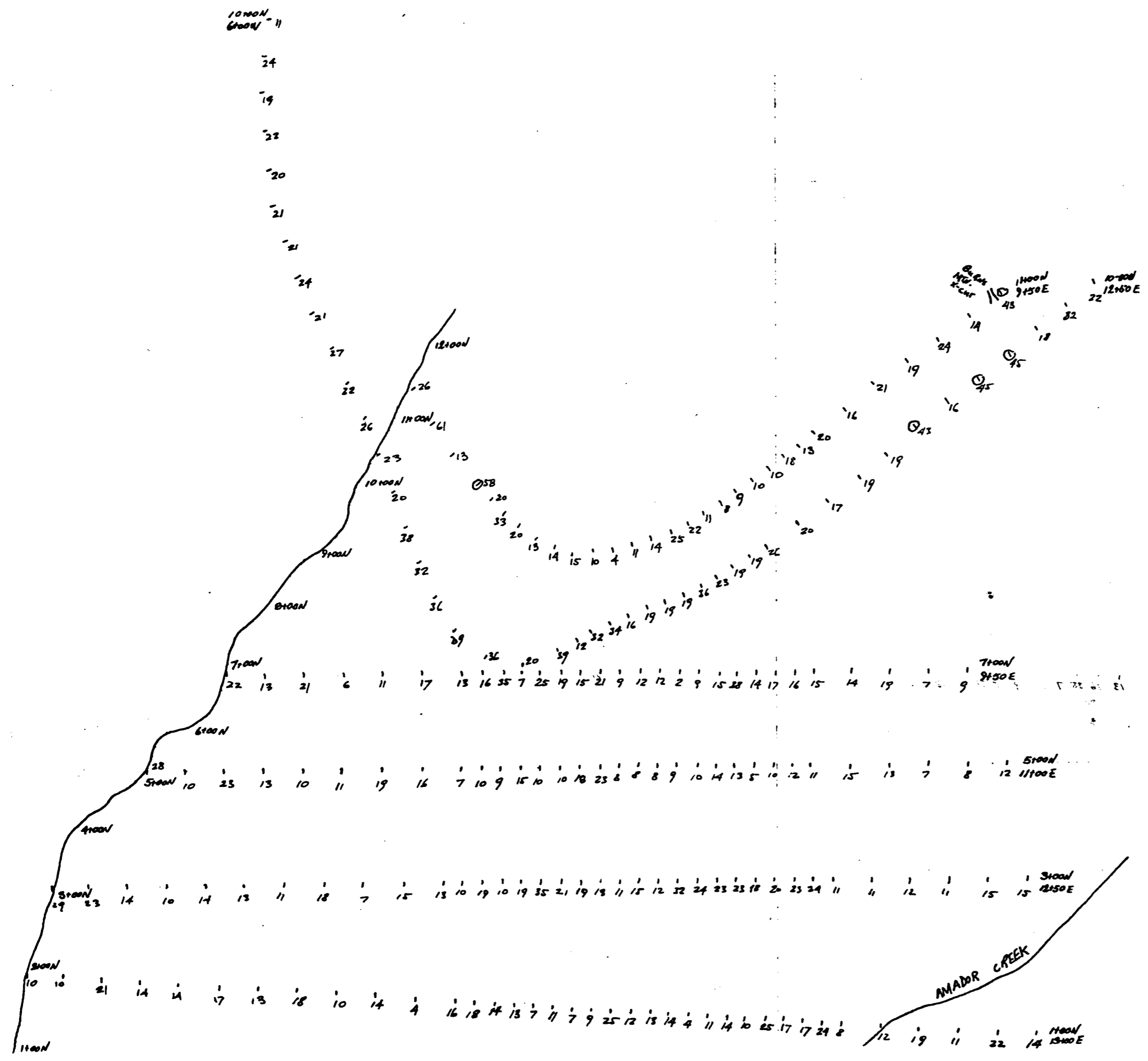

MINERAL RESOURCES BRANCH
 ASSESSMENT REPORT
8039
 NO.

PART 1072

CU

MONTY CLAIMS
 SOIL SAMPLE LOCATION PLAN

SCALE: 1:5000

GENERAL TESTING LABORATORIES

DIVISION SUPERINTENDENCE COMPANY LIMITED

1001 EAST PENDER ST. VANCOUVER, B.C. CANADA V6A 1W2
PHONE (604) 254-1647 TELEX 04-507514 CABLE SUPERFINE

TO:
L & G RESOURCES LTD.
26 - 610 Burrard Street
Vancouver, B.C.
V6C 2L1
Attn: Mr. Jack E. La Flour

CERTIFICATE OF ASSAY

No.: 7310-0450 DATE: Oct. 16/79

We hereby certify that the following are the results of assays on: **Ore**

MARKED	GOLD	SILVER	Copper	XXX	XX	XX	XX	XX
	oz/st	oz/st	Cu (%)					
RM.1	0.002	trace	0.003					
RM 2	0.008	trace	0.002					
RM 3	0.002	trace	0.002					
RM 6	0.002	trace	0.002					
RM-7-1	0.002	trace	0.003					
RM-7-2	0.002	trace	0.003					
RM-7-3	0.002	trace	0.004					
RM-7-4	0.002	trace	0.003					
RM-7-8	0.002	trace	0.002					
RM 9	0.002	trace	0.002					
RM 10	0.002	trace	0.002					
R 1	0.002	trace	0.002					
R 5	0.002	trace	0.002					
R 6	0.002	trace	0.002					

NOTE: REJECTS RETAINED ONE MONTH. PULPS RETAINED THREE MONTHS. ON REQUEST PULPS AND REJECTS WILL BE STORED FOR A MAXIMUM OF ONE YEAR.

ALL REPORTS ARE THE CONFIDENTIAL PROPERTY OF CLIENTS. PUBLICATION OF STATEMENTS, CONCLUSION OR EXTRACTS FROM OR REGARDING OUR REPORTS IS NOT PERMITTED WITHOUT OUR WRITTEN APPROVAL. ANY LIABILITY ATTACHED THERETO IS LIMITED TO THE FEE CHARGED.

L. Wong

PROVINCIAL ASSAYER

COPY

Analytical and Consulting Chemists, Bulk Cargo Specialists, Surveyors, Inspectors, Samplers, Weighers

MEMBER American Society For Testing Materials • The American Oil Chemists Society • Canadian Testing Association
REFEREE AND/OR OFFICIAL CHEMISTS FOR National Institute Of Oilseed Products • The American Oil Chemists Society
OFFICIAL WEIGHMASTERS FOR Vancouver Board Of Trade

GENERAL TESTING LABORATORIES

DIVISION SUPERINTENDENCE COMPANY (CANADA) LTD.

1001 EAST PENDER ST. VANCOUVER, B.C., CANADA, V.6A 1W1
PHONE (604) 254-1647 TELEFAX 04-507511 CABLE SUPERINTEN

TO:
L & G RESOURCES LTD.
26 - 640 Burrard Street
Vancouver, B.C.
V6C 2L1

CERTIFICATE OF ASSAY

No7911-1551 DATE: Dec. 18/79

We hereby certify that the following are the results of assays on: soil samples

MARKED	GOLD	SILVER	Copper	Lead	XXX	XXXX	XXXXX	XXX
	Au(ppm)	Ag(ppm)	Cu (ppm)	Pb (ppm)				
Line B - 0+00 W	0.05	0.5	109	28				
0+50	0.07	0.1	10	28				
1+00	0.07	0.5	8	23				
1+50	0.03	0.3	11	28				
2+00	0.05	0.5	14	25				
2+50	0.03	0.3	6	15				
3+00	0.05	0.3	14	30				
3+50	0.03	0.5	24	30				
4+00	0.03	0.5	21	35				
4+50	0.02	0.3	15	33				
5+00	<0.02	0.3	16	67				
5+50	<0.02	0.5	20	40				
6+00	0.02	0.3	12	35				
6+50	<0.02	0.1	30	35				
7+00	<0.02	0.3	8	35				
7+50	<0.02	0.3	28	28				
8+00	0.02	0.1	20	23				
8+50	0.03	0.3	64	71				
9+00	<0.02	0.6	29	45				
9+50	<0.02	0.5	41	52				
Line B - 10+00 W	<0.02	0.1	9	9				
Line 10N - 0+50 W	<0.02	0.3	26	30				
1+00	<0.02	0.3	22	23				
1+50	<0.02	0.1	27	30				
2+00	<0.02	0.1	21	30				
2+50	<0.02	0.1	24	20				
3+00	0.13	0.3	21	28				
3+50	0.02	0.3	21	33				
4+00	0.02	0.3	20	33				
4+50	<0.02	0.3	22	28				
5+00	<0.02	0.1	19	23				
5+50	<0.02	0.1	24	30				
Line 10N - 6+00 W	0.07	0.1	11	20				

/ Continued on page 2

< = less than

R. Nadeau
R. Nadeau, Chemist
PROVINCIAL ASSAYER

NOTE: REJECTS RETAINED ONE MONTH. PULPS RETAINED THREE MONTHS. ON REQUEST PULPS AND REJECTS WILL BE STORED FOR A MAXIMUM OF ONE YEAR.

ALL REPORTS ARE THE CONFIDENTIAL PROPERTY OF CLIENTS PUBLICATION OF STATEMENTS, CONCLUSION OR EXTRACTS FROM OR REGARDING OUR REPORTS IS NOT PERMITTED WITHOUT OUR WRITTEN APPROVAL. ANY LIABILITY ATTACHED THERETO IS LIMITED TO THE FEE CHARGED.

Analytical and Consulting Chemists, Bulk Cargo Specialists, Surveyors, Inspectors, Samplers, Weighers

MEMBER American Society For Testing Materials • The American Oil Chemists' Society • Canadian Testing Association
REFEREE AND/OR OFFICIAL CHEMISTS FOR National Institute Of Oiled Products • The American Oil Chemists' Society
OFFICIAL WEIGHMASTERS FOR Vancouver Board Of Trade

GENERAL TESTING LABORATORIES

DIVISION SUPERINTENDENCE COMPANY (CANADA), LTD.

1001 EAST PENDER ST. VANCOUVER, B.C. CANADA, V6A 1W2
PHONE (604) 253-1647 TELEEX 24-507514 CABLE SUPERINTEN

TO:
L & G RESOURCES LTD.

(Continued) ... page 2 ...

CERTIFICATE OF ASSAY

No.: **7911-1551** DATE: **Dec. 18/79**

We hereby certify that the following are the results of assays on: **soil samples**

MARKED	GOLD	SILVER	Copper	Lead	xxx	xxx	xxx	xxx
	Au (ppm)	Ag (ppm)	Cu (ppm)	Pb (ppm)				
Line 11N - 0+00 E	0.02	0.3	26	30				
0+50	0.03	0.3	61	58				
1+00	0.02	0.3	13	30				
1+50	0.02	0.8	58	40				
1+75	<0.02	0.5	20	20				
2+00	<0.02	1.0	33	45				
2+25	0.02	0.8	20	33				
2+50	<0.02	0.7	13	29				
2+75	0.02	0.8	14	29				
3+00	<0.02	0.8	15	27				
3+25	<0.02	0.7	10	20				
3+50	0.02	0.5	4	20				
3+75	0.02	0.5	11	22				
4+00	0.02	1.1	14	38				
4+25	0.02	0.5	25	29				
4+50	0.03	0.7	22	45				
4+75	<0.02	1.4	11	35				
5+00	0.05	0.8	8	24				
5+25	0.04	0.7	9	20				
5+50	0.03	0.7	10	24				
5+75	0.03	0.8	10	24				
6+00	0.03	0.5	18	18				
6+25	0.03	0.5	13	20				
6+50	0.04	0.7	20	24				
7+00	0.07	0.7	16	233				
7+50	0.04	0.5	21	38				
8+00	0.04	0.5	19	20				
8+50	0.04	0.7	24	18				
9+00	0.04	0.7	14	20				
Line 11N - 9+50 E	0.03	1.0	43	20				
Line 1N - 0+00 E	0.08	0.2	10	10				
0+50	0.04	0.5	10	20				
1+00	0.06	0.7	21	31				
1+50	0.05	0.8	14	20				
2+00	0.04	0.8	14	45				
2+50	0.04	1.3	17	33				
Line 1N - 3+00 E	0.04	0.7	13	20				

/ Continued on page 3

NOTE: REJECTS RETAINED ONE MONTH. PULPS RETAINED THREE MONTHS. ON REQUEST PULPS AND REJECTS WILL BE STORED FOR A MAXIMUM OF ONE YEAR.

ALL REPORTS ARE THE CONFIDENTIAL PROPERTY OF CLIENTS PUBLICATION OF STATEMENTS, CONCLUSION OR EXTRACTS FROM OR REGARDING OUR REPORTS IS NOT PERMITTED WITHOUT OUR WRITTEN APPROVAL. ANY LIABILITY ATTACHED THERETO IS LIMITED TO THE FEE CHARGED.

R. Nadeau
R. Nadeau, Chemist

~~PROVINCIAL ASSAYER~~

Analytical and Consulting Chemists, Bulk Cargo Specialists, Surveyors, Inspectors, Samplers, Weighers

MEMBER American Society For Testing Materials • The American Oil Chemists' Society • Canadian Testing Association
REFERRED AND/OR OFFICIAL CHEMISTS FOR National Institute Of Oilseed Products • The American Oil Chemists' Society
OFFICIAL WEIGHMASTERS FOR Vancouver Board Of Trade

GENERAL TESTING LABORATORIES

DIVISION SUPERINTENDENCE COMPANY (CANADA) LTD.

1001 EAST FENDER ST., VANCOUVER, B.C., CANADA V6A 1W1
PHONE (604) 254-1847 TELEEX 04-507514 CABLE SUPERVAN

TO:
L & G RESOURCES LTD.

(Continued) ..page 3

CERTIFICATE OF ASSAY

No.: **7911-1551** DATE: **Dec. 18/79**

We hereby certify that the following are the results of assays on: soil samples

MARKED	GOLD	SILVER	Copper	Lead	xxx	xxx	xxx	xxx
	Au(ppm)	Ag(ppm)	Cu (ppm)	Pb (ppm)				
Line 1 N - 3+50 E	0.04	1.0	18	105				
4+00	0.05	1.1	10	29				
4+50	0.06	0.7	14	10				
5+00	0.04	0.5	4	5				
5+50	0.06	0.7	16	12				
5+75	0.06	0.7	18	31				
6+00	0.05	0.7	14	29				
6+25	0.03	0.8	13	22				
6+50	0.04	0.7	7	24				
6+75	0.06	0.7	11	16				
7+00	0.04	0.7	7	12				
7+25	0.04	0.7	9	18				
7+50	0.04	1.1	25	29				
7+75	0.04	0.5	12	12				
8+00	0.04	0.5	13	12				
8+25	0.05	0.5	14	10				
8+50	0.04	0.4	4	12				
8+75	0.03	0.4	11	22				
9+00	0.04	0.4	14	20				
9+25	0.04	0.4	10	12				
9+50	0.04	0.4	25	22				
9+75	0.04	0.4	17	22				
10+00	0.04	0.4	17	20				
10+25	0.06	0.5	24	16				
10+50	0.05	0.5	8	27				
11+00	0.05	0.7	12	24				
11+50	0.05	0.6	19	29				
12+00	0.04	0.6	11	22				
12+50	0.04	0.4	22	27				
Line 1N - 13+00 E	0.04	0.6	14	22				
Line 10N - 0+00 E	0.01	0.6	23	20				
0+50	0.02	0.6	20	27				
1+00	0.04	0.6	38	24				
1+50	0.03	0.4	32	22				
2+00	0.02	0.7	36	27				
2+50	0.03	0.6	39	33				
Line 10N - 3+00 E	0.05	0.9	36	36				

Continued on page 4

NOTE: REJECTS RETAINED ONE MONTH. PULPS RETAINED THREE MONTHS. ON REQUEST PULPS AND REJECTS WILL BE STORED FOR A MAXIMUM OF ONE YEAR.

ALL REPORTS ARE THE CONFIDENTIAL PROPERTY OF CLIENTS. PUBLICATION OF STATEMENTS, CONCLUSION OR EXTRACTS FROM OR REGARDING OUR REPORTS IS NOT PERMITTED WITHOUT OUR WRITTEN APPROVAL. ANY LIABILITY ATTACHED THERETO IS LIMITED TO THE FEE CHARGED.

R. Nadeau, Chemist

PROVINCIAL ASSAYER

Analytical and Consulting Chemists, Bulk Cargo Specialists, Surveyors, Inspectors, Samplers, Weighers

MEMBER American Society For Testing Materials • The American Oil Chemists Society • Canadian Testing Association
REFEREE AND/OR OFFICIAL CHEMISTS FOR National Institute Of Oilseed Products • The American Oil Chemists Society
OFFICIAL WEIGHMASTERS FOR Vancouver Board Of Trade

GENERAL TESTING LABORATORIES

DIVISION SUPERINTENDENCE COMPANY (CANADA) LTD.

1001 EAST PENDER ST. VANCOUVER, B.C., CANADA, V6A 1A2
PHONE (604) 254-1517 TELEX 04-007514 CABLE SUPERVIDE

TO: L & G RESOURCES LTD.

(Continued) ... page 4

CERTIFICATE OF ASSAY

No.: 7911-1551 DATE: Dec. 18/79

We hereby certify that the following are the results of assays on: soil samples

MARKED	GOLD	SILVER	Copper	Lead	xxx	xxx	xxx	xxx
	Au (ppm)	Ag (ppm)	Cu (ppm)	Pb (ppm)				
Line 10N - 3+50 E	0.04	0.7	20	29				
4+00	0.02	0.6	39	27				
4+25	0.03	1.0	12	29				
4+50	0.03	0.4	32	36				
4+75	0.02	0.4	34	38				
5+00	0.03	0.4	16	31				
5+25	0.02	0.6	19	31				
5+50	<0.02	0.4	19	29				
5+75	0.03	0.4	19	31				
6+00	0.08	0.4	36	27				
6+25	0.03	0.4	23	29				
6+50	0.03	0.4	19	42				
6+75	0.03	0.3	19	24				
7+00	0.02	0.6	26	31				
7+50	0.03	0.4	20	27				
8+00	0.04	0.4	17	29				
8+50	0.03	0.4	19	27				
9+00	0.03	0.4	19	13				
9+50	0.04	0.7	43	24				
10+00	0.03	0.4	16	29				
10+50	0.04	0.4	45	29				
11+00	0.03	0.6	45	40				
11+50	0.03	0.3	18	22				
12+00	0.04	0.3	32	38				
Line 10N - 12+50 E	0.04	0.4	22	27				
Line A - 0+00 E	0.05	0.4	23	40				
0+50	0.03	0.3	11	11				
1+00	0.03	0.3	8	18				
1+50	0.02	0.2	3	9				
2+00	0.02	0.4	18	33				
2+50	0.02	0.3	23	22				
3+00	<0.02	0.3	8	24				
3+50	0.04	0.4	17	42				
4+00	0.04	0.3	16	31				
Line A - 4+50	0.06	0.7	21	44				

/ Continued on page 5

NOTE: REJECTS RETAINED ONE MONTH. PULPS RETAINED THREE MONTHS. ON REQUEST PULPS AND REJECTS WILL BE STORED FOR A MAXIMUM OF ONE YEAR.

ALL REPORTS ARE THE CONFIDENTIAL PROPERTY OF CLIENTS. PUBLICATION OF STATEMENTS, CONCLUSION OR EXTRACTS FROM OR REGARDING OUR REPORTS IS NOT PERMITTED WITHOUT OUR WRITTEN APPROVAL. ANY LIABILITY ATTACHED THERETO IS LIMITED TO THE FEE CHARGED.

R. Nadeau, Chemist

 R. Nadeau, Chemist

Analytical and Consulting Chemists, Bulk Cargo Specialists, Surveyors, Inspectors, Samplers, Weighers

MEMBER: American Society For Testing Materials • The American Oil Chemists' Society • Canadian Testing Association
 REFEREE AND/OR OFFICIAL CHEMISTS FOR: National Institute Of Oilseed Products • The American Oil Chemists' Society
 OFFICIAL WEIGH-MASTERS FOR: Vancouver Board Of Trade

GENERAL TESTING LABORATORIES

DIVISION SUPERINTENDENCE COMPANY (CANADA) LTD.

1001 EAST BENDER ST., VANCOUVER, B.C., CANADA V6A 1W2
PHONE (604) 254-1647 TELEX 04-507514 CABLE SUPERVISE

TO:
L & G RESOURCES LTD.

(Continued) page 5

CERTIFICATE OF ASSAY

No.: 7911-1551 DATE: Dec. 18/79

We hereby certify that the following are the results of assays on: soil sample

MARKED	GOLD	SILVER	Copper	Lead	XXX	XXX	XXX	XXX
	Au (ppm)	Ag (ppm)	Cu (ppm)	Pb (ppm)				
Line B - 1+00 E	0.05	0.4	12	33				
1+50	0.06	0.3	8	11				
2+00	0.04	0.2	3	18				
2+50	0.04	0.7	18	52				
3+00	0.05	0.8	17	48				
3+50	0.04	0.7	31	42				
4+00	0.04	0.8	31	36				
Line B - 4+50 E	0.05	0.8	32	50				
Line 3N - 0+00E	0.07	1.0	29	38				
0+50	0.03	0.5	23	28				
1+00	0.03	0.8	14	18				
1+50	0.03	0.5	10	16				
2+00	0.03	0.4	14	18				
2+50	0.02	0.4	13	32				
3+00	0.05	0.5	11	36				
3+50	0.05	0.5	18	36				
4+00	0.05	0.4	7	34				
4+50	0.03	0.5	15	36				
5+00	0.07	0.5	13	28				
5+25	0.07	0.7	10	40				
5+50	0.08	0.7	19	36				
5+75	0.05	0.5	10	28				
6+00	0.05	0.7	19	16				
6+25	0.05	0.8	35	52				
6+50	0.05	0.8	21	32				
6+75	0.08	0.5	19	34				
7+00	0.05	0.5	13	28				
7+25	0.05	0.8	11	18				
7+50	0.03	0.7	15	28				
7+75	0.07	0.5	12	30				
8+00	0.07	1.2	32	48				
8+25	0.07	0.7	24	38				
8+50	0.05	0.8	23	36				
8+75	0.05	1.3	23	48				
9+00	0.03	0.7	18	32				
Line 3N - 9+25 E	0.05	1.0	20	34				

/ Continued on page 6

NOTE: REJECTS RETAINED ONE MONTH. PULPS RETAINED THREE MONTHS. ON REQUEST PULPS AND REJECTS WILL BE STORED FOR A MAXIMUM OF ONE YEAR.

ALL REPORTS ARE THE CONFIDENTIAL PROPERTY OF CLIENTS. PUBLICATION OF STATEMENTS, CONCLUSION OR EXTRACTS FROM OR REGARDING OUR REPORTS IS NOT PERMITTED WITHOUT OUR WRITTEN APPROVAL. ANY LIABILITY ATTACHED THERETO IS LIMITED TO THE FEE CHARGED.

R. Nadeau
R. Nadeau, Chemist

XXXXXXXXXXXX

Analytical and Consulting Chemists, Bulk Cargo Specialists, Surveyors, Inspectors, Samplers, Weighers

MEMBER American Society For Testing Materials • The American Oil Chemists' Society • Canadian Testing Association
REFEREE AND/OR OFFICIAL CHEMISTS FOR National Institute Of Oilseed Products • The American Oil Chemists' Society
OFFICIAL WEIGHTMASTERS FOR Vancouver Board Of Trade

GENERAL TESTING LABORATORIES

DIVISION SUPERINTENDENCE COMPANY CANADA LTD.

1001 EAST FLANDER ST., VANCOUVER, B.C., CANADA, V6A 1A2
PHONE (604) 254-1647 TELEEX 04-507514 CABLE SUPERINTEN

TO:

L & G RESOURCES LTD.

(Continued) page 6

CERTIFICATE OF ASSAY

No.: 7911-1551 DATE: Dec. 18/79

We hereby certify that the following are the results of assays on: soil samples

MARKED	GOLD	SILVER	Copper	Lead	xxx	xxx	xxx	xxx
	Au (ppm)	Ag (ppm)	Cu (ppm)	Pb (ppm)				
Line 3N - 9+50 E	0.03	0.7	23	32				
9+75	0.02	1.3	24	48				
10+00	0.05	0.4	11	20				
10+50	<0.02	0.3	11	20				
11+00	0.02	0.4	12	24				
11+50	0.02	0.4	11	20				
12+00	<0.02	0.3	15	30				
Line 3N - 12+50 E	0.03	0.4	15	22				
Line 5N - 0+00 E	0.02	0.4	28	38				
0+50	0.03	0.4	10	22				
1+00	0.02	0.4	23	30				
1+50	<0.02	0.4	13	30				
2+00	0.05	0.4	10	20				
2+50	0.03	0.4	11	20				
3+00	0.03	0.5	19	20				
3+50	0.03	0.4	16	20				
4+00	0.02	0.4	7	10				
4+25	0.03	0.3	10	10				
4+50	0.03	0.4	9	26				
4+75	0.03	0.3	15	10				
5+00	0.02	0.5	10	32				
5+25	0.03	0.3	10	20				
5+50	0.03	0.5	18	34				
5+75	0.03	0.5	23	32				
6+00	<0.02	0.3	8	10				
6+25	0.03	0.3	8	10				
6+50	0.02	0.3	8	16				
6+75	<0.02	0.4	9	18				
7+00	0.03	0.4	10	26				
7+25	<0.02	0.4	14	26				
7+50	0.03	0.5	13	32				
7+75	<0.02	0.1	5	8				
8+00	0.03	0.3	10	10				
8+25	0.03	0.7	12	22				
8+50	<0.02	0.3	11	10				
Line 5N - 9+00 E	0.04	0.4	15	24				

/ Continued on page 7

NOTE: REJECTS RETAINED ONE MONTH. PULPS RETAINED THREE MONTHS. ON REQUEST PULPS AND REJECTS WILL BE STORED FOR A MAXIMUM OF ONE YEAR.

ALL REPORTS ARE THE CONFIDENTIAL PROPERTY OF CLIENTS. PUBLICATION OF STATEMENTS, CONCLUSION OR EXTRACTS FROM OR REGARDING OUR REPORTS IS NOT PERMITTED WITHOUT OUR WRITTEN APPROVAL. ANY LIABILITY ATTACHED THERETO IS LIMITED TO THE FEE CHARGED.

R. Nadeau, Chemist

PROVINCIAL ASSAYER

Analytical and Consulting Chemists, Bulk Cargo Specialists, Surveyors, Inspectors, Samplers, Weighers

MEMBER American Society For Testing Materials • The American Oil Chemists' Society • Canadian Testing Association
REFEREE AND/OR OFFICIAL CHEMISTS FOR National Institute Of Oilseed Products • The American Oil Chemists' Society
OFFICIAL WEIGHMASTERS FOR Vancouver Board Of Trade

GENERAL TESTING LABORATORIES

DIVISION SUPERINTENDENCE COMPANY (CANADA) LTD.

1001 EAST PENDER ST. VANCOUVER B.C., CANADA, V6A 1W2
PHONE (604) 254-1647 TELEEX 04-507514 CABLE SUPERVISI

TO:
L & G RESOURCES LTD.

(Continued) ... page 7

CERTIFICATE OF ASSAY

No.: 7911-1551 DATE: Dec. 18/79

We hereby certify that the following are the results of assays on: soil samples

MARKED	GOLD	SILVER	Copper	Lead	xxx	xxx	xxx	xxx
	Au(ppm)	Ag(ppm)	Cu (ppm)	Pb (ppm)				
Line 5N - 9+50 E	0.03	0.5	13	26				
10+00	0.04	0.4	7	10				
10+50	0.03	0.4	8	13				
Line 5N - 11+00 E	0.03	0.4	12	23				
Line 7N - 0+00 E	0.04	0.4	22	23				
0+50	0.04	0.5	13	27				
1+00	<0.02	0.7	21	27				
1+50	0.03	0.4	6	17				
2+00	<0.02	0.4	11	26				
2+50	0.03	0.5	17	36				
3+00	0.03	0.4	13	17				
3+25	0.05	0.4	16	24				
3+50	0.03	0.3	35	45				
3+75	0.03	0.3	7	21				
4+00	0.08	0.4	25	30				
4+25	0.04	0.4	19	30				
4+50	0.05	0.3	15	19				
4+75	0.04	0.7	21	26				
5+00	0.04	0.4	9	24				
5+25	0.04	0.5	12	27				
5+50	0.03	0.7	12	49				
5+75	0.04	0.4	2	9				
6+00	0.04	0.4	9	21				
6+25	0.03	0.3	15	23				
6+50	0.04	0.5	38	46				
6+75	0.04	0.4	14	26				
7+00	0.05	0.5	17	31				
7+25	0.04	0.5	16	30				
7+50	0.04	0.5	15	26				
8+00	0.04	0.5	14	31				
8+50	0.05	0.5	19	26				
9+00	0.04	0.3	7	15				
Line 7N - 9+50 E	0.05	0.5	9	28				

NOTE: REJECTS RETAINED ONE MONTH. PULPS RETAINED THREE MONTHS. ON REQUEST PULPS AND REJECTS WILL BE STORED FOR A MAXIMUM OF ONE YEAR.

ALL REPORTS ARE THE CONFIDENTIAL PROPERTY OF CLIENTS PUBLICATION OF STATEMENTS, CONCLUSION OR EXTRACTS FROM OR REGARDING OUR REPORTS IS NOT PERMITTED WITHOUT OUR WRITTEN APPROVAL. ANY LIABILITY ATTACHED THERETO IS LIMITED TO THE FEE CHARGED.

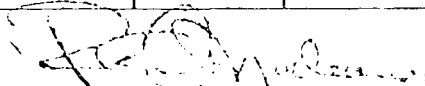
R. Nadeau, Chemist

~~XXXXXXXXXXXX~~

Analytical and Consulting Chemists, Bulk Cargo Specialists, Surveyors, Inspectors, Samplers, Weighers

MEMBER American Society For Testing Materials • The American Oil Chemists' Society • Canadian Testing Association
REFEREE AND/OR OFFICIAL CHEMISTS FOR National Institute Of Oilseed Products • The American Oil Chemists' Society
OFFICIAL WEIGHMASTERS FOR Vancouver Board Of Trade

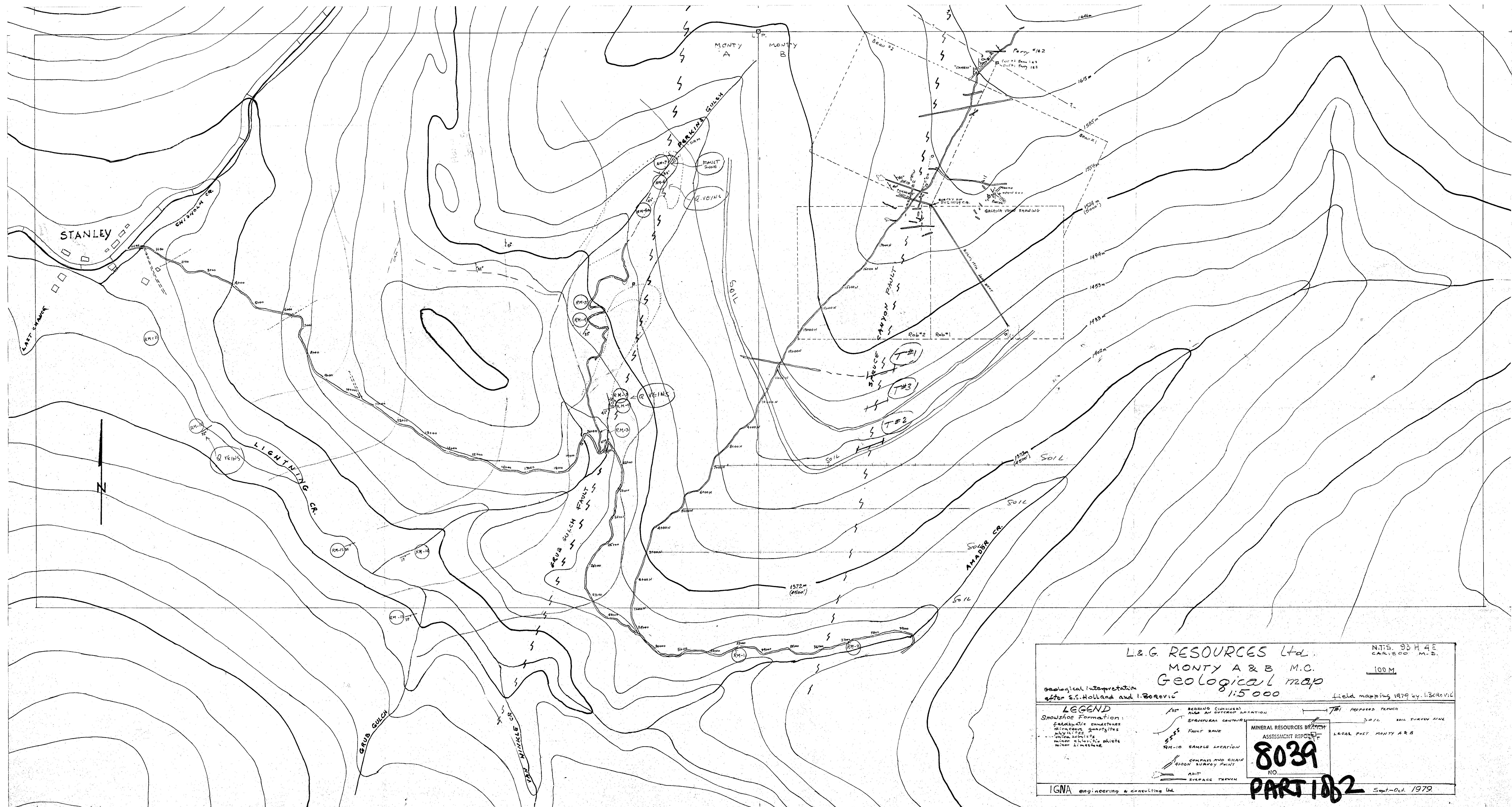

N.T.S. 93 H 4 E
CARIBOO M.B.

100 M

L & G RESOURCES Ltd.
MONTY A & B M.C.
Geological map
1:5000

Geological interpretation
after S.S. Holland and I. Borovic

Field mapping 1979 by I. Borovic

<p>LEGEND</p> <p>Shoshone Formation: feldspathic sandstones micaceous quartzites phyllites mica schists minor chlorite schists minor limestone</p>	<p>1st BEDDING (dashed) ALSO AN OUTCROP LOCATION</p> <p>STRUCTURAL CONTOUR</p> <p>FAULT ZONE</p> <p>RM-10 SAMPLE LOCATION</p> <p>COMPASS AND CHAIN WOOD SURVEY POINT</p> <p>ADIT</p> <p>SURFACE TRENCH</p>	<p>PROPOSED TRENCH</p> <p>SOIL SURVEY LINE</p> <p>MINERAL RESOURCES BRANCH ASSESSMENT REPORT NO. 8039</p> <p>LEGAL DIST. MONTY A & B</p>
---	--	--

PART 1062 Sept-Oct. 1979

IGNA engineering & consulting Ltd.