

M.C.'s 180-#309-#
IMA 4 and IMA 5 8082
Nanaimo Mining Division
Assessment Work Report 5/80

MINERAL RESOURCES BRANCH
ASSESSMENT REPORT

8082

ASSESSMENT REPORT

Port McNeill Drilling Project
Mineral Claims IMA4 and IMA5
Nanaimo Mining Division

NTS Location - 92L11E
Latitude - 50⁰ 33.3' North
Longitude - 127⁰ 03' West

Owner of Claims - Donald F. Gunning, P.Eng.

Operator - International Marble & Stone Co. Ltd.

Author of Report - Owner

Date Submitted - May 8, 1980

TABLE OF CONTENTS

	Page
Introduction	1
Location Map	2
Claim Map	3
Project Costs	4
Drill Core Logs	5, 6

INTRODUCTION

The claims (IMA4 and IMA5) are located about 2½ miles S.E. of Port McNeill (see location map on page 2). Access is via a good logging road, about 1.4 miles from the Island Highway.

The limestone deposit was quarried in the late 1960's under S.U.P. 6000 (see B.C. M. of M. A.R. 1968, p. 315). The rock is currently used for road fill by MacMillan Bloedel.

International Marble & Stone Co. Ltd. has been granted a Special Use Permit (#9375) for exploration by the B. C. Forest Service. During January, February, and March, 1980, twelve 1 inch diameter holes were drilled (see map on page 3), using company personnel from Sirdar and company owned equipment (wire-line drill). A total of 1638 feet of drilling was completed.

The cost of the programme totalled about \$20,000 (see itemized list on page 4). The drill core logs are shown on pages 5 and 6. The Author is a graduate Metallurgical Engineer(U.B.C.); the driller is a competent diamond driller with over 30 years experience. The drill core is stored at the home of Bill Velie, just south of Port McNeill.

A handwritten signature in cursive script, appearing to read "A. F. Penning". The signature is written in dark ink and is centered on the page.

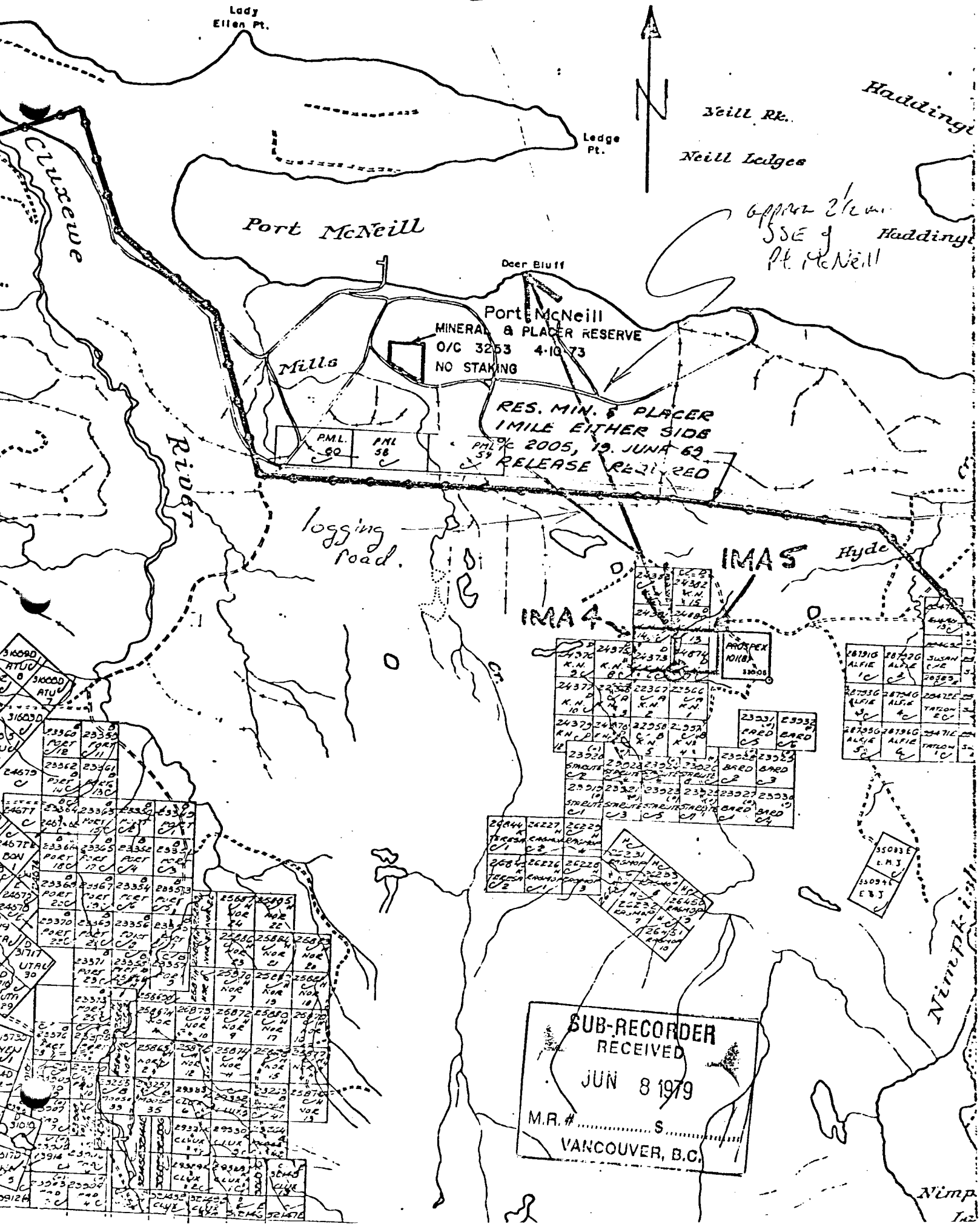

Lady Ellen Pt.



3 Mill Rk.

Hadding

Neill Ledges

Port McNeill

Deer Bluff

Port McNeill
 MINERAL & PLACER RESERVE
 O/C 3253 4-10-73
 NO STAKING

6 APR 21 AM
 SSE of
 Pt. McNeill

Mills

RES. MIN. & PLACER
 1 MILE EITHER SIDE
 PML 2005, 19 JUN 69
 RELEASE REQUIRED

logging road.

IMAS Hyde

IMA 4

24370	24371	24372	24373	24374	24375	24376	24377	24378	24379	24380	24381	24382	24383	24384	24385	24386	24387	24388	24389	24390
K.N.	K.N.	K.N.	K.N.	K.N.	K.N.	K.N.	K.N.	K.N.	K.N.	K.N.	K.N.	K.N.	K.N.	K.N.	K.N.	K.N.	K.N.	K.N.	K.N.	K.N.
3C	3C	3C	3C	3C	3C	3C	3C	3C	3C	3C	3C	3C	3C	3C	3C	3C	3C	3C	3C	

23360	23361	23362	23363	23364	23365	23366	23367	23368	23369	23370	23371	23372	23373	23374	23375	23376	23377	23378	23379	23380
P.M.L.	P.M.L.	P.M.L.	P.M.L.	P.M.L.	P.M.L.	P.M.L.	P.M.L.	P.M.L.	P.M.L.	P.M.L.	P.M.L.	P.M.L.	P.M.L.	P.M.L.	P.M.L.	P.M.L.	P.M.L.	P.M.L.	P.M.L.	P.M.L.
50	58	50	58	50	58	50	58	50	58	50	58	50	58	50	58	50	58	50	58	50

SUB-RECORDER
 RECEIVED
 JUN 8 1979
 M.R.# S
 VANCOUVER, B.C.

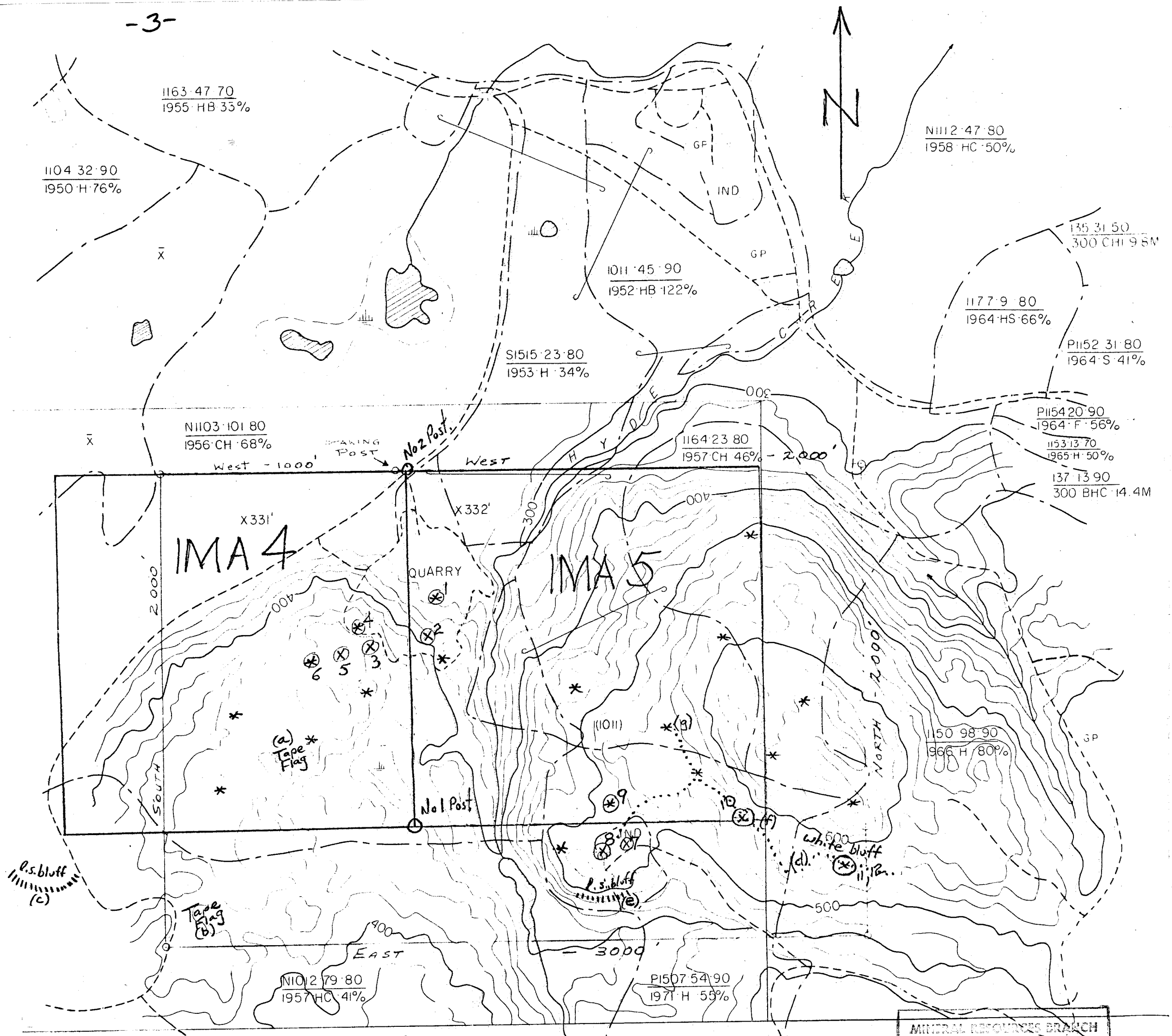

SUP. 9375

- holes 1-5 - vertical
- 6 - -50° S.E.
- 7 - -50° N.W.
- 8 - -50° S.
- 9 - -50° N.E. ?
- 10 - vertical
- 11 - vertical
- 12 - -10° North.

* - suggested drill hole locations
 ⊗ - drill holes.

1" = 400'
 cat trail

MINERAL RESOURCES BRANCH
 ASSESSMENT REPORT
8082
 NO. _____

PORT McNEILL
HYDE CREEK
 Scale - 1/4800
 20' Contour Interval
 scale: 1" = 400'

Port McNeill Drilling Project - Cost Statement

January 16 - March 19, 1980

12 holes, 1" Ø, wire line drill, 1638' drilled

- driller (T. Lysohirka - IMASCO - Sirdar) and helper 60 days @ \$150 per day	\$ 9,000.00
- food, lodging and misc. expenses 60 days @ \$75	4,500.00
- materials, parts, and depreciation; estimate	5,000.00
- transportation of personnel, and freight; estimate	<u>1,500.00</u>
Total	<u>\$20,000.00</u> =====

International Marble & Stone Co. Ltd.

190 - 10691 Shellbridge Way • Richmond, B.C. V6X 2W8 • (604) 270-2730

Logs of drill core - all core samples effervesced in hydrochloric acid - therefore no dolomite.

March 6, 1980
Port McNeill
S.U.P. 9375

<u>Hole</u>	<u>Box</u>	<u>Footage</u>	<u>Description</u>
#1	1 & 2	0-56'	light grey limestone
	2 & 3	56'-65'	mixed dyke and limestone
#2	1 & 2	0-70'	white and light grey limestone
	3	70'-90'	light and dark grey limestone
#3	1	0-19'	white limestone
	1	19'-26'	grey and black limestone
	1 - 4	26'-130'	light grey limestone
	5 - 8	130'-233'	light grey and grey limestone
#4	1	0-15'	white limestone
	1	15'-31'	grey and light grey limestone
	1 - 3	102'-187'	grey and dark grey limestone
(at 150' broken rock c/w pyrite)			
#5	1	0-38'	very light grey limestone
	2 - 7	38'-200'	light grey limestone (dark at 43' - green cuttings only at the bottom)
#6	1 - 3	95'-107'	light grey limestone
	4	107'-117'	dark limestone
	4-6	117'-172'	very light grey limestone
		172'-176'	volcanic rock and limestone
#7	1	0-46'	light grey limestone
	2	46'-63'	light grey limestone and dyke
	2 - 4	63'-115'	green dyke and limestone
#8	1	0 - 4'	grey limestone
	1	4'-7'	green-grey volcanic
	1 - 8	7'-195'	light grey limestone
(total footage (1-8) = 1261')			

International Marble & Stone Co. Ltd.

190 - 10691 Shellbridge Way • Richmond, B.C. V6X 2W8 • (604) 270-2730

Logs of drill core - as with the first eight holes, all core samples effervesced freely in hydrochloric acid; i.e.: no dolomite.

March 19-20/80
Port McNeill
S.U.P. 9375

<u>Hole</u>	<u>Box No.</u>	<u>Footage</u>	<u>Description</u>
#9 (-50° N.E.)	1	0-17'	light grey limestone
		17'-23'	mostly dark grey limestone
	2	23'-35'	light grey limestone + 6" dyke
		36'-58'	light grey and white limestone
	3	58'-61'	green dyke
		61'-66'	light grey limestone
		66'-72'	dark grey limestone
	4	72'-88'	light grey limestone
		88'-95'	dark grey limestone
	5	95'-110'	mostly light grey limestone
		110'-112'	green dyke
		112'-124'	grey limestone
	124'-132'	green dyke	
#10 (vertical)	1	0-1'	dark dyke
		1'-16'	light grey and white limestone
		16'-35'	dark dyke
#11 (vertical)	1	0-52'	white, light grey, and mottled limestone
	2	52'-73'	grey and dark grey limestone
	3	73'-102'	mostly light grey limestone
	4	102'-124'	grey and light grey limestone
	5	124'-127'	green dyke
		127'-139'	light and dark grey limestone
#12 (-10° North)	1	0-46'	light grey limestone + 6" dyke
	2	46'-65'	light grey + mottled limestone