

'80-#248-#8189

GILLIAN MINES LTD.

ASSESSMENT REPORT ON THE GILLIAN EAST AND WEST CLAIMS
OMINECA MINING DIVISION

Lat. 54 degrees 10 minutes N Long. 126 degrees 22 minutes W

Prepared by,

J. Paul Stevenson

MINERAL RESOURCES BRANCH
ASSESSMENT REPORT
8189
No.

~~8189~~ Part 1
83

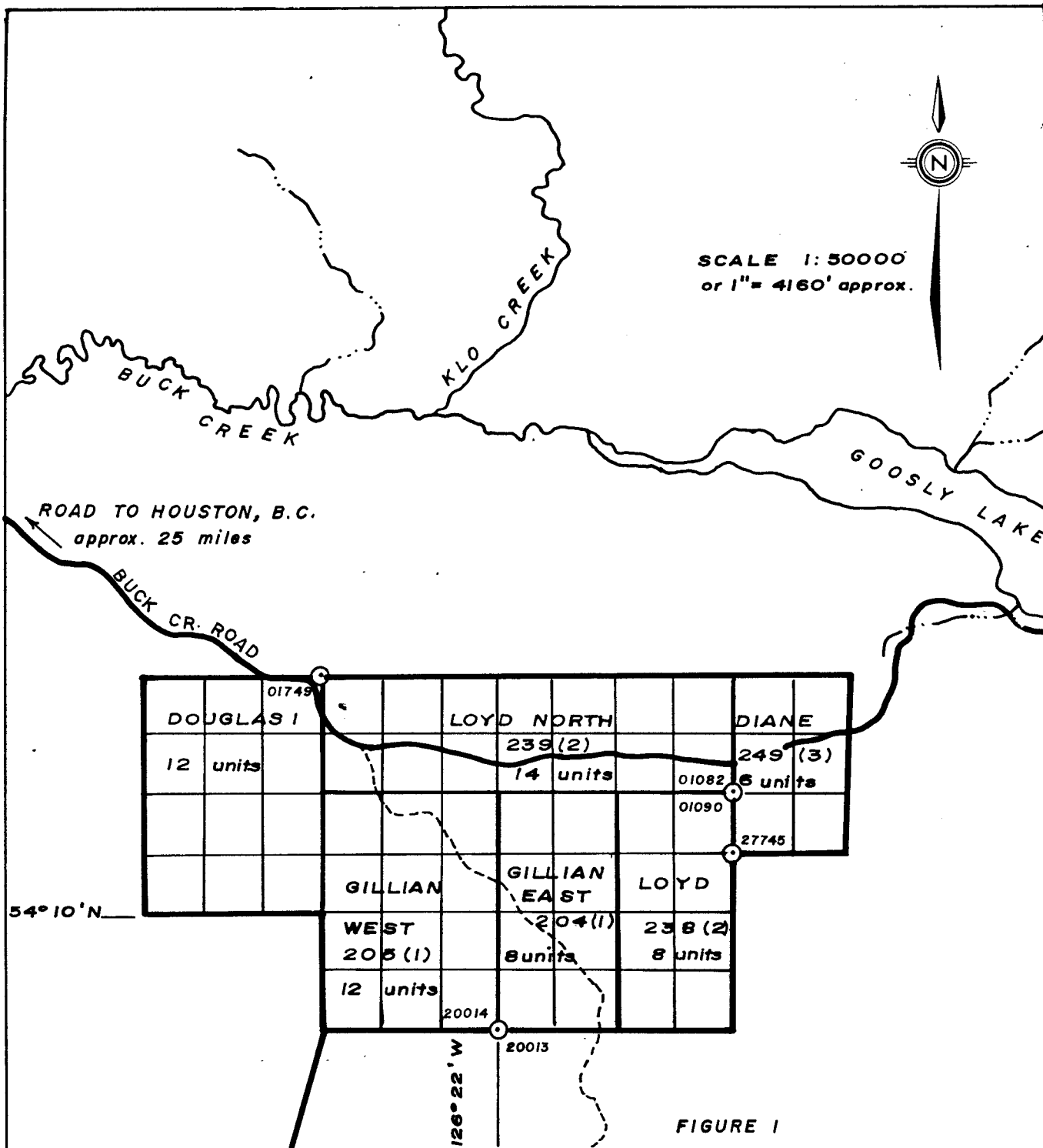
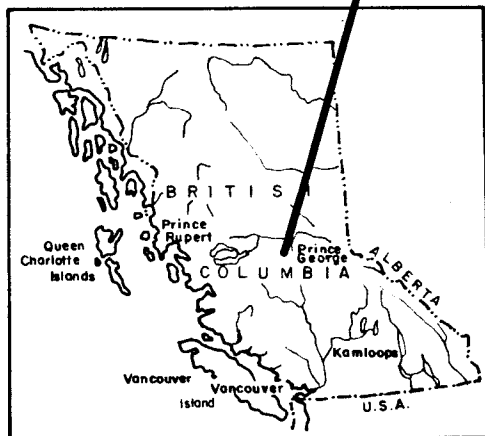

FIGURE I



British Columbia
GILLIAN MINES LTD.
GILLIAN PROPERTY - GOOSLY LAKE AREA
MINING DIVISION: OMINECA
PROPERTY LOCATION & CLAIM MAP
MAP REFERENCE: 93 L / 1W
COORDINATES: 54° 10' N, 126° 22' W

The 1979 assessment work on the Gillian Claims began on August 28, 1979. A total of eight miles of line were rehabilitated in preparation for a geophysical survey. Work commenced August 28, 1979 and terminated September 1, 1979. The costs for the survey are itemized in Appendix A.

A geophysical survey was conducted by Glen White Geophysics Ltd. from September 23, 1979 to September 27, 1979 and from October 3, 1979 to October 10, 1979. This survey cost a total of \$8,980.00 and his report accompanies this report.

Diamond drilling was initiated December 1979 and approximately 1,652 feet of NQ drilling was completed by December 14, 1979. The results and locations of the drill holes are referred to in a report titled, "Geological Report on the Gillian Property Houston, British Columbia", by D.G. Leighton and R. R. Culbert Ph.D., P.Eng. This report is dated 28 March 1980 and accompanies this report. A summary of the holes and random assays can be found in Appendix B. A total of \$35,587.10 was paid directly to J. T. Thomas Diamond Drilling Ltd. His invoice and a summary of other related costs can be found in Appendix C.

The diamond drill core is stored at the offices of Gillian Mines Ltd. where it has been observed by B. N. Church of the British Columbia Department of Mines.

APPENDIX A

Line Cutting Costs

Brian Sauer	4 days at \$75	\$ 300.00
Dean de La Mothe	4 days at \$50	200.00
J. Paul Stevenson	5 days at \$100	500.00
Travel and accomadation		300.00

TOTAL COSTS

\$1300.00

APPENDIX B

Summary of Diamond Drill Holes 79-1, 79-2, and 79-3

All drill holes were into the area referred to as a breccia dome. The geology of these holes was very similar in that all displayed varying degrees of auto brecciation. Chloritic and sericite alteration was common and pyrite was noted in the first one hundred feet of coring in each hole. The overburden at DDH 79-1 was 130 feet, in DDH 79-2 80 feet and in DDH 79-3 170 feet. Various assays were taken in a random manner and were as a whole uninteresting. One assay from 133 feet in DDH 79-1 did yield 10 ppb gold however but in subsequent drilling more interest has developed to the east. Random assays of these holes are contained in this report.

DDH 79-1	131 feet to 407 feet	rhyolite breccia
DDH 79-2	80 feet to 595 feet	rhyolite breccia
DDH 79-3	171 feet to 650 feet	rhyolite breccia



CHEMEX LABS LTD.

212 BROOKSBANK AVE.
 NORTH VANCOUVER, B.C.
 CANADA V7J 2C1
 TELEPHONE: [REDACTED] 984-0221
 AREA CODE: 604
 TELEX: 043-52597

• ANALYTICAL CHEMISTS • GEOCHEMISTS • REGISTERED ASSAYERS

CERTIFICATE OF ANALYSIS

TO: Gillian Mines Lmtd.,
 c/o J. Paul . Stevenson
 1650 Riverside Drive
 N. Vancouver,

"ROCKS"

ATTN:

CERTIFICATE NO. 51844
 INVOICE NO. 34510
 RECEIVED Dec. 21/79
 ANALYSED Jan. 09/80

SAMPLE NO. :	PPM Pb	PPM Zn	PPM Ag	PPM As	PPB Hg	PPB Au
001	10	36	0.1	7.5	20	< 10
002	8	46	0.2	6.0	30	< 10
003	12	36	0.2	7.0	20	< 10
004	4	38	0.1	12	10	< 10
005	4	38	0.6	2.5	30	< 10
006	8	42	0.4	14	30	< 10
007	10	78	0.2	12	10	< 10
008	1	16	0.1	16	10	< 10
009	4	36	0.1	88	80	< 10
010	1	32	0.1	1.0	70	< 10
011	1	72	0.1	6.5	80	< 10
012	2	20	0.4	7.0	30	< 10
013	4	14	0.2	4.5	30	10
014	10	32	0.2	21	40	< 10
015	8	28	0.2	24	20	< 10
016	6	40	0.1	15	40	< 10



MEMBER
 CANADIAN TESTING
 ASSOCIATION

CERTIFIED BY: *Handwritten Signature*

APPENDIX C

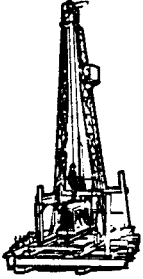

J. T. THOMAS
DIAMOND DRILLING LTD.
—
SMITHERS, B.C.

PH. 847-3531
P.O. BOX 394
VOJ 2N0

December 20, 1979

JAN 11 1980

Gillian Mines Ltd.
101 - 531 Lonsdale Avenue
North Vancouver, B.C.

Attention: Mr. Paul Stevenson.

Dear Paul:

Enclosed are two copies of the invoice for drilling done on your property at Gooseley Lake.

You will note that we have not charged the diamond products that were worn in reaming cave. This is to try and bring the invoice in line with the figure originally discussed for the program.

If you have any questions, Paul, please feel free to call at any time.

Yours truly,

A handwritten signature in cursive script that reads "Matt Norris".

Matt Norris

MN/pk
encls. 2

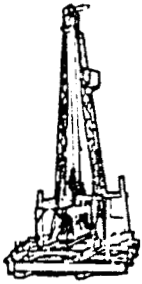

J. T. THOMAS
DIAMOND DRILLING LTD.
 —
SMITHERS, B.C.

PH. 847-3531
 P.O. BOX 394
 VOJ 2N0

To: Gillian Mines Ltd.
 101-531 Lonsdale Avenue
 North Vancouver, B.C.

Invoice No. 79-41
 Property: Gooseley Lake
 Invoice
 Date: Dec. 20/79

This invoice is for diamond drilling and other services on the above property per contract.

<u>Hole No.</u>	<u>Date From</u>	<u>To</u>	<u>Overburden From</u>	<u>To</u>	<u>Coring From</u>	<u>To</u>	<u>Total Footage</u>	<u>Rate</u>	<u>Amount</u>
-----------------	------------------	-----------	------------------------	-----------	--------------------	-----------	----------------------	-------------	---------------

DIAMOND DRILLING, See attached Page 1.									\$ 25,515.00
--	--	--	--	--	--	--	--	--	--------------

Mobilization:									
Man and machine hours, see attached Page 1									7,122.50
Demobilization:									

Moving Costs:

Mud Costs:									
Materials used, lost or damaged, see attached Page 2									2,949.60
Cementing Costs:									

Tractor Rental:

Core Boxes:

Testing Hole:

Casing and Shoes Left in Hole:

Camp Provision:

Downtime:

Fly Time:

Other:	Less: Advance received on invoice								<u>20,000.00</u> #96
--------	-----------------------------------	--	--	--	--	--	--	--	----------------------

Invoice Total:									<u>\$ 15,587.10</u>
----------------	--	--	--	--	--	--	--	--	---------------------

The above calculations are agreed to by:

Company Representative

Jim Thomas
 J. T. THOMAS DIAMOND DRILLING LTD.

*paid Jan. 18/80
 cheque # 124*

[Signature]

DIAMOND DRILLING

<u>Date</u>	<u>Hole No.</u>	<u>Overburden</u>		<u>Coring</u>		<u>Total Footage</u>	<u>Rate</u>	<u>Amount</u>
		<u>From</u>	<u>To</u>	<u>From</u>	<u>To</u>			
Dec. 8 - 9	79-1	0	131	131	407	407	\$ 15.00	\$ 6,105.00
Dec. 9 - 11	79-2	0	80	80	500	500	15.00	7,500.00
				500	595	95	18.00	1,710.00
Dec. 11 - 14	79-3	0	171	171	500	500	15.00	7,500.00
				500	650	150	18.00	<u>2,700.00</u>
Total Diamond Drilling								<u>\$ 25,515.00</u>

MAN AND MACHINE HOURS:

<u>Date</u>	<u>McLean</u>	<u>D'Amour</u>	<u>Leduc</u>	<u>McDougall</u>	<u>Shaw</u>	<u>Drill</u>	<u>Cat</u>	<u>Water Truck</u>
Dec. 8, Day	12		12		12		8	
8, Night	14½	14½				4½		12
9, Day			5½		5½	3½	2	12
9, Night	7	7						7
10, Day			3	3		3	11	9
10, Night	1½	1½				1½		5
11, Day			9	1½			7½	
11, Night	4½	5½				2½	2	6
12, Day			4					4
12, Night	3½	3				3½		6
13, Day			3	4		3		4
13, Night	3½	3½				3½		4
14, Day			2	2				2
15, Day		4		4				
16, Day	3½			3½			15	
17, Day	7	5½		7			1½	
	<u>57</u>	<u>44½</u>	<u>38½</u>	<u>25</u>	<u>17½</u>	<u>25</u>	<u>47</u>	<u>71</u>

Total Man and Drill Hours 207½ @ \$15.00	\$ 3,112.50
Total Tractor Hours 47 @ \$40.00	1,880.00
Total Water Truck Hours 71 @ \$30.00	<u>2,130.00</u>
Total Hours	<u>\$ 7,122.50</u>

MATERIALS USED, LOST OR DAMAGED:

<u>Date</u>	<u>Quantity</u> •	<u>Item</u>	<u>Cost</u>	<u>Amount</u>
Dec. 8, Day	1	NW Casing Shoe	\$ 300.00	\$ **n/c
	13	Bags Quik Gel	8.00	104.00
	12	Bags Quik Trol	3.00	36.00
	24	Gallons Diesel Fuel for mix mud	.90	21.60
Dec. 9, Day	7½	Gallons Alcomber	37.00	277.50
	10	Bags Quik Trol	3.00	30.00
	20	Gallons Diesel	.90	18.00
	1	50% NQ Bit	250.00	**n/c
	1	100 lb. Bottle Propane	20.00	20.00
Dec. 9, Night	10	Bags Quik Gel	8.00	80.00
	10	Bags Quik Trol	3.00	30.00
	1	40% NQ Bit	200.00	**n/c
	15	Coreboxes	6.00	90.00
	20	Gallons Diesel	.90	18.00
Dec. 10, Day	10	Gallons Alcomber	37.00	370.00
	5	Bags Quik Trol	3.00	15.00
	1	NW Casing Shoe	300.00	**n/c
	10	Gallons Diesel	.90	9.00
Dec. 10, Night	15	Gallons Soluble Oil	5.00	75.00
	1	25% NQ Bit	125.00	**n/c
	1	100 lb. Bottle Propane	20.00	20.00
	5	Bags Quik Trol	3.00	15.00
	10	Gallons Diesel	.90	9.00
Dec. 11, Day	23	Coreboxes	6.00	138.00
	5	Bags Quik Trol	3.00	15.00
	10	Gallons Soluble Oil	5.00	50.00
Dec. 11, Night	15	Bags Quik Gel	8.00	120.00
	15	Bags Quik Trol	3.00	45.00
	30	Gallons Diesel	.90	27.00
	1	NW Casing Shoe	300.00	**n/c
	1	40% NQ Bit	200.00	**n/c
Dec. 12, Day	2½	Gallons Alcomber mud	37.00	92.50
Dec. 12, Night	7½	Gallons Alcomber mud	37.00	277.50
	1	100 lb Bottle propane	20.00	20.00
	25	Gallons Soluble Oil	5.00	125.00
	1	70% NQ Bit	350.00	**n/c
Dec. 13, Day	5	Gallons Alcomber mud	37.00	185.00
	20	Gallons Soluble Oil	5.00	100.00
	1	35% NQ Bit	165.00	**n/c
Dec. 13, Night	1	100 lb. Bottle Propane	20.00	20.00
	2½	Gallons Alcomber mud	37.00	92.50
	1	40% Bit	200.00	**n/c
	25	Gallons Soluble Oil	5.00	125.00
	25	Coreboxes	6.00	150.00
Dec. 14	2	Coreboxes	6.00	120.00
Dec. 11, Day	10	Gallons Diesel	.90	9.00
			Total	<u>\$ 2,949.60</u>

** No charge for Diamond products worn in reaming cave.

Drilling Costs

Chemex Labs	Analysis	\$ 228.00
Chemex Labs	Sample bags	128.50
David Coote	Property Supervisor	1,150.00 7days at \$150.00
Bela Horvath	core splitting	279.00
Brian Sauer	core splitting	325.00
J.C. Stephen	consulting	300.00 2 days at 150.00
Westminster Auto Leasing	Blazer truck	903.91
J. P. Stevenson	evaluation	750.00 5 days at 150.00
Accomadation		327.40
Fuel	for truck	316.05
Travel	commercial flights	719.55
meals	those not on room bill	70.88

Total \$5,498.29

STATEMENT OF QUALIFICATIONS

I, J. Paul Stevenson do attest to the following:

- 1) That I have been engaged in various aspects of mining exploration since 1965.
- 2) That over the last six year I have directed and have been responsible for numerous exploration and development programs.
- 3) That all statements concerning geology and alteration have been made after communication with D. G. Leighton of Leighton and Assoc. and with B. N. Church of the B.C. Department of Mines.
- 4) That all costs submitted can be verified with receipts and invoices.

Respectfull submitted May 29, 1980,

A handwritten signature in dark ink, appearing to read 'J. Paul Stevenson', is written over a horizontal line.

J. Paul Stevenson, President

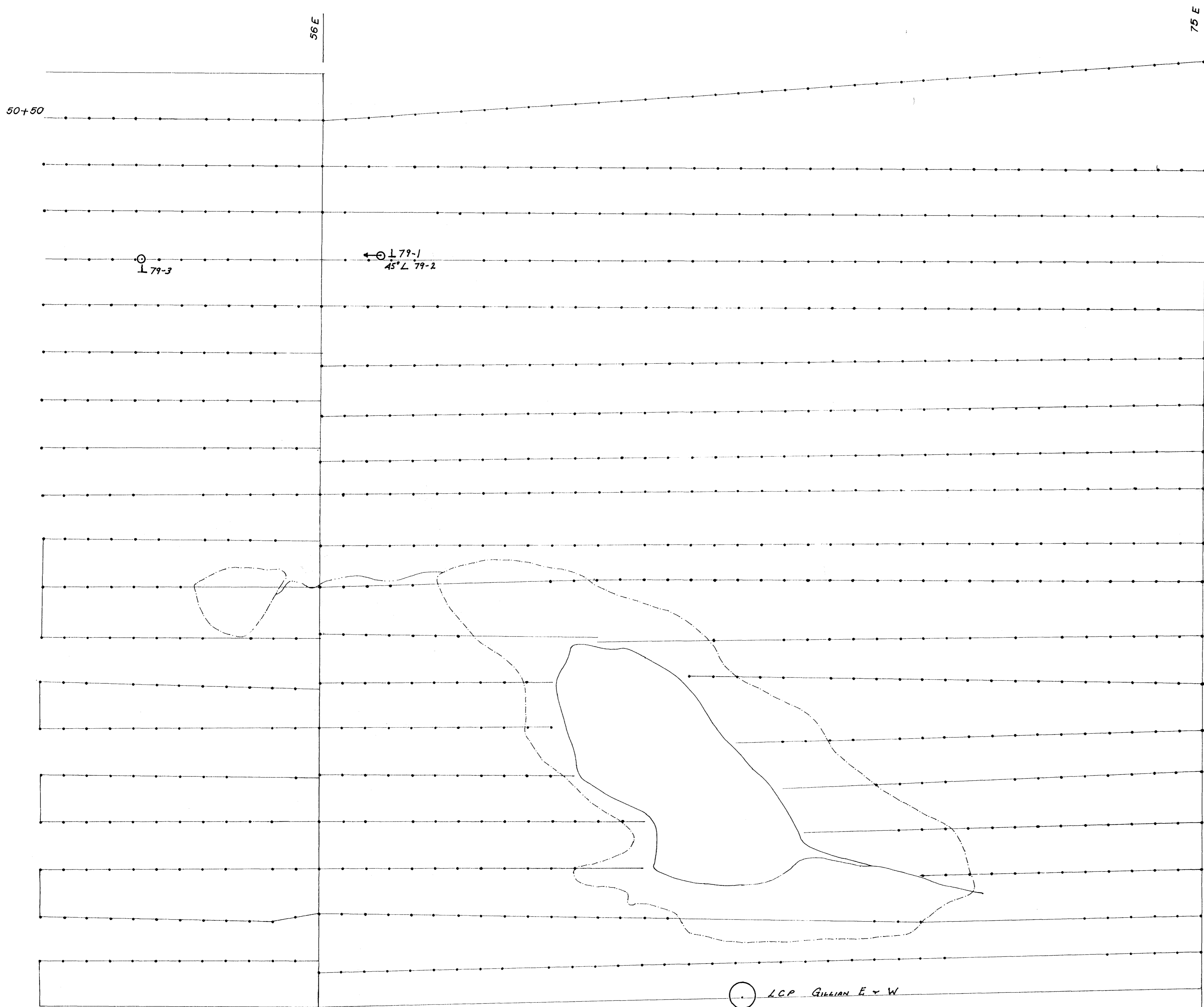

50
51 S
52 S
53 S
54 S
55 S
56 S
57 S
58 S
59 S
60 S
61 S
62 S
63 S
64 S
65 S
66 S
67 S
68 S
69 S

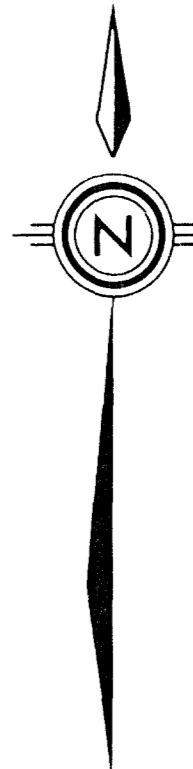

LEGEND

- GEOCHEMICAL SOIL SAMPLING STATION ON CUT LINE GRID WITH VALUE IN P.P.M.
- GEOCHEMICAL CONTOUR LINE
- - - MARSH BOUNDARY
- CREEK
- LEGAL CORNER POST
- DIAMOND DRILL HOLE

MINERAL RESOURCES DIVISION
ASSESSMENT REPORT
8189
Part 1
OF 3

gillian mines ltd.
GILLIAN EAST AND WEST MINERAL CLAIMS
GOOSLY LAKE AREA
OMENICA M.D., B.C.

VALUE AND CONTOUR MAP
SCALE IN METERS
100 50 0 100 200 300
1:50
MAP REFERENCE NTS 94L/1
PROPERTY COORDINATES 54° 10' N 126° 22' W