

BULLIS ENGINEERING LTD.

GEOLOGICAL CONSULTANTS

P.O. BOX 1039,
STATION A.
DELTA, B.C.
V4M 3T2

A. R. BULLIS, P.ENG.
(604) 539-2795

A. S. ASHTON, P.ENG.
(604) 943-4541

February 11, 1980.

Mining Recorder,
Skeena Mining Division,
Prince Rupert, B.C.

Dear Sir:

Re: MB Mineral Claims (240 Units Total)

The program, as indicated in the attached report, was done in consultation with Mr. Dion. It is part of a continuing program and, as it was commenced late in the season, only enough was accomplished to complete assessment work requirements. The limited information obtained is insufficient to draw any conclusions and, on completion of the total program, conclusions and recommendations will be forthcoming.

Samples were collected in an approved manner and assays completed by a qualified assayer.

Respectfully submitted,

A. S. Ashton, P. Eng.

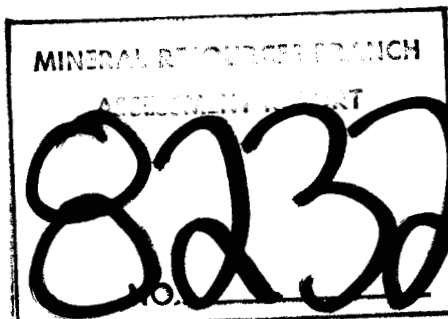

GEOCHEMISTRY REPORT

on the

MB MINERAL CLAIMS

Graham Island, Queen Charlotte Islands, B. C.

Skeena Mining Division
N.T.S. 103F/9E and 9W.

Latitude: $53^{\circ}33'$ to $53^{\circ}38'$
Longitude: $132^{\circ}10'$ to $132^{\circ}20'$

for

CALABRIGO & ASSOCIATES
711 - 543 Granville Street
Vancouver, B. C.

by:

R. R. Dion

February 29, 1980

TABLE OF CONTENTS

	<u>Page</u>
Summary	
Introduction	1
Location	1
Access	1
Topography	2
Claim Groups	2
Cost of Program	3
Geochemical Program	3
Results	4
Discussion	4
Recommendations	5

APPENDICES

- "A" N.T.S. Topographic Maps 1:50,000
Department of Mines Claim Maps 1:50,000
- "B" Sample Location Maps
- "C" Assay Procedures
Assay Certificates
- "D" Certificate
- "E" Statement of Costs

SUMMARY

This report details the procedure, work done and results to date of that portion of a recommended reconnaissance geochemical survey which was completed during the 1979 field season, for filing assessment work required to maintain the claims in good standing.

Until the balance of the survey is completed, no conclusions or further recommendations should be drawn from the work to date. It is anticipated that the balance of the recommended program will be completed during the 1980 field season.

The estimated cost to complete the survey is approximately \$48,000.00 or more.

Respectfully submitted,



R. R. Dion,
February 29, 1980.

GEOCHEMISTRY REPORT
on the
MB MINERAL CLAIMS
Graham Island, Queen Charlotte Islands, B. C.
Skeena Mining Division
for
Calabrigo & Associates
711 - 543 Granville Street
Vancouver, B. C.
by:
R. R. Dion

INTRODUCTION

This report was authorized by Reno Calabrigo, one of the partners in the development of the subject mineral claims.

Its purpose is to report on the procedure, costs and results to date of that portion completed during the 1979 field season, of a recommended reconnaissance geochemical survey of the subject claims.

LOCATION

The property is located in the north central part of Graham Island with its northeast corner located at Juskatla, a logging community, and its southeast corner located between Canoe Creek and the Yakoun River at a point approximately three kilometres northeast of a mineral zone being developed by Consolidated Cinola Mines Ltd.

ACCESS

Except for the MB 13 claim, the claims are cut by a number of logging roads established by MacMillan-Bloedel Ltd. These are active logging roads and are well maintained, but permission to use them should be obtained from the logging company.

These roads provide easy access to the claims from Port Clements and Juskatla on the north, or from Queen Charlotte City on the south. At most times of the year the property is accessible by two-wheel drive vehicles.

The Queen Charlotte Islands are serviced by daily jet flights into Sandspit and twice-weekly barge service into Massett.

TOPOGRAPHY⁽¹⁾

The topography is generally of low relief, from 000 metres ASL to 120 metres ASL. Most slopes are quite gentle except those immediately adjoining portions of Florence Creek and Canoe Creek.

Most of the claims have been partially logged over, and the balance are scheduled for logging in the near future. There is considerable area of fresh slash, as well as some dense second growth timber.

There is abundant water supply most of the year, except in the late August dry season.

CLAIM GROUPS⁽²⁾

The property consists of the following claims:

<u>Group Name</u>	<u>Claim Names</u>	<u>Units</u>	<u>Record No.</u>	<u>Expiry Date</u>
MB1	MB1	20	853	December 20, 1980
"	MB16	20	868	" " "
MB2	MB2	20	854	" " "
"	MB4	20	856	" " "
MB3	MB3	20	855	" " "
"	MB10	20	862	" " "
MB7	MB7	20	859	" " "
"	MB8	20	860	" " "
MB11	MB11	20	863	" " "
"	MB113	20	865	" " "
MB12	MB12	20	864	" " "
"	MB14	20	866	" " "

(1) Topographic Maps: NTS 103F/9E & 9W, 1:50,000 (Appendix A)

(2) Claim Maps and Files: B. C. Department of Mines & Petroleum Resources Maps 103F/9E & W. 1:50,000 (Appendix A)

Assessment work for one year was filed at the Vancouver office of the sub-recorder for the Skeena Mining Division on December 20, 1979 for the above six groups of 40 units each, totalling 240 units. The exact location of the ground and the area covered can only be determined by a legal survey.

COST OF PROGRAM

The current program was carried out under contract by Team Mineral Services Inc., a company owned and operated by the writer. The amount of assessable work performed on the MB Group was \$24,100.00 as detailed in Appendix E, "Statement of Costs".

GEOCHEMICAL PROGRAM

1. Grid

Depending upon the accessibility of the particular claim area, the grid was laid out for sample spacing varying from 100 metres by 100 metres to 100 metres by 500 metres, as shown on the detail maps (see Appendix B). This is only a reconnaissance grid, and there is enough room between lines to hide a mine. Future work will close the spacing and cover the balance of the claim area.

2. Sampling

Samples were dug with a pick, and an effort was made to get to the "B" horizon. Most samples of necessity were taken in the "A" horizon, since the "B" was too deep.

All samples were put in standard "wet proof" paper bags marked with their location.

3. Assaying

The samples were taken to Acme Analytical Labs Ltd., Vancouver, B. C., for assaying for gold and mercury.

The analysis procedure and the assay certificates are enclosed in Appendix C.

RESULTS

Gold

The assay results indicate a background reading for gold varying from the detection limit, .005 ppm. to .010 ppm. of 572 samples taken and assayed, 8 exceeded this background level, yielding assays ranging from .015 ppm. to .050 ppm.

Mercury

56% of the samples assayed less than .200 ppm.

86% of the samples assayed less than .300 ppm.

94.6% of the samples assayed less than .400 ppm.

Threshold has been taken at .300 ppm.

Anomalous has been taken at .400 ppm.

5.4% (= 31 samples) were considered to be anomalous, yielding assays ranging from .405 ppm. to 1.400 ppm.

DISCUSSION

Although the results are not conclusive, it appears that anomalous areas will be defined by the results of a complete survey over the claims area, since some samples on the widely spaced grid yielded results which must be considered anomalous.

RECOMMENDATIONS

It is recommended that the geochemical survey be continued during the 1980 field season. If financing permits, the grid spacing should be closed in to 50 metres by 100 metres.

The cost of covering the claims area as recommended is estimated at \$48,000.00 to \$72,000.00 depending on the season, the lower value representing the lower cost of summer working conditions.

Respectfully submitted,



R. R. Dion
February 29, 1980

APPENDIX "A"

N.T.S. Topographic Maps 1:50,000
Department of Mines Claim Maps 1:50,000

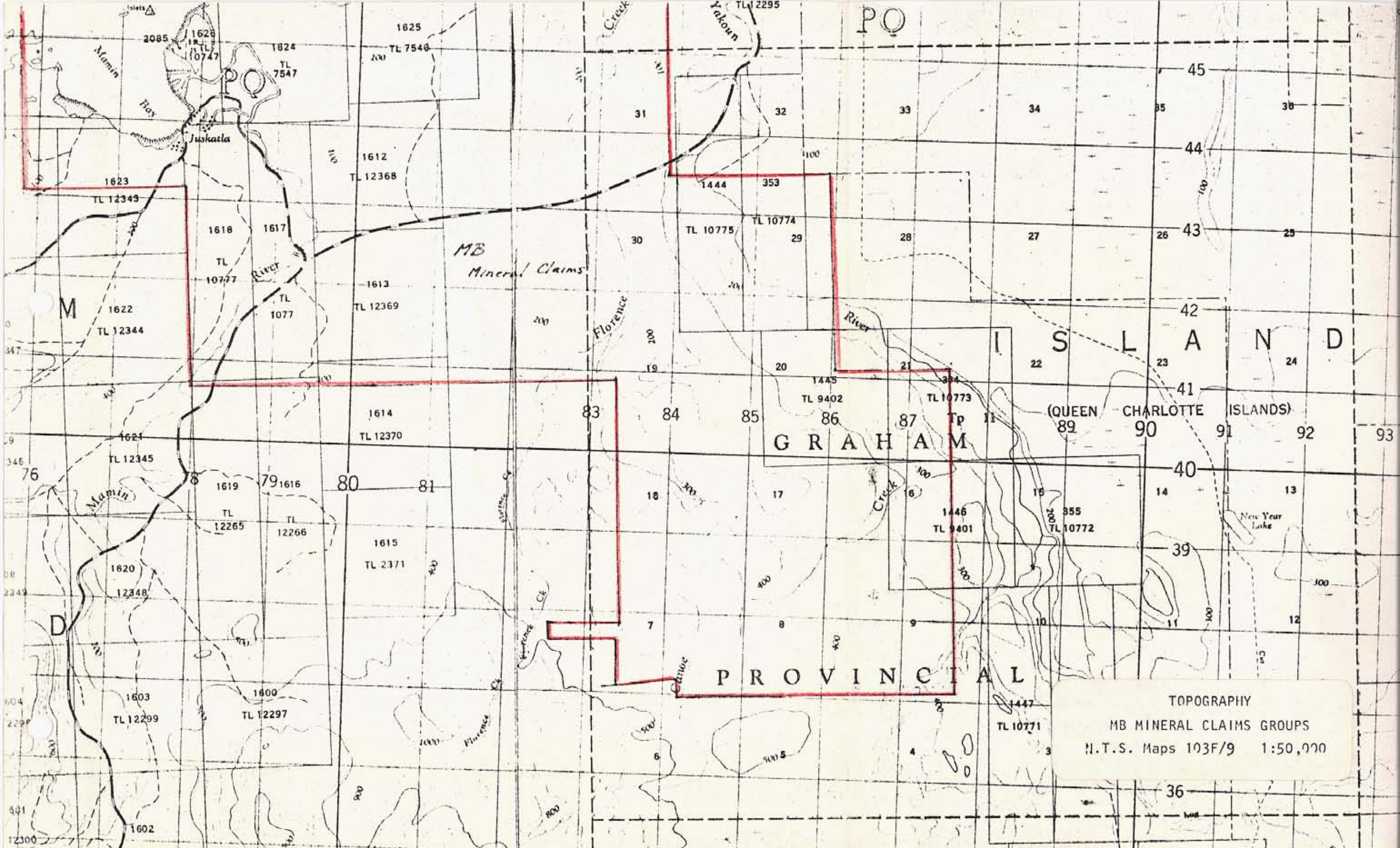

MB Mineral Claims

PROVINCIAL

GRAHAM

(QUEEN CHARLOTTE ISLANDS)

TOPOGRAPHY
MB MINERAL CLAIMS GROUPS
N.T.S. Maps 103F/9 1:50,000

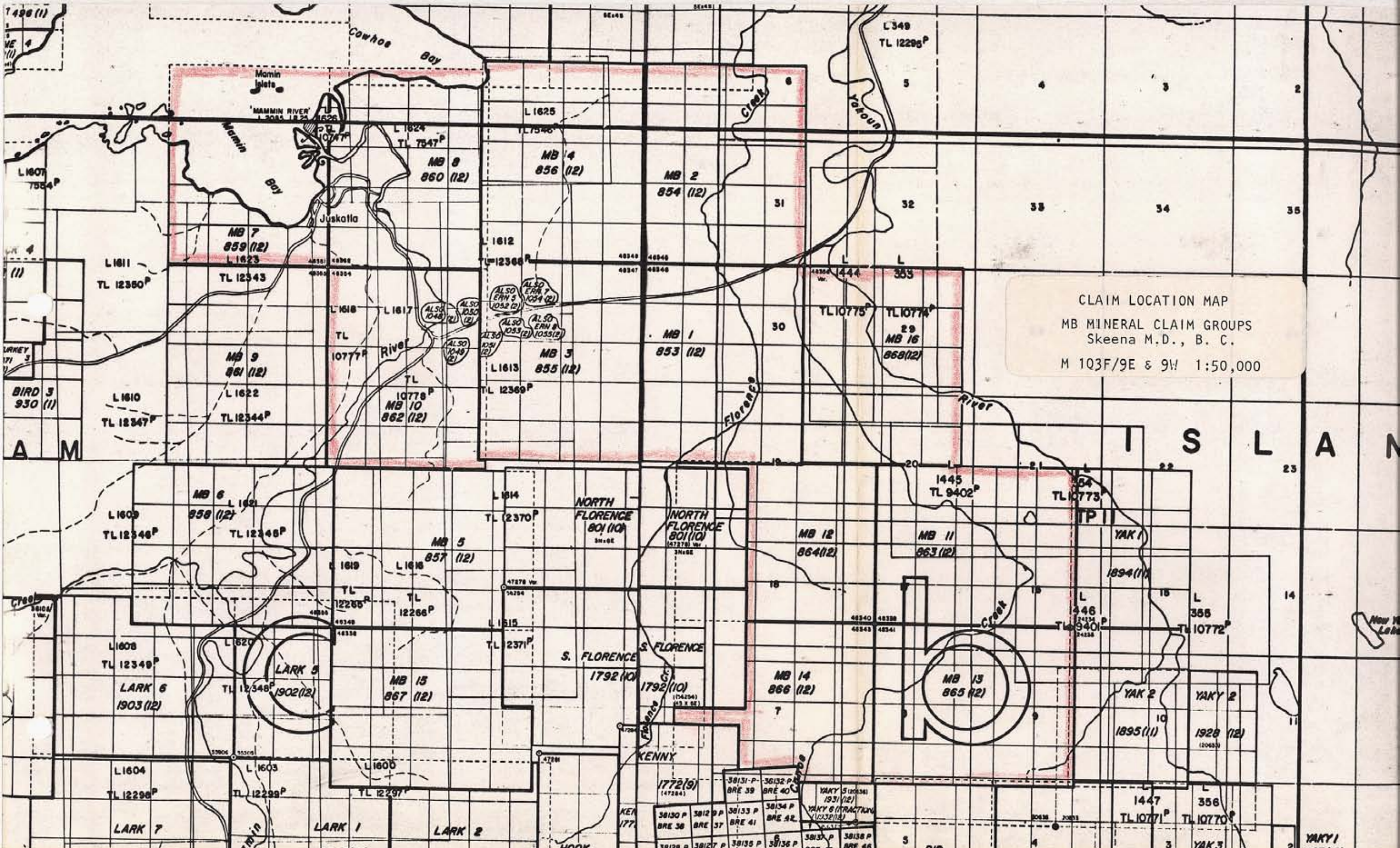

CLAIM LOCATION MAP
 MB MINERAL CLAIM GROUPS
 Skeena M.D., B. C.
 M 103F/9E & 9W 1:50,000

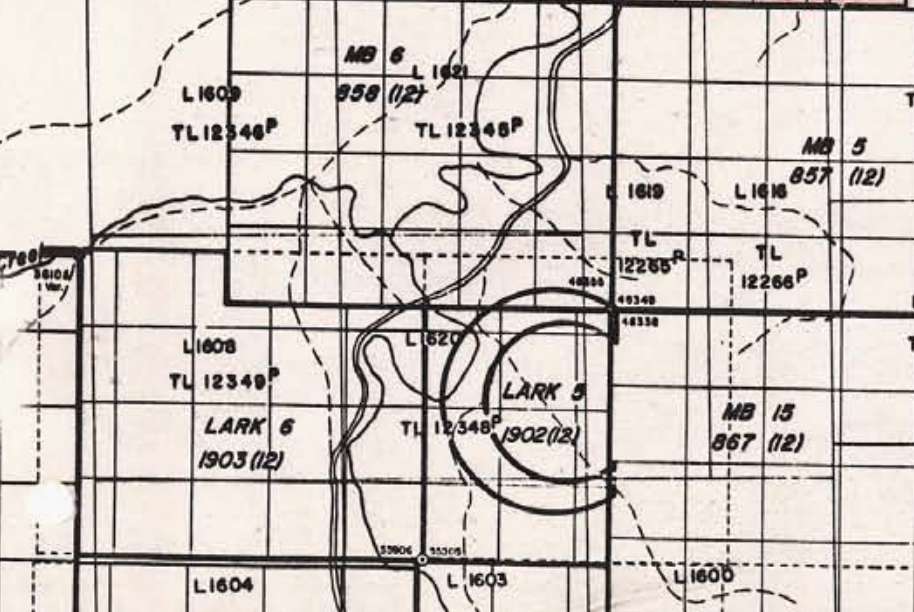
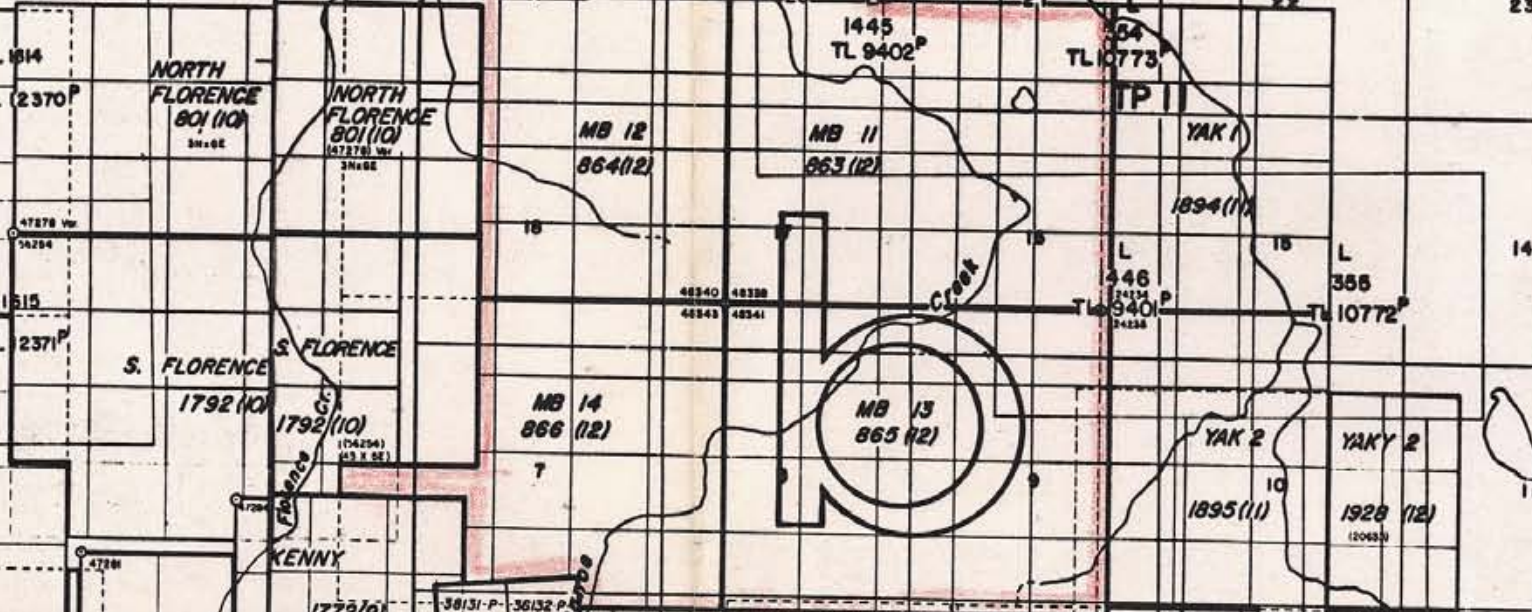
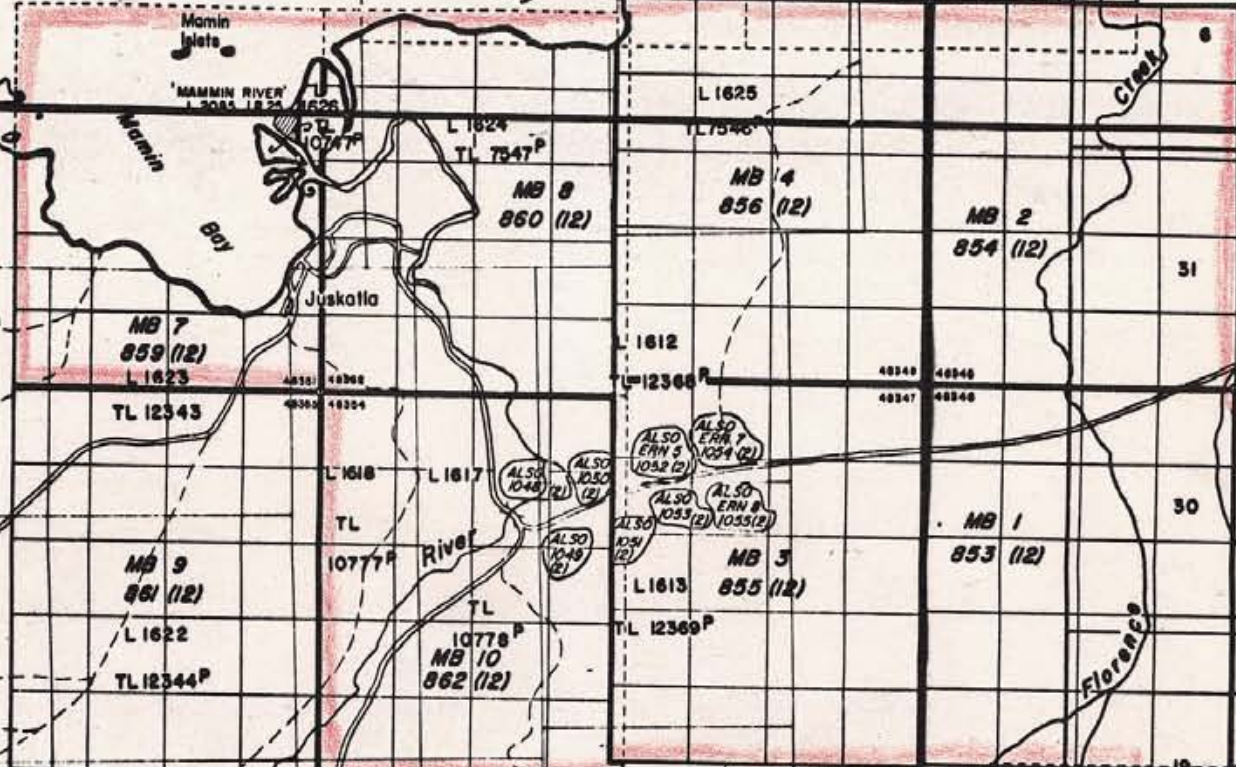

APPENDIX "B"

Sample Location Maps

APPENDIX "C"

Assay Procedures
Assay Certificates

Geochemical Analysis of Mo, Cu, Pb, Zn, Ag*, Ni, Co,
Mn, Bi*, V, Fe, Cd*, & Sb*

Sample preparation

Soil samples are dried at 75°C and sieved to -80 mesh.

Rock samples are ground to -100 mesh.

Digestion

A .50 gram sample is digested with dilute aqua regia in boiling water bath and diluted to 10 mls with demineralized water.

Determination

All the above elements are determined by Atomic Absorption from the solution.

* With background correction.

Geochemical Analysis of Au ✓

Digestion and extraction

A 10 gram sample which has been ignited over night at 600°C is digested hot with dilute aqua regia, and the clear solution is extracted with Methyl Isobuthyl Ketone.

Determination

Au is determined by AA from the MIBK extractant with background correction.

Geochemical Analysis of Ba

A .100 gram sample is digested hot with NaOH and EDTA solution. The solution is analysis for Ba by AA.

Geochemical Uranium Analysis

Digestion

A .50 gram sample is digested hot with nitric and perchloric acid and diluted to 10 mls.

Fusion

An aliquot is solvent extracted with salting agent and aliquot of is fused with NaF, K₂CO₃, & Na₂CO₃ flux in platinum dish.

Determination

The fluorescence of the pellet is read in the Turner fluorometer.

Geochemical Analysis for Tungsten

A 1.00 gram sample is fused with KCl, KNO₃, & Na₂CO₃ flux in a test-tube, is leached with 10.0 mls water. An aliquot is used to develop a complex with SnCl₂, KSCN and HCl which is extracted by n-tributylphosphate and carbon tetrachloride.

Geochemical Analysis for Fluorine

A .25 gram sample is fused with sodium hydroxide and is leached with water. The solution neutralized, buffered and adjusted to pH 7.8 and diluted to 100 mls. Fluorine is determined by specific ion electrode with specific ion meter, Orion Model 404.

Geochemical Analysis for Tin

A 1.0 gram sample is fused with ammonium iodide in a test-tube. The decomposed iodine is leached with dilute hydrochloric acid; an aliquot is use for colorimetric development with gallein in a buffered solution.

Geochemical Analysis for Platinum

A 10 gram sample is digested with aqua regia to dryness. An aliquot of HCl leached solution is reduced by stannous chloride and extracted into MIBK. The extracted Pt is determined by AA with background correction.

Geochemical Analysis of As ✓

Digestion

A .50 gram digested hot with 5 mls of 50% HCl, and then diluted to 10 mls.

Determination

The As is evolved from solution of KI, SnCl₂ by Zn metal into AgDDC solution which is read colorimetically.

Geochemical Analysis of Hg ✓

Digestion

A .50 gram sample is digested with nitric and perchloric acid and diluted with 20% HCl.

Determination

Hg is determined by cold vapour AA using F & J scientific Hg assembly. An aliquot is added to stannous chloride-hydrochloric acid solution. The reduced Hg is carried by bubbling air through the solution and passed into the Hg cell determined by AA.

Oxalic Acid Leach of Rock, Soil & Silt Samples

A .50 gram sample is digested hot with 10 mls 5% oxalic acid solution. The oxalic acid will dissolve Fe and Mn from their oxides of M - 1 fraction (but not from magnetite & ilmenite) limonites and clays. The following metals are analysed by atomic absorption: Cu, Zn, Pb, Ni, Mo, Fe, & Mn.

Cold HCl Acid Extraction

A .50 gram sample is leached at room temperature for 2 hours with occasional shaking with 10 mls 5% HCl solution. This will dissolve Cu from the organic and surface of clay fractions.

EDTA Extraction

A .50 gram sample is leached at room temperature for 4 hours with 10 mls of 2.5% EDTA solution.

CORE & ROCK ASSAYS SOIL, ROCK & WATER GEOCHEM ANALYSIS
ACME ANALYTICAL LABORATORIES LTD.

MAIN LAB - 6455 LAUREL ST.
BURNABY, B.C. V5B 3B4
(604) 299-5242

ROSS RIVER - YUKON - (403) 969-2217

DEAN TOYE, B.Sc.
CHIEF CHEMIST, CERTIFIED B.C. ASSAYER
HOME PHONE 438-7672



To: Calabrigo & Associates,
c/o Consolidated Cinola Mines Ltd.,
711 - 535 Granville St.,
Vancouver, B.C.

File No. 0722

Type of Samples _____

Disposition _____

GEOCHEMICAL ASSAY CERTIFICATE

* All samples are pulverized

SAMPLE No.		Au	Hg																		
MBJ 1W		.005	.200																		1
2	org.	.005	.180																		2
3	org.	.005	.260																		3
4	org.	.005	.120																		4
5	org.	.005	.135																		5
6	org.	.005	.150																		6
7		.005	.230																		7
8		.005	.260																		8
9		.005	.275																		9
10		.005	.250																		10
11		.005	.230																		11
12		.005	.220																		12
13		.005	.205																		13
14		.040	.200																		14
15	org.	.025	.190																		15
16	org.	.025	.125																		16
17		.005	.215																		17
18		.005	.210																		18
19		.010	.310																		19
20	org.	.005	.170																		20
21	org.	.005	.150																		21
22		.005	.210																		22
23		.010	.245																		23
24	org.	.010	.220																		24
MBJ 25W	org.	.050	.165																		25
																					26
MBJ 1N OW		.005	.160																		27
1	org.	.005	.165																		28
2	org.	.010	.120																		29
3	org.	.010	.160																		30
4	org.	.005	.195																		31
5	org.	.010	.155																		32
6	org.	.005	.090																		33
7	org.	.015	.080																		34
8	org.	.005	.120																		35
9	org.	.010	.130																		36
10	org.	.020	.125																		37
11	org.	.005	.140																		38
MBJ 1N 12W	org.	.005	.150																		39
																					40

All reports are the confidential property of clients
All results are in PPM.

DIGESTION:.....

DETERMINATION:.....

DATE SAMPLES RECEIVED Dec. 17, 1979

DATE REPORTS MAILED Jan. 9, 1980

ASSAYER Dean Toye

DEAN TOYE, B.Sc.
CHIEF CHEMIST
CERTIFIED B.C. ASSAYER



To: Calabrigo & Associates,

ACME ANALYTICAL LABORATORIES LTD.

Assaying & Trace Analysis

852 E. Hastings St., Vancouver, B. C. V6A 1R6

phone: 253 - 3158

File No. 0722

Type of Samples

Disposition

GEOCHEMICAL ASSAY CERTIFICATE

SAMPLE No.	Au	Hg																			
2																					
MBJ 1N 13W	.005	.260																			1
14	.010	.210																			2
15	.005	.220																			3
MBJ 1N 16W	.005	.105																			4
																					5
MBJ 1N 18W	.005	.110																			6
19	.005	.050																			7
20	.005	.185																			8
21	.005	.110																			9
22	.005	.185																			10
23	.005	.260																			11
24	.005	.285																			12
MBJ 1N 25W	.005	.175																			13
																					14
MBJ 2N 0W	.005	.640																			15
1	.005	.160																			16
2	.005	.150																			17
3	org.	.095																			18
4		.175																			19
5		.550																			20
6		.190																			21
7	org.	.250																			22
8	org.	.330																			23
9	org.	.170																			24
10		.250																			25
																					26
12	.005	.310																			27
13	.005	.330																			28
14	.005	.610																			29
15	org.	.135																			30
16		.185																			31
17		.170																			32
18	org.	.340																			33
18		.040																			34
19		.025																			35
20	.005	.050																			36
21	.010	.575																			37
22	.010	.410																			38
MBJ 2N 23W	.020	.230																			39
																					40

All reports are the confidential property of clients
All results are in PPM.

DIGESTION:.....

DETERMINATION:.....

DATE SAMPLES RECEIVED Dec. 17, 1979

DATE REPORTS MAILED Jan 9, 1980

ASSAYER *D. Toye*

DEAN TOYE, B.Sc.
CHIEF CHEMIST
CERTIFIED B.C. ASSAYER



To: Calabrigo & Associates,

ACME ANALYTICAL LABORATORIES LTD.

Assaying & Trace Analysis

852 E. Hastings St., Vancouver, B. C. V6A 1R6

phone: 253 - 3158

File No. 0722

Type of Samples

Disposition

GEOCHEMICAL ASSAY CERTIFICATE

3

SAMPLE No.		Au	Hg																			
MBJ 2N 25W		.005	.300																		1	
																						2
MBJ 3N 1W		.005	.295																			3
	2	.010	.130																			4
	3	.010	.215																			5
	4	.010	.265																			6
	5	.005	.180																			7
	6	.005	.170																			8
	7	.005	.155																			9
	8	.010	.090																			10
	9	.010	.650																			11
	10	.005	.200																			12
	11	.010	.040																			13
	12	.010	.020																			14
	13	.005	.010																			15
	14	.005	.015																			16
	15	.005	.010																			17
	16	.005	.030																			18
	17	.005	.010																			19
																						20
	19	.005	.220																			21
	20	.010	.260																			22
	21	.005	.290																			23
	22	.005	.510																			24
	23	.005	.245																			25
	24	.005	.280																			26
	24	org.	.005	.235																		27
MBJ 3N 25W		.005	.335																			28
																						29
MB#1 500E OS		.005	.140																			30
	1	org.	.005	.160																		31
	2	org.	.005	.115																		32
																						33
	4	org.	.010	.165																		34
	5	org.	.005	.050																		35
	6		.005	.025																		36
	7		.005	.100																		37
MB#1 500E 8S		.020	.140																			38
																						39
																						40

All reports are the confidential property of clients
All results are in PPM.

DIGESTION:.....

DETERMINATION:.....

DATE SAMPLES RECEIVED Dec. 17, 1979

DATE REPORTS MAILED Jan. 9, 1980

ASSAYER

Dean Toye
DEAN TOYE, B.Sc.
CHIEF CHEMIST
CERTIFIED B.C. ASSAYER



To: Calabrigo & Associates

ACME ANALYTICAL LABORATORIES LTD.

Assaying & Trace Analysis

852 E. Hastings St., Vancouver, B. C. V6A 1R6

phone: 253 - 3158

File No. 0722

Type of Samples

Disposition

GEOCHEMICAL ASSAY CERTIFICATE

4

SAMPLE No.		Au	Hg																	
MB#1	500E 9S	.005	.140																	1
	10	.005	.115																	2
	11	.005	.165																	3
MB#1	500E 12S	.010	.085																	4
																				5
MB#1	1000E 0S org.	.005	.155																	6
	1 org.	.005	.150																	7
	2 org.	.005	.160																	8
	3 org.	.005	.210																	9
	4 org.	.005	.210																	10
	5 org.	.005	.220																	11
	6 org.	.005	.210																	12
	7	.005	.145																	13
	8	.005	.025																	14
	9	.005	.040																	15
	10	.005	.060																	16
	11	.005	.085																	17
MB#1	1000E 12S	.005	.080																	18
																				19
MB#1	1500E 0S org.	.005	.090																	20
	1 org.	.005	.085																	21
	2 org.	.005	.080																	22
	3 org.	.005	.210																	23
	4 org.	.005	.265																	24
	5 org.	.005	.250																	25
	6 org.	.005	.165																	26
	7 org.	.005	.175																	27
	8 org.	.005	.200																	28
	9	.005	.190																	29
	10	.005	.230																	30
	11	.005	.230																	31
MB#1	1500E 12S org.	.005	.250																	32
																				33
MB#1	2000E 0S org.	.005	.135																	34
	1 Aorg.	.010	.150																	35
	1 Borg.	.005	.175																	36
	2 org.	.005	.280																	37
MB#1	2000E 2S	.005	.215																	38
																				39
																				40

All reports are the confidential property of clients
All results are in PPM.

DIGESTION:.....

DETERMINATION:.....

DATE SAMPLES RECEIVED Dec. 17, 1979

DATE REPORTS MAILED Jan. 9, 1980

ASSAYER *D. Toye*

DEAN TOYE, B.Sc.
CHIEF CHEMIST
CERTIFIED B.C. ASSAYER



To: Calabrigo & Associates

ACME ANALYTICAL LABORATORIES LTD.

Assaying & Trace Analysis

852 E. Hastings St., Vancouver, B. C. V6A 1R6

phone:253 - 3158

File No. 0722

Type of Samples

Disposition

GEOCHEMICAL ASSAY CERTIFICATE

5

Table with columns: SAMPLE No., Au, Hg, and numbered rows 1-40. Data includes sample IDs like MB#1 2000E 3S org. and MB#2 500E ON org. with corresponding Au and Hg values.

All reports are the confidential property of clients
All results are in PPM.

DIGESTION:.....

DETERMINATION:.....

DATE SAMPLES RECEIVED Dec. 17, 1979

DATE REPORTS MAILED Jan. 9, 1980

ASSAYER

DEAN TOYE, B.Sc.
CHIEF CHEMIST
CERTIFIED B.C. ASSAYER



To: Calabrigo & Associates

ACME ANALYTICAL LABORATORIES LTD.

Assaying & Trace Analysis

852 E. Hastings St., Vancouver, B. C. V6A 1R6

phone: 253 - 3158

File No. 0722

Type of Samples

Disposition

GEOCHEMICAL ASSAY CERTIFICATE

6

SAMPLE No.		Au	Hg																		
MB#2 1500E ON		.005	.160																		1
	1	.005	.260																		2
	2	org. .005	.200																		3
	3	org. .010	.145																		4
	4	.005	.180																		5
	5	org. .005	.155																		6
	6	org. .010	.125																		7
	7	org. .005	.170																		8
	8	org. .005	.220																		9
	9	.005	.300																		10
	10	.005	.090																		11
	11	.005	.220																		12
MB#2 1500E 12N		.005	.240																		13
																					14
MB#2 2000E ON		.005	.125																		15
	1	.005	.155																		16
	2	.005	.125																		17
	3	.005	.235																		18
	4	org. .005	.285																		19
	5	org. .005	.375																		20
	6	.005	.155																		21
	7	.005	.120																		22
	8	.005	.120																		23
	9	.005	.210																		24
	10	.005	.230																		25
	11	.005	.200																		26
MB#2 2000E 12N	org.	.005	.330																		27
																					28
MB#3	1S	org. .005	.240																		29
	2	org. .005	.255																		30
	3	.005	.025																		31
	4	.005	.185																		32
	5	.005	.300																		33
	6	.005	.260																		34
	7	org. .005	.170																		35
	8	.005	.210																		36
	9	org. .005	.230																		37
	10	.005	.515																		38
	11	.005	.375																		39
MB#3	12S	org. .005	.370																		40

All reports are the confidential property of clients
All results are in PPM.

DIGESTION:.....

DETERMINATION:.....

DATE SAMPLES RECEIVED Dec. 17, 1979

DATE REPORTS MAILED Jan. 9, 1980

ASSAYER Dean Toy

DEAN TOYE, B.Sc.
CHIEF CHEMIST
CERTIFIED B.C. ASSAYER



To: Calabrigo & Associates

ACME ANALYTICAL LABORATORIES LTD.

Assaying & Trace Analysis

852 E. Hastings St., Vancouver, B. C. V6A 1R6

phone: 253 - 3158

File No. 0722

Type of Samples _____

GEOCHEMICAL ASSAY CERTIFICATE

Disposition _____

7

SAMPLE No.		Au	Hg																		
MB#3 500W 1S		.005	.210																		1
	2	.005	.240																		2
	3	.005	.325																		3
	4	.005	.130																		4
	5	.005	.210																		5
	6	.005	.210																		6
	7	.005	.305																		7
	8	.010	.320																		8
	9	.005	.190																		9
	10	.005	.405																		10
	11	org.	.005	.480																	11
MB#3 500W 12S		.005	.090																		12
																					13
MB#3 1000W 1S		.005	.165																		14
	2	.005	.350																		15
	3	.005	.135																		16
	4	org.	.005	.180																	17
	5	.005	.180																		18
	6	.005	.140																		19
	7	org.	.010	.150																	20
	8	.005	.120																		21
	9	.005	.240																		22
	10	.005	.195																		23
	11	.010	.200																		24
MB#3 1000W 12S		.005	.200																		25
																					26
MB#3 1500W 1S		.005	.220																		27
	2	.005	.130																		28
	3	org.	.005	.230																	29
	4	.005	.205																		30
	5	org.	.005	.050																	31
	6	org.	.005	.240																	32
	7	org.	.005	.080																	33
	8	.005	.180																		34
	9	.010	.200																		35
	10	org.	.010	.235																	36
	11	org.	.005	.125																	37
MB#3 1500W 12S		.005	.290																		38
																					39
																					40

All reports are the confidential property of clients
All results are in PPM.

DIGESTION:.....

DETERMINATION:.....

DATE SAMPLES RECEIVED Dec. 17, 1979

DATE REPORTS MAILED Jan. 9, 1980

ASSAYER Dean Toye

DEAN TOYE, B.Sc.
CHIEF CHEMIST
CERTIFIED B.C. ASSAYER



To: Calabrigo & Associates

ACME ANALYTICAL LABORATORIES LTD.

Assaying & Trace Analysis

852 E. Hastings St., Vancouver, B. C. V6A 1R6

phone: 253 - 3158

File No. 0722

Type of Samples

Disposition

GEOCHEMICAL ASSAY CERTIFICATE

8

SAMPLE No.			Au	Hg									
MB#4	1N	org.	.005	.200									1
	2	org.	.005	.175									2
	3		.005	.210									3
	4		.005	.130									4
	5		.005	.120									5
	6		.005	.170									6
	7		.005	.120									7
	8		.005	.195									8
	9		.005	.115									9
	10		.005	.110									10
	11		.005	.065									11
MB#4	12N	org.	.005	.165									12
													13
MB#4	500W	1N	.005	.120									14
	2		.005	.420									15
	3		.005	.090									16
	4		.005	.150									17
	5		.005	.100									18
	6		.005	.145									19
	7	org.	.005	.070									20
													21
	9 (A)		.005	.090									22
	9	org.	.005	.030									23
	10	org.	.005	.080									24
	11		.005	.075									25
MB#4	500W	12N	.005	.055									26
													27
MB#4	1000W	ON	.005	.135									28
	1	org.	.005	.095									29
	2		.005	.080									30
	3		.005	.110									31
	4		.005	.140									32
	5		.005	.090									33
	6		.005	.065									34
	7		.005	.040									35
	8		.005	.040									36
	9	org.	.005	.080									37
	10		.005	.050									38
MB#4	1000W	11N	.005	.210									39
													40

All reports are the confidential property of clients
All results are in PPM.

DIGESTION:.....

DETERMINATION:.....

DATE SAMPLES RECEIVED Dec. 17, 1979

DATE REPORTS MAILED Jan. 9, 1980

ASSAYER Dean Toye

DEAN TOYE, B.Sc.
CHIEF CHEMIST
CERTIFIED B.C. ASSAYER



To: Calabrigo & Associates

ACME ANALYTICAL LABORATORIES LTD.

Assaying & Trace Analysis

852 E. Hastings St., Vancouver, B. C. V6A 1R6

phone: 253 - 3158

File No. 0722

Type of Samples

Disposition

GEOCHEMICAL ASSAY CERTIFICATE

10

SAMPLE No.			Au	Hg															
MB#10	26	org.	.005	.230															1
	27		.005	.200															2
	28		.005	.260															3
	29	org.	.005	.120															4
	30	org.	.005	.260															5
	31	org.	.005	.180															6
	32	org.	.005	.190															7
	33	org.	.005	.205															8
	34	org.	.005	.190															9
	35		.005	.190															10
	36		.005	.220															11
	37		.005	.270															12
	38		.005	.335															13
	39		.005	.090															14
	40		.005	.020															15
	41		.005	.120															16
	42	org.	.005	.270															17
	43		.005	.250															18
	44		.005	.115															19
	45		.005	.165															20
	46		.005	.210															21
	47		.005	.185															22
	48	org.	.005	.230															23
	49	org.	.005	.290															24
MB#10	50		.005	.130															25
																			26
MB#16	100E	OS	.005	.145															27
	1		.010	.115															28
	2	org.	.005	.190															29
	3	org.	.005	.290															30
	4		.005	.100															31
	5		.005	.250															32
	6		.005	.120															33
	7		.005	.100															34
	8		.005	.110															35
	9	org.	.005	.135															36
	10	org.	.005	.285															37
	11	org.	.005	.200															38
MB#16	100E	12S	org.	.005	.280														39
																			40

All reports are the confidential property of clients
All results are in PPM.

DIGESTION:.....

DETERMINATION:.....

DATE SAMPLES RECEIVED Dec. 17, 1979

DATE REPORTS MAILED Jan. 9, 1980

ASSAYER

Dean Toy
DEAN TOYE, B.Sc.
CHIEF CHEMIST
CERTIFIED B.C. ASSAYER



To: Calabrigo & Associates

ACME ANALYTICAL LABORATORIES LTD.

Assaying & Trace Analysis

852 E. Hastings St., Vancouver, B. C. V6A 1R6

phone: 253 - 3158

File No. 0722

Type of Samples

Disposition

GEOCHEMICAL ASSAY CERTIFICATE

11

SAMPLE No.		Au	Hg																	
MB#16	100E 13S	.005	.130																	1
	14 org.	.005	.255																	2
	15	.005	.260																	3
MB#16	100E 16S org.	.005	.230																	4
																				5
MB#16	200E OS	.005	.150																	6
	1	.005	.250																	7
	2	.005	.270																	8
	3	.005	.225																	9
	4	.005	.220																	10
	5	.005	.305																	11
	6	.005	.270																	12
	7	.005	.260																	13
	8	.005	.150																	14
	9	.005	.270																	15
	10	.005	.300																	16
	11	.005	.230																	17
	12	.005	.180																	18
	13	.005	.210																	19
	14	.005	.200																	20
	15	.005	.230																	21
MB#16	200E 16S org.	.005	.305																	22
																				23
MB#16	300 OS	.005	.075																	24
	1	.005	.125																	25
	2	.005	.140																	26
	3	.005	.155																	27
	4	.005	.210																	28
	5	.005	.230																	29
	6	.005	.210																	30
	7	.010	.300																	31
	8	.005	.210																	32
	9	.005	.235																	33
	10	.005	.125																	34
	11	.005	.180																	35
	12 org.	.005	.175																	36
MB#16	300E 13S org.	.005	.220																	37
																				38
																				39
																				40

All reports are the confidential property of clients
All results are in PPM.

DIGESTION:.....

DETERMINATION:.....

DATE SAMPLES RECEIVED Dec. 17, 1979

DATE REPORTS MAILED Jan. 8, 1980

ASSAYER *Dean Toye*

DEAN TOYE, B.Sc.
CHIEF CHEMIST
CERTIFIED B.C. ASSAYER



To: Calabrigo & Associates

ACME ANALYTICAL LABORATORIES LTD.

Assaying & Trace Analysis

852 E. Hastings St., Vancouver, B. C. V6A 1R6

phone: 253 - 3158

File No. 0722

Type of Samples

Disposition

GEOCHEMICAL ASSAY CERTIFICATE

12

SAMPLE No.		Au	Hg																	
MB#16 300E 14S	org.	.010	.200																	1
15	org.	.005	.275																	2
MB#16 300E 16S		.005	.185																	3
																				4
MBY-0- 0S	org.	.010	.405																	5
1	org.	.005	.390																	6
2		.005	.290																	7
3	org.	.005	.410																	8
4	org.	.005	.760																	9
5	org.	.005	.435																	10
6	org.	.005	.200																	11
7	org.	.005	.490																	12
8	org.	.005	.390																	13
9		.005	.255																	14
10		.010	.340																	15
11		.005	.310																	16
12		.005	.375																	17
13	org.	.005	.405																	18
																				19
15		.010	.300																	20
16	org.	.005	.385																	21
17		.010	.350																	22
18		.005	.405																	23
19		.005	.335																	24
MBY-0-20S		.005	.620																	25
																				26
MBY-0- 0(A)	org.	.005	.200																	27
1	org.	.005	.100																	28
2	org.	.005	.115																	29
3	org.	.005	.145																	30
4	org.	.005	.155																	31
5	org.	.005	.145																	32
6	org.	.005	.100																	33
7	org.	.005	.195																	34
8		.005	.145																	35
9		.005	.290																	36
MBY-0-10(A)	org.	.005	.350																	37
																				38
																				39
																				40

All reports are the confidential property of clients
 All results are in PPM.
 DIGESTION:.....
 DETERMINATION:.....

DATE SAMPLES RECEIVED Dec. 17, 1979
 DATE REPORTS MAILED Jan. 9, 1980
 ASSAYER Dean Toye

DEAN TOYE, B.Sc.
 CHIEF CHEMIST
 CERTIFIED B.C. ASSAYER



To: Calabrigo & Associates

ACME ANALYTICAL LABORATORIES LTD.

Assaying & Trace Analysis

852 E. Hastings St., Vancouver, B. C. V6A 1R6

phone: 253 - 3158

File No. 0722

Type of Samples

Disposition

GEOCHEMICAL ASSAY CERTIFICATE

13

SAMPLE No.		Au	Hg																	
MBY-0-11 (A)	org.	.005	.120																	1
12	org.	.005	.170																	2
13	org.	.005	.085																	3
14	org.	.005	.160																	4
15		.005	.125																	5
16	org.	.005	.140																	6
17	org.	.005	.160																	7
18		.005	.200																	8
19	org.	.005	.260																	9
MBY-0-20 (A)	org.	.005	.405																	10
																				11
MBY- 500W - 0S	org.	.005	.290																	12
1	org.	.005	.330																	13
2		.005	.120																	14
3		.005	.130																	15
4		.005	.310																	16
5	org.	.005	.250																	17
6	org.	.005	.320																	18
7	org.	.005	.270																	19
8	org.	.005	.325																	20
9	org.	.005	.260																	21
10	org.	.005	.230																	22
11	org.	.005	.235																	23
12	org.	.005	.270																	24
13	org.	.005	.180																	25
14	org.	.005	.310																	26
15	org.	.005	.270																	27
16	org.	.005	.410																	28
17	org.	.005	.460																	29
18	org.	.005	.475																	30
19	org.	.005	.895																	31
MBY- 500W -20S	org.	.005	.855																	32
																				33
MBY -1000W - 0	org.	.005	.160																	34
1	org.	.005	.210																	35
2	org.	.005	.290																	36
3		.005	.090																	37
4	org.	.005	.175																	38
MBY-1000W - 5	org.	.005	.240																	39
																				40

All reports are the confidential property of clients
All results are in PPM.

DIGESTION:.....

DETERMINATION:.....

DATE SAMPLES RECEIVED Dec. 17, 1979

DATE REPORTS MAILED Jan 9, 1980

ASSAYER Dean Toye

DEAN TOYE, B.Sc.
CHIEF CHEMIST
CERTIFIED B.C. ASSAYER



To: Calabrigo & Associates

ACME ANALYTICAL LABORATORIES LTD.

Assaying & Trace Analysis

852 E. Hastings St., Vancouver, B. C. V6A 1R6

phone: 253 - 3158

File No. 0722

Type of Samples

Disposition

GEOCHEMICAL ASSAY CERTIFICATE

SAMPLE No.		Au	Hg																			
14	MBY-1000W	6	org.	.005	.310																1	
		7	org.	.005	.315																	2
		8		.005	.110																	3
		9		.005	.085																	4
		10	org.	.005	.430																	5
		11		.005	.175																	6
		12		.005	.210																	7
		13		.005	.120																	8
		14	org.	.005	.720																	9
		15		.005	.110																	10
		16		.005	.805																	11
		17		.005	.130																	12
		18	org.	.005	.860																	13
		19		.005	1.400																	14
	MBY-1000W	20		.005	.215																	15
																						16
	MBY-1500W	0	org.	.005	.125																	17
		1		.005	.160																	18
		2		.005	.145																	19
		3		.005	.140																	20
		4	org.	.005	.185																	21
		5	org.	.005	.195																	22
		6	org.	.005	.135																	23
		7		.005	.175																	24
		8	org.	.005	.185																	25
		9		.005	.090																	26
		10		.005	.150																	27
		11		.005	.065																	28
		12		.005	.050																	29
		13		.005	.050																	30
		14		.005	.100																	31
		15		.005	.070																	32
		16		.005	.175																	33
		16(A)		.005	.160																	34
		17		.005	.155																	35
		18		.005	.250																	36
		19		.005	.180																	37
	MBY-1500W	20		.005	.100																	38
																						39
																						40

All reports are the confidential property of clients
All results are in PPM.

DIGESTION:.....

DETERMINATION:.....

DATE SAMPLES RECEIVED Dec. 17, 1979

DATE REPORTS MAILED Jan. 8, 1980

ASSAYER *Dean Toye*

DEAN TOYE, B.Sc.
CHIEF CHEMIST
CERTIFIED B.C. ASSAYER



To: Calabrigo & Associates

ACME ANALYTICAL LABORATORIES LTD.

Assaying & Trace Analysis

852 E. Hastings St., Vancouver, B. C. V6A 1R6

phone: 253 - 3158

File No. 0722

Type of Samples

Disposition

GEOCHEMICAL ASSAY CERTIFICATE

15

SAMPLE No.		Au	Hg																	
MBY - 500E	OS	.005	.205																	1
	1	.005	.260																	2
	2 org.	.005	.390																	3
	3 org.	.005	.170																	4
	4	.005	.220																	5
	5 org.	.005	.155																	6
	6 org.	.005	.215																	7
	7 org.	.005	.180																	8
	8	.005	.115																	9
	9	.005	.195																	10
MBY- 500E	10S org.	.005	.100																	11
																				12
MBY -1000E	OS	.005	.250																	13
	1	.010	.190																	14
	2	.005	.185																	15
	3 org.	.005	.180																	16
	4 org.	.005	.230																	17
	5 org.	.005	.225																	18
	6 org.	.005	.215																	19
	7 org.	.005	.170																	20
	8 org.	.005	.210																	21
	9 org.	.005	.225																	22
	10 org.	.005	.200																	23
	11 org.	.005	.215																	24
	12 org.	.005	.160																	25
	13 org.	.005	.190																	26
	14 org.	.010	.135																	27
	15 org.	.005	.160																	28
	16 org.	.005	.150																	29
	17 org.	.005	.130																	30
	18 org.	.005	.250																	31
	19 org.	.005	.185																	32
MBY -1000E	20S	.005	.190																	33
MBY -2000E	ON	.005	.125																	34
MBY -2000E	1N org.	.005	.150																	35
	2	.010	.175																	36
	3	.010	.140																	37
	4 org.	.005	.105																	38
MBY -2000E	5N org.	.005	.060																	39
																				40

All reports are the confidential property of clients
All results are in PPM.

DIGESTION:.....

DETERMINATION:.....

DATE SAMPLES RECEIVED Dec. 17, 1979

DATE REPORTS MAILED Jan. 9, 1980

ASSAYER Dean Toye

DEAN TOYE, B.Sc.
CHIEF CHEMIST
CERTIFIED B.C. ASSAYER



To: Calabrigo & Associates

ACME ANALYTICAL LABORATORIES LTD.

Assaying & Trace Analysis

852 E. Hastings St., Vancouver, B. C. V6A 1R6

phone: 253 - 3158

0722

File No. _____

Type of Samples _____

Disposition _____

GEOCHEMICAL ASSAY CERTIFICATE

16

SAMPLE No.		Au	Hg																	
MBY-2000E 6N	org.	.005	.090																	1
	7	.005	.105																	2
	8	org.	.245																	3
	9	.005	.150																	4
	10	.005	.150																	5
	11	org.	.155																	6
	12	org.	.245																	7
	13	.005	.170																	8
	14	.005	.135																	9
	15	org.	.210																	10
	16	.005	.180																	11
	17	.005	.160																	12
	18	.005	.140																	13
	19	.005	.110																	14
MBY-2000E 20N		.005	.140																	15
																				16
MBY-2500E 0		.005	.180																	17
	1	.005	.190																	18
	2	org.	.230																	19
	3	.005	.295																	20
	4	org.	.335																	21
	5	org.	.350																	22
	6	org.	.205																	23
	7	org.	.225																	24
	8	org.	.330																	25
	9	.005	.260																	26
MBY-2500E 10	org.	.005	.370																	27
																				28
ON 2.5E+5ED		.005	.135																	29
																				30
																				31
																				32
																				33
																				34
																				35
																				36
																				37
																				38
																				39
																				40

All reports are the confidential property of clients
All results are in PPM.

DIGESTION:.....

DETERMINATION:.....

DATE SAMPLES RECEIVED Dec. 17, 1979

DATE REPORTS MAILED Jan. 9, 1980

ASSAYER Dean Toye

DEAN TOYE, B.Sc.
CHIEF CHEMIST
CERTIFIED B.C. ASSAYER

APPENDIX 'D'

Certificate

APPENDIX 'D'

CERTIFICATE:

I, Robert Ross Dion, of 5446 - 7B Avenue, Delta, British Columbia,
HEREBY CERTIFY THAT:

1. I attended the University of B. C., Department of Applied Science, and completed all the requirements of the Bachelor of Applied Science, Geological Engineering, except the Bachelor's Thesis, in 1961.
2. I have been employed in various responsible positions in the mining industry during the period 1961 to the present (except for the period 1965 to 1970 inclusive, during which I was employed as a securities salesman) some of which are as follows:
 - Spring 1962 to Spring 1963: Mine Surveyor & Mining Engineer, Jersey Mine, Canadian Exploration Ltd., Salmo, B. C.
 - Spring 1963 to Fall 1964: Resident Geologist & Mine Engineer, Peso Silver Mines Ltd., Mayo, Y. T.
 - Fall 1964 to Fall 1965: Engaged in independent prospecting, B. C. and Y. T.
 - Fall 1970 to 1976: Self-employed, Geologist, Prospector, and Contract Exploration services throughout B. C., Y. T. and N.W. U. S. A.
 - 1977 and 1978: Resident Geologist, Interior B. C., Abacus Industries Ltd., Vancouver, B. C.
 - 1979 to present: Self-employed, Geologist and Prospector.
3. I have no interest, direct or indirect, in the subject properties.



Robert Ross Dion,
Delta, B. C.

February 19, 1980.

APPENDIX "E"

Statement of Costs

APPENDIX "E1"

Contractor's Cost Analysis
(from the books of account of Team Mineral Services Inc.)

PART I Payroll Analysis (September - December, 1979 inclusive)

<u>Employee</u>	<u>Gross Wages (Days Worked)</u>				<u>Totals</u>
	<u>September</u>	<u>October</u>	<u>November</u>	<u>December</u>	
Dion, R.	\$1500(10)	\$1500(10)	\$1500(10)	\$1500(10)	\$6000(40)
Hunchuk, D.	2000(20)	1500(15)	2000(20)	2000(20)	7500(75)
MacRae, B.	1200(20)	900(15)	1200(20)	1800(30)	5100(85)
Kolesar, F.		1100(20)	1200(20)	780(13)	3080(53)
Degontiere, R.		500(10)	1200(20)	780(13)	2480(43)
Meyerhoff, M.		500(10)	1200(20)	780(13)	2480(43)
Kirkwood, W.		500(10)	1200(20)	780(13)	2480(43)
Neufeld, T.		500(10)	1200(20)		1700(30)
Montrose, A.		600(10)	600(10)		1200(20)
Croft, T.		600(10)	1200(20)		1800(30)
Harper, S.				1000(20)	<u>1000(20)</u>
					\$34820(482)

PART II Total Cost Analysis

Payroll (as above)	\$34,820
Holiday pay, U.I.C., CPP, WCB @ 20%	<u>6,964</u>
Sub-total	41,784
Room & Board @ \$40/man/day	19,280
Air fares and excess baggage	3,940
Fuel, Insurance, Engineering supplies and miscellaneous costs (estimated)	4,600
Truck Rentals	8,400
Typing, Drafting and Maps	<u>1,000</u>
	<u>\$79,004</u>



APPENDIX "E2"

Contract Analysis

<u>Employer</u>	<u>Claim Group</u>	<u>No. of Units</u>	<u>Contract Amount</u>	<u>Assays paid by Employer</u>	<u>Other Costs Paid by Employer *</u>	<u>Total Assessable Work</u>
Calabrigo	Bridge	110	\$ 8,689.70	\$ 2,310.30	\$ 100.00 ⁽³⁾	\$ 11,100.00
Ashcroft	Golden	76	17,000.00	4,279.05	2,000.00 ⁽³⁾	23,279.05
Calabrigo	MB	240	20,131.80	3,868.20	100.00 ⁽³⁾	24,100.00
Ventura	MB	80	6,500.00	1,238.40	1,000.00 ⁽³⁾	8,738.40
R. Dion	Easy	20	1,595.00	405.00	50.00 ⁽³⁾	2,050.00
Alexander	DH	40	3,254.80	745.20	100.00 ⁽³⁾	4,050.00
Black Diamond	FLY	40	3,000.00	763.20	567.00 ⁽²⁾	4,330.20
Southern Union	FLY 6	20	1,625.00		400.00 ⁽¹⁾	2,025.00
Knobby Lake	Dip & Corner	35	3,000.00	542.16		3,542.16
Foremost Energy	Survey	120	9,480.00	2,520.00	100.00 ⁽³⁾	12,100.00
R. Dion	(GCS, GCN)	79	<u>4,740.00</u>	<u> </u>	<u> </u>	<u>4,740.00</u>
	(YAKI-3)					
	(BET,)					
	(GOLDBIT)					
			<u>\$79,016.30</u>	<u>\$16,671.51</u>	<u>\$4,367.00</u>	<u>\$100,054.81</u>

- * (1) Cash in Lieu
 (2) Helicopters Costs, or
 (3) Engineering Reports (estimated)

NOTE: The Contractor's Cost Figure \$79,004.00 (from Appendix A) = 99.98% of total of contract prices above.

Therefore, for all practical purposes, the pro-rated cost of each contract performed is equal to the contract price paid by each employer to the contractor.

The Contracts were originally accepted on terms of cost plus 25% but field conditions and resulting performance were so poor that the contracts resulted in "break-even" operations.



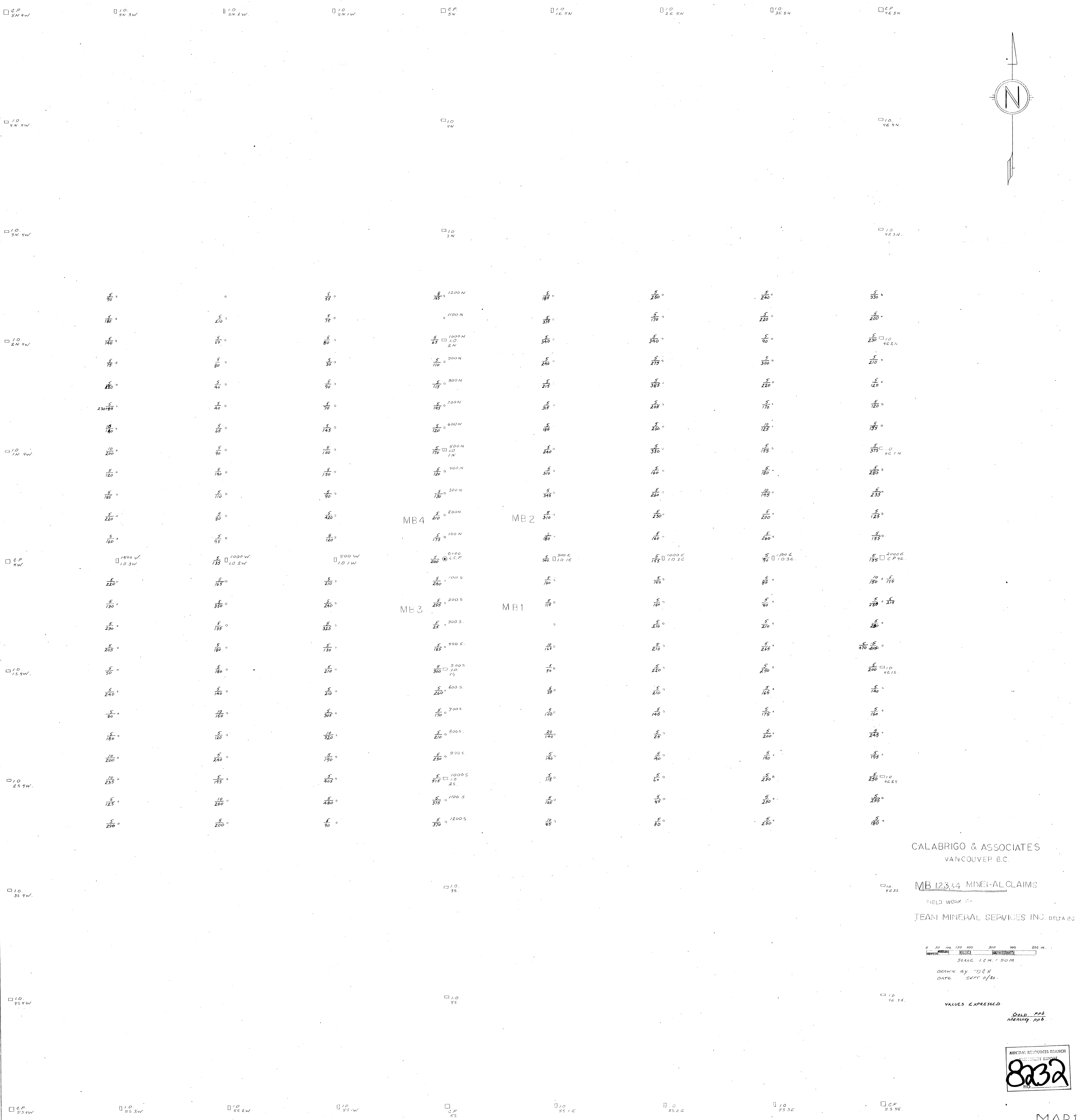
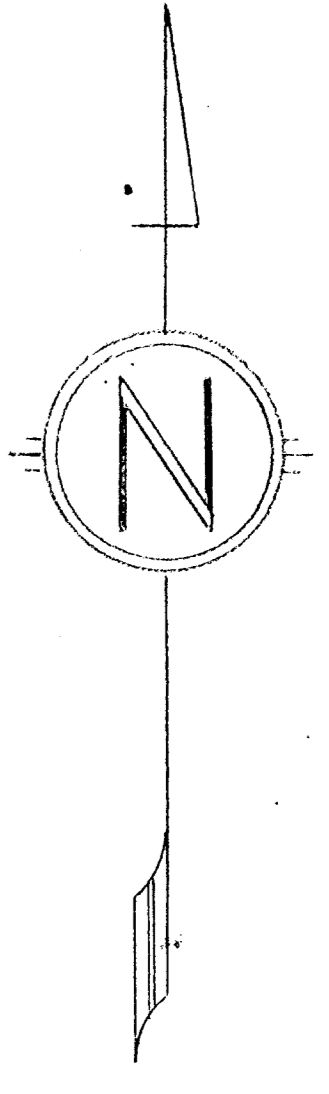

CALABRIGO & ASSOCIATES
VANCOUVER B.C.

MB 123 & 4 MINERAL CLAIMS

FIELD WORK BY
TEAM MINERAL SERVICES INC. DELTA B.C.

0 50 100 150 200 250 300 350 400 450 500 m
SCALE 1 C.M. = 50 M

DRAWN BY JDE/H
DATE: SEPT 11/80.

VALUES EXPRESSED
Gold - PPM
Mercury - PPM

MINERAL RESOURCES BRANCH
8032

10 4N 3W 125' □ 1500 W	10 4N 2W 180' □ 1000 W	10 4N 1W 290' □ 500 W	10 C.P. 405 4N □ 0-00	10 4N 1E 205' □ 500 E	10 4N 2E 250' □ 1000 E	10 4N 3E □ 1500 E	10 4N 4E 125' □ 2000 E	C.P. 5E 4N 180' □ 2500 E
5/160	5/210	5/330	5/390	5/260	5/170		5/150	5/190
5/145	5/290	5/120	5/290	5/390	5/185		5/175	5/130
5/140	5/90	5/130	5/410	5/170	5/180		5/140	5/245
5/185	5/175	5/310	5/760	5/220	5/230		5/105	5/335
5/195	5/240	5/250	5 10 435 3N □ 500 S	5/155	5/225		5/60	5 10 350 5E 3N □
5/135	5/370	5/320	5/200	5/275	5/275		5/90	5/205
5/175	5/375	5/270	5/490	5/180	5/170		5/105	5/225
5/185	5/110	5/325	5/390	5/115	5/270		5/245	5/330
5/90	5/85	5/260	5 00 345 2E 255	5/195	5/225		5/150	5/260
5/150	5/430	5/230	5 10 340 2N □ 1000	5/100	5/200		5/150	5 10 370 5E 2N □
5/65	5/175	5/235	5/370	5/275	5/275		5/155	
5/50	5/210	5/270	5/375	5/160	5/160		5/245	
5/50	5/120	5/180	5/405	5/190	5/190		5/170	
5/100	5/120	5/370		5/135	5/135		5/135	
5/70	5/110	5/270	5 10 300 1N □ 1500 S	5/160	5/160		5/210	5 10 5E 1N □
5/175	5/805	5/710	5/365	5/150	5/150		5/180	
5/155	5/130	5/460	5/350	5/130	5/130		5/160	
5/250	5/860	5/475	5/405	5/250	5/250		5/140	
5/180	5/1400	5/895	5/335	5/185	5/185		5/110	
5 10 10 3W	5 10 10 2W	5 10 10 1W	5 620 2000 S L.C.P.	5 10 10 1E	5 10 10 2E	5 10 10 3E	5 740 10 4E	5 10 C.P. 5E

MB 12

MB 11

MB 14

MB 13

□ 10 15

□ 10 5E 15

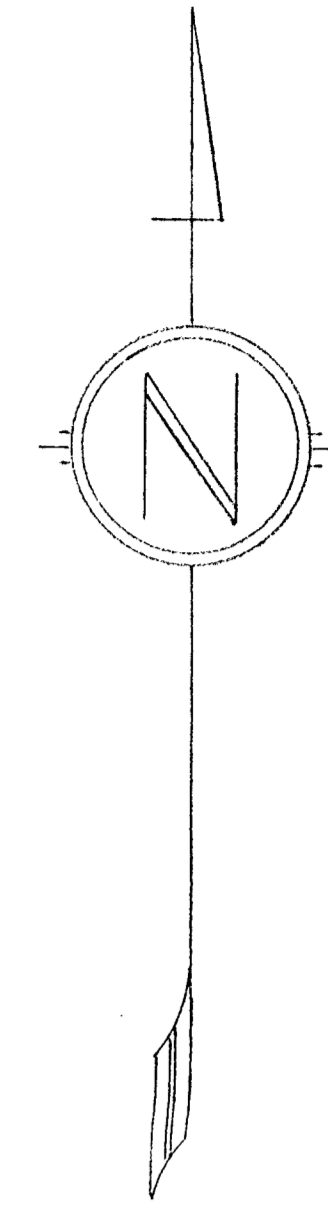

8232

CALABRIGO & ASSOCIATES

VANCOUVER B.C.

MB 11, 12, 13 & 14 MINERAL CLAIMS

BY TEAM MINERAL SERVICES INC.

DELTA B.C.

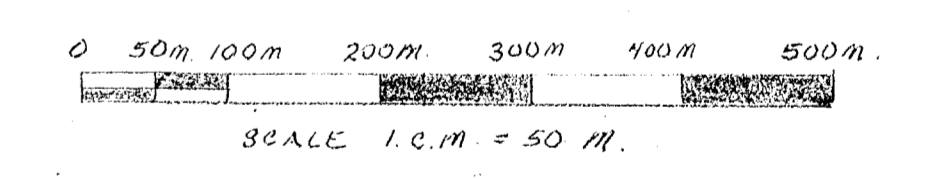

DRAWN BY D.C.H.
DATE: SEPT 8/80.

VALUES EXPRESSED:
GOLD PPB
MERCURY PPB

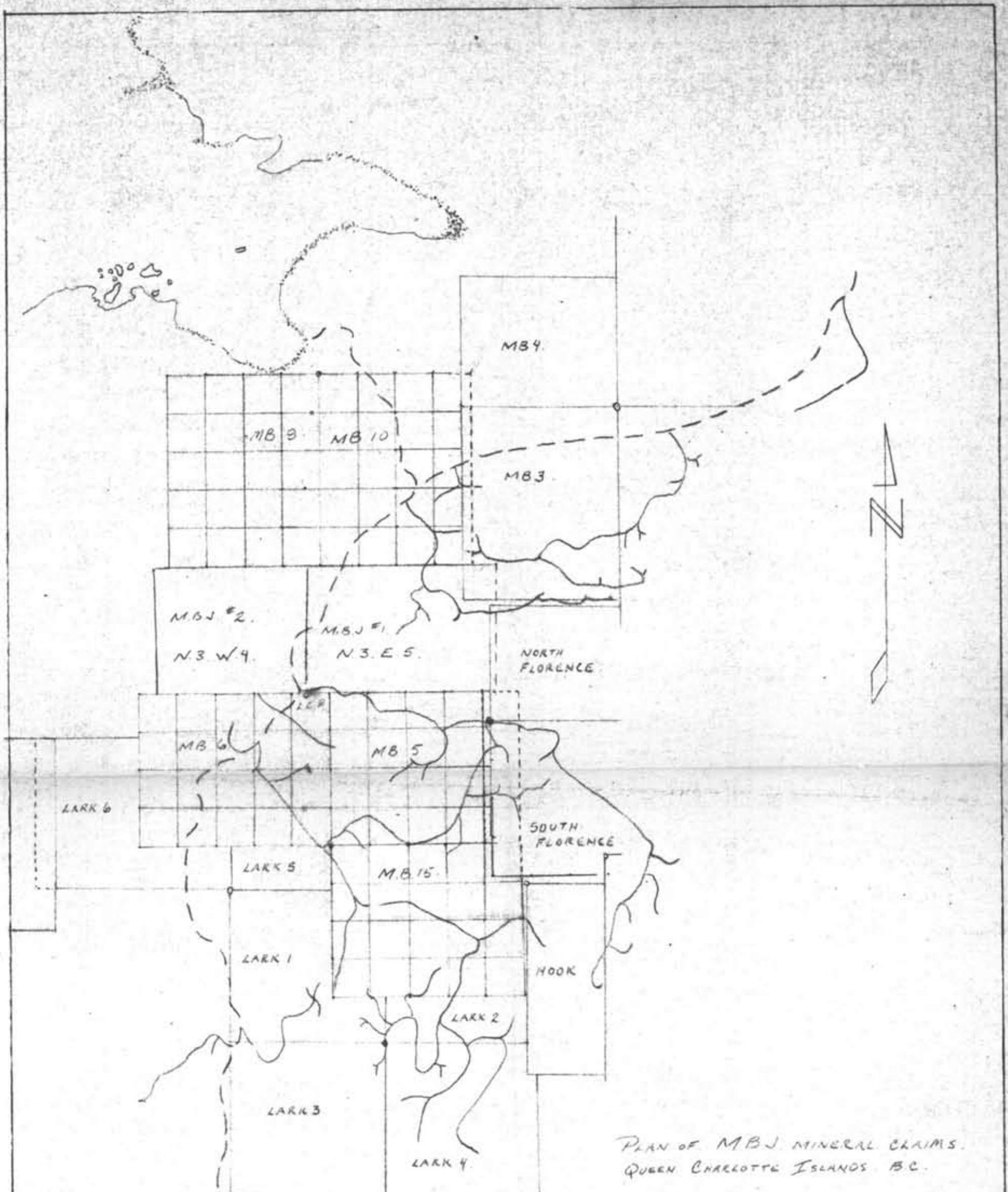

PLAN OF M.B.J. MINERAL CLAIMS.
 QUEEN CHARLOTTE ISLANDS B.C.
 BY TEAM MINERAL SERVICES, INC.
 DELTA B.C.

FOR
 VENTORA RESOURCES
 VANCOUVER B.C.

SCALE 1 C.M. = 500 M.

DRAWN BY D.E.H.
 DATE SEPT 80
 103 F 9. E & W.

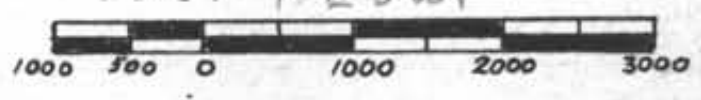

MINERAL RESOURCES BRANCH
 APPRAISAL REPORT
8232
 NO.

MAP 3

1.0
4W
1N

MB 7

1.0
1N

MB 8

1.0
1N 4E

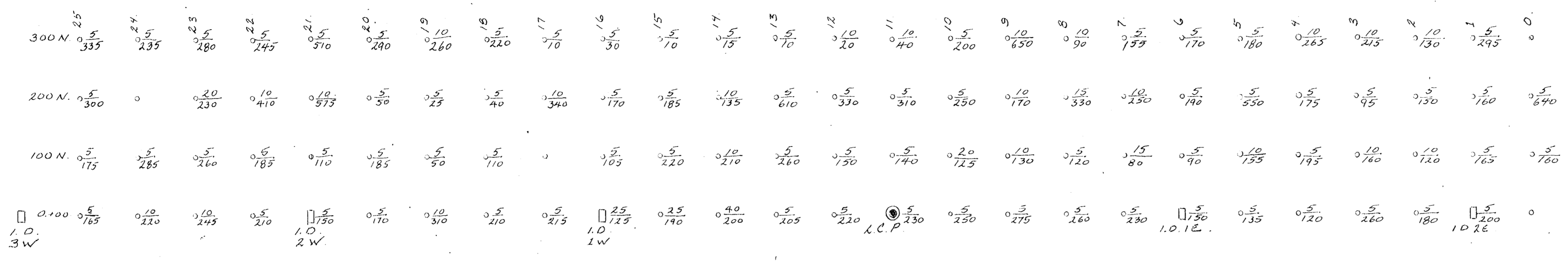

C.P. 4W

1.0
3W

1.0
3E

C.P.
4E

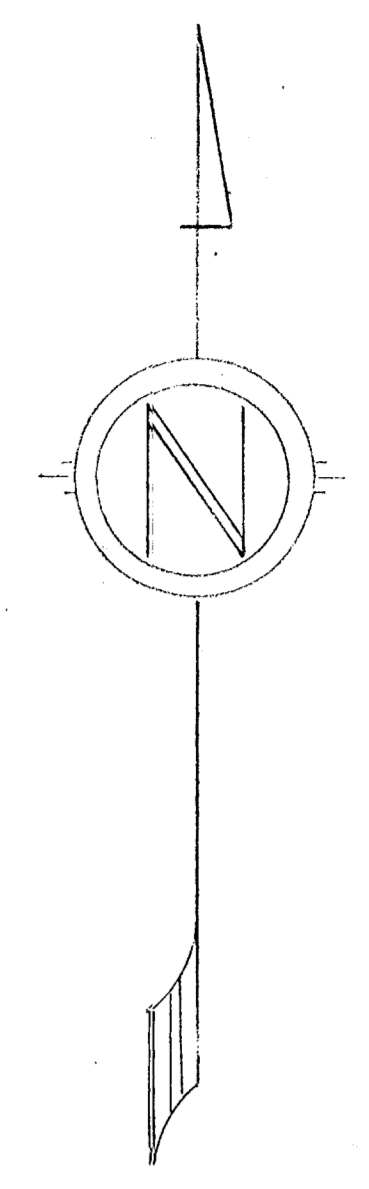

M.B. 16

1.0
1S

MB 10

1.0
1S 4E

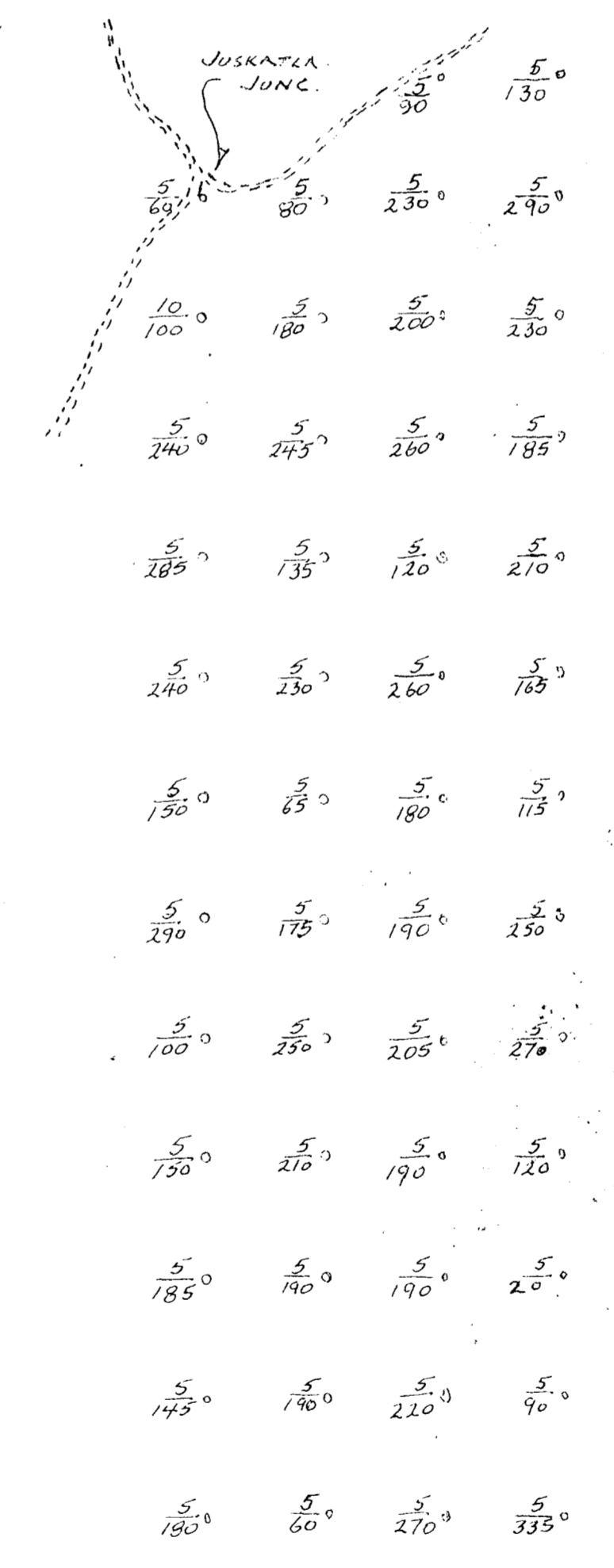

1.0
2S

1.0
2S 4E

1.0
3S

1.0
3S 4E

1.0
4S

1.0
4S 4E

C.P.
5S

1.0
5S 1E

1.0
5S 2E

1.0
5S 3E

C.P.
5S 4E

1.0 4S

CALABRIGO & ASSOCIATES
VANCOUVER B.C.

MB 7, 8, 10 & 16 MINERAL CLAIMS

BY TEAM MINERAL SERVICES INC.
DELTA B.C.

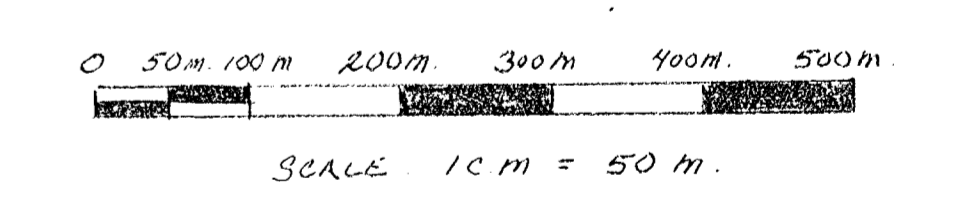

DRAWN BY D.C.H.
DATE SEPT 11/80.

VALUES EXPRESSED
GOLD PPB
MERCURY PPB

MINERAL SERVICES INC.
8232
NO.

MAP 4