

0500-1000  
80-728-A 8411

REPORT ON THE  
GEOCHEMICAL SURVEY CONDUCTED  
ON THE RABBITT PROPERTY  
(BOULDERS 1 AND 2 AND RABBITTS 1 TO 4 CLAIMS)

By:  
L.E. Thorstad

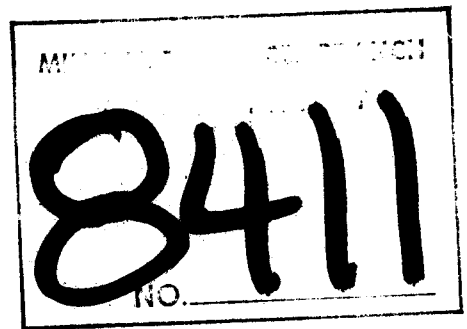

PART  
2 of 2

Latitude: 49° 33' to 49° 37' 30'  
Longitude: 120° 47' 30" to 120° 50'  
NTS: 92H/10  
Owner: Harold J. Adams  
Operators: Ventures West Minerals Ltd.  
Kenam Resources Ltd.  
Consultant: L.E. Thorstad  
Submitted: October 2, 1980; Vancouver, B.C.

TABLE OF CONTENTS

	<u>Page</u>
INTRODUCTION	1
LOCATION AND ACCESS	1
GEOCHEMISTRY PROGRAM	1
PROGRAM RESULTS	1
SUMMARY	2
STATEMENT OF COSTS	3
CERTIFICATION	4

FIGURES

FIGURE 1 - LOCATION MAP OF RABBITT PROPERTY	Follows page 1
FIGURE 2 - LOCATION MAP OF RABBITT AND BOULDER CLAIMS AND GEOCHEMICAL SURVEY GRID	Follows Figure 1

ENCLOSURES

GEOCHEMICAL RESULTS - Pb

GEOCHEMICAL RESULTS - Cu

GEOCHEMICAL RESULTS - Zn

8411  
Part 2 of 2

## INTRODUCTION

The Rabbitt Property, held jointly by Ventures West Minerals Ltd. and Kenam Resources Ltd., is comprised of 6 claims including "BOULDER 1 AND 2" and "RABBITT 1 TO 4", and, 10 crown grants (Figure 1). In December of 1979 Ventures West Minerals Ltd. carried out a geochemistry program on the property to determine the effectiveness of geochemistry in detecting and outlining massive sulphide mineralization and to extend the massive sulphide horizon along strike. A ground magnetometer survey was begun in conjunction with the geochemical survey but was abandoned due to lack of magnetic response over sulphide mineralization.

## LOCATION AND ACCESS

The Rabbitt Property, located northwest of Tulameen, B.C., occupies the uplands area immediately west of Otter Creek Valley. The property is accessed by four-wheel drive logging roads.

## GEOCHEMISTRY PROGRAM

An orientation soil geochemistry program was carried out by Ventures West Minerals Ltd. over the Rabbitt Property in early December, 1979 to determine the effectiveness of geochemistry in delineating massive sulphide mineralization and to trace along strike extensions of mineralization. A total of 505 samples were collected from the B Horizon, where possible, and sampling was largely restricted to areas of known massive sulphide mineralization with some exploratory lines in areas where no sulphide mineralization is exposed. Samples were collected at 30 metre intervals along east-west lines spaced at 200 metre intervals along a north-south baseline. The geochemistry grid is shown on Figure 2.

Soil samples were analyzed for Cu, Pb and Zn by Chemex Labs of North Vancouver using a strong acid extraction. Anomalous values were found for the three elements and threshold values of 50 ppm, 20 ppm and 250 ppm, respectively were determined.

## PROGRAM RESULTS

Soil geochemistry proved successful in defining anomalous zones over massive sulphide mineralization and projected extensions of the mineralization. Two specific types of geochemical anomalies are apparent; the first of which is dominantly for Cu and Pb and less commonly Zn are coincident with known massive sulphide

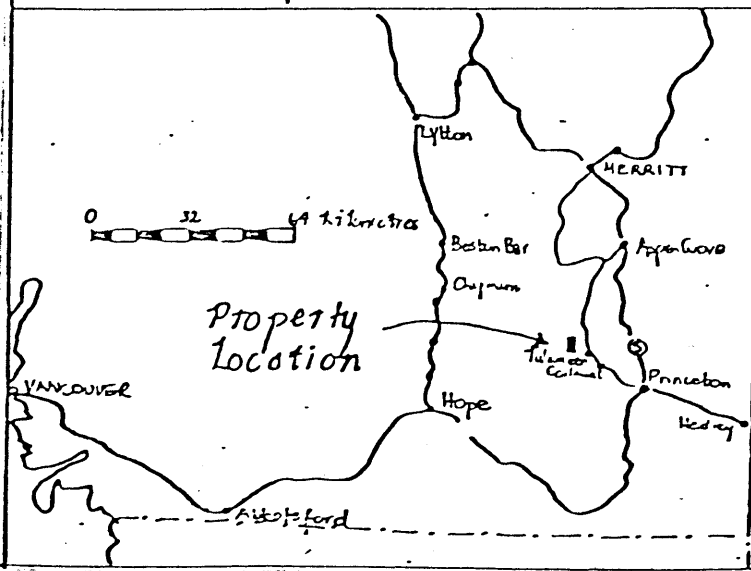
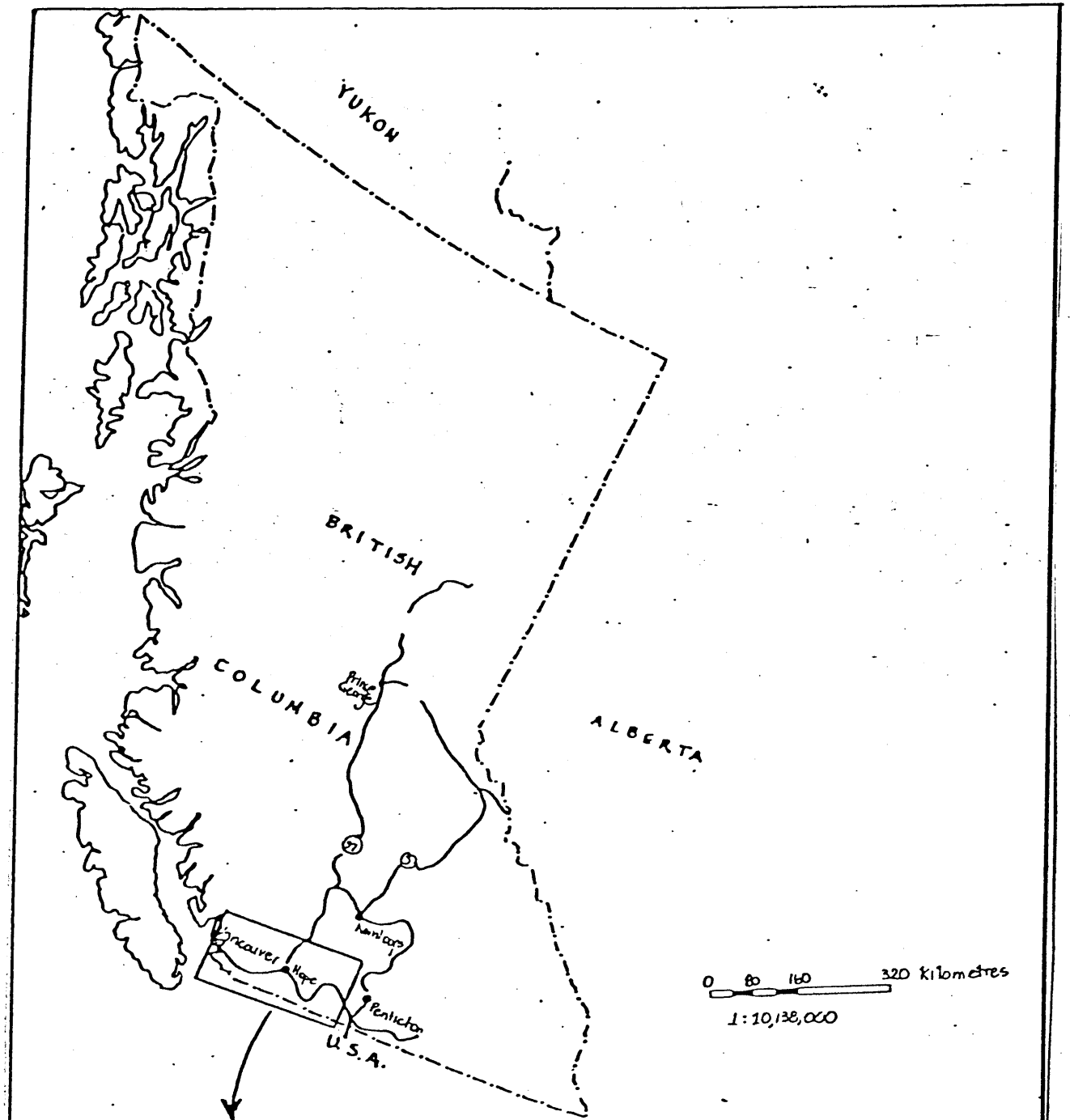

K. L. Daughtry and Associates  
 Kenam Resources Ltd and  
 Ventures West Minerals Ltd.

### Rabbit Property- Location Map

Drawn by: I. E. Thorstad  
 April 22, 1980. Figure 1

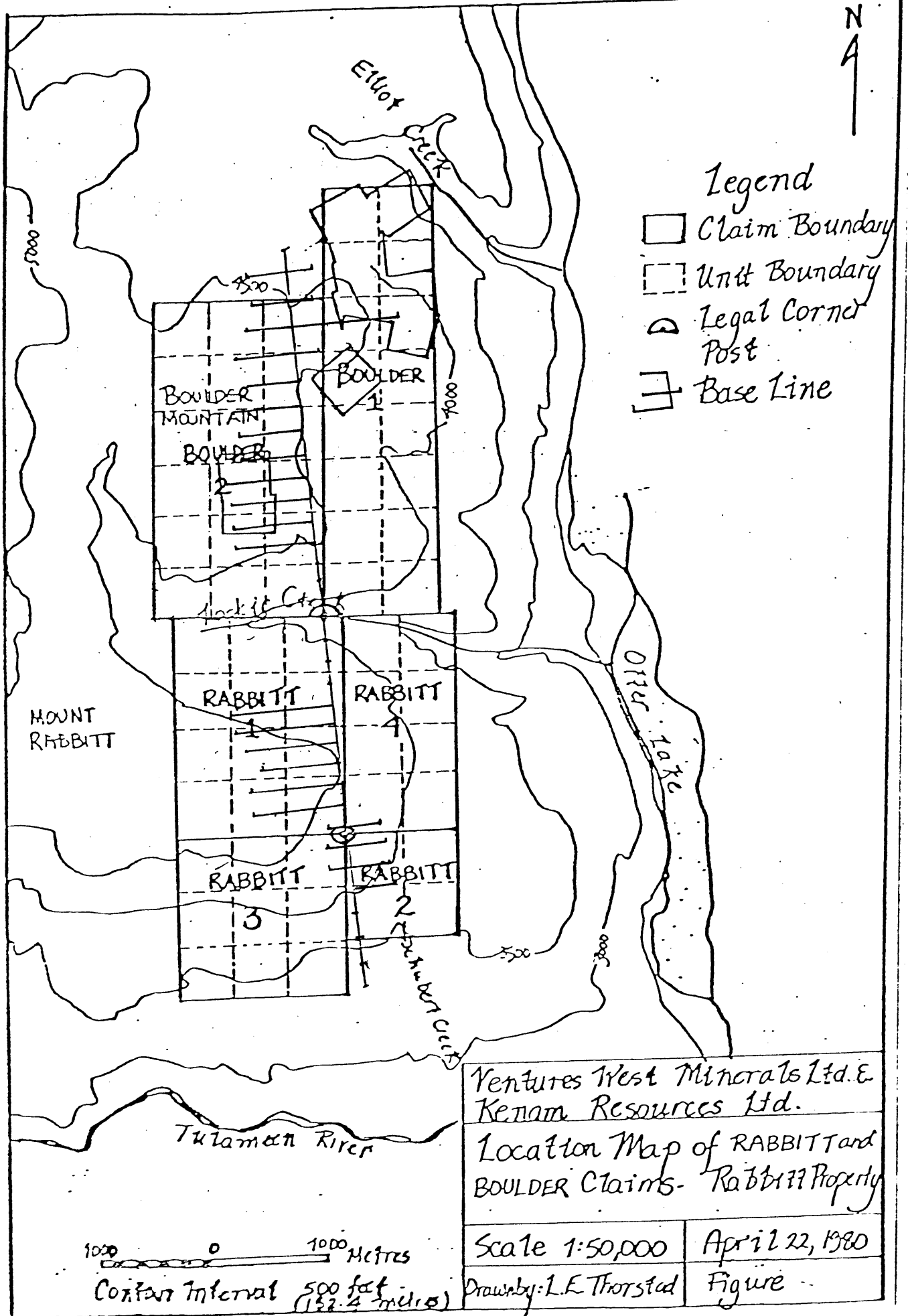

- Legend
- Claim Boundary
  - Unit Boundary
  - Legal Corner Post
  - Base Line

Ventures West Minerals Ltd. & Kenam Resources Ltd.

Location Map of RABBIT and BOULDER Claims - Rabbit Property

Scale 1:50,000      April 22, 1980

Drawn by: L.E. Thorstad      Figure

1000 0 1000 Metres  
 Contour Interval 500 feet (152.4 metres)

mineralization and roughly coincident with projected areas of potential mineralization. The second type of anomaly are Pb and Zn anomalies which are distinct in their lack of a coincident Cu anomaly, their linear trend (i.e. there is no apparent topographic effect and their easterly position with respect to Cu-Pb±Zn anomalies. These Pb-Zn anomalies appear specifically related to the system of mineralized veins exposed at the Cousin Jack Showings. Previous geochemistry defined similar coincident Pb and Zn anomalies (Mitchel, 1971).

#### SUMMARY

A preliminary soil geochemistry program on the Rabbitt Property outlines two types of anomalies: Cu-Pb±Zn and Pb-Zn associated with massive sulphide and galena-sphalerite-quartz veins respectively. A magnetometer has not proven effective in outlining massive sulphide mineralization.

STATEMENT OF COSTS

Geochemical Survey

Professional Services:		
1 man day @ \$200/day	\$ 200.00	
Labour:		
11 man days @ \$90/day	990.00	
11 man days @ \$80/day	880.00	
Vehicle Rental:		
13 days @ \$22.40/day	292.50	
4 days @ \$20.00/day	80.00	
Vehicle Distance:		
1542 km @ 15¢/km	231.30	
430 km @ 12¢/km	51.60	
Gas and Oil:	187.30	
Field Supplies:	148.20	
Magnetometer Rental:	80.00	
Shipping:	3.25	
Food and Lodging:	825.00	
Office and Telephone	<u>287.59</u>	\$4,256.74

Geochemical  
Geochemical Analysis

Chemex Labs:		
Analyses for Cu, Pb, Zn - 505 samples		1,290.24

Geochemical Survey Report

Professional Services:		
6 days @ \$115/day	\$ 690.00	
Drafting:		
2 days @ \$55/day	110.00	
Photocopies and Secretarial Services	<u>80.00</u>	880.00

TOTAL COSTS \$6,426.98

CERTIFICATION

I, Linda E. Thorstad, do hereby certify that:

1. I am a geologist residing in British Columbia at 3529 West 3rd Avenue, Vancouver, B.C.
2. I attended Vancouver City College for one year and the University of British Columbia for five years.
3. I have had seven summers' experience in both regional and detailed mapping, and mineral exploration in Northern British Columbia, the Northwest Territories and the United States.
4. My report, dated October 3, 1980, is based on the results of the geochemical survey conducted by Ventures West Minerals Ltd. in December, 1979.
5. I have no personal interest, direct or indirect, in the property covered by the submitted report.

Respectfully submitted,

Linda E. Thorstad

October 2, 1980,  
Vancouver, B.C.



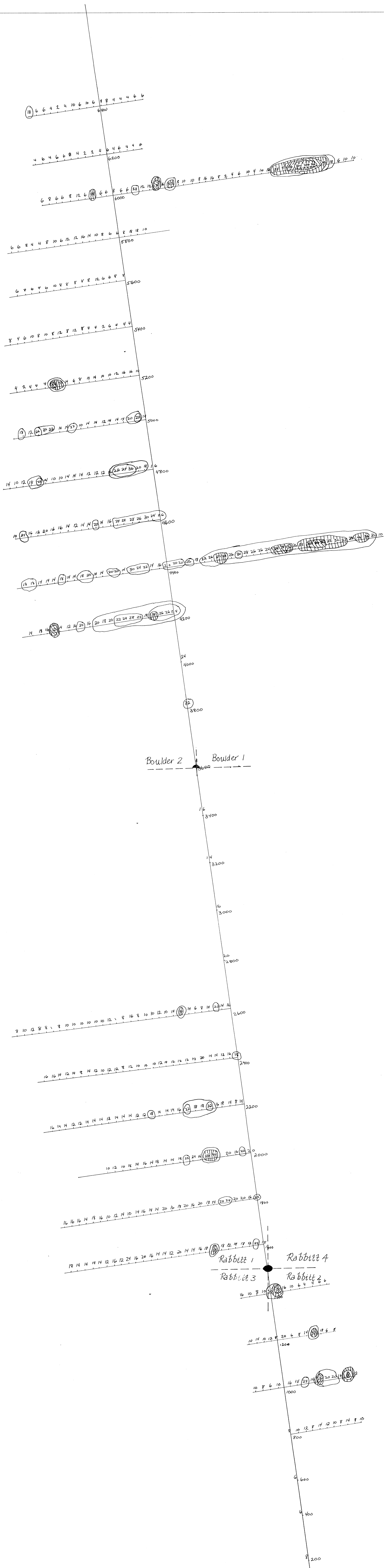

Key	
⊗	greater than 140 ppm Pb
⊘	90 to 140 ppm Pb
⊙	51 to 90 ppm Pb
⊚	31 to 50 ppm Pb
○	21 to 30 ppm Pb
—	Legal Corner Post
- - -	Claim Boundary and Claim Name

ANNUAL REVENUES BRANCH  
 8411  
 PART  
 2 of 2

Ventures West Minerals Ltd.	
Ventures West Minerals Ltd. and Kenam Resources Ltd.	
Geochemical Results: Pb ppm	
Rabbit Property: Rabbit and Boulder Claim Groups	
Sensitization Mining Division 92H 10 BC	
Scale 1:5,000	October 1, 1980
Drawn by: I.E. Thorstad	Figure 1A



Key

	greater than 300 ppm Cu
	151 to 300 ppm Cu
	121 to 150 ppm Cu
	91 to 120 ppm Cu
	61 to 90 ppm Cu
	Legal Corner Post
	Claim Boundary and Claim Name

8411  
PART  
2 of 2

Ventures West Minerals Ltd.	
Ventures West Minerals Ltd and Kenam Resources Ltd	
Geochemical Results: Cu ppm Rabbit Properties Rabbit and Boulder Claim Groups Semikameen Mining Division 82410 BC	
Scale 1:5,000	October 1, 1980
Drawn by: L.E. Thorstad	Figure 1B

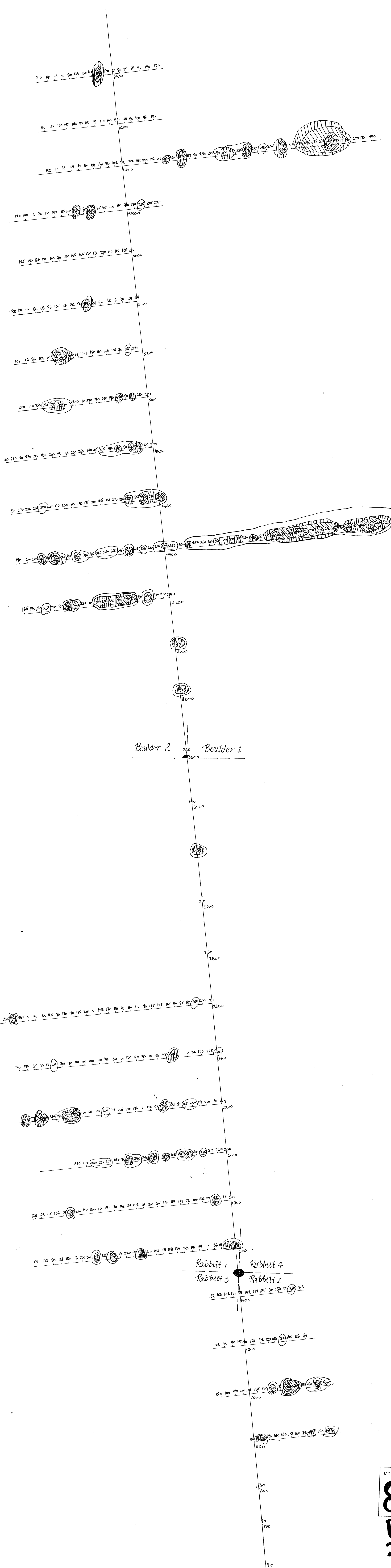

Key

○	greater than 1000 ppm Zn
○	700 to 1000 ppm Zn
○	400 to 700 ppm Zn
○	300 to 400 ppm Zn
○	>250 ppm Zn
—	Legal Corner Post
—	Claim Boundary and Claim Name

8411  
PART  
2 of 2

Ventures West Minerals Ltd.	
Ventures West Minerals Ltd. and Kenam Resources Ltd.	
Geochemical Results: Zn ppm	
Rabbit Property, Rabbit and Boulder Claim Groups	
Semi-Kamien Mining Division 82H 10 BC	
Scale 1:5,000	October 1, 1990
Drawn by I.E. Thorstad	Figure 1c