

80-#1042-#8701

SOIL GEOCHEMISTRY
TIGER CLAIM
AINSWORTH, SLOCAN MINING DIVISION, B. C.
NTS 82F/10W
LATITUDE 49°45' LONGITUDE 116°56'

ARCTEX ENGINEERING SERVICES

L. B. GOLDSMITH, P.ENG.
CONSULTING GEOLOGIST
OWNER, OPERATOR, CONSULTANT, AUTHOR

DECEMBER, 1980

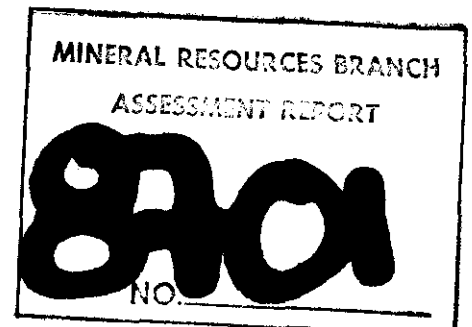

TABLE OF CONTENTS

SUMMARY.....	1
INTRODUCTION.....	2
GEOLOGY.....	2
LOCATION MAP, MAP 1.....	3
CLAIM MAP, MAP 2.....	4
SOIL GEOCHEMISTRY.....	5
CONCLUSIONS.....	6
RECOMMENDATIONS.....	6
COST ESTIMATE.....	6
ENGINEER'S CERTIFICATE.....	7
REFERENCES.....	8
ITEMIZED COST STATEMENT, 1980 PROGRAMME.....	9

APPENDIX: GEOCHEMICAL ANALYSES

ASSAYS

SURFACE GEOLOGY AND SOIL GEOCHEMISTRY, MAP 3

(Pocket inside back cover)

SOIL GEOCHEMISTRY
TIGER CLAIM
AINSWORTH, SLOCAN MINING DIVISION, B. C.

SUMMARY

A programme of soil geochemistry on the Tiger claim did not locate new targets for exploration. Assays of mineralization in picked samples from dumps are encouraging.

Underground mapping and sampling is recommended to investigate the possibility that the deposit is bedded rather than vein-type. Cost of the programme is estimated to be \$4400.00.

INTRODUCTION

The Tiger claim is located 2.0 km (1.2 miles) at azimuth 306° from the village of Ainsworth, B. C., near the top of the south slope of the valley of Cedar Creek. Access is by dirt roads from Ainsworth to approximately the centre of claim L 10675, and thence by foot for 700 metres at 345° . (The claim was acquired by the author of this report and his associates November 8, 1978.)

A total of 24 soil samples and 2 picked samples of dump material were analysed. Sampling was supervised and performed by the author. Approximately 1 km of grid was established.

Early history of the property is summarized in (1) and (3). Small shipments of ore have been made at various times, the last perhaps being in 1952. Dumps are overgrown with vegetation and certainly no mining activity has occurred in recent years. MINDEP computer files (4) list the production through 1978 as:

Tons	oz/ton Au	oz/ton Ag	% Pb	% Zn
46	0.042	7.75	19.3	10.7

GEOLOGY

The claim lies on a contact between limestone and schist. Attitudes of bedding trend northerly and dip 50°E (3) or moderately west (1). Foliation trends northwesterly with southerly dips. Mineralization is reported to occur at and near the limestone-schist contact in veins along small faults.

TIGER CLAIM

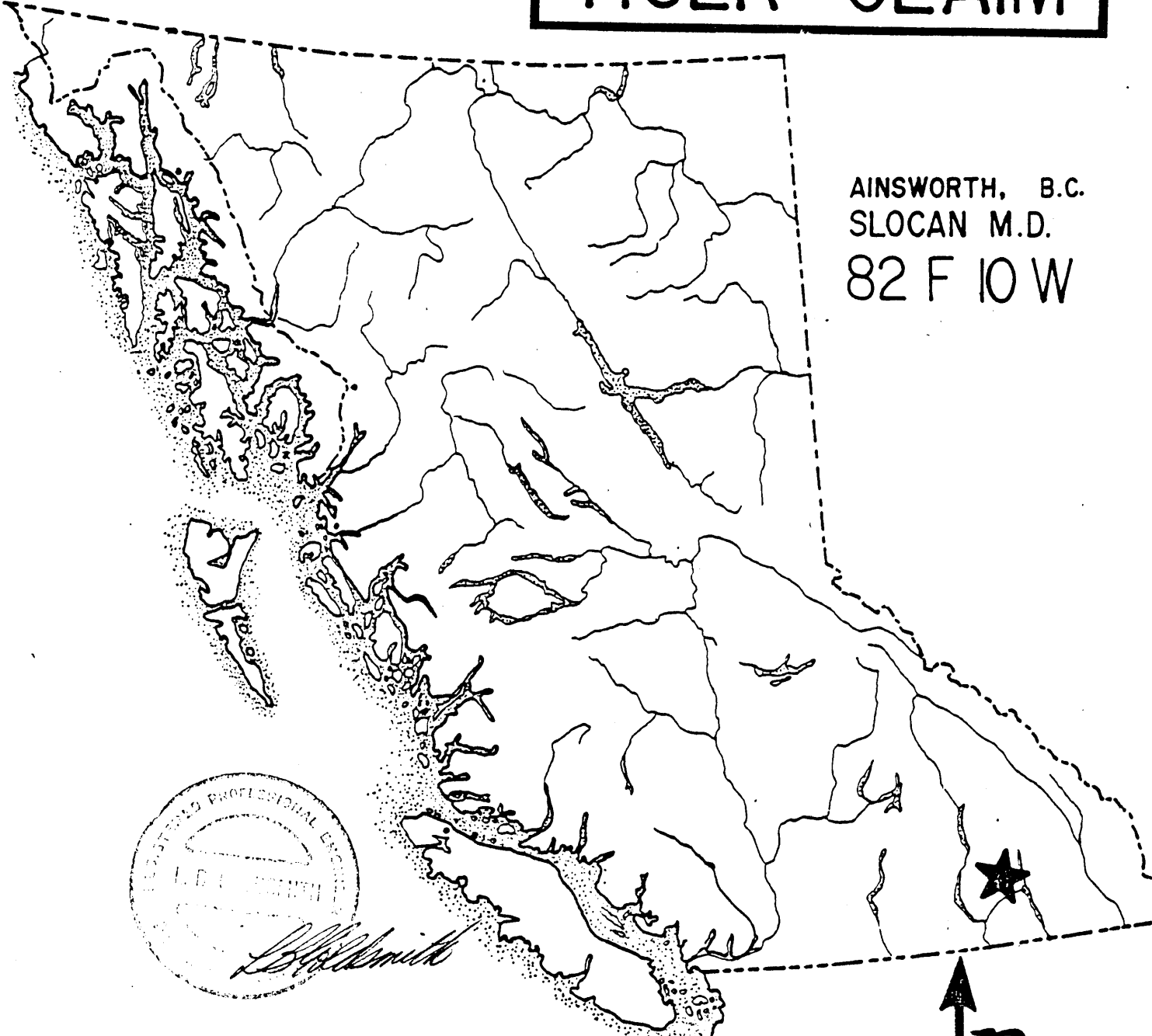

AINSWORTH, B.C.
SLOCAN M.D.
82 F 10 W



L. Bloomfield

Location map



11 IV

Cedar Cr.

117° 00'
49° 45'

TIGER L-88

GREEN ACRES FR. 530(11)

Ainsworth

Mile Pt.

Suspended Cables

LKIRK MOUNTAINS

KOKANEE RANGE

Coffee Cr.

576 L(2)
12405
12404
575(2)
12404

5822 U
362 (4)
NOWA
457 (8)
13815

RESERVED
MIN. PLACER
976 3820
12/12/53

MISSOURI
163 (8)

AV. 1
556(2)

1301
2308
12224

ALF
1027

7523
7524
7525
7526
7527
7528
7529
7530
7531
7532
7533
7534
7535
7536
7537
7538
7539
7540
7541
7542
7543
7544
7545
7546
7547
7548
7549
7550
7551
7552
7553
7554
7555
7556
7557
7558
7559
7560
7561
7562
7563
7564
7565
7566
7567
7568
7569
7570
7571
7572
7573
7574
7575
7576
7577
7578
7579
7580
7581
7582
7583
7584
7585
7586
7587
7588
7589
7590
7591
7592
7593
7594
7595
7596
7597
7598
7599
7600

10678

12640

2647

12649

AINSWORTH, B.C.
SLOCAN M.D.
82 F 10W

CLAIM MAP

0 500 1000 m.



TIGER CLAIM



ARCTEX ENGINEERING SERVICES OCTOBER 1980

MAP 2

An inspection by the author indicates that the geology is more complex than has been reported. Hand specimens of dump material are suggestive of bedded sulphides rather than vein fillings. Two samples of dump material were assayed for silver, lead, and zinc. Tig #1 displayed discontinuous bands and wisps of galena parallel to bedding (?) in limestone. Tig #2 contained finely disseminated galena in light-coloured siderite and sphalerite.

SOIL GEOCHEMISTRY

Base line for the grid was established at 125° with crosslines at 035°. Line spacing is 100 metres with sample intervals at 50 metres. Samples were taken with a narrow elongate spade at depths of 20 cm below the organic debris.

Analyses for silver and lead were performed by Loring Laboratories Ltd., 629 Beaverdam Road N.E., Calgary, Alberta. Samples are screened to -80 mesh and 500 mg of the fine fraction is weighed into test tubes. Aquaregia is added and the sample is digested in a water bath at 100°C for three hours. Test tubes are then bulked to the 10 ml level, mixed, and allowed to settle overnight. The samples are then put through atomic absorption, with appropriate standards, and the results reported in parts per million.

One sample at 00, 1N contains an anomalous quantity of lead. This location is near the old workings. Otherwise no new mineralized areas were suggested from soil geochemistry.

CONCLUSIONS

Soil geochemistry did not expand the potential mineralized horizon on the property. Values obtained in assays of dump material are encouraging in the specimens at TIG-1, particularly because bedded sulphides are indicated. Thence the possibility of a larger-tonnage deposit than a vein-type or replacement on fractures is present.

RECOMMENDATIONS

Geological mapping and sampling of the underground workings (which appear to be in good condition) is required to evaluate the suggestion of strataform mineralization.

COST ESTIMATE

Geological mapping, sampling	\$2,000.00
Analyses	500.00
Vehicle, supplies, room, board	500.00
Engineering, supervision	300.00
Reporting	700.00
	<u>\$4,000.00</u>
Contingencies @ 10%	400.00
	<u>\$4,400.00</u>
TOTAL	\$4,400.00

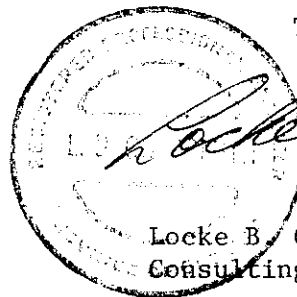

Locke B. Goldsmith, P. Eng.
Consulting Geologist

Vancouver, B. C.
December 1, 1980

ENGINEER'S CERTIFICATE

LOCKE B. GOLDSMITH

1. I, Locke B. Goldsmith, am a Registered Professional Engineer in the Province of Ontario and a Registered Professional Geologist in the State of Oregon. My address is 301 - 1855 Balsam Street, Vancouver, B. C.
2. I have a B.Sc. (Honours) degree in Geology from Michigan Technological University and have done postgraduate study at Michigan Tech, University of Nevada, and University of British Columbia. I am a graduate of the Haileybury School of Mines and am a Certified Mining Technician.
3. I have been engaged in mining exploration for 22 years.
4. I have authored the report entitled "Soil Geochemistry, Tiger Claim, Ainsworth, Slocan Mining Division, B. C." The report is based on research and field work conducted and supervised by the author.
5. I control, with associates, 100% interest in the property.
6. I consent to the use of this report in a prospectus or in a statement of material facts related to the raising of funds.

Respectfully submitted,

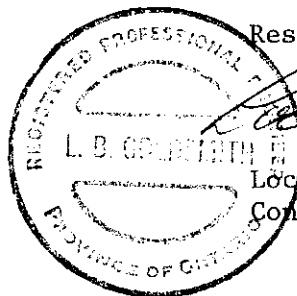

Locke B. Goldsmith
Locke B. Goldsmith, P.Eng.
Consulting Geologist

Vancouver, B. C.

December 1, 1980

REFERENCES

- (1) Fyles, J. T., 1967, Geology of the Ainsworth-Kaslo Area: BCDM Bulletin 53, p. 112-113.
- (2) Rice, H. M. A., 1944, Notes on Geology and Mineral Deposits at Ainsworth, B. C.: GSC Paper 44-13.
- (3) Schofield, S. J., 1920, Ainsworth Mining District, B. C.: GSC Memoir 117, p. 55-56.
- (4) University of British Columbia, MINDEP Computer Files.

ITEMIZED COST STATEMENT, 1980 PROGRAMME

(a) Wage Scales:

L. B. Goldsmith, Consulting Geologist	
October 8, December 1, total 2 days	
@ \$300/day	\$ 600.00
P. Harker, Prospector	
October 8, 1 day @ \$130/day	130.00
G. Bennett, Prospector	
October 8, 1 day @ \$130/day	130.00

(b) Food:

Total expenditure of \$19.45 divided by	
3 field days = \$6.48/day	19.45

(c) Transportation:

Approximately 120 mile round trip to the property	
from Silverton, B. C., @ \$0.25/mile = \$30.00	
Gasoline = \$14.20, total = \$44.20	44.20

(d) Geochemical Survey:

L. B. Goldsmith, October 8, \$300	
G. Bennett, October 8, \$130	
P. Harker, October 8, \$130	
	<u>\$560</u>

(e) Analyses:

24 soil samples, cost \$62.60	
= \$2.61 /sample	
2 rock samples, cost \$50.20	
= \$25.10/sample	112.80

(f) Report:

L. B. Goldsmith, December 1, 1 day,	\$300	
M. Izard, drafting	\$210.00	
M. Izard, drafting expenses	7.00	
L. Borleske, typing	20.00	
Xerox, prints	<u>25.00</u>	
	\$262.00	\$ 262.00
		<u>1,298.45</u>
	TOTAL	

APPENDIX

To: Mr. L.B. Goldsmith,
 Box 29,
 Silverton, B.C. VOG 2B0

 cc: Vancouver, B.C.

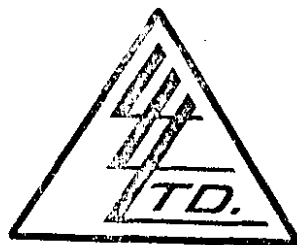

File No. 20368
 Date October 14, 1980
 Samples Soil
 "TIG" SERIES

Certificate of
 ASSAY OF
 LORING LABORATORIES LTD.

SAMPLE No.	PPM Pb	PPM Ag
<u>"Soil Samples"</u>		
TIG-00+00BL-00+00	32	1.8
TIG-0+00 -0+50N	28	1.0
1+00N	300	1.0
1+50N	38	1.0
IG-1+00E-0+00	40	1.0
0+50N	50	1.0
1+00N	70	0.8
1+50N	46	0.5
1+50S	50	1.0
TIG-2+00E-BL	58	1.5
0+50N	68	1.0
1+00N	48	1.0
1+50N	54	1.0
0+50S	38	2.0
TIG-3+00E-BL	34	0.8
0+50N	30	0.8
1+00N	38	1.0
1+50N	32	1.5
2+00N	54	1.0
TIG-4+00E-BL	30	0.8
0+50N	44	1.0
1+00N	52	1.0
1+50N	24	1.0
2+00N	22	0.8

I Hereby Certify THAT THE ABOVE RESULTS ARE THOSE
 ASSAYS MADE BY ME UPON THE HEREIN DESCRIBED SAMPLES

Rejects Retained one month.
 Pulps Retained one month
 unless specific arrangements
 made in advance.

Edmund J. ...
 Licensed Assayer of British Columbia

To: Mr. L.D. Goldsmith,
 P.O. Box 29,
 Silverton, B.C. VOG 2E0
 cc: Vancouver

File No. 20383
 Date October 17, 1980
 Samples Rock



Certificate of
 ASSAY of
 LORING LABORATORIES LTD.

Page # 1

SAMPLE No.	OZ./TON SILVER	% Pb	% Zn
<u>"Rock Samples"</u>			
Tig # 1	4.48	11.47	5.59
Tig # 2	2.60	.37	26.32
<p>I Hereby Certify THAT THE ABOVE RESULTS ARE THOSE ASSAYS MADE BY ME UPON THE HEREIN DESCRIBED SAMPLES</p>			

acts Retained one month.
 Pulps Retained one month
 unless specific arrangements
 made in advance.

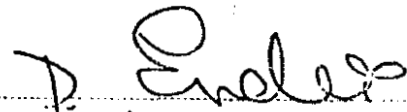
 Assayer

SURFACE GEOLOGY AND SOIL GEOCHEMISTRY

AFTER J.T. FYLES BCDMB 53 1967

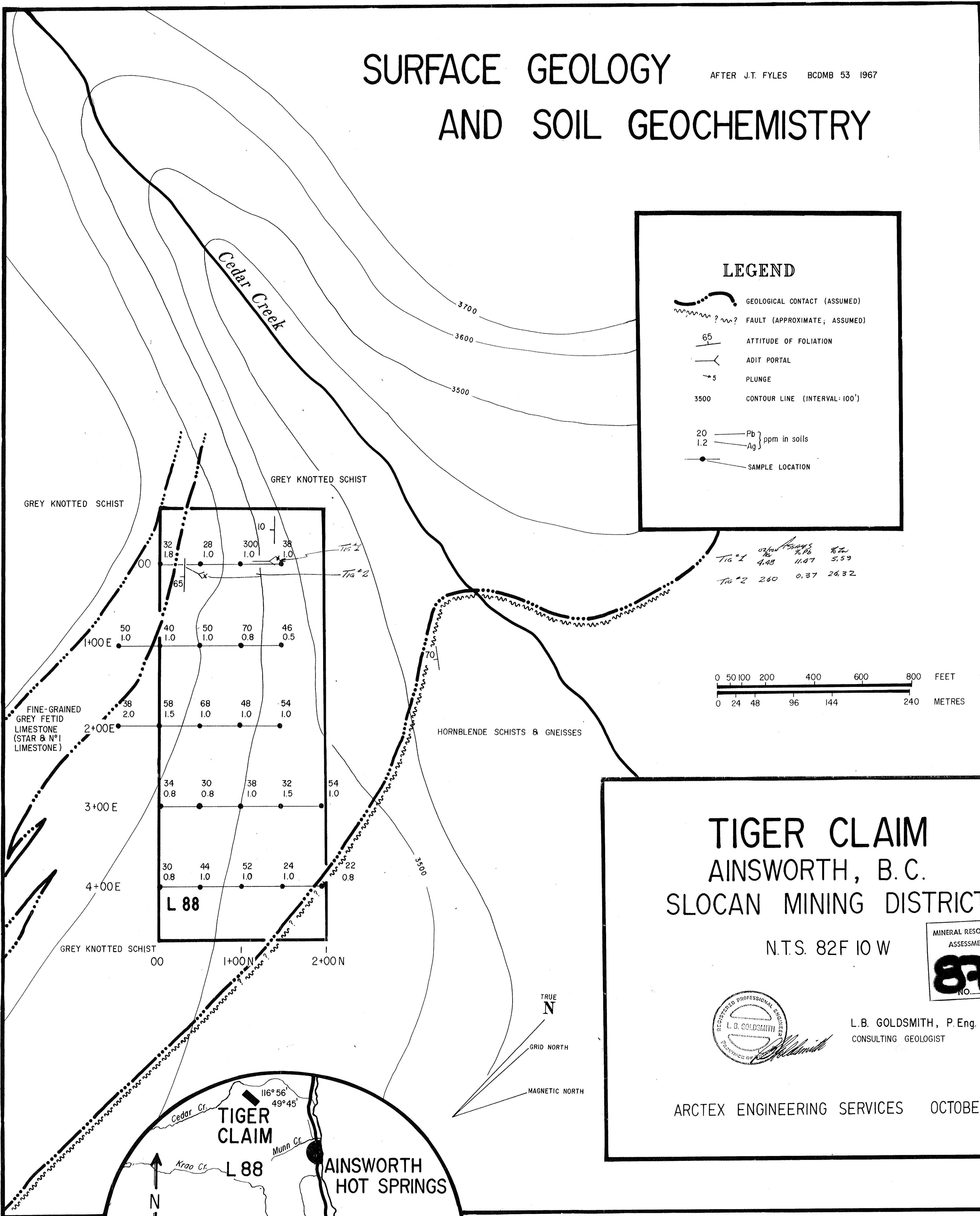

LEGEND

- GEOLOGICAL CONTACT (ASSUMED)
- FAULT (APPROXIMATE; ASSUMED)
- ATTITUDE OF FOLIATION
- ADIT PORTAL
- PLUNGE
- CONTOUR LINE (INTERVAL: 100')
- Pb } ppm in soils
Ag }
- SAMPLE LOCATION

TIG #	oz Au / TON	% Pb	% Zn
TIG #1	4.48	11.47	5.59
TIG #2	2.60	0.37	26.32

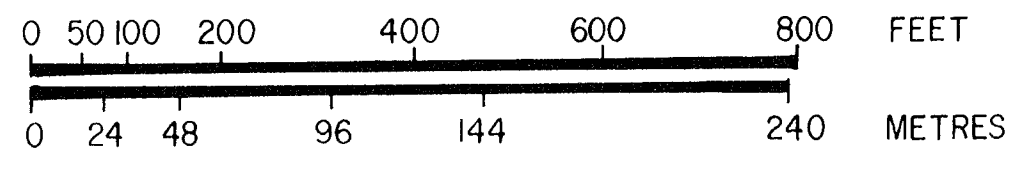

TIGER CLAIM

AINSWORTH, B.C.

SLOCAN MINING DISTRICT

N.T.S. 82F 10 W

MINERAL RESOURCES BRANCH
ASSESSMENT REPORT
1078
NO.

L.B. GOLDSMITH, P. Eng.
CONSULTING GEOLOGIST

ARCTEX ENGINEERING SERVICES OCTOBER 1980

Map 3

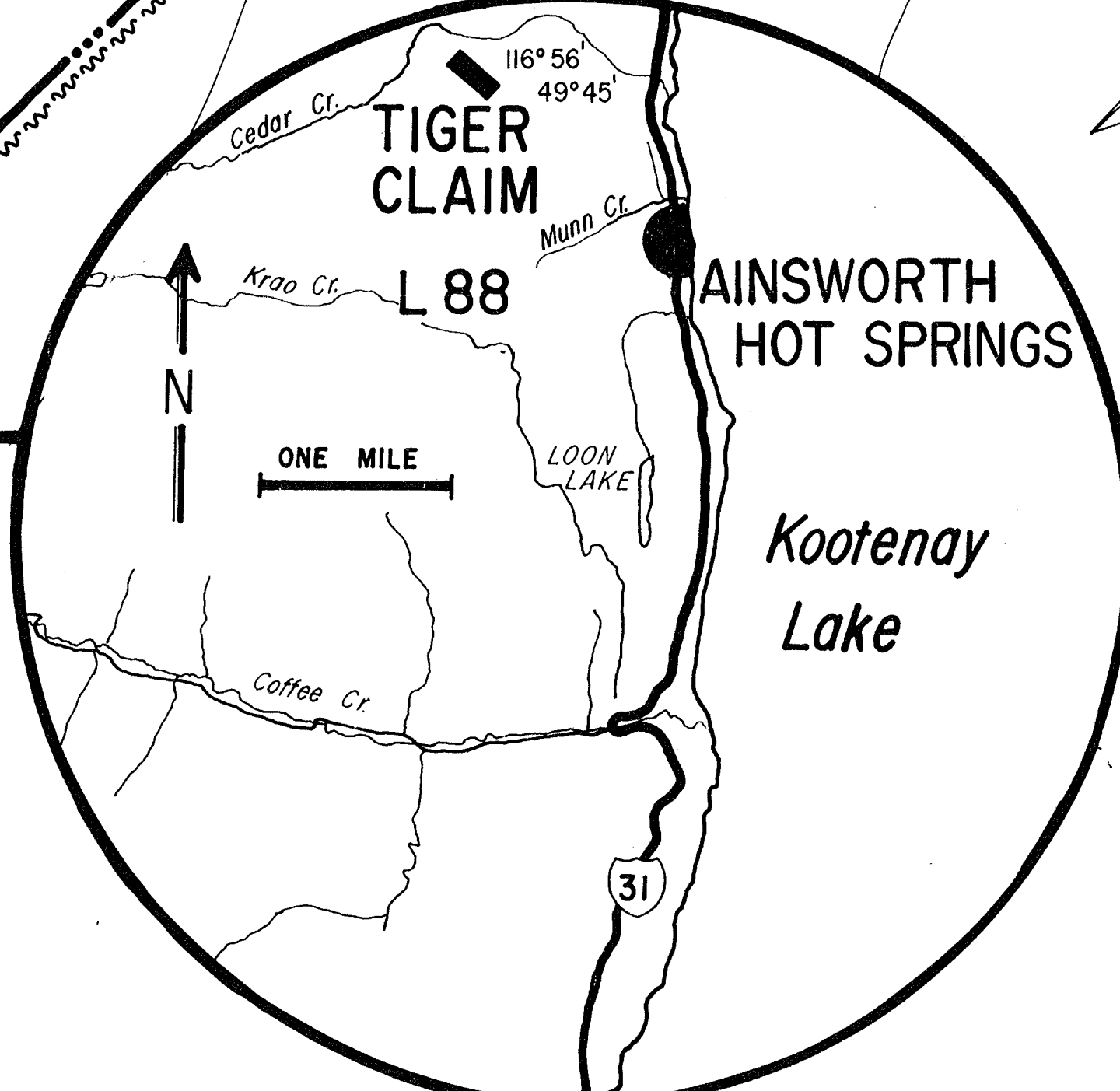

ROCK SAMPLES	OZ / TON Au	% Pb	% Zn
TIG N°1	4.48	11.47	5.59
TIG N°2	2.60	0.37	26.32