

REPORT ON
PERCUSSION DRILLING
CANTY PROPERTY
OSOYOOS MINING DIVISION

49°-25' North Latitude
120 -00 West Longitude
Nts. Maps 92H/8E & 82E/5W

FOR

GOOD HOPE RESOURCES LTD.
1518-1177 West Hastings Street
Vancouver, B.C.

by

A.D. WILMOT P. ENG.

December 15, 1980

Kelowna, B.C.

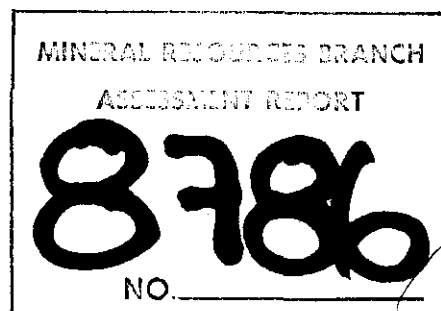

TABLE OF CONTENTS

	PAGE
(A) INTRODUCTION	1
(1) Location & Access	1
(11) Property	1
History	1
Ownership	1
Economic Assessment	1
(111) Summary of Work done	1
Location of drilling	1
Purpose of drilling & results	1
(B) Notes on the Drilling	2
(C) Statement of Expenditures	3
(4) Certificate of A.D. Wilmot P. Eng	4

APPENDICES

Key Map	Plate 1
Claim Map	2
Location of Drill Site	3
Plan of Percussion Holes	4
Drill Hole Sections & Assays	
Holes P 200 & P-202	5
Hole P-203	6
Holes P-204, P-205, & P-206	7
Hole P-207	8
Hole P-208	9
Holes P-209 & P-210	10

(A) INTRODUCTION

(1) Location & Access

The Canty Mine is located on Nick~~e~~ Plate Mountain, 18 Km. by road from Hedley, B.C. An index map, Plate 1, is appended.

(11) Property

The Canty Group of mineral claims, consists of 16 Crown Granted claims and 13 claims owned by right of location.

History

Canty Gold Mines Ltd. explored the property continuously between 1935 and 1940. A shipment of 1200 tons of ore, grading 0.168 ozs. of gold per ton, was treated at the Mascot Mill.

Ownership

The property is owned by Good Hope Resources Ltd. of 1518-1177 West Hastings Street, Vancouver, B.C.

Economic Assessment

As all the mine records of the previous work have been lost, including the underground assay plans and drill logs, its not possible at this time to give a reliable estimate of either grade or tonnage.

(111) Summary of Work Done

Between September 12th and October 24th, 1980 a total 372 metres of percussion drilling was done on the Canty property. This drilling, consisting of 11 holes, was located near an old prospect shaft on the Boston Crown Grant.

The purpose of the drilling was to explore in depth the mineralization occuring in old surface cuts. This mineralization, consisting mainly of arsenopyrite in a host rock of highly siliceous and altered sediments, contains appreciable amounts of gold.

From the amount of drilling completed this year its not possible to give an estimate of the grade or tonnage of the deposit.

(B) Notes on the Drilling

- (a) The depth of overburden varied between 0 and 2 meters.
- (b) As the holes were in a homogeneous meta sediment no variation was observed in the cuttings.
- (c) The sample interval was 3 meters.
- (d) A small portion was taken from each sample and retained for reference.

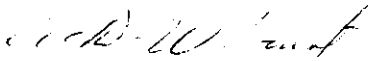
A.D. Wilmot P. Eng.

(C) STATEMENT OF EXPENDITURES

(1)	Mobilization	1,200.00
(2)	H.D. Drilling Contract 372 m. @ 18.00 per m.	6,696.00
(3)	99 gold assays @ 6.50	643.50
(4)	Vehicle rental September 12 to October 24/80 6 weeks @ 150.00 per wk. milage 1,870 @ 30¢ mile	900.00 561.00
(5)	Salaries & Wages	

NAME	CATEGORY	RATE	DAYS WORKED	PERIOD	COST
A.D. Wilmot	Prof. Eng.	150/day	16	Sept. 12-Sept.20 9 days	1,350.00
				Oct. 19-Oct. 24 7 days	1,050.00
C. Mullin	Helper	75/day	5	Oct. 20-24	375.00
R. Anderson	Helper	75/day	5	Sept 16-20	375.00
	TOTAL -----				3,150.00

(6)	Food & Accomodation A.D. Wilmot 20 days @ 40.00 per day	800.00
(7)	Report including typing, mapping, & reproduction	400.00
	TOTAL -----	14,350.00

CERTIFICATE

I, Ashley D. Wilmot of Kelowna, B.C. Certify that:

I graduated from Queen's University in 1936 with a B. Sc. degree in Mining Engineering.

I'm a member of the B.C. Professional Engineers and a life member of the Canadian Institute of Mining & Metallurgy and the B.C. Yukon Chamber of Mines.

I have practiced my profession for forty years.

A D Wilmot
A.D. Wilmot P. Eng.

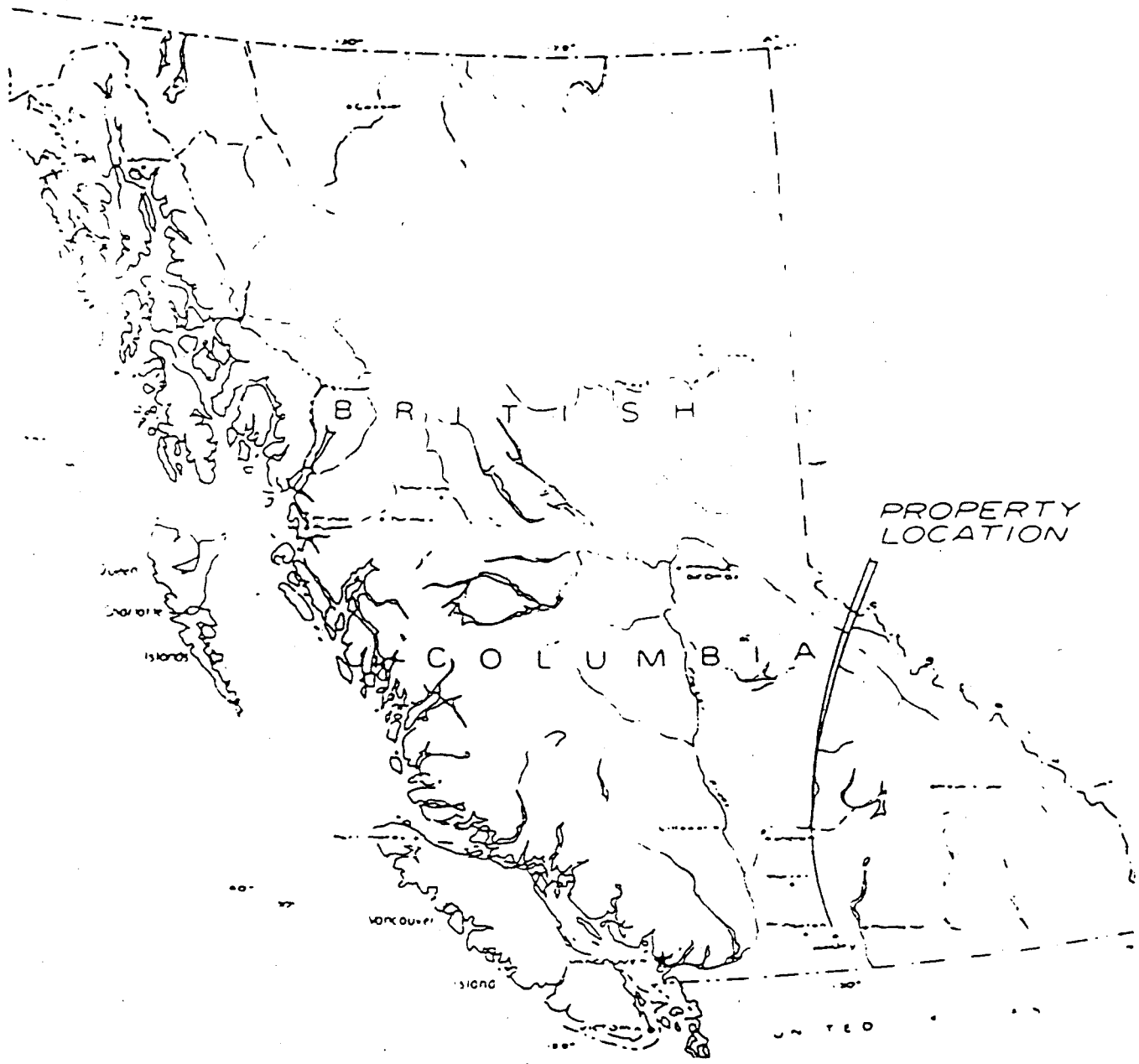

GOOD HOPE RESOURCES LTD.

LOCATION MAP

PLATE 1



GOOD HOPE RESOURCES LTD.

AREA CLAIM MAP

SCALE : 1:50,000

PLATE 2

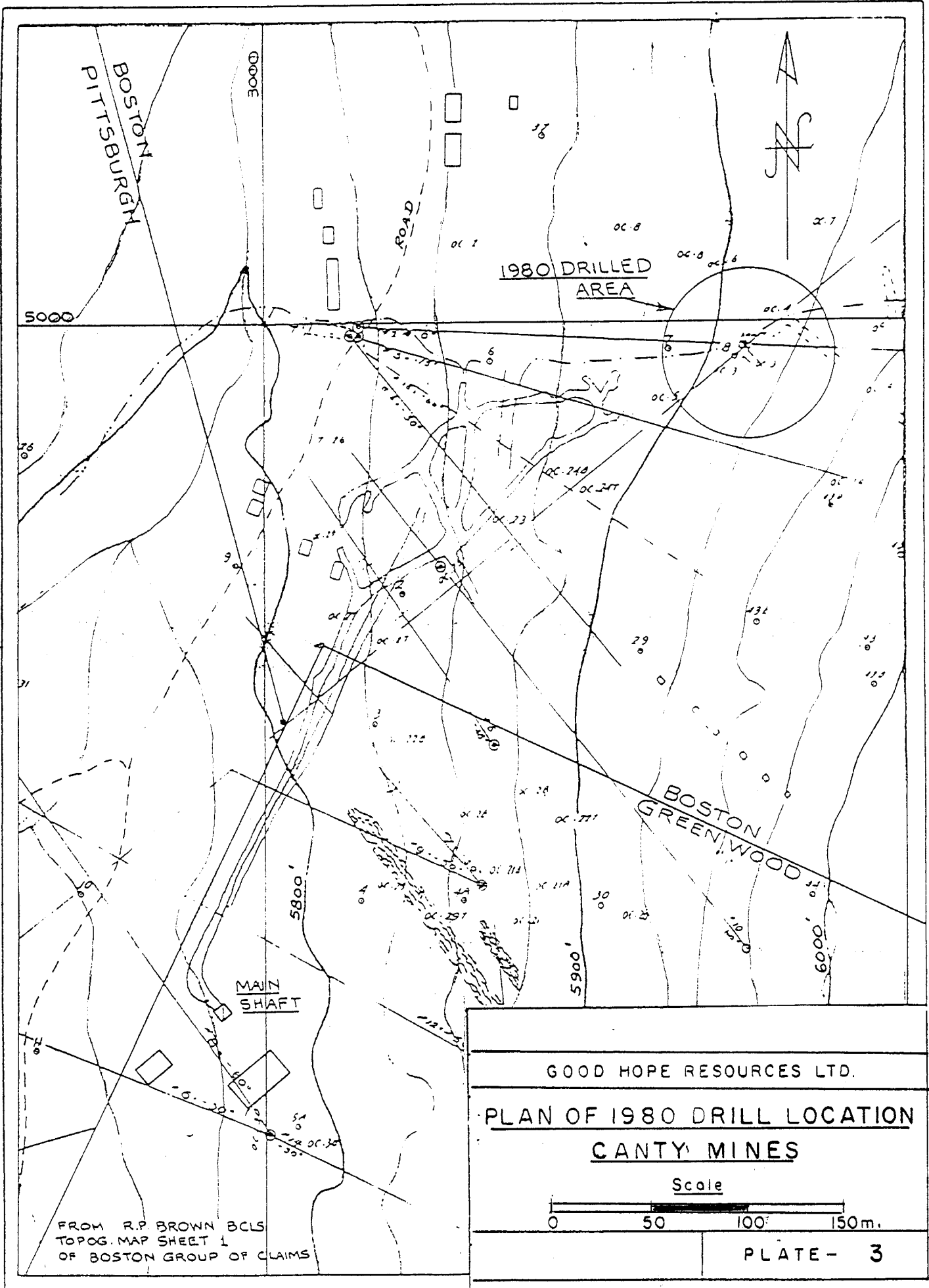

GOOD HOPE RESOURCES LTD.					
<u>PLAN OF 1980 DRILL LOCATION</u>					
<u>CANTY MINES</u>					
Scale					
<table border="1"> <tr> <td>0</td> <td>50</td> <td>100</td> <td>150m.</td> </tr> </table>		0	50	100	150m.
0	50	100	150m.		
<table border="1"> <tr> <td>PLATE - 3</td> </tr> </table>		PLATE - 3			
PLATE - 3					

FROM R.P. BROWN BCL'S
TOPOG. MAP SHEET 1
OF BOSTON GROUP OF CLAIMS

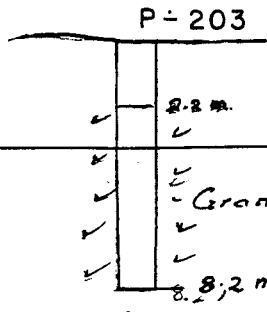

EL. 1800 m

CANTY MINE
X - SECTION of P-203

Scale



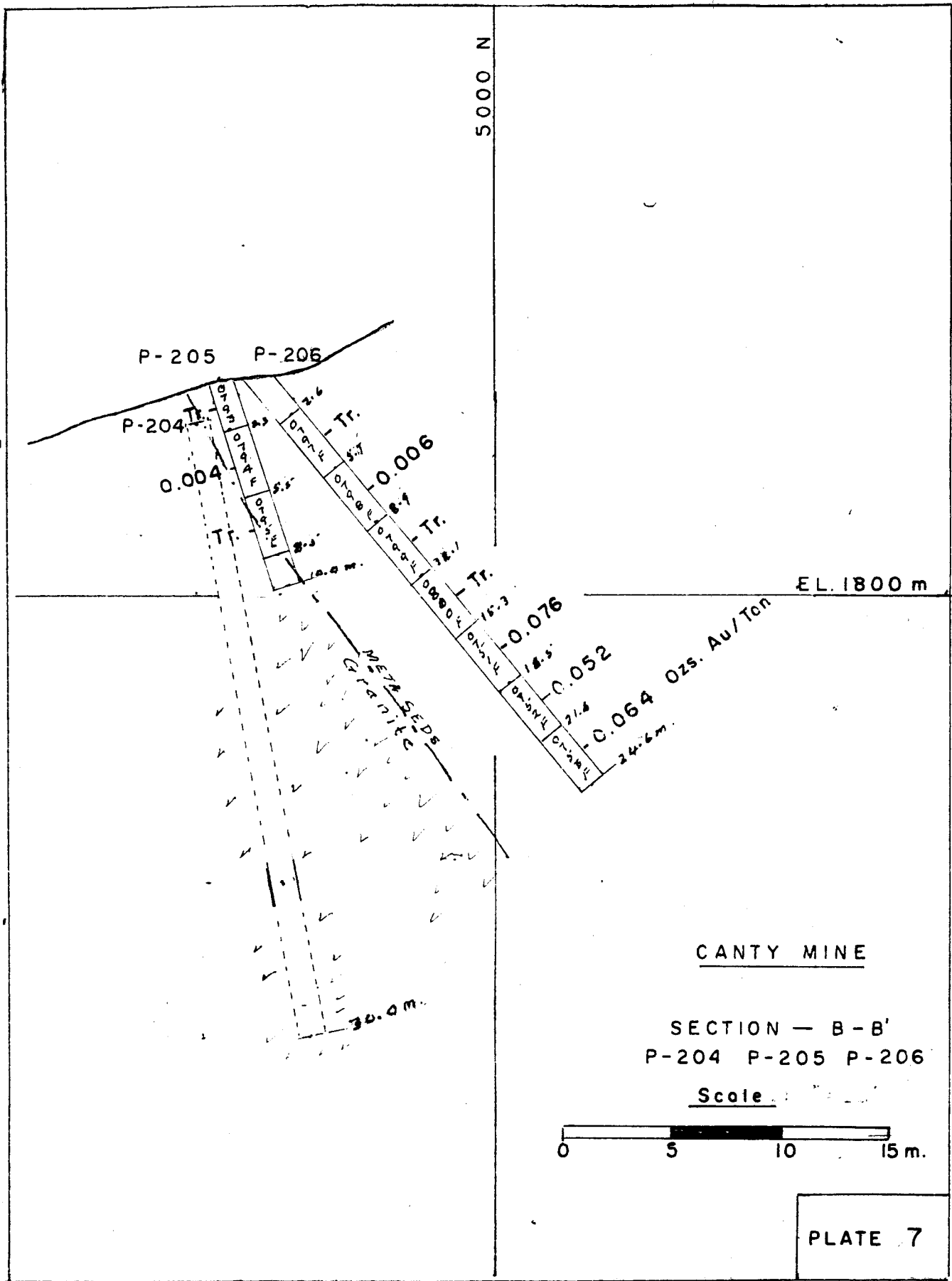

PLATE 7

5000 N 8 3437 E

P-207

EL 1800m.

CANTY MINE
X-SECTION of P-207

Scale

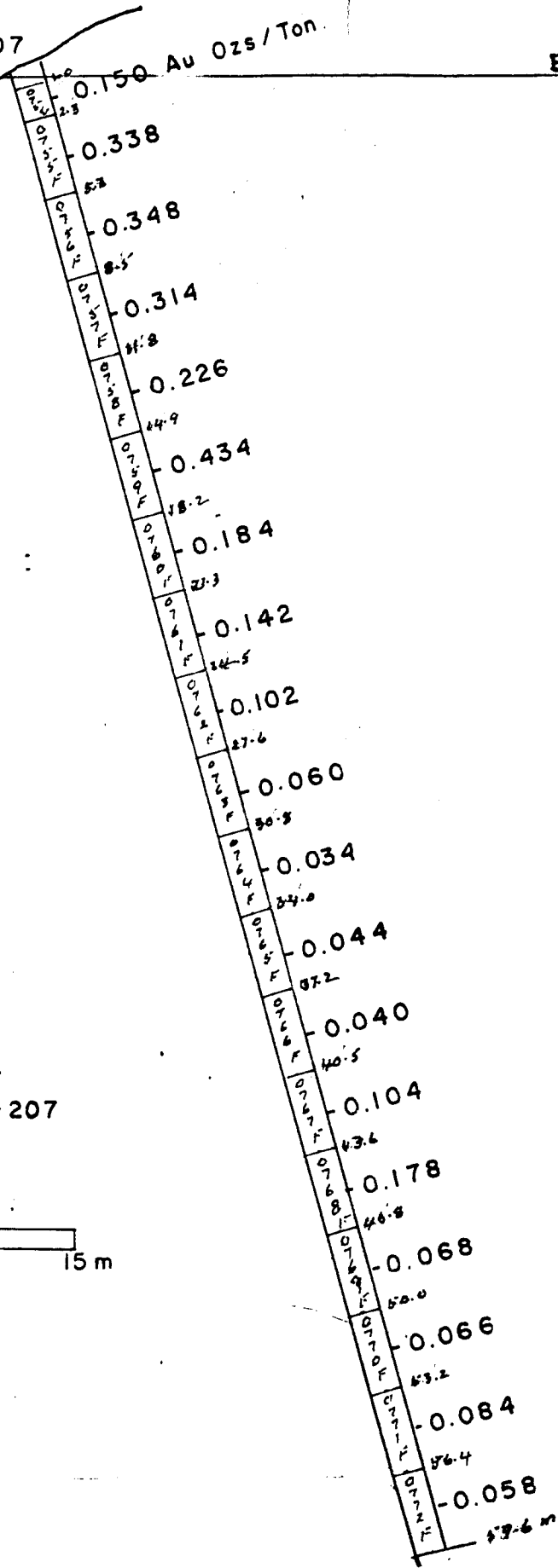

5000 N

P-208 Au Ozs/Ton

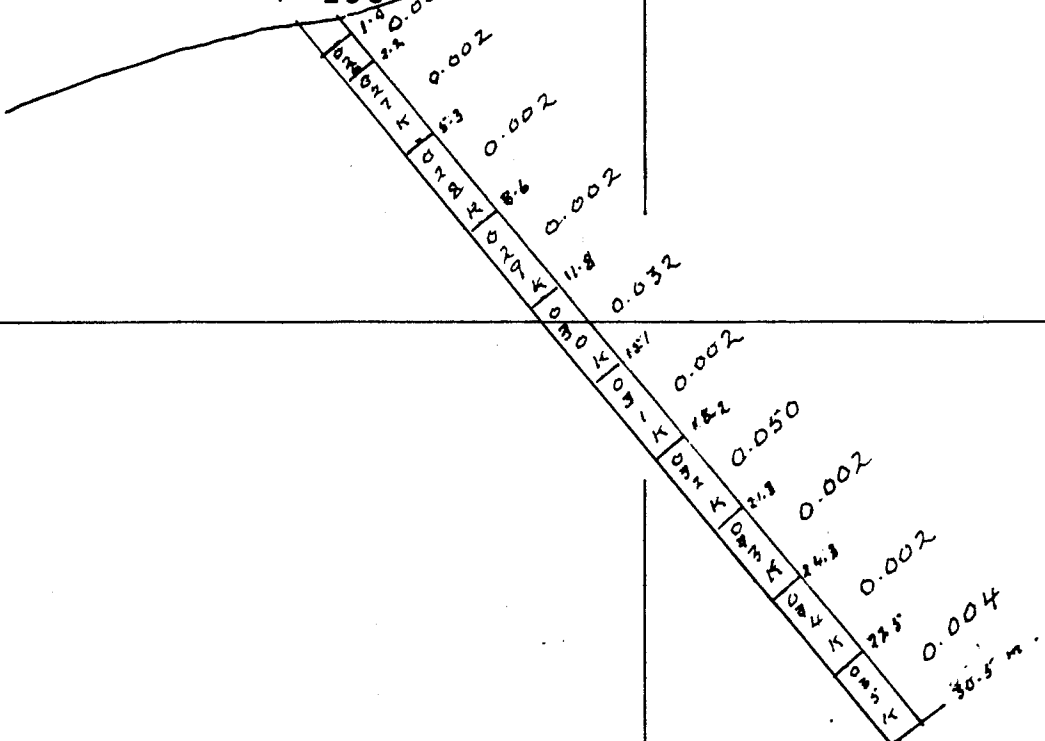

E.L. 1800m

Scale



CANTY MINE

SECTION - B - B'

P - 208

PLATE 9

3437 E

P-209

P-210

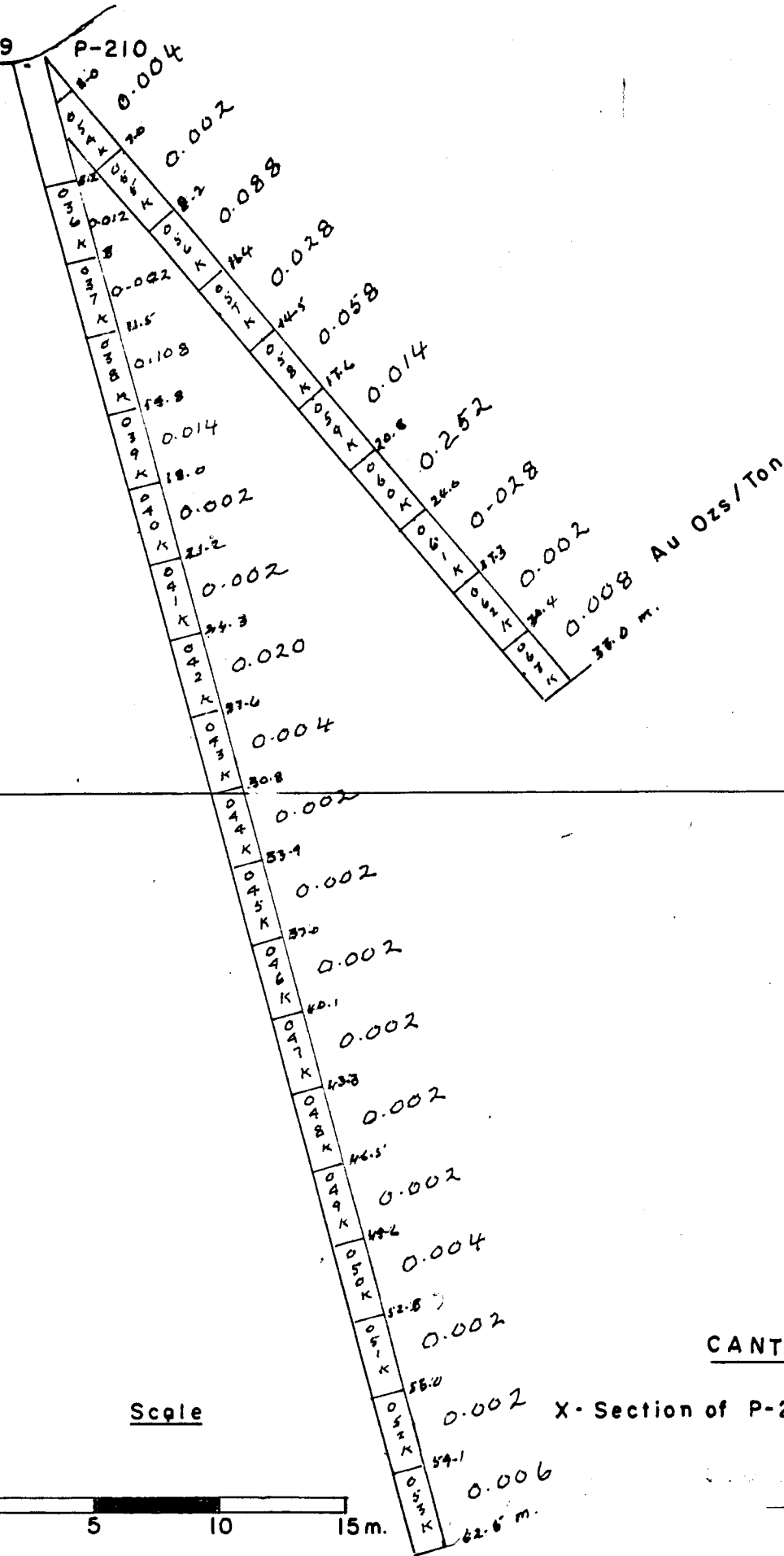

EL. 1768 m.

Scale



CANTY MINE

X-Section of P-209 & P-210

PLATE 10

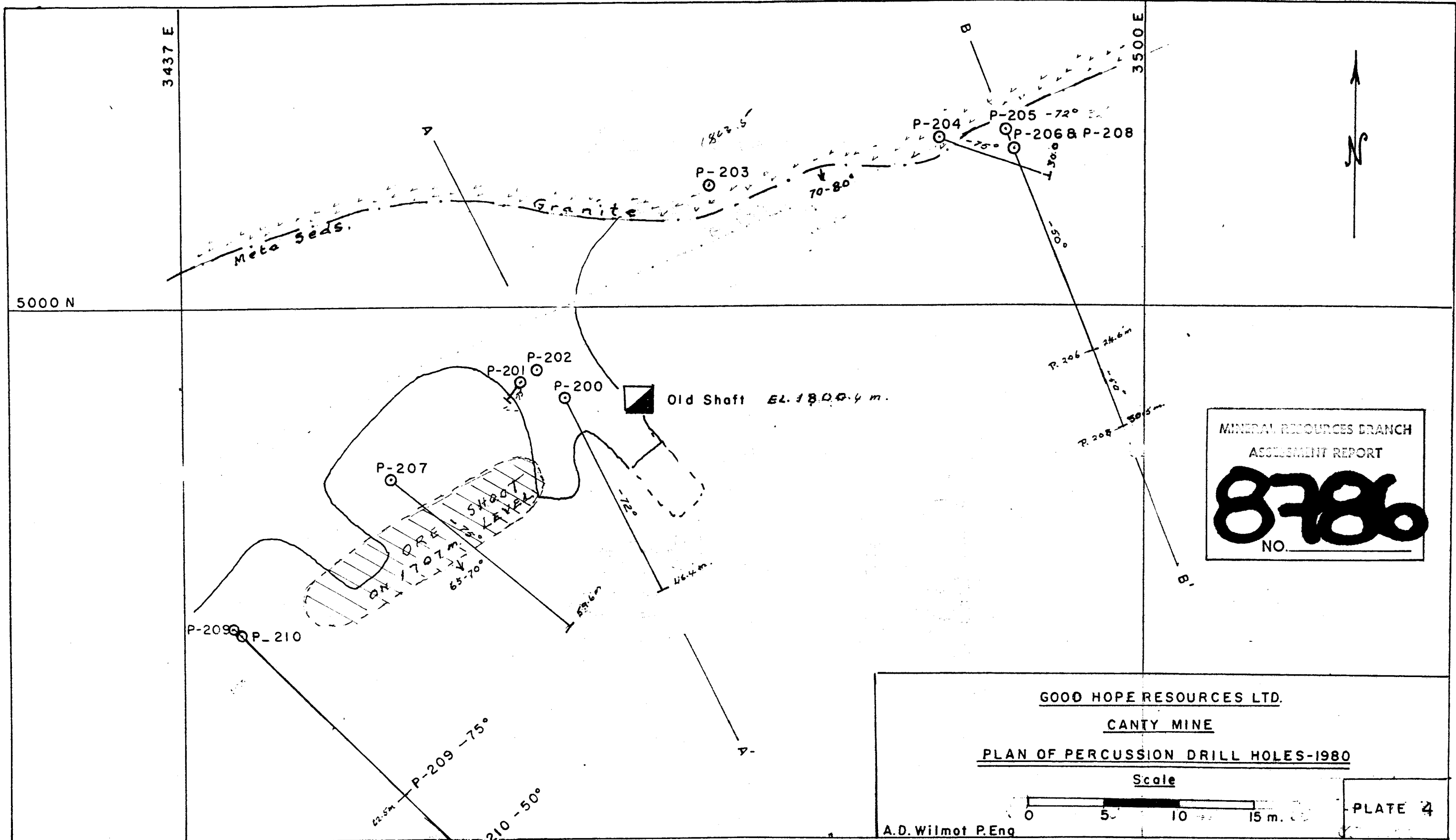

3437 E

3500 E

5000 N

Meta sed.

Granite

Old Shaft EL. 1800.4 m.

MINERAL RESOURCES BRANCH
ASSESSMENT REPORT
8786
NO.

GOOD HOPE RESOURCES LTD.
CANTY MINE
PLAN OF PERCUSSION DRILL HOLES-1980

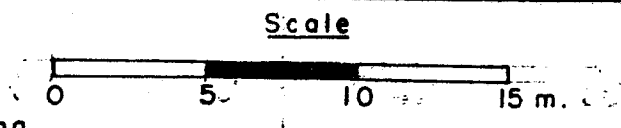

PLATE 4

A.D. Wilmot P.Eng

5000 N

P-202
P-200

EL. 1800 m.

Melka-Spels
Granite

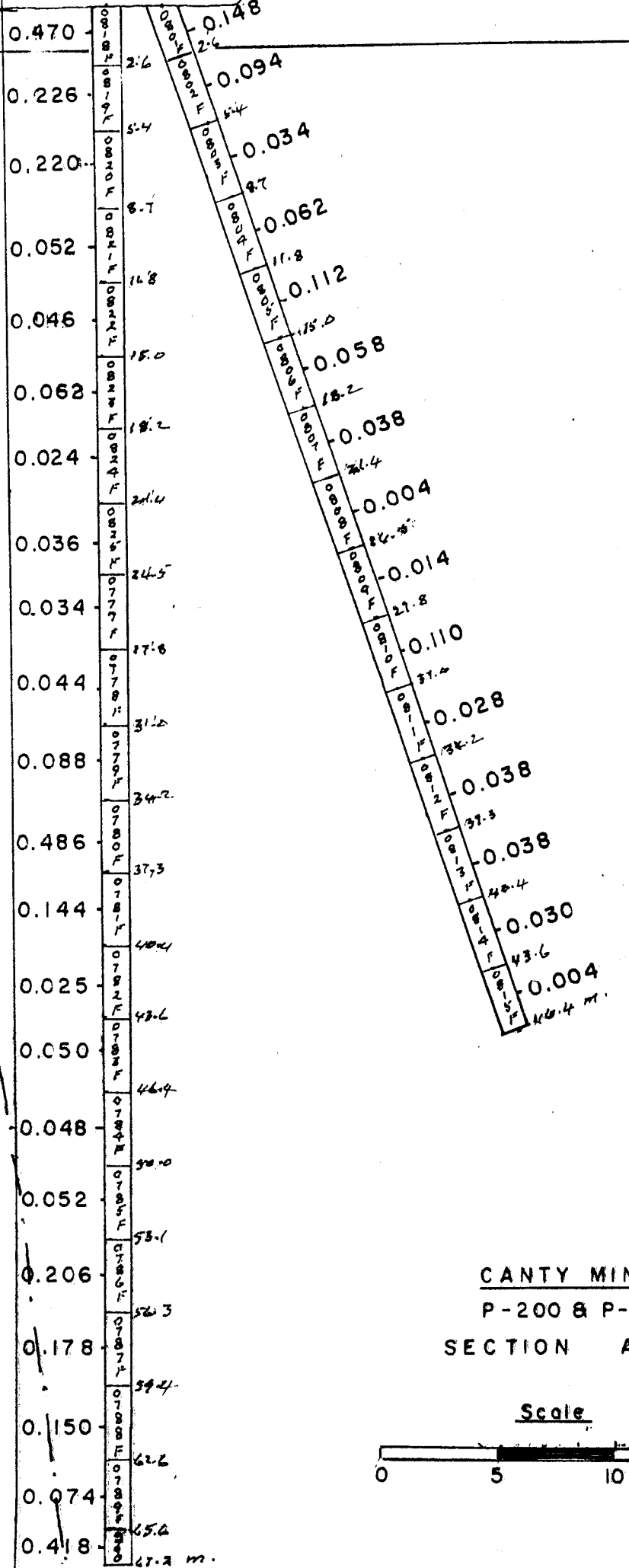

Au Ozs./Ton

CANTY MINE
P-200 & P-202
SECTION A-A'

Scale



8786

MINERAL RESOURCES BRANCH
ASSESSMENT REPORT

Au Ozs./Ton

PLATE 5