

PROSPECTING ASSESSMENT REPORT

on the

BELLE, MARBLE EDGE, RAPID GROUPS

claims

at Taghum, B.C.

5 miles west of

the City of Nelson

NTS 82F/6 Latitude & Longitude are

$49^{\circ}29\frac{1}{2}'N$   $117^{\circ}23'W$

Nelson Mining Division

On behalf of Robin W. Pearson

Nelson, B.C.

Report by:

Pearson, Gallagher Ltd.

June 1980

MINERAL RESOURCES BRANCH  
ASSESSMENT REPORT

**8806**

NO. \_\_\_\_\_

TABLE OF CONTENTS

PAGE 1

BACKGROUND	PAGE 2
LOCATION AND ACCESS	PAGE 2
PROPERTY INFORMATION	PAGE 2
DISCUSSION	PAGE 3
GENERAL SETTING	PAGE 3

FIGURES

LOCATION MAP
CLAIMS AND GRID
MAGNETOMETER VALUES

APPENDIX

I ASSESSMENT WORK DETAILS	PAGE 4
LL AUTHOR'S QUALIFICATIONS	PAGE 5

BACKGROUND

The claims were crown granted at the turn of the century. No information as to development of the claims is available in the B.C. Ministry of Mines general reports.

In 1979, rock samples from these claims were taken and assayed.

This magnetometer survey was performed by Pearson, Gallagher Ltd. on behalf of Robin W. Pearson, conducting a vertical force ground fluxgate magnetometer orientation survey over a portion of the claims.

This report discusses field procedures and results of this survey.

LOCATION AND ACCESS

The claims are located approximately five miles west of the City of Nelson on the west arm of Kootenay Lake at Taghum, B.C. The claims are intersected by Highway 3A.

NTS Location 82F/6.

PROPERTY INFORMATION

CLAIM NAME	RECORD #	MONTH OF EXPIRY
Belle	1113	July
Marble Edge	1113	July
Rapid	1113	July

A small grid was laid out over the outcrop containing visible molbdenite with readings taken every 50 metres with a McPhar M700 Fluxgate magnetometer.

A total number of 0.9 kilometres of line was surveyed.

The results of the magnetometer survey are shown on accompanying maps.

Values ranged from a low of 20 gammas to a high of 1,000 gammas.



A detailed geological mapping program and geochemical soil survey are recommended to find the significance of the change in the gammas from station to station.

GENERAL SETTING

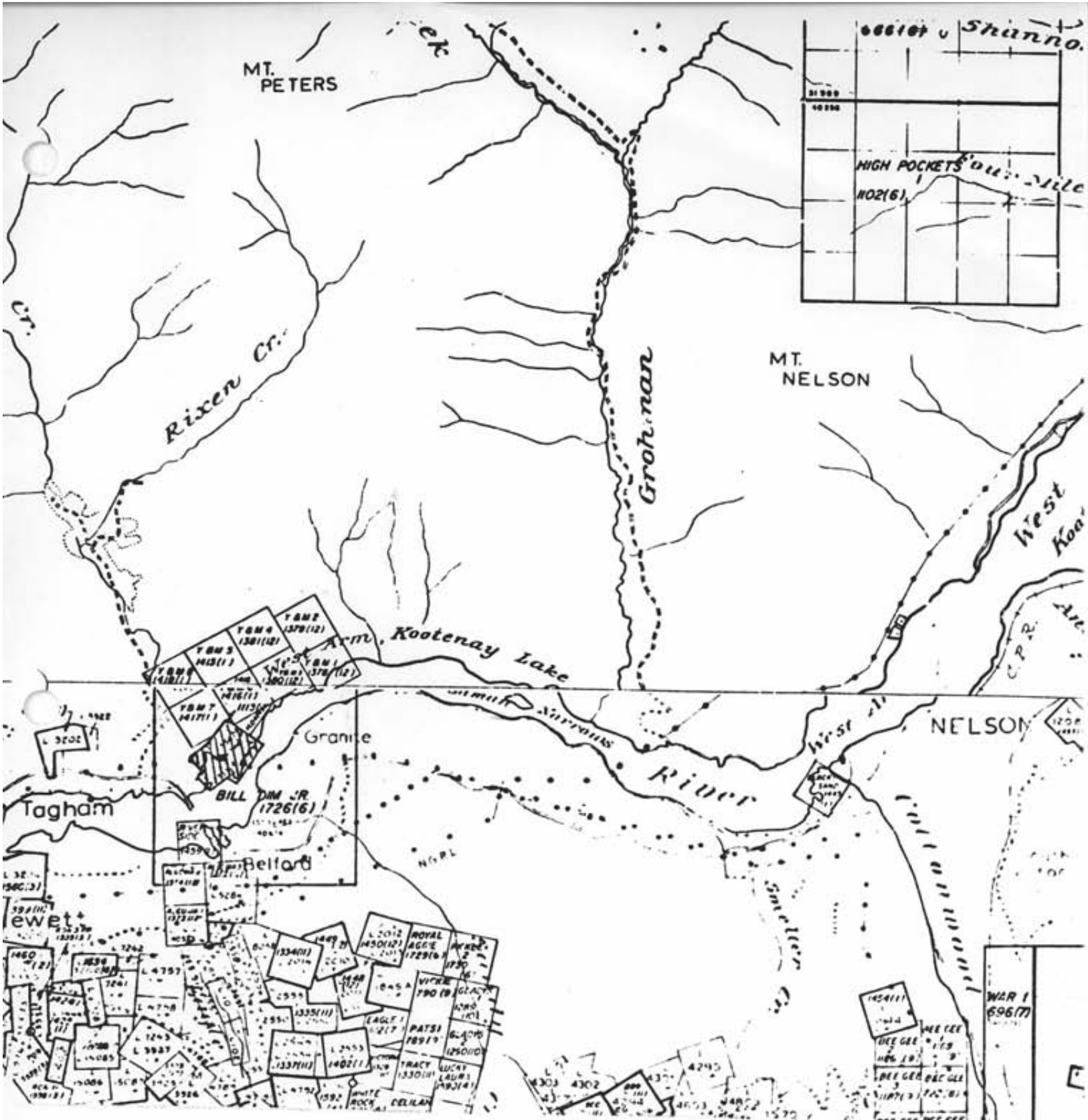
The Rapid, Marble Edge, and Belle Mineral Claims are situated on the north shore of the west arm of Kootenay Lake at an elevation of approximately 1,800 feet above sea level. The vegetation and forest cover varies from assiduous to deciduous trees with some underbrush and open fields. The area is underlain by Nelson plutonic rocks which consists mainly of non-porphyritic granite to granodiorite "Map 1090 A" Nelson West Half-Geological Survey of Canada. There is a small remanent of metasediments mapped as Hall Formation on Map 1090 A, being mainly argilllite, sandstone and conglomerate. Visible mineralization consisting of molybdenite and pyrite is found in the fractures and quartz veins usually associated with pegmatite.



INDEX

-  belle, marble edge
-  rapid group

M 82F/6,11W

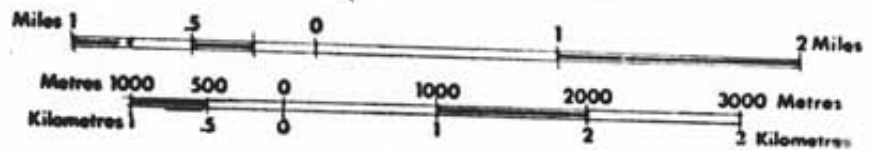

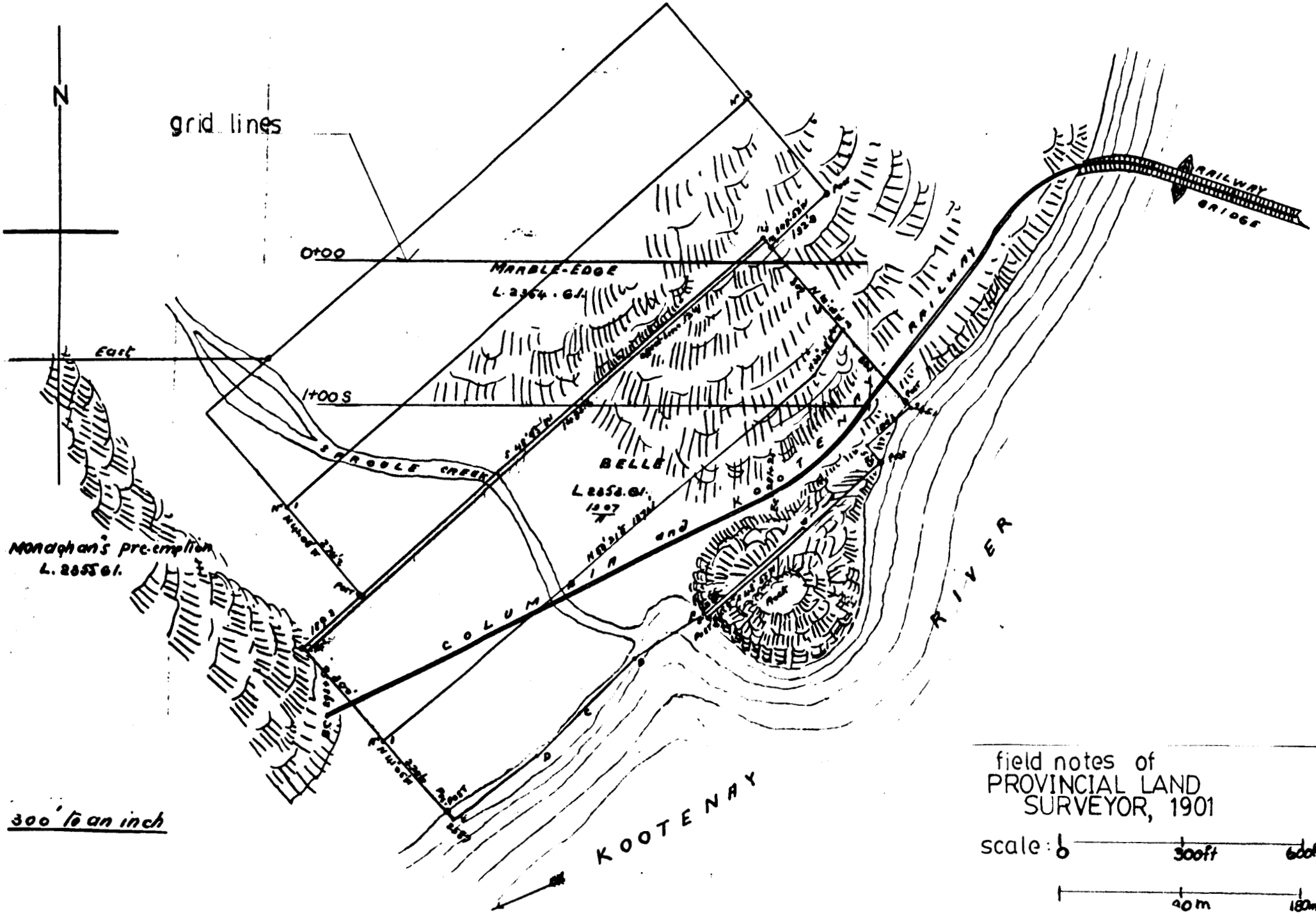

300' to an inch

field notes of  
PROVINCIAL LAND  
SURVEYOR, 1901

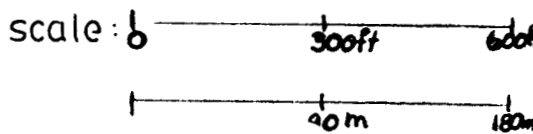

APPENDIX I

ASSESSMENT WORK DETAILS

PAGE 4

PROJECT: Belle, Marble Edge, Rapid Groups

LOCATION: Taghum, Nelson Mining District 82F/6.

June 9th - 1 day;

Fluxgate magnometer survey, \$250.00 per day for instrument, transportation and operator	\$250.00
---------------------------------------------------------------------------------------------	----------

June 10th and 11th - 2 days;

Analysis and office work, \$25.00 per day for analysis and office work	50.00
---------------------------------------------------------------------------	-------

TOTAL	<u>\$300.00</u>
-------	-----------------

QUALIFICATIONS

I, Daniel J. Gallagher, have completed the "Mineral Exploration for Prospectors" course offered by the Ministry of Energy, Mines & Petroleum Resources in April/May of 1979. I have been a prospector for the past ten years and have completed and passed the Rocks & Minerals Course given by George Addy, District Geologist for the Ministry of Energy, Mines & Petroleum in Nelson, B.C.

Signed:

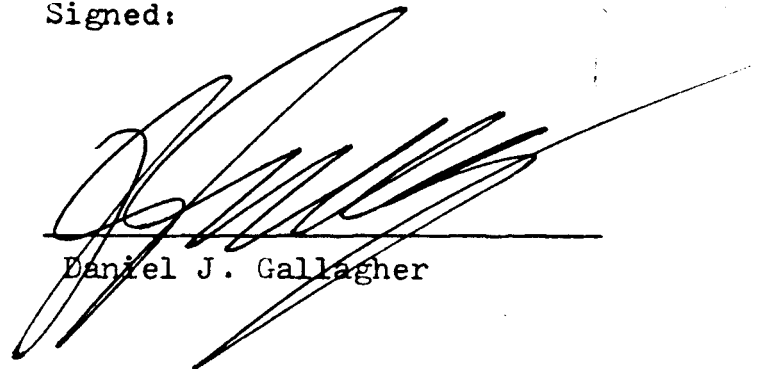
A large, stylized handwritten signature in black ink, appearing to read 'D. J. Gallagher', is written over a horizontal line. The signature is highly cursive and somewhat illegible.

Daniel J. Gallagher



SELKIRK



COLLEGE

CASTLEGAR, B. C., CANADA

COMMUNITY EDUCATION SERVICES

THIS IS TO CERTIFY THAT

DAN GALLAGHER

HAS PARTICIPATED IN

"MINERAL EXPLORATION FOR PROSPECTORS"

120 Hour Course

Sponsored by: Ministry of Energy, Mines & Petroleum  
Resources, & Ministry of Education, Science & Technology

April 29 - May 12, 1979



*A. Fraser Stephens*  
INSTRUCTOR/PROGRAM COORDINATOR

*J.C. Baker*  
DIRECTOR OF COMMUNITY EDUCATION SERVICES



MINERAL RESOURCES BRANCH  
 ASSESSMENT REPORT  
**8806**  
 NO.

Magnetometer Survey.  
 Property - Belle - L2353  
               Marble Edge - L2354  
               Rapid - L5302  
 Date of Survey - June 9, 1980  
 Scale - 1 centimeter = 12.5 metres  
 Instrument - M'Phar M700 Flurgate