

REPORT ON DIAMOND DRILLING
ON THE
SUE, A, CAMP AND HICKMAN GROUPS
SCHAFT CREEK, LIARD MINING DIVISION, B. C.
BY
A. I. BETMANIS, P.ENG.

Claims: Bird, Sno, Schaft, etc.

Mining Division: Liard

N.T.S.: 104 G/6 and 7

Latitude and Longitude: $57^{\circ}22'N$; $131^{\circ}00'W$

Owner: Teck Corporation

Operator: Teck Explorations Limited

8832

PART 1 of 2

Vancouver, B. C.

December 10, 1980

CONTENTS

	<u>Page</u>
Introduction	1
(a) Location and Access	1
(b) Property	2
(c) Summary of Work Done	3
(d) Claims on Which Work Done	4
Technical Data and Interpretation	5
References	6
Statement of Qualifications	7
APPENDIX A: Drill logs	Separate cover
APPENDIX B I and B II: Claim Data and Statement of Exploration Development	
APPENDIX C: Costs of Exploration	
Figure 1: Index Map	Following Page 1
Map 1: Claim Map	In Pocket
Map 2: Drill Hole Location Map	In Pocket

INTRODUCTION

In 1980 Teck Explorations Ltd., on behalf of Teck Corporation, conducted a diamond drilling program on the Schaft Creek property, totalling 451 two post claims and 62 units in four claims, of 47,615 feet of diamond drilling in 45 holes. The program was started in mid-May and completed by mid-November. All results and total cost of the program are not available yet. This report covers the extent of the program used for assessment credits during 1980 (Sue, A, Camp and Hickman Groups of claims).

Drilling on the property since the late 1960's, which had exceeded 113 thousand feet of drilling on a 500-foot basic grid, was done using the British measurement system. For conformity, and useful interpretation of data, the system established on the property was maintained for the 1980 program.

(a) Location and Access (See Index Map, Fig. 1)

The property is located between Schaft and Mess Creeks, on the south side of Mount LaCasse, approximately 60 km S.13°E. from Telegraph Creek and 80 km S.50°W from Iskut, at elevations between 830 meters and 1850 metres a.s.l. The geographic co-ordinates of the centre of the mineralized zone are 57°22'N, 131°00'E (NTS 104G/6 and 7). The claims are within the Liard Mining Division.

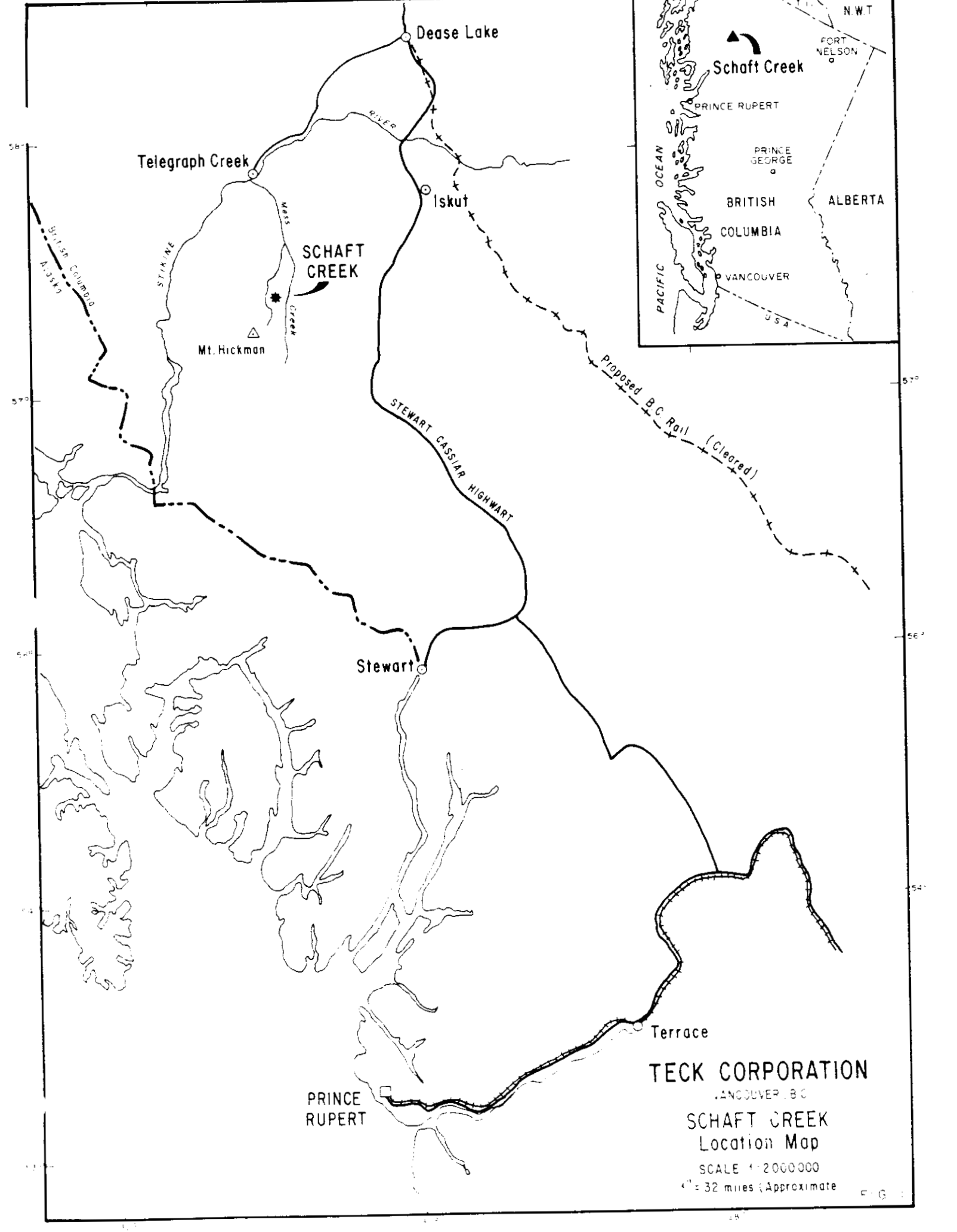

Telegraph Creek

Dease Lake

Iskut

SCHAFT CREEK

Mt. Hickman

STEWART CASSIAR HIGHWAY

Stewart

Terrace

PRINCE RUPERT

TECK CORPORATION

VANCOUVER, B.C.

SCHAFT CREEK
Location Map

SCALE 1:2000000

1" = 32 miles (Approximate)

FIG. 1

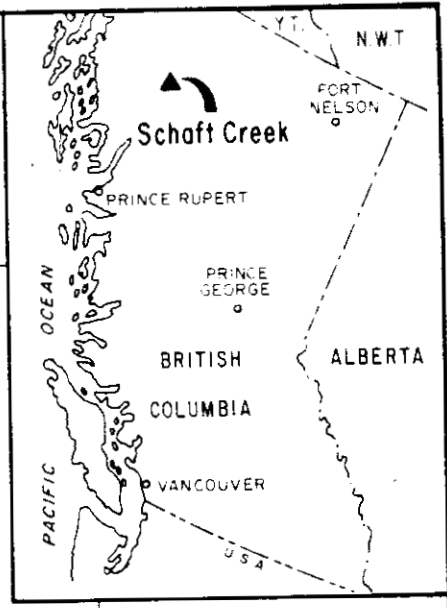

Schaft Creek

PRINCE RUPERT

PRINCE GEORGE

BRITISH COLUMBIA

ALBERTA

VANCOUVER

Y.T. N.W.T.

FORT NELSON

U.S.A.

Proposed B.C. Rail (Cleared)

58°

57°

56°

57°

56°

54°

Access to the property is by fixed wing aircraft on wheels from Terrace or Dease Lake to the company maintained 1000 meter gravel strip at Schaft Creek. Trans Provincial Airlines maintains six scheduled flights per week to Schaft Creek Camp from Terrace during the summer months. The property has no road access; heavy equipment and fuel have to be flown in by DC-3 or Caribou aircraft.

(b) Property

The first claims of the property (Bird claims) were staked in 1957 for the BIK Syndicate operated by Silver Standard Mines Ltd. The original exploration was performed by BIK Syndicate and Asarco. Liard Copper Mines was formed to hold the property and the claims were optioned to Hecla Operating Company. Hecla continued exploration, and by 1977 one hundred and four diamond drill holes with a total footage exceeding 113 thousand feet had been drilled.

Approximately 505 million drill-indicated tons grading 0.38% Cu and 0.039% MoS₂ had been outlined, predominantly as dissemination and fracture fillings of chalcopyrite, bornite, and molybdenite in volcanic and intrusive rocks.

Teck Corporation assumed Hecla's option agreement on the property in the winter of 1978. The 1980 program by Teck Explorations Ltd. for Teck Corporation was to define better, and to delimit the mineralized zone on the established 500 foot grid system.

(c) Summary of Work Done

A total of 47,615 feet of diamond drilling was done in 45 holes. Core size was NQ, although a few holes were collared in HQ and some had to be reduced to BQ. Overburden and some broken ground was drilled by tricone. Three Longyear Super 38 drills were used. The maximum depth of hole was 1947 feet and the minimum depth was 580 feet (drill holes T-122, T-130 and T-147 were abandoned at 320, 400, and 503 feet respectively due to drilling conditions).

The drilling contractor was Thirty-two Albert Crescent Limited (part of the Tonto Group of companies).

Bulldozer work for site preparation and access road construction was done with a D6D Caterpillar bulldozer on contract from Grant Stewart Construction Limited of Watson Lake, Y.T. Assaying of drill core on a 10 foot sample interval was done by Afton Mines Ltd. in Kamloops.

Drill core was logged for geology and recovery. The core was split with half being sent for assay and half stored at Schaft Creek Camp in prefabricated racks.

The number of holes or partial holes reported for assessment work was 14 holes for a total footage of 12,202 feet.

(d) Claims on which work was done

Work recorded was done on the claims listed below, and the work applied to the corresponding groups (See Appendix B).

<u>Claim</u>	<u>Drill Holes</u>	<u>Group</u>	<u>Date Work Recorded</u>
Schaft	T-118,T-121,T-124 T-130,T-132	Hickman	Aug. 19, 1980
Bird 2	T-119,T-122,T-125	A	July 29, 1980
Bird 3	T-110	Sue	July 29, 1980
Bird 4	T-114, T-116	Sue	July 29, 1980
Sno 7	T-117,T-120	Camp	July 21, 1980
Gav 68 Fr	T-123	Camp	July 21, 1980

Map of drill hole locations relative to claim boundaries is attached to this report as Map 2. The claim groupings are shown on the property claim map Map 1.

TECHNICAL DATA AND INTERPRETATION
(See Appendix A and Map 2)

Copies of diamond drill logs showing lithology, survey data, assays, etc. are attached as Appendix A. A half split of all core recovered is stored in core racks at Schaft Creek camp, the remainder having been sent to Afton Mines Ltd. for copper and molybdenite assaying and preparation of beads for gold and silver assays.

Due to the voluminous data collected from the 1980 drilling program, compilation and interpretation of the results is not expected to be complete until approximately March 1981. Interpretations and conclusions made from the incomplete data available at this time could be misleading or erroneous. However, preliminary indications are that the mineralized zone has been extended to the north and partly to the west, that the intrusive breccia is more extensive to the north than originally thought, and that a significant re-interpretation of previous geological concepts of the deposit may have to be made.

Respectfully submitted,



A. I. Betmanis, P.Eng.

December 10, 1980

Vancouver, B. C.

STATEMENT OF QUALIFICATIONS

I, Andris I. Betmanis, do hereby certify that:

I am a geologist residing at 1988 Arroyo Court, North Vancouver, B. C., and employed by Teck Explorations Ltd.;

I am a graduate of the University of Toronto with a B.A.Sc. degree in Applied Geology;

I am a registered member of the Association of Professional Engineers of the Province of British Columbia;

I have practiced my profession in geology continuously since 1965, and since 1970 in British Columbia;

From May to November, 1980 I supervised the diamond drilling exploration program on the Schaft Creek deposit described in this report, on behalf of Teck Corporation.



A. I. Betmanis, P.Eng.
December 10, 1980

DIAMOND DRILL RECORD

PROPERTY Schaft Creek

HOLE No. T-110

DIP TEST		
Footage	Angle	
	Reading	Corrected
Collar 1000	-90°	-90° -89°

Hole No. T-110 Sheet No. 1 of 2 Lat. 22,906.18 N Total Depth 1000'
 Section 23,000 N Dep. 10,517.03 E Logged By J. Jenks
 Date Begun June 12, 1980 Bearing Claim BIRD 3
 Date Finished June 18, 1980 Elev. Collar 3337.0' Core Size NQ

DEPTH	DESCRIPTION	SAMPLE No.	WIDTH OF SAMPLE				
0 - 40.0	OVERBURDEN						
40.0 - 109.0	FRAGMENTAL ANDESITE; strongly altered, light green to grey, orange (Kspar?) altered zones						
109.0 - 137.9	AUGITE PORPHYRY DYKE, medium greenish grey, 30% by volume chloritized mafics						
137.9 - 505.0	METAVOLCANIC, PROBABLE FRAGMENTAL ANDESITE; intensely altered, healed fractures, variable colour from greenish grey to orange, well mineralized with chalcopyrite, bornite, moly.						
505.0 - 530.0	ANDESITIC CONGLOMERATE (?), BRECCIA AND GRIT.						
530.0 - 570.0	FELDSPAR-QUARTZ LATITE PORPHYRY light pink to buff, med. grained, thin qtz healed stockworks common.						
570.0 - 703.0	ANDESITIC CONGLOMERATE, BRECCIA, GRIT med. to dk green, variable grain size, sub-angular rock fragments in f.g. altered epidote and chlorite rich matrix.						
703.0 - 720.0	PLAGIOCLASE RICH ANDESITE; med. grained, green, approx 60% plagioclase, some epidote, trace to minor sulphides						

DIAMOND DRILL RECORD

PROPERTY

HOLE No. T-110

DIP TEST		
Angle		
Footage	Reading	Corrected

Hole No. Sheet No. 2 of 2 Lat. Total Depth

Section Dep. Logged By

Date Begun Bearing Claim

Date Finished Elev. Collar Core Size

DEPTH	DESCRIPTION	SAMPLE No.	WIDTH OF SAMPLE			
720.0 - 740.6	FELDSPAR PORPHYRY (LATITE) with some included PLAGIOCLASE RICH ANDESITE ; greenish white to pink, fine hairline stockwork healed with chlorite, biotite, tr bornite, cp.					
740.6 - 799.0	PLAGIOCLASE RICH ANDESITE ; as above					
799.0 - 860.0	ANDESITIC BRECCIA AND CONGLOMERATE ; dk grey to green, med to coarse grained, angular lithic fragments approx 30% of volume					
860.0 - 880.0	CONTACT BRECCIA ; 10-60% angular clasts of pink/orange felsite dyke in dk green fine grained altered matrix					
880.0 - 886.0	FRAGMENTAL ANDESITE					
886.0 - 930.0	CONTACT BRECCIA ; as above.					
930.0 -	FRAGMENTAL ANDESITE ; light to medium green, breccia texture					
-1000.0	END OF HOLE					

DIAMOND DR. RECORD

PROPERTY Schoft CreekHOLE No. T-117

DIP TEST		
	Angle	
Footage	Reading	Corrected
Collar		-90°
1417'		-87½°

Hole No. T-117 Sheet No. 1 of 2Lat. 25,994.11 NTotal Depth 1417'Section 26,000 NDep. 8,500.55 ELogged By J. JenksDate Begun June 26, 1980

Bearing

Claim SNO 7Date Finished July 3, 1980Elev. Collar 3034.1'Core Size NQ

DEPTH	DESCRIPTION	SAMPLE No.	WIDTH OF SAMPLE				
0 - 23	OVERBURDEN						
23 - 99	ANDESITE; med. to dk grey, very fine grained, possible tuff, pyritic at top, inc cp w. depth.						
99 - 121	QUARTZ-FELDSPAR PORPHYRY; 50% 1-2mm plag. phenoxsts, 15% qtz, fg. pink feldspathized matrix, patches chloritized biotite, qtz-py-cp ults.						
121 - 130	ANDESITE; as above, with qtz-fspar porph. stringers.						
130 - 498	QUARTZ-FELDSPAR PORPHYRY; as above, increasing molybdenite, diss. cp, minor py, variable tourmaline						
498 - 504	ANDESITE; f.g. dk green, xenolith.						
504 - 515	QUARTZ-FELDSPAR PORPHYRY; as above						
515 - 540	ANDESITE; dk grn, xenolith(?)						
540 - 690	BRECCIA; andesite and qtz-fspar porphyry frags w. inc qtz-fspar with depth, matrix lt. greenish grey to orange-pink w. qtz, py and tourmaline in matrix.						
690 - 1049	META-ANDESITE; grn, very fine grained, crackle brecciated at top of section, feldspathized and clay altered; qtz, chl, hem veinlets w. cp, py.						
1049 - 1077	AUGITE PORPHYRY; dk green, med. grained, 45% augite phenoxsts altered to chlorite.						

DIAMOND DRILL RECORD

PROPERTY Schaft Creek

HOLE No. T-118

DIP TEST		
		Angle
Footage	Reading	Corrected
Collar 956		-90° -89°

Hole No. T-118 Sheet No. 1
 Section 29,000 N
 Date Begun June 29, 1980
 Date Finished July 5, 1980

Lat. 29,007.99 N
 Dep. 7,024.79 E
 Bearing _____
 Elev. Collar 3179.4'

Total Depth 956'
 Logged By J. Stritychuk
 Claim SCHAFT
 Core Size NQ

DEPTH	DESCRIPTION	SAMPLE No.	WIDTH OF SAMPLE			
0 - 35	OVERBURDEN					
35 - 163	QUARTZ DIORITE; med. grained, Kspar in matrix, poss secondary, ep. and MnOx alteration, minor malachite staining.					
163 - 219	ANDESITE; dk green, augite and plaq. phenoxite, med grained, mod cp and mo in fractures					
219 - 307	BRECCIA; white-grey to pink, frags. of above andesite, cp predom in matrix.					
307 - 320	FRAGMENTAL ANDESITE AND TUFF, dk grey-green, ep stringers.					
320 - 414	PORPHYRITIC ANDESITE; fspar phenoxite vary from close packed to sparse, diss cp and py, pink alteration - Kspar or hem.					
414 - 664	QUARTZ FELDSPAR PORPHYRY BRECCIA; Kspar or hem pink alteration, chloritic matrix, cp in fractures and bbs, py bbs, sulphides decrease with depth.					
664 - 680	DIORITE DYKE; bio-chlorite clusters, some ep.					
680 - 826	QUARTZ FELDSPAR PORPHYRY; mod. fract, wk min.					
826 -	ANDESITES; variable from alt. or diff. flows.					
- 956	END OF HOLE					

DIAMOND DF L RECORD

PROPERTY Schaft CreekHOLE No. T-119

DIP TEST		
Footage	Angle	
	Reading	Corrected
Collar		-55°
811'		-54°

Hole No. T-119 Sheet No. 1 of 2Lat. 24,479.45NTotal Depth 811'Section 24,500NDep. 11,656.13ELogged By J. StritychukDate Begun July 1, 1980Bearing Due EClaim BIRD 2Date Finished July 7, 1980Elev. Collar 3841.4'Core Size N/C

DEPTH	DESCRIPTION	SAMPLE No.	WIDTH OF SAMPLE					
0 - 13	OVERBURDEN							
13 - 33	PORPHYRITIC ANDESITE; variable greenish colour, phenoxsts of fspar and some augite, minor biotite							
33 - 39	BASALT DYKE; dk grn, rounded phenoxsts.							
39 - 98	ANDESITE; lt. to med. grn, finely porphyritic, pink alt. from Kspar or hem.							
98 - 160	FRAGMENTAL ANDESITE; 2-6 mm lithic frags in andesitic matrix; patchy kspar alt.							
160 - 182	PORPHYRITIC ANDESITE; prob. dyke, dk grey matrix w. plag. phenoxsts,							
182 - 279	INTERBEDDED FRAGMENTAL ANDESITE, FINE GRAINED ANDESITE AND PORPHYRITIC ANDESITES; mod. to strongly fractured, py and minor cp, bio alt.							
279 - 288	QUARTZ MONZONITE; grey, porph., diss py.							
288 - 317	FRAGMENTAL ANDESITE; as above, diss py.							
317 - 343	ANDESITE; fine grained, dk grn, py min.							
343 - 408	FELSIC PORPHYRY; bleached, kspar and minor sericite alteration, py.							
408 - 615	FRAGMENTAL ANDESITE; as above, chloritic alteration, some bio alt. with local cp.							

DIAMOND DR. RECORD

PROPERTY Schaft Creek

HOLE No. T-121

DIP TEST		
Footage	Angle	
	Reading	Corrected
Collar		-20°
1073		-90°

Hole No. T-121 Sheet No. 1 of 2 Lat. 28,509.43 N Total Depth 1073'
 Section 28,500 N Dep. 7,583.62 E Logged By J. Stritychuk
 Date Begun July 5, 1980 Bearing _____ Claim SCHAFT
 Date Finished July 12, 1980 Elev. Collar 3206.5' Core Size NQ

DEPTH	DESCRIPTION	SAMPLE No.	WIDTH OF SAMPLE					
0 - 22	OVERBURDEN							
22 - 37	QUARTZ FELDSPAR PORPHYRY BRECCIA; lt. grey to white fragments in minor (5%) matrix.							
37 - 57	ANDESITE; plagioclase rich, slightly porphyritic, chloritic and limonitic fractures.							
57 - (67)	QUARTZ FELDSPAR PORPHYRY BRECCIA; as above.							
67 - 103	FAULT ZONE(?); triconed, no core recovered.							
(103) - 193	QUARTZ FELDSPAR PORPHYRY BRECCIA; as above.							
193 - 198	ANDESITE DYKE; dk grey, fine rounded phenoxists.							
198 - 291	QUARTZ FELDSPAR PORPHYRY BRECCIA; as above.							
291 - 307	ANDESITE DYKE; plagioclase rich; f.g. matrix.							
307 - (351)	QUARTZ FELDSPAR PORPHYRY BRECCIA; as above, increased sericite alteration, increased cp and mo.							
351 - 364	FAULT ZONE(?); lost core, ser. alt. above and below.							
(364) - 711	QUARTZ FELDSPAR PORPHYRY BRECCIA; as above, strong cp min and inc. mo continues, minor small andesite dyke sections.							
711 - 739	FRAGMENTAL ANDESITE; 1/4"-1/2" rounded to subangular frags, kspar alteration.							
739 - 779	ANDESITE; plagioclase rich, f.g. matrix, strong ep. alteration, dec mineralization.							

DIAMOND DRILL RECORD

PROPERTY Schaft Creek

HOLE No. T-123

DIP TEST		
Footage	Angle	
	Reading	Corrected
Collar		-90°
1007'		-90°

Hole No. T-123 Sheet No. 1 of 2
 Section 26,500 N
 Date Begun July 8, 1980
 Date Finished July 13, 1980

Lat. 26,507.63 N
 Dep. 7,748.96 E
 Bearing _____
 Elev. Collar 2969.1'

Total Depth 1057'
 Logged By J. Stritychuk
 Claim GAV 68 FR.
 Core Size NQ

DEPTH	DESCRIPTION	SAMPLE No.	WIDTH OF SAMPLE			
0 - 82	OVERBURDEN					
82 - 165	QUARTZ-FELDSPAR PORPHYRY BRECCIA; qtz-fspar porph frags in andesitic matrix, cp and mo on fract, cp diss and in bbs, chloritic fract.					
165 - 172	ANDESITE DYKE; similar to bx matrix, less mineralized					
172 - 346	QUARTZ-FELDSPAR PORPHYRY BRECCIA; as above, mo increasing w. depth and strong thru unit.					
346 - 385	QUARTZ FELDSPAR PORPHYRY; as frags of above bx, pink to orange (hem?) alt, dec cp and mo.					
385 - 410	QUARTZ FELDSPAR PORPHYRY BRECCIA; as before, strong Kspar alt, inc cp and mo.					
410 - 435	QUARTZ FELDSPAR PORPHYRY; as before.					
435 - 598	ANDESITE BRECCIA; predom and frags, occ qtz-fspar porph frags, in and matrix, rare mo, greatly reduced cp, start of py.					
598 - 771	ANDESITE, possible FRAGMENTAL ANDESITE; vague fragments or alteration remnants, occ cp stringers, ep alt.					
771 - 821	AUGITE PORPHYRY BASALT; approx 30% aug phenoxst in an andesitic or basaltic matrix					

DIAMOND DR L RECORD

PROPERTY Schaft CreekHOLE No. T-124

DIP TEST		
Footage	Angle	
	Reading	Corrected
Collar		-90°
1285'		-76°

Hole No. T-124 Sheet No. 1 of 2Lat. 29,012.31 NTotal Depth 1285'Section 29,000 NDep. 7,990.39 ELogged By J. JenksDate Begun July 13, 1980

Bearing

Claim SCHAFTDate Finished Aug. 6, 1980Elev. Collar 3447.9'Core Size NQ

DEPTH	DESCRIPTION	SAMPLE No.	WIDTH OF SAMPLE					
0 - 89	OVERBURDEN							
89 - 126	QUARTZ-FELDSPAR PORPHYRY; pink to white, med. grained, 10% subrounded qtz phenoxst, matrix alt ser-clay, 15% mafics alt to bio and chlorite							
126 - (167)	ANDESITE DYKE; dk grey to grn, v. fine grained, occ. sections w. small plag. phenoxst.							
169 - 224	NO RECOVERY; very fractured, section triconed.							
(224) - (253)	QUARTZ-FELDSPAR PORPHYRY; as above, diss cp and bo, minor moly.							
253 - 305	NO RECOVERY; very fractured, section triconed.							
(305) - 309	ANDESITE DYKE; v. fine grained, dk green.							
309 - 425	QUARTZ-FELDSPAR PORPHYRY; as before, very strong arg. alteration.							
425 - 434	QUARTZ-FELDSPAR PORPHYRY CATACLAST; completely sheared and crushed with some bx texture and chloritic matrix.							
434 - 614	CATACLASTIC QUARTZ-FELDSPAR PORPHYRY BRECCIA similar to above, more pronounced bx.							
614 - 647	QUARTZ FELDSPAR PORPHYRY BRECCIA; subangular to subrounded qtz-fspar porph. intrusive fragments in fine grained chloritic matrix.							

DIAMOND D. L RECORD

PROPERTY Schaft CreekHOLE No. T-125

DIP TEST		
Footage	Angle	
	Reading	Corrected
Collar		-90°
1363'		-90°

Hole No. T-125 Sheet No. 1 of 2Lat. 25,490.42 NTotal Depth 1363'Section 25,500 NDep. 11,690.54 ELogged By J. JenksDate Begun July 13, 1980

Bearing

Claim BIRD 2Date Finished July 31, 1980Elev. Collar 3968.8'Core Size HQ/NQ

DEPTH	DESCRIPTION	SAMPLE No.	WIDTH OF SAMPLE				
0 - 28	OVERBURDEN						
28 - 122	META-ANDESITE; fine grained, dk grey to green, mafics, partly chlor. and bio alt, minor py and ep on fract.						
122 - 142	DIORITE PORPHYRY DYKE; fine grained, 40% pseudomorphs ser-clay-ep. after plag, and 20% anhedral bio-chl in dk grn. matrix.						
142 - 164	SEDIMENTARY FRAGMENTAL ANDESITE; 20% rounded to subrounded frags in greenish ser-carb-chl matrix of rounded sand size lithic andesite.						
164 - 200	ANDESITE; 70% plag in dk green groundmass, qtz-calcite fract. fillings.						
200 - 223	FRAGMENTAL ANDESITE; dk grey fg. matrix with rounded lithic frags.						
223 - 236	DIORITE PORPHYRY DYKE; similar to before.						
236 - 298	ANDESITE; fine grained, dk grey to grn.						
298 - 309	DIORITE DYKE; fine grained, dk grn, occ. rounded greenish qtz amygdules.						
309 - 619	ANDESITE; fine grained as before, very minor py and ep on fract, qb and calcite filled fract.						

DIAMOND D. L RECORD

PROPERTY

HOLE No. T-125

DIP TEST		
	Angle	
Footage	Reading	Corrected

Hole No. Sheet No. 2 of 2 Lat. Total Depth.
 Section Dep. Logged By.
 Date Begun Bearing Claim
 Date Finished Elev. Collar. Core Size

DEPTH	DESCRIPTION	SAMPLE No.	WIDTH OF SAMPLE			
619 - 634	DIORITE DYKE; banded, fine to v. fine grained alternating bands dk grey and lt. to med grey, patchy chlorite alt.					
634 - 640	ANDESITE; fine grained as before					
640 - 662	DIORITE DYKE; similar to above, less banded.					
662 - 747	ANDESITE; fine grained as before.					
747 - 773	QUARTZ FELDSPAR PORPHYRY; whitish to pinkish orange, med. grained, felsic, minor chloritized mafics, diss py.					
773 - 891	ANDESITE; fine grained, dk green					
891 - 903	DIORITE DYKE INTRUSIONS; dk grn, f. grained, plag. phenoxists.					
903 - 1057	ANDESITE; fine grained, as before, increasing K-spar alteration with depth.					
1057 - 1250	REWORKED ANDESITE TUFF; fine grained lath shaped lithic frags, and rounded particles.					
1250 -	ANDESITE; fine grained, as before.					
- 1363	END OF HOLE.					

DIAMOND DI L RECORD

PROPERTY Schaft CreekHOLE No. T-132

DIP TEST		
Footage	Angle	
	Reading	Corrected
Collar		-90°
1947		-77°

Hole No. T-132 Sheet No. 1 of 4Lat. 28,489.30 NTotal Depth 1947'Section 28,500 NDep. 8,029.70 ELogged By A. MARTON/P. FOLKDate Begun August 12, 1980

Bearing

Claim SCHAFTDate Finished August 26, 1980Elev. Collar 3352.1'Core Size NA/BQ

DEPTH	DESCRIPTION	SAMPLE No.	WIDTH OF SAMPLE				
0 - 194	OVERBURDEN						
194 - (240)	QUARTZ MONZONITE; med. grained, equigranular, salmon pink, matrix chloritized, cp and mo on fract.						
240 - 300	NO RECOVERY; very broken, triconed.						
(300) - 333	QUARTZ MONZONITE; as above, tr bo.						
333 - 351	ANDESITE; porphyritic, carbonate alt, magnetic, py disc cubes and in fract.						
351 - 387	QUARTZ MONZONITE; as above, antlerite-gypsum veining.						
387 - 409	ANDESITE; porphyritic, as above.						
409 - 427	QUARTZ MONZONITE; as above.						
427 - 436	ANDESITE; as above.						
436 - 711	QUARTZ MONZONITE; as above, minor tourm, esp. in narrow bx zones, inc mo on fract, disc cp and bo.; fract., shear and gouge zones frequent.						
711 - 733	DIORITE; fine grained, very dk grey-green.						
733 - 750	QUARTZ MONZONITE; as above, strongly sheared.						
750 - 804	MIXED LITHOLOGIES; mixed intrusions of basalt, diorite and qtz monzonite in altered volcanics, possibly fragmental andesite; andesite may be altered remnant blocks; frequent gouge zones.						

DIAMOND D. L RECORD

PROPERTY

HOLE No. T-132.....

DIP TEST		
Footage	Angle	
	Reading	Corrected

Hole No. Sheet No. 2 of 4 Lat. Total Depth.....
 Section..... Dep..... Logged By.....
 Date Begun..... Bearing..... Claim.....
 Date Finished..... Elev. Collar..... Core Size.....

DEPTH	DESCRIPTION	SAMPLE No.	WIDTH OF SAMPLE			
804 - 831	QUARTZ MONZONITE; fine to med. grained, pink and green patchy alt., strongly fractured, silicified, qtz veinlets.					
831 - 838	BRECCIA; 90% qtz-fspar porph and 10% meta-andesite frags in grey-brn. f.g. alt. matrix.					
838 - 851	META-ANDESITE; fine grained, gyp-ca. on fract.					
851 - 878	GRANODIORITE PORPHYRY; fine to med grained, grey to lt. pink, strongly alt, ser, gyp, andankerite.					
878 - 899	ANDESITE DYKES (post-min.) intruding GRANODIORITE and META-ANDESITE; ser, ankerite, gypsum and calcite on fract.					
899 - 926	GRANODIORITE; fine to med grained, slightly porphyritic, chloritized mafics, similar to before.					
926 - 947	GRANODIORITE BRECCIA; as above but brecciated and healed, 90% clasts.					
947 - 971	GRANODIORITE; as above.					
971 - 1009	BRECCIA; 90% clasts of granodiorite, feldspar porphyry and minor metavolcs. in greenish granodioritic matrix, well min w. bq, cp, mo.					
1009 - 1041	MIXED GRANODIORITE, FELSITE and FELDSPAR PORPHYRY; diss bq, dec. cp, mo on fract.					

DIAMOND D. L RECORD

PROPERTY

HOLE No. T-132

DIP TEST		
Footage	Angle	
	Reading	Corrected

Hole No. Sheet No. 3 of 4 Lat. Total Depth.....
 Section..... Dep..... Logged By.....
 Date Begun..... Bearing..... Claim.....
 Date Finished..... Elev. Collar..... Core Size.....

DEPTH	DESCRIPTION	SAMPLE No.	WIDTH OF SAMPLE			
1041 - 1054	BRECCIA; as before.					
1054 - 1067	ANDESITE DYKE; fine grained, bean on frags, minor cp near contacts.					
1067 - 1119	BRECCIA; similar to before, frags inc to 95%					
1119 - 1173	AUGITE PORPHYRY DYKE; aug. phenoxists alt to serpentine, diss mag, carbonate and gypsum stringers, minor cp and no min on frags.					
1173 - 1256	GRANODIORITE; similar to before, K-spar altered to gtz monzonite 1196-1229.					
1256 - 1262	GRANODIORITE BRECCIA; 95% chloritized gd. frags in chloritic matrix					
1262 - 1270	META-ANDESITE; fine grained, brecciated					
1270 - 1284	GRANODIORITE; med. grained, porphyritic					
1284 - 1389	BRECCIA; predom porphyritic gd frags, lesser felsite and metavolcanic frags, in approx 25% f.g. altered andesitic matrix; 5% gtz, minor tourmaline; very well mineralized w. cp, bo, no.					
1389 - 1410	HEALED FAULT ZONE; gouge and rv frags.					
1410 - 1417	BRECCIA; as above					
1417 - 1429	FRAGMENTAL ANDESITE; strongly altered, pinkish grn; inc. gtz vltts.					

DIAMOND DI L RECORD

PROPERTY

HOLE No. T-132

DIP TEST		
Footage	Angle	
	Reading	Corrected

Hole No. Sheet No. 4 of 4 Lat. Total Depth.....
 Section..... Dep..... Logged By.....
 Date Begun..... Bearing..... Claim
 Date Finished..... Elev. Collar..... Core Size

DEPTH	DESCRIPTION	SAMPLE No.	WIDTH OF SAMPLE			
1429 - 1493	BRECCIA; as before but dec. min.					
1493 - 1510	ANDESITIC TUFF; altered, < 2mm frags in f.g. matrix.					
1510 - 1531	PORPHYRITIC GRANODIORITE DYKE SWARMS IN ALTERED ANDESITIC TUFFS; complex contacts, minor qtz v. stockwork with kspar envelopes.					
1531 - 1720	BRECCIA; as before, silicified, weak min.					
1720 - 1753	MIXED PORPHYRITIC GRANODIORITE, ALTERED FINE GRAINED ANDESITES AND ANDESITE TUFFS. siliceous, qtz stringers, chloritized mafics.					
1753 - 1784	COMPACT BRECCIA AND CONGLOMERATE (?); clastic texture, altered, f.g. magnetic matrix.					
1784 - 1863	FELDSPAR PORPHYRY DYKE; green, ep and clay alt., prob porph andesite, v. weak min.					
1863 - 1880	BRECCIA; as above.					
1880 - 1920	FELDSPAR PORPHYRY DYKE; as above					
1920 -	BRECCIA; as above, inc volc frag proportion					
- 1947	END OF HOLE					

APPENDIX B I and B II

CLAIM DATA AND
STATEMENTS OF EXPLORATION DEVELOPMENT

TECK CORP. - LIARD

GROUP NAME Liard Claims AREA Schaft Creek
 TOWNSHIP _____ MINING DIV. Liard
 PROVINCE British Columbia JOB NO. _____ NTS NO. _____

Agreement date:		
Amt. or Nature	Date Due	Action

Page No. TC-164
 Total claims 93
 Revised 31 AUG 80
 Sheet No. 3 of 8

IDENTIFICATION	* DATE RECORDED	DUE DATE	UNDER EXTN.	AMOUNT DUE	ASSESSMENT WORK FILED-YEARS					RECORD NO.	GROUP	
					1980							
Bird 1	01 Aug 57	01 Aug 90		\$200	2 yrs					6585	SUE	ACCEPTANCE OF 1980 WORK TO COME
Bird 2	"	"			2					6586	A	
Bird 3	"	"			2					6587	SUE	
Bird 4	"	"		PER	2					6588	SUE	
Bud 1	18 Sep 64	18 Sep 90			6					15160	CRIMP	
Bud 2	"	"			6					15161	CRIMP	
Bud 3	"	"		CLAIM	6					15162	CRIMP	
Bud 4	"	"			6					15163	CRIMP	
Bud 5	"	"			6					15164	CRIMP	
Bud 6	"	"			6					15165	CRIMP	
Bud 7	"	"			6					15166	CRIMP	
Bud 8	"	"		PER	6					15167	CRIMP	
Bud 9	"	"			6					15168	CRIMP	
Bud 10	"	"			6					15169	CRIMP	
Bud 13	18 Sep 64	18 Sep 90			6					15172	CRIMP	
Bud 14	"	"			6					15173	SUE	
Bud 15	"	"		YEAR	6					15174	CRIMP	
Bud 16	"	"			6					15175	SUE	
Bud 17	"	"			6					15176	CRIMP	

* Time for filing assessment work is calculated from this date.

RECORDED OWNER TECK CORP. Licence _____ Decl. of Trust on file _____ Abstracts on file _____ Renewal _____
 OTHER TERMS OF AGREEMENT _____ Excess Credits _____ Balance excess _____

TECK CORP. - LIARD

GROUP NAME LIARD CLAIMS AREA Schaft Creek
 TOWNSHIP _____ MINING DIV. Liard
 PROVINCE British Columbia JOB NO. _____ NTS NO. _____

Agreement date:		
Amt. or Nature	Date Due	Action

Page No. TC-164

Total claims 93

Revised 31 AUG 0

Sheet No. 4 of 8

IDENTIFICATION	* DATE RECORDED	DUE DATE	UNDER EXTN.	AMOUNT DUE	ASSESSMENT WORK FILED					RECORD NO.	GROUP
					1980						
Bud 18	18 Sep 64	18 Sep 90		\$200	6 yrs.					15177	SUF
Bud 25	29 Oct 64	29 Oct 90			5					15957	CAMP
Bud 26	"	"			5					15958	CAMP
Bud 27	"	"			5					15959	SUF
Bud 28	"	"		WORK	5					15960	SUF
Bud 29	26 Jun 67	26 Jun 90			2					27079	A
Bud 30	"	"			2					27080	A
Bud 31	26 Jun 67	26 Jun 90		PER	5					27081	A
Bud 32	"	"			5					27082	A
Bud 33	26 Jun 67	26 Jun 90			6					27083	A
Bud 34	"	"		CLAIM	6					27084	A
Bud 111	12 Oct 67	12 Oct 90			6					28755	CAMP
Bud 112	"	"		PER	6					28756	CAMP
Bud 119	12 Oct 67	12 Oct 90			6					28757	CAMP
Bud 120	"	"		YEAR	6					28758	SUF

* Time for filing assessment work is calculated from this date.

Excess Credits _____

RECORDED OWNER Teck Corp. Licence _____ Decl. of Trust on file _____ Abstracts on file _____ Renewal _____

OTHER TERMS OF AGREEMENT _____ Balance excess _____

TECK CORP - LIARD

GROUP NAME Liard Claims AREA Schaft Creek
 TOWNSHIP _____ MINING DIV. Liard
 PROVINCE British Columbia JOB NO. _____ NTS NO. _____

Agreement date:		
Amt. or Nature	Date Due	Action

Page No. TC-164
 Total claims 93
 Revised 21 AUG 80
 Sheet No. 5 of 8

IDENTIFICATION	* DATE RECORDED	DUE DATE	UNDER EXTN.	AMOUNT DUE	ASSESSMENT WORK FILED-YEARS					RECORD NO.	GROUP
					1980						
Bud 121	12 Oct 67	12 Oct 90		\$200	6 yrs.					28759	CAMP
Bud 122	"	"			6					28760	SUE
Bud 123	"	"			6					28761	CAMP
Bud 124	"	"			6					28762	SUE
Gav 1	23 Mar 66	12 Mar 90		WORK	6					21671	CAMP
Gav 2	"	"			2					21672	CAMP
Gav 3	"	"			5					21673	CAMP
Gav 4	"	"			6					21674	CAMP
Gav 5	"	"			5					21675	CAMP
				PER							
Gav 6	23 Mar 66	23 Mar 90			6					21676	CAMP
Gav 7	"	"			6					21677	CAMP
Gav 8	"	"			6					21678	CAMP
Gav 9	"	"		CLAIM	6					21679	CAMP
Gav 16	23 Mar 66	23 Mar 90			6					21686	Hickman
Gav 17	"	" 90			6					21687	Hickman
				PER							
Gav 21	23 Mar 66	23 Mar 90			6					21691	Hickman
Gav 22	"	" 90		YEAR	6					21692	Hickman

* Time for filing assessment work is calculated from this date.

RECORDED OWNER TECK CORP. Licence _____ Decl. of Trust on file _____ Abstracts on file _____ Renewal _____ Excess Credits _____

OTHER TERMS OF AGREEMENT _____ Balance excess _____

TECK CORP - LIARD

GROUP NAME Liard Claims AREA Schaft Creek
 TOWNSHIP _____ MINING DIV. Liard
 PROVINCE British Columbia JOB NO. _____ NTS NO. _____

Agreement date:		
Amt. or Nature	Date Due	Action

Page No. TC-164

Total claims 93

Revised 31 AUG 80

Sheet No. 6 of 8

IDENTIFICATION	* DATE RECORDED	DUE DATE	UNDER EXTN.	AMOUNT DUE	ASSESSMENT WORK FILED-YEARS					RECORD NO.	GROUP
					1986						
Gav 23	23 Mar 66	23 Mar 90		\$200	6					21693	Hickman
Gav 56	23 Mar 66	23 Mar 90			2					21726	SUE
Gav 58	23 Mar 66	23 Mar 90		WORK	2					21728	SUE
Gav 60	23 Mar 66	23 Mar 85								21730	
Gav 62	23 Mar 66	23 Mar 85		PER						21732	
Gav 66	23 Mar 66	23 Mar 90			2					21736	CAMP
Gav 67 FR	23 Mar 66	23 Mar 90			2					21737	CAMP
Gav 68 FR	"	"			2					21738	CAMP
				YEAR							
ID 1 FR	21 Jul 66	21 Jul 90			2					23301	CAMP
ID 2 FR	"	"			2					23302	CAMP
ID 3 FR	02 Aug 66	02 Aug 90		PER	2					23630	SUE
ID 4 FR	"	"			2					23631	SUE
ID 5 FR	"	"		CLAIM	2					23632	CAMP

* Time for filing assessment work is calculated from this date.

Excess Credits _____

RECORDED OWNER Teck Corp.

Licence _____ Decl. of Trust on file _____

Abstracts on file _____

Renewal _____

OTHER TERMS OF AGREEMENT _____

Balance excess _____

TECK CORP. - LIARD

GROUP NAME Liard Claims AREA Schaft Creek
 TOWNSHIP _____ MINING DIV. Liard
 PROVINCE British Columbia JOB NO. _____ NTS NO. _____

Agreement date:		
Amt. or Nature	Date Due	Action

Page No. TC-164

Total claims 93

Revised 31 AUG 80

Sheet No. 7 of 8

IDENTIFICATION	* DATE RECORDED	DUE DATE	UNDER EXTN.	AMOUNT DUE	ASSESSMENT WORK FILED-YEARS					RECORD NO.	GROUP
					1980						
ID 6 FR	02 Aug 66	02 Aug 90		\$200	5 yrs					23633	crimp
ID 7 FR	02 Aug 66	02 Aug 90			2					23634	Hickman
ID 9 FR	02 Aug 66	02 Aug 88		WORK						23636	
ID 10 FR	"	" 90			2					23637	Hickman
ID 11 FR	"	" 90			2					23638	Hickman
NOV 1	14 Dec 65	14 Dec 88		PER						20205	
NOV 2	"	"								20206	
NOV 3	"	"								20207	
NOV 4	"	"								20208	
				YEAR							
NOV 5	14 Dec 65	14 Dec 90			2					20209	Hickman
NOV 6	14 Dec 65	14 Dec 85		PER						20210	
NOV 7	"	" 90			5					20211	Hickman
NOV 8	"	" 85								20212	
SNO 1	16 Jun 64	16 Jun 90		CLAIM	2					13973	Hickman
SNO 2	"	" 90			2					13974	Hickman

* Time for filing assessment work is calculated from this date.

RECORDED OWNER Teck Corp.

Licence _____

Decl. of Trust on file _____

Abstracts on file _____

Excess Credits _____

Renewal _____

OTHER TERMS OF AGREEMENT _____

Balance excess _____

TECK CORP. - LIARD

GROUP NAME Liard Claims AREA Schaft Creek
 TOWNSHIP _____ MINING DIV. Liard
 PROVINCE British Columbia JOB NO. _____ NTS NO. _____

Agreement date:		
Amt. or Nature	Date Due	Action

Page No. TC-164

Total claims 93

Revised 21 AUG 80

Sheet No. 8 of 8

IDENTIFICATION	* DATE RECORDED	DUE DATE	UNDER EXTN.	AMOUNT DUE	ASSESSMENT WORK FILED-YEARS					RECORD NO.	GROUP
					1980						
SNO 3	16 Jun 64	16 Jun 90		\$200	2					13975	Hickman
SNO 4	"	" 90			2					13976	Hickman
SNO 5	"	" 90			2					13977	SUE
SNO 6	"	" 90			2					13978	SUE
SNO 7	"	" 90			2					13979	CHMP
SNO 8	"	" 90		WORK	2					13980	CHMP
SNO 9	16 Jun 64	16 Jun 90			2					13981	A
SNO 10	"	" 90			2					13982	A
SNO 11	"	" 90		PER	2					13983	A
SNO 12	"	" 90			2					13984	A
SNO 13	"	" 90			2					13985	SUE
SNO 14	"	" 90			2					13986	SUE
SNO 15	"	" 90		YEAR	2					13987	CHMP
SNO 16	"	" 90			2					13988	CHMP
				PER							
				CLAIM							

* Time for filing assessment work is calculated from this date.

RECORDED OWNER Teck Corp. Licence _____ Decl. of Trust on file _____ Abstracts on file _____ Renewal _____
 OTHER TERMS OF AGREEMENT _____ Excess Credits _____ Balance excess _____

TECK CORP - HECLA

GROUP NAME Hecla Claims AREA Schaft Creek
 TOWNSHIP _____ MINING DIV. Liard
 PROVINCE British Columbia JOB NO. _____ NTS NO. _____

Agreement date: <u>See Summary TC-164</u>		
Amt. or Nature	Date Due	Action

Page No. TC-164-1
 Total claims 358
 Revised 21 AUGUST 80
 Sheet No. 1 of 21

IDENTIFICATION	* DATE RECORDED	DUE DATE	UNDER EXTN.	AMOUNT DUE	ASSESSMENT WORK FILED				Record No.	GROUP	
					JULY 1980						
Von 1	17 Apr. 68	17 Apr. 90		\$200	6	yes			30064	A	<i>Receipts of 1980 work to come</i>
Von 2	"	" 90			6			30065	A		
Von 3	"	" 84						30066			
Von 4	"	" 84						30067			
Von 5	17 Apr. 68	17 Apr. 90		WORK	5				30068	Sue	
Von 6	17 Apr. 68	17 Apr. 90			2				30069	Sue	
Von 7	17 Apr. 68	17 Apr. 90			6				30070	A	
Von 8	"	" 84		PER					30071		
Von 9	"	" 84							30072		
Von 10	"	" 84							30073		
Von 11	"	" 84							30074		
Von 12	"	" 84		CLAIM					30075		
Von 13	"	" 84							30076		
Von 14	"	" 84							30077		
Von 15	"	" 84		PER					30078		
Von 16	17 Apr. 68	17 Apr. 84							30079		
Von 17	"	" 84		YEAR					30080		

* Time for filing assessment work is calculated from this date.

RECORDED OWNER Teck Corporation Licence _____ Decl. of Trust on file _____ Abstracts on file _____ Renewal _____
 OTHER TERMS OF AGREEMENT _____ Excess Credits _____ Balance excess _____

TECK CORP - HECLA

GROUP NAME Hecla Claims AREA Schaft Creek
 TOWNSHIP _____ MINING DIV. Liard
 PROVINCE British Columbia JOB NO. _____ NTS NO. _____

Agreement date: See Summary TC-164		
Amt. or Nature	Date Due	Action

Page No. TC-164-1

Total claims 358

Revised _____

Sheet No. 8 of 21

IDENTIFICATION	* DATE RECORDED	DUE DATE	UNDER EXTN.	AMOUNT DUE	ASSESSMENT WORK FILED				Record No.	GROUP
					JULY 1980					
A 1	7 Jul. 71	7 Jul. 84		\$200					51305	
A 2	"	" 90			6				51306	A
A 3	"	" 84							51307	
A 4	"	" 90			6				51308	A
A 5	"	" 84		WORK					51309	
A 6	"	" 84							51310	
A 7	"	" 84							51311	
A 8	"	" 84							51312	
A 9	"	" 84		PER					51313	
A 10	"	" 84							51314	
A 11	"	" 90			6				51315	A
A 12	"	" 90			6				51316	A
				CLAIM						
A 13	7 Jul. 71	7 Jul. 90			7				51317	A
A 14	"	" 90			7				51318	A
A 15	"	" 90			7				51319	A
A 16	"	" 90		PER	7				51320	A
A 17	"	" 90			7				51321	A
A 18	"	" 90			7				51322	A
A 19	"	" 90			7				51323	A
A 20	"	" 90		YEAR	7				51324	A

* Time for filing assessment work is calculated from this date.

Excess Credits _____

RECORDED OWNER Teck Corporation

Licence _____

Decl. of Trust on file _____

Abstracts on file _____

Renewal _____

OTHER TERMS OF AGREEMENT _____

Balance excess _____

TECK CORP - HECLA

GROUP NAME Hecla Claims AREA Schaft Creek
 TOWNSHIP _____ MINING DIV. Liard
 PROVINCE British Columbia JOB NO. _____ NTS NO. _____

Agreement date: See Summary TC-164		
Amt. or Nature	Date Due	Action

Page No. TC-164-1

Total claims 358

Revised _____

Sheet No. 9 of 21

IDENTIFICATION	* DATE RECORDED	DUE DATE	UNDER EXTN.	AMOUNT DUE	ASSESSMENT WORK FILED					Record No.	GROUP
					JULY 1970						
A 21	7 Jul. 71	7 Jul. 90		\$200	6 yrs					51325	A
A 22	"	" 90			6					51326	A
A 23	"	" 90			7					51327	A
A 24	"	" 90		WORK	7					51328	A
A 25	"	" 90			7					51329	A
A 26	"	" 90			7					51330	A
A 27	"	" 90			7					51331	A
A 28	"	" 90		PER	7					51332	A
A 29	"	" 90			7					51333	A
A 30	"	" 90			7					51334	A
A 31	7 Jul. 71	7 Jul. 90		CLAIM	6					51335	A
A 33	7 Jul. 71	7 Jul. 90			7					51337	A
A 35	7 Jul. 71	7 Jul. 90		PER	7					51339	A
A 37	7 Jul. 71	7 Jul. 90			7					51340	A
BB 1	16 Mar. 70	16 Mar. 74		YEAR						42403	

* Time for filing assessment work is calculated from this date.

Excess Credits _____

RECORDED OWNER TECK CORPORATION

Licence _____

Decl. of Trust on file _____

Abstracts on file _____

Renewal _____

OTHER TERMS OF AGREEMENT _____

Balance excess _____

TECK CORP - HECLA

GROUP NAME Hecla Claims AREA Schaft Creek
 TOWNSHIP _____ MINING DIV. Liard
 PROVINCE British Columbia JOB NO. _____ NTS NO. _____

Agreement date: See Summary TC-164		
Amt. or Nature	Date Due	Action

Page No. TC-164-1

Total claims 358

Revised 31 AUG. 80

Sheet No. 12 of 21

IDENTIFICATION	* DATE RECORDED	DUE DATE	UNDER EXTN.	AMOUNT DUE	ASSESSMENT WORK FILED					Record No.	GROUP
					July 1980						
BB 102	16 Mar. 70	16 Mar. 84		\$200						42504	
Sue 1	13 Mar. 69	13 Mar. 90			6					35763	Sue
Sue 2	"	" 90			6					35764	Sue
Sue 3	"	" 90		WORK	6					35765	Sue
Sue 4	"	" 90			6					35766	Sue
Sue 5 FR.	13 Mar. 69	13 Mar. 90			6					35767	Sue
				PER							
Sue 6	13 Mar. 69	13 Mar. 90			6					35768	Sue
Sue 7	"	" 90			6					35769	Sue
Sue 8	"	" 90			6					35770	Sue
Sue 9	"	" 90		CLAIM	6					35771	Sue
Sue 10	"	" 90			6					35772	Sue
Sue 11	"	" 90			6					35773	Sue
Sue 12	"	" 90			6					35774	Sue
Sue 13	"	" 90		PER	6					35775	Sue
Sue 14	"	" 90			6					35776	Sue
Sue 15	"	" 90			6					35777	Sue
Dave 1 FR	11 Aug. 70	11 Aug. 81		YEAR						46003	

* Time for filing assessment work is calculated from this date.

RECORDED OWNER Teck Corporation Licence _____ Decl. of Trust on file _____ Abstracts on file _____ Renewal _____ Excess Credits _____

OTHER TERMS OF AGREEMENT _____ Balance excess _____

TECK CORP - HECLA

Agreement date: See Summary TC-164		
Amt. or Nature	Date Due	Action

Page No. TC-164-1

GROUP NAME Hecla Claims AREA Schaft Creek

Total claims 358

TOWNSHIP _____ MINING DIV. Liard

Revised 31 AUG. 80

PROVINCE British Columbia JOB NO. _____ NTS NO. _____

Sheet No. 13 of 21

IDENTIFICATION	* DATE RECORDED	DUE DATE	UNDER EXTN.	AMOUNT DUE	ASSESSMENT WORK FILED					Record No.	GROUP
					AUG 1980						
Dave 2 FR	11 Aug. 70	11 Aug. 84		\$200						46004	
Dave 3 FR	"	" 84								46005	
Dave 4 FR	"	" 84								46006	
Dave 5 FR	"	" 84								46007	
Dave 6 FR	"	" 84		WORK						46008	
Dave 7 FR	"	" 84								46009	
Dave 8 FR	"	" 84								46010	
Dave 9 FR	3 Oct. 73	3 Oct. 84		PER						70659	
Dave 11 FR	10 Aug. 70	10 Aug. 84								46013	
Dave 12 FR	11 Aug. 70	11 Aug. 84		CLAIM						46014	
Dave 13 FR	10 Aug. 70	10 Aug. 84								46015	
Dave 14 FR	11 Aug. 70	11 Aug. 84		PER						46016	
Emu 1 FR	21 Aug. 69	21 Aug. 84								39474	
Emu 2 FR	21 Aug. 69	21 Aug. 90		YEAR	2					39475	Hickman

Excess Credits _____

RECORDED OWNER Teck Corporation

Licence _____ of Trust on file _____

Abstracts on file _____

Renewal _____

OTHER TERMS OF AGREEMENT _____

Balance excess _____

* Time for filing assessment work is calculated from this date.

TECK CORP - HECLA

GROUP NAME Hecla Claims AREA Schaft Creek
 TOWNSHIP _____ MINING DIV. Liard
 PROVINCE British Columbia JOB NO. _____ NTS NO. _____

Agreement date: See Summary TC-164		
Amt. or Nature	Date Due	Action

Page No. TC-164-1
 Total claims 358
 Revised 21 Aug. 80
 Sheet No. 14 of 21

IDENTIFICATION	* DATE RECORDED	DUE DATE	UNDER EXTN.	AMOUNT DUE	ASSESSMENT WORK FILED					Record No.	GROUP
					July 1980						
Emu 3 FR	21 Aug. 69	21 Aug. 85		\$200						39476	
Emu 4 FR	21 Aug. 69	21 Aug. 90			2					39477	Sue
Emu 5 FR	"	" 90			2					39478	Sue
				WORK							
Emu 6 FR	21 Aug. 69	21 Aug. 90			5					39479	Sue
Emu 7 FR	21 Aug. 69	21 Aug. 90			2					39480	Sue
				PER							
Mess 1	16 Mar. 70	16 Mar. 84								42509	
Mess 2	"	" 84								42510	
Mess 3	"	" 84								42511	
Mess 4	"	" 84		CLAIM						42512	
Mess 5	"	" 84								42513	
Mess 6	"	" 84								42514	
Mess 7	"	" 84								42515	
Mess 8	"	" 84		PER						42516	
Mess 9	"	" 84								42517	
Mess 10	"	" 84								42518	
Mess 11	16 Mar. 70	16 Mar. 84		YEAR						42519	

* Time for filing assessment work is calculated from this date.

RECORDED OWNER Teck Corporation Licence _____ Decl. of Trust on file _____ Abstracts on file _____ Renewal _____ Excess Credits _____
 OTHER TERMS OF AGREEMENT _____ Balance excess _____

TECK CORP - HECLA

GROUP NAME Hecla Claims AREA Schaft Creek
 TOWNSHIP _____ MINING DIV. Liard
 PROVINCE British Columbia JOB NO. _____ NTS NO. _____

Agreement date: <u>See Summary TC-164</u>		
Amt. or Nature	Date Due	Action

Page No. TC-164-1

Total claims 358

Revised 21 AUG. 80

Sheet No. 18 of 21

IDENTIFICATION	* DATE RECORDED	DUE DATE	UNDER EXTN.	AMOUNT DUE	ASSESSMENT WORK FILED					Record No.	GROUP
					Aug. 1988						
Jack 6	5 Aug. 71	5 Aug. 81		\$200						52149	
LL 21 FR	2 Aug. 71	2 Aug. 84								53018	
LL 22 FR	"	" 84								53019	
				WORK							
Rum 1 FR	21 Aug. 69	21 Aug. 90			6					39484	Hickman
Rum 7	21 Aug. 69	21 Aug. 81								39489	
				PER							
Rum 9	21 Aug. 69	21 Aug. 81								39491	
X-Ray 1	20 Aug. 74	20 Aug. 81								71752	
X-Ray 2	"	" 84		CLAIM						71753	
P 1	11 Jun. 74	11 Jun. 81								71311	
P 2	"	" 84								71312	
P 3	"	" 84		PER						71313	
P 5	11 Jun. 74	11 Jun. 84								71315	
P 6	"	" 81								71316	
P 7	"	" 84		YEAR						71317	

* Time for filing assessment work is calculated from this date.

RECORDED OWNER Teck Corporation Licence _____ Decl. of Trust on file _____ Abstracts on file _____ Renewal _____ Excess Credits _____
 OTHER TERMS OF AGREEMENT _____ Balance excess _____



"Sue" Group

MINERAL ACT

SUB-RECORDER RECEIVED JUL 29 1980 VANCOUVER, B.C.

Statement of Exploration and Development

I, Andris I. Betmanis (Name) 1988 Arroyo Court (Address) North Vancouver, B. C. Valid subsisting F.M.C. No. 177464

Agent for Teck Corporation (Name) 1199 West Hastings Street (Address) Vancouver, B. C. Valid subsisting F.M.C. No. 177457

STATE THAT

1. I have done, or caused to be done, work on the Bird 3 and Bird 4 Mineral Claim(s) Record No.(s) 6587 and 6588 Situate at Schaft Creek in the Liard Mining Division, to the value of at least 35,200 dollars. Work was done from the 12th day of June 1980, to the 30 day of June 1980.

2. The following work was done in the 12 months in which such work is required to be done:

(COMPLETE APPROPRIATE SECTION(S) A, B, C, D, FOLLOWING)

A. PHYSICAL (Trenches, open cuts, adits, pits, shafts, reclamation, and construction of roads and trails)

(Give details as required by section 13 of regulations.)

Table with 2 columns: Description, COST. Includes a row for TOTAL PHYSICAL.

B. PROSPECTING (Details in report submitted as per section 9 of regulations.) (The itemized cost statement must be part of the report.)

Table with 2 columns: Description, COST. Includes a row for TOTAL PHYSICAL AND PROSPECTING.

I wish to apply \$..... of this work to the claims listed below.

(State number of years to be applied to each claim and its month of record.)

2676 feet diamond drilling in DDH's T-110, T-114, T-116 @ \$40 per foot.	\$107,040.00
Report to follow in November D. GEOLOGICAL, GEOPHYSICAL, GEOCHEMICAL (Details in report submitted as per section 5, 6, or 7 of regulations.) (The itemized cost statement must be part of the report.) (State type of work in space below.)	
TOTAL OF C AND D	
	\$107,040.00

Who paid for the above-described work? Name Teck Corporation
Address 1199 West Hastings Street
Vancouver, B.C.

Portable Assessment Credits (PAC) Withdrawal Request		AMOUNT
Amount to be withdrawn from owner(s) account(s):		
Name of Owner		
(May be no more than 30 per cent of value of the approved work submitted as assessment work in C and (or) D.)	1.	
	2.	
	3.	
	4.	
TOTAL WITHDRAWAL		
TOTAL OF C AND (OR) D PLUS PAC WITHDRAWAL		

I wish to apply \$ 35,200 of this work to the claims listed below.
(State number of years to be applied to each claim and its month of record.)
See attached list.

Value of work to be credited to portable assessment credit (PAC) account(s).
(May only be credited from the approved value of C and (or) D not applied to claims.)

Name		AMOUNT
In owner(s) name.	1.	
	2.	
	3.	
In operator(s) name (person paying for the work).	1.	
	2.	
	3.	

Alberta
(Signature of Applicant)

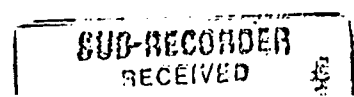

NAME OF CLAIM	No. of Units	Record No. or Lot No.	Month of Record	SIGNATURE OF DIVISION YEARS WORK	Free Miner's Certificate No.
Bird 1		6585	Aug	2	
Bird 3		6587	Aug	2	
Bird 4		6588	Aug	2	
Sno 5		13977	Jun	2	
Sno 6		13978	Jun	2	
Sno 13		13985	Jun	2	
Sno 14		13986	Jun	2	
Id 3 Fr		23630	Aug	2	
Id 4 Fr		23631	Aug	2	
Emu 4 Fr		39477	Aug	2	
Emu 5 Fr		39478	Aug	2	
Emu 6 Fr		39479	Aug	5	
Emu 7 Fr		39480	Aug	2	
Gaw 56		21726	Mar	2	
Gaw 58		21728	Mar	2	
Von 5		30068	Apr	5	
Von 6		30069	Apr	2	
Bud 14		15173	Sep	6	
Bud 15		15175	Sep	6	
Bud 18		15177	Sep	6	
Bud 27		15959	Oct	5	
Bud 28		15960	Oct	5	
Bud 120		28758	Oct	6	
Bud 122		28760	Oct	6	
Bud 124		28763	Oct	6	
Sue 1		35763	Mar	6	
Sue 2		35764	Mar	6	
Sue 3		35765	Mar	6	
Sue 4		35766	Mar	6	
Sue 5 Fr		35767	Mar	6	
Sue 6		35768	Mar	6	
Sue 7		35769	Mar	6	
Sue 8		35770	Mar	6	
Sue 9		35771	Mar	6	
Sue 10		35772	Mar	6	
Sue 11		35773	Mar	6	
Sue 12		35774	Mar	6	
Sue 13		35775	Mar	6	
Sue 14		35776	Mar	6	
P. 15		35777	Mar	6	

SUB-RECORDER
 RECEIVED
 JUL 29 1990
 M.P. #
 VANCOUVER, B.C.



NOTICE TO GROUP

SUB-RECORDER
RECEIVED

JUL 29 1980

Mining Division LIARD Location SCHAFT CREEK M.R.# S.....
 Name of group SUE Map No. 104 G/6, 7
 VANCOUVER, B.C.

We, the undersigned owners* of the following adjoining mineral claims, desire to group them according to the provisions of the *Mineral Act*:—

NAME OF CLAIM	No. of Units	Record No. or Lot No.	Month of Record	SIGNATURE OF OWNER*	Free Miner's Certificate No.
Bird 1		6585	Aug		
Bird 3		6587	Aug		
Bird 4		6588	Aug		
Sno 5		13977	Jun		
Sno 6		13978	Jun		
Sno 13		13985	Jun		
Sno 14		13986	Jun		
Id 3 Fr		23630	Aug		
Id 4 Fr		23631	Aug	<i>A. I. Betmanis</i> A. I. Betmanis	177464
Emu 4 Fr		39477	Aug	For	
Emu 5 Fr		39478	Aug	Teck Corporation	177457
Emu 6 Fr		39479	Aug		
Emu 7 Fr		39480	Aug		
Gav 56		21726	Mar		
Gav 58		21728	Mar		
Van 5		30068	Apr		
Van 6		30069	Apr		
Bud 14		15173	Sep		
Bud 16		15175	Sep		
Bud 18		15177	Sep		
Bud 27		15959	Oct		
Bud 28		15960	Oct		
Bud 120		28758	Oct		
Bud 122		28760	Oct		
Bud 124		28763	Oct		
Sue 1		35763	Mar		
Sue 2		35764	Mar		
Sue 3		35765	Mar		
Sue 4		35766	Mar		
Sue 5 Fr		35767	Mar		
Sue 6		35768	Mar		
Sue 7		35769	Mar		
Sue 8		35770	Mar		
Sue 9		35771	Mar		
Sue 10		35772	Mar		
Sue 11		35773	Mar		
Sue 12		35774	Mar		
Sue 13		35775	Mar		

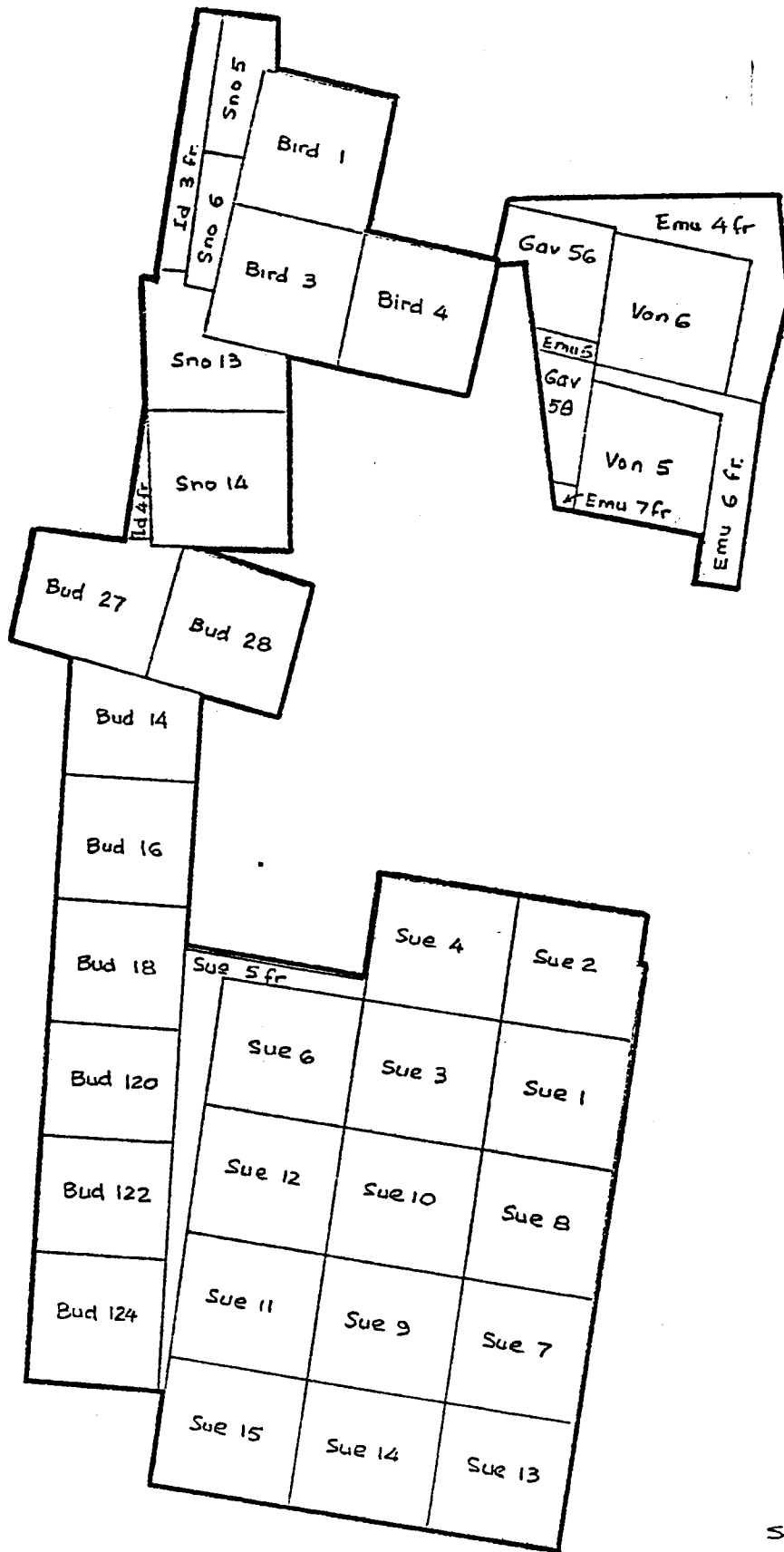

SUE GROUP
 SCHAFT CREEK, B.C.
 GROUPED JULY 29, 1980
 1" = 2000'

1831 feet diamond drilling (DDH E-119, T-122, T-125)
@ \$40/foot

\$73,240.00

Report to follow
D. GEOLOGICAL, GEOPHYSICAL, GEOCHEMICAL
(Details in report submitted as per section 5, 6, or 7 of regulations.)
(The itemized cost statement must be part of the report.)
(State type of work in space below.)

TOTAL OF C AND D

\$73,240.00

Who paid for the above-described work? Name Teck Corporation
Address 1199 West Hastings Street
Vancouver, B. C.

Portable Assessment Credits (PAC) Withdrawal Request		AMOUNT
Amount to be withdrawn from owner(s) account(s):		
	Name of Owner	
(May be no more than 30 per cent of value of the approved work submitted as assessment work in C and (or) D.)	1.	
	2.	
	3.	
	4.	
		TOTAL WITHDRAWAL
		TOTAL OF C AND (OR) D PLUS PAC WITHDRAWAL

I wish to apply \$ 45,800 of this work to the claims listed below.
(State number of years to be applied to each claim and its month of record.)

See attached list

Value of work to be credited to portable assessment credit (PAC) account(s).
(May only be credited from the approved value of C and (or) D not applied to claims.)

		Name	AMOUNT
In owner(s) name.	1.		
	2.		
	3.		
In operator(s) name (person paying for the work).	1.		
	2.		
	3.		

A. Retnam
(Signature of Applicant)

SUB-RECORDER
RECEIVED

NAME OF CLAIM	No. of Units	Record No. or Lot No.	Month of Record	SIGNATURE OF OWNER YEARS WORK	Free Miner's Certificate No.
BIRD 2		6586	Aug	2	
SNO 9		13981	Jun	2	
SNO 10		13982	Jun	2	
SNO 11		13983	Jun	2	
SNO 12		13984	Jun	2	
BUD 29		27079	Jun	2	
BUD 30		27080	Jun	2	
BUD 31		27081	Jun	5	
BUD 32		27082	Jun	5	
BUD 33		27083	Jun	6	
BUD 34		27084	Jun	6	
VON 1		30064	Apr	6	
VON 2		30065	Apr	6	
VON 7		30070	Apr	6	
A 2		51306	Jul	6	
A 4		51308	Jul	6	
A 11		51315	Jul	6	
A 12		51316	Jul	6	
A 13		51317	Jul	7	
A 14		51318	Jul	7	
A 15		51319	Jul	7	
A 16		51320	Jul	7	
A 17		51321	Jul	7	
A 18		51322	Jul	7	
A 19		51323	Jul	7	
A 20		51324	Jul	7	
A 21		51325	Jul	6	
A 22		51326	Jul	6	
A 23		51327	Jul	7	
A 24		51328	Jul	7	
A 25		51329	Jul	7	
A 26		51330	Jul	7	
A 27		51331	Jul	7	
A 28		51332	Jul	7	
A 29		51333	Jul	7	
A 30		51334	Jul	7	
A 31		51335	Jul	6	
A 33		51337	Jul	7	
A 35		51339	Jul	7	
A 37		51341	Jul	7	

SUB-RECORDER
RECEIVED
JUL 29 1990
M.P. #
VANCOUVER, B.C.



RECEIVED
JUL 29 1960

NOTICE TO GROUP

M.R. # S
VANCOUVER, B.C.

Mining Division Liard Location Schaft Creek

Name of group A Map No. 104 G/6, 7

We, the undersigned owners* of the following adjoining mineral claims, desire to group them according to the provisions of the *Mineral Act*:-

NAME OF CLAIM	No. of Units	Record No. or Lot No.	Month of Record	SIGNATURE OF OWNER*	Free Miner's Certificate No.
Bird 2		6586	Aug		
Sno 9		13981	Jun		
Sno 10		13982	Jun		
Sno 11		13983	Jun		
Sno 12		13984	Jun		
Bud 29		27079	Jun	<i>A. I. Betmanis</i>	
Bud 30		27080	Jun	A. I. Betmanis	177464
Bud 31		27081	Jun	For	
Bud 32		27082	Jun	Teck Corporation	177457
Bud 33		28983	Jun		
Bud 34		27084	Jun		
Von 1		30064	Apr		
Von 2		30065	Apr		
Von 7		30070	Apr		
A 2		51306	Jul		
A 4		51308	Jul		
A 11		51315	Jul		
A 12		51316	Jul		
A 13		51317	Jul		
A 14		51318	Jul		
A 15		51319	Jul		
A 16		51320	Jul		
A 17		51321	Jul		
A 18		51322	Jul		
A 19		51323	Jul		
A 20		41324	Jul		
A 21		51325	Jul		
A 22		51326	Jul		
A 23		51327	Jul		
A 24		51328	Jul		
A 25		51329	Jul		
A 26		51330	Jul		
A 27		51331	Jul		
A 28		51332	Jul		
A 29		51333	Jul		
A 30		51334	Jul		
A 31		51335	Jul		
A 33		51337	Jul		

"A" GROUP
 SCHAFT CREEK, B.C.
 GROUPED JULY 29, 1980
 1" = 2000'

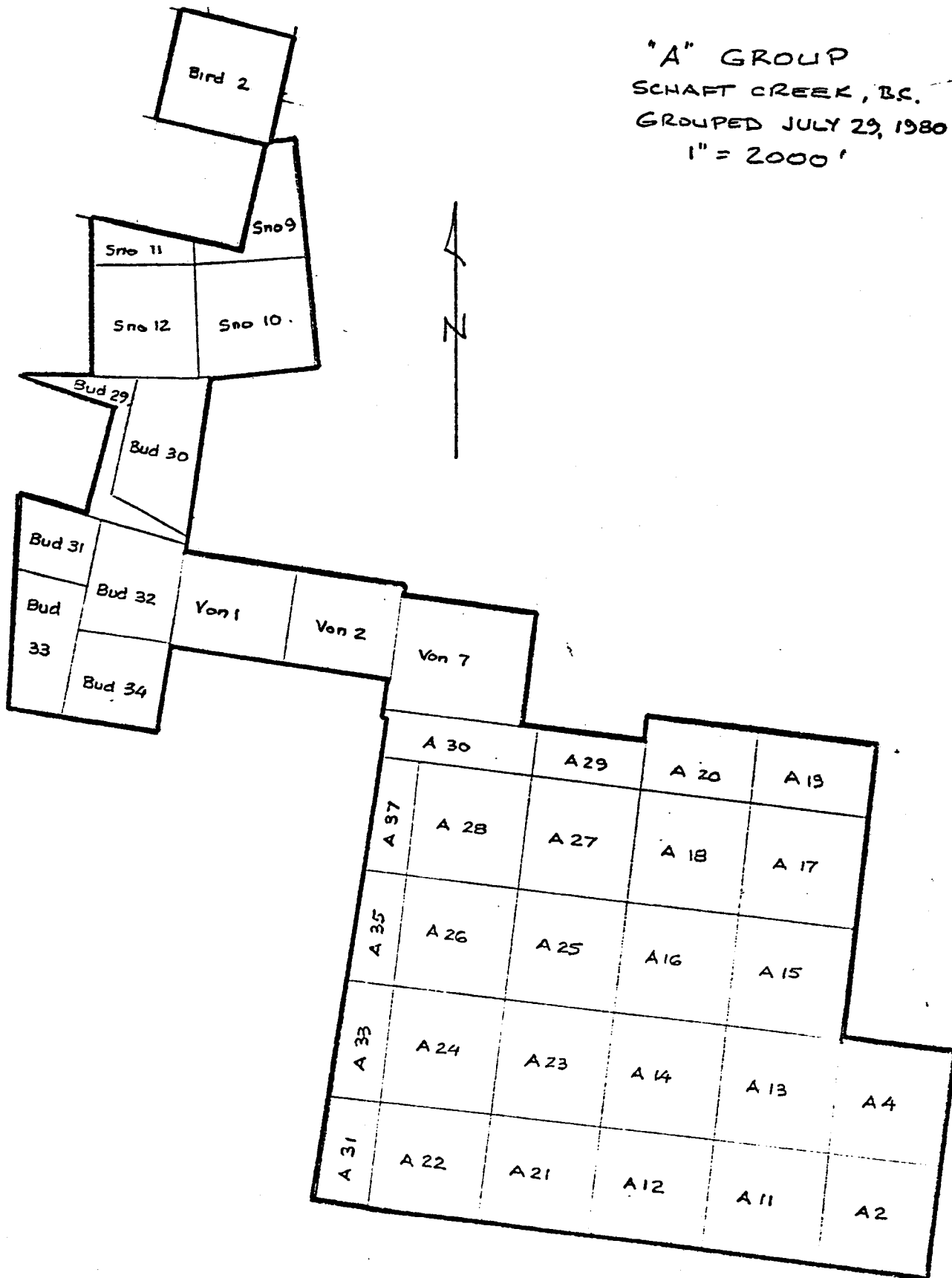

C. DRILLING (Details in report submitted as per section 8 of regulations.)
 (The itemized cost statement must be part of the report.)

3,681 feet in holes T-117, 120, 123 @ \$40/ft.

COST

\$147,240

REPORT TO FOLLOW

D. GEOLOGICAL, GEOPHYSICAL, GEOCHEMICAL

(Details in report submitted as per section 5, 6, or 7 of regulations.)
 (The itemized cost statement must be part of the report.)
 (State type of work in space below.)

TOTAL OF C AND D

\$147,240

Who paid for the above-described work? Name Teck Corporation
 Address 1199 West Hastings Street
Vancouver, B. C.

Portable Assessment Credits (PAC) Withdrawal Request

AMOUNT

Amount to be withdrawn from owner(s) account(s):

Name of Owner

(May be no more than 30 per cent of value of the approved work submitted as assessment work in C and (or) D.)

1. _____
2. _____
3. _____
4. _____

TOTAL WITHDRAWAL

TOTAL OF C AND (OR) D PLUS PAC WITHDRAWAL

I wish to apply \$ 38,200 of this work to the claims listed below.

(State number of years to be applied to each claim and its month of record.)

- See attached list

Value of work to be credited to portable assessment credit (PAC) account(s).

(May only be credited from the approved value of C and (or) D not applied to claims.)

Name

AMOUNT

In owner(s) name.

1. _____
2. _____
3. _____

In operator(s) name
(person paying for the work).

1. _____
2. _____
3. _____

Albertmann
 (Signature of Applicant)

Name of group CAMP Map No. 104 G/6, 7
 We, the undersigned owners* of the following adjoining mineral claims, desire to group them according to the provisions of the *Mineral Act*:—

NAME OF CLAIM	No. of Units	Record No. or Lot No.	Month of Record	Years Work YEARS WORK	Free Miner's Certificate No.
GAV 67 Fr	/	21737	Mar	2	
GAV 68 Fr	/	21738	"	2	
Gav 1	/	21671	"	6	
Gav 2	/	21672	"	2	
Gav 3	/	21673	"	5	
Gav 4	/	21674	"	6	
Gav 5	/	21675	"	5	
Gav 6	/	21676	"	6	
Gav 7	/	21677	"	6	
Gav 8	/	21678	"	6	
Gav 9	/	21679	"	6	
Gav 66	/	21736	"	2	
Sno 7	/	13979	Jun	2	
Sno 8	/	13980	"	2	
Sno 15	/	13987	"	2	
Sno 16	/	13988	"	2	
Id 1 Fr	/	23301	Jul	2	
Id 2 Fr	/	23302	"	2	
Id 5 Fr	/	23632	Aug	2	
Id 6 Fr	/	23633	"	5	
Bud 1	/	15160	Sep	6	
Bud 2	/	15161	"	6	
Bud 3	/	15162	"	6	
Bud 4	/	15163	"	6	
Bud 5	/	15164	"	6	
Bud 6	/	15165	"	6	
Bud 7	/	15166	"	6	
Bud 8	/	15167	"	6	
Bud 9	/	15168	"	6	
Bud 10	/	15169	"	6	
Bud 13	/	15172	"	6	
Bud 15	/	15174	"	6	
Bud 17	/	15176	"	6	
Bud 25	/	15957	Oct	5	
Bud 26	/	15958	"	5	
Bud 111	/	28755	"	6	
Bud 112	/	28756	"	6	
Bud 119	/	28757	"	6	
Bud 121	/	28759	"	6	
Bud 123	/	28761	"	6	

* May be signed by agent on behalf of owner.



JUL 21 1980

NOTICE TO GROUP

M.R. #..... S.....

VANCOUVER, B.C.

Mining Division.....Liard..... Location.....Schaff Creek.....

Name of group.....CAMP..... Map No. 104 G/6, 7

We, the undersigned owners* of the following adjoining mineral claims, desire to group them according to the provisions of the Mineral Act:—

NAME OF CLAIM	No. of Units	Record No. or Lot No.	Month of Record	SIGNATURE OF OWNER*	Free Miner's Certificate No.
GAV 67 Fr		21737	Mar		
GAV 68 Fr		21738	"		
Gav 1		21671	"		
Gav 2		21672	"		
Gav 3		21673	"	<i>A. I. Betmanis</i>	
Gav 4		21674	"	A. I. Betmanis	177464
Gav 5		21675	"	for	
Gav 6		21676	"	Teck Corporation	177457
Gav 7		21677	"		
Gav 8		21678	"		
Gav 9		21679	"		
Gav 66		21736	"		
Sno 7		13979	Jun		
Sno 8		13980	"		
Sno 15		13987	"		
Sno 16		13988	"		
Id 1 Fr		23301	Jul		
Id 2 Fr		23302	"		
Id 5 Fr		23632	Aug		
Id 6 Fr		23633	"		
Bud 1		15160	Sep		
Bud 2		15161	"		
Bud 3		15162	"		
Bud 4		15163	"		
Bud 5		15164	"		
Bud 6		15165	"		
Bud 7		15166	"		
Bud 8		15167	"		
Bud 9		15168	"		
Bud 10		15169	"		
Bud 13		15172	"		
Bud 15		15174	"		
Bud 17		15176	"		
Bud 25		15957	Oct		
Bud 26		15958	"		
Bus 111		28755	"		
Bud 112		28756	"		
Bud 119		28757	"		
Bud 121		28759	"		

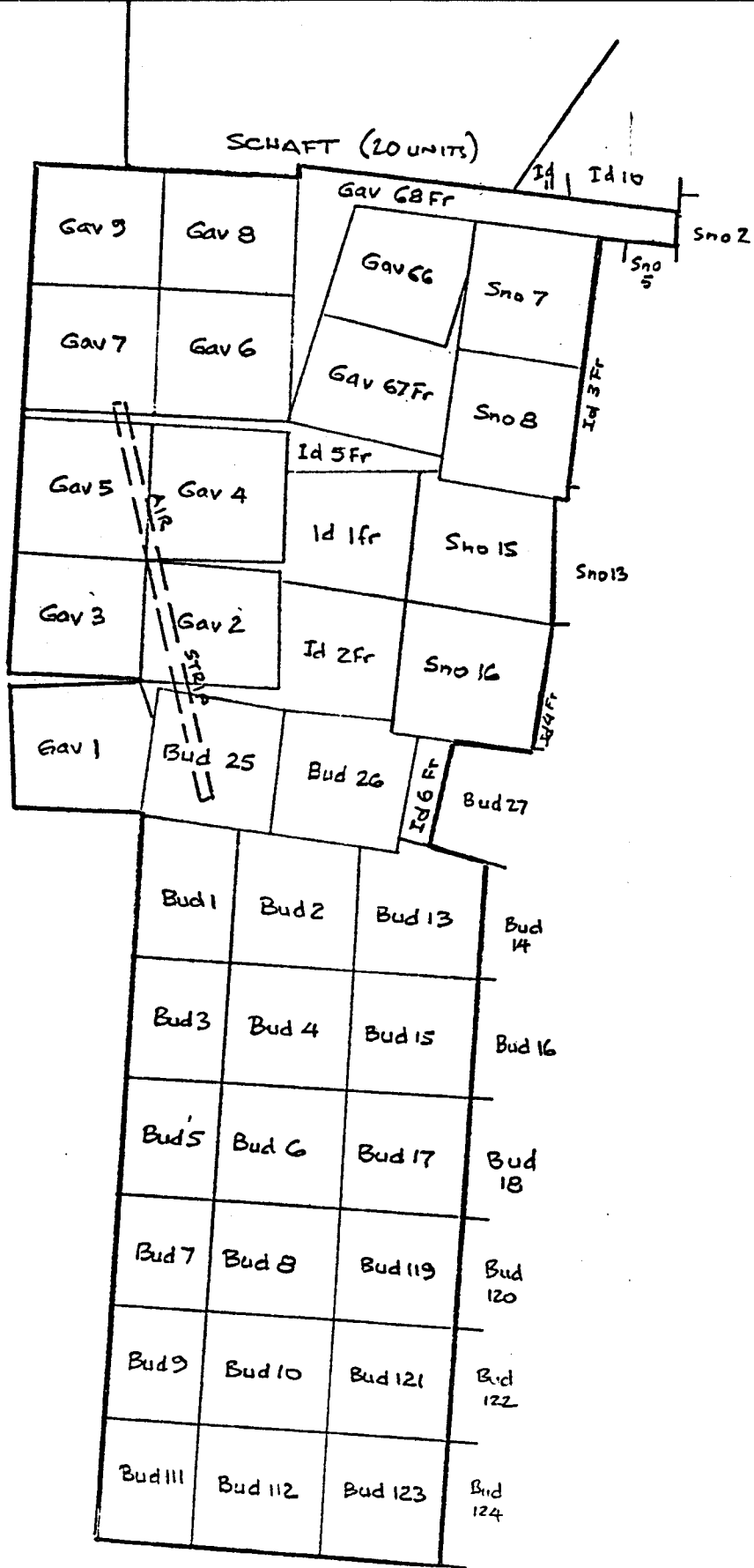
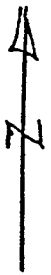

CAMP GROUP
SCHAFT CREEK B.C.
GROUPED 22 JULY 1980
1" = 2000'



Statement of Exploration and Development

I, Andris I. Betmanis (Name) 1988 Arroyo Court (Address) North Vancouver, B.C.

Agent for Teck Corporation (Name) 1199 W. Hastings Street (Address) Vancouver, B.C.

Valid subsisting F.M.C. No. 177464

Valid subsisting F.M.C. No. 177457

STATE THAT

1. I have done, or caused to be done, work on the Schaft Mineral Claim(s)

Record No.(s) 520

Situate at Schaft Creek in the Liard Mining Division, to the value of at least \$600.00 dollars. Work was done from the 26th day of June 1980, to the 15th day of August 1980.

2. The following work was done in the 12 months in which such work is required to be done:

(COMPLETE APPROPRIATE SECTION(S) A, B, C, D, FOLLOWING)

A. PHYSICAL (Trenches, open cuts, adits, pits, shafts, reclamation, and construction of roads and trails)

(Give details as required by section 13 of regulations.)

Table with 2 columns: Description, COST. Includes a row for TOTAL PHYSICAL.

B. PROSPECTING (Details in report submitted as per section 9 of regulations.) (The itemized cost statement must be part of the report.)

Table with 2 columns: Description, COST. Includes a row for TOTAL PHYSICAL AND PROSPECTING.

I wish to apply S of this work to the claims listed below.

(State number of years to be applied to each claim and its month of record.)

(The itemized cost statement must be part of the report.)		COST
4014 feet diamond drilling (DDH's T-118, T-121, T-124, T-130 and T-132) @ \$40/foot		\$160,560.00
Report to follow in November		
D. GEOLOGICAL, GEOPHYSICAL, GEOCHEMICAL		
(Details in report submitted as per section 5, 6, or 7 of regulations.)		
(The itemized cost statement must be part of the report.)		
(State type of work in space below.)		
TOTAL OF C AND D		\$160,560.00

Who paid for the above-described work? Name Teck Corporation
 Address 1199 West Hastings Street
Vancouver, B.C.

Portable Assessment Credits (PAC) Withdrawal Request		AMOUNT
Amount to be withdrawn from owner(s) account(s):		
Name of Owner		
(May be no more than 30 per cent of value of the approved work submitted as assessment work in C and (or) D.)	1.	
	2.	
	3.	
	4.	
TOTAL WITHDRAWAL		
TOTAL OF C AND (OR) D PLUS PAC WITHDRAWAL		

I wish to apply \$ 600.00 of this work to the claims listed below.
 (State number of years to be applied to each claim and its month of record.)
3 years - Nov 7 (2011) - December

.....

.....

.....

.....

Value of work to be credited to portable assessment credit (PAC) account(s).
 (May only be credited from the approved value of C and (or) D not applied to claims.)

Name		AMOUNT
In owner(s) name.	1.	
	2.	
	3.	
In operator(s) name (person paying for the work).	1.	
	2.	
	3.	

 (Signature of Applicant)

NAME OF CLAIM	No. of Units	Record No. or Lot No.	MONTH of Record	RECORD NO. YEARS WORK	Free Miner's Certificate No.
HICKMAN	4	<i>AVG</i> 520624	AUG.	46 (10 YRS. PER UNIT)	
SCHAFT	20	624520	OCT.	160 (8 YRS. PER UNIT)	
SNO 1	1	13973	JUN	2	
SNO 2	1	13974	JUN	2	
SNO 3	1	13975	JUN	2	
SNO 4	1	13976	JUN	2	
NOV 5	1	20209	DEC	2	
NOV 7	1	20211	DEC	2	
GAV 16	1	21686	MAR	6	
GAV 17	1	21687	MAR	6	
GAV 21	1	21691	MAR	6	
GAV 22	1	21692	MAR	6	
GAV 23	1	21693	MAR	6	
ID 7 Fr	1	23634	AUG	2	
ID 10	1	23637	AUG	2	
ID 11 Fr	1	23638	AUG	2	
EMU 2 Fr	1	39475	AUG	62 <i>AD.</i>	
RUM 1 Fr	1	39484	AUG	6	

HICKMAN GROUP

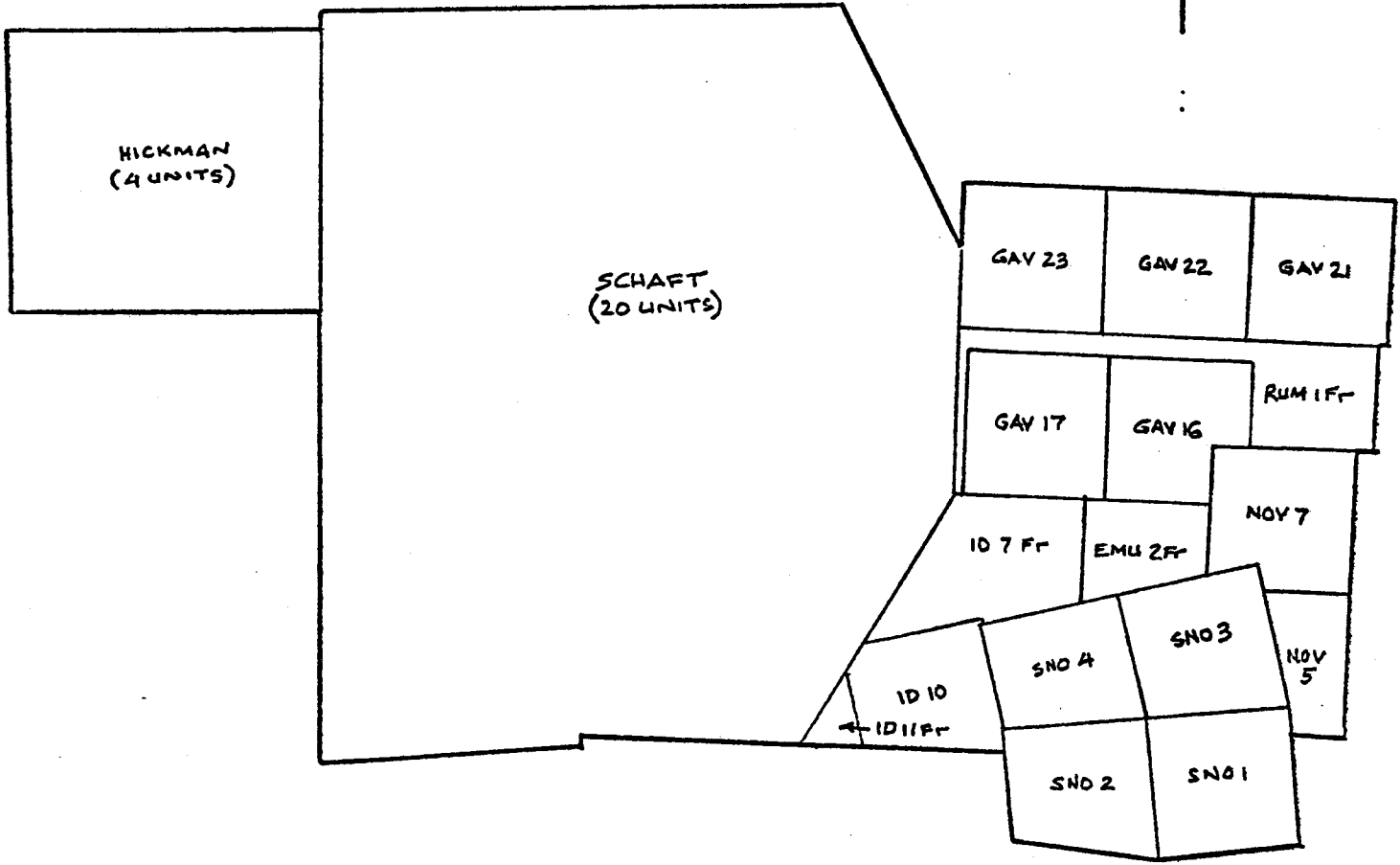
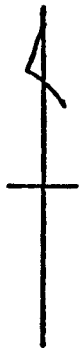

HICKMAN GROUP
SCHAFT CREEK. BC.
GROUPED AUG 17, 1980
1" = 2000'

APPENDIX C

COST OF EXPLORATION

COST OF EXPLORATION

I. PARTIAL ITEMIZED COSTS

A. Basic Drill Hole Charges (Tonto Drilling)

Sue Group

<u>DDH</u>	<u>Feet</u>	<u>\$ Footage</u>	<u>\$ Hourly</u>	<u>\$ Materials</u>	<u>\$ Total</u>	<u>Invoices</u>
T-110	1000	24,000.00	1,182.50	-	25,182.50	4714C, 4725C
T-114	581	13,525.00	2,382.50	2,121.98	18,029.48	4725C
T-116	<u>1095</u>	26,565.00	3,097.50	315.74	<u>29,978.24</u>	4725C
	2676				\$ 73,190.22	or \$27.35/ft.

A. Group

<u>DDH</u>	<u>Feet</u>	<u>\$ Footage</u>	<u>\$ Hourly</u>	<u>\$ Materials</u>	<u>\$ Total</u>	<u>Invoices</u>
T-119	811	19,292.50	3,657.50	721.99	23,671.99	4737C
T-122	320	7,360.00	7,450.00	85.53	14,895.53	4737C
T-125	1363	34,851.00	2,295.00	-	37,126.00	4737C, 4753C, 4766C
	<u>2494</u>				\$ 75,693.52	or \$30.35/ft.

Camp Group

<u>DDH</u>	<u>Feet</u>	<u>\$ Footage</u>	<u>\$ Hourly</u>	<u>\$ Materials</u>	<u>\$ Total</u>	<u>Invoices</u>
T-117	1417	35,259.00	552.50	-	35,811.50	4725C, 4737C
T-120	1207	29,589.00	510.00	-	30,099.00	4737C
T-123	<u>1057</u>	25,539.00	1,637.50	-	<u>27,176.50</u>	4737C
	3681				\$ 93,087.00	or \$25.29/ft.

Hickman Group

<u>DDH</u>	<u>Feet</u>	<u>\$ Footage</u>	<u>\$ Hourly</u>	<u>\$ Materials</u>	<u>\$ Total</u>	<u>Invoices</u>
T-118	956	22,900.00	1,929.50	1,321.15	26,150.65	4725C, 4737C
T-121	1073	25,971.00	2,162.50	1,025.57	29,159.07	4737C
T-124	1285	31,695.00	4,149.50	1,366.50	37,209.00	4737C, 4753C, 4766C
T-130	400	9,200.00	5,731.50	4,321.38	19,252.88	4766C
T-132	<u>1947</u>	50,910.00	3,163.00	711.31	<u>54,784.31</u>	4766C, 4779C
	5661				\$166,555.91	or \$29.42/ft.

B. General Drilling Charges (Tonto Drilling)

<u>Period</u>	<u>Feet Drilled</u>	<u>\$ Charges</u>	<u>Invoice</u>
May 16-31	0	65,204.56	4701C
June 1-15	4767	21,891.53	4714C
June 16-30	7493	36,419.75	4725C
July 1-15	6368	17,486.91	4737C
July 16-31	2954	46,710.42	4753C
August 1-15	5721	1,265.00	4766C
August 16-31	7522	29,734.44	4779C
September 1-15	5188	2,650.00	4790C
September 16-30	4121	55,480.93	4824C, 4813C
October 1-15	3549	5,115.12	4834C
October 16-31	0	19,087.39	4849C
	47,683	\$301,046.05 or \$6.31/foot	

C. Bulldozer Site and Access Work (Grant Stewart Construction Ltd.)

Basic lease applied to work period 12 mos. @ \$4950/month	\$ 59,400.00
Average 10 hours/day for 137 days @ \$44/hour	<u>60,280.00</u>
	\$119,680.00
Apply 80% use on drill moves, sites and access	95,744.00
	= 2.01/foot

D. Aircraft Charter and Freight (Trans Provincial Airlines, Kelowna Flightcraft)

Charges received May 15-October 31	\$ 78,338.84
	= 1.64/foot

E. Assaying (Afton Mines, Chemex Labs)

Includes various gold, silver assays, check assays, excludes pending assays Laboratory charges May 15-October 31	\$ 86,596.45
	= 1.85/foot

F. Living Costs (Cal-Van Catering, camp living supplies, etc.)

Charges from May 15-October 31	\$ 71,058.25
	= 1.45/foot

II. PARTIAL COMPILED COSTS PER FOOT

<u>Group</u>	<u>Charge A</u>	<u>Charge B</u>	<u>Charge C</u>	<u>Charge D</u>	<u>Charge E</u>	<u>Charge F</u>	<u>Total</u>
Sue	27.35	6.31	2.01	1.64	1.82	1.49	\$40.62
A	30.35	6.31	2.01	1.64	1.82	1.49	\$43.62
Camp	25.29	6.31	2.01	1.64	1.82	1.49	\$38.56
Hickman	29.42	6.31	2.01	1.64	1.82	1.49	\$42.69

III. RECORDED WORK

<u>Group</u>	<u>Feet Recorded</u>	<u>Cost per Foot</u>	<u>Total</u>	<u>Amount Claimed</u>
Sue	2676	40.62	108,699.12	35,200.00
A	1831	43.62	79,868.22	45,800.00
Camp	3681	38.56	141,939.36	38,200.00
Hickman	4014	42.69	171,357.66	51,000.00

The above listed costs do not include fuel costs, salaries for all support staff, support travel costs, camp and project costs, compilation costs, etc. The costs are partial costs that are applicalbe to assessment work.

A. I. Betmanis, P.Eng.

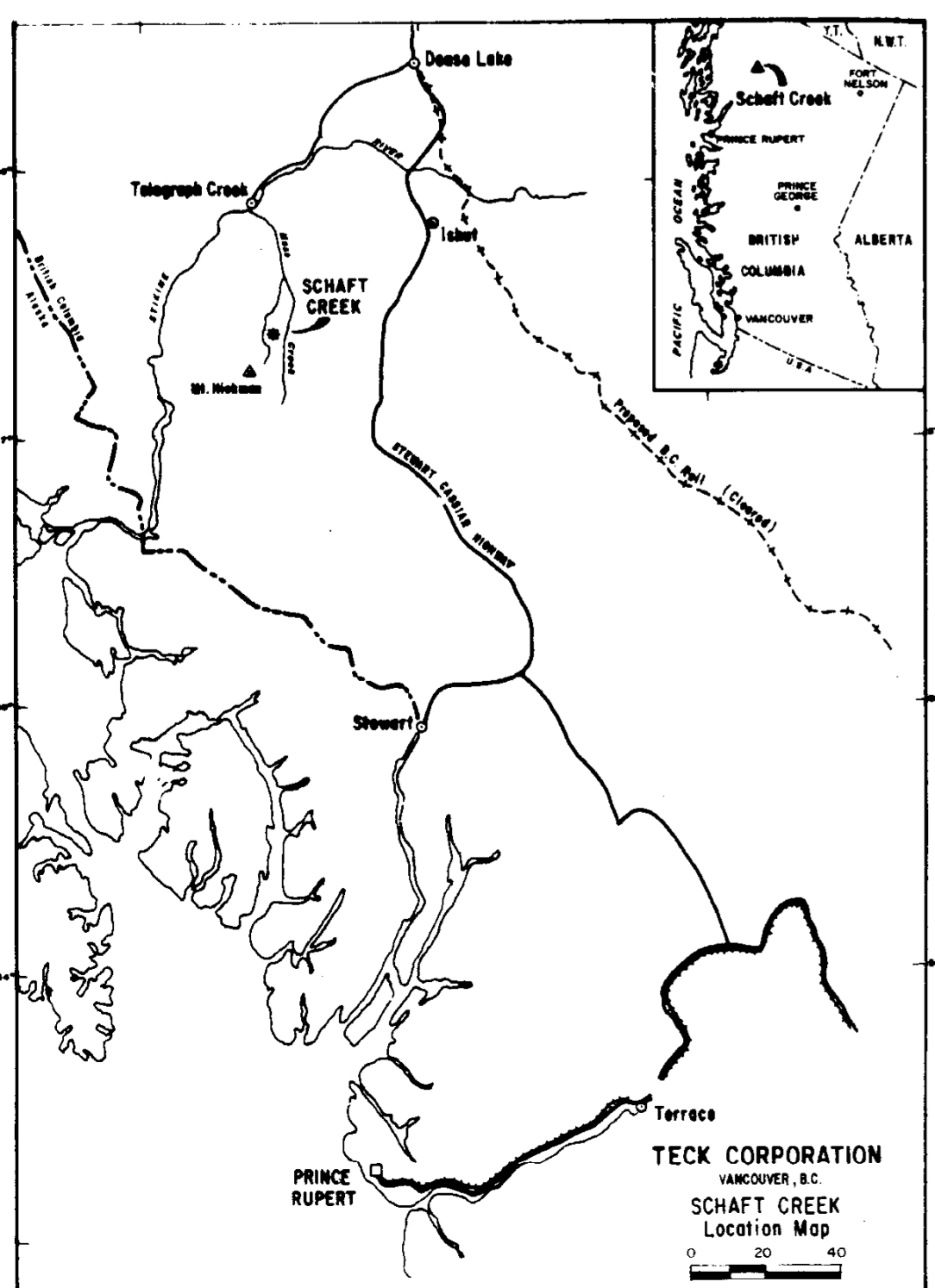
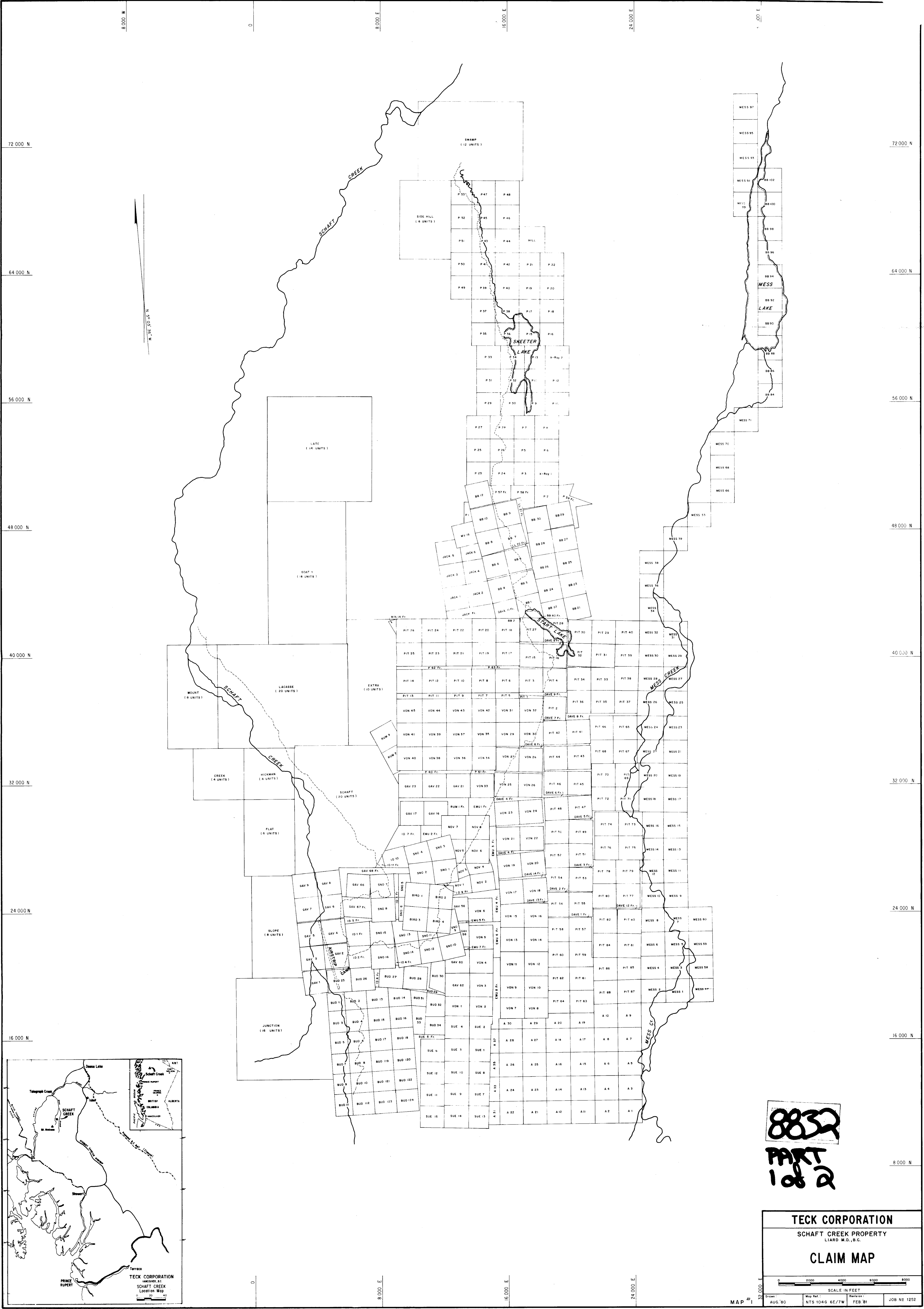

8832
PART
1 of 2

TECK CORPORATION
 SCHAFT CREEK PROPERTY
 LIARD M.D., B.C.
CLAIM MAP

0 2000 4000 6000 8000
 SCALE IN FEET

Drawn: NTS 104-G 6E/7W
 Map Ref.: AUG. 80
 Revision: FEB. 81
 JOB NO. 1252

MAP #1

