

REPORT ON
DIAMOND DRILL PROGRAM
For
FIVE M RESOURCES, INC.
DIK CLAIM
Sayward, Vancouver Island

NANAIMO M.D.

92 L / 1E, 8E 50° 15 N 126° 02.5 W

Vancouver, B.C.
January 9, 1981

By:
E. P. Sheppard, P.Eng.
Consulting Geologist

* * *

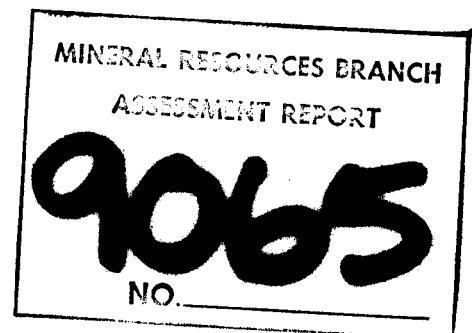

CONTENTS

	<u>Page</u>
INTRODUCTION	1
DRILLING PROGRAM	1, 2, 3
CONCLUSIONS	4

APPENDIX

References

D.D. Plan Scale: 1=1000

D.D. Logs: 80-1, 2, 3, S-4, 5

D.D. Sections " "

Assay Certificate

* *

REPORT ON
DIAMOND DRILL PROGRAM
For
FIVE M RESOURCES, INC.

INTRODUCTION

A diamond drill program consisting of 1500 ft. of BQ wireline core was completed during December 1-15, 1980 on the DIK claim, Sayward, Vancouver Island.

The program was undertaken as a follow-up of a limited magnetometer survey, geological mapping, and soil sampling of a portion of the property optioned by the Company in February 1980.

The work was laid out to explore skarn showings and limestone volcanic contacts in Claim DIK. Great care was taken to prevent muddy water being poured into the Upper Adam River and a minimum of bulldozing was carried out to prevent damage to the main logging road of MacMillan Bloedel, Ltd.

The DIK claim is located 7 km from the Wosk Lake turnoff on Highway 19, along the Upper Adam Main Logging Road, and straddles the Upper Adam River. Access to the property is by this logging road.

DRILLING PROGRAM

The drilling was done by the D. J. Drilling Co., Ltd. of Surrey, B.C. The drill used was a BBS-17A, BQ wireline. Two 12-hour shifts were run. A Cat was secured in Campbell River which was moved in on December 3rd to clear access roads for the two setups. Storms held up delivery of the drilling equipment which arrived on the 4th, and the crew arrived the next day.

cont....

No. 1 setup. Located at 10,000N and 5000E, on a strip of land not more than 100 ft. wide between the river and the road, on the west side of the road. Three holes were drilled from this site: 80-1, 80-2, 80-3, for a total of 1032 feet.

No. 2 setup. Laid out at 10,118N and 5000E. Drill holes S-4, S-5, for a total of 681 feet.

Total drilled: 1713 feet.

Dip of holes had to be changed to -70° and -65° on account of nearness to the river and difficulty in collar-ing S-4 and S-5.

Drilling stopped on December 14th and the equipment was moved out on December 15th and 16th.

The core was moved to Campbell River. A core splitter was obtained and the core was re-logged and split wherever mineralization showed sufficient widths to warrant sampling. 19 samples were split for a total length of 97.4 feet.

Logs are appended showing location of samples and values obtained. Drill holes are plotted in sections.

The first site was located over a strong showing consisting of rusted gossan type outcrops and the contact between Karmutsen volcanics and limestone. A drift had been driven earlier beneath this showing and mapped and sampled. (See Fig. 2, Geology of Underground Work-ings) Low copper, significant gold, and low silver values are shown on the map.

DDH 80-1: Dip- 70° W. Gave mineralization from 25.6' to 35.0', but only insignificant values in Cu, gold and silver, approximating surface samples. This mineralization occurred at the contact of limestone and Karmutsen volcanics; mostly in fractured volcanics, the remainder along the contact. No further mineralization of any significance occurred in this hole.

cont....

DDH 80-2: Dip -65° . Mineralization at limestone-volcanic contact, 26.0-29.0' gave extremely low results. Second occurrence at 35.0-38.0', in fractured volcanics. Similar to above.

DDH 80-3: Bearing W, dip -65° Mineralized from limestone contact at 29.0-53.0' in Karmutsen volcanics. Gave very low values. This was the last hole drilled in No. 1 setup.

The geophysical survey showed a small VLF-EM anomaly marked "e" on the map. This anomaly was directly over the drilling and could be ascribed to the mineralization shown in the skarn outcrop and/or the mineralization in the adit below. Geochemical values must be disregarded owing to soil disturbance by logging road construction and transportation by water runoff.

The second site was started in overburden on a steep slope, thus hole angles were increased to -65° .

DDH S-4: Bearing S 80W, dip -65° . Cut weak mineralization from 240'-244' in fractures in broken Karmutsen; 278'-283' in Karmutsen volcanic-limestone contact. Results were negligible.

The upper limestone-Karmutsen volcanics contact was lost by casing to 37'.

DDH S-5: Bearing N 70° W, Dip collar -65° , casing to 35'. Scattered mineralization showed from 214'-291'. Sampling is shown on log. Mineralization ended at 291'. The lower limestone-Karmutsen volcanics contact results were too low to be mentioned.

This site centered on a VLF-EM anomaly which could not have been caused by deep-seated mineralization, as shown in DDH S-5. The most likely explanation is a sheared and broken contact between limestone and Karmutsen volcanics.

cont...

The assaying was done by Acme Analytical Laboratories, Ltd. of Vancouver.

CONCLUSIONS

The five-hole drilling program carried out on the DIK claim intersected two layers of limestone in contact with Karmutsen volcanics and also indicated the presence of a fold along the direction of the Adam River.

Core showing mineralization was split; half sent to the assay office and the remainder returned to the box.

The mineralization was very weak and assay values were negligible.

The geophysical anomaly located over the No. 1 drill site could have been caused by massive chalcopryrite, pyrite mineralization alongside skarn outcrops on surface. The northern anomaly, over the No. 2 drill site may be ascribed to sheared contacts and water-filled fractures in the Karmutsen. The weak mineralization found in the drill holes did nothing to explain the presence of the EM anomalies.

It is concluded that this portion of the DIK claim does not warrant further work.

E. P. Sheppard
E. Percy Sheppard, P.Eng.
Consulting Geologist

Vancouver, B.C.
January 9, 1981



eps;ds

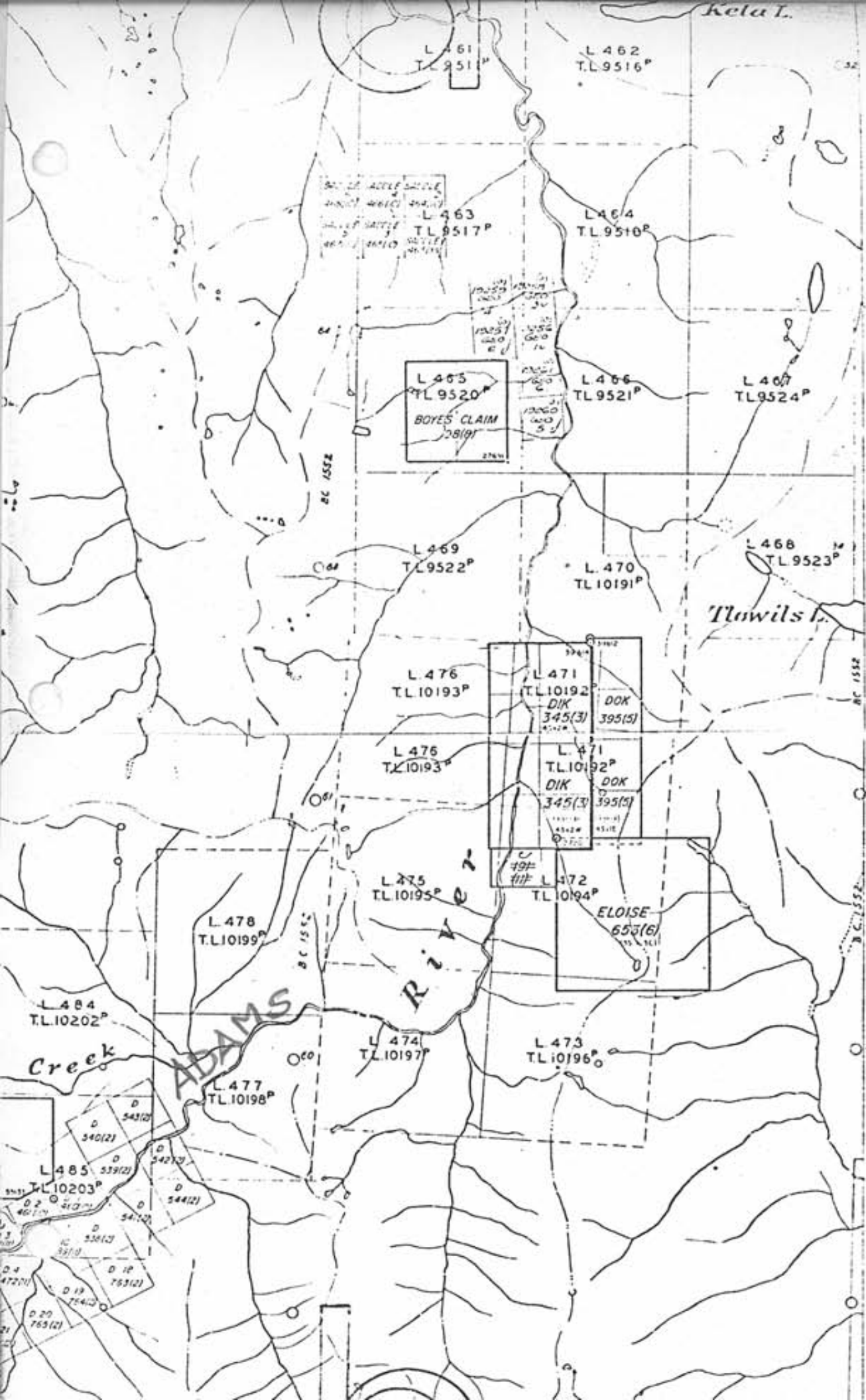

2 Miles
 2000
 3 Kilometers

UNLESS VERIFIED ON SURVEY, THE MAP POSITION OF A LEGAL CORNER POST IS BASED ON THE LOCATOR'S SKETCH. FOR FURTHER INFORMATION, APPLY TO THE OFFICE OF THE MINING DIVISION CONCERNED.

DATE OF MICROFILM: 80 09-25

Index Map
 92L/1E,8E
 1:1000 M

REFERENCES

- G. A. Noel, P.Eng.: SUMMARY REPORT, GEOLOGICAL &
GEOCHEMICAL SURVEY, DIK PROPERTY
June 1980
- David G. Mark: GEOPHYSICAL REPORT, VLF-EM SURVEY
October 7, 1980
- L.S.Trenholme, P.Eng.: REPORT ON ADAM RIVER GOLD
PROSPECT, July 31, 1980

Property S-M Resources

DIAMOND DRILL SAMPLING RECORD

DIP TESTS

Hole No. 80-2

Started Dec 7 - 80

Bearing E 45° W Dip at Collar -65 Hor. Comp. Ver. Comp.

Sheet No. 1

Finished Dec 9 - 80

Location DIKE 1 Elevation 370 m. Lat. 10.005 N Dept. 5010 E

Logged by E.P.S.

Purpose of Hole

Distance		DESCRIPTION	Sample No.	Length Ft.	Core Recovery %	Analysis			PROGRESSIVE TOTALS				
From	To					c.g./t Ag ₂ O/t Au ₂ O/t			FEET & PER CENT				
0	12	Casing											
12.0	14.0	L.S. broken L.C. 8'											
14.0	17.0	Lost Core											
17.0	22.0	L. SE. bed at 19' bed none, mass d. grey + bed white quartz											
23.0	26.0	Limestone a. grey mass. silicified, quat.?											
26.0	29.0	Karmutsen Volcanics, 26-26.3 mass Sulf. Py. 13710 see minz. beds	13710	26.0	29.0	0.10	0.04	0.001					
29.0	35.0	" ss above little minz. mass - fg.											
35.0	38.0	" L. grey minz. num units, Py. 13711	13711	35.0	38.0	0.05	0.01	0.006					
38.0	60	Limestone grey to d. grey minz @ 58 - 58.3 isolated											
60	84	Karmutsen Volc bed 35' num gtz strc											
84	152	" @ 71' py. ss. on unit 38' + "											
84	152	" as described above											
152	224	" " basaltic											
224	287	" 10' lengths basaltic rem. as above											
END of Hole													

Property SEM Resources

DIAMOND DRILL SAMPLING RECORD

DIP TESTS

Hole No. S-5

Started 12/13/80

Bearing N 72° W Dip at Collar -65 Hor. Comp. Ver. Comp.

Sheet No. 2

Finished 12/14/80

Location Dike ch. Elevation 370 Lat. 10.118 N Dept. 5000 E

Logged by E.P.S.

Purpose of Hole

Distance		DESCRIPTION	Sample No.	Length Ft.	Core Recovery %	Analysis			PROGRESSIVE TOTALS				
From	To								FEET & PER CENT				
274	282	Kar vols shattered	13718	274	282 90%	Cu .06/t	Ag .03/t	Au .01/t					
282	291	Karmutsen volc. d. grey Silic. scat mgn. limy areas	13719	287	291	.07	.03	.075					
291	302	L.S. med grey to d grey Bonanza. Silicified areas											
302	333	L.S. as above - shattered - grey to white											
END OF HOLE													

Property 5-M Resources

DIAMOND DRILL SAMPLING RECORD

DIP TESTS

Hole No. DDH-80-3

Started 12/19/80

Bearing W. Dip at Collar -65° Hor. Comp. Ver. Comp.

Sheet No. 1

Finished 12/10/80

Location DIX cl. Elevation 370 Lat. 10 005 N Dept. 5010 E

Logged by E.P.S.

Purpose of Hole

Distance			DESCRIPTION	Sample No.	From	To	L	Analysis			PROGRESSIVE TOTALS							
From	To	Core%						Cu% _T	Aggr _T	Aug _T	FEET & PER CENT							
0	12		Casing															
12	29		Limestone, d. grey broken-															
29	33		Karmutsen minz _n at contact	13722	29	33												
33	38		" " Thru out. w _{ky} Ep. Py Cubas.	13723	33	38												
38	43		" minz 1' @ 4'	13724	38	43												
43	48		" weak minz	13725	43	48												
48	53		" 48.5 - 49.5. 1 mass minz occ 1" band pepi	13726	48	53												
53	77		Karmutsen L. grey num frags															
77	97		Porph. d. grey to bk mass, med gr diabase augite, - gabbro type															
97	103		as above f. grn															
103	114		B+ calc. gtz filled. green. grey.															
114	127		Karmutsen - mass.															
127	147		" " gr. grn.															
147	197		" " occ widely spaced unit Py															
197	217		Perph as above, oc. 1/8 str py occ? C. grain.															
217	237		Karmutsen occ. str. Some Porph several widely spaced py str. @ 45° to core															
			END of Hole															

ELEV 370 m

S 70° W

N 70° E

26.5	27	13708	0.35	0.12	0.005
27	35	13709	0.02	0.01	0.001

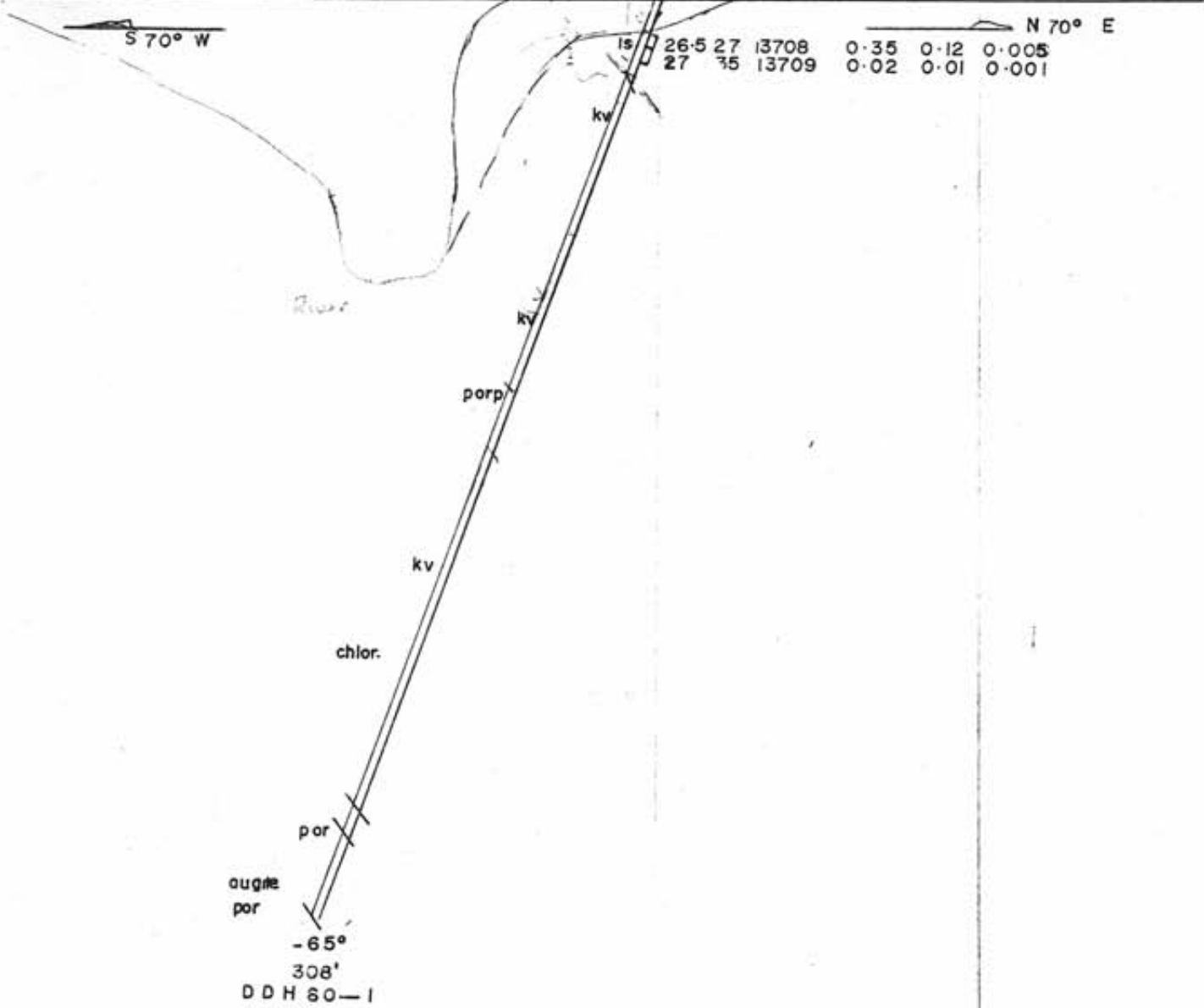

augre
por
-65°
308'
DDH 80-1



5-M RESOURCES INC.
DDH 80-1
BEARING S 70° W
SCALE 1" = 50'

5000E

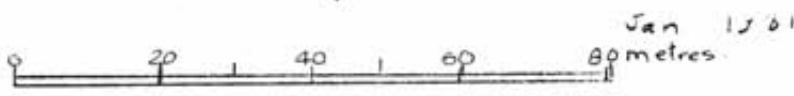

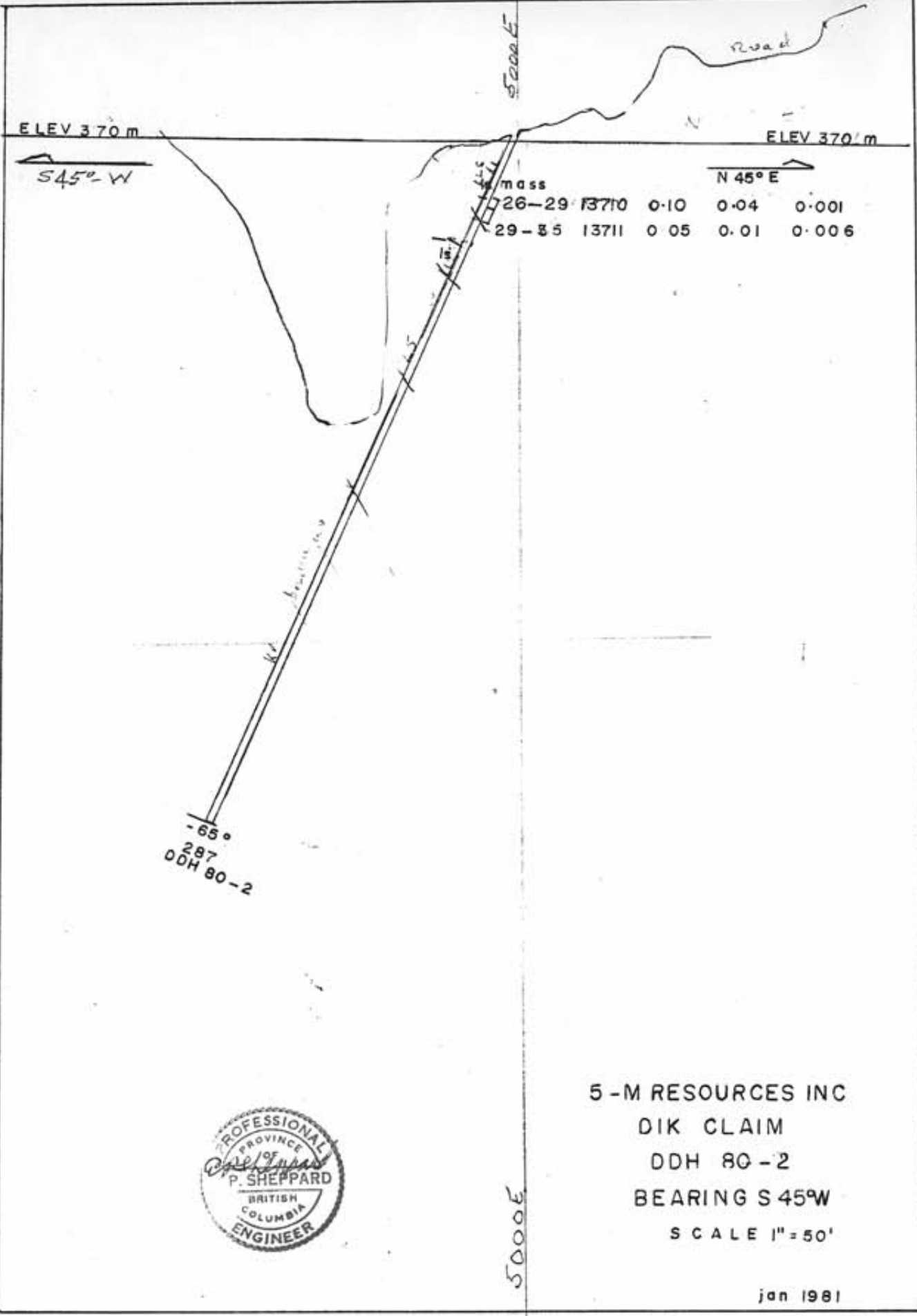

5-M RESOURCES INC
 DIK CLAIM
 DDH 80-2
 BEARING S 45°W
 SCALE 1" = 50'



jan 1981

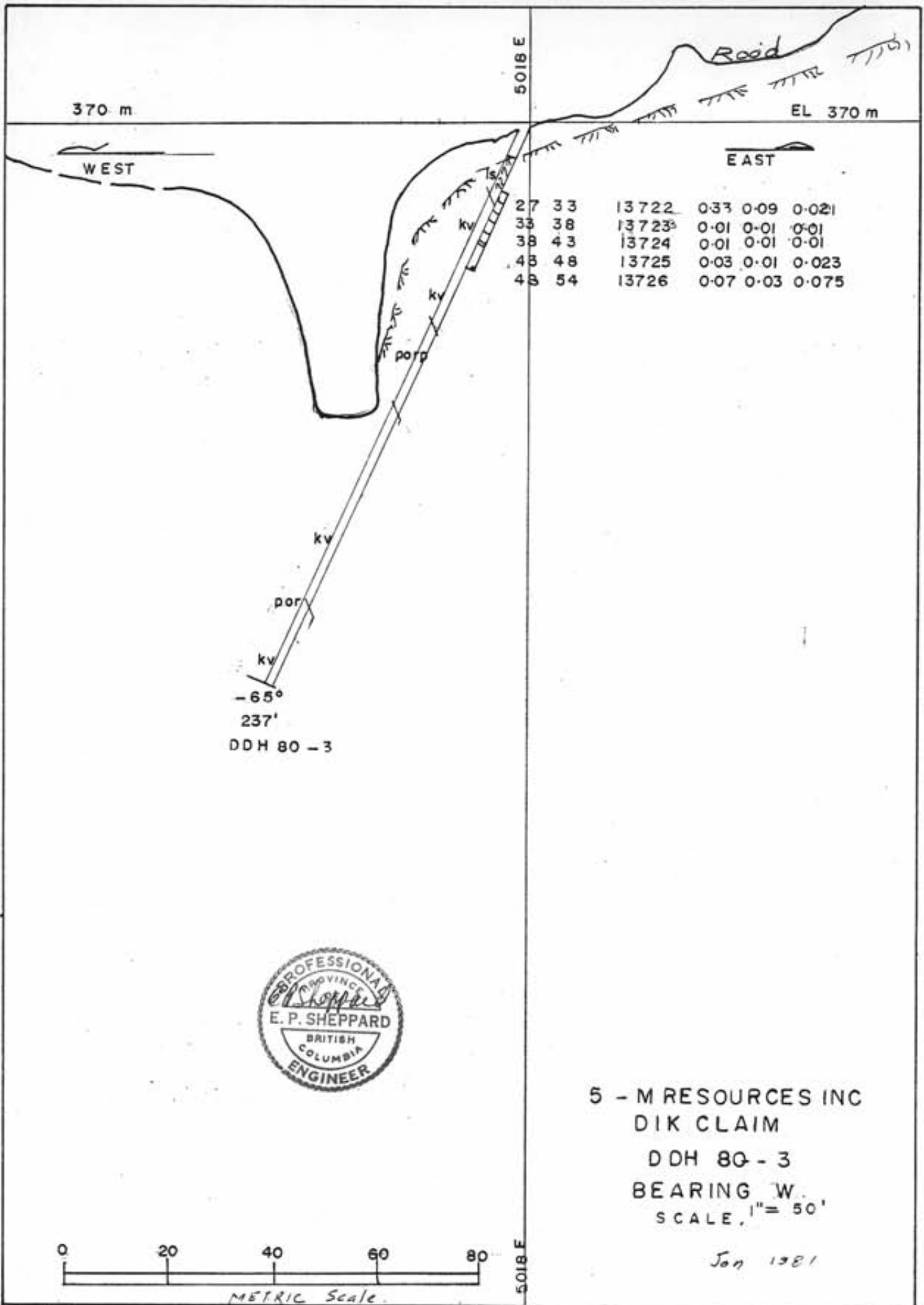

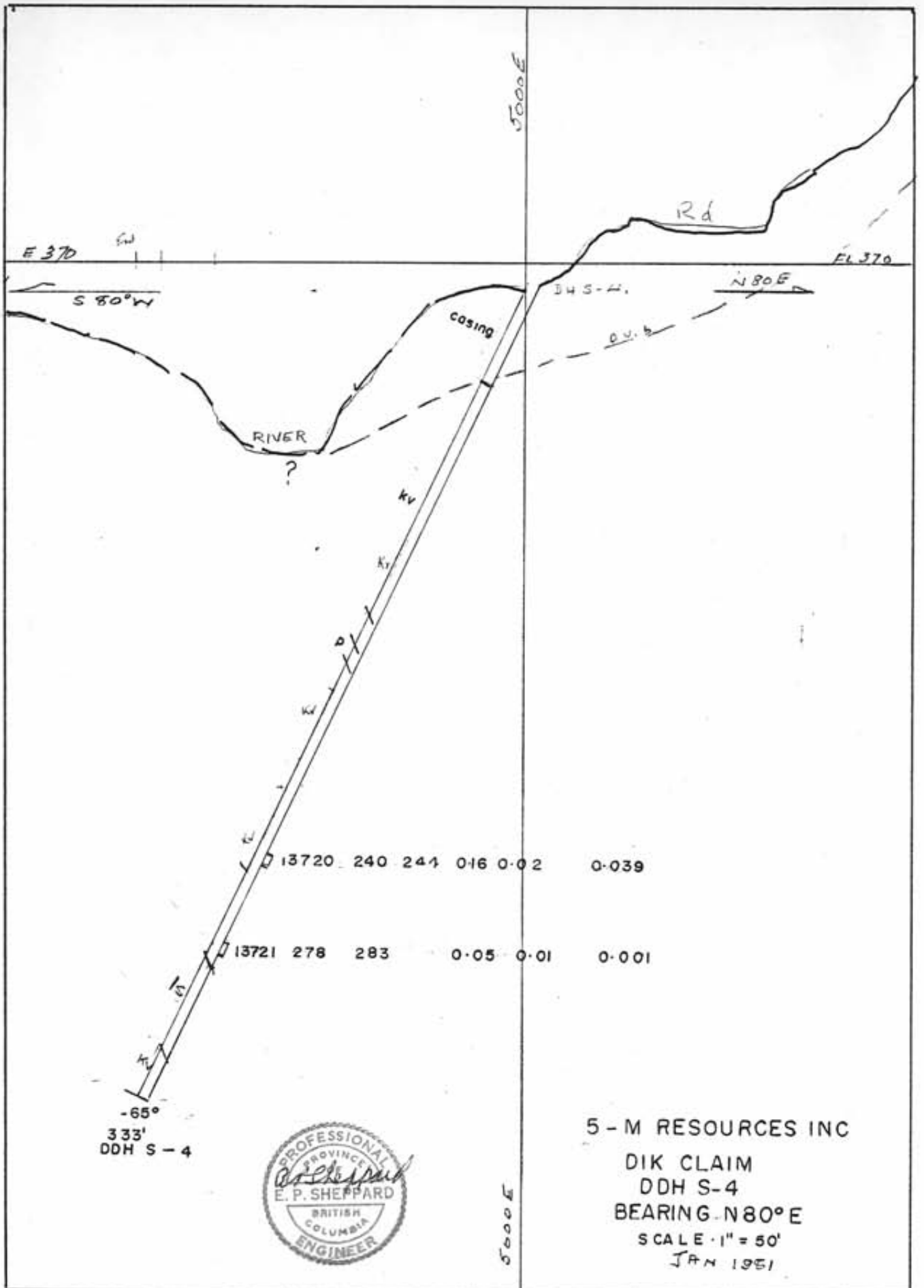

333'
DDH S-4



5 - M RESOURCES INC
DIK CLAIM
DDH S-4
BEARING N80°E
SCALE 1" = 50'
JAN 1951

5000E

5000E

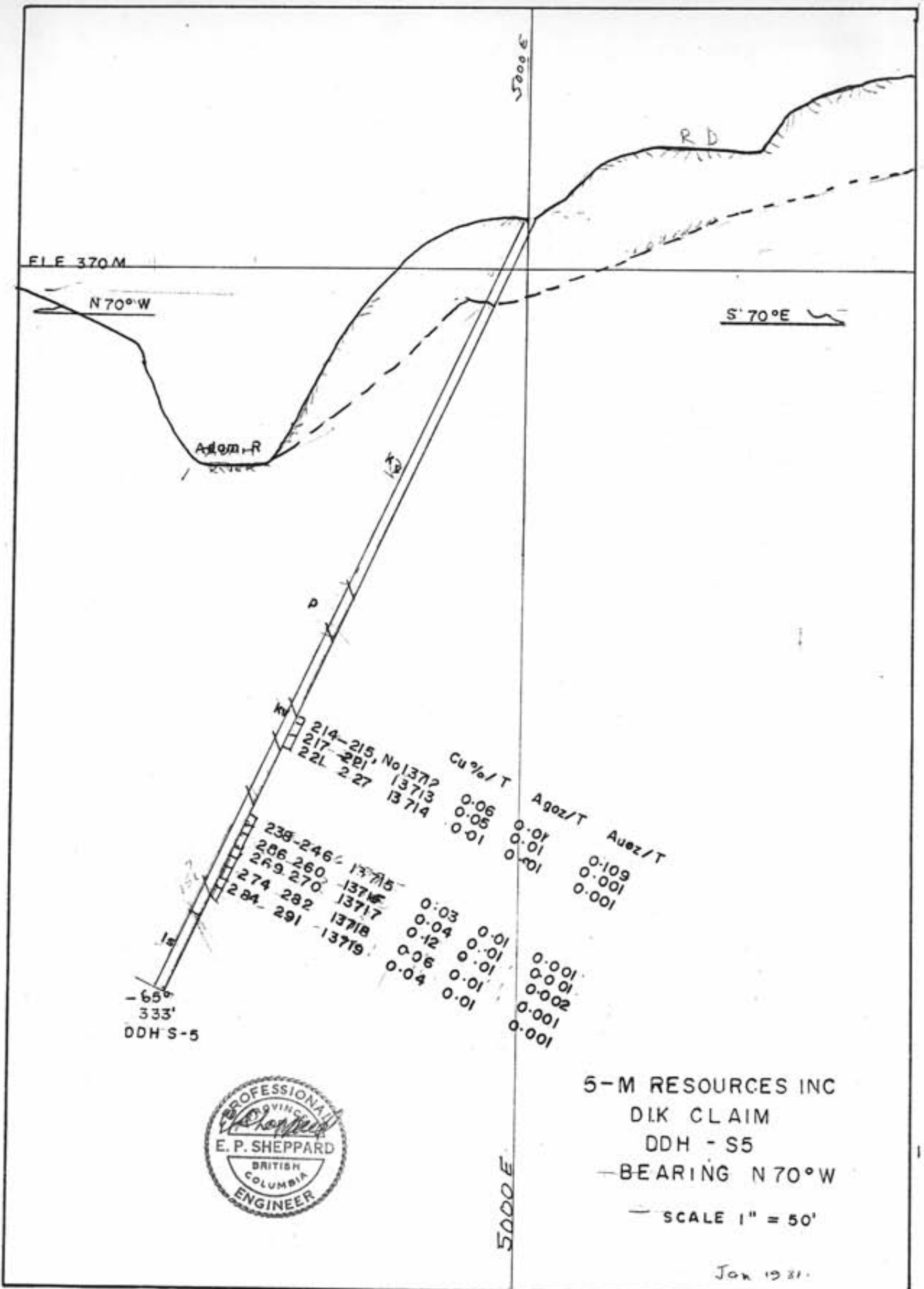

Interval	No	Cu % / T	Agoz / T	Auez / T
214-215	1372	0.06	0.01	0.109
217-221	1373	0.05	0.01	0.001
22L-227	1374	0.01	0.01	0.001
238-246	1375	0.03	0.01	0.001
266-260	1376	0.04	0.01	0.001
269-270	1377	0.12	0.01	0.002
274-282	1378	0.06	0.01	0.001
284-291	1379	0.04	0.01	0.001



5-M RESOURCES INC
 DIK CLAIM
 DDH - S5
 BEARING N 70° W
 SCALE 1" = 50'

Jan 19 31

E. PERCY SHEPPARD, P.ENG.
CONSULTING GEOLOGIST

1606-M, 1600 Beach Ave.
Vancouver, B.C., V6G 1Y7
March 3, 1981

Five M Resources Inc.
3437 St. Mary's Ave.
North Vancouver, B.C.

RE: Diamond Drill Programs
DIK Claim
Vancouver Island

Gentlemen:

In December 1980 a 5-hole drilling program was carried out on the DIK claim. The holes were located on the a and e anomalies indicated by the geophysical survey.

These holes were designed to cut the Karmutsen volcanic limestone contact, where skarn was found on surface, and good mineralization in a short adit below the surface showing. Three holes were drilled from this set-up in a fan pattern. Each hole cut mineralization close to surface but the remainder of the core lengths proved barren.

The second set-up, 100 m north, 10,000N, 5000E, drilled through weak pyritization but found no copper, gold or silver.

This drilling proved that sulphide mineralization cut at surface does not continue with depth.

It is proposed that diamond drilling be carried out in 1981 as follows:

Hole #1 - On anomaly d. Located at 5000E, 9300N, on east side of Adam River Road.

20 m due East from edge of road

7 m South of Lois Culvert

Elevation of collar, 375 m

Bearing: Due E, dip 50°

Horizontal components: 70 m

Vertical " 85 m

Length of hole, 110 m

cont...



To: E. Percy Sheppard, P. Eng.
 Consulting Geologist,
 1606 M 1600 Beach Ave.,
 Vancouver, B.C.
 V6G 1Y7

ACME ANALYTICAL LABORATORIES LTD.

Assaying & Trace Analysis

852 E. Hastings St., Vancouver, B.C. V6A 1R6

Telephone: 253 - 3158

File No. 80-1584

Type of Samples Core

Disposition _____

ASSAY CERTIFICATE

Five M Resources

No.	Sample	Cu%	Ag oz/ton	Au oz/ton	DD. H	From Foots. 2	To	Length	No.
1	13708 A	.35	.12	.005	80-1	25.6	27.0	1.4'	1
2	13709	.02	.01	.001	80-1	27.0	35.0	8.0	2
3	13710	.10	.04	.001	80-2	26.0	29.0	3.0	3
4	13711	.05	.01	.006	80.2	35.0	35.0	3.0	4
5	13712	.06	.01	.109	5-5	214.0	215.0	1.0	5
6	13713	.05	.01	.009	5-5	217.0	221.0	5.0	6
7	13714	.01	.01	.001	5-5	212.0	227.0	5.0	7
8	13715	.03	.01	.001	5-5	238.0	246.0	8.0	8
9	13716	.04	.01	.001	5-5	256.0	260.0	4.0	9
10	13717	.12	.01	.002	5-5	269.0	270.0	10.0	10
11	13718	.06	.01	.001	5-5	274.0	282.0	8.0	11
12	13719	.04	.01	.001	5-5	284.0	291.0	7.0	12
13	13720	.16	.02	.039	5-4	240.0	244.0	4.0	13
14	13721	.05	.01	.001	5-4	278.0	283.0	5.0	14
15	13722	.33	.09	.001	80-3	29.0	33.0	4.0	15
16	13723	.01	.01	.021	80-3	33.0	38.0	5.0	16
17	13724	.01	.01	.001	80-3	38.0	43.0	5.0	17
18	13725	.03	.01	.023	80-3	43.0	48.0	5.0	18
19	13726 A	.07	.03	.075	80-3	48.0	54.0	6.0	19
20								97.4	20

All reports are the confidential property of clients.

E. P. Sheppard P. Eng.

DATE SAMPLES RECEIVED Dec. 29, 1980

DATE REPORTS MAILED Jan. 2, 1981

ASSAYER _____

DEAN TOYE, B.Sc.
 CHIEF CHEMIST
 CERTIFIED B.C. ASSAYER

Five M Resources Inc.

- 2 -

Hole #2 - On anomaly c. Located at 4918E, 9514N, 20 m West of Adam River Road. Nearest water at river, 40 m West.

Contingent upon the results from these two holes, additional holes could be drilled from the same set-ups.

Yours truly,

E.P. Sheppard.

E. Percy Sheppard, P.Eng.

EPS:d

Statement of Expenditures

1500 feet of B Q wireline drilling @ \$24 /foot	36,000.00
Bulldozer - site preparation and reclamation	5,350.00
Assays	228.00
Mobilisation	227.00
Accomodation and Meals	5,849.00
Geological Supervision and Report	5,322.00
	<hr/>
	\$ 52,976.00

G. Taylor P. Eng
Director

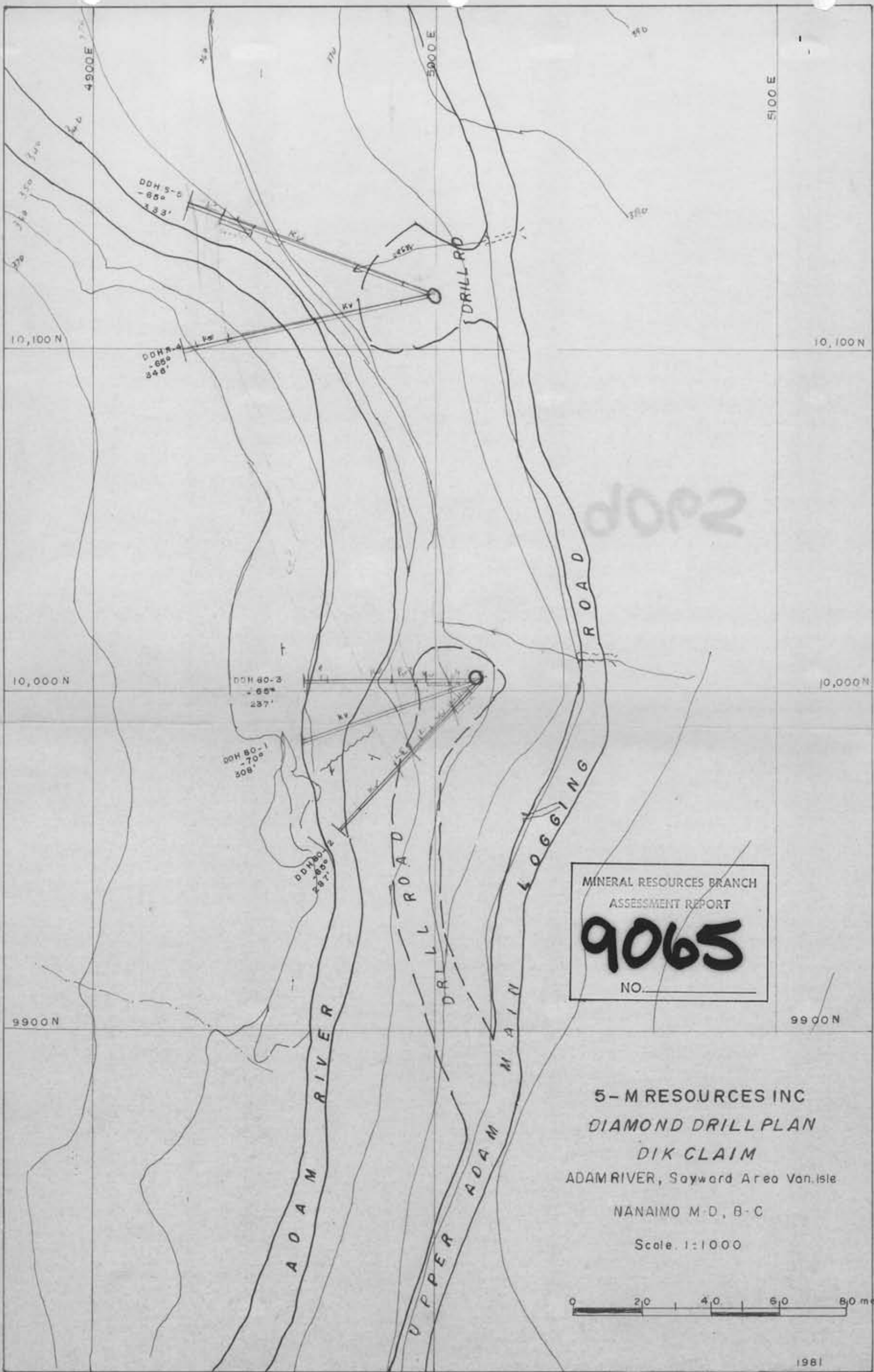

MINERAL RESOURCES BRANCH
 ASSESSMENT REPORT
9065
 NO. _____

5-M RESOURCES INC
DIAMOND DRILL PLAN
DIK CLAIM
 ADAM RIVER, Sayward Area Van. Isle

NANAIMO M-D, B-C

Scale 1:1000

