

Assessment Report
on
Additional Geological and Geochemical Work
on the
Porcupine Group of Mineral Claims
and Specifically the Porcupine Reverted Crown
Grant Situated on

Porcupine Creek, Ymir Area, B.C.

Nelson Mining Division

N.T.S. 82 F/6E

Lat. 49° 15'; Long. 117° 10' W

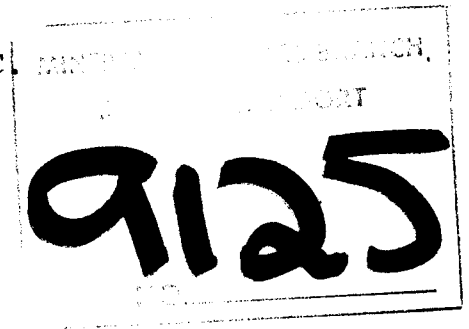

Field Work Sept. 27, 1980; March 27, 1981.

Report by

Robert Wolfe, P. Eng.
April 29, 1981
Maple Ridge, B.C.

Robert Wolfe, P. Eng.

TABLE OF CONTENTS

INTRODUCTION	1
LOCATION AND ACCESS	1
CLAIMS INFORMATION	2
HISTORY	5
GENERAL GEOLOGY	6
FIELD WORK	8
DISCUSSION OF RESULTS	9

Figures:

1. Location and Claims Map
2. Claims Sketch and Assay Plan
3. Geochemical Plan

Report Body
Map
Pocket

Appendices.

1. Certificate
- II. Geochemical Certificate
- III. Assessment Work Details.

INTRODUCTION

The following assessment work report describes the field work performed in 1980 and 1981 on the Porcupine claims near Ymir, B.C.

LOCATION AND ACCESS

The Ymir Gold Camp is situated in B.C.'s Kootenay District, some 40 air kilometers East and slightly North of Trail, and 20 air kilometers South of the city of Nelson. The town of Ymir is the nearest settlement and consists of a hotel, general store, and gas station, and several residences. Ymir is located on Highway #6 which follows the Salmo River and it is serviced by the West Kootenay Power line and Burlington Northern Rail line.

Road access to the Porcupine Claim is excellent by proceeding South from Ymir along Highway #6 for about 3 km, then East up Porcupine Creek for 2 km.

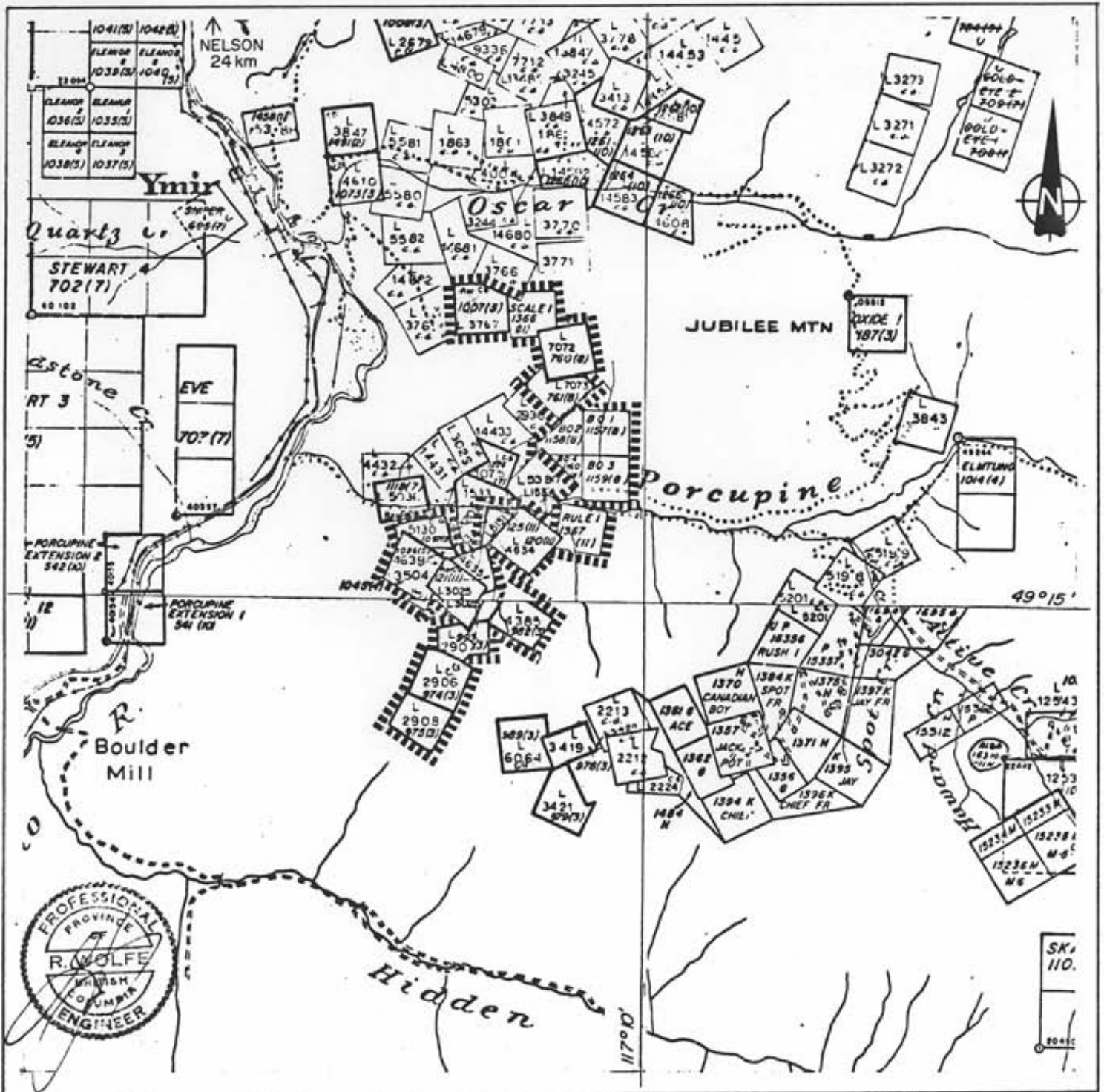

Nithex Exploration Ltd.

YMIR PROJECT
Porcupine Group



Scale 1: 50,000

Nelson Mining Division Ymir, B.C.
N.T.S. 82F / 6E & 3E.

LOCATION & CLAIMS MAP Figure 1
From E.M.B.R. map 82F / 3 & 6 Ed. 3 "Nelson" sheet (1976)

P.K.C. 1980
B.A.C. 5-81

Robert Wolfe, P. Eng.

CLAIMS INFORMATION

The Porcupine Claim is part of the Porcupine Group of 20 reverted crown grants and two-post claims registered in the Nelson Mining Division. Details are set out in the following table.

Anniversary dates include assessment work credits applied for in this report.

TABLE OF CLAIMS - PORCUPINE GROUP

CLAIM NAME	TYPE	LOT NO.	RECORD NO.	ACRES	ACQUIRED	OWNER	ANNIVERSARY DATE	EXPIRY YEAR *
Blue Quartz	R.C.G.	7072	760	51.65	'78	NITHEX	August 22	1981
Rover	R.C.G.	7073	761	37.84	'78	EXPLOR-	August 22	1981
B.Q. No. 1	L. C.	----	1157	50 (approx.)	'79	ATION LTD.	August 14	1982
B.Q. No. 2	L. C.	----	1158	50 "	'79		August 14	1982
B.Q. No. 3	L. C.	----	1159	50 "	'79		August 14	1982
B.Q. No. 4	L. C.	----	1160	50 "	'79		August 14	1982
Scale No. 1	L. C.	----	1366	50 "	'79		November 27	1981
Rule No. 1	L. C.	----	1367	50 "	'79		November 27	1981
Porcupine	R.C.G.	4634	120	51.65	'75		November 10	1982
Franklin	R.C.G.	4635	121	23.07	'75		November 10	1982
Champagne	R.C.G.	5131	125	18.36	'75		November 10	1982
Nevada	R.C.G.	3504	1045	48.50	'79		April 9	1981
Sandaulphon	R.C.G.	4639	1096	6.14	'79		May 31	1982
Georgina	R.C.G.	5130	1097	33.74	'79		May 31	1982
Imperial	R.C.G.	3025	1095	37.43	'79		May 31	1982
Sunrise	R.C.G.	4385	982	38.17	'79		March 29	1982
Emerald	R.C.G.	2907	993	30.76	'79		March 29	1982
Victor	R.C.G.	2906	974	50.04	'79		March 29	1983
Porcupine	R.C.G.	2908	975	42.24	'79		March 29	1983

Twilight	R.C.G.	3767	1007	48.30	'79	March 30	1982
Total	20 claims						

R.C.G. = Reverted Crown Grant

L. C. = Located Claim (2post)

* Includes credits applied for by this report.

HISTORY

The history of the property under discussion is well documented in various Minister of Mines Reports, and the following is a precis of the history:

The Porcupine claim, the oldest claim in the immediate area and the one the creek is named after, was staked in 1895 and most of the old workings date back to 1897. It was crown granted by J.S. Clute in 1902 and was worked by Messers. Haukendahl, Guille and Peterson in the 20's. The property originally consisted of seven (7) claims (Easter, Porcupine, Amador, Sunrise, Franklin and Champagne), and the name of the group was changed to the Maple Leaf in the early '50's.

Apart from the first years of activity in the late 1800's, work on the Porcupine and adjacent claims was primarily conducted between 1925 to 1930 and again in the 1940's.

In 1926 and 1948 the Porcupine shipped a total of 44 tons of ore containing 405 ounces of silver, 3747 pounds of lead, 3832 pounds of zinc and 3 ounces of gold. (Memoir 308).

The average of the 44 tons shipped is tabulated below.

Porcupine (Maple Leaf)

<u>Tons</u>	<u>%Pb</u>	<u>%Zn</u>	<u>Ag (oz/ton)</u>	<u>Au (oz/ton)</u>
44	4.26	4.35	9.20	0.068

The presence of tin has also been noted in the Porcupine mineralization.

In 1948, the Maple Leaf Gold Mining Co., drove an adit on the property and shipped 26 tons to the Trail smelter. Since that time only periodic surface work has been completed.

The Porcupine is extensively developed and workings consist of ten (10) short adits and a number of open cuts. Many of the adits are now caved and inaccessible.

GENERAL GEOLOGY

The Ymir Gold Camp lies on the east flank of a large, north trending synclinerium whose axis runs from Salmo to Nelson, a distance of roughly 40 kilometres. The synclinerium is "floating" being enclosed for the most part in Nelson plutonic rocks, and the latter is considered by most workers as being derived by metamorphism of pre-existing volcanic and sedimentary rocks (Little, pg. 98). The synclinerium consists of the following sequence (from outside or oldest, towards the center):

1. Lower or Pre-Jurassic Ymir Group (formerly Pend D'Oreille by Drysdale) consisting of argillite, slate and paragneiss.
2. Lower Jurassic Rosslund Formation consisting predominately of greenstones.
3. Mid/Upper Jurassic Hall Formation, which conformably overlies the Rosslund, and consists of argillite, sandstone, and conglomerate.

This entire complex is intruded by various intrusives of the Nelson plutonic suite and is locally strongly deformed and metamorphosed.

To the east of the synclinerium is a sequence of Cambrian and Ordovician strata that are northerly trending and are characterized by quartzite, argillite, and various schists.

Productive metaliferous gold, silver, lead and zinc deposits occur in all the above described rocks except the Hall Formation.

Various attempts have been made in the past to classify the metal deposits in the Nelson-Ymir area, and the problem has yet to be satisfactorily solved. Cockfield (1936), utilized a host rock system, and Little (1960), used a relative abundant metal system. However, the past producing mines of the Ymir Camp are predominately gold deposits, although significant amounts of silver, lead, and zinc have been recorded.

Mineralization on Porcupine, Franklin, and Champagne claims consists of pyrite, galena, and sphalerite, with silver and gold values lying with Pend D'Oreille schists at or close to the contact with small bodies of Nelson plutonic rocks. Traces of copper and tin have been reported, and mineralization has been previously classified as lying within silicified and/or shear zones.

The geology of the Porcupine is particularly interesting due to widespread silicification and pyritization which accompanies the mineralization.

FIELD WORK

On Sept. 27, 1980, the writer and two helpers spent one day on the Porcupine claim. The intention was to try to locate old workings and showings in the densely forested area and in addition augment sampling of some of the known showings by D.R. Cochrane in 1978. Although several old pits were found, the workings were caved to such an extent that sampling was impossible. Eight additional rock samples were taken on the known showings and analyzed for Au, Ag, Pb, and Zn. Results are plotted on fig. 2.

On March 27, 1981, D.R. Cochrane and 3 helpers spent another day on the Porcupine. The intent was to sample soils in an area to the West of the main showings in order to investigate the continuation of possible mineralized vein structures. 900 feet of line was cut, chained, and marked every 50 feet. However, since the ground was still frozen, only 10 soil samples could be collected. These were analyzed for Au, Ag, Pb, Zn, and Hg. Sample numbers are plotted on fig. 3. Results in appendix II.

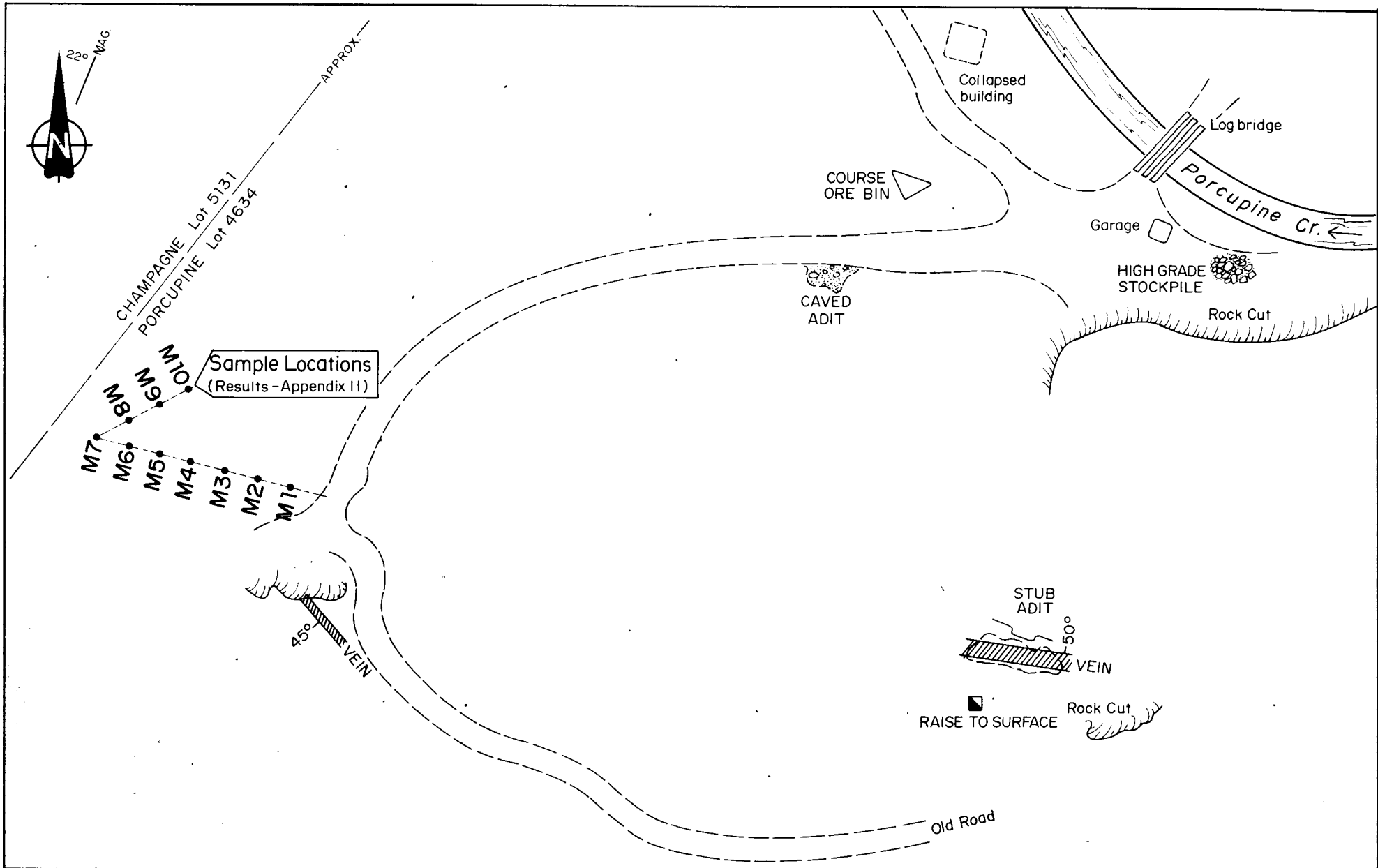

Nithex Exploration Ltd.

YMIR PROJECT

Porcupine Group



Scale: 1:500

Nelson Mining Division
GEOCHEMICAL PLAN
B.A.C. 5-81.

Ymir, British Columbia

Figure 3

N.T.S. 82F/6E.

Robert Wolfe P.Eng.

DISCUSSION OF RESULTS

Results of the soil sampling were inconclusive. Gold content ranged from less than 5 ppb to a high of 50 ppb for M.G.

No correlation between metal content could be observed.

Respectfully Submitted,

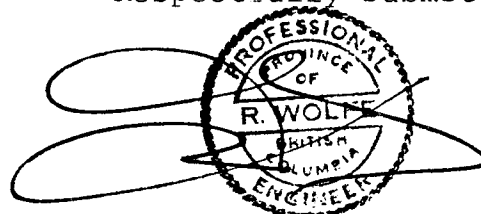

R. Wolfe, P. Eng.

April 29, 1981

Maple Ridge, B.C.

Appendix I

CERTIFICATE

I, Robert Wolfe, of the Municipality of Maple Ridge, British Columbia, do hereby certify that:

1. I am a consulting geological engineer with an office at 25771 102nd Ave., Whonnock, B.C.
2. I am a graduate of the University of Alberta, (1963) with a degree in Geology and Physics (B.Sc.). I also took an extra year of Geology at the University of British Columbia, in 1963-1964.
3. I have practiced my profession since 1964, while being employed by such companies as KennCo (Western) Exploration Meridian Exploration Syndicate, (Canex Aerial Exploration Ltd., Noranda Mines Ltd., Home Oil Co.) Orequest Syndicate (Granby Mining Co., Home Oil Co., Homestake Silver Mines.) I have been in private independent practice since 1968.
4. I have no interest, either direct or indirect in the properties or securities of Nithex Exploration Ltd., nor do I expect to receive or acquire any such interest.
5. I have been a member in good standing of the Association of Professional Engineers of the province of British Columbia since 1967.

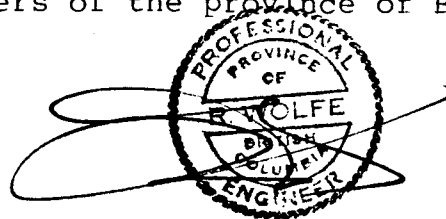

Robert Wolfe, P. Eng.
April 29, 1981

Appendix III

ASSESSMENT WORK DETAILS

Field work

R. Wolfe, P. Eng.	Sept. 27, 1980	
	1 day @ \$250	250.00
2 prospectors	1 day @ \$200	200.00
D.R. Cochrane, P.Eng.	Mar. 27, 1981	
	1 day @ \$400	400.00
3 helpers	1 day @ \$300	300.00
Assay costs		161.00
Geochem Analysis		90.00
Vehicle, Accommodation, food expenses		245.00

Report Preparation

Draftsperson, April 25,26,27, 1981, 20 hrs @ \$20/hr	400.00
Typist, April 30, 1981, 6 hrs @ \$14/hr	84.00
R. Wolfe, P.Eng, April 29, 1981, 1 day @ \$300	300.00
Reproduction	57.00

Total	\$2,487.00
-------	------------

