

81-# 398-# 9137

MAPS TO ACCOMPANY REPORT

1980 EXPLORATION PROGRAM

on

GOLDFINCH GROUP MINERAL CLAIMS

(Camborne Group)

50° 49' N, 117° 39' W NTS 82K / 13E

for

EATON MINING & EXPLORATION LTD.

in the

REVELSTOKE MINING DIVISION

BRITISH COLUMBIA

CANADA

by

W. S. Read, B.Sc., P.Eng.
Cobble Hill, B.C.
Canada

part 2
070

MINERAL RESOURCES BRANCH
ASSESSMENT REPORT
9137

31 May 1981



Part 2
 of 2
 9137

TO ACCOMPANY REPORT BY W.S. READ, P. ENG., DATED 31, MAY, 1981

EATON MINING & EXPLORATION LTD.
 GOLDFINCH PROPERTY, CANBORNE, B.C.

COMPILATION MAP

SCALE: 1:1000 (metric)

DATE: 31, May, 1981

DRAWN BY: WAYLAND S. READ P. Eng., Consulting Geologist, Cobble Hill, B.C.

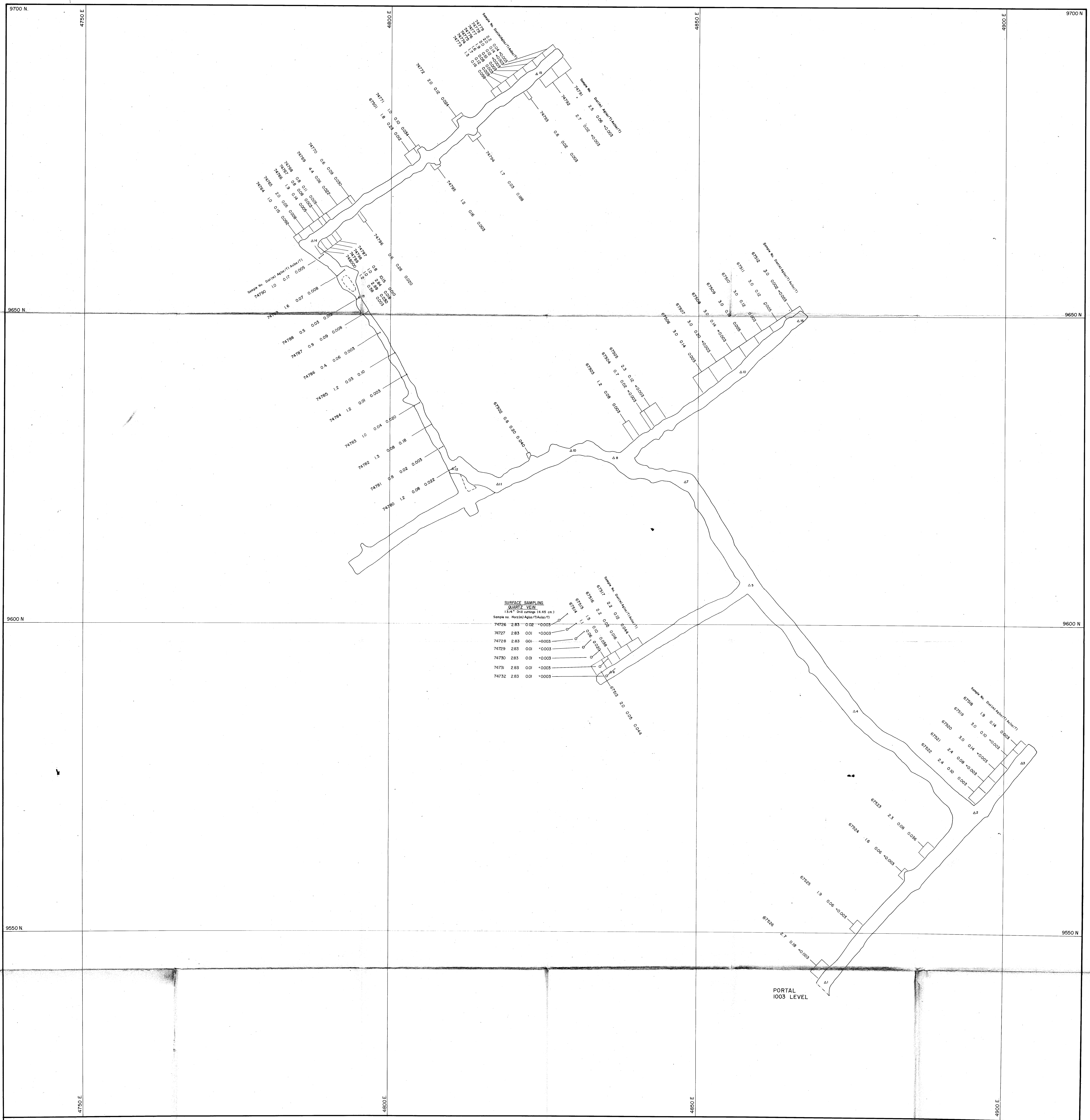

SURFACE SAMPLING
 QUARTZ VEIN
 13/4" Drill core (4.45 cm.)
 Sample no. Width Ass Au Ag

74726	2.85	0.02	<0.003		
74727	2.85	0.01	<0.003		
74728	2.85	0.01	<0.003		
74729	2.85	0.01	<0.003		
74730	2.85	0.01	<0.003		
74731	2.85	0.01	<0.003		
74732	2.85	0.01	<0.003		

LEGEND

Sample Number	Width Metres	Ass (g/T)	Au (g/T)	Ag (g/T)
---------------	--------------	-----------	----------	----------

9131

part 2
of 2

TO ACCOMPANY REPORT BY W.S. READ, P. ENG., DATED 31, MAY, 1981.

EATON MINING & EXPLORATION LTD.
 GOLDFINCH PROPERTY, CANBORNE, B.C.
 N.T.S. 82°47'33"E 50°48'N 117°39'W

1003 LEVEL
ASSAY PLAN

Feet 0 10 20 30 40
 Metres 0 5 10 15 20

DRAWN BY: L.R. REVISOR: SCALE: 1:200 (metric) No. 4
 DATE: 31, May, 1981
 WAYLAND S. READ P. Eng., Consulting Geologist, Cobble Hill, B.C.

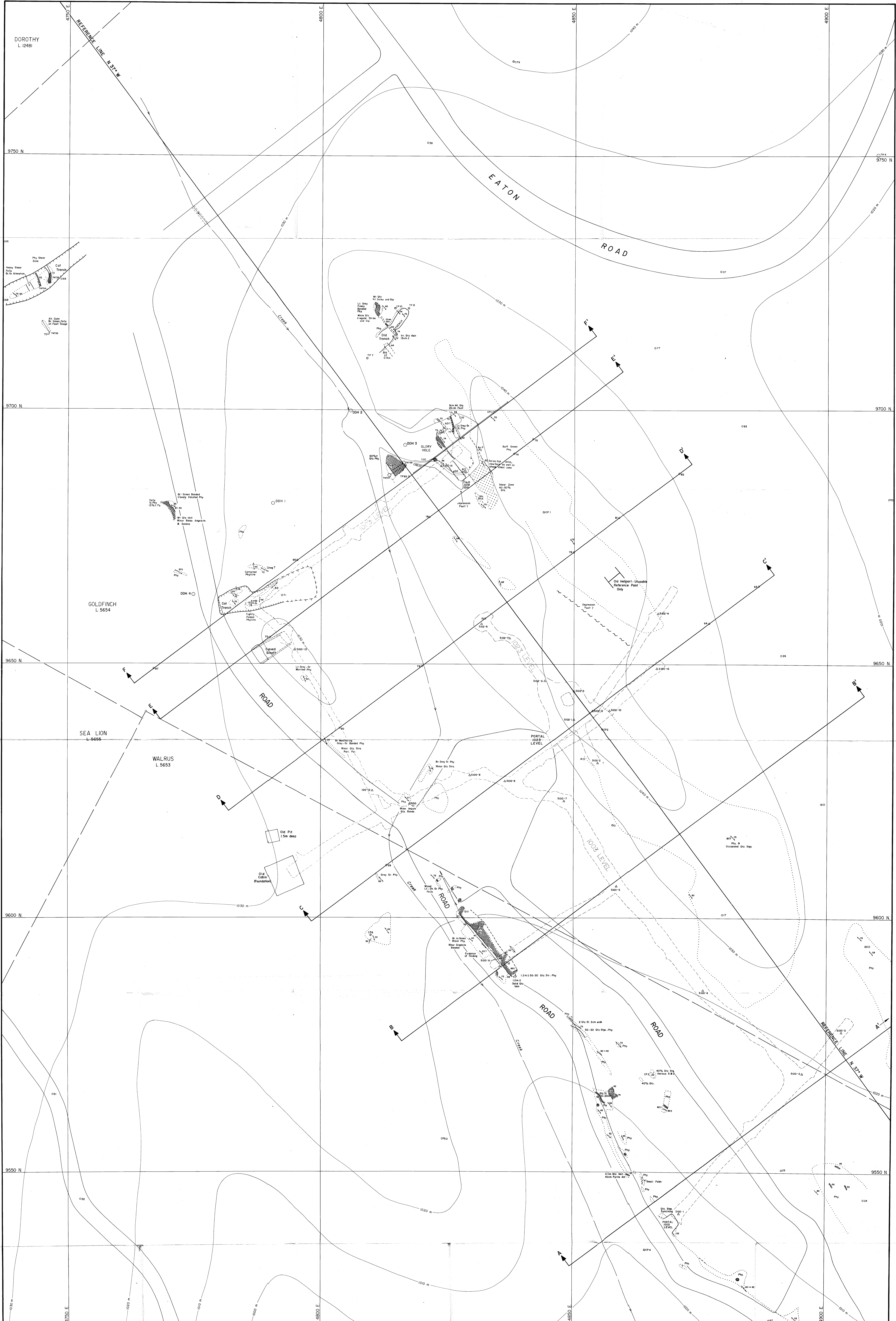

LEGEND

- Strike, Dip
- - - Fault, Strike, Dip
- - - Fault, Observed, Inferred-Dip
- Survey Control Points (Iron Bar in Rock and Concrete)
- △ Underground Survey Control Points (Steel Spud)
- Open Shrinker Zone
- ▨ Open Vents
- Openings
- ▭ Underground Workings
- Contour, Observed, Projected

ABBREVIATIONS

Quartz - Qtz
Phyllite - Phyl
Light Lt.
Dark Lt.
Green - Gr.

TO ACCOMPANY REPORT BY W.S. READ, P. ENG., DATED 31, MAY, 1981.

EATON MINING & EXPLORATION LTD.
GOLDFINCH PROPERTY, CANBORNE, B.C.
N.T.S. 82° N. / 152° E 50° 45' N. 117° 35' W.

COMPOSITE PLAN AND SURFACE GEOLOGY

FEET 0 20 40 60 80
METRES 0 10 20 30

SCALE: 1:200 (metric)

DRAWN BY: L.R., W.R. REVISED: No 2
DATE: 31, MAY, 1981 P. Eng., Consulting Geologist, Cobble Hill, B.C.

MINERAL RESOURCES DIVISION
ACCUMULATIVE REPORT
9137
1:0

Part 2
of 2

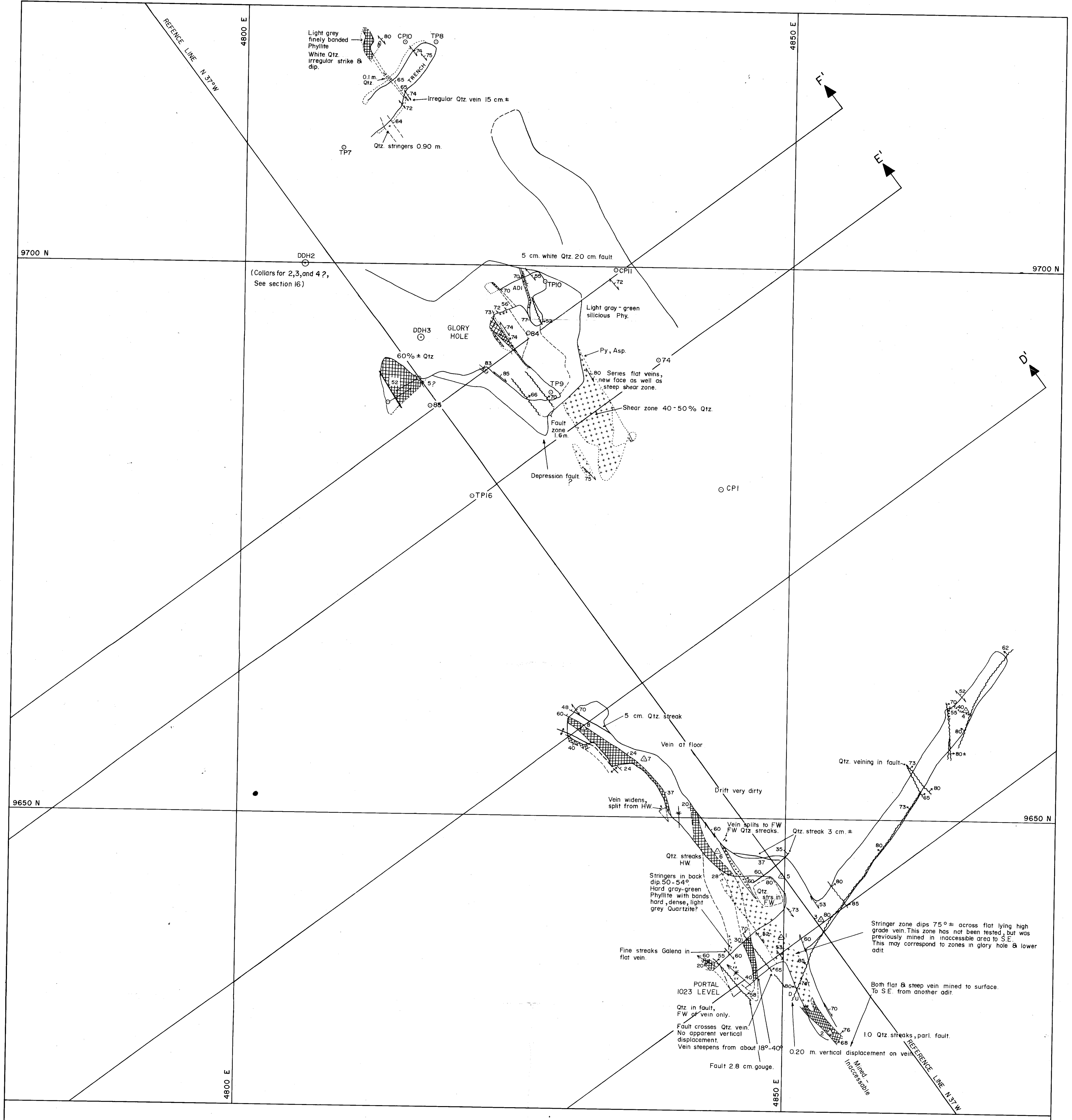

ABBREVIATIONS

Quartz - Qtz
 Phyllite - Phy
 Light - Lt.
 Dark - Dk.
 Green - Gr.
 White - Wh.
 Hangwall - HW
 Footwall - FW
 Parallel - Parl.

LEGEND

— Strike, Dip
 — Foliation, Strike, Dip
 — Jointing
 ~ Fault, Observed, Inferred-Dip
 ○ CPI Survey Control Points (Iron Bar in Rock and Concrete)
 △ S100-1 Underground Survey Control Points (steel spud)

• Quartz Stringer Zone
 ▨ Quartz Vein
 ▭ Outcrop
 --- Underground Workings
 --- Contact/Dip, Observed, Projected

TO ACCOMPANY REPORT BY W.S. READ, P. ENG., DATED 31 MAY, 1981.

EATON MINING & EXPLORATION LTD.
 GOLDFINCH PROPERTY, CANBORNE, B.C.
 N.T.S. 82K/13E 50°49' N. 117°39' W.

**1023 LEVEL & SURFACE
 GEOLOGY PLAN**

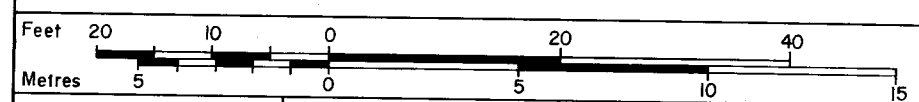

DRAWN BY: W.R. REVISIONS: SCALE: 1:200 (metric) No. 5
 DATE: 31, May, 1981

WAYLAND S. READ P. Eng., Consulting Geologist, Cobble Hill, B.C.

MINING BRANCH
 REPORT
9137

*part 2
 of 2*

W.S. Read

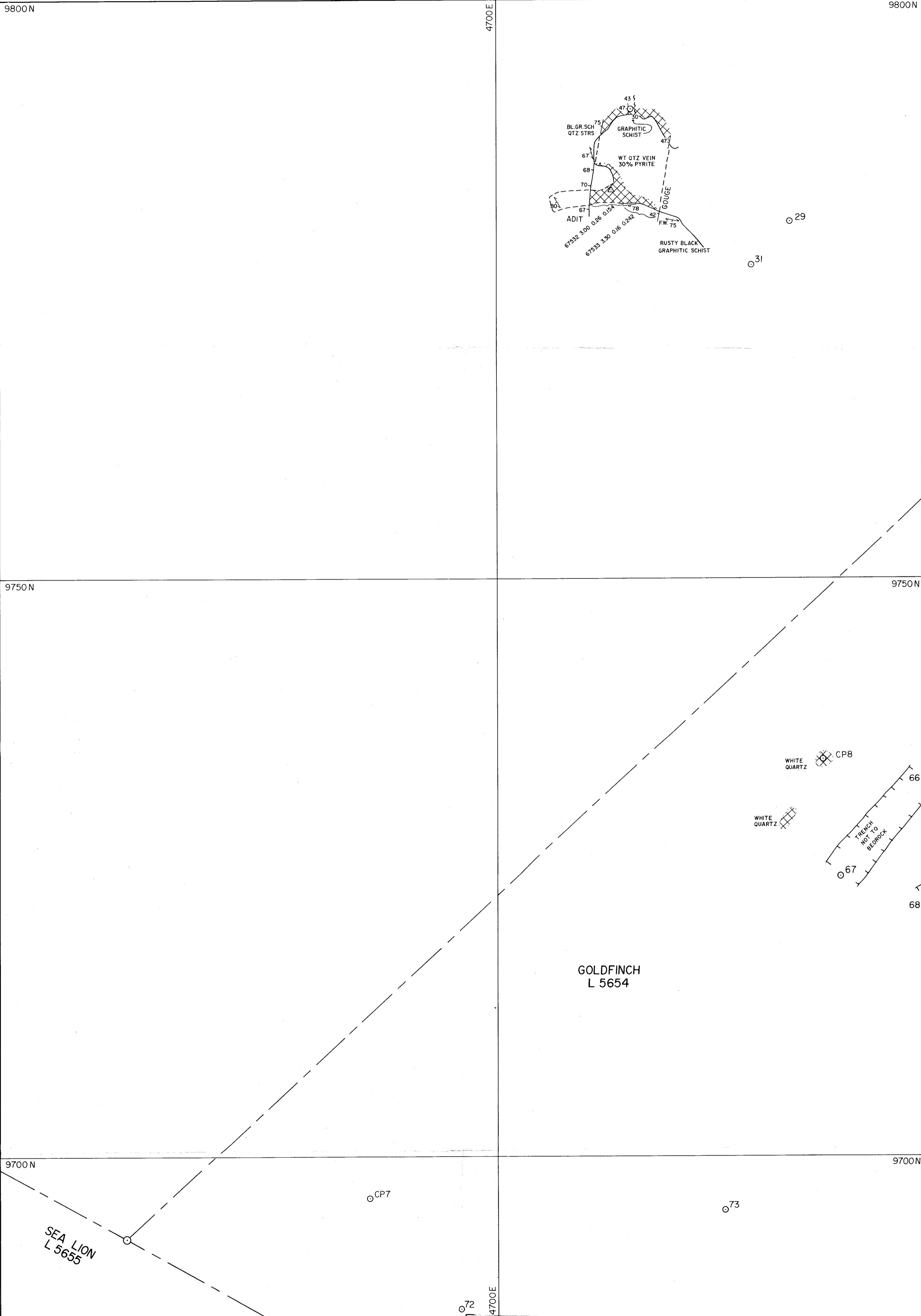

LEGEND

- Strike, Dip
- Foliation, Strike, Dip
- Jointing
- ~ Fault, Observed, Inferred-Dip
- ▣ Quartz Stringer Zone
- ▣ Quartz Vein
- Outcrop
- Underground Workings

MINERAL RIGHTS BRANCH
 AMENDMENT REPORT
9137
 NO.

part 2 of 2

TO ACCOMPANY REPORT BY W. S. READ, P. ENG., DATED 31, MAY, 1981.

EATON MINING & EXPLORATION LTD. GOLDFINCH PROPERTY, CANBORNE, B.C. N.T.S. 82 K / 13E 50° 49' N. 117° 39' W.			
SURFACE GEOLOGY PLAN			
Feet 20 10 0 20 40 Metres 5 10 0 5 10 15		SCALE: 1:200 (metric)	No. 7
DRAWN BY: L. R., W. R. DATE: 31, May, 1981.	REVISED:	WAYLAND S. READ P. Eng., Consulting Geologist, Cobble Hill, B.C.	

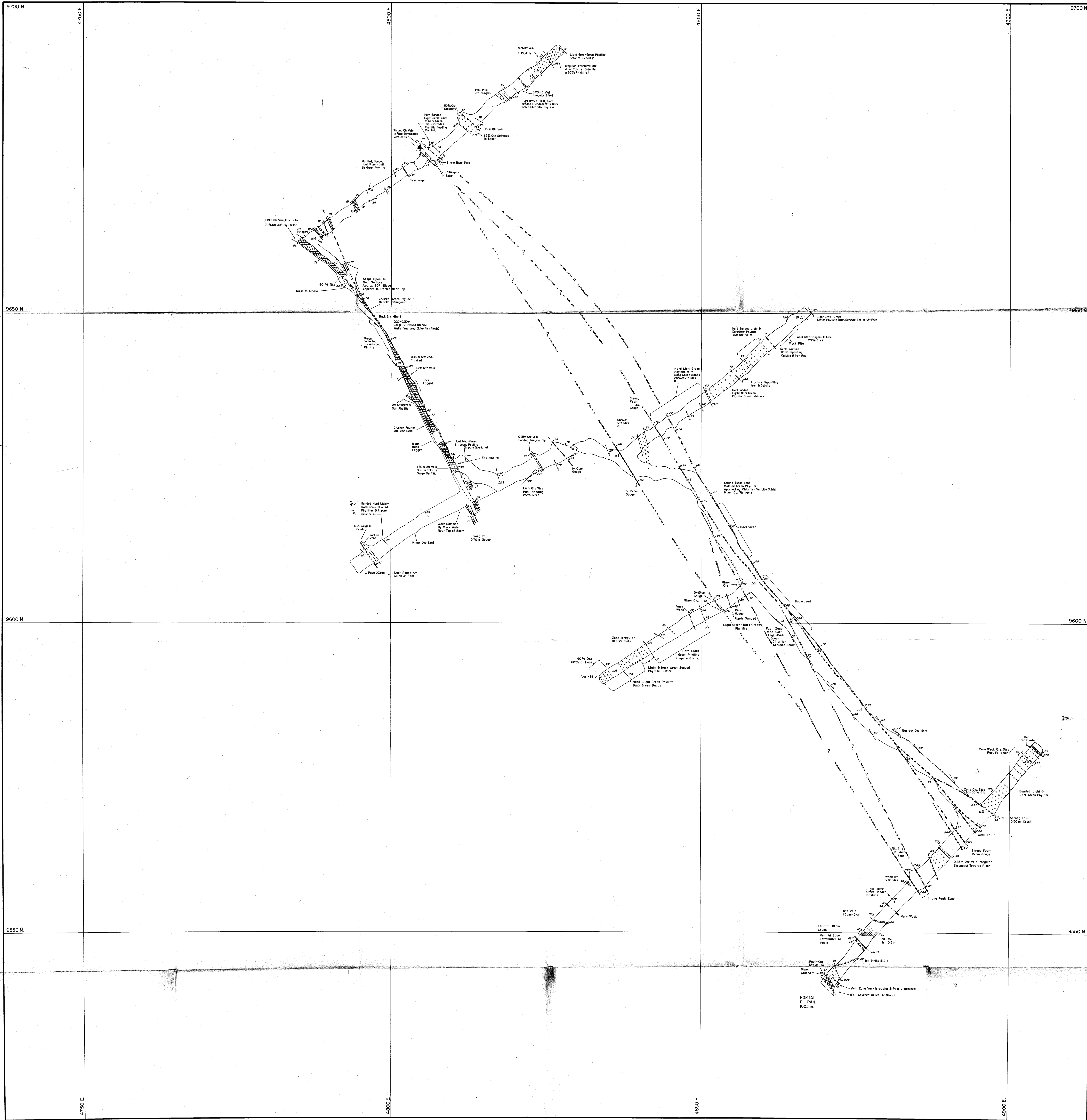

LEGEND

- Strike, Dip
- - - Foliation, Strike, Dip
- - - Jolting
- - - Fault, Observed, Inferred-Dip
- CPI
- Survey Control Points (Iron Bar in Rock and Concrete)
- △ S-100-1

ABBREVIATIONS

- Quartz - QZ
- Phyllite - Ph
- Light - Lt
- Dark - Dk
- Green - Gr
- White - Wh
- Hongwall - HW
- Footwall - FW
- Parallel - Par

MINERAL RESOURCES BRANCH
ASSESSMENT REPORT

part 2 of 2 **9137**

TO ACCOMPANY REPORT BY W.S. READ, P. ENG., DATED 31, MAY, 1981

EATON MINING & EXPLORATION LTD.
GOLDFINCH PROPERTY, CANBORNE, B.C.
N.T.S. 82° K / 13 E 50° 48' N 117° 39' W

1003 LEVEL
GEOLOGICAL PLAN

Feet: 0 10 20 30 40
Metres: 0 5 10 15 20

DRAWN BY: WSR REVISED: SCALE: 1:200 (metric) No. 3
DATE: 31, May, 1981

WAYLAND S. READ, P. Eng., Consulting Geologist, Cobble Hill, B.C.

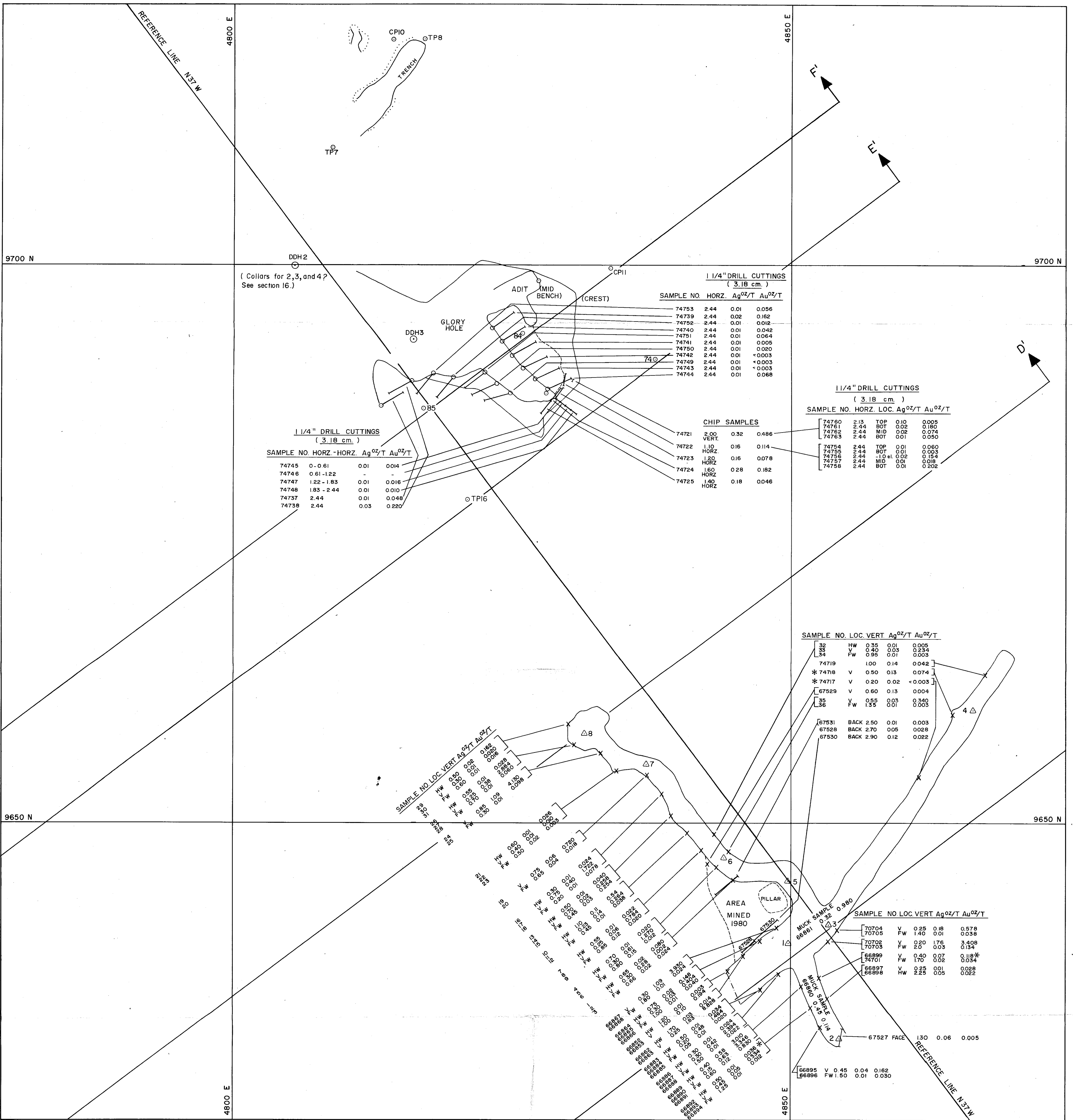

SHIPMENTS FROM 1023 LEVEL 1980

LOT NO.	SHORT DRY TONS	SILVER oz/ton	GOLD oz/ton	SiO ₂ %
1	11.4	0.85	0.351	68.5
2	14.2	1.35	0.562	68.2
3	14.3	0.40	0.251	69.3
4	269.8	0.35	0.306	67.8

MINERAL RESOURCES BRANCH
ASSESSMENT REPORT
9137
NO.

LEGEND

- HW - HANGING WALL
- V - VEIN
- FW - FOOT WALL
- * - HORIZONTAL SAMPLE

TO ACCOMPANY REPORT BY W.S. READ P. ENG., DATED 31, MAY, 1981.

EATON MINING & EXPLORATION LTD.
GOLDFINCH PROPERTY, CANBORNE, B.C.
N.T.S. 82K / 13E 50°49'N. 117°39'W.

**1023 LEVEL & SURFACE
ASSAY PLAN**

Feet 20 10 0 20 40
Metres 5 0 5 10 15

DRAWN BY: L.R. REVISÉD: SCALE: No.
DATE: 31, May, 1981. 1:200 (metric) 6

WAYLAND S. READ P. Eng., Consulting Geologist, Cobble Hill, B.C.

part 2 of 2

W.S. Read



part 2
of 2

9137 NO. LEGEND

GOLD P.P.B. P.P.M.	LEAD P.P.M.
TOTAL HEAVY METALS (Dithizone)	TOTAL SAMPLE NUMBER

Geochemical analysis by atomic absorption.

GOLD: Parts per billion
LEAD: Parts per million
TOTAL HEAVY METALS: By Dithizone field test. (Range 0 - 10+)

Soil ph by B.D.H. Universal indicator (field test) (5.7)

Slope direction ↙

NOTE:
 31.1 Grams = 1 Troy oz.
 31.1 P.P.M. = 1 Troy oz. / Tonne (1,000 kg.)
 84.3 P.P.M. = 1 Troy oz. / Ton (2,000 lbs.)
 34,386 P.P.B. = 1 Troy oz. / Ton (2,000 lbs.)
 1,000 P.P.M. = 1%
 10,000,000 P.P.B. = 1%
 *0 = Less than 0.

W.S. READ

TO ACCOMPANY REPORT BY W.S. READ, P. ENG., DATED 31. MAY, 1981.

EATON MINING & EXPLORATION LTD.
 GOLDFINCH PROPERTY, CANBORNE, B.C.
N.T.S. 26° 15' 30" N 117° 39' W

RECONNAISSANCE GEOCHEMICAL SURVEY
 DETAILED AREA

Scale: 1:1000 (Metric)

DATE: 31. MAY, 1981. REVISION: No. 8

WAYLAND S. READ P. Eng. Consulting Geologist, Cobble Hill, B.C.

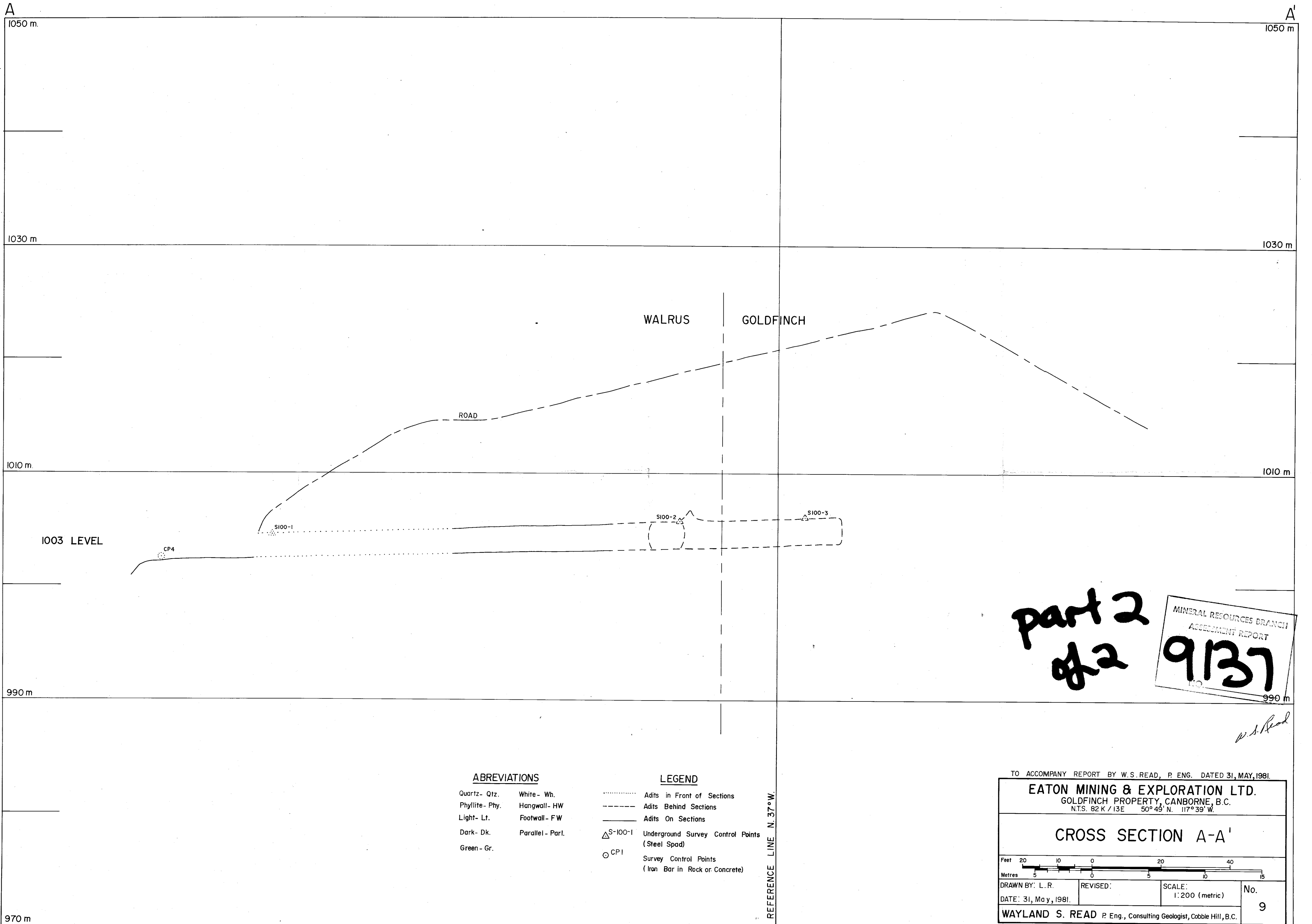

ABBREVIATIONS

Quartz - Qtz.	White - Wh.
Phyllite - Phy.	Hangwall - HW
Light - Lt.	Footwall - FW
Dark - Dk.	Parallel - Parl.
Green - Gr.	

LEGEND

.....	Adits in Front of Sections
-----	Adits Behind Sections
-----	Adits On Sections
△ S-100-1	Underground Survey Control Points (Steel Spad)
○ CPI	Survey Control Points (Iron Bar in Rock or Concrete)

TO ACCOMPANY REPORT BY W.S. READ, P. ENG. DATED 31, MAY, 1981.

EATON MINING & EXPLORATION LTD.

GOLDFINCH PROPERTY, CANBORNE, B.C.
N.T.S. 82 K / 13E 50° 49' N. 117° 39' W.

CROSS SECTION A-A'



DRAWN BY: L.R.	REVISED:	SCALE: 1:200 (metric)	No. 9
----------------	----------	-----------------------	-------

WAYLAND S. READ P. Eng., Consulting Geologist, Cobble Hill, B.C.

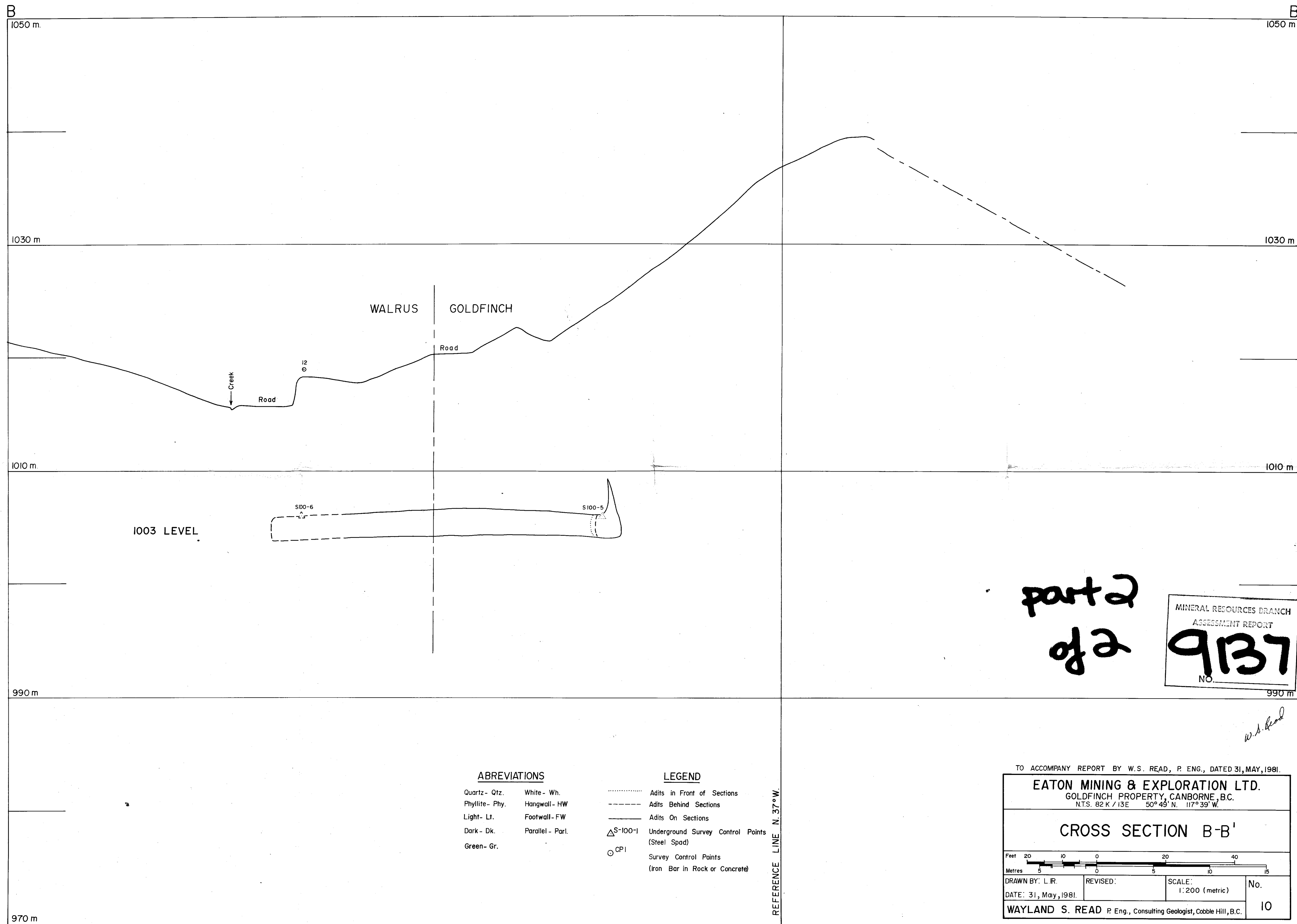

part 2
of 2

MINERAL RESOURCES BRANCH
ASSESSMENT REPORT
NO. **9137**

W.S. Read

TO ACCOMPANY REPORT BY W.S. READ, P. ENG., DATED 31, MAY, 1981.

EATON MINING & EXPLORATION LTD.
GOLDFINCH PROPERTY, CANBORNE, B.C.
N.T.S. 82° K / 13E 50° 49' N. 117° 39' W.

CROSS SECTION B-B'

Feet 20 10 0 20 40
Metres 5 10 0 5 10 15

DRAWN BY: L.I.R.	REVISED:	SCALE: 1:200 (metric)	No.
DATE: 31, May, 1981.			10

WAYLAND S. READ P. Eng., Consulting Geologist, Cobble Hill, B.C.

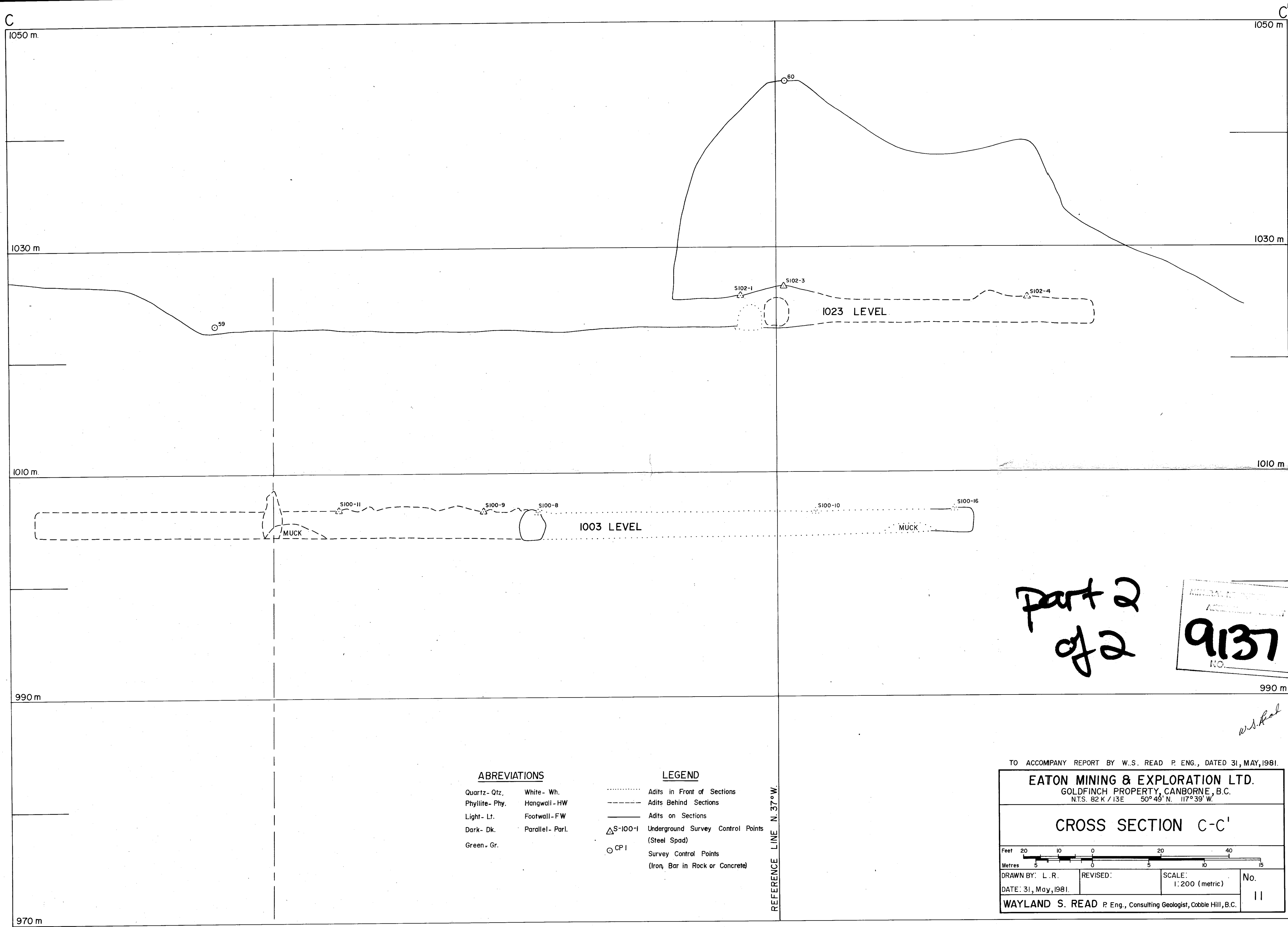

ABBREVIATIONS

Quartz - Qtz. White - Wh.
 Phyllite - Phy. Hangwall - HW
 Light - Lt. Footwall - FW
 Dark - Dk. Parallel - Parl.
 Green - Gr.

LEGEND

..... Adits in Front of Sections
 - - - - - Adits Behind Sections
 _____ Adits on Sections
 △ S-100-1 Underground Survey Control Points (Steel Spad)
 ○ CPI Survey Control Points (Iron Bar in Rock or Concrete)

REFERENCE LINE N. 37° W.

TO ACCOMPANY REPORT BY W.S. READ P. ENG., DATED 31, MAY, 1981.

EATON MINING & EXPLORATION LTD.
 GOLDFINCH PROPERTY, CANBORNE, B.C.
 N.T.S. 82 K / 13E 50° 49' N. 117° 39' W.

CROSS SECTION C-C'

Feet 20 10 0 20 40
 Metres 5 10 0 5 10 15

DRAWN BY: L. R.	REVISED:	SCALE: 1:200 (metric)	No. 11
DATE: 31, May, 1981.			

WAYLAND S. READ P. Eng., Consulting Geologist, Cobble Hill, B.C.

part 2 of 2

9137
NO.

W.S. Read

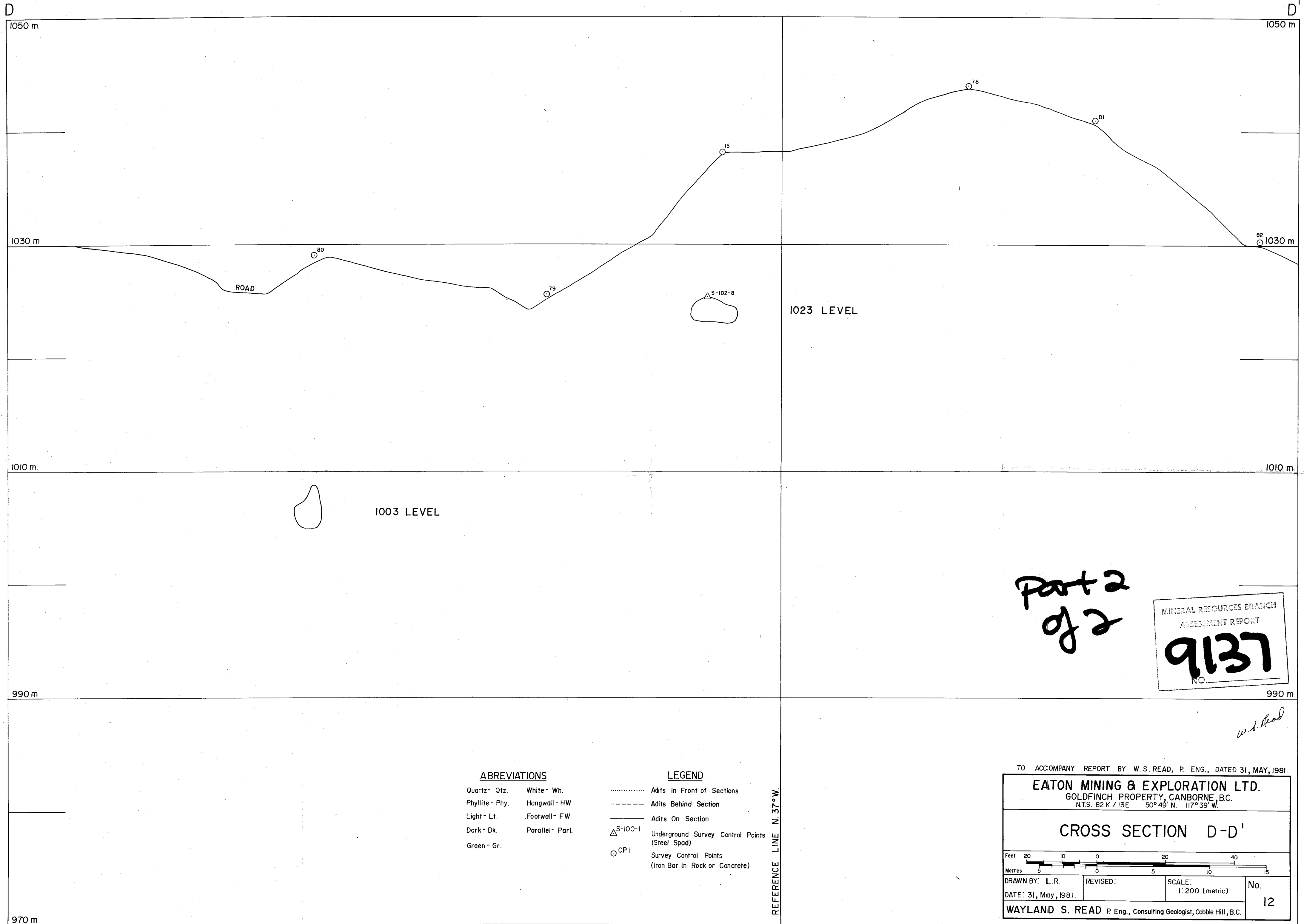

ABBREVIATIONS

Quartz - Qtz. White - Wh.
 Phyllite - Phy. Hangwall - HW
 Light - Lt. Footwall - FW
 Dark - Dk. Parallel - Parl.
 Green - Gr.

LEGEND

..... Adits In Front of Sections
 - - - - - Adits Behind Section
 ——— Adits On Section
 △ S-100-1 Underground Survey Control Points (Steel Spad)
 ○ CPI Survey Control Points (Iron Bar in Rock or Concrete)

REFERENCE LINE N. 37° W.

Part 2 of 2

MINERAL RESOURCES BRANCH
 ASSESSMENT REPORT
9137
 NO.

W.S. Read

TO ACCOMPANY REPORT BY W.S. READ, P. ENG., DATED 31, MAY, 1981.

EATON MINING & EXPLORATION LTD.
 GOLDFINCH PROPERTY, CANBORNE, B.C.
 N.T.S. 82 K / 13E 50° 49' N. 117° 39' W.

CROSS SECTION D-D'

Feet 20 10 0 20 40
 Metres 5 10 0 5 10 15

DRAWN BY: I.L.R. REVISED: SCALE: 1:200 (metric)
 DATE: 31, May, 1981. No. 12

WAYLAND S. READ P. Eng., Consulting Geologist, Cobble Hill, B.C.

990 m

990 m

1010 m

1010 m

1030 m

1030 m

1050 m

1050 m

970 m

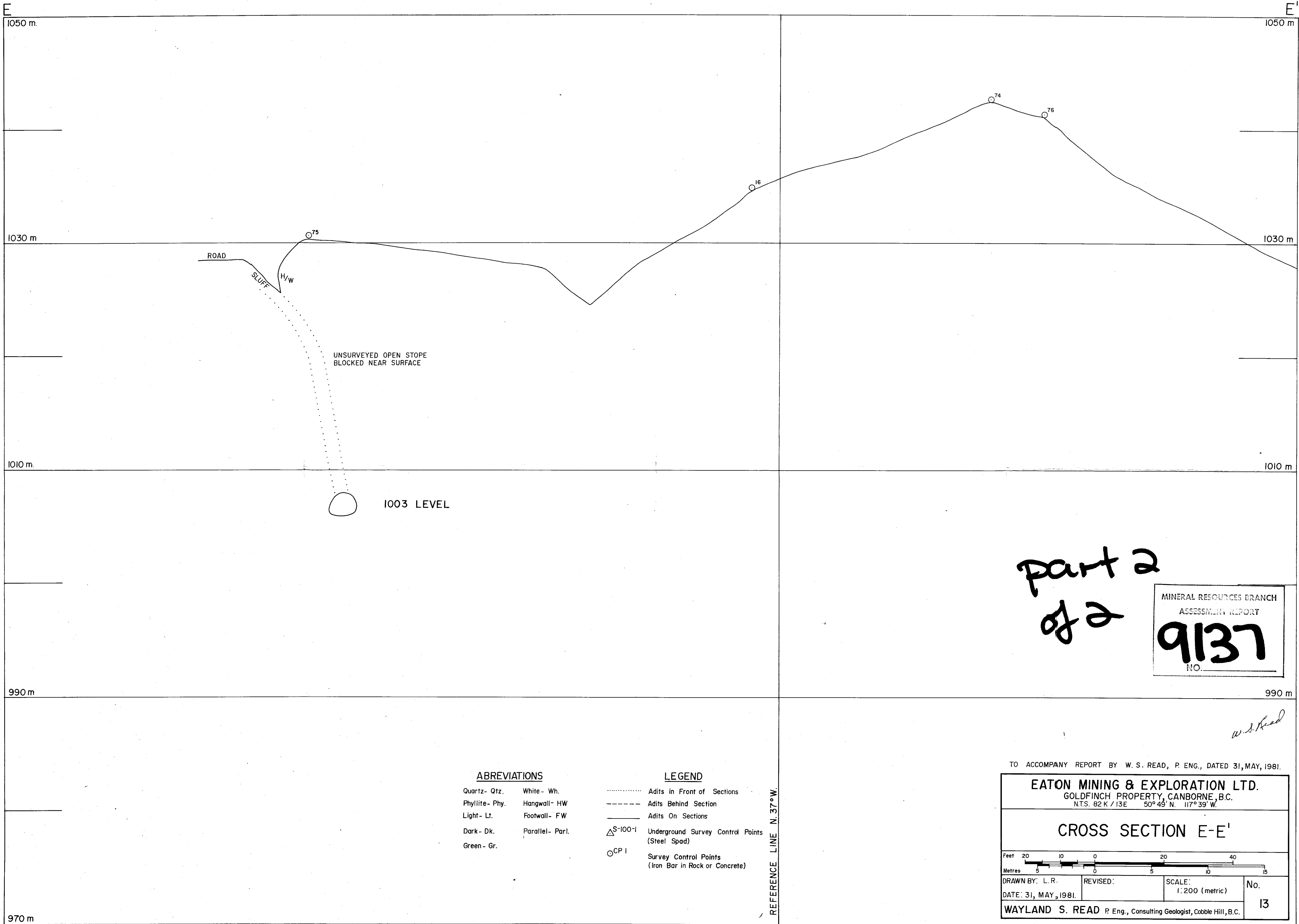

part 2
of 2

MINERAL RESOURCES BRANCH
ASSESSMENT REPORT
9137
NO.

W.S. Read

ABBREVIATIONS

Quartz - Qtz. White - Wh.
Phyllite - Phy. Hangwall - HW
Light - Lt. Footwall - FW
Dark - Dk. Parallel - Parl.
Green - Gr.

LEGEND

..... Adits in Front of Sections
- - - - - Adits Behind Section
——— Adits On Sections
△ S-100-l Underground Survey Control Points (Steel Spad)
○ CP 1 Survey Control Points (Iron Bar in Rock or Concrete)

REFERENCE LINE N. 37° W.

TO ACCOMPANY REPORT BY W. S. READ, P. ENG., DATED 31, MAY, 1981.

EATON MINING & EXPLORATION LTD.
GOLDFINCH PROPERTY, CANBORNE, B.C.
N.T.S. 82 K / 13E 50° 49' N. 117° 39' W.

CROSS SECTION E-E'

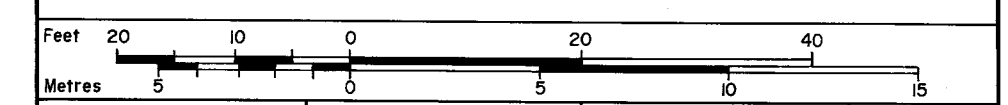

DRAWN BY: L.R.	REVISED:	SCALE: 1:200 (metric)	No.
DATE: 31, MAY, 1981.			13
WAYLAND S. READ P. Eng., Consulting Geologist, Cobble Hill, B.C.			

970 m

990 m

1010 m

1030 m

1050 m

990 m

1010 m

1030 m

1050 m

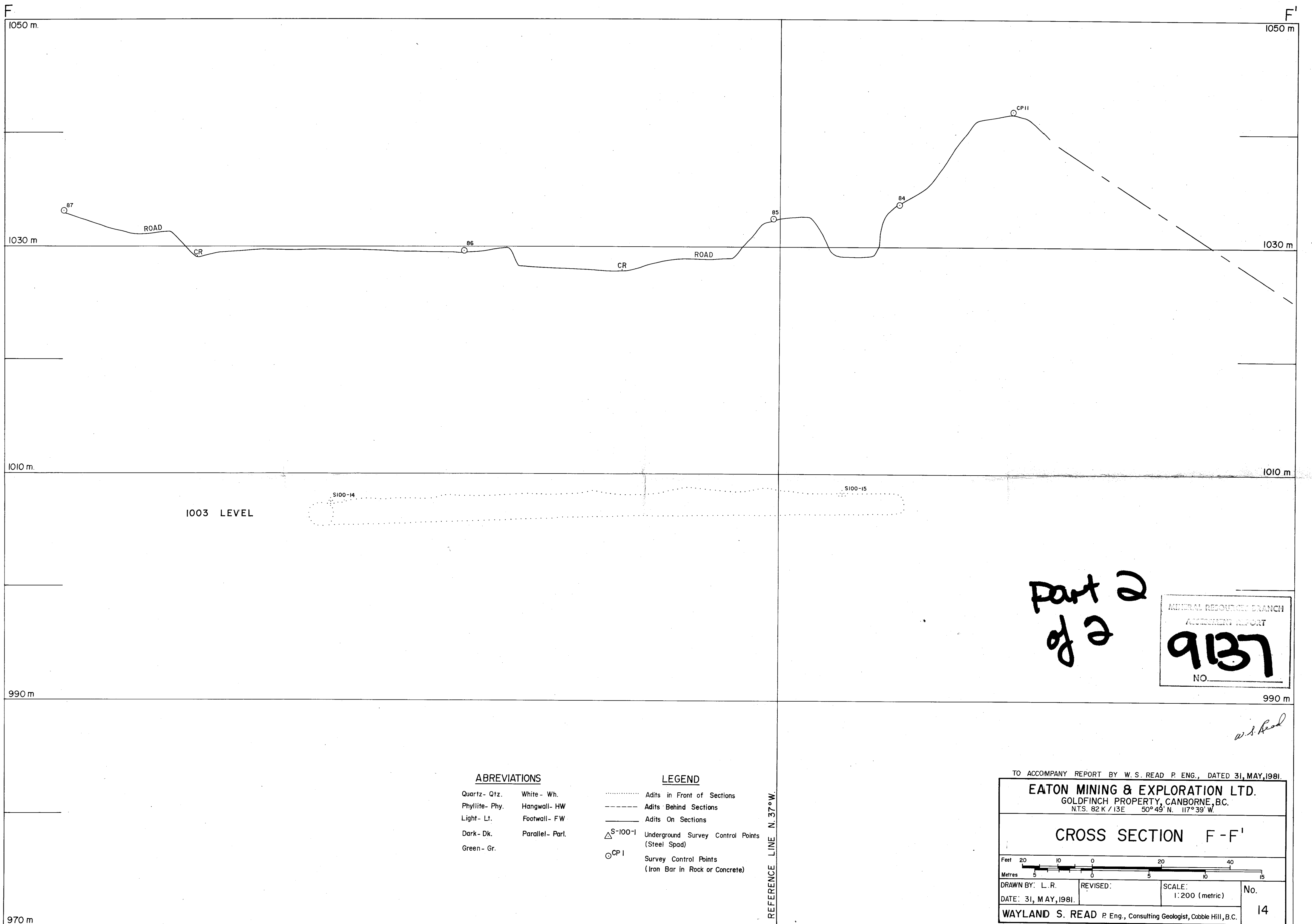

Part 2
of 2

MINERAL RESOURCES BRANCH
ASSESSMENT REPORT
NO. **9137**

W.S. Read

ABBREVIATIONS

Quartz - Qtz. White - Wh.
Phyllite - Phy. Hangwall - HW
Light - Lt. Footwall - FW
Dark - Dk. Parallel - Parl.
Green - Gr.

LEGEND

..... Adits in Front of Sections
- - - - - Adits Behind Sections
———— Adits On Sections
△^{S-100-1} Underground Survey Control Points
(Steel Spad)
○ CP 1 Survey Control Points
(Iron Bar in Rock or Concrete)

REFERENCE LINE N. 37° W.

TO ACCOMPANY REPORT BY W.S. READ P. ENG., DATED 31, MAY, 1981.

EATON MINING & EXPLORATION LTD.
GOLDFINCH PROPERTY, CANBORNE, B.C.
N.T.S. 82 K / 13 E 50° 49' N. 117° 39' W.

CROSS SECTION F-F'

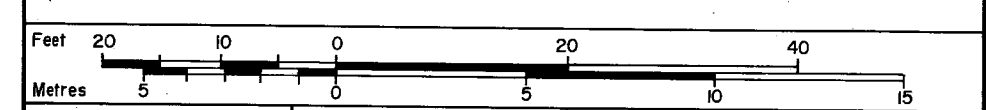

DRAWN BY: L. R. REVISED: SCALE: 1:200 (metric) No. 14
DATE: 31, MAY, 1981. WAYLAND S. READ P. Eng., Consulting Geologist, Cobble Hill, B.C.

OUTLINE OF DETAIL
GEOCHEMICAL SURVEY
FIG. 8

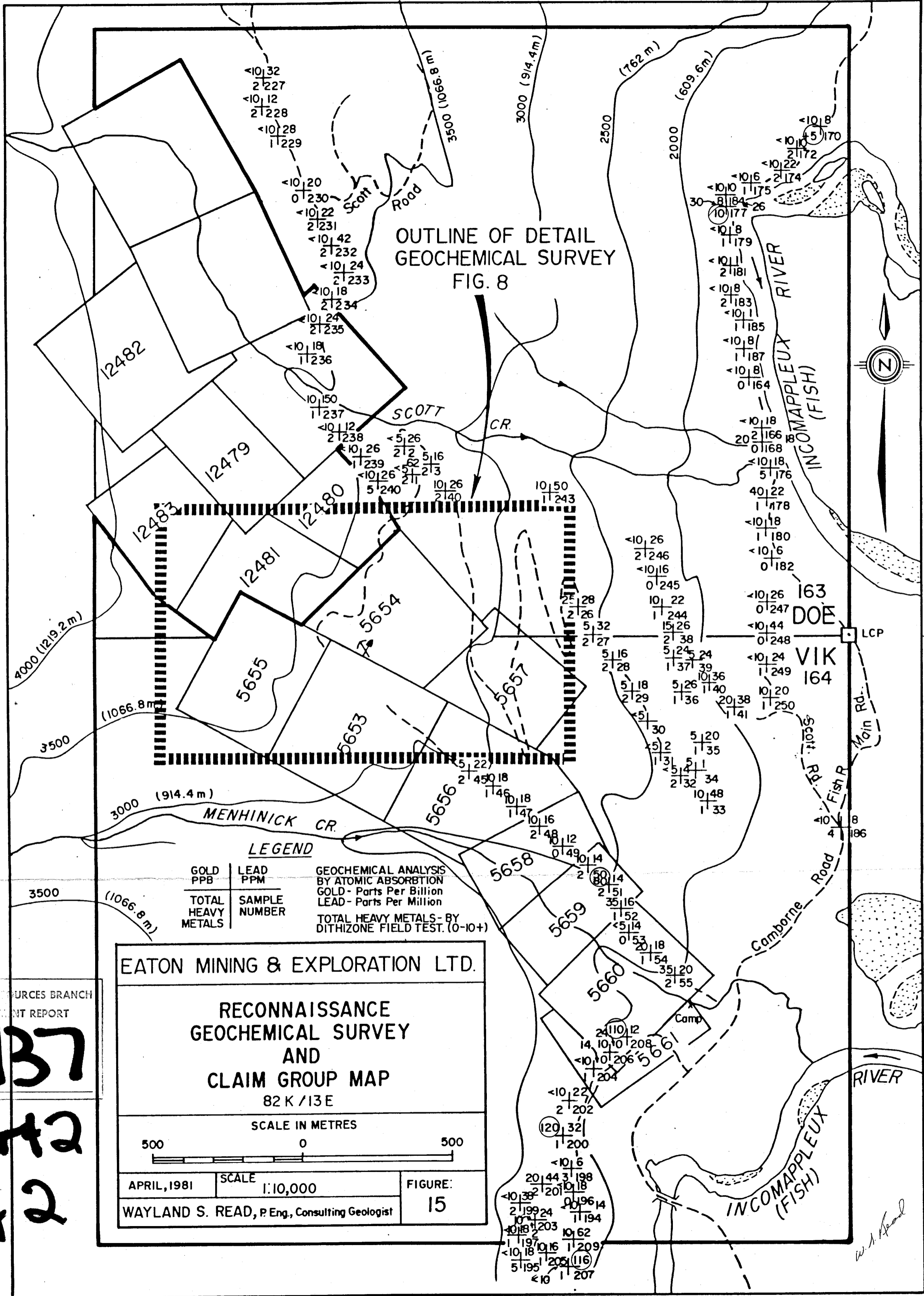

LEGEND

GOLD PPB	LEAD PPM	GEOCHEMICAL ANALYSIS BY ATOMIC ABSORPTION GOLD - Parts Per Billion LEAD - Parts Per Million
TOTAL HEAVY METALS	SAMPLE NUMBER	
		TOTAL HEAVY METALS - BY DITHIZONE FIELD TEST. (0-10+)

EATON MINING & EXPLORATION LTD.

**RECONNAISSANCE
GEOCHEMICAL SURVEY
AND
CLAIM GROUP MAP**
82 K / 13 E

SCALE IN METRES

500 0 500

APRIL, 1981 SCALE 1:10,000 FIGURE: 15

WAYLAND S. READ, P. Eng., Consulting Geologist

9137

MINERAL RESOURCES BRANCH
ASSESSMENT REPORT

9137

**Part 2
of 2**

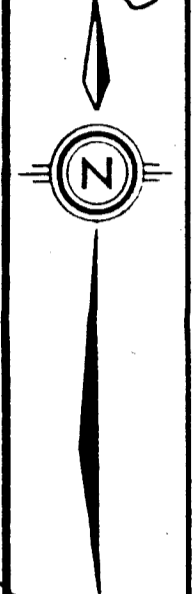

W.S. Read