

SHIMA RESOURCES LIMITED

81-4515
-29300

RESULTS OF 1980 DRILL PROGRAM
TEXADA ISLAND PROPERTY
NANAIMO M.D., B. C.

JANUARY 1981 K.C. FAHRNI, P.ENG.

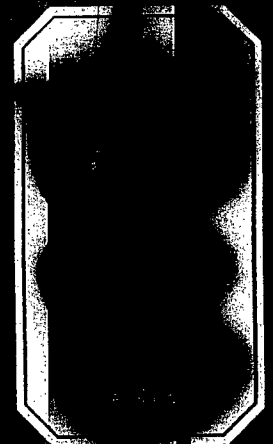

KEITH C. FAHRNI, P.ENG.

7011 ANGUS DRIVE
VANCOUVER, B. C.
CANADA, V6P 5J6
(604) 261-6426

January 31, 1981.

R.W. Margetts, President,
Shima Resources Limited,
213-475 Howe Street,
Vancouver, B.C.
V6C 2B3

Dear Sir:

Attached is my report of the results of the 1980 drilling program on the company's Texada Island property. I have limited the report to factual results without more than a minimum of interpretation with the idea that this report would be a record of work done rather than an assessment of the potential of the property.

Some further thought should be given to the situation before planning additional work.

Yours very truly



Keith C. Fahrni, P.Eng.
Consultant.

MINERAL RESOURCES BRANCH
ASSESSMENT REPORT

9300

NO. _____

REPORT OF 1980 DRILLING

SHIMA RESOURCES LIMITED

TEXADA ISLAND PROPERTY

NANAIMO MINING DIVISION

B.C., CANADA

NT.S 92 F-NE

LONGITUDE $49^{\circ}43'$ NORTH

LATITUDE $124^{\circ}32'$ WEST



BY KEITH C. FAHRNI, P.ENG.
CONSULTANT
7011 ANGUS DRIVE,
VANCOUVER, B.C.
V6P 5J6

JANUARY 1980

CONTENTS

	<u>PAGE</u>
1. INTRODUCTION	1
2. SUMMARY AND CONCLUSIONS	1
2.1 Little Billie Grid	1
2.2 Lake North Program	2
2.3 Basic II Program	2
3. RECOMMENDATIONS	3
4. DETAILED REPORT	4
4.1 Summary of Drillers Log Sheets	4
4.2 Location of Drill Hole Collars	7
4.3 Geological Logging and Sampling	7
4.4 Assaying	8
4.5 Costs of Drill Program for 1980	9
5. MAPS AND SECTIONS	12
6. REFERENCES	13
7. CERTIFICATION	14
8. APPENDICES	15
8.1 Drill Hole Geological Logs	
8.2 Assay Certificates	
8.2 Copies of Invoices	

1. INTRODUCTION

This report has been prepared to record work which was done during 1980 on property held by Shima Resources Ltd. on Texada Island, Nanimo Mining Division of B.C. The property extend across the island from the town of Vananda in the north to the town of Gillies Bay on the south and includes a number of old mines with records of production, the most recent operation being that of Texada Mines Ltd. The mineral claims comprising the property are shown on an accompanying map. Most of these are under contract from Ideal Basis and Ideal Cement Ltd. and some are held by Shima Resources. In total there are 108 located claims, 31 Crown grants and 3 mineral leases. They have recently been regrouped according to the new mining regulations and all are in good standing.

The work which was done follows recommendations of my report dated March 7th, 1980. Recommendations of Stage I were carried out with slight modification. The estimation of costs for the Stage 1 work was \$138,750 for 1850 meters of drilling in 12 drill holes based upon an estimated rate of \$75.00 per meter.

Work recommendations beyond Stage I were contingent upon the results of the proposed Stage I drilling.

2. SUMMARY AND CONCLUSIONS

The drilling carried out during 1980 totalled 1501.8 meters of drill hole in 10 holes for a total cost of \$99,077.61 which gives an average cost of \$66.00 per meter. Work went ahead with little delay and benefited by having had the drill outfit stored on Texada Island during the 1979-1980 winter season. The work was concentrated on three mineral claims which covered the six geophysical anomalies defined by Ager's report of July 7, 1979.

- 2.1 LITTLE BILLIE GRID: This work was to investigate Ager's anomalies #1 and #2. All of this work was on McLeod No. 3 M.C. Total length drilled was 848.6 meters in DHs SR 80-1 through to SR80-5 at a pro-rated cost of

\$54,978.85. SR80-1 checked Anomaly #1, a combined gravity and I.P. anomaly which lay above the projected intersection of the floor of the limestone basin with the Little Billie diorite stock. At the projected depth the diorite was intersected with only a little skarn on the contact where mineralization was expected. A small amount of molybdenite was noted but assays showed only 0.069% Mo over 2.3 meters. Holes SR80-2 to 5 provided additional follow up at closer spacing on the good values previously obtained from drill hole SR79-1. All of these holes ended in the diorite stock and none showed any significant mineralization.

- 2.2 The Lake North program was to check Ager's anomalies No. 5 and 6 which were due to higher gravity values and I.P. indications. The work was done on Lime M.C. Three drill holes had a total length of 399.0 meters being SR80-6 to SR80-8. The pro-rated cost of this work was \$26,354.64. The drilling proved the effectiveness of the gravity survey in identifying up-swellings of basement volcanics. Considerable quantities of fine grained pyrite and some garnet and magnetite were found at the contact between the overlying limestone and the volcanics but assays failed to show the presence of significant mineralization except for one sample in SR80-7 located entirely within the basement volcanics which assayed 0.082 ounces per ton in gold over 1.0 meters.
- 2.3 The Basic II program was drilled to check anomalies #3 and #4 identified by Ager's geophysical survey. Work was entirely on Basic II Mineral claim. Two holes, SR80-9 and SR80-10 totalled 254.2 meters. The pro-rated cost of the work was \$16,744.12.

The drill holes showed two intersecting dykes, one being a wide diorite dyke which apparently underlies the entire lake and muskeg and the other is a traverse andite dyke. Substantial amounts of epidote alteration occur with some pyrite but sampling failed to indicate any mineralization of interest.

3. RECOMMENDATIONS

- 3.1 It is recommended that the amounts of drilling expenditures for 1980 as pro-rated to the three mineral claims listed be recorded in favour of the claims with the district Mining Recorder at Nanaimo. In this way a credit will be established which can be used at some future time for the benefit of claims groups in which its claims occur.
- 3.2 On the Little Billie prospect, inspite of the negative results from the 1980 drill program, the fact that two mining operations once existed here makes it the property with the best exploration hopes. Any further exploration efforts should be based upon a detailed assessment of the geology of the entire area including the old mines and earlier drill holes as well as the recent drilling by Shima in the anomalous area identified by Ager's geophysical survey. The interesting junction of the floor of the limestone syncline with the Little Billie diorite still remains to be located and further exploration for this feature is recommended.
- 3.3 Further drilling in the Lake North area is recommended. While the 1980 drill holes did not cut any interesting mineralization, the position of the synclinal structure in which the Lake ore body of Texada Mines lies has been defined. Although drill holes from surface will be long (over 150 meters) there should be a good success ratio. The hope would be that a greater proportion of precious metals will be present further back from the Gillies Bay diorite body. Ultimate mining access would be possible through the adit incline from the floor of Lake pit with dewatering.
- 3.4 It is recommended that interest in the Basic II area be dropped. Although the apparent magnetic anomaly was not explained, the complete absence of metal values in the samples from the drill holes is discouraging.

4. DETAILED REPORT

4.1 Summary of Drillers Log Sheets

Note: Drill crews worked shifts of 10 hours.

LITTLE BILLIE AREA MARCH 25 to APRIL 3, 1980

Hole No.	Date	Shift No.	ADVANCE (FT)			LENGTH		Remarks
			From	To	Net	Ft.	M.	
SR80-1	25/3/80	D2	-	-	-			Gathering equipment, travel
	26/3/80	D2	-	-	-			Working on outfit modification
	27/3/80	D2	-	-	-			Moving and setting up
	28/3/80	D	0	102	102			Drilling
		A	102	200	98			"
	29/3/80	D	200	345	145			"
		A	345	458	113			"
	30/3/80	D	458	563	105			"
		A	563	666	103			"
	31/3/80	D	666	756	90			"
		A	756	827	71			"
	1/4/80	D	827	888	61			"
		A	888	954	66			"
	2/4/80	D	954	1044	90			"
		A	1044	1054	10	1054	321.3	Drilling and tear down
	3/4/80	D						Store outfit. demob.

LITTLE BILLIE AREA JUNE 10-22, 1980

Hole No.	Date	Shift No.	ADVANCE (FT)			LENGTH		Remarks
			From	To	Net	Ft.	M	
SR80-2	10/6/80	(1)						Travelling
	11/6/80	(2)	0	10	10			Set up & Drilling
	12/6/80	D	10	116	106			Drilling
		A	116	218	102			"
	13/6/80	D	218	327	109	327	99.67	Finished hole
		A	-	-	-			Tear down

Hole No.	Date	Shift No.	ADVANCE (FT)			LENGTH		Remarks
			From	To	Net	Ft.	M.	
SR80-3	14/6/80	D	0	24	24			Set up and drill Drilling
		A	24	103	79			
	15/6/80	D	103	208	105			Drilling
		A	208	301	93			Drilling
	16/6/80	D	301	427	126			Drilling Finished Hole
		A	427	494	67	494	150.57	
SR80-4	17/6/80	D	0	28	28			Set up & drilling Drilling
		A	28	148	120			
	18/6/80	D	148	308	160			Drilling
		A	308	418	110			Drilling
	19/6/80	D	418	501	87	501	152.70	Finish Hole Tear Down
		A	-	-	-			
SR80-5	20/6/80	D	0	43	43			Drilling Drilling
		A	43	163	120			
	21/6/80	D	163	265	102			Drilling
		A	265	345	80			Finished Hole
	22/6/80	A	345	408	63	408	124.36	

LAKE NORTH AREA

JULY 7 - 22, 1980

SR80-6	7/7/80	D(2)						Travelling
	8/7/80	D(2)						Moving rig to site
	9/7/80	D	0	38	38			Finish set-up Rods stuck, lights out
		A	38	89	51			
	10/7/80	D	89	191	102			Repairs & drilling Light Plant quit
		A	191	248	57			
	11/7/80	D	248	373	125			Repairs & drilling Broke shaft
		A	373	474	101	474	144.5	
SR80-7	12/7/80	D(2)						Repairs & moving
	13/7/80	D(2)						Move & set up
	14/7/80	D						Service drill Drilling
		A	0	51	51			
	15/7/80	D	51	152	101			Drilling Drilling & blocking
		A	152	230	78			

SR80-7 continued....

Hole No.	Date	Shift No.	ADVANCE (FT)			LENGTH		Remarks
			From	To	Net	Ft.	M.	
SR80-7 cont'd	16/7/80	D	230	247	17			Helper quit Water short, broken
		A	247	277	30			
	17/7/80	D	277	331	54			Hole caving Bad ground
		A	331	363	32			
	18/7/80	D	363	411	48			Cave in hole Broken ground
		A	411	451	40			
	19/7/80	D(2)	451	482	31	482	146.9	Drill & tear down
SR80-8	20/7/80	D	0	74	74			Move & set up Drilling
		A	74	145	71			
	21/7/80	D	145	221	76			Drilling Drilling
		A	221	327	106			
	22/7/80	D(2)	327	353	26	353	107.6	Finish and moving

BASIC II AREA

JULY 23 - 29, 1980

SR80-9	23/7/80	D(2)						Moving Rig
	24/7/80	D	0	103	103			Drilling Drilling
		A	103	281	178			
	25/7/80	D	281	423	142	423	128.9	Hole finished
SR80-10	25/7/80	A						Moving
	26/7/80	D	0	95	95			Drilling Drilling
		A	95	193	98			
	27/7/80	D	193	307	114			Drilling Drilling
		A	307	411	104	411	125.2	
	28/7/80	D(2)						Moving rig to yard
	29/7/80							Logged

TOTALS

Drilling	59				4927	1501.8	72.8% of time
Mechanical Delay	3						3.7% of time
Moving	19						23.5% of time
ALL DHs	81				4927	1501.8	Av. Advance 18.5 meters per shift

4.2 Location of Drill Hole Collars

The drill holes are located in three distinct areas as defined by the geophysical survey. In each area a grid line which was laid out by the geophysical crews was used as the control for hole location and after the drilling was completed simple surveys by tape and compass tied the drill hole collars to the grid stations. The coordinates of the holes are given in terms of the grid location for each of the three areas as shown on the accompanying location map. Elevations were obtained from the elevations provided by the geophysical survey at grid points with interpolation to the drill hole collar locations. Results are tabulated below and are indicated on accompanying sketches.

GRID AREA	HOLE NO.	LAT	DEP	ELEV.	BEAR.	INCLIN	LENGTH
L. Billie	SR80-1	2 + 50S	1 + 50E	83.8	-	- 90 ^o	321.3
	SR80-2	0 + 50S	1 + 80E	34.1	-	- 90 ^o	99.7
	SR80-3	0 + 68S	1 + 83E	36.1	-	- 90 ^o	150.6
	SR80-4	0 + 73S	2 + 10E	36.6	-	- 90 ^o	152.7
	SR80-5	0 + 50S	2 + 20E	33.6	-	- 90 ^o	124.3
TOTAL FOR L. BILLIE AREA							848.6
LAKE N.	SR80-6	0 + 00S	1 + 91E	177	-	- 90 ^o	144.5
	SR80-7	0 + 29N	1 + 00E	176	S56W	- 55 ^o	146.9
	SR80-8	0 + 00N	1 + 92E	177	DueW	- 55 ^o	107.6
TOTAL FOR LAKE NORTH AREA							399.0
BASIC II	SR80-9	2 + 08N	0 + 98W	125	-	- 90 ^o	128.9
	SR80-10	1 + 77N	0 + 12W	119	S27W	- 70 ^o	125.3
TOTAL FOR BASIC II GRID							254.2
TOTAL YEAR TO DATE:				LITTLE BILLIE			848.6
				LAKE NORTH			399.0
				BASIC II			254.2
				TOTAL			<u>1501.8</u>

4.3 Geological Logging and Sampling

The geological logs have been prepared for each drill hole with an accompanying graphic log on the left hand edge of the log sheets. Copies of these log sheets are included in the appendix of this report. The interpretation of the

geology of each area drilled are shown on accompanying plans and sections of the three areas.

Samples were taken for assay from sections of the drill core in which there appeared to be mineral of possible significance. These sections were noted in the drill logs and the core was split into two parts longitudinally by means of a Longyear screw type core splitter. One half of the core sampled retained with the rest of the core in the core trays and the other portion was bagged with an accompanying identification tag for transport to the assayers. The core trays carrying the core from the 1980 drilling have been stored in a core shed maintained by Ideal Basics Ltd. on the old Texada Mines plant site. Previous Shima drill cores are stored in the same repository.

4.4 Assaying

Samples taken from the drill core from the 1980 drill program were taken to Vancouver and were submitted for assay to General Testing Laboratories. Base metals were determined by fluorometric methods of assay and precious metals were determined by fire assaying. The results of the assays are tabulated below. Copies of the assay certificates are included in the appendix of the report.

		A S S A Y S			
LOCATION OF SAMPLE	SAMPLE NO.	GOLD OZ/ST	SILVER OZ/ST	COPPER %	MOLYBDENUM
DHSR80-1	095P	.002	Tr.	0.01	0.69
DHSR80-3	096P	.002	Tr.	-	
DHSR80-3	097P	.006	0.01	0.32	
DHSR80-5	098P	.008	TR.	-	
DHSR80-7	099P	.002	TR.	0.02	
"	100P	.002	TR.	0.01	
"	0151A	.082	TR.	0.02	
DHSR80-8	0152A	.012	TR.	0.08	
"	0153A	.006	TR.	0.04	
DHSR80-10	0154A	.002	TR.	0.01	
"	0155A	.002	TR.	0.01	
"	0156A	.008	TR.	0.02	
"	0157A	.008	TR.	0.01	
LAKE NOLD CUT.	0158A	.002	TR.	0.01	

4.5 Costs of Drill Program 1980

The costs of the drilling program are accumulated below under heading of "Drilling, "Core Handling" and "Engineering and Assaying." The invoices are listed by date below and copies of the actual invoices are included in the appendix of the report.

4.5.1 Drilling Costs

DATE	INVOICE	AMOUNT
April 11/80	D.J. Drilling - Footage Cost & Expenses	\$18,162.09
May 20/80	D.J. Drilling - Demob for Hole 80-1	891.00
June 27/80	D.J. Drilling - Work June 10-23 SR80-2 to 80-5	26,298.05
July 31/80	D.J. Drilling - Work for July 7-29 SR80-6 to SR80-10	42,568.57
July 18/80	Wayne Benjam Transport of Drill July 18/80	200.00
Aug 15/80	Bens Welding - Moving drill rig	200.00
Sept. 26/80	H. Stacy - Roadwork and sump	150.00
	TOTAL	\$88,468.71

4.5.2 Core Handling

July 2/80	Account S.L. Beale March 28/ to April	929.40
July 3/80	Account June 11-26 S.L. Beale	1,742.34
July 21/80	Account July 7 - July 21 S.L. Beale	1,761.62
Sept 1/80	Account July 22 - July 30 S.L. Beale	988.72
July 7/80	Texada Arms - Meals S.L. Beale	160.95
July 29/80	Texada Arms - meals S.L. Beale	147.15
July 11/80	Texada Food Market - groceries etc.	94.15
July 30/80	Centennial Service - gas and rental of truck	276.90
	TOTAL	\$6,101.23

4.5.3 Engineering and Assaying

DATE	INVOICE	AMOUNT
July 3/80	R.W. Margetts - Travel expenses KCF/RWM	140.00
June 7/80	KCF Invoice - Drill hole eng. & expenses	1,648.68
Sept 8/80	KCF Invoice - DD reports & logs, assays etc.	<u>2,717.99</u>
	TOTAL	\$4,506.67

TOTAL FOR ENGINEERING & ASSAYING \$ 4,506.67

4.5.4 Total and Average Costs of Program

The costs as accumulated above are combined below with the total length drilled of 1501.8 meters to provide average values for future estimation.

Cost Centre	Total \$	Cost/M	Per Cent.	Total
Drilling	88,469.71	58.91	98.29%	
Core Handling	6,101.23	4.06	6.16%	
Engineering & Assays	4,506.67	3.03	4.55%	
TOTAL	\$99,077.61	66.00	100.00%	

4.5.5 Drilling Costs pro rated to Areas

In all of the three areas rock and drilling conditions were quite similar. Because of the difficulty in assigning costs to individual drill holes, costs are pro-rated to each drilling area in proportion to the footage drilled. Results are as follows:

Area	Meters Drilled	Per Cent Total M.	Pro-Rated Cost
Little Bille	848.6	56.5%	\$55,978.85
Lake North	399.0	26.6%	26,354.64
Basic II	254.2	16.9%	16,744.12
TOTAL	1501.8	100.0	\$99,077.61

- 11 -

Respectfully submitted,

Keith C. Fahrni

Keith C. Fahrni, P.Eng.
Consultant

January, 1981

5. MAPS AND SECTIONS

The following plans and cross sections are attached to show the setting of the claim group and the relative positions of the areas in which exploratory drilling was carried out during 1980. Larger scale plans and sections illustrate the relative positions of drill holes in each area and the geological pattern which was developed. For the larger scale plans and sections the reference systems indicated are the grid systems for each particular area as marked out by the geophysical field cre s for Ager's 1979 survey.

Maps and illustrations are as follows:

5.1 Key Map showing position of property	page 12a
5.2 Shima Claim Map Vananda sheet	pocket
5.3 Shima Claim Map Gillies Bay Sheet	pocket
5.4 Location of Areas of Interest	page 12b
5.5 Plan of Little Billie Area	pocket
5.6 Cross Section 2 + 00 East, Little Billie Area	pocket
5.7 Cross Section 2 + 00 East, Little Billie Area	page 12c
5.8 Cross Section 1 + 50 East, Little Billie Area	page 12d
5.9 Cross Section 2 + 50 East, Little Billie Area	page 12e
5.10 Long. Section 0 + 50 South, Little Billie Area	page 12f
5.11 Long. Section 0 + 73 South, Little Billie Area	page 12g
5.12 Surface Plan Lake North Zone	page 12h
5.13 Cross Section 0 + 00 North, Lake North Zone	page 12i
5.14 Surface Plan Basic II Area	page 12j
5.15 Cross Section Basic II Area	page 12k

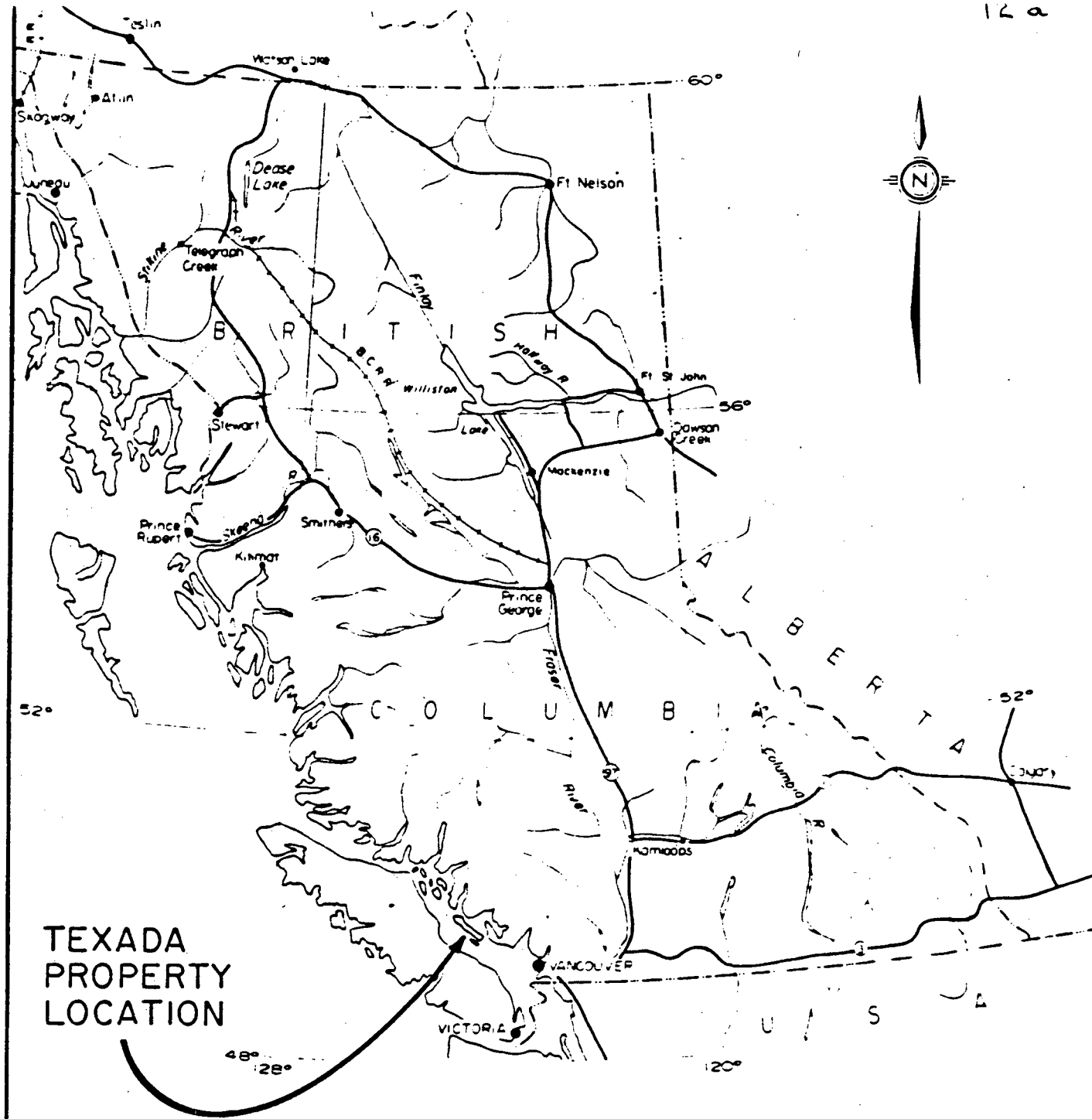

TEXADA
PROPERTY
LOCATION

SHIMA RESOURCES LIMITED
BOX 61 GILLIES BAY B.C.

TEXADA PROPERTY

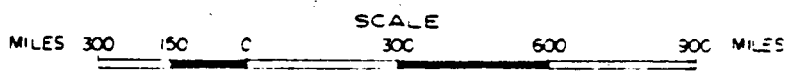

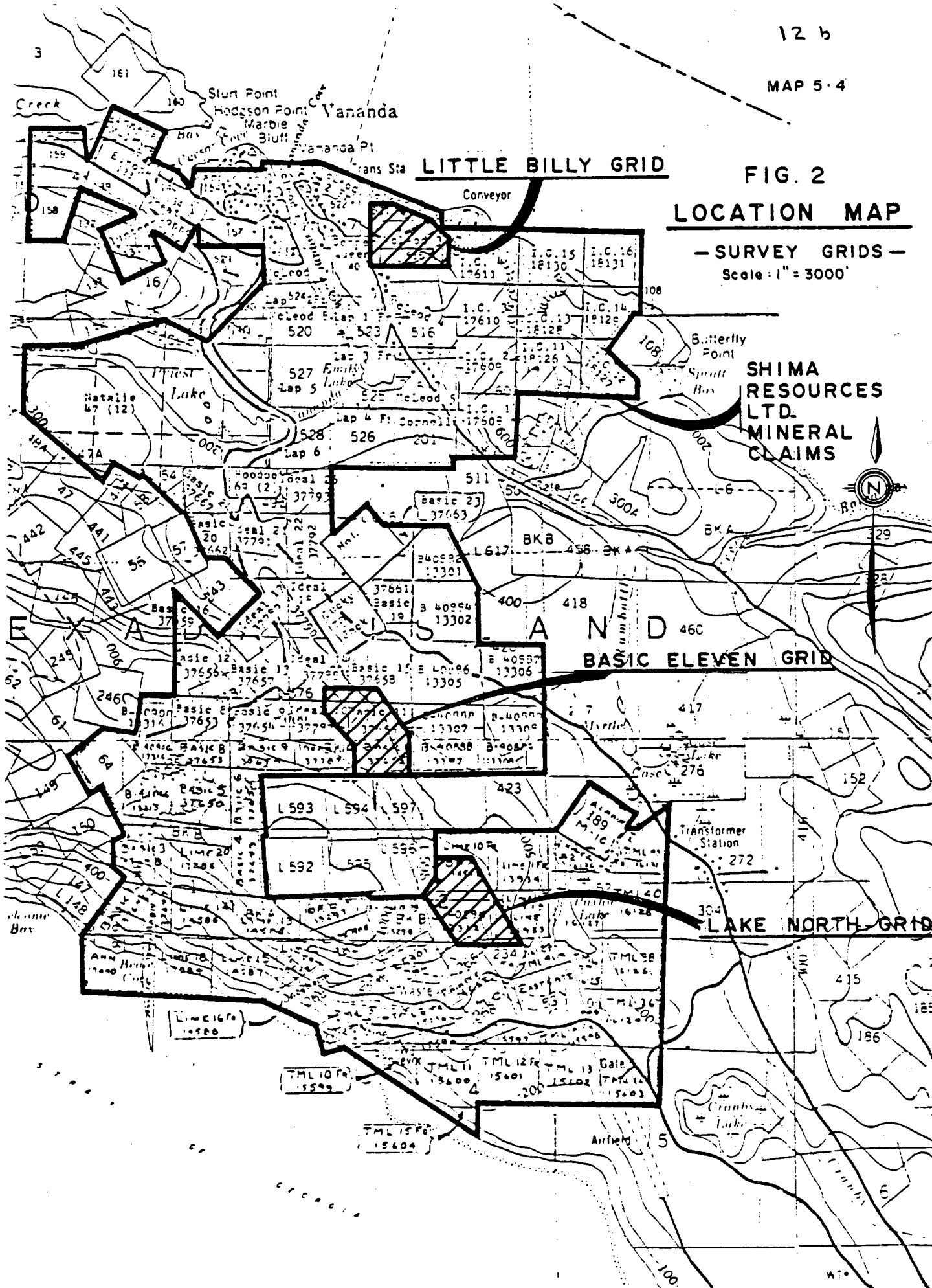

LITTLE BILLY GRID

FIG. 2

LOCATION MAP

- SURVEY GRIDS -

Scale: 1" = 3000'

SHIMA RESOURCES LTD. MINERAL CLAIMS

BASIC ELEVEN GRID

LAKE NORTH GRID



3

Slut Point
Hodgson Point
Marble Bluff
Vananda
Vananda Pt
Trans Sta
Conveyor

Creek

Conveyor

Butterfly Point

Smull Bay

Natalie Lake

Lake

AND

Transformer Station

LAKE NORTH GRID

Cranby Lake

Airfield

Bay

Ann

5

415

186

6

W.P.

REVISED: JULY 16, 1980

MAP 5-7

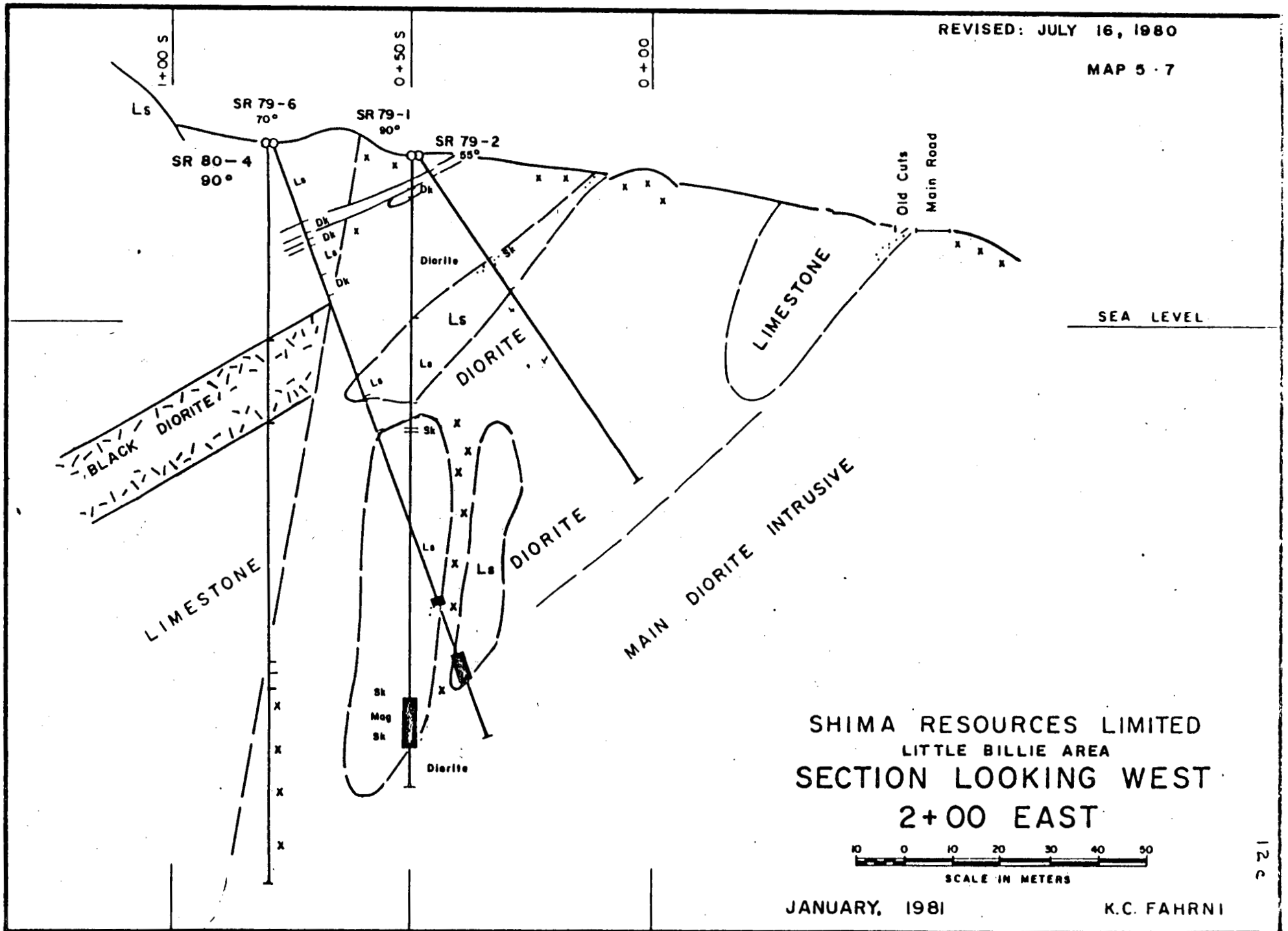

SHIMA RESOURCES LIMITED
LITTLE BILLIE AREA
SECTION LOOKING WEST
2+00 EAST

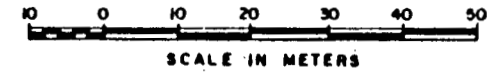

JANUARY, 1981

K.C. FAHRNI

12c

REVISED: JULY 16, 1980

MAP 5-8

1+00 S

0+50 S

0+00

SR 79-4
90°

SR 79-3
90°

Old Cut

L I M E S T O N E

G R A N O D I O R I T E

L I M E S T O N E

G R A N O D I O R I T E

SEA LEVEL

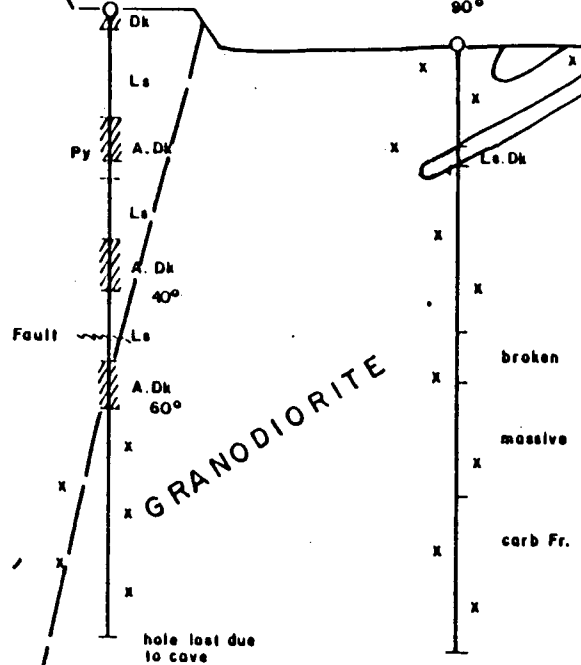

SHIMA RESOURCES LIMITED
LITTLE BILLIE AREA
SECTION LOOKING WEST
1+50 EAST

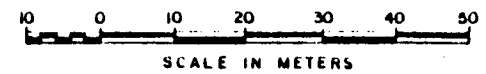

JANUARY, 1981

K.C. FAHRNI

124

REVISED: JULY 16, 1980

MAP 5-9

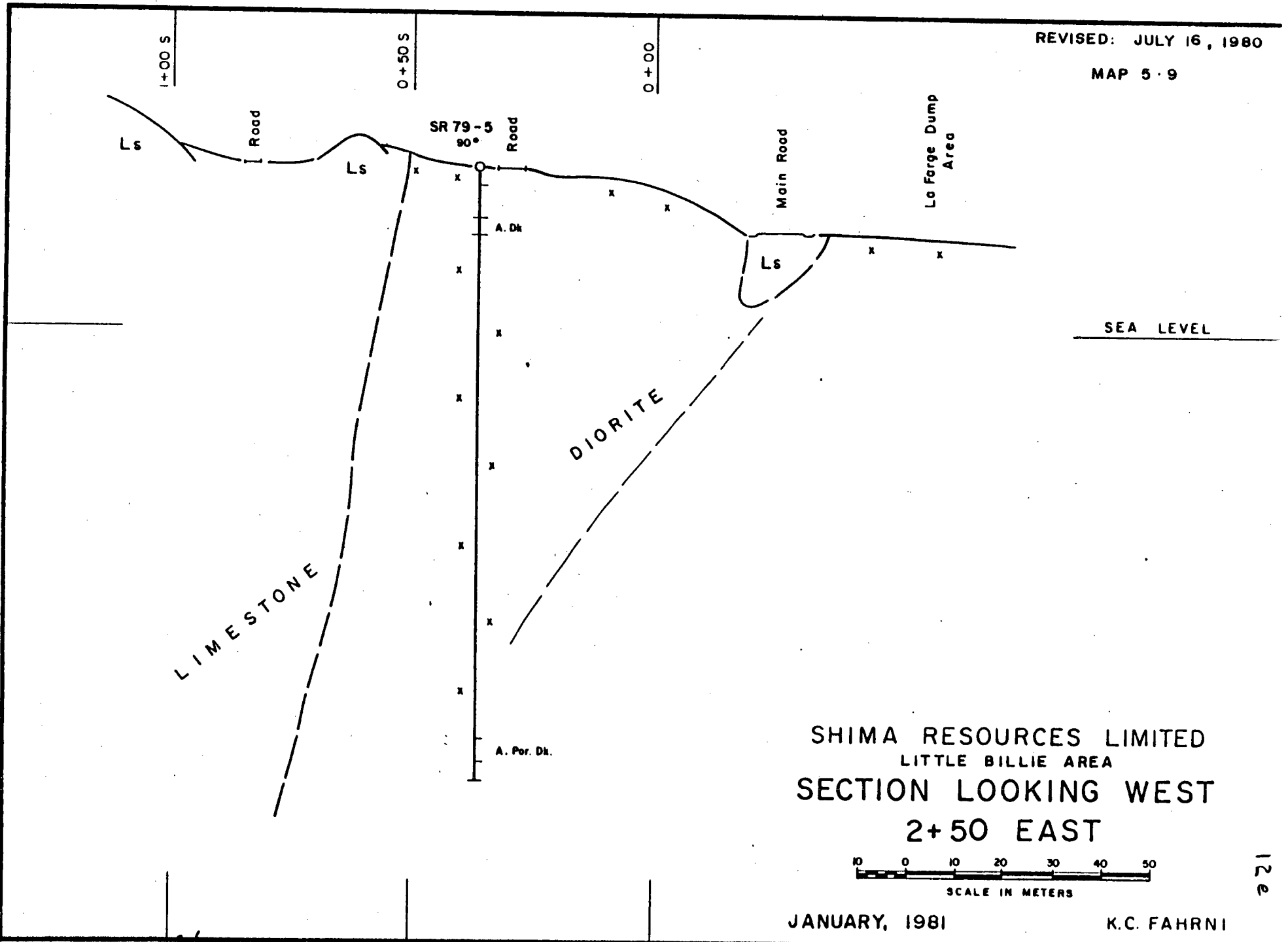

SHIMA RESOURCES LIMITED
LITTLE BILLIE AREA
SECTION LOOKING WEST
2+50 EAST



JANUARY, 1981

K.C. FAHRNI

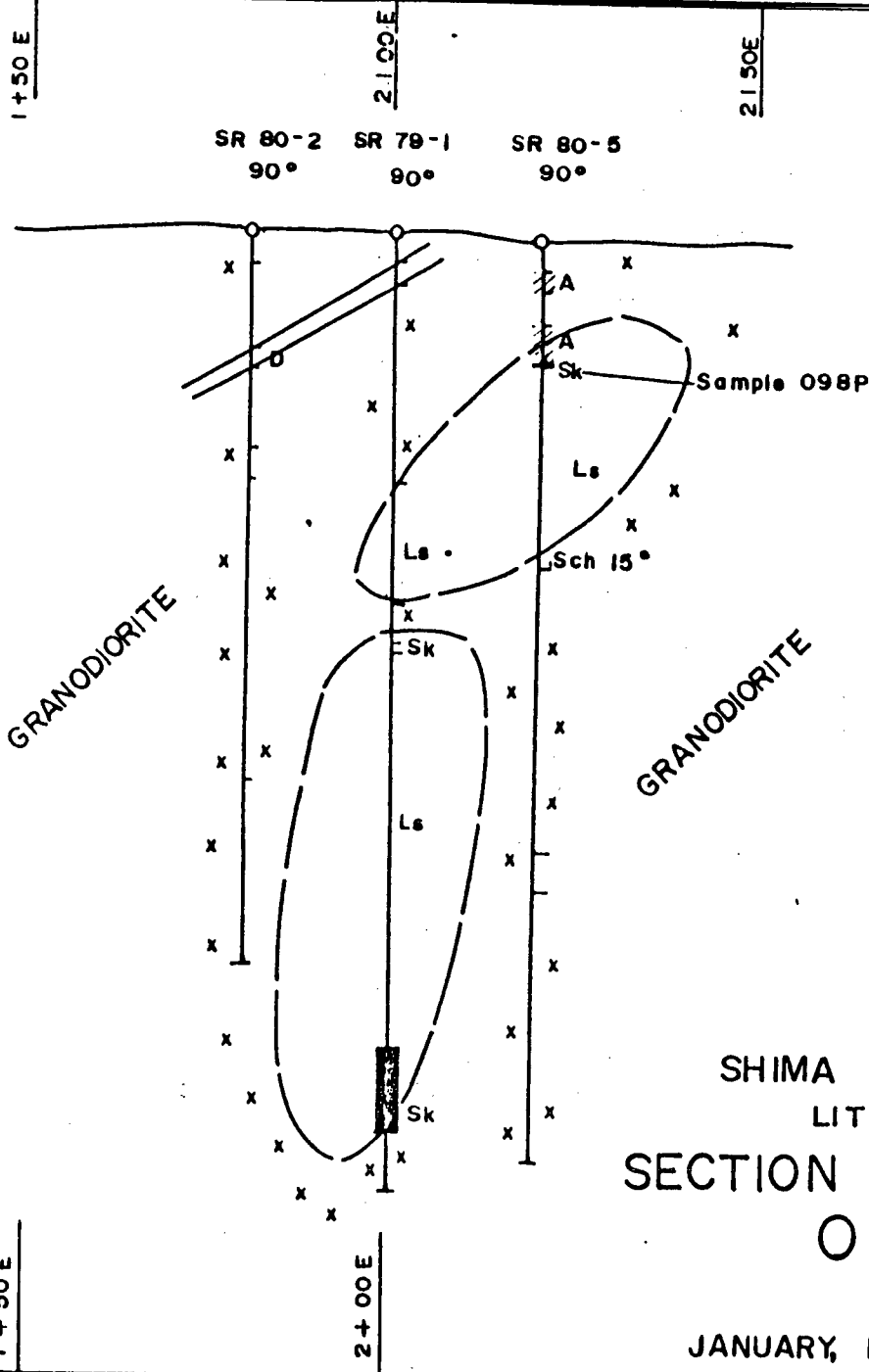

SEA LEVEL

SEA LEVEL

SHIMA RESOURCES LIMITED
 LITTLE BILLIE AREA
 SECTION LOOKING NORTH
 0+50 SOUTH

SCALE, 1 = 1000.

JANUARY, 1981

K.C. FAHRNI

121

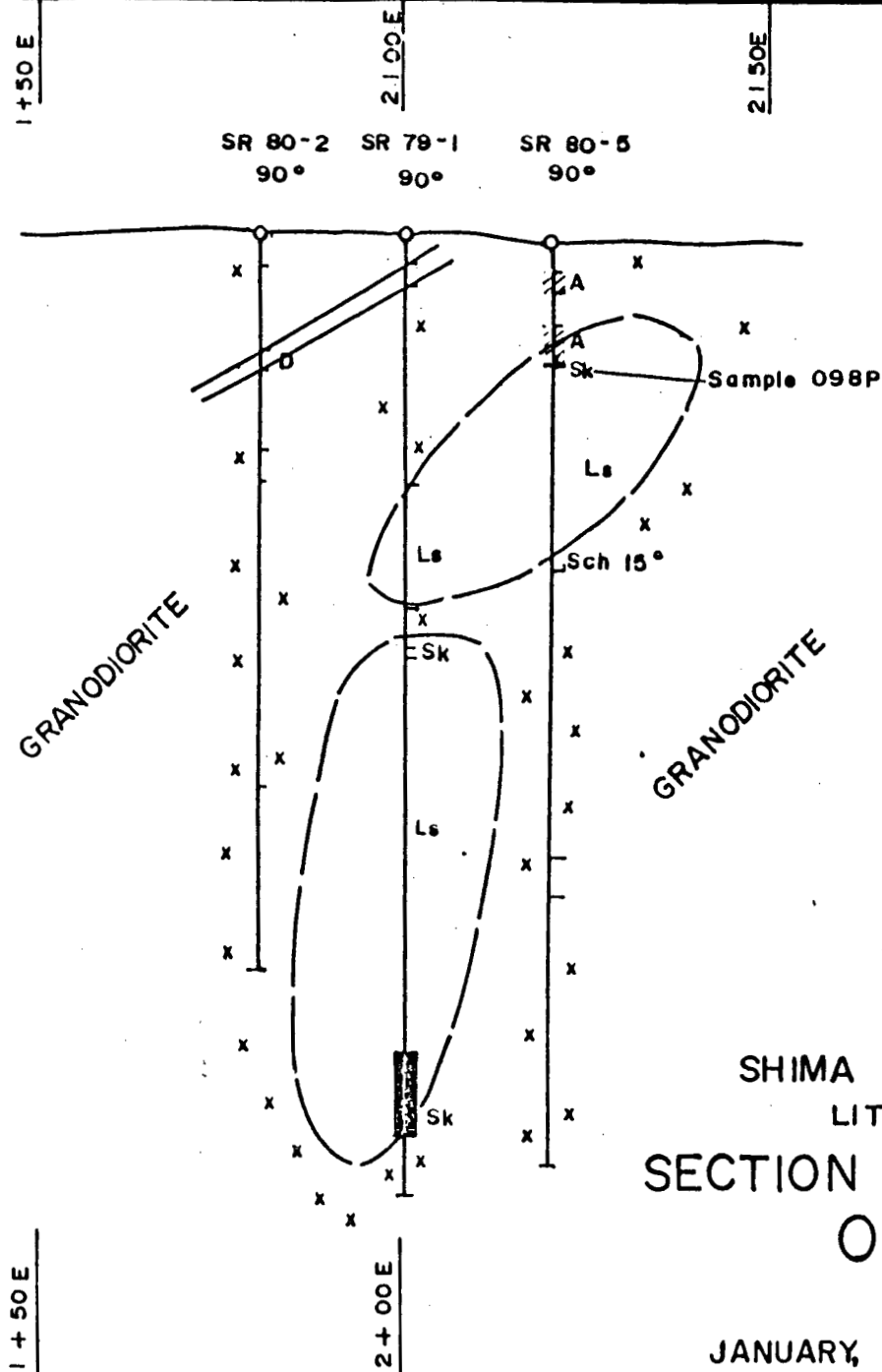

SEA LEVEL

SEA LEVEL

SHIMA RESOURCES LIMITED
 LITTLE BILLIE AREA
 SECTION LOOKING NORTH
 0+50 SOUTH

SCALE, 1 : 1000

JANUARY, 1981

K.C. FAHRNI

124

MAP 5 · 11

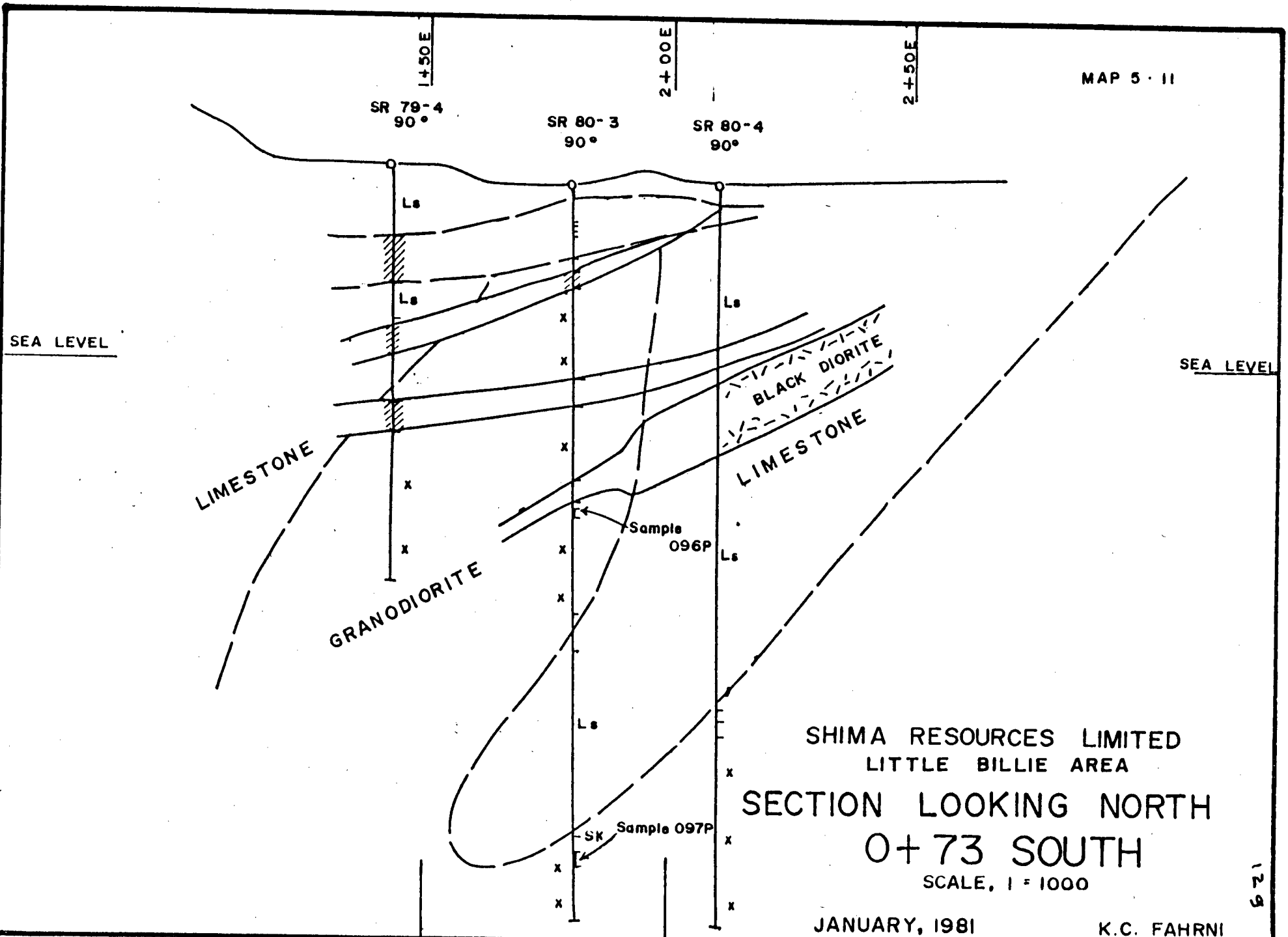

SEA LEVEL

SEA LEVEL

SHIMA RESOURCES LIMITED
LITTLE BILLIE AREA
SECTION LOOKING NORTH
0+73 SOUTH
SCALE, 1" = 1000

JANUARY, 1981

K.C. FAHRNI

129

SHIMA RESOURCES LIMITED

LAKE NORTH ZONE

LITTLE BILLIE AREA

SURFACE PLAN

Scale : 1 : 1000

K. C. Fahrni

Jan. 1981

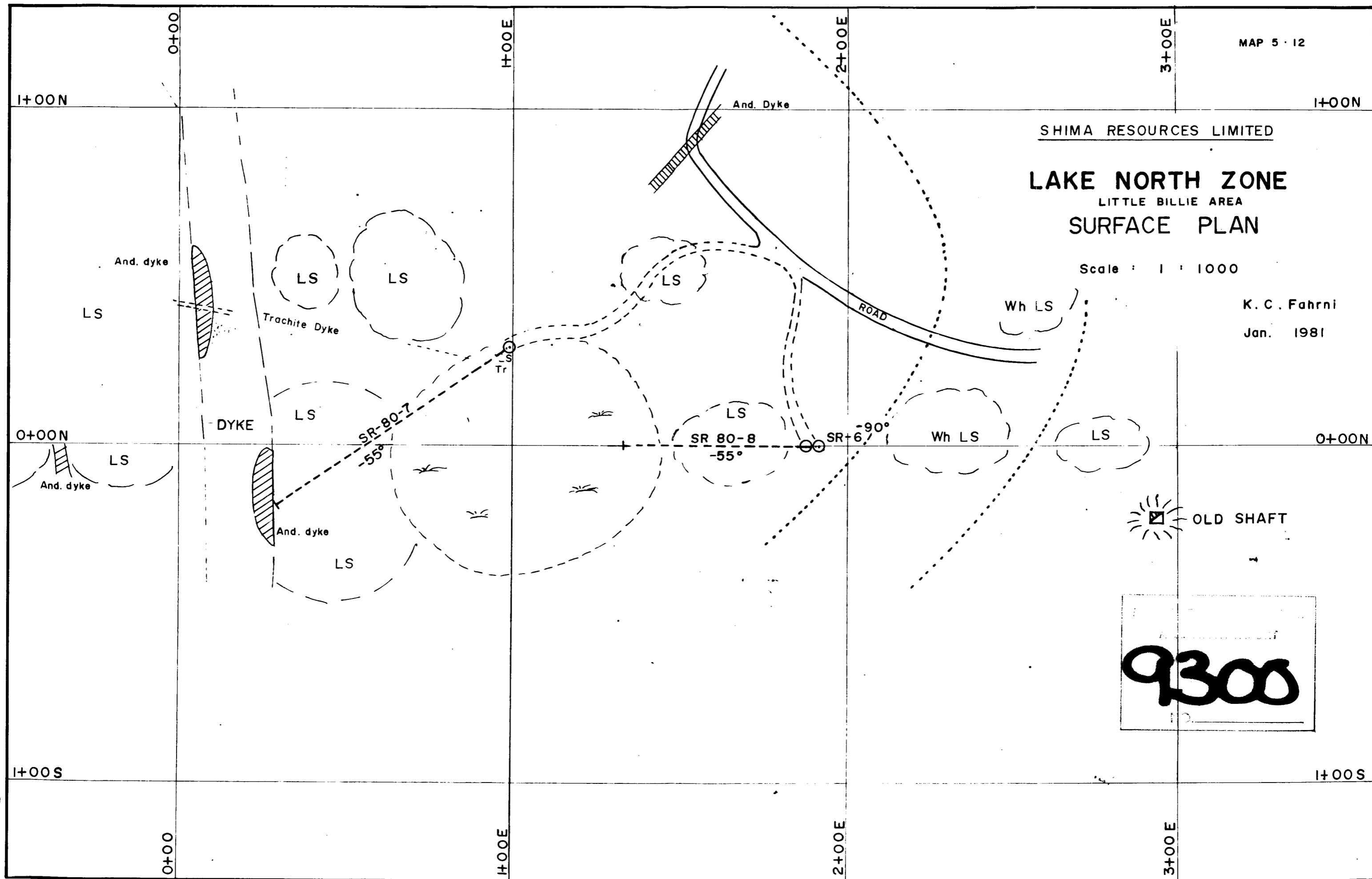

ELEV.

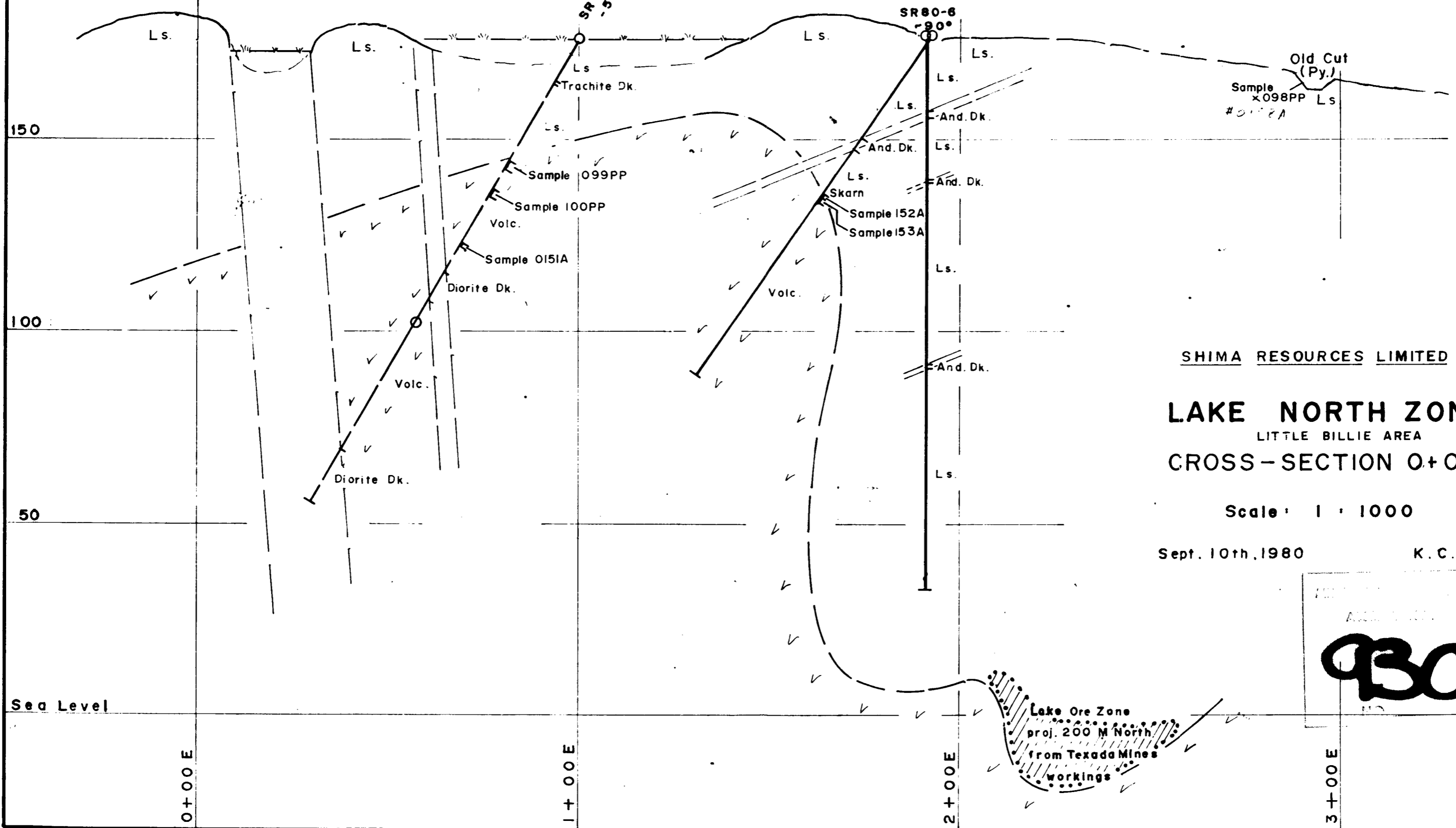

SHIMA RESOURCES LIMITED

LAKE NORTH ZONE
LITTLE BILLIE AREA
CROSS-SECTION 0+00N

Scale: 1 : 1000

Sept. 10th, 1980

K. C. Fahrni

PROJECT NO. 1000
 DATE: 10/10/80
 9300
 10

SHIMA RESOURCES LIMITED
BASIC II

D.H.s SR 80-9 & SR 80-10

MAP 5-14

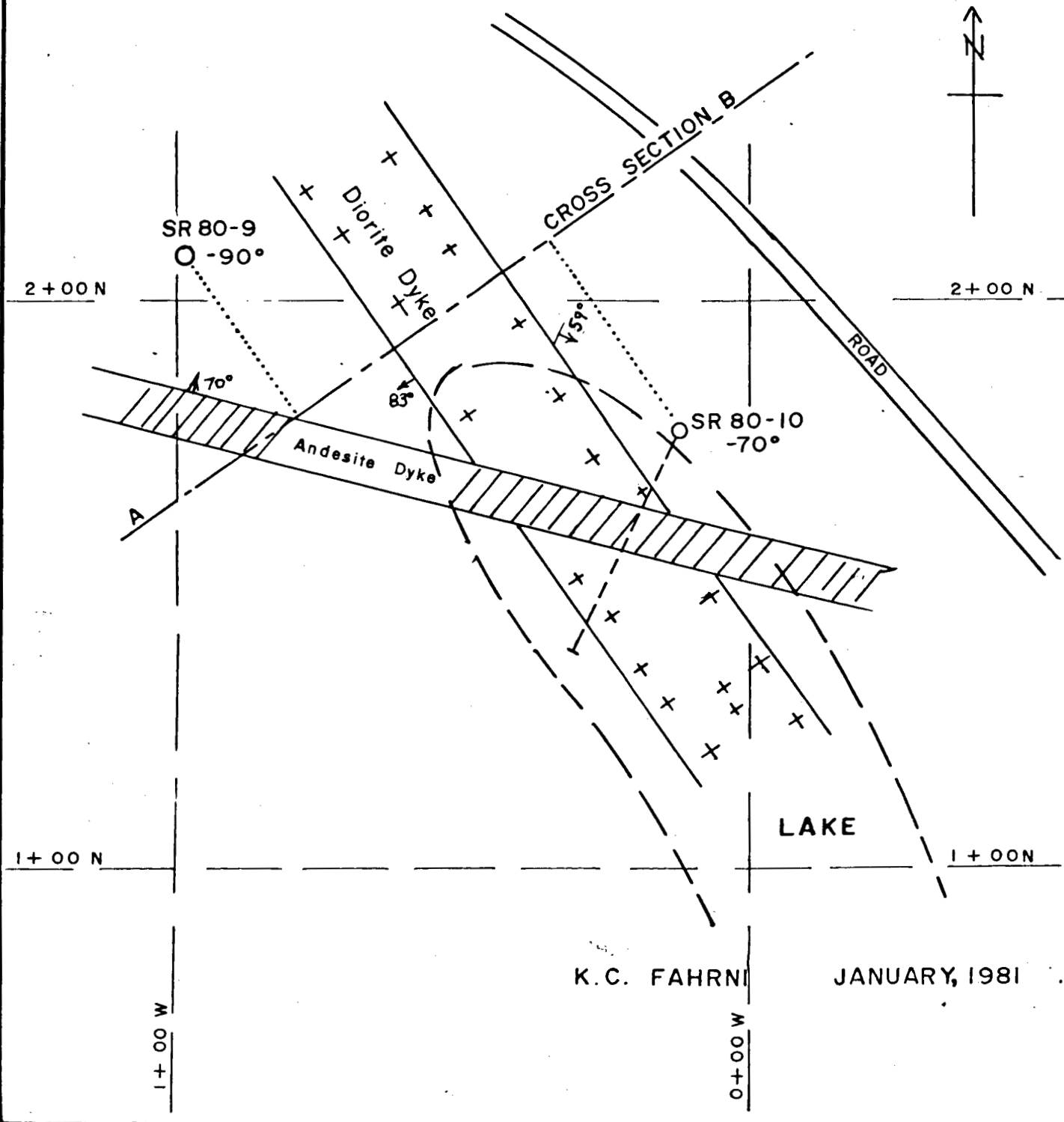

K.C. FAHRNI

JANUARY, 1981

SHIMA RESOURCES LIMITED
BASIC II

CROSS SECTION AB WITH D.H.s
PROJECTED TO SECTION

MAP 5.-15

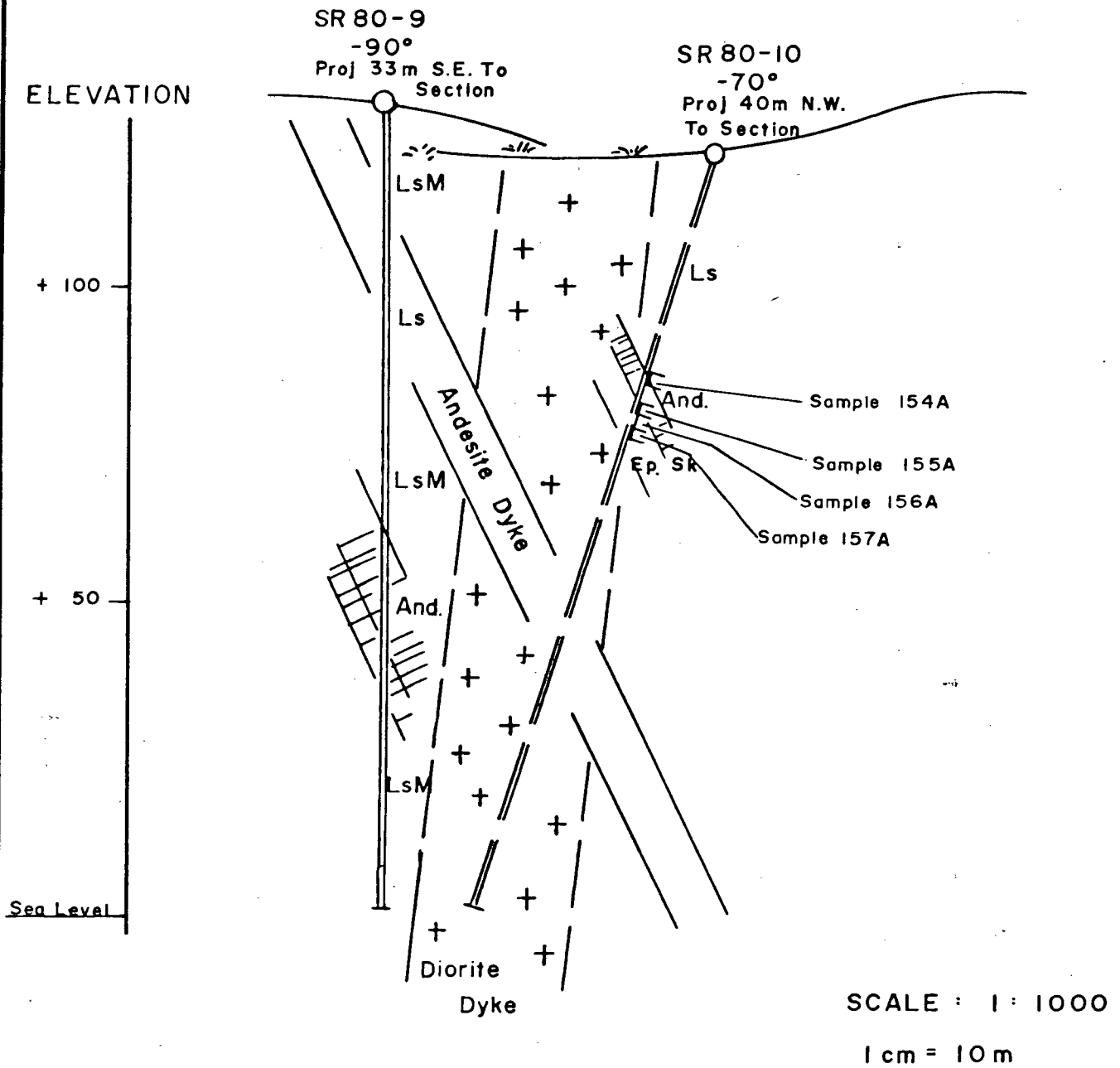

6. REFERENCES

- 6.1 Gravity Survey Texada Island Claim Group
Shima Resources Ltd.
C.A. Ager Ph.D., P.Eng. - January 31, 1978.
- 6.2 Shima Resources Ltd. Property
Texada Island, B.C.
K.C. Fahrni, P.Eng. - March 15, 1978.
- 6.3 Gravity, I.P., Magnetic and E.M. Survey
Texada Island Claim Groups
Ager & Berretta - July 9, 1979
- 6.4 Proposal for 1980 Drilling and Report of 1979 work.
Shima Resources Ltd., Texada Island B.C.
K.C. Fahrni, P.Eng. - March 7, 1980.

KEITH C. FAHRNI, P.ENG.

7011 ANGUS DRIVE
VANCOUVER, B. C.
CANADA, V6P 5J6
(604) 261-6426

7. CERTIFICATION

January 31, 1981.

TO WHOM IT MAY CONCERN:

This report has been prepared based upon my personal observations of the drill cores from the 1980 work.

I am a Professional Engineer, registered in British Columbia and Alberta (#1885 and #05773) who has practiced mining and geological engineering in western Canada continuously since graduation from the University of British Columbia in 1936 with the degree of B.A.Sc.

I do not now nor do I expect to hold any interest in Shima Resources Limited or in the Texada Island group of mineral claims which they hold.

This report may be used by Shima Resources Ltd. for the information of the public in promotional releases to assist the financing of further work on the property.

Yours truly

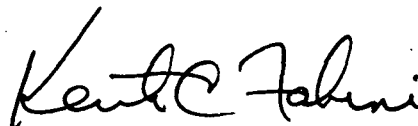

KEITH C. FAHRNI, P.Eng.
Consultant.

8. APPENDICES

8.1 Drill Hole Geological Logs

8.2 Assay Certificates

8.3 Copies of Invoices for Work

Scale
1:250
Column, Plot
& Dip

Drill Hole Record

SHIMA RESOURCES LIMITED
2002 - 1177 West Hastings Street, Vancouver, B.C. - V6E 2K3

Property Little Billie	District Nanaimo - Texada	Hole No. SR80-1	Length 321.3
Commenced March 28th, 1980	Location Ager No. 1 DH Prop.	Tests at	Hor. Comp.
Completed April 3, 1980	Core Size BQ - 36mm	Corr. Dip -90°	Vert. Comp. 321.3
LAT. 2 + 50 S	DEP. 1 + 50 E	ELEV. 83.8	True Brg.
Objective Possible skarn at limestone floor and diorite contact	% Recov. 98.2%	Date April 4th, 1980	Logged by K.C.F.

Claim
T Brg.
Collar Dip
Elev.
Length
Hole No.
Sheet

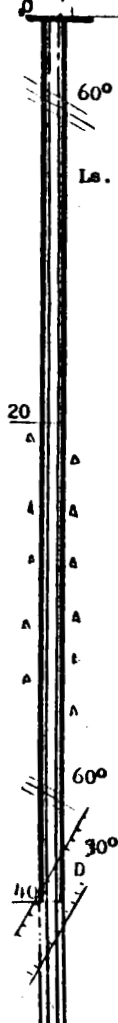

METERS From To	Description	RECOVERY		Sample Interval	Sample No.	Length	Analysis							
		RUN	SHORT											
0 - 8.20	Limestone - Faint banding at 60° to hole in grey to white fine grained rock.	0-4.27	Casing											
		-4.88	0.1											
		-6.40	0.1											
8.20 - 18.3	LIMESTONE - Massive, medium grained, dark grey, fetid limestone with white mottling. Shows sharp contact with following rock at 60° to hole with some grains of pyrite and stringers for 5 cm at contact with thin layers of dyke.	-7.92	0.1											
		-8.53	0.1											
		-11.58	--											
		-14.63	--											
		17.68	--											
18.3 - 32.0	LIMESTONE - Fragmental Shadowy darker inclusions can be seen on core surface with a few lighter patches of mottling. Rock is medium grained, fetid ls., finer at last.	-18.59	--											
		-20.73	--											
		-23.77	--											
		-26.83	--											
32.0 - 38.8	LIMESTONE - Uniform medium to fine grained light grey rock. Occasional white spots. Some faint banding at 60° to core. Stylolitic structures at start.	-28.35	--											
		-29.87	--											
		-31.09	--											
		-32.00	--											
38.8 - 41.5	DYKE - Andesite Mottled bluish green to black altered fine grained rock with amygdular texture. Contacts are at 30° to drill hole. Some limestone inclusions.	-32.92	--											
		-35.97	--											
		-38.40	--											

Scale
1:250
Colour Print
& Dips

Drill Hole Record

SHIMA RESOURCES LIMITED
2002 - 1177 West Hastings Street, Vancouver, B.C. - V6E 2K3

Property **Little Billie** District **Nanaimo - Texada Is.** Hole No. **SR80-1** Length **321.3**
 Commenced **March 28th, 1980** Location **Ager #1 IH Proposal** Tests at **Hor. Comp.**
 Completed **April 3rd, 1980** Core Size **BQ - 36 mm** Corr. Dip **-90°** Vert. Comp. **321.3**
 LAT. **2 + 50 S** DEP. **1 + 50 E** ELEV. **83.8** True Brg. **Logged by K.C.F.**
 Objective **Limestone floor at diorite contact** % Recov. **98.2%** Date **April 4th, 1980**

Claim
T Brg.
Collar Dip
Elev.
Length
Hole No.
Sheet

10
30°
La
D
La
60
La
80

METERS From To	Description	RECOVERY		Sample Interval	Sample No.	Length	Analysis						
		RUN	SHORT										
41.5 - 45.7	LIMESTONE Medium grained light grey massive. A few white stringers at start & end.	38.40 -40.24	--										
		-41.45	--										
		-43.28	--										
45.7 - 46.9	MARBELIZED LIMESTONE Some scattered fine pyrite noted.	-44.81	--										
		-46.94	--										
		-47.85	--										
46.9 - 51.3	LIMESTONE; Medium to fine grained light grey massive.	-49.98	--										
		-51.50	--										
51.3 - 51.5	GRANODIORITE DYKE; Medium to coarse light grey rock. Some fine scattered pyrite. Thin quartz veinlets on contacts.	-54.24	--										
		-55.78	--										
		-58.83	--										
		-60.96	--										
51.5 - 56.2	LIMESTONE - Fine grained - Some thin black stringers with tr. pyrite.	-63.40	--										
		-66.45	--										
56.2 - 67.4	LIMESTONE; Fine grained light grey massive. Some veinlets of dark carbonaceous material at 40° to hole	-67.37	--										
		-69.49	--										
		-71.19	--										
67.4 - 86.9	LIMESTONE Mostly uniformly medium grained but some lighter colored marbelized patches. Occ. stylolitic structures. Last 2 meters coarser with banding at 70° to hole. Traces of pyrite occur.	-72.24	--										
		-73.46	--										
		-74.86	0.2										
		-77.72	--										
		-78.64	--										

Scale
1:250
Colour Print
1 Dept.

Drill Hole Record

SHIMA RESOURCES LIMITED
2002 - 1177 West Hastings Street, Vancouver, B.C. - V6E 2X3

Page 3/8

Property **Little Billie** District **Nanaimo - Texada Island** Hole No. **SR80 - 1** Length **321.3**
 Commenced **March 28th, 1980** Location **Ager #1 DH proposal** Tests at **Hor. Comp.**
 Completed **April 3rd, 1980** Core Size **BQ - 36 mm** Corr. Dip **-90°** Vert. Comp. **321.3**
 LAT. **2 + 50 S** DEP. **1 + 50 E** ELEV. **83.8** True Brg. **Logged by K.C.F.**
 Objective **% Recov. 98.2%** Date **April 4th, 1980**

Claim
T Brg.
Collar Dip
Elev.
Length
Hole No.
Sheet

80
70°
100
120
La
D
D
La

METERS From To	Description	RECOVERY		Sample Interval	Sample No.	Length	Analysis								
		RUN	SHORT												
		70.68													
86.9 - 89.9	ANDESITE DYKE Black fine grained rock with much mottling to greenish grey color. Dyke contacts at 70°. Plentiful pyrite to 1 or 2 %.	-81.69	--												
		-84.73	--												
		-86.87	--												
		-87.48	--												
		-87.79	--												
89.9 - 106.9	LIMESTONE Coarser graining at start becomes medium grained. Color white to lt. grey Pyrite occurs in scattered grains and thin stringers. Banding occurs in rock at 50° to 60° to hole	-88.39	--												
		-88.88	--												
		-90.83	--												
		-92.96	--												
		-96.18	--												
106.9 - 116.6	LIMESTONE Medium grained grey colored.	-98.75	--												
		-99.97	--												
		-101.98	--												
116.6 - 117.1	ANDESITE DYKE Mottled dark grey to brownish rock. Contacts at 25° to hole.	-105.16	--												
		-108.20	--												
		-109.73	--												
117.1 - 118.5	LIMESTONE White marbelized rock.	-112.17	--												
		115.21	--												
		-117.04	--												
		-118.87	--												
		-120.09	--												
		-122.22	--												

Scale
1:250
Column
& Dip

Drill Hole Record

SHIMA RESOURCES LIMITED
2002 - 1177 West Hastings Street, Vancouver, B.C. - V6E 2K3

Page 4/8

120

Property **Little Billie** District **Nanaimo - Texada Island** Hole No. **SR80 - 1** Length **321.3**
 Commenced **March 28th, 1980** Location **Ager #1 DH location** Tests at **Hor. Comp.**
 Completed **April 3rd, 1980** Core Size **BQ - 36mm** Corr. Dip **-90°** Vert. Comp. **321.3**
 LAT. **2 + 50 E** DEP. **1 + 50 E** ELEV. **83.8** True Brg. **Logged by K.C.F.**
 Objective **Limestone floor at diorite contact** % Recov. **98.2%** Date **April 4th, 1980**

140

45°

45°

50-60°

160

METERS from To	Description	RECOVERY		Sample Interval	Sample No.	Length	Analysis							
		RUN	SHORT				Claim	T Brg.	Collar Dip	Elev.	Length	Hole No.		
		122.22												
		-124.35	--											
118.5 - 119.0	ANDESITE DYKE	-127.40	--											
	Medium grained dark grey to brownish color. Contact at 30° to 45° to hole.	-129.54	--											
		-130.18	--											
119.0 - 122.5	LIMESTONE	-131.37	--											
	White patches and marbelized areas. No pyrite noted.	-132.89	0.2											
		-134.72	--											
122.5 - 130.0	LIMESTONE	-137.16	--											
	Medium grained light grey color. Becomes coarser grained to last.	-139.90	--											
		-142.95	--											
130.0 - 131.9	ANDESITE DYKE	-145.39	--											
	Black fine grained rock. Contacts at 45° and 65° to hole. No pyrite.	-148.44	0.4											
		-149.35	0.6											
131.9 - 148.5	LIMESTONE	-150.57	0.2											
	Some very coarse grained marbelized patches and white mottling.	-154.84	--											
	Some poor banding occurs at 45° to hole.	-157.89	--											
		-160.94	--											
148.5 - 150.6	ANDESITE DYKE	-162.00	--											
	Badly broken up greenish black chloritized rock of medium to coarse	-163.07	--											
	grain with yellowish green clay alteration. Contacts at 50° to 60°	-163.68	--											
		-163.98	--											
		-164.59	--											

Scale
1:250
Change Plot
& Dip

Drill Hole Record

SHIMA RESOURCES LIMITED
2002 - 1177 West Hastings Street, Vancouver, B.C. - V6E 2K3

Page 6/8

200

Property	Little Billie	District	Manalmo - Texada Island	Hole No.	sr80 - 1	Length	321.3
Commenced	March 28th, 1980	Location	Agex #1 DH location	Tests at		Hor. Comp.	
Completed	April 3rd, 1980	Core Size	AQ - 36 mm.	Corr. Dip	-90°	Vert. Comp.	321.3
LAT.	2 + 50 S	DEP.	1 + 50 E	ELEV.	83.8	True Brg.	Logged by K.G.F.
Objective	Limestone floor at diorite contact		% Recov.	98.2%	Date	April 4th, 1980	

70°
D1
D
D1
220
25°
La
15°
D1
240

METERS From To	Description	RECOVERY		Sample Interval	Sample No.	Length	Analysis							
		RUN	SHORT				Claim	T Brg.	Collar Dip	Elev.	Length	Hole No.		
		215.89												
		-217.93	--											
192.3 - 202.1	LIMESTONE	-219.45	--											
	Medium grained light grey uniform rock. Some white marble patches at start	-221.28	--											
		-223.87	--											
202.1 - 224.0	DIORITE DYKE	-227.07	--											
	Medium to coarse grained dark grey rock with occ. pyrite on fractures.	-230.27	--											
	Mottled alteration to lighter gives granitic appearance. At 210 m. there	-230.72	0.2											
	is 1.3 m. of fine grained black andesite dyke. Red stain with calcite	-231.94	--											
	and epidote occur in alteration patches. Contacts 70° at start and about	-234.70	--											
	25° at last. Rock becomes coarser and more porphyritic (hornblende).	-236.37	--											
		-237.74	--											
224.0 - 231.7	LIMESTONE - White, coarse grained marbelized.	-239.57	--											
		-240.48	--											
231.7 - 276.5	DIORITE DYKE	-242.01	--											
	From start to 234 m. is fine grained with many calcite stringers. Rest	-243.84	--											
	coarse grained granitic texture with prominent black mineral (hornblende)	-246.28	--											
	Occasional white calcite stringers. Magnetite a primary constituent.	-246.89	--											
	Contact at start at 15°. At last is 15° with 10cm andesite border and	-247.19	--											
	line of brown garnet about 0.5 cm on contact.	-248.25	--											
		-250.53	--											
276.5 - 288.5	LIMESTONE - marbelized.	-252.07	--											
	Coarse grained with light grey color with darker patches.	-254.81	--											

Scale 1:250
 Calculated
 & Dips

Drill Hole Record

SHIMA RESOURCES LIMITED
 2002 - 1177 West Hastings Street, Vancouver, B.C. - V6E 2K3

Property **Little Billie** District **Nanaimo, Texada Island** Hole No. **SR80 - 1** Length **321.3**
 Commenced **March 28th, 1980** Location **Ager #1 DH location** Tests at **Hor. Comp.**
 Completed **April 3rd, 1980** Core Size **AQ - 36 mm** Corr. Dip **-90°** Vert. Comp. **321.3**
 LAT. **2 + 50 S** DEP. **1 + 50 E** ELEV. **83.8** True Brq. **Logged by K.C.F.**
 Objective **Limestone floor at diorite contact** % Recov. **98.2%** Date **April 3rd, 1980**

Claim
 True Brq.
 Collar Dip
 Elev.
 Length
 Hole No. Sheet

METERS from To	Description	RECOVERY		Sample Interval	Sample No.	Length	Analysis						
		RUN	SHORT				Cu (%)	Mo (%)	Au (g/g at)	Ag (g/g at)			
288.5 - 296.2	LIMESTONE - Marbelized Several black bands and stringers some with a little garnet and pyrite.	254.81 -257.86	--										
296.2 - 297.4 (1.2)	GARNET SKARN Brown garnet with calcite and traces of pyrite. Contact at 45°	-258.77 -260.45 -261.51	--	296.2 -298.5	095 PP	2.3	.01	.069	.002	tr.			
297.4 - 298.1 (0.7)	GRANODIORITE White to greenish rock. Epidote, calcite and pyrite with trace chalcopyrite noted in this rock.	-263.19 -264.86 -267.00	--										
298.1 - 298.5 (0.4)	GARNET SKARN Brown garnet with some good molybdenite mineralization in stringers and grains to 2 mm. Pyrite and traces of chalcopyrite also noted. Stringers are parallel to contact at about 15° to drill hole. Estimate 1% MoS ₂ .	-268.83 -270.66 -271.26 -273.41	--										
298.5 - 301.4	GRANODIORITE White alteration with epidote and pyrite at start then becomes more uniform in appearance. Contact at last is at 30° to hole.	-274.32 -276.15 -278.59 -281.64	--										
301.4 - 302.6	LIMESTONE Dark colored and mottled - marbelized.	-284.84 -288.04 -290.78 -293.83	--										
		-296.72 -299.61	--										

240
 D1
 266
 15°
 La
 280
 7

Grade
11250
Calson Fuel
1 Dip

280

Drill Hole Record

SHIMA RESOURCES LIMITED
2002 - 1177 West Hastings Street, Vancouver, B.C. - V6E 2K3

Property	Little Billie	District	Nanaimo, Texada Island	Hole No.	BR80 - 1	Length	321.3
Commenced	March 28th, 1980	Location	Ager #1 DH proposal	Tests at		Hor. Comp.	
Completed	April 3rd, 1980	Core Size	AQ - 36 mm	Corr. Dip	-90°	Vert. Comp.	321.3
LAT.	2 + 50 S	DEP.	1 + 50 E	ELEV.	83.8	True Brg.	Logged by K.C.F.
Objective	Limestone floor at diorite contact			% Recov.	98.2%	Date	April 4th, 1980

Claim
T Brg.
Collar Dip
Elev.
Length
Hole No.
Sheet

METERS From To	Description	RECOVERY		Sample Interval	Sample No.	Length	Analysis							
		RUN	SHORT											
		299.61												
302.6 - 304.6	ANDESITE DYKE Dark brown fine grained rock with some grey bleached patches. Contacts are at 45° to hole.	-302.50	--											
		-305.55	--											
		-309.07	--											
		-312.12	--											
		-315.14	--											
304.6 - 305.7	LIMESTONE - Marbelized	-318.21	--											
		-321.26	--											
305.7 - 321.3	GRANODIORITE Medium to coarse grained grey to black & white rock. Rock attracts magnet. Scattered rounded black pebble like inclusions occur sized from 2 cm to 30 cm in diameter. A few calcite stringers occur with pink bleached borders.	E.O.H.												
	End of Hole													

45°
Sk
Gr
Sk/Mc
300
Gr
Ls
D
45°
Ls
Gr
321
321.3 End

Drill Hole Record SHIMA RESOURCES LIMITED
 2002 - 1177 West Hastings Street, Vancouver, B.C. - V6E 2X3

Property Little Billie District Nanaimo - Texada Hole No. SR80 - 2 Length 99.7 M
 Commenced June 11th, 1980 Location Ager #2 Area Tests at Hor. Comp.
 Completed June 13th, 1980 Core Size B Q - 36 mm Corr. Dip - 90° Vert. Comp. 99.7
 LAT. 0 + 50 S DEP. 1 + 80 E ELEV. 34.1 True Brq. Logged by K.C.P.
 Objective Extension of min. skarn of SR79 - 1 DH % Recov. 99.9% Date June 26th, 1980

Claim	T Brq.	Collar Dip	Elev.	Length	Hole No.
-------	--------	------------	-------	--------	----------

no core
 Grano
 30°
 Di
 20
 Grano
 Grano Bx.
 Grano
 Por.
 40

METERS		Description	RECOVERY		Sample Interval	Sample No.	Length	Analysis									
From	To		RUN	SHORT													
0	4.6	No core	8.0	4.57	casin												
4.6	16.0	GRANODIORITE - About 10% dark minerals Rock is variable with calcite veinlets and bleached areas some with associated pink colored feldspars. A small and.dyke from 15.3 to 15.5	5.49	6.40													
16.0	18.6	DIORITE DYKE - Coarse grained, dark colored. A sharp contact at start at 30° to hole but no chilled zone. Grain size almost like preceding granodiorite. Occasional white feldspars to 2 mm. Contact at last at 10° to hole, still with no finer grained chill zone.	8.53	10.67													
18.6	29.6	GRANODIORITE Medium to coarse grained rock with 10% dark minerals being hornblende, biotite and magnetite with faintly gneissic arrangement at 45° to hole.	12.65	14.17													
29.6	33.3	GRANODIORITE - Broken Some shearing and alteration at start on planes at 15° to hole with pink feldspar alteration and limey stringers. Several short pink aplitic bands occur and some of granodiorite has pink colored zones.	15.54	17.52													
			19.18	20.73													
			23.77	26.83													
			28.65	29.87													
			31.24	32.91													
			35.36	39.01													
			40.54	41.45													
			44.50														

Scale
1:250
Colour Plan
& Diagram

Drill Hole Record

SHIMA RESOURCES LIMITED
2002 - 1177 West Hastings Street, Vancouver, B.C. - V6E 2X3

Page 2 / 2

Property Little Billie District Nanaimo - Texada Hole No. SR 80 - 2 Length 99.7 m.
 Commenced June 11th, 1980 Location Ager #2 Area Tests at Hor. Comp.
 Completed June 13th, 1980 Core Size B Q - 36 mm Corr. Dip - 90° Vert. Comp. - 99.7
 LAT. 0 + 50 S DEP. 1 + 80 E ELEV. 34.1 True Brg. Logged by K.C.P.
 Objective Extension of mineralized skarn of DI SR 79 - 1 % Recov. 99.9% Date June 26th, 1980

Claim
T Brg.
Collar Dip
Elev.
Length
Hole No.
Sheet

METERS From To	Description	RECOVERY		Sample Interval	Sample No.	Length	Analysis				
		RUN	SHORT								
		47.54									
33.3 - 74.5	GRANODIORITE - Coarse, porphyritic, massive. Some larger white feldspars are developed but still about 10% dark minerals. This is a massive, continuous rock. Occasional black pebble-like spots at from 1 to 5 cm diameter. From 67 to 68 are several calcite stringers (3 mm) at 5° to hole with some clayey alteration and bleaching developed.	48.77									
		50.90									
		53.95									
		57.15									
		60.19									
		62.03									
		64.92									
74.5 - 99.7	GRANODIORITE - Medium to coarse grained, massive. This section carries more plentiful and larger black pebble-like inclusions up to 20 cm diameter. A few thin calcite stringers of 1 to 2 mm lie at 15° to hole. No mineralization occurs.	66.45									
		67.66									
		69.49									
		72.54									
		73.91									
	End of Hole	75.59									
		78.48									
		80.31									
		81.68									
		84.73									
		87.78									
		90.83									
		95.57									
		98.89									

Scale
1:250
Colour Photo
& Dip

Drill Hole Record

SHINA RESOURCES LIMITED
2002 - 1177 West Hastings Street, Vancouver, B.C. - V6E 2K3

Property Little Billie District Nanaimo - Texada Hole No. SR 80 - 3 Length 150.6 m
 Commenced June 14th, 1980 Location Ager #2 Area Tests at Hor. Comp.
 Completed June 16th, 1980 Core Size BQ - 36 mm Corr. Dip - 90° Vert. Comp. 150.6
 LAT. 0 + 68 S DEP. 1 + 83 E ELEV. 36.1 True Brg. Logged by K.C.F.
 Objective Extension of mineralized skarn in SR 79 - 1 DH % Recov. 99.7% Date June 26th, 1980

Claim
T Brg.
Collar Dip
Elev.
Length
Hole No.

Let.	METERS		Description	RECOVERY		Sample Interval	Sample No.	Length	Analysis
	From	To		RUN	SHORT				
70'	0	3.0	No core	0.0	3.05	casin			
DI	3.0	8.3	DIORITE - Black to greenish medium grained rock.		4.57				
Grano			Finer chilled contact noted at last for 0.3 m. Rock is broken with thin		5.79				
60°			rusty slips, some with calcite film at small angle to hole.		6.40				
21'	8.3	9.2	LIMESTONE - grey to white, marbelized.		7.16				
And. Dyke			Traces of brown garnet on bands at 65° to hole.		7.92				
Grano					8.23				
					8.53				
					8.83	0.2			
	9.2	10.6	DIORITE - medium grained, dark grey		10.36				
			Chilled contact for 0.2 m against limestone at 70° to hole.		11.58				
			Rock becomes gradationally lighter color toward following granodiorite.		13.11				
					14.63				
	10.6	11.6	GRANODIORITE - medium grained with tight uneven contacts both sides.		14.94				
					16.76				
	11.6	15.9	DIORITE - medium grained dark grey. Some thin calcite str. at 0° /		18.59				
					20.42				
	15.9	18.6	GRANODIORITE -		23.32				
			A few pebble-like inclusions to 2 cm occur. Some calcite stringers occur		24.99				
			almost parallel to hole with related pink alteration of feldspars.		26.21				
40'					27.74				
And. Dyke					29.87				

Scale 1:250
 Corrosion Pits
 & Gaps

Drill Hole Record

SHIMA RESOURCES LIMITED
 2002 - 1177 West Hastings Street, Vancouver, B.C. - V6E 2K3

Property Little Billie District Nanaimo - Texada Hole No. SR 80 - 3 Length 150.6 m
 Commenced June 14th, 1980 Location Ager #2 Area Tests at Hor. Comp.
 Completed June 16th, 1980 Core Size BQ - 36 mm Corr. Dip - 90° Vert. Comp. 150.6 m
 LAT. 0 + 68 S DEP. 1 + 83 E ELEV. 36.1 True Brg. Logged by K.C.F.
 Objective Extension of mineralized skarn in DH SR 79 - 1 % Recov. 99.7% Date June 26th, 1980

Claim
 T Brg.
 Collar Dip
 Elev.
 Length
 Hole No. Sheet

40
 And.
 Dyke
 60
 45°
 DI
 Grano
 Bl.
 Grano
 Grano
 80

METERS from To	Description	RECOVERY		Sample Interval	Sample No.	Length	Analysis							
		RUN	SHORT											
18.6 - 21.5	ANDESITE DYKE - fine grained, grey to greenish with white 1 mm spots	29.87												
	Contacts at 60° to hole. Rock is massive and uniformly fine grained.	31.70												
			32.61											
21.5 - 39.8	GRANODIORITE													
	From 22 to 22.4 is pink aplitic band with coarse crystallized quartz against aplite at 45° to hole. Traces of pyrite occur. Continuing in granodiorite a few calcite stringers occur with related pink alteration													
			33.83											
39.8 - 46.0	ANDESITE DYKE - fine grained greenish grey with 1mm white feldspars. Some gouge and clayey alteration at start suggest faulting.													
			35.05											
46.0 - 60.6	GRANODIORITE													
	Well developed pebble-like inclusions of diorite from 2 to 5 cm diameter.													
			35.97											
60.6 - 64.7	DIORITE - medium to coarse grained dark grey feldspathic rock. Sharp contacts with granodiorite at 45° to hole.													
			36.57											
64.7 - 66.3	GRANODIORITE													
	Rock has pebble-like inclusions like preceding granodiorite.													
			37.18											
		37.95												
		39.01												
		39.77												
		40.54												
		41.45												
		42.82												
		44.80												
		46.48												
		48.16												
		51.21												
		52.75												
		54.25												
		57.30												
		58.52												
		60.04												

Scale
1:250
Column Head
& Ops

Drill Hole Record

SHIMA RESOURCES LIMITED
2002 - 1177 West Hastings Street, Vancouver, B.C. - V6E 2K3

Page 3 / 4

Property	Little Billie	District	Nanaimo - Texada	Hole No.	SR 80 - 3	Length	150.6 m
Commenced	June 14th, 1980	Location	Ager #2 area	Tests at		Hor. Comp.	
Completed	June 16th, 1980	Core Size	BQ - 36 mm	Corr. Dip	- 90°	Vert. Comp.	150.6
LAT.	0 + 68 S	DEP.	1 + 83 W	ELEV.	36.1	True Brg.	Logged by K.C.F.
Objective	Extension of mineralized skarn in SR79-1 IH			% Recov.	99.7%	Date	June 26th, 1980

Claim
T Brg.
Collar Dip
Elev.
Length
Hole No.
Sheet

METERS From To	Description	RECOVERY		Sample Interval	Sample No.	Length	Analysis		
		RUN	SHORT				Au	Ag	Cu
D1 66.3 - 68.4	GREY BLEACHED GRANODIORITE Boundaries of alteration fairly sharp. Plentiful pyrite occurs up to 3% of rock. Some calcite stringers are present.	60.04		66.3 - 68.4	096 P	2.1	.002	Tr.	--
		61.26							
		63.40							
		64.92							
		66.45							
Let 68.4 - 87.7	GRANODIORITE - Uniform massive med. to coarse grained. This rock has relatively few of the black pebble inclusions.	67.66							
		67.97							
		69.19							
		70.41							
		72.39							
		74.98							
		77.11							
		78.64							
		80.47							
		83.51							
		86.56							
		90.52							
Let 95.4 - 132.7	LIMESTONE Marbled to 100.8 then med to fine grained massive grey rock to 109.4 then mottled. Some graphitic stringers are present. Mottling and some fragmental texture continues to 117.7 then massive limestone to end.	91.74							
		92.96		132.7 - 133.5	097 P	0.8	006	.10	.32
		93.88							
		95.40							
		96.93							
		99.21							

Scale
1:250
Color Plot
& Dip

Drill Hole Record

SHIMA RESOURCES LIMITED
2002 - 1177 West Hastings Street, Vancouver, B.C. - V6E 2X3

120

Property Little Billie District Nanaimo - Texada Is. Hole No. SR 80 - 3 Length 150.6
 Commenced June 14th, 1980 Location Ager #1 area Tests at Hor. Comp.
 Completed June 16th, 1980 Core Size BQ - 36 mm Corr. Dip - 90° Vert. Comp. 150.6
 LAT. 0 + 68 S DEP. 1 + 83 E ELEV. 36.1 True Brg. Logged by K.C.F.
 Objective Extension of mineralization of DH SR79 - 1 % Recov. 99.7% Date June 26th, 1980

Claim
T Brg.
Collar Dip
Elev.
Length
Hole No.

Lat

METERS From To	Description	RECOVERY		Sample Interval	Sample No.	Length	Analysis							
		RUN	SHORT											
133.5 - 136.5	BLEACHED GRANODIORITE - Medium grained, massive	99.21												
	Rock resembles following rock in texture but is pale greenish white with	102.41												
	no dark minerals evident.	105.46												
		108.66												
		111.71												
136.5 - 150.3	GRANODIORITE - Massive	114.91												
	Occasional scattered rounded pebbles of darker material at from 1 to 5 cm	116.13												
	diameter. A few calcite stringers occur at small angles to hole with some	118.41												
	associated pink alteration of feldspars.	121.31	0.1											
		123.90												
	END OF HOLE	127.10												
		130.15												
		133.20												
		136.25												
		136.70												
		138.07												
		139.60												
		140.51												
		Recovery												
		Run	Short											
		146.00 - 147.21	-											
		147.21 - 148.74	-											
		148.74 - 150.27	-											
		End of Hole												

140

Scale
250
Feet
1 Dip

Drill Hole Record

SHIMA RESOURCES LIMITED
2002 - 1177 West Hastings Street, Vancouver, B.C. - V6E 2K3

Property **Little Billie** District **Nanaimo - Texada Is.** Hole No. **SR 80 - 4** Length **152.7 m**
 Commenced **June 17th, 1980** Location **Ager #2 area** Tests of Hor. Comp.
 Completed **June 19th, 1980** Core Size **BQ - 36 mm** Corr. Dip **- 90°** Vert. Comp. **152.7**
 LAT. **0 + 73 S** DEP. **2 + 10 E** ELEV. **36.6** True Brq. Logged by **K.C.F.**
 Objective **Extension of mineralized skarn of DH SR79-1** % Recov. **99.0** Date **June 26th, 1980**

Claim
T Brq.
Collar Dip
Elev.
Length
Hole No.

METERS from	to	Description	RECOVERY		Sample Interval	Sample No.	Length	Analysis									
			RUN	SHORT													
0.0	4.9	No core - casing	0.00	4.88	casing												
4.9	7.0	DIORITE - Dark grey Some bleaching to granodiorite-like appearance.	5.18	5.48													
7.0	41.2	LIMESTONE - Massive No sign of marbelization. Some graphitic structures occur. At 20.5 and from 31.3 to 31.7 are siliceous zones with the development of traces of chlorite, epidote and garnet. These may be small dyke zones. An andesite dyke occurs from 36.0 to 38.4 with broken core and some pyrite. Limestone continues to end of section.	7.92	8.53													
41.2	56.9	DIORITE - Broken and altered At start are several gougey fractures and serpentine alteration. This may be andesite dyke intrusion. Toward last of section, still in broken diorite, injections of younger granodiorite appear with small lenses and several irregular bands. Clay minerals and some pink aplitic material occurs with the granodiorite, but no skarn seen. There are traces of pyrite. At last of section contact is at 45° to the hole.	26.82	29.87	0.1												
			31.70	33.53	0.1												
			35.66	36.12													
			37.03	38.40	0.8												
			40.54	47.89	0.1												

no core
Di.
Di.
20
40
Di.

Scale
250
Colour Print
& Dyes

Drill Hole Record

SHIMA RESOURCES LIMITED
2002 - 1177 West Hastings Street, Vancouver, B.C. - V6E 2K3

Property **Little Billie** District **Nanaimo** - Texada Is. Hole No. **SR 80 - 4** Length **152.7 m**
 Commenced **June 17th, 1980** Location **Ager #2 area** Tests at **Hor. Comp.**
 Completed **June 19th, 1980** Core Size **BQ - 46 mm** Corr. Dip **- 90°** Vert. Comp. **152.7**
 LAT. **0 + 73 B** DEP. **2 + 10 E** ELEV. **36.6** True Brg. **Logged by K.C.F.**
 Objective **Extension of mineralized skarn of DH SR79-1** % Recov. **99.0%** Date **June 26th, 1980**

Claim
T Brg.
Collar Dip
Elev.
Length
Hole No.
Sheet

METERS from To	Description	RECOVERY		Sample Interval	Sample No.	Length	Analysis							
		RUN	SHORT											
56.9 - 107.9	LIMESTONE = Grey medium grained massive Rock is very uniform to 75.0. From 71.0 there are several black graphitic bands or stringers with fine grained pyrite or marcasite less than 1 cm. From 75.0 rock has an obscure fragmental texture with fragments not over 1 cm. Rock continuous massive and continuous but darkens in color.	3.89												
		44.96												
		46.33												
		47.55												
		48.46												
		48.92	0.1											
107.9 - 110.2	BLEACHED DIORITE - Earthy white to pinkish bleaching to give a uniform appearing rock.	49.53	0.1											
		50.44												
110.2 - 113.5	GREY DIORITE (EPIDOTE) With a sharp color change from the preceding rock, the texture remains about the same but now carries plentiful epidote and the alteration becomes siliceous rather than limey or clayey. Traces of fine pyrite occur but no samples were taken.	51.66												
		54.10												
		55.62												
		57.30												
		60.35												
		63.40												
		66.45												
		69.49												
		72.54												
		75.60												
78.64														
81.69														
84.73														
87.78														
90.83														

Scale
250
Cust. Plot
1 Day

Drill Hole Record

SHIMA RESOURCES LIMITED
2002 - 1177 West Hastings Street, Vancouver, B.C. - V6E 2K3

Property	Little Billie	District	Nanaimo - Texada	Hole No.	SR 80 - 4	Length	152.7 m
Commenced	June 17th, 1980	Location	Agex #2 area	Tests at		Hor. Comp.	
Completed	June 19th, 1980	Core Size	BQ - 36 mm	Corr. Dip	- 90°	Vert. Comp.	152.7
LAT.	0 + 73 S	DEP.	2 + 10 E	ELEV.	36.6	True Brg.	
Objective	Extension of mineralised skarn of DH SR79-1			% Recov.	99.0%	Logged by	K.C.F.
						Date	June 26th, 1980

Claim	Brg.	Collar Dip	Elev.	Length	Hole No.
-------	------	------------	-------	--------	----------

METERS from To	Description	RECOVERY		Sample Interval	Sample No.	Length	Analysis							
		RUN	SHORT											
113.5 - 152.7	GRANODIORITE Massive, medium to coarse grained. Scattered rounded dark spots from 1 to 10 cm in diameter, increasing to last of hole. A uniformly continuous appearing rock section.	90.83	93.88											
		96.92												
		99.97												
		103.02												
	END OF HOLE	106.38												
		108.81												
		109.72												
		111.40												
		112.69												
		Recovery												
		Run	Short											
		113.99												
		117.65												
		134.26-135.94												
		135.94-137.64												
		137.64-141.58												
		141.58-142.34												
		142.34-142.95	0.1											
		142.95-144.78	0.1											
		144.78-146.30												
		146.30-148.78												
		148.78-149.66												
		149.66-152.70												

80

Lat

100

Bl.
Di

Ep
Di

Grano
to
end
at
152.7

120

Scale 1:250

Color Plot
& Dip

Drill Hole Record

SHIMA RESOURCES LIMITED
2002 - 1177 West Hastings Street, Vancouver, B.C. - V6E 2K3

Page 1 / 3

Property	Little Billie	District	Nanaimo - Texada Is.	Hole No.	SR 80 - 5	Length	124.3
Commenced	June 20th, 1980	Location	Ager #2 area	Tests at		Hor. Comp.	
Completed	June 22nd, 1980	Core Size	BQ - 36 mm	Corr. Dip	- 90°	Vert. Comp.	124.3
Grano	LAT. 0 + 50 S	DEP.	2 + 20 E	ELEV.	33.6	True Big.	Logged by K.C.F.
And.	Objective		Extension of mineralized skarn of DH SR79 - 1	% Recov.	99.3%	Date	June 26th, 1980

Claim

T Brg.

Collar Dip

Elev.

Length

Hole No.

Sheet

Grano	METERS		Description	RECOVERY		Sample Interval	Sample No.	Length	Analysis			
	From	To		RUN	SHORT				Au	Ag	Cu	
	0.0	3.96	No Core	0.0								
				3.96	casin							
And.	3.96	4.6	Broken GRANODIORITE - Rusty fractures - surface weathering.	4.88	0.1							
Dyke				5.48	0.1							
Skarn				6.09								
	4.6	6.0	ANDESITE DYKE - Fine grained, massive.	6.86								
			Contacts not seen, broken	7.92	0.1							
				9.14	0.1							
Lat	6.0	11.7	GRANODIORITE - Medium to coarse grained	10.97								
			Occasional rounded pebble-like spots at from 2 to 5 cm.	12.80								
				13.11								
	11.7	16.6	ANDESITE DYKE	14.48	0.1							
			Some short inclusions of granodiorite at 12.8 - 13.5. Some greenish calcite slips occur.	15.54								
				16.61								
				19.81								
	16.6	17.0	SKARN - Pale brownish color	22.25		16.6 - 17.0	098 P	0.4	.008	Tr	--	
			Some gougey, broken fracture material occurs in the skarn. Pyrite,	23.77								
			hematite and magnetite noted in skarn but no chalcopyrite seen.	25.90								
				28.96								
				32.00								
				35.20								
				38.40								
				39.01								

Scale
1:250
Calculated
100%

Drill Hole Record

SHIMA RESOURCES LIMITED
2002 - 1177 West Hastings Street, Vancouver, B.C. - V6E 2K3

40

Property Little Billie District Nanaimo - Texada Is. Hole No. SR 80 - 5 Length 124.3
 Ldt. Commenced June 20th, 1980 Location Ager #2 area Tests at Hor. Comp.
 15° Completed June 22nd, 1980 Core Size BQ - 36 mm Corr. Dip -90° Vert. Comp. 124.3
 Sp. LAT. 0 + 50 S DEP. 2 + 20 E ELEV. 33.6 True Brg. Logged by K.C.F.
 Objective Extension of mineralized skarn of DH SR79-1 % Recov. 99.3% Date June 26th, 1980

Claim
T Brg.
Collar Dip
Elev.
Length
Hole No.

METERS From To	Description	RECOVERY		Sample Interval	Sample No.	Length	Analysis							
		RUN	SHORT											
Grano 17.0 - 45.5	LIMESTONE - Medium grained, massive	39.06												
	Dark grey color at start, becoming lighter with some fragmental areas.	42.06												
		45.11												
		47.55												
		49.68												
Grano 45.5 - 45.6	CONTACT SCHIST	51.04												
	A sericitic gougey zone at an angle of about 15° to the hole with a khaki brown color. No sulphides were noted.	54.25												
		57.30												
		59.74												
		62.94												
Grano 45.6 - 83.3	GRANODIORITE	65.99												
	Typical massive medium grained to coarse grained texture with 10% dark minerals. Rounded pebbles of dark material at from 2 to 10 cm diameter are fairly plentiful up to 55.0 then scarce to end of section.	67.97												
		69.49												
		72.54	0.1											
		74.06												
		75.59												
		77.42	0.1											
		78.64	0.1											
Grano 83.3 - 88.5	WHITE GRANODIORITE	79.70												
	Similar in texture to preceding rock but dark minerals are completely bleached to pale greenish minerals. Some siliceous banding occurs at angle of 40° to drill hole.	80.77												
		81.99												
		83.21												

Drill Hole Record SHIMA RESOURCES LIMITED
 2002 - 1177 West Hastings Street, Vancouver, B.C. - V6E 2K3

Scale 1:250
 Colour Print
 4 Dots

Property Little Billie District Nanaimo - Texada Hole No. SR 80 - 5 Length 124.3 m
 Commenced June 20th, 1980 Location Ager #2 area Tests at Hor. Comp.
 Completed June 22nd, 1980 Core Size BQ - 36 mm Corr. Dip - 90° Vert. Comp. 124.3
 LAT. 0 + 50 S DEP. 2 + 20 E ELEV. 33.6 True Brg. Logged by K.C.F.
 Objective Extension of mineralised skarn of SR79 - 1 IH % Recov. 99.3% Date June 26th, 1980

Claim
 T Brg.
 Collar Dip
 Elev.
 Length
 Hole No. Sheet

80
 Grano
 White
 Grano
 40°
 Grano
 100
 120
 end

METERS from To	Description	RECOVERY		Sample Interval	Sample No.	Length	Analyses
		RUN	SHORT				
83.21							
86.26							
87.17	GRANODIORITE - Massive, medium to coarse grained.						
88.69	Rock is of typical appearance with rounded pebble-like inclusions through-						
89.30	out. Rock has about 10% dark minerals and is sensibly magnetic.		0.1				
90.22	continuous rock with no change to end						
92.66							
93.88							
98.45							
100.12	END OF HOLE						
101.50							
103.63							
105.15							
106.68							
108.36							
111.25							
112.01							
115.06							
118.26							
121.31					0.1		
124.36							

Drill Hole Record

SHIMA RESOURCES LIMITED
2002 - 1177 West Hastings Street, Vancouver, B.C. - V6E 2K3

Property	Lake North Zone	District	Nanaimo - Texada Island	Hole No.	SR 80 - 6	Length	144.5 M
Commenced	July 9th, 1980	Location	Ager #6 Area	Tests at		Hor. Comp.	
Completed	July 12th, 1980	Core Size	BQ - 36 mm	Corr. Dip	- 90°	Vert. Comp.	144.5 M
LAT.	0 + 00 S	DEP.	1 + 91 E	ELEV.	177 M	True Brg.	Logged by K.C.F.
Objective	To investigate Lake North anomaly			% Recov.	100%	Date	July 15th, 1980

No
coreLs.
band.

70°

METERS from To	Description	RECOVERY		Sample Interval	Sample No.	Length	Analysis	Collar Dip	Elev.
		RUN	SI ONT						
0 - 3.2	No core	0							
		-3.96	casing						
		-5.44							
3.2 - 19.7	LIMESTONE - Grey with wavy banding of darker color.	-6.70							
	This appears to be a muddy, rippled limestone with average bedding angle at about 70° to the hole. Some darker figures and also lighter white calcite patches are also seen occasionally. From about 19.0 to end of section rock is white recrystallized limestone.	-8.53							
		-9.14							
		-11.58							
		-12.80							
		-14.63							
19.7 - 21.2	ANDESITE DYKE - Amygdular	-17.68							
	Contact at start sharp at 60° to hole. Small white spots are from 1 to 3mm, some larger spots with pyrite core. At last contact is also about 60° to the drill hole. Traces of brown garnet and some epidote and pyrite for last 10 cm.	-20.72							
		23.16							
		-25.60							
		-27.12							
21.2 - 24.9	LIMESTONE -	-27.89							
	First 1.0 M is recrystallized to coarser marbelized rock then changes to same grey rippled limestone as seen before dyke.	-28.04							
		-29.26							
		-32.30							
24.9 - 37.5	LIMESTONE - Massive medium grained.	-33.53							
	Color grey to white with fetid H ₂ S odor when broken.	-35.97							
		-37.34							
		-39.01	0.1						
		-39.62							

20

And.
Dyke
60°

Ls.

Ls.
(H₂S)And.
Dyke

40

Ls.

11250

Drill Hole Record

SHIMA RESOURCES LIMITED
2002 - 1177 West Hastings Street, Vancouver, B.C. - V6E 2K3

Page 2 / 3

Property	Lake North Zone	District	Nanaimo - Texada Island	Hole No.	SR 80 - 6	Length	144.5 M.
Commenced	July 9th, 1980	Location	Ager #6 Area	Tests at		Hor. Comp.	
Completed	July 12th, 1980	Core Size	BQ - 36 mm	Corr. Dip	- 90 °	Vert. Comp.	144.5 M
LAT.	0 + 00 S	DEP.	1 + 91 E	ELEV.	177 M	True Brg.	Logged by K.O.F.
Objective	To investigate Lake North anomaly.			% Recov.	100 %	Date	July 15th, 1980

Ls.
band.
@
70°

METERS from	To	Description	RECOVERY		Sample Interval	Sample No.	Length	Analysis	Claim	T Brg.	Collar Dip	Elev.	Length
			RUN	SHORT									
37.5	38.5	ANDESITE DYKE - Dark greenish, amygdular. Contacts not seen. This dyke has little or no effects on enclosing rock.	39.52										
			-42.06										
			-44.35										
			-47.55										
			-48.16										
38.5	50.8	LIMESTONE - Massive, medium grained, white and dark grey color. A grey limestone with white bands from 5 to 15 cm. thick throughout. Banding is at 70° to line of drill hole.	-51.20										
			-53.64										
			-55.93										
50.8	74.0	LIMESTONE - Medium grained, massive rock of uniform appearance. Some finer grained sections occur. There are occasional dark carbonaceous streaks at 70° to the drill hole.	-56.23										
			-57.30										
			-58.36										
			-59.28										
74.0	85.6	LIMESTONE - Fine grained, light grey massive. This is a very uniform structureless rock.	-60.96										
			-63.70										
			-66.45										
85.6	86.4	ANDESITE DYKE - Amygdular. A fine grained matrix has amygdules of white mineral and chlorite with traces of pyrite. Amygdules rounded to 3mm diameter. Some calcite slips also occur. Dyke contacts not well defined, may be at 30° to drill hole.	-68.12										
			-70.56										
			-74.67										
			-75.89										
			-78.63										
			-81.68										
			-83.82										
			-85.65										

40

60

Ls.
stks.
@
70°

80

Ls.
fine
gn.

1:250
1:100

Drill Hole Record

SHIMA RESOURCES LIMITED
2002 - 1177 West Hastings Street, Vancouver, B.C. - V6E 2K3

Page 2 / 5

Property	Lake North Zone	District	Nanaimo - Texada Island	Hole No.	SR 80 - 7	Length	146.9 M.
Commenced	July 15th, 1980	Location	Ager #5 Area	Tests at		Hor. Comp.	84.2
Completed	July 19th, 1980	Core Size	BQ - 36 mm	Corr. Dip	- 55°	Vert. Comp.	120.3
LAT.	0 + 29 N	DEP.	1 + 00 E	ELEV.	176 M	True Brg.	S 56° W
Objective	To test Lake North anomaly			% Recov.	96.3 %	Date	July 19th, 1980

Claim
T Brg.
Collar Dip
Elev.

40

Volc.

#100P

METERS From To	Description	RECOVERY		Sample interval	Sample No.	Length	Analysis			
		RUN	SHORT				Au	Ag	Cu	
28.3 - 38.5	LIMESTONE - Medium grained, grey massive. Color banding at start and end at 45° to hole. Small Andesite Dyke from 35.4 to 36.0 with chilled borders at 45° to hole being greenish felspar porphyry. Another small 0.2 m dyke later. Limestone continues to end.	39.85								
		-34.13								
		-35.66								
		-37.49								
		38.70		38.5-40.7	099PP	2.2	.002	Tr.	.02	
		-41.45	0.6							
38.5 - 40.7	ANDESITE VOLCANICS - Skarney and amygdaloidal Tight contact at start at 50° to hole. Rounded amygdular openings carry garnet, epidote and pyrite. Pyrite on both sides of contact. The sample overlaps the contact a little ways. Amygdules to 1 cm diam.	-42.67								
		-43.28								
		-44.65								
		-44.95								
		-45.56								
40.7 - 47.5	ANDESITE VOLCANICS - Medium to fine grained Dark greenish color with scattered spots and crystals of pyrite. Some white veinlets of calcite occur at various angles to hole. Some of these are quartz/calcite to 5 mm. Stringers of pyrite also occur toward last.	-47.70								
		-48.93								
		-49.53								
		-49.83								
		-51.51								
47.5 - 63.5	ANDESITE VOLCANICS Amygdular at start for 0.5 m with greenish white propylite, pyrite and epidote. Rock then becomes fine grained dark with obscure fragmental texture which gradationally changes to porphritic with white radiating flowers of felspar to 1 cm at 55.3. At 58.0 rock becomes fine grained again with amygdular texture indicating another flow top. Gradationally amygdules decrease in frequency, increase in size and texture is coarser.	-52.42								
		-54.25								
		-55.32		47.5-49.3	100PP	1.8	.002	Tr.	.01	
		-58.21								
		-60.04								
		-63.09								
		-64.46								

Volc.

60

#0151A

Volc.

60°

Dior-
ite
Dyke

80

1:250
1:250

Drill Hole Record

SHIMA RESOURCES LIMITED
2002 - 1177 West Hastings Street, Vancouver, B.C. - V6E 2K3

80

Property	Lake North Zone	District	Nanaimo - Texada Island	Hole No.	SR 80 - 2	Length	146.9 M
Commenced	July 15th, 1980	Location	Ager #5 area	Tests at		Hor. Comp.	84.2
Completed	July 19th, 1980	Core Size	BQ - 36 mm	Corr. Dip	-55°	Vert. Comp.	120.3
LAT.	0 + 29 N	DEP.	1 + 00 E	ELEV.	176 M	True Brg.	S 56° W
Objective	To test Lake North anomaly.			% Recov.	96.3 %	Date	July 19th, 1980

Claim
T Brg.
Collar Dip
Elev.

Volc

METERS from	To	Description	RECOVERY		Sample Interval	Sample No.	Length	Analysis		
			RUN	SHORT				Au	Ag	Cu
64.40	64.40									
47.5-63.5	Cont.	All of this rock carries from 1 to 3% pyrite as mineralized patches and as crystal grains in amygdules.	-65.22							
			-66.75							
			-68.12							
63.5 - 74.0		VOLCANICS - Fine grained, limey, black.	-69.18		63.5-64.5	0151A	1.0	.082	Tr.	.02
		Brecciation at start with white limey cement (flow top ?) and some thin limey stringers at 60° to hole. Pyrite is scarce in this rock but a few short sections of pyrite/epidote mineralization occur. No chalcopryrite was seen. Core is broken with some looses. Rock is slightly magnetic.	-70.26							
			-71.01							
			-71.93							
			-72.54							
			-73.45							
74.0 - 83.3		DIORITE DYKE	-74.06	0.1						
		Contact at start sharp at 60°. A medium to coarse grained light greenish colored rock with scarce black minerals. Rock is not magnetic. This is a uniform appearing rock with closely packed feldspars to 2 mm. Contact at start is unmineralized and only a few thin surfaces of pyrite were seen.	-74.67							
			-74.98							
			-75.43							
			-77.11							
		No mineralization by copper was noted. Contact at last is missing and rock shows no grain size change or fracturing at last.	-78.33	0.8						
			-79.24							
			-79.85							
			-81.38							
			-83.21	0.1						
			-84.26	0.9						
			-85.64							
			-87.47							

100

Volc

120

Volc.

Scale
1:250
Colour Plot
& Dip

Drill Hole Record

SHIMA RESOURCES LIMITED
2002 - 1177 West Hastings Street, Vancouver, B.C. - V6E 2K3

page 1 / 3

Property	Lake North Zone	District	Nanaimo	Hole No.	SR-80-8	Length	107.6 M
No	Commenced July 20 / 80	Location	Ager #6 Area	Tests at		Hor. Comp.	61.7 M
core	Completed July 22 / 80	Core Size	BQ	Corr. Dip	- 55°	Verl. Comp.	88.1 M
LAT.	0 + 00 N	DEP.	1 + 92 E	ELEV.	177	True Brg.	Due West
Objective	To explore Lake North Anomaly			% Recov.	99.7 %	Logged by	K.C.F.
						Date	July 21 / 80

Claim
T Brg.
Collar Dip
Elev.
Length

METERS	Description	RECOVERY		Sample Interval	Sample No.	Length	Analysis
		From	To				
Is.							
0 - 5.0	No core			0 - 5.18			
				5.48			
Beds				6.40			
50°	LIMESTONE - Grey medium grained to fine grained.			7.01			
	Banding at about 50° to hole, at about 19.0.			8.23			
	Continuing with occasional banding decreasing to 40° to hole at about			9.75			
	25.0. A few slightly rusty fractures.			11.17			
				12.80			
27.7 - 32.4	MARBLE LIMESTONE - White coarse grained.			13.41			
	Has "oatmeal" texture with some fine pyritic fractures and			14.02			
	a few clusters of garnet (pale brown) with trace of pyrite.			16.46			
				19.50			
And.	32.4 - 35.3 ANDESITE BRECCIA DYKE -			22.55			
Brecc	Fine grained greenish color and			23.47			
Dyke	with angular fragments to 2 cm. Some scattered pyrite.			26.52			
25°	A central of 1.2 meters of marble occur.			29.56			
Is.	Contacts are about 25° to hole.			31.24			
Marb.				32.61			
				34.44			
	35.3 - 49.7 MARBLE LIMESTONE			36.57			
	Some darker bands at about 60° to hole at 39.0.			37.75			
	Toward last, some scattered apidote and pyrite can be seen.			39.77			
	Contact at 60° to hole						

20

40

Scale
1 : 250
Contours Plus
& Dips

Drill Hole Record

SHIMA RESOURCES LIMITED
2002 - 1177 West Hastings Street, Vancouver, B.C. - V6E 2K3

page 2 / 3

40	Property	Lake North Zone	District	Nanaimo	Hole No.	8R - 80-8	Length	107.6 M
L.S.	Commenced	July 20 / 80	Location	Ager # 6 Area	Tests at		Hor. Comp.	61.7 M
Harb.	Completed	July 22 / 80	Core Size	BQ	Corr. Dip	- 55°	Vert. Comp.	88.1 M
Bands	LAT.	0 + 00N	DEP.	1 + 92 E	ELEV.	177	True Brg.	Due West
40°	Objective	To explore Lake North Anomaly Zone			% Recov.	99.7 %	Date	July 22 / 80

Claim
T Brg.
Collar Dip
Elev.
Length

	METERS		Description	RECOVERY		Sample Interval	Sample No.	Length	Analysis		
	From	To		RUN	SHORT				Au	Ag	Cu
#152 Skarn #153 60°	49.7	50.6	SKARN AND MARBLE	39.77	40.84	49.7 - 50.3	0152A	0.6	.012	Tr.	.08
			Epidote calcite magnetite and pyrite. Some possible	42.67							
And. Volc.			chalcopryite noted but scarce. From 50.3 to end is short section of marble.	44.19		50.3 - 52.6	0153A	2.3	.006	Tr.	.04
				45.11							
				45.87							
60°	50.6	58.8	ANDESITE - Fine grained dark grey massive	47.24							
			epidote and pyrite and some calcite filled fractures to	49.07							
And. Porc.			52.6. Scattered pyrite blebs continue with occasional	50.29							
Volc.			epidote especially at last of section where a few calcite stringers occur.	50.59	(-.03)						
				51.66							
				52.58							
	58.8	71.0	ANDESITE PORPHYRY VOLCANIC	53.64							
			Rock is massive dark grey with plentiful white amygdaloids, crystalites and	56.38							
			phenocrysts. No pyrite noted.	56.69	(-.03)						
Amyg. Volc.			Coarser amygdular at 69 to 1 cm.	57.30							
				57.76							
	71.0	85.0	AMYGDULAR VOLCANIC	58.82	(-.06)						
			Fine grained dark matrix with plentiful rounded and	59.28							
			elongated amygdula . up to 2 cm. Also white feldspar phenocryst	60.04	(-.06)						
			to 2 mm.	63.09							
				64.62							
				65.22							

80

Scale
1 : 250
Column
& Dip

Drill Hole Record

SHIMA RESOURCES LIMITED
2002 - 1177 West Hastings Street, Vancouver, B.C. - V6E 2K3

Property	Basic 11 Zone	District	Nanaimo M.D. - Texada	Hole No.	SR-80-9	Page 1 Length	128.9
Commenced	July 24/80	Location	Ager No. 4 Area	Tests at		Hor. Comp.	
Completed	July 25 / 80	Core Size	BQ	Corr. Dip	-90°	Vert. Comp.	128.9
LAT.	2 + 08N	DEP.	0 + 98W	ELEV.	125 M	True Brg.	Logged by K.C.F.
Objective	To investigate gravity anomaly			% Recov.	100 %	Date	July 29 / 80

Claim
T Brg.
Collar Dip
Elev.
Length
Hole No.
Sheet

METERS From To	Description	RECOVERY		Sample Interval	Sample No.	Length	Analysis									
		RUN	SHORT													
0 - 1.5	Ng CORE	1.83	CASING													
1.5 - 23.0	LIMESTONE - MARBELIZED Medium to coarse grained texture with some indistinct and crumpled banding. Color greyish from 5.0 to 11.5. At 5.0 is some scattered epidote over 0.1 m but no pyrite noted. From 19.0 becomes greyish colored mottled, with suggestion of fragmental texture.	3.35														
		5.18														
		7.01														
		7.62														
		9.14														
23.0 - 40.0	LIMESTONE - Finer grained grey Massive med. grained rock of uniform appearance.	10.05														
		12.19														
		12.65														
40.0 - 53.0	LIMESTONE - Alternating bands of white and grey. No bedding noted to 48.0. The uniform grey color with some faint black carbon lines continues.	14.32														
		14.78														
		17.37														
		19.81														
53.0 - 66.7	LIMESTONE - MARBELIZED Some coarse grained patches occurs, but there is a tight contact with following rock without significant alteration.	22.86														
		24.38														
		25.75														
		26.52	(-.03)													
		27.88														
		30.33	(-.03)													
		31.55														
		32.31														
		34.13														

N.G.
Ls.
Harb.
20
Ls.
Mass.
f.g.
40

Drill Hole Record

SHIMA RESOURCES LIMITED
2002 - 1177 West Hastings Street, Vancouver, B.C. - V6E 2K3

90

Property Basic 11 Zone District Nanaimo - Texada Island Hole No. SR 80 - 9 Length 128.9 M

And Dyke

Commenced July 24th, 1980 Location Ager #4 area Tests at Hor. Comp.

Mixed Cont. Zone

Completed July 25th, 1980 Core Size BQ - 36 mm Corr. Dip - 90° Vert. Comp. 128.9

LAT. 2 + 08 N DEP. 0 + 98 W ELEV. 125 M True Brg. Logged by K.C.F.

Objective To investigate gravity anomaly. % Recov. 100 % Date July 29th, 1980

Claim
T Brg.
Collar Dip
Elev.

METERS		Description	RECOVERY		Sample Interval	Sample No.	Length	Analysis
from	to		RUN	SHORT				
113.0	128.9	LIMESTONE - Medium grained grey color	85.65					
		Some white banding occurs at 45° to hole. A few thin chloritic slips		-88.85				
		occur at 35° to hole at 120.0. Rock becomes increasingly finer grained		-90.52				
		to last where a little pyrite in crystals occurs on chloritic slips.		-93.57				
				-95.70				
		End of Hole		-97.23				
				-99.67				
				-101.49				
				-103.94				
				-105.76				
				-107.89				
				-110.95				
				-113.08				
				-114.90				
				-116.28				
				-117.04				
			Recovery	-118.56				
			Run Short	-119.33				
			125.27-126.95	-120.09				
			126.95-128.32	-121.92				
			128.92-128.93	-123.75				
			-----	-125.27				

La. Harb.

100

La. med. gn.

120

128.9 End

L. 11250
 Plot
 11250

Drill Hole Record

SHIMA RESOURCES LIMITED
 2002 - 1177 West Hastings Street, Vancouver, B.C. - V6E 2K3

Property	Basic 11 Zone	District	Nanaimo - Texada Island	Hole No.	SR 80 - 10	Length	125.8 M
Commenced	July 26th, 1980	Location	Age #3 Zone	Tests at		Hor. Comp.	42.8
Completed	July 28th, 1980	Core Size	BQ - 36 mm	Corr. Dip	- 70°	Vert. Comp.	117.6
LAT.	1 + 77 N	DEP.	0 + 12 W	ELEV.	119 M	True Brq.	S 27° W
Objective	To explore magnetic anomaly.			% Recov.	98.4 %	Date	July 29th, 1980

No core

Claim
 T Brq.
 Collar Dip
 Elev.

METERS from To	Description	RECOVERY		Sample interval	Sample No.	Length	Analysis		
		RUN	SHORT				Au	Ag	Cu
0 - 11.4	No rock - some plastic clay.	0	-13.10	casin					
			-14.32						
11.4 - 24.7	WHITE LIMESTONE		-15.85						
	Some dark grey irregular carbonaceous streaks occur.		-17.37						
	No sulphides noted.		-17.98						
			-20.29						
24.7 - 26.3	Small ANDESITE DYKES in limestone		-21.03						
	There are three dykes each about 0.2 meters at 30° to the hole with		-21.79						
	white limestone like preceding between. Dykes are amygdular with some		-22.70						
	epidote and garnet in amygdules. Limestone is not mineralized.		-23.46						
			-24.68						
			-26.36						
26.3 - 36.7	LIMESTONE - Coarse grained, marbelized.		-26.97						
	Some patches of dark limestone of irregular outline and some doubtful		-28.95						
	banding at 45° to drill hole.		-30.17						
			-32.00						
36.7 - 41.6	ANDESITE DYKE mixed with EPIDOTE SKARN		-33.22	36.7-38.7	0154A	2.0	.002	Tr	.01
	Epidote, calcite and pyrite occur at the start with some hematite but		-35.66						
	no magnetite continues to 38.7 then mainly dark grey andesite with		-36.73						
	occasional blebs of pyrite.		-38.71						
			-39.93						
			-41.45						

White Ls.

20

3 And. Dykes @ 30°

Ls. Marb.

And. dyke

#154A

40

skn.

11250

Drill Hole Record

SHINA RESOURCES LIMITED
2002 - 1177 West Hastings Street, Vancouver, B.C. - V6E 2K3

Page 2 / 3

40
Samples
#155A
#156A
#157A

Property Basic 11 Zone District Nanaimo - Texada Is. Hole No. SR 80 - 10 Length 125.8 M
Commenced July 26th, 1980 Location Ager #3 area Tests at Hor. Comp. 42.8
Completed July 28th, 1980 Core Size BQ - 36 mm Corr. Dip - 70° Vert. Comp. 117.6
LAT. 1 + 77 N DEP. 0 + 12 W ELEV. 119 M True Brq. S 27° W Logged by K.C.F.
Objective To explore magnetic anomaly % Recov. 98.4 % Date July 29th, 1980

METERS from To	Description	RECOVERY		Sample Interval	Sample No.	Length	Analysis		
		RUN	SHORT				Au	Ag	Cu
41.6 - 47.7	EPIDOTE SKARN	41.65		41.6					
	Heavy green epidote with some brown garnet and sections of plentiful pyrite near start. Banding occurs at 30° to drill hole.	-43.43		43.6	0155A	2.0	.002	Tr.	.01
		-44.80		45.6	0156A	2.0	.008	Tr.	.02
		-45.56		47.7	0157A	2.1	.008	Tr.	.01
		-47.70							
47.7 - 95.2	DIORITE DYKE - Medium grained, slightly porphyritic.	-49.07							
	Rock is mainly dark but bleached zones give granitic appearance. Bleaching related to calcite stringers and reddish aplitic veinlets to 4 cm which are almost parallel to hole from 52 to 54 M. From 56.5 is more uniform appearing greenish medium grained rock with occasional zones of drusy calcite stringers which give brecciated look up to 78.0 when rock becomes more competent.	-49.83							
		-51.05							
		-51.66							
		-51.90							
		-53.95							
		-54.86							
		-55.77							
95.2 - 125.2	DIORITE DYKE - (BROKEN)	-56.23							
	Rock is similar to preceding section but the presence of many thin calcite fractures gives a broken appearance. Traces of pyrite occur but no other mineralization was noted. A remarkably uniformly textured rock. Probably drilling almost parallel to dyke walls.	-57.91							
		-58.97							
		-61.11							
		-62.18							
		-62.78	0.1						
	End of Hole	-63.70							
		-65.53							
		-66.45							
		-67.21	0.1						

Claim

T Brq.

Collar Dip

Elev.

Diorite Dyke

60

80

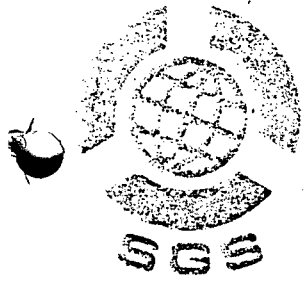

GENERAL TESTING LABORATORIES

Formerly: DIVISION SUPERINTENDENCE COMPANY (CANADA) LTD.

1001 EAST PENDER ST., VANCOUVER, B.C., CANADA, V6A 1W2
 PHONE (604) 254-1647 TELEX 04-507514 CABLE SUPERVISE

TO:
MR. K. C. FAHRNI
 Shima Resources
 7011 Angus Drive
 Vancouver, B.C.
 V6P 5J6

CERTIFICATE OF ASSAY

No.: 8004-1056 DATE: April 23/80

We hereby certify that the following are the results of assays on:

Ore

MARKED	GOLD	SILVER	Copper	Molybdenum	XXXX	XXXXX	XXXXX	XXXXX
	(oz/st)	(oz/st)	Cu (%)	Mo (%)				
P.O. # E-42286 Mark <u>095-PP</u>	0.002	trace	0.01	0.069	(DH	SE20	-1)	

NOTE: REJECTS RETAINED ONE MONTH. PULPS RETAINED THREE MONTHS. ON REQUEST PULPS AND REJECTS WILL BE STORED FOR A MAXIMUM OF ONE YEAR. A Division of SGS SUPERVISION SERVICES INC.

ALL REPORTS ARE THE CONFIDENTIAL PROPERTY OF CLIENTS. PUBLICATION OF STATEMENTS, CONCLUSION OR EXTRACTS FROM OR REGARDING OUR REPORTS IS NOT PERMITTED WITHOUT OUR WRITTEN APPROVAL. ANY LIABILITY ATTACHED THERETO IS LIMITED TO THE FEE CHARGED.

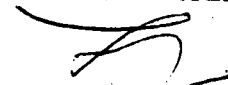
L. WONG PROVINCIAL ASSAYER

Analytical and Consulting Chemists, Bulk Cargo Specialists, Surveyors, Inspectors, Samplers, Weighers

MEMBER American Society For Testing Materials • The American Oil Chemists' Society • Canadian Testing Association
 REFEREE AND OR OFFICIAL CHEMISTS FOR: National Institute Of Oilseed Products • The American Oil Chemists Society
 OFFICIAL WEIGHMASTERS FOR Vancouver Board Of Trade



TO:
 K.C. FAHRMI, P. ENG.
 7011 ANGUS DRIVE
 VANCOUVER, B.C.
 V6P 5J6

General Testing Laboratories
 A Division of SGS Supervision Services Inc.

1001 EAST PENDER ST., VANCOUVER, B.C., CANADA, V8A 1W2
 PHONE (604) 254-1847 TELEX 04-507514 CABLE: SUPERVISE

CERTIFICATE OF ASSAY

No.: 8006-2657 DATE: July 7, 1980

We hereby certify that the following are the results of assays on: Ore

MARKED	GOLD	SILVER	Copper	XXX	XXX	XXX	XXX	XXX
	(oz/st)	(oz/st)	Cu (%)					
E - 52483								
096	0.002	trace	-	} SR20 - 3				
097	0.006	0.10	0.32					
098	0.008	trace	-		- SR20 - 5			

NOTE: REJECTS RETAINED ONE MONTH. PULPS RETAINED THREE MONTHS. ON REQUEST PULPS AND REJECTS WILL BE STORE FOR A MAXIMUM OF ONE YEAR.

ALL REPORTS ARE THE CONFIDENTIAL PROPERTY OF CLIENTS. PUBLICATION OF STATEMENTS, INCLUSION OR EXTRACTS FROM OR REGARDING OUR REPORTS IS NOT PERMITTED WITHOUT OUR WRITTEN APPROVAL. ANY LIABILITY ATTACHED THERETO IS LIMITED TO THE FEE CHARGED.

I. WONG PROVINCIAL ASSAYER

Analytical and Consulting Chemists, Bulk Cargo Specialists, Surveyors, Inspectors, Samplers, Weighers

MEMBER: American Society For Testing Materials • The American Oil Chemists Society • Canadian Testing Association
 REFEREE AND OR OFFICIAL CHEMISTS FOR: National Institute of Oilseed Products • The American Oil Chemists' Society
 OFFICIAL WEIGHMASTERS FOR: Vancouver Board Of Trade



TO:
 KEITH C. FAHRNI P. ENG.
 7011 Angus Drive
 Vancouver, B.C.
 V5P 5.6

General Testing Laboratories

A Division of SGS Supervision Services Inc.

1001 EAST PENDER ST., VANCOUVER, B.C., CANADA, V6A 1W2
 PHONE (604) 254-1647 TELEX 04-507514 CABLE SUPERVISE

CERTIFICATE OF ASSAY

No.: 8007-2154 DATE: August 1, 1980

We hereby certify that the following are the results of assays on: Ore

MARKED	GOLD	SILVER	Copper	XXX	XXX	XXX	XXX	XXX
	(oz/st)	(oz/st)	Cu (%)					
P.O. # E - 52499								
151	0.082	trace	0.02	} (S.F. - 7)				
099	0.002	trace	0.02					
100	0.002	trace	0.01					

NOTE: REJECTS RETAINED ONE MONTH. PULPS RETAINED THREE MONTHS. ON REQUEST PULPS AND REJECTS WILL BE STORE FOR A MAXIMUM OF ONE YEAR.

ALL REPORTS ARE THE CONFIDENTIAL PROPERTY OF CLIENTS. PUBLICATION OF STATEMENTS, CONCLUSION OR EXTRACTS FROM OR REGARDING OUR REPORTS IN NOT PERMITTED WITHOUT OUR WRITTEN APPROVAL. ANY LIABILITY ATTACHED THERETO IS LIMITED TO THE FEE CHARGED.

L. WONG

PROVINCIAL ASSAYER

Analytical and Consulting Chemists, Bulk Cargo Specialists, Surveyors, Inspectors, Samplers, Weighers

MEMBER: American Society For Testing Materials • The American Oil Chemists Society • Canadian Testing Association
 REFEREE AND OR OFFICIAL CHEMISTS FOR: National Institute of Oilseed Products • The American Oil Chemists' Society
 OFFICIAL WEIGHMASTERS FOR: Vancouver Board Of Trade



General Testing Laboratories

A Division of SGS Supervision Services Inc.

1001 EAST PENDER ST., VANCOUVER, B.C., CANADA, V6A 1W2
 PHONE (604) 254-1647 TELEX 04-507514 CABLE SUPERVISE

TO:
 K.C. FAHRNI P. ENG
 7011 Angus Drive
 Vancouver, B.C.
 V6P 5J6

CERTIFICATE OF ASSAY

No.: 8008-0162 DATE: Aug. 14, 1980

We hereby certify that the following are the results of assays on: ORE

MARKED	GOLD	SILVER	Copper	XXX	XXX	XXX	XXX	XXX
	(oz/st)	(oz/st)	Cu (%)					
0152	0.012	trace	0.08	SR30-3				
0153	0.006	trace	0.04					
0154	0.002	trace	0.01					
0155	0.002	trace	0.01	SR30-10				
0156	0.008	trace	0.02					
0157	0.008	trace	0.01					
0158	0.002	trace	0.01	old cut on Lake North.				

..0. # 52306

NOTE: REJECTS RETAINED ONE MONTH. PULPS RETAINED THREE MONTHS. ON REQUEST PULPS AND REJECTS WILL BE STORE FOR A MAXIMUM OF ONE YEAR.

ALL REPORTS ARE THE CONFIDENTIAL PROPERTY OF CLIENTS. PUBLICATION OF STATEMENTS INCLUSION OR EXTRACTS FROM OR REGARDING OUR REPORTS IS NOT PERMITTED WITHOUT OUR WRITTEN APPROVAL. ANY LIABILITY ATTACHED THERETO IS LIMITED TO THE FEE CHARGED.

[Signature]
 L. JONG PROVINCIAL ASSAYER

Analytical and Consulting Chemists, Bulk Cargo Specialists, Surveyors, Inspectors, Samplers, Weighers

MEMBER: American Society For Testing Materials • The American Oil Chemists Society • Canadian Testing Association
 REFEREE AND OR OFFICIAL CHEMISTS FOR: National Institute of Oilseed Products • The American Oil Chemists' Society
 OFFICIAL WEIGHMASTERS FOR: Vancouver Board Of Trade



Es

ALL ACCOUNTS PAYABLE TO

CENTENNIAL SERVICE

P.O. BOX 84, VANANDA, TEXADA ISLAND, B.C.
PHONE 486-7416

DATE

TO Schima Resources Ltd.
St # 2002-1177 West Hastings
Vancouver, B.C.

PLEASE
RETURN THIS
PART WITH
YOUR REMITTANCE

IN ACCOUNT
WITH

CENTENNIAL SERVICE

Phone 486-7416, Vananda, Texada Island, B.C.

KEEP THIS PART

DATE	INVOICE NO.	CHARGES	CREDITS	BALANCE
		BALANCE FORWARD		
June 20	6712	1.50		1.50
23	6726	33.20		34.70
25	6818	6.42		41.12
26	6815	5.00		46.12
18	6673	28.50		74.62
July 7	7080	34.13		108.75
12	7186	26.60		135.35
19	7310	36.60		171.95
21	7316	12.52		184.47
24	7408	8.10		192.47
26	7432	34.00		226.47
28	7442	6.25		232.72
30	7527	44.18		276.90
CHARGE ACCOUNTS ARE A MAXIMUM OF 30 DAYS OR FULL PAYMENT RECEIPT OF STATEMENT. CHARGES WILL BE ASSESSED 2% PER MONTH.				
				OK p.m. JMM

STATEMENT

PAYMENTS MADE AFTER DATE SHOWN WILL APPEAR ON NEXT STATEMENT

2% PER MONTH INTEREST CHARGED ON OVERDUE ACCOUNTS

LAST AMOUNT IN THIS COLUMN IS BALANCE OF YOUR ACCOUNT AT THE DATE SHOWN.

DATE JULY 29th / 80 .80

NAME Shima Resources

ADDRESS 1177 West Hastings Vancouver BC

SOLD BY	C. O. D.	CHARGE	ON ACCT.	ACCT. FWD.

1				
2	July 20th	5 hrs	150.00	
3				
4	Digging pump &			
5	repairing road			
6				
7				
8				
9				
10				
11				
12				
1	SIGNATURE	TAX #	150.00	

◆ 06010300

H. Stoy
Box 125 Gillies Bay

DATE Sept 26 1980

NAME Shima Resources

ADDRESS _____

SOLD BY	C. O. D.	CHARGE	ON ACCT.	ACCT. FWD.

1	July 20th	5 hrs	150.00	
2				
3				
4	Digging pump	4 hrs		
5				
6	Repairing rd.	1 hr		
7				
8	30/HR x 5 HRS			
9				
10				
11				
12				
5	SIGNATURE	TAX	150.00	

◆ 06010300

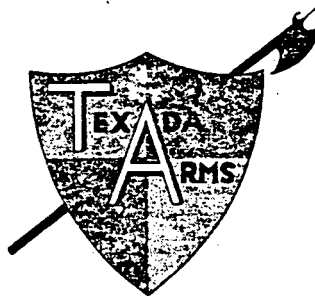

BOX 220
VANANDA, B.C.

DATE: July 29/80

TO: Shima Res.
Stanley B. Cole

DATES	INVOICE #	IDENTITY	RATE	DEBIT
6/7/80	220483/87	meal	11.55	11.55
7/7/80	220483	" "	265	14.20
9/7/80	220489	" "	275	3.95
9/7/80	220438	" "	7.50	24.45
10/7/80	220498	" "	160	26.05
11/7/80	220510/16	" "	5.00	31.05
13/7/80	220526/40	" "	12.10	43.15
14/7/80	220528/54	" "	15.95	59.10
15/7/80	220579	" "	14.25	73.35
16/7/80	220604	" "	260	76.95
18/7/80	220621	" "	1.25	78.20
19/7/80	220644/589	" "	20.55	98.75
20/7/80	220680	" "	2.25	101.00
23/7/80	222312/755/24716	" "	14.05	115.05
24/7/80	220841/146	" "	15.25	130.30
25/7/80	220883	" "	40.5	170.80
26/7/80	220889	" "	4.15	174.95
27/7/80	220428/918	" "	8.65	147.15

8/19/80 RCM
M.M.

BALANCE DUE 147.15

TERMS: 30 DAYS

INTEREST CHARGED

Shiva Resources

Sept 1, 1980

Account for July 22 - July 30

K

Contract services to instruction of engineer
\$100 per day 9 days \$900.00

Truck rental. 443.6 miles @ 20¢/m 88.72

\$988.72

APPROVAL

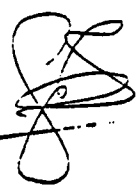
 J.L.M.

paid Sept 2/80
#85

Stanley L. Zerk

SHIMA Resources
2002 - 1177 W. Hastings
Vancouver, BC

S. L. Beale
4469 Belmont Ave.,
Vancouver V6R 1C3
July 21, 1980

Account for July 7 - July 21

Contract services to instruction of Engineer	\$1,500. ⁰⁰
\$100 per day - 15 days	
Transportation via Air West	68. ⁹⁰
Truck rental 963.6 miles @ 20¢/m.	192. ⁷²
TOTAL	<u>\$ 1,761.⁶²</u>

*Texada Arms + Texada Food Market to bill SHIMA direct.

Stanley L. Beale

APPROVED

JLM

paid Sept 2/80
54

SHIMA RESOURCES
2002 - 1177 W. HASTINGS
VANCOUVER, B.C.

S. L. Beale
4469 Belmont Ave,
Vancouver, BC
V6R1C3
July 3, 1980

Account for June 11 - 26 (minus June 14 + 15) K

Contract services to instruction of Engineer	\$1,400. ⁰⁰
\$100. ⁰⁰ per day - 14 days	
Transportation via Air West	68. ⁹⁰
*Board excluding Texada Arms	57. ⁷⁹
Hardware Tools	12. ¹⁵
Calculator	30. ⁰⁴
Truck rental 867.3 miles @ 20¢/m	173. ⁴⁶
TOTAL	<u>\$ 1,742.³⁴</u>

* Texada Arms to bill SHIMA directly.

APPROVED

Summa Resources
2002 - 1177 W. Hastings
Vancouver, BC

S.L. Beale
4469 Belmont Ave
Vancouver V6R 1C3
July 3, 1980

Account for March 28, 1980 - April 4, 1980

Contract services to instruction of engineer	# 700.00
#100 per day - 7 days	
Transporation via BC ferries	57.90
Milage charge 25¢/m @ 126 m	31.50
Board @ \$20.00 per day	140.00
TOTAL	<hr/> \$ 929.40

APPROVED

D.J. DRILLING COMPANY LTD.

13135 - 20th Avenue
SURREY, B.C. V4A 1Z1
Phone 531-4134

July 31, 1980.

Shima Resources Limited,
2002 - 1177 West Hastings Street,
Vancouver, B.C.
V6E 2K3

Dear Sir:

Re: BQ Diamond Drilling
Texada Island, B.C.

The following is a summary of the attached invoice covering work completed at the above address from July 7 - 29, 1980.

Hole #SR-80-6	\$ 6,090.60
Hole #SR-80-7	\$ 6,380.50
Hole #SR-80-8	\$ 4,594.35
Hole #SR-80-9	\$ 5,410.65
Hole #SR-80-10	\$ 5,407.15
Labour re mobilization, moves travel, demobilization	\$ 7,656.00
Freight-Duncan to Exada	\$ 900.00
Ferries	\$ 68.20
JD 450 Bulldozer	\$ 5,200.00
Core Boxes	\$ <u>861.12</u>
Total	\$ <u>42,568.57</u>

Yours truly,

E.M. Schussler

(Mrs) E.M. Schussler
Secretary.

*OK
21.11.80
R.W.M.*

encl.

D.J. DRILLING COMPANY LTD.

13135 - 20th Avenue
SURREY, B.C. V4A 1Z1
Phone 531-4134

April 11, 1980

<

Shima Resources Ltd.,
Suite 2002, Board of Trade Tower,
1177 West Hastings Street,
Vancouver, B.C. V6E 2K3

Dear Sir:

Re: BQ Diamond Drilling
Texada Island, B.C.

The following is a summary of the invoice covering Diamond Drilling at Texada Island.

Hole SR-80-1	\$ 14,078.25
Labour	2,805.00
Core Boxes	248.04
Freight Equipment Texada to Duncan	800.00
Bulldozer Bldg Road, Moving Equipment to Drill Site	150.00
Ferries	<u>80.80</u>
Total	\$ <u>18,162.09</u>

Yours truly,

E. M. Schussler

(Mrs) E.M. Schussler,
Secretary

APPROVED

KEITH C. FAHRNI, P.ENG.

7011 ANGUS DRIVE
VANCOUVER, B. C.
CANADA, V6P 5J6
(604) 261-6426

Shima Resources Limited
2002 - 1177 West Hastings Street
Vancouver, B.C. - V6E 2L6

September 8th, 1980

I N V O I C E

For Engineering Services:

<u>Date</u>	<u>Service</u>	<u>Time Billed</u>	<u>Amount</u>
June 7/80	Preparing drill program	2 hrs	
June 17	Travel to Texada Is and inspect work	2 hrs	
June 18	Return to Vancouver	---	
June 23	Meeting Mr. Livegard re Shima work	2 hrs	
June 25	To Texada to log core and check work	7 hrs	
July 14	Preparing DD logs	7 hrs	
July 15	To Texada to log core and check progress	7 hrs	
July 16	Preparing DD cross sections	6 hrs	
July 17	Preparing maps/ Meeting w. C. Ager	6 hrs	
July 18	Prep. report on geophysics meeting	4 hrs	
July 19	To Texada to check progress	4 hrs	
July 21	Preparing data for TRV meeting/meeting	5 hrs	
July 22	Meeting re drill progress r. Margetts	1 hr	
July 25	Phone calls, Joubin, Margetts, Beale	1 hr	
July 26	Meeting Beale, Mearns and Margetts	1 hr	
July 29	To Texada w. E. Livgard to log core, etc.	7 hrs	
July 30	Samples to assayers	---	
Aug 19	Lunch meeting with Speton and Margetts	1 hr	
August 27	Meeting re Treasure Mt. with E. Livgard	1 hr	
Total time billed		64 hrs	
64 hours at 7 hrs per day = 9.14 days			
9.14 days at \$250 per day.....			\$2285.00

For Expenses:

<u>Date</u>	<u>Items</u>	<u>Cost</u>
June 8	Canadian Geoscience for typing	13.74
July 3	Airwest to Texada and return	68.50
July 9	General Testing, for assays	33.00
July 16	Copytime for printing drill forms	4.76
July 17	Engineers Club, lunches	9.60
July 18	L. Fahrni for draughting	36.00
July 18	BC Tel. for long distance calls	14.49
July 29	Airwest transportation to Texada	66.00
July 30	Parking for delivery of samples	4.00

*OK
2/2/80*

Subtotals	\$236.35	\$2285.00
-----------	----------	-----------

<u>Date</u>	<u>Items</u>	<u>Cost</u>	<u>Amount</u>
	Foreward from page 1	\$236.35	\$2285.00
August 8	General Testing for assaying samples	43.50	
August 19	Engineers Club for lunches	17.20	
August 19	General Testing for assaying samples	101.50	
August 20	BC Tel. for long distance calls	8.29	
August 27	Canadian Geoscience for printing forms	6.15	
September 1	L. Fahrni for typing drill logs	20.00	

Total for Expenses	\$432.99	432.99
--------------------	----------	--------

TOTAL OF INVOICE \$2717.99 <

Plus Outstanding Invoice of June 7th, 1980..... \$1648.68 <

Plus interest on overdue account at 1.5% per month \$ 49.46 <

Total outstanding to date..... \$4416.13

Keith C. Fahrni

Keith C. Fahrni

KEITH C. FAHRNI, P.ENG.

Shima Resources Limited
2002 - 1177 West Hastings Street
Vancouver, B.C. - V6E 2K3

7011 ANGUS DRIVE
VANCOUVER, B. C.
CANADA, V6P 5J6

(604) 261-6426

June 7th, 1980

I N V O I C E

For Engineering Services:

<u>Date</u>	<u>Service</u>	<u>Time Billed</u>	<u>Amount</u>
March 26	Travel to Texada Island	---	
March 27	Drill hole spotting and line-up	1 day	
March 28	Checking drill core and instructing S.Beale	1 day	
March 29	Travel to Vancouver	---	
April 2	Phone calls re Texada drilling	1 hr	
April 3	Travel to Texada, Checking drill core	2 hrs	
April 4	Logging core, DH line-up, travel Vancouver	1 day	
April 5	Plotting DH data, meeting R.Margetts	3 hrs	
April 7	Preparing drill logs	3 hrs	
April 14	Prep. extra reports on '79 work	2 hrs	
May 8	Meeting re Dave Murphy property	1 hr	
May 9	Conference at Mr Lafleur's office	---	
May 15	Write-up report on DH SR 80-1	1 hr	
May 16	Prep. prints etc to acc. report	1 hr	
May 20	Conference R. Margetts	---	

Total time billed 3 days 14 hrs or 5 days

5 days at \$250 per day..... \$1250.00

For Expenses:

<u>Date</u>	<u>Items</u>	<u>Cost</u>	
March 17	Postage mailing report to Victoria	1.27	
March 26-29	Travel and meals for trip to Texada	63.79	
March 26-29	Auto mileage for trip 260 @.22/mile	57.20	
March 31	Copytime, printing drill log forms	3.40	
	Subtotals	125.66	\$1250.00

160

4+50 S 4+00 S 3+50 S 3+00 S 2+50 S 2+00 S 1+50 S 1+00 S 0+50 S 0+00 0+50 N 1+00 N

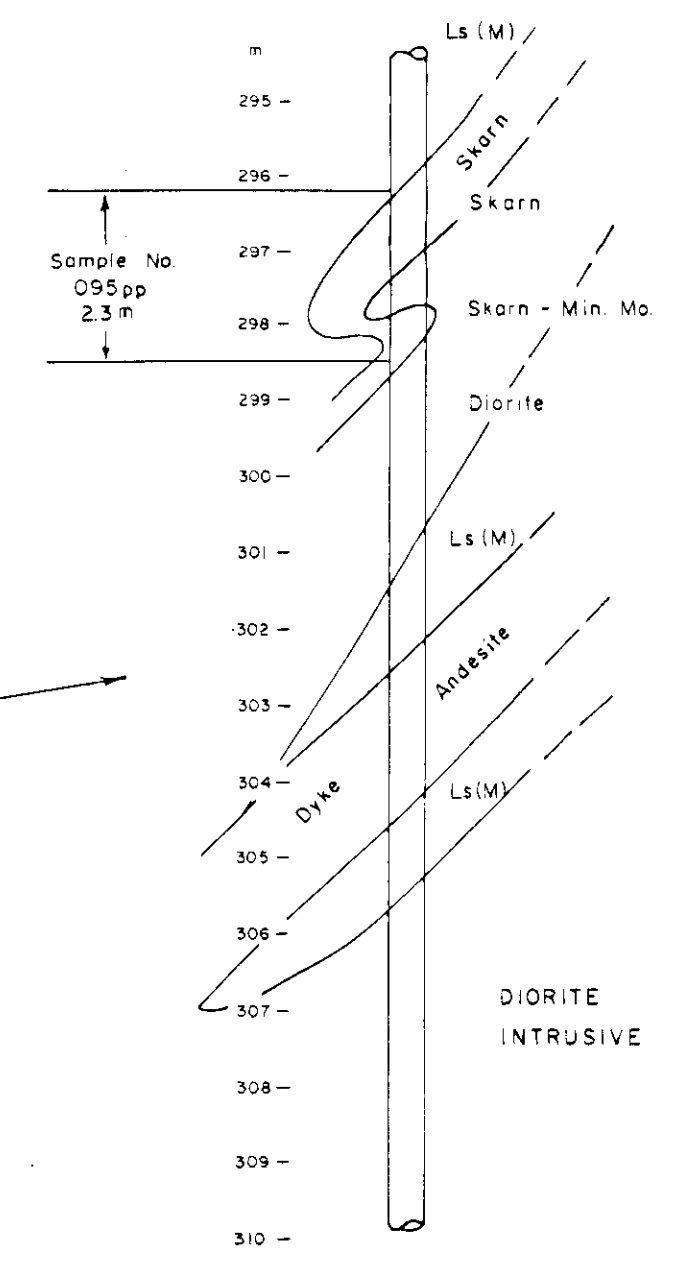
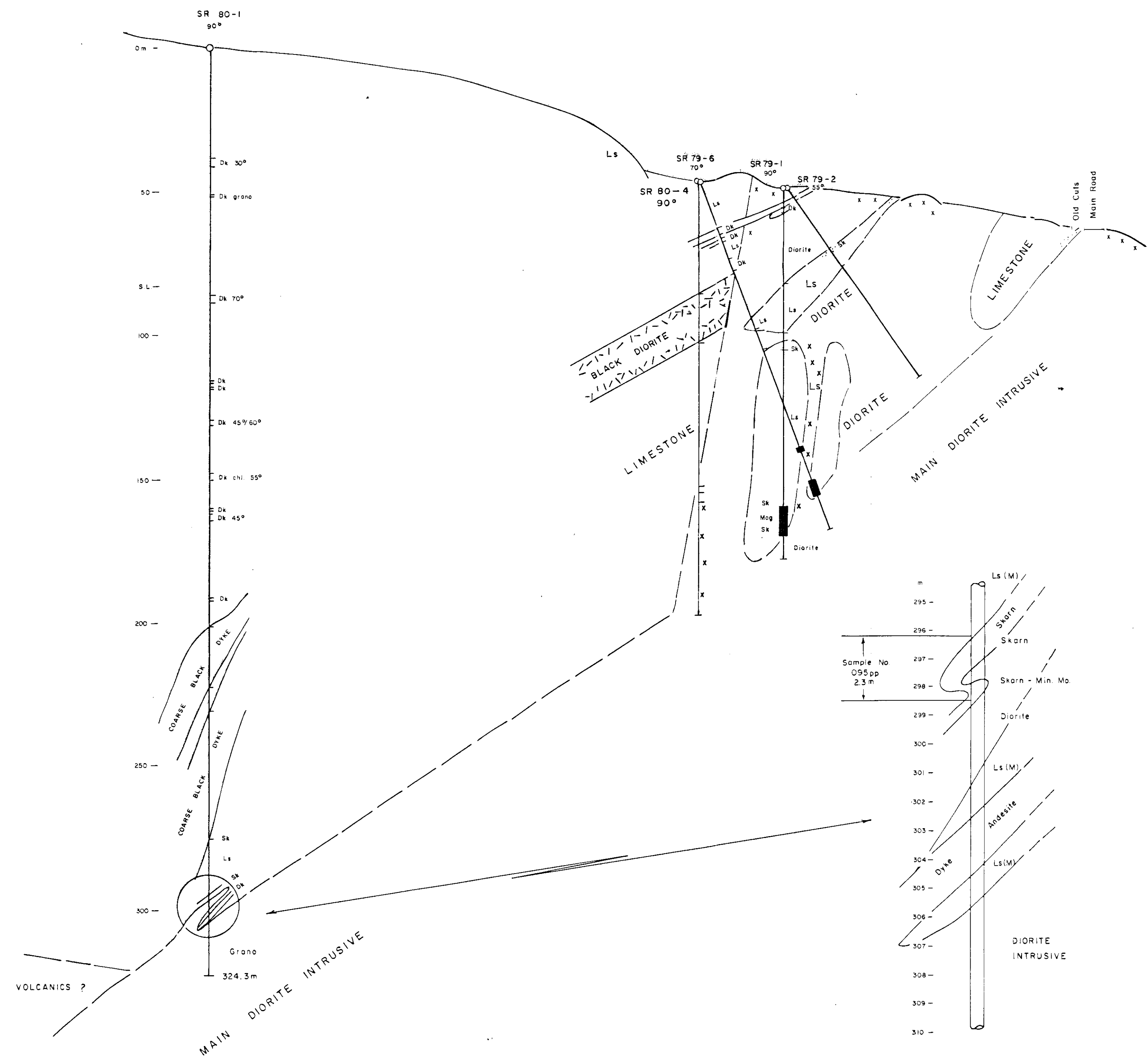

DRILL HOLE DETAIL
ENLARGED 10x

9300

SHIMA RESOURCES LIMITED
LITTLE BILLIE AREA
SECTION LOOKING WEST
2+00 EAST



JANUARY, 1981

K.C. FAHRNI
MAF 5-6



3+00 N

2+00 N

1+00 N

0+00

1+00 S

2+00 W

CO Shaft 30m South

1+00 W

0+00

1+00 E

McLEOD No. 3 M.C.
LOT 515

To Ager #1 DDH
30m South

2+00 E

3+00 E



9300

SHIMA RESOURCES LIMITED
DRILLING ON LITTLE BILLIE ANOMALY
TEXADA ISLAND, NANAIMO M.D., B.C.

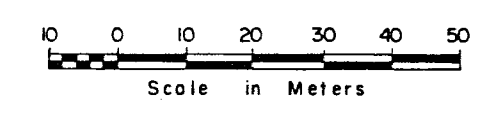

JANUARY 1981

K.C. FAHRNI