

PROSPECTING ASSESSMENT REPORT

ON THE  
AMCO #16 FRACTION

in the  
NELSON MINING DIVISION

NTS LOCATION 82F/3W

LATITUDE 49°10' LONGITUDE 117°10'

REPORT BY:

PEARSON GALLAGHER LTD.

JUNE, 1981

part 1  
of 2

MINERAL RESOURCES BRANCH ASSESSMENT REPORT 9312 NO.
--

TABLE OF CONTENTS

LOCATION MAP .....Page 1  
INDEX MAP .....Page 2  
LOCATION AND ACCESS .....Page 3  
GENERAL SETTING .....Page 3  
PROPERTY INFORMATION .....Page 4  
WORK SUMMARY .....Page 5  
INTERPRETATION AND RECOMMENDATIONS ...Page 5  
AUTHOR'S QUALIFICATIONS .....Page 6 & 7  
ITEMIZED COST STATEMENT .....Page 8  
GEOLOGICAL MAP .....in envelope



PEARSON GALLAGHER LTD.  
LOCATION MAP of  
AMCO #16 FR. CLAIM  
NELSON MINING DIVISION  
BC

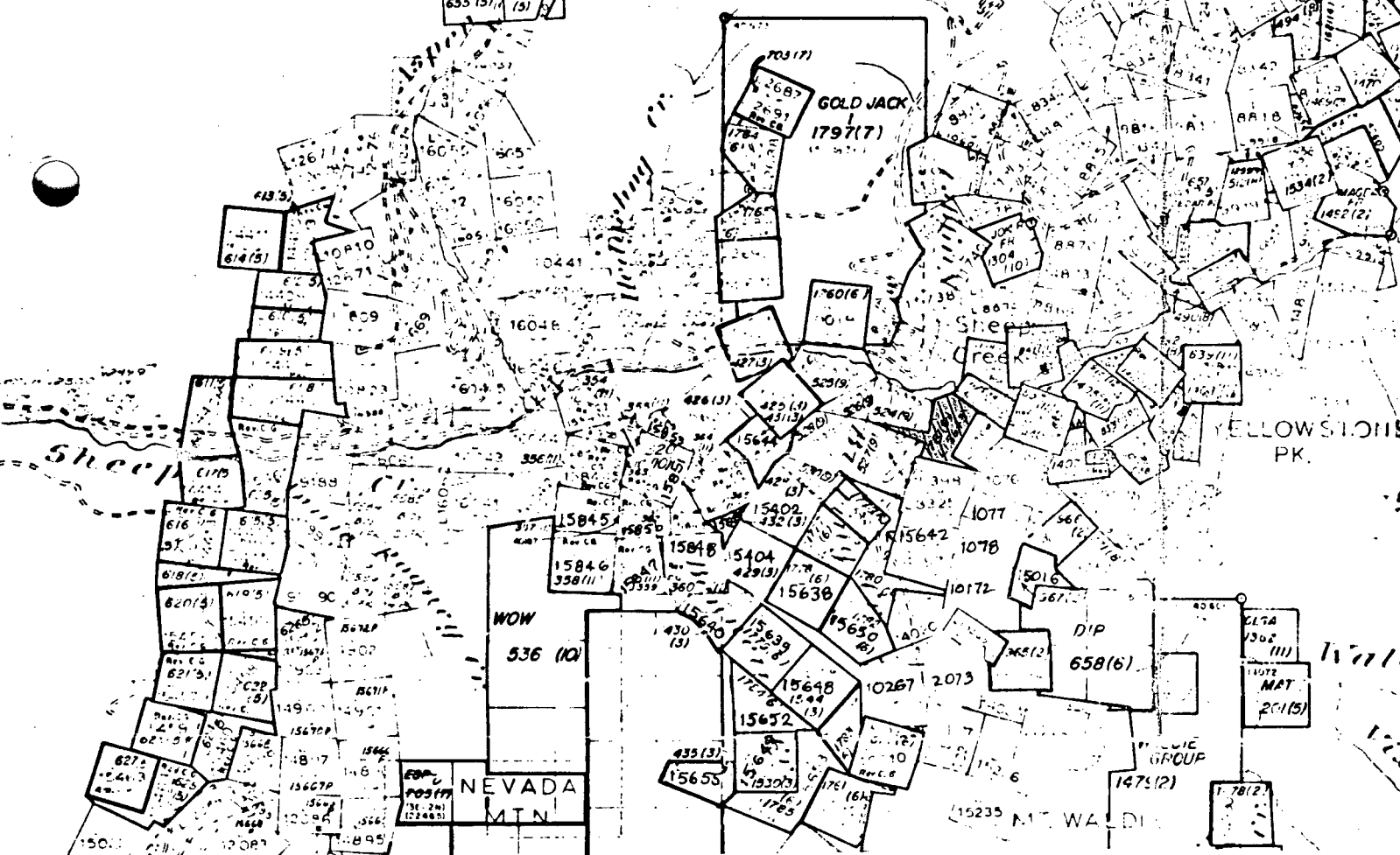
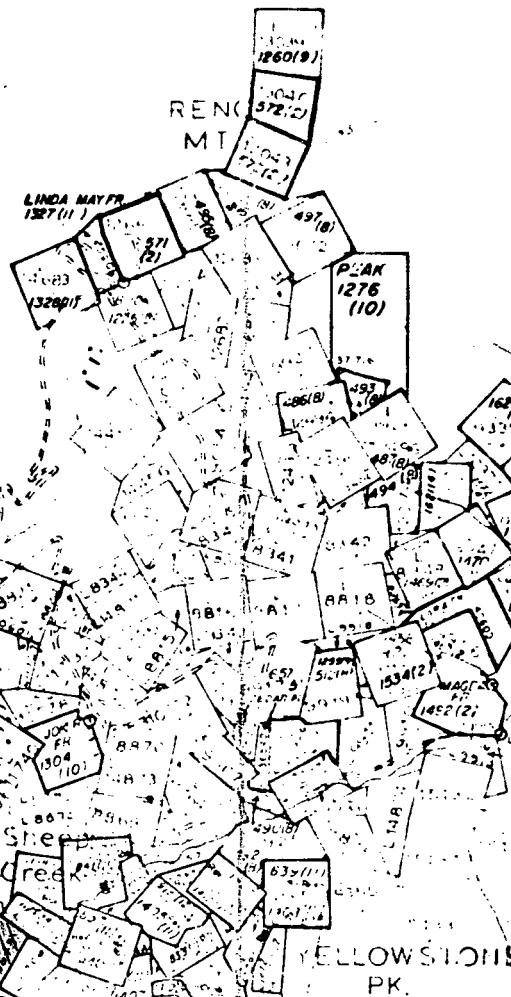
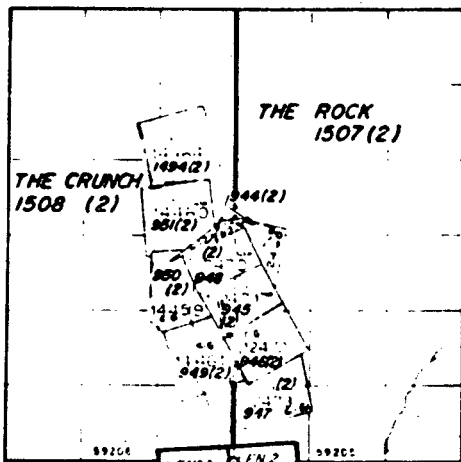

M82F/3E

AMCO #16 FR

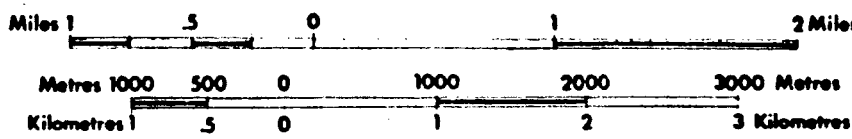

### LOCATION AND ACCESS

The Amco #16 claim is located south of Sheep Creek, south of Salmo in southeastern British Columbia. The claim can be reached by four-wheel drive on the Sheep Creek road, 6 km southeast of Salmo. The road can be followed for 10 km to the Yellowstone adits, at which point a road branches off to the south. This branch is followed for 1 km and it intersects the claim.

### GENERAL SETTING

The Amco #16 Fr is situated in the Selkirk Mountain Range, rising southward from Sheep Creek to Mount Waldie. The elevation is approximately 2,800' above sea level.

The terrain is moderate to steep with coniferous forest cover and some underbrush.

The rock formations covering the property are of the Laib group (which includes limestones and argillite) and the Reno Formation (which includes argillite, argillaceous quartzite and dark quartzite).

PROPERTY INFORMATION

The claim is owned by Robin W. Pearson of 280 Baker Street,  
Nelson, B.C.

<u>Claim Name</u>	<u>Lot #</u>	<u>Record #</u>
Amco #16 Fr	15643	1781 (6)

WORK SUMMARY

In June of 1981, the author and an assistant traversed the Amco #16 Fr. We geologically mapped and prospected the claim. The rock types observed were limestone with some dolomite conglomerate near the road and some biotite schist on the eastern portion of the claim. No showings were observed on the claim. The rock formations generally strike northeast (see map in envelope).

INTERPRETATIONS AND RECOMMENDATIONS

Although we noticed no mineralization on the Amco #16 Fr claim, we recommend further development work in conjunction with our other claims in the area. Further geological mapping along the limestone dolomite contact and near the biotite schist and a soil sampling programme are suggested.

SELKIRK



COLLEGE

CASTLEGAR, B. C., CANADA

COMMUNITY EDUCATION SERVICES

THIS IS TO CERTIFY THAT

DAN GALLAGHER

HAS PARTICIPATED IN

"MINERAL EXPLORATION FOR PROSPECTORS"

120 Hour Course

Sponsored by: Ministry of Energy, Mines & Petroleum  
Resources, & Ministry of Education, Science & Technology

April 29 - May 12, 1979

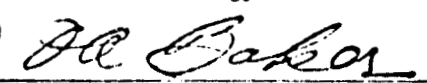

  
INSTRUCTOR / PROGRAM COORDINATOR

  
DIRECTOR OF COMMUNITY EDUCATION SERVICES



AUTHOR'S QUALIFICATIONS

I, Daniel J. Gallagher, have completed the "Mineral Exploration for Prospectors" course offered by the Ministry of Energy, Mines & Petroleum Resources in April/May of 1979. I have been a prospector for the past ten years, have completed and passed the Rocks & Minerals Course given by George Addy, District Geologist for the Ministry of Energy, Mines & Petroleum in Nelson, B.C.

Signed:



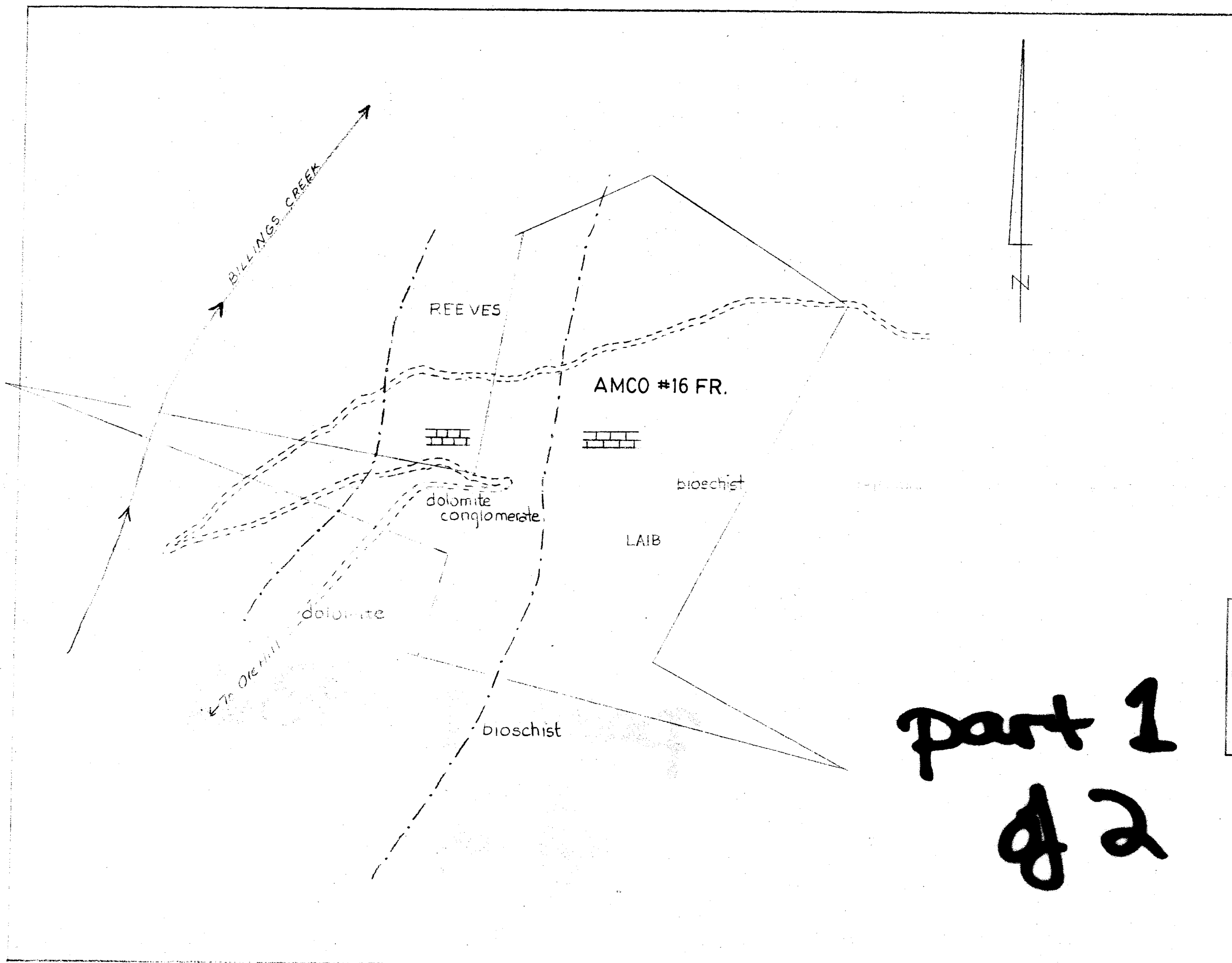

  
Daniel J. Gallagher

ITEMIZED COST STATEMENT

One prospector for one day - June 11, 1981 - @ \$200./day	\$200.00
One prospector for one day @ \$100./day	100.00
Office Work	<u>25.00</u>
TOTAL	<u><u>\$325.00</u></u>

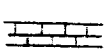

**LEGEND**

-  creek
-  road
-  claim boundary
-  geological contact
-  limestone

MINERAL RESOURCES BRANCH  
ASSESSMENT REPORT  
**9312**  
NO. \_\_\_\_\_

part 1  
of 2

PEARSON GALLAGHER LTD  
PROSPECTING MAP  
of the  
AMCO # 16 FR. CLAIM  
scale 1:3600  
date June, 1981