

81-#561  
9315

REPORT ON GEOCHEMICAL ROCK CHIP SAMPLING

ON

DIADEM MINERAL CLAIM

Vancouver M. D.

Owned by: James R. Glass

Lat.  $54^{\circ} 00'N$

Long.  $124^{\circ} 00'W$

NTS 92F/16E and 92K/1E

for

FURY EXPLORATIONS LTD. (N.P.L.)

By: James R. Glass, P. Eng.

July 5, 1981.

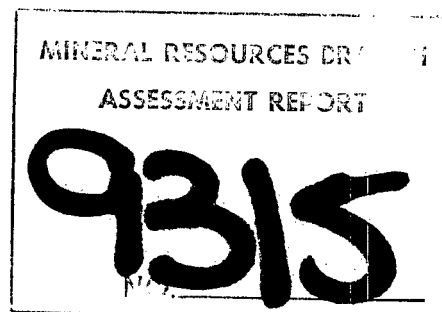

TABLE OF CONTENTS

	<u>Page</u>
SUMMARY . . . . .	1
PROPERTY . . . . .	1
GENERAL GEOLOGY . . . . .	2
HISTORY . . . . .	3
PRESENT PROGRAM . . . . .	4
RESULTS . . . . .	5
GENERAL STATEMENT . . . . .	5
STATEMENT OF COSTS . . . . .	6

MAP      Scale 1" = 70 M (approx.)

GEOCHEMICAL LAB REPORT

# BRITISH COLUMBIA

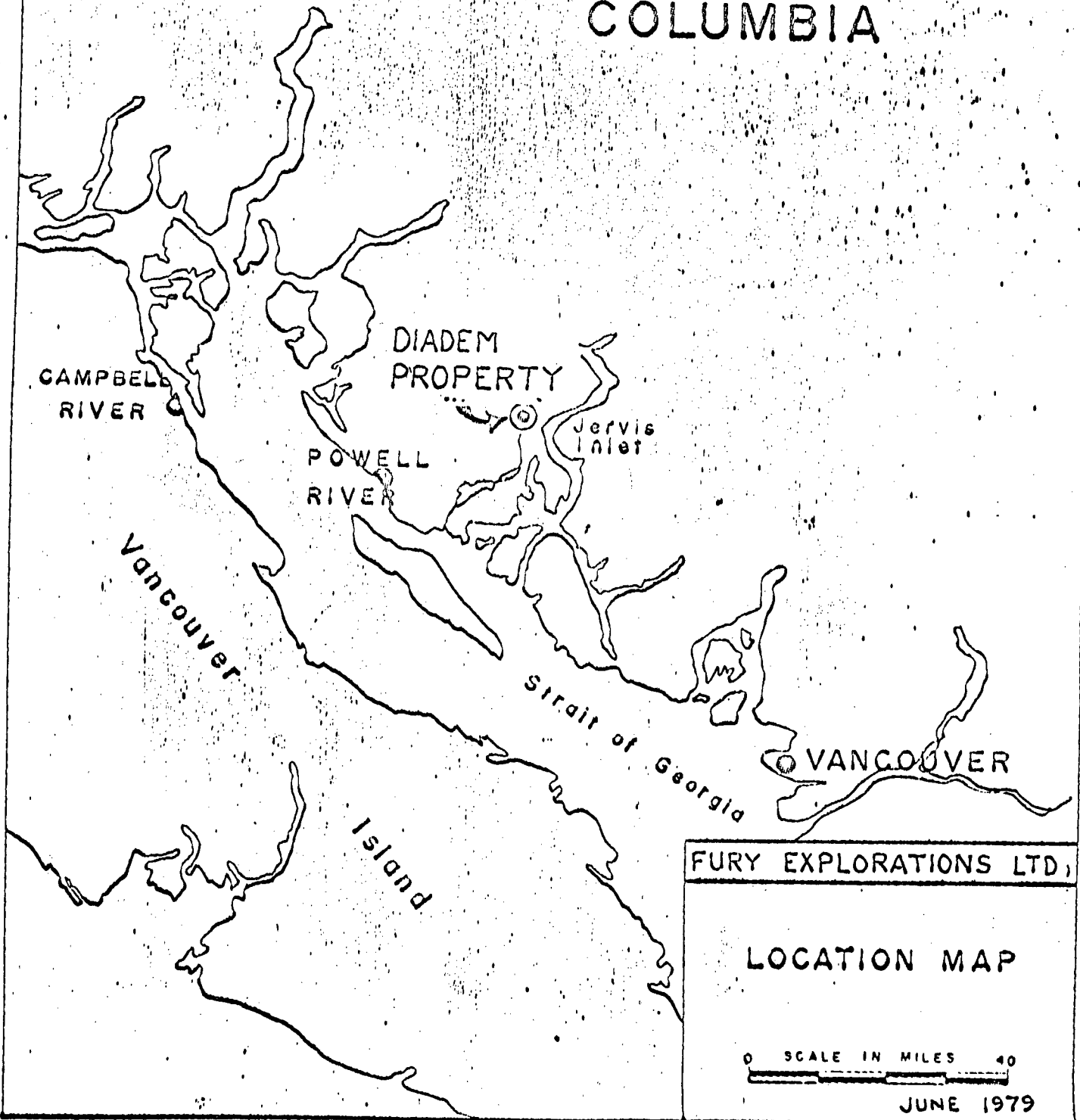



#### SUMMARY

Fury Explorations Ltd. carried out a reconnaissance rock chip geo-chemical survey over the southern portion of the Diadem claim during the month of May, 1981.

During this program a new access road was investigated. The work was carried out by Amadeus Consultants Ltd., under the direction of the writer.

#### PROPERTY

The Diadem mineral claim, consisting of nine units, was staked June 3, 1979 and is located on Lois River, near Mt. Diadem, west of Jervis Inlet in the Vancouver Mining Division at  $50^{\circ} 00'$  N. Lat. and  $124^{\circ} 05'$  W. Long. The claim is registered in the name of James R. Glass with Record Number 453. It is plotted on NTS Maps 92 K 1 E and 92 F 16 E.

GENERAL GEOLOGY

The area surrounding the Claim is underlain by a series of steeply dipping volcanic and sedimentary rocks which have been intruded by and partially engulfed by part of the Coast Range Batholith. The age of the volcanic rocks and sediments is unknown, the intrusive rocks are Jurassic or later in age.

The sedimentary rocks which host the gold, silver, copper, zinc showings have a vertical thickness of 3900 feet on the Claim area. They consist of fine grained quartzites and shaley argillites intercolated with quartzite and greenstone flows of basaltic and andesitic composition. The rocks are very well banded with the argillite exhibiting the low grade or "green schist" type of metamorphism.

Mineral occurrences have been found on the Diadem Claim at the 2700' elevation and the 3700' elevation in the vicinity of Lois Creek. The intervening ground is largely masked by overburden and forest growth. The sulphide showings are localized and associated with shear zones and folds. They are mainly massive sphalerite and pyrrhotite with lesser amounts of chalcopyrite, magnetite and pyrite. The surrounding sediments contain disseminated pyrite and some pyrrhotite and exhibit a fairly prominent gossan.

The upper showing has returned high grade assays over widths of 17 feet and is associated with two parallel faults 300 feet apart.

HISTORY

The property was mentioned in the B. C. Minister of Mines Annual Report for 1928 when Brittain River Mining Company was working the claim. Since that time a number of other companies have examined the showings. During 1967 and again in 1970, 1971 geochemical, geophysical and geological surveys were carried out and some small diameter diamond drilling was done. Assessment Reports Nos. 3329 and 2621 were filed. The Engineers in charge of this work recommended that more work be done but nothing more was recorded.

A detailed geophysical and geochemical survey was carried out on the northern part of the property in 1979 under the direction of the writer. At that time no safe helicopter landing was found on the southern part of the property containing the "lower showing" but it was noted that a logging road had recently been constructed to within two miles of the southern end.

The 1979 program demonstrated that silver mineralization exists in the sediments over a zone much wider than had been previously recognized in the old 1971 drilling.

PRESENT PROGRAM

The present program was designed (a) to measure the silver - gold content of the rocks underlying the southern part of the property near the "lower showing"; (b) to decide on an access road for future exploration.

When on the property at the start of the survey it was realized that straight lines for a geochemical survey would not be practical because of the difficulty of the terrain. The 55 samples were therefore taken along two rough lines from outcrops and from talus when no outcrop was available at selected locations generally 30 metres apart which were plotted on existing maps. The rock chip samples were sent to Bondar Clegg & Company Ltd. of North Vancouver where they were analyzed for Ag. and Au. The results of this sampling are plotted on a map of scale 1" = 70 M (approx.) is included with this report.



RESULTS

The background for silver is 0.2 ppm, threshold is 0.6 ppm and the three small anomalies peak at 4.3 ppm, 2.6 ppm and 42.0 ppm. The 42.0 ppm was taken over 4' of sulphide material from an old working. All of these anomalies are along strike to the south of the area of the "lower showing" and indicate that this general area requires more detailed work in an effort to locate economic mineralization.

The gold content of the rocks is extremely low and is not detected in most samples. A few isolated samples have values ranging from 5 ppb to 70 ppb. The sample taken across 4' at the old working returned 2500 ppb.

GENERAL STATEMENT

Access to these claims in the past has been by helicopter. On this occasion the writer walked to the claims from the existing logging roads which now have been extended to within two miles of the southern boundary.

A road along Lois Creek could be constructed at a nominal cost without encountering terrain problems. This would facilitate future exploration.

STATEMENT OF COSTS

Truck -	3 dys. @ \$30 p/d	\$ 90.00 -
Assaying -	Bondar Clegg & Company Ltd.	522.50 -
Travel -		32.00 -
Living Expenses -	2 dys. @ \$20/man/day	80.00 -
Wages -	James R. Glass, P. Eng. 1 dy. @ \$100 p/d	100.00 -
	2 dys @ \$200 p/d	400.00 -
	Richard Glass 2 dys.	---
		<u>\$1,224.00</u>

Personnel

James R. Glass, P. Eng.  
433 - 355 Burrard Street,  
Vancouver, B. C.  
V6C 2G8

May 19th - May 22nd, 1981

Richard Glass  
5742 Willow Street,  
Powell River, B. C.

May 20th - May 21st, 1981

Respectfully submitted,

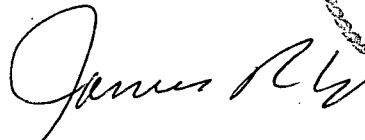
  
James R. Glass, P. Eng.

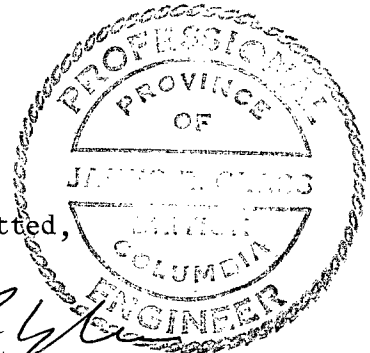

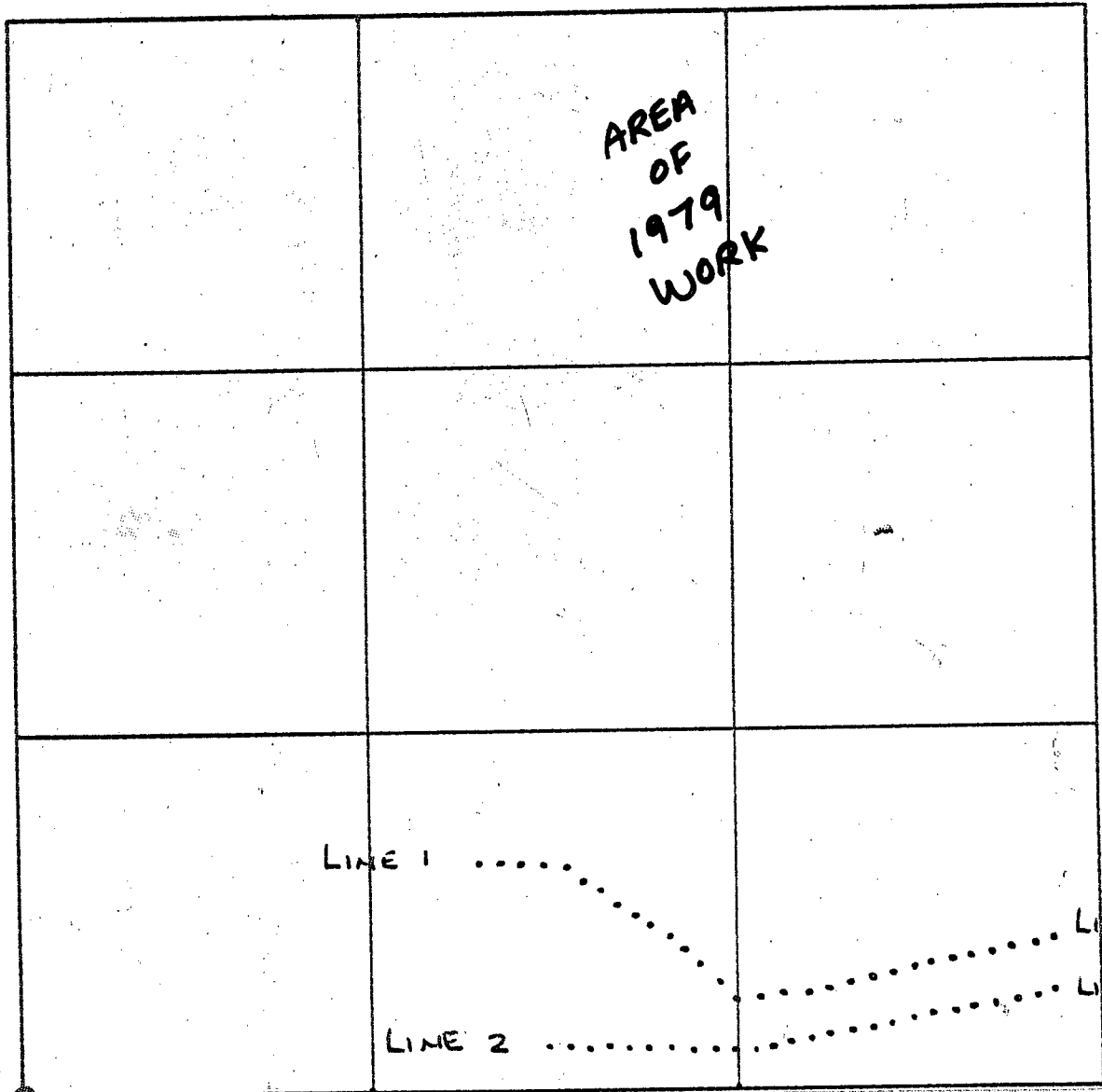

I.P.

# DIADEM CLAIM

MAP SHOWING  
LINE LOCATION  
ROCK CHIP GEO-CHEM  
Scale 1" = 250 M

JULY 1981

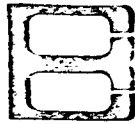

# BONDAR-CLEGG & COMPANY LTD.

130 PEMBERTON AVE., NORTH VANCOUVER, B.C. V7P 2R5 PHONE: (604) 985-0221 TELEX: 04-352667

## Geochemical Lab Report

# 9315

REPORT: 121-0852

PAGE

SAMPLE IDENTIFIERS	ELEMENT UNITS	Ag PPM	Au PPB	NOTES	SAMPLE IDENTIFIERS	ELEMENT UNITS	Ag PPM	Au PPB	NOTES
I-S01	SEDIMENT	0.3	5	OUTCROP	L2-S01	SEDIMENT	0.6	5	OUTCROP
I-S02	"	0.2	10	"	L2-S02	"	0.2	ND	"
I-S03	"	0.2	ND	"	L2-S03	"	4.3	ND	TALUS
I-S04	"	0.2	ND	"	L2-S04	"	0.5	ND	TALUS
I-S05	"	0.2	ND	"	L2-S05	"	0.4	ND	TALUS
I-S06	"	0.3	ND	"	L2-S06	"	0.2	ND	OUTCROP
I-S07	"	0.2	ND	"	L2-S07	"	0.2	ND	"
I-S08	"	0.2	ND	"	L2-S08	"	0.3	ND	"
I-S09	"	0.2	ND	"	L2-S09	"	0.4	ND	"
I-S10	"	0.2	ND	"	L2-S10	"	2.6	10	"
I-S11	"	0.2	ND	"	L2-S11	"	0.2	ND	TALUS
I-S12	"	0.2	ND	"	L2-S12	"	0.2	ND	"
I-S13	"	0.2	ND	"	L2-S13	"	0.2	ND	"
I-S14	"	0.2	ND	"	L2-S14	"	0.2	ND	OUTCROP
I-S15	SULPHIDE ZONE	42.0	2500	OLD WORKING	L2-S15	"	0.2	ND	OUTCROP
I-S16	SEDIMENT	0.2	5	OUTCROP	L2-S16	"	1.7	ND	TALUS
I-S17	DIORITE	0.3	15	"	L2-S17	"	0.2	ND	"
I-S18	"	0.2	ND	"	L2-S18	"	1.1	20	"
I-S19	"	0.2	5	"	L2-S19	"	0.2	ND	"
I-S20	"	0.2	ND	"	L2-S20	"	0.5	70	"
I-S21	SEDIMENT	1.2	15	"	L2-S21	"	0.2	ND	"
I-S22	"	1.3	10	"	L2-S22	"	0.2	10	"
I-S23	"	1.4	5	"	L2-S23	"	0.2	ND	"
I-S24	"	0.2	ND	TALUS	L2-S24	"	0.2	ND	"
I-S25	"	0.6	ND	TALUS	L2-S25	"	0.2	ND	"
I-S26	"	1.2	5	OUTCROP	L2-S26	"	0.3	ND	"
I-S27	"	0.7	15	"					
I-S28	"	0.6	ND	"					
I-S29	"	0.4	ND	"					
I-S30	"	0.4	ND	"					

RECEIVED  
JUL 11 1981

RECEIVED

RECEIVED

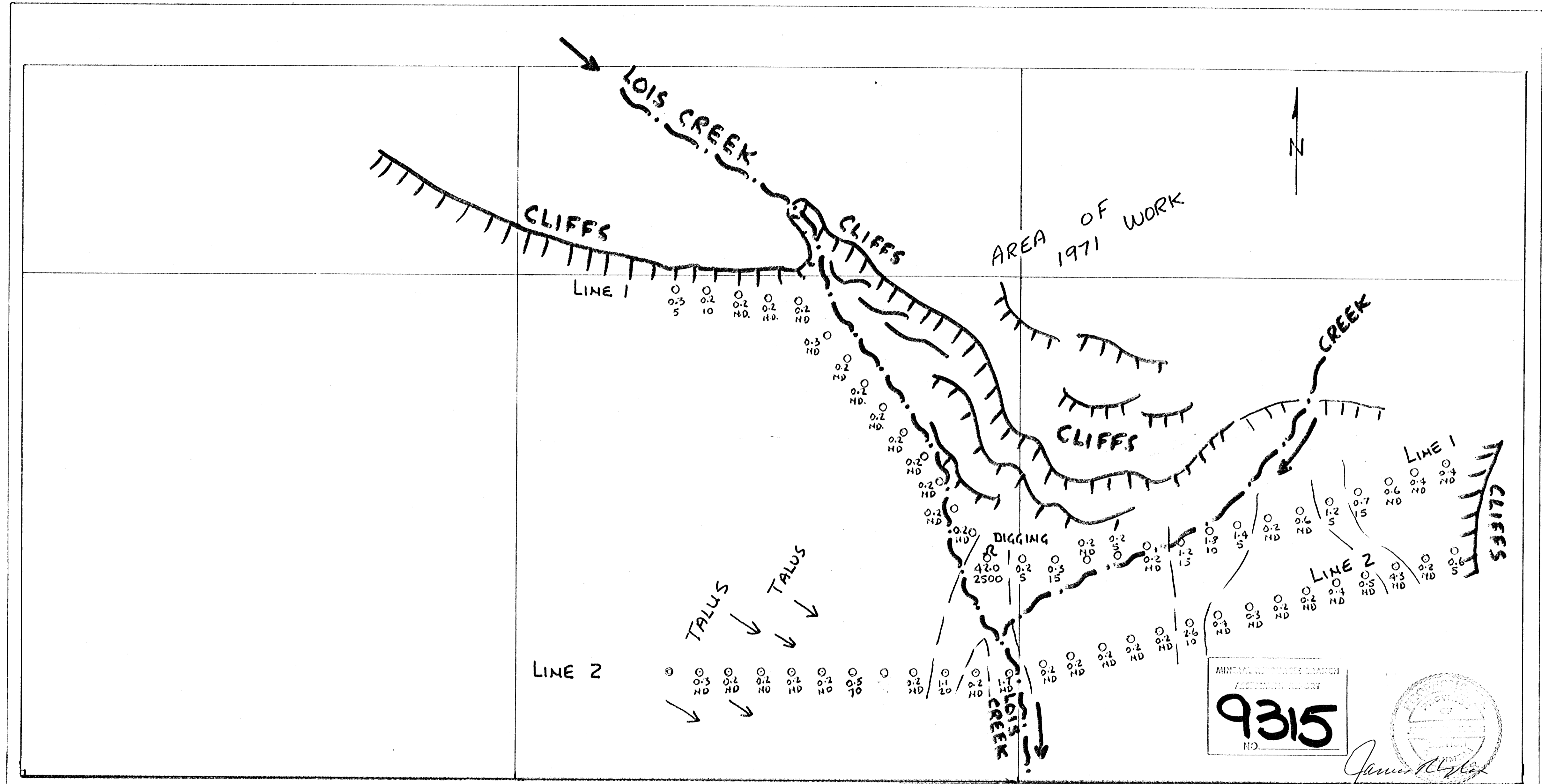

L.P.

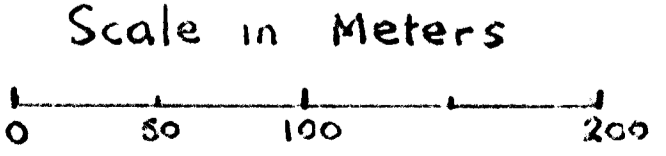

LEGEND  
 O 0.2 Ag in ppm.  
 S 5 Au in ppb.

MINERAL RESOURCES BRANCH  
 AGGREGATE REPORT  
**9315**  
 NO.

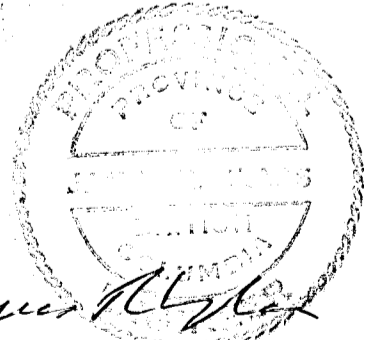

*James [Signature]*

FURY EXPLORATIONS LTD.  
 DIADEM CLAIM  
 ROCK CHIP SAMPLING

July 1981