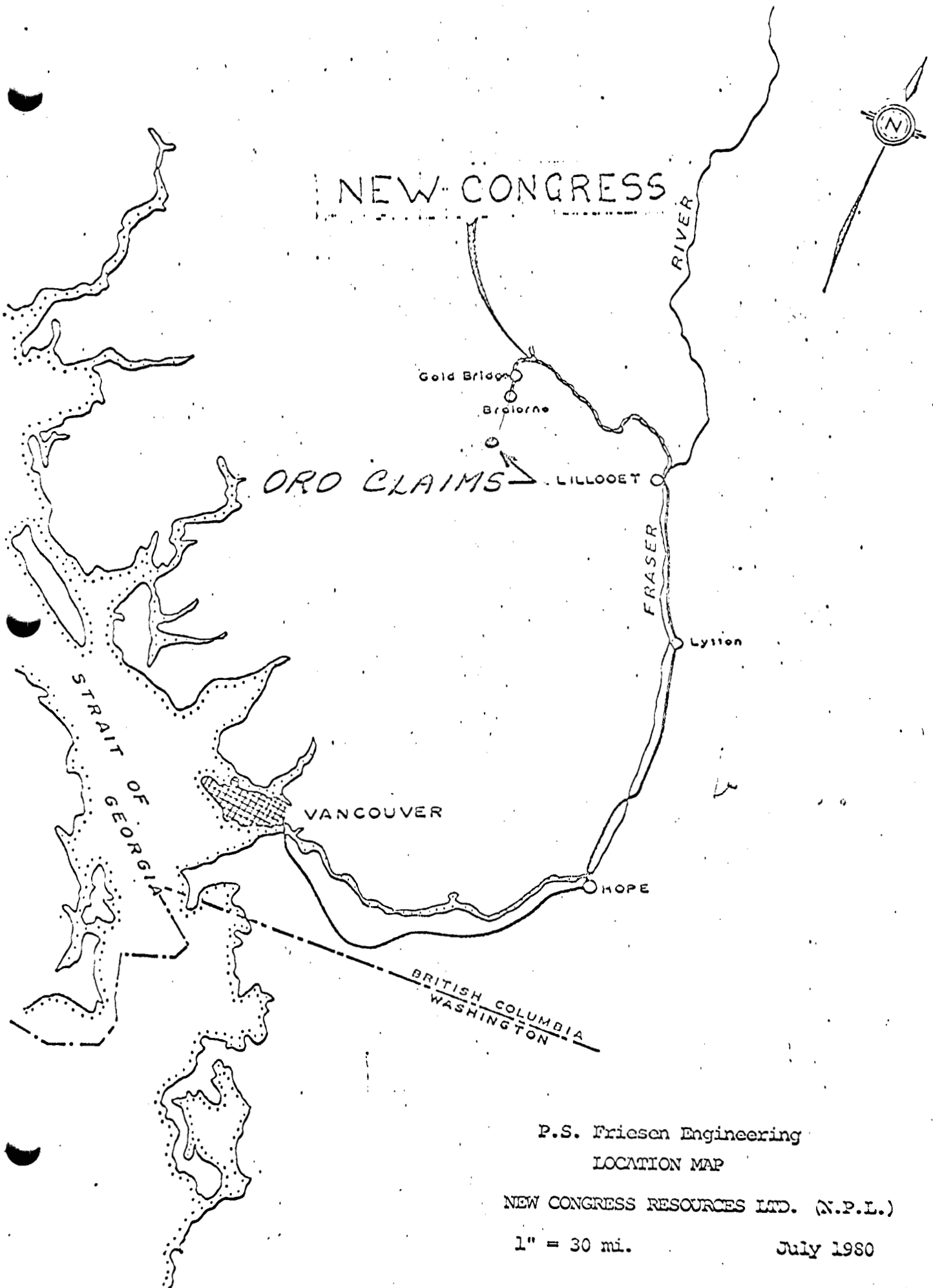

TABLE OF CONTENTS

- 1) General Location Map
- 2) Map showing location of claims.
- 3) Report - Reconnaissance Geochemical Survey of the ORO Group of Claims. Bridge River area, B.C. 92-J-15-W. by P.S. Friesen.
- 4) Certificate of Qualification.
- 5) In appendix - Analytical Procedure used to geochemically analyse soils for gold in parts per million.
- 6) Certificate of Assay.
- 7) Cost Statement.
- 8) Statement of assay costs.
- 9) Contract for soil sampling.
- 10) Receipt for payment of contractor.

9375



P.S. Friesen Engineering  
LOCATION MAP

NEW CONGRESS RESOURCES LTD. (N.P.L.)

1" = 30 mi.

July 1980

GEOCHEMISTRY

General

The results of the 1979 soil sampling program indicated the presence of two or more gold-bearing veins bearing north 70 degrees west. Near one of these anomalies, trenches had exposed a very narrow vein of massive stibnite, five to twenty centimeters in width. Near another anomaly, fragments of massive stibnite were found but these appeared to have been recently transported. Because of the mineralized vein as indicated by the geochemical anomalies and one exposed vein, it was decided to check the area with one north-south line extending 320 meters north from the south boundary of the property, and four short north-south lines across the anomalous area.

Survey Data

A north-south line, using the 1979 baseline, was established by chain and compass extending from the south boundary of ORO No. 3. Stations were established at 10 meter intervals using flagging tape for markers. The length of the line is 2.16 kilometers. However it became necessary to shift the baseline .66 kilometers east at the north boundary of ORO No. 1 in order to remain on the property.

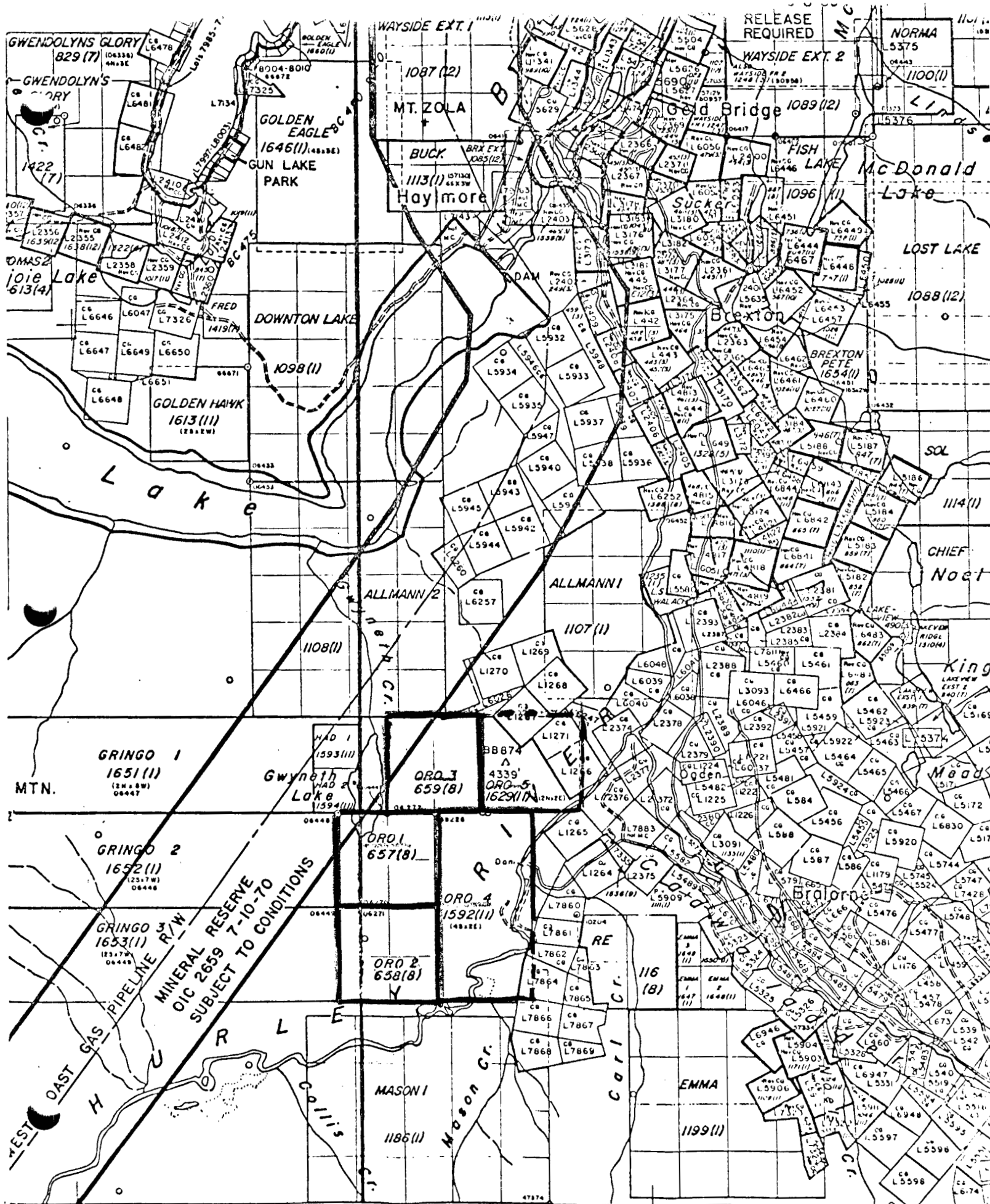

TO SOUTH SEE MAP 92J/10W  
**MINERAL TITLES REFERENCE MAP 92J/15W**

nted  
 G. Mineral Claim

NEW CONGRESS RESOURCES LTD.

RECONNAISSANCE GEOCHEMICAL SURVEY OF THE  
SFO GROUP OF CLAIMS  
OFIDGE RIVER AREA, B.C.

92-J-15-W

50° 47'

122° 52'

Lillooet N.D.

by  
P.C. Friesen P. Eng.  
July 1981

## TABLE OF CONTENTS

	page
<u>INTRODUCTION</u>	
General	1
Property, Location and means of Access	1
Previous Work	2
Acknowledgements	2
<u>GEOGRAPHY</u>	
General	3
Water	3
Timber	3
<u>GEOCHEMISTRY</u>	
General	4
Survey Data	4
Sampling Procedure	5
Analyst	5
Analytical Procedure	5
Survey Results	5
Conclusion and Recommendation	5
<u>APPENDIX</u>	
I - Analytical Procedure used by Analyst.	
II- Assay certificates	
<u>IN POCKET</u>	
Plan showing results of the Geochemical Survey.	

NEW CONGRESS RESOURCES LTD.

RECONNAISSANCE GEOCHEMICAL SURVEY OF THE  
ORO GROUP OF CLAIMS  
BRIDGE RIVER AREA, B.C.

92-J-15-W

by  
P.S. Friesen P. Eng.  
July 1981

INTRODUCTION

General

The 1979 soil sampling program results suggested that the mineralized veins in the Gwenyth Lake area trended North 70 degrees west. In order to obtain further information with the possibility of finding other parallel veins, a reconnaissance survey was undertaken. It was limited to one north-south line.

Property Location & Means of Access

The ORO Group of claims consist of 5 claims numbered from 1 to 5 and comprise 24 units. They are located about 9 kilometers south of Goldbridge, B.C. in topographic subdivision 92-J-15-W and are accessible from Goldbridge by a fairly good dirt road. The group of claims is wholly owned by New Congress Resources Ltd. (N.P.L.)

Previous Work

C E Cairnes (1937) in Memoir 214 (page 93) of the Geological Survey of Canada, states that the area was explored by the Golden Mitt Mining Company Limited ( name changed from Bridge River Pacific Mines in 1934). A shallow shaft, short adit and surface trenches had been made on one or more quartz veins.

Acknowledgements

Cairnes C E (1937) - Memoir 213, Pg 93  
Annual Report, Minister of Mines B.C., 1933 Pg 274-275  
Friesen P.S. - 1980 - Report on the 1979 Geochemical  
Survey of the ORO Group.



GEOGRAPHY

General

The ORO Group covers a bench and except for the eastern part of the property has relatively gentle slopes. The east side of the property parallels the Hurley River, the west bank of which is extremely steep.

Water

Gwenyth Lake extends into the north part of ORO No. 1. This would be the only readily accessible water for any drilling or underground exploration.

Timber

The area covering ORO No. 5, 1 and 3 is now being actively logged for commercial timber. This should provide access roads to a large part of the claimed area.

Four additional lines 0.32 kilometers long were established 100 meters and 200 meters on both to the east and west of the baseline. These lines extend northward from the south boundary of ORO No. 2. A total of 4.10 kilometers of lines were established.

#### Sampling Procedure

Soil samples were taken at the stations using a shovel. The sample was taken from a rusty layer immediately below a layer of volcanic ash that blankets the area. Above a teacupful of soil was taken at each of 400 sites and placed in special bags.

#### Analyst

All soil samples were submitted to General Testing Laboratories, 1001 East Pender Street, Vancouver, B.C. V6A 1W2. The samples were analysed geochemically for gold only.

#### Analytical Procedure

A brief description of the analytical procedure was provided by the analysts and is appended.

#### Survey Results

No conspicuous anomalies were obtained from the reconnaissance soil geochemical survey. Only two samples contained 0.03 parts per million of gold which are doubtfully anomalous.

In the course of traversing the property an irregular quartz vein trending in a northerly direction was found along the eastern boundary of ORO No. 1. Farther to the north-east, an old shaft, now filled with water was located. These occurrences indicate that the survey lines should be established in an east-west direction over this part of the property.

Conclusion & Recommendation

The soil geochemical survey has not been detailed enough to give an indication of the potential of the claim group. A more detailed survey should be carried out. However, an airborne magnetic and electromagnetic survey would be beneficial in determining geochemical target areas.

Respectfully submitted,



P.S. Friesen, p. Eng.

CERTIFICATE OF QUALIFICATION

With regard to report on the Reconnaissance  
Geochemical Survey of the CNO Group of  
mineral claims.

July 5, 1981

I, Peter S. Friesen of Sardis B.C. hereby certify as  
follows:

I am a geological engineer residing at 6780 Sumas Prairie  
Rd., R.R. #1 Sardis, B.C. V0X 1Y0

I am a registered Professional Engineer in British  
Columbia.

I graduated from the University of Saskatchewan in 1950.

I have practiced my profession except for one year spent  
in teaching since 1950.

I have no interest directly or indirectly in the properties  
or Capital stock of New Congress Resources Ltd. (N.P.L.)  
nor do I expect to receive any.

The above information is based upon available data in the  
company files and personal examination of the property  
at various times during 1981.

That this report may be used in a Statement of Material  
Facts or similar document but may not be abbreviated or  
excerpted without my consent.

  
\_\_\_\_\_  
P.S. Friesen, p. Eng.

To Mr. Peter Friesen,

Re - method of analysis for geochemical gold determinations: 10-15 gm sample, concentration by fire assay, gold-silver dore dissolved in aqua-regia, atomic absorption finish.

L. WONG



TO:  
**NEW CONGRESS RESOURCES LTD.**

(Continued) .... page 4 ....

**CERTIFICATE OF ASSAY**

No.: 8010-2350      DATE: Nov. 26/80

We hereby certify that the following are the results of assays on:      Soil samples

MARKED	GOLD	SILVER	XXXX	SAMPLE MARKED:	GOLD	XXX	SAMPLE MARKED:	GOLD
	Au (ppm)				Au (ppm)			Au (ppm)
<u>200E +</u>				<u>100W +</u>			<u>200W +</u>	
110N	0.01			110N	0.02		160N	0.02
120N	0.05			130N	0.01		170N	0.02
130N	0.01			140N	0.02		180N	0.01
140N	0.02			150N	0.01		190N	0.03
150N	0.02			160N	0.03		200N	0.02
160N	0.03			170N	0.03		210N	0.01
170N	0.03			180N	0.03		220N	0.01
180N	0.02			190N	0.03		230N	0.01
190N	0.02			200N	0.03		240N	0.01
200N	0.03			260N	0.01		250N	0.02
210N	0.02			270N	0.01		260N	0.02
220N	0.01			280N	0.03		270N	0.02
230N	0.03			290N	0.03		280N	0.02
240N	0.03			300N	0.02		290N	0.02
250N	0.04			310N	0.03		300N	0.02
260N	0.03			320N	0.02		310N	0.02
270N	0.03						320N	0.01
280N	0.03			<u>200W +</u>			FINAL	
290N	0.03			00	0.01		A63305 &	0.02
300N	0.04			10N	0.02		102033	
310N	0.02			20N	0.03			
320N	0.01			30N	0.02			
<u>100W +</u>				40N	0.01			
0	0.02			50N	0.04			
10N	0.03			60N	0.02			
20N	0.02			70N	0.02			
30N	0.02			80N	0.02			
40N	0.02			90N	0.02			
50N	0.04			100N	0.02			
60N	0.04			110N	0.02			
70N	0.02			120N	0.02			
80N	0.01			130N	0.01			
90N	0.01			140N	0.01			
100N	0.01			150N	0.02			

NOTE: REJECTS RETAINED ONE MONTH. PULPS RETAINED THREE MONTHS ON REQUEST PULPS AND REJECTS WILL BE STORE FOR A MAXIMUM OF ONE YEAR.

ALL REPORTS ARE THE CONFIDENTIAL PROPERTY OF CLIENTS. PUBLICATION OF STATEMENTS, CONCLUSION OR EXTRACTS FROM OR REGARDING OUR REPORTS IS NOT PERMITTED WITHOUT OUR WRITTEN APPROVAL. ANY LIABILITY ATTACHED THERETO IS LIMITED TO THE FEE CHARGED.

*R. Nadeau*  
 R. Nadeau, Chemist

Analytical and Consulting Chemists, Bulk Cargo Specialists, Surveyors, Inspectors, Samplers, Weighers

MEMBER: American Society For Testing Materials • The American Oil Chemists Society • Canadian Testing Association  
 REFEREE AND OR OFFICIAL CHEMISTS FOR: National Institute of Oilseed Products • The American Oil Chemists' Society  
 OFFICIAL WEIGHMASTERS FOR: Vancouver Board Of Trade



TO: NEW CONGRESS RESOURCES LTD.  
804 - 750 West Pender Street  
Vancouver, B.C.

SGS Analytical Laboratory  
A Division of SGS Supervision Services Inc.  
1001 EAST PENDER ST., VANCOUVER, B.C., CANADA, V6A 1W2  
PHONE (604) 254-1647 TELEX 04-507514 CABLE: SUPERVISE

CERTIFICATE OF ASSAY

No.: 8010-2350 DATE: Nov. 26/80

We hereby certify that the following are the results of assays on: Soil samples

MARKED	GOLD	SILVER	XXXX	SAMPLE MARKED:	GOLD	XXXX	SAMPLE MARKED:	GOLD
	Au(ppm)				Au(ppm)			Au (ppm)
<u>BL</u>				<u>BL</u>			<u>BL</u>	
0+0	0.01			0+380N	0.03		0+740N	0.01
0+10	0.01			0+390N	0.01		0+750N	0.01
0+20	0.01			0+400N	0.02		0+760N	0.02
0+30	0.02			0+410N	0.02		0+770N	0.01
0+40	0.02			0+420N	0.03		0+780N	0.01
0+50	0.02			0+430N	0.01		0+790N	0.01
0+60	0.01			0+440N	0.01		0+800N	0.01
0+70	0.01			0+450N	0.02		0+810N	0.01
0+80	0.01			0+460N	0.01		0+820N	0.02
0+90	0.02			0+470N	0.02		0+830N	0.02
0+100	0.02			0+480N	0.02		0+840N	0.02
0+110N	0.02			0+490N	0.03		0+850N	0.02
0+120N	0.02			0+500N	0.02		0+860N	0.02
0+130N	0.05			0+510N	0.03		0+870N	0.02
0+140N	0.04			0+520N	0.01		0+880N	0.02
0+150N	0.02			0+530N	0.02		0+890N	0.02
0+160N	0.02			0+540N	0.02		0+900N	0.02
0+170N	0.02			0+550N	0.04		0+910N	0.03
0+180N	0.02			0+560N	0.02		0+920N	0.01
0+190N	0.02			0+570N	0.02		0+930N	0.01
0+200N	0.02			0+580N	0.02		0+940N	0.02
0+210N	0.02			0+590N	0.02		0+950N	0.02
0+220N	0.02			0+600N	0.02		0+960N	0.02
0+230N	0.02			0+610N	0.03		0+970N	0.02
0+240N	0.02			0+620N	0.03		0+980N	0.02
0+250N	0.02			0+630N	0.01		0+990N	0.03
0+260N	0.02			0+640N	0.01		0+1000N	0.02
0+270N	0.02			0+650N	0.02		0+1010N	0.02
0+280N	0.02			0+660N	0.02		0+1020N	0.01
0+290N	0.03			0+670N	0.02		0+1030N	0.01
0+300N	0.03			0+680N	0.02		0+1040N	0.02
0+310N	0.02			0+690N	0.03		0+1050N	0.02
0+320N	0.02			0+700N	0.03		0+1060N	0.03
0+330N	0.02			0+710N	0.02		0+1070N	0.03
0+340N	0.03			0+720N	0.02			
0+350N	0.02			0+730N	0.01			
0+360N	0.03							
0+370N	0.02							

/ Continued on page 2 ....

*[Signature]*  
V. Lawson, Chemist

NOTE: REJECTS RETAINED ONE MONTH PULPS RETAINED THREE MONTHS ON REQUEST PULPS AND REJECTS WILL BE STORED FOR A MAXIMUM OF ONE YEAR  
ALL REPORTS ARE THE CONFIDENTIAL PROPERTY OF CLIENTS. PUBLICATION OF STATEMENTS, CONCLUSIONS OR EXTRACTS FROM OUR REPORTS IS NOT PERMITTED WITHOUT OUR WRITTEN APPROVAL. ANY LIABILITY ATTACHED THERE TO IS LIMITED TO THE FEE CHARGED.



TO:  
 NEW CONGRESS RESOURCES LTD.  
 (Continued) ... page 3 ....

A Division of SGS Supervision Services Ltd.  
 1001 EAST PENDER ST., VANCOUVER, B.C., CANADA, V6A 1V7  
 PHONE (604) 254-1647 TELEX 04-507514 CABLE: SUPERVIS

CERTIFICATE OF ASSAY

No.: 8010-2350 DATE: Nov. 26/80

We hereby certify that the following are the results of assays on: Soil samples

MARKED	GOLD	SILVER	COPPER	SAMPLE MARKED:	GOLD	SILVER	SAMPLE MARKED:	GOLD
	Au (ppm)				Au (ppm)			Au (ppm)
<u>BL 1200N +</u>				<u>BL 1200N +</u>			<u>100E +</u>	
10E	0.01			450E	0.02		110N	0.02
20E	0.01			460E	0.02		120N	0.02
30E	0.02			470E	0.02		130N	0.02
120E	0.01			480E	0.02		140N	0.03
130E	0.03			490E	0.02		150N	0.03
140E	0.01			500E	0.02		160N	0.02
150E	0.01			510E	0.01		170N	0.02
160E	0.01			510E (A)	0.03		180N	0.02
170E	0.01			520E	0.02		190N	0.01
180E	0.01			540E	0.01		200N	0.03
190E	0.01			550E	0.01		210N R.O.	0.03
200E	0.02			560E	0.01		220N	0.04
210E	0.03			570E	0.02		230N R.O.	0.02
220E	0.03			580E	0.02		240N R.O.	0.03
230E	0.02			590E	0.02		250N	0.02
240E	0.03			600E	0.02		260N	0.03
250E	0.03			610E	0.02		270N	0.02
260E	0.03			620E	0.01		280N	0.04
270E	0.02			630E	0.02		290N	0.03
280E	0.02			640E	0.03		300N	0.01
290E	0.03			660E	0.03		310N	0.01
300E	0.01						320N	0.01
300E	0.03			<u>100E +</u>				
310E	0.01			00N	0.02		<u>200E +</u>	
320E	0.03			10N	0.03		00	0.02
340E	0.03			20N	0.03		10N	0.03
350E	0.03			30N	0.02		20N	0.03
360E	0.03			40N	0.02		30N	0.02
370E	0.02			50N	0.02		40N	0.02
380E	0.02			60N	0.02		50N	0.03
390E	0.02			70N	0.02		60N	0.03
400E	0.03			80N	0.02		70N	0.03
410E	0.03			90N	0.02		80N	0.02
420E	0.03			100N	0.01		90N	0.04
430E	0.03						100N	0.02
440E	0.02							

NOTE: REJECTS RETAINED ONE MONTH. PULPS RETAINED THREE MONTHS. ON REQUEST PULPS AND REJECTS WILL BE STORE FOR A MAXIMUM OF ONE YEAR.  
 ALL REPORTS ARE THE CONFIDENTIAL PROPERTY OF CLIENTS. PUBLICATION OF STATEMENTS, CONCLUSION OR EXTRACTS FROM OR REGARDING OUR REPORTS IS NOT PERMITTED WITHOUT OUR WRITTEN APPROVAL. ANY LIABILITY ATTACHED THERETO IS LIMITED TO THE FEE CHARGED.

Continued on page 4  
 R. Nadeau, Chemist

Analytical and Consulting Chemists, Bulk Cargo Specialists, Surveyors, Inspectors, Samplers, Weighers

MEMBER: American Society For Testing Materials • The American Oil Chemists Society • Canadian Testing Association  
 REFEREE AND OR OFFICIAL CHEMISTS FOR: National Institute of Oilseed Products • The American Oil Chemists Society  
 OFFICIAL WEIGHMASTERS FOR: Vancouver Board of Trade





TO:  
**NEW CONGRESS RESOURCES LTD.**  
 (Continued) ... page 2 ....

**CERTIFICATE OF ASSAY**

No.: 8010-2350      DATE: Nov. 25/80

We hereby certify that the following are the results of assays on:      Soil samples

MARKED	GOLD	SILVER	xxx	SAMPLE MARKED:	GOLD	xxx	SAMPLE MARKED:	GOLD
	Au (ppm)			Au (ppm)	Au (ppm)		Au (ppm)	
<u>BL</u>				<u>BL</u>			<u>BL</u>	
0+1080N	0.02			0+1450N	0.01		0+1810N	0.03
0+1090N	0.01			0+1460N	0.03		0+1820N	0.01
0+1100N	0.01			0+1470N	0.03		0+1830N	0.01
0+1110N	0.02			0+1480N	0.02		0+1840N	0.01
0+1120N	0.02			0+1490N	0.02		0+1850N	0.02
0+1130N	0.03			0+1500N	0.03		0+1860N	0.01
0+1140N	0.03			0+1510N	0.03		0+1870N	0.03
0+1150N	0.02			0+1520N	0.04		0+1880N	0.03
0+1160N	0.02			0+1530N	0.02		0+1890N	0.03
0+1170N	0.03			0+1540N	0.02		0+1900N	0.03
0+1180N	0.02			0+1550N	0.02		0+1910N	0.03
0+1190N	0.02			0+1560N	0.02		0+1920N	0.02
0+1200N	0.02			0+1570N	0.02		0+1930N	0.02
0+1210N	0.02			0+1580N	0.02		0+1940N	0.02
0+1220N	0.02			0+1590N	0.03		0+1950N	0.02
0+1230N	0.02			0+1600N	0.01		0+1960N	0.01
0+1240N	0.01			0+1610N	0.03		0+1970N	0.02
0+1250N	0.03			0+1620N	0.02		0+1980N	0.02
0+1260N	0.02			0+1630N	0.03		0+1990N	0.03
0+1270N	0.02			0+1640N	0.02		0+2000N	0.01
0+1280N	0.02			0+1650N	0.02		0+2010N	0.01
0+1290N	0.03			0+1660N	0.02		0+2020N	0.03
0+1300N	0.03			0+1670N	0.01		0+2030N	0.02
0+1310N	0.03			0+1680N	0.01		0+2040N	0.01
0+1320N	0.02			0+1690N	0.01		0+2050N	0.01
0+1330N	0.02			0+1700N	0.01		0+2060N	0.02
0+1340N	0.02			0+1710N	0.02		0+2070N	0.02
0+1350N	0.02			0+1720N	0.02		0+2080N	0.02
0+1360N	0.02			0+1730N	0.01		0+2090N	0.02
0+1370N	0.02			0+1740N	0.02	2100	0+3000N	0.03
0+1380N	0.02			0+1750N	0.03	2120	0+3010N	0.01
0+1390N	0.02			0+1760N	0.03	2130	0+3020N	0.01
0+1400N	0.01			0+1770N	0.02		0+3030N	0.01
0+1410N	0.01			0+1780N	0.02	2150	0+3040N	0.01
0+1420N	0.02			0+1790N	0.03	2150	0+3050N	0.01
0+1430N	0.02			0+1800N	0.03	2150	0+3060N	0.01
0+1440N	0.02							

/ Continued on page 3 .....

NOTE: REJECTS RETAINED ONE MONTH. PULPS RETAINED THREE MONTHS. ON REQUEST PULPS AND REJECTS WILL BE STORED FOR A MAXIMUM OF ONE YEAR.

ALL REPORTS ARE THE CONFIDENTIAL PROPERTY OF CLIENTS. PUBLICATION OF STATEMENTS, CONCLUSIONS OR EXTRACTS FROM OUR REPORTS IS NOT PERMITTED WITHOUT OUR WRITTEN APPROVAL. ANY LIABILITY ATTACHED THERE TO IS LIMITED TO THE FEE CHARGED.

*[Signature]*  
 R. Gaudreau, Chemist

Analytical and Consulting Chemists, Bulk Cargo Specialists, Surveyors, Inspectors, Samplers, Weighers

MEMBER: American Society For Testing Materials • The American Oil Chemists Society • Canadian Testing Association  
 REFEREE AND/OR OFFICIAL CHEMISTS FOR: National Institute of Oilseed Products • The American Oil Chemists Society  
 OFFICIAL WEIGHMASTERS FOR: Vancouver Board of Trade

COST STATEMENT

Soil sampling as per contract	\$4,400.00
Analysis of soil samples	2,080.00
Supervision	2,000.00
Examination by R.L.Seraphim Engineering	300.00
Travel expenses - Friesen	700.00
Travel expenses - Seraphim	100.00
Drafting	84.00
H. Gebauer - assistant (one day)	100.00
Office overhead @ 10%	<u>976.40</u>
TOTAL	\$10,740.40



GENERAL TESTING LABORATORIES  
 A Division of SGS SUPPLY AND SERVICE CO. LTD.  
 formerly

General Testing Laboratories Division  
 Superintendence Company (Canada) Ltd.  
 1001 East Pender St.  
 Vancouver, B.C. V6A 1W2  
 Ph (604) 254-1647

INVOICE <b>V 46702</b>
DATE November 25, 1980
JOB NO.
LAB NO. 8010-2350

NO 076

TO: NEW CONGRESS RESOURCES  
 804 - 750 West Pender Street  
 Vancouver, B.C.

JO	JOB#	CM	G.L.	BR	RR

To: Submitted samples of soil for geochemical analysis;

401 Au	x	\$ 4.50	=	\$ 1,804.50
sample prep.	@	0.50	=	200.50
extra drying			=	75.00

\$ 2,080.00

*New Congress*

*309 Dec 3/80*

*Nov 1/80*

DUE AND PAYABLE ON RECEIPT OF INVOICE. 1½% PER MONTH (18%) PER ANNUM CHARGED ON OVERDUE ACCOUNTS.

## CONTRACT AGREEMENT

This agreement dated 10th October 1980, is between NEW CONGRESS RESOURCES LTD., (NPL) of 804-750 West Pender Street, Vancouver B. C., hereinafter called the "Company" and Mr. Tom Illidge, of Gold Bridge, B. C. hereinafter called the "Contractor".

- (1) The Contractor agrees to establish North-South lines as per sketch totalling approximately 4.320 kilometers as per attached sketch. These lines shall be clearly marked by flagging tape so that they can be easily followed.
- (2) The Contractor will establish stations at 10 meter intervals along these lines by using flagging tape on which shall be marked the distance in meters from the south end of the line.
- (3) The Contractor will assemble a crew who will take a soil sample from the "F" horizon which is below the layer of volcanic ash which blankets the area.
- (4) The soil samples will be placed in soil sample bags designed for this purpose.
- (5) Each sample bag shall clearly show the line and the station along that line where the contained sample was taken.
- (6) The Contractor will hold the Company blameless for any compensation, or other governmental action brought against himself or his crew.
- (7) The Contractor will record and advise the Company of such stations where a sample could not be taken and the reason therefor by using the following symbols; SW for swamp, RO for rock outcrop and BR for bedrock where the lava ash lies directly over bedrock.
- (8) This Contract will start and be brought to completion as quickly as possible.
- (9) The Contractor will provide all tools or equipment as well as all transportation required by his crew.

(10) For this the Company agrees to pay to the Contractor a sum equal to the number of samples taken times eleven dollars.  
(No. of samples x \$11.00)

Dated This 31 day of October, 1980.

Signed;

*T. Illidge*  
T. Illidge, Contractor

*P.S. Friesen*  
P.S. Friesen, Exploration Manager,  
for New Congress Resources Ltd.,

*Edgar Munnitt*  
Witness

*Edgar Munnitt*  
Witness

