

~~81-# 765-9533~~  
81-# 765-9533

ASSESSMENT REPORT  
ON THE  
HANK I MINERAL CLAIM  
RECORD NO. 2831 (7)  
CHERRY CREEK AREA  
KAMLOOPS MINING DIVISION  
KAMLOOPS, BRITISH COLUMBIA

N. Lat. 50° 34'

W. Long. 120° 33'

92 - I - 10E

for

ANGLO WESTERN PETROLEUM LTD.  
Suite 511  
850 West Hastings Street  
Vancouver, British Columbia

by

DONALD W. TULLY, P. ENG.

September 16, 1981

West Vancouver, B.C.

TABLE OF CONTENTS

	<u>Page</u>
INTRODUCTION.....	1
SUMMARY AND CONCLUSIONS.....	1
PROPERTY - LOCATION, ACCESS, PHYSIOGRAPHY AND ENVIRONMENTAL CONSIDERATIONS.....	2
CLAIM.....	3
HISTORY - PREVIOUS DEVELOPMENT.....	3
REFERENCES.....	3
REGIONAL AND LOCAL GEOLOGICAL SETTING.....	4
MINERALIZATION.....	5
RESULTS OF THE 1981 VLF ELECTROMAGNETIC GEOPHYSICAL SURVEY.....	5
RECOMMENDATIONS.....	6
TIME-COST DISTRIBUTION.....	7
CERTIFICATE.....	8

MAPS

Figure 1 - Location Map.....	(Frontispiece)
Figure 2 - Topographic Map.....	(Follows page 1)
Figure 3 - Claim Map.....	(Follows page 2)
Figure 4 - Geophysical Survey - VLF Electromagnetic Survey (by Strato Geological Engineer- ing Ltd.).....	(In Pocket)
Figure 5 - VLF Electromagnetic Survey - Fraser Filter Contour Map (by Strato Geological Engin- eering Ltd.).....	(In Pocket)

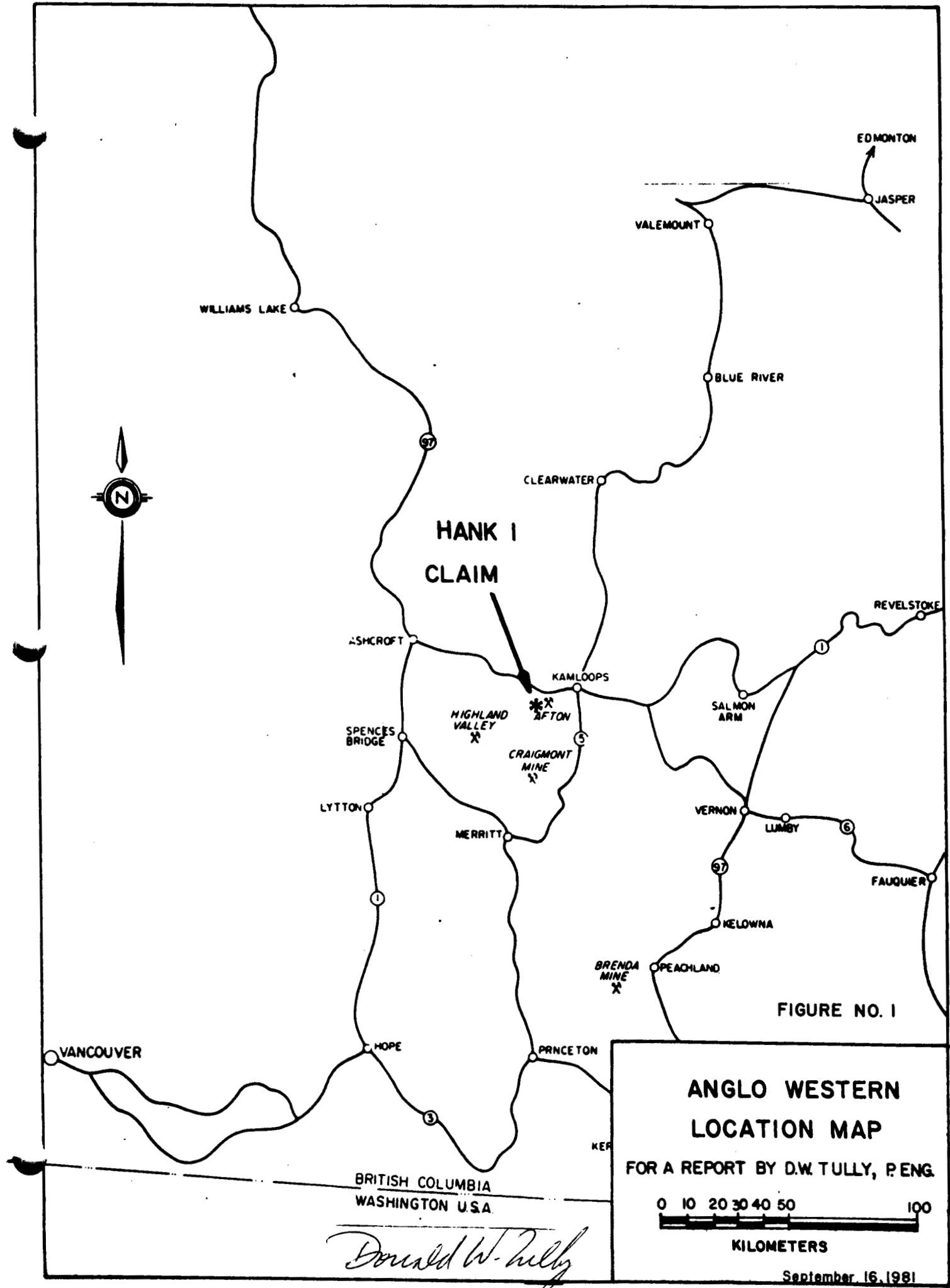
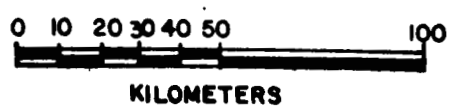

FIGURE NO. 1

**ANGLO WESTERN  
LOCATION MAP**  
FOR A REPORT BY D.W. TULLY, P. ENG.



KILOMETERS

September 16, 1981

*Donald W. Tully*

## INTRODUCTION

This assessment report was prepared pursuant to a request from the Directors of Anglo Western Petroleum Ltd., Suite 511, 850 West Hastings Street, Vancouver, B.C.

The purpose of this report is to evaluate the recently completed geophysical mineral exploration work performed on the HANK I mineral claim.

The basis of this report is the writer's extensive experience from the supervision of diamond drill programs on nearby claim groups.

A further program of mineral exploration is recommended.

## SUMMARY AND CONCLUSIONS

The HANK I mineral claim comprises twenty units located about six kilometres due south of the Afton Mine and some ten kilometres southwest of Kamloops, British Columbia.

Andesite and associated volcanic tuffs and fragmental rocks belonging to the Nicola Group underlie the claim area. The Iron Mask batholith of complex plutonic masses occurs about four kilometres to the northeast. Bodies of base and precious metal mineralization often occur in Nicola volcanics in the contact areas of the Iron Mask batholithic pluton.

The trend of the rocks through the claim area is northwesterly.

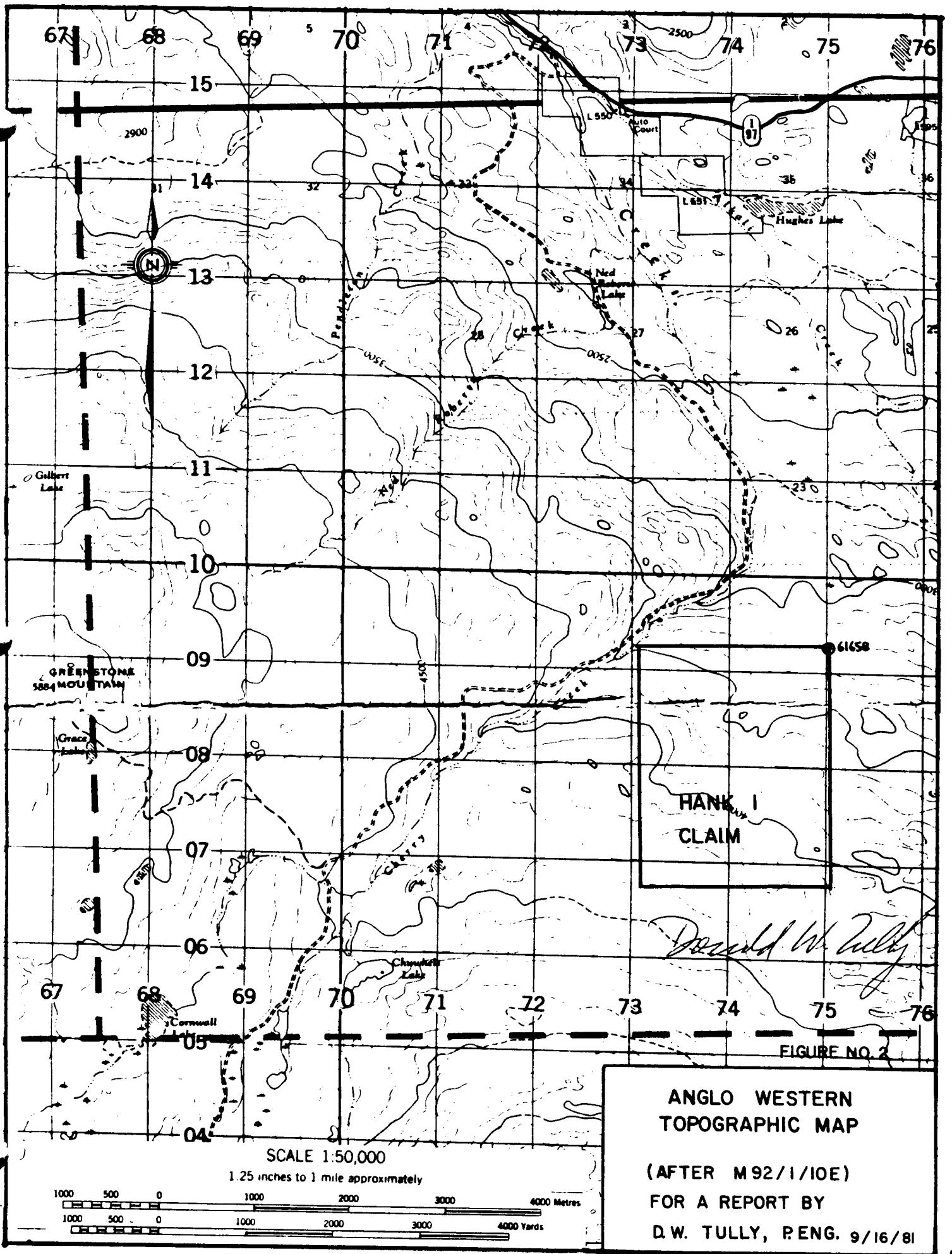

HANK I CLAIM

*Donald W. Tully*

ANGLO WESTERN  
 TOPOGRAPHIC MAP  
 (AFTER M92/1/10E)  
 FOR A REPORT BY  
 D.W. TULLY, PENG. 9/16/81

FIGURE NO. 2

SCALE 1:50,000  
 1.25 inches to 1 mile approximately

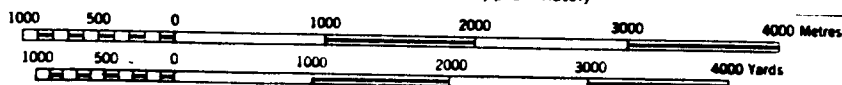

Although economic mineralization has not yet been reported from the area occupied by the HANK I claim, it is concluded from the results of a VLF electromagnetic survey over the north section (20%) of the claimed land that this ground is in a favourable geological environment for the occurrence of base and precious metals and merits a program of mineral exploration to outline any mineral targets for further development.

The cost of the 1981 VLF Electromagnetic geophysical exploration work program was \$6,338.00.

PROPERTY - LOCATION, ACCESS, PHYSIOGRAPHY  
AND ENVIRONMENTAL CONSIDERATIONS

The HANK I mineral claim property is situated in the Kamloops Mining Division. It consists of twenty units and covers an area of 500 hectares (1,236 acres).

The property is accessible by 4 WD vehicle along a bush road leading westward from the highway to Logan Lake or alternately along a bush road from the Dominic Lake road. The road distance from Kamloops is about twenty kilometres and thence by bush trail to the claim. The HANK I claim occupies a north-facing slope that is forested with pine, poplar and considerable underbrush. Elevations vary over the property between 1,200 metres on the north and rising to about 1,550 metres at the southern extremity of the ground.

The climate is warm in summer and moderate in winter.

The land area is under grazing lease.

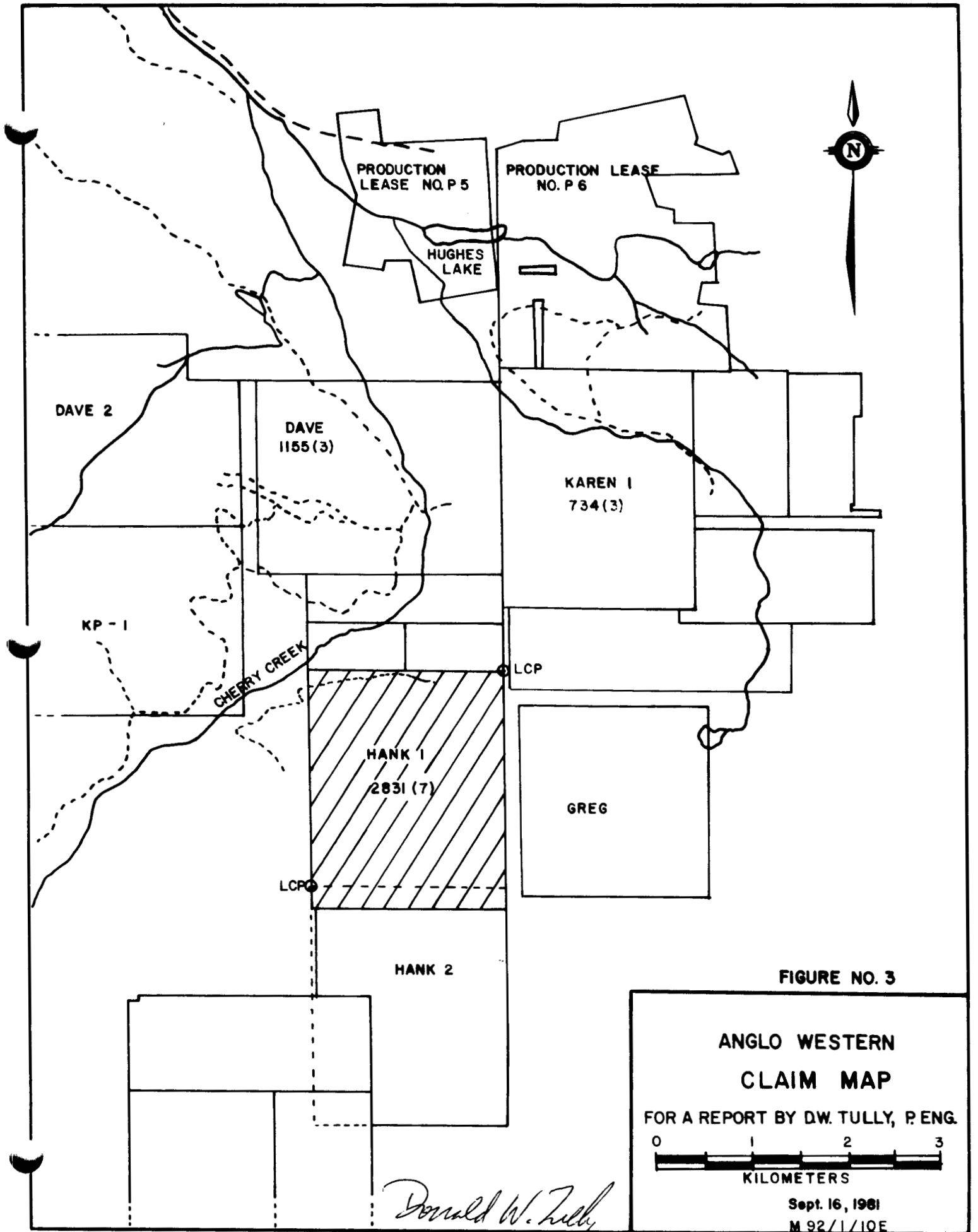

FIGURE NO. 3

ANGLO WESTERN  
CLAIM MAP

FOR A REPORT BY DW. TULLY, P. ENG.



Sept. 16, 1981

M 92/1/10E

### CLAIM

Information on file with the Gold Commissioner at Kamloops, British Columbia on September 16, 1981 was as follows:

Claim Name	-	HANK I
Record Number	-	2831 (7)
Units (5 x 4)	-	20
Record Date	-	July 24, 1980
Recorded Owner	-	Heino Leis

The HANK I mineral claim is shown on British Columbia Ministry of Energy, Mines and Petroleum Resources Mineral Titles Reference Map 92-I-10E (Figure 3).

### HISTORY - PREVIOUS DEVELOPMENT

The staking rush in the Kamloops area that followed the discovery of the Afton Mine in late 1971 resulted in the staking of the ground now held by the HANK I claim. The results of any exploration work done at that time on what is now designated the HANK I claim area are not available to the writer.

A VLF electromagnetic geophysical survey was done by Strato Geological Engineering Ltd. over the north portion (20%) of the claim area in 1981.

### REFERENCES

Geological Survey of Canada Memoir 249 and accompanying Map 886A

Geological Survey of Canada Aeromagnetic Maps 5216G and 5217G



REGIONAL AND LOCAL GEOLOGICAL SETTING

The general geology of the HANK I claim area is shown on Geological Survey of Canada Map 886A (Nicola).

A tentative geologic timetable pertaining to the property area is as follows:

<u>Formation</u>	<u>Description/Event</u>	<u>Age</u>
Sand, gravel, glacial debris and loam	Unconsolidated  (Erosional unconformity)	Quaternary
Coast Intrusions	Complex intrusive sequence of granite, granodiorite, diorite and related felsic and mafic dykes  (Folding, faulting, shearing and related tectonic activity)	Jurassic
Nicola Group of volcanics	Greenstone, andesite and basalt	Upper Triassic

Structurally, the rock sequence of Nicola volcanics which underlie the HANK I mineral claim, trend northwesterly. This is confirmed by a study of the aeromagnetic maps of the area, which reflect the basement geologic structural trend. The magnetic relief over the claim area rises gently northward towards the area of the Iron Mask pluton and inversely to the trend of the surface terrain.

## MINERALIZATION

There is no economic mineralization known to the writer on the claim area. However, the writer considers the presence of the Nicola volcanics and the nearby Iron Mask batholith to be a favourable geological environment for the discovery of bodies of economic mineralization.

### RESULTS OF THE 1981 VLF ELECTROMAGNETIC SURVEY

During the period Feb. 26 through March 4, 1981, Strato Geological Engineering Ltd. did a VLF electromagnetic geophysical survey over the north sector of the property. The surveyed area covers an east-west distance of two kilometres across the north boundary of the HANK I claim area and extends south a distance of 450 metres. This surveyed area is shown on Figures 4 and 5 accompanying this report and represents some 20% of the HANK I mineral claim.

The results of the survey show three north-south trending linear anomalies over the surveyed area. These zones have been designated Anomalies A, B and C respectively and are described as follows:

#### Anomaly A

This zone of apparent conductivity is located in the extreme northwest corner of the claim area and appears to be trending beyond the claim boundary. It is the most intense of the three indicated anomalies and may be significant.

#### Anomaly B

This anomalous zone occurs in the central sector of the surveyed ground. The lineal extent and moderate

intensity suggests this zone of apparent conductivity may reflect current-channeling along a north-south trending geological structure that could be a channel-way for mineralization from depth.

### Anomaly C

This north-south trending lineal anomaly is located in the eastern portion of the claim area surveyed and probably represents current-channeling along a geological structure such as a fault or shear zone along which mineralization may be found.

### RECOMMENDATIONS

It is recommended the HANK I mineral claim be surveyed by chain and compass to establish the position of the boundary of the property.

A program of geological mapping, geophysical surveying and geochemical soil sampling is proposed for the remaining (80%) unexplored area of the HANK I claim to delineate any further mineral target or targets of merit. Geological mapping will outline the rock exposures. VLF electromagnetic and magnetometer geophysical surveying will determine the presence of any apparent conductor zones. Geochemical soil sampling should indicate any near surface zones of mineralization.

As a follow-up program, to delineate any indicated anomalous mineral target zones and also to test the ground to depth by geophysical means, a deep-penetrating Elfast Turam electromagnetic survey is proposed.

Respectfully submitted,

*Donald W. Tully*

Donald W. Tully, P. Eng.

September 16, 1981



STRATO GEOLOGICAL ENGINEERING LTD.  
103-709 DUNSMUIR STREET  
VANCOUVER, BRITISH COLUMBIA  
V6C 1M9

TELEPHONE (604) 687-4610

March 15, 1981

Anglo-Western Petroleums Ltd.,  
709 Dunsmuir Street,  
Vancouver, B.C.  
V6C 1M9

Electromagnetic Survey and Flagging of Lines,

February 26 - March 4, 1981

Ralph Englund - Geophysicist  
Geoffrey Smith - Operator  
Grey May - Assistant

Labour.....	\$2,560.00
Supplies.....	\$ 84.39
Transportation.....	\$ 423.99
Room and Board.....	\$ 371.18
Drafting.....	\$1,707.61
Report by P.Eng.....	\$1,029.21
Filing Fee.....	\$ 300.00

\$6,476.38

6176.38.

*Ursu Lee*

*Not for B.R. credit*

*T-k -*

CERTIFICATE

I, DONALD WILLIAM TULLY, of the Municipality of West Vancouver, Province of British Columbia, hereby certify as follows:

- 1) I am a Consulting Geologist with an office at Suite 102, 2222 Bellevue Avenue, West Vancouver, British Columbia.
- 2) I am a registered Professional Engineer in the Provinces of Ontario and British Columbia.
- 3) I graduated with a degree of Bachelor of Science, Honours Geology, from McGill University in 1943.
- 4) I have practiced my profession for thirty-six years.
- 5) I have no direct, indirect or contingent interest in the HANK I mineral claim, subject of this report, or in the securities of Anglo Western Petroleum Ltd., nor do I intend to receive any interest.
- 6) This report dated September 16, 1981 is based upon a field examination of the claim posts and claim area on April 6, 1981, a study of the available reports and published information, and personal communications with persons familiar with the ground.
- 7) Written permission is required from the writer to publish this report dated September 16, 1981 in any Prospectus or Statement of Material Facts.

DATED at West Vancouver, British Columbia this 29th day of September, 1981.



DONALD W. TULLY, P. ENG.

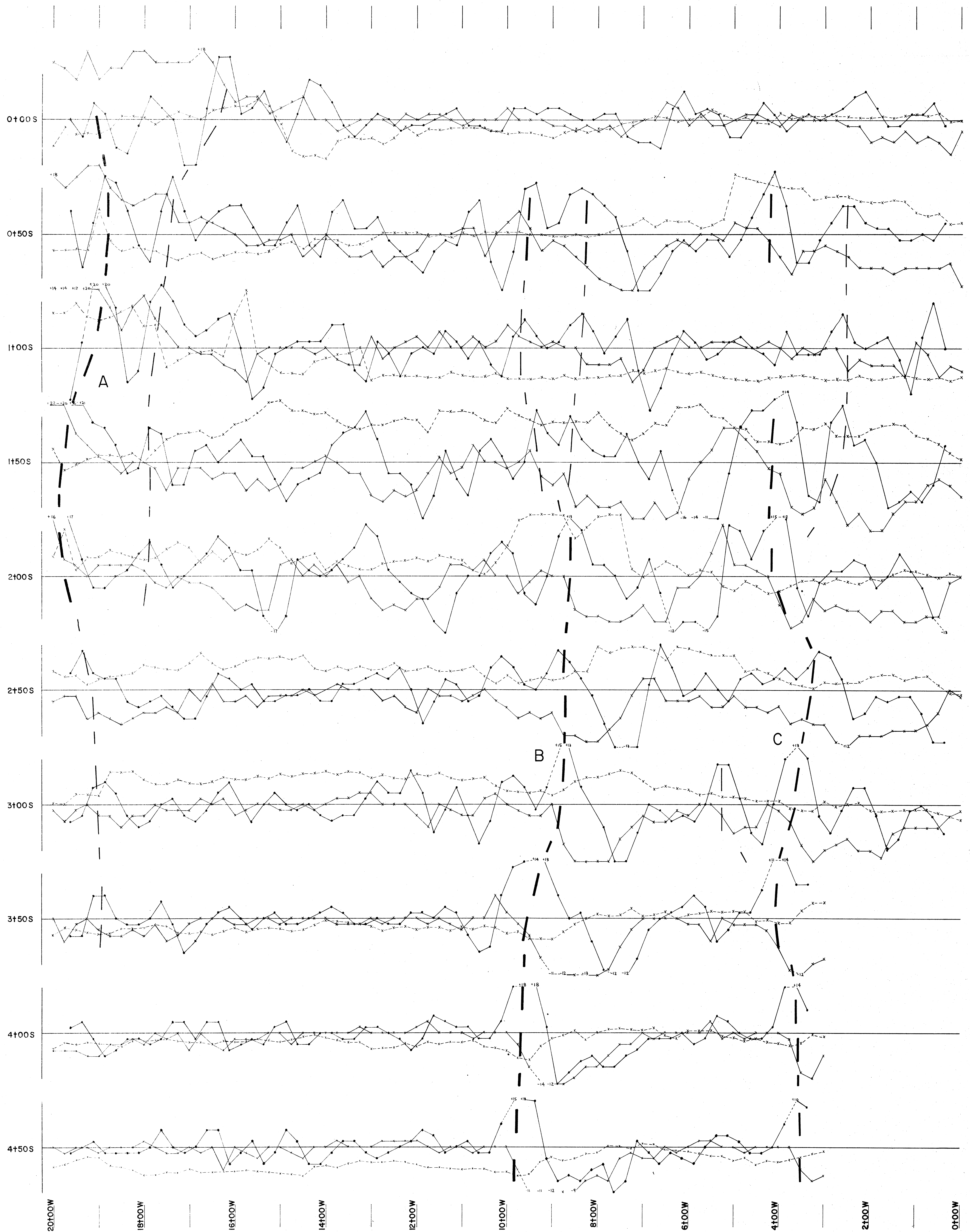
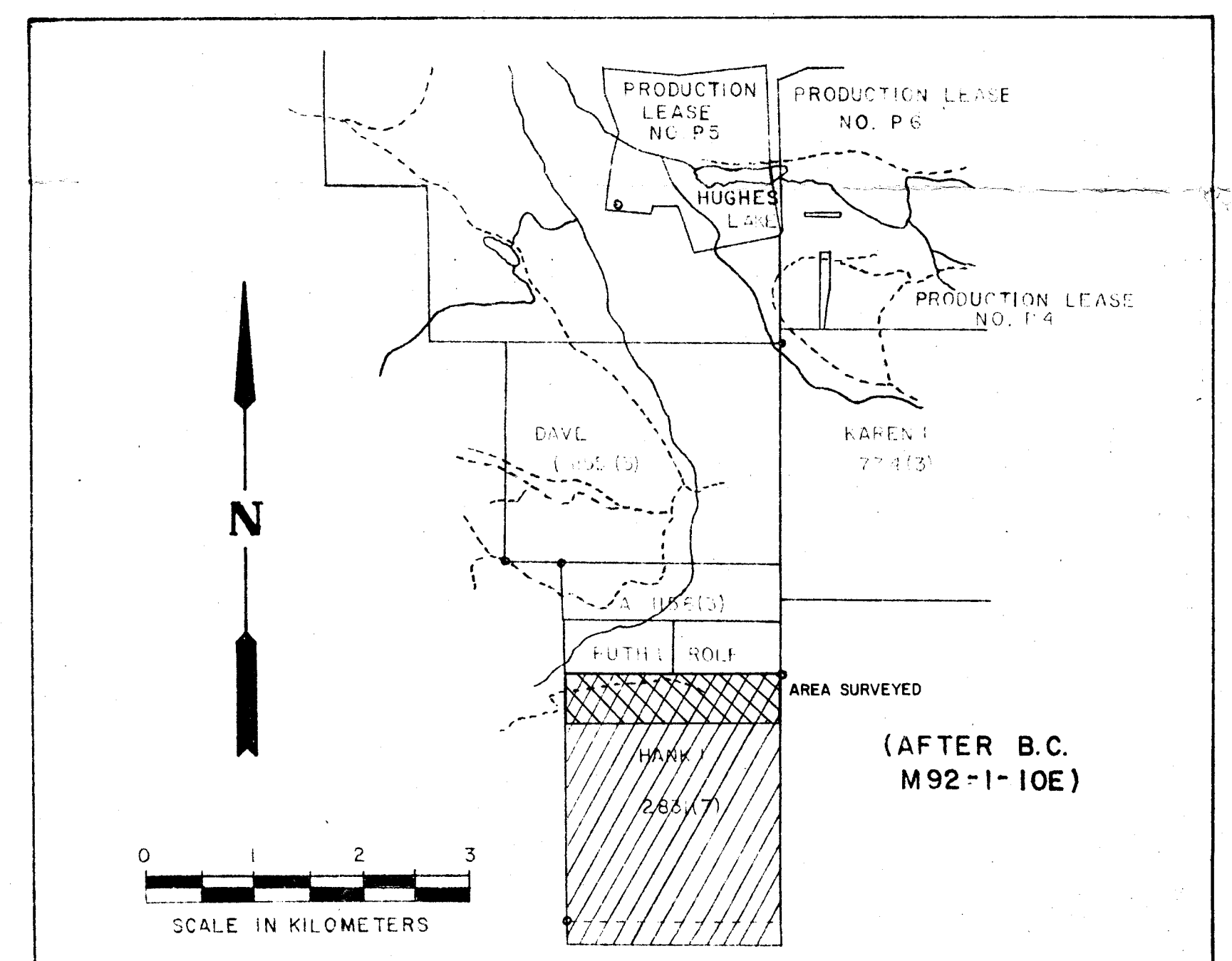

FIGURE 4



NOTE: VLF RECEIVER, SABBRE ELECTRONICS  
 MODEL 27, SERIAL NO. 57  
 VLF TRANSMITTER, NPG SEATTLE  
 18.6 KHZ

*Donald W. Tully*

ANGLO WESTERN PETROLEUM LTD.  
 HANK I CLAIM GROUP  
 KAMLOOPS MINING DIVISION

**GEOPHYSICAL SURVEY**  
 VLF ELECTROMAGNETIC SURVEY  
 CROSS SECTIONS OF DIP ANGLE AND FRASER FILTER

SCALE IN METERS  
 0 100 200

TO ACCOMPANY A REPORT BY D.W. TULLY, PENG  
 GEOPHYSICAL SURVEY BY:  
 STRATO GEOLOGICAL  
 103-709 DUNDAS ST. VANCOUVER, B.C.

LEGEND

- DIP ANGLE
- FRASER FILTER
- FIELD STRENGTH
- CONDUCTOR

**9533**

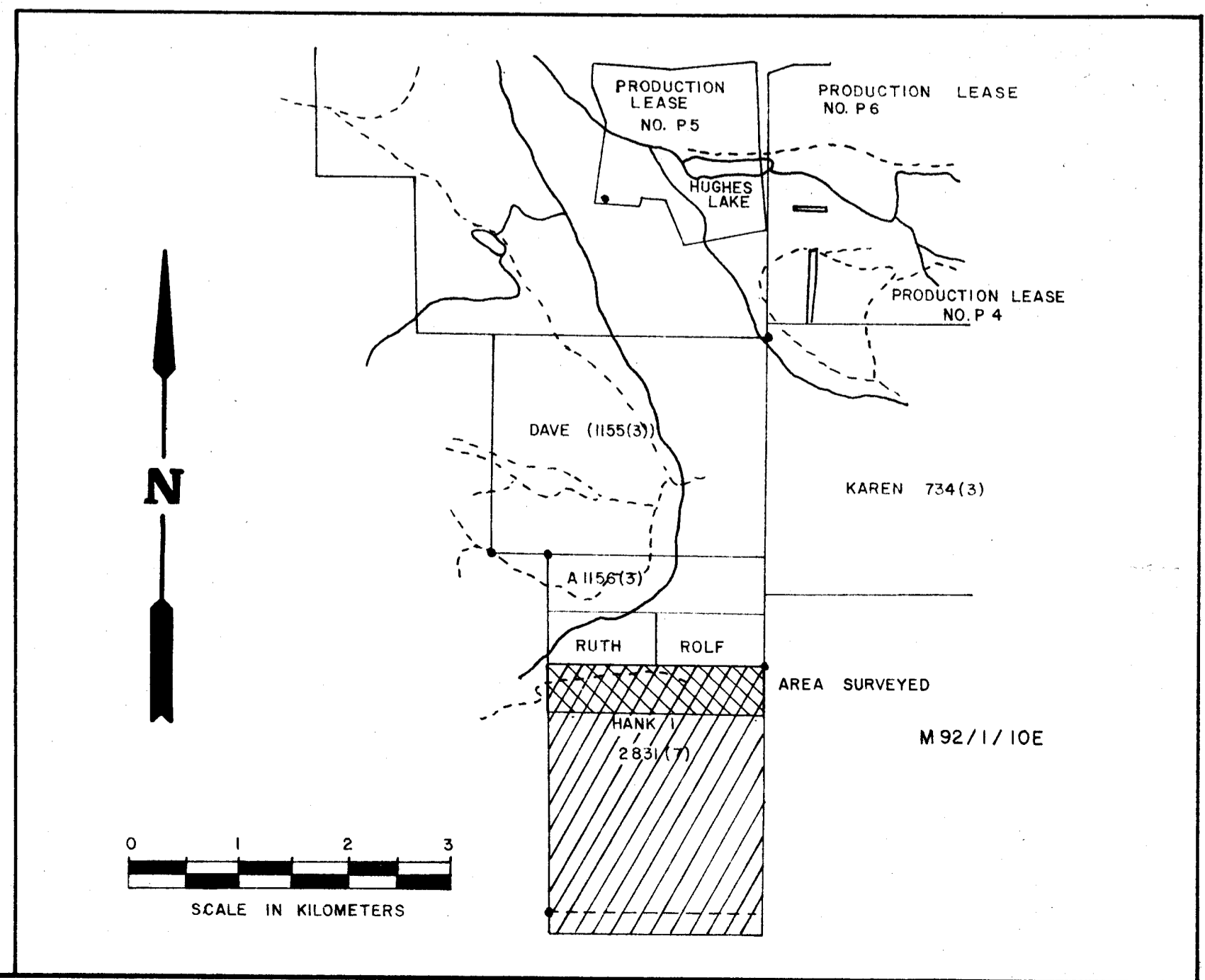
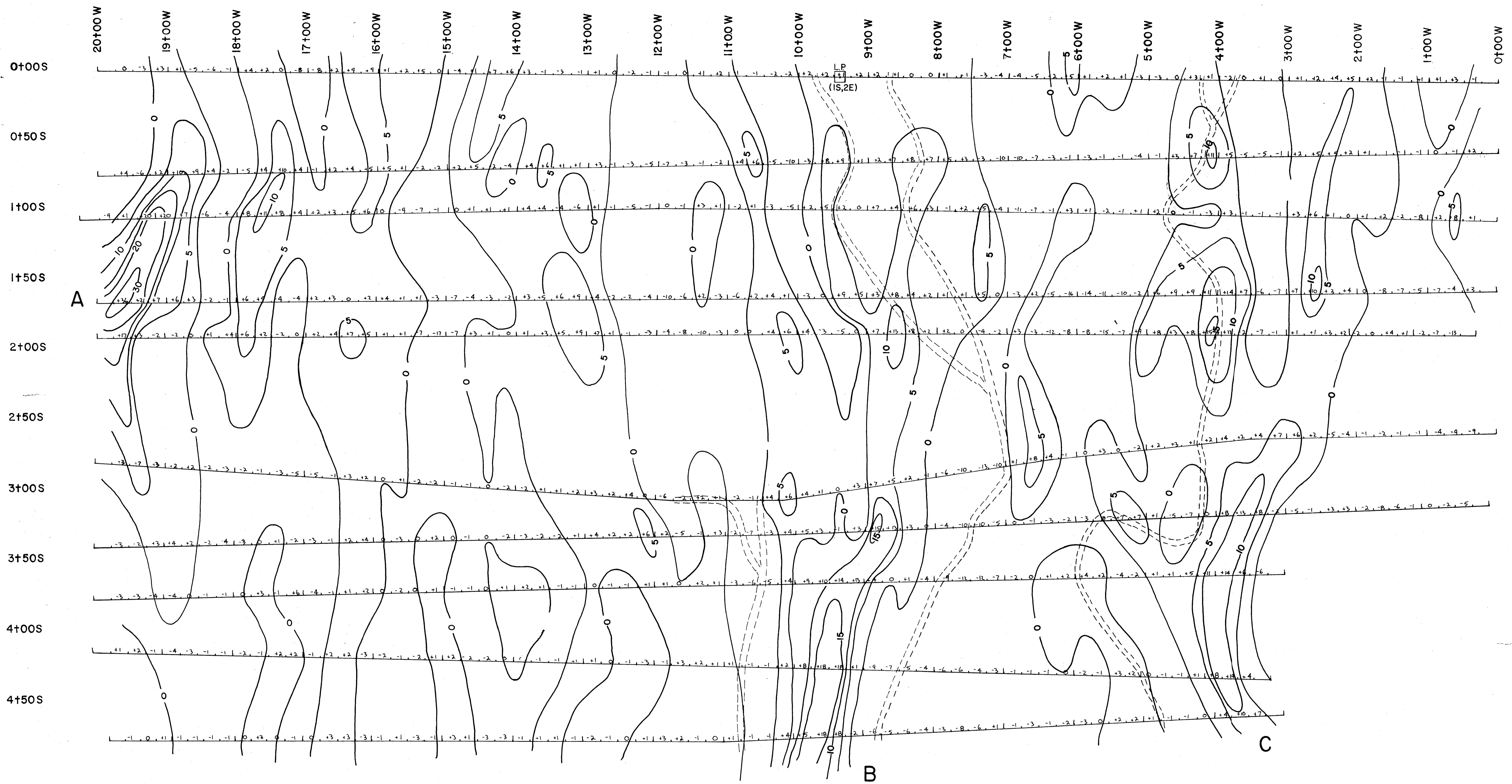

NOTE: VLF RECEIVER, SABRE ELECTRONICS  
 MODEL 27, SERIAL 57  
 VLF TRANSMITTER, NPG SEATTLE  
 18.6 KHz

CONTOUR INTERVAL = 5°

**9533**

FIGURE 5

**ANGLO WESTERN PETROLEUM LTD.**  
 HANK I CLAIM GROUP  
 KAMLOOPS MINING DIVISION  
**VLF ELECTROMAGNETIC SURVEY**  
**FRASER FILTER CONTOUR MAP**

0 100 200  
 SCALE IN METERS

TO ACCOMPANY A REPORT BY D.W. TULLY P.ENG.

SURVEY BY:  
 STRATO GEOLOGICAL ENGINEERING  
 103-709 DUNSMUIR ST.  
 VANCOUVER B.C.

*Donald W. Tully*