

81-7719.
-9590

ASSESSMENT REPORT

ON THE

1981 DIAMOND DRILL PROGRAM

SOL (MINERAL CLAIM)

RECORD NO. 703(9)

ASPEN GROVE - QUILCHENA CREEK AREA

NICOLA MINING DIVISION

MERRITT, BRITISH COLUMBIA

N. Lat. 49°58'

W. Long. 120°29'

for

ABATON RESOURCES LTD.
5316 Fleming Street
Vancouver, British Columbia

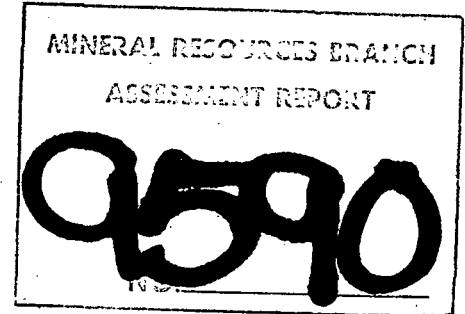

by

DONALD W. TULLY, P. ENG.

September 21, 1981

West Vancouver, B.C.

TABLE OF CONTENTS

	<u>Page</u>
INTRODUCTION.....	1
SUMMARY AND CONCLUSIONS.....	1
PROPERTY - LOCATION, ACCESS, PHYSIOGRAPHY.....	2
CLAIMS.....	3
HISTORY - PREVIOUS DEVELOPMENT.....	3
REFERENCES.....	4
REGIONAL AND LOCAL GEOLOGICAL SETTING.....	5
MINERALIZATION - ASSAYS.....	6
RESULTS OF THE 1981 PROGRAM OF DIAMOND DRILL PROGRAM.....	7
TIME-COST DISTRIBUTION.....	8
CERTIFICATE.....	9

MAPS

Figure 1 - Location Map.....	(Frontispiece)
Figure 2 - Topographic Plan (After 92H/NE)....	(Follows page 1)
Figure 3 - Claim Plan (After M92H/16W).....	(Follows page 2)
Figure 4 - Regional Geology (After GSC Map 888A).....	(Follows page 3)
Figure 5 - Plan of SOL Claim.....	(Follows page 4)
Figure 6 - Plan of D.D. Holes A-1-81 through A-4-81, A-6-81, A-7-81.....	(Follows page 5)
Figure 7 - Section through DDH A-1-81.....	(Follows page 6)
Figure 8 - Section through DDH A-2-81, A-3-81.....	(Follows page 7)
Figure 9 - Section through DDH A-4-81.....	(Follows page 7)
Figure 10 - Section through DDH A-6-81.....	(Follows page 8)
Figure 11 - Section through DDH A-7-81.....	(Follows page 8)

APPENDIX

Assay Certificates #8108-2457; 8109-0865
Logs of D.D. Holes A-1-81 through A-7-81

FIGURE I.
LOCATION MAP

Scale 1" = 30 miles
SEPT 21, 1981

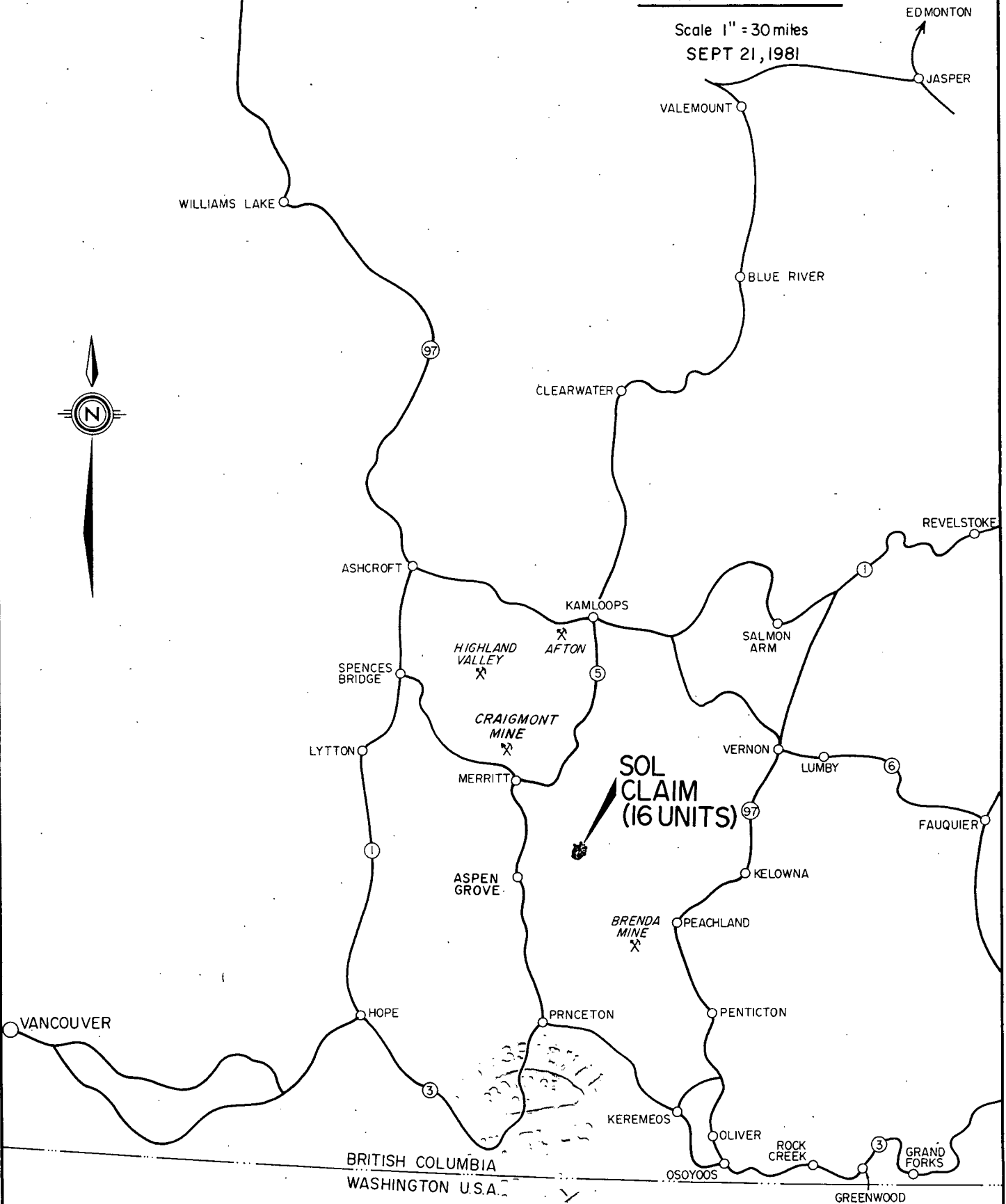

Donald W. Kelly

INTRODUCTION

This Assessment Report was prepared pursuant to a request from the Directors of ABATON RESOURCES LTD., 5316 Fleming Street, Vancouver British Columbia.

The purpose of this report is to summarize and evaluate the results of the 1981 Diamond Drill Program done on the SOL claim area in 1981.

Further mineral exploration work is recommended.

SUMMARY AND CONCLUSIONS

The SOL claim area comprises sixteen units located southeast of Merritt, British Columbia in the Aspen Grove - Tommy Lake - Quilchena Creek area (Figure 2).

During the period July 13, 1981 through August 17, 1981 a total of 616.18 metres (2,021 feet) of BQ core size (36 mm) diamond drilling was done in seven drill holes on the SOL mineral claim.

The program of diamond drilling was designed to test the copper showing previously tested by the former Skeena Silver Mines in the early 1960's and recently acquired as the SOL mineral claim by Abaton Resources Ltd. Abaton trenched the area of the former copper showing in 1980 and found evidence of iron sulphide mineralization.

The results of the diamond drilling indicated a series of lenses of massive pyrite occur in an andesitic volcanic breccia. This zone of massive pyrite showed

To Merritt - 23 km

30'

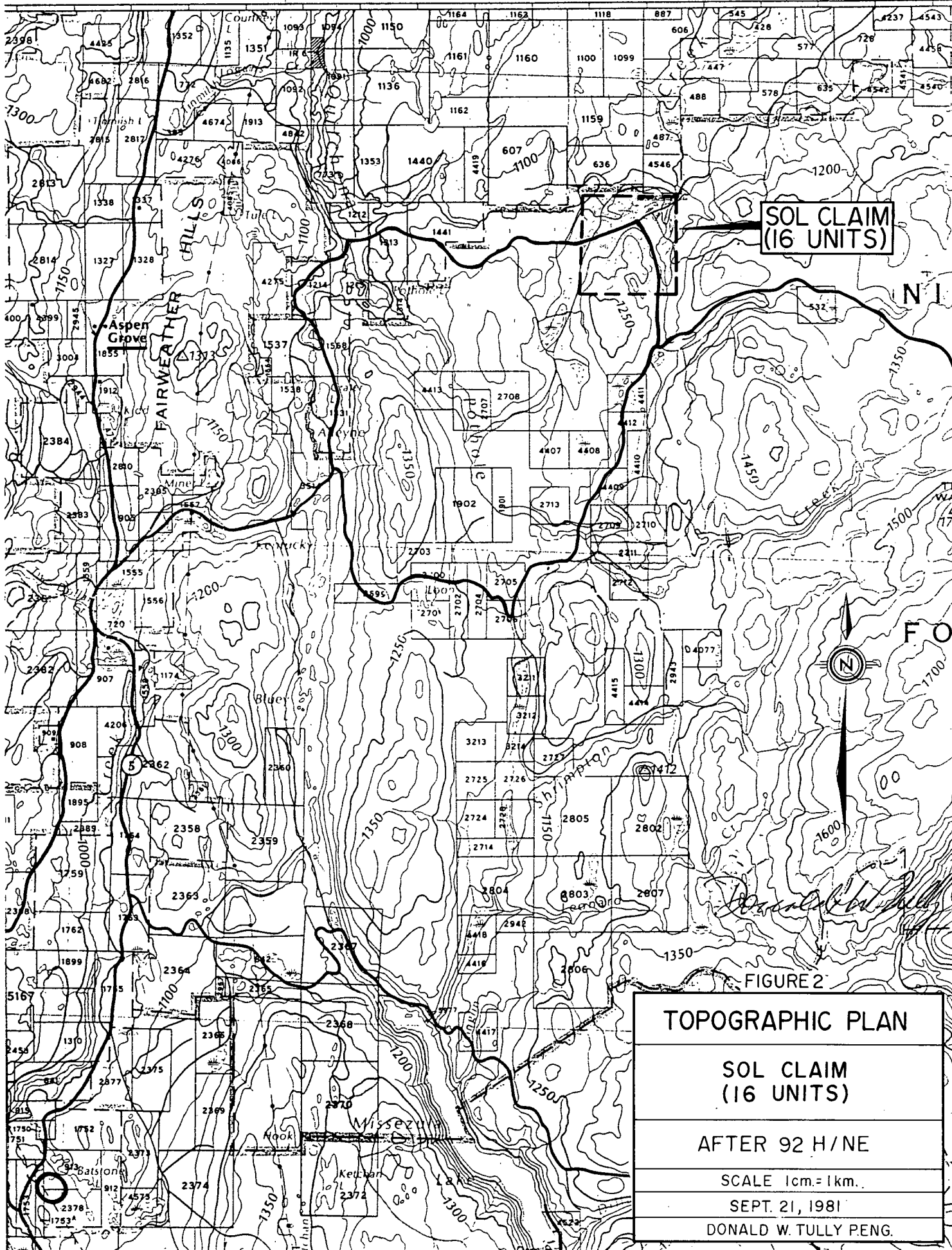

SOL CLAIM
(16 UNITS)



FIGURE 2

<p>TOPOGRAPHIC PLAN</p> <p>SOL CLAIM (16 UNITS)</p> <p>AFTER 92 H/NE</p> <p>SCALE 1cm = 1km.</p> <p>SEPT. 21, 1981</p> <p>DONALD W. TULLY PENG.</p>

widths of up to forty feet (13 metres) in one of the drill holes. The pyrite zone appears to be flat-dipping to the east and strikes slightly south of west (Figure 6). Evidence in diamond drill hole #7 showed the massive pyrite zone to be open to the south.

A geochemical soil sampling survey of the total SOL claim area is recommended to search for new mineral target areas.

PROPERTY - LOCATION, ACCESS, PHYSIOGRAPHY

The property is located about eleven kilometres east of the Hamlet of Aspen Grove on Highway 5, British Columbia.

Road access is available to the ground from a point about five kilometres south of Aspen Grove on Highway 5, thence a road distance of about twenty-six kilometres to the claim area (Figure 2).

The valley of Quilchena Creek lies a few hundred metres north of the claimed ground. A small creek is located about a claim west of the road which traverses along the east portion of the property in a north-south direction. This creek water should meet any immediate industrial needs.

Elevations vary from about 3,600 feet above sea-level to some 4,200 feet over the ground. Second-growth forest of spruce, pine, fir, poplar and brush cover the claim area.

5000' M 92H/16W

(FOR PLACER SEE P 92H/16W)

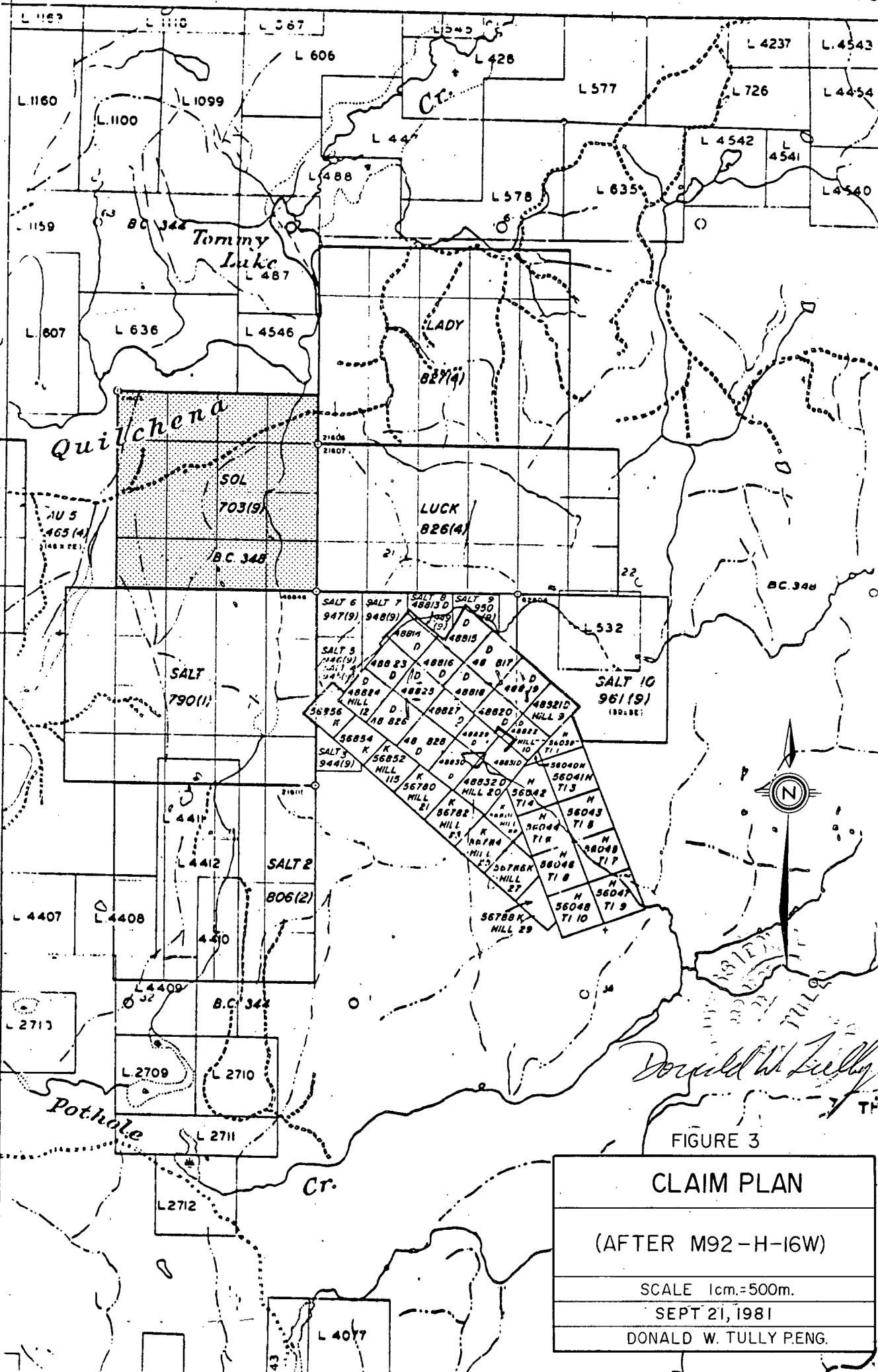

FIGURE 3

CLAIM PLAN

(AFTER M92-H-16W)

SCALE 1cm.=500m.

SEPT 21, 1981

DONALD W. TULLY PENG.

MAP 92 H/15 E

CLAIMS

The SOL claim consists of 16 units located in the Nicola Mining Division, Quilchena Creek-Aspen Grove area, British Columbia. Information on file with the British Columbia Ministry of Energy, Mines and Petroleum Resources was as follows:

<u>Claim Name</u>	<u>Units</u>	<u>Record Number</u>	<u>Expiry Date</u>	<u>Recorded Holder</u>
SOL	16	703(9)	September 4, 1982	Abaton Resources Ltd.

The claim is shown on B.C. Mineral Titles Reference Map M92/H - 16W.

HISTORY - PREVIOUS DEVELOPMENT

In 1961, the ground held by the present SOL claim was occupied by the WEN 1 - 14 and HN 1 - 18 and held by Skeena Silver Mines Ltd. At that time some 7,200 feet of stripping was done. In 1962, more bulldozer stripping was performed, an electromagnetic survey was done and nineteen short diamond drill holes were done totalling 3,989 feet. The showings were said to consist of skarn containing chalcopryrite and magnetite. In 1962, the claimed ground was held by the Malachite 1 - 14 and the Chalcocite 1 - 18 mineral claims. Several major mining companies had already optioned this ground and a report by one of them indicated the best diamond drill intersection from the diamond drill hole results was 1.62 percent copper across a core length of 20 feet. No indication of the gold and silver content was given but the intersection of copper was said to contain 50% or more of magnetite with pyrite in a skarn host rock.

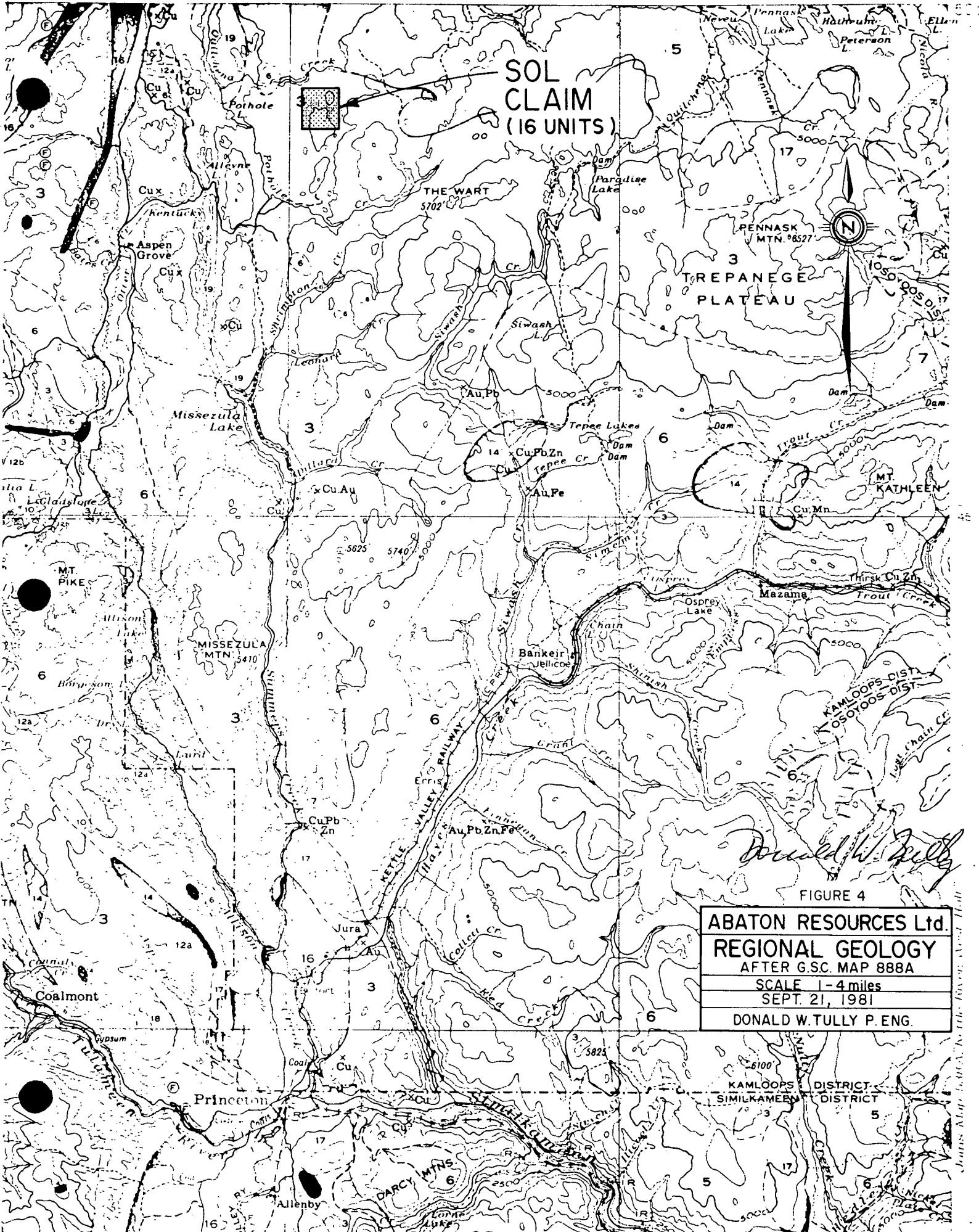

Donald W. Tully

FIGURE 4

<p>ABATON RESOURCES Ltd. REGIONAL GEOLOGY AFTER G.S.C. MAP 888A SCALE 1 - 4 miles SEPT. 21, 1981 DONALD W. TULLY P. ENG.</p>

KAMLOOPS DISTRICT
 SIMILKAMEEN DISTRICT

Joins Map 886 A, "Nicola" by The River View, Ltd.

Skeena Silver Mines subsequently became Consolidated Skeena Mines and did geochemical and geophysical surveys in 1968. Four geochemical anomalies of significance were reported. Apparently the magnetometer survey work was inconclusive but the induced polarization survey by Barringer Research Limited was reported by W.M. Sharp, P.Eng., (Deceased) to have indicated several important zones of anomalous response reflecting a considerable content of disseminated pyrite in underlying volcanic rocks.

A VLF electromagnetic and magnetometer survey was done over the SOL claim area in the period February - May, 1980. A bulldozer trenching program was done on the mineralized showing, drilled by Skeena Silver Mines in 1962, during June-July and about 2.4 line-kilometres of Maxmin electromagnetic surveying was done in October - November, 1980. The Maxmin geophysical work was done over a portion of an indicated anomalous zone from the VLF electromagnetic work in the area of the mineralized showing previously developed by Skeena Silver. The Maxmin work confirmed one EM conductor at the 100 metre coil spacing at the 1777 Hertz frequency north of the mineral showing. Deep overburden prevented a test of one of these EM Conductors at the location of diamond drill hole #5 (Figure 5).

In 1981 a total of 616.18 metres of BQ core size diamond drilling was done in seven holes.

REFERENCES

Reports and publications pertinent to the ground now held by the SOL claim are as follows:

Minister of Mines and Petroleum Resources Annual Report
for 1961, p-46

Minister of Mines and Petroleum Resources Annual Report
for 1962, p-59

B.C. Minister of Energy, Mines and Petroleum Resources
Assessment Reports

No. 1049 - Geochemical Survey dated August, 1967

No. 1089 - Airborne Geophysical Survey and Ground
Geochemical Survey dated October 15, 1967

No. 1586 - Geological, Geophysical and Geochemical
Surveys dated July 26, 1968

No. 1718 - Induced Polarization Survey MAL-CHAL
Group, Aspen Grove Area, B.C. by Barringer
Research Limited, dated October 1968

No. 1953 - Line-cutting: report dated May 15, 1969

Geological Survey of Canada Memoir 243 by H.M.A. Rice

Report by W.M. Sharp, P.Eng., (Deceased) dated January 15,
1969 entitled "Summary Report 69-1, Geological-Geo-
chemical-Geophysical Exploration, Tommy Lake, Boot
Lake Area, Nicola M.D.

Summary Report on Geological, Geochemical and Geophysical
Investigations of the Tommy Lake - Paradise Lake Prop-
erty for Consolidated Skeena Mines Ltd. (NPL) by W.M.
Sharp, P.Eng., dated July 25, 1968

Assessment Report on a Combined (VLF) Electromagnetic and
Magnetometer Survey on the SOL Claim Group for Abaton
Resources Ltd., by Donald W. Tully, P.Eng., and dated
October 1, 1980

Summary Report 1980 Program of Mineral Exploration, SOL
Mineral Claim Group, by Donald W. Tully, P.Eng., and
dated March 12, 1981

REGIONAL AND LOCAL GEOLOGICAL SETTING

The area is underlain by Nicola volcanics in the
west contact zone of the Pennask Pluton. The trend of the
rocks is slightly west of north. The main structural fea-
ture is a synclinal axis lying a few kilometres to the west
of the claim area (Figure 4).

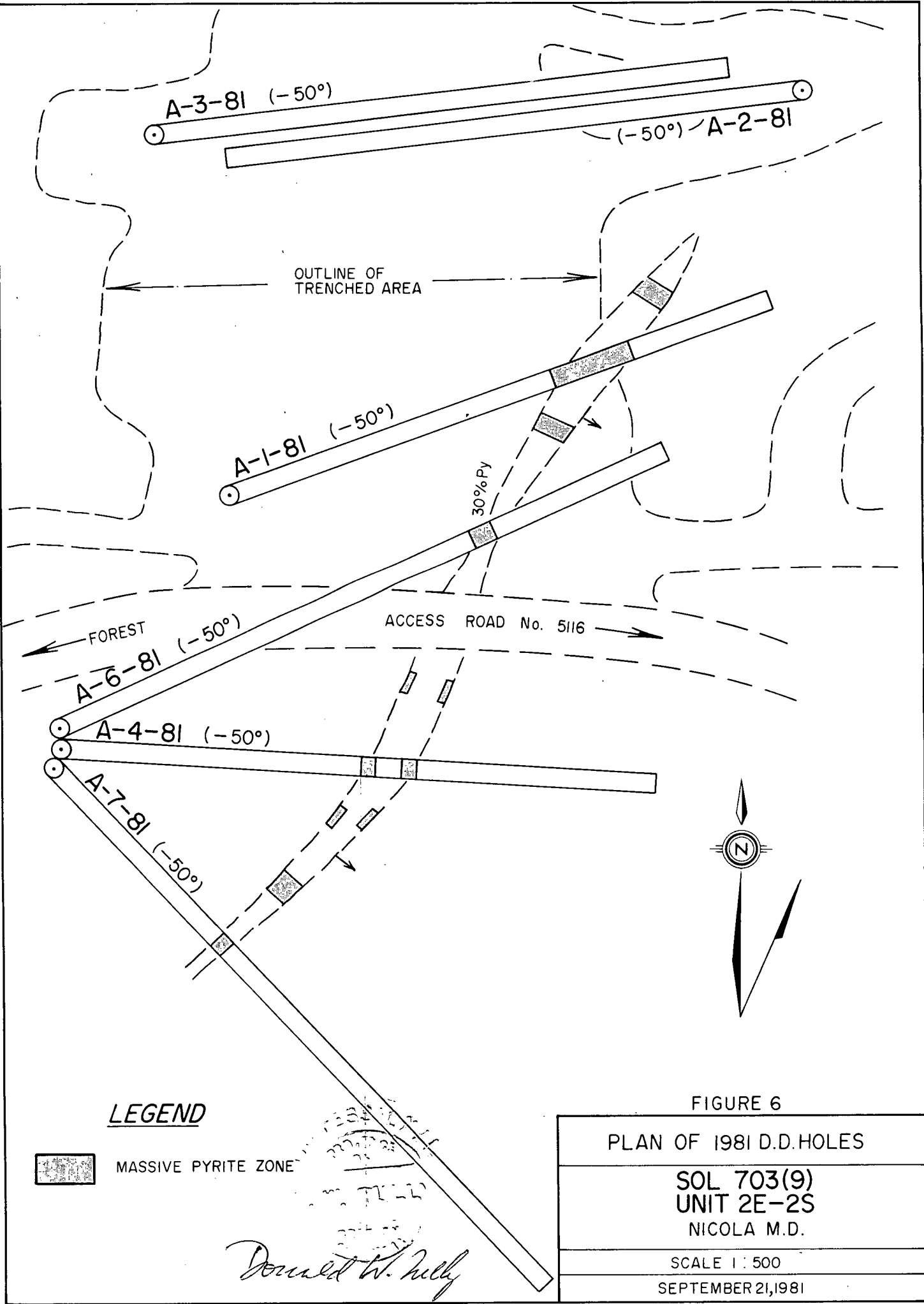

A tentative timetable of geologic events for the SOL claim area is as follows:

<u>Formation</u>	<u>Description/Event</u>	<u>Age</u>
Sand, gravel and loam	Unconsolidated (Erosional unconformity)	Quaternary
Mineralization, metamorphism and hydrothermal alteration in skarn-type rocks	Sulphides and oxides of iron and copper (Faulting, folding and intrusive activity attendant to the Pennask Pluton)	Tertiary (?) Post Jurassic
Pennask Pluton Complex	Granodiorite and monzonite (Faulting, folding and related tectonic activity)	Jurassic
Nicola Volcanics	Basalt, andesite and associated volcanic fragmental phases, pelitic sediments and minor conglomerate	Upper Triassic

MINERALIZATION - ASSAYS

The principal mineral showing occurs in the area of SOL claim unit 2E - 2S (Figure 5). The host rock is an altered andesite lava flow skarn composed of abundant epidote, magnetite, garnet and altered volcanic carrying disseminated pyrite, minor chalcopyrite and malachite stain.

Thirteen split-core samples were taken for assay. The assays of the massive pyrite section in drill hole #1

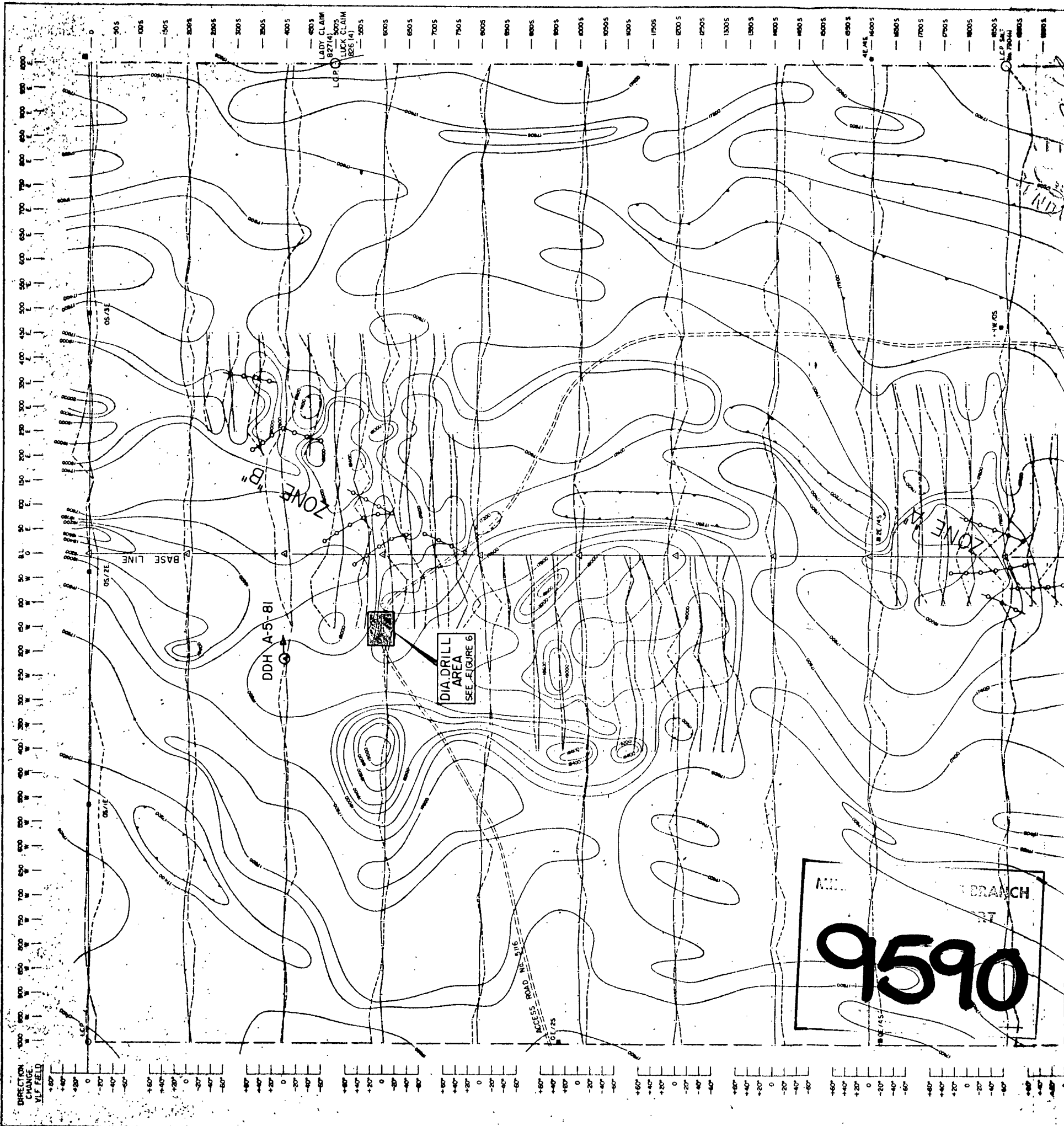

David L. Kelly
 Revised Sept 21, 1981
 FIGURE 5

ABATON RESOURCES LTD.	
ELECTROMAGNETIC (MVF) - MAGNETOMETER	
EM PROFILES - ISOMAGNETIC CONTOURS	
SOL CLAIM No. 703 (9)	
ASPEN GROVE - TOMMY LAKE AREA	
NICOLA, B.C.	
METRES 90	0 50 100 150 200 250 300 350 400 450 500
DONALD W. TULLY, P. ENG. DATE: APRIL 27, 1980	

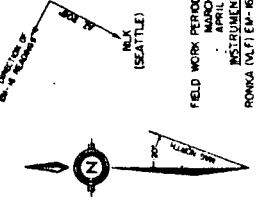

FIELD WORK PERIOD: FEB. 24 - 26, 1980
 MARCH 20 - APRIL 3, 1980
 APRIL 20 - MAY 3, 1980
 INSTRUMENT USED:
 RONKA MVF EM-16 No. 89
 CON - MAG. MAGNETOMETER No. 0047

CLAIM POST - FIELD LOCATED (APPROX.)
 REVISION: SEPT - 1980

- EXPLANATION**
- STATION FLAGGED - LOCATION BY CHAIN AND COMPASS
 - 1W/45 (CLAIM UNIT POST) (LOCATION APPROX.)
 - LCP (LEGAL CORNER POST)
 - LOGGING ROAD
 - TRAIL
 - CREEK
 - MAGNETOMETER BASE STATION
 - M - PHASE READING
 - W - PHASE READING
 - QUADRATURE READING
 - M - PHASE PROFILE (VERTICAL)
 - QUADRATURE PROFILE (VERTICAL)
 - MAGNETIC CONTOUR - INTERNAL 200 GAUSS
 - MAGNETIC CONTOUR
 - APPARENT ELECTROMAGNETIC CONDUCTOR ZONE

NOTE - ALL LOCATIONS SUBJECT TO B.C.L.S. SURVEY

A-1-81

→ 070°

EL. 3740 ft.

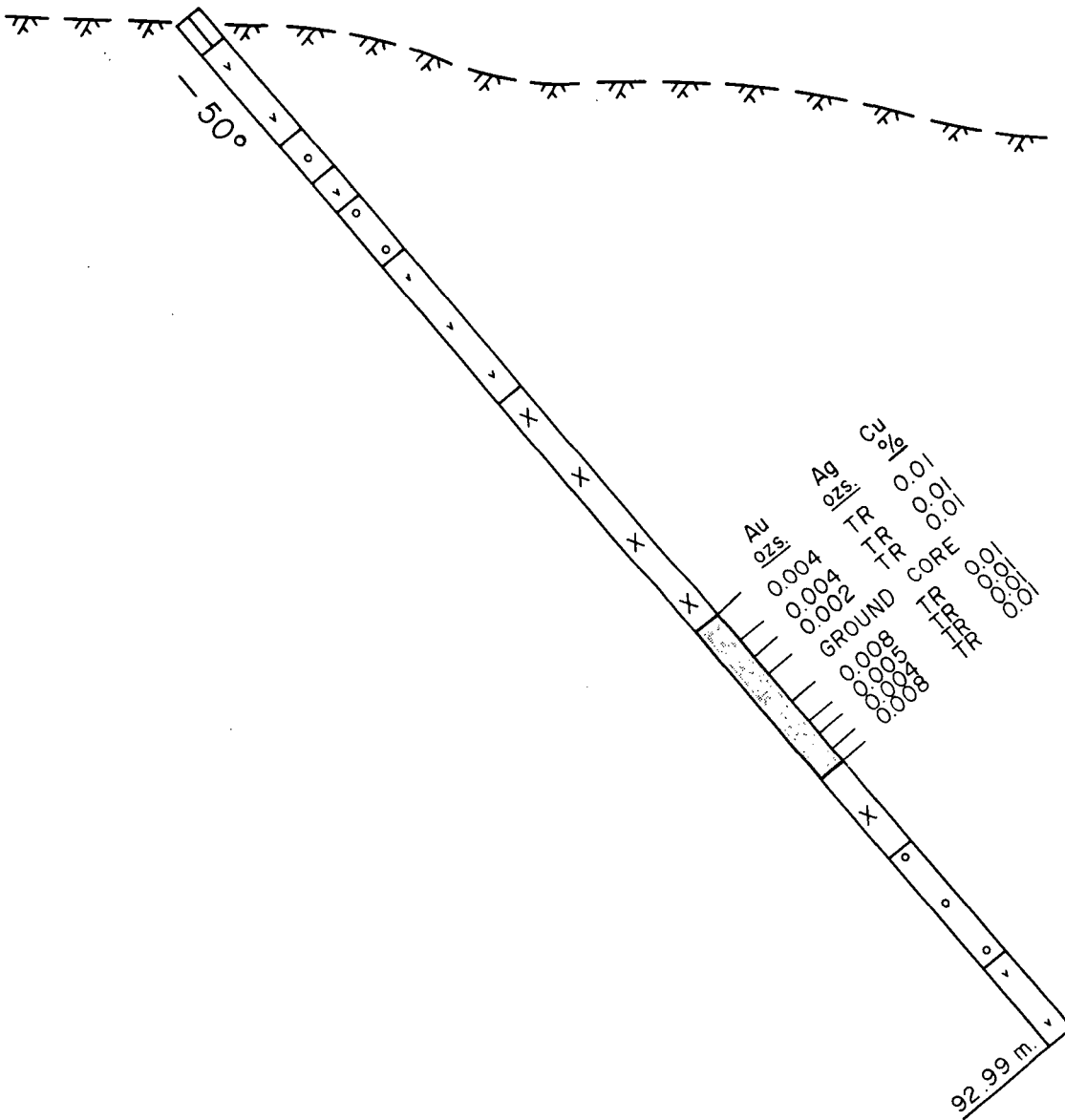

LEGEND



FAULT ZONE

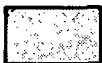

MASSIVE PYRITE

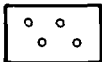

MAGNETITE-RICH ANDESITE

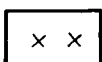

ANDESITE BRECCIA (PINK FRAGMENT PHASE)

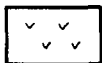

ANDESITE BRECCIA

FIGURE 7

D.D. HOLE A-1-81

SECTION LOOKING NORTH

SCALE 1:500

SEPTEMBER 21, 1981

Donald W. Hilby

showed a low gold content with no silver and negligible copper content.

Massive, medium grained (0.5 - 1 mm) pyrite occurs with a phase of the metamorphosed andesitic lava that carries pink trachyte-like fragments. Most of the fragments are less than two centimetres in dimension but on occasion larger ones are in evidence in the core from diamond drill holes, 1, 2, 3 and 6, 7.

The paragenesis of the alteration-mineralization sequence in the volcanic rocks appears to be epidote, magnetite and pyrite.



RESULTS OF THE 1981 PROGRAM OF DIAMOND DRILL PROGRAM

Seven BQ core size diamond drill holes were drilled on the SOL mineral claim during the period July 13 through August 17, 1981 by Tri-Mac Drilling Ltd., Suite 707, 543 Granville Street, Vancouver, British Columbia. The drill hole locations are shown on Figures 5 and 6. One of these holes, #5, did not penetrate the local deep overburden to bedrock.

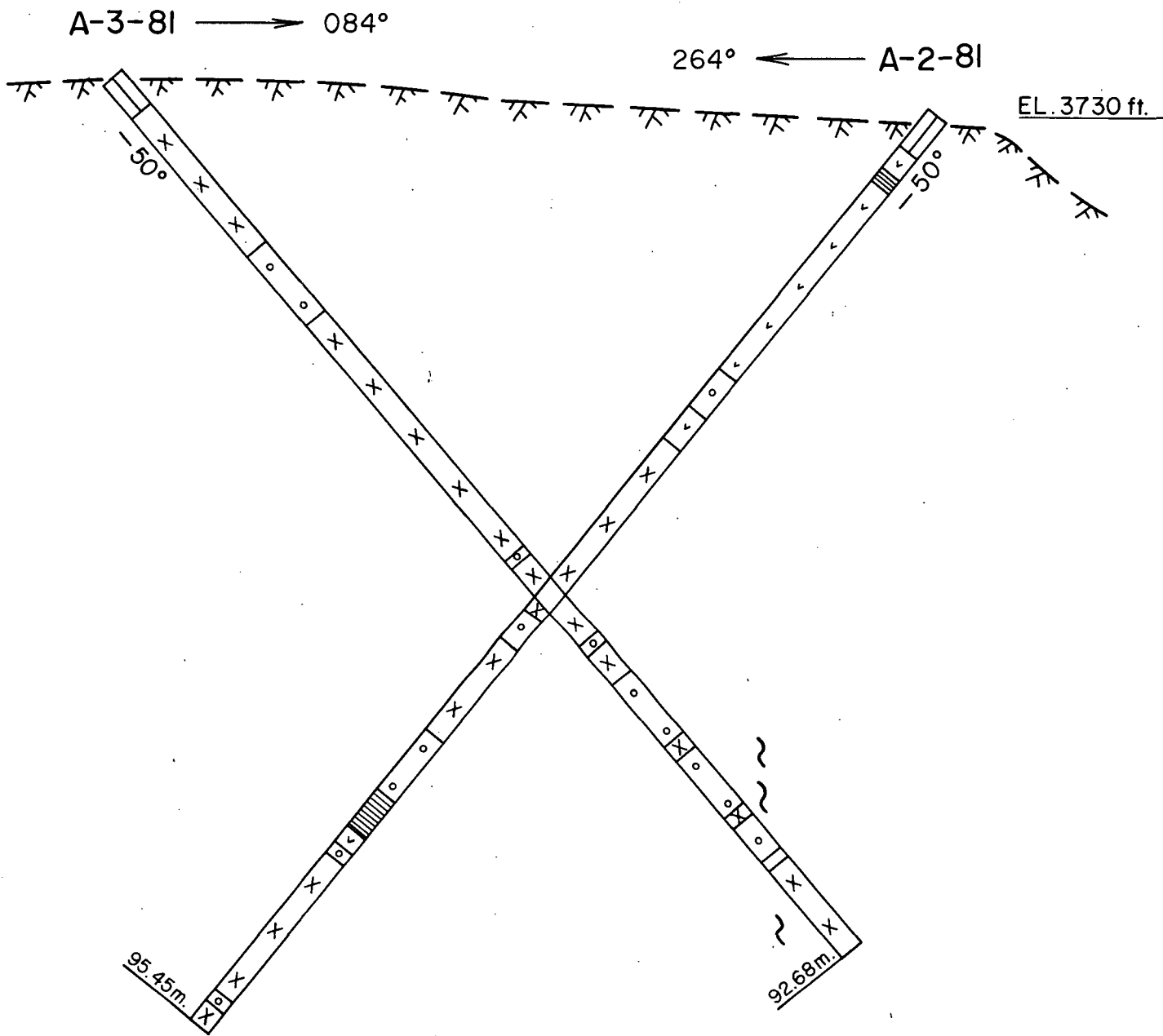
A summary of the diamond drill holes is as follows:

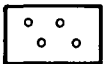
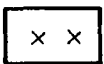

LEGEND

- ~ ~ FAULT ZONE
-  MASSIVE PYRITE
-  MAGNETITE-RICH ANDESITE
-  ANDESITE BRECCIA (PINK FRAGMENT PHASE)
-  ANDESITE BRECCIA
-  PINK TRACHYTE



Donald W. Hilby

FIGURE 8

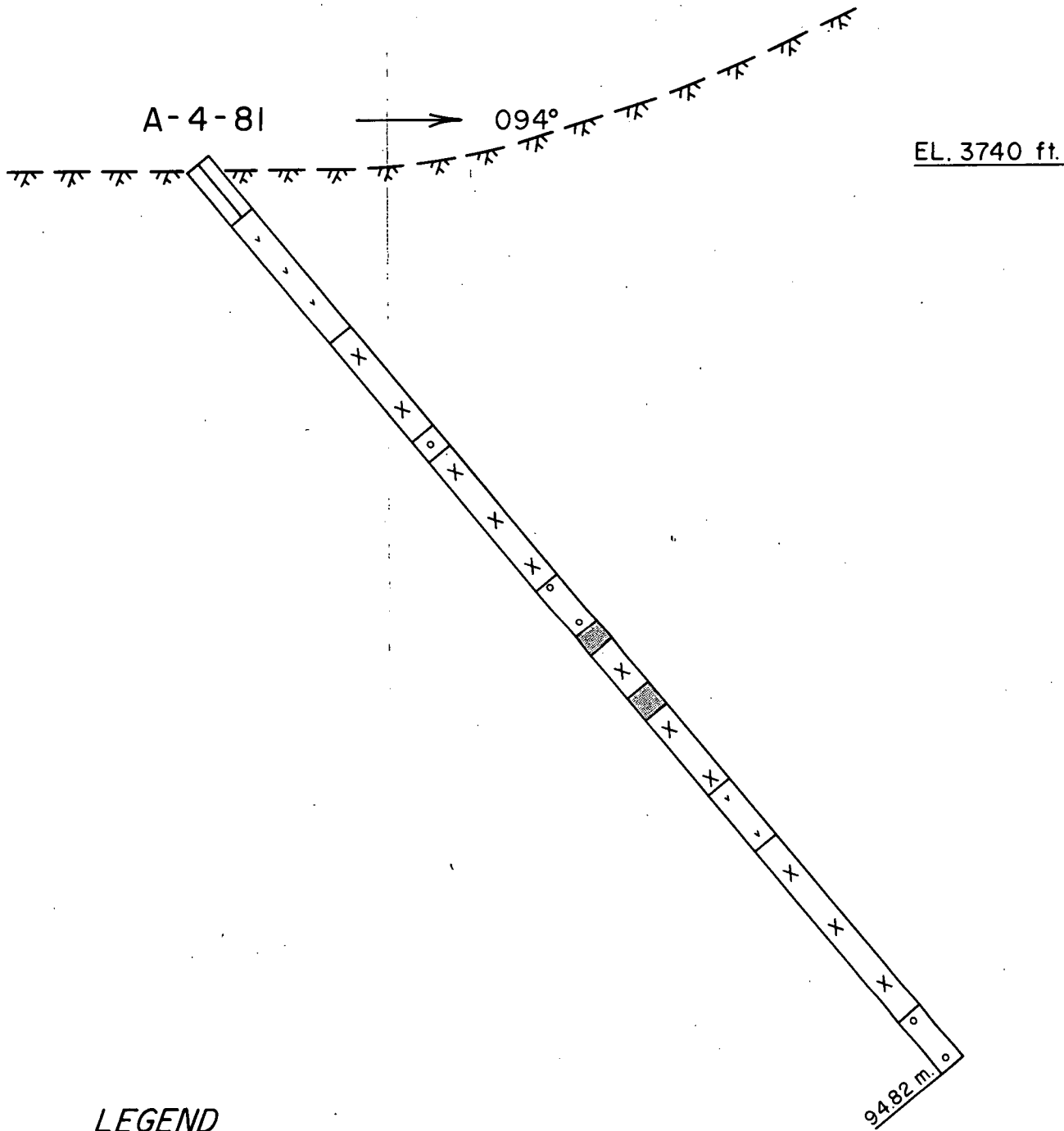
D.D. HOLE A-2-81, A-3-81
SECTION LOOKING NORTH
SCALE 1:500
SEPTEMBER 21, 1981

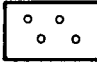
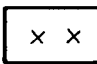

LEGEND

- ~ ~ FAULT ZONE
-  MASSIVE PYRITE
-  MAGNETITE-RICH ANDESITE
-  ANDESITE BRECCIA (PINK FRAGMENT PHASE)
-  ANDESITE BRECCIA

 Donald W. Kelly

FIGURE 9
 D.D. HOLE A-4-81
 SECTION LOOKING NORTH
 SCALE 1:500
 SEPTEMBER 21, 1981

DDH #	Direc- tion	Dip	Depth	Assay Results		Gold/ozs	Remarks	
				From	To			
A-1-81	070°	50°	92.99m	55.40m	68.60m	0.005	13.20 metres of massive pyrite	
A-2-81	264°	50°	95.45m	71.34m	75.00m		3.66 metres of magnetite-epidote skarn	
A-3-81	084°	50°	92.68m					
A-4-81	094°	50°	94.82m				Two narrow zones of massive pyrite	
A-5-81	090°	50°	17.98m				Overburden found to be impenetrable with the equipment on hand.	
A-6-81	062°	50°	106.71m				3.6 metres of 30% pyrite	
A-7-81	138°	50°	115.55m	39.32m	40.24m	0.005	0.92 metres massive pyrite	
			<u>616.18m (2,021 feet)</u>					

TIME - COST DISTRIBUTION

The drilling was done in the period July 13 through August 17, 1981.

An audited statement of the expenditures covering program of diamond drilling is not available from the company auditors at the time of this writing.

It is known the cost of the diamond drilling was \$28.00 per foot or \$91.84 per metre with extra cost-plus charges for penetrating overburden.

Respectfully submitted,

Donald W. Tully

September 21, 1981

Donald W. Tully, P. Eng.

A-6-81 → 062°

EL. 3740 ft.

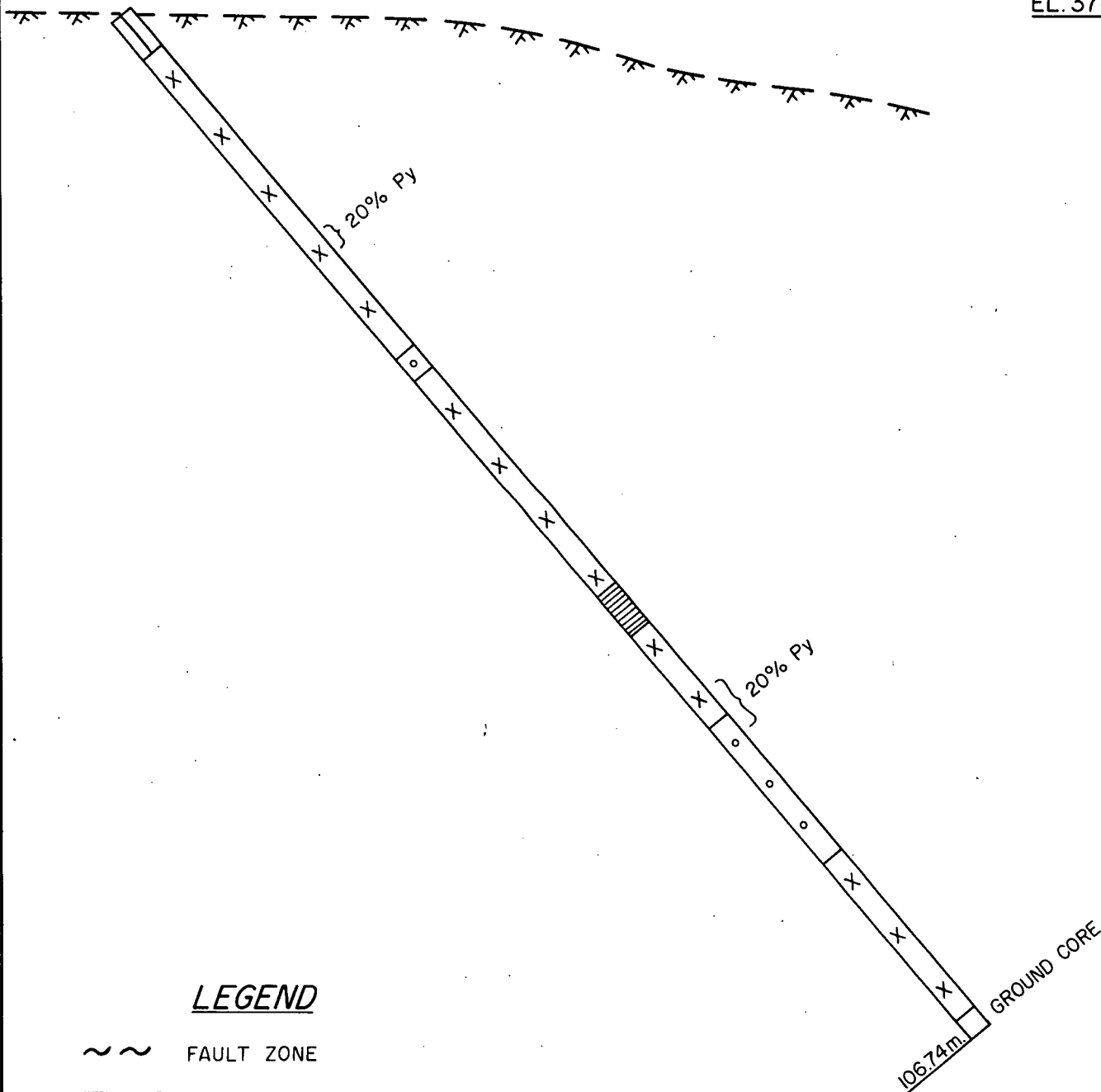

LEGEND

~~~~ FAULT ZONE

 MASSIVE PYRITE

 MAGNETITE-RICH ANDESITE

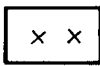
 ANDESITE BRECCIA (PINK FRAGMENT PHASE)

 ANDESITE BRECCIA

 PINK TRACHYTE

FIGURE 10

D.D. HOLE A-6-81

SECTION LOOKING  
NORTHWEST



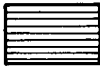

SCALE 1:500

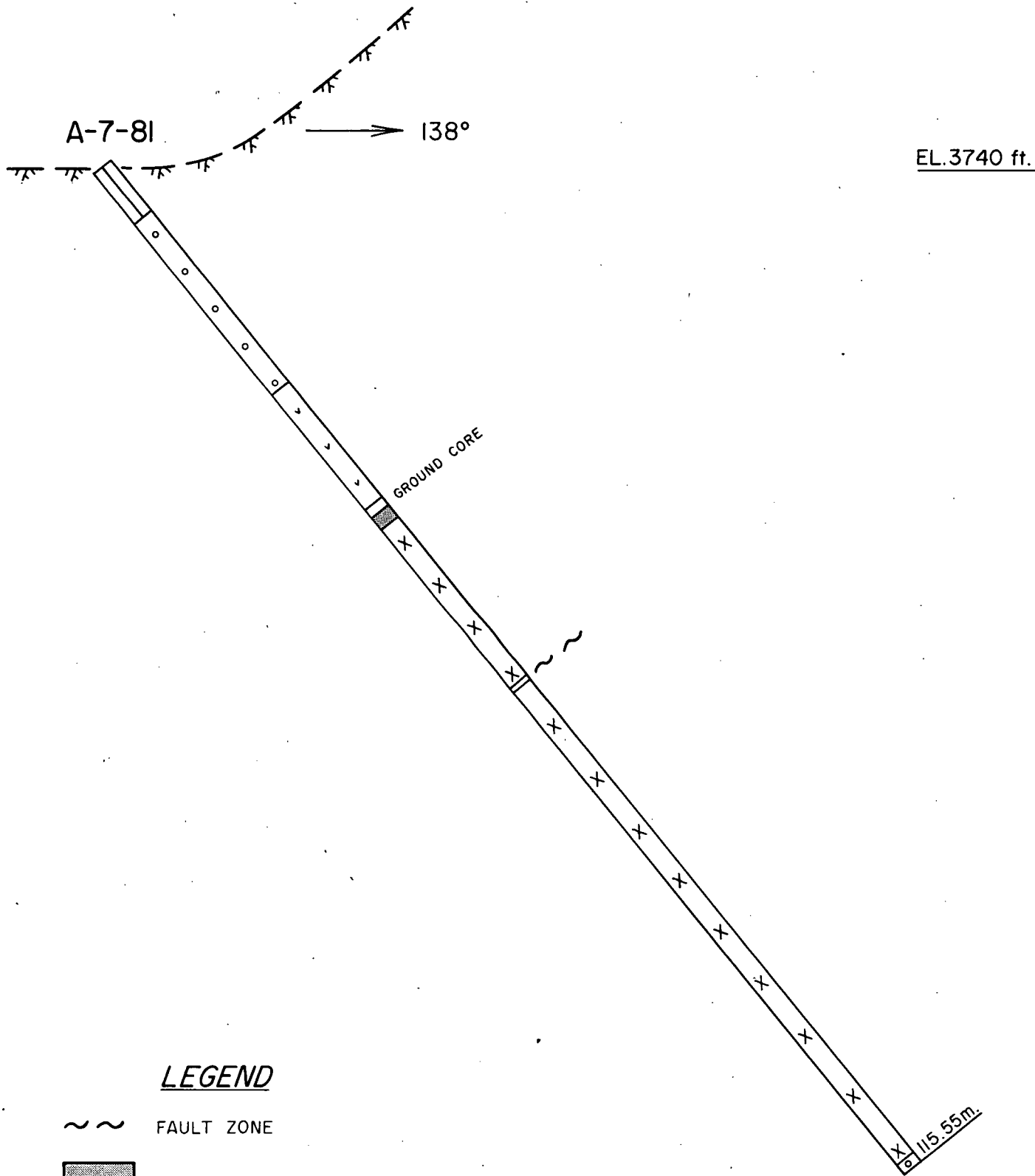
SEPTEMBER 21, 1981

*Donald W. Kelly*

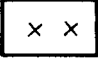

**LEGEND**

- ~ ~ FAULT ZONE
-  MASSIVE PYRITE
-  MAGNETITE-RICH ANDESITE
-  ANDESITE BRECCIA (PINK FRAGMENT PHASE)
-  ANDESITE BRECCIA

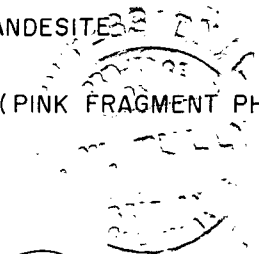

*Donald W. Hilby*

FIGURE II

D.D. HOLE A-7-81

SECTION LOOKING NORTHEAST

SCALE 1:500

SEPTEMBER 21, 1981

CERTIFICATE

I, DONALD WILLIAM TULLY, of the City of West Vancouver, Province of British Columbia, hereby certify as follows:

- 1) I am a Consulting Geologist with an office at Suite 102, 2222 Bellevue Avenue, West Vancouver, B.C.
- 2) I am a registered Professional Engineer of the Provinces of British Columbia and Ontario.
- 3) I graduated with a degree of Bachelor of Science, Honours Geology, from McGill University in 1943.
- 4) I have practiced my profession for thirty-six years.
- 5) I have no direct, indirect or contingent interest in the SOL (703) mineral claim, nor the securities of Abaton Resources Ltd., subject of this report, nor do I intend to have any interest.
- 6) This report dated September 21, 1981, is based on personal field examinations I have made on the job-site on June 23, July 15, 21, 29, August 8, 23 and September 6, 7, 1981, and from information gathered from available maps and reports.
- 7) Written permission from the author is required to publish this report dated September 21, 1981 in any Prospectus or Statement of Material Facts.

DATED at West Vancouver, Province of British Columbia, this 28th day of September, 1981.

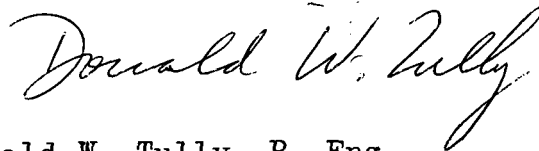

Donald W. Tully, P. Eng.,  
Consulting Geologist

ABATON RESOURCES LTD.  
 SOL mineral claim  
(Drilling report #81 - #719)

Itemized cost statement - 1981 diamond drill program

|                                       | <u>Ck. #</u> | <u>Amount</u>    | <u>Total</u>  |
|---------------------------------------|--------------|------------------|---------------|
| Diamond drilling -                    |              |                  |               |
| Tri-Mac Drilling Ltd.                 | 170          | \$ 20,000.00     |               |
| "      "      "                       | 171          | 38,689.96        |               |
| "      "      "                       | 185          | <u>21,700.00</u> | \$ 80,389.96  |
| Cat work -                            |              |                  |               |
| Macal Services Ltd.                   | 172          | 10,455.55        |               |
| "      "      "                       | 173          | 607.94           |               |
| Tri-Mac Drilling Ltd.                 | 175          | 1,634.60         |               |
| Macal Services Ltd.                   | 186          | <u>4,080.00</u>  | 16,778.09     |
| Room and board (drill crew) -         |              |                  |               |
| Valnicola Hotel                       | 169          | 1,660.51         |               |
| Valnicola Hotel                       | 181          | 3,566.57         |               |
| Valnicola Hotel                       | 189          | <u>237.01</u>    | 5,464.09      |
| 4 x 4 truck rental, gas and repairs - |              |                  |               |
| Denu Mines & Development              | 177          | 3,143.55         |               |
| Dearborn Motors                       | 177          | 875.00           |               |
| Marcel Carriere                       | 188          | <u>1,575.00</u>  | 5,593.55      |
| Engineering -                         |              |                  |               |
| Don Tully (report)                    | 180          | 1,365.38         |               |
| Don Tully                             | 180          | <u>4,592.76</u>  | 5,958.14      |
| Government fees -                     |              |                  |               |
| B.C. Mining Rec. #162294E             | 180          |                  | 1,520.00      |
| Assaying -                            |              |                  |               |
| General Testing Labs                  | 180          |                  | 234.50        |
| Travel -                              |              |                  |               |
| Dennis Vigouret                       | 183          | 47.25            |               |
| "      "                              | 11-1         | <u>462.47</u>    | <u>509.72</u> |
| Total                                 |              |                  | \$ 116,448.05 |

Vancouver, B.C.  
 December 14, 1981

APPENDIX

DON TULLY ENGINEERING LTD.  
SUITE 102 - 2222 BELLEVUE AVENUE  
WEST VANCOUVER, BRITISH COLUMBIA  
V7V 1C7



HOLE No. A-1-81

COMPANY ABATON RESOURCES LTD.

HOLE DEPTH 92.99m (305 ft.)

CLAIM SOL

DIAMOND DRILL CORE LOG - SAMPLE RECORD

CORE SIZE 36 mm

Loc'n Unit 2E - 25  
PROPERTY

HOLE DIRECTION 070°

DIP 50°

collar ELEV. 3740 ft. PAGE No. 1 of 2

| LENGTH IN METRES |       | DESCRIPTION                                                                                  | MINERALIZATION | SAMPLE No. | ABBAYS |    |        |        |        |      |
|------------------|-------|----------------------------------------------------------------------------------------------|----------------|------------|--------|----|--------|--------|--------|------|
| FROM             | TO    |                                                                                              |                |            | From   | To | Length | AU GZR | AG GZR | EN   |
| 0.0              | 2.44  | Casing                                                                                       |                |            |        |    |        |        |        |      |
|                  | 7.32  | Andesite, with epidote skarn and breccia, very blocky ground with limonite on fracture faces |                |            |        |    |        |        |        |      |
|                  | 10.98 | Andesite and breccia with epidote skarn                                                      |                |            |        |    |        |        |        |      |
|                  | 14.02 | Magnetite-rich phase of andesite (massive) with CaSO <sub>4</sub> veinlets at 14.02 m        |                |            |        |    |        |        |        |      |
|                  | 16.77 | Andesite breccia with zones of epidote skarn                                                 |                |            |        |    |        |        |        |      |
|                  | 21.65 | Magnetite-rich phase of andesite (massive)                                                   |                |            |        |    |        |        |        |      |
|                  | 55.18 | Andesite breccia with pink fragments, epidote skarn and disseminated pyrite                  |                |            |        |    |        |        |        |      |
|                  | 57.62 | Massive pyrite, granular, medium grain (1 mm)                                                |                | 999R       |        |    | 0.004  | Tr     |        | 0.01 |
|                  | 59.15 | Massive pyrite, granular, medium grain (1 mm)                                                |                | 1000R      |        |    | 0.004  | Tr     |        | 0.01 |
|                  | 60.37 | Massive pyrite, granular, medium grain (1 mm)                                                |                | 776R       |        |    | 0.002  | Tr     |        | 0.01 |
|                  | 63.41 | Ground core                                                                                  |                |            |        |    |        |        |        |      |
|                  | 64.94 | Massive pyrite as above samples                                                              |                | 777R       |        |    | 0.008  | Tr     |        | 0.01 |
|                  | 66.16 | Massive pyrite as above samples                                                              |                | 778R       |        |    | 0.005  | Tr     |        | 0.01 |
|                  | 67.68 | Massive pyrite as above samples                                                              |                | 779R       |        |    | 0.004  | Tr     |        | 0.01 |
|                  | 68.60 | Massive pyrite with epidote skarn inclusions (25%)                                           |                | 780R       |        |    | 0.008  | Tr     |        | 0.01 |
|                  | 75.61 | Andesite breccia, pink fragments, epidote skarn, diss.py.                                    |                |            |        |    |        |        |        |      |

LEGEND

Note: Core stored at collar of hole

C/A - CORE AXIS  
Bx - BRECCIATED  
NA - NOT ASSAYED  
Dis. - DISSEMINATED  
f.g. - fine-grained  
m.g. - med. grained

py - PYRITE  
Mg - MAGNETITE  
Pb - GALENA  
Zn - SPHALERITE  
Po - PYRRHOTITE

CORE Logged by: D.W. Tully, P. Eng.  
CORE Split by: D.W. Tully, P. Eng.  
HOLE STARTED: July 13, 1981  
HOLE FINISHED: July 15, 1981

HOLE No. A-1-81

COMPANY ABATON RESOURCES LTD.

HOLE DEPTH 92.99m (305 ft.)

CORE SIZE 36 mm

HOLE DIRECTION 070°

CLAIM SOL

DIAMOND DRILL CORE LOG - SAMPLE RECORD

DIP 50°

LOC'n Unit 2E - 2S

collar ELEV.

PAGE No. 2 of 2

| LENGTH IN METRES |       | DESCRIPTION                                              | MINERALIZATION | SAMPLE No. | ABBATS |    |        |        |        |    |
|------------------|-------|----------------------------------------------------------|----------------|------------|--------|----|--------|--------|--------|----|
| FROM             | TO    |                                                          |                |            | From   | To | Length | AU OZS | AG OZS | EN |
| 75.61            | 85.67 | Magnetite-rich andesite (massive)                        |                |            |        |    |        |        |        |    |
|                  | 90.24 | Andesite breccia                                         |                |            |        |    |        |        |        |    |
|                  | 91.77 | Andesite breccia with epidote skarn, disseminated pyrite |                |            |        |    |        |        |        |    |
|                  | 92.99 | Andesite breccia as above sample                         |                |            |        |    |        |        |        |    |
|                  |       | END OF HOLE                                              |                |            |        |    |        |        |        |    |
|                  |       |                                                          |                |            |        |    |        |        |        |    |
|                  |       |                                                          |                |            |        |    |        |        |        |    |
|                  |       |                                                          |                |            |        |    |        |        |        |    |
|                  |       |                                                          |                |            |        |    |        |        |        |    |
|                  |       |                                                          |                |            |        |    |        |        |        |    |
|                  |       |                                                          |                |            |        |    |        |        |        |    |
|                  |       |                                                          |                |            |        |    |        |        |        |    |
|                  |       |                                                          |                |            |        |    |        |        |        |    |
|                  |       |                                                          |                |            |        |    |        |        |        |    |
|                  |       |                                                          |                |            |        |    |        |        |        |    |
|                  |       |                                                          |                |            |        |    |        |        |        |    |
|                  |       |                                                          |                |            |        |    |        |        |        |    |
|                  |       |                                                          |                |            |        |    |        |        |        |    |
|                  |       |                                                          |                |            |        |    |        |        |        |    |
|                  |       |                                                          |                |            |        |    |        |        |        |    |
|                  |       |                                                          |                |            |        |    |        |        |        |    |
|                  |       |                                                          |                |            |        |    |        |        |        |    |
|                  |       |                                                          |                |            |        |    |        |        |        |    |

LEGEND

Note: Core stored at collar of hole

- C/A - CORE AXIS
- Bx - BRECCIATED
- NA - NOT ASSAYED
- Dis. - DISSEMINATED
- f.g. - fine-grained
- m.g. - med. grained

- py - PYRITE
- Mg - MAGNETITE
- Pb - GALENA
- Zn - SPHALERITE
- Po - PYRRHOTITE

CORE Logged by: D.W. Tully, P.Eng.  
 CORE Split by: D.W. Tully, P.Eng.  
 HOLE STARTED: July 13, 1981  
 HOLE FINISHED: July 15, 1981

HOLE No. A-2-81

COMPANY ABATON RESOURCES LTD.

HOLE DEPTH 95.45m (313 ft.)

CLAIM SOL

CORE SIZE 36 mm

Loc'n Unit 2E - 2S

DIAMOND DRILL CORE LOG - SAMPLE RECORD

HOLE DIRECTION 264°

DIP 50°

collar ELEV. 3700 ft. PAGE No. 1 of 2

| LENGTH IN METRES |       | DESCRIPTION                                                                                        | MINERALIZATION | SAMPLE No. | ASSAYS |    |        |        |        |    |      |
|------------------|-------|----------------------------------------------------------------------------------------------------|----------------|------------|--------|----|--------|--------|--------|----|------|
| FROM             | TO    |                                                                                                    |                |            | From   | To | Length | AU OZS | AG OZS | KN | CU % |
| 0.0              | 3.96  | Casing                                                                                             |                |            |        |    |        |        |        |    |      |
|                  | 6.10  | Andesite breccia with epidote skarn, very blocky, limonite on fracture planes, disseminated pyrite |                |            |        |    |        |        |        |    |      |
|                  | 7.32  | Pink Trachyte dyke or volcanic block fragment, very blocky                                         |                |            |        |    |        |        |        |    |      |
|                  | 27.13 | Andesite breccia with epidote skarn, blocky, diss. py.                                             |                |            |        |    |        |        |        |    |      |
|                  | 31.10 | Magnetite-rich phase of andesite (massive) some epidote and disseminated pyrite                    |                |            |        |    |        |        |        |    |      |
|                  | 34.15 | Andesite breccia with epidote skarn and dissem. pyrite.                                            |                |            |        |    |        |        |        |    |      |
|                  | 52.44 | Pink altered breccia zone with epidote skarn, diss. py.                                            |                |            |        |    |        |        |        |    |      |
|                  | 55.18 | Magnetite-rich andesite (massive)                                                                  |                |            |        |    |        |        |        |    |      |
|                  | 64.94 | Pink altered breccia zone as above section                                                         |                |            |        |    |        |        |        |    |      |
|                  | 71.34 | Magnetite-rich andesite (massive)                                                                  |                |            |        |    |        |        |        |    |      |
|                  | 72.87 | Pink altered trachyte magnetite-rich zone with sparse disseminated pyrite                          |                | 791R       |        |    | 0.002  | Tr     | 0.01   |    |      |
|                  | 74.39 | Pink altered trachyte magnetite-rich zone with sparse disseminated pyrite                          |                | 792R       |        |    | 0.002  | Tr     | 0.01   |    |      |
|                  | 75.00 | Pink altered trachyte magnetite-rich zone with sparse disseminated pyrite                          |                | 793R       |        |    | 0.002  | Tr     | 0.01   |    |      |

LEGEND

C/A - CORE AXIS  
 Bx - BRECCIATED  
 NA - NOT ASSAYED  
 Diss. - DISSEMINATED  
 f.g. - fine-grained  
 m.g. - med. grained

NOTE: Core stored at collar of hole

py - PYRITE  
 Mg - MAGNETITE  
 Pb - GALENA  
 Zn - SPHALERITE  
 Po - PYRRHOTITE

CORE Logged by: D.W. Tully, P.Eng.  
 CORE Split by: D.W. Tully, P.Eng.  
 HOLE STARTED: July 15, 1981  
 HOLE FINISHED: July 25, 1981

HOLE No. A-2-81

CLAIM SOL

Loc'n Unit 2E - 2S  
PROPERTY

COMPANY ABATON RESOURCES LTD.

DIAMOND DRILL CORE LOG - SAMPLE RECORD

HOLE DEPTH 95.45m (313 ft.)

CORE SIZE 36 mm

HOLE DIRECTION 264°

DIP 50°

collar ELEV. 3700 ft PAGE No. 2 of 2

| LENGTH IN METRES |       | DESCRIPTION                                              | MINERALIZATION | SAMPLE No. | ASSAYS |    |        |    |    |    |
|------------------|-------|----------------------------------------------------------|----------------|------------|--------|----|--------|----|----|----|
| FROM             | TO    |                                                          |                |            | From   | To | Length | AU | AG | EN |
| 75.00            | 76.52 | Andesite breccia with epidote skarn zones                |                |            |        |    |        |    |    |    |
|                  | 77.13 | Magnetite-rich andesite (massive)                        |                |            |        |    |        |    |    |    |
|                  | 92.07 | Andesite breccia with pink fragments, epidote, diss. py. |                |            |        |    |        |    |    |    |
|                  | 93.29 | Magnetite-rich andesite (massive)                        |                |            |        |    |        |    |    |    |
|                  | 95.43 | Andesite breccia with pink fragments, blocky             |                |            |        |    |        |    |    |    |
|                  |       | END OF HOLE                                              |                |            |        |    |        |    |    |    |
|                  |       |                                                          |                |            |        |    |        |    |    |    |
|                  |       |                                                          |                |            |        |    |        |    |    |    |
|                  |       |                                                          |                |            |        |    |        |    |    |    |
|                  |       |                                                          |                |            |        |    |        |    |    |    |
|                  |       |                                                          |                |            |        |    |        |    |    |    |
|                  |       |                                                          |                |            |        |    |        |    |    |    |
|                  |       |                                                          |                |            |        |    |        |    |    |    |
|                  |       |                                                          |                |            |        |    |        |    |    |    |
|                  |       |                                                          |                |            |        |    |        |    |    |    |
|                  |       |                                                          |                |            |        |    |        |    |    |    |
|                  |       |                                                          |                |            |        |    |        |    |    |    |
|                  |       |                                                          |                |            |        |    |        |    |    |    |
|                  |       |                                                          |                |            |        |    |        |    |    |    |
|                  |       |                                                          |                |            |        |    |        |    |    |    |
|                  |       |                                                          |                |            |        |    |        |    |    |    |
|                  |       |                                                          |                |            |        |    |        |    |    |    |
|                  |       |                                                          |                |            |        |    |        |    |    |    |
|                  |       |                                                          |                |            |        |    |        |    |    |    |

LEGEND

C/A - CORE AXIS  
 Bx - BRECCIATED  
 NA - NOT ASSAYED  
 Dias - DISSEMINATED  
 f.g. - fine-grained  
 m.g. - med. grained

NOTE: Core stored at collar of hole

py - PYRITE  
 Mg - MAGNETITE  
 Pb - GALENA  
 Zn - SPHALERITE  
 Po - PYRRHOTITE

CORE Logged by: D.W. Tully, P.Eng.  
 CORE Split by: D.W. Tully, P.Eng.  
 HOLE STARTED: July 15, 1981  
 HOLE FINISHED: July 25, 1981

HOLE No. A-3-81

COMPANY ABATON RESOURCES LTD.

HOLE DEPTH 92.68m (304 ft.)

CLAIM SOL

DIAMOND DRILL CORE LOG - SAMPLE RECORD

CORE SIZE 36 mm

Loc'n

HOLE DIRECTION 084°

PROPERTY 2E - 25

collar ELEV. 3725 ft. PAGE No. 1 of 1

| LENGTH IN METRES |       | DESCRIPTION                                               | MINERALIZATION | SAMPLE No. | ASSAYS |    |        |    |    |    |    |
|------------------|-------|-----------------------------------------------------------|----------------|------------|--------|----|--------|----|----|----|----|
| FROM             | TO    |                                                           |                |            | From   | To | Length | AU | AG | CN | CU |
| 0.0              | 3.65  | Casing                                                    |                |            |        |    |        |    |    |    |    |
|                  | 18.29 | Andesite breccia with pink fragments, epidote skarn and   |                |            |        |    |        |    |    |    |    |
|                  |       | diss. py. (10%) @ 4.3 - 4.6 m                             |                |            |        |    |        |    |    |    |    |
|                  |       | 5.9 - 6.4                                                 |                |            |        |    |        |    |    |    |    |
|                  |       | 13.4 - 14.1                                               |                |            |        |    |        |    |    |    |    |
| 25.61            |       | Andesite breccia with abundant magnetite and epi. skarn   |                |            |        |    |        |    |    |    |    |
| 50.30            |       | Andesite breccia with pink fragments, epidote & diss. py. |                |            |        |    |        |    |    |    |    |
| 51.22            |       | Magnetite-rich andesite                                   |                |            |        |    |        |    |    |    |    |
| 59.75            |       | Andesite breccia with pink fragments & epi., dissem. py.  |                |            |        |    |        |    |    |    |    |
| 60.37            |       | Magnetite-rich andesite                                   |                |            |        |    |        |    |    |    |    |
| 63.72            |       | Andesite breccia with pink fragments, epidote, diss. py.  |                |            |        |    |        |    |    |    |    |
| 70.12            |       | Magnetite-rich andesite                                   |                |            |        |    |        |    |    |    |    |
| 71.65            |       | Andesite breccia with pink fragments & epidote, diss. py. |                |            |        |    |        |    |    |    |    |
| 77.74            |       | Magnetite-rich andesite                                   |                |            |        |    |        |    |    |    |    |
| 78.66            |       | Andesite breccia with pink fragments & epidote, diss. py. |                |            |        |    |        |    |    |    |    |
| 82.31            |       | Magnetite-rich andesite                                   |                |            |        |    |        |    |    |    |    |
| 82.92            |       | Fault zone @ 20° c/a                                      |                |            |        |    |        |    |    |    |    |
| 92.68            |       | Andesite breccia with pink fragments, epidote, diss. py.  |                |            |        |    |        |    |    |    |    |
|                  |       | END OF HOLE                                               |                |            |        |    |        |    |    |    |    |

LEGEND

NOTE: Core stored at collar of hole

C/A - CORE AXIS  
 Bx - BRECCIATED  
 NA - NOT ASSAYED  
 Diss. - DISSEMINATED  
 f.g. - fine-grained  
 m.g. - med. grained

py - PYRITE  
 Mg - MAGNETITE  
 Pb - GALENA  
 Zn - SPHALERITE  
 Po - PYRRHOTITE

CORE Logged by: D.W. Tully, P. Eng.  
 CORE Split by: D.W. Tully, P. Eng.  
 HOLE STARTED: July 15, 1981  
 HOLE FINISHED: Aug. 1, 1981

HOLE No. A-4-81

COMPANY ABATON RESOURCES LTD.

HOLE DEPTH 94.82m (311 ft)

CLAIM SOL

**DIAMOND DRILL CORE LOG - SAMPLE RECORD**

CORE SIZE 36 mm

HOLE DIRECTION 094°

Loc'n 2E - 25  
PROPERTY

DIP 50°

collar ELEV 3740 ft. PAGE No. 1 of 1

| LENGTH IN METRES |       | DESCRIPTION                                                                               | MINERALIZATION | SAMPLE No. | ASSAYS |    |        |        |        |      |      |
|------------------|-------|-------------------------------------------------------------------------------------------|----------------|------------|--------|----|--------|--------|--------|------|------|
| FROM             | TO    |                                                                                           |                |            | From   | To | Length | AU OZS | AG OZS | KN   | CU % |
| 0.0              | 5.48  | Casing                                                                                    |                |            |        |    |        |        |        |      |      |
|                  | 17.99 | Andesite breccia, magnetite and epidote skarn, diss. py.                                  |                |            |        |    |        |        |        |      |      |
|                  | 28.35 | As above section, with pink fragments                                                     |                |            |        |    |        |        |        |      |      |
|                  | 30.18 | Epidote zone with 10% diss. py. and fine (1-2 mm) seams py                                |                |            |        |    |        |        |        |      |      |
|                  | 38.41 | Andesite breccia with pink fragments, epidote and magnetite skarn and disseminated pyrite |                |            |        |    |        |        |        |      |      |
|                  | 39.02 | As above section with 10% disseminated pyrite                                             | 579R           |            |        |    | 0.002  | Tr     |        | 0.01 |      |
|                  | 43.90 | As above section with disseminated pyrite                                                 |                |            |        |    |        |        |        |      |      |
|                  | 44.51 | Brown colored ferruginous zone with sparse dissem. pyrite                                 |                |            |        |    |        |        |        |      |      |
|                  | 50.30 | 80% mass. py. with epi. & quartz-calcite veinlets                                         | 577R           |            |        |    | 0.002  | Tr     |        | 0.03 |      |
|                  | 55.18 | Andesite breccia with pink fragments and dissem. pyrite                                   |                |            |        |    |        |        |        |      |      |
|                  | 57.62 | 90% massive pyrite with epidote                                                           | 578R           |            |        |    | 0.002  | Tr     |        | 0.02 |      |
|                  | 65.55 | Andesite breccia with pink fragments and dissem. pyrite                                   |                |            |        |    |        |        |        |      |      |
|                  | 71.34 | Andesite with sparse magnetite and abundant epidote                                       |                |            |        |    |        |        |        |      |      |
|                  | 89.02 | Andesite breccia with pink fragments, abundant epidote and disseminated pyrite            |                |            |        |    |        |        |        |      |      |
|                  | 94.82 | Andesite with magnetite and epidote, disseminated pyrite                                  |                |            |        |    |        |        |        |      |      |
|                  |       | END OF HOLE                                                                               |                |            |        |    |        |        |        |      |      |

LEGEND

C/A - CORE AXIS  
Bx - BRECCIATED  
NA - NOT ASSAYED  
Diss. - DISSEMINATED  
f.g. - fine-grained  
m.g. - med. grained

NOTE: Core stored at collar of hole

py - PYRITE  
Mg - MAGNETITE  
Pb - GALENA  
Zn - SPHALERITE  
Po - PYRRHOTITE

CORE Logged by: D.W. Tully, P.Eng.  
CORE Split by: D.W. Tully, P.Eng.  
HOLE STARTED: August 2, 1981  
HOLE FINISHED: August 5, 1981

HOLE No. A-5-81

CLAIM SOL

Loc'n PROPERTY 2E - 15

COMPANY ABATON RESOURCES LTD.

**DIAMOND DRILL CORE LOG - SAMPLE RECORD**

HOLE DEPTH 17.98 (59 ft.)

CORE SIZE 36 mm

HOLE DIRECTION 090°

DIP 50°

collar ELEV.3800 ft. PAGE No. 1 of 1

| LENGTH IN METRES |       | DESCRIPTION                                                                                                                                                   | MINERALIZATION | SAMPLE No. | ASSAYS |    |        |    |    |    |    |  |
|------------------|-------|---------------------------------------------------------------------------------------------------------------------------------------------------------------|----------------|------------|--------|----|--------|----|----|----|----|--|
| FROM             | TO    |                                                                                                                                                               |                |            | From   | To | Length | AU | AG | EN | CU |  |
| 0.0              | 17.98 | Casing (hole was drilled to 12 m and then tricone bits were used to attempt penetration of granitic boulders without success and hole was stopped at 17.98 m) |                |            |        |    |        |    |    |    |    |  |
|                  |       | END OF HOLE (no core)                                                                                                                                         |                |            |        |    |        |    |    |    |    |  |
|                  |       |                                                                                                                                                               |                |            |        |    |        |    |    |    |    |  |
|                  |       |                                                                                                                                                               |                |            |        |    |        |    |    |    |    |  |
|                  |       |                                                                                                                                                               |                |            |        |    |        |    |    |    |    |  |
|                  |       |                                                                                                                                                               |                |            |        |    |        |    |    |    |    |  |
|                  |       |                                                                                                                                                               |                |            |        |    |        |    |    |    |    |  |
|                  |       |                                                                                                                                                               |                |            |        |    |        |    |    |    |    |  |
|                  |       |                                                                                                                                                               |                |            |        |    |        |    |    |    |    |  |
|                  |       |                                                                                                                                                               |                |            |        |    |        |    |    |    |    |  |
|                  |       |                                                                                                                                                               |                |            |        |    |        |    |    |    |    |  |
|                  |       |                                                                                                                                                               |                |            |        |    |        |    |    |    |    |  |
|                  |       |                                                                                                                                                               |                |            |        |    |        |    |    |    |    |  |
|                  |       |                                                                                                                                                               |                |            |        |    |        |    |    |    |    |  |
|                  |       |                                                                                                                                                               |                |            |        |    |        |    |    |    |    |  |
|                  |       |                                                                                                                                                               |                |            |        |    |        |    |    |    |    |  |
|                  |       |                                                                                                                                                               |                |            |        |    |        |    |    |    |    |  |
|                  |       |                                                                                                                                                               |                |            |        |    |        |    |    |    |    |  |
|                  |       |                                                                                                                                                               |                |            |        |    |        |    |    |    |    |  |
|                  |       |                                                                                                                                                               |                |            |        |    |        |    |    |    |    |  |
|                  |       |                                                                                                                                                               |                |            |        |    |        |    |    |    |    |  |

LEGEND

C/A - CORE AXIS  
 Bx - BRECCIATED  
 N/A - NOT ASSAYED  
 Diss. - DISSEMINATED  
 f.g. - fine-grained  
 m.g. - med. grained

py - PYRITE  
 Mg - MAGNETITE  
 Pb - GALENA  
 Zn - SPHALERITE  
 Po - PYRRHOTITE

CORE Logged by: D.W. Tully, P.Eng.  
 CORE Split by: D.W. Tully, P.Eng.  
 HOLE STARTED: August 5, 1981  
 HOLE FINISHED: August 8, 1981

HOLE No. A-6-81

CLAIM SOL

Loc'n 2E - 25  
PROPERTY

COMPANY ABATON RESOURCES LTD.

DIAMOND DRILL CORE LOG - SAMPLE RECORD

HOLE DEPTH 106.71 m (350 ft.)

CORE SIZE 36 mm

HOLE DIRECTION 062°

DIP 50°

collar ELEV. 3740 ft. PAGE No. 1 of 1

| LENGTH IN METRES |        | DESCRIPTION                                                                                                                                        | MINERALIZATION | SAMPLE No. | ABBATS |    |        |    |    |    |    |
|------------------|--------|----------------------------------------------------------------------------------------------------------------------------------------------------|----------------|------------|--------|----|--------|----|----|----|----|
| FROM             | TO     |                                                                                                                                                    |                |            | From   | To | Length | AU | AG | ZN | CU |
| 0.0              | 3.96   | Casing                                                                                                                                             |                |            |        |    |        |    |    |    |    |
|                  | 35.06  | Andesite breccia, pink fragments, magnetite and epidote skarn, disseminated pyrite (20% pyrite 23.7 - 24.1) and fine splashes chalcopyrite at 32 m |                |            |        |    |        |    |    |    |    |
|                  | 37.20  | Magnetite-rich phase of massive andesite                                                                                                           |                |            |        |    |        |    |    |    |    |
|                  | 60.06  | Andesite breccia with pink fragments, magnetite, epidote skarn and disseminated pyrite (very blocky 49.4-50.0) (very blocky 53.7-56.1)             |                |            |        |    |        |    |    |    |    |
|                  | 64.33  | Pink trachyte type lava, f.g., blocky ground                                                                                                       |                |            |        |    |        |    |    |    |    |
|                  | 74.21  | Andesite breccia, pink fragments epidote and magnetite skarn with diss. py. (30% py 71.7 - 75.3)                                                   |                |            |        |    |        |    |    |    |    |
|                  | 88.41  | Magnetite-rich phase of andesite                                                                                                                   |                |            |        |    |        |    |    |    |    |
|                  | 104.88 | Andesite breccia with pink fragments, epidote, magnetite skarn, diss. py. (blocky 94.8 - 96.7)                                                     |                |            |        |    |        |    |    |    |    |
|                  | 106.71 | Ground core reported by driller                                                                                                                    |                |            |        |    |        |    |    |    |    |
|                  |        | END OF HOLE                                                                                                                                        |                |            |        |    |        |    |    |    |    |

LEGEND

C/A - CORE AXIS  
Bx - BRECCIATED  
NA - NOT ASSAYED  
Diss. - DISSEMINATED  
f.g. - fine-grained  
m.g. - med. grained

NOTE: Core stored at collar of hole

py - PYRITE  
Mg - MAGNETITE  
Pb - GALENA  
Zn - SPHALERITE  
Po - PYRRHOTITE

CORE Logged by: D.W. Tully, P.Eng.  
CORE Split by: D.W. Tully, P.Eng.  
HOLE STARTED: August 9, 1981  
HOLE FINISHED: August 12, 1981



HOLE No. A-7-81

CLAIM SOL

Loc'n  
PROPERTY 2E - 2S

COMPANY ABATON RESOURCES LTD.

**DIAMOND DRILL CORE LOG - SAMPLE RECORD**

HOLE DEPTH 115.55 m (379 ft)

CORE SIZE 36 mm

HOLE DIRECTION 138°

DIP 50°

collar ELEV.3740 ft. PAGE No. 1 of 1

| LENGTH IN METRES |        | DESCRIPTION                                                                      | MINERALIZATION | SAMPLE No. | ASSAYS |    |        |        |        |      |
|------------------|--------|----------------------------------------------------------------------------------|----------------|------------|--------|----|--------|--------|--------|------|
| FROM             | TO     |                                                                                  |                |            | From   | To | Length | AU OZS | AG OZS | ZN   |
| 0.0              | 5.79   | Casing                                                                           |                |            |        |    |        |        |        |      |
|                  | 7.93   | Magnetite-rich phase of andesite, very blocky                                    |                |            |        |    |        |        |        |      |
|                  | 8.54   | Andesite with epidote skarn and sparse disseminated pyrite                       |                |            |        |    |        |        |        |      |
|                  | 20.73  | Andesite breccia with magnetite and disseminated pyrite                          |                |            |        |    |        |        |        |      |
|                  | 26.22  | Andesite with epidote skarn, magnetite and sparse disseminated pyrite            |                |            |        |    |        |        |        |      |
|                  | 38.41  | Andesite breccia with magnetite and epidote skarn and disseminated pyrite        |                |            |        |    |        |        |        |      |
|                  | 39.02  | Lost core                                                                        |                |            |        |    |        |        |        |      |
|                  | 39.32  | Andesite breccia as last section                                                 |                |            |        |    |        |        |        |      |
|                  | 40.24  | Massive pyrite with epidote inclusions                                           |                | 576R       |        |    | 0.005  | 0.20   |        | 0.37 |
|                  | 59.15  | Andesite breccia with pink fragments, epidote and disseminated pyrite            |                |            |        |    |        |        |        |      |
|                  | 59.76  | Fault zone                                                                       |                |            |        |    |        |        |        |      |
|                  | 114.02 | Andesite breccia with pink fragments, epidote, magnetite and disseminated pyrite |                |            |        |    |        |        |        |      |
|                  | 115.55 | Andesite, epidote skarn and disseminated pyrite                                  |                |            |        |    |        |        |        |      |
|                  |        | END OF HOLE                                                                      |                |            |        |    |        |        |        |      |

LEGEND

C/A - CORE AXIS  
 Bx - BRECCIATED  
 N/A - NOT ASSAYED  
 Dis. - DISSEMINATED  
 f.g. - fine-grained  
 m.g. - med. grained

NOTE: Core stored at collar of hole

py - PYRITE  
 Mg - MAGNETITE  
 Pb - GALENA  
 Zn - SPHALERITE  
 Po - PYRRHOTITE

CORE Logged by: D.W. Tully, P.Eng.  
 CORE Split by: D.W. Tully, P.Eng.  
 HOLE STARTED: August 13, 1981  
 HOLE FINISHED: August 17, 1981



TO:  
 DON TULLY ENGINEERING  
 102 - 2222 Bellvue Ave.,  
 West Vancouver, B.C.  
 V7V 1C7  
 ABATON

# General Testing Laboratories

A Division of SGS Supervision Services Inc.

1001 EAST PENDER ST., VANCOUVER, B.C., CANADA, V6A 1W2  
 PHONE (604) 254-1647 TELEX 04-507514 CABLE: SUPERVISE

## CERTIFICATE OF ASSAY

No.: 8108-2457      DATE: Sept. 2/81

We hereby certify that the following are the results of assays on:      Ore

| MARKED | GOLD  | SILVER | Copper<br>Cu (%) | XXX      | XXX | XXX | XXX | XXX |
|--------|-------|--------|------------------|----------|-----|-----|-----|-----|
|        | oz/st | oz/st  |                  |          |     |     |     |     |
| 776 R  | 0.002 | trace  | 0.01             | } A-1-81 |     |     |     |     |
| 777 R  | 0.008 | trace  | 0.01             |          |     |     |     |     |
| 778 R  | 0.005 | trace  | 0.01             |          |     |     |     |     |
| 779 R  | 0.004 | trace  | 0.01             |          |     |     |     |     |
| 780R   | 0.008 | trace  | 0.01             |          |     |     |     |     |
| 999 R  | 0.004 | trace  | 0.01             |          |     |     |     |     |
| 1000 R | 0.004 | trace  | 0.01             |          |     |     |     |     |

REJECTS RETAINED ONE MONTH. PULPS RETAINED THREE MONTHS. ON REQUEST PULPS AND REJECTS WILL BE STORE FOR A MAXIMUM OF ONE YEAR.  
 ALL REPORTS ARE THE CONFIDENTIAL PROPERTY OF CLIENTS. PUBLICATION OF STATEMENTS, CONCLUSION OR EXTRACTS FROM OR REGARDING OUR REPORTS IN NOT PERMITTED WITHOUT OUR WRITTEN APPROVAL. ANY LIABILITY ATTACHED THERETO IS LIMITED TO THE FEE CHARGED.

L. Wong   
 PROVINCIAL ASSAYER

Analytical and Consulting Chemists, Bulk Cargo Specialists, Surveyors, Inspectors, Samplers, Weighers

MEMBER: American Society For Testing Materials • The American Oil Chemists Society • Canadian Testing Association  
 REFEREE AND OR OFFICIAL CHEMISTS FOR: National Institute of Oilseed Products • The American Oil Chemists' Society  
 OFFICIAL WEIGHMASTERS FOR: Vancouver Board Of Trade



# General Testing Laboratories

A Division of SGS Supervision Services Inc.

1001 EAST PENDER ST., VANCOUVER, B.C., CANADA, V6A 1W2  
 PHONE (604) 254-1647 TELEX 04-507514 CABLE: SUPERVISE

TO:  
 DON TULLY ENGINEERING LTD.  
 102 - 2222 Bellvue Avenue  
 West Vancouver, B.C.  
 V7V 1C7  
 ABATON

## CERTIFICATE OF ASSAY

No.: 8109-0865      DATE: Sept. 21/81

We hereby certify that the following are the results of assays on:      Ore

| MARKED | GOLD  | SILVER | Copper | XXX | XXX | XXX | XXX | XXX |
|--------|-------|--------|--------|-----|-----|-----|-----|-----|
|        | oz/st | oz/st  | Cu (%) |     |     |     |     |     |
| 576 R  | 0.005 | 0.20   | 0.37   |     |     |     |     |     |
| 577 R  | 0.002 | trace  | 0.03   |     |     |     |     |     |
| 578 R  | 0.002 | trace  | 0.02   |     |     |     |     |     |
| 579 R  | 0.002 | trace  | 0.01   |     |     |     |     |     |
| 791 R  | 0.002 | trace  | 0.01   |     |     |     |     |     |
| 792 R  | 0.002 | trace  | 0.01   |     |     |     |     |     |
| 793 R  | 0.002 | trace  | 0.01   |     |     |     |     |     |

NOTE: REJECTS RETAINED ONE MONTH. PULPS RETAINED THREE MONTHS. ON REQUEST PULPS AND REJECTS WILL BE STORE FOR A MAXIMUM OF ONE YEAR.  
 ALL REPORTS ARE THE CONFIDENTIAL PROPERTY OF CLIENTS. PUBLICATION OF STATEMENTS, CONCLUSION OR EXTRACTS FROM OR REGARDING OUR REPORTS IS NOT PERMITTED WITHOUT OUR WRITTEN APPROVAL. ANY LIABILITY ATTACHED THERETO IS LIMITED TO THE FEE CHARGED.

*L. Wong*  
 L. Wong

PROVINCIAL ASSAYER

Analytical and Consulting Chemists, Bulk Cargo Specialists, Surveyors, Inspectors, Samplers, Weighers

MEMBER: American Society For Testing Materials • The American Oil Chemists Society • Canadian Testing Association  
 REFEREE AND OR OFFICIAL CHEMISTS FOR: National Institute of Oilseed Products • The American Oil Chemists' Society  
 OFFICIAL WEIGHMASTERS FOR: Vancouver Board Of Trade