

81-# 767

PROSPECTING REPORT

TYPE OF PROSPECTING: Rock sampling, analyses and physical work needed  
(open-cuts, road improvement & under ground tunnel  
work)

Claim Involved: Tommy (Alberni Mining Division)  
50 km. south west of Port Alberni  
Lat. 49° 10' N., Long. 125° 24' W.

Operator: W. Ejtel

Supervision and  
Report by: W. Ejtel

Claim Held by: W. Ejtel

Dates Worked: September 18, 1980 to September 7, 1981 inclusive.

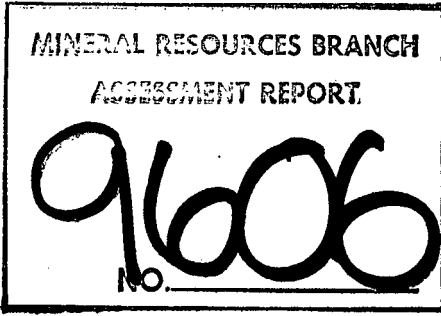

TABLE OF CONTENTS

PAGE 1

TITLE PAGE 1

TABLE OF CONTENTS PAGE 1

INDEX MAPS PAGES 1 & 2

INTRODUCTION PAGES 1 TO 6 INCLUSIVE

DATA PAGES 1 TO 23 INCLUSIVE

ITEMIZED COST STATEMENT PAGES 1 & 2

QUALIFICATIONS PAGE 1

500  
1000  
Metres

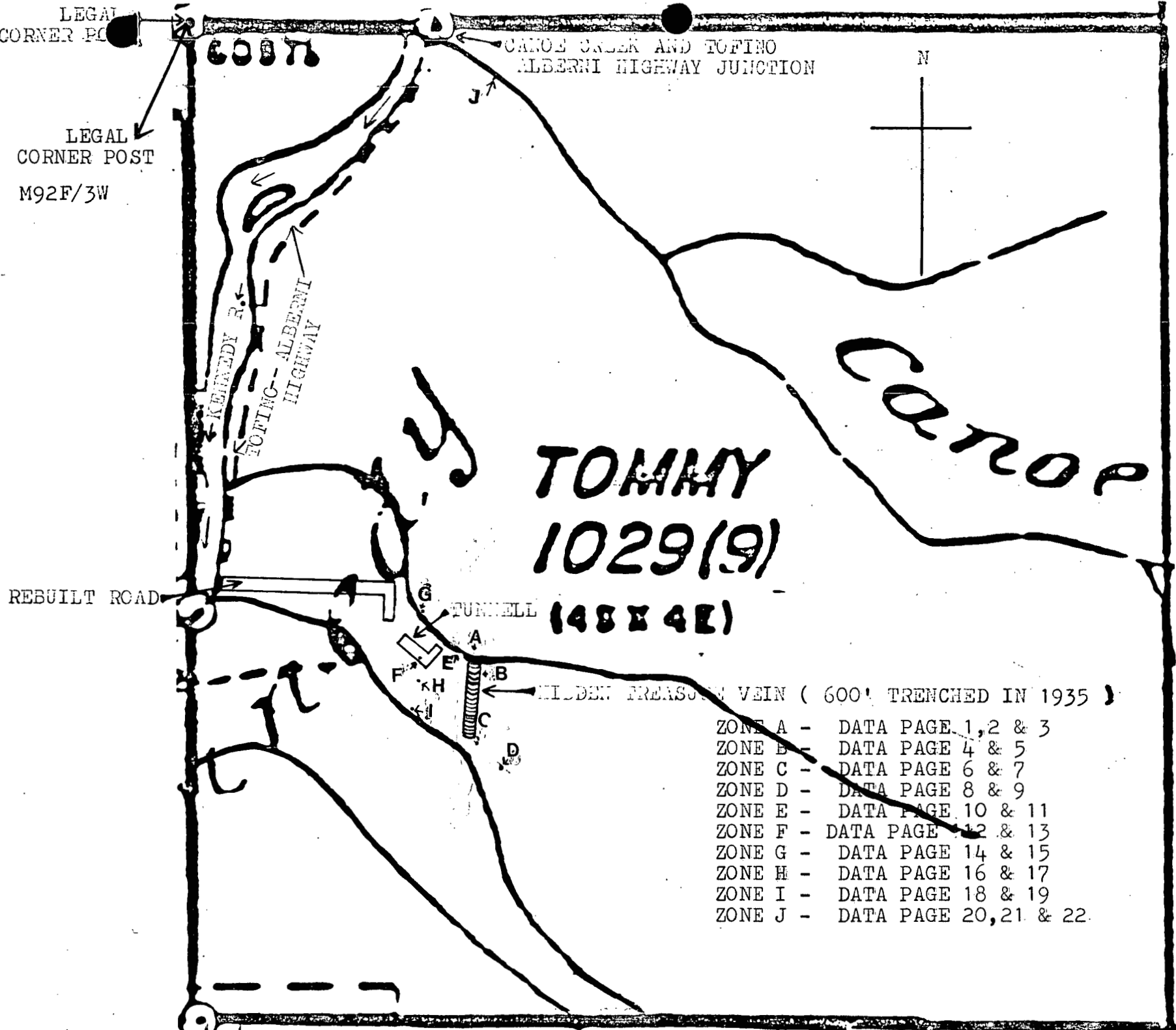

- ZONE A - DATA PAGE 1, 2 & 3
- ZONE B - DATA PAGE 4 & 5
- ZONE C - DATA PAGE 6 & 7
- ZONE D - DATA PAGE 8 & 9
- ZONE E - DATA PAGE 10 & 11
- ZONE F - DATA PAGE 12 & 13
- ZONE G - DATA PAGE 14 & 15
- ZONE H - DATA PAGE 16 & 17
- ZONE I - DATA PAGE 18 & 19
- ZONE J - DATA PAGE 20, 21 & 22

LEGAL  
CORNER POST  
M92F/3W

REBUILT ROAD

CANOE CREEK AND TOFINO  
ALBERNI HIGHWAY JUNCTION

6007

KENNEDY R.  
TOFINO - ALBERNI  
HIGHWAY

**TOMMY**  
**1029(9)**  
**(48 X 4E)**

TUNNELL

HIDDEN TREASURE VEIN ( 600' TRENCHED IN 1935 )

N

COURTENAY

SOMOX

INDEX MAP # 2

PAGE 2



Scale: 6 Miles to 1 inch

PACIFIC RIM NATIONAL PARK

INTRODUCTION

From October 18, 1980 to September 7, 1981 prospecting work was carried out by W. Ejtel, owner of the Tommy Mineral Claim near Port Alberni, British Columbia.

<u>Claim Name</u>	<u>Record Number</u>	<u>Metal Tag Number</u>	<u>Expiry Date</u>
Tommy	1029	60975	18 Sept. 1981

The claim is located approximately 50 km. south west of Port Alberni and lies immediately east of Kennedy River approximately 5 miles north of the mouth of Kennedy Lake. The approximate location of the claim is shown in Figure 1. The property can be reached from Port Alberni by the Tofino Highway.

The purpose of rock sampling, mapping and assaying was to locate the quartz veins system in concurrence to length, width, and direction and to estimate surface tonnage for volume and value of gold and other metals.

<u>LIST OF SAMPLES</u>		AU oz/ton	AG oz/ton
1 - 882	4"	1.590	1.08
2 - 50A	ROCK	.004	
3 - 501	5"	3.960	
4 - 12A	4"	2.005	
5 - 36B	3"	0.49	
6 - 39A	2"	.440	
7 - 881	15"	.580	.32
8 - 86	2"	.006	
9 - 87	2"	.317	
10 - 100	ROCK	.014	
11 - 88	3"	.510	
12 - 36B	2"	.280	
13 - 12B	1"	.038	
14 - 85	6"	.086	
15 - 84	5"	.028	
16 - 83	1"	.013	
17 - 82	4"	.715	
18 - 81	1"	.505	
19 - 80	ROCK	.001	
20 - 29A	2"	.694	
21 - 29B	2"	.192	
22 - 91	2"	.007	
23 - 90	4"	.078	
24 - 92	4"	.034	
25 - 50B	2"	.170	
26 - 1	2"	.150	

1 inch = 2.54 cm

LIST OF SAMPLES

27 - SP	8"	.600	1.5	2	.16	.05	1Cp
28 - CS	14"	.102	.75	1.28			
29 - B2S	2"	.926	5.15	7.45			
30 - B1S	2"	.474	.40	.28			
31 - BS	10"	.019					
32 - AS	10"	.015					
33 - FS	3"	.297					
34 - HS	1/2"	.043					
35 - 4D	6"	1.950	4.49	4.19			
36 - 2D	2"	.203					
37 - 3E	2"	.072					
38 - 3A	2"	.025					
39 - 7D	2"	.018					
40 - 5D	2"	.425					
41 - 4E	2"	.101					
42 - 1F	2"	.075					
43 - P1	12"	.395	2.55				
44 - 44	5"	.018	1.56				
45 - 45	2"	.132	.38				
46 - 46	1"	.080	.12				
47 - 47	4"	.003	.05				
48 - 76	3"	.009					
49 - 75	2"	.103					
50 - 74	1"	.025					
51 - 73	1"	.009					
52 - F3	2"	.002	.11	.04			
53 - F5	2"	.041	.16	.05			
54 - F6	1"	.026	.25	.08			
55 - D1	2"	1.150	.96	1.42			
56 - A1	3"	.018	1.76				
57 - 66	2"	.176					
58 - 67	2"	.570					
59 - 69	2"	1.020					
60 - 70	2"	1.460					
61 - 64	4"	.830					

LIST OF SAMPLES

62 - 884	2"	1.485	2.39	1.26	
63 - E1	1"	.030			
64 - Z14	1"	.090			
65 - 887	4"	1.183	4.10		
66 - 886	Barren Rock	.048	trace	.32	
67 - 885	2½"	1.608	.91	.76	
68 - 16	2"	.580			
69 - 20	4"	1.450			
70 - Z21	Barren Rock	.012			
71 - 60D	4"	.660			
72 - Z12	4"	.810			
73 - EG	40"	52.000			
74 - E1	12"	1.800			
74 - B12	12"	.005			ICp
75 - B15	12"	.005			LCP
76 - E7	12"	.090			
77 - E4	12"	.020			
78 - 1E	20"	5.500			ICP
79 - 2F	12"	.115			
80 - 4C	12"	.015			ICP
81 - 6D	12"	.140			
82 - E10	12"				LCP
83 - 12B	4"	2.90			
84 - 877	3"	1.679	.97		
85 - 50E	4"	.550			
86 - 50D	5"	.290	1.48	1.42	.09
87 - 880	4"	.334	.66	.73	
88 - 60B	4"	.512	.78	1.18	.09
89 - 878	3"	.096	.25		
90 - 60C	3"	.210			
91 - 60A	Rock	.070			
92 - 879	Rock	.002	trace		
93 - 6B	Rock	.002			
94 - 19D	Rock	.095			
95 - 20D	Rock	.080			
96 - 26E	3"	.225			
97 - 5A	Rock	trace			



LIST OF SAMPLES

98 - 1A	Rock	.048				
99 - 1B	Rock	.016				
100 - 4A	Rock	trace				
101 - 1C			.01		.01	
102 - 2C			.01		.01	
103 - 3C			.01		.01	
104 - 2E		.001				
105 - 65		.004				
106 - 68		.001				
107 - 87H		.001				
108 - 88		.001				
109 - 89		.001	.01	.03		
110 - 90		.001				
111 - 91H		.001				
112 - B12	1"	150	11.			X
113 - E1	1"	500	5.1			X
114 - V1	1"	10	0.5	78	6	X
115 - W1	1"	25	1.0			X
116 - W2	1"	5	0.6	70		X
117 - W3	1"	1000	10.			X
118 - W6	1"	5	0.4	62		X
119 - Z1	1"	5	0.6	82	6	X
120 - Z2	1"	20	2.2			X
121 - A1	1"	.001				
122 - A2	1"	.008				
123 - A3	1"	.002				
124 - A4	1"	.365				
125 - A5	1"	.414				
126 - A61	1"	.075				
127 - A7	1"	.015				
128 - A8	1"	.031				
129 - A9	1"	.002				
130 - P2	5"	.005				
131 - P3	5"	.005				
132 - B1	5"	.280				
133 - C1	5"	.040				
134 - E1	5"	+1.000				
135 - 48	5"	.025				
136 - 52	5"	.005				

LIST OF SAMPLES

137 - 54      5"      .015

SAMPLES LISTED BELOW WERE RECHECKED AND PUT  
ON MAPS WITH DIFFERENT NUMBERS

138-14(3)  
139-27A  
140-27B  
141-30A  
142-37A  
143-31A  
144-31B  
145-32A  
146-32B  
147-33A  
148-38B  
149-39A

149 - TOTAL OF ASSAYED SAMPLES

# ZONE A

DATA PAGE 1

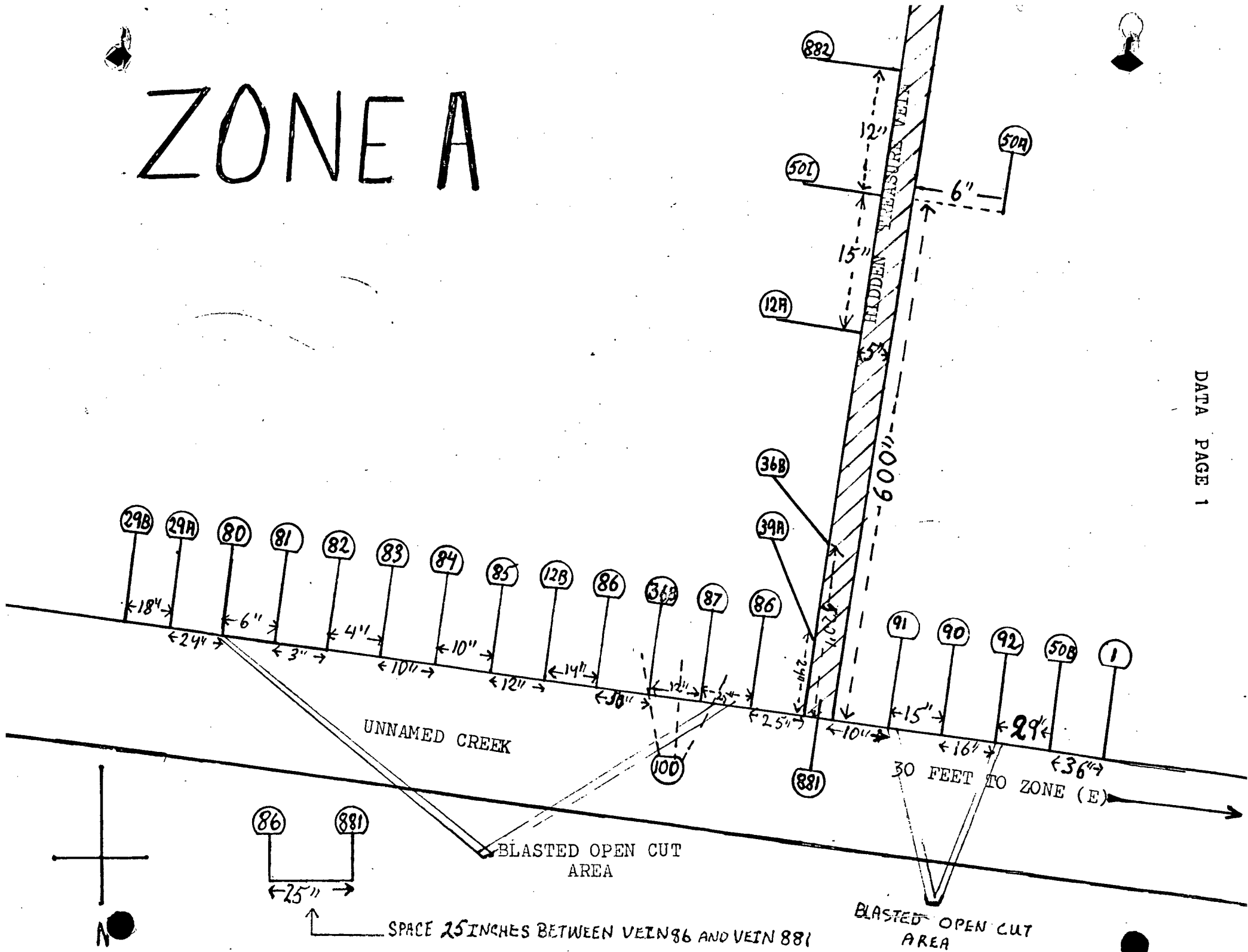





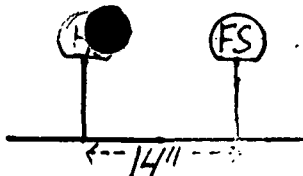

SPACE 14" INCHES BETWEEN VEIN Hs  
and VEIN Fs

0- NO SPACE

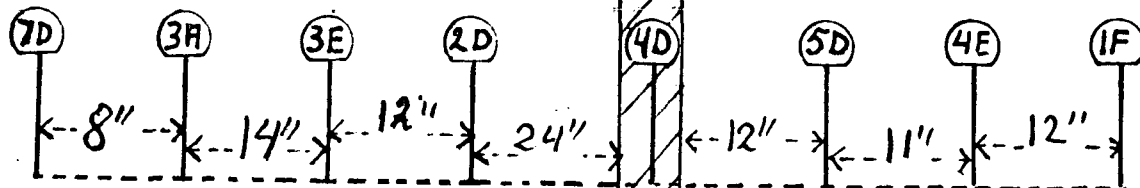

# ZONE B

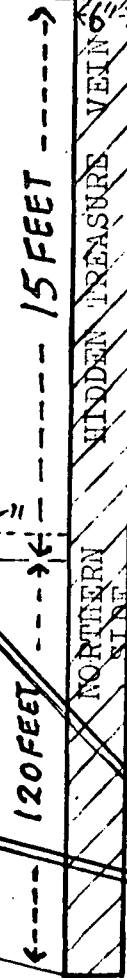
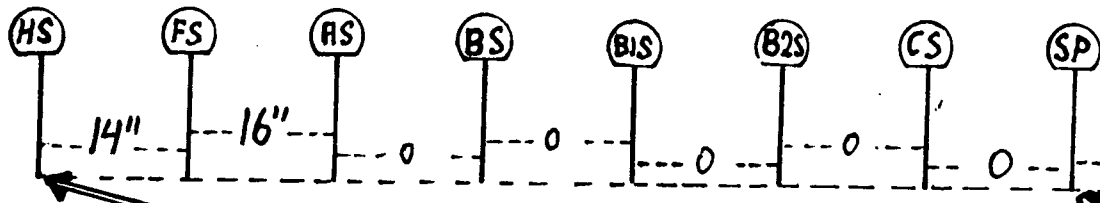

BLASTED OPEN CUT  
AREA

TO HIGHWAY

20 feet to ZONE (E)

UNNAMED CREEK

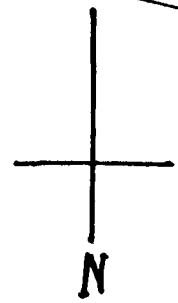



# ZONE C

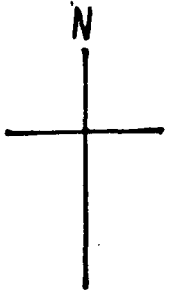

HIDDEN TREASURE VEIN

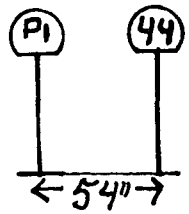
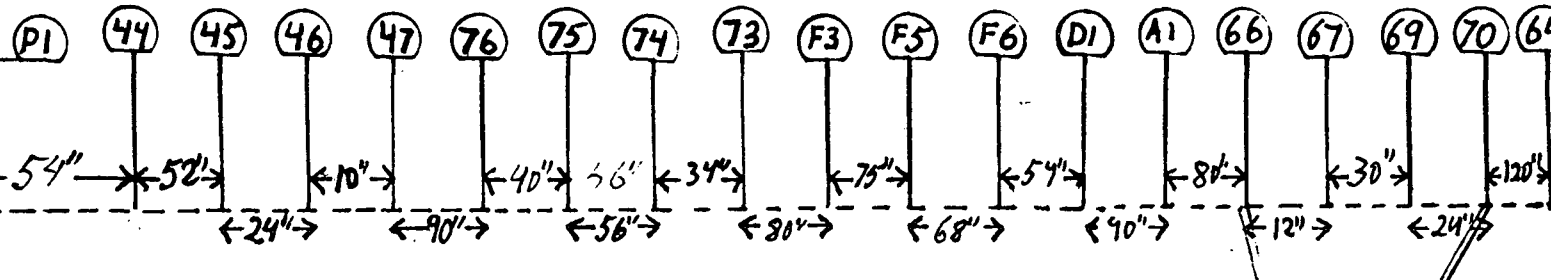

54" INCHES BETWEEN VEIN P1 and VEIN 44

ELASTED OPENCUT AREA

DATA PAGE 6





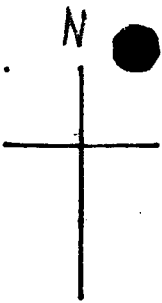

HIDDEN TREASURE VEIN

300 FEET

ZONE (C)

18" INCHES BETWEEN VEIN Z14 and VEIN 16

ZONE D

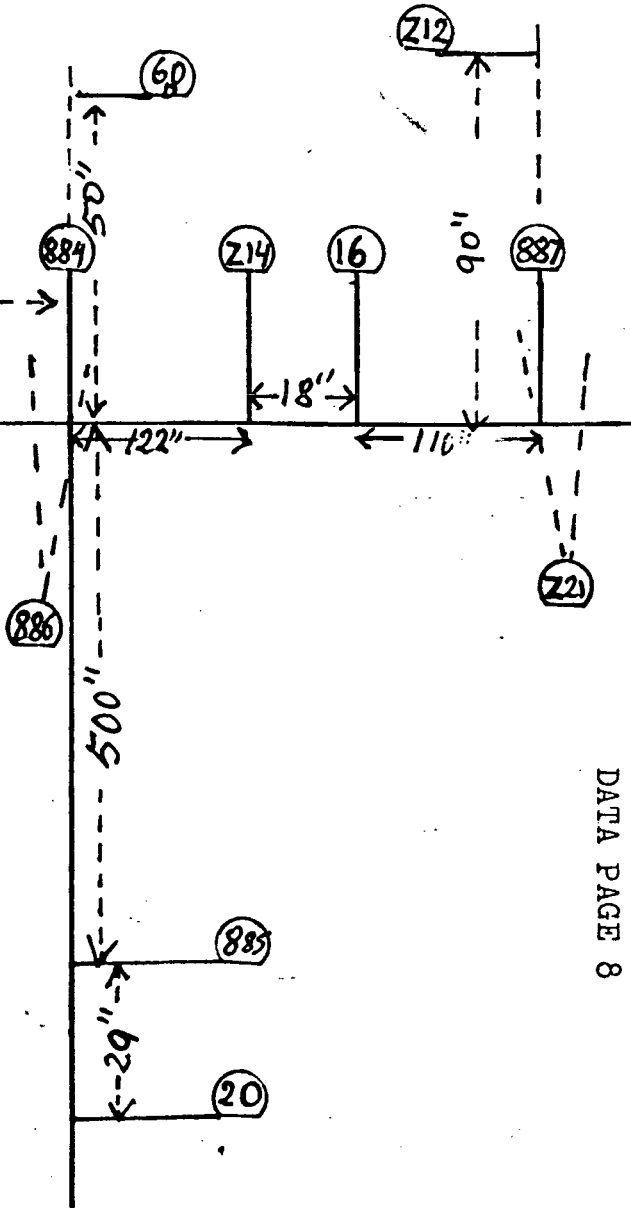
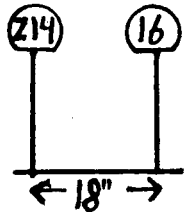



# ZONE E

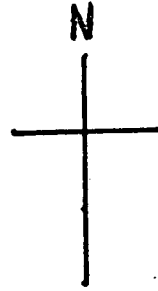

80 FEET TO TUNNELL ENTRANCE  
←-----→

20 feet to ZONE (A)  
←-----→

UNNAMED CREEK

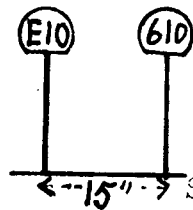
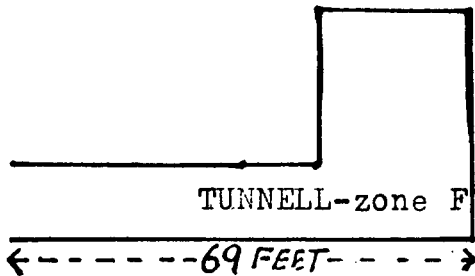
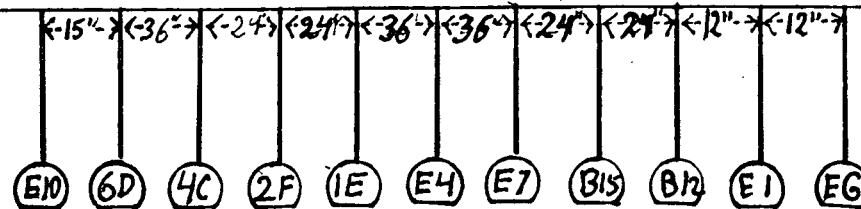

SPACE 15" INCHES BETWEEN VEIN E10 and VEIN 6D



N

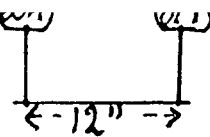
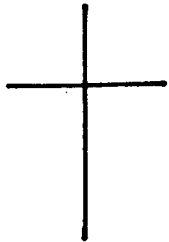

SPACE 12 INCHES BETWEEN VEIN 60A and VEIN 879

# ZONE F

50 FEET TO ZONE (G)

UNNAMED CREEK

TUNNELL

TUNNELL VEIN  
4"-8"

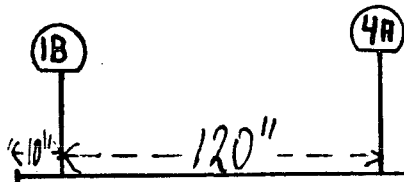

UNDERGROUND TUNNELL ENTRANCE

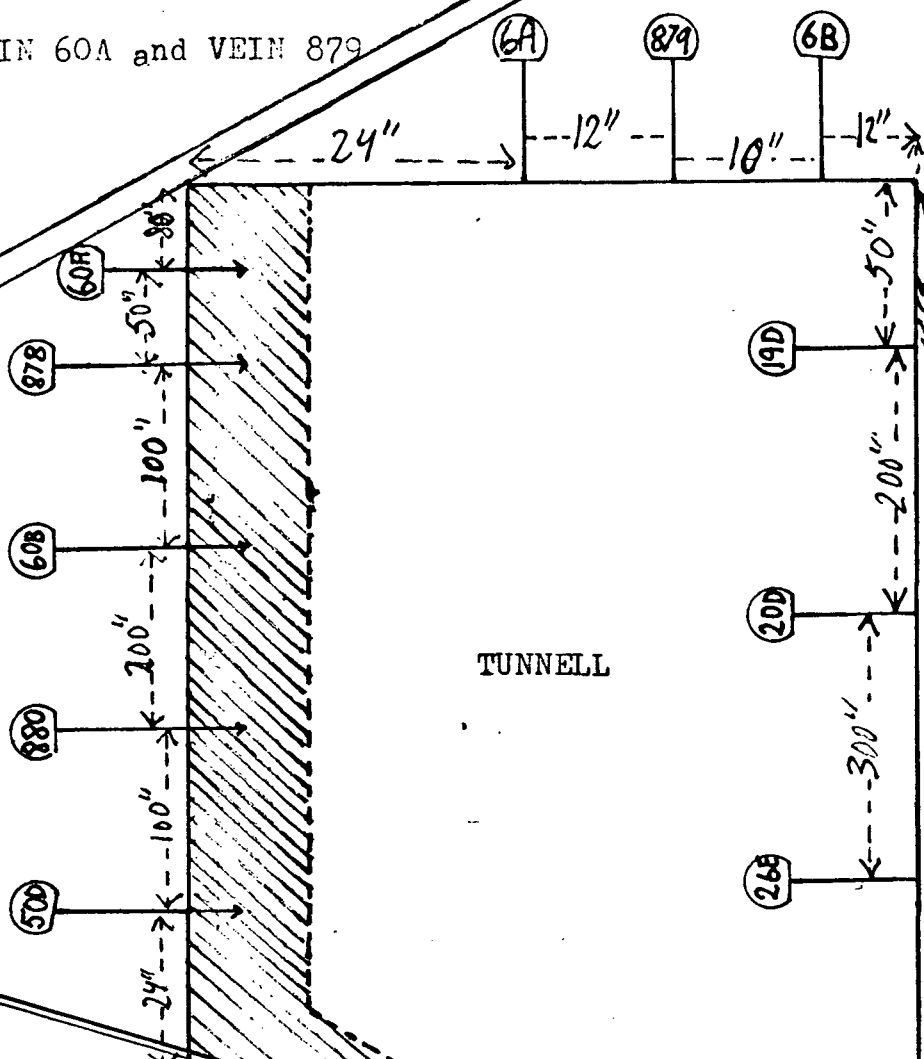
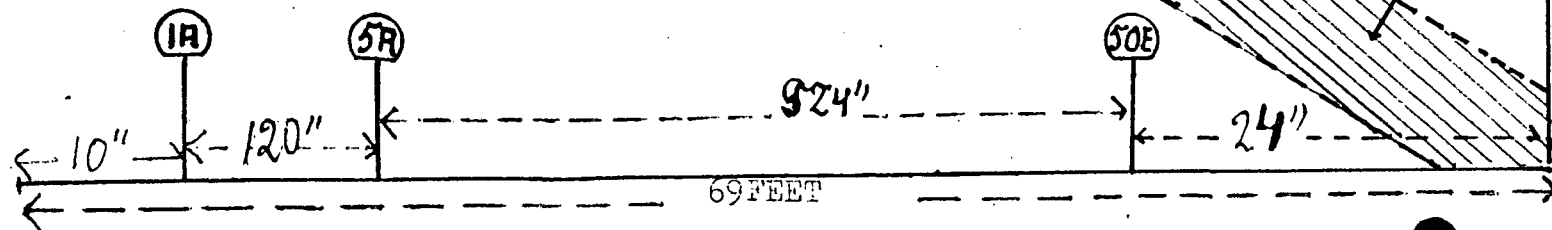

TO HIGHWAY

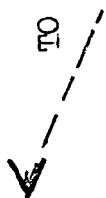





# ZONE G

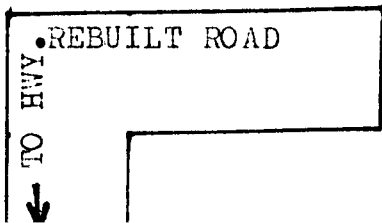
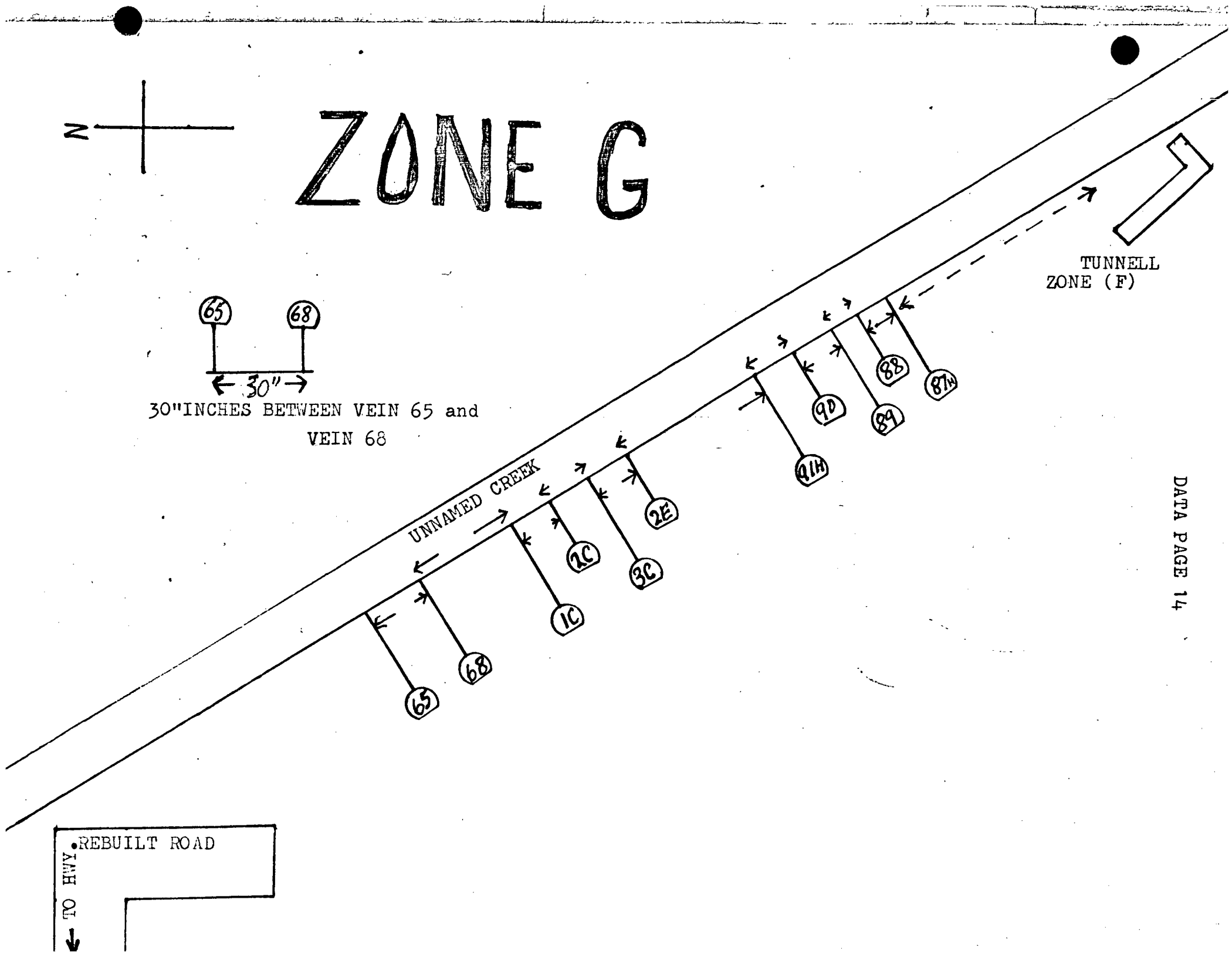
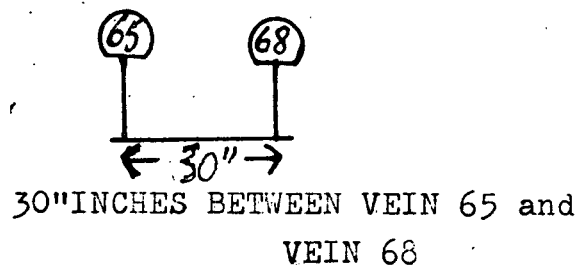





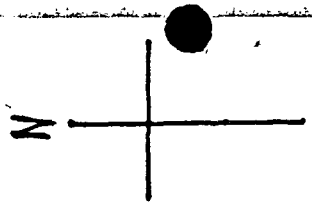

HIDDEN TREASURE VEIN

UNNAMED CREEK

TUNNELL

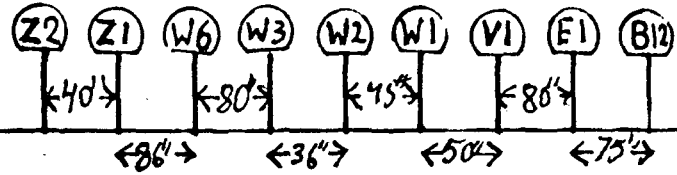

REBUILT ROAD

UNNAMED CREEK

ZONE (I)

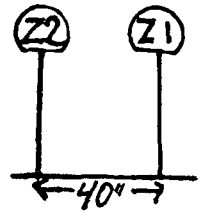

SPACE 40" BETWEEN VEIN Z2 and Z1

# ZONE H

ALBERNI TOFINO  
HIGHWAY



# ZONE I



400 FEET TO  
ZONE (G)

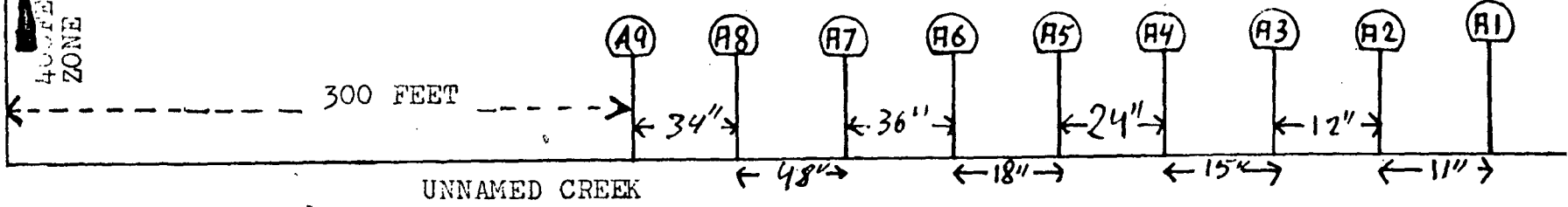

DATA PAGE 18

REBUILT ROAD

700 FEET

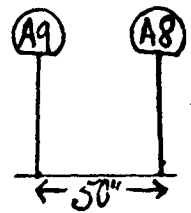

50 " INCHES BETWEEN VEIN A9 and VEIN A 8

← ALBERNI TOFINO →  
HIGWAY





# ZONE J

DATA PAGE 20

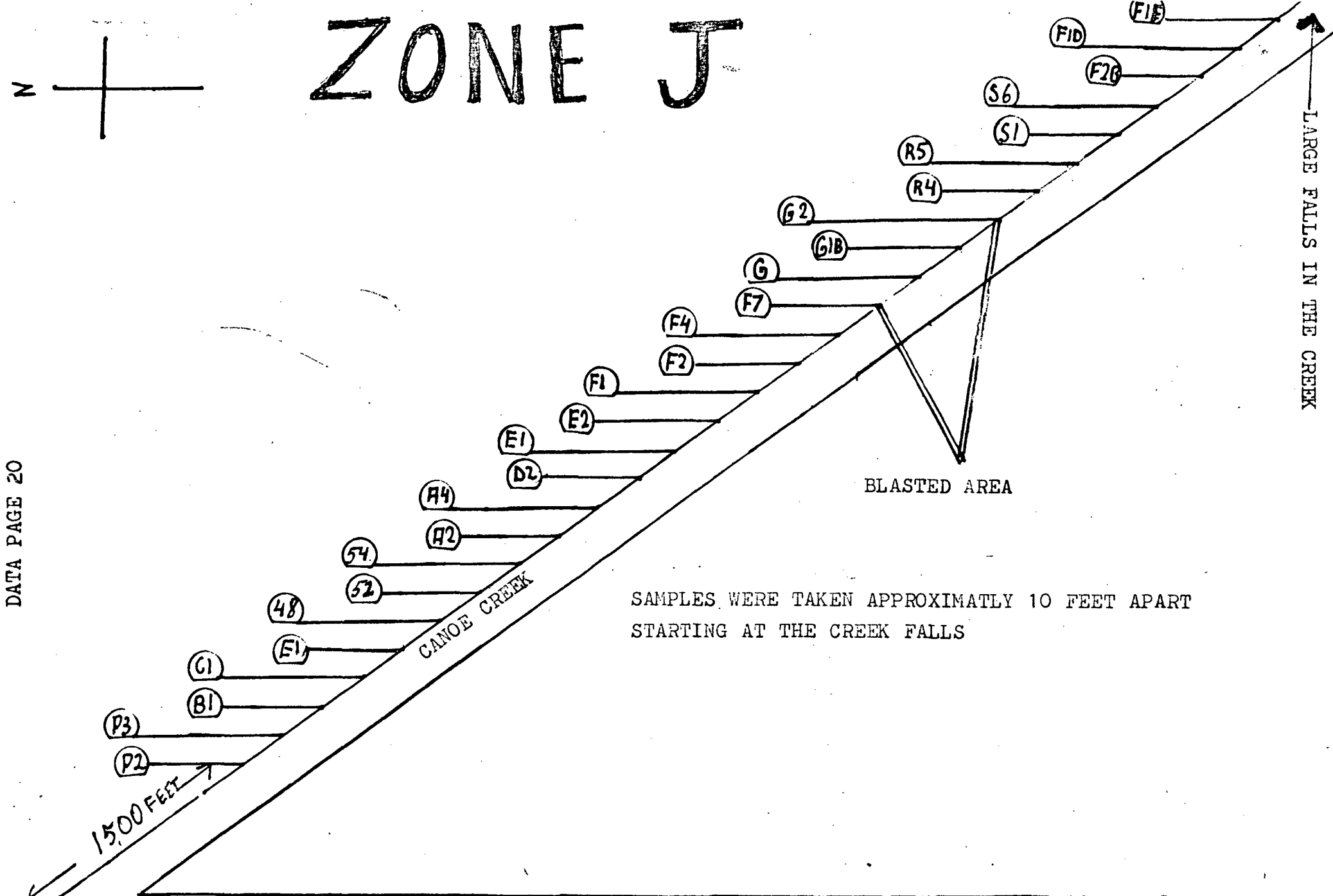

BLASTED AREA

LARGE FALLS IN THE CREEK

SAMPLES WERE TAKEN APPROXIMATELY 10 FEET APART  
STARTING AT THE CREEK FALLS

ALBERNI - TOFINO HIGHWAY







CONCLUSION

ON THE TOMMY PROPERTY THERE ARE EXCELLENT SURFACE SHOWINGS THE QUARTZ VEINS CONTAIN SMALL AMOUNTS OF PYRITE, CALCOPYRITE AND ALL STRIKE IN A NORTH EASTERLY DIRECTION. THE QUARTZ VEINS SYSTEM IN ZONES A, B, C, D, AND E EXTEND IN A NORTH EASTERLY DIRECTION OVER APPROXIMATLY 1000 FEET AND WIDE APPROXIMETLY 60 FEET TO 300 FEET. THE QUARTZ VEINS AVERAGE IN SIZES FROM 1 INCH TO 5 INCHES WITH AVERAGE WIDTH BETWEEN VEINS BEING 1 FOOT TO 10 FEET. GOOD SHOWINGS WERE ALSO FOUND IN THE BARREN ROCK BETWEEN QUARTZ VEINS.

ALL SAMPLES TAKEN WERE QUARTZ EXCEPT WHERE OTHERWISE SPECEFIED ON DATA PAGES 1 TO 22

## ITEMIZED COST STATEMENT

PAGE 1

1) WORK DONE		
149 ASSAYED SAMPLES		
IMPROVED AND SLASHED ROAD - 1000 M		
BLASTED OPEN-CUTS - 10 CUBIC METERS	\$	600.00
CLEANING UNDERGROUND TUNNEL - 5 CUBIC METERS		300.00
COST OF ASSAYING		1,085.00
2) TOOL RENTALS		
GAS DRILL - 3 TIMES		250.00
CHAIN SAW		35.00
3) TRANSPORTATION		
21 TRIPS TO ISLAND		840.00
FERRIES - 21 BY \$40.00		
GAS - 21 BY \$25.00		515.00
CAR RENTALS		350.00
20% OF TOTAL TRANSPORTATION COST (TOTAL ALLOWED)		340.00
4) LABOUR		
2 MEN \$60.00 PER DAY/MAN (\$120.00)		
25 DAYS WORKED BY \$120.00 A DAY		3,000.00
3MEN \$60.00 PER DAY/MAN (\$180.00)		
7 DAYS WORKED BY \$180.00 A DAY		1,260.00
5) FIELD ACCOMODATION		
2 MEN \$20.00 PER DAY/MAN (\$40.00)		
25 DAYS OF FIELD WORK		
25 BY \$40.00		1,000.00
3 MEN \$20.00 PER DAY/MAN (\$60.00)		
7 DAYS OF FIELD WORK		
7 BY \$60.00		420.00
TOTAL	\$	8,290.00

## ITE MIZET COST STATEMENT

PAGE 2

DATES	DAYS	# OF ROCK SAMPLES	MAN PER/DAY	TOTAL
1980				
SEPT. 17	1	15	2 MEN/\$120	\$ 120.00
OCT. 1	1	6	"	120.00
8	1	16	"	120.00
19	1	12	"	120.00
25	1	12	"	120.00
NOV. 3	1	9	"	120.00
6	1	16	"	120.00
DEC. 2	1	9	"	120.00
7	1	25	"	120.00
20&21	2	10	"	240.00
1981				
FEB. 13&14	2	25	"	240.00
APRIL 11, 12&13	3	35	3 MEN/\$180	540.00
19&20	2	12	2 MEN/\$120	240.00
MAY 2 & 3	2	12	"	240.00
11, 12, 13&14	4	40	3 MEN/\$180	720.00
20	1	6	2 MEN/\$120	120.00
JUNE 23&24	2	14	"	240.00
JULY 1	1	8	"	120.00
12	1	20	"	120.00
15	1	24	"	120.00
AUG. 3&4	2	25	"	240.00

TOTAL \$ 4,260.00

QUALIFICATIONS

PAGE 1

I, Waldo Ejtel of #808, 777 Cardero Street Vancouver, B.C.

My experience started with studying library books on mining, geologic and prospecting.

Three years ago I commenced field work staking and working on my placer leases.

In 1980 I discovered and staked the Tommy Mineral Claim (for which this prospecting report is being written) after a couple of months of work with encouraging results I asked the geologist from the Ministry of Mines in Victoria, Mr. Grove to visit my claim and advise me on future work. After his visit I started developing this claim on Mr. Grove's advice.

Occasionally I had a few different geologists and mining engineers visit the Tommy property and advised me further on developing this property.

A handwritten signature in black ink, consisting of several overlapping, fluid strokes that form a cursive name, likely 'Waldo Ejtel'.

To: Mr. W. Eitel

File No. 81-0649  
Type of Samples Rock  
Disposition \_\_\_\_\_

# ASSAY CERTIFICATE

No.	Sample	Au oz/ton	Ag oz/ton	Zn%	No.
1	1 C ✓		.01	.01	1
2	2 C ✓		.01	.01	2
3	3 C ✓		.01	.01	3
4	2 E ✓	.001			4
5					5
6					6
7					7
8					8
9					9
10					10
11					11
12					12
13					13
14					14
15					15
16					16
17					17
18					18
19					19
20					20

All reports are the confidential property of clients.

DATE SAMPLES RECEIVED July 2, 1981  
DATE REPORTS MAILED July 9, 1981  
ASSAYER Dean Toye

DEAN TOYE, B.Sc.  
CHIEF CHEMIST  
CERTIFIED B.C. ASSAYER

To: Mr. W. Eitel

File No. 81-0329  
Type of Samples \_\_\_\_\_  
Disposition \_\_\_\_\_

# ASSAY CERTIFICATE

No.	Sample	Au oz/ton	No.
1	65 ✓	.004	1
2	68 ✓	.001	2
3			3
4			4
5			5
6			6
7			7
8			8
9			9
10			10
11			11
12			12
13			13
14			14
15			15
16			16
17			17
18			18
19			19
20			20

All reports are the confidential property of clients.

DATE SAMPLES RECEIVED May 20, 1981  
DATE REPORTS MAILED May 25, 1981  
ASSAYER Dean Toye

DEAN TOYE, B.Sc.  
CHIEF CHEMIST  
CERTIFIED B.C. ASSAYER



To: Ejtcl  
777 Cardero St.,  
Vancouver, B.C.  
V6G 2G4

ACME ANALYTICAL LABORATORIES LTD.  
Assaying & Trace Analysis  
852 E. Hastings St., Vancouver, B. C. V6A 1R6  
phone: 253-3158

File No. 81-0280  
Type of Samples Rock  
Disposition

### GEOCHEMICAL ASSAY CERTIFICATE

SAMPLE No.	Au									
A 2	.020	✓								1
A 4	.015	✓								2
										3
D 2	.040	✓								4
E 1	1.500	✓								5
E 2	.110	✓								6
F 1	.020	✓								7
F 2	.005	✓								8
F 4	.050	✓								9
F 7	.065	✓								10
G	.820	✓								11
G 18	.005	✓								12
G 2	.010	✓								13
R 4	.050	✓								14
R 5	.020	✓								15
S 1	.010	✓								16
S 6	.040	✓								17
F 28	.005	✓								18
FID	.005	✓								19
FIF	.010	✓								20
										21
										22
										23
										24
										25
										26
										27
										28
										29
										30
										31
										32
										33
										34
										35
										36
										37
										38
										39
										40

All reports are the confidential property of clients  
All results are in PPM.

DIGESTION: \_\_\_\_\_

DETERMINATION: \_\_\_\_\_

DATE SAMPLES RECEIVED Apr. 14, 1981

DATE REPORTS MAILED Apr. 16, 1981

ASSAYER D. Toy

DEAN TOYE, B.Sc.  
CHIEF CHEMIST  
CERTIFIED B.C. ASSAYER



To: Ejtcl  
777 Cardero St.,  
Vancouver, B.C.

ACME ANALYTICAL LABORATORIES LTD.  
Assaying & Trace Analysis  
852 E. Hastings St., Vancouver, B. C. V6A 1R6  
Telephone: 253-3158

File No. 80-1570  
Type of Samples Rock  
Disposition

### ASSAY CERTIFICATE

No.	Sample	Cu%	Ag oz/ton	Au oz/ton						No.
1	87 H	✓		.001						1
2	88	✓		.001						2
3	89	✓	.03	.01	.001					3
4	90	✓		.001						4
5	91 H	✓		.001						5
6										6
7										7
8										8
9										9
10										10
11										11
12										12
13										13
14										14
15										15
16										16
17										17
18										18
19										19
20										20

All reports are the confidential property of clients.

DATE SAMPLES RECEIVED Dec. 22, 1980

DATE REPORTS MAILED Dec. 23, 1980

ASSAYER D. Toy

DEAN TOYE, B.Sc.  
CHIEF CHEMIST  
CERTIFIED B.C. ASSAYER





# BONDAR-CLEGG & COMPANY LTD.

130 PEMBERTON AVENUE, NORTH VANCOUVER, B.C. (604) 985-0681 TLX: 04-352667

## Geochemical Lab Report

FROM: Mr. Fred Tobias REPORT NUMBER: 21 - 213

PROJECT: NOT LISTED DATE: February 24, 1981

SAMPLE NUMBERS	Pb PPM	Zn PPM	Ag PPM	Au PPM					
B 12	-	-	11.	150					
R 1	-	-	3.1	500					
V 1	6	78	0.5	10					
W 1	-	-	1.0	25					
W 2	-	70	0.6	5					
W 3	-	-	10.	1000					
W 6	-	62	0.4	5					
Z 1	6	82	0.6	5					
Z 2	-	-	2.2	20					

FOR METHOD, EXTRACTION AND FRACTION USED - SEE ATTACHED



To: Mr. W. Ejtel  
808 - 777 Cardero St.,  
Vancouver, B.C.  
V6G 2G4

ACME ANALYTICAL LABORATORIES LTD.

Assaying & Test Analysis  
852 E. Hastings St., Vancouver, B.C. V6A 1R6  
Telephone: 273-3158

## ASSAY CERTIFICATE

File No. 81-0954  
Type of Samples Rock  
Disposition \_\_\_\_\_

No.	Sample	Au oz/ton							No.
1	A 1	.001	✓						1
2	A 2	.008	✓						2
3	A 3	.002	✓						3
4	A 4	.365	✓						4
5	A 5	.414	✓						5
6	A 6	.075	✓						6
7	A 7	.015	✓						7
8	A 8	.031	✓						8
9	A 9	.002	✓						9
10									10
11									11
12									12
13									13
14									14
15									15
16									16
17									17
18									18
19									19
20									20

All reports are the confidential property of clients.

DATE SAMPLES RECEIVED Aug. 5, 1981

DATE REPORTS MAILED Aug. 12, 1981

ASSAYER DKS

DEAN TOYE, B.Sc.  
CHIEF CHEMIST  
CERTIFIED B.C. ASSAYER





To: Mr. Ejtel,  
808 - 777 Cardero St.,  
Vancouver, B.C.  
V6G 2G4

ACME ANALYTICAL LABORATORIES LTD.  
Assaying & Trace Analysis  
852 E. Hastings St., Vancouver, B. C. V6A 1R6  
Telephone: 253-3158

File No. 80-1386  
Type of Samples Rock  
Disposition \_\_\_\_\_

### ASSAY CERTIFICATE

Tunnell

No.	Sample	Au oz/ton				No.
1	19 D ✓	.095 ✓	✓			1
2	20 D ✓	.080 ✓	✓			2
3	26 E	.225 ✓	✓			3
4	60 A	.070 ✓	✓			4
5	60 C	.210 ✓	✓			5
6						6
7						7
8						8
9						9
10						10
11						11
12						12
13						13
14						14
15						15
16						16
17						17
18						18
19						19
20						20

All reports are the confidential property of clients.

DATE SAMPLES RECEIVED Nov. 4, 1980

DATE REPORTS MAILED Nov 10, 1980

ASSAYER Dean Toye

DEAN TOYE, B.Sc.  
CHIEF CHEMIST  
CERTIFIED B.C. ASSAYER



To: Mr. Ejtel,  
808 - 777 Cardero St.,  
Vancouver, B.C.  
V6G 2G4

ACME ANALYTICAL LABORATORIES LTD.  
Assaying & Trace Analysis  
852 E. Hastings St., Vancouver, B. C. V6A 1R6  
Telephone: 253-3158

File No. 80-1333  
Type of Samples Rock  
Disposition \_\_\_\_\_

### ASSAY CERTIFICATE

Tunnell

No.	Sample	Cu%	Zn%	Ag oz/ton	Au oz/ton		No.
1	1 A ✓				.048		1
2	1 B ✓				.016		2
3	12 B ✓				2.900		3
4	50 D ✓	1.42	.09	1.48	.290		4
5	50 E ✓				.550		5
6	60 B ✓	1.18	.09	.78	.512		6
7							7
8							8
9							9
10							10
11							11
12							12
13							13
14							14
15							15
16							16
17							17
18							18
19							19
20							20

All reports are the confidential property of clients.

DATE SAMPLES RECEIVED Oct. 27, 1980

DATE REPORTS MAILED Oct. 31, 1980

ASSAYER Dean Toye

DEAN TOYE, B.Sc.  
CHIEF CHEMIST  
CERTIFIED B.C. ASSAYER



# General Testing Laboratories

A Division of SGS Supervision Services Inc.

1001 EAST PENDER ST., VANCOUVER, B.C., CANADA, V6A 1W2  
PHONE (604) 254-1647 TELEX 04-507514 CABLE SUPERVISE

TO:

MR. FRED TOBIAS  
36 Flood Alley S Q  
Vancouver, B.C.

## CERTIFICATE OF ASSAY

No. 8012-2954

DATE: Jan. 9/81

Dec

We hereby certify that the following are the results of assays on: Ore

MARKED	GOLD	SILVER	XXX	XXX	XXX	XXX	XXX
	oz/st	oz/st					
W 6 A	0.002	W					
W 6 B	0.002	W					

NOTE: REJECTS RETAINED ONE MONTH. PULPS RETAINED THREE MONTHS. ON REQUEST PULPS AND REJECTS WILL BE STORE FOR A MAXIMUM OF ONE YEAR.

ALL REPORTS ARE THE CONFIDENTIAL PROPERTY OF CLIENTS. PUBLICATION OF STATEMENTS, CONCLUSION OR EXTRACTS FROM OR REGARDING OUR REPORTS IN NOT PERMITTED WITHOUT OUR WRITTEN APPROVAL. ANY LIABILITY ATTACHED THERETO IS LIMITED TO THE FEE CHARGED.

L. Wong

PROVINCIAL ASSAYER

Analytical and Consulting Chemists, Bulk Cargo Specialists, Surveyors, Inspectors, Samplers, Weighers

MEMBER: American Society For Testing Materials • The American Oil Chemists Society • Canadian Testing Association  
REFEREE AND OR OFFICIAL CHEMISTS FOR: National Institute of Oilseed Products • The American Oil Chemists' Society  
OFFICIAL WEIGHMASTERS FOR: Vancouver Board Of Trade



# General Testing Laboratories

A Division of SGS Supervision Services Inc.

1001 EAST PENDER ST., VANCOUVER, B.C., CANADA, V6A 1W2  
PHONE (604) 254-1647 TELEX 04-507514 CABLE SUPERVISE

TO:

MR. W. ESTEL  
777 Cardero Street  
Vancouver, B.C.

## CERTIFICATE OF ASSAY

No. 8012-2255

DATE: Jan. 14/81

Dec

We hereby certify that the following are the results of assays on: Ore

MARKED	GOLD	SILVER	XXX	XXX	XXX	XXX	XXX
	oz/st	oz/st					
E-6954							
W 4A	trace	W					
W 5A	trace	W					

NOTE: REJECTS RETAINED ONE MONTH. PULPS RETAINED THREE MONTHS. ON REQUEST PULPS AND REJECTS WILL BE STORE FOR A MAXIMUM OF ONE YEAR.

ALL REPORTS ARE THE CONFIDENTIAL PROPERTY OF CLIENTS. PUBLICATION OF STATEMENTS, CONCLUSION OR EXTRACTS FROM OR REGARDING OUR REPORTS IN NOT PERMITTED WITHOUT OUR WRITTEN APPROVAL. ANY LIABILITY ATTACHED THERETO IS LIMITED TO THE FEE CHARGED.

L. Wong

PROVINCIAL ASSAYER

Analytical and Consulting Chemists, Bulk Cargo Specialists, Surveyors, Inspectors, Samplers, Weighers

MEMBER: American Society For Testing Materials • The American Oil Chemists Society • Canadian Testing Association  
REFEREE AND OR OFFICIAL CHEMISTS FOR: National Institute of Oilseed Products • The American Oil Chemists' Society  
OFFICIAL WEIGHMASTERS FOR: Vancouver Board Of Trade





To: Mr. W. Ejtel

ACME ANALYTICAL LABORATORIES, LTD.

Assaying & Trace Analysis

852 E. Hastings St., Vancouver, B. C. V6A 1R6

phone: 253 - 3158

File No. 81-0739

Type of Samples Rock

Disposition

### GEOCHEMICAL ASSAY CERTIFICATE

SAMPLE No.	Au									
B 12 ✓	.005	+	ICP							1
B 15 ✓	.005	+	ICP							2
E 1 ✓	1.800									3
E 4 ✓	.020									4
E 6 ✓	52.000									5
E 7 ✓	.090									6
E 10 ✓		+	ICP							7
										8
										9
										10
										11
										12
										13
										14
										15
										16
										17
										18
										19
										20
										21
										22
										23
										24
										25
										26
										27
										28
										29
										30
										31
										32
										33
										34
										35
										36
										37
										38
										39
										40



All reports are the confidential property of clients  
 All results are in PPM.  
 DIGESTION: \_\_\_\_\_  
 DETERMINATION: \_\_\_\_\_

DATE SAMPLES RECEIVED July 13, 1981  
 DATE REPORTS MAILED July 18, 1981  
 ASSAYER D. Toye

DEAN TOYE, B.Sc.  
 CHIEF CHEMIST  
 CERTIFIED B.C. ASSAYER



To: Mr. Ejtél,  
808 - 777 Cardero St.,  
Vancouver, B.C.  
V6G 2G4

ACME ANALYTICAL LABORATORIES LTD.  
Assaying & Trace Analysis  
852 E. Hastings St., Vancouver, B.C. V6A 1R6  
Telephone: 253 - 3158

File No. 80-1413  
Type of Samples Rock  
Disposition \_\_\_\_\_

### ASSAY CERTIFICATE

No.	Sample	Au oz/ton		No.
1	Z 14	.090	✓	1
2	16	.580	✓	2
3	20	1.450	✓	3
4	Z 21	.012	✓	4
5	60 D	.660	✓	5
6	Z 12	.810	✓	6
7				7
8				8
9				9
10				10
11				11
12				12
13				13
14				14
15				15
16				16
17				17
18				18
19				19
20				20

ports are the confidential property of clients.

DATE SAMPLES RECEIVED Nov. 7, 1980  
DATE REPORTS MAILED Nov. 10, 1980  
ASSAYER Dean Toye

DEAN TOYE, B.Sc.  
CHIEF CHEMIST  
CERTIFIED B.C. ASSAYER



To: Mr. Ejtél,  
808 - 777 Cardero St.,  
Vancouver, B.C.

ACME ANALYTICAL LABORATORIES LTD.  
Assaying & Trace Analysis  
852 E. Hastings St., Vancouver, B.C. V6A 1R6  
phone: 253 - 3158

File No. 81-0598  
Type of Samples Rock  
Disposition \_\_\_\_\_

### GEOCHEMICAL ASSAY CERTIFICATE

SAMPLE No.	Au						No.
1 E	5.500	+	ICP				1
2 F	.115						2
4 C	.015	+	ICP				3
6 D	.140						4
							5
							6
							7
							8
							9
							10
							11
							12
							13
							14
							15
							16
							17
							18
							19
							20
							21
							22
							23
							24
							25
							26
							27
							28
							29
							30
							31
							32
							33
							34
							35
							36
							37
							38
							39
							40

All reports are the confidential property of clients  
All results are in PPM.  
DIGESTION: \_\_\_\_\_  
DETERMINATION: \_\_\_\_\_

DATE SAMPLES RECEIVED June 25, 1981  
DATE REPORTS MAILED July 2, 1981  
ASSAYER Dean Toye

DEAN TOYE, B.Sc.  
CHIEF CHEMIST  
CERTIFIED B.C. ASSAYER



To: Mr. W. Ejtel  
 777 Cardero St.,  
 Vancouver, B.C.  
 V6G 2G4

ACME ANALYTICAL LABORATORIES LTD.  
 Assaying & Trace Analysis  
 852 E. Hastings St., Vancouver, B.C. V6A 1R6  
 Telephone: 253-3158

### ASSAY CERTIFICATE

File No. 81-0280A  
 Type of Samples Rock  
 Disposition \_\_\_\_\_

No.	Sample	Cu%	Ag oz/ton	Au oz/ton	No.
1	F 3 ✓	.04	.11	.002	1
2	F 5 ✓	.05	.16	.041	2
3	F 6 ✓	.08	.25	.026	3
4	D 1 ✓	1.42	.96	1.150	4
5					5
6					6
7					7
8					8
9					9
10					10
11					11
12					12
13					13
14					14
15					15
16					16
17					17
18					18
19					19
20					20

All reports are the confidential property of clients.

DATE SAMPLES RECEIVED Apr. 14, 1981

DATE REPORTS MAILED Apr. 16, 1981

ASSAYER Dean Toye

DEAN TOYE, B.Sc.  
 CHIEF CHEMIST  
 CERTIFIED B.C. ASSAYER



To: Mr. W. Ejtel

ACME ANALYTICAL LABORATORIES LTD.  
 Assaying & Trace Analysis  
 852 E. Hastings St., Vancouver, B.C. V6A 1R6  
 Telephone: 253-3158

### ASSAY CERTIFICATE

File No. 81-0201  
 Type of Samples Rock  
 Disposition \_\_\_\_\_

No.	Sample	Ag oz/ton	Au oz/ton	No.
1	P I ✓	2.55	.395	1
2	A I ✓	1.76	.018	2
3				3
4				4
5				5
6				6
7				7
8				8
9				9
10				10
11				11
12				12
13				13
14				14
15				15
16				16
17				17
18				18
19				19
20				20

All reports are the confidential property of clients.

DATE SAMPLES RECEIVED Apr 11 21, 1981

DATE REPORTS MAILED Apr 11 23, 1981

ASSAYER Dean Toye

DEAN TOYE, B.Sc.  
 CHIEF CHEMIST  
 CERTIFIED B.C. ASSAYER

*ll*



ACME ANALYTICAL LABORATORIES LTD.

Assaying & Trace Analysis

852 E. Hastings St., Vancouver, B. C. V6A 1R6

Telephone: 253-3158

To: Mr. W. Eitel,  
808 - 777 Cardero St.,  
Vancouver, B.C.

File No. 81-0598

### ASSAY CERTIFICATE

Type of Samples \_\_\_\_\_  
Disposition \_\_\_\_\_

No.	Sample	Cu%	Ag oz/ton	Au oz/ton	No.	
1	1 F	✓		.075 ✓	1	
2	2 D	✓		.203 ✓	2	
3	3 A	✓		.025 ✓	3	
4	3 E	✓		.072 ✓	4	
5	4 D	✓	4.19	4.49	1.950 ✓	5
6	4 E	✓		.101 ✓	6	
7	5 D	✓		.425 ✓	7	
8	7 D	✓	.23	.23	.018 ✓	8
9					9	
10					10	
11					11	
12					12	
13					13	
14					14	
15					15	
16					16	
17					17	
18					18	
19					19	
20					20	

All reports are the confidential property of clients.

DATE SAMPLES RECEIVED June 25, 1981

DATE REPORTS MAILED July 2, 1981

ASSAYER

DEAN TOYE, B.Sc.  
CHIEF CHEMIST  
CERTIFIED B.C. ASSAYER



ACME ANALYTICAL LABORATORIES LTD.

Assaying & Trace Analysis

852 E. Hastings St., Vancouver, B. C. V6A 1R6

Telephone: 253-3158

To: Mr. W. Eitel,  
808 - 777 Cardero St.,  
Vancouver, B.C.  
V6G 2G4

File No. 81-0328

### ASSAY CERTIFICATE

Type of Samples Rock  
Disposition \_\_\_\_\_

No.	Sample	Au oz/ton	Ag oz/ton	No.
1	44 ✓	.018	1.56	1
2	45 ✓	.132	.38	2
3	46 ✓	.080	.12	3
4	47 ✓	.003	.05	4
5				5
6				6
7				7
8				8
9				9
10				10
11				11
12				12
13				13
14				14
15				15
16				16
17				17
18				18
19				19
20				20

All reports are the confidential property of clients.

DATE SAMPLES RECEIVED May 4, 1981

DATE REPORTS MAILED May 7, 1981

ASSAYER

DEAN TOYE, B.Sc.  
CHIEF CHEMIST  
CERTIFIED B.C. ASSAYER

ICP GEOCHEMICAL ANALYSES

A .500 GRAM OF SAMPLE IS DIGESTED WITH 3 ML OF 31:1:3 NITRIC ACID TO HYDROCHLORIC ACID TO WATER AT 90 DEG. C FOR 1 HOUR. THE SAMPLE IS DILUTED WITH WATER TO 10.0 ML. THE RESULTS ARE REPORTED IN PPM EXCEPT FOR: FE, CA, P, MG, BA, AND AL WHICH IS IN PERCENT.  
 THIS LEACH IS PARTIAL FOR: CA, P, MG, AL, TI, LA, AND V. VERY LITTLE BA IS DISSOLVED.  
 IS = INTERNAL STANDARD.

\*HO/SP  
 EGC

EJTEL

FILE# 81-3798B

EURN # 1 CE16 10:54 27JULY81

IS	1348	CU	12531	ZN	1627	AG	49.1	NI	56	CO	154	MY	162	FE	19.6	AS	6.3
MO	29	IS	1191	IS	1191	CD	35	SB	96	BI	566	V	8	CA	0.83	P	0.86
U	-4	7.4	1.0	1191	1191	TI	3	B	AL	IS	132	IS	132	IS	8.9	V	14
LA	26	IN	-21	0.88	0.81	TI	-9	B	AL	IS	132	IS	132	IS	8.9	V	14

*Cu & Ag Assay required*



To: Mr. W. Ejtel

ASSAY CERTIFICATE

File No. 81-0790 B  
 Type of Samples Rock  
 Disposition

No.	Sample	Au oz/ton	Ag oz/ton	Cu%	No.
1	CS	.102	.75	1.28	1
2	B2S	.926	5.15	7.45	2
3	B1S	.474	.40	.28	3
4	SP	.600			4
5	AS	.015			5
6	BS	.019			6
7	FS	.297			7
8	HS	.043			8
9	KS	.011			9
10	LS	.009			10
11					11
12					12
13					13
14					14
15					15
16					16
17					17
18					18
19					19
20					20

All reports are the confidential property of clients.

DATE SAMPLES RECEIVED July 16, 1981  
 DATE REPORTS MAILED July 23, 1981  
 ASSAYER *skd*  
 DEAN TOYE, B.Sc.  
 CHIEF CHEMIST  
 CERTIFIED B.C. ASSAYER





To: Eitel  
777 Cardero St.,  
Vancouver, B.C.  
V6G 2G4

ACME ANALYTICAL LABORATORIES LTD.  
Assaying & Trace Analysis  
852 E. Hastings St., Vancouver, B. C. V6A 1R6  
Telephone: 253-3158

# ASSAY CERTIFICATE

File No. 80-1285

Type of Samples Rock

Disposition

No.	Sample	Au oz/ton		No.
1	1	.150	✓	1
2				2
3				3
4				4
5				5
6				6
7				7
8				8
9				9
10				10
11				11
12				12
13				13
14				14
15				15
16				16
17				17
18				18
19				19
20				20

All reports are the confidential property of clients.

DATE SAMPLES RECEIVED Oct. 20, 1980

DATE REPORTS MAILED Oct. 21, 1980

ASSAYER

DEAN TOYE, B.Sc.  
CHIEF CHEMIST  
CERTIFIED B.C. ASSAYER

W. G. STEVENSON & ASSOCIATES LIMITED  
CONSULTING GEOLOGISTS

Sample Number	Location	Description	Width	Gold oz/ton	Silver	Copper
876	Below tunnel on north edge of creek	Vein N10°E dips 90° 10% sulfide	2"	.014	.07	
877	In tunnel at vein in cross cut	Vein N50°E dips out 65°	3"	1.679	.92	
878	In tunnel near face	Vein in left wall	3"	.096	.25	
879	In tunnel at face	Specimen wall rock	-	.002	Trace	
880	In tunnel	Vein same as 877	4"	.334	.66	.73
X 881	On creek small cut hidden treasure	3 qtz. veins S15°W 70° over 15" width	3"	.580	.32	
X 882	On strike & above 881 30'	Vein S15°W dip W70° heavy sulfide	4"	1.590	1.08	
883	On strike & 2' below 882	Same as 882	4"	.286	.32	1.26
884	On north side of creek 1/4 mile south of 1st creek	Quartz vein N25°E	2"	1.485	2.39	
885	15 ft. northwest of 884	Quartz vein parallel #884 good copper	1"	1.608	.91	.76
886	Both sides of 885	Barren wall rock	-	.048	Trace	.32
887	30 feet east of 884	Quartz vein parallel with 884	4"	1.183	4.16	

TABULATION OF SAMPLE AND ASSAY DATA TOMMY K. GOLD PROSPECT ALBERNI MINING  
DIVISION TO ACCOMPANY REPORT BY W.C. STEVENSON, P. ENG.



# BONDAR-CLEGG & COMPANY LTD.

130 PEMBERTON AVENUE, NORTH VANCOUVER, B.C. (604) 985-0681 TLX: 04-352667

## Geochemical Lab Report

FROM: Sylvia Robertson REPORT NUMBER: 20 - 2158

PROJECT: \_\_\_\_\_ DATE: September 18, 1980

SAMPLE NUMBERS	Cu	Zn	Ag	Au															
	ppm	ppm	ppm	ppb															
31 - A	-	-	1.5	285															
31 - B	1430	-	12.	580															
32 - A	-	-	5.6	60															
32 - B	-	-	4.8	105															
33 - A	-	-	8.6	635															
X 36 - B <i>36A</i>	1760	575	3.4	9040	.28	✓													
X 38 - B	3250	-	9.4	995	.29	✓													
X 39 - A <i>39B</i>	7400	415	16.	>10000															

FOR METHOD, EXTRACTION AND FRACTION USED - SEE ATTACHED

NOTE:   
Refracts retained three weeks   
Pulps retained three months   
unless otherwise arranged.

*[Signature]*  
Registered Assayer, Province of British Columbia

MARKED	GOLD		SILVER		Percent	Percent	Percent	Percent	Percent	Percent	Percent
	Ounces per Ton	Grams per Metric Ton	Ounces per Ton	Grams per Metric Ton							
X 36 B	0.49	✓									
X 39 A	0.44	✓									

I hereby certify that the following are the results of assays made by us upon the herein described 2158 samples.

To: Mrs. Sylvia Robertson REPORT NO. A20 - 1564

PAGE No. 1 DATE: October 17, 1980

BONDAR-CLEGG & COMPANY LTD. Samples submitted: October 2, 1980

808 - 777 Cordova Street Results completed: October 17, 1980

Vancouver, B.C. V6S 2G4 CERTIFICATE OF ASSAY



**General Testing Laboratories**  
A Division of SGS Supervision Services Inc.

1001 EAST PENDER ST., VANCOUVER, B.C., CANADA, V6A 1W2  
PHONE (604) 254-1647 TELEX 04-507514 CABLE: SUPERVISE



To: Mr. W. Ejte...

ACME ANALYTICAL LABORATORIES LTD.  
Assaying & Trace Analysis  
852 E. Hastings St., Vancouver, B.C. V6A 1R6  
Telephone: 254-1158

O: B.C. EXPLORATION CO.  
Ste. 808 - 777 Cardero Street  
Vancouver, B.C.  
V6G 2G4

**CERTIFICATE OF ASSAY**

No.: 8010-0352 DATE: Oct. 9/80

File No. 80-1306  
Type of Sample Rock  
Disposition

**ASSAY CERTIFICATE**

We hereby certify that the following are the results of assays on: Ore

MARKED	GOLD	SILVER	XXX	XXX	XXX	XXX	XXX	XXX
	oz/st							
X 12A	2.005	✓						
X 12B	0.038	✓						
X 14(3)	0.378							
□ 27A	0.001							
□ 27B	0.001							
X 29A	0.694	✓						
X 29B	0.192	✓						
X 30A	0.118							
□ 37A	0.004							

No.	Sample	Au oz/ton						No.
X 1	50 (A)	.004	✓					1
X 2	50 (B)	.170	✓					2
X 3	50 (I)	3.960	✓					3
4								4
5								5
6								6
7								7
8								8
9								9
10								10
11								11
12								12
13								13
14								14
15								15
16								16
17								17
18								18
19								19
20								20

NOTE: REJECTS RETAINED ONE MONTH. PULPS RETAINED THREE MONTHS. ON REQUEST PULPS AND REJECTS WILL BE STORE FOR A MAXIMUM OF ONE YEAR.  
ALL REPORTS ARE THE CONFIDENTIAL PROPERTY OF CLIENTS. PUBLICATION OF STATEMENTS, CONCLUSION OR EXTRACTS FROM OR REGARDING OUR REPORTS IS NOT PERMITTED WITHOUT OUR WRITTEN APPROVAL. ANY LIABILITY ATTACHED THERETO IS LIMITED TO THE FEE CHARGED.

*R. Wadeau*  
R. Wadeau, Chemist

Analytical and Consulting Chemists, Bulk Cargo Specialists, Surveyors, Inspectors, Samplers, Weighers  
MEMBER: American Society For Testing Materials • The American Oil Chemists Society • Canadian Testing Association  
REFEREE AND/OR OFFICIAL CHEMISTS FOR: National Institute of Oilseed Products • The American Oil Chemists' Society  
OFFICIAL WEIGHMASTERS FOR: Vancouver Board Of Trade

All reports are the confidential property of clients.

DATE SAMPLES RECEIVED Oct. 21, 1980  
DATE REPORTS MAILED Oct. 27, 1980  
ASSAYER *D. Toye*

DEAN TOYE, B.Sc.  
CHIEF CHEMIST  
CERTIFIED B.C. ASSAYER



To: tel.   
777 Cardero St.,  
Vancouver, B.C.  
V6G 2G4

ACME ANALYTICAL LABORATORIES LTD.  
Assaying & Trace Analysis  
852 E. Hastings St., Vancouver, B.C. V6A 1R6  
Telephone: 253-3158



To: Mr. Ejtrel

ACME ANALYTICAL LABORATORIES LTD.  
Assaying & Trace Analysis  
852 E. Hastings St., Vancouver, B.C. V6A 1R6  
Telephone: 3158

# ASSAY CERTIFICATE

File No. 81-0369  
Type of Samples Rock  
Disposition \_\_\_\_\_

# ASSAY CERTIFICATE

File No. 81-0369  
Type of Samples Rock  
Disposition \_\_\_\_\_

No.	Sample	Au oz/ton					No.
1	55	.003					1
2	56	.242					2
3	58	.023					3
4	61	.076					4
5	63	.590					5
6	64	.830	✓				6
7	66	.176	✓				7
8	67	.570	✓				8
9	69	1.020	✓				9
10	70	1.460	✓				10
11	73	.009	✓				11
12	74	.025	✓				12
13	75	.103	✓				13
14	76	.009	✓				14
15	80	.001	✓				15
16	81	.505	✓				16
17	82	.715	✓				17
18	83	.013	✓				18
19	84	.028	✓				19
20	85	.086	✓				20

No.	Sample	Au oz/ton					No.
<del>1</del>	<del>86</del>	<del>.006</del>	<del>✓</del>				<del>1</del>
<del>2</del>	<del>87</del>	<del>.317</del>	<del>✓</del>				<del>2</del>
<del>3</del>	<del>88</del>	<del>.510</del>	<del>✓</del>				<del>3</del>
<del>4</del>	<del>89</del>	<del>.010</del>					<del>4</del>
<del>5</del>	<del>90</del>	<del>.078</del>	<del>✓</del>				<del>5</del>
<del>6</del>	<del>91</del>	<del>.007</del>	<del>✓</del>				<del>6</del>
<del>7</del>	<del>92</del>	<del>.034</del>	<del>✓</del>				<del>7</del>
<del>8</del>	<del>100</del>	<del>.014</del>	<del>✓</del>				<del>8</del>
9							9
10							10
11							11
12							12
13							13
14							14
15							15
16							16
17							17
18							18
19							19
20							20

All reports are the confidential property of clients.

DATE SAMPLES RECEIVED May 15, 1981

DATE REPORTS MAILED May 19, 1981

ASSAYER DKT

DEAN TOYE, B.Sc.  
CHIEF CHEMIST  
CERTIFIED B.C. ASSAYER

All reports are the confidential property of clients.

DATE SAMPLES RECEIVED May 15, 1981

DATE REPORTS MAILED May 19, 1981

ASSAYER DKT

DEAN TOYE, B.Sc.  
CHIEF CHEMIST  
CERTIFIED B.C. ASSAYER