

81-#590

9686

EMPIRE RESOURCES INC.

Assessment Report on Anarchist Claims

Greenwood M.D. B.C.

Property Coordinates Long. 119 13' W
Lat 49 06' N

NTS MAP SHEET 82E/3E

Report by

W. Waters Geologist

August 11, 1981

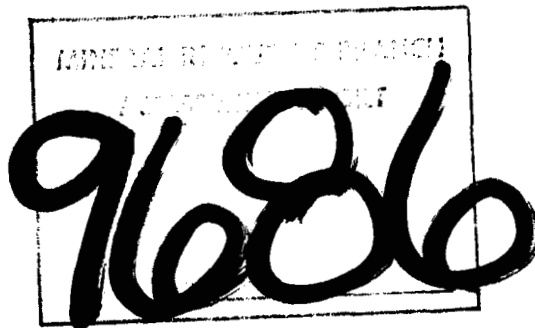

TABLE OF CONTENTS

1.1	TERMS OF REFERENCE	PAGE 1
1.2	LOCATION AND ACCESS	PAGE 1
1.3	TERRAIN AND VEGETATION	PAGE 1
1.4	PROPERTY	PAGE 2
1.5	PREVIOUS WORK AND HISTORY	PAGE 2
1.6	GEOLOGY	PAGE 2
1.7	DIAMOND DRILLING	PAGE 3
1.8	RECOMMENDATIONS	PAGE 4
1.9	COST ESTIMATE	PAGE 4
1.10	AUTHOR'S QUALIFICATIONS	PAGE 5

FIGURES

GENERAL LOCATION

ANARCHIST CLAIM GROUP

DIAMOND DRILL HOLES

ASSAY CERTIFICATES

AUDITED FINANCIAL STATEMENTS

CANCELLED CHEQUES RE: EXPENDITURES

DIAMOND DRILL LOGS

1.0 INTRODUCTION

1.1 TERMS OF REFERENCE

W. Waters supervised the Diamond Drilling of 4 BQ Wireline holes on the Empire Resources Inc. Anarchist Claim Group. All diamond drill holes were drilled on the Anarchist claim with all holes drilled at -60 degrees for a combined total footage of 469'.

Drilling was started January 20, 1981 and completed January 31, 1981.

1.2 LOCATION AND ACCESS

The Anarchist Group of claims is located at 119 13' W Longitude and 49 06' N Latitude. The property is on NTS map sheet 82E/3W and is 14Km north of Bridesville, a Village on Highway 3, access is by good gravel road to within 2 Km of the the property. Then by a road preferably by pickup or 4X4 to NW corner of Lot 647 (Anarchist Claim).

1.3 TERRAIN AND VEGETATION

The Anarchist Claim Group is located in mountainous terrain with an abundance of vegetation and local streams which would provide adequate water for any mining situation.

1.4 PROPERTY

The Anarchist Claim Group is comprised of 4 Re-verted Crown Grants and 4 Located Claims. All four Re-verted Crown Grants are Registered in the name of Empire Resources Inc. The 4 Located Claims were staked in the name of the Company.

CLAIM GROUP

NAME	Lot#	Record	Acreage	Expiry Date	Owner
Anarchist	647	1364	51.65	Oct 23/81	Empire Res. Inc
Dynamite	767	1677	51.65	July 20/81	Empire Res. Inc.
Balmoral	1966	1676	49.72	July 20/81	Empire Res. Inc.
Granite	1585	1675	51.65	July 20/81	Empire Res. Inc.
Empire 1-4		2345-2348		July 17/81	Empire Res. Inc.

1.5 PREVIOUS WORK AND HISTORY

The Department of Mines Report shows no date for the Dynamite, Balmoral and Granite claims. The Anarchist claim had a small amount of work done on it in the form of 2 shallow shafts, #1 is 90 feet deep and #2 is 60 feet deep. These two shafts are approximately 100 metres apart. In addition several shallow trenches were dug.

1.6 GEOLOGY

The geology underlying the claim group is the Cretaceous Nelson Plutonic Rock of various granitic composition.

The walls on the east side of the vein appear to be biotite rich granites. There is a vague appearance of gneissosity

Further east from the vein some of the granitic rocks were bleached and the biotite was gone.

The west wall of the vein was a silicified bleached granitic rock, at the contact.

The depth of this silicification was not seen, but appeared that it would only be a few inches.

The strongest fractures here had a strike of N32E.

There is a variation in strike of an auxiliary structure that may be due to small faults. The strikes at the shaft were N32E dip vertical 150cm wide, 30 metres south strike due north, dip vertical, vein visible 60 cm wide, structure about 30 metres further south strikes N32E, and is 120 cm wide.

The vein appears to be consistent in width through this distance and its dip is also consistent.

Mineralization consisted of pockets and blebs of pyrite, fine to coarse, and blebs of galena up to 5mm across.

Structure, other than the veins were not seen, and were not detected in the drilling.

Two reported parallel veins were not detected in the drilling, but additional drilling and trenching may uncover these structures.

1.7 DIAMOND DRILLING

Diamond drilling was started on January 20, and completed on January 31, 1981. During this period, 4 holes were drilled using BQ Wireline and a total of 469 feet of drilling was done. Diamond Drill core was stored on property.

All diamond drill holes were drilled at -60 degrees.

DD #1 N78W at -60 degrees 140' in length.

DD #2 N55W at -60 degrees 128' in length.

DD #3 N78W at -60 degrees 101' in length.

DD #4 N55W at -60 degrees 108' in length.

1.8 RECOMMENDATIONS

It appears as though the Anarchist Quartz Vein is somewhat stronger where Diamond Drill Holes 1,2,3, & 4 intersected it at 60 to 80 feet of depth.

Although only minor values in gold and silver were found in assays from the core, additional diamond drilling should be done in order to try and substantiate surface assay values of gold and silver that were found in previous work.

1.9 COST ESTIMATE

The cost for work taken place on the Anarchist Claim is the following.

Engineering and Consulting	\$ 1,060
Licenses and Fees	780
Field Travel	665
Assays	253
Diamond Drilling	9,000
Trenching	<u>1,122</u>
Total Costs	\$ 12,880

1.10 AUTHOR'S QUALIFICATIONS

W. Waters is a Graduate Geologist from the University of British Columbia for the year 1972. He has supervised numerous projects in British Columbia, Yukon, and Western United States.

Wayne Waters, Geologist



March 11 1982

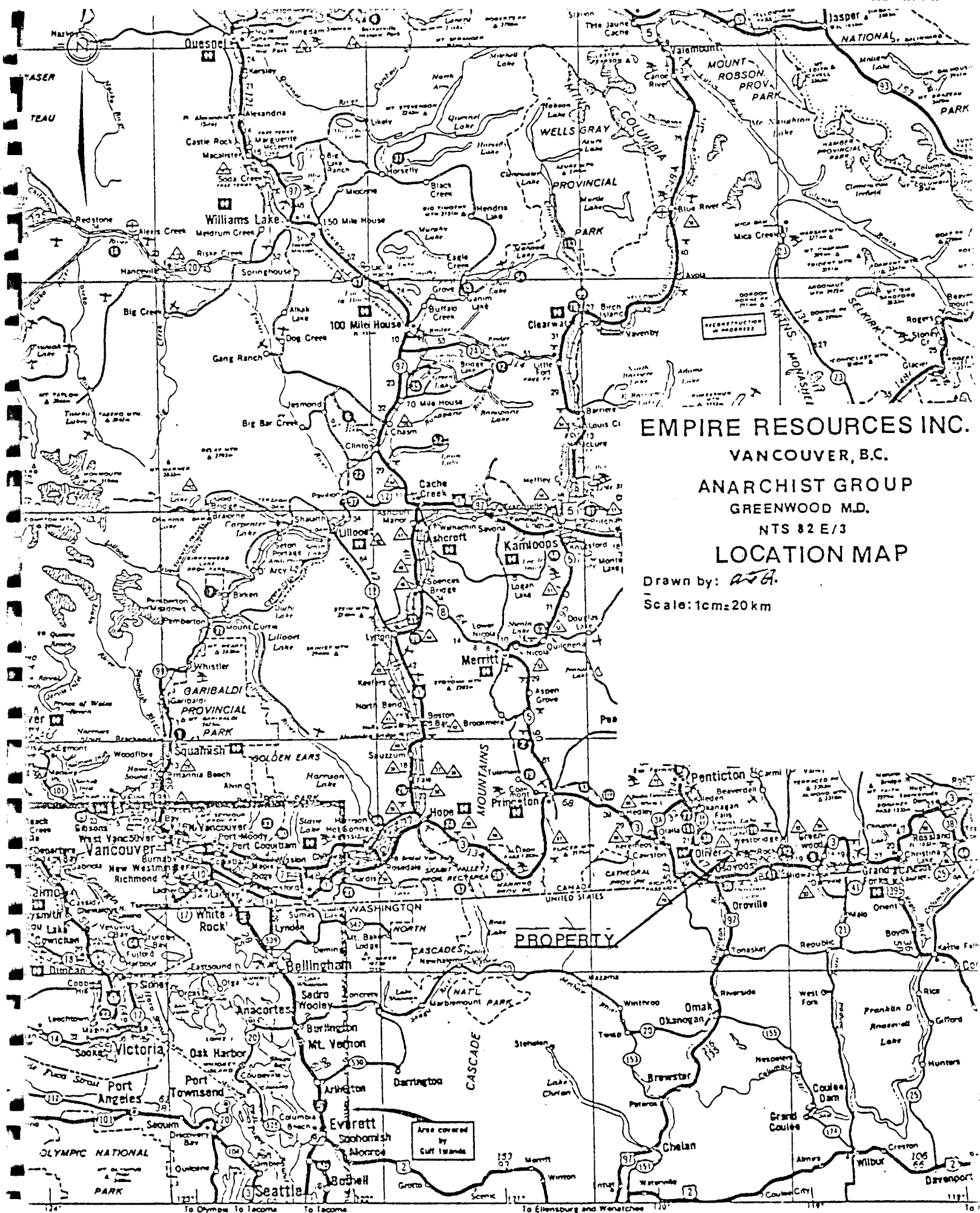

EMPIRE RESOURCES INC.
VANCOUVER, B.C.
ANARCHIST GROUP
GREENWOOD M.D.
NTS 82 E/3
LOCATION MAP

Drawn by: *ATG*
 Scale: 1cm=20 km

Area covered by
 Gulf Islands

PROPERTY

EMPIRE RESOURCES INC
 VANCOUVER, B.C.
 ANARCHIST GROUP
 GREENWOOD M.D.
 NTS 82 E/3
CLAIM MAP

Drawn by: *ATB*
 Scale: 1:50,000

PROPOSED SKI RESORT
 MINERAL RESERVE
 O/C 3419 68/11-01
 SUBJECT TO CONDITIONS

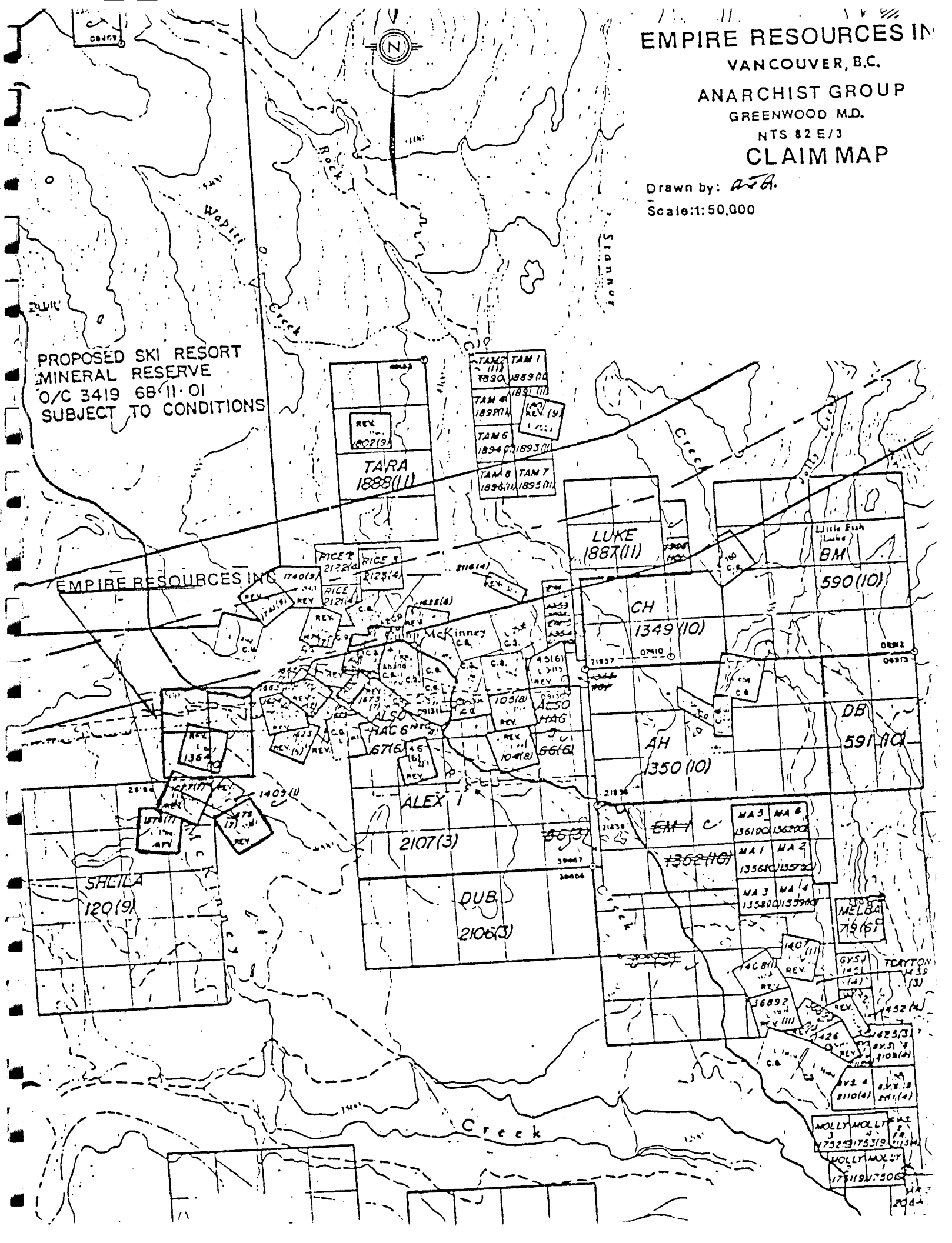

EMPIRE RESOURCES INC 174019

REV 180219
TARA
 1888(11)

TAM 1 1889(11)
 TAM 2 1890(11)
 TAM 3 1891(11)
 TAM 4 1892(11)
 TAM 5 1893(11)
 TAM 6 1894(11)
 TAM 7 1895(11)
 TAM 8 1896(11)
 TAM 9 1897(11)

LUKE
 1887(11)

Little Fish Lake
BM
 590(10)

CH
 1349(10)

AH
 1350(10)

DB
 591(10)

ALEX
 2107(3)

DUB
 2106(3)

EM1 C
 1352(10)

MA 3 136100
 MA 4 136200
 MA 1 135600
 MA 2 135700
 MA 3 135800
 MA 4 135900

MELBA
 79(5)

SHEILA
 120(9)

MOLLY
 1732(11)
 1733(11)
 1734(11)
 1735(11)
 1736(11)
 1737(11)
 1738(11)
 1739(11)
 1740(11)

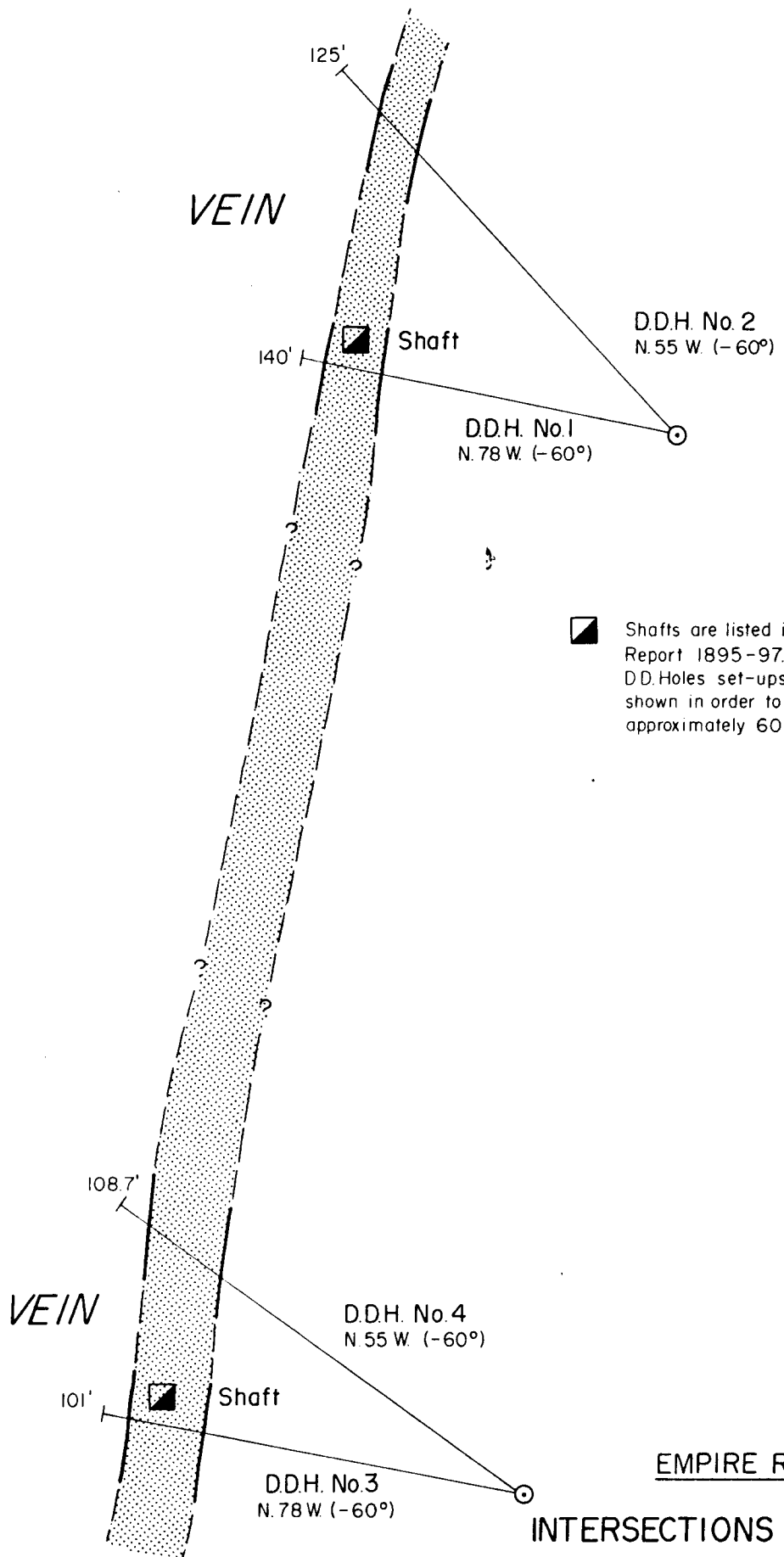

■ Shafts are listed in the Minister of Mines Report 1895-97.
D.D.Holes set-ups were stepped back as shown in order to intersect Vein, approximately 60-80 feet below surface.

EMPIRE RESOURCES INC.
**INTERSECTIONS OF ANARCHIST VEIN
WITH D.D.H. 1, 2, 3 & 4**

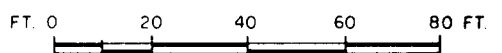



CHEMEX LABS LTD.

212 BROOKSBANK AVE.
NORTH VANCOUVER, B.C.
CANADA V7J 2C1

TELEPHONE: (604)984-0221
TELEX: 043-52597

• ANALYTICAL CHEMISTS • GEOCHEMISTS • REGISTERED ASSAYERS

CERTIFICATE OF ASSAY

TO : EMPIRE RESOURCES INC.
STE. 901-675 WEST HASTINGS STREET,
VANCOUVER, B.C.
V6B 1P2

CERT. # : A8110142-001-
INVOICE # : I8110142
DATE : 10-FEB-81
P.O. # : NONE

Sample description	Prep code	Pb percent	Zn percent	Ag oz/t	Au oz/t		
# 01	207	--	--	2.19	0.866	200-250 Top Hand Frame	--
#1 SHAFT DUMP	207	--	--	15.70	0.556	ADAMCOST	--
#2 TRENCH NORTH	207	--	--	0.18	0.002	150-200 Hand Frame	--
16401	207	3.05	0.41	1.86	0.056	Hand Frame - open unit	--
70836	207	--	--	0.09	0.003		--
70837	207	--	--	0.12	<0.003		--
70838	207	--	--	0.12	<0.003		--
70839	207	--	--	0.06	<0.002		--
70840	207	--	--	0.36	<0.003		--
70841	207	--	--	0.16	<0.003		--
70842	207	--	--	0.02	<0.003		--
70843	207	--	--	0.01	<0.003		--
70844	207	--	--	0.10	<0.003		--
70845	207	--	--	0.04	<0.003		--
70846	207	--	--	<0.01	<0.003		--
70847	207	--	--	0.10	<0.003		--
70848	207	--	--	0.01	<0.003		--
70849	207	--	--	0.14	<0.003		--

B. Swaites

Registered Assayer, Province of British Columbia





CHEMEX LABS LTD.

212 BROOKSBANK AVE
NORTH VANCOUVER, B.C.
CANADA V7J 2C1
TELEPHONE: (604) 984-0221
TELEX: 043-52597

ANALYTICAL CHEMISTS

GEOCHEMISTS

REGISTERED ASSAYERS

CERTIFICATE OF ANALYSIS

TO : RAPINE RESOURCE INC.
STE. 201-676 WEST HASTINGS STREET,
VANCOUVER, B.C.
V6E 1P2

CERT. # : A0110175-001
INVOICE # : I0110175
DATE : 10-27-81
C.O. # : NONE

Sample description	Prod code	Cu percent	Pb percent	Fe percent	Ag g/t	Au g/t	
93966	207	0.01	<0.001	--	1.91	0.010	--
93967	207	--	<0.001	--	2.92	0.015	--
R1045	207	--	<0.001	0.75	0.04	<0.002	--

2-306 surface samples



MEMBER
CANADIAN TESTING
ASSOCIATION

Registered Assay by the Province of British Columbia



CHEMEX LABS LTD.

212 BROOKSBANK AVE
NORTH VANCOUVER, B.C.
CANADA V7J 2C1
TELEPHONE (604)984-0221
TELEX 043-52597

ANALYTICAL CHEMISTS

GEOCHEMISTS

REGISTERED ASSAYERS

CERTIFICATE OF ASSAY

TO : EMPIRE RESOURCES INC.
STE. 901-675 WEST HASTINGS STREET,
VANCOUVER, B.C.
V6B 1P2

CERT. # : 48110218-001-
INVOICE # : 18110218
DATE : 24-FEB-81
P.C. # : NONE

Sample description	Prep code	Ag oz/t	Au oz/t
93968	207	3.34	0.024

Surface Samples



Ken Amos
Registered Assayer, Province of British Columbia

EMPIRE RESOURCES INC.

FINANCIAL STATEMENTS

AS AT MARCH 31, 1981

AUDITORS' REPORT

To the Shareholders of,
Empire Resources Inc.

We have examined the balance sheet of Empire Resources Inc., as at March 31, 1981 and the related statement of changes in financial position for the period then ended. Our examination was made in accordance with generally accepted auditing standards, and accordingly included such tests and other procedures as we considered necessary in the circumstances.

In our opinion, these financial statements present fairly the financial position of the company as at March 31, 1981 and the costs of its exploration activities and the changes in its financial position for the period then ended, in accordance with generally accepted accounting principles.



Chartered Accountants

Vancouver, B.C.
April 28, 1981

EMPIRE RESOURCES INC.

BALANCE SHEET

AS AT MARCH 31, 1981

ASSETS

CURRENT ASSETS:

Cash	\$114,262	
Funds held in trust	2,000	
Accrued interest receivable	826	\$117,088

MINERAL PROPERTIES (Note 1):

Rights to claims acquired by issue of 750,000 shares at a value of 10¢ per share	75,000	
Rights to claims acquired for cash	500	75,500

DEFERRED COSTS (Schedule 1) -

102,840
\$295,428

LIABILITIES AND SHARE CAPITAL

ACCOUNTS PAYABLE AND ACCRUED CHARGES -

\$ 7,228

SHARE CAPITAL:

Authorized -
10,000,000 shares without par value

Issued and fully paid - (Note 4)

1,027,000 shares for cash	\$213,200	
750,000 shares as consideration for rights to claims (Notes 1 & 4)	75,000	288,200
<u>1,777,000</u>		

\$295,428
=====

APPROVED ON BEHALF OF THE BOARD:

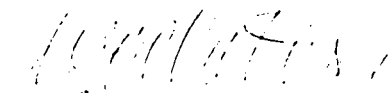

Director.

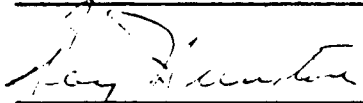

Director.

The accompanying notes form an integral part of these financial statements.

EMPIRE RESOURCES INC.

STATEMENT OF CHANGES IN FINANCIAL POSITION

FOR THE PERIOD FROM THE DATE OF INCORPORATION

OCTOBER 5, 1979 TO MARCH 31, 1981

SOURCE OF WORKING CAPITAL:

Sale of share capital for cash \$213,200

APPLICATION OF WORKING CAPITAL:

Deferred costs		\$102,840	
Purchase of mineral claims	\$75,500		
Less - consideration given therefor in the form of treasury shares	<u>75,000</u>	<u>500</u>	<u>103,340</u>

WORKING CAPITAL MARCH 31, 1981 - \$109,860
=====

REPRESENTED BY:

Current Assets \$117,088

Current Liabilities 7,228

\$109,860
=====

The accompanying notes form an integral part of these financial statements.

EMPIRE RESOURCES INC.

SCHEDULE OF DEFERRED COSTS

FOR THE PERIOD FROM THE DATE OF INCORPORATION

OCTOBER 5, 1979 TO MARCH 31, 1981DIRECT COSTS:

Oil and gas prospects (Note 2) -

Grampian	\$ 33,724	
Madera	16,330	
Coldport	16,330	
Finder's fee	5,000	
Engineering	2,303	\$ 73,687

Mineral exploration -

Engineering and consulting	1,060	
Licenses and fees	780	
Field travel	665	
Assays	253	
Drilling	9,000	
Trenching	1,122	12,880
		<u>86,567</u>

INDIRECT COSTS:

Administration and general -

Accounting and audit	1,675	
Legal	10,607	
Office supplies and expenses	644	
Office rent	592	
Transfer agent	710	
Printing	1,852	
Telephone	210	
Sundry	209	
	<u>16,499</u>	
<u>Deduct - interest income</u>	826	
	<u>15,673</u>	
Incorporation costs	600	16,273

BALANCE AS AT MARCH 31, 1981 -\$102,840
=====

The accompanying notes form an integral part of these financial statements.

EMPIRE RESOURCES INC.

NOTES TO FINANCIAL STATEMENTS

MARCH 31, 1981

1. MINERAL PROPERTIES

Mineral properties owned or under option as at March 31, 1981 consisted of: -

- | | |
|---|-----------------|
| (a) Three reverted Crown-granted mineral claims in the Greenwood Mining Division, Province of British Columbia (Granite, Dynamite and Balmoral) acquired for 750,000 shares of the capital stock of the Company issued at a deemed price of 10¢ per share | \$75,000 |
| (b) One mineral claim in the Greenwood Mining Division, Province of British Columbia (Anarchist, Lot 647) optioned for plus \$50,000 to be paid as a 10% royalty on the net smelter returns from the claim | 500 |
| | <u>\$75,500</u> |

2. OIL AND GAS INTERESTS

The Company has acquired in Clearfield County, Pennsylvania, U.S.A. a 5% beneficial interest of a 68.6250 net percentage interest in two wells located within the Madera Prospect, an undivided 5% beneficial interest of a 68.6250 net percentage interest in two wells located within the Coalport Prospect and an undivided 10% beneficial interest of a 68.6250 net percentage interest in two wells located within the Grampian Prospect.

3. REMUNERATION OF DIRECTORS AND OFFICERS

No remuneration was paid or is payable during the period to directors and officers, as defined in the Companies Act, British Columbia.

..... Cont'd

EMPIRE RESOURCES INC.NOTES TO FINANCIAL STATEMENTSMARCH 31, 19814. SHARE CAPITAL

Since incorporation the following shares have been issued:

	<u>NUMBER</u>	<u>AMOUNT</u>
For cash		
At \$0.10	422,000	\$ 42,200
At \$0.20	355,000	71,000
At \$0.40	250,000	100,000
	<u>1,027,000</u>	<u>213,200</u>
For mineral properties		
At \$0.10	<u>750,000</u>	<u>75,000</u>
	1,777,000	\$288,200
	=====	=====

Of the 1,777,000 shares issued 750,000 are held in escrow subject to the order of the British Columbia Securities Commission.

5. SUMMARY OF SIGNIFICANT ACCOUNTING POLICIES(a) Deferred Costs

The Company is in the development stage and has established a policy of deferring all costs relating to exploration projects, including related administration costs, until such time as the projects are put into commercial production, abandoned or sold. The accumulated deferred costs on exploration projects which are abandoned are written-off to deficit.

(b) Values

The amounts shown for mineral properties and deferred costs represent costs to date and do not necessarily reflect present or future values.



CANADIAN IMPERIAL
BANK OF COMMERCE

HASTINGS & GRANVILLE
VANCOUVER, B.C.

0 9 6 1

Feb 12 1981

PAY TO THE
ORDER OF

Chemex Labs

\$ 182.50

One hundred & Eighty Two ⁵⁰ DOLLARS

EMPIRE RESOURCES INC.

NO. *52*

Ray Hunter *CPA*

⑈074⑈ ⑆00010⑈010⑆ 34⑈13519⑈

⑈0000018250⑈



CANADIAN IMPERIAL
BANK OF COMMERCE

HASTINGS & GRANVILLE
VANCOUVER, B.C.

Feb 18 1981

PAY TO THE
ORDER OF

Chemex Labs Ltd

\$ 61.00

Sixty One ^{xx} DOLLARS

EMPIRE RESOURCES INC.

NO. *53*

Ray Hunter *CPA*

⑈074⑈ ⑆00010⑈010⑆ 34⑈13519⑈

⑈0000006100⑈



CANADIAN IMPERIAL
BANK OF COMMERCE

HASTINGS & GRANVILLE
VANCOUVER, B.C.

Feb 26 1981

PAY TO THE
ORDER OF

Chemex Labs Ltd

\$ 9.50

Nine ⁵⁰ DOLLARS

EMPIRE RESOURCES INC.

NO. *56*

Ray Hunter *CPA*

⑈074⑈ ⑆00010⑈010⑆ 34⑈13519⑈

⑈0000000950⑈

+ Admin (Statement \$ 11725⁰⁰) T.K

FEB 22 1981

**CANADIAN IMPERIAL
BANK OF COMMERCE**
HASTINGS & GRANVILLE
VANCOUVER, B.C.

PAY TO THE
ORDER OF

Newmac Industries Ltd.

\$ 4860.00

Four thousand, Eight hundred & Sixty - ^{xx} DOLLARS

EMPIRE RESOURCES INC.

NO. 45

Ray Samston (Signature)

⑈074⑈ ⑆00010⑈010⑆ 34⑈13519⑈

⑈0000486000⑈

207 113 2 4 7 Feb 4 1981

**CANADIAN IMPERIAL
BANK OF COMMERCE**
HASTINGS & GRANVILLE
VANCOUVER, B.C.

PAY TO THE
ORDER OF

Newmac Industries Ltd.

\$ 4140.00

Four thousand One hundred & Forty - ^{xx} DOLLARS

EMPIRE RESOURCES INC.

NO. 50

Ray Samston (Signature)

⑈074⑈ ⑆00010⑈010⑆ 34⑈13519⑈

⑈0000414000⑈

DIAMOND DRILL RECORD,

HOLE NO. 1(3) on box.

PROPERTY Anarchist Empire Res Inc.

SHEET NUMBER 1
 LATITUDE 49°06'N-^{long} 119°13'W
 DEPARTURE NTS 82E/3
 ELEVATION _____

SECTION FROM _____ TO _____
 DATUM _____
 BEARING N55W.
 DIP -60°

STARTED Jan 21 1981
 COMPLETED Jan 22 1981
 ULTIMATE DEPTH 125
 PROPOSED DEPTH 125

DEPTH FEET	CORE RECOV	DESCRIPTION	CORE SAMPLE NO.	FOOTAGE	CORE ASSAYS				SLUDGE SAMPLE		SLUDGE ASSAYS			
					AG.	CU.	PB.	ZN.	NO.	FOOTAGE	AG.	CU.	PB.	ZN.
0-15	967	Altered Qtz Diorite Minor Pyt.												
15-23	"	Altered Qtz Diorite Minor Pyt.												
23-26	"	Altered Qtz Diorite Minor Pyt.												
26-33	"	Altered Qtz Diorite Minor Pyt.												
33-43	"	Altered Qtz Diorite Minor Pyt. at 34' 1/2" band of chlorite.												
		at 37' 1/2" band of chlorite												
43-53	"	Altered Qtz Diorite Minor Pyt. at 44' 1/2" band Chlorite, at 46.5' 3/4" Qtz stringer 60° to DDH.												
53-63	"	Altered Qtz Diorite Minor Pyt. Occasional Chlorite bands.												
63-73	"	Altered Qtz Diorite Minor Pyt. at 66' shear minor chlorite. shear 75° to DDH.												

9686

[Handwritten signature]

DIAMOND DRILL RECORD,

HOLE NO. _____

PROPERTY _____

SHEET NUMBER 2 SECTION FROM _____ TO _____ STARTED _____

LATITUDE _____ DATUM _____ COMPLETED _____

DEPARTURE _____ BEARING _____ ULTIMATE DEPTH _____

ELEVATION _____ DIP _____ PROPOSED DEPTH _____

DEPTH FEET	CORE RECOV	DESCRIPTION	CORE SAMPLE NO.	FOOTAGE	CORE ASSAYS				SLUDGE SAMPLE		SLUDGE ASSAYS			
					AG.	CU.	PB.	ZN.	NO.	FOOTAGE	AG.	CU.	PB.	ZN.
		66-71 Series of Minor Chlorite bands.												
		at 71' 2 1/2" of chlorite.												
73-79	"	Altered Qtz Diorite Minor Pyt.												
		73.5' shear 60° to DDH												
		73.8' 1/2" chlorite band.			Ag	Cu								
79-85	"	Qtz Vein Minor Pyt, PbS; Znd.			.09	.003								
85-90	"	Qtz Vein Minor Pyt.			.12	.003								
90-95	"	Qtz Vein Minor Pyt.			.12	.002								
95-100	"	Qtz Vein Minor Pyt. Some			.06	2.003								
		Altered Qtz Diorite.												
100-110	"	Altered Qtz Diorite Minor Pyt												
110-120	"	Altered Qtz Diorite Minor Pyt.												
120-125	"	Altered Qtz Diorite Minor Pyt.												

DIAMOND DRILL RECORD,

HOLE NO. #2 (4 on box)

PROPERTY Archist Empire Res. Inc.

SHEET NUMBER 1

SECTION FROM _____ TO _____

STARTED Jan 20 1981

Lat
LATITUDE 49° 06' N 119° 13' W

DATUM _____

COMPLETED Jan 21 1981

DEPARTURE N 05 82 E 13

BEARING N 78 W.

ULTIMATE DEPTH 140'

ELEVATION _____

DIP -60°

PROPOSED DEPTH 140'

DEPTH FEET	CORE RECOV	DESCRIPTION	CORE SAMPLE NO.	FOOTAGE	CORE ASSAYS				SLUDGE SAMPLE		SLUDGE ASSAYS			
					AG.	CU.	PB.	ZN.	NO.	FOOTAGE	AG.	CU.	PB.	ZN.
0-13	96%	Altered Qtz Diorite Minor Pyt Minor Chlorite Mineralization												
13-23	"	Altered Qtz Diorite Minor Pyt Minor Chlorite Dyke at 13.6-14.0 Vert Mafic mineralization.												
23-33	"	Altered Qtz Diorite Minor Pyt. 32.6'-33' Mottled Qtz.												
33-43	"	Altered Qtz Diorite Minor Pyt.												
43-53	"	Altered Qtz Diorite Minor Pyt. 45-46 Silicified section minor mafics, 51' shear, chlorite min. shear 70' to DDH.												
53-63	"	Altered Qtz Diorite minor pyt, fair concentration of biotite. shear 55°												

9686

[Handwritten signature]

DIAMOND DRILL RECORD,

HOLE NO. _____

PROPERTY _____

SHEET NUMBER 2 SECTION FROM _____ TO _____ STARTED _____

LATITUDE _____ DATUM _____ COMPLETED _____

DEPARTURE _____ BEARING _____ ULTIMATE DEPTH _____

ELEVATION _____ DIP _____ PROPOSED DEPTH _____

DEPTH FEET	CORE RECOV	DESCRIPTION	CORE SAMPLE NO.	FOOTAGE	CORE ASSAYS				SLUDGE SAMPLE		SLUDGE ASSAYS			
					AG.	CU.	PB.	ZN.	NO.	FOOTAGE	AG.	CU.	PB.	ZN.
		<i>To DDH.</i>												
<i>63-73'</i>	<i>"</i>	<i>Altered Qtz Diorite Minor Pyt concentration of chlorite at 71.5'</i>												
					<i>Ag</i>	<i>Au</i>								
<i>73-83</i>	<i>"</i>	<i>Qtz Vein Minor Pyt, Pbs & Zns</i>			<i>.36</i>	<i>4.003</i>								
<i>83-93</i>	<i>"</i>	<i>Qtz Vein, horse for 6' (Altered Diorite)</i>			<i>.16</i>	<i>4.003</i>								
<i>93-103</i>	<i>"</i>	<i>Qtz Vein Minor Pyt, Pbs & Zns</i>			<i>.02</i>	<i>4.003</i>								
<i>103-108</i>	<i>"</i>	<i>Qtz Vein Minor Pyt</i>			<i>.01</i>	<i>4.003</i>								
<i>108-113</i>	<i>"</i>	<i>Altered Qtz Diorite Minor Pyt.</i>												
<i>113-118</i>	<i>"</i>	<i>Altered Qtz Diorite Minor Pyt.</i>												
<i>118-125</i>	<i>"</i>	<i>Altered Qtz Diorite Minor Pyt</i>												
<i>125-129</i>	<i>"</i>	<i>Altered Qtz Diorite Minor Pyt</i>												
<i>129-132</i>	<i>"</i>	<i>Altered Qtz Diorite Minor Pyt.</i>												
<i>132-135</i>	<i>"</i>	<i>Altered Qtz Diorite Minor Pyt.</i>												
<i>135-140</i>	<i>"</i>	<i>Altered Qtz Diorite Minor Pyt.</i>												

[Handwritten signature]

DIAMOND DRILL RECORD,

HOLE NO. #3 (on son box)

PROPERTY Marchist Empire Res Inc.

SHEET NUMBER 1

SECTION FROM _____ TO _____

STARTED Jan 25 1981

LATITUDE Lat 49° 06' N - Long 119° 13' W

DATUM _____

COMPLETED Jan 27 1981

DEPARTURE NTS 82 E 1/3

BEARING N 78 W

ULTIMATE DEPTH 101'

ELEVATION _____

DIP -60°

PROPOSED DEPTH _____

DEPTH FEET	CORE RECOV	DESCRIPTION	CORE SAMPLE NO.	FOOTAGE	CORE ASSAYS				SLUDGE SAMPLE		SLUDGE ASSAYS				
					AG.	CU.	PB.	ZN.	NO.	FOOTAGE	AG.	CU.	PB.	ZN.	
0-10	96%	Altered Qtz Diorite Minor Pyx Core well broken.													
10-20	"	Altered Qtz Diorite Minor Pyx.													
20-30	"	Altered Qtz Diorite Minor Pyx chlorite bands 1/2"													
30-40	"	Altered Qtz Diorite Minor Pyx.													
40-50	"	Altered Qtz Diorite Minor Pyx. shear 55° to DDH.													
50-60	"	Altered Qtz Diorite Minor Pyx. abundant 1/2" bands of chlorite.													
60-70	"	Altered Qtz Diorite Minor Pyx.													
70-80	"	Altered Qtz Diorite Minor Pyx. abundant 1/2" bands of chlorite.													
80-82	"	Altered Qtz Diorite Minor Pyx broken abundant chlorite.													
82-92.3	"	Vein Qtz													

9686

[Handwritten signature]

DIAMOND DRILL RECORD,

HOLE NO. _____

PROPERTY _____

SHEET NUMBER 2.

SECTION FROM _____ TO _____

STARTED _____

LATITUDE _____

DATUM _____

COMPLETED _____

DEPARTURE _____

BEARING _____

ULTIMATE DEPTH 101

ELEVATION _____

DIP _____

PROPOSED DEPTH _____

DEPTH FEET	CORE RECOV	DESCRIPTION	CORE SAMPLE NO.	FOOTAGE	CORE ASSAYS				SLUDGE SAMPLE		SLUDGE ASSAYS			
					AG.	CU.	PB.	ZN.	NO.	FOOTAGE	AG.	CU.	PB.	ZN.
92.3-96	"	Vein Qtz horse of altered Qtz Diorite Minor Diorite			.04	.002								
96-99	"	Vein Qtz			2.01	.003								
99-101	"	Altered Qtz Diorite Minor Pyz												

[Handwritten Signature]

DIAMOND DRILL RECORD,

HOLE NO. #4 (60N 80A)

PROPERTY Murchist Empire Res Inc.

SHEET NUMBER 1

SECTION FROM _____ TO _____

STARTED Jan 29 1981

LATITUDE 49° 06' N Long 119° 13' W

DATUM _____

COMPLETED Jan 31 1981

DEPARTURE NTS 82E13

BEARING N55 W

ULTIMATE DEPTH 108.7

ELEVATION _____

DIP -60°

PROPOSED DEPTH _____

DEPTH FEET	CORE RECOVER	DESCRIPTION	CORE SAMPLE NO.	FOOTAGE	CORE ASSAYS				SLUDGE SAMPLE		SLUDGE ASSAYS			
					AG.	CU.	PB.	ZN.	NO.	FOOTAGE	AG.	CU.	PB.	ZN.
0-8	96%	Bodily broken altered Qtz Diorite minor Pyx.												
8-10	"	altered Qtz Diorite minor Pyx.												
10-20	"	altered Qtz Diorite minor Pyx.												
20-30	"	altered Qtz Diorite minor Pyx. abundant chlorite.												
30-40	"	altered Qtz Diorite minor Pyx. chlorite, shears 57° to DDH.												
40-50	"	altered Qtz Diorite minor Pyx.												
50-60	"	altered Qtz Diorite minor Pyx.												
60-70	"	altered Qtz Diorite minor Pyx.												
70-80	"	altered Qtz Diorite minor Pyx.												
80-92.6	"	altered Qtz Diorite minor Pyx. abundant chlorite. and intense alteration at 92'			Ag	2W								
92.6-100.6	"	vein Qtz minor Sulphides			.10	2.00%								

9686

[Handwritten signature]

DIAMOND DRILL RECORD,

HOLE NO. _____

PROPERTY _____

SHEET NUMBER 2 SECTION FROM _____ TO _____ STARTED _____

LATITUDE _____ DATUM _____ COMPLETED _____

DEPARTURE _____ BEARING _____ ULTIMATE DEPTH _____

ELEVATION _____ DIP _____ PROPOSED DEPTH _____

DEPTH FEET	CORE RECOV	DESCRIPTION	CORE SAMPLE NO.	FOOTAGE	CORE ASSAYS				SLUDGE SAMPLE		SLUDGE ASSAYS			
					AG.	CU.	PB.	ZN.	NO.	FOOTAGE	AG.	CU.	PB.	ZN.
100.6-106	"	Vein Qtz Minor Sulphides			.01	2.003								
106-107	"	Vein Qtz Minor Sulphides			.14	2.003								
107-108.7	"	Altered Qtz Diorite Minor Py & Intense Alteration												

[Handwritten Signature]