

GEOLOGICAL, GEOCHEMICAL AND GEOPHYSICAL REPORT ON THE GOLDEN 1
CLAIM, SUMMERS CREEK AREA, SIMILKAMEEN MINING DIVISION (92H/9W-10E)

Latitude: 49°38' Longitude 120°30'

Owner and Operator:

Lornex Mining Corporation Ltd.
P.O. Box 10335, Pacific Centre
Suite 1650, 609 Granville St.,
Vancouver, B.C.
V7Y 1G5

By: Peter A. Christopher, Ph.D., P. Eng.



Peter A. Christopher

November 20, 1981.

9821

TABLE OF CONTENTS

INTRODUCTION	1
HISTORY	1 - 2
SUMMARY OF WORK	2 - 3
REGIONAL GEOLOGY	3 - 4
PROPERTY GEOLOGY	4 - 5
GEOPHYSICS	5 - 7
GEOCHEMICAL SURVEY	7 - 9
SUMMARY AND RECOMMENDATIONS	9
REFERENCES	10
STATEMENT OF QUALIFICATIONS	11
STATEMENT OF COSTS	12
CERTIFICATES OF ANALYSIS	
Figure 1 INDEX MAP	1 (a)
Figure 2 PROPERTY GEOLOGY	In Pocket
Figure 3 SOIL GEOCHEMISTRY COPPER	In Pocket
Figure 4 SOIL GEOCHEMISTRY MOLYBDENUM	In Pocket
Figure 5 SOIL GEOCHEMISTRY LEAD	In Pocket
Figure 6 SOIL GEOCHEMISTRY ZINC	In Pocket
Figure 7 SOIL GEOCHEMISTRY SILVER	In Pocket
Figure 8 SOIL GEOCHEMISTRY GOLD	In Pocket
Figure 9 RECCE GEOCHEM GOLDEN CLAIM	In Pocket
Figure 10 MAGNETOMETER SURVEY	In Pocket

INTRODUCTION

The Golden 1 claim is located in the Thompson Plateau of British Columbia. The claim consists of twenty (20) units (500 hectares) extending 4 units west and 5 units north from a LCP located 1200 metres north and 700 metres east of the north end of Rampart Lake. The claim is bordered on the west by the Missezula Lake (Summers Creek) Road (Figure 1).

Access is via the Missezula Lake road which branches off Hwy. 5 about 9 kilometres north of Princeton, B.C. The western boundary of the property is situated along the Missezula Lake road from about Km 19 to Km 21.5. The eastern boundary can be reached via the Rampart Creek road which branches off the Missezula Lake road at 9.6 Km, and the Dillard Main logging road. Secondary logging roads end about 150 metres east of ten north on the baseline. Easy access by foot is possible to about 1300 metres west of the baseline where the steep decline to the Summers Creek valley starts. B.C. Government air photos BC 79048 No. 0265 and 0266 cover the claim area.

The terrain varies from the steep valley wall of Summers Creek to a gently rolling upland plateau. Elevations vary from about 1000 m (3300 ft) ASL at the western boundary of the claims to just over 1500 m (4950 ft) ASL at the northern central part of the claim. The property is mainly forested with jackpine and fir with small areas of mature timber.

TABLE (1) Claim Data

<u>Name</u>	<u>Record #</u>	<u>Recorded</u>	<u>Held till</u>	<u>Work</u>
Golden 1	905 (12)	Dec. 13, 1979	Dec. 13, 1981	Cash in lieu

HISTORY

The Golden 1 claim was staked by Darrell Grigg for prospectors Gerald Burr and Edward Mullin of Princeton, B.C. in November of 1979. The claim was sold to Good Hope Resources Ltd on September

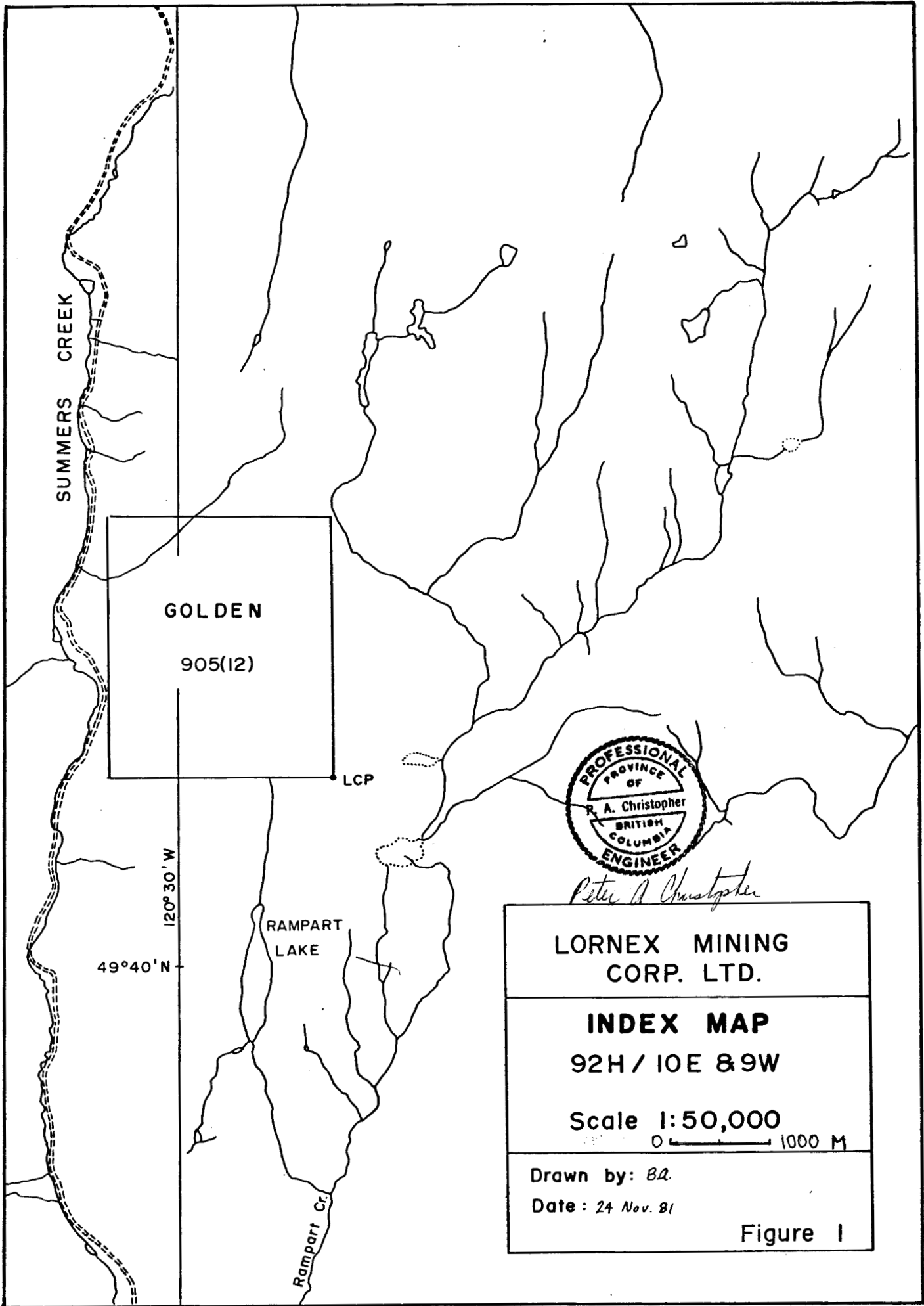

3rd, 1980 and to Lornex Mining Corporation Ltd. on September 4, 1981. The claim was staked to cover the possibility of extensions of the stratigraphically controlled mineralization present on the adjoining ground to the north (MS claims). The claims were held in 1980 by paying cash in lieu and no record of recent work on the ground was found.

Claim posts located during geological mapping suggest that several companies have previously staked the area. It has been held as the Ron claims by MacInyre Mines in 1966, the Rum claims by Amax in 1970 and the Sean claims by D. Siemens in 1972. Previous owners have not filed assessment work on the property.

The property was acquired to evaluate modest copper soil geochemical anomalies obtained during prospecting the break in slope near the western boundary of the claim. Malachite had been found in talus but no showings were known prior to this work.

SUMMARY OF WORK

From early September to mid-October, 1981 the author and a contract crew established a grid, soil sampled, ran a magnetometer survey, attempted to run VLF-EM and geologically mapped the Golden Claim. Reconnaissance, prospecting and soil lines had previously been conducted by the author (July 28, 1981) and two prospectors (August 7th, 1981). Figures 2 to 10 show the results of this work.

In order to conduct the surveys 3.0 Km of cut baseline was established along the eastern boundary of the claim and about 28 kilometres of EW cross lines were chained and flagged. Soil samples were collected at 50 metre intervals along lines spaced at 200 metre intervals. A total of 560 soil samples were collected

from the Golden claim. Magnetometer readings were taken at 25m intervals with about 25 Km surveyed. Two days were spent collecting VLF-EM reading but rechecking of stations showed that the instrument was faulty and the survey was stopped. Geological mapping of the claim was carried out at 1:5,000 scale with about 450 hectares or ninety percent of the claim area mapped.

REGIONAL GEOLOGY

The Golden claim is situated in the Intermontane Tectonic Belt of the southern Canadian Cordillera. In southern British Columbia the upper Triassic Nicola Group dominates the belt. The Nicola Group consists mainly of alkalic and calc-alkalic volcanic and volcanoclastic rocks that have been divided by Preto (1979) into three north-trending structural belts, bounded by major faults. The Summers Creek fault zone running along the western boundary of the Golden Claim separates rocks of Preto's Central belt from rocks of the Eastern Belt which underlie the property.

Eastern Belt rocks along Summers Creek include both alkalic and calc-alkalic suites derived from comagmatic intrusions and are dominated by extensive tuffs, lahar deposits, some basaltic flows, and high-level syenitic stocks (Preto, 1979; Christopher, 1973).

The Alleyne-Summers Creek fault system, a major north-south rift system passes along the western boundary of the claims and dominates the tectonic fabric of the property. Local faults generally parallel the northerly trend but N20°W and N40-45°E linears are probably also important fault directions.

Nicola rocks are generally only weakly metamorphosed with maximum regional grade reaching greenschist facies. Locally comagmatic intrusions have produced metamorphic and metasomatic effects with

deposits like Ingerbelle, Copper Mountain, Afton and Craigmont resulting.

PROPERTY GEOLOGY

The geological setting of the Golden claim is shown in Figure 2. Five units were mapped on the claim. Four of the units are part of the Triassic Nicola Group with a small intrusive body of comagmatic monzonite mapped in the western part of the claim.

Units trend between N-S to N20°E, dip moderately to the west and unless overturned, young toward the west. Units generally represent a rock package with some unifying features and may contain agglomerate, auto breccia, tuff, tuff breccia, and/or lahar. An increase in hematite noted from east to west suggests that conditions changed from submarine to partly subaerial during the deposition period.

The main tectonic fabric (faulting) appears to parallel the N-S Summers Creek fault zone. Strong air photo linears also occur at about N20°W and N40-45°E.

UNIT 1

Unit 1 mainly underlies the eastern part of the property and consists of dark grey augite andesite porphyry flows and agglomerate with minor tuff. Augite is the dominante mafic mineral but hornblende is generally present. The unit is moderately to strongly magnetic and locally exhibits epidote alteration or veining. Minor pyrite is present in the rock but only one small fracture controlled occurrence of malachite, chalcopyrite and bornite was found on the Golden claim.

UNIT 2

Unit 2 is a hornblende diorite or andesite which consists of flows agglomerate and minor tuff. Coarser grained areas, with hornblende

phenocrysts to 5 mm, may be sills or feeder dykes. The rock is generally grey and weakly to moderately magnetic with traces of pyrite and minor epidote and calcite veinlets or alteration. No copper mineralization was seen in this unit.

UNIT 3 AND UNIT 4

Units 3 and 4 are similar in lithology and composition with the exception of monzonite or syenite fragments in Unit 4. The rocks are interlayered and occupy most of the western two thirds of the claim. In general epidote-calcite alteration and veining is stronger in these units and hematite is commonly present. The units vary from weakly to moderately magnetic. Several showings with chalcopyrite, bornite, chalcocite, malachite and azurite were located. The unit generally contained only minor pyrite and had variable intensity of veining. A coarse lahar layer several metres thick was cemented with calcite. A 20 metre wide mineralized zone trending about N20°W occurs between 14N-13W and 17N-15W. Mineralization consists of malachite, bornite, chalcocite and chalcopyrite. Assays over 1% copper were obtained from small outcrops within the zone.

UNIT 5

A small plug or sill of fine to medium grained monzonite occurs near the western margin of the property. This unit is poorly exposed but appears to be similar in composition to fragmental material in Unit 4.

GEOPHYSICS

A magnetometer survey employed the use of a Model G-846 Uni Mag II Proton Magnetometer produced by EG & G GeoMetrics. Readings were collected at 25 metre interval along lines with the sensor detached and staff mounted. GeoMetric claims a one gamma accuracy for readings employing a staff mounted sensor and taken in low

gradient fields. The tuning-kilogamma knob was set at 56,000 gammas to correspond with the earth's known magnetic field. A base station magnetometer and Rustiack Recorder, Model #2146 produced by geoMetrics (geoMetrics G826A) were employed to correct for diurnal shift and to indicate magnetic storms. Phoenix Geophysics Ltd. was retained to correct magnetic data and produce strip logs of the data.

The magnetometer survey was conducted between September 17th and September 22nd, 1981. A total of about 920 stations were measured on the Golden claim. Magnetic relief on the claim is 3986 gammas with values ranging from 59,995 gammas to 56,009 gammas.

The instrument used measured total magnetic field intensity. Survey results were plotted on a magnetic survey plan at a scale of 1:5,000 (Figure 10). Results were corrected for diurnal variations and reduced by 50,000 gammas before plotting. Strip logs were produced to aid with geological interpretation.

The magnetic survey has shown the area to be one of high magnetic gradient. Magnetic patterns generally confirm the NS to N20°E strike to the rock units and general NS grain of the property. The best copper geochemistry and best copper showing are associated with a strong magnetic response on lines 12N and 14N at about 12W. The linear trend of the anomaly suggest possible fault controlled mineralization. A strong magnetic response appears to be associated with the monzonite mapped on line 16N at 18W but the magnetic pattern suggests a restricted distribution of the unit.

ELECTROMAGNETIC SURVEY

An attempt was made to employ a Geonics Ltd. model EM 16 unit for a VLF-EM survey of the claim. Readings were collected for two days but station checks showed that results could not be repeated. Instrument malfunction was determined to be the cause of the spurious results and the survey was discontinued.

GEOCHEMICAL SURVEY

A total of about 530 soil samples were collected from the Golden claim area. The initial reconnaissance samples were analysed for copper and zinc while grid station samples were analysed for Cu, Mo, Pb, Zn, Ag and Au.

Samples were collected at 50 m intervals and placed in kraft paper envelopes. The B horizon was sampled with mattock at a depth of about 15 cm. The A horizon is generally shallow except in swampy areas or creek valleys. The B horizon is generally greyish brown.

LABORATORY PROCEDURE

Samples were prepared and analysed by Chemex Labs Ltd. in North Vancouver, B.C. Soil samples were dried, sieved to -80 mesh, split to obtain a 1 gram sample and digested for 2 hours in a mixture of perchloric (HClO_4) and nitric HNO_3 acid with Cu, Pb, Zn, Mo and Ag analyses by atomic absorption (AA). Lead and Silver are background corrected. Gold analyses were by fire assay (FA) and AA. FA uses 10 g with standard FA methods to produce a bead. Aqua regia is used to digest the bead and final analyses is by standard AA.

Rock samples were crushed and pulverized to -100 mesh, acid digested and analysed by standard AA.

RESULTS AND INTERPRETATION

Results from Cu, Mo, Pb, Zn, Ag and Au were plotted on a 1:5,000 scale maps (Figures 3 to 8) for comparison with the property geology and magnetic maps. Recce Cu and zinc values were plotted on Figure 9. Background, slightly anomalous and anomalous ranges for elements were based on other surveys conducted over Nicola volcanic terrain. Statistical treatment was not attempted because of the low number of anomalous samples. Assay results are included in the appendix at the end of this report.

COPPER

Copper values plotted on Figure 3 range from 2 to 475 ppm with values between 75 and 150 ppm considered weakly anomalous and over 150 ppm considered anomalous. A total of 27 weakly anomalous and 10 anomalous samples were detected. Most anomalous copper values occur at or near the cliff area and south from L16N. Copper mineralization was found in float and outcrop along the anomalous trend. Two short chip samples (#26927 and 26928) contained over 1% copper.

Molybdenum values plotted on Figure 4 range from 1 to 3 ppm and none of the samples are considered anomalous.

LEAD

Lead values plotted on Figure 5 range from 1 to 530 ppm with only one anomalous value at L20N - 12W over 100 ppm and values between 21 ppm and 100 ppm considered weakly anomalous. The 3 values considered anomalous or weakly anomalous occur between 11 + 50W and 13W on line 20N.

ZINC

Zinc values plotted on Figure 6 range from 3 to 210 ppm with only six weakly anomalous values over 150 ppm. Weakly anomalous values are generally in or near stream valleys and may result from scavenging by organics.

SILVER

Silver values plotted on Figure 7 range from 0.1 ppm (detection limit) to 1.2 ppm with only one value on L8N over 1 ppm. Values between >0.5 ppm and 1.5 ppm were considered weakly anomalous. Only 6 weakly anomalous samples were found and 5 of the 6 anomalous samples occur in or near stream channels. Silver values in rock samples of 16.5 ppm (#26927) and 20.0 ppm (#26928) indicate a positive correlation between copper and silver mineralization.

GOLD

Gold values plotted on Figure 8 range from < 5 ppb (detection limit) to 95 ppb with only one value on line 6S at 14 + 50W over 50 ppb and four values between 21 ppb and 100 ppb considered weakly anomalous. No anomalous values (ie. over 100 ppb) were obtained. Two adjacent weakly anomalous samples were found on line 6S at 14W and 14 + 50W. No coincident gold and silver highs occur.

RECONNAISSANCE SOILS

Reconnaissance samples were analysed for Cu and Zn and values shown on Figure 9. Modest anomalous values for copper (to 220 ppm) and zinc (to 155 ppm) and precious metal potential in this belt led to acquisition of the Golden claim.

SUMMARY AND RECOMMENDATION

A moderate intensity copper anomaly located during reconnaissance soil samples has been confirmed by more detailed soil sampling, mapping and geophysical survey. A north-south copper bearing zone has been located but the uphill potential (eastward) for extending the mineralized zone is limited by negative soil geochem and prospecting results.

Additional soil sampling should be tried in the SW corner of the claim where the highest copper values occur. The extent of the showings on lines 14W and 12W should be checked by trenching.

REFERENCES

Christopher, P.A., 1973 Preliminary geological map of the Aspen Grove Area, British Columbia, B.C. Ministry of Energy, Mines & Petroleum Resources, Preliminary Map No. 10.

Preto, V.A., 1979. Geology of the Nicola Group between Merritt and Princeton. B.C. Ministry of Energy, Mines & Petroleum Resources, Bulletin No. 69, P. 1- 90.

STATEMENT OF QUALIFICATIONS

The fieldwork for this report was supervised by Peter A. Christopher whose qualifications are outlined below.

Peter A. Christopher, P. Eng., Ph.D., Exploration Manager for Peter A. Christopher and Assoc. Inc., Vancouver, British Columbia.

Completed his B.Sc. at the State University of New York at Fredonia in 1966, M.A. at Dartmouth College in 1968, and Ph.D at the University of British Columbia in 1973. He has worked for several mining companies on porphyry, massive sulphide, uranium, and gold deposits in the western United States and Canada. He served as exploration geologist for Newmont Mining Corporation, in 1973 and 1974, as project geologist with the British Columbia Ministry of Energy, Mines and Petroleum Resources, from 1974 to 1980 and as senior geologist for Utah Mines from June 1980 to July 1981. In July, 1980 he assumed his present position.

STATEMENT OF COSTS.

<u>Personnel</u>	<u>Dates (1981)</u>	<u>Days</u>	<u>Rate</u>	<u>Cost</u>
Senior Geologist Peter Christopher	July 28, Sept. 16, 20-28 Oct. 1,7,15, ½22. Nov. 13, 16-19	19½	200	\$3,900.00
Prospectors: Shaun Godwin	July 28 and Aug. 17	2	60	120.00
John Cathro	July 28 and Aug. 7	2	60	120.00
Line cutter, geophysical operator and samplers:				
T. Mackenzie	Sept. 8-23	16	150	2,400.00
Pierre Mackenzie	Sept. 8-23	16	150	2,400.00
Motel Accomodation		18	35/day	625.40
Board		33	25/day	1,075.00
Camp and Field gear				350.00
Truck Rental, 4 wheel drive		11	30/day	330.00
2 wheel drive		16	+mileage 20/day + gas	320.00
Mileage: 1500 Km			0.15/Km	225.00
Gas				163.33
Instrument Rental *				1,000.00
Geophysical data treatment - Phoenix Geophysics Ltd.				444.78
Materials				195.95
Miscellaneous: Phone, postage, etc.				39.19
Drafting, typing and reproduction costs				700.00
Geochemical Analyses - Chemex Labs Ltd.				6,225.95
TOTAL COST				\$ 20,634.60

* Base-station Magnetometer ½ month @ 1,477.00/month.
 Proton Magnetometer ½ month @ 400.00/month.
 EM 16 4 days @ 500.00/ month.

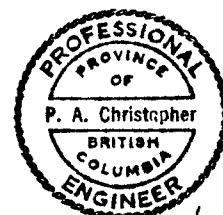

Peter A. Christopher

A P P E N D I X
CERTIFICATES OF ANALYSIS



CHEMEX LABS LTD.

212 BROOKSBANK AVE.
NORTH VANCOUVER, B.C.
CANADA V7J 2C1
TELEPHONE: (604)984-0221
TELEX: 043-52597

• ANALYTICAL CHEMISTS • GEOCHEMISTS • REGISTERED ASSAYERS

CERTIFICATE OF ANALYSIS

TO : LORNE MINING CORP. LTD.
ATTN: D.R. BUDINSKI, MGR. OF EXPL.
P. O. BOX 10335, STOCK EXCHANGE TOWER
STE 1650 - 609 GRANVILLE ST.
VANCOUVER, B.C. V7Y 1G5

CERT. # : A8114043-001-1
INVOICE # : 18114043
DATE : 26-OCT-81
P.O. # : NONE
GOLDEN

ATTN: R. BUDINSKI

CORRECTED COPY

To P. A. C.

Sample description	Prep code	Cu ppm	Mo ppm	Pb ppm	Zn ppm	Ag ppm	Au ppb	FA+AA ppb
ON 00+00 W	201	43	2	2	70	0.2		5
ON 00+50 W	201	28	1	1	86	0.1		10
ON 01+00 W	201	41	1	5	83	0.2		5
ON 01+50 W	201	49	1	2	62	0.1		10
ON 02+00 W	201	51	1	5	75	0.2		5
ON 02+50 W	201	52	1	10	65	0.1		10
ON 03+00 W	201	41	1	4	85	0.1		10
ON 03+50 W	201	39	1	3	110	0.3		10
ON 04+00 W	201	34	1	5	210	0.2		10
ON 04+50 W	201	35	1	4	98	0.2		10
ON 05+00 W	201	34	1	6	80	0.2		5
ON 05+50 W	201	50	1	2	55	0.4		10
ON 06+00 W	201	49	1	5	52	0.2		20
ON 06+50 W	201	47	1	6	75	0.4		10
ON 07+00 W	201	56	1	6	50	0.2		10
ON 07+50 W	201	32	1	4	60	0.2		10
ON 08+00 W	201	49	1	2	74	0.1		25
ON 08+50 W	201	33	1	3	95	0.4		10
ON 09+00 W	201	44	1	4	74	0.1		5
ON 09+50 W	201	39	2	6	76	0.2		15
ON 10+00 W	201	38	1	4	112	0.2		10
ON 10+50 W	201	41	1	4	70	0.1		10
ON 11+00 W	201	22	1	2	80	0.1		5
ON 11+50 W	201	35	1	6	68	0.1		5
ON 12+00 W	201	101	1	6	72	0.2		<5
ON 12+50 W	201	45	1	5	75	0.1		<5
ON 13+00 W	201	59	1	6	72	0.2		5
ON 13+50 W	201	31	1	3	96	0.2		5
ON 14+00 W	201	35	1	6	88	0.1		5
2N 00+00 W	201	52	1	1	73	0.1		5
2N 00+50 W	201	49	1	2	85	0.2		<5
2N 01+00 W	201	37	1	1	68	0.1		<5
2N 01+50 W	201	36	1	1	68	0.1		5
2N 02+00 W	201	36	1	1	55	0.1		5
2N 02+50 W	201	210	1	2	60	0.4		5
2N 03+00 W	201	57	1	3	103	0.1		5
2N 03+50 W	201	35	1	6	80	0.1		5
2N 04+00 W	201	38	1	6	56	0.1		5
2N 04+50 W	201	23	1	3	47	0.1		15
2N 05+00 W	201	34	1	3	56	0.1		<5

Hank Buchler

Certified by



MEMBER
CANADIAN TESTING
ASSOCIATION



CHEMEX LABS LTD.

212 BROOKSBANK AVE.
 NORTH VANCOUVER, B.C.
 CANADA V7J 2C1
 TELEPHONE: (604)984-0221
 TELEX: 043-52597

• ANALYTICAL CHEMISTS

• GEOCHEMISTS

• REGISTERED ASSAYERS

CERTIFICATE OF ANALYSIS

TO : LORNEX MINING CORP. LTD.
 ATTN: D.R. BUDINSKI, MGR. OF EXPL.
 P. O. BOX 10335, STOCK EXCHANGE TOWER
 STE 1650 - 609 GRANVILLE ST.
 VANCOUVER, B.C. V7Y 1G5

CERT. # : A8114043-002-A
 INVOICE # : 18114043
 DATE : 09-OCT-81
 P.C. # : NONE
 GOLDEN

ATTN: R. BUDINSKI

Sample description	Prep code	Cu ppm	Mo ppm	Pb ppm	Zn ppm	Ag ppm	Au	FA+AA ppb
2N 05+50 W	201	31	1	6	68	0.1		5
2N 06+00 W	201	38	1	3	60	0.2		5
2N 07+00 W	201	19	1	1	63	0.1		5
2N 07+50 W	201	59	1	4	50	0.2		5
2N 08+00 W	201	63	1	3	70	0.3		5
2N 08+50 W	201	53	1	5	63	0.6		5
2N 09+00 W	201	41	1	5	67	0.2		10
2N 09+50 W	201	38	1	5	58	0.1		<5
2N 10+00 W	201	18	1	2	63	0.1		<5
2N 10+50 W	201	20	1	2	55	0.1		5
2N 11+00 W	201	34	1	3	58	0.1		5
2N 11+50 W	201	30	1	4	67	0.1		5
2N 12+00 W	201	32	1	4	81	0.1		<5
2N 12+50 W	201	51	1	7	55	0.3		<5
2S 00+00 W	201	37	1	2	80	0.2		5
2S 00+50 W	201	31	1	8	68	0.1		5
2S 01+00 W	201	26	1	3	60	0.2		5
2S 01+50 W	201	49	1	5	75	0.1		5
2S 02+00 W	201	39	1	4	78	0.3		5
2S 02+50 W	201	94	1	3	63	0.5		5
2S 03+00 W	201	44	1	4	65	0.3		5
2S 03+50 W	201	27	1	5	50	0.1		<5
2S 04+00 W	201	59	1	6	93	0.1		5
2S 04+50 W	201	104	1	2	100	0.8		10
2S 05+00 W	201	67	1	6	69	0.5		5
2S 05+50 W	201	52	1	5	62	0.5		5
2S 06+00 W	201	58	1	4	50	0.2		5
2S 06+50 W	201	8	1	1	3	0.2		5
2S 07+00 W	201	52	1	5	78	0.4		5
2S 07+50 W	201	47	1	4	70	0.4		5
2S 08+00 W	201	29	1	5	78	0.1		<5
2S 08+50 W	201	34	1	2	52	0.1		5
2S 09+00 W	201	46	1	5	65	0.2		5
2S 09+50 W	201	55	1	4	65	0.1		<5
2S 10+00 W	201	47	1	6	63	0.1		<5
2S 10+50 W	201	39	1	4	50	0.1		5
2S 11+00 W	201	24	1	3	57	0.4		<5
2S 11+50 W	201	50	1	6	60	0.2		<5
2S 12+00 W	201	50	1	5	55	0.2		10
2S 12+50 W	201	35	1	2	75	0.1		5

Certified by *J.F. McKay*



MEMBER
 CANADIAN TESTING
 ASSOCIATION



CHEMEX LABS LTD.

212 BROOKSBANK AVE.
 NORTH VANCOUVER, B.C.
 CANADA V7J 2C1
 TELEPHONE: (604)984-0221
 TELEX: 043-52597

• ANALYTICAL CHEMISTS • GEOCHEMISTS • REGISTERED ASSAYERS

CERTIFICATE OF ANALYSIS

TO : LORNE MINING CORP. LTD.
 ATTN: D.R. BUDINSKI, MGR. OF EXPL.
 P. O. BOX 10335, STOCK EXCHANGE TOWER
 STE 1650 - 609 GRANVILLE ST.
 VANCOUVER, B.C. V7Y 1G5

CERT. # : A8114043-003-AA
 INVOICE # : I8114043
 DATE : 09-OCT-81
 P.O. # : NONE
 GOLDEN

ATTN: R. BUDINSKI

Sample description	Prep code	Cu ppm	Mo ppm	Pb ppm	Zn ppm	Ag ppm	Au ppb	FA+AA ppb
2S 13+00 W	201	42	1	4	88	0.1		<5
2S 13+50 W	201	29	1	3	47	0.1		<5
2S 14+00 W	201	15	1	1	102	0.1		5
2S 14+50 W	201	27	1	3	85	0.1		5
4N 00+00W	201	37	1	1	83	0.2		<5
4N 00+50W	201	43	1	1	65	0.1		<5
4N 01+00W	201	31	1	1	54	0.2		<5
4N 01+50W	201	23	1	1	50	0.1		<5
4N 02+00W	201	35	1	1	55	0.3		<5
4N 02+50W	201	40	1	1	59	0.1		<5
4N 03+00W	201	53	1	1	57	0.1		5
4N 03+50W	201	43	2	1	68	0.1		10
4N 04+00W	201	45	1	6	76	0.1		5
4N 04+50W	201	43	1	7	77	0.2		5
4N 05+00W	201	59	1	10	83	0.2		5
4N 05+50W	201	91	1	10	77	0.5		15
4N 06+00W	201	50	1	10	88	0.1		5
4N 06+50W	201	36	1	7	50	0.1		10
4N 07+00W	201	66	1	8	72	0.1		10
4N 07+50W	201	48	1	8	75	0.1		10
4N 08+00W	201	39	1	4	62	0.1		5
4N 08+50W	201	46	1	2	68	0.2		20
4N 09+00W	201	31	1	3	65	0.3		5
4N 09+50W	201	31	1	6	84	0.1		5
4N 10+00W	201	77	1	4	70	0.1		5
4N 10+50W	201	38	1	9	70	0.1		<5
4N 11+00W	201	36	1	1	65	0.1		5
4N 11+50W	201	28	1	1	70	0.2		5
4N 12+00W	201	51	1	4	66	0.1		5
4N 12+50W	201	56	1	1	44	0.1		5
4N 13+00W	201	36	1	2	68	0.1		50
4N 13+50W	201	51	1	2	65	0.4		10
4S 00+00W	201	40	1	2	75	0.2		5
4S 00+50W	201	42	1	3	61	0.3		<5
4S 01+00W	201	39	1	1	62	0.2		5
4S 01+50W	201	36	1	1	81	0.1		<5
4S 02+00W	201	31	1	1	67	0.3		<5
4S 02+50W	201	36	1	2	62	0.3		<5
4S 03+00W	201	31	1	2	63	0.1		5
4S 03+50W	201	29	1	1	53	0.2		5

Certified by *J.F. McKay*



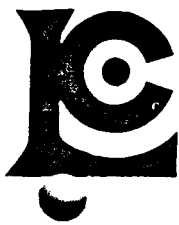

CHEMEX LABS LTD.

212 BROOKSBANK AVE.
NORTH VANCOUVER, B.C.
CANADA V7J 2C1
TELEPHONE: (604)984-0221
TELEX: 043-52597

• ANALYTICAL CHEMISTS • GEOCHEMISTS • REGISTERED ASSAYERS

CERTIFICATE OF ANALYSIS

TO : LORNEX MINING CORP. LTD.
ATTN: D.R. BUDINSKI, MGR. OF EXPL.
P. O. BOX 10335, STOCK EXCHANGE TOWER
STE 1650 - 609 GRANVILLE ST.
VANCOUVER, B.C. V7Y 1G5

CERT. # : A8114043-004-A
INVOICE # : 18114043
DATE : 09-OCT-81
P.O. # : NONE
GOLDEN

ATTN: R. BUDINSKI

Sample description	Prep code	Cu ppm	Mo ppm	Pb ppm	Zn ppm	Ag ppm	Au ppb	FA+AA ppb
4S 04+00W	201	39	1	4	70	0.1		5
4S 04+50W	201	166	1	4	165	0.5		5
4S 05+00W	201	63	1	5	60	0.2		<5
4S 05+50W	201	45	1	6	57	0.1		5
4S 06+00W	201	176	1	3	46	0.1		<5
4S 06+50W	201	35	1	4	32	0.1		<5
4S 07+00W	201	38	1	1	46	0.2		<5
4S 07+50W	201	38	1	3	53	0.1		<5
4S 08+00W	201	45	1	6	58	0.1		<5
4S 08+50W	201	48	1	3	53	0.1		<5
4S 09+00W	201	26	1	3	90	0.1		<5
4S 09+50W	201	36	1	3	73	0.3		<5
4S 10+00W	201	27	1	1	75	0.1		<5
4S 10+50W	201	30	1	4	52	0.1		<5
4S 11+00W	201	38	1	5	73	0.1		<5
4S 11+50W	201	23	1	4	70	0.1		<5
4S 12+00W	201	38	1	4	82	0.1		5
4S 12+50W	201	24	1	2	58	0.3		5
4S 13+00W	201	12	1	1	8	0.1		5
4S 13+50W	201	35	1	3	77	0.2		5
4S 14+00W	201	25	1	1	70	0.1		10
4S 14+50W	201	62	1	3	105	0.1		<5
4S 15+00W	201	31	1	1	98	0.1		5
6N 00+00W	201	16	1	2	78	0.1		5
6N 00+50W	201	41	1	1	77	0.4		5
6N 01+00W	201	55	1	1	96	0.1		5
6N 01+50W	201	49	1	1	83	0.1		<5
6N 02+00W	201	46	1	1	80	0.2		5
6N 02+50W	201	48	1	1	66	0.2		5
6N 03+00W	201	38	1	2	85	0.1		<5
6N 03+50W	201	12	1	2	52	0.1		<5
6N 04+00W	201	37	1	1	75	0.4		5
6N 04+50W	201	37	1	1	62	0.1		5
6N 05+00W	201	39	1	5	60	0.1		5
6N 05+50W	201	50	1	10	68	0.1		5
6N 06+00W	201	63	1	12	87	0.2		<5
6N 06+50W	201	54	1	9	80	0.1		<5
6N 07+00W	201	48	1	6	96	0.1		<5
6N 07+50W	201	32	1	5	85	0.2		<5
6N 08+00W	201	63	1	5	90	0.3		<5



Certified by *J.F. McKey*



CHEMEX LABS LTD.

212 BROOKSBANK AVE.
 NORTH VANCOUVER, B.C.
 CANADA V7J 2C1
 TELEPHONE: (604)984-0221
 TELEX: 043-52597

• ANALYTICAL CHEMISTS • GEOCHEMISTS • REGISTERED ASSAYERS

CERTIFICATE OF ANALYSIS

TO : LORNE MINING CORP. LTD.
 ATTN: D.R. BUDINSKI, MGR. OF EXPL.
 P. O. BOX 10335, STOCK EXCHANGE TOWER
 STE 1650 - 609 GRANVILLE ST.
 VANCOUVER, B.C. V7Y 1G5

CERT. # : A8114043-005-A
 INVOICE # : I8114043
 DATE : 09-OCT-81
 P.O. # : NONE
 GOLDEN

ATTN: R. BUDINSKI

Sample description	Prep code	Cu ppm	Mo ppm	Pb ppm	Zn ppm	Ag ppm	Au ppb	FA+AA ppb
6N 08+50W	201	26	1	4	83	0.1	<5	
6N 09+00W	201	43	1	5	108	0.3	5	
6N 09+50W	201	24	1	6	180	0.1	<5	
6N 10+00W	201	36	1	4	78	0.2	5	
6N 10+50W	201	52	2	6	118	0.4	<5	
6N 11+00W	201	25	1	4	76	0.1	5	
6N 11+50W	201	45	1	1	58	0.1	5	
6N 12+00W	201	26	1	1	90	0.1	<5	
6N 12+50W	201	25	1	1	130	0.1	5	
6S 00+00W	201	27	1	4	55	0.3	5	
6S 00+50W	201	30	1	1	50	0.2	<5	
6S 01+00W	201	52	1	3	68	0.2	5	
6S 01+50W	201	27	1	3	78	0.1	5	
6S 02+00W	201	31	1	2	72	0.1	10	
6S 02+50W	201	26	1	4	75	0.1	5	
6S 03+00W	201	34	1	3	65	0.2	5	
6S 03+50W	201	33	1	1	58	0.2	<5	
6S 04+00W	201	40	1	4	70	0.3	5	
6S 04+50W	201	56	1	5	68	0.1	5	
6S 05+00W	201	61	1	6	80	0.1	5	
6S 05+50W	201	29	1	4	75	0.1	<5	
6S 06+00W	201	23	1	7	70	0.1	5	
6S 06+50W	201	64	1	2	53	0.1	5	
6S 07+00W	201	39	1	5	86	0.1	<5	
6S 07+50W	201	37	1	3	68	0.4	5	
6S 08+00W	201	37	2	3	50	0.3	<5	
6S 08+50W	201	59	1	2	52	0.1	<5	
6S 09+00W	201	35	1	2	75	0.2	<5	
6S 09+50W	201	34	1	1	83	0.1	<5	
6S 10+00W	201	49	1	1	41	0.2	<5	
6S 10+50W	201	35	1	1	60	0.1	<5	
6S 11+00W	201	25	1	2	66	0.1	5	
6S 11+50W	201	18	1	1	76	0.1	<5	
6S 12+00W	201	42	1	1	85	0.1	<5	
6S 12+50W	201	27	1	1	72	0.1	<5	
6S 13+00W	201	37	1	1	105	0.2	<5	
6S 13+50W	201	35	1	4	82	0.3	25	
6S 14+00W	201	26	1	1	47	0.1	50	
6S 14+50W	201	85	1	7	62	0.1	95	
6S 15+00W	201	39	1	6	65	0.2	<5	

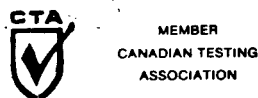

Certified by *J.F. McPhay*



CHEMEX LABS LTD.

212 BROOKSBANK AVE.
NORTH VANCOUVER, B.C.
CANADA V7J 2C1

• ANALYTICAL CHEMISTS • GEOCHEMISTS • REGISTERED ASSAYERS

TELEPHONE: (604)984-0221
TELEX: 043-52597

CERTIFICATE OF ANALYSIS

TO : LORNEX MINING CORP. LTD.
ATTN: D.R. BUDINSKI, MGR. OF EXPL.
P. O. BOX 10335, STOCK EXCHANGE TOWER
STE 1650 - 609 GRANVILLE ST.
VANCOUVER, B.C. V7Y 1G5

CERT. # : A8114043-006-A
INVOICE # : I8114043
DATE : 09-OCT-81
P.O. # : NONE
GOLDEN

ATTN: R. BUDINSKI

Sample description	Prep code	Cu ppm	Mo ppm	Pb ppm	Zn ppm	Ag ppm	Au ppb	FA+AA ppb
8N 00+00W	201	28	1	2	75	0.2	<5	
8N 00+50W	201	27	1	2	68	0.2	5	
8N 01+00W	201	60	1	1	61	0.3	<5	
8N 01+50W	201	35	1	1	85	0.7	<5	
8N 02+00W	201	43	1	1	78	1.2	5	
8N 02+50W	201	32	1	1	105	0.4	<5	
8N 03+00W	201	24	1	1	86	0.1	<5	
8N 03+50W	201	62	1	2	62	0.1	15	
8N 04+00W	201	30	1	1	52	0.3	<5	
8N 04+50W	203	40	1	2	44	0.2	5	
8N 05+00W	201	34	1	1	36	0.5	5	
8N 05+50W	201	31	1	3	35	0.1	<5	
8N 06+00W	201	23	1	5	78	0.1	5	
8N 06+50W	201	35	1	4	88	0.3	10	
8N 07+00W	201	34	1	4	80	0.3	<5	
8N 07+50W	201	90	1	4	54	0.2	<5	
8N 08+00W	201	62	1	10	35	0.1	<5	
8N 08+50W	201	52	1	9	88	0.4	5	
8N 09+00W	201	43	1	10	100	0.1	10	
8N 09+50W	201	33	1	4	96	0.6	<5	
8N 10+00W	201	18	1	4	88	0.1	<5	
8N 10+50W	201	22	1	8	85	0.1	5	
8N 11+00W	201	44	1	7	93	0.1	5	
8N 11+50W	201	44	1	3	83	0.1	10	
8N 12+00W	201	40	1	5	110	0.2	<5	
8N 12+50W	201	69	1	2	75	0.1	5	
8N 13+00W	201	134	2	2	115	0.5	5	
8N 13+50W	201	27	1	6	75	0.1	5	
8N 14+00W	201	185	1	6	138	0.2	<5	
10N 00+00W	201	31	1	1	82	0.1	<5	
10N 00+50W	201	31	1	1	60	0.2	5	
10N 01+00W	201	28	1	1	75	0.3	25	
10N 01+50W	201	44	1	1	93	0.4	5	
10N 02+00W	201	25	1	1	46	0.1	5	
10N 02+50W	201	40	2	1	56	0.1	<5	
10N 03+00W	201	60	1	2	70	0.1	10	
10N 03+50W	201	56	1	2	80	0.1	<5	
10N 04+00W	201	32	1	1	53	0.1	5	
10N 04+50W	201	36	1	1	55	0.6	<5	
10N 05+00W	201	48	2	4	93	0.2	5	



Certified by *J.F. McManis*



CHEMEX LABS LTD.

212 BROOKSBANK AVE.
NORTH VANCOUVER, B.C.
CANADA V7J 2C1
TELEPHONE: (604)984-0221
TELEX: 043-52597

• ANALYTICAL CHEMISTS • GEOCHEMISTS • REGISTERED ASSAYERS

CERTIFICATE OF ANALYSIS

TO : LORNE MINING CORP. LTD.
ATTN: D.R. BUDINSKI, MGR. OF EXPL.
P. O. BOX 10335, STOCK EXCHANGE TOWER
STE 1650 - 609 GRANVILLE ST.
VANCOUVER, B.C. V7Y 1G5

CERT. # : A8114044-001-A
INVOICE # : 18114044
DATE : 09-OCT-81
P.C. # : NONE
GOLDEN

ATTN: DAVID R. BUDINSKI

- Master.

Sample description	Prep code	Cu ppm	Mo ppm	Pb ppm	Zn ppm	Ag ppm	Au ppb	FA+AA ppb
10N 05+50W	201	46	1	3	68	0.2	<5	<5
10N 06+00W	201	44	1	4	88	0.1	<5	<5
10N 06+50W	201	45	1	3	83	0.1	<5	<5
10N 07+00W	201	48	1	6	81	0.2	<5	<5
10N 07+50W	201	36	1	10	88	0.4	<5	<5
10N 08+00W	201	56	1	7	70	0.1	10	10
10N 08+50W	201	95	1	11	90	0.2	5	5
10N 09+00W	201	59	1	8	75	0.3	5	5
10N 09+50W	201	42	1	8	90	0.5	5	5
10N 10+00W	201	42	1	4	122	0.1	<5	<5
10N 10+50W	201	29	1	1	86	0.2	5	5
10N 11+00W	201	43	1	6	90	0.1	5	5
10N 11+50W	201	36	1	1	95	0.1	5	5
10N 12+00W	201	48	1	6	102	0.1	5	5
12N 00+00W	201	42	1	1	75	0.1	5	5
12N 00+50W	201	36	1	1	70	0.2	<5	<5
12N 01+00W	201	37	1	1	58	0.1	5	5
12N 01+50W	201	38	1	1	75	0.1	5	5
12N 02+00W	201	34	1	2	52	0.2	5	5
12N 02+50W	201	60	1	2	60	0.3	5	5
12N 03+00W	201	46	1	1	66	0.1	5	5
12N 03+50W	201	36	1	1	63	0.1	<5	<5
12N 04+00W	201	46	1	1	60	0.2	5	5
12N 04+50W	201	35	1	1	72	0.7	5	5
12N 05+00W	201	44	1	3	88	0.2	10	10
12N 05+50W	201	42	1	1	49	0.1	5	5
12N 06+00W	201	52	1	4	80	0.2	15	15
12N 06+50W	201	39	1	5	82	0.3	<5	<5
12N 07+00W	201	48	1	8	110	0.4	5	5
12N 07+50W	201	77	1	9	70	0.2	5	5
12N 08+00W	201	40	1	10	92	0.1	5	5
12N 08+50W	201	63	1	9	65	0.1	<5	<5
12N 09+00W	201	49	1	11	88	0.1	10	10
12N 09+50W	201	46	1	7	110	0.2	5	5
12N 10+00W	201	54	1	9	102	0.1	5	5
12N 10+50W	201	31	1	4	96	0.2	5	5
12N 11+00W	201	34	1	5	73	0.3	<5	<5
12N 11+50W	201	33	1	4	77	0.1	20	20
12N 12+00W	201	48	1	5	85	0.1	5	5
12N 12+50W	201	47	1	4	83	0.1	5	5

Certified by *J. F. McDay*





CHEMEX LABS LTD.

212 BROOKSBANK AVE.
 NORTH VANCOUVER, B.C.
 CANADA V7J 2C1
 TELEPHONE: (604)984-0221
 TELEX: 043-52597

• ANALYTICAL CHEMISTS • GEOCHEMISTS • REGISTERED ASSAYERS

CERTIFICATE OF ANALYSIS

TO : LORNEX MINING CORP. LTD.
 ATTN: D.R. BUDINSKI, MGR. OF EXPL.
 P. O. BOX 10335, STOCK EXCHANGE TOWER
 STE 1650 - 609 GRANVILLE ST.
 VANCOUVER, B.C. V7Y 1G5

CERT. # : A8114044-002-A
 INVOICE # : I8114044
 DATE : 09-OCT-81
 P.O. # : NONE
 GOLDEN

ATTN: DAVID R. BUDINSKI

Sample description	Prep code	Cu ppm	Mo ppm	Pb ppm	Zn ppm	Ag ppm	Au ppb	FA+AA ppb
14N 00+00W	201	62	1	1	80	0.2		5
14N 00+50W	201	44	1	1	62	0.4		<5
14N 01+00W	201	52	1	1	82	0.4		<5
14N 01+50W	201	24	1	1	73	0.1		<5
14N 02+00W	201	42	1	2	88	0.1		5
14N 02+50W	201	52	1	1	59	0.1		<5
14N 03+00W	201	46	1	1	56	0.1		15
14N 03+50W	201	48	1	1	106	0.1		5
14N 04+00W	201	43	1	1	63	0.1		5
14N 04+50W	201	41	1	1	52	0.1		5
14N 05+00W	201	40	1	1	80	0.1		5
14N 05+50W	201	19	1	1	64	0.2		5
14N 06+00W	201	35	1	3	90	0.2		5
14N 06+50W	201	27	1	1	75	0.1		10
14N 07+00W	201	30	1	3	80	0.2		10
14N 07+50W	201	33	1	3	102	0.1		<5
14N 08+00W	201	29	1	7	82	0.1		5
14N 08+50W	201	41	1	10	70	0.2		5
14N 09+00W	201	42	1	10	115	0.3		5
14N 09+50W	201	43	1	6	95	0.1		5
14N 10+00W	201	35	1	4	90	0.1		<5
14N 10+50W	201	50	1	7	90	0.2		<5
14N 11+00W	201	49	1	9	108	0.3		<5
14N 11+50W	201	57	1	6	85	0.2		15
14N 12+00W	201	56	1	1	100	0.4		<5
14N 12+50W	201	26	1	4	95	0.1		5
16N 00+00W	201	40	1	1	72	0.5		<5
16N 00+50W	201	40	1	1	63	0.1		<5
16N 01+00W	201	43	1	1	56	0.1		<5
16N 01+50W	201	37	1	1	55	0.1		<5
16N 02+00W	201	37	1	1	70	0.3		<5
16N 02+50W	201	29	1	1	80	0.1		<5
16N 03+00W	201	34	2	1	63	0.2		<5
16N 03+50W	201	40	1	1	57	0.1		<5
16N 04+00W	201	51	1	1	68	0.1		5
16N 04+50W	201	9	1	1	42	0.1		<5
16N 05+00W	201	38	1	1	70	0.2		5
16N 05+50W	201	48	1	1	60	0.1		<5
16N 06+00W	201	37	1	1	60	0.1		15
16N 06+50W	201	50	1	1	86	0.2		5

Certified by *J. G. McDay*





CHEMEX LABS LTD.

212 BROOKSBANK AVE.
NORTH VANCOUVER, B.C.
CANADA V7J 2C1
TELEPHONE: (604)984-0221
TELEX: 043-52597

• ANALYTICAL CHEMISTS • GEOCHEMISTS • REGISTERED ASSAYERS

CERTIFICATE OF ANALYSIS

TO : LORNEX MINING CORP. LTD.
ATTN: D.R. BUDINSKI, MGR. OF EXPL.
P. O. BOX 10335, STOCK EXCHANGE TOWER
STE 1650 - 609 GRANVILLE ST.
VANCOUVER, B.C. V7Y 1G5

CERT. # : A8114044-003-A
INVOICE # : I8114044
DATE : 09-OCT-81
P.O. # : NONE
GOLDEN

ATTN: DAVID R. BUDINSKI

Sample description	Prep code	Cu ppm	Mo ppm	Pb ppm	Zn ppm	Ag ppm	Au ppm	FA+AA ppb
16N 07+00W	201	49	1	2	78	0.2		5
16N 07+50W	201	20	1	1	62	0.2		<5
16N 08+00W	201	38	1	5	92	0.1		<5
16N 08+50W	201	54	1	6	75	0.1		<5
16N 09+00W	201	36	1	5	78	0.1		<5
16N 09+50W	201	26	1	4	135	0.3		<5
16N 10+00W	201	20	1	1	130	0.1		<5
16N 10+50W	201	63	1	4	98	0.1		<5
16N 11+00W	201	49	1	4	66	0.1		<5
16N 11+50W	201	113	1	1	90	0.1		<5
16N 12+00W	201	152	1	4	128	0.1		5
16N 12+50W	201	153	1	2	135	0.1		<5
16N 13+00W	201	21	1	1	106	0.1		<5
16N 13+50W	201	80	1	2	65	0.1		<5
16N 14+00W	201	101	1	2	53	0.1		<5

RECEIVED

OCT 10 1981

LORNEX VANCOUVER

Certified by *J.F. McMan*



MEMBER
CANADIAN TESTING
ASSOCIATION



CHEMEX LABS LTD.

212 BROOKSBANK AVE.
 NORTH VANCOUVER, B.C.
 CANADA V7J 2C1
 TELEPHONE: (604)984-0221
 TELEX: 043-52597

• ANALYTICAL CHEMISTS • GEOCHEMISTS • REGISTERED ASSAYERS

CERTIFICATE OF ANALYSIS

TO : LORNE MINING CORP. LTD.
 ATTN: D.R. BUDINSKI, MGR. OF EXPL.
 P. O. BOX 10335, STOCK EXCHANGE TOWER
 STE 1650 - 609 GRANVILLE ST.
 VANCOUVER, B.C. V7Y 1G5

CERT. # : A8114239-001-
 INVOICE # : I8114239
 DATE : 20-OCT-81
 P.O. # : NONE
 GOLDEN CLAIM

ATTN: D. BUDINSKI CC: PETER CHRISTOPHER & ASSOC. *→ Master File*

Sample description	Prep code	Cu ppm	Mo ppm	Pb ppm	Zn ppm	Ag ppm	Au	FA+AA ppb
6N 14+00 W	201	169	1	9	145	0.1		5
6N 14+50 W	201	38	1	8	90	0.2		<5
6N 15+00 W	201	83	1	4	90	0.1		<5
6N 15+50 W	201	31	1	5	110	0.1		<5
6N 16+00 W	201	174	1	5	128	0.1		5
6N 16+50 W	201	20	2	1	47	0.1		<5
6N 17+00 W	201	475	1	6	92	0.1		<5
6N 17+50 W	201	126	1	6	118	0.1		5
6N 18+00 W	201	81	1	4	103	0.1		<5
6N 18+50 W	201	65	2	4	90	0.1		<5
6N 19+00 W	201	63	1	4	100	0.1		<5
6N 19+50 W	201	31	1	5	110	0.1		5
6N 20+00 W	201	60	1	5	117	0.1		5
8N 15+00 W	201	205	1	5	102	0.1		20
8N 15+50 W	201	24	1	10	105	0.1		<5
8N 16+00 W	201	17	1	5	83	0.1		<5
8N 16+50 W	201	41	1	9	90	0.1		<5
8N 17+00 W	201	24	1	6	100	0.1		5
8N 17+50 W	201	52	1	10	62	0.1		<5
8N 18+00 W	201	42	1	8	55	0.1		<5
8N 18+50 W	201	11	1	14	94	0.1		<5
8N 19+00 W	201	27	1	9	80	0.1		<5
8N 19+50 W	201	5	1	5	65	0.1		<5
8N 20+00 W	201	7	1	3	72	0.1		<5
10N 14+50 W	201	188	1	4	90	0.1		15
10N 15+00 W	201	167	1	5	90	0.1		5
10N 15+50 W	201	94	1	3	80	0.1		<5
10N 16+00 W	201	19	1	5	68	0.1		<5
10N 16+50 W	201	12	1	4	60	0.1		<5
10N 17+00 W	201	7	1	3	65	0.1		<5
10N 17+50 W	201	10	1	5	55	0.1		<5
10N 18+00 W	201	5	1	5	85	0.1		<5
10N 18+50 W	201	4	1	3	52	0.1		5
10N 19+00 W	201	21	1	8	76	0.1		<5
10N 19+50 W	201	9	1	6	60	0.1		<5
10N 20+00 W	201	17	1	7	65	0.1		5
12N 14+50 W	201	9	1	4	90	0.1		<5
12N 15+00 W	201	9	1	5	75	0.1		<5
12N 15+50 W	201	4	1	2	52	0.1		5
12N 16+00 W	201	3	2	3	70	0.1		5

Hart Buchler

Certified by

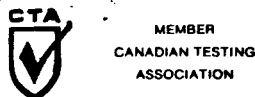



CHEMEX LABS LTD.

212 BROOKSBANK AVE.
 NORTH VANCOUVER, B.C.
 CANADA V7J 2C1
 TELEPHONE: (604)984-0221
 TELEX: 043-52597

• ANALYTICAL CHEMISTS • GEOCHEMISTS • REGISTERED ASSAYERS

CERTIFICATE OF ANALYSIS

TO : LORNE MINING CORP. LTD.
 ATTN: D.R. BUDINSKI, MGR. OF EXPL.
 P. O. BOX 10335, STOCK EXCHANGE TOWER
 STE 1650 - 609 GRANVILLE ST.
 VANCOUVER, B.C. V7Y 1G5

CERT. # : A8114239-002-
 INVOICE # : I8114239
 DATE : 20-OCT-81
 P.O. # : NONE
 GOLDEN CLAIM

ATTN: D. BUDINSKI CC: PETER CHRISTOPHER & ASSOC.

Sample description	Prep code	Cu ppm	Mo ppm	Pb ppm	Zn ppm	Ag ppm	Au FA+AA ppb
12N 16+50 W	201	6	1	4	78	0.1	<5
12N 17+00 W	201	7	1	3	128	0.1	<5
12N 17+50 W	201	7	1	2	70	0.1	<5
12N 18+00 W	201	8	3	1	11	0.1	<5
12N 18+50 W	201	53	1	8	54	0.1	5
12N 19+00 W	201	26	1	10	65	0.1	<5
12N 19+50 W	201	38	1	13	63	0.1	<5
12N 20+00 W	201	18	1	7	60	0.1	<5
14N 13+00 W	201	425	1	6	130	0.1	<5
14N 15+50 W	201	20	1	14	48	0.1	5
14N 16+00 W	201	16	1	8	122	0.1	5
14N 16+50 W	201	6	1	3	68	0.1	<5
14N 17+00 W	201	4	1	1	60	0.1	5
14N 17+50 W	201	2	1	4	80	0.1	5
14N 18+00 W	201	10	1	4	85	0.1	5
14N 18+50 W	201	52	1	10	58	0.1	10
14N 19+00 W	201	46	1	11	76	0.1	<5
14N 19+50 W	201	29	1	10	115	0.1	5
14N 20+00 W	201	17	1	5	88	0.1	5
16N 14+50 W	201	40	1	2	60	0.1	5
16N 15+00 W	201	13	1	20	66	0.1	<5
16N 15+50 W	201	6	1	5	72	0.1	<5
16N 16+00 W	201	16	1	5	100	0.1	<5
16N 16+50 W	201	18	1	4	65	0.1	<5
16N 17+00 W	201	28	1	13	77	0.1	5
16N 17+50 W	201	57	1	12	76	0.1	5
16N 18+00 W	201	103	2	13	75	0.1	5
16N 18+50 W	201	41	2	7	130	0.1	5
16N 19+00 W	201	29	1	10	90	0.1	10
16N 19+50 W	201	34	1	6	120	0.1	5
18N 0+00 BL	201	30	1	4	100	0.1	<5
18N 0+50 W	201	79	1	3	63	0.1	5
18N 1+00 W	201	43	1	2	75	0.1	5
18N 1+50 W	201	32	2	3	58	0.1	<5
18N 2+00 W	201	21	3	3	52	0.1	<5
18N 2+50 W	201	22	2	2	50	0.1	5
18N 3+00 W	201	48	2	3	70	0.1	5
18N 3+50 W	201	32	1	5	40	0.1	5
18N 4+00 W	201	35	1	4	42	0.1	5
18N 4+50 W	201	34	2	3	43	0.1	5

20201-ANV-48
 2581
 OCT 30 1981

RECEIVED

Certified by Hart Bichler





CHEMEX LABS LTD.

212 BROOKSBANK AVE.
NORTH VANCOUVER, B.C.
CANADA V7J 2C1
TELEPHONE: (604)984-0221
TELEX: 043-52597

• ANALYTICAL CHEMISTS • GEOCHEMISTS • REGISTERED ASSAYERS

CERTIFICATE OF ANALYSIS

TO : LORNE MINING CORP. LTD.
ATTN: D.R. BUDINSKI, MGR. OF EXPL.
P. O. BOX 10335, STOCK EXCHANGE TOWER
STE 1650 - 609 GRANVILLE ST.
VANCOUVER, B.C. V7Y 1G5

CERT. # : A8114239-003
INVOICE # : 18114239
DATE : 20-OCT-81
P.O. # : NONE
GOLDEN CLAIM

ATTN: D. BUDINSKI CC: PETER CHRISTOPHER & ASSOC.

Sample description	Prep code	Cu ppm	Mo ppm	Pb ppm	Zn ppm	Ag ppm	Au ppb	FA+AA ppb
18N 5+00 W	201	33	1	5	68	0.1	<5	<5
18N 5+50 W	201	26	2	5	77	0.1	<5	<5
18N 6+00 W	201	41	1	5	58	0.1	<5	<5
18N 6+50 W	201	36	1	3	64	0.1	5	5
18N 7+00 W	201	46	1	4	85	0.1	<5	<5
18N 7+50 W	201	26	1	3	75	0.1	<5	<5
18N 8+00 W	201	27	1	3	92	0.1	<5	<5
18N 8+50 W	201	25	1	4	70	0.1	5	5
18N 9+00 W	201	53	1	8	82	0.1	<5	<5
18N 9+50 W	201	37	1	6	118	0.1	5	5
18N 10+00 W	201	72	1	15	155	0.1	<5	<5
18N 10+50 W	201	43	1	5	72	0.1	<5	<5
18N 11+00 W	201	77	1	3	100	0.1	<5	<5
18N 11+50 W	201	136	1	4	82	0.1	<5	<5
18N 12+00 W	201	34	1	3	82	0.1	<5	<5
18N 12+50 W	201	41	1	3	66	0.1	5	5
18N 13+00 W	201	46	5	7	95	0.1	5	5
18N 13+50 W	201	56	3	6	80	0.1	5	5
18N 14+00 W	201	38	2	5	102	0.1	5	5
18N 14+50 W	201	92	1	20	60	0.1	10	10
18N 15+00 W	201	39	1	10	68	0.1	10	10
18N 15+50 W	201	30	1	6	75	0.1	15	15
18N 16+00 W	201	38	1	7	65	0.1	10	10
18N 16+50 W	201	69	1	12	86	0.1	15	15
18N 17+00 W	201	71	1	10	88	0.1	15	15
18N 17+50 W	201	65	1	8	83	0.1	10	10
18N 18+00 W	201	113	1	10	86	0.1	5	5
18N 18+50 W	201	31	1	9	81	0.1	10	10
18N 19+00 W	201	43	1	14	78	0.1	5	5
18N 19+50 W	201	29	1	16	88	0.1	10	10
18N 20+00 W	201	24	1	11	106	0.1	5	5
20N 0+00 W	201	34	1	1	70	0.1	5	5
20N 0+50 W	201	48	1	3	75	0.1	5	5
20N 1+00 W	201	49	1	5	72	0.1	5	5
20N 1+50 W	201	34	1	3	62	0.1	5	5
20N 2+00 W	201	38	1	2	65	0.1	5	5
20N 2+50 W	201	27	1	1	52	0.1	<5	<5
20N 3+00 W	201	42	1	3	54	0.1	<5	<5
20N 3+50 W	201	41	1	6	55	0.1	<5	<5
20N 4+00 W	201	25	1	2	40	0.1	<5	<5

CHEMEX - 127
OCT 25 1981
BUDINSKI

Hart Buchler

Certified by





CHEMEX LABS LTD.

212 BROOKSBANK AVE.
NORTH VANCOUVER, B.C.
CANADA V7J 2C1
TELEPHONE: (604)984-0221
TELEX: 043-52597

- ANALYTICAL CHEMISTS
- GEOCHEMISTS
- REGISTERED ASSAYERS

CERTIFICATE OF ANALYSIS

TO : LORNE MINING CORP. LTD.
ATTN: D.R. BUDINSKI, MGR. OF EXPL.
P. O. BOX 10335, STOCK EXCHANGE TOWER
STE 1650 - 609 GRANVILLE ST.
VANCOUVER, B.C. V7Y 1G5

CERT. # : A8114239-004
INVOICE # : I8114239
DATE : 20-OCT-81
P.O. # : NONE
GOLDEN CLAIM

ATTN: D. BUDINSKI CC: PETER CHRISTOPHER & ASSOC.

Sample description	Prep code	Cu ppm	Mo ppm	Pb ppm	Zn ppm	Ag ppm	Au	FA+AA ppb
20N 4+50 W	201	37	1	2	46	0.1		<5
20N 5+00 W	201	32	1	2	46	0.1		<5
20N 5+50 W	201	38	1	2	62	0.1		<5
20N 6+00 W	201	30	1	1	48	0.1		5
20N 6+50 W	201	40	1	4	82	0.1		<5
20N 7+00 W	201	46	1	1	72	0.1		<5
20N 7+50 W	201	37	1	3	72	0.1		<5
20N 8+00 W	201	71	3	5	120	0.1		<5
20N 8+50 W	201	40	1	4	80	0.1		5
20N 9+00 W	201	35	1	2	95	0.1		5
20N 9+50 W	201	26	1	1	68	0.1		5
20N 10+00 W	201	33	1	6	94	0.1		<5
20N 10+50 W	201	50	1	5	98	0.1		15
20N 11+00 W	201	47	1	6	79	0.1		5
20N 11+50 W	201	56	1	76	77	0.1		5
20N 12+00 W	201	93	1	530	94	0.1		<5
20N 12+50 W	201	51	3	15	135	0.1		<5
20N 13+00 W	201	32	1	52	88	0.2		<5
20N 13+50 W	201	33	2	5	80	0.1		<5
20N 14+00 W	201	39	1	2	20	0.1		<5
20N 14+50 W	201	68	1	15	58	0.1		<5
20N 15+00 W	201	93	1	19	78	0.1		5
20N 15+50 W	201	108	1	8	78	0.1		20
20N 16+00 W	201	41	1	15	95	0.1		5
20N 16+50 W	201	20	1	5	104	0.1		10
20N 17+00 W	201	34	1	6	95	0.1		5
20N 17+50 W	201	19	1	6	115	0.1		15
20N 18+00 W	201	20	1	7	80	0.1		<5
20N 18+50 W	201	33	1	6	100	0.1		5
20N 19+00 W	201	102	1	9	130	0.1		<5
20N 19+50 W	201	48	1	8	140	0.1		10
22N 0+00 BL	201	46	1	3	72	0.1		5
22N 0+50 W	201	42	1	4	68	0.1		5
22N 1+00 W	201	35	1	3	72	0.1		5
22N 1+50 W	201	40	1	2	74	0.1		<5
22N 2+00 W	201	36	1	5	65	0.1		15
22N 2+50 W	201	52	1	4	69	0.1		15
22N 3+00 W	201	30	1	2	58	0.1		5
22N 3+50 W	201	37	1	2	58	0.1		5
22N 4+00 W	201	48	1	3	53	0.1		10

RECEIVED
OCT 20 1981
LABORATORY - VANCOUVER

Certified by *Hart Bichler*





CHEMEX LABS LTD.

212 BROOKSBANK AVE.
NORTH VANCOUVER, B.C.
CANADA V7J 2C1
TELEPHONE: (604)984-0221
TELEX: 043-52597

• ANALYTICAL CHEMISTS • GEOCHEMISTS • REGISTERED ASSAYERS

CERTIFICATE OF ANALYSIS

TO : LORNE X MINING CORP. LTD.
ATTN: D.R. BUDINSKI, MGR. OF EXPL.
P. O. BOX 10335, STOCK EXCHANGE TOWER
STE 1650 - 609 GRANVILLE ST.
VANCOUVER, B.C. V7Y 1G5

CERT. # : A8114239-006
INVOICE # : I8114239
DATE : 20-OCT-81
P.O. # : NONE
GOLDEN CLAIM

ATTN: D. BUDINSKI CC: PETER CHRISTOPHER & ASSOC.

Sample description	Prep code	Cu ppm	Mo ppm	Pb ppm	Zn ppm	Ag ppm	Au	FA+AA ppb
24N 4+50 W	201	43	1	2	70	0.1		5
24N 5+00 W	201	36	1	1	60	0.1		5
24N 5+50 W	201	35	1	2	52	0.1		5
24N 6+00 W	201	33	1	2	65	0.1		5
24N 6+50 W	201	119	1	3	80	0.1		5
24N 7+00 W	201	41	1	2	80	0.1		<5
24N 7+50 W	201	31	1	2	78	0.1		<5
24N 8+00 W	201	27	1	3	100	0.1		5
24N 8+50 W	201	28	1	2	58	0.1		5
24N 9+00 W	201	28	1	2	80	0.1		<5
24N 9+50 W	201	40	1	3	90	0.1		5
24N 10+00 W	201	53	1	1	58	0.1		5
24N 10+50 W	201	10	1	3	55	0.1		<5
24N 11+00 W	201	35	1	8	92	0.1		15
24N 11+50 W	201	27	1	14	108	0.1		<5
24N 12+00 W	201	32	1	13	157	0.1		<5
24N 12+50 W	201	16	1	7	110	0.1		5
24N 13+00 W	201	20	1	3	150	0.1		5
24N 13+50 W	201	84	1	20	210	0.1		5
24N 14+00 W	201	37	1	5	103	0.1		<5
24N 14+50 W	201	27	1	10	73	0.1		<5
24N 15+00 W	201	23	1	8	70	0.1		<5
24N 15+50 W	201	31	1	8	95	0.1		10
24N 16+00 W	201	18	1	6	92	0.1		<5
24N 16+50 W	201	25	1	6	103	0.1		<5
24N 17+00 W	201	21	1	5	90	0.1		5
24N 17+50 W	201	35	1	1	100	0.1		10
24N 18+00 W	201	29	1	1	80	0.1		5
24N 18+50 W	201	81	1	5	140	0.1		10
24N 19+00 W	201	115	1	4	112	0.1		5
24N 19+50 W	201	89	1	2	100	0.1		5
24N 20+00 W	201	51	1	4	55	0.1		10

RECEIVED

OCT 26 1981

LORNE X - VANCOUVER

Certified by *Hart Bichler*





CHEMEX LABS LTD.

212 BROOKSBANK AVE.
 NORTH VANCOUVER, B.C.
 CANADA V7J 2C1
 TELEPHONE: (604)984-0221
 TELEX: 043-52597

- ANALYTICAL CHEMISTS
- GEOCHEMISTS
- REGISTERED ASSAYERS

CERTIFICATE OF ANALYSIS

TO : PETER A. CHRISTOPHER & ASSOCIATES
 3707 W. 34TH AVE.
 VANCOUVER, B.C.
 V6N 2K9

CERT. # : A8113157-001-A
 INVOICE # : I8113157
 DATE : 03-SEP-81
 P.O. # : NONE
 NO. 1

CC: DAVID R. BUDINSKI-LORNEK, VANCOUVER.

Sample description	Prep code	Cu ppm	Mo ppm	Pb ppm	Zn ppm	Ag ppm	AU-FA+AA ppm
RS86-1	201	50	--	--	105	--	--
RS86-04	201	75	--	--	85	--	--
RS86-05	201	60	--	--	65	--	--
RS86-06	201	51	--	--	75	--	--
RS86-07	201	63	--	--	130	--	--
RS86-08	201	39	--	--	103	--	--
RS86-09	201	100	--	--	95	--	--
RS86-10	201	38	--	--	47	--	--
RS86-11	201	44	--	--	76	--	--
RS86-12	201	36	--	--	65	--	--
RS86-13	201	26	--	--	60	--	--
RS86-14	201	31	--	--	58	--	--
RS86-15	201	44	--	--	74	--	--
RS86-16	201	33	--	--	80	--	--
RS86-17	201	41	--	--	42	--	--
RS86-18	201	34	--	--	49	--	--
RS86-19	201	50	--	--	68	--	--
RS86-20	201	36	--	--	80	--	--
RS86-21	201	48	--	--	87	--	--
RS86-22	201	32	--	--	112	--	--
RS86-23	201	46	--	--	105	--	--
RS86-24	201	62	--	--	100	--	--
RS86-25	201	48	--	--	110	--	--
SST86-6	201	95	1	13	70	0.1	15
ZS86-01	201	210	--	--	30	--	--
ZS86-02	201	72	--	--	58	--	--
ZS86-03	201	64	--	--	72	--	--
ZS86-04	201	64	--	--	95	--	--
ZS86-05	201	47	--	--	72	--	--
ZS86-09	201	61	--	--	90	--	--
ZS86-10	201	46	--	--	80	--	--
ZS86-11	201	40	--	--	70	--	--
ZS86-12	203	105	--	--	35	--	--
ZS86-13	201	40	--	--	76	--	--
ZS86-14	201	86	--	--	75	--	--
ZS86-15	201	33	--	--	65	--	--
ZS86-16	201	43	--	--	52	--	--
ZS86-17	201	47	--	--	60	--	--
ZS86-18	201	33	--	--	46	--	--
ZS86-19	201	19	--	--	45	--	--



Certified by *Hart Bickler*

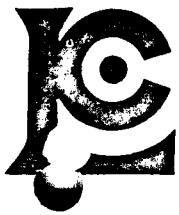

CHEMEX LABS LTD.

212 BROOKSBANK AVE.
NORTH VANCOUVER, B.C.
CANADA V7J 2C1
TELEPHONE: (604)984-0221
TELEX: 043-52597

• ANALYTICAL CHEMISTS • GEOCHEMISTS • REGISTERED ASSAYERS

CERTIFICATE OF ANALYSIS

TO : PETER A. CHRISTOPHER & ASSOCIATES
3707 W. 34TH AVE.
VANCOUVER, B.C.
V6N 2K9

CERT. # : A8113157-002-A
INVOICE # : I8113157
DATE : 03-SEP-31
P.O. # : NONE
NO. 1

CC: DAVID R. BUDINSKI-LORNEX, VANCOUVER.

Sample description	Prep code	Cu ppm	Mo ppm	Pb ppm	Zn ppm	Ag ppm	AU-FA+AA ppm
ZS86-20	201	42	--	--	55	--	--
ZS86-21	201	46	--	--	78	--	--
ZS86-22	201	42	--	--	63	--	--
ZS86-23	201	44	--	--	64	--	--
ZS86-24	201	44	--	--	56	--	--
ZS86-25	201	42	--	--	68	--	--



MEMBER
CANADIAN TESTING
ASSOCIATION

Certified by *David R. Budinski-Lornex*



CHEMEX LABS LTD.

212 BROOKSBANK AVE.
NORTH VANCOUVER, B.C.
CANADA V7J 2C1
TELEPHONE: (604)984-0221
TELEX: 043-52597

• ANALYTICAL CHEMISTS • GEOCHEMISTS • REGISTERED ASSAYERS

CERTIFICATE OF ANALYSIS

TO : PETER A CHRISTOPHER & ASSOC.
3707 W. 34th AVE.
VANCOUVER, B.C.
V6N 2K9

CERT. # : A8112918-001-1
INVOICE # : 18112918
DATE : 14-AUG-81
P.O. # : NONE
NO. 1

CC: DAVID R. BUDINSKI

Sample description	Prep code	Cu ppm	Zn ppm				
✓ GS-728-01	201	12	126	--	--	--	--
GS-728-02	201	13	85	--	--	--	--
GS-728-03	203	16	146	--	--	--	--
GS-728-04	201	25	110	--	--	--	--
GS-728-05	201	5	59	--	--	--	--
GS-728-06	201	9	75	--	--	--	--
GS-728-07	201	66	73	--	--	--	--
GS-728-08	201	34	84	--	--	--	--
GS-728-09	201	52	98	--	--	--	--
GS-728-10	201	19	90	--	--	--	--
GS-728-11	203	80	68	--	--	--	--
GS-728-12	201	220	91	--	--	--	--
GS-728-13	203	100	90	--	--	--	--
GS-728-14	201	145	72	--	--	--	--
GS-728-15	201	90	104	--	--	--	--
GS-728-16	201	140	95	--	--	--	--
GS-728-18	201	155	101	--	--	--	--
GS-728-19	201	145	73	--	--	--	--
GS-728-20	201	120	120	--	--	--	--
GS-728-21	201	160	105	--	--	--	--
GS-728-22	203	95	118	--	--	--	--
GS-728-23	201	160	155	--	--	--	--



MEMBER
CANADIAN TESTING
ASSOCIATION

Certified by *Hart Bidler*



CHEMEX LABS LTD.

212 BROOKSBANK AVE.
NORTH VANCOUVER, B.C.
CANADA V7J 2C1
TELEPHONE: (604)984-0221
TELEX: 043-52597

• ANALYTICAL CHEMISTS • GEOCHEMISTS • REGISTERED ASSAYERS

CERTIFICATE OF ANALYSIS

TO : PETER A CHRISTOPHER & ASSOC.
3707 W. 34th AVE.
VANCOUVER, B.C.
V6N 2K9

CERT. # : A8114827-001-
INVOICE # : I8114827
DATE : 18-NCV-81
P.C. # : NONE
GOLDEN

CC: LORNE MINING ATTN: DAVID BUDINSKI

Sample description	Prep code	Cu ppm	Ag ppm	Au FA+AA ppb			
26926	205	2300	2.7	15	--	--	--
26927	205	>10000	16.5	10	--	--	--
26928	205	>10000	20.0	5	--	--	--

26926 @ L12 + 80W	14 + 5N	Select					
26927 @ L16N	14 + 20W	2' Chip					
26928 @ L15 + 50N	≈ 14W	4' Chip					

Certified by *Hart Buchler*





CHEMEX LABS LTD.

212 BROOKSBANK AV.
NORTH VANCOUVER, B.C.
CANADA V7J 2C1
TELEPHONE: (604)984-0221
TELEX: 043-5251

• ANALYTICAL CHEMISTS • GEOCHEMISTS • REGISTERED ASSAYERS

CERTIFICATE OF ANALYSIS

TO : LORNEX MINING CORP. LTD.
ATTN: D.R. BUDINSKI, MGR. OF EXPL.
P. O. BOX 10335, STOCK EXCHANGE TOWER
STE 1650 - 609 GRANVILLE ST.
VANCOUVER, B.C. V7Y 1G5

CERT. # : A8114045-001-
INVOICE # : 18114045
DATE : 30-SEP-81
P.O. # : NONE
~~5301 NELSON~~
~~→ 5465 GOLDEN~~ GOLDEN
→ TO P.A. C

ATTN: A.D. CLENDENAN

Sample description	Prep code	Cu ppm	Mo ppm	Pb ppm	Zn ppm	Ag ppm	AU-AA ppb
25056	205	120	1	7	345	0.1	20

Golden Claims
No 25056 B
Meta Volc, Rusty stain
CHEMEX LABS LTD.
 212 Brooksbank Avenue
 North Vancouver, B.C. V7J 2C1
 985-0648

DATE 13/9/81
 CORE SIZE Grab by Terry
 DRILL HOLE Mackenzie
 FOOTAGE Gate #1 claim
 REMARKS BL B+0 N

ASSAY FOR:
Cu, Pb, Zn, Ag, Au, Ni (Mo)

OTHER _____
 ROCK GEOCHEM.

RECEIVED

OCT 5 1981

LORNEX - VANCOUVER

Certified by Hartfelder





CHEMEX LABS LTD.

212 BROOKSBANK AVE.
NORTH VANCOUVER, B.C.
CANADA V7J 2C1
TELEPHONE: (604)984-0221
TELEX: 043-52597

• ANALYTICAL CHEMISTS • GEOCHEMISTS • REGISTERED ASSAYERS

CERTIFICATE OF ANALYSIS

TO : LORNEX MINING CORP. LTD.
ATTN: D.R. BUDINSKI, MGR. OF EXPL.
P. O. BOX 10335, STOCK EXCHANGE TOWER
STE 1650 - 609 GRANVILLE ST.
VANCOUVER, B.C. V7Y 1G5

CERT. # : A8114240-001-
INVOICE # : I8114240
DATE : 06-OCT-81
P.O. # : NONE
GOLDEN CLAIM

→ Master File

ATTN: DAVE BUDINSKI

Sample description	Prep code	Cu ppm	Ag ppm	AU-AA ppb			
24N 18+75 W	205	26	0.1	<10	--	--	--

RECEIVED

OCT 9 1981

LORNEX - VANCOUVER

COPY

Certified by *[Signature]*



MEMBER
CANADIAN TESTING
ASSOCIATION

SMALL LAKE

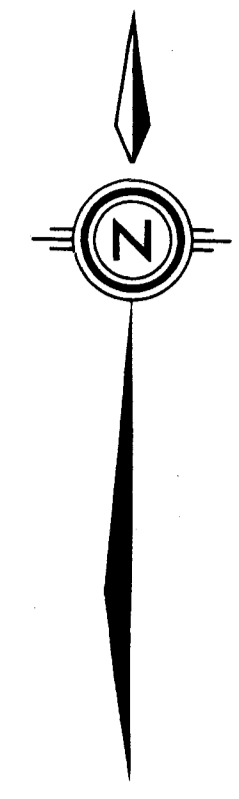
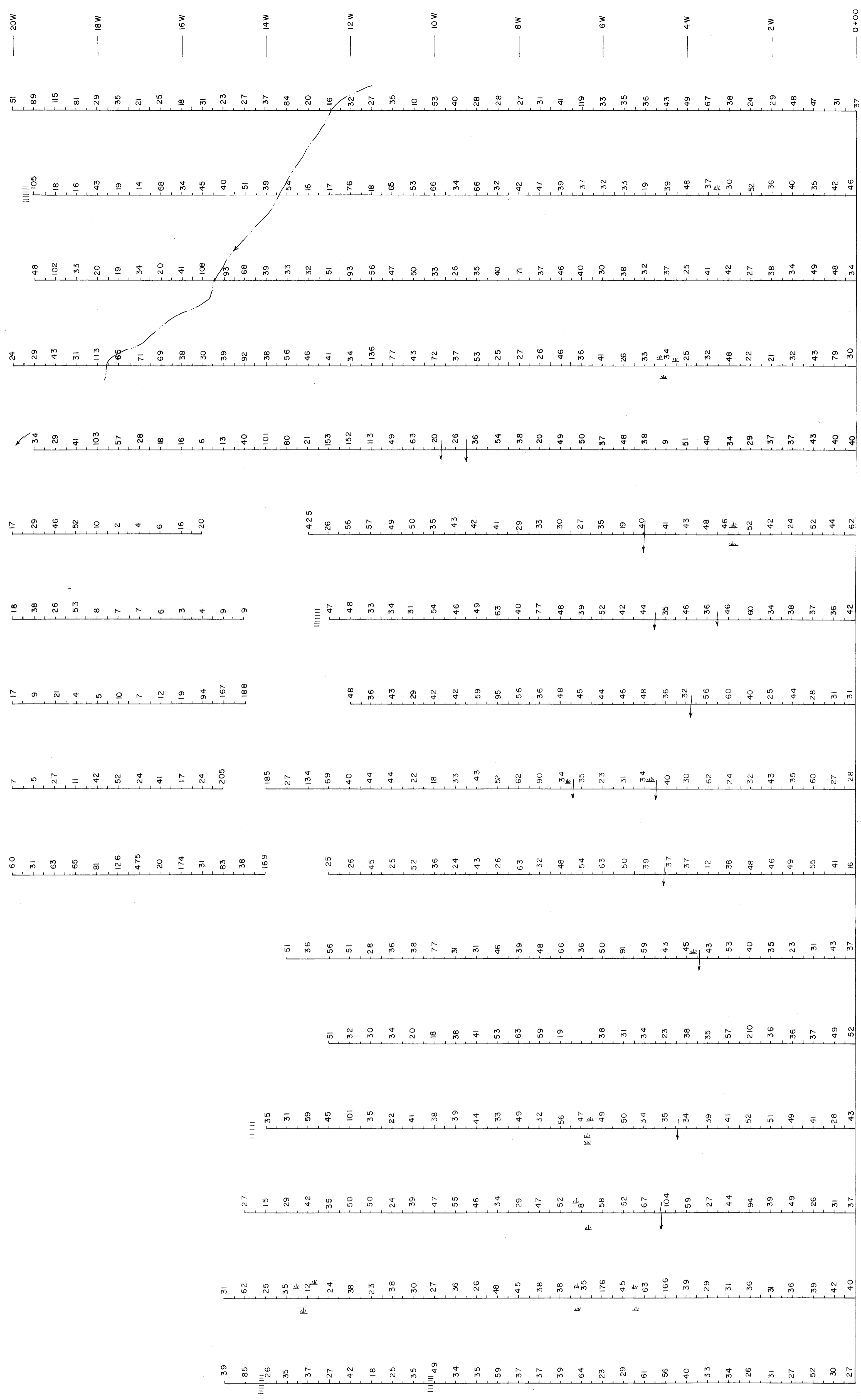
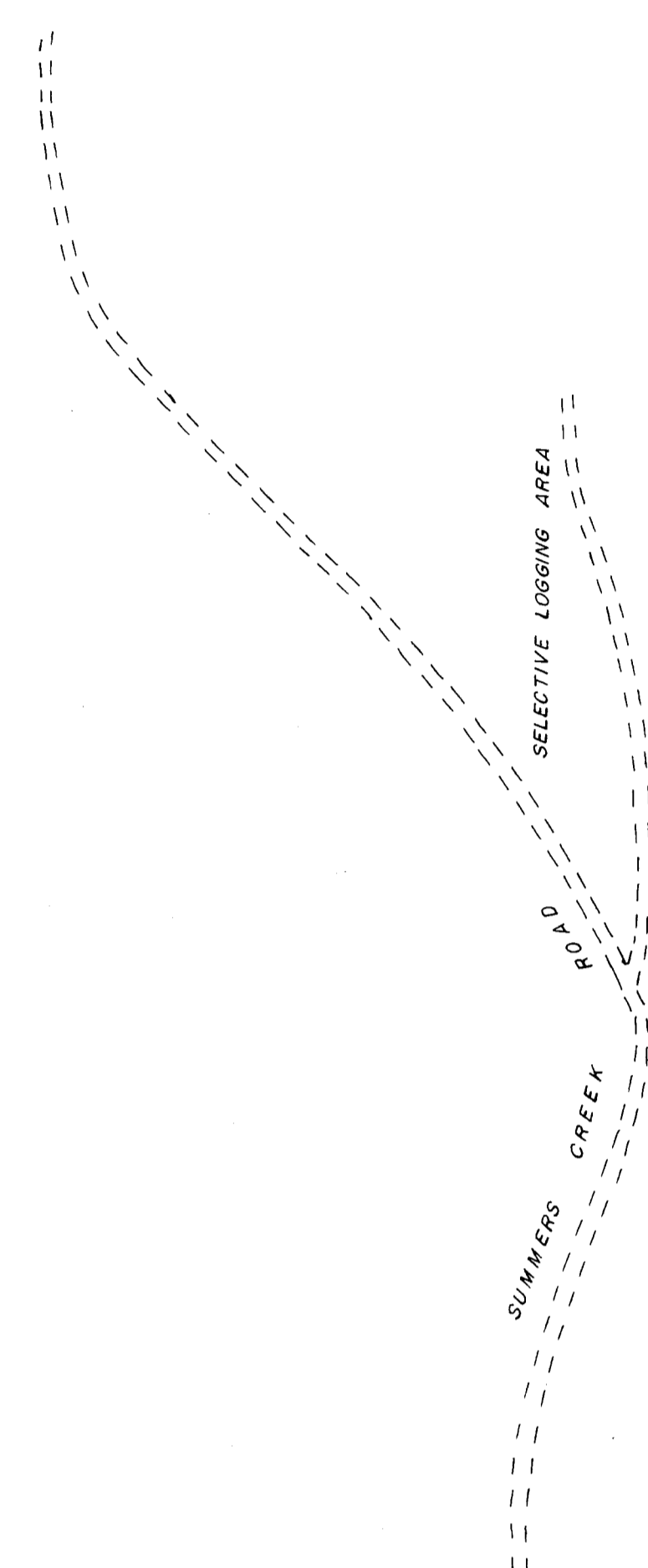

LEGEND

- |||| CLIFF
- ≡ SWAMP
- CREEK



9821

LORNEX MINING CORPORATION LTD.
 GOLDEN # 1 PROPERTY

SOIL GEOCHEMISTRY
COPPER PPM

DATE: OCT. 1981. SCALE: 1:5000 T.M. (J.S.)
 FIGURE 3

SMALL LAKE

SELECTIVE LOGGING AREA
SUMPERS CREEK

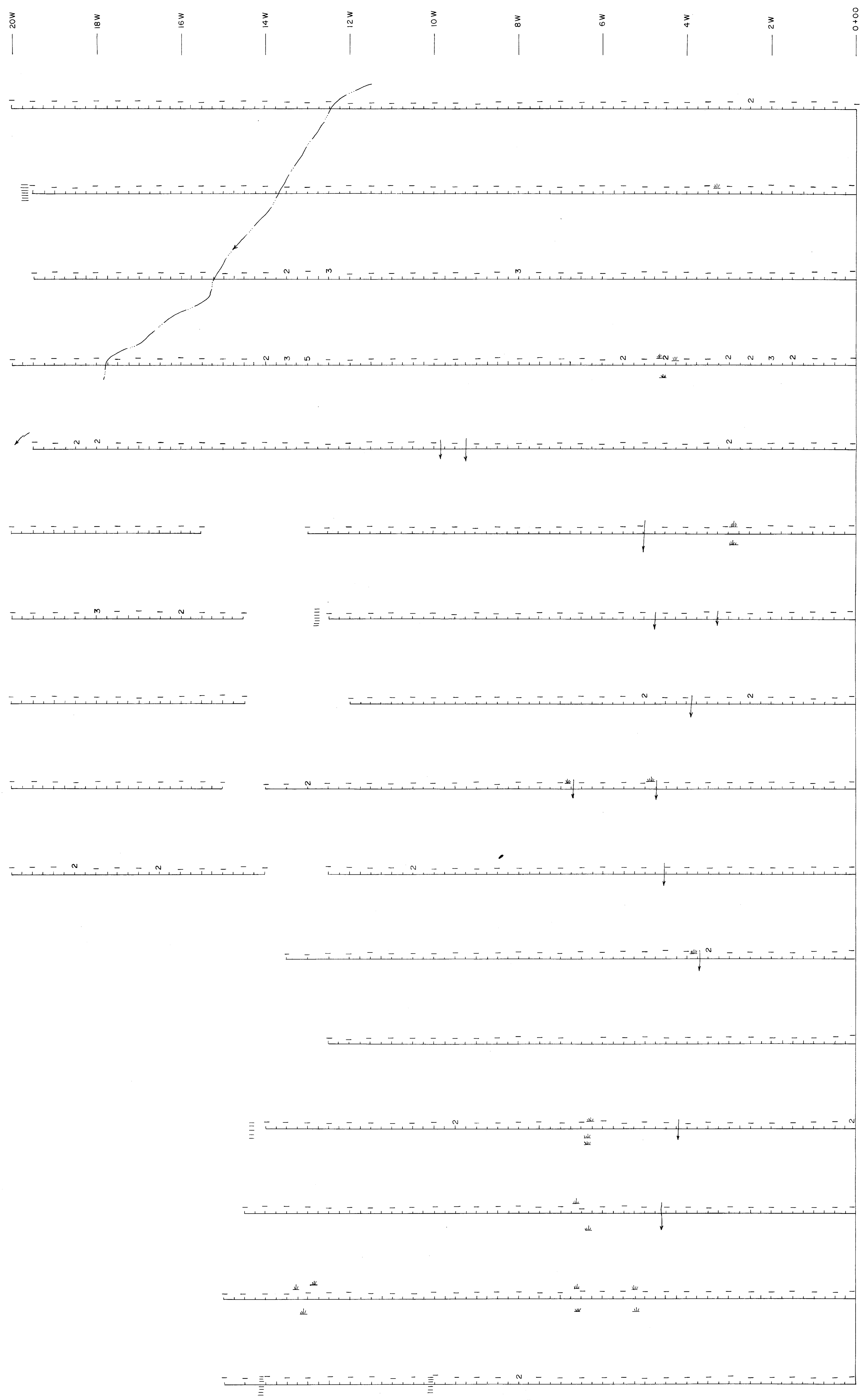

L 24+00N
 L 22+00N
 L 20+00N
 L 18+00N
 L 16+00N
 L 14+00N
 L 12+00N
 L 10+00N
 L 8+00N
 L 6+00N
 L 4+00N
 L 2+00N
 L 0+00
 L 2+00S
 L 4+00S
 L 6+00S

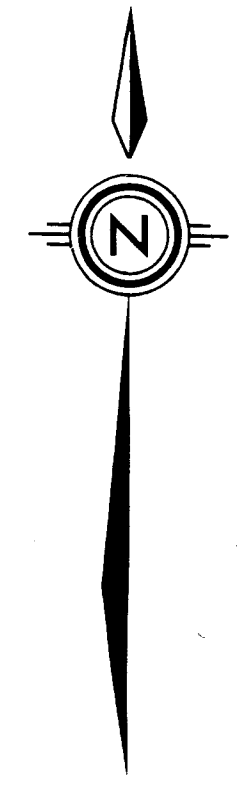

9821

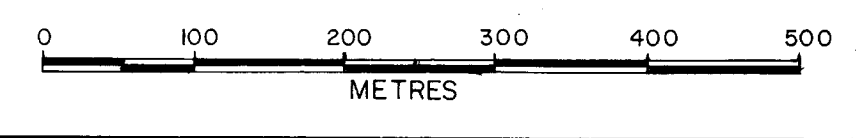

LEGEND
 |||| CLIFF
 sw SWAMP
 → CREEK

LORNEX MINING CORPORATION LTD.		
GOLDEN # 1 PROPERTY		
SOIL GEOCHEMISTRY		
MOLYBDENUM PPM		
DATE: NOV. 1981.	SCALE: 1:5000	T.M. (J.S.)
FIGURE 4		



SMALL LAKE

SUMMERS CREEK
SELECTIVE LOGGING AREA

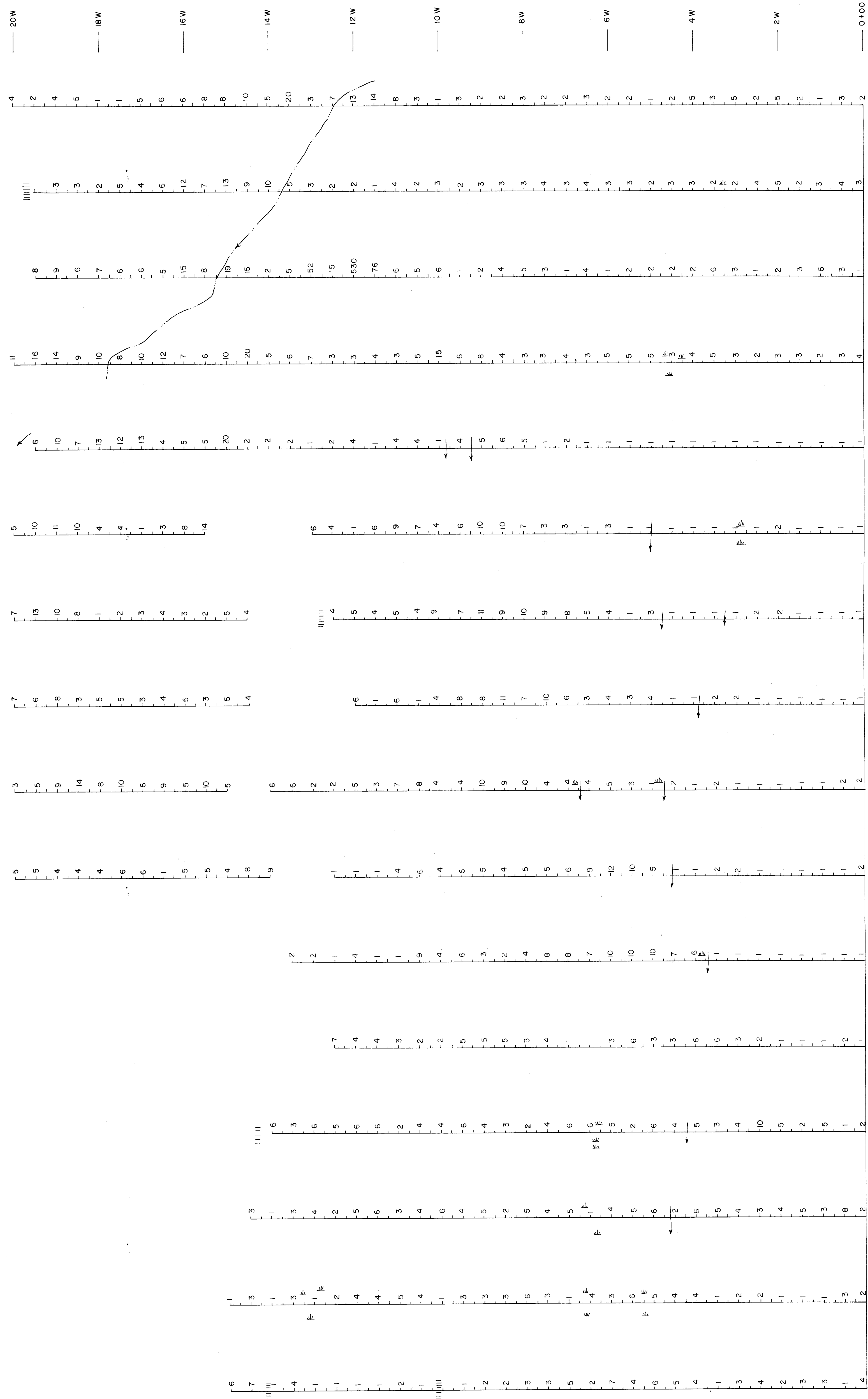

LEGEND

- |||| CLIFF
- ~ SWAMP
- CREEK

9821



LORNEX MINING CORPORATION LTD.	
GOLDEN # 1 PROPERTY	
SOIL GEOCHEMISTRY	
LEAD PPM	
DATE: OCT. 1981.	SCALE: 1:5000
FIGURE 5	T.M. (J.S.)

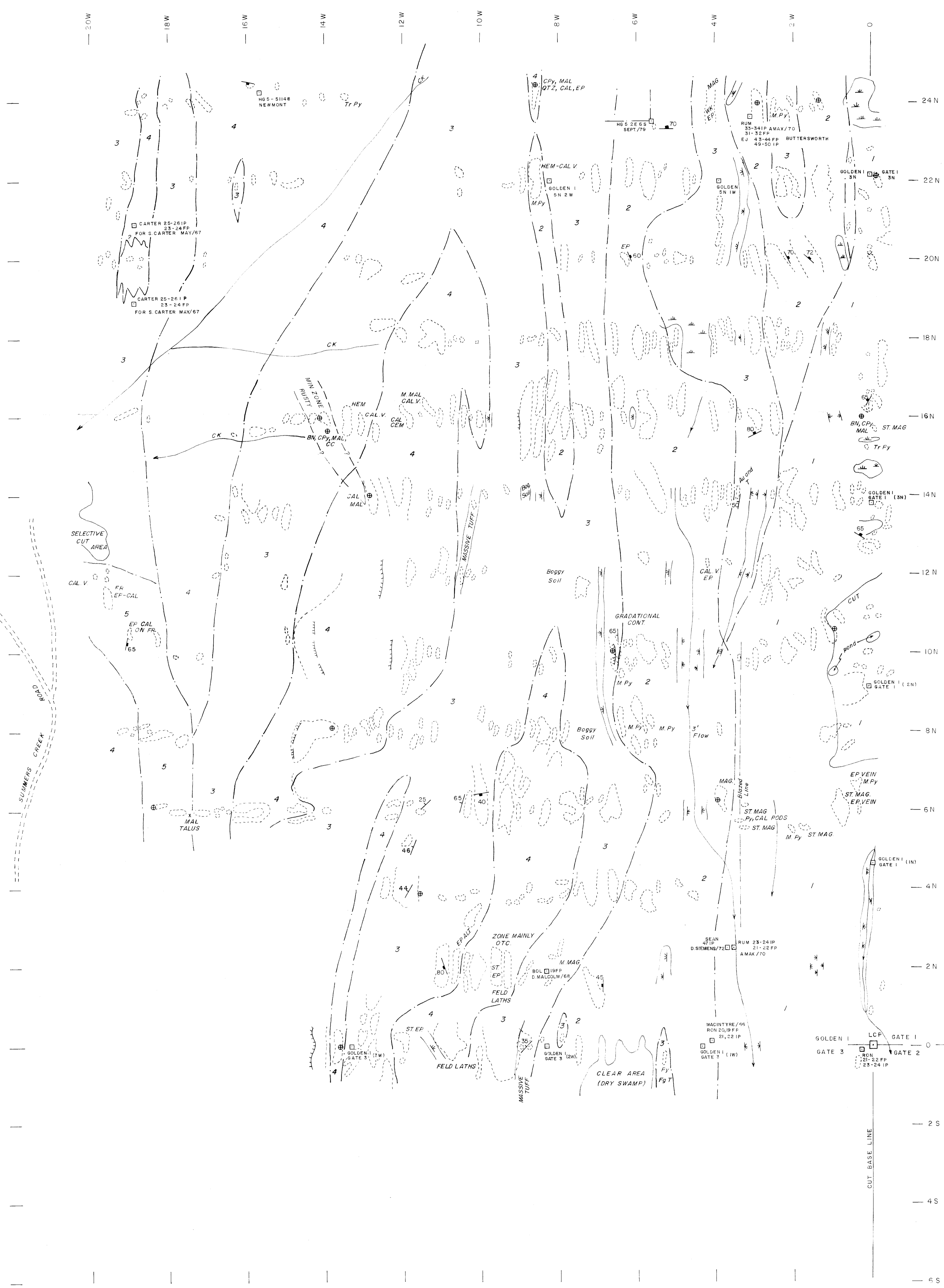

LEGEND

- | | | | |
|--|---|--|---|
| | CONTACT | | MONZONITE |
| | OUTCROP AREA | | MONZONITE (PINK) FRAGMENT LAHAR AND TUFF BRECCIA |
| | FRACTURE SHOWING DIP | | GREY GREEN CLASTIC VOLCANIC UNIT, TUFF, TUFF BRECCIA, LAHAR AND MINOR AGGLOMERATE |
| | LAYERING OR BEDDING SHOWING DIP | | HBD DIORITE UNIT, TUFF BRECCIA AND LAHAR, MINOR FLOWS AND DYKES |
| | ROCK SAMPLE LOCATION | | AUGITE ANDESITE, FLOWS AND AGGLOMERATE WITH MINOR CRYSTAL TUFF |
| | CLAIM POST, CLAIM POST SHOWING DIRECTION OF LINES | | |
| | LCP LEGAL CORNER POST | | |
| | IP, FP INITIAL POST, FINAL POST | | |
| | SWAMP | | |
| | CLIFF | | |
-
- | | |
|---------------------|--|
| MAL, BN, CPy, CC | MALACHITE, BORNITE, CHALCOPYRITE, CHALCOCITE |
| Py, MPy, TrPy | PYRITE, MINOR PYRITE <0.5% ; RARE PYRITE GRAIN |
| EP Alt, WK EP Alt | EPIDOTE ; WEAK EPIDOTE ALTERATION |
| HEM, CAL, V | HEMATITE, CALCITE, AS VEINS OR VEINLETS |
| MAG, ST MAG, WK MAG | MAGNETITE, STRONG >2% , WEAK <0.5% |

9821

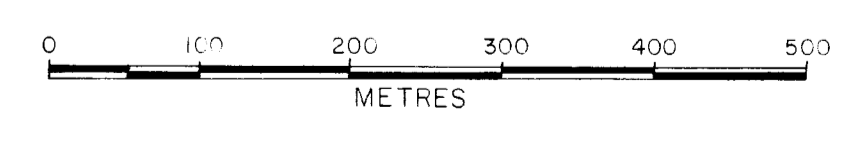

LORNEX MINING CORPORATION LTD.	
SUMMERS CREEK AREA NTS 92H/10E-9W	
GOLDEN PROSPECT GEOLOGY	
DRAWN: P.A.C. TRACED: J.S. REVISED	SCALE: 1:5000 OCT. 1981.

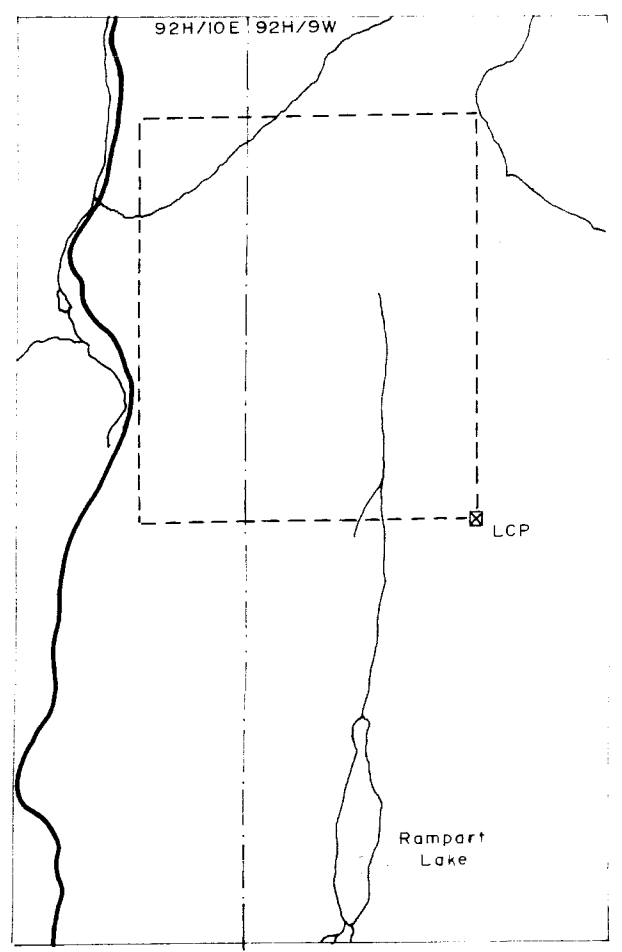
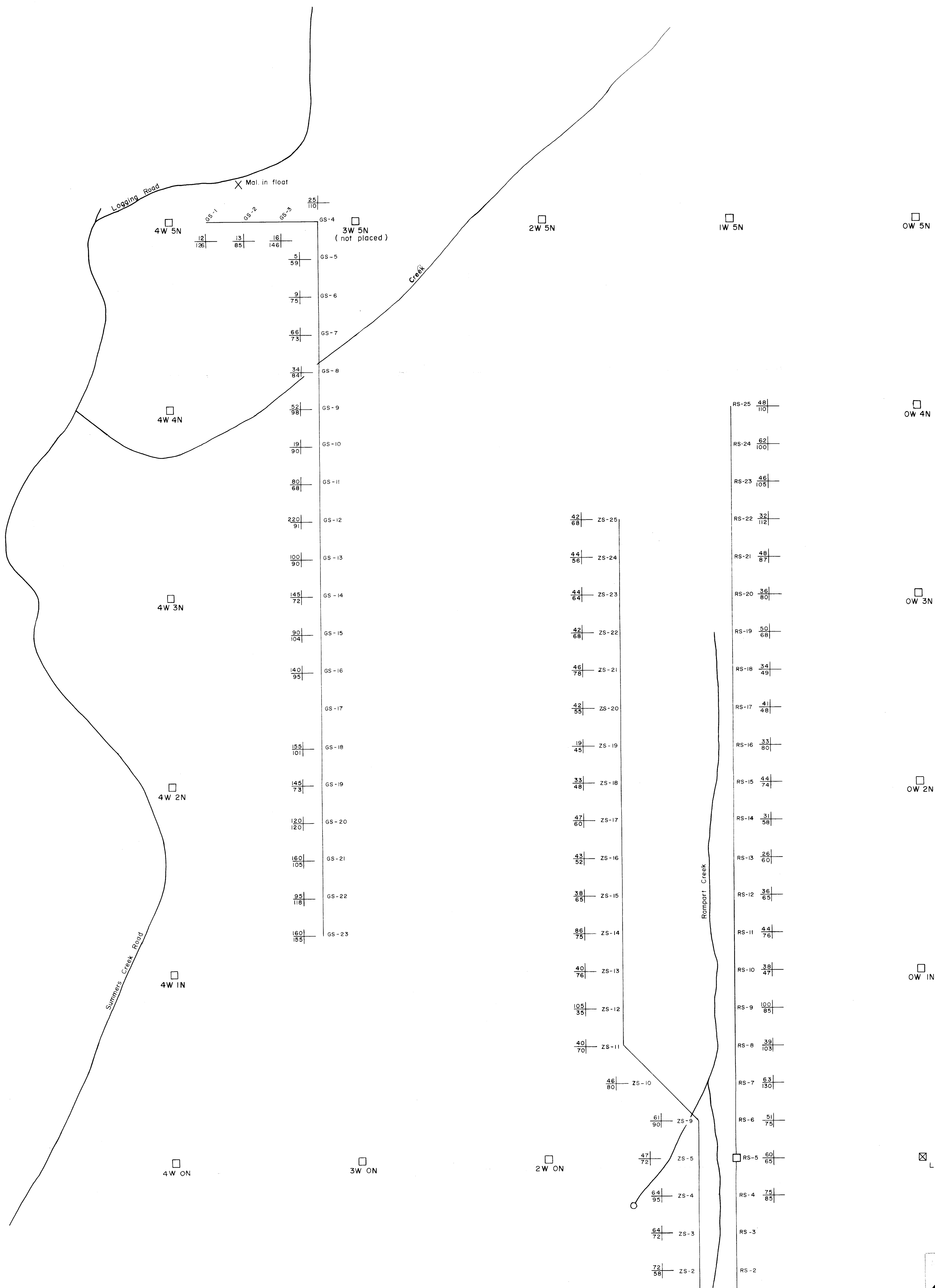

LEGEND

- Cu (ppm) | Ag (ppm)
 Zn (ppm) | Au (ppb)
- RS-1 Sample number
 - ☒ Legal Corner Post
 - Intermediate Post
 - ⊗ Silt Sample Site
- Cu (ppm) | Zn (ppm) | Pb (ppm)
 Mo (ppm) | Ag (ppm) | Au (ppb)

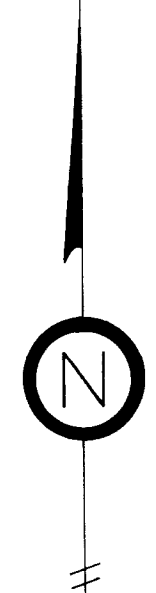

9821

PAC SYNDICATE VANCOUVER B.C. CANADA		
SUMMERS CREEK NTS 92H/10E a9W		
RECCE GOLDEN PROSPECT		
Drawn: _____ By _____ Date _____	SCALE 1:5000 	
Drafted: _____ Revised: _____	Map No.: Fig. 9 File No.: _____	

SMALL LAKE

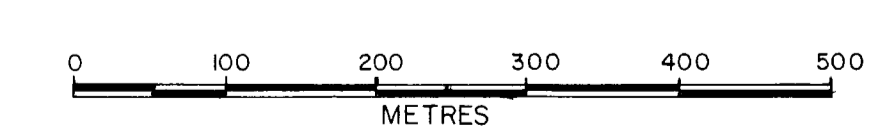
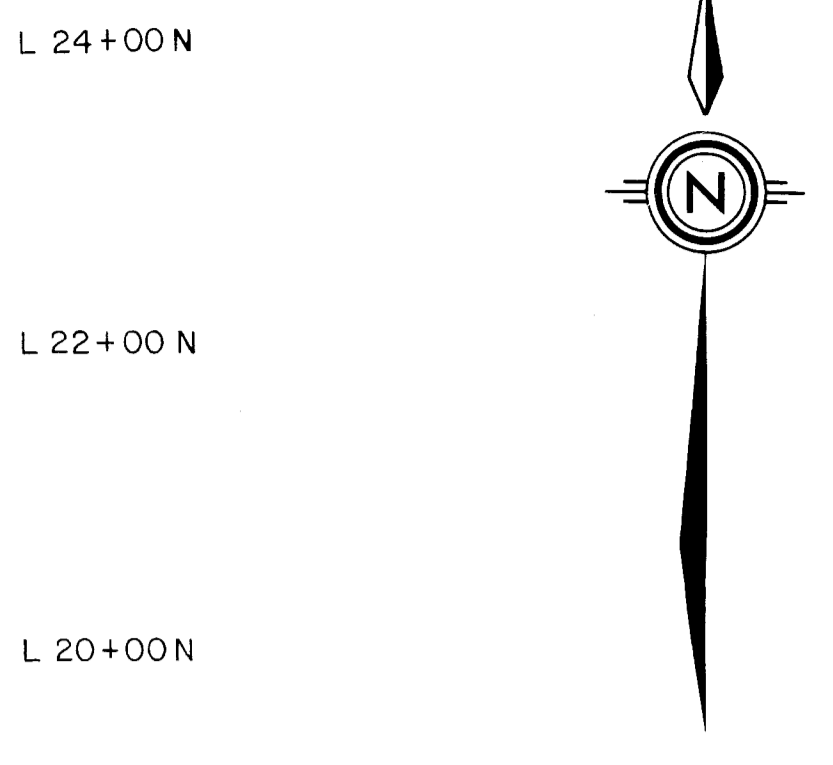
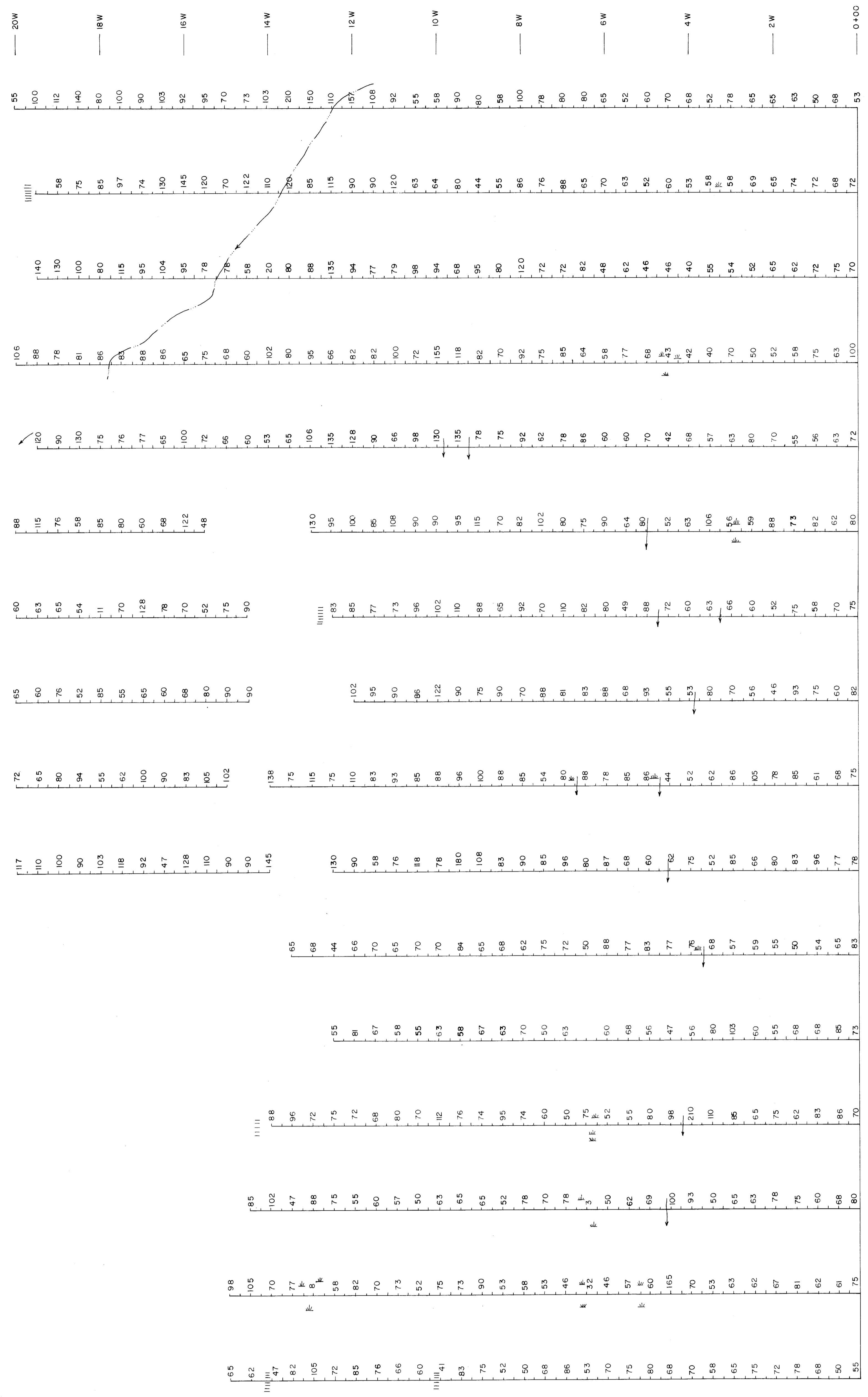
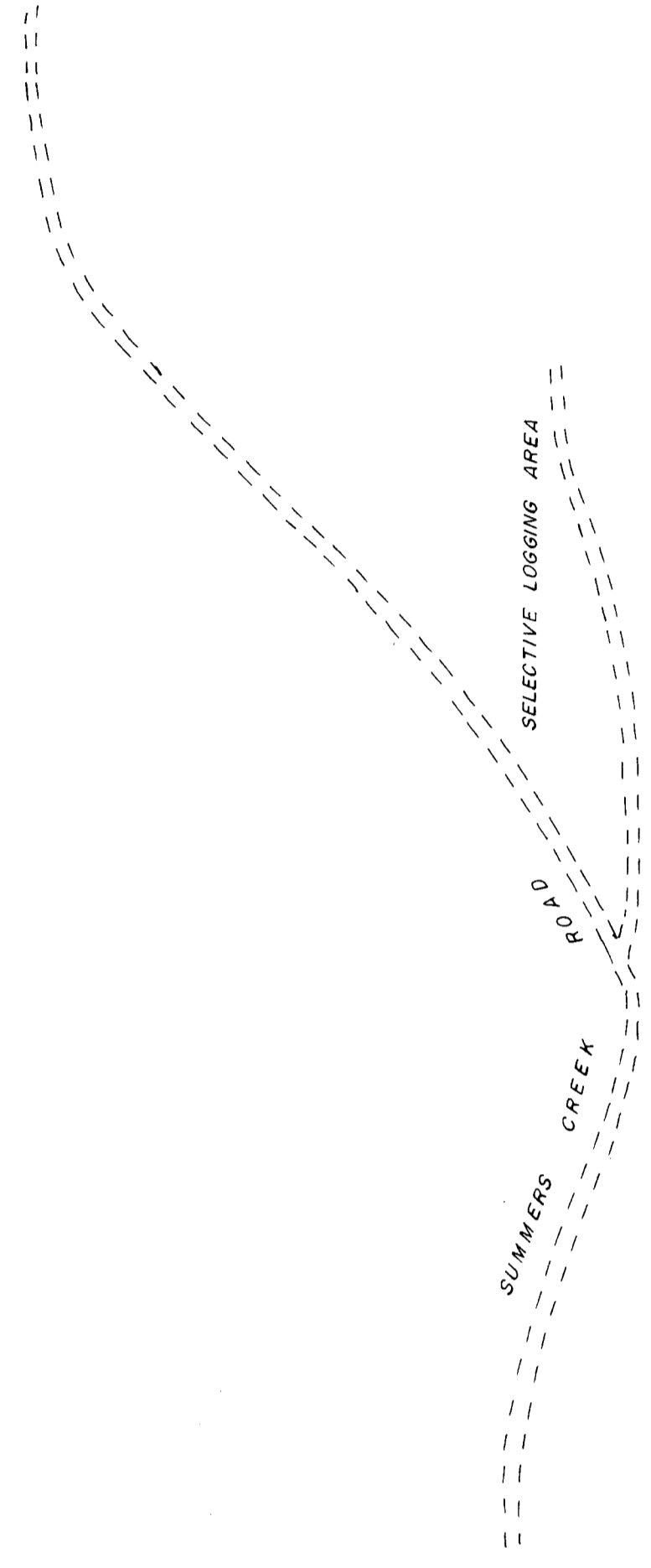

LEGEND
CLIFF
SWAMP
CREEK

9821

Project information including LORNE MINING CORPORATION LTD., GOLDEN #1 PROPERTY, SOIL GEOCHEMISTRY ZINC PPM, DATE: OCT 1981, SCALE: 1:5000, and a professional engineer's stamp.

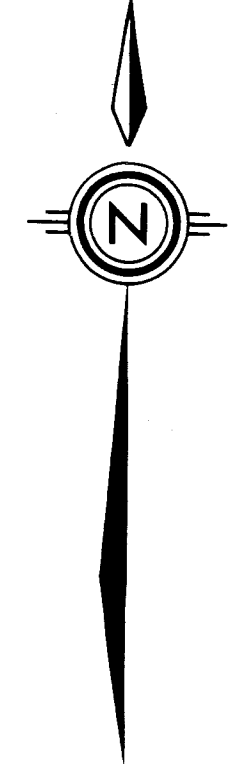
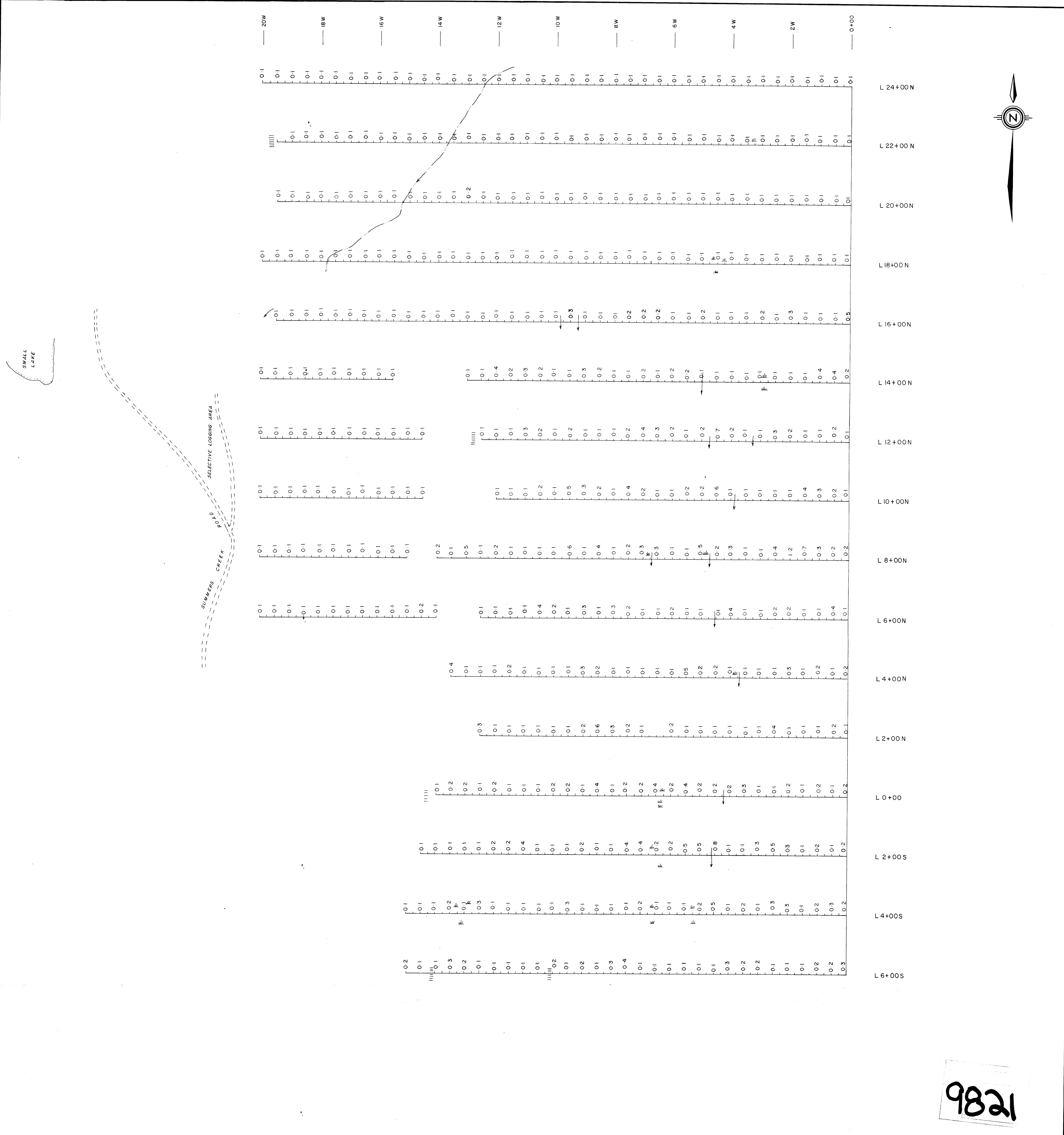

9821

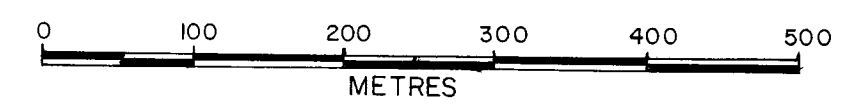

LEGEND
 ||||| CLIFF
 ≡ SWAMP
 → CREEK

LORNEX MINING CORPORATION LTD.	
GOLDEN # 1 PROPERTY	
SOIL GEOCHEMISTRY	
SILVER PPM	
DATE: OCT 1981.	SCALE: 1:5000
FIGURE 7	T. M. (J. S.)

SMALL LAKE

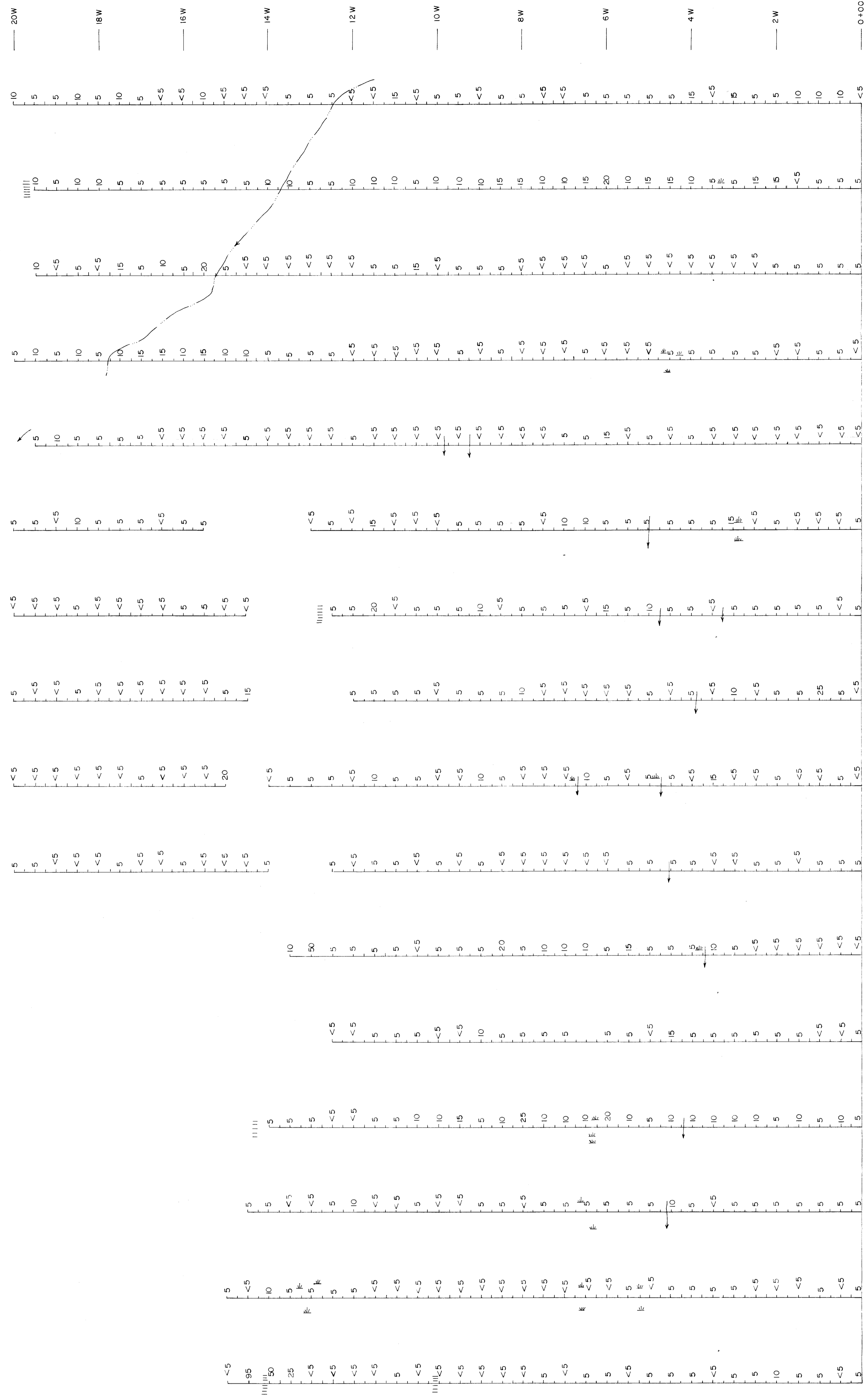
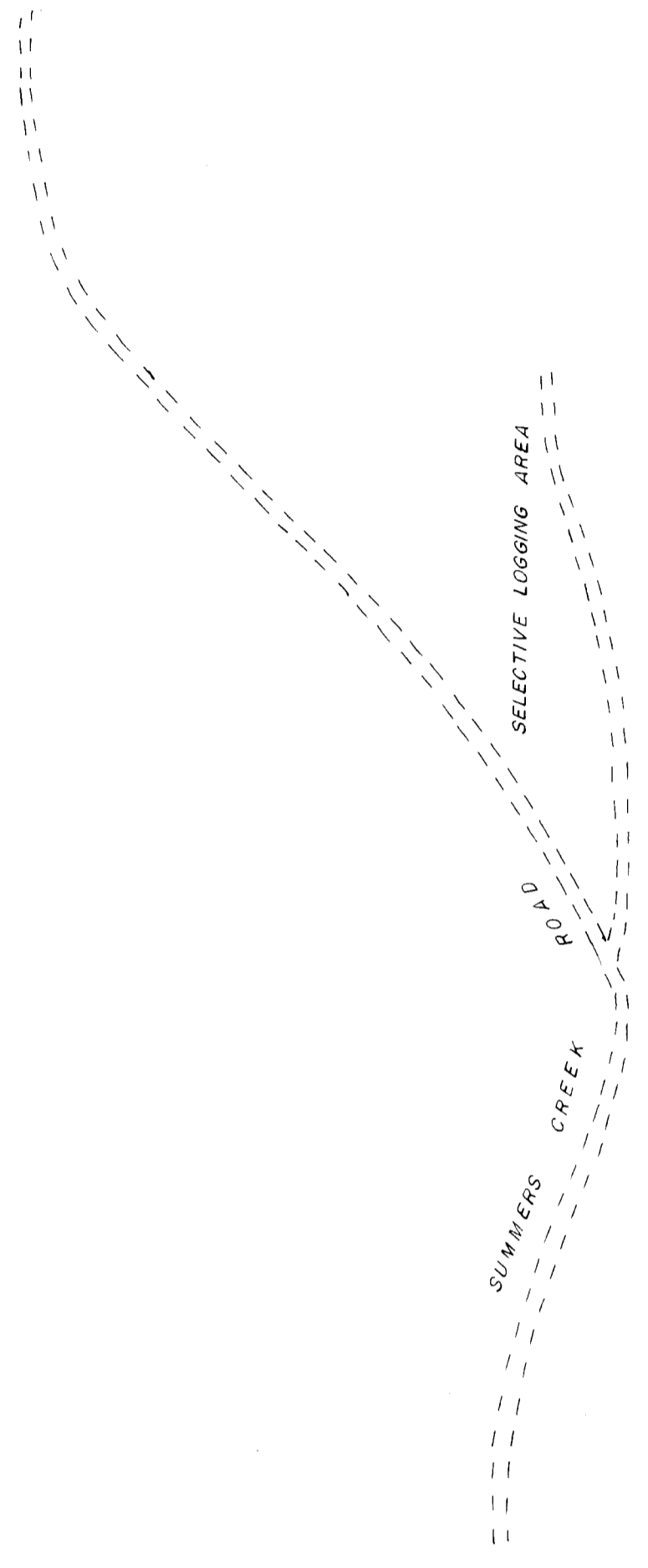

L 24+00N
L 22+00N
L 20+00N
L 18+00N
L 16+00N
L 14+00N
L 12+00N
L 10+00N
L 8+00N
L 6+00N
L 4+00N
L 2+00N
L 0+00
L 2+00S
L 4+00S
L 6+00S

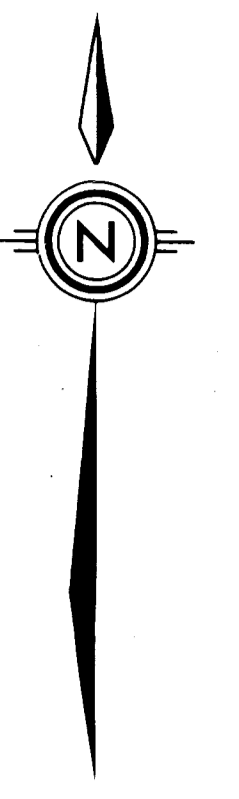

LEGEND
||||| CLIFF
▲ SWAMP
→ CREEK

9821

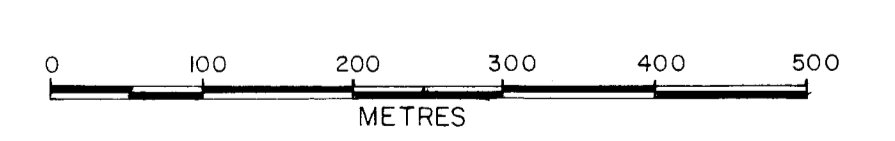

LORNEX MINING CORPORATION LTD.	
GOLDEN # 1 PROPERTY	
SOIL GEOCHEMISTRY	
GOLD PPB	
DATE: NOV 1981.	SCALE: 1:5000
FIGURE 8	T.M. (J.S.)

