

REPORT ON THE GEOLOGY  
OF THE  
JOHN AND GRACE CLAIMS  
TWO JOHN CREEK,  
ATLIN AREA,  
B.C.

OMMECA MINING DISTRICT

104N/12E

59°42'N, 133°35'W.

By

JoAnne Nelson, M.Sc.

For

ANGLO CANADIAN MINING CORPORATION  
713 - 744 W. Hastings Street,  
Vancouver, B.C.  
V6C 1A5

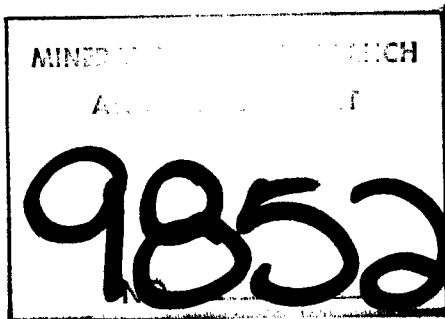

October, 1981.

TABLE OF CONTENTS.

	<u>Page</u>
Introduction	1
Geology	1
Assays	2
Appendix I Certificate of Assay	5
Appendix II Claim Map (Part of 104N1/12E)	7
Appendix III Geologist's qualifications	9
Appendix IV Cost Statement	11
Fig. 1. Geology of the John & Grace claims	3

\* \* \* \* \*

INTRODUCTION.

At the suggestion of Lloyd Hodgson, Anglo Canadian personnel staked two blocks of claims on upper Two John Creek - John (20 units) and Grace (3 units) on August 4th and August 7th, 1981 respectively.

Two John Creek has been prospected for placer gold. Pits and small sluices were encountered during this study.

<u>Name</u>	<u>Units</u>	<u>Record No.</u>	<u>Record date.</u>
John	20	1403	Aug. 6, 1981.
Grace	3	1550	Aug.20, 1981.

GEOLOGY.

Exposures in the claim area are limited to the banks of Two John Creek (Fig. 1). Two rock types are seen: non-porphyrific alaskite, and quartz diorite similar to that in the Fourth of July Creek body. (See Aitken 1948). Alaskite is dominant. Over most of the exposed area it is unaltered and relatively fresh. Fine quartz veinlets occur sporadically. Heavy fracturing, limonite staining and some shearing have affected the alaskite over an interval of 200 m. at the lower end of bedrock exposure along the creek. Within this zone, a single quartz vein 1 m wide, trending 045/90 cuts the alaskite. The quartz is white, milky and massive in texture; hematite coats fracture surfaces and small shears.

ASSAYS.

Two assays were conducted of the main quartz vein, 1) on a large sampling of the main quartz vein, 2) on a high-graded grab sample representative of the quartz veinlets within a 50 m outcrop length. Neither showed detectable gold.

Assays (For location see Fig.1)

1. < .002 oz/ton Au
2. < .002 oz/ton Au

It is not recommended that further work be done on these claims.

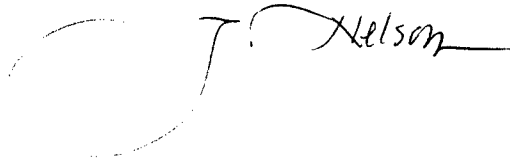
A handwritten signature in cursive script that reads "J. Nelson". The signature is written in black ink and is positioned to the right of a large, sweeping flourish that starts under the word "Assays" and extends to the left.

REFERENCE:

Aitken, J.D. 1958 Geology Atlin,  
Cassiar District, B.C.  
GSC map 1082A.

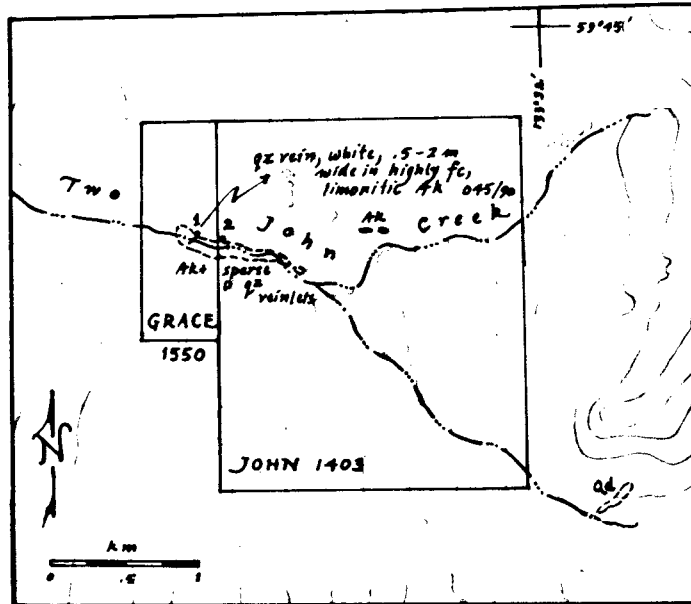

Fig. 1. Geology of the John and Grace claims

LEGEND

- AK alaskite, probably Cretaceous
- Qd quartz diorite, Fourth of July Creek body
- rock sample taken for assay
- ⌋ outcrop limit

Base: 104 7/12 E 1/2

APPENDIX I.

CERTIFICATE OF ASSAY

By: Sembo  
 PAGE No. 1

**BONDAR-CLEGG & COMPANY LTD.**

REPORT NO. A21 - 97

DATE: August 21, 1981

713 - 744 West Hastings Street  
 Vancouver, B. C. V6C 1A2

**CERTIFICATE OF ASSAY**

Samples submitted: August 11, 1981  
 Results completed: August 21, 1981

PROJECT: NONE GIVEN

I hereby certify that the following are the results of assays made by us upon the herein described rock samples.

MARKED	GOLD		SILVER		Cu	Pb					
	Ounces per Ton	Grams per Metric Ton	Ounces per Ton	Grams per Metric Ton	Percent	Percent	Percent	Percent	Percent	Percent	Percent
SAMPLE #											
1) (148)	<0.002		-		-	-					
2) (149)	<0.002		-		-	-					
cc Elin Beal											

RE:  
 Rejects retained three weeks  
 Pulps retained three months  
 unless otherwise arranged.

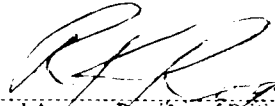
  
 Registered Assayer, Province of British Columbia

APPENDIX I.

APPENDIX II.

CLAIM MAP.

(Part of 104N/12E)



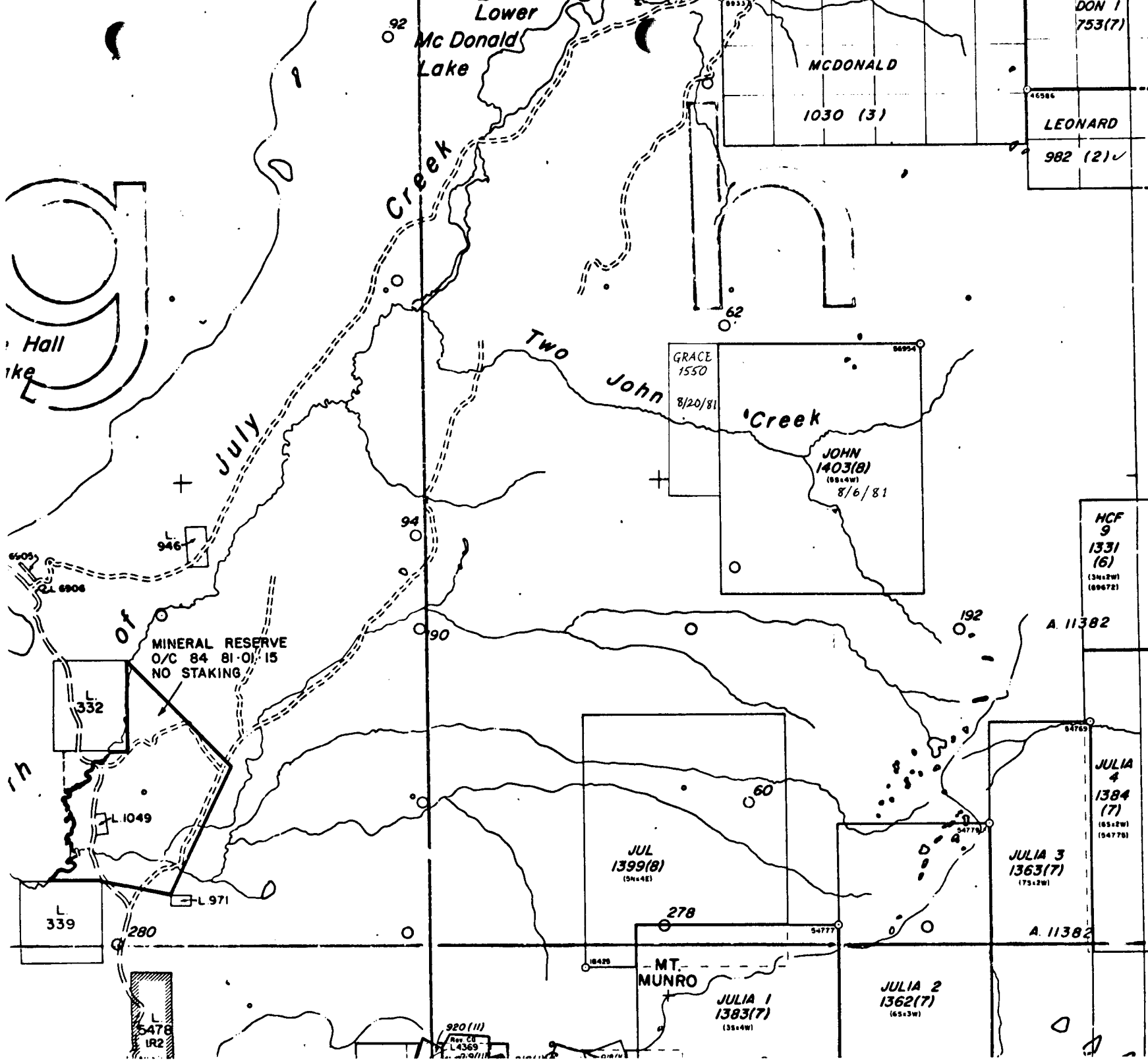

APPENDIX II.

EAST SEE MAP 104-N-11-W  
 FORFEITED MINERAL CLAIM  
 VERIFIED LEGAL CORNER POST  
 LEGAL SURVEY  
 LEGAL CORNER POST & TAG NUMBER

APPENDIX III.

Geologist's qualifications.

C E R T I F I C A T E .

I. JoAnne Nelson, do hereby certify:

That I am a geologist residing at 4027  
West 18th Avenue, Vancouver, British  
Columbia, V6B 2T2.

That I hold a B.Sc in geology from  
the University of Washington (1973)  
and an M.Sc in geology from the  
University of British Columbia (1976).

That I have no financial interest, either  
direct or indirect, in the subject property  
and that I do not expect to obtain any  
such interest.

That the information contained in this  
report is based on my personal knowledge  
of the general area, reference to the  
works cited in this report, and to examination  
of the property in question.

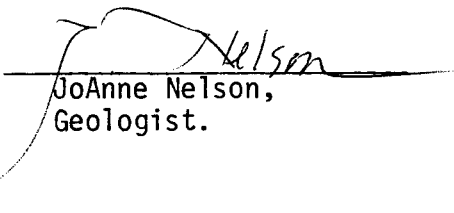
  
JoAnne Nelson,  
Geologist.

JAN/cmp

APPENDIX IV.

Cost Statement.

COST STATEMENT  
JOHN & GRACE CLAIMS.

J. Nelson, geologist, August 8, 1981	\$ 250.00
G. Smith, assistant, August 8, 1981	84.00
Helicopter transportation, August 8, 1981	548.00
Assays, 2 Au @ \$8.00	16.00
Camp support costs, \$21/day.	42.00
Report writing, J. Nelson, 1 day \$250	250.00
Secretary, \$50	50.00
	<hr/>
Total -	\$1,240.00
	<hr/> <hr/>