

81 - #985 - #9869

DRILLING
ASSESSMENT REPORT

EXCALIBUR CLAIMS

CARIBOO MINING DISTRICT

N.T.S. LOCATION 93G/14 W

~~80~~⁰ LATITUDE ~~81~~⁰ LONGITUDE
53°48 123°17

OWNER - JERRY J. OFUKANY

OPERATOR - NORTHROCK INDUSTRIES LTD.

AUTHOR - JERRY J. OFUKANY

DATE SUBMITTED: NOV. 17, 1981

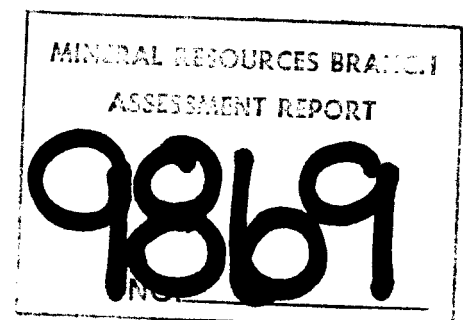

TABLE OF CONTENTS

- PAGE 1 - INTRODUCTION
- PAGE 2 - LOCATION MAP
- PAGE 3 - ITEMIZED COSTS OF PHYSICAL
ASSESSMENTS
- PAGE 4 - MINERAL CLAIM PHYSICAL WORK
LOCATION MAP
- PAGE 5 - ITEMIZED COSTS OF PERCUSSION
DRILLING
- PAGE 6 - PERCUSSION DRILLING LOCATION MAP
- PAGE 7 - PERCUSSION DRILLING LOG REPORT
- PAGE 8 - AUTHOR'S QUALIFICATIONS

INTRODUCTION

The Excalibur mineral claims are located ^{35.2 km} ~~22 miles~~ west, ~~7 miles~~ south of Prince George, B.C., north of Dahl ^{lake} Lake. The property is a limerock deposit. The current owner is Jerry J. Ofukany and the operator is Northrock Industries Ltd.

The property at present is producing chemical limerock for local pulp mills on D.L. 3474 and has shown traces of silver deposits mixed in with the limerock formation.

Trenching was undertaken and stripping of overburden to solid rock. The overburden consisting of boulder clay.

Percussion drilling in two locations took place. 2 3/4" diameter holes were drilled to various depths. Drill cuttings were logged and a drill log kept.

10 drill holes were drilled for a total of ~~345~~ ^{105.2 M} feet drilled.

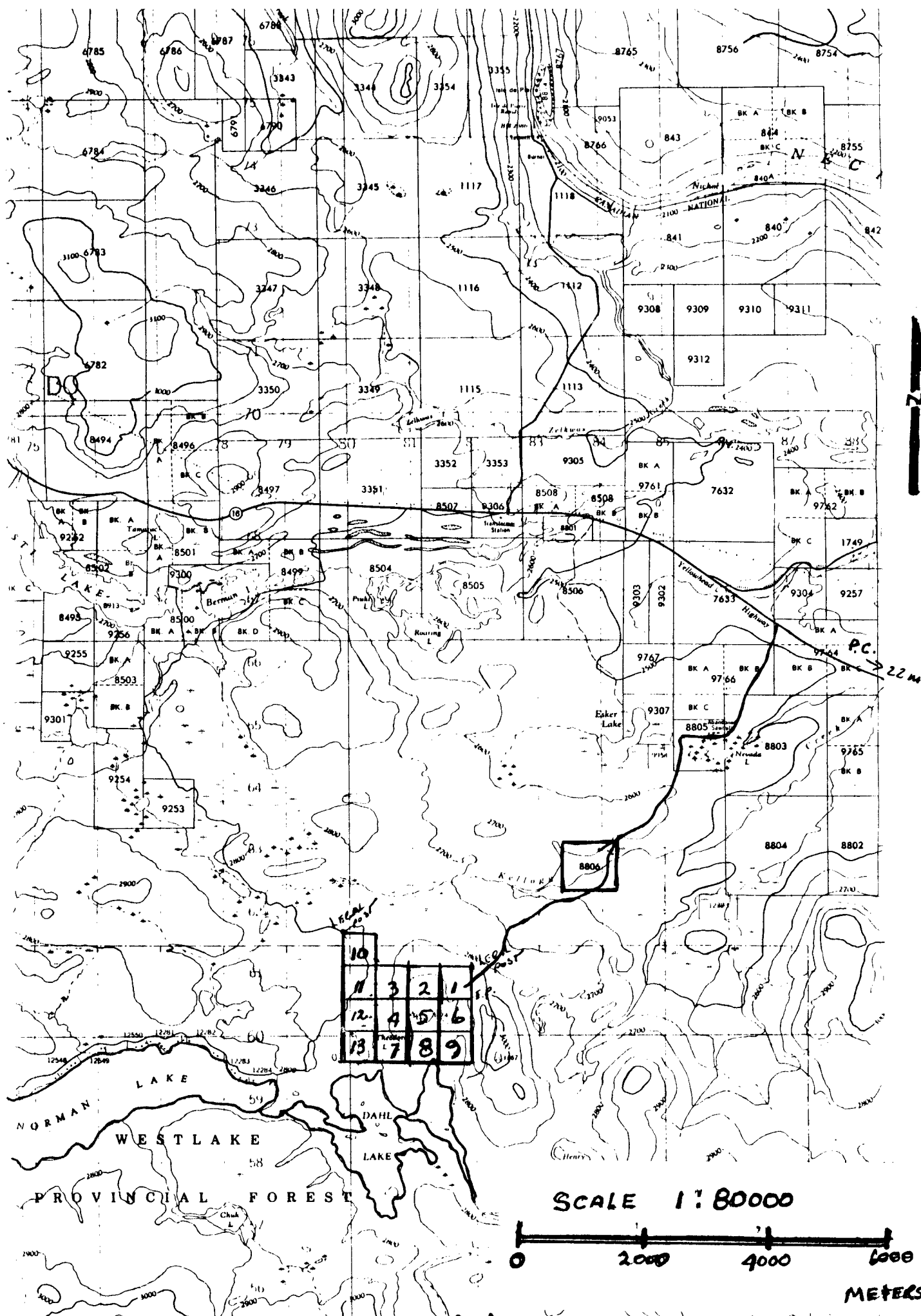

10				
11	3	2	1	
12	4	5	6	
13	7	8	9	

SCALE 1:80000

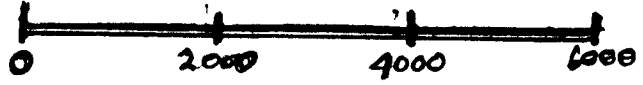

COSTS OF PHYSICAL ASSESSMENTS

OCT. 14/81	Trenching - D8 Dozer	8 hrs.	@ \$50.00 per hour	= \$400.00
" 15/81	" - " "	8 "	@ \$50.00 " "	= 400.00
" 16/81	" - " "	8 "	@ \$50.00 " "	= 400.00
" 17/81	" - " "	8 "	@ \$50.00 " "	= 400.00
" 14 - 17/81	Transportation	384 km.	@ 25¢ per km.	= 96.00
" 14/81	Labour Trenching	8 hrs.	@ \$20.00 per hour	= 160.00
" 15/81	" "	8 "	@ \$20.00 " "	= 160.00
" 16/81	" "	8 "	@ \$20.00 " "	= 160.00
" 17/81	" "	8 "	@ \$20.00 " "	= 160.00
TOTAL PHYSICAL =				\$2,336.00
				=====

EXCALIBUR MINERAL CLAIMS PHYSICAL WORK (MAP)

PAGE (4)

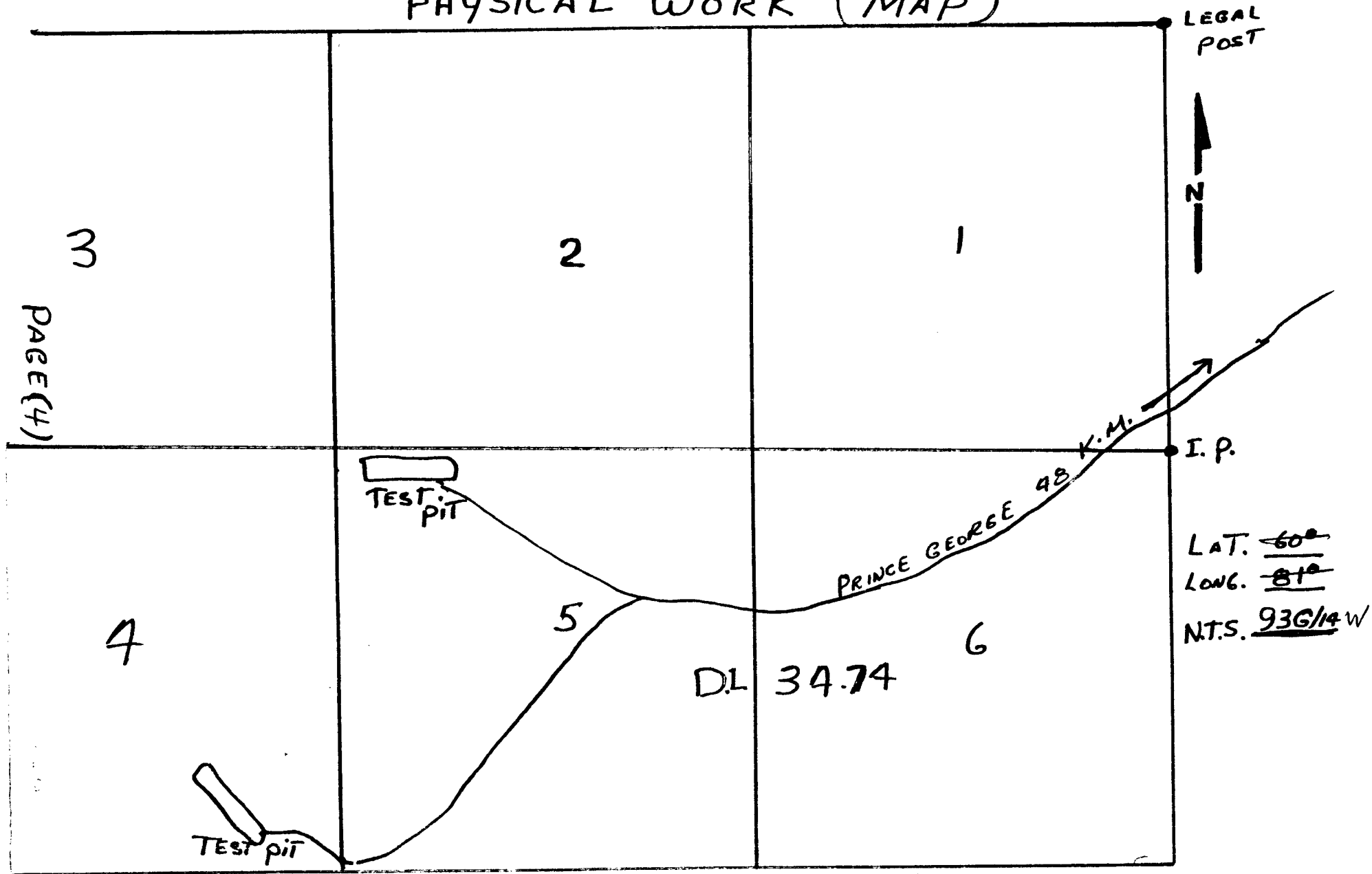

LEGAL POST



LAT. ~~60°~~
LONG. ~~81°~~
NTS. 93G/14W

SCALE 1:6250

0 250 500 METERS

C. DRILLING - 2 3/4" PERCUSSION

Oct. 15/81	Drilling	8 hrs. @ \$50.00 per hr.	\$400.00
" 16/81	"	8 hrs. @ \$50.00 per hr.	400.00
" 15/81	Labour	32 hrs. @ \$15.00 per hr.	480.00
" 16/81	"	32 " @ \$15.00 per hr.	480.00
Transportation	202 km. @ 25¢ per km.		50.50
			<hr/>
			\$1,810.50
			=====

DRILLING - 2 3/4" PERCUSSION

Nov. 12/81	Drilling	8 hrs. @ \$50.00 per hr.	400.00
" 13/81	"	8 hrs. @ \$50.00 per hr.	400.00
" 12/81	Labour	32 hrs. @ \$15.00 per hr.	480.00
" 13/81	"	32 hrs. @ \$15.00 per hr.	480.00
Transportation	202 km. @ 25¢ per km.		50.50
			<hr/>
			\$1,810.50
			=====

345 feet drilled Total cost \$3,621.00
=====

DRILLING (PERCUSSION)

POST

2

1



LAT 60°
LONG 87°

N.T.S 936/14

SCALE
1:5000

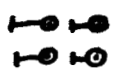

- D.H 1-E-15' 90°
- D.H 2-E-15' 90°
- D.H 3-E-15' 90°
- D.H 4-E-15' 90°
- D.H 5-E-15' 90°
- D.H 6-E-15' 90°
- D.H 7-E-15' 90°
- D.H 8-E 60' 45° WEST
- D.H 9-E 60' 45° "
- D.H 10-E 60' 45° "
- D.H 11-E 60' 45° "

5

6

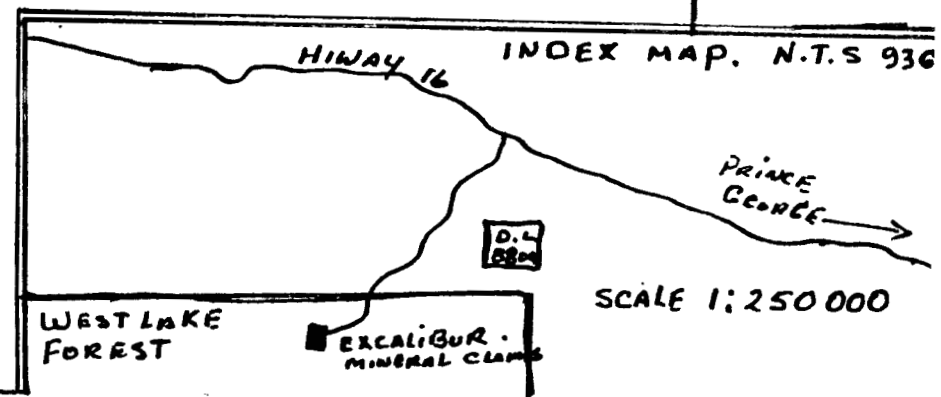

3
PAGE 9

4

DRILL LOG REPORT

(1 FT = 0,305 M)

PERCUSSION DRILLING - 2 3/4" DIAMETER HOLES

Depth of overburden on all holes was 6 feet which consisted of boulder clay.

- Drill hole # 1-81-E - 20 feet deep, 90 degrees
- limerock
- trace of mineralization at 18 feet
- Drill hole #2-81-E - 20 feet deep, 90 degrees
- limerock
- no mineralization
- Drill hole # 3-81-E - 20 feet deep, 90 degrees
- limerock
- no mineralization
- Drill hole # 4-81-E - 20 feet deep, 90 degrees
- limerock
- broken rock at 15 feet
- some mineralization at 15 feet
- Drill hole # 5-81-E - 20 feet deep, 90 degrees
- limerock
- broken rock at 12 feet
- Drill hole # 6-81-E - 20 feet deep, 90 degrees
- limerock
- broken rock
- discoloured rock at 11 feet to 20 feet
- Drill hole # 7-81-E - 20 feet deep, 90 degrees
- mineralization at 12 feet
- Drill hole # 8-81-E - 60 feet deep, 45 degrees
- limerock
- mineralization at 17 feet and 40 feet
- Drill hole # 9-81-E - 60 feet deep, 45 degrees
- limerock
- no mineralization
- Drill hole #10-81-E - 60 feet deep, 45 degrees
- limerock
- no mineralization
- Drill hole #11-81-E - 60 feet deep, 45 degrees
- limerock
- no mineralization

Author of all reports - Jerry J. Ofukany

Qualifications;

Previous experience in staking property and supervising of drilling and trenching.

Construction superintendent c/w British Columbia Dep't. of Mines Shifters ticket and Workers' Compensation Board General Blasting ticket.