

81-#644

REPORT
LUCKY JIM CLAIMS
KLEANZA CREEK
OMINECA MINING DIVISION
MAP M 103I/9E

54° 34 N, 128° 13 W

for

KELLY CREEK JOINT VENTURE
709-744 WEST HASTINGS STREET
VANCOUVER, B.C.

by

STEPHEN QUIN
B.Sc. MINING GEOLOGY
709-744 WEST HASTINGS STREET
VANCOUVER, B.C.

September 22, 1980

MINERAL RESOURCES BRANCH
ASSESSMENT REPORT
9914
NO.

TABLE OF CONTENTS

	Page
LOCATION & ACCESS	1
THE PROPERTY	1
WORK DONE & PERSONNEL	3
RESULTS	4
DISCUSSING RESULTS.....	5
GEOLOGY	6
RECOMMENDATIONS	7
STATEMENT OF QUALIFICATIONS	8
APPENDIX 1: ROCK CHIP GEOCHEMISTRY	9
APPENDIX 2: SOIL GEOCHEMISTRY	11
APPENDIX 3: ROCK ASSAYS	14

LIST OF MAPS

1. LOCATION & ACCESS	Page 2
2. SOIL SAMPLE SITES	Pocket
3. COPPER SOIL GEOCHEMISTRY	Pocket
4. SILVER SOIL GEOCHEMISTRY	Pocket
5. STREAM SAMPLE SITES	Pocket
6. STREAM SEDIMENT GEOCHEMISTRY	Pocket
7. LOCATION OF ROCK CHIP SAMPLES	Pocket
8. GEOLOGY	Pocket

LOCATION & ACCESS

The Lucky Jim claims are located approximately 8½ miles south of Highway #16 and approximately 25 miles southeast of Terrace, B.C.

Access is by logging road off Highway #16 approximately 15 miles east of Terrace. The logging road follows the North side of Kleanza Creek for approximately 8½ miles and passes through the centre of the property.

A location map accompanies this report (Map 1).

THE PROPERTY

The Lucky Jim claims consist of 4 2-Post claims in a 2 x 2 block. The Record Number is .

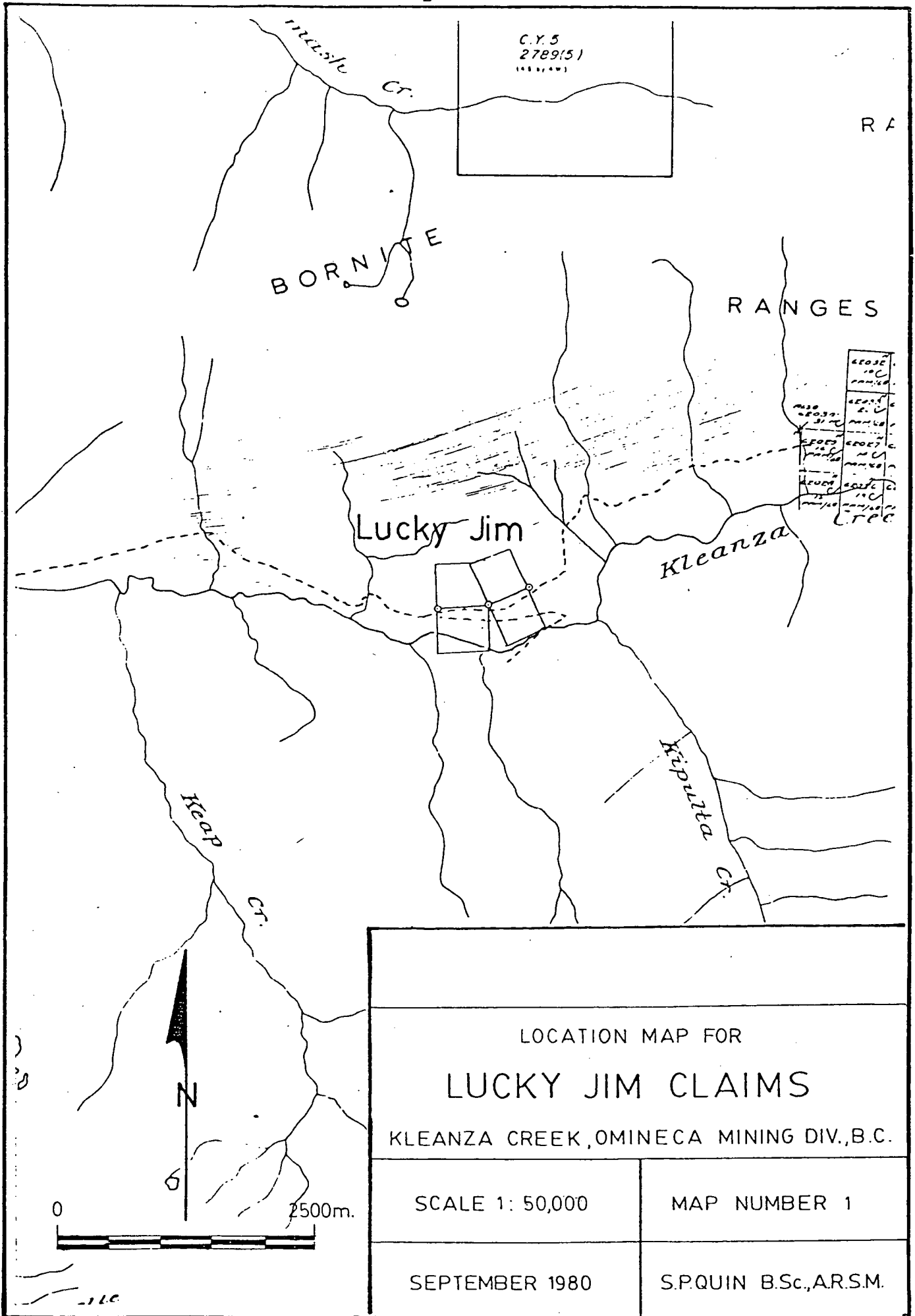

C.Y. 5
2789(5)
(1887-1901)

RA

BORNITE

RANGES

Lucky Jim

Kleanza

Heap

Kipitla



LOCATION MAP FOR

LUCKY JIM CLAIMS

KLEANZA CREEK, OMINECA MINING DIV., B.C.

SCALE 1: 50,000

MAP NUMBER 1

SEPTEMBER 1980

S.P. QUIN B.Sc., A.R.S.M.

WORK DONE AND PERSONNEL

On Septmeber 5th the author accompanied J. McGoran B.Sc. and J. Tough (the owner) to the property and was assisted by P. Cheetham (a student Geologist).

In order to determine a strike and extent of the mineralization 3 survey lines were put down along the three roads that traverse the property, measuring orientations, elevations and distances along these roads.

Every 50 m a soil sample was taken from the B Horizon - if such existed - along all three lines. At the same time the geology was noted and each lithology chip sampled. Any streams crossed were sediment sampled. All samples were analysed for copper and silver by a commercial laboratory.

THE RESULTS

- (1) Soils: The sample sites are shown on Map 2 and geochemistry of each sample on Maps 3 & 4 for copper and silver respectively.
- (2) Streams: The positions of the streams sampled are shown on Map 5 and the copper and silver geochemistry given on Map 6.
- (3) Rock Chips: Map 7 shows the position of all the chip samples and the results are given in Appendix 1.

DISCUSSION OF RESULTS

The soil sampling clearly shows up a strongly copper anomalous area over 450m (MR450 - MR900) with values of up to 100 times background but averagging 5 - 10 times background. On the lower road the anomaly is narrower, being only 100m wide (LR750 - LR850) and less intense - values up to 50 times background. The upper road (J) shows no significant values.

Silver values tend to be high where the copper is high but only by a factor of 10 at most and there are 5 - 10 times background anomalies unassociated with copper anomalies.

The anomalies on the Middle Road (MR) are probably clastre and primary but those on the Lower Road (LR) could well be Hydromorphic seepages on either side of the creek due to leaching of dump material up slope.

Stream sampling picks up little of interest, although the highest anomaly (410 ppm Cu, 2.4 ppm Ag for LR750 (s)) occurs within the main anomalous area.

Chip sampling only indicates one area of interest - MR614(R) - but this is known to be a fault bound block less than a metre across. Otherwise no significant primary mineralization is detected.

Rock Assay Samples - 4 of which were taken - appears to show a fairly uniform 6-7m wide body of 1.5 - 2.0% Cu and 0.7 - 1.4oz/ton Ag with a 1m highgrade zone of 3.4 - 7.0% Cu and 1.2 - 3.3oz/ton silver. Gold is insignificant (0.002 oz/ton).

GEOLOGY

The Property is underlain by volcanics of the lower part of the Hazelton group. It consists mainly of Grey andesites that are occasionally slightly Porphyritic (Feldspar Phenocrysts up to 0.5cm) and often amygdaloidal. Amygdales are generally filled with calcite, but are often weathered out at surface to give a vuggy appearance.

At the western end of the property purple-red andesites appear. They are generally very fine grained and amygdaloidal.

Faulting in the area is generally fairly intense but no folding is observed. Stratigraphy appears to be approximately North-South.

Map 8 shows the mapped exposures.

RECOMMENDATIONS

More detailed sampling on a 25 x 25m grid should be carried out over the whole anomalous area to determine the actual aerial extent of this anomaly. If it is found to be of a reasonable size it should be trenched by backhoe for detailed examination.

Detailed Geological mapping is necessary to determine the relationship between Mineralization, Stratigraphy and Structural features such as fracturing, faulting and shearing.

CERTIFICATE

I, Stephen Paul Quin, of 709-744 West Hastings, Vancouver B.C., do hereby certify that

1. I am a Mining Geologist of 709-744 West Hastings, Vancouver, B.C. with an office at this address.
2. I am a graduate in Mining Geology from the Royal School of Mines, London, Great Britain, and I am an associate of the said school.
3. I have 6 months prospecting and exploration experience in British Columbia with Invex Resources Ltd.
4. The above report is compiled from the given references on the authors personal experience of the property.

Dated at Vancouver, B.C. this 22nd day of September, 1980



S.P. QUIN, B.Sc., A.R.S.M.

APPENDIX 1

ROCK CHIP GEOCHEMISTRY

Geochemical Lab Report

Report No. 20 - 2077

Page No. 2

SAMPLE NO.	Cu ppm	Ag ppm	Au ppb		SAMPLE NO.	Cu ppm	Ag ppm	Au ppb	
J 0+25 ROCKS	4	0.2			LR - 1134 (R)	265	0.6		
0+60	101	0.2			1250 (R)	19	0.2		
3	196	0.6			1286 (R)	12	0.2		
LR 250 (R)	29	0.4			1300 (R)	9	0.2		
265 (R)	34	0.2			MR 0 (R)	116	0.2		
272 (R)	3	0.2			28 (R)	2	0.2		
328 (R)	15	0.2			233 (R)	6	0.2		
390 (R)	132	0.2			370 (R)	88	0.2		
396 (R)	60	0.2			614 (R)	9600	8.2		
431 (R)	23	0.2			983	99	0.3		
500 (R)	2	0.2							
540 (R)	91	0.2							
633 (R)	2	0.2							
642 (R)	87	0.2							
750 (R)	31	0.2							
798 (R)	4	0.2			cc Mr. J. P. McGoran				
800 (R)	20	0.8							
883 (R)	8	1.3							
917 (R)	22	0.2							
919 (R)	43	0.6							
933 (R)	7	0.2							
941 (R)	13	0.4							
943 (R)	6	0.2							
944 (R)	10	0.3							
961 (R)	62	0.2							
977 (R)	89	0.5							
1133 (R)	65	0.2							

APPENDIX 2

Soil Geochemistry

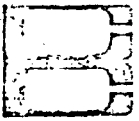

BONDAR-CLEGG & COMPANY LTD.

130 PEMBERTON AVE., NORTH VANCOUVER, B.C.

PHONE 985-0681

TELEX 04-352607

Geochemical Lab Report

Location _____

Report No. 20 - 2077

Method _____

From Mr. J. Tough

Section Used _____

Date September 12, 19 80

SAMPLE NO.	Cu ppm	Ag ppm	Au ppb		SAMPLE NO.	Cu ppm	Ag ppm	Au ppb	
J - 0	6	0.2			LR - 850	1495	2.0		
150	23	0.6			900	88	0.2		
217	111	0.4			950	73	0.5		
232+264	17	0.4			1000	27	0.4		
237+ 53	26	0.2			1050	229	0.6		
107	16	0.6			1100	60	1.2		
152	28	0.4			1150	117	0.2		
220	31	0.3			1200	87	1.2		
LR 1	16	0.4			1250	65	0.6		
50	73	0.4			1300	84	0.2		
83	221	0.8			1313 (S)	300	0.4		
100	123	0.6			1350	114	0.4		
150	45	0.3			1400	150	0.3		
186 (S)	135	0.6			MR 0	72	0.2		
189 (S)	84	0.2			8 (S)	46	0.4		
200	46	0.4			50	555	0.2		
203 (S)	61	0.2			59 (S)	112	0.8		
250	148	0.8			100	33	1.2		
300	201	1.1			150	32	0.2		
350	55	0.8			200	12	0.2		
400	42	1.0			250	16	0.2		
450	30	0.4			282 (S)	20	0.2		
LR 500	24	0.6			300	< 1	0.2		



BONDAR-CLEGG & COMPANY LTD.

130 PEMBERTON AVE., NORTH VANCOUVER, B.C.

PHONE: 985-0681

TELEX 04-352667

Geochemical Lab Report

Fraction _____

Report No. 20 - 2077

Method _____

From Mr. J. Tough

Reaction Used _____

Date September 12, 19 80

SAMPLE NO.	Cu ppm	Ag ppm	Au ppb		SAMPLE NO.	Cu ppm	Ag ppm	Au ppb	
<i>LR</i> 500	24	0.6			<i>MR</i> 300	< 1	0.2		
550	132	2.5			350	48	0.2		
600	32	0.2			400	116	2.4		
650	166	0.9			450	685	0.4		
700	103	0.6			500	825	2.0		
750	1375	0.8			550	7200	11.		
750 (S)	410	2.4			600	4400	1.8		
<i>LR</i> 800	89	0.4			650	845	0.5		
					<i>MR</i> - 700	338	0.8		
					750	238	0.7		
					800	321	1.2		
					850	490	2.0		
					900	74	1.8		
					950	150	0.8		
					981 (S)	228	0.4		
					<i>MR</i> 1000	72	0.8		

APPENDIX 3

Rock Assays

To: Mr. Tough

PAGE No. 1

General Delivery
Squamish, B.C. V0N 3G0

BONDAR-CLEGG & COMPANY LTD.

CERTIFICATE OF ASSAY

REPORT NO. 0 - 1384

DATE: September 24, 1980

Samples submitted: September 9, 1980
Results completed: September 24, 1980

I hereby certify that the following are the results of assays made by us upon the herein described.....samples.

MARKED	GOLD		SILVER		Cu						
	Ounces per Ton	Grams per Metric Ton	Ounces per Ton	Grams per Metric Ton	Percent	Percent	Percent	Percent	Percent	Percent	
1 7m	0.002		1.42		1.82						
2 1m	0.002		3.28		6.98						
A 1 6m	0.002		0.72		1.45						
2 17.5m	0.003		1.23		3.44						
cc Mr. John P. McGoran											

NOTE:
Rejects retained three weeks
Pulps retained three months
unless otherwise arranged.

Registered Assayer, Province of British Columbia

Cost Statement.

Kleanza Creek Gyps.

J.T. Claims 1-6

America Mining Div.

Transportation. Van - Tenace. 158.40

Weight - Camp gear Van - Tenace
Shipment of Samples 110.40

Assaying
105 Geo Chemical cu. av. AG 810.75
4 Rock Samples " " "

Accom. Tenace Hotel 2 nights 56.70.

Physical work. 5 days @ \$60⁰⁰ day,
Locating old workings etc prior to
Engineer examination. (James Tough) 300.00

\$ 1436.75.

James Tough.

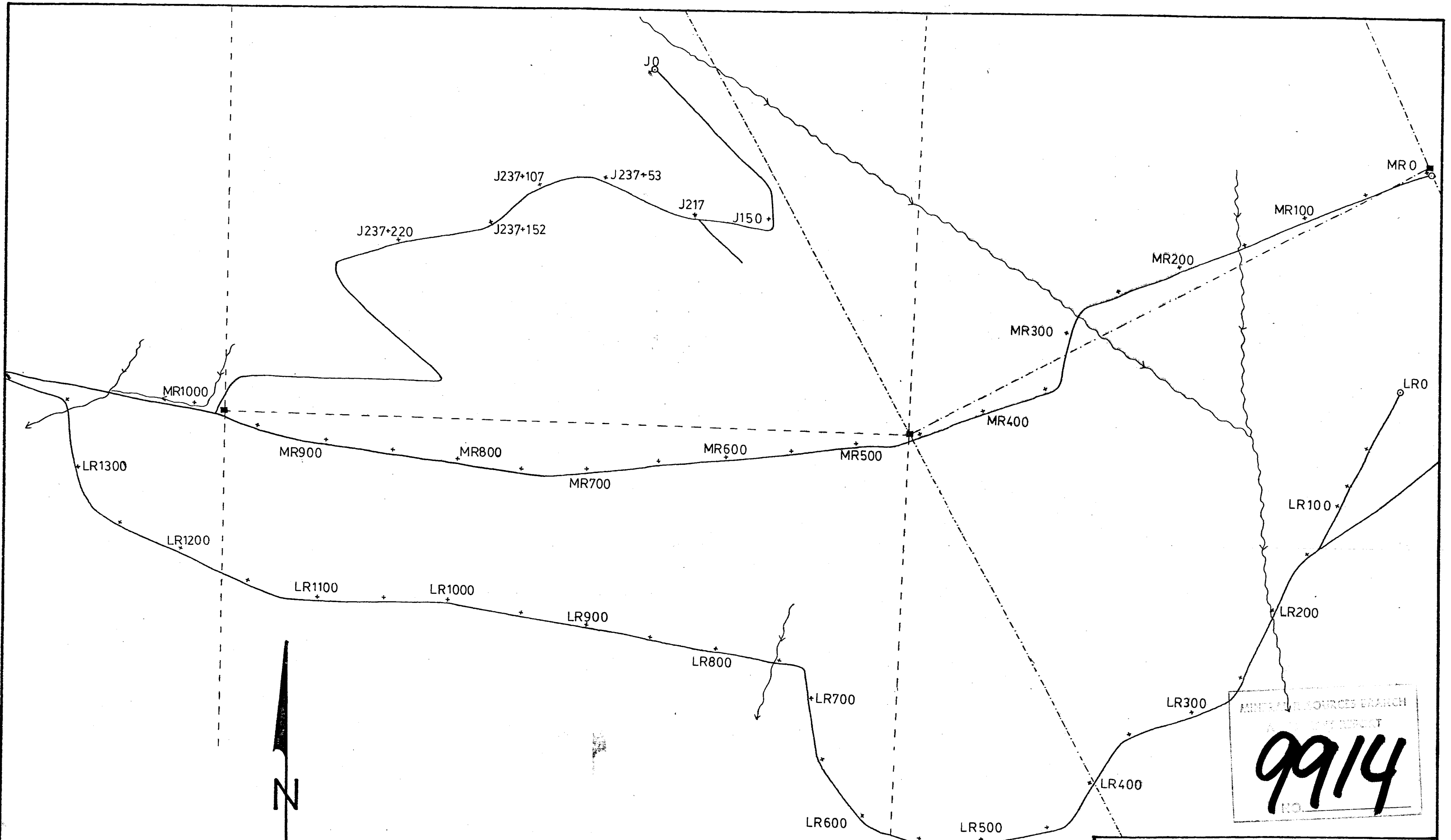

LEGEND
 Claim Post ■
 Claim Line - - - - -
 Road —
 Creek ~ ~ ~
 Sample Site +

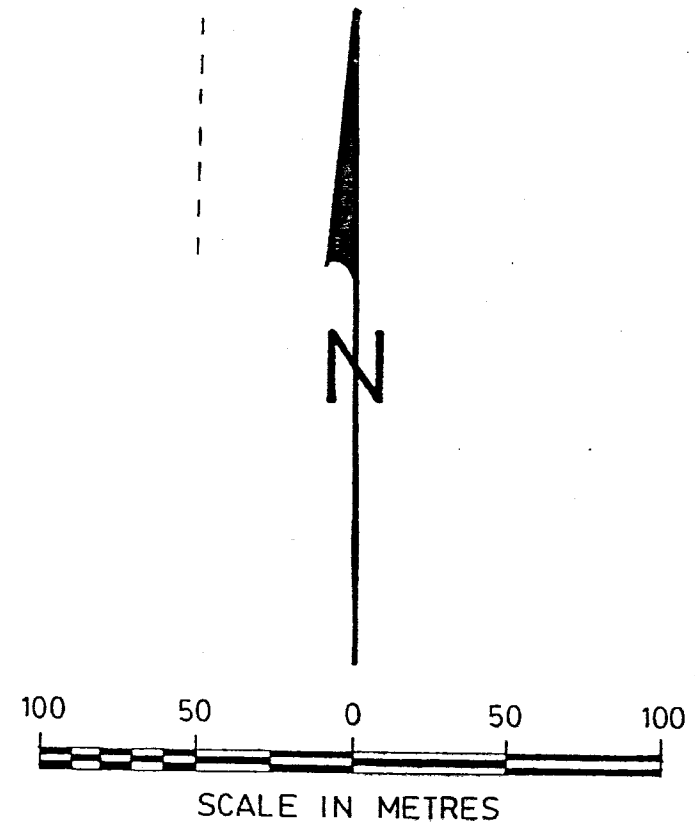

SOIL SAMPLE LOCATIONS	
LUCKY JIM CLAIMS	
KLEANZA CREEK, OMINECA MINING DIV., B.C.	
SCALE 1:2,500	MAP NUMBER 2
SEPTEMBER 1980	S.P. QUIN B.Sc., A.R.S.M.

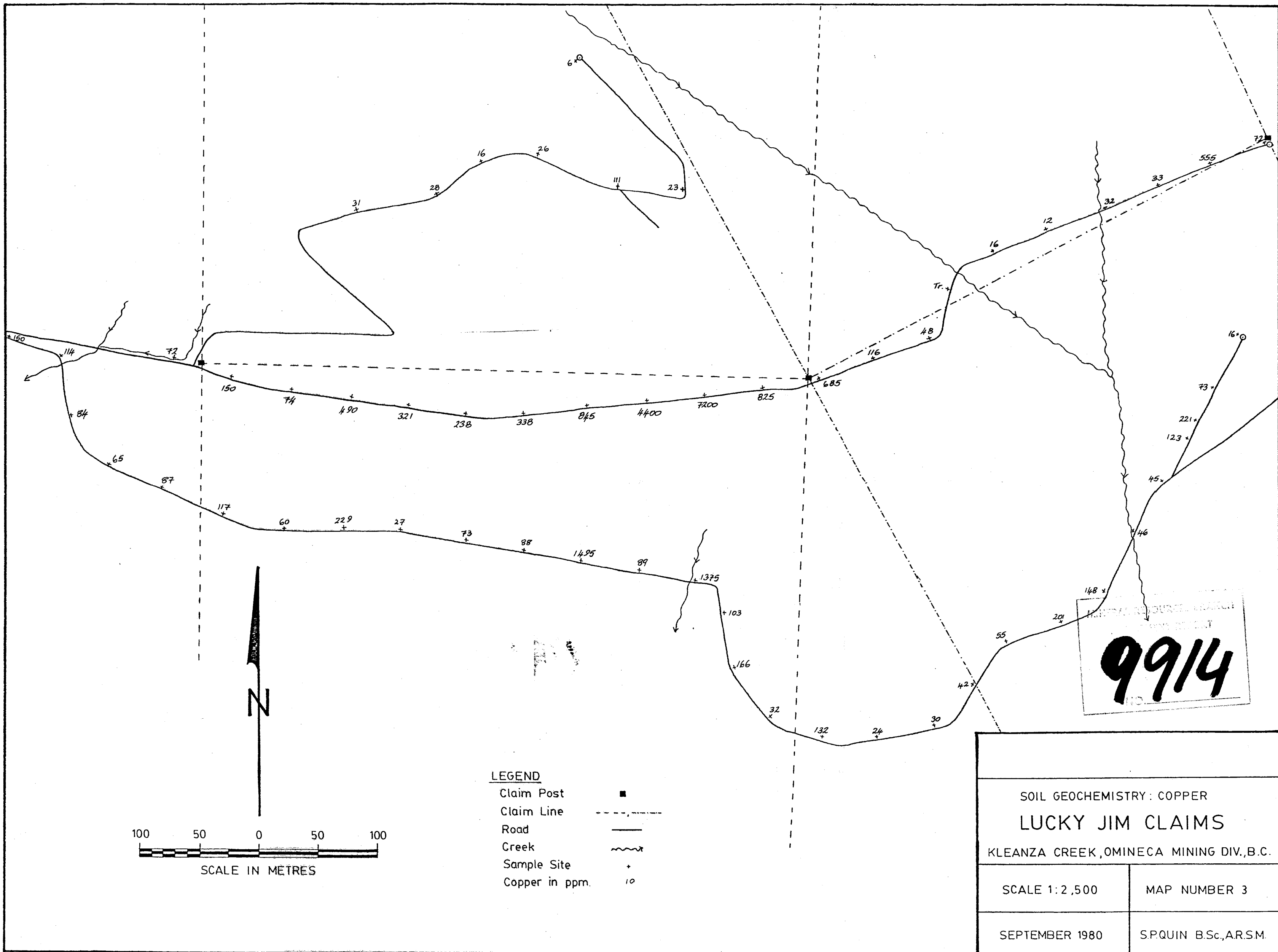

LEGEND

- Claim Post ■
- Claim Line - - - - -
- Road —
- Creek ~ ~ ~
- Sample Site +
- Copper in ppm. 10

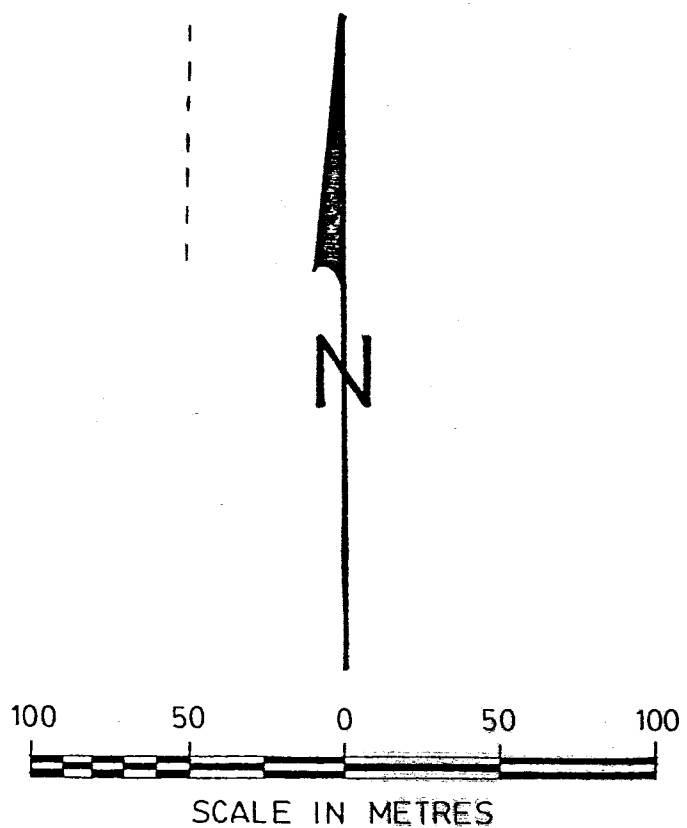

SOIL GEOCHEMISTRY: COPPER	
LUCKY JIM CLAIMS	
KLEANZA CREEK, OMINECA MINING DIV., B.C.	
SCALE 1:2,500	MAP NUMBER 3
SEPTEMBER 1980	S.P. QUIN B.Sc., A.R.S.M.

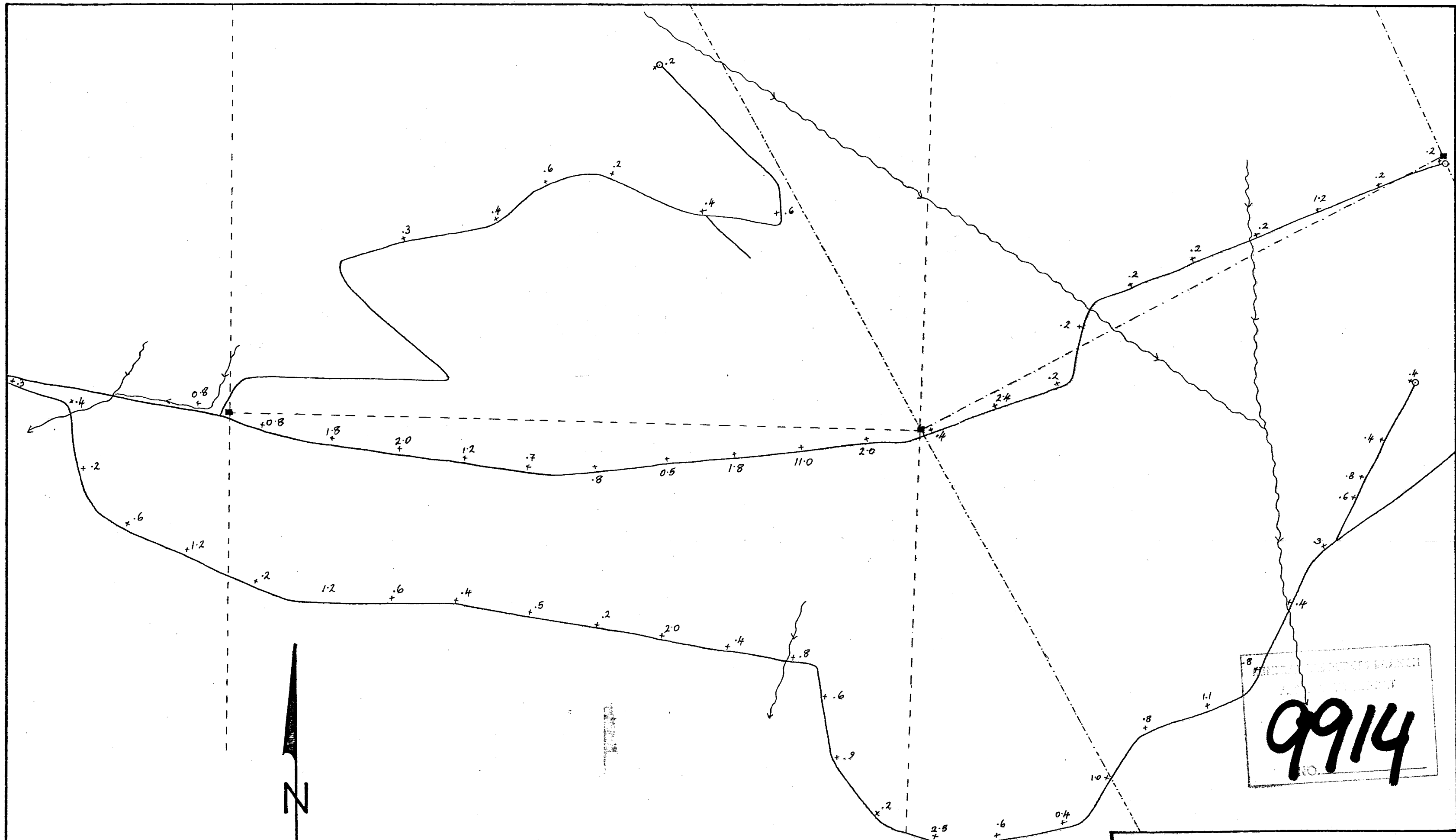

LEGEND

- Claim Post ■
- Claim Line - - - - -
- Road —
- Creek ~ ~ ~
- Sample Site +
- Silver in ppm .2

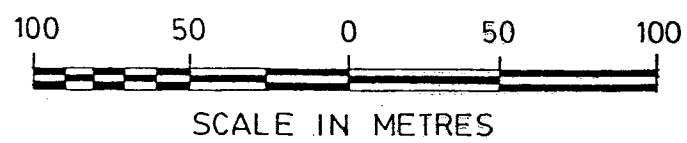

SOIL GEOCHEMISTRY : SILVER LUCKY JIM CLAIMS KLEANZA CREEK, OMINECA MINING DIV., B.C.	
SCALE 1:2,500	MAP NUMBER 4
SEPTEMBER 1980	S.P. QUIN B.Sc., A.R.S.M.

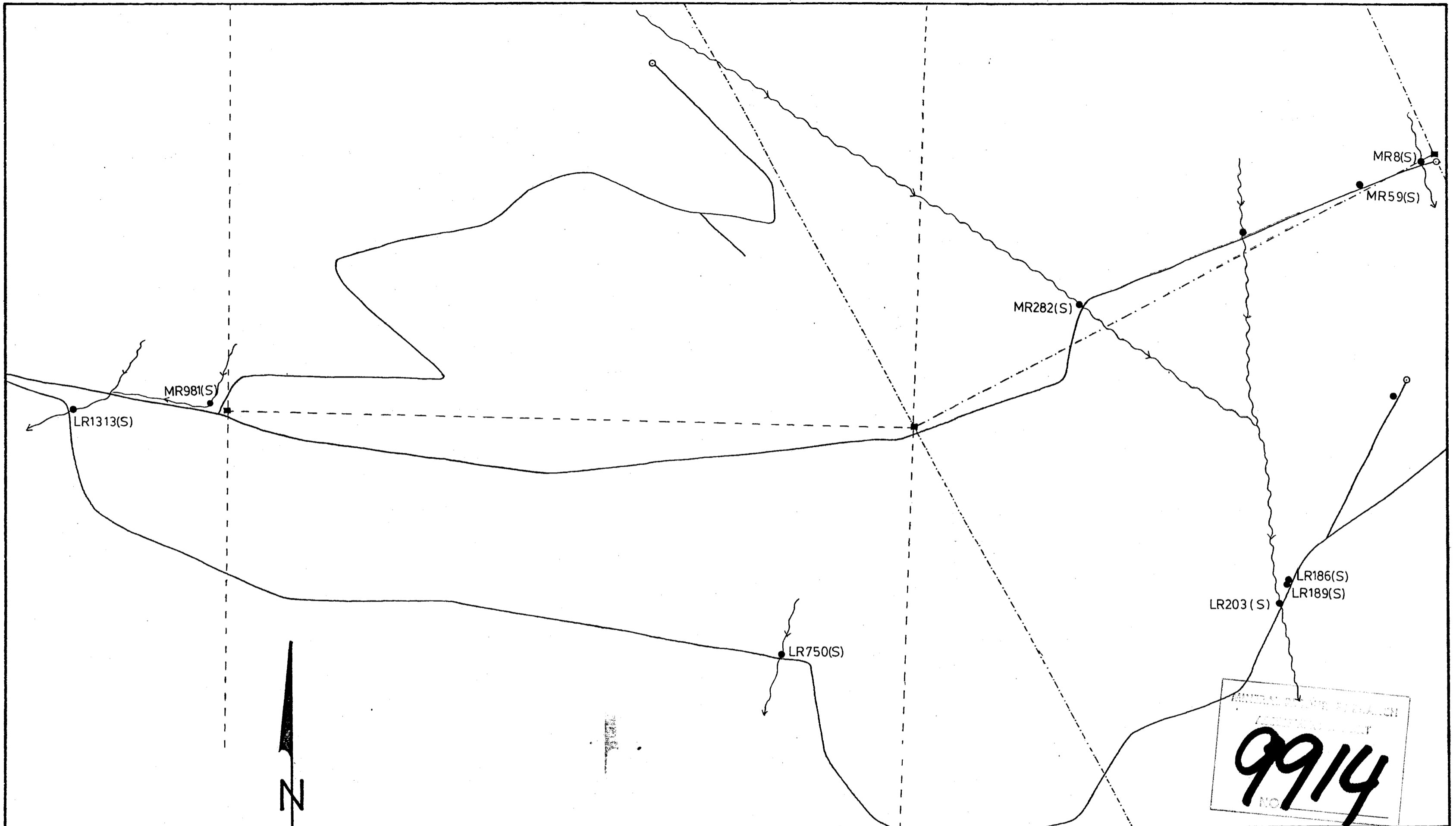

- LEGEND**
- Claim Post
 - Claim Line
 - Road
 - Creek
 - Sample Site

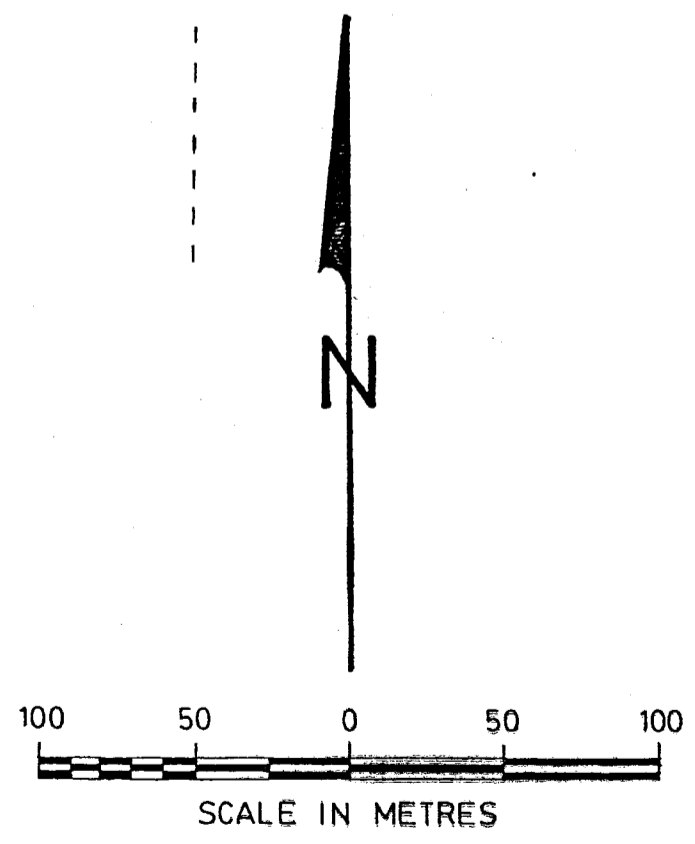

STREAM SAMPLE LOCATIONS LUCKY JIM CLAIMS KLEANZA CREEK, OMINECA MINING DIV., B.C.	
SCALE 1:2,500	MAP NUMBER 5
SEPTEMBER 1980	SPQUIN B.Sc., AR.S.M.

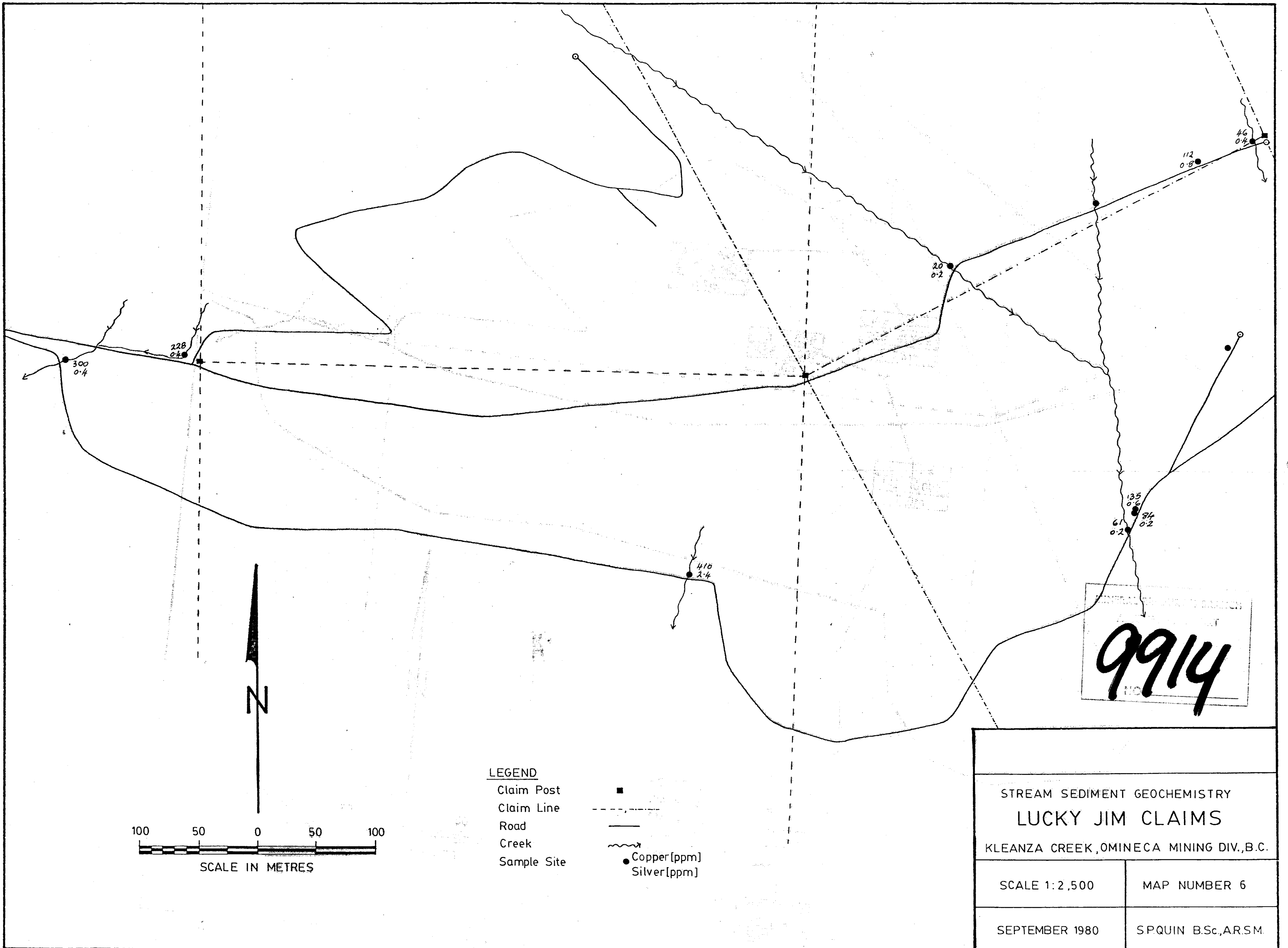

100 50 0 50 100
SCALE IN METRES

LEGEND
 Claim Post
 Claim Line
 Road
 Creek
 Sample Site
 Copper [ppm]
 Silver [ppm]

STREAM SEDIMENT GEOCHEMISTRY LUCKY JIM CLAIMS KLEANZA CREEK, OMINECA MINING DIV., B.C.	
SCALE 1:2,500	MAP NUMBER 6
SEPTEMBER 1980	SPQUIN B.Sc., AR.S.M.

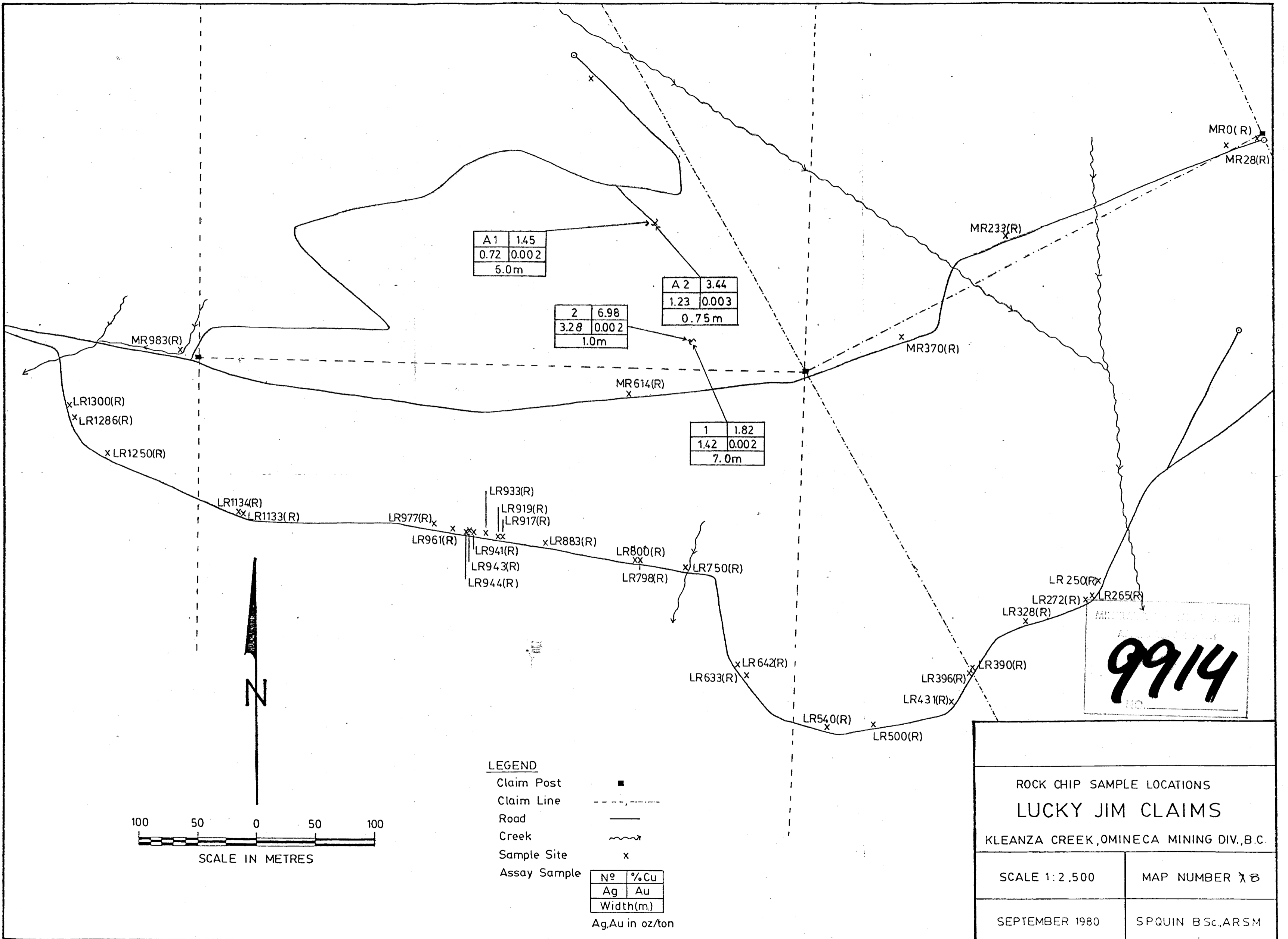

A 1	1.45
0.72	0.002
6.0m	

A 2	3.44
1.23	0.003
0.75m	

2	6.98
3.28	0.002
1.0m	

1	1.82
1.42	0.002
7.0m	

9914

LEGEND

- Claim Post
- Claim Line
- Road
- Creek
- Sample Site
- Assay Sample

Nº	%Cu
Ag	Au
Width(m.)	

Ag,Au in oz/ton

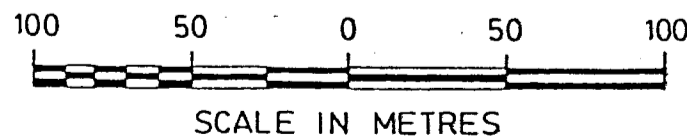

ROCK CHIP SAMPLE LOCATIONS LUCKY JIM CLAIMS KLEANZA CREEK, OMINECA MINING DIV., B.C.	
SCALE 1:2,500	MAP NUMBER 78
SEPTEMBER 1980	SPQUIN B.Sc., ARSM

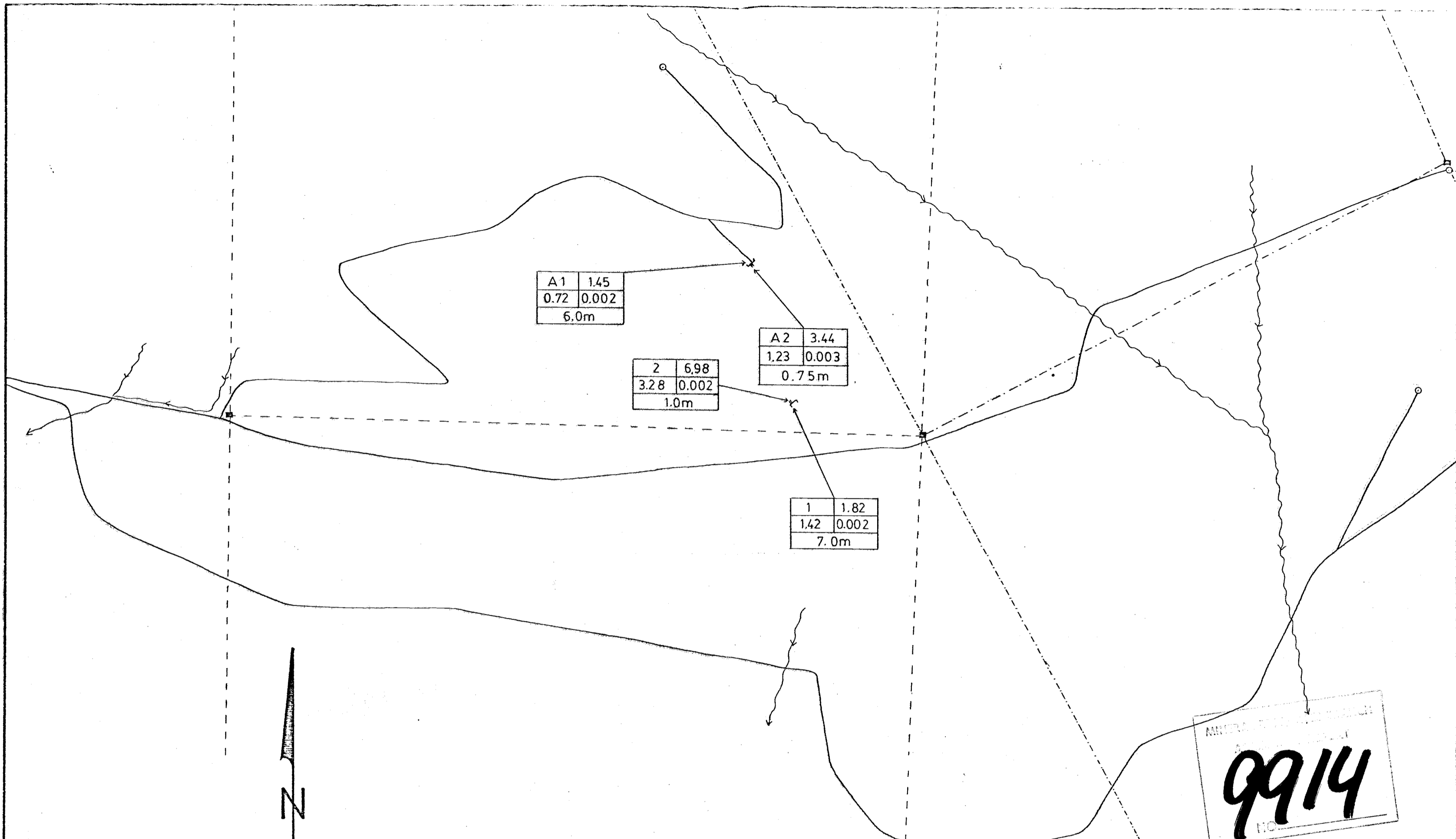

A1	1.45
0.72	0.002
6.0m	

A2	3.44
1.23	0.003
0.75m	

2	6.98
3.28	0.002
1.0m	

1	1.82
1.42	0.002
7.0m	

MINING DIVISION
 9914
 NO.

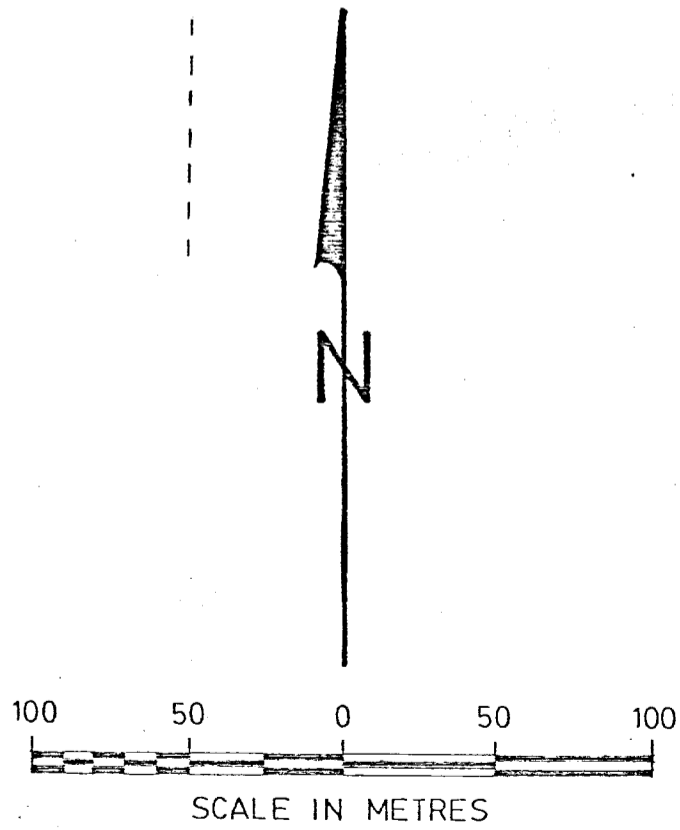

LEGEND

- Claim Post
- Claim Line
- Road
- Creek
- Sample Site

Assay Sample	
Nº	%Cu
Ag	Au
Width(m)	

Ag,Au in oz/ton

ROCK SAMPLE LOCATIONS & ASSAYS LUCKY JIM CLAIMS KLEANZA CREEK, OMINECA MINING DIV., B.C.	
SCALE 1:2,500	MAP NUMBER 7
SEPTEMBER 1980	SPQUIN B.Sc., AR.S.M.