

MARGIE CLAIM (752)

SOIL GEOCHEMICAL SURVEY

FOR

E. AMENDOLAGINE

IN THE

NEW WESTMINSTER MINING DIVISION

OF

BRITISH COLUMBIA

Latitude: 49°25'N

Longitude: 121°26'W

NTS 92H/6W

WORK PERIOD: September 23 to October 3, 1981

BY

E. AMENDOLAGINE, P. Eng.

March 1, 1982

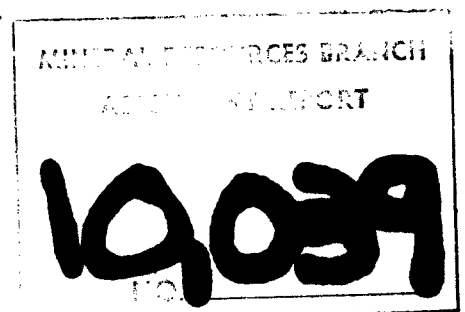

TABLE OF CONTENTS

	<u>PAGE</u>
PROPERTY	1
LOCATION	1
ACCESS	1
SURVEY PERFORMED	2
SOIL GEOCHEMISTRY	3
STATISTICAL ANALYSIS	4
DISCUSSION	5

APPENDICES

APPENDIX I	RECORD OF EXPENSES
APPENDIX II	GEOCHEMICAL ASSAY CERTIFICATES
APPENDIX III	GEOCHEMICAL SURVEYS

PROPERTY

The Margie Claims 752 (12) consisting of 12 units in the New Westminster Mining Division of British Columbia.

LOCATION

The claim is some 4 km by road north of Hope, British Columbia at 121°26'W Longitude, 49°25'N Latitude, on the west side of the Fraser River.

ACCESS

Access is some 4 km north on the Trans Canada Highway with the highway straddling the claim. The main showings are on the east side of the road.

SURVEY PERFORMED

A line grid and soil geochemistry surveys were conducted on the property during the period September 23rd to October 3rd, 1981. The survey was conducted by Manny Consultants Ltd. with the assistance of:

Maurice Amendolagine

Rob Ferraro

Dave Leskewycz

Pete Daviduk

The line grid was established on the property tied into the LCP in the southwest corner of the claim.

The grid consisted of compass and chain flagging lines.

The main baseline E-W starts on the west boundary of the claim 500 meters north of the L.C.P. The north-south lines are run off the baseline and are spaced 150 meters apart.

The soil geochemical survey used the line grid for control and samples were taken at 150 meter spacings along the lines and the baseline.

There were 91 soil samples taken on the property.

SOIL GEOCHEMISTRY

Soil sampling was performed on an established grid at 150 meter intervals. The samples were taken with a mattock in the "B" horizon where possible. They were placed in bags and marked for grid location.

The samples were assayed by Acme Analytical Laboratories in Vancouver, B.C. The assays were for Au, As, Ag, Cu, Mo, Pb, Zn, Ni and Co. The assay certificates follow after the statistical analyses. The assays are plotted on the plans and enclosed in the report following the statistical analysis.

The assay report and plotted assays are in Appendix 1 and 11, respectively.

The statistical analysis follows.

STATISTICAL ANALYSIS

<u>ELEMENT</u>	<u>ASSAY RANGE</u>		<u>NO. OF SAMPLES</u>
Gold	B.G.	0.005	84
	Threshold	.010	3
	Anomalous	.015-.120	4
Arsenic	B.G.	1-9	49
	Threshold	10-14	20
	Anomalous	15-43	22
Silver	B.G.	.1	70
	Threshold	.2	8
	Anomalous	.3-1.9	13
Lead	B.G.	0-19	75
	Threshold	20-29	7
	Anomalous	30-456	9
Zinc	B.G.	1-99	57
	Threshold	100-125	19
	Anomalous	126-191	15
Copper	B.G.	0-29	62
	Threshold	30-39	7
	Anomalous	40-327	22
Molybdenum	B.G.	0-1	72
	Threshold	2	10
	Anomalous	3-5	4
Nickel	B.G.	0-69	69
	Threshold	70-79	10
	Anomalous	80-367	12
Cobalt	B.G.	0-19	72
	Threshold	19-29	13
	Anomalous	30-52	6

DISCUSSION

Some high soil sample assays values were received in Mo, Cu, Pb, Zn, Ag, Ni, Co and Au.

The survey should be followed up with a closer detail soil sampling survey and possible geophysical surveys.

Respectfully submitted,

E. Amendolagine, P.Eng.

March 1, 1982

APPENDIX 1

RECORD OF EXPENSES

RECORD OF EXPENSES

LABOR

Rob Ferrero	23 Sept.-3 Oct/81 11 M/D @ \$100/day	\$ 1,100.00
Dave Leskewycz	23 Sept-3 Oct/81 11 M/D @ \$100/day	1,100.00
Pete Daviduk	23 Sept-3 Oct/81 11 M/D @ \$100/day	1,100.00
Maurice Amendolagine	23 Sept-3 Oct/81 11 M/D @ \$150/day	<u>1,650.00</u> \$ 4,950.00

ASSAYS		741.65
ROOM AND BOARD- 44 M/D @ \$55/day		2,420.00
4 x 4 GAS TRAVEL		605.00
REPORT TYPING, DRAFT, PRINTS		<u>1,500.00</u>
		<u>\$10,216.65</u>

APPENDIX 11

GEOCHEMICAL ASSAY CERTIFICATES



To: Manny Consultants Ltd.,
4550 Harriet St.,
Vancouver, B.C.
V5V 4K5

File No. 81-1722

Type of Samples Soils

GEOCHEMICAL ASSAY CERTIFICATE

Disposition _____

Project : Margie

1

SAMPLE No.	Mo	Cu	Pb	Zn	Ag	Ni	Co	Mn	Fe%	As	Au	
BL 1+50 E	1	24	17	58	.1	100	16	860	2.1	6	.005	1
3	1	16	2	113	.1	71	14	970	2.5	9	.005	2
4+50	1	24	2	40	.1	59	11	228	1.5	20	.005	3
6	1	19	2	126	.4	76	18	412	2.8	6	.005	4
7+50	1	23	5	140	.2	65	14	642	2.6	11	.005	5
9	1	14	6	92	.1	48	13	766	2.3	2	.005	6
10+50	1	32	4	126	.1	51	20	1190	2.8	6	.005	7
12	1	23	4	92	.1	74	19	474	3.1	16	.005	8
13+50	1	25	17	116	.1	83	14	1099	2.3	10	.005	9
BL 15 E	1	49	2	105	.2	367	27	378	3.0	10	.005	10
												11
1+50E 1+50 S	1	23	2	60	.2	223	27	621	3.1	8	.005	12
3	1	18	13	103	.1	73	22	4157	3.0	6	.005	13
1+50E 4+60 S	1	29	2	102	.2	114	21	923	3.1	5	.005	14
												15
1+50E 1+50 N	1	15	6	101	.1	41	16	2492	2.3	6	.005	16
3	1	61	2	51	.1	47	15	192	2.2	13	.005	17
1+50E 4+50 N	2	230	456	151	.1	86	15	358	2.2	8	.005	18
												19
3 E 1+50 S	1	27	28	106	.2	26	33	1688	2.5	20	.005	20
3	1	21	8	73	.1	57	14	917	2.4	13	.120	21
3 E 4+50 S	1	18	11	59	.1	56	13	562	2.3	15	.005	22
												23
3 E 1+50 N	1	14	8	87	.1	36	10	652	2.0	6	.005	24
3	1	35	8	78	.1	45	15	440	2.5	8	.005	25
3 E 4+25 N	1	146	117	92	.1	73	18	280	2.5	11	.005	26
												27
4+50E 1+50 S	1	28	9	113	.3	61	17	961	2.7	16	.005	28
3	1	22	7	68	.2	62	16	619	2.5	15	.005	29
4+50E 4+50 S	1	11	6	57	.1	50	13	328	2.3	7	.005	30
												31
4+50E 1+50 N	1	44	2	84	.1	47	15	381	2.9	20	.005	32
3	1	35	4	81	.2	55	17	388	2.8	12	.005	33
4+50E 4+50 N	1	13	25	88	.1	17	8	571	1.7	7	.005	34
												35
6 E 1+50 S	1	20	8	103	.1	73	18	1041	2.8	18	.005	36
3	1	17	9	186	.1	56	16	1839	2.4	21	.005	37
6 E 4+50 S	1	37	8	124	.1	56	26	1525	3.4	26	.015	38
												39
												40

All reports are the confidential property of clients
All results are in PPM.

DIGESTION:.....

DETERMINATION:.....

DATE SAMPLES RECEIVED Oct. 29, 1981

DATE REPORTS MAILED Nov. 12, 1981

ASSAYER Dean Toy

DEAN TOYE, B.Sc.
CHIEF CHEMIST
CERTIFIED B.C. ASSAYER



To: Manny Consultants Ltd.,

File No. 81-1722

Type of Samples _____

GEOCHEMICAL ASSAY CERTIFICATE

Disposition _____

SAMPLE No.	Mo	Cu	Pb	Zn	Ag	Ni	Co	Mn	Fe%	As	Au	
6 E 1+50 N	1	21	12	78	.1	44	15	929	2.5	10	.005	1
3	1	15	9	104	.1	44	14	735	2.5	7	.005	2
6 E 4+50 N	2	54	21	151	.5	52	18	345	3.3	23	.005	3
7+50 E 1+50 S	1	24	14	126	.1	115	25	3171	3.4	43	.005	4
3	1	24	11	87	.1	62	16	439	2.7	13	.005	5
7+50 E 4+50 S	2	53	10	91	.4	65	25	295	3.0	31	.005	6
7+50 E 1+50 N	1	13	15	82	.1	63	14	754	2.4	5	.005	7
3	1	17	10	57	.1	43	12	269	2.4	7	.005	8
7+50 E 4+50 N	1	18	20	64	.1	35	11	711	2.2	8	.005	9
9 E 1+50 S	1	49	13	92	.1	64	24	802	3.5	15	.005	10
3	1	24	9	73	.1	52	18	541	2.9	9	.005	11
9 E 4+50 S	1	23	11	122	.1	52	16	564	2.6	16	.005	12
9 E 1+50 N	1	14	10	130	.1	40	12	1220	2.3	7	.005	13
3	1	13	5	49	.1	34	10	1008	2.0	9	.005	14
4+50	1	19	11	58	.1	41	11	403	2.2	5	.005	15
6	1	15	11	55	.1	39	12	537	2.2	4	.005	16
9 E 7+50 N	1	30	15	69	.1	46	15	468	2.7	10	.005	17
10+50 E 1+50 S	2	20	9	66	.1	63	15	313	2.8	12	.005	18
3	1	45	8	70	.1	70	17	238	2.6	12	.005	19
10+50 E 4+50 S	1	22	15	59	.1	52	15	576	2.7	10	.005	20
10+50 E 1+50 N	1	17	10	85	.1	36	12	946	2.1	8	.005	21
3	1	12	10	128	.1	32	10	1787	2.1	5	.005	22
4+50	1	20	9	61	.1	46	12	435	2.3	3	.005	23
6	1	18	8	68	.1	45	13	596	2.4	6	.005	24
7+50	1	15	16	80	.1	32	10	680	2.1	3	.005	25
10+50	1	22	7	86	.1	51	14	484	2.6	4	.005	26
12	4	176	70	185	.5	231	50	1221	5.2	40	.005	27
13+50	1	14	10	83	.1	51	12	498	2.2	5	.005	28
10+50 E 15 N	1	31	6	69	.1	67	12	181	3.0	20	.005	29
12 E 1+50 N	1	27	11	61	.1	53	16	360	2.8	7	.005	30
3	1	11	9	92	.1	34	14	600	2.6	6	.005	31
12 E 4+50 N	1	16	6	93	.1	39	13	754	2.4	11	.005	32

All reports are the confidential property of clients
All results are in PPM.

DIGESTION:.....

DETERMINATION:.....

DATE SAMPLES RECEIVED Oct. 29, 1981

DATE REPORTS MAILED Nov. 12, 1981

ASSAYER

Dean Toyé

DEAN TOYE, B.Sc.
CHIEF CHEMIST
CERTIFIED B.C. ASSAYER



To: Manny Consultants Ltd.,

File No. 81-1722

Type of Samples

Disposition

GEOCHEMICAL ASSAY CERTIFICATE

3

SAMPLE No.	Mo	Cu	Pb	Zn	Ag	Ni	Co	Mn	Fe%	As	Au	
12E 6 N	1	18	9	76	.1	42	13	760	2.4	13	.005	1
7+50	1	26	14	85	.1	46	13	594	2.3	13	.005	2
10+50	1	21	12	92	.1	46	13	835	2.4	10	.005	3
12	1	162	35	187	.4	183	50	991	5.4	27	.005	4
13+50	1	19	17	108	.1	47	16	499	2.5	5	.010	5
12E 15 N	1	26	7	69	.1	48	15	626	2.7	9	.010	6
13+50E 1+50 S	5	327	21	127	.4	262	34	535	3.1	30	.005	8
3	1	108	27	188	1.4	69	15	461	2.4	6	.010	9
13+50E 4+50 S	1	15	14	103	.1	39	13	968	2.3	7	.020	10
13+50E 1+50 N	1	13	7	60	.1	48	12	255	2.4	8	.005	12
3	2	29	26	115	.1	43	13	605	2.2	25	.005	13
4+50	4	85	15	72	.4	78	15	232	2.5	15	.005	14
6	2	25	10	87	.1	200	28	386	2.7	34	.005	15
7+50	1	19	8	91	.1	49	13	479	2.7	6	.005	16
9	1	21	13	80	.1	49	8	125	1.8	4	.005	17
13+50	1	63	59	98	.1	44	22	1269	2.8	8	.005	18
13+50E15 N	2	94	39	109	.1	79	30	518	3.5	14	.005	19
15E 1+50 N	1	129	41	191	.4	58	31	792	3.1	10	.005	21
1+50 A	1	92	14	93	.2	57	20	319	2.8	6	.005	22
3	1	69	17	126	1.0	60	15	370	2.5	2	.005	23
15E 4+50 N	2	11	8	38	.1	31	8	114	2.4	8	.005	24
15E 1+50 N	2	67	9	94	.1	124	24	261	3.0	12	.005	26
3+50	1	14	14	216	.4	29	10	192	2.1	5	.015	27
4+50	3	71	95	176	1.9	41	14	381	2.6	7	.005	28
6	2	22	8	78	.1	71	14	496	2.5	9	.005	29
7+50	1	19	9	80	.1	42	14	695	2.6	8	.005	30
9	1	40	7	74	.1	54	16	286	2.7	9	.005	31
15E 15 N	1	35	30	101	.1	59	15	398	2.6	3	.005	32
												33
												34
												35
												36
												37
												38
												39
												40

All reports are the confidential property of clients
All results are in PPM.

DIGESTION:.....

DETERMINATION:.....

DATE SAMPLES RECEIVED Oct. 29, 1981

DATE REPORTS MAILED Nov. 12, 1981

ASSAYER

DEAN TOYE, B.Sc.
CHIEF CHEMIST
CERTIFIED B.C. ASSAYER

APPENDIX 111

GEOCHEMICAL SURVEYS

MARGIE CLAIM

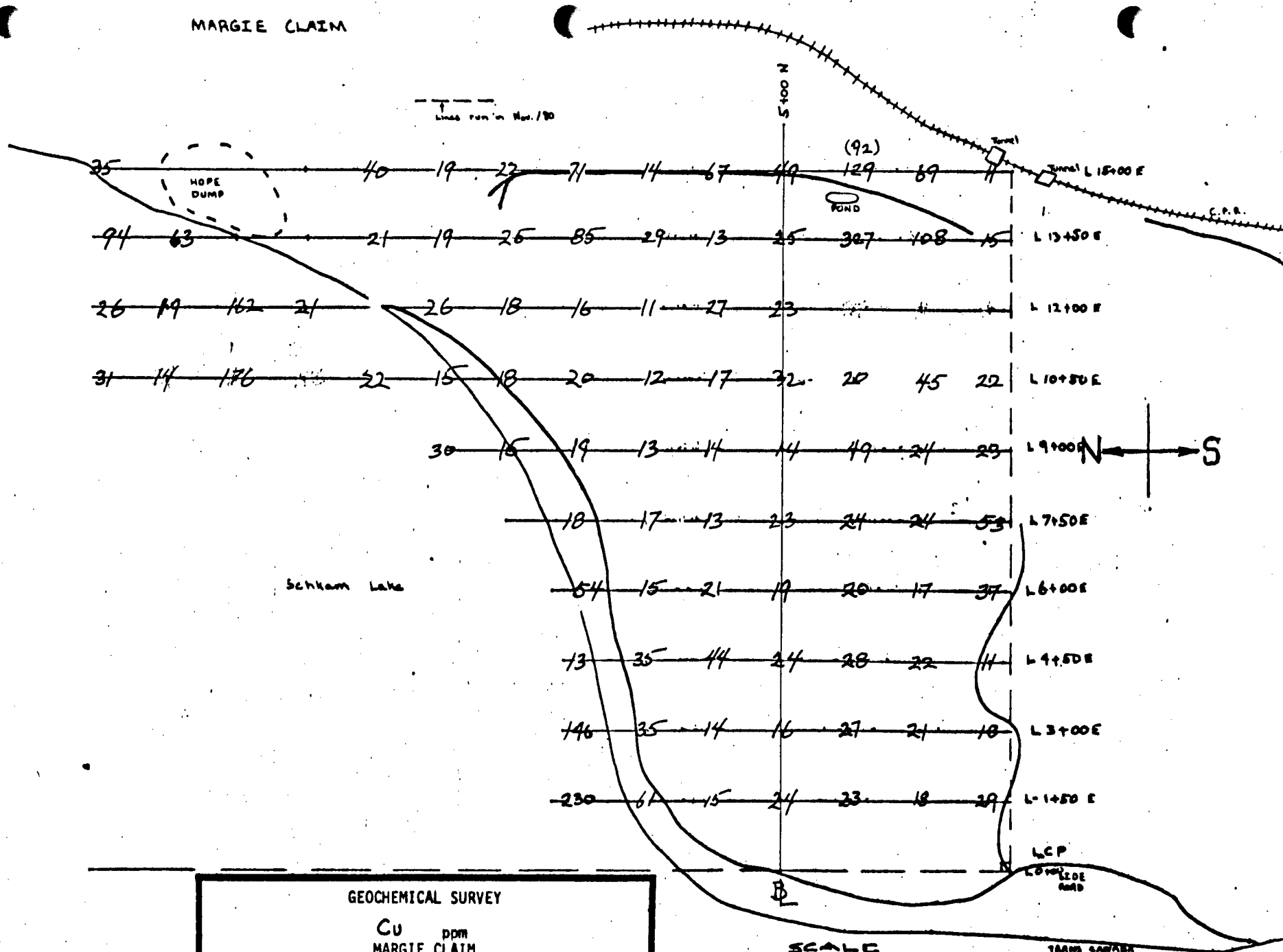

GEOCHEMICAL SURVEY

Cu ppm

MARGIE CLAIM

E. AMENDOLAGINE

NEW WESTMINSTER MINING DIVISION

NTS 92H/6W

49°25'N Latitude 121°26'W Longitude

MARGIE CLAIM

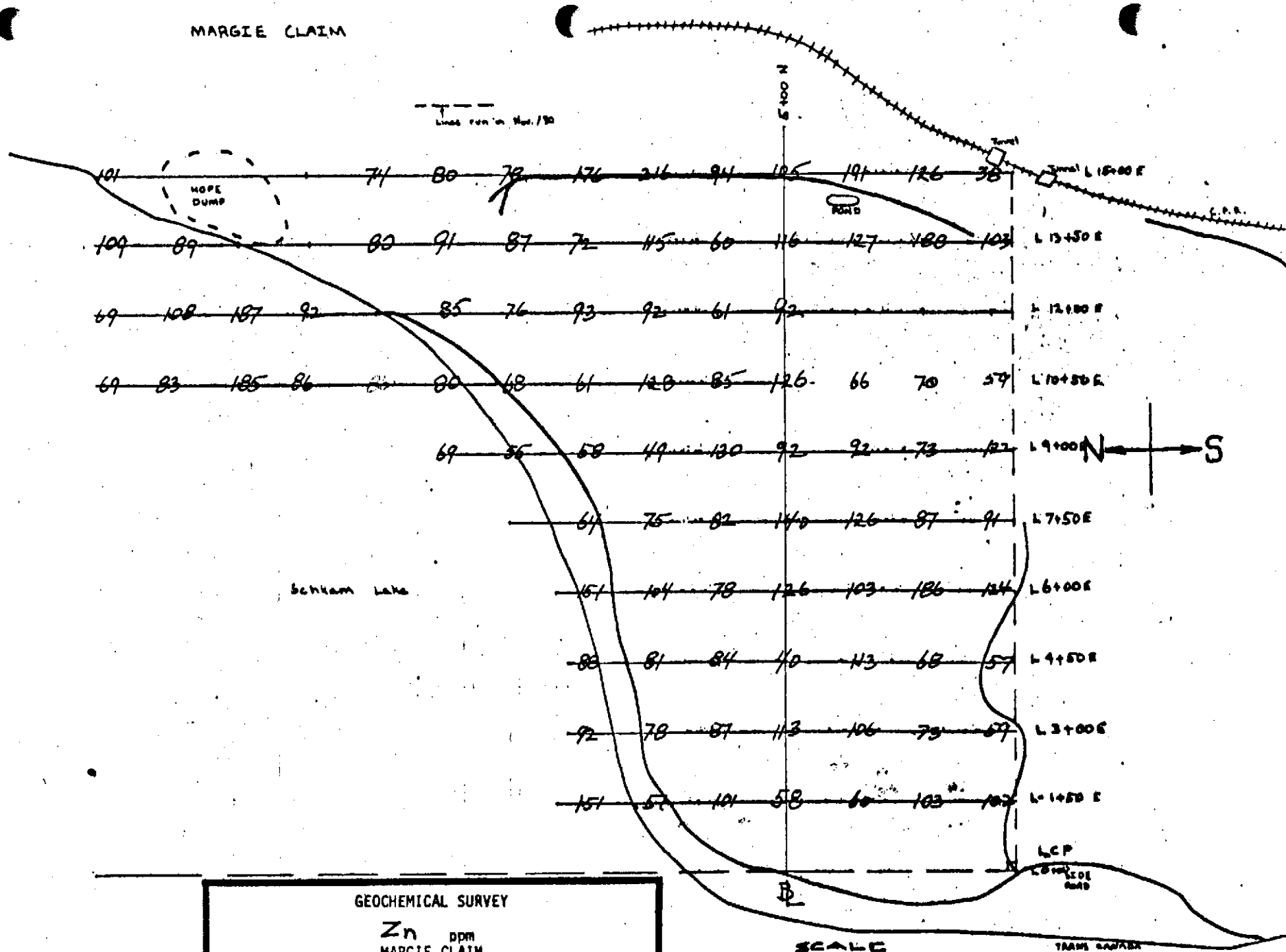

GEOCHEMICAL SURVEY

Zn DPM

MARGIE CLAIM

E. AMENDOLAGINE

NEW WESTMINSTER MINING DIVISION

NTS 92H/6W

49°25'N Latitude 121°26'W Longitude

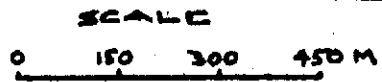

MARGIE CLAIM

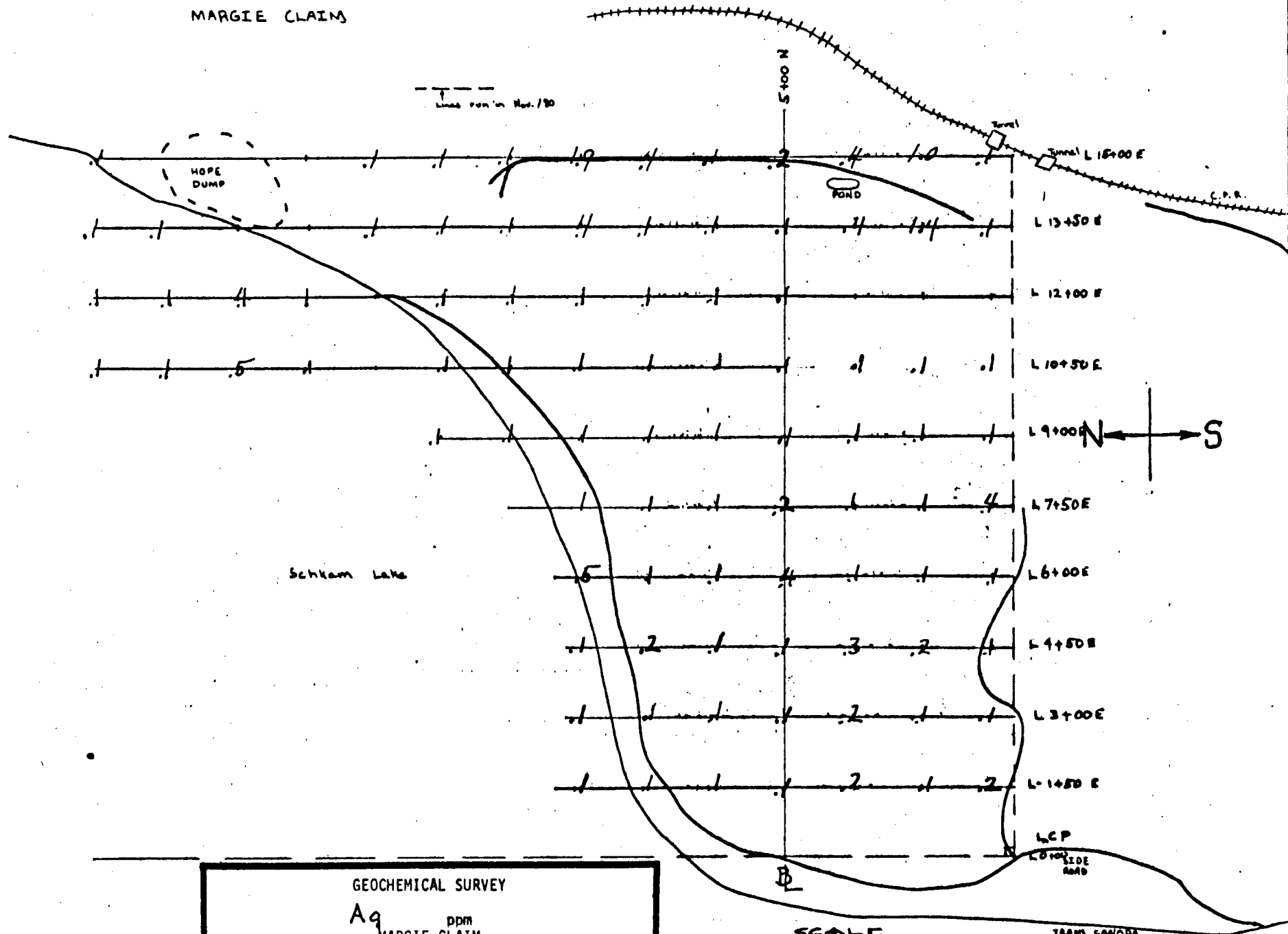

GEOCHEMICAL SURVEY
 Ag DPM
 MARGIE CLAIM
 E. AMENDOLAGINE
 NEW WESTMINSTER MINING DIVISION
 NTS 92H/6W
 49°25'N Latitude 121°26'W Longitude

SCALE
 0 150 300 450 M
 TRAMS CANADA

MARGIE CLAIM

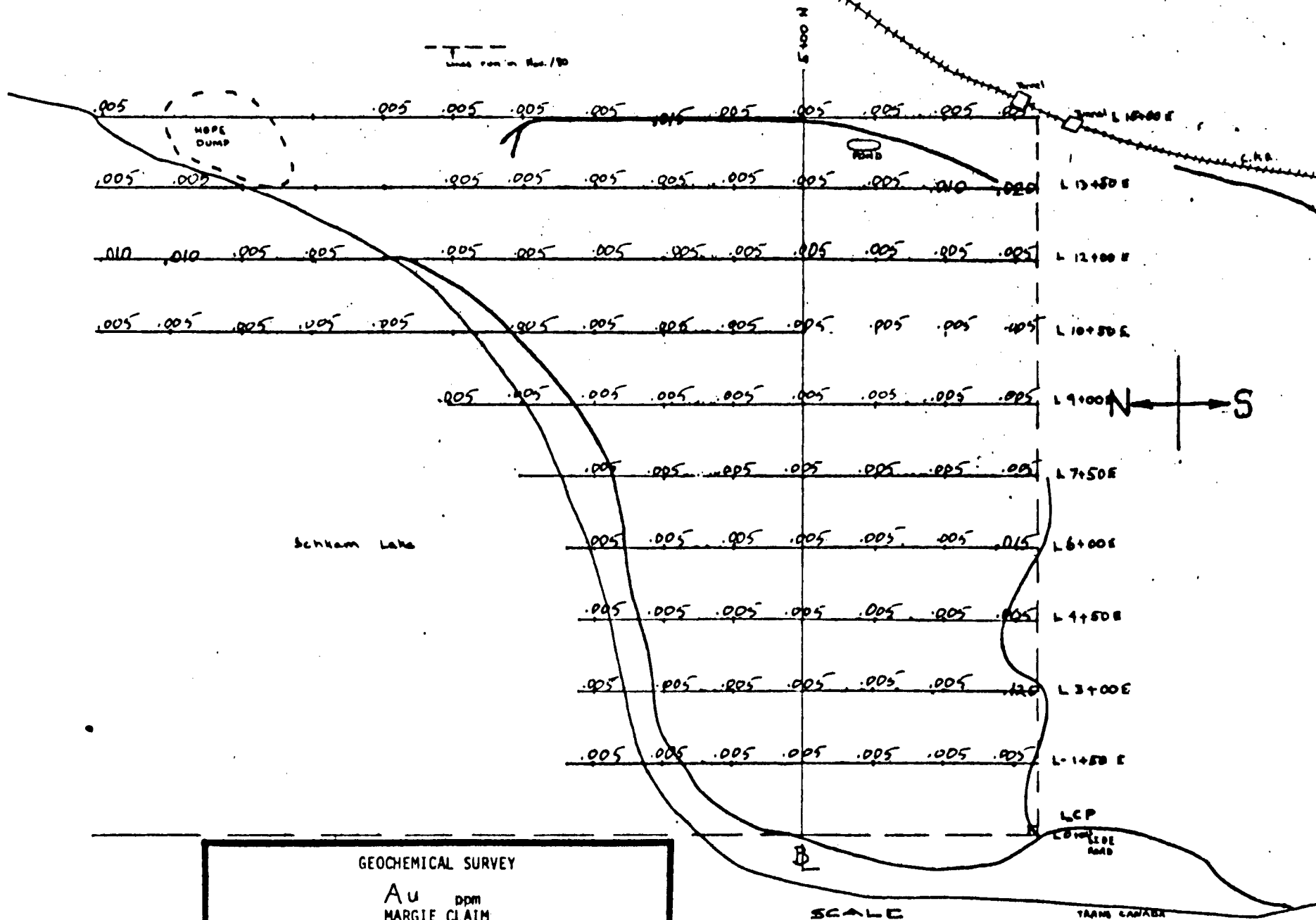

GEOCHEMICAL SURVEY

Au ppm

MARGIE CLAIM

E. AMENDOLAGINE

NEW WESTMINSTER MINING DIVISION

NTS 92H/6W

49°25' N Latitude 121°26' W Longitude

MARGIE CLAIM

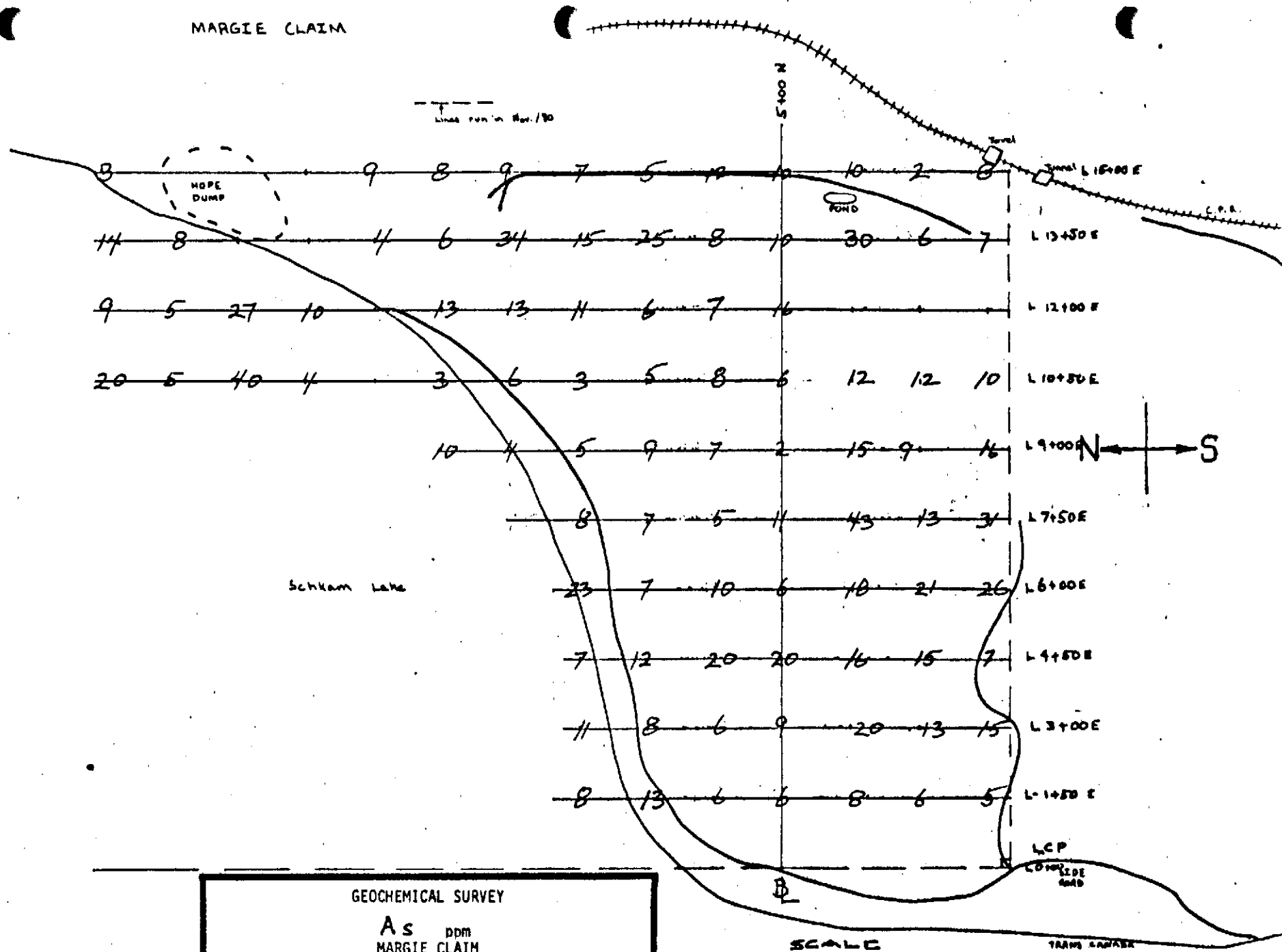

GEOCHEMICAL SURVEY

As ppm
MARGIE CLAIM
E. AMENDOLAGINE
NEW WESTMINSTER MINING DIVISION
NTS 92H/6W

49°25'N Latitude 121°26'W Longitude

MARGIE CLAIM

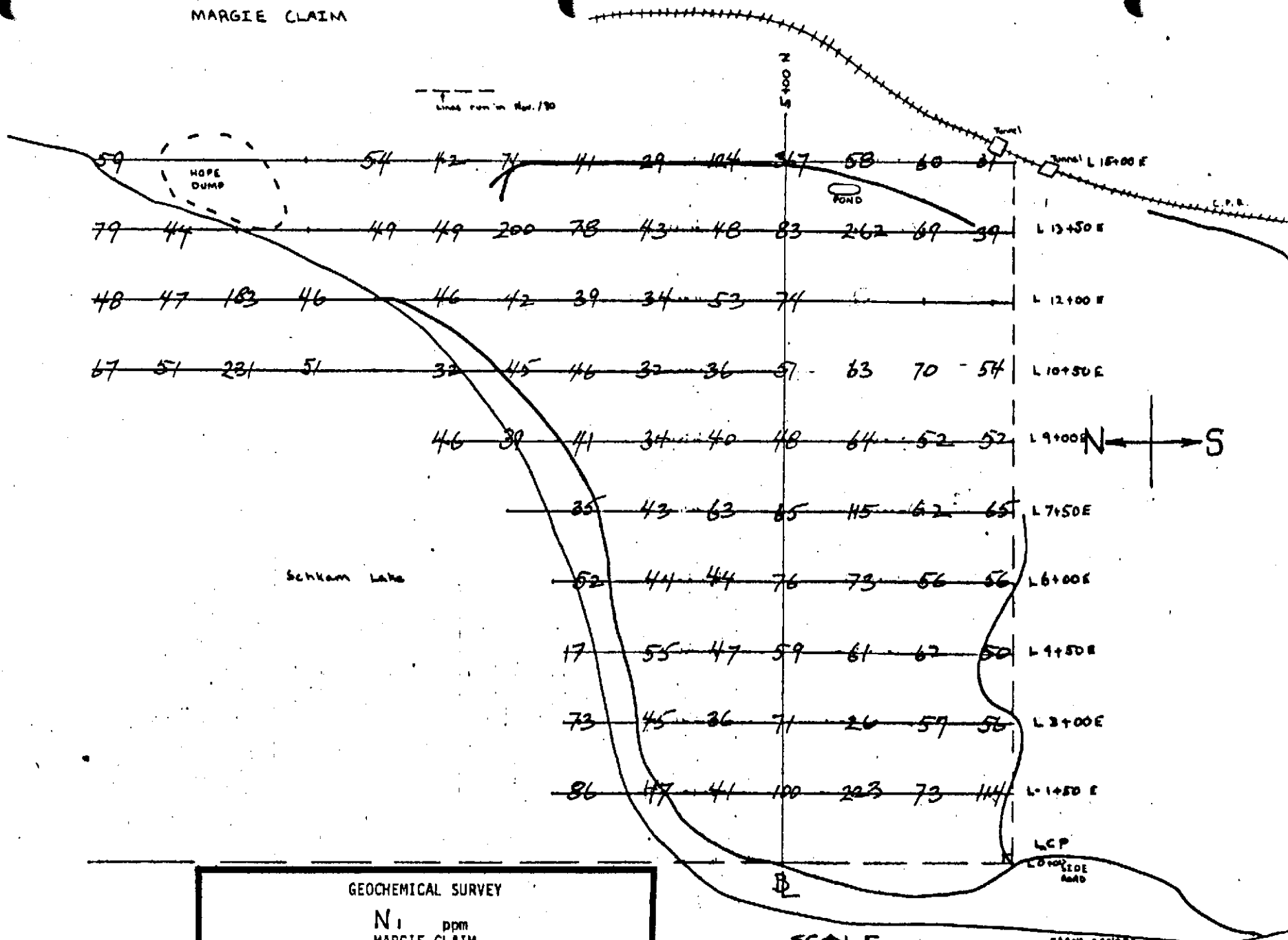

GEOCHEMICAL SURVEY

N₁ ppm

MARGIE CLAIM

E. AMENDOLAGINE

NEW WESTMINSTER MINING DIVISION

NTS 92H/6W

49°25'N Latitude 121°26'W Longitude

MARGIE CLAIM

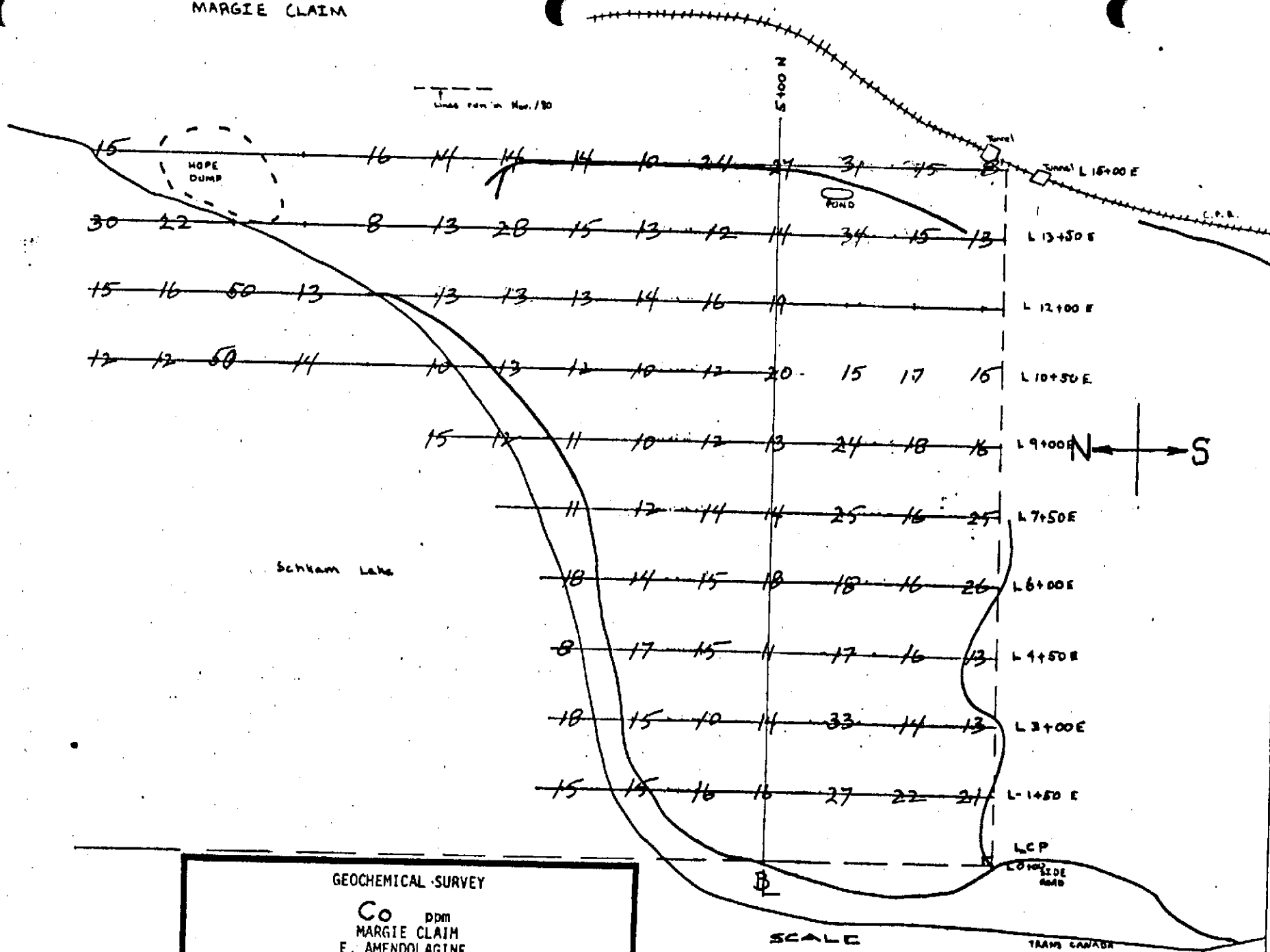

GEOCHEMICAL SURVEY

Co DPM
MARGIE CLAIM
E. AMENDOLAGINE
NEW WESTMINSTER MINING DIVISION
NTS 92H/6W

49°25'N Latitude 121°26'W Longitude

MARGIE CLAIM

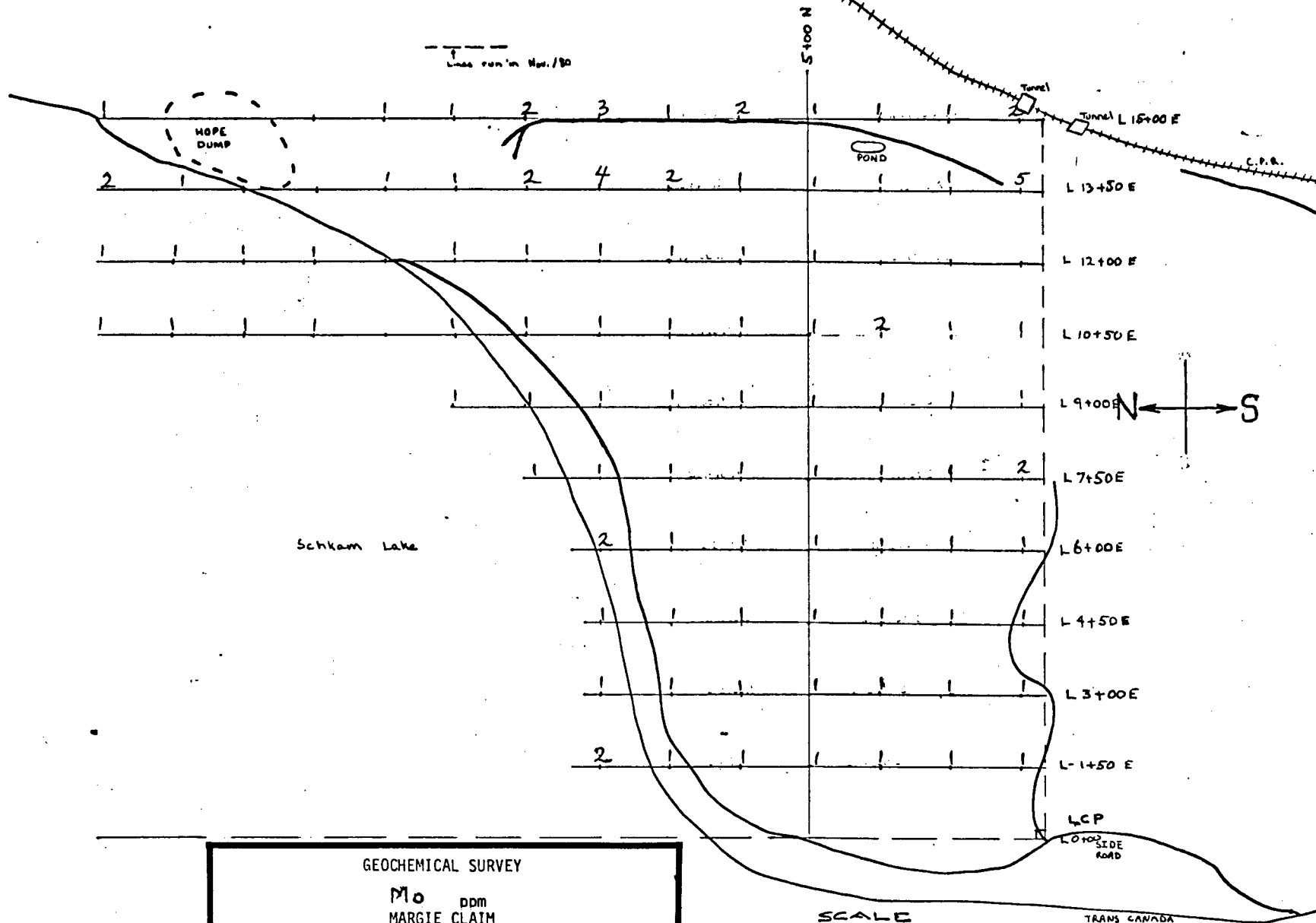

GEOCHEMICAL SURVEY

Mo ppm
MARGIE CLAIM
E. AMENDOLAGINE
NEW WESTMINSTER MINING DIVISION
NTS 92H/6W

49°25'N Latitude 121°26'W Longitude