

NORTHAIR MINES LTD.
Induced Polarization Test
Thanksgiving Property
Revelstoke, B.C.
N.T.S. 82 M/1

AUTHOR: Glen E. White, B.Sc., P.Eng.,
Geophysicist

DATE OF WORK: June 17-19/81

DATE OF REPORT: June 30/81

81-1243-10041

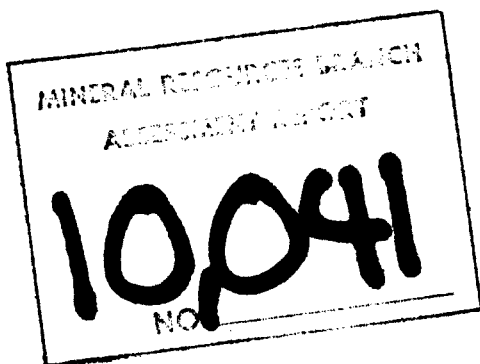

part 3 of 6



NORTHAIR MINES LTD.
 THANKSGIVING PROPERTY
 LOCATION MAP

Glen C. White
 geographical consulting
 of
 Vancouver, B.C.

INTRODUCTION

At the request of Northair Mines Ltd. C. Candy geophysicist for Glen E. White Geophysical Consulting & Services Ltd. conducted a short test induced polarization survey over the Thanksgiving property assisted by Northair personnel. The survey consisted of four test lines over an area containing high grade scheelite mineralization to see if the induced polarization method could be of any exploration assistance. The equipment used was a Huntec Lopo time domain transmitter and Mark III receiver deployed in the dipole array with an "a" spacing of 50 m, n=1

DISCUSSION OF RESULTS

Figure 2 shows the general location of Highway 23 with respect to the showings. Figure 3 depicts a plan view of the chargeability. A very strong zone was detected which trends northwest across the survey area. Values of 40 to 55 milliseconds were obtained. Background is some 3 milliseconds. The apparent resistivity data, Figure 4 shows a pronounced northwest-southeast low trend which coincides with the chargeability high. This zone is likely caused by a graphitic/argillaceous horizon. High resistivity values were detected to the south. These can be caused by unaltered limestones, volcanics or intrusive rocks. Figure 7 also shows high resistivity values on the larger separation of n=1 a=100 m. Figures 5 to 8 show the chargeability and resistivity data in profile format. The scheelite showings appear to be associated with the chargeability high trend. It should try to be determined if this is a

coincidence or a genetic relationship since the induced polarization method is very definitive with regards to the graphitic/argillaceous horizon.

Yours truly

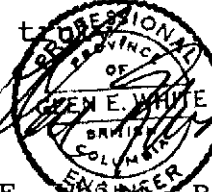
Glen E. White, B.Sc., P.Eng.,
Geophysicist

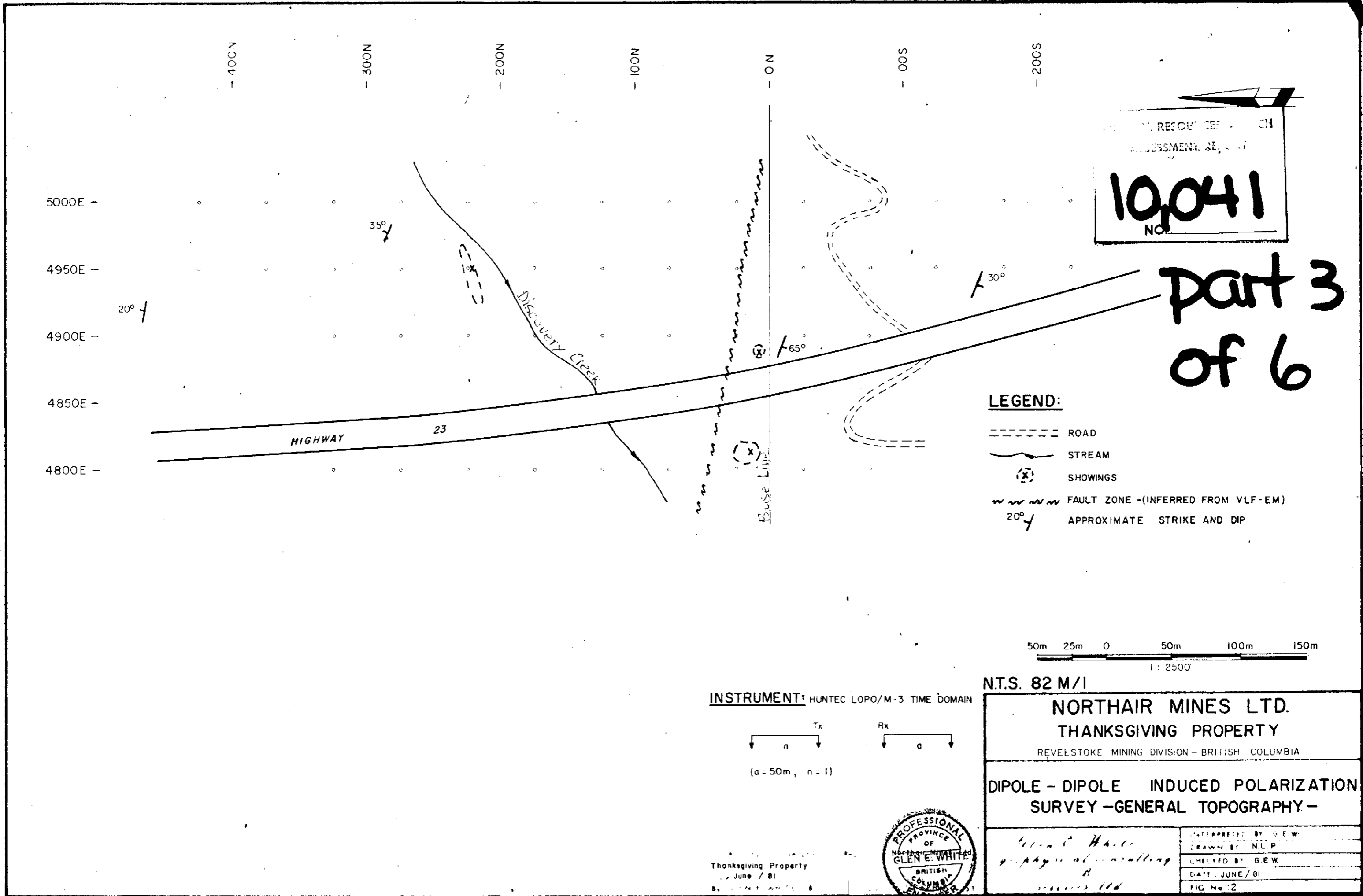

RESOURCE
ASSESSMENT
10,041
NO.

part 3
of 6

LEGEND:

- ROAD
- ~~~~~ STREAM
- (x) SHOWINGS
- ~~~~~(x) FAULT ZONE -(INFERRED FROM VLF-EM)
- 20° APPROXIMATE STRIKE AND DIP

50m 25m 0 50m 100m 150m
1:2500

INSTRUMENT: HUNTEC LOPO/M-3 TIME DOMAIN

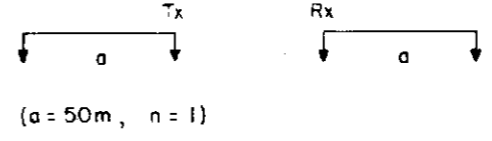

N.T.S. 82 M/1

NORTH AIR MINES LTD.
THANKSGIVING PROPERTY
 REVELSTOKE MINING DIVISION - BRITISH COLUMBIA

DIPOLE - DIPOLE INDUCED POLARIZATION SURVEY - GENERAL TOPOGRAPHY -

<i>Glen E. White</i> geophysical consulting Revelstoke B.C.	INTERPRETED BY: G.E.W.
	DRAWN BY: N.L.P.
	CHECKED BY: G.E.W.
	DATE: JUNE / 81
FIG No 12	



Thanksgiving Property
June / 81

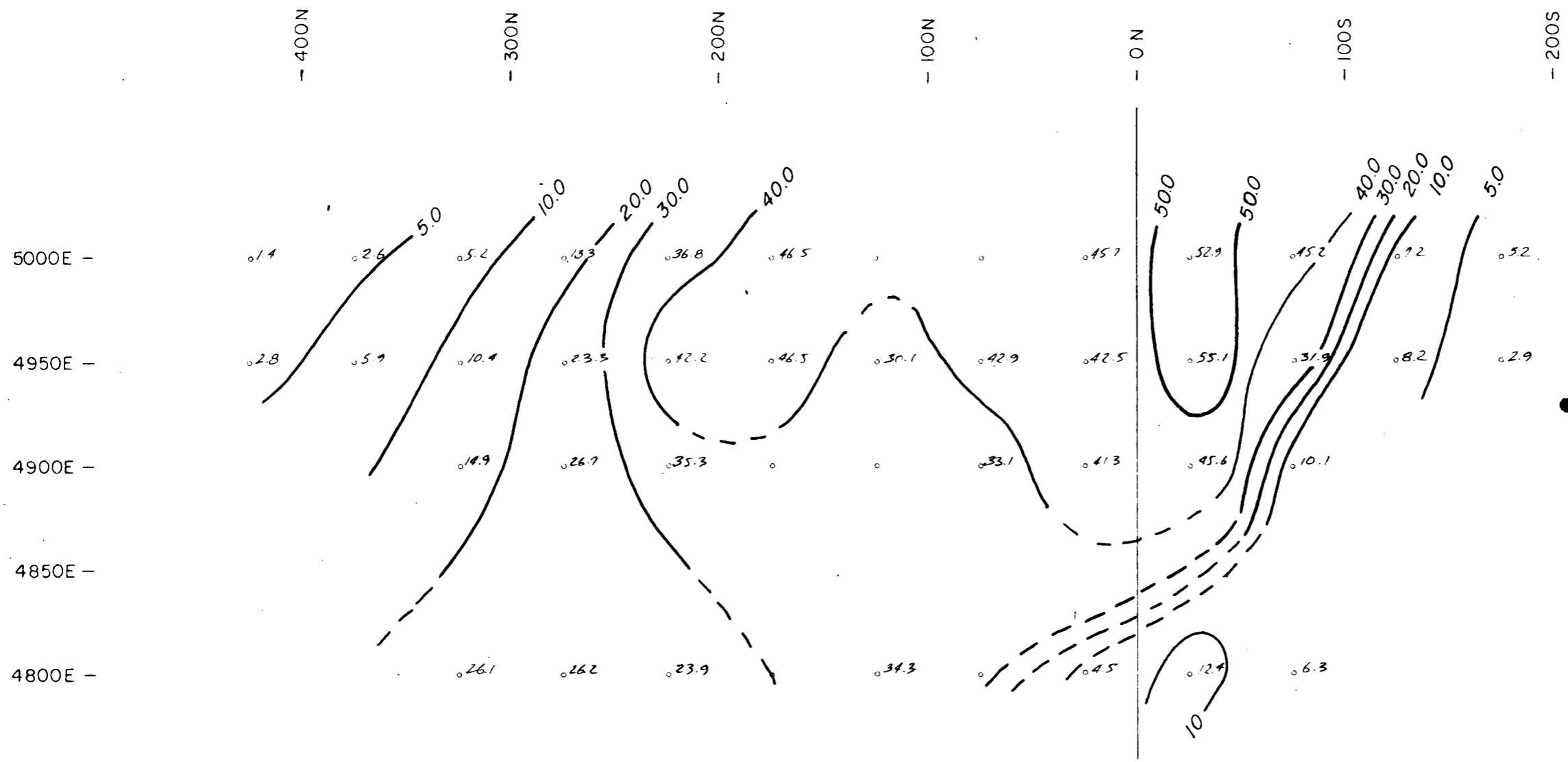

MINERAL BRANCH
ASSESSMENT REPORT
10041
No.

part 3 of 6
CHARGEABILITY KEY

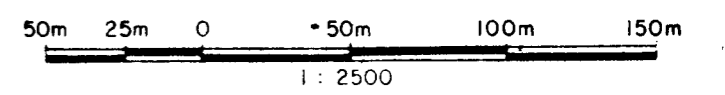
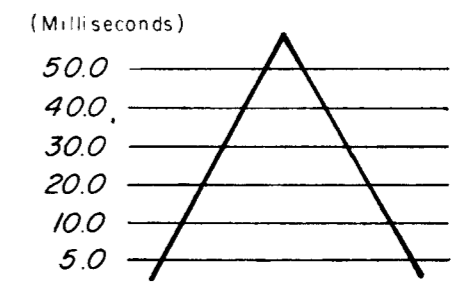

INSTRUMENT: HUNTEC LOPO/M-3 TIME DOMAIN

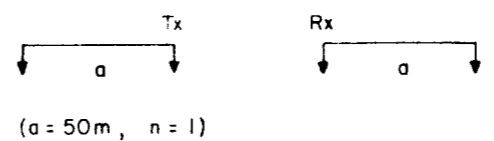

N.T.S. 82 M/1

NORTH AIR MINES LTD.
THANKSGIVING PROPERTY
REVELSTOKE MINING DIVISION - BRITISH COLUMBIA

DIPOLE - DIPOLE INDUCED POLARIZATION SURVEY - CHARGEABILITY -

INTERPRETED BY: G.E.W.
DRAWN BY: N.L.P.
CHECKED BY: G.E.W.
DATE: JUNE / 81
FIG No: 3

Thanksgiving Property
June / 81
GLEN E. WHITE

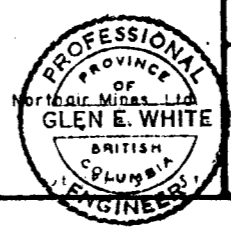

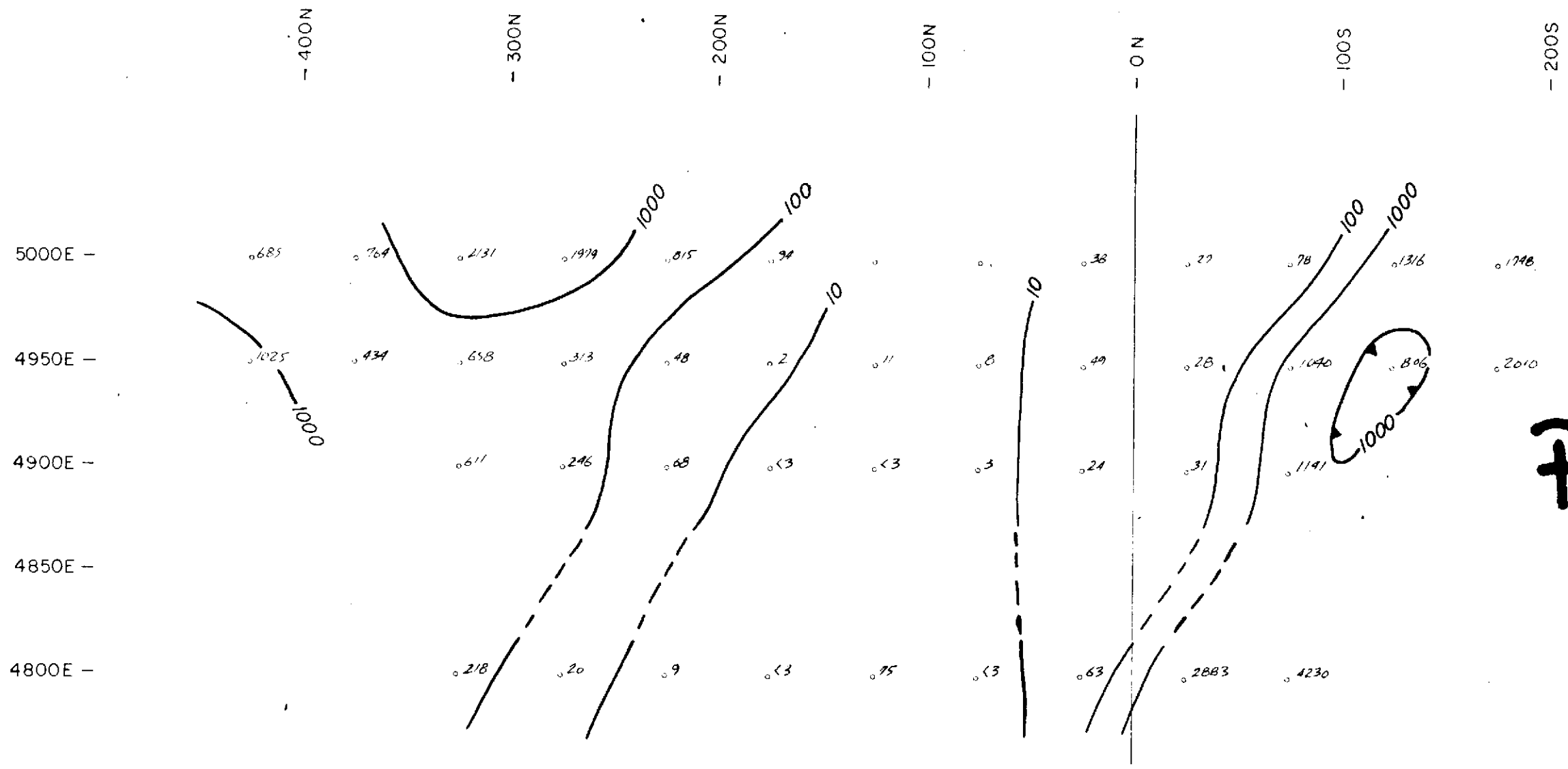

MINERAL RESC. BRANCH
ASSESSMENT DIST.
10,041
NO.

part 3 of 6
RESISTIVITY KEY

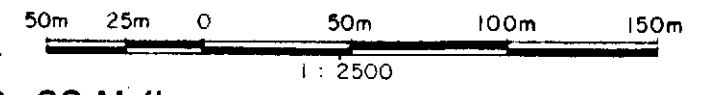
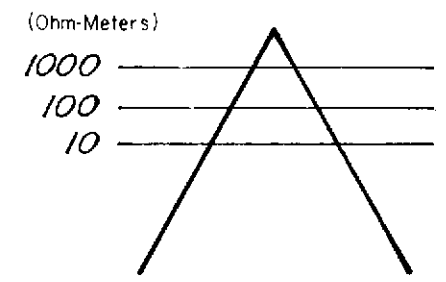

INSTRUMENT: HUNTEC LOPO/M-3 TIME DOMAIN

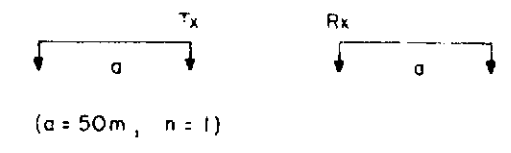

Thanksgiving Property
June / 81
By: [Signature]

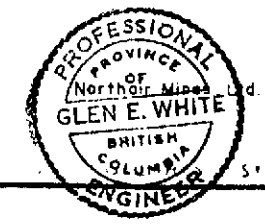

N.T.S. 82 M/I

NORTH AIR MINES LTD.
THANKSGIVING PROPERTY
REVELSTOKE MINING DIVISION - BRITISH COLUMBIA

DIPOLE - DIPOLE INDUCED POLARIZATION SURVEY - APPARENT RESISTIVITY -

<i>Glen E. White</i> Geophysical Consulting	INTERPRETED BY: G.E.W.
	DRAWN BY: N.L.P.
	CHECKED BY: G.E.W.
	DATE: JUNE / 81
	FIG No: 4

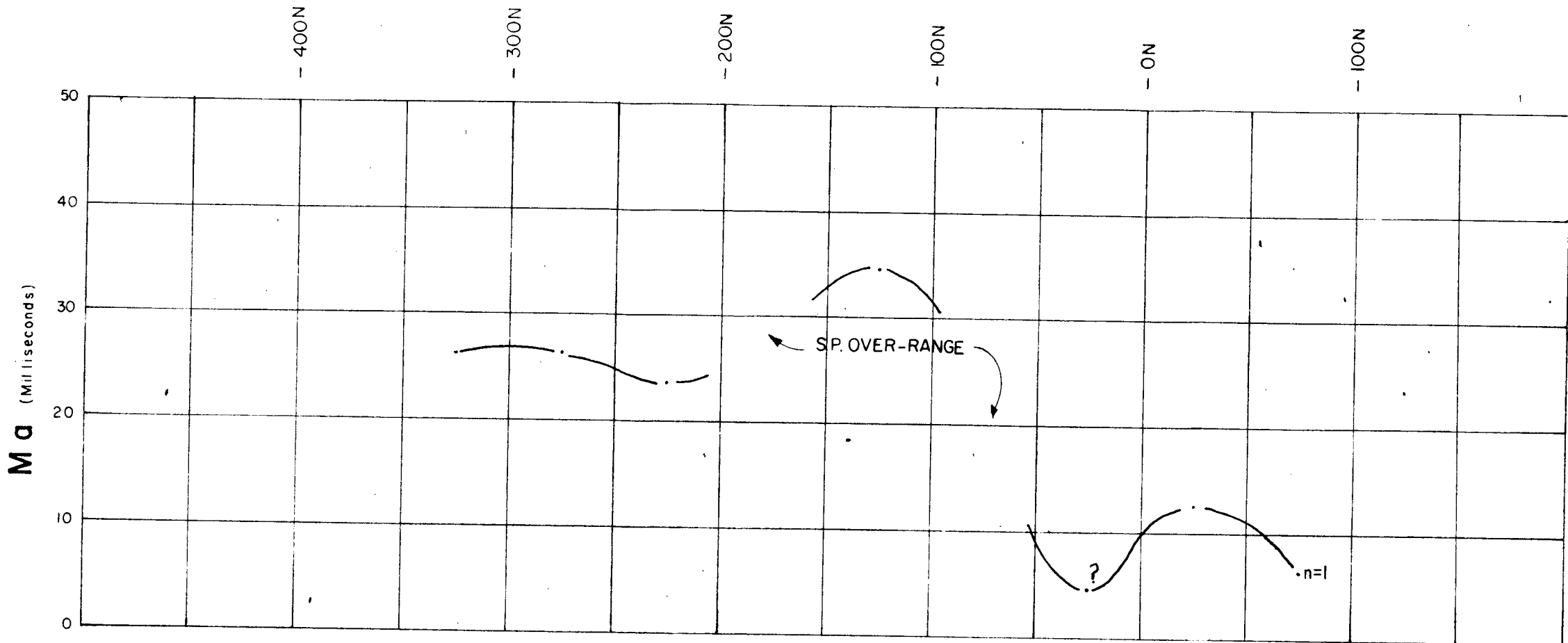

MINERAL RESOURCE
ASSESSMENT REPORT
10,041
NO.

**part 3
of 6**

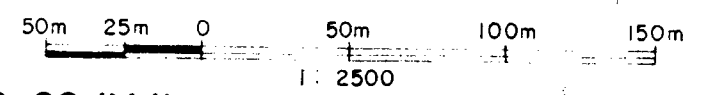

INSTRUMENT: HUNTEC LOPO/M-3 TIME DOMAIN

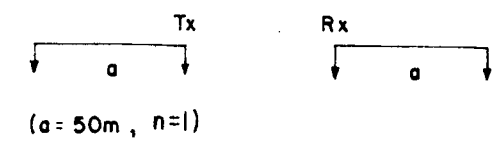

N.T.S. 82/M/1

NORTH AIR MINES LTD.
THANKSGIVING PROPERTY
 REVELSTOKE MINING DIVISION - BRITISH COLUMBIA

INDUCED POLARIZATION PROFILE
 — LINE 4800E —

Glen & White
geophysical consulting
services Ltd.

INTERPRETED BY: G.E.W.
DRAWN BY: N.L.P.
CHECKED BY: G.E.W.
DATE: AUG 1979
FIG No: 5

Thanksgiving Property
 Core June / Bl
 By GLEN & WHITE
 ENGINEER



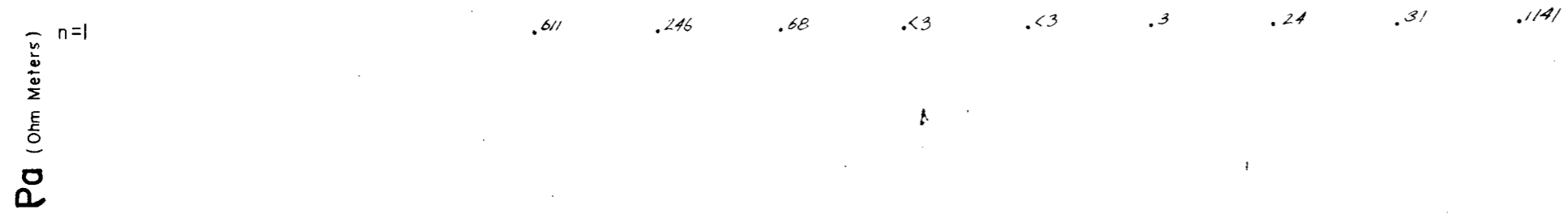
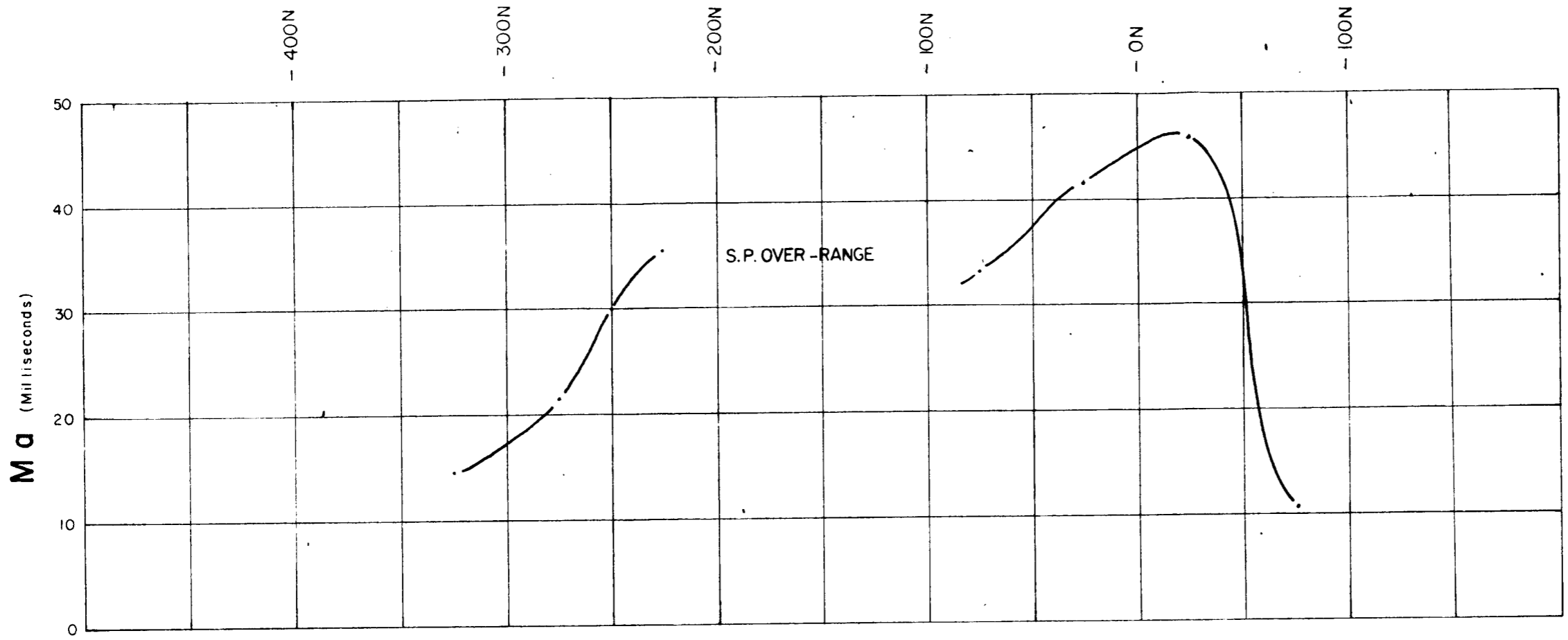

MINERAL RESEARCH BRANCH
ASSESSMENT UNIT
10041
NO.

**part 3
of 6**

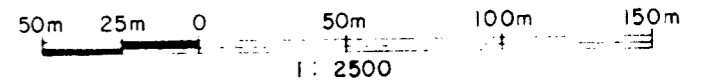

INSTRUMENT: HUNTEC LOPO/M-3 TIME DOMAIN

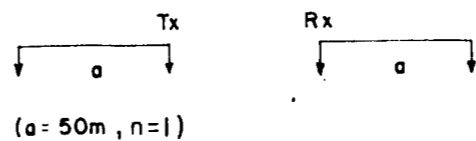

N.T.S. 82/M/1

NORTHAIR MINES LTD.
THANKSGIVING PROPERTY
 REVELSTOKE MINING DIVISION - BRITISH COLUMBIA

INDUCED POLARIZATION PROFILE
- LINE 4900E -

INTERPRETED BY: G.E.W.
DRAWN BY: N.L.P.
CHECKED BY: G.E.W.
DATE: AUG 1979
FIG No: 6

Glen E. White
geophysical consulting
services ltd

Thanksgiving Property
June / 81
By: GLEN E. WHITE B.Sc. Geophysicist

PROFESSIONAL
 PROVINCE OF
GLEN E. WHITE
 BRITISH COLUMBIA
 ENGINEER

MINERAL RESOURCE BRANCH
ASSESSMENT REPORT
10,041
No.

**Part 3
of 6**

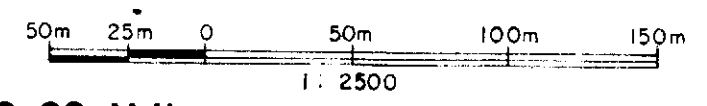
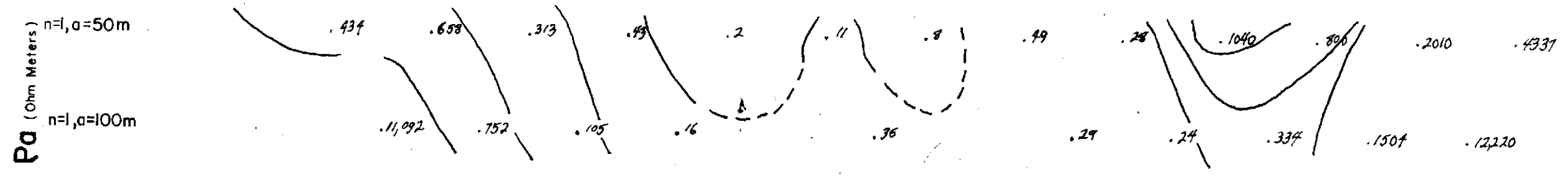
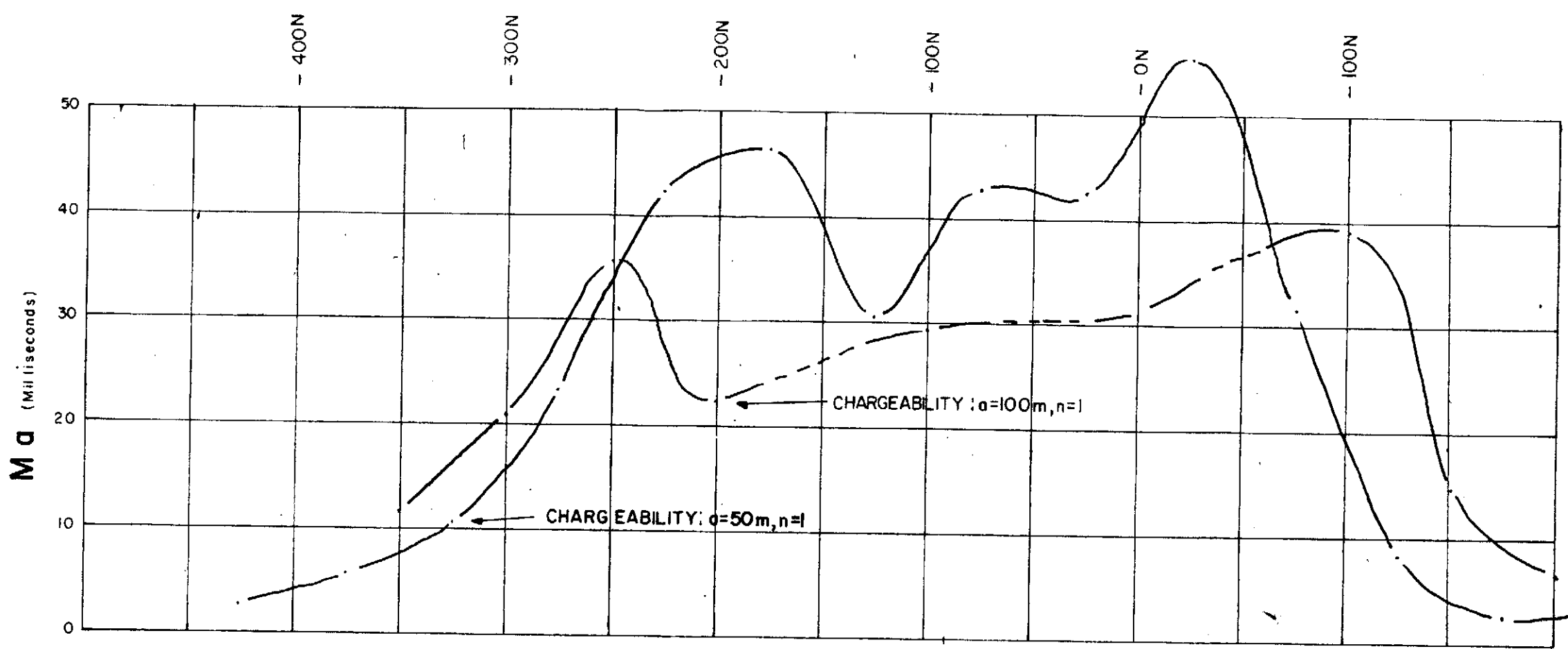

INSTRUMENT: HUNTEC LOPO/M-3 TIME DOMAIN

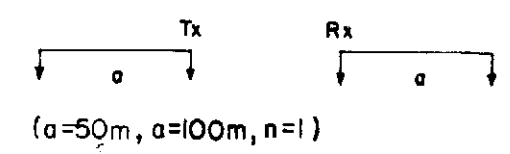

N.T.S. 82 M/I

NORTH AIR MINES LTD.
THANKSGIVING PROPERTY
REVELSTOKE MINING DIVISION - BRITISH COLUMBIA

INDUCED POLARIZATION PROFILE
— LINE 4950E —

Glen E. White
geophysical consulting
B
services Ltd.

INTERPRETED BY: G.E.W.
DRAWN BY: N.L.P.
CHECKED BY: G.E.W.
DATE: AUG. 1979
FIG. No: 7

To Accompany Geophysical Report
Thanksgiving Property
Date June / 81
By GLEN E. WHITE - B.Sc.



MINERAL RESOURCE BRANCH
ASSESSMENT REPORT
19041

**part 3
of 6**

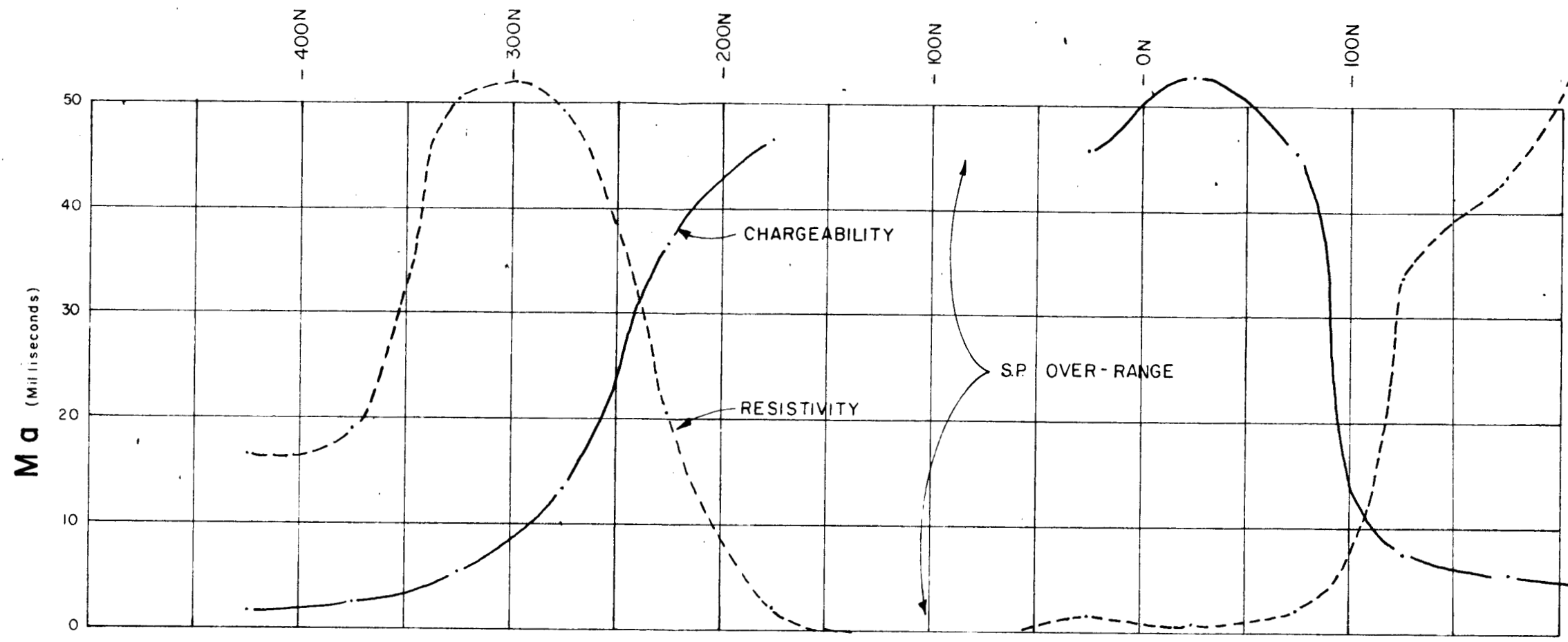

Pa (Ohm Meters) n=1 .685 .764 .2131 .1979 .815 .94 <10 <10 .38 .27 .78 .1317 .1748 .4957

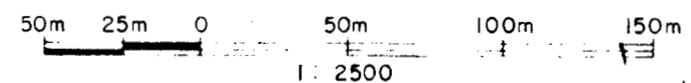

INSTRUMENT: HUNTEC LOPO/M-3 TIME DOMAIN

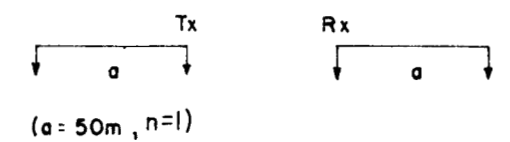

N.T.S. 82 M/I

NORTHAIR MINES LTD. THANKSGIVING PROPERTY REVELSTOKE MINING DIVISION-BRITISH COLUMBIA	
INDUCED POLARIZATION PROFILE — LINE 5000E —	
<i>Glen E. White</i> geophysical consulting services ltd.	INTERPRETED BY: G.E.W. DRAWN BY: N.L.P. CHECKED BY: G.E.W. DATE: AUG 1979 FIG No: 8

Thanksgiving Property
Date June / 81
By GLEN E. WHITE
BRITISH COLUMBIA ENGINEER

