

part 3
of 4

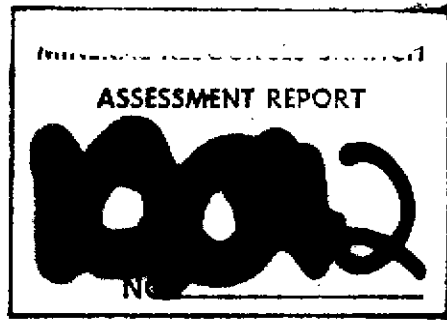

ORE RESERVES OF
THE NORTH STAR AND WOLF DEPOSITS
HELD BY DOLLY VARDEN MINERALS INC.
KITSAULT VALLEY, BRITISH COLUMBIA

VOLUME 3 / 4

SKEENA D.D.

55° 42 129° 31

D. & C. LTD.

I. S. Thompson, P.Eng.

W. N. Pearson, Ph.D.

Toronto, Ontario
February 15, 1981

This report may not be reproduced, in whole or in part, without the written permission of Derry, Michener & Booth.

VOLUME 3

WOLF DEPOSIT

TABLE CONTENTS

IN MAP POCKET

Longitudinal Section - Wolf Deposit

Cross Section 1100N - " "

" " 1150N - " "

" " 1200N - " "

" " 1250N - " "

" " 1300N - " "

" " 1350N - " "

" " 1400N - " "

" " 1450N - " "

" " 1500N - " "

" " 1550N - " "

" " 1600N - " "

" " 1650N - " "

" " 1700N - " "

" " 1750N - " "

" " 1800N - " "

D. & C. LTD.

130°15' 130°00' 45' 30' 15' 12

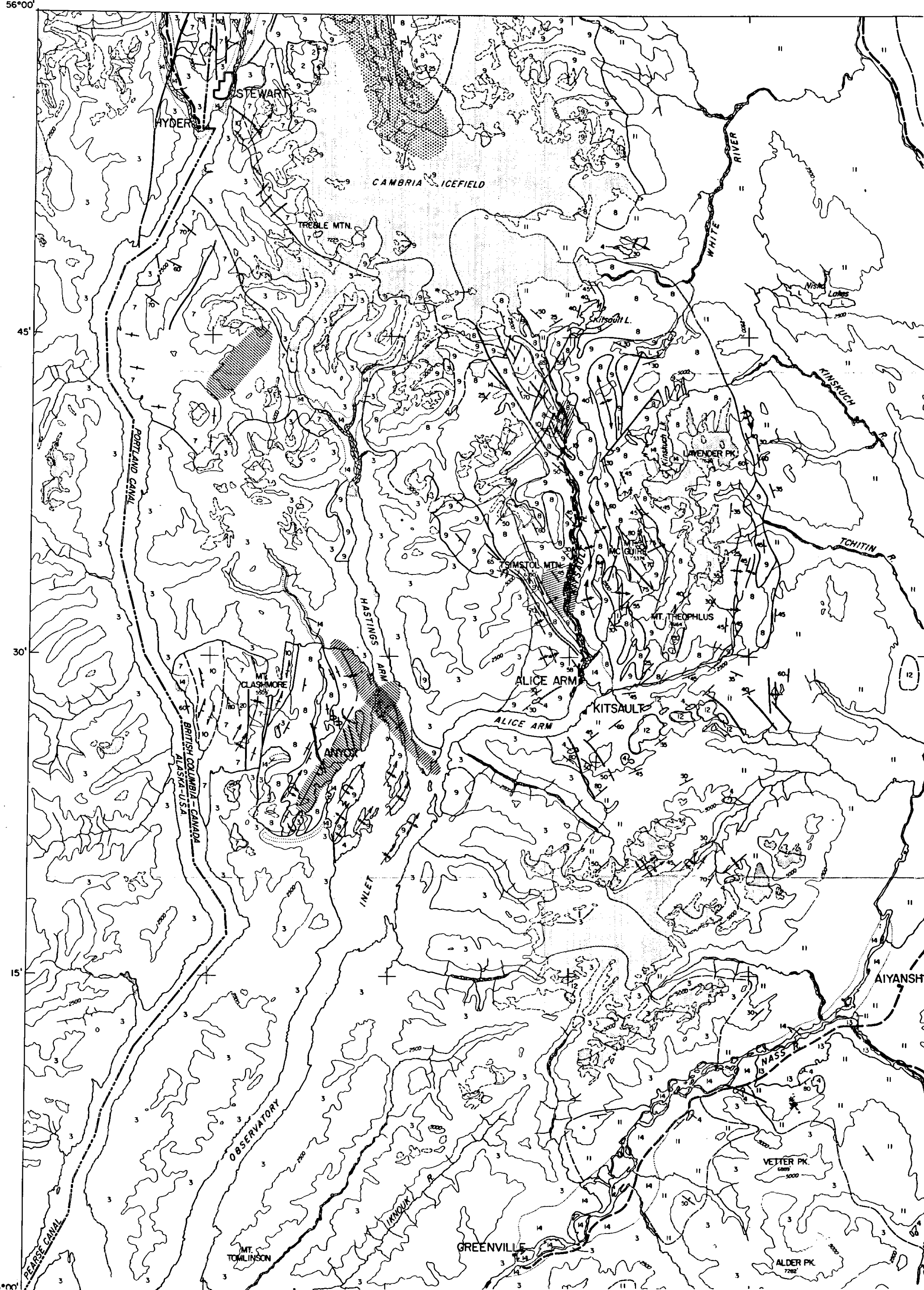

LEGEND

- 14 Alluvium, sand, gravel, till
- 13 Basalt flows, cinder cones, etc.
- 12 Plateau basalts, etc.
- 11 Siltstone, graywacke, sandstone, conglomerate
- 10 Cataclasite, mylonite, & schist
- 9 Graywacke, sandstone, conglomerate
- 8 Volcanic tuff & breccia, pillow lava
- 7 Green, red, & purple volcanic breccia, conglomerate
- 6 Mafic volcanic rocks
- 5 Gneiss complex
- Lamprophyre, basalt & andesite dyke swarms
- Portland canal dyke swarm
- 4 Alice arm intrusions - Quartz monzonite porphyry, quartz feldspar porphyry
- 3 Coast plutonic complex: Granitic rocks; quartz diorite, granodiorite
- 2 Augite diorite, hornblende granodiorite
- 1 Feldspar porphyry, augite porphyry

MINERAL RESOURCES BRANCH
ASSESSMENT REPORT
10042

**part 3
of 4**

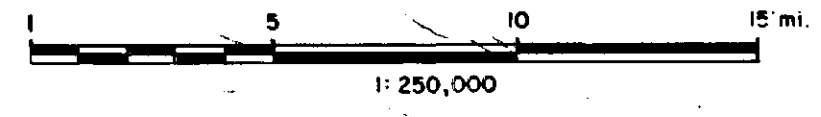

DERRY, MICHENER & BOOTH		
DOLLY VARDEN RESOURCES LTD.		
KITSULT AREA		
REGIONAL		GEOLOGY
DATE: Nov. 1979	BY:	MAP NO.

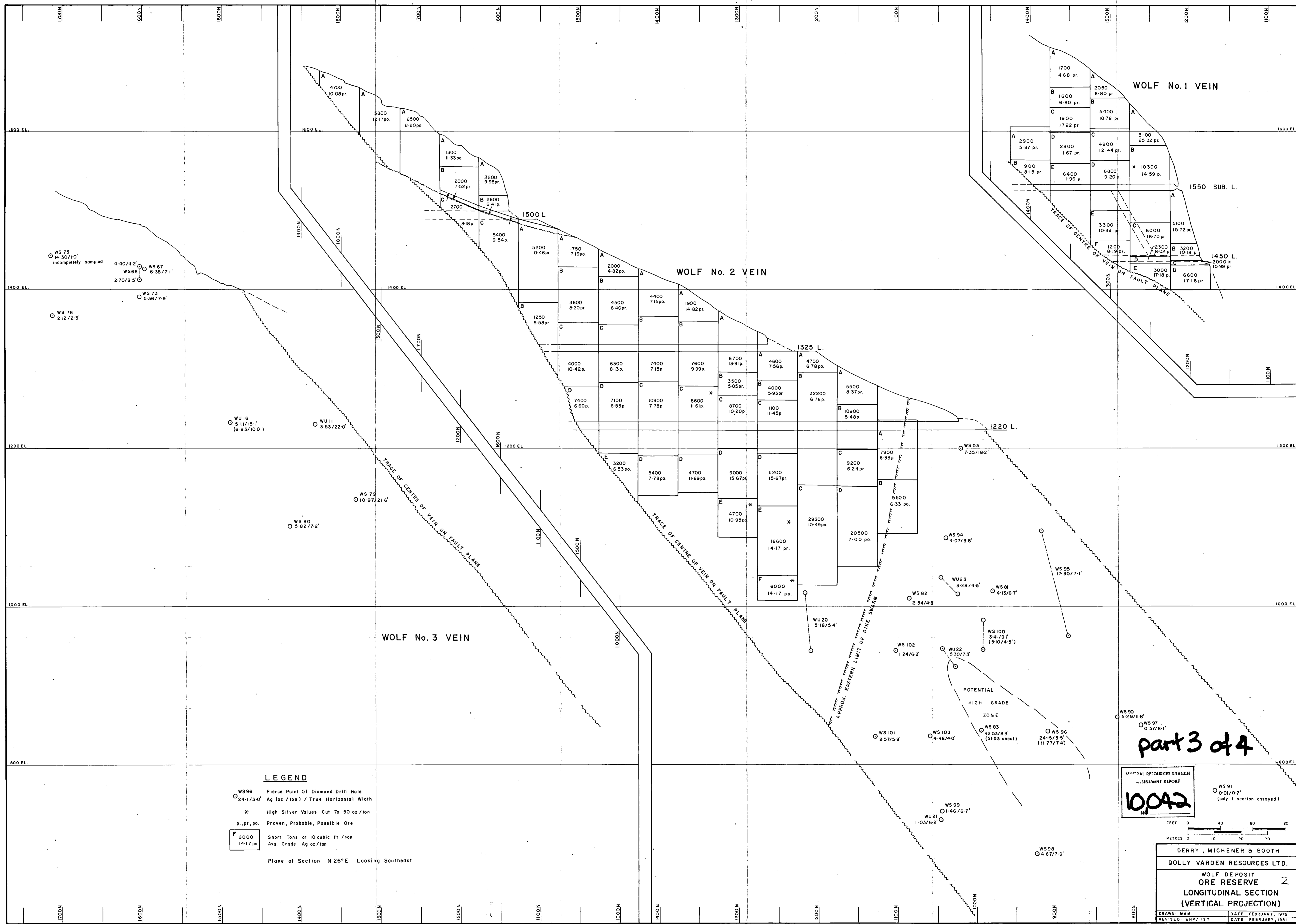

LEGEND

WS96 Pierce Point of Diamond Drill Hole
 Ag (oz / ton) / True Horizontal Width
 24-1/3-0'

* High Silver Values Cut To 50 oz/ton

p., pr., po. Proven, Probable, Possible Ore

F 6000 Short Tons at 10 cubic ft / ton
 Avg. Grade Ag oz/ton

Plane of Section N 26° E Looking Southeast

part 3 of 4

MINERAL RESOURCES BRANCH
 ASSESSMENT REPORT

10042

WS 91 0-01/0-7' (only 1 section assayed)

FEET 0 40 80 120
 METRES 0 10 20 30

DERRY, MICHENER & BOOTH
 DOLLY VARDEN RESOURCES LTD.

WOLF DEPOSIT
 ORE RESERVE
 LONGITUDINAL SECTION
 (VERTICAL PROJECTION)

DRAWN: MAM DATE: FEBRUARY, 1972
 REVISED: WNF/1ST DATE: FEBRUARY, 1981

1800

1600

1400

1200

1000

800

600

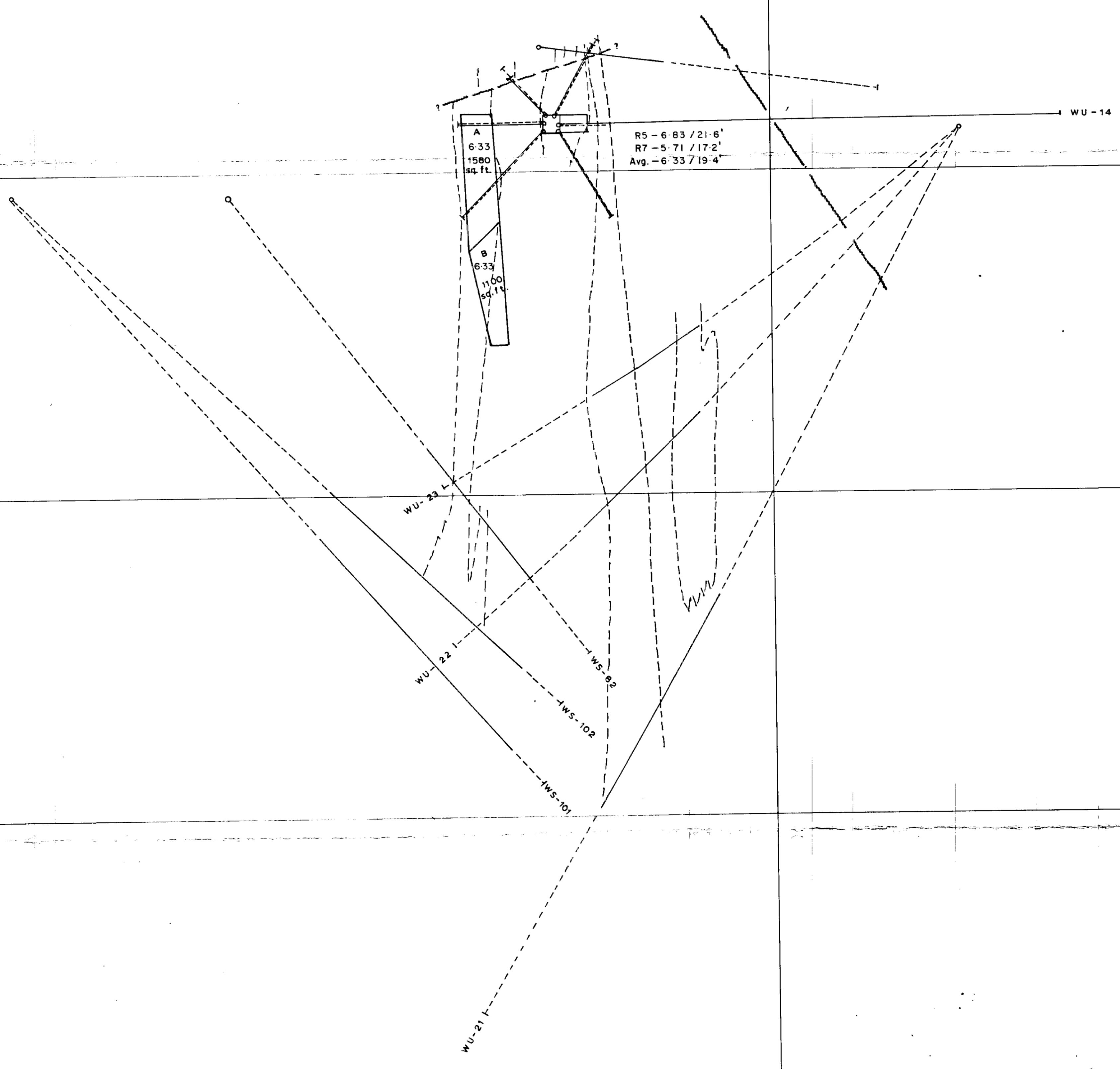

part 3
of 4



DERRY, MICHENER & BOOTH
DOLLY VARDEN RESOURCES LTD.
WOLF DEPOSIT
SECTION 1100N
0 40 80 120
FEET
DRAWN: M.A.M. DATE: FEBRUARY, 1972
REVISED: WNP/157 DATE: FEBRUARY, 1981

3

1800

1600

1400

1200

1000

800

600

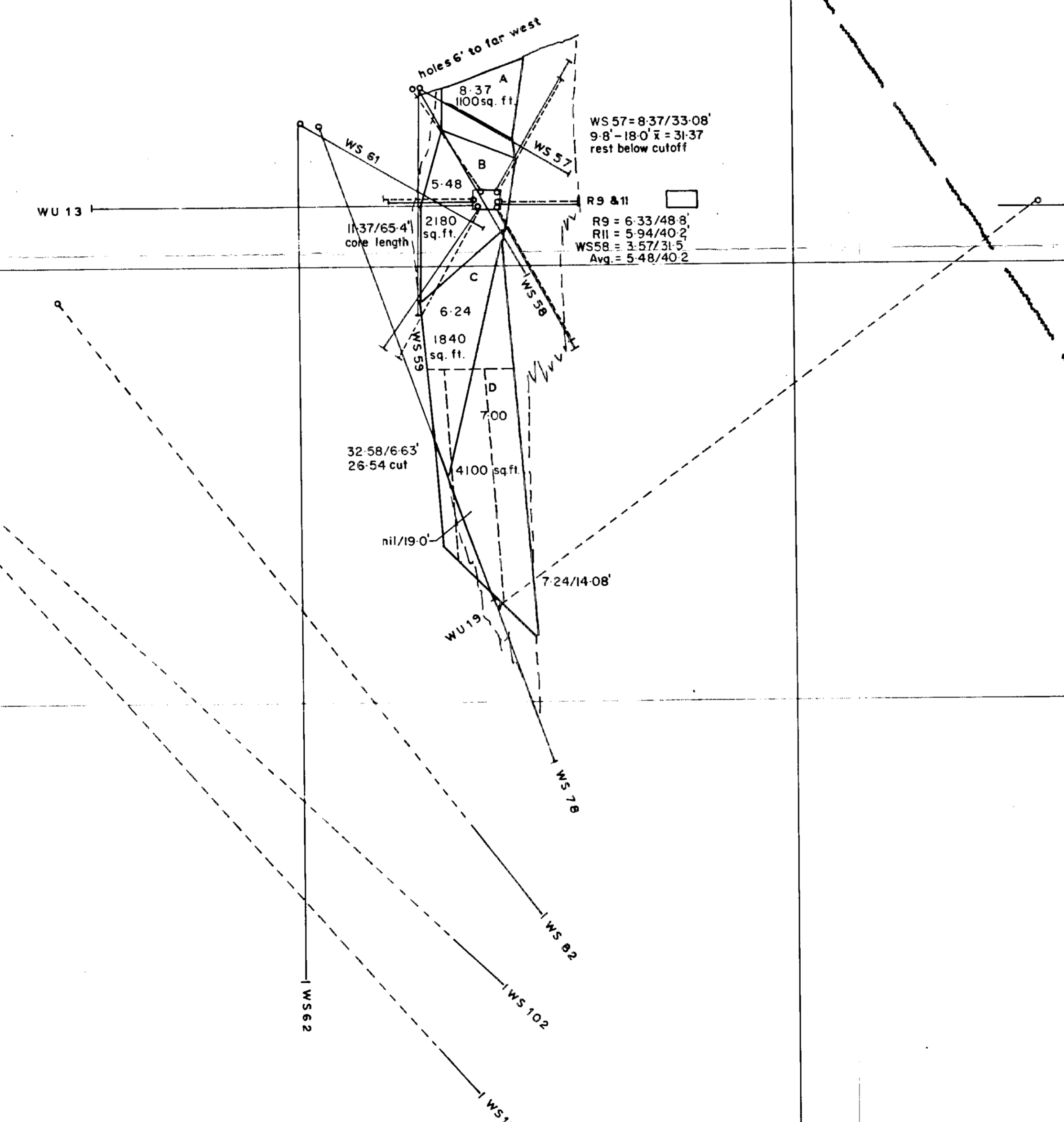

MINERAL RESOURCES BRANCH
ASSESSMENT REPORT
NO. 10092

part 3
of 4



DERRY, MICHENER & BOOTH
DOLLY VARDEN RESOURCES LTD.
WOLF DEPOSIT
SECTION 1150N
0 40 80 120
FEET
DRAWN: MAM DATE: FEBRUARY, 1972
REVISED: WNP/IST DATE: FEBRUARY, 1981

1800

1600

1400

1200

1000

800

600

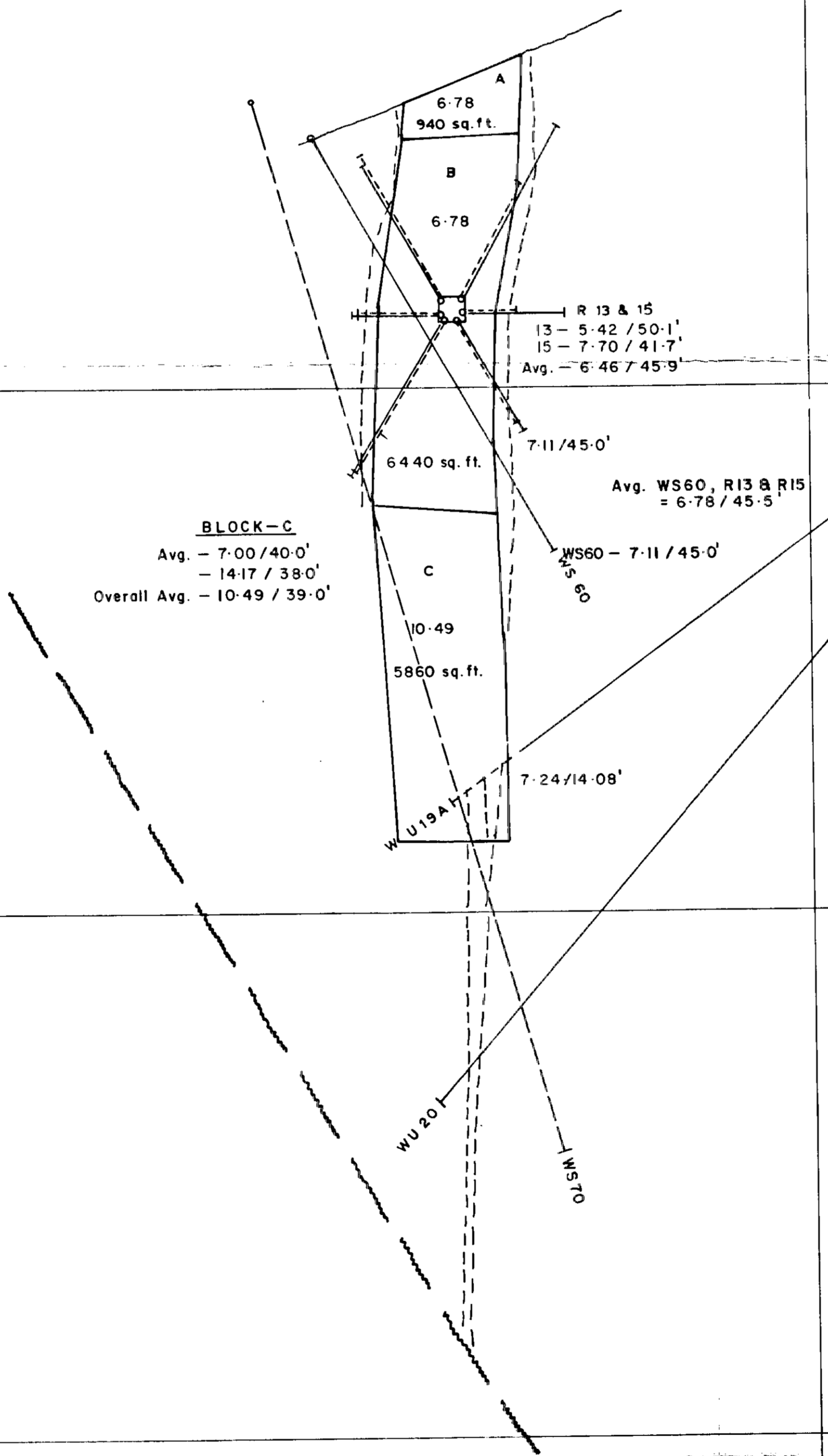
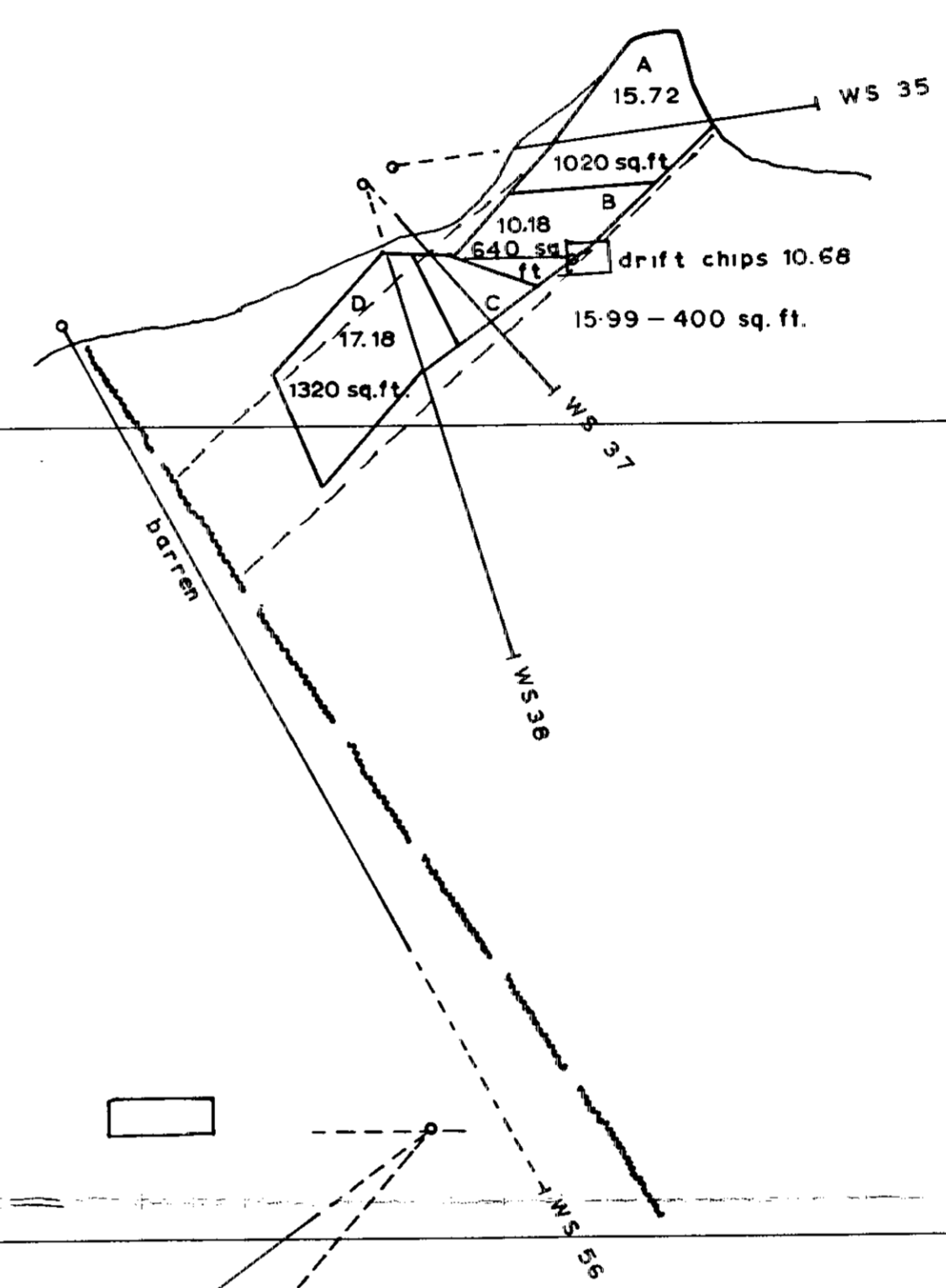

BLOCK-C
 Avg. - 7-00 / 40-0'
 - 14-17 / 38-0'
 Overall Avg. - 10-49 / 39-0'

R 13 & 15
 13 - 5-42 / 50-1'
 15 - 7-70 / 41-7'
 Avg. - 6-46 / 45-9'

Avg. WS 60, R13 & R15
 = 6-78 / 45-5'

WS 60 - 7-11 / 45-0'

7-24 / 14-08'

MINERAL RESOURCES BRANCH
 ASSESSMENT REPORT
1012

Part 3 of 4

10,042 Part 3 of 4



DERRY, MICHENER & BOOTH
 DOLLY VARDEN RESOURCES LTD.
 WOLF DEPOSIT
 SECTION 1200N
 0 40 80 120
 FEET
 DRAWN: MAM DATE: FEBRUARY, 1972
 REVISED: WNP/IST DATE: FEBRUARY, 1981

REFERENCE LINE

5

1800

1600

1400

1200

1000

800

600

REFERENCE LINE

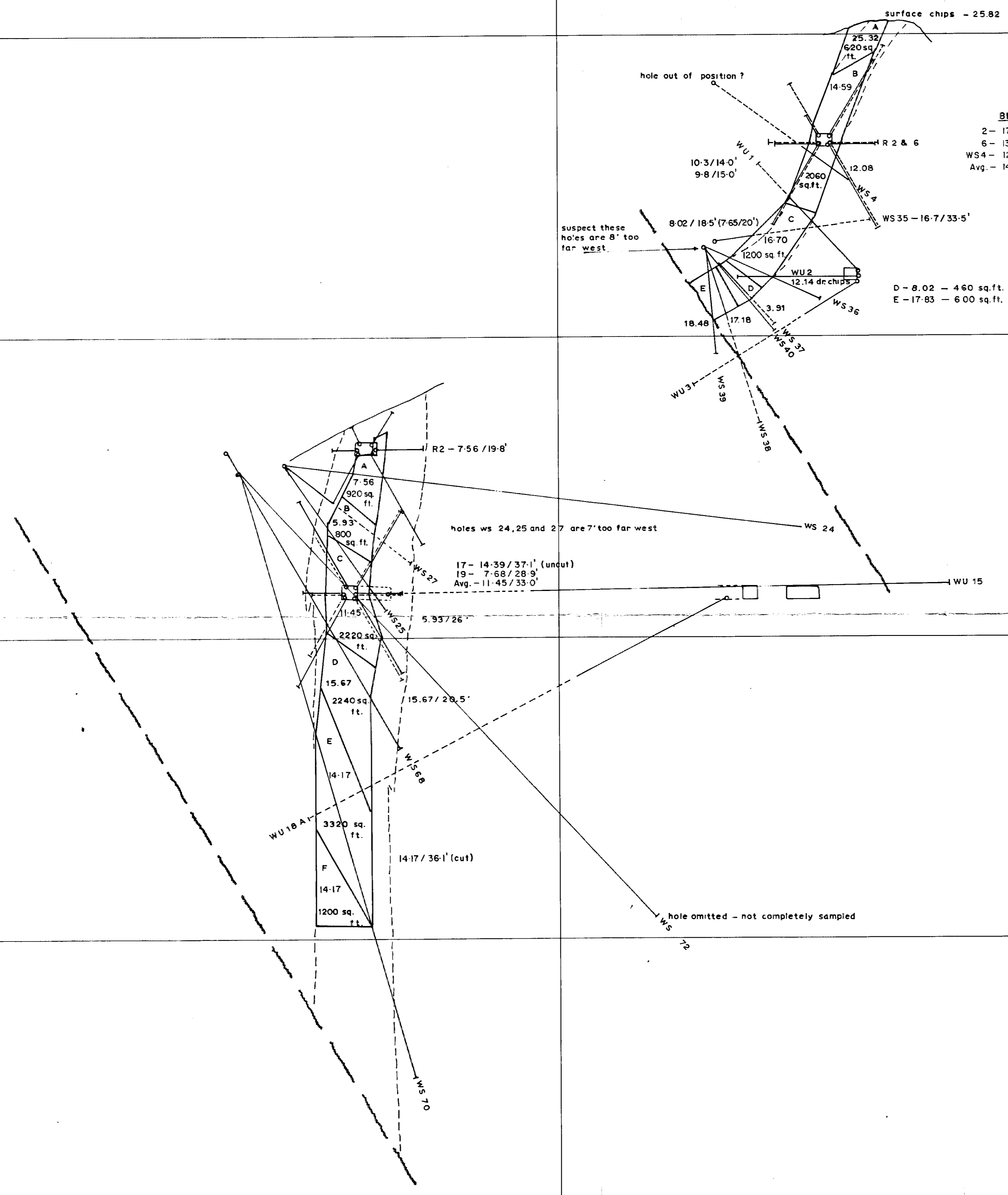

MINERAL RESOURCES BRANCH
ASSESSMENT REPORT
10,042

part 3
of 4

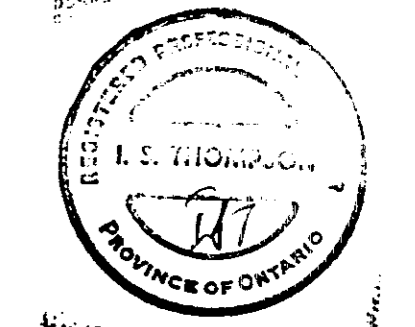

DERRY, MICHENER & BOOTH
DOLLY VARDEN RESOURCES LTD.
WOLF DEPOSIT
SECTION 1250N

0 40 80 120
FEET

DRAWN: MAM DATE: FEBRUARY, 1972
REVISED: WNP/IST DATE: FEBRUARY, 1981

6

1800

1600

1400

1200

1000

800

600

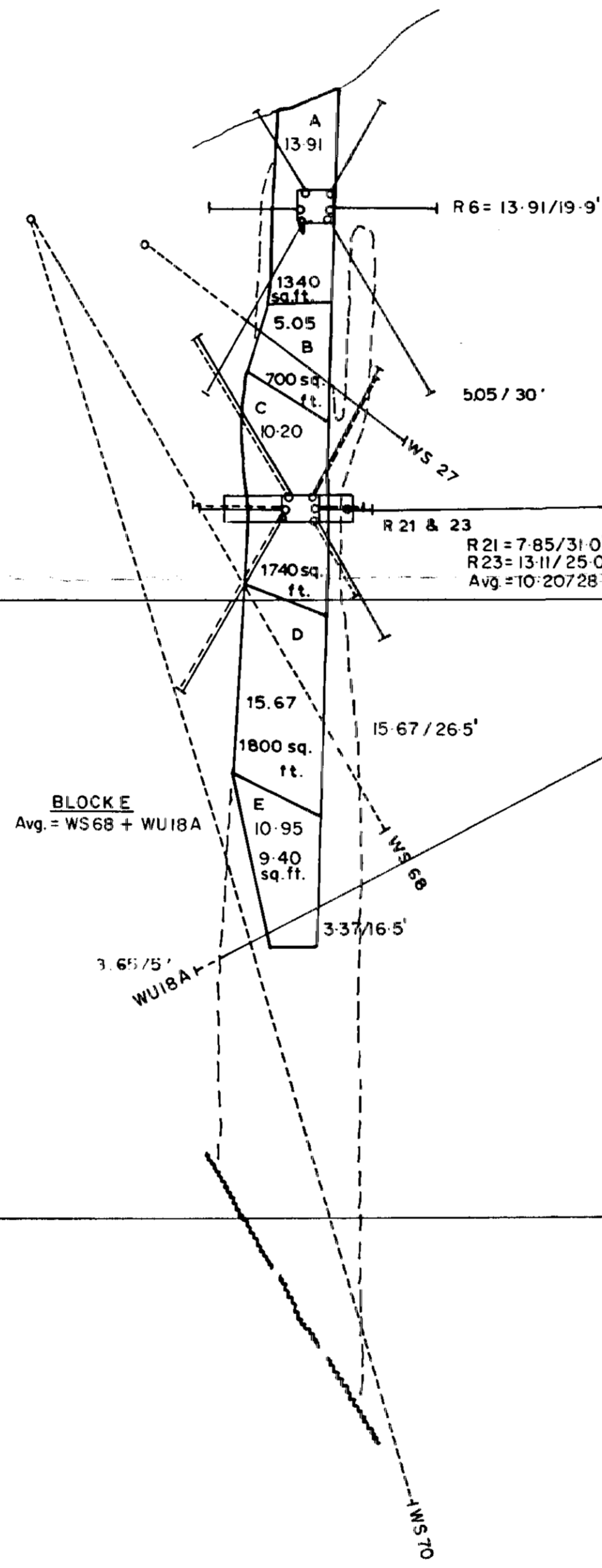
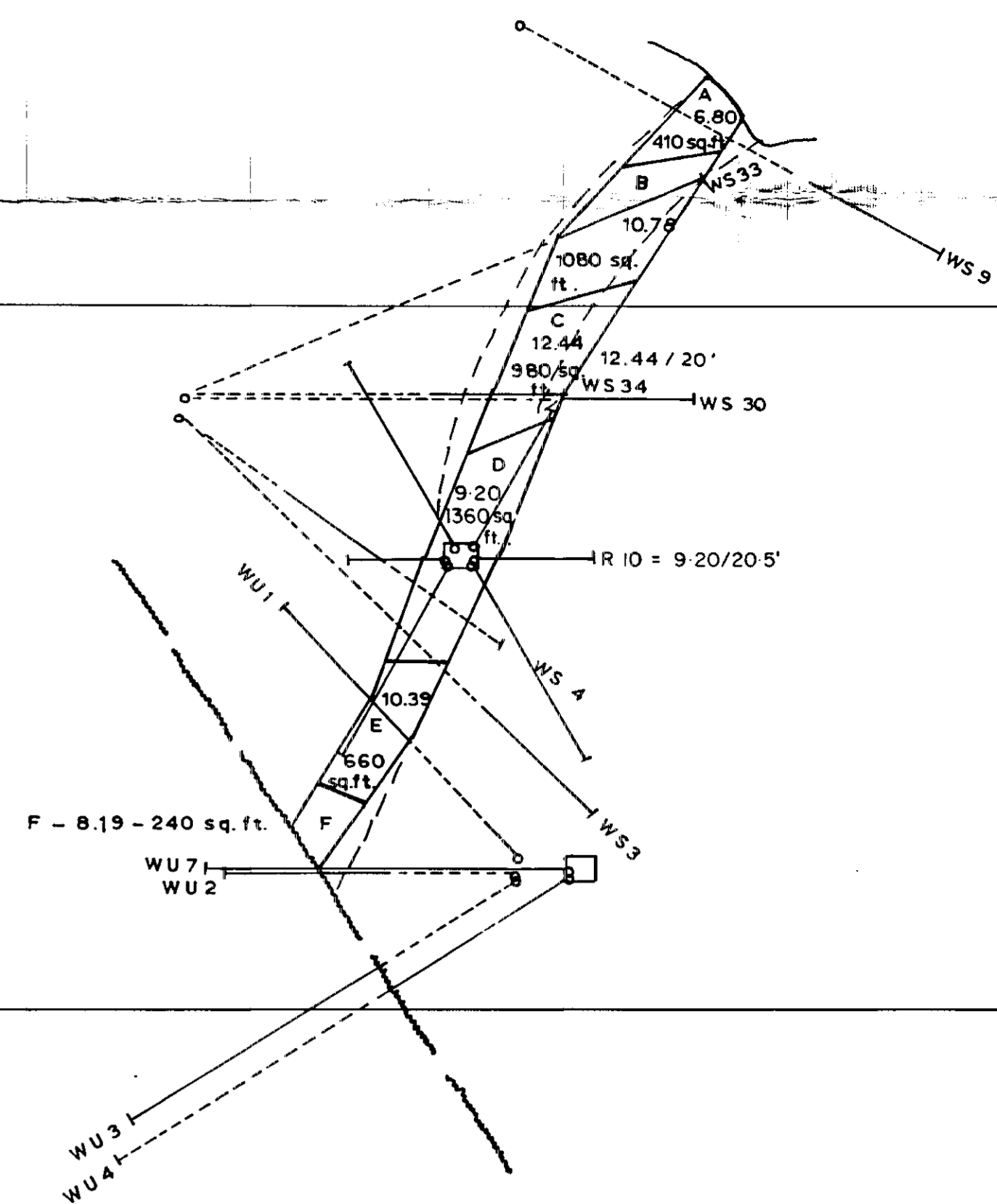

MINERAL RESOURCES BRANCH
ASSESSMENT REPORT
1012
Part 3 of 4
10,042 Part 3 of 4



DERRY, MICHENER & BOOTH
DOLLY VARDEN RESOURCES LTD.
WOLF DEPOSIT
SECTION 1300N
0 40 80 120
FEET
DRAWN: MAM DATE: FEBRUARY, 1972
REVISED: WNP/IST DATE: FEBRUARY, 1981

REFERENCE LINE

1800
1600
1400
1200
1000
800
600

- A - 4.68 - 340 sq.ft.
- B - 6.80 - 320 sq.ft.
- C - 17.22 - 380 sq.ft.
- D - 11.67 - 560 sq.ft.
- E - 11.96 - 1280 sq.ft.

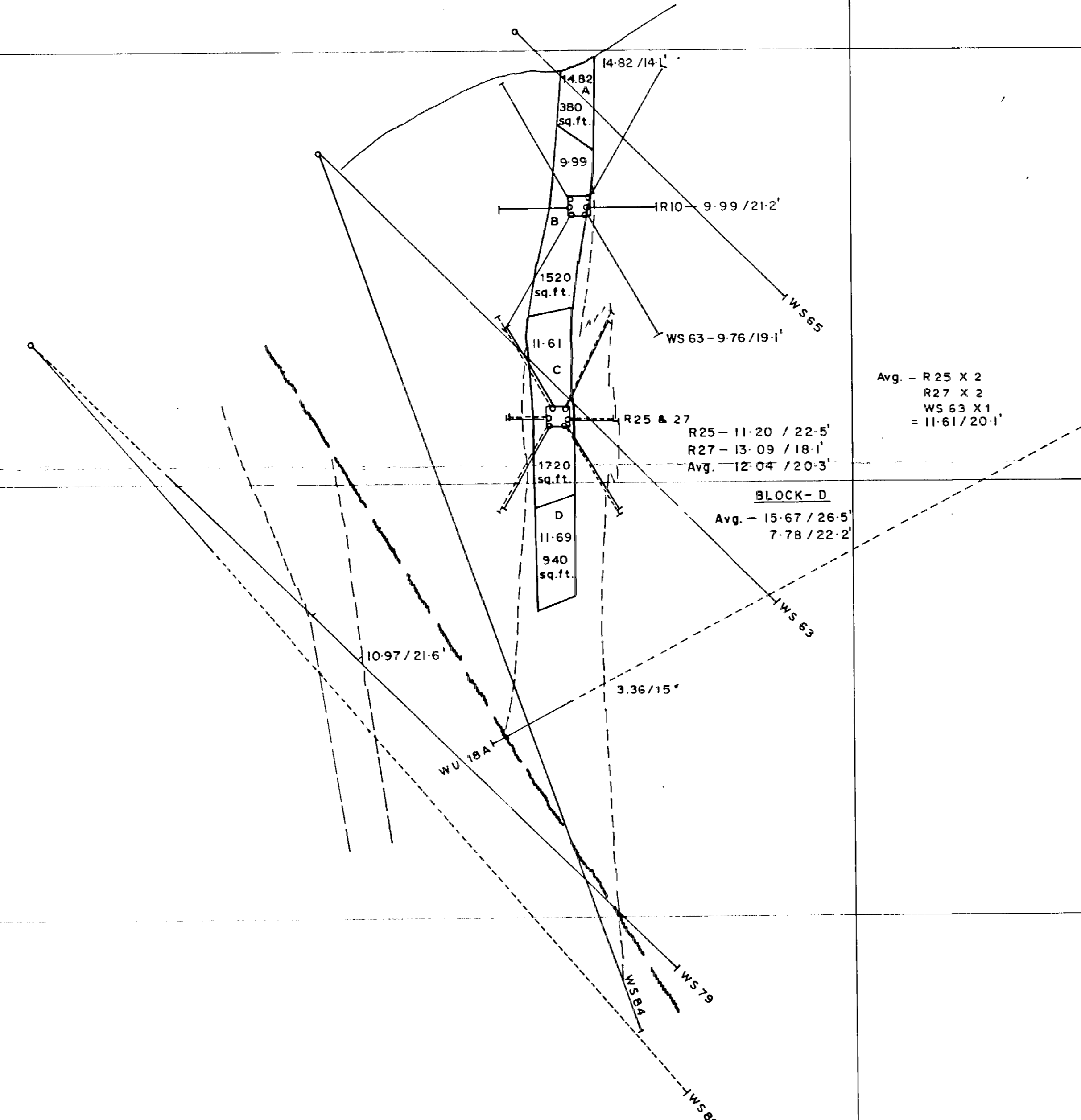
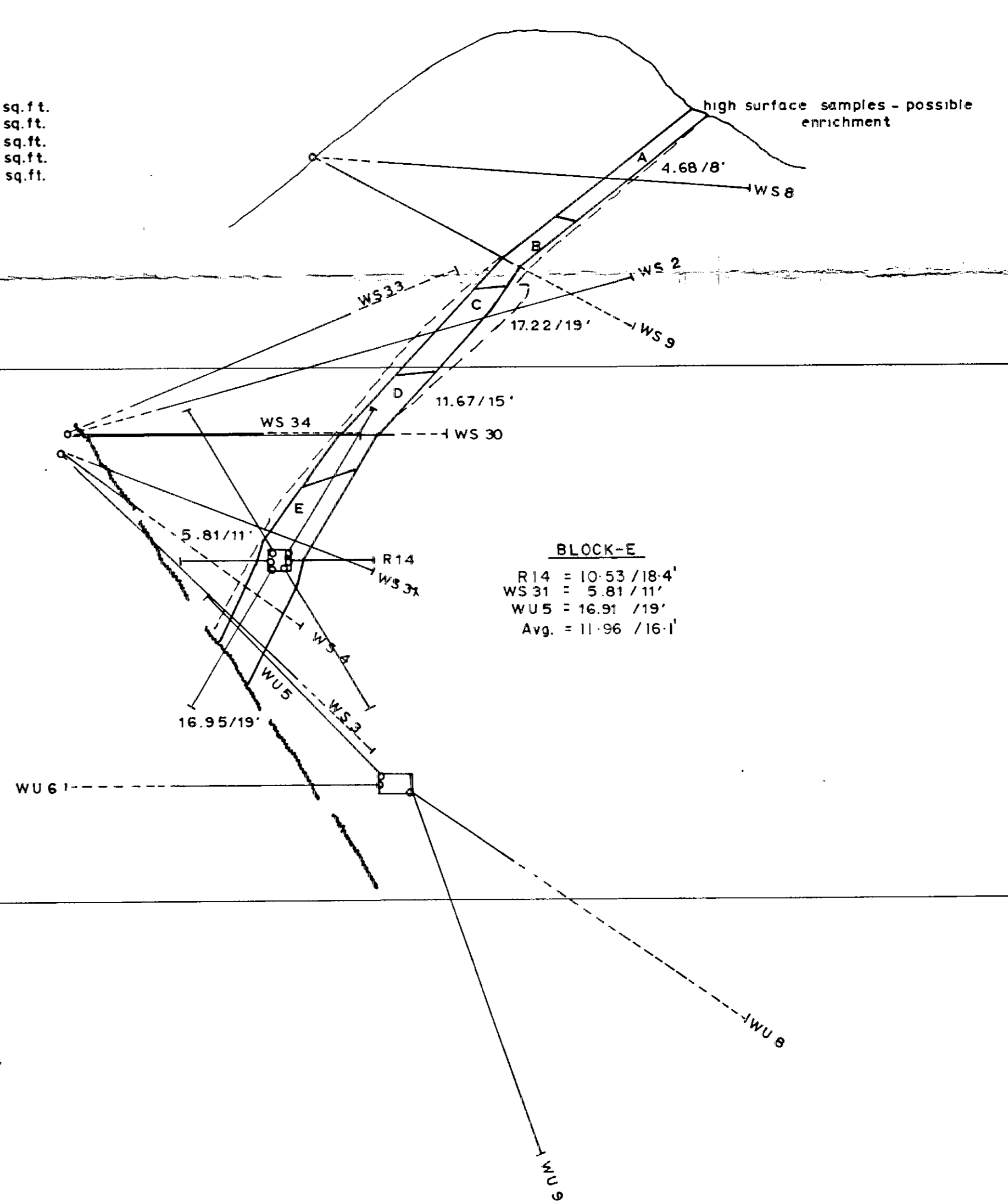

MINERAL RESOURCES BRANCH
ASSESSMENT REPORT
10,042
NO.
part 3
of 4
10,042 3 of 4



DERRY, MICHENER & BOOTH
DOLLY VARDEN RESOURCES LTD.
WOLF DEPOSIT
SECTION 1350N
0 40 80 120 FEET
DRAWN: MAM DATE: FEBRUARY, 1972
REVISED: WNP/IST DATE: FEBRUARY, 1981

REFERENCE LINE

8

1800

1600

1400

1200

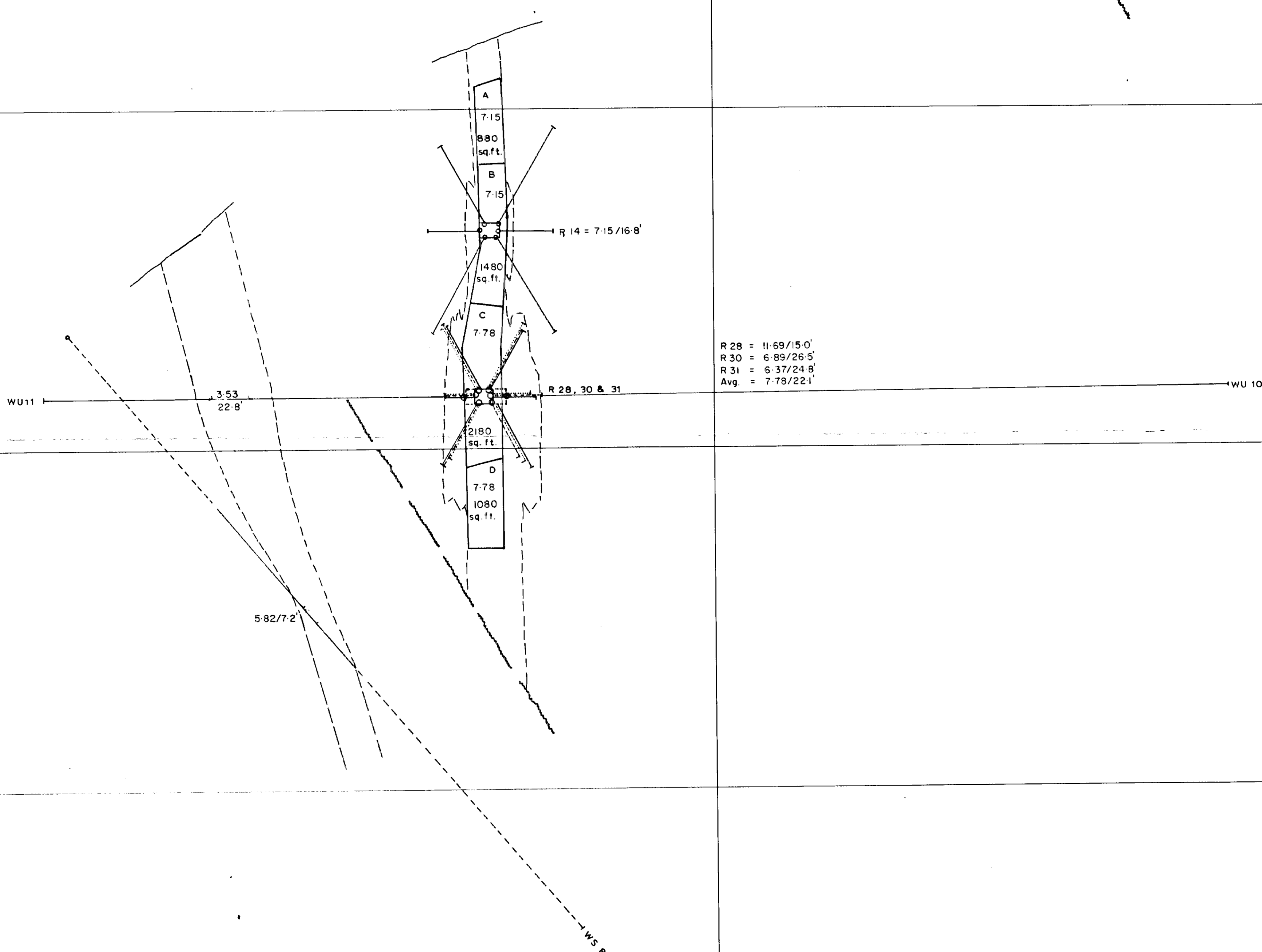
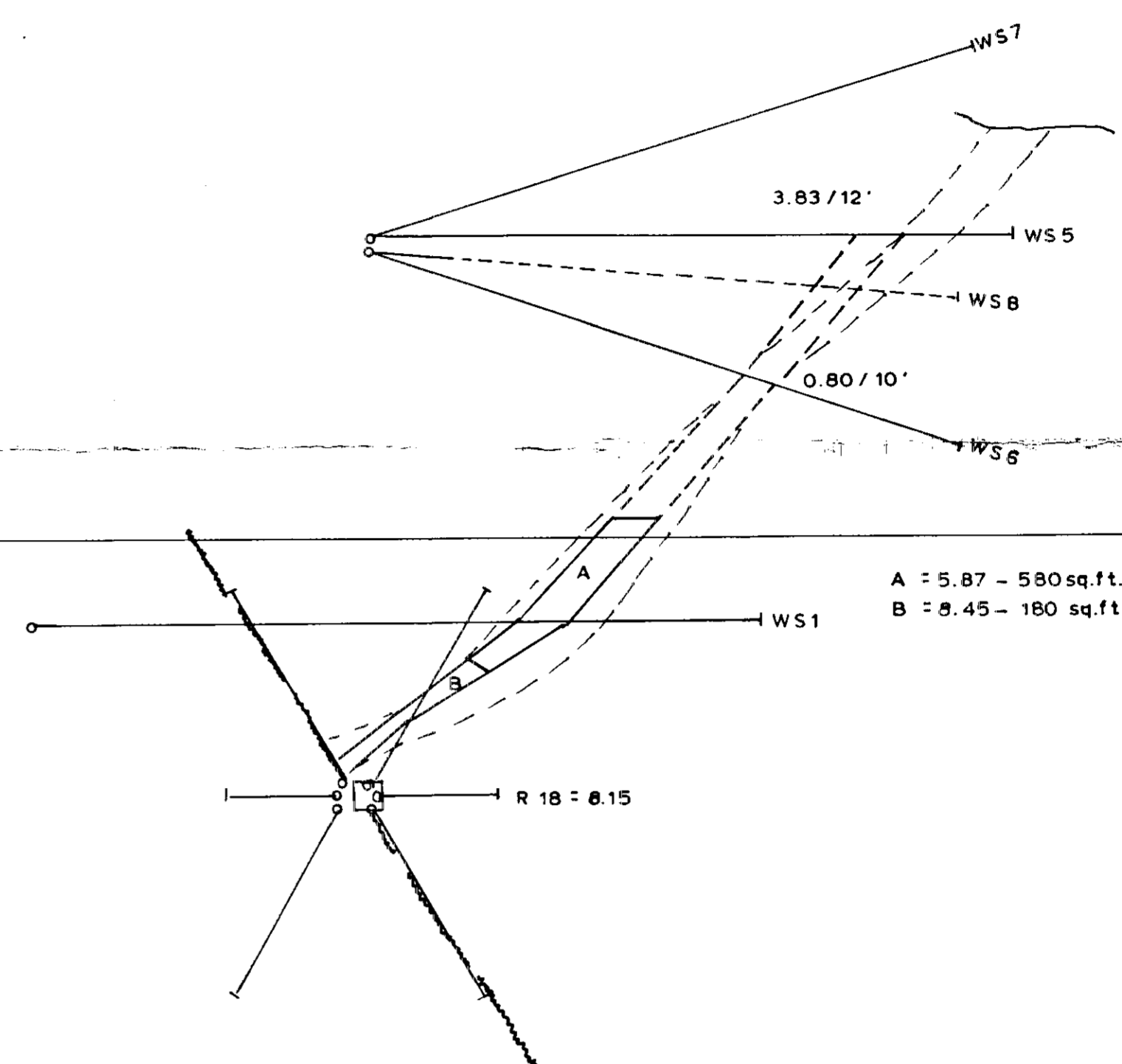

Part 3 of 4

MINERAL RESOURCES BRANCH
 ASSESSMENT REPORT
10042
 NO.



DERRY, MICHENER & BOOTH
 DOLLY VARDEN RESOURCES LTD.
 WOLF DEPOSIT
 SECTION 1400N

0 40 80 120 FEET

DRAWN: MAM DATE: FEBRUARY, 1972
 REVISED: WNP/IST DATE: FEBRUARY, 1981

1800

1600

1400

1200

1000

800

600

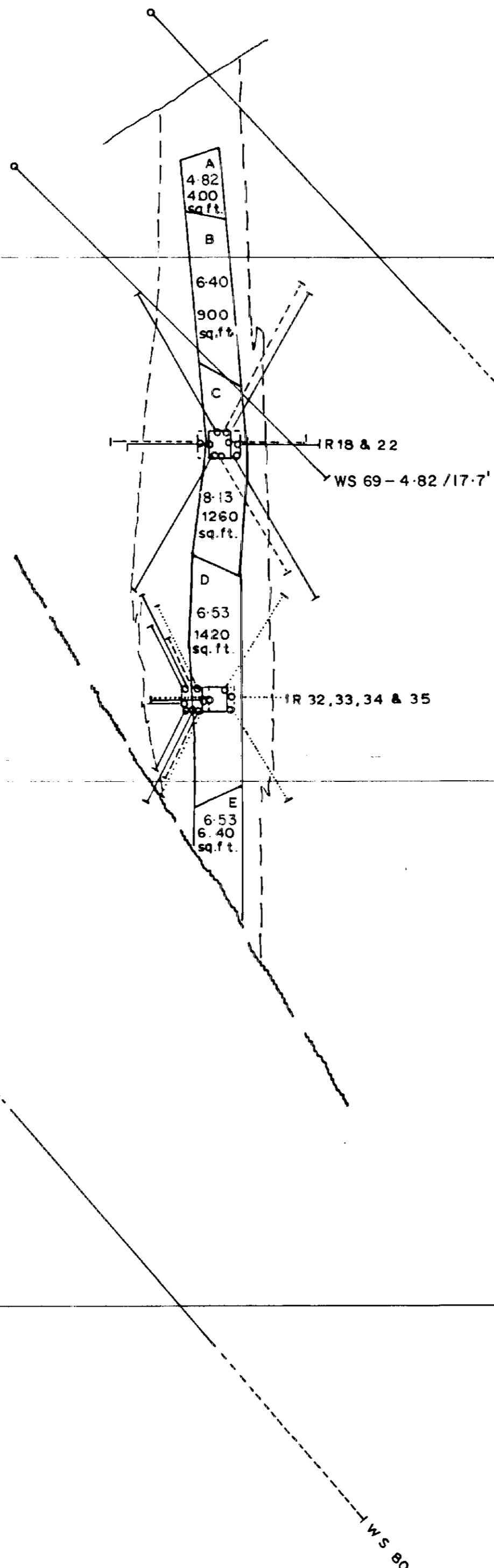
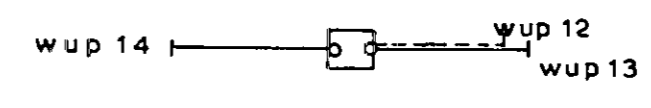
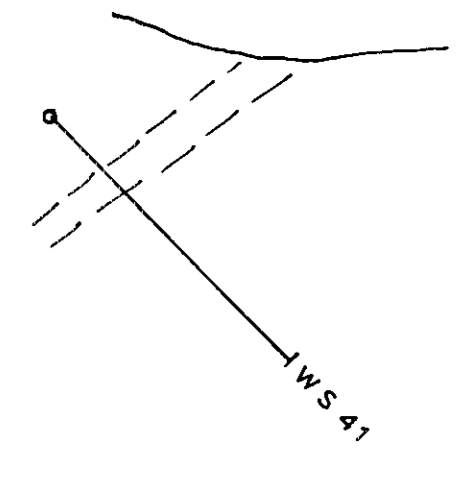

R18 - 8.95 / 16.7'
 R22 - 7.26 / 15.6'
 Avg. - 8.13 / 16.2' includes level chips

R32 - no samples - out of ore
 R33 - 6.70 / 20.1'
 R34 - no samples - out of ore
 R35 - 6.37 / 20.6'
 Avg. - 6.53 / 20.4'

part 3
of 4

MINERAL RESOURCES BRANCH
 ASSESSMENT REPORT
 10042



DERRY, MICHENER & BOOTH
 DOLLY VARDEN RESOURCES LTD.
 WOLF DEPOSIT
 SECTION 1450N
 0 40 80 120
 FEET
 DRAWN: MAM DATE: FEBRUARY, 1972
 REVISED: WNP/IST DATE: FEBRUARY, 1981

1800

1600

1400

1200

1000

800

600

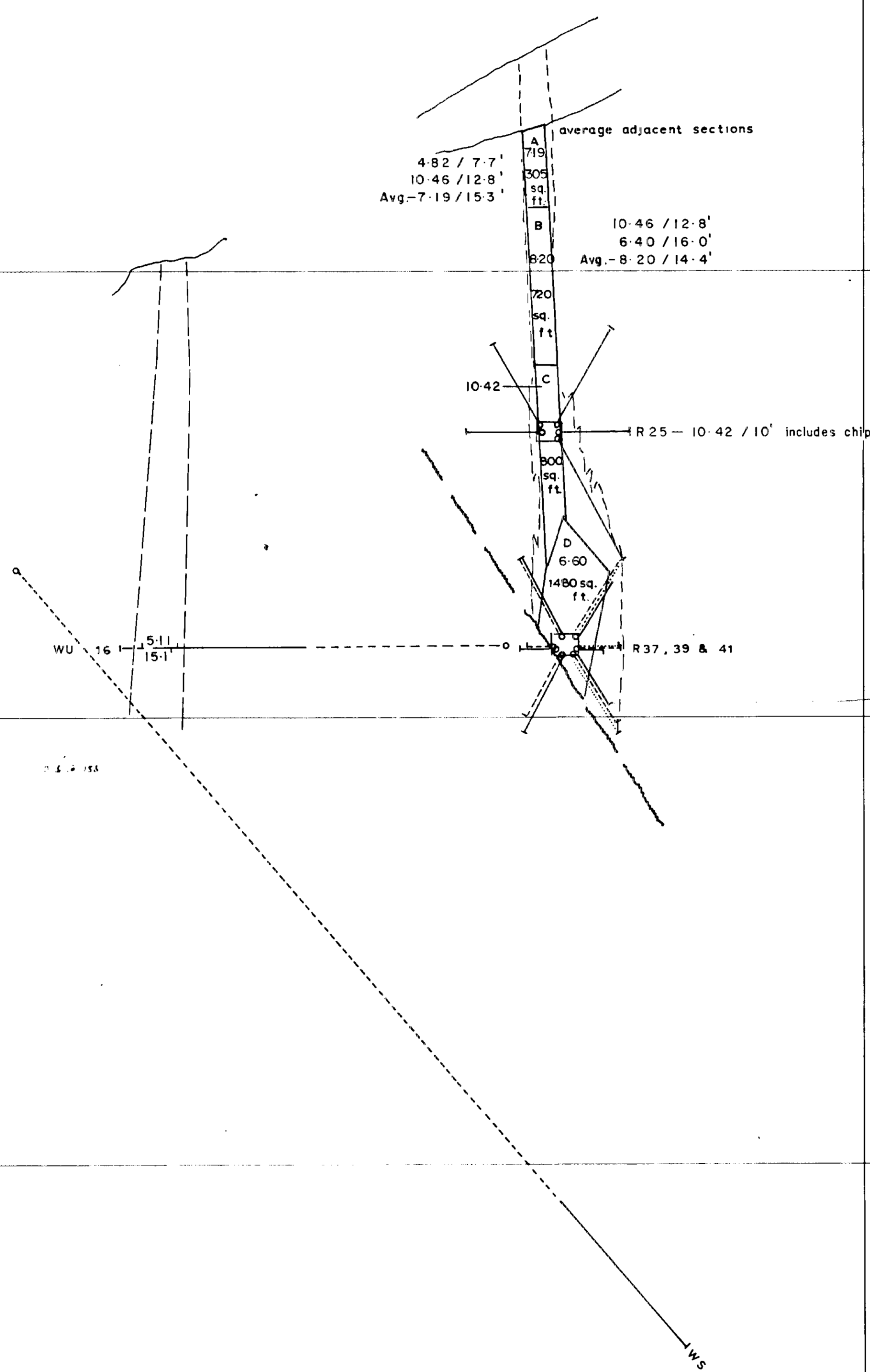

part 3
of 4

MINERAL RESOURCES BRANCH
ASSESSMENT REPORT
10042
NO.



DERRY, MICHENER & BOOTH
DOLLY VARDEN RESOURCES LTD.
WOLF DEPOSIT
SECTION 1500N

0 40 80 120
FEET

DRAWN: MAM DATE: FEBRUARY, 1972
REVISED: WNP/IST DATE: FEBRUARY, 1981

REFERENCE LINE

1800

1600

1400

1200

1000

800

600

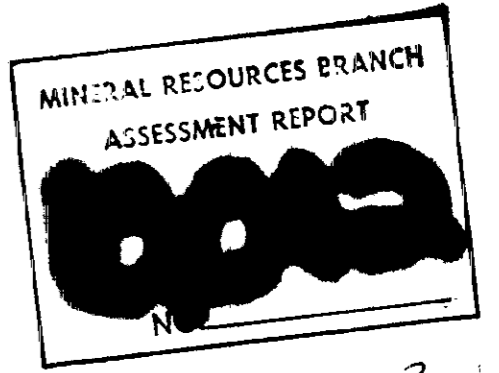
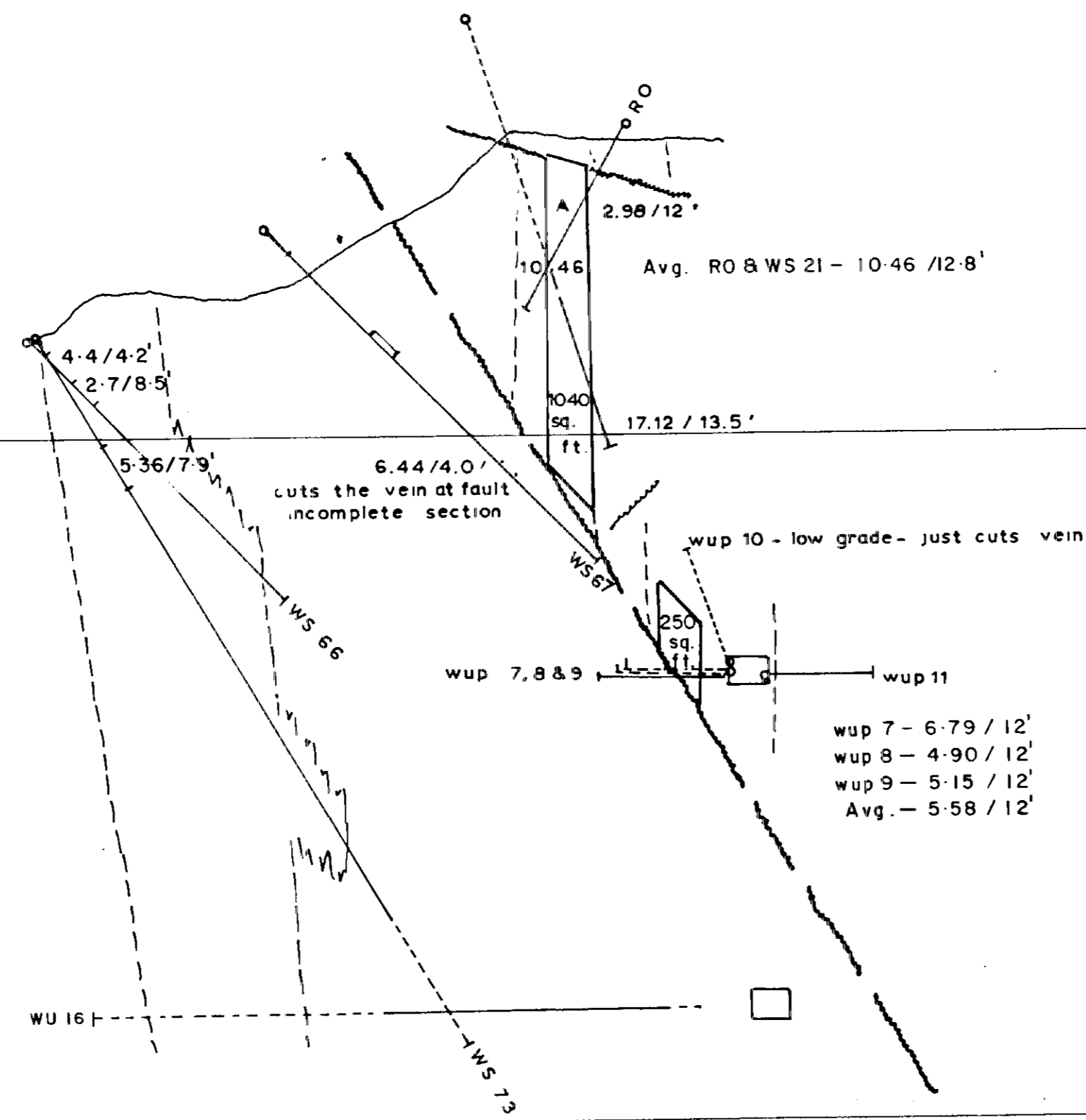

Part 3
of 4

10,042 Part 3 of 4



DERRY, MICHENER & BOOTH	
DOLLY VARDEN RESOURCES LTD.	
WOLF DEPOSIT	
SECTION 1550N	
DRAWN: M.A.M.	DATE: FEBRUARY, 1972
REVISED: WND/IST	DATE: FEBRUARY, 1981

REFERENCE LINE

1800

1600

1400

1200

1000

800

600

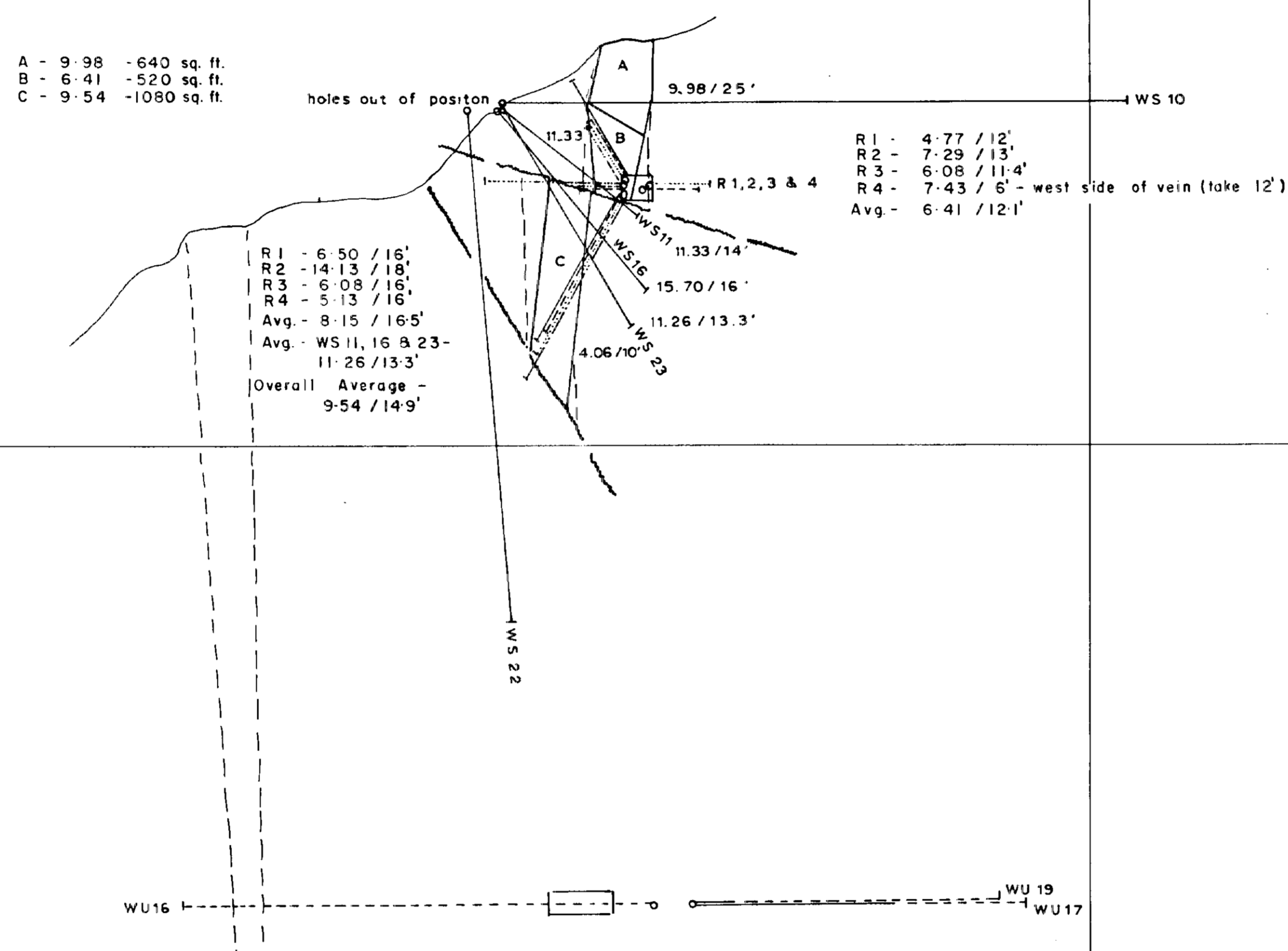

REFERENCE LINE

MINERAL RESOURCES BRANCH
ASSESSMENT REPORT
10042
NC

part 3
of 4



DERRY, MICHENER & BOOTH
DOLLY VARDEN RESOURCES LTD.
WOLF DEPOSIT
SECTION 1600N

0 40 80 120
FEET

DRAWN: MAM DATE: FEBRUARY, 1972
REVISED: WNP/IST DATE: FEBRUARY, 1981

13

1600
1500
1400
1200
1000
800
600

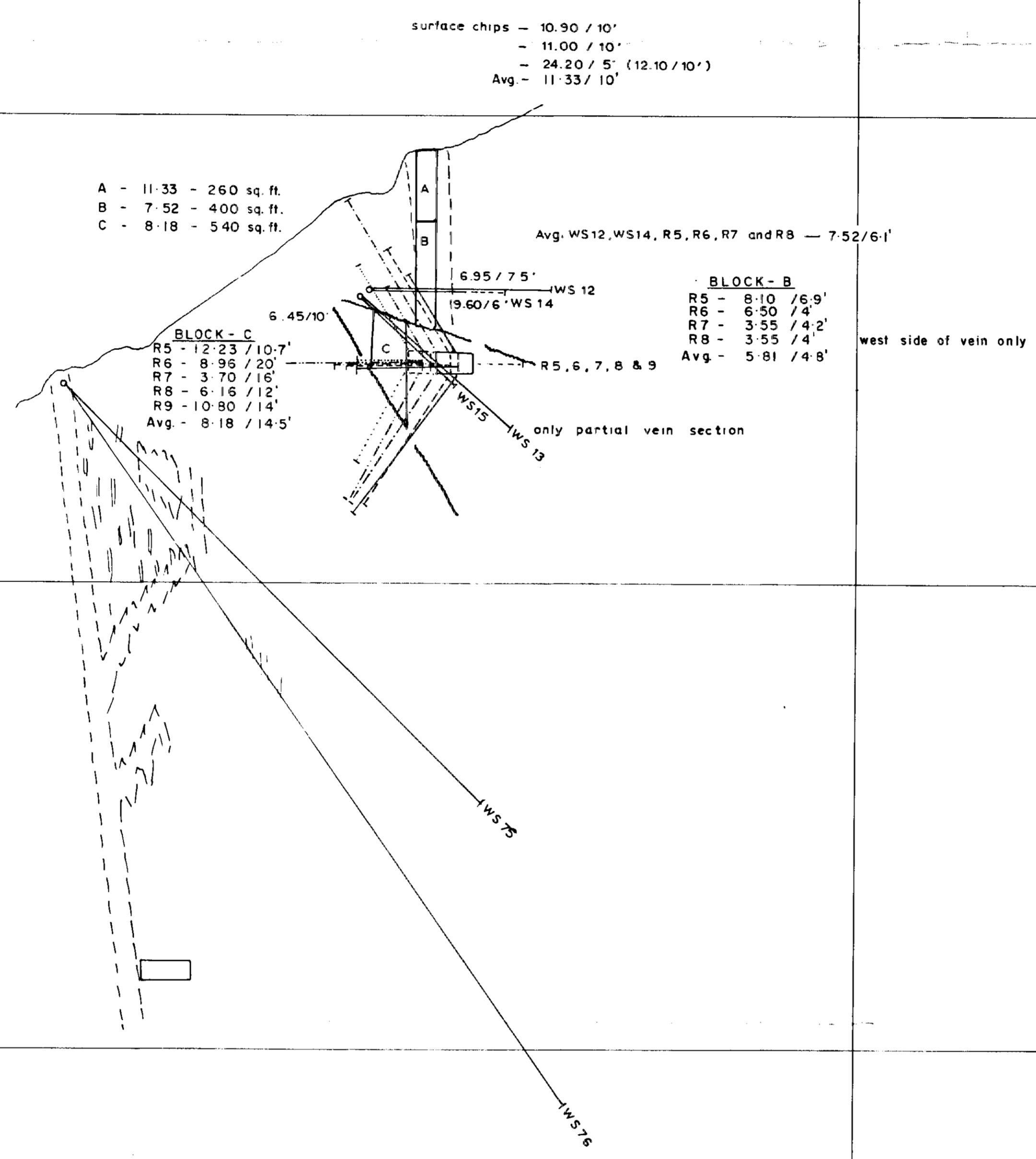

MINERAL RESOURCES BRANCH
ASSESSMENT REPORT
10042

part 3
of 4



DERRY, MICHENER & BOOTH
DOLLY VARDEN RESOURCES LTD.
WOLF DEPOSIT
SECTION 1650N

0 40 80 120
FEET

DRAWN: M.A.M. DATE: FEBRUARY, 1972
REVISED: WNP/IST DATE: FEBRUARY, 1981

REFERENCE LINE

14

1800

1600

1400

1200

1000

800

600

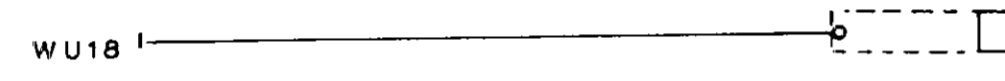
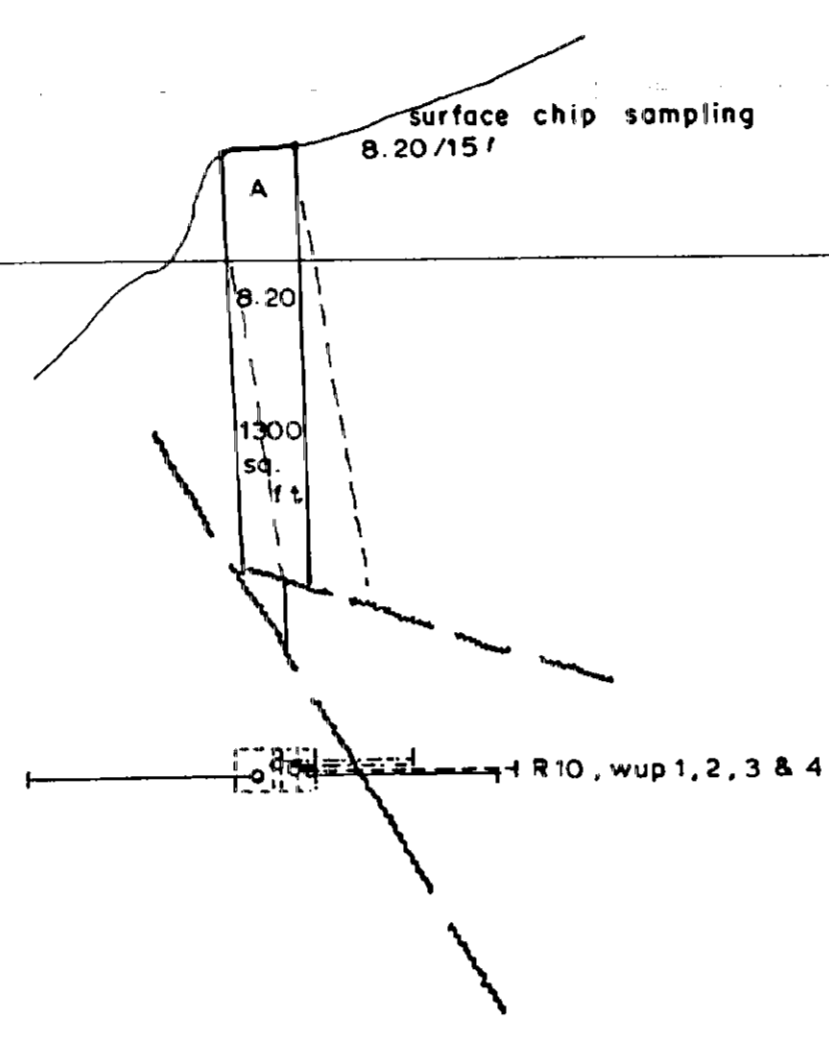

MINERAL RESOURCES BRANCH
ASSESSMENT REPORT

Part 3 of 4
84

10,042 Part 3 of 4

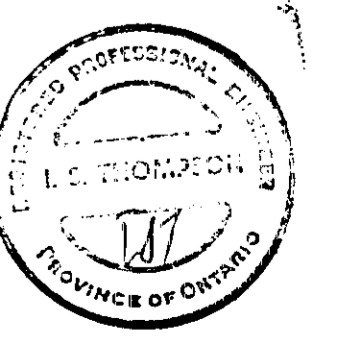

DERRY, MICHENER & BOOTH
DOLLY VARDEN RESOURCES LTD.
WOLF DEPOSIT
SECTION 1700N

0 40 80 120
FEET

DRAWN: M&M DATE: FEBRUARY, 1972
REVISED: WNP/157 DATE: FEBRUARY, 1981

REFERENCE LINE

15

1800

1600

1400

1200

1000

800

600

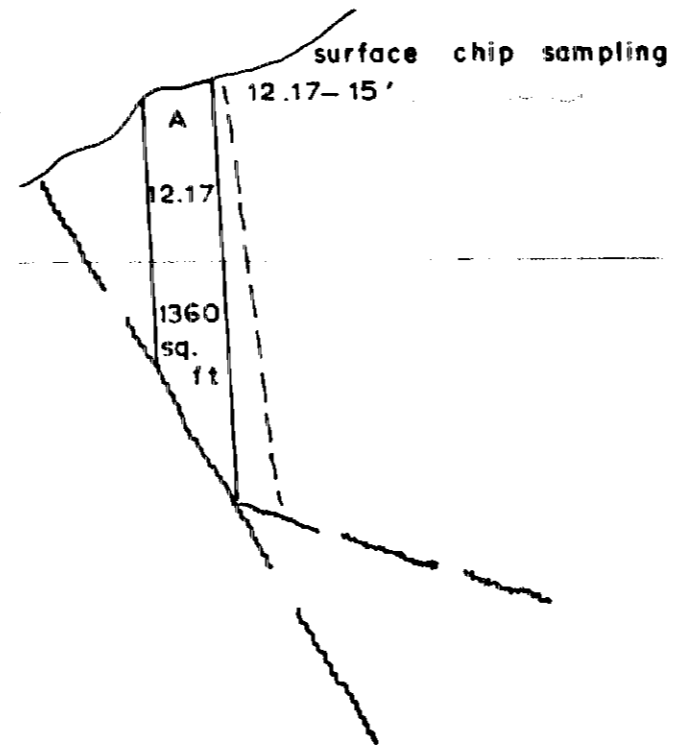

JWS 77

JWS 74

JWS 85

JWS 86



MINERAL RESOURCES BRANCH
ASSESSMENT REPORT
10042

part 3
of 4



DERRY, MICHENER & BOOTH
DOLLY VARDEN RESOURCES LTD.
WOLF DEPOSIT
SECTION 1750N
0 40 80 120
FEET
DRAWN: MAM DATE: FEBRUARY, 1972
REVISED: WNP/IST DATE: FEBRUARY, 1981

REFERENCE LINE

16

1800

1600

1400

1200

1000

800

600

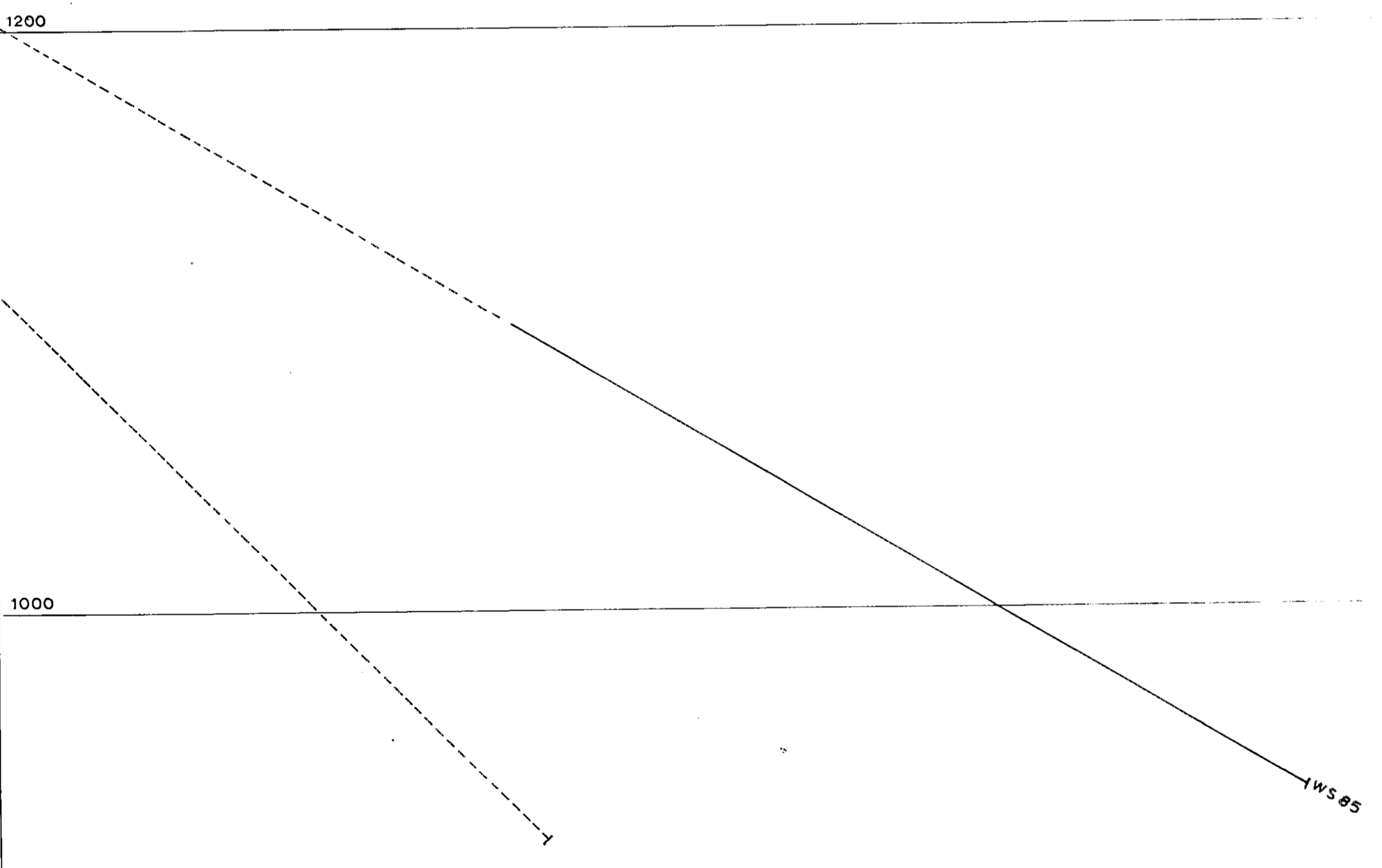
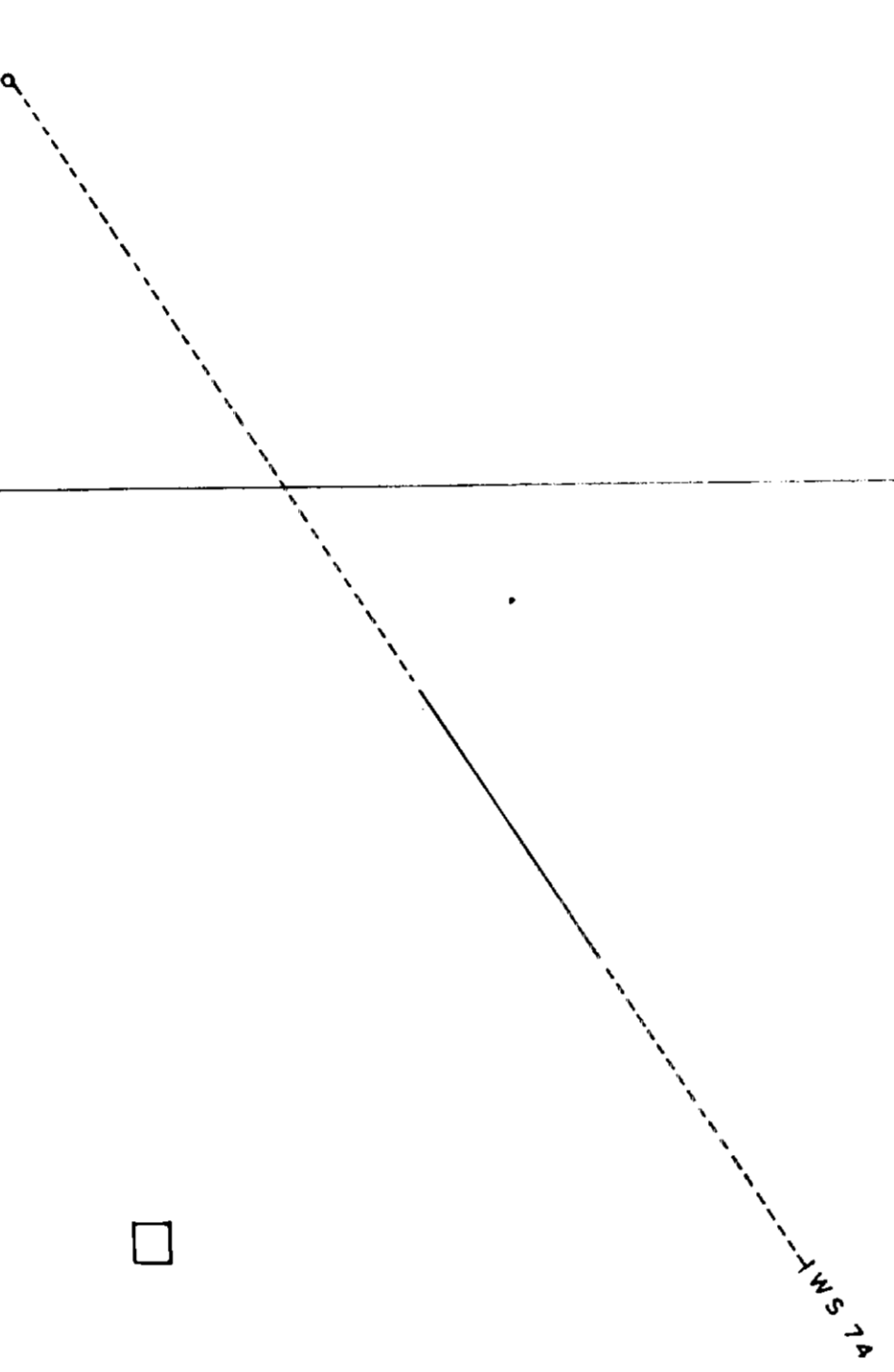
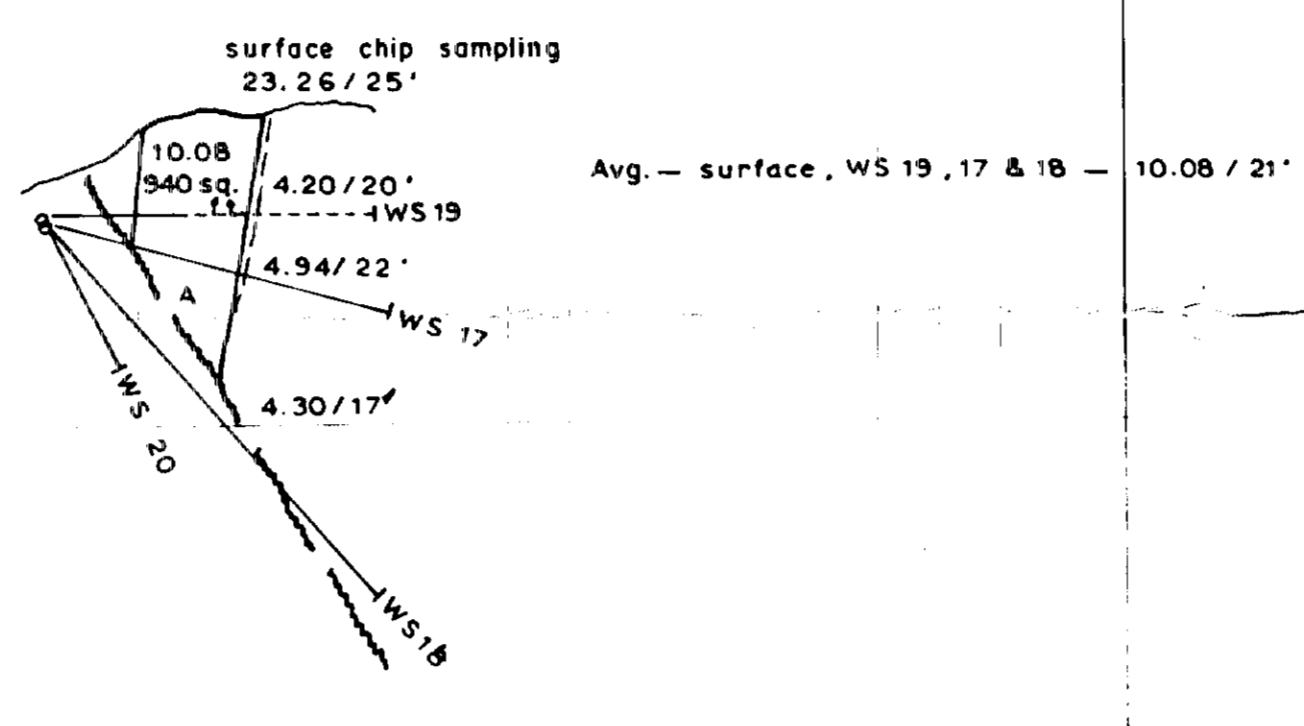

REFERENCE LINE

MINERAL RESOURCES BRANCH
ASSESSMENT REPORT
19042

Part 3
of 4



DERRY, MICHENER & BOOTH
DOLLY VARDEN RESOURCES LTD.
WOLF DEPOSIT
SECTION 1800N

0 40 80 120
FEET

DRAWN: MAM DATE: FEBRUARY, 1972
REVISED: WNP/IST DATE: FEBRUARY, 1981