

part 3 of 3

81-2048
1148-10068

ASSESSMENT REPORT 1981

PROSPECTING REPORT

CLAIMS ORB #1 1356
ORB #2 1357
ORB #3 1358
ORB #4 1406

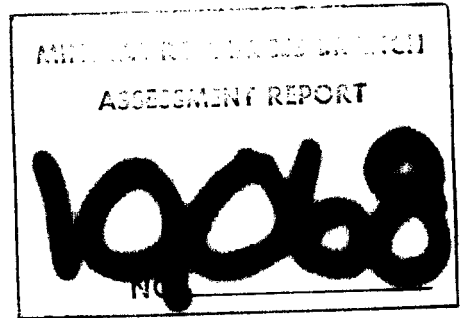

EMERALD STAR MINING EXPLORATIONS LTD.

SIMILKAMEEN-PRINCETON DIVISION

NTS 92H/7E - SOUTH QUADRANT

LATITUDE 49°15'N

LONGITUDE 120°33'W

16 MILES (24.9 km) DUE SOUTH OF PRINCETON, B.C.

OWNER

EMERALD STAR MINING EXPLORATIONS

OPERATOR

EMERALD STAR MINING EXPLORATIONS

CONSULTANT

ERNST WEDEKIND

Prospector, Geological Consultant, Mineralogist

AUTHOR

TOD PROSKIN

Prospector after completing

B.C. & Yukon Chamber of Mines Geological Prospecting School

DATE SUBMITTED

September 29th, 1981

TABLE OF CONTENTS

	<u>PAGE</u>
LOCATION AND ACCESS	1
GENERAL GEOLOGY	1
PROPERTY DEFINITION	1
TOTAL AREA PROSPECTED	1
GENERAL PROSPECTING OBSERVATIONS	1
PANNING SURVEY	4
GEOCHEMICAL PROSPECTING	5
CONCLUSIONS.....	6
TRAVEL EXPENSES	7
TOTAL WAGES PAID	8
INSTRUMENTAL RENTAL	9
ACCOMMODATION COSTS	10

Appendix

ILLUSTRATIONS

- FIGURE 1 LOCATION AND CLAIMS MAP
- FIGURE 2 PROSPECTING MAP

LOCATION AND ACCESS

The mineral claims are located some 25 km due south of Princeton, B.C., covering Sunday Creek between Highway #3 and the Similkameen River, Latitude 49°15'N, Longitude 120°33'W, NTS Location 92H/7 East.

GENERAL GEOLOGY

The general area of Sunday Creek is shown on Geology Map 888A Princeton, at a scale of 1" - 4 miles. The property is shown to be underlain by rocks of the Princeton Group. The grid appears to overlay a series of varicolored andesite and basalt which overlay a sedimentary sequence of shale, sandstone, conglomerate and coal.

PROPERTY DEFINITION

The property is owned and operated by Emerald Star Mining Explorations who have been developing consistently. Currently, the property has sustained an investment cost of approximately \$ 50,000.

TOTAL AREA PROSPECTED

The total area prospected was approximately 18 kilometers. Sightings were made at random locations.

GENERAL PROSPECTING OBSERVATIONS

The ORB claims are well covered in overburden, and although many hours have been spent prospecting, very few outcroppings were discovered.

What very few outcroppings that were located were well weathered, and there was no visible dip or strike. Most of the rock was covered in moss and so weathered it could not be identified until a fresh surface was exposed.

Outcropping Number 1, found above the banks of Sunday Creek, is located 2200 meters 85°SE from the legal corner post of ORB claims 1 and 2, or 1050 meters 72°NE from the junction of Sunday Creek North and South Fork.

This outcropping is exhibited on the prospecting report map as Figure No. 1. This outcrop consisted largely of dolomite with a shear face, mostly weathered to obscurity.

A second outcropping approximately 2150 meters 78°NE of the legal corner post for ORB claims, and/or 1250 meters 43°NE of the junction between Sunday Creek North Fork and Sunday Creek South Fork. The rock in this location is generally slate, although one section did exhibit two long parallel quartz veins, about a foot apart and two inches in diameter.

A blasting operation was conducted to expose the origin of the quartz veins. After conducting the blasting, the quartz veins were no longer visible, and quite a bit of calcite was exposed. There was no indication of mineralization or leached out sulfides. The area where the blasting was conducted is marked on the prospecting map as False Tooth Hill.

The third outcropping was 200 meters 5°SE , directly below outcropping #2 where blasting took place. Its location is 2175 meters 80°NE of the legal corner post for ORB claims 1 and 2. On this outcropping there was no visible strike or dip recorded. The rock was identified as rhyolite.

The fourth outcropping was 1650 meters, 80°NE of the junction of Sunday Creek. For reference, the junction is 1300 meters 68°SE from the legal corner posts of ORB claims 1 and 2. This outcrop consisted of a sedimentary shale at a fairly good strike of 70°NW , and a dip of 20°N .

The fifth outcrop was spotted 1550 meters 76°NE from the crossing of Sunday Creek South Fork and Highway #3. This outcrop was badly weathered and had no identifiable strike or dip to it, also identified as a type of sedimentary shale.

The sixth outcropping is 250 meters 78°SE of outcrop #4. It is also 1850 meters 84°NE of the junction of Sunday Creek North and South Fork. The rock had a strike of 38°NW and a dip of 7°N . This outcrop was found on the side of a hill, with a slope of 30° overlooking the Similkameen River. This rock resembled argillite in texture, grain size, and composition; however, it was completely different in color. It was rust-red, very fractured and broken up, with leached out sulfides throughout. The rock had been exposed when the road was constructed, and consequently was eroded and leached by the elements.

PANNING SURVEY

Panning began at the junction of Sunday Creek North and South Fork, slowly working downstream to the mouth of Sunday Creek and the Similkameen River.

No mineralization, other than small amounts of black sand, possibly magnetite, was found. Although consistent, it was in no great abundance throughout Sunday Creek.

The junction of Creek No. 2 with Sunday Creek is 1200 meters 56° SE of the legal corner post for ORB claims 1 and 2. Creek No. 3 crosses the 5 O'Clock Road 1975 meters 44° SE of the junction of Sunday Creek North Fork and Sunday Creek South Fork.

In both creeks, 2 & 3, there were no visible black sands in the gravel, and absolutely no traceable mineralization.

GEOCHEMICAL PROSPECTING

One geocheming effort was made in the form of a silt sample and a water sample at 1600 meters 71' SE of the legal claim post for ORB claims 1 & 2. The results were as follows:

Aluminum	7	ppm
Barium	0.03	ppm
Calcium	2.0	ppm
Chromium	0.001	ppm
Copper	0.003	ppm
Iron	2.0	ppm
Manganese	0.07	ppm
Magnesium	2.0	ppm
Potassium	2.0	ppm
Sodium	2.0	ppm
Strontium	0.03	ppm
Titanium	0.3	ppm

The results of the water sample are listed as follows:

Silver	0.004	ppm
Copper	3.0	ppm
Lead	3.0	ppm
Zinc	0.13	ppm

The major constituent of the creek silt sample was silica.

CONCLUSIONS

So far there has been no visible signs of mineralization in any of the outcrops except for Outcrop #6 which exhibited leached out sulfides throughout. There were very few outcroppings visible on the property, except for False Tooth Hill which consisted of many very small outcroppings.

The countless hours spent prospecting were most often disappointing. The area is well covered with glacial till and overburden. Because of this, the bedrock is rarely ever visible.

The property is too well covered with overburden for simple, inexpensive prospecting techniques. Many of the creeks never receive enough velocity to cut through the humus to the sand and gravel. Prospecting could be conducted with electromagnetics to permeate the dense overburden.

TRAVEL EXPENSES (continued)

- forward -

\$ 1,049.97

May 21-25, 1981

Travelling cost from New Westminster to Princeton to ORB Claims return to New Westminster: Esso Gas

Total Cost

54.17

July 5-6, 1981

Travelling expenses from New Westminster to Princeton to ORB Claims return to New Westminster: Pay Less Gas \$14.60; Mohawk Gas, \$10.00.

Total Cost

24.60

July 5-6, 1981

For travelling costs from New Westminster to Princeton to ORB Claims return to New Westminster. Pay Less Gas, \$14.25, Mohawk, \$10.00.

Total Cost

24.25

July 20-23, 1981

Travelling expenses for New Westminster to Princeton to ORB Claims return to New Westminster. Texaco \$18.90; Imperial Oil, \$15.00

Total Cost

33.34

August 25-28, 1981

Travelling expenses from New Westminster to ORB Claims to Princeton return to New Westminster. Mohawk Oil, \$18.90.

Total Cost

18.90

Sept. 3-7, 1981

Travelling costs from New Westminster to Princeton to ORB Claims to return to New Westminster. Mohawk Gas, \$ 6.00; Mohawk Gas, \$18.75.

Total Cost

24.75

One only American Motors Car, Type Eagle, 4-wheel Drive for driving back roads, etc. - Total Cost

Three monthes useage for 1981

2700.00

TOTAL COST OF EXPENSES

\$3929.98

ACCOMMODATION

December 30-January 2, 1981

Four days, \$ 34.00 per night, plus meals
Sandman Motel, Princeton

Total Cost \$ 246.90

January 5-21, 1981

Sixteen days, \$ 24.00/night, plus meals
(Special Rate)

391.88

Feb 2-8, 1981

Seven days, \$ 22.00/night, plus means

213.70

Feb. 9-15, 1981

Seven days, \$ 22/night, plus means

178.18

April 12-14/81

Two days, \$ 24/night, plus tax

60.70

May 14, 1981

Two days, \$ 24.00/night

51.00

May 21-25, 1981

Five nights, \$26.50/night, plus meals

198.70

July 5-6/81

Two nights, \$34.00/night

72.44

July 20-24/81

Four nights, \$36.74/night, plus meals

149.49

Sept. 4-7, 1981

Four days, \$ 36.47/night, plus meals

172.44

TOTAL COST ACCOMMODATION

\$ 1,735.43

TOTAL WAGES

December 31/80 -January 2/81

2 men @ \$7.00/hour, 20 hours
Prospecting
(Tod Proskin, Ivan Peterson)

Total Cost \$ 280.00

February 2-8, 1981

2 men @ \$12.00/hour, 48 hours
Allocation of drill holes preparing for
percussion drill
(Tod Proskin, Ernst Wedekind)

Total Cost 1,152.00

February 9-15, 1981

1 man @ \$12.00/hour, 56 hours
Labor
(Tod Proskin)

Total Cost 672.00

April 12-14, 1981

1 man @ \$20/hour, 20.5 hours
Blasting
(Linda Bennet)

Total Cost 410.00

April 12-14, 1981

1 man, 16 hours
Blasting Assistant

Total Cost 100.00

May 14-16, 1981

2 men, 25 hours @ \$12/hour
(Tod Proskin, Ernst Wedekind)

Total Cost 600.00

May 21-25, 1981

1 man, @ \$12/hour, 48 hours
Drilling, prospecting and road repair

Total Cost 576.00

- forward -

\$ 3,790.00

~~for~~ ✓

TOTAL WAGES (continued)

- forward -

\$ 3,790.00

July 21-23, 1981

2 men @ \$12/hour, 30 hours
Geophysical prospecting

Total Cost

768.00

Sept. 3-7, 1981

2 men, @ \$12/hour, 46 hours
Percussion drilling
(Tod Proskin, Ernst Wedekind)

Total Cost

1,064.00

TOTAL WAGES PAID

\$ 5,622.00

INSTRUMENT RENTAL

December 30, 1980 - January 3, 1981

Five days, VLF-2 E.M. Rental from Phoenix
Geophysics Ltd. @ \$ 22/day \$ 110.00

Dec. 30, 1980- Jan. 3, 1981

Five days, Scintrex Fluxgate Magnetometer
Rental from Glen White Geophysics @ \$30/day 150.00

January 4-18, 1981

Fourteen days, VLF-2 EM
Rental from Phoenix Geophysics Ltd. @ \$22/day 308.00

January 4-13, 1981

Nine days,
Scintrex Fluxgate Magnetometer
Rental from Glen White Geophysics @ \$30/day 270.00

April 4-7, 1981

Three days, Back-pack Percussion Drill
Rental from Project Machinery @ \$32/day 96.00

April 11-14, 1981

Four days, Back-pack percussion drill
Rental from Project Machienry @ \$32.00/day 128.00

TOTAL INSTRUMENT RENTAL

\$ 1,062.00

GEOCHEMICAL SURVEY

49 soil samples, 49 vegetation samples from geochemical grid. ACME Analytical performed the testing. The Grid consisted of 2.4 km grid lines.

GEOPHYSICAL SURVEY

A 2.4 km gridline survey.

GEOLOGICAL SURVEY

A 2.4 km survey, Map scale 1:5000 or 1 cm = 50 metres.

PERCUSSION DRILLING

Total number of holes drilled is Ten (10) at a total of 646 M of drilling.

PROSPECTING

The total area prospected was approximately 18 km. The line cutting was approximately 3 km.

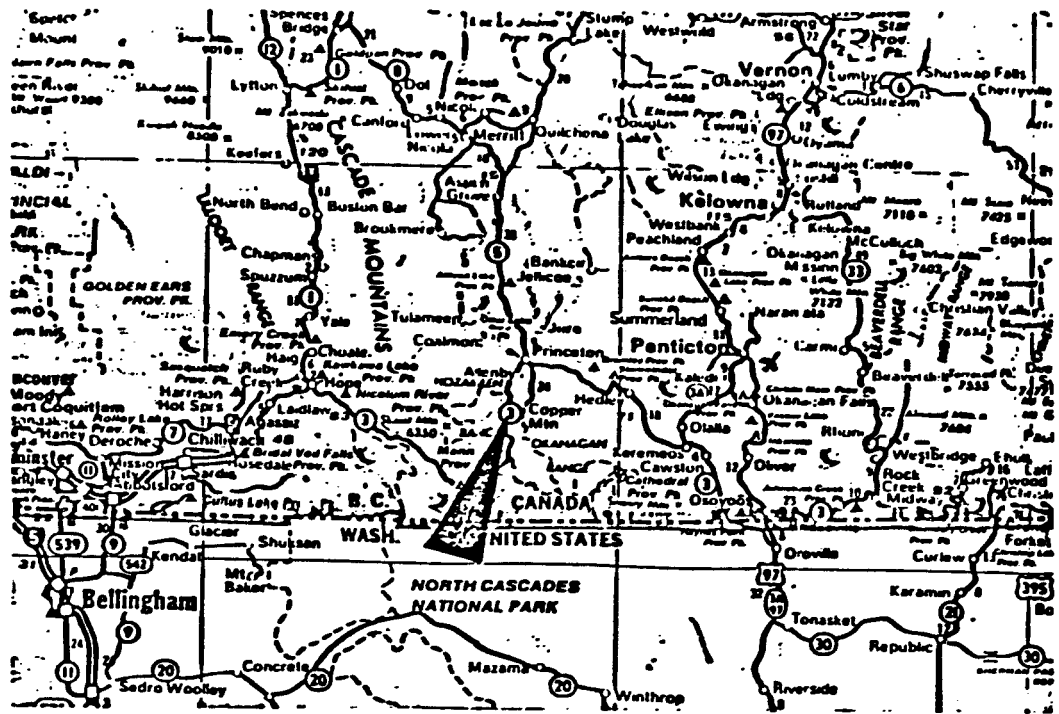

N.T.S. 92 H/7E

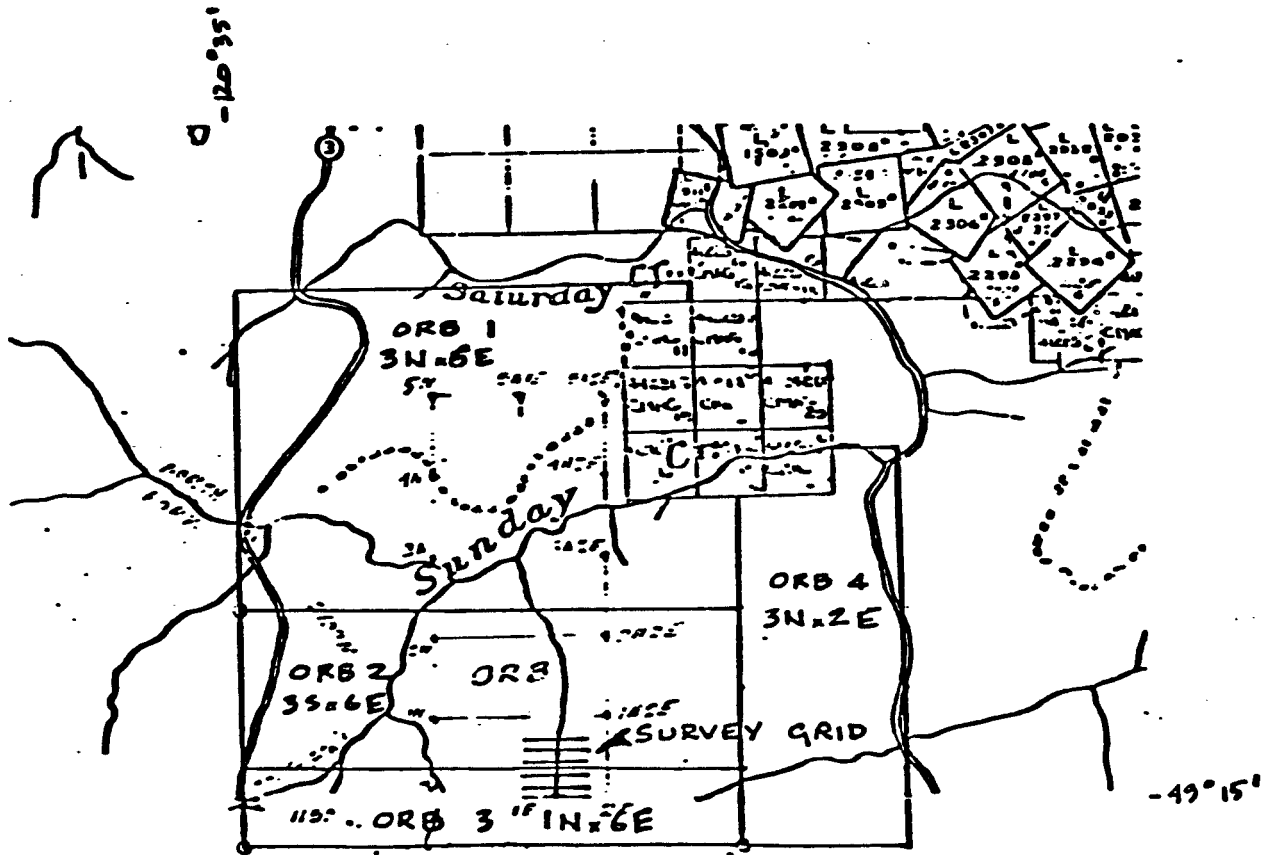

EMERALD STAR MINING EXPLORATION LTD.
 - ORB CLAIMS -
 LOCATION AND CLAIMS MAP

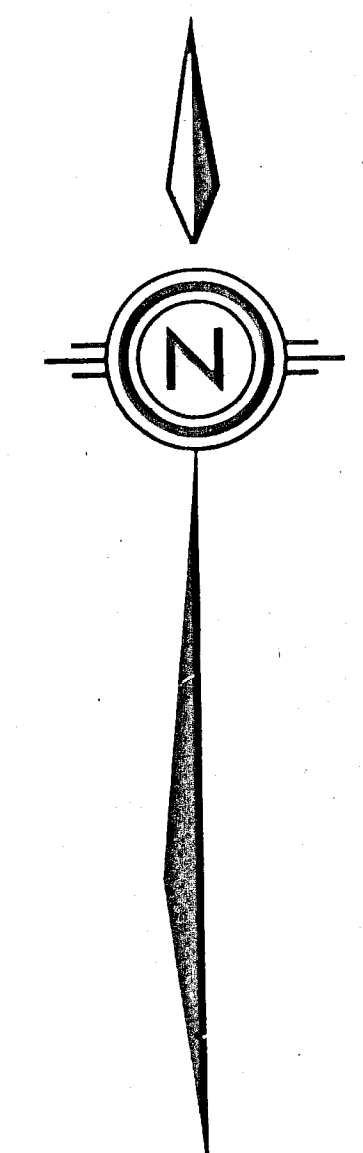
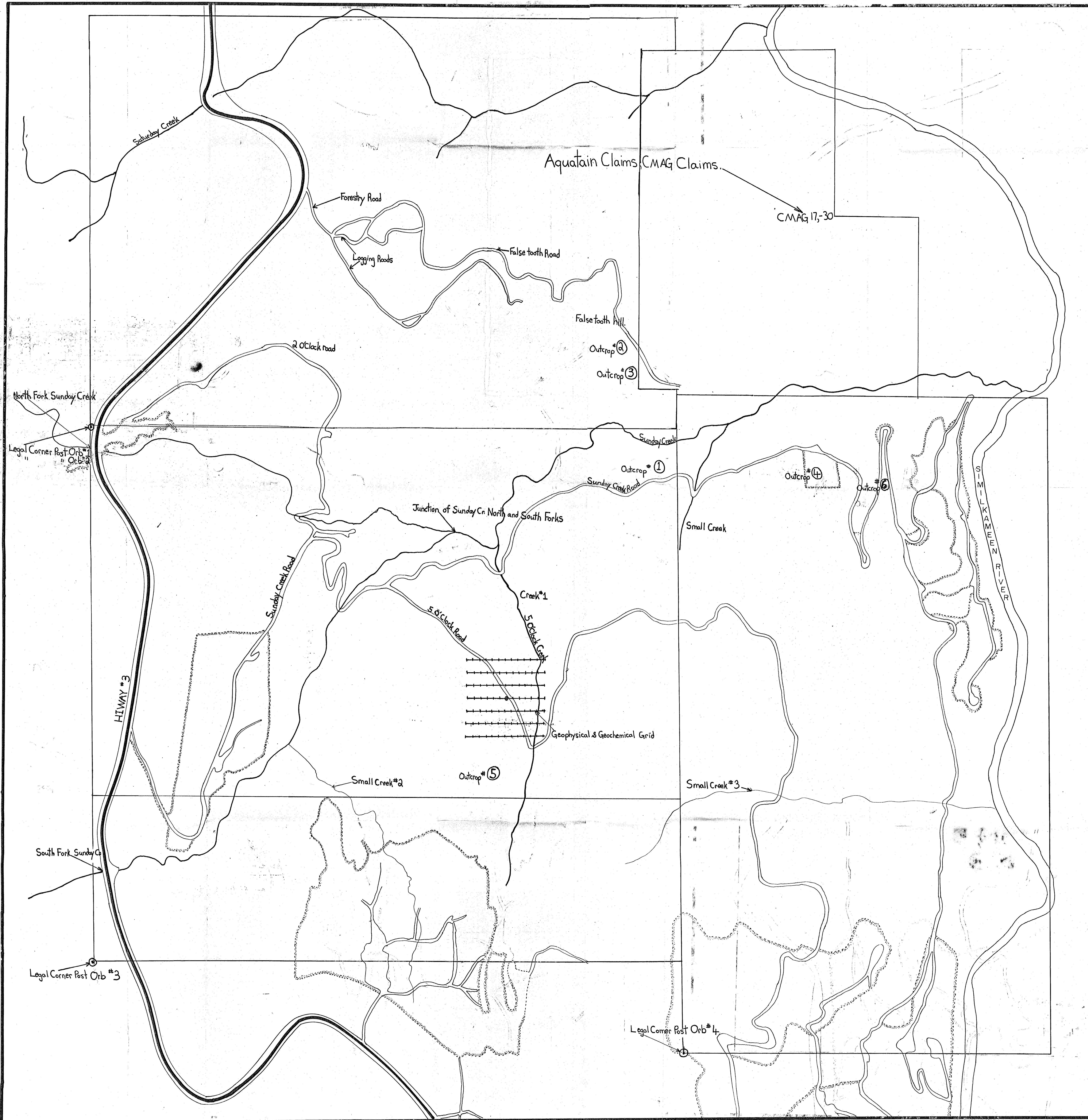

MINERAL RIGHTS OFFICE
ASSESSMENT
10,068

Part 3 of 3 Fig 2.

Emerald Star Mining Explorations
Orb Claims #1 to 4
Similkameen Mining division: BC
PROSPECTING MAP
Key 3, Map 92H7E south quadrant
Map taken from BC Government Airphoto
BC. 79030-105

Scale 1:5000.
Meters 0 50 100 150 200 250