

ASSESSMENT WORK REPORT

KELLY #1 DDH

on the  
HENNESSEY CLAIM GROUP (GC 1-5)

NICOLA LAKE AREA  
NICOLA MINING DIVISION

NTS Sheet 921/2E  
Latitude  $50^{\circ}10.8'$   
Longitude  $120^{\circ}35.9'$

GEORGE F. CRESSY  
BOX 406  
MERRITT, B. C.  
VOK 2B0

February 20, 1982.

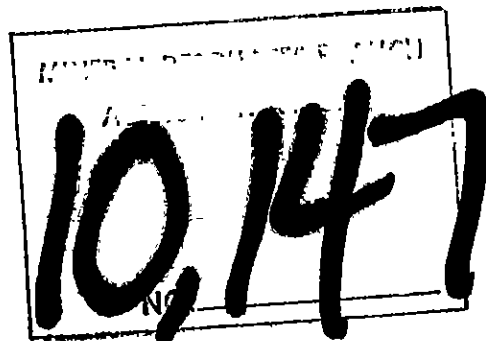

TABLE OF CONTENTS

SUMMARY OF WORK

Location and Access  
Topography and Physical Environment  
Mineral Title  
Diamond Drilling

STATEMENT OF EXPENDITURES

DRILL HOLE DATA

Drill Hole Record  
Drill Hole Logs  
Assay Report

STATEMENT OF QUALIFICATIONS

ILLUSTRATIONS

## SUMMARY OF WORK

### LOCATION AND ACCESS

The G.C. mineral claims are located on the north side of Nicola Lake some 5.5 km ENE of the settlement of Nicola. The geographic co-ordinates at the centre of the property are 50° 10.8' latitude and 120° 35.9' longitude. NTS sheet no. is 921/2E.

Access is gained via a gravel and dirt road running north, northeast and then southeast from Nicola, a distance of 11 km.

### TOPOGRAPHY AND PHYSICAL ENVIRONMENT

The claims are situated on a generally southwest facing slope of an unnamed mountain located immediately north of the western end of Nicola Lake. Elevations on the property range from 900 to 1300 m A.S.L. with the central portion of the block averaging 1150 m. The relief is generally moderate over the northern three-quarters of the area but fairly steep in the southern section overlooking the lake.

Timber cover is moderate with the predominant species being lodgepole and ponderosa pine.

The area is generally semi-arid and receives in the order of 30 cm. of annual precipitation.

### MINERAL TITLE

The property, in the Nicola Mining Division, is comprised of five unsurveyed modified grid claims totalling thirty two units, all of which are recorded in the name of George F. Cressy. The details of these mineral claims are listed below:

<u>Claim Name</u>	<u>No. of Units</u>	<u>Tag. No.</u>	<u>Record No.</u>	<u>Recording Date</u>	<u>Expiry Date</u>
G.C. 1	4	19638	75(2)	February 24, 1976	Feb. 24, 1982
G.C. 2	2	19690	298(8)	August 4, 1977	Aug. 4, 1982
G.C. 3	2	19691	299(8)	"	"
G.C. 4	8	19692	300(8)	"	"
G.C. 5	16	48955	1200(11)	November 18, 1981	Nov. 18, 1982.

DIAMOND DRILLING

One diamond drill hole. BQ core size designated Kelly #1 was drilled to a depth of 500 feet or 152.4 metres. Location on accompanying map on GC #1 claim. Drilling was carried out during the period November 4 to 20, 1981. Diamond drill core was logged and assayed by Michael J. Casselman, M. Sc.

No problems were encountered drilling to depth of 500' or (152.4 metres) and core recovery was 95% or better.

Diamond drill core is presently stored at the residence of George F. Cressy, claim owner.

STATEMENT OF EXPENDITURES

Expense Period -Starting November 4 to February 20,  
1981 - 1982.

Diamond drilling at \$20.00 per ft. or \$60.96 per metre-\$10,000.00,  
paid by George F. Cressy November 20, 1981.

Core Log and Assays paid by Comino Limited.

Kelly Property

Assaying of Diamond drill core

- Preparation	22 samples @ \$2.00/sample	\$ 44.00
- Atomic Absorption Analysis		
*Cu	- 22 samples @ 1.65/sample	36.30
*Ag	- 22 samples @ .70/sample	15.40

\* Note: Hot extraction with aque-regia

**Au	- 21 samples @ \$.00/sample	84.00
***Mo	- 1 sample @ 1.65/sample	1.65
****W	- 12 samples @ 3.25/sample	42.25

TOTAL \$ 223.60

NOTE: \*\* Solvent Extration/Atomic Absorption  
      \*\*\* Acid Extration/Atomic Absorption  
      \*\*\*\* Fusion/Colorimetric

## Drill Hole Record



Property	GC	District	Nicola Mining	Hole No.	1
Commenced	Location 1200 m N. of Nicola Lake			Tests at	Hor. Comp.
Completed	Core Size	BQ	Corr. Dip	90°	Vert. Comp.
Co-ordinates	True Brg.			Logged by M.J. Casselman	
Objective	% Recov.			Date November 23, 1981	

Claim

T Brg.

Collar Dip

Elev.

Length

Hole No.

Sheet

Footage From To	Description	Sample No.	Length	Analysis						
0 - 3	Overburden									
3 - 37	Mainly andesite tuffs, flows and tuffites: locally thin diorite and dioritized andesite zones. Foliation in andesites outlined by foliated biotite bands and grains. Biotite bands vary from 1/16 to 1/8 inch wide. Sections with biotite > 5% are tuffites and make up 60% of section. Foliation at 45° to core length. - 1/8" - 4" wide epidote bands parallel foliation and make up 10% of section. - 1/8"-1/4" quartz veins parallel foliation; 49'-69' strongest quartz vein development (50% of core length) - 1/8"-1/4" calcite veins common throughout section; parallel and cut foliation. - Disseminated to banded pyrite throughout section; bands parallel foliation; pyrite averages 1-3%, but locally up to 5-10%. Assayed: 14-20' - Andesite tuffite; 1-5% disseminated and banded pyrite. 50.5'-56' - strongly silicified andesite tuff; locally dioritized; 30% epidote bands.									
73 - 77.5	Diorite - fine to medium grained; massive to weakly foliated.									
77.5 - 93	Andesite tuffs and flows - strongly foliated (45% to core length) - Locally 1/8"-1/4" quartz and epidote veins paralleling foliation. - Minor clots and bands of pyrite; pyrite averages 1-3%, but locally up to 10-15%. - 1/8"-1/4" calcite vein throughout section; both cutting and paralleling foliation. Assayed: 82-91' - Sheared andesite tuff; 3-10% banded pyrite; 5% of section consists of quartz veins and epidote veins.									

10147







# Drill Hole Record



Colour Plot & Dips

Property	District	Hole No.	
Commenced	Location	Tests at	Hor. Comp.
Completed	Core Size	Corr. Dip	Vert. Comp.
Co-ordinates		True Brg.	Logged by
Objective		% Recov.	Date

Claim  
T Brg.  
Collar Dip  
Elev.  
Length  
Hole No.  
Sheet

Footage		Description	Sample No.	Length	Analysis				
From	To								
339	366	Strongly sheared andesite tuffite; foliation 45° to core length. - 1/8"-1/2" calcite veinlets throughout section; paralleling and cutting foliation. - 10-15% disseminated and banded pyrite. - minor disseminated chalcopryite. Assayed: 339-345 - Strongly foliated andesite tuffite; 10-15% banded pyrite. 352-364 - Strongly foliated andesite tuffite; 10-15% banded pyrite.							
366	381	Massive to moderately foliated andesite tuff or flow. - minor 1/8"-1/2" wide veinlets of calcite paralleling foliation. - 1/8"-1/2" bands of epidote paralleling foliation. - 1-5% disseminated to locally banded pyrite paralleling foliation.							
381	400	Diorite-weakly to strongly foliated; fine to medium grained; xenoliths of andesite common. - 1-5% disseminated pyrite. - 396-398- 10-15% banded pyrite paralleling foliation. Assayed: 396-398 - Diorite; 10-15% pyrite.							
400	438	Massive to moderately foliated andesite tuffs, flows and tuffites. - 1/8"-1/2" calcite veins common throughout section; parallel and cut foliation. - locally 1/8"-1/2" epidote veins. - 0-5% disseminated pyrite. - Trace disseminated chalcopryite.							

10,147

# Drill Hole Record



Property	District	Hole No.
Commenced	Location	Tests at
Completed	Core Size	Corr. Dip
Co-ordinates	True Brg.	Logged by
Objective	% Recov.	Date

Claim  
T Brg.  
Collar Dip  
Elev.  
Length  
Hole No.  
Sheet

Footage From To	Description	Sample No.	Length	Analysis
438 - 458	Dioritized andesite, moderately-strongly foliated. - 1/8"-1/2" calcite veins common; cut and parallel foliation. - locally 1/8" - 1/2" quartz veins paralleling foliation. Assayed: 438-439 foliated andesite; 10-15% banded pyrite. 442.5-447.5 -dioritized andesite; 5-15% banded pyrite. 455-458 - dioritized andesite; 1-15% banded pyrite.			
458 - 500	Andesite tuff or flow, locally dioritized; foliation cuts core at 45° or parallels core length. - 1/8"-1/2" calcite veins locally: cut and parallel foliation. - 489-498 15% of core contains 1/8"-1/2" quartz veins. Assayed: 466-470 - dioritized andesite; 5-10% disseminated pyrite. 476-481.5 - dioritized andesite; 1-5% disseminated pyrite. 488.5-491.5 - dioritized andesite; 5-10% disseminated pyrite and some thin quartz veins.			

10,147

SC GENERAL

REPORTING DATE 21 JAN 1982

SAMPLE NUMBER	FIELD NUMBER	Cu PPM	Ag PPM	Au PPB	Mo PPM	N PPM
RB1 20443	KELLY 14-20	17	<.4	<10		<2
RB1 20444	KELLY 50.5-56	28	<.4	<10		
RB1 20445	KELLY 82-91	31	<.4	<10		<2
RB1 20446	KELLY 93-100	9	<.4	<10		<2
RB1 20447	KELLY 127-131	16	<.4	<10		
RB1 20448	KELLY 159.5-163	14	1.0	<10		<2
RB1 20449	KELLY 196-198	53	<.4	<10		<2
RB1 20450	KELLY 241-245.5	7	<.4	<10		<2
RB1 20451	KELLY 272-275	35	<.4	<10	3	
RB1 20452	KELLY 303-307	2	<.4	<10		
RB1 20453	KELLY 323-328	4	<.4	<10		<2
RB1 20454	KELLY 330-332	5	<.4	<10		
RB1 20455	KELLY 332-338.5	43	<.4	<10		
RB1 20456	KELLY 339-345	4	<.4	<10		
RB1 20457	KELLY 352-364	25	<.4	<10		<2
RB1 20458	KELLY 396-398	15	<.4	<10		
RB1 20459	KELLY 438-439	67	<.4	<10		<2
RB1 20460	K 442.5-447.5	1051	.7	<10		<2
RB1 20461	KELLY 455.458	542	.8	<10		<2
RB1 20462	KELLY 466-470	42	<.4	<10		<2
RB1 20463	KELLY 476-481.5	35	<.4	<10		<2
RB1 20464	K 488.5-491.5	29	.5			

WHERE ANALYSIS REQUESTED BUT NO VALUES SHOWN, RESULTS ARE TO FOLLOW

ANALYTICAL METHODS

AU AQUA REGIA DIGESTION / SOLVENT EXTRACTION / AA  
 N PYROSULPHATE FUSION / COLORIMETRIC  
 CU AG AQUA REGIA DIGESTION / AA  
 Mo HNO3 - HClO4 / AA

JAN 22 1982

10,147

APPENDIX "B"

COMINCO LTD.

EXPLORATION

WESTERN DISTRICT

STATEMENT OF QUALIFICATIONS

I, MICHAEL J. CASSELMAN, OF THE CITY OF VERNON, BRITISH COLUMBIA, HEREBY CERTIFY:

1. THAT I AM A GEOLOGIST, RESIDING AT 14056 PONDEROSA DRIVE, VERNON, BRITISH COLUMBIA, WITH A BUSINESS ADDRESS AT 4405 - 28th STREET, VERNON, BRITISH COLUMBIA.
2. THAT I GRADUATED WITH B.Sc. AND M.Sc. DEGREES IN GEOLOGY FROM THE UNIVERSITY OF BRITISH COLUMBIA IN 1969 AND CARLETON UNIVERSITY IN 1977.
3. THAT I HAVE PRACTISED GEOLOGY WITH COMINCO LTD. FROM 1969 TO THE PRESENT.

DATED this 4th day of February, 1982 at Vernon, British Columbia.

SIGNED 

Michael J. Casselman, M. Sc.

STATEMENT OF QUALIFICATIONS

George F. Cressy, Prospector

1. Attended night school course, Prospector's Geology courses at Merritt Secondary School 1965-1966.
2. Worked under direction of Sherwin F. Kelly, P. Eng., Geophysicist and Geologist 1966-1972. Magnetic, electromagnetic, soil surveys.
3. Wrote prospectors reports exams under supervision of Mr. P. Lean, Gold Commissioner, Merritt, B.C. September, 1974.
4. Wrote prospector log and report on prospectors grant, 1975.
5. Wrote prospectors log and report on prospectors grant, 1977.
6. Continued prospecting and field exploration work, claim staking 1965 - 1982.

Respectfully submitted

*George F. Cressy*

George F. Cressy

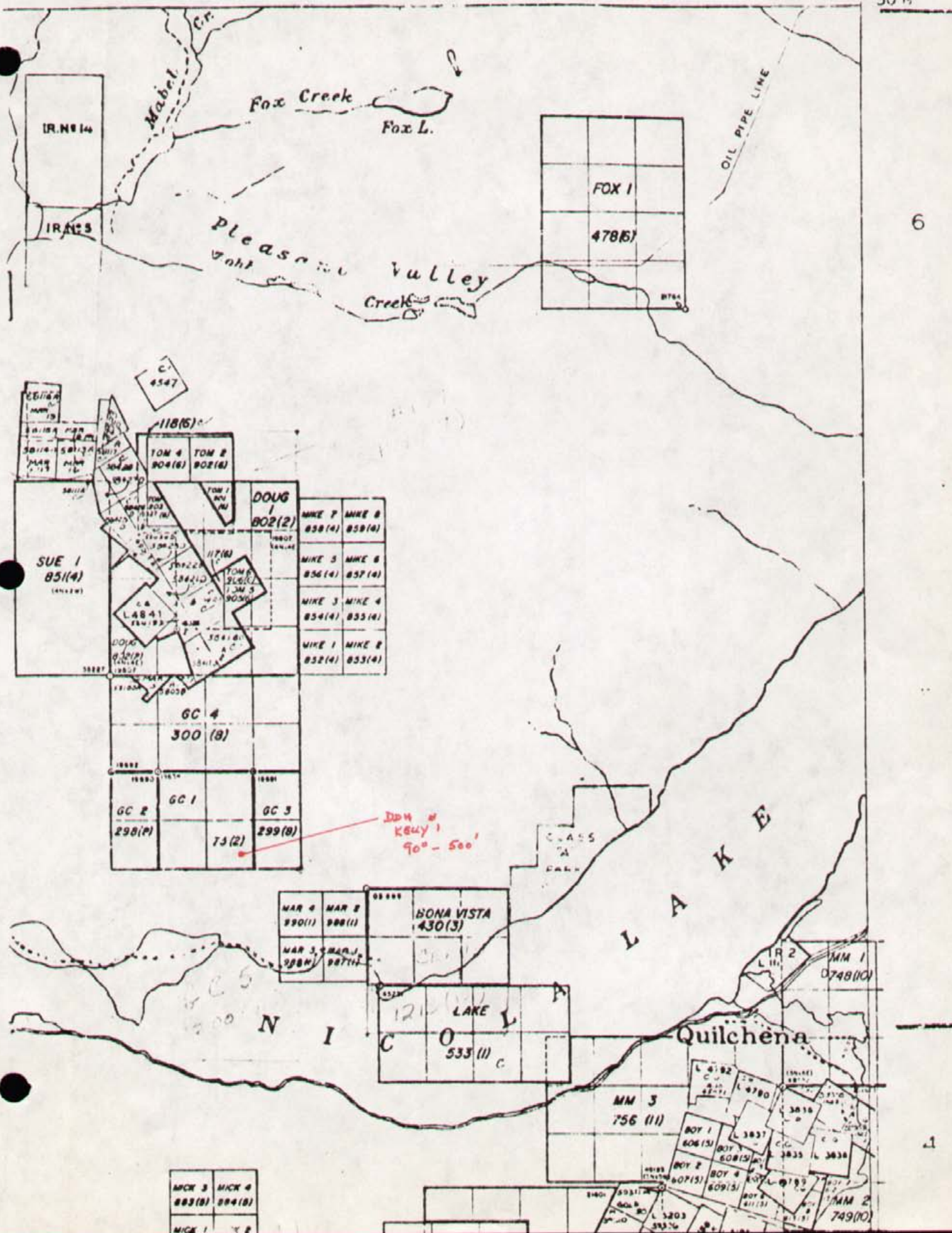

6

1

MICK 3	MICK 4
883(8)	884(8)
MICK 1	MICK 2